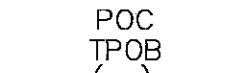
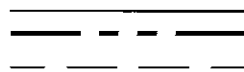

EXHIBIT B

LEGEND

- PUBLIC STREET EASEMENT ACQUIRED PARCEL "A" AREA = 266 SQUARE FEET (0.006 ACRES)
- PUBLIC STREET EASEMENT ACQUIRED PARCEL "B" AREA = 677 SQUARE FEET (0.016 ACRES)
- PROPERTY LINE/ R-O-W LINE
- SUBDIVISION BOUNDARY
- EASEMENT LINE
- POINT OF COMMENCEMENT
- TRUE POINT OF BEGINNING EXHIBIT A RECORD DATA PER PARCEL MAP NO. 5131
- RECORD DATA PER ROS NO. 10942
- RECORD DATA PER MAP NO. 12901



REFERENCES

- PARCEL MAP NO. 5131
- RECORD OF SURVEY MAP NO. 10942
- MAP NO. 12901

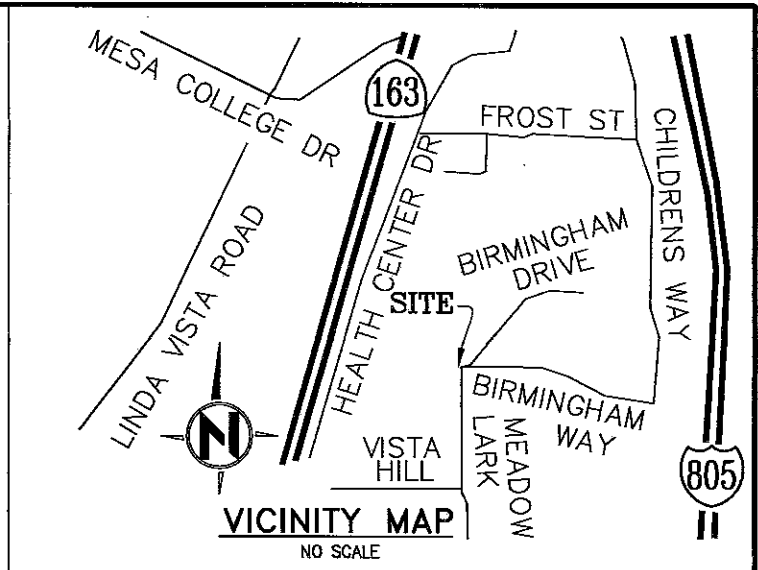

EXISTING 10'-WIDE CITY OF SAN DIEGO ELECTRICAL EASEMENT RECORDED 6-23-1976, F/P 76-195720 O.R.

EXISTING 12'-WIDE SDGE EASEMENT RECORDED 5-22-1961 IN F/P 87927, SERIES 2, BOOK 1961 O.R.

PARCEL 1 PARCEL MAP 5131

PORTION OF MEADOW LARK DRIVE DEDICATED PER MAP NO. 7664

PORTION OF MEADOW LARK DR. DEDICATED PER DOC. REC. 1/25/1962 AS DOC.# 15149, SERIES 3, BK 1962, O.R.

PORTION OF PARCEL 2 PARCEL MAP 5131



BASIS OF BEARINGS
 THE BASIS OF BEARINGS FOR THIS PLAT IS A PORTION OF THE NORTHERLY ROW OF BIRMINGHAM WAY PER MAP NO. 12901 I.E.: NORTH 89°39'00"

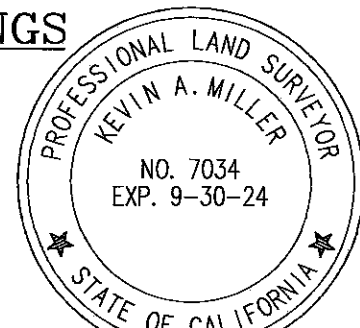

BVE
 9449 Balboa Avenue, Suite 270
 San Diego, CA 92123 (619) 299-5550

K.A.M. 11/18/22
 KEVIN A. MILLER LS 7034 DATE

DOCUMENT NO. 2023-0117919 O.R.

RECORDED MAY 5, 2023

**PUBLIC STREET EASEMENT
 MEADOW LARK DRIVE AND BIRMINGHAM DRIVE
 IN A PORTION OF PUEBLO LOT 1199, M.M. 36, AND PARCEL 1 PM 5131**

| DESCRIPTION | BY | APPROVED | DATE | FILMED | CITY OF SAN DIEGO, CALIFORNIA | PRJ NO. 1038196 |
|-------------|----|----------|------|--------|--|---------------------------------|
| ORIGINAL | | | | | SHEET 1 OF 1 SHEETS | J.O. NO. |
| | | | | | <i>Trish R. DJ</i> 5/5/2023 FOR CITY LAND SURVEYOR DATE | 1870-6281 NAD-83 COORDINATES |
| | | | | | | 230-1721 LAMBERT COORDINATES |
| | | | | | | 100057-B |
| | | | | | STATUS | |