

STREET DEDICATION / EASEMENT LEGEND

- A** PORTION OF AIRWAY ROAD DEDICATED PER DEED REC. 7/21/1897 BOOK 257, PGS. 298 & 299 OF DEEDS
- B** PORTION OF AIRWAY ROAD DEDICATED PER DEED REC. 8/08/1900 BOOK 292, PAGE 116 OF DEEDS
- C** PORTION OF AIRWAY ROAD DEDICATED PER DEED REC. 6/27/1986 AT F/P NO. 86-265324 O.R. (SEE CITY DWG. 22604-D)
- D** DRAINAGE EASEMENT RESERVED BY THE STATE OF CALIFORNIA REC. 9/20/2011 AS DOC. NO. 2011-0487205 O.R.

LINE DATA

L1	N00°52'25"E	27.36'
L2	N88°43'49"E	276.61'
L3	N00°52'41"E	60.00'
L4	N01°21'02"E	20.00'

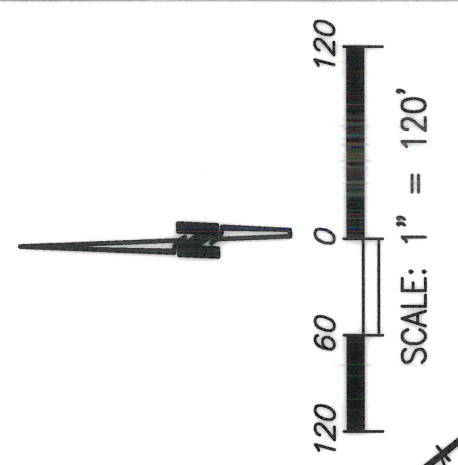

11 - SD - 905

POR. E. 1/2, N.E. 1/4, SEC. 35,
T.18S., R.1W., SBM.
DEED REC. 5/10/2013 AS DOC.
NO. 2013-0297142 O.R.

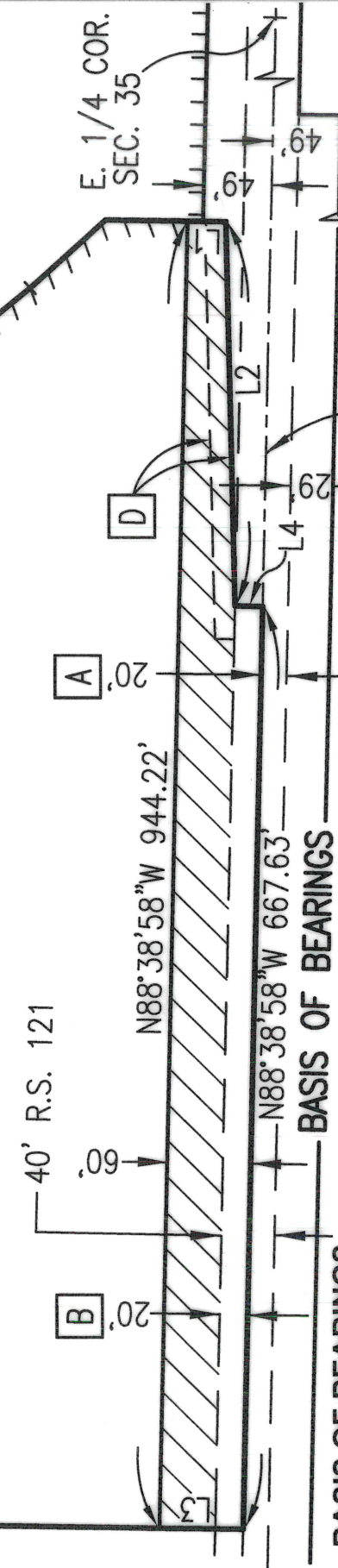

BASIS OF BEARINGS

THE BASIS OF BEARINGS FOR THIS MAP IS THE SOUTH LINE OF THE N.E. 1/4, SEC. 35, T.18S., R.1W., SBM, AS SHOWN ON R.O.S. MAP NO. 21887, I.E. N88°38'58"W.

REFERENCE DWG #

R.O.S. MAP NO. 21887
P.M. NO. 19454
22604-D, 39795-D
APN 646-121-33

LEGEND

- INDICATES PUBLIC STREET EASEMENT ACQUIRED AREA=0.827 ACRES
- ABUTTERS RIGHTS OF ACCESS RELINQUISHED PER DOC. NO. 2011-0487205 REC. 9/20/2011 O.R.
- RIGHTS OF ACCESS RESERVED PER DOC. NO. 2013-0742585 REC. 12/30/2013 O.R.

AIRWAY ROAD

PGL. 1, P.M. 19454

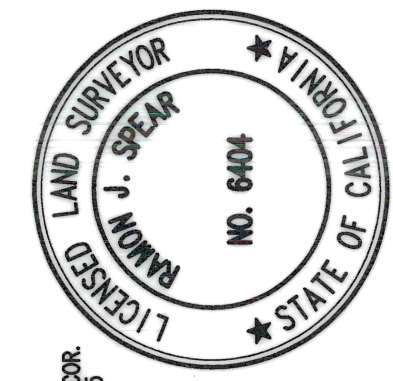
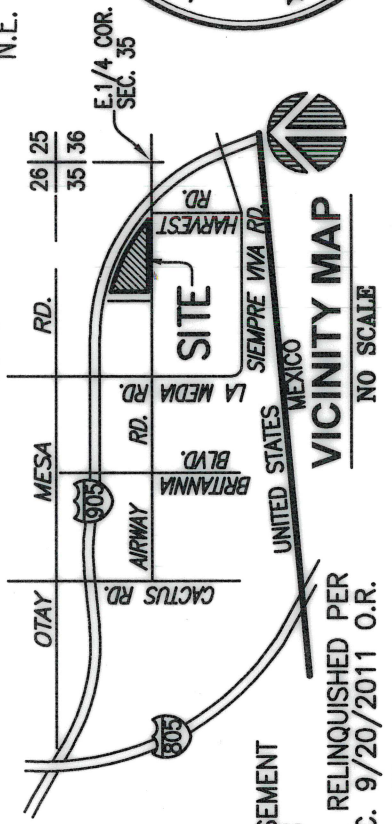

SPEAR & ASSOCIATES, INC

CIVIL ENGINEERING AND LAND SURVEYING
475 PRODUCTION STREET, SAN MARCOS, CA. 92078
PHONE (760) 736-2040 FAX (760) 716-0246

BY: 3/4/2021
DATE

DOCUMENT NO. 2021-0207674
RECORDED MARCH 17, 2021

**ROW DEDICATION - AIRWAY ROAD
SECTION 35, TOWNSHIP 18 SOUTH, RANGE 1 WEST, SBM**

DESCRIPTION	BY	APPROVED	DATE	FILMED
ORIGINAL	S&A	CED	3/10/21	

COMPLETE

STATUS

CITY OF SAN DIEGO, CALIFORNIA SHEET 1 OF 1 SHEET		PROJECT NO. 564615
FOR CITY LAND SURVEYER- ENGINEER		1782-6343 NAD83 COORDINATES
DIVISION HEAD		142-1783 LAMBERT COORDINATES
SECTION HEAD		40252-B