

LINE TABLE		
NO.	BEARING	DISTANCE
L1	N 41°43'00" W	14.61'
L2	N 79°47'37" E	4.81'
L3	S 10°12'23" E (R)	17.80'
L4	S 34°26'19" W (R)	17.80'
L5	S 42°41'45" W	12.14'

CURVE TABLE		
C1	Δ = 44°38'42"	R = 17.80' L = 13.87'

VICINITY MAP
NO SCALE

LEGEND

- () INDICATES RECORD DATA PER MAP NO. 2531
- P.O.B. INDICATES POINT OF BEGINNING
- INDICATES AREA COVERED BY THE COVENANT OF EASEMENT.
AREA = 112.7 SQ. FT./0.003 ACRE

EASEMENT NOTES

- INDICATES EXISTING VIEW CORRIDOR
- EASEMENT PER CITY DRAWING NO. 40578-B

MAP NO. 2531
BLOCK 3

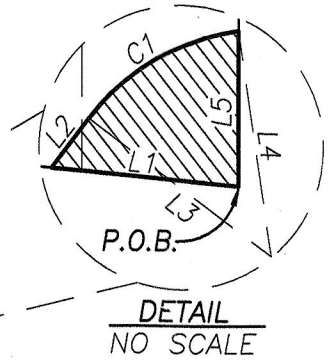
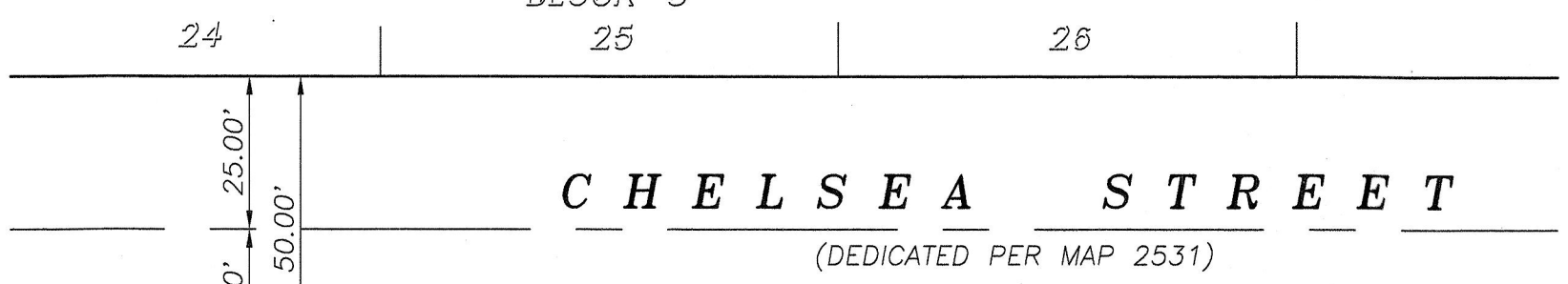

REFERENCES
MAP 2531

BASIS OF BEARING
THAT PORTION OF THE SOUTHWESTERLY RIGHT-OF-WAY LINE OF CHELSEA STREET PER MAP NO. 2531 I.E. S 47°18'15" E
A.P.N. 415-062-10

SAN DIEGO LAND SURVEYING & ENGINEERING, INC.
9665 CHESAPEAKE DRIVE, SUITE 445
SAN DIEGO, CA 92123 (858) 565-8362
Robert J. Bateman DATE: 8-1-2018
ROBERT J. BATEMAN L.S. 7046

DOCUMENT NO. 2018-0327804
RECORDED 8/9/2018

COVENANT OF EASEMENT
OVER A PORTION OF LOT 10, BLOCK 4, PACIFIC RIVIERA VILLAS UNIT NO.1, MAP NO. 2531

DESCRIPTION	BY	APPROVED	DATE	FILMED	CITY OF SAN DIEGO, CALIFORNIA	P.T.S. NO. 598034
ORIGINAL	SDLS&E			8/10/18	SHEET 1 OF 1 SHEET	
					<i>Frank R. Jr</i> 8/10/18 FOR CITY LAND SURVEYOR DATE	1874-6247 CCS 83 COORDINATES
						234-1687 LAMBERT COORDINATES
Acquired				STATUS		40579-B