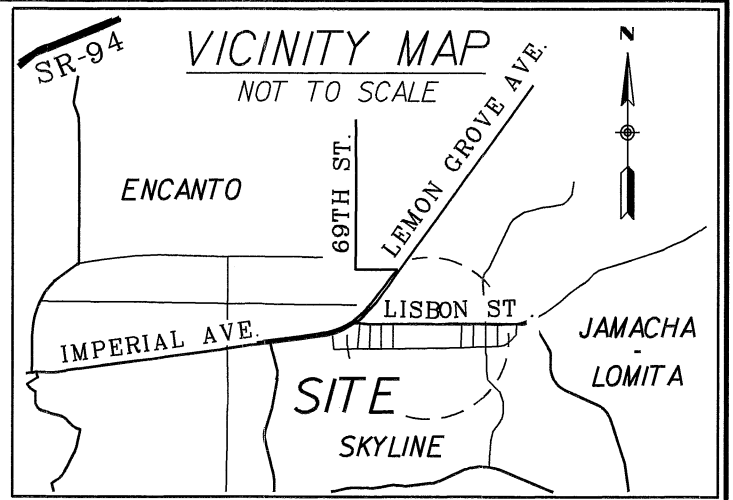
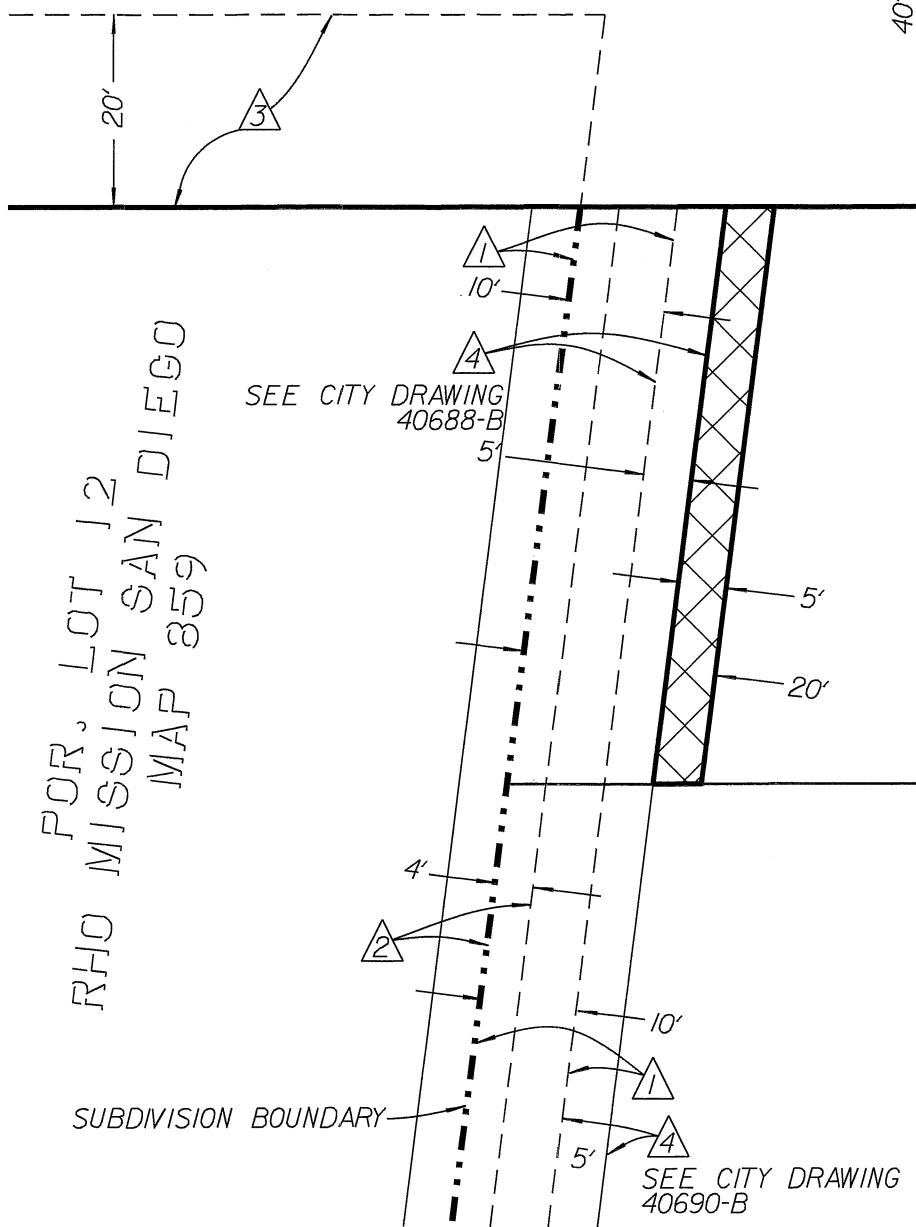

EXHIBIT "B"

OWNER:
NATALIA GONZALEZ, AN UNMARRIED WOMAN
APN 581-131-01



LISBON STREET



MAP 2675
LOT 1
APN 581-131-01
NATALIA GONZALEZ

PORTER STREET

EASEMENT NOTES

- ① 10' WIDE UNNAMED EASEMENT PER MAP NO. 2675
- ② PAC. TEL. & TELEGRAPH CO. EASEMENT PER BK. 3695, PG. 324 O. R. REC. 07/14/1950
- ③ PUBLIC STREET EASEMENT PER BK. 3446, PG. 75 O. R. REC. 01/06/1950
- ④ 5' WIDE DRAINAGE EASEMENT TO BE ACQUIRED BY SEPARATE DOCUMENT

LEGEND

INDICATES TEMPORARY CONSTRUCTION AREA TO BE ACQUIRED
AREA = 302.39 SQ.FT. (0.0069 ACRE)

BASIS OF BEARINGS

THE BASIS OF BEARINGS FOR THIS SURVEY IS THE GRID BEARING FROM GPS-1181 TO GPS-1200 PER ROS 14492; (I.E., N. 85°20'46" E.)

SCALE: 1" = 20'

CGF = 1.0000022 @ GPS 1181
MAPPING ANGLE = -0° 26' 59.08"
ELEV. = 296.63' (NGVD29)

PREPARED BY:

CITY OF SAN DIEGO PUBLIC WORKS
DEPARTMENT FIELD DIVISION - SURVEY
SECTION, UNDER THE DIRECTION OF
RICHARD T. McCORMICK, LS 7450,
SENIOR LAND SURVEYOR.



Richard T. McCormick 5-08-2018
RICHARD T. McCORMICK, LS 7450

RESOLUTION No. _____
RECORDED _____
DOCUMENT No. _____
RECORDED _____

TEMPORARY CONSTRUCTION AREA
PORTION OF LOT 1, HERMOSILLO MANOR MAP NO. 2675

DESCRIPTION	BY	APPROVED	DATE	FILMED	CITY OF SAN DIEGO, CALIFORNIA	PTS
ORIGINAL	DV		04/18		SHEET 1 OF 1 SHEET	1.0. B-13116
					<i>Richard T. McCormick 5-08-2018</i> FOR CITY LAND SURVEYOR DATE	1838-6316 CCS 83 COORDINATES
						198-1755 NAD 27 COORDINATES
						40689-B
STATUS						