

VICINITY MAP

NOT TO SCALE

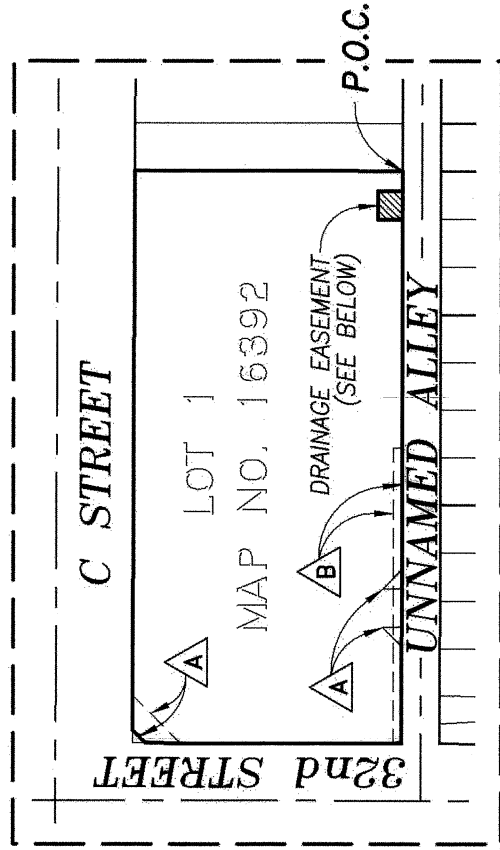

LOT 1
MAP NO. 16392

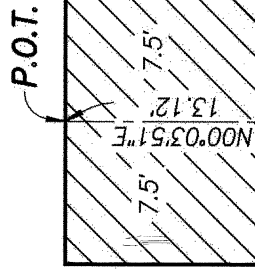

(N89°56'09\"/>

BASIS OF BEARINGS

(N89°56'09\"/>

UNNAMED ALLEY
(DEDICATED PER MAP NO. 167)

CHOATE'S

ADDITION BLOCK 124

MAP NO. 167

REFERENCES

MAP NO. 16392
CITY OF SAN DIEGO DRAWING: 41399-D

APN
539-563-01

LOT 12
MAP NO. 167

P.O.C.
SE COR. LOT 1

i.e. N89°56'09\"/>

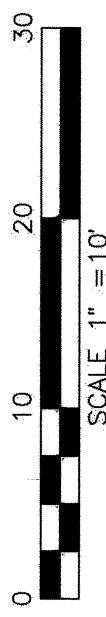

LEGEND

15.00' WIDE DRAINAGE EASEMENT ACQUIRED AREA = 197 SQ. FT., MORE OR LESS

P.O.C. INDICATES POINT OF COMMENCEMENT

T.P.O.B. INDICATES TRUE POINT OF BEGINNING

P.O.T. INDICATES POINT OF TERMINUS

() INDICATES RECORD DATA PER MAP NO. 16392

INDICATES RIGHT OF WAY LINE

INDICATES LOT LINE

INDICATES CENTERLINE

INDICATES EASEMENT LINE

EASEMENT LEGEND

EXISTING SIGHT VISIBILITY EASEMENT TO THE CITY OF SAN DIEGO PER MAP NO. 16392.

EXISTING EASEMENT FOR PEDESTRIAN AND NON-VEHICULAR USES TO THE CITY OF SAN DIEGO PER MAP NO. 16392.

THE EASEMENT HELD BY SAN DIEGO COUNTY REGIONAL AIRPORT AUTHORITY (SDCRAA) RECORDED NOVEMBER 19, 2019 AS INSTRUMENT NO. 2019-0535703, OF OFFICIAL RECORDS, HAS NO SPECIFIC LOCATION SET FORTH IN THE DOCUMENT AND IS NOT PLOTTED HEREON.

BASIS OF BEARINGS

THE BASIS OF BEARINGS FOR THIS EASEMENT IS THE SOUTHERLY LINE OF LOT 1 OF MAP 16392.

R:\1452\Map\EP 32nd & C Street Drainage Esmt Dedication SHT 01.dwg



HUNSAKER & ASSOCIATES
SAN DIEGO, INC.
9707 Waples Street (858)558-4500
San Diego, CA 92124

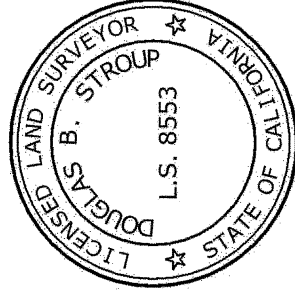

DOUGLAS B. STROUP, P.L.S. 8553

[Signature] 3/15/21
DATE

DOCUMENT No. **2021-0410871**

RECORDED **JUNE 7, 2021**

DRAINAGE EASEMENT
IN LOT 1, MAP 16392

DESCRIPTION	BY	APPROVED DATE	FILMED	STATUS
ORIGINAL	H&A			
	<i>[Signature]</i>	5/2/21		

CHOATE'S	ADDITION	BLOCK
		124
MAP NO.		167

PTS	667947
I.O.	N/A
CCS 83 COORDINATES	1840-6291
NAD 27 COORDINATES	200-1731
42004-1-B	42004-1-B

CITY OF SAN DIEGO, CALIFORNIA	
SHEET 1 OF 1 SHEETS	
FOR CITY ENGINEER	<i>[Signature]</i>
DATE	6/11/2021