

# LEGEND

- — — — — INDICATES PROPERTY LINE
- R/W — — — — — INDICATES RIGHT-OF-WAY LINE
- — — — — INDICATES CENTERLINE STREET ROW
- ////// INDICATES RELINQUISHED ACCESS RIGHTS PER MAP 4802 TO BE REVESTED
- ( ) INDICATES RECORD DATA PER PM 9284
- (#) INDICATES PLOTTABLE EASEMENT
- [#] INDICATES NON-PLOTTABLE EASEMENT

# REFERENCE DRAWINGS

MAP NO. 4802, PARCEL MAP NO. 9284, PARCEL MAP NO. 18116

# ASSESSORS PARCEL NUMBER

361-661-12-00

# BASIS OF BEARINGS

THE BASIS OF BEARINGS FOR THIS PLAT IS THE EASTERLY LINE OF PARCEL 1 OF PARCEL MAP 9284.  
 I.E. NORTH 23°29'20" WEST

# EASEMENT LEGEND

4. PUBLIC UTILITY EASEMENT SHOWN OR DEDICATED ON THE MAP FILED OR RECORDED JUNE 27, 1961 AS MAP NO. 4802
5. ABUTTER'S RIGHTS OF INGRESS AND EGRESS TO OR FROM GENESEE AVENUE, HAVE BEEN DEDICATED OR RELINQUISHED ON THE FILED MAP RECORDED JUNE 27, 1961 AS MAP NO. 4802, FILE NO. 110303 O.R.
6. SDG&E EASEMENT FOR PUBLIC UTILITIES, RECORDED SEPTEMBER 06, 1961 AS FILE NO. 154915 O.R.
7. SDG&E EASEMENT FOR PUBLIC UTILITIES, RECORDED JANUARY 31, 1962 AS FILE NO. 18128 O.R.
8. PACIFIC TELEPHONE AND TELEGRAPH CO. EASEMENT FOR PUBLIC UTILITIES, RECORDED FEBRUARY 28, 1962 AS FILE NO. 34431 O.R.
9. EASEMENT TO G. M. SHUMAKER AND LESLIE EADE FOR INGRESS AND EGRESS, RECORDED SEPTEMBER 06, 1963 AS FILE NO. 159149 O.R. THE EXACT LOCATION OF THE EASEMENT CANNOT BE DETERMINED FROM RECORD INFORMATION.
10. SDG&E EASEMENT FOR PUBLIC UTILITIES, RECORDED FEBRUARY 16, 1970 AS FILE NO. 27851 O.R.
12. SDG&E EASEMENT FOR PUBLIC UTILITIES, RECORDED JUNE 03, 1971 AS FILE NO. 116389 O.R.
13. SDG&E EASEMENT FOR PUBLIC UTILITIES, RECORDED MAY 07, 1974 AS FILE NO. 74-118246 O.R. THE LOCATION OF THE EASEMENT CANNOT BE DETERMINED FROM RECORD INFORMATION.
15. SDG&E EASEMENT FOR PUBLIC UTILITIES AND INCIDENTAL PURPOSES, RECORDED MARCH 12, 1981 AS FILE NO. 81-075379 O.R. THE LOCATION OF THE EASEMENT CANNOT BE DETERMINED FROM RECORD INFORMATION.

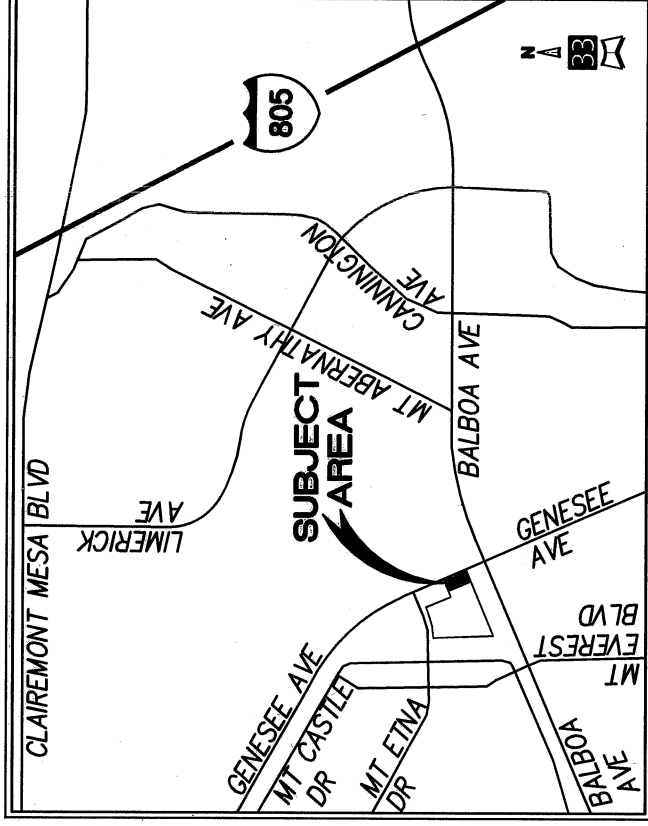

# VICINITY MAP

NO SCALE

**latititude**  
 PLANNING & ENGINEERING

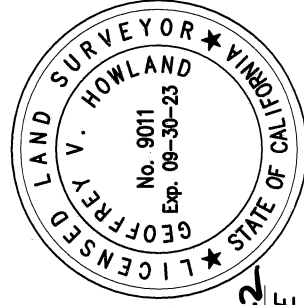

*Geoffrey V. Howland*  
 GEOFFREY V. HOWLAND PLS 9011  
 REGISTRATION EXPIRES 09-30-23  
 DATE 6/10/2022

DOCUMENT NO.: 2022-0259162  
 RECORDED: JUNE 13, 2022

# REVESTMENT OF ACCESS RIGHTS

IN A PORTION OF GENESEE AVENUE DEDICATED PER BK. 6970, PG. 57 OF O.R.

DESCRIPTION	BY	APPROVED	DATE	FILMED	PTS NO.
ORIGINAL	LAT33				686586
					I.O. NO. N/A
					1878 - 6273
					CCS '83 COORDINATES
					238-1713
					LAMBERT COORDINATES
					42326-1-B
					STATUS

CITY OF SAN DIEGO, CALIFORNIA  
 DEVELOPMENT SERVICES DEPARTMENT  
 SHEET 1 OF 3 SHEETS

*Frederick R. King*  
 FOR LAND SURVEYOR  
 DATE 6/20/2022



