

LEGEND

- INDICATES MAP BOUNDARY
- P.O.B. INDICATES POINT OF BEGINNING
- T.P.O.B. INDICATES TRUE POINT OF BEGINNING
- [Cross-hatched box] INDICATES ACCESS & WATER EASEMENT ABANDONED
 PARCEL 1 0.076 ACRES PARCEL 4 0.002 ACRES
 PARCEL 2 0.020 ACRES PARCEL 5 0.089 ACRES
 PARCEL 3 0.002 ACRES PARCEL 6 0.090 ACRES
- [Diagonal-hatched box] INDICATES ACCESS & WATER EASEMENT ACQUIRED
 PARCEL A 0.002 ACRES
 PARCEL B 0.002 ACRES
 PARCEL C 0.002 ACRES
 PARCEL D 0.005 ACRES

BASIS OF BEARING

THE BASIS OF BEARING FOR THIS DRAWING IS THE EASTERLY LINE OF LOT 4 AS SHOWN ON PALM PROMENADE MAP NO. 13071
 I.E. N11°37'00"E

REFERENCE DRAWINGS

MAP NO. 13071	27249-D	27203-D
PARCEL MAP NO. S 17082 & 17530	27281-D	18144-B
MISCELLANEOUS SURVEY NO. 772	17682-B	27756-D
		29290-D

ASSESSOR'S PARCEL NO. S

631-041-02	631-041-04
631-041-03	631-042-02

OWNER

AMC REALTY, INC.

ACQUISITION
 REC. 8-9-2000
 DOC. 2000-042122

SURVEYOR OF WORK

Robert G. Schoettmer 4-11-00
 ROBERT G. SCHOETTNER, LS 4324 DATE



COURSE TABLE

NO.	BEARING	DISTANCE
L1	N11°37'00"E	10.00
L2	N78°23'00"W	10.00
L3	N78°23'00"W	26.00
L4	N11°37'00"E	30.00
L5	N11°37'00"E	8.23
L6	N11°37'00"E	7.06
L7	N31°45'00"E	3.13
L8	N78°23'00"W	8.92
L9	N72°10'05"W	10.00
L10	N17°49'55"E	20.00

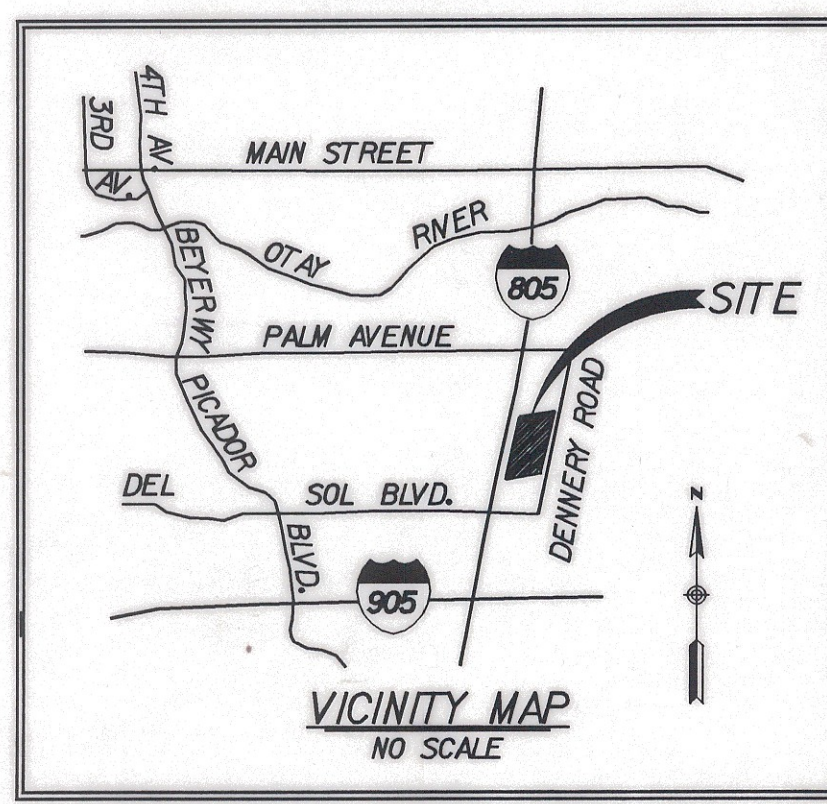
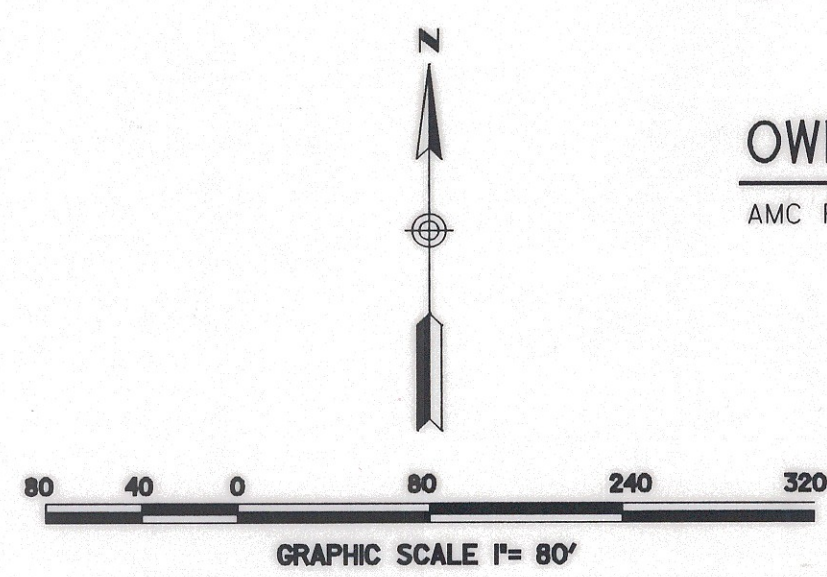

EXISTING WATER AND ACCESS EASEMENT GRANTED TO THE CITY OF SAN DIEGO PER DEED REC. NOVEMBER 4, 1999 AS FILE NO. 1999-0737459 O.R. (CITY DWG NO. 27756-D)

EXISTING WATER AND ACCESS EASEMENT GRANTED TO THE CITY OF SAN DIEGO PER DEED REC. NOVEMBER 4, 1999 AS FILE NO. 1999-0737459 O.R. (CITY DWG NO. 27756-D)

RESOLUTION R-294100
 ADOPTED ON NOVEMBER 14, 2000
 F/P 2000-0638262
 RECORDED ON NOVEMBER 22, 2000

DOCUMENT NO. **F-782P**
 FILE **08-07-00**
 OFFICE OF THE CITY CLERK
 SAN DIEGO, CALIFORNIA

RICK ENGINEERING COMPANY
 5620 Friars Road,
 San Diego,
 California 92110-2596
 (619) 291-0707

J-13121			
ACCESS & WATER EASEMENT IN LOTS 4, 5 & 6 OF PALM PROMENADE MAP NO. 13071			
ACCESS & WATER EASEMENT ABANDONMENT IN LOTS 3, 4, 5, & 6, ALL OF PALM PROMENADE MAP NO. 13071			
CITY OF SAN DIEGO, CALIFORNIA PLANNING AND DEVELOPMENT REVIEW SHEET 1 OF 1 SHEETS			W.O. NO. 980323
<i>Robert G. Schoettmer</i> FOR CITY ENGINEER		DATE 6/15/00	
DESCRIPTION	BY	APPROVED	DATE FILMED
ORIGINAL	<i>DT</i>	<input checked="" type="checkbox"/>	FEB 13 '01 FEB 13 '01
			1788-6317 NAD 83 COORDINATES
			148-1757 LAMBERT COORDINATES
COMPLETED			00033-C