

LEGEND:

INDICATES PORTIONS OF CAMPUS POINT DRIVE AND GENESEE AVENUE DEDICATED TO PUBLIC USE FOR ROAD PURPOSES.

PARCEL B1 = 0.262 ACRES
PARCEL B2 = 0.088 ACRES

INDICATES STREET DEDICATION GENESEE AVENUE.

PARCEL A = 0.074 ACRES
PARCEL C = 0.052 ACRES
PARCEL D1 = 0.001 ACRES
PARCEL D2 = 0.070 ACRES

BASIS OF BEARINGS:
THE NAD83, ZONE 6 GRID BEARING BETWEEN CITY OF SAN DIEGO CONTROL MONUMENTS 251 AND 252 PER ROS 14492.
BEARING: N 01°24'38" E

REFERENCE DRAWINGS:
30909-D, 17993B, 25856D, 11533CD, PM 10410, PM 16242, MAP NO. 9303, CITY DWG. NO. 17993-B

ASSESSOR'S PARCEL NUMBERS:
343-230-05,06 & 343-160-06,26

STREET DEDICATION PER C5
F/P: 1996-0020902, O.R.
RECORDED 01/16/1996

PORTION OF STREET RESERVATION CAMPUS POINT DRIVE PARCEL "B" PER DOC. RECORDED 4/02/1993 FILE 1993-0206214 O.R. TO REMAIN RESERVED.

PORTION OF STREET RESERVATION CAMPUS POINT DRIVE PARCEL "B" PER DOC. RECORDED 4/02/1993 FILE 1993-0206214 O.R. DEDICATED TO PUBLIC USE FOR ROAD PURPOSES.

STREET LIMITS
STREET DEDICATION PER RESOLUTION 187507, RECORDED 06/14/1966 F/P: 97708, SERIES 7, BOOK 1965, O.R.

CURVE TABLE			
CURVE	RADIUS	LENGTH	DELTA
C1	2349.00'	629.41'	15°21'08"
C2	2471.00'	293.32'	06°48'05"
C3	1993.00'	48.57'	01°23'47"
C4	807.00'	161.06'	11°26'06"
C5	2469.00'	205.73'	04°46'27"
C6	2460.00'	412.76'	09°36'49"
C7	20.00'	29.21'	83°40'22"
C8	20.00'	25.67'	73°31'53"
C9	1900.00'	220.87'	06°39'38"
C10	20.00'	34.23'	98°03'13"
C11	1151.00'	100.35'	04°59'43"
C12	20.00'	34.32'	98°19'17"
C15	444.00'	202.57'	26°08'28"
C16	90.00'	37.11'	23°37'35"
C17	210.00'	47.77'	13°01'58"
C18	458.00'	231.54'	28°57'55"
C19	807.00'	14.08'	01°00'00"
C20	458.00'	295.78'	37°00'09"
C21	20.00'	4.73'	13°32'33"
C22	20.00'	20.94'	59°59'20"
C23	458.00'	295.78'	37°00'09"

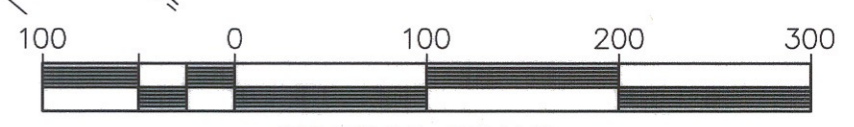

CONVERGENCE ANGLE AT MONUMENT 252 = -0°32'15.79"

LINE TABLE		
LINE	DIRECTION	DISTANCE
L1	N48°05'08"W	83.04'
L2	N27°37'48"W	551.10'
L3	N32°06'24"W	118.91'
L4	N27°38'03"W	194.92'
L5	N27°38'03"W	102.28'
L6	N35°20'06"W	78.31'
L7	N29°11'06"W	633.55'
L8	N27°38'03"W	256.11'
L9	N62°22'12"E	8.49'
L10	N48°05'08"W	14.14'
L11	N29°11'06"W	5.31'
L12	N33°19'14"E	2.61'

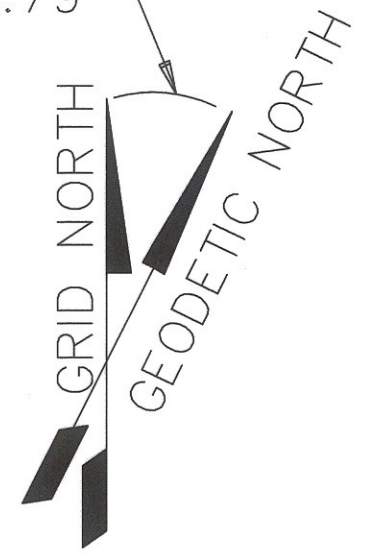

Kimley-Horn and Associates, Inc.
Engineering, Planning, and Environmental Consultants
517 Fourth Avenue, Suite 301 San Diego, California 92101
Tel. No. (619) 234-9411 Fax No. (619) 234-9433

James D. Nowlan 5-11-04
JAMES D. NOWLAN LS 4620 DATE

PROJECT 095240004
S:\DWG\09524000\DED-PLAT\SH1-1.DWG

DOC # 2006-0588671 RCD 17 AUG 2006

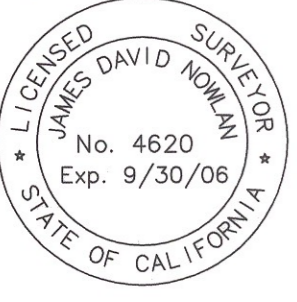

STREET DEDICATION
GENESEE AVENUE NORTHWESTERLY OF CAMPUS POINT DRIVE AND CAMPUS POINT DRIVE NORTHEASTERLY OF GENESEE AVENUE.

DESCRIPTION	BY	APPROVED	DATE	FILMED	CITY OF SAN DIEGO, CALIFORNIA	W.O. NO.
ORIGINAL				9-1-6	SHEET 1 OF 1 SHEET	119617
					<i>James D. Nowlan</i> FOR CITY ENGINEER	1880-6285 NAD 83 COORDINATES
					7-14-2004 DATE	240-1725 LAMBERT COORDINATES
				9-1-6	<i>James D. Nowlan</i> DIVISION HEAD	00047-C
					7-14-07 DATE	
					<i>James D. Nowlan</i> SECTION HEAD	

DEDICATED STATUS