

CARMEL DEL MAR NEIGHBORHOOD 5
 UNIT NO. 11
 MAP NO. 12440

LEGEND

- INDICATES SEWER AND WATER EASEMENT GRANTED PER MAP NO. 12984, VACATED
- R/W INDICATES RIGHT-OF-WAY
- P INDICATES PROPERTY LINE

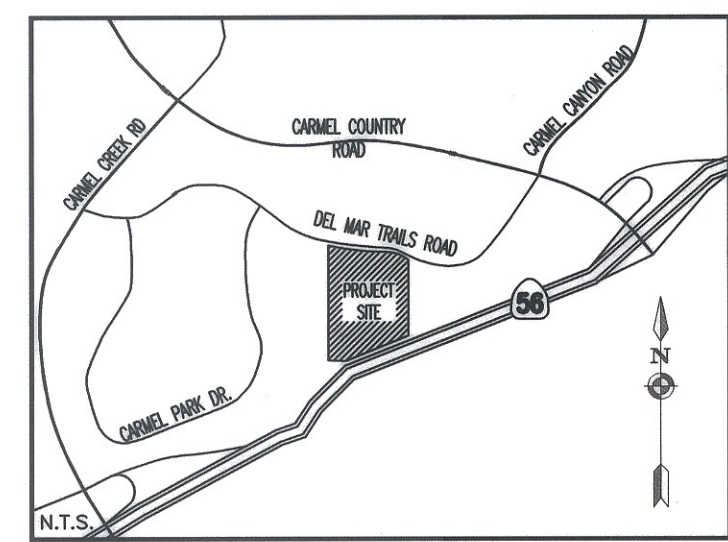

VICINITY MAP
 NO SCALE

ASSESSOR'S PARCEL NUMBER 307-040-72

REFERENCE MAPS
 CARMEL DEL MAR NEIGHBORHOOD 5 EAST UNIT NO. 12
 MAP NO. 12984

ENGINEER OF WORK:
BDS ENGINEERING, INC.
 CIVIL ENGINEERING
 LAND SURVEYING
 6859 Federal Boulevard
 Lemon Grove, California 91945
 (619) 582-4992
 DWG. FILE L:\PROJECTS\02-21\ENGR
Thomas A. Jones
 SURVEYOR L.S. 6622

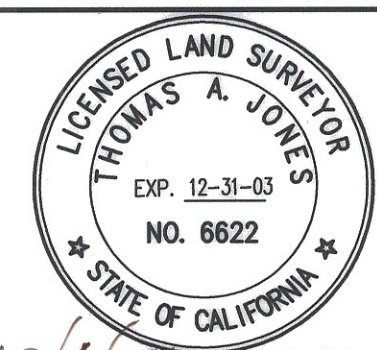

DATE 10/4/02 JOB NO. 02-21

SEWER AND WATER EASEMENT VACATION
 IN LOT 1, CARMEL DEL MAR NEIGHBORHOOD 5
 EAST UNIT NO. 12, MAP NO. 12984

CITY OF SAN DIEGO, CALIFORNIA
 DEVELOPMENT SERVICES DEPARTMENT
 SHEET 1 OF 1 SHEET
See Thomas DATE 5/8/03
 FOR CITY ENGINEER

W.O. NO. 420377
 1922-6261
 CCS 83 COORDINATES
 282-1701
 LAMBERT COORDINATES
00081-C

FILMED 1/16/15