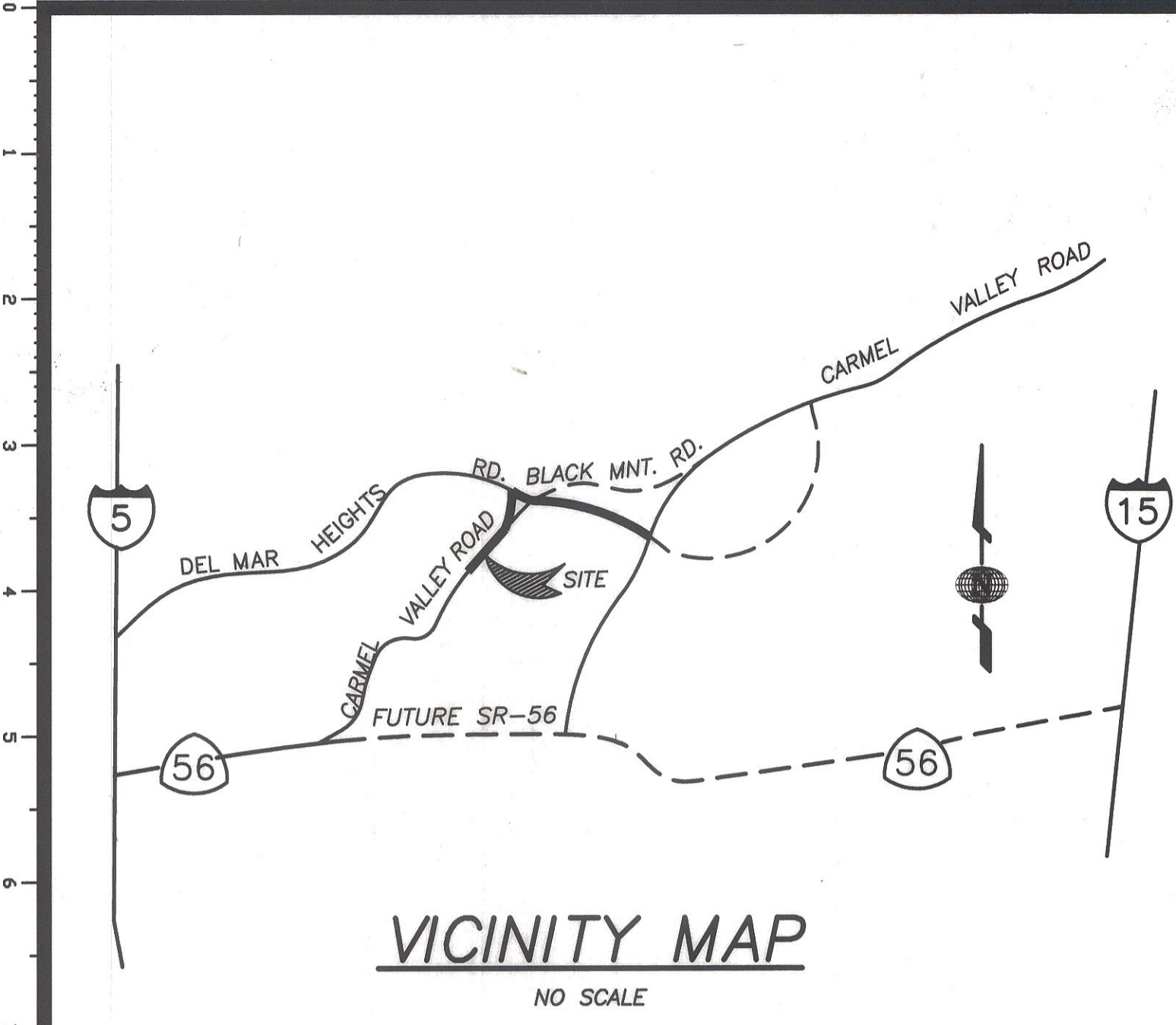

EXHIBIT 'B'



- LEGEND:**
- DENOTES PARCEL LINE
  - P.O.B.: DENOTES POINT OF BEGINNING
  - T.P.O.B.: DENOTES TRUE POINT OF BEGINNING
  - (R): DENOTES RADIAL BEARING
  - DENOTES STREET DEDICATION CARMEL VALLEY ROAD PARCEL 'A' - 0.604 ACRES PARCEL 'G' - 59.87 SQ. FT.
  - DENOTES STREET DEDICATION CARMEL VALLEY ROAD PARCEL 'B' - 0.020 ACRES
  - DENOTES STREET DEDICATION CARMEL VALLEY ROAD PARCEL 'C' - 0.060 ACRES
  - DENOTES STREET DEDICATION CARMEL VALLEY ROAD PARCEL 'D' - 0.190 ACRES
  - DENOTES STREET DEDICATION CARMEL VALLEY ROAD/DEL MAR HEIGHTS ROAD PARCEL 'E' - 0.462 ACRES
  - DENOTES STREET DEDICATION DEL MAR HEIGHTS ROAD PARCEL 'F' - 3.663 ACRES
  - (A) BLACK MOUNTAIN RD. DEDICATED 7-21-2000 AS DOC. NO. 2000-0385589 O.R. (DWG. NO. 00020-C)

**ASSESSOR'S PARCEL NUMBER:**  
 305-030-29  
 305-030-30  
 305-030-33  
 305-031-12

**REFERENCE DRAWING:**  
 PM 18971, PM 18755 AND  
 PACIFIC HIGHLANDS RANCH  
 UNIT NO. 2A, MAP NO. 14484  
 IMPROVEMENT DWG. 32262-D  
 (W.O.# 420936)  
 CITY DRAWING NO. 19466-2-B  
 CITY DRAWING NO. 00020-C  
 CITY DRAWING NO. 17908-D  
 CITY DRAWING NO. 20122-D

**Latitude 33**

**Planning and Engineering**  
 4933 Paramount Drive, 2nd Floor  
 San Diego, CA 92123  
 858-751-0633 Fax 858-751-0634



**BASIS OF BEARINGS:**  
 THE BASIS OF BEARINGS FOR THIS DRAWING IS  
 THE EASTERLY LINE OF PARCEL 2 OF PARCEL  
 MAP NO. 18755, IE: N38°25'17"E

H:\400\482.10\MAPS\PLATS\DMHR-PL01.dwg 4/7/2003 10:56:30 AM PST

*C. John Eardensohn* 4/16/03  
 C. JOHN EARDENSOHN L.S. 5278 DATE  
 (MY REGISTRATION EXPIRES 12-31-03)



**RECORDING INFO.:**  
 PAR'S "A" & "C" DOC.# 2003-0935943  
 PAR'S "B", "D", "E", "F", "G"  
 DOC.# 2003-0935868, AUGUST 4, 2003  
 JOINT USE AGREEMENT 2003-0935903, 8-4-03

**STREET DEDICATION**  
**CARMEL VALLEY ROAD AND DEL MAR HEIGHTS ROAD**  
 A PORTION OF PARCELS 2 AND 4 OF PM 18755 AND PARCELS 2 AND 3 OF PM 18971

| DESCRIPTION     | BY    | APPROVED | DATE    | FILMED   | CITY OF SAN DIEGO, CALIFORNIA<br>DEVELOPMENT REVIEW DEPARTMENT<br>SHEET 1 OF 6 SHEETS |  | W.O. NO. 420936                  |
|-----------------|-------|----------|---------|----------|---|--|----------------------------------|
| ORIGINAL        | LAT33 | K.S.     | 7/24/03 | SEP 8 03 | <i>Spet Hennes</i> 7/24/03<br>FOR CITY ENGINEER DATE                                  |  | 1930-6271<br>CCS '83 COORDINATES |
| <b>COMPLETE</b> |       |          |         |          |   |  | 290-1711<br>LAMBERT COORDINATES  |
|                 |       |          |         |          |   |  | 00088-1-C                        |