

SAN DIEGO LAND & TOWN CO'S SOUTH CHOLLAS ADD.

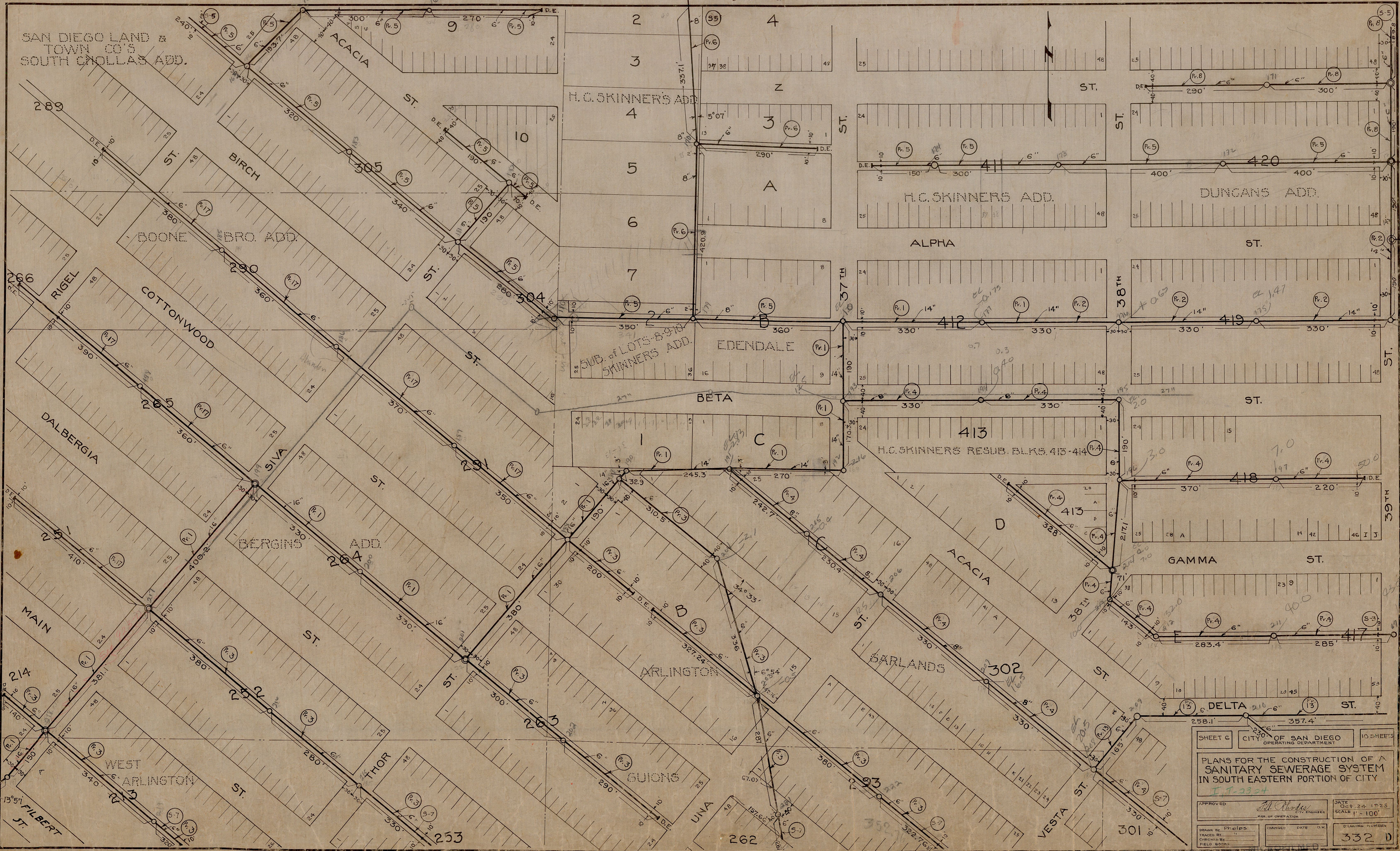

SHEET 6	CITY OF SAN DIEGO OPERATING DEPARTMENT	10 SHEETS
PLANS FOR THE CONSTRUCTION OF A SANITARY SEWERAGE SYSTEM IN SOUTH EASTERN PORTION OF CITY		
I.T. 2324		
APPROVED	<i>J.H. [Signature]</i> CITY ENGINEER	DATE Oct. 24, 1925
DRAWN BY Phelps		SCALE 1" = 100'
CHECKED BY	DATE	DRAWING NUMBER
FIELD BOOK		332 D