

CITY OF SAN DIEGO

GPS CONTROL MONUMENT DATA SHEET

Point No./Name: 202	Date: AUG 1992	See Sheet 2 for Visibility Diagram <input checked="" type="checkbox"/>
Station/Mon. Name: TORREY P/EXCHANGE	Year: UNKNOW	Agency Set By: UNKNOWN
Type of Monument: FOUND LEAD & BRASS DISK IN CONC WALK Stamped: ALLEN RCE 913	Latitude: 32-50-45.20358 Longitude: 117-16-08.04934	NAD 83 (91.35)
Elevation 51.717 * NAVD 88 (meters) Elevation 167.43 * NGVD 29 (feet) * Note: Not to be used as a City benchmark	Acc.Horiz.: 1 Order	
Acc. Vert.: NAVD88: GPS 2-II NGVD29: GPS 3-I	CCS Zone 6 Grid Coordinates NAD 83 (U.S. Feet) NAD 83 (Meters) N= 1889083.40 N= 575793.772 E= 6248732.71 E= 1904617.538	
ROS: <input type="checkbox"/> ROS Number:	Combined Factor at Station: 0.9999875	

To Station	Grid Distance	Bearing or Azimuth	G.S.F. of Line

Monument Description: NW SIDE OF TORREY PINES RD SW OF EXCHANGE PL

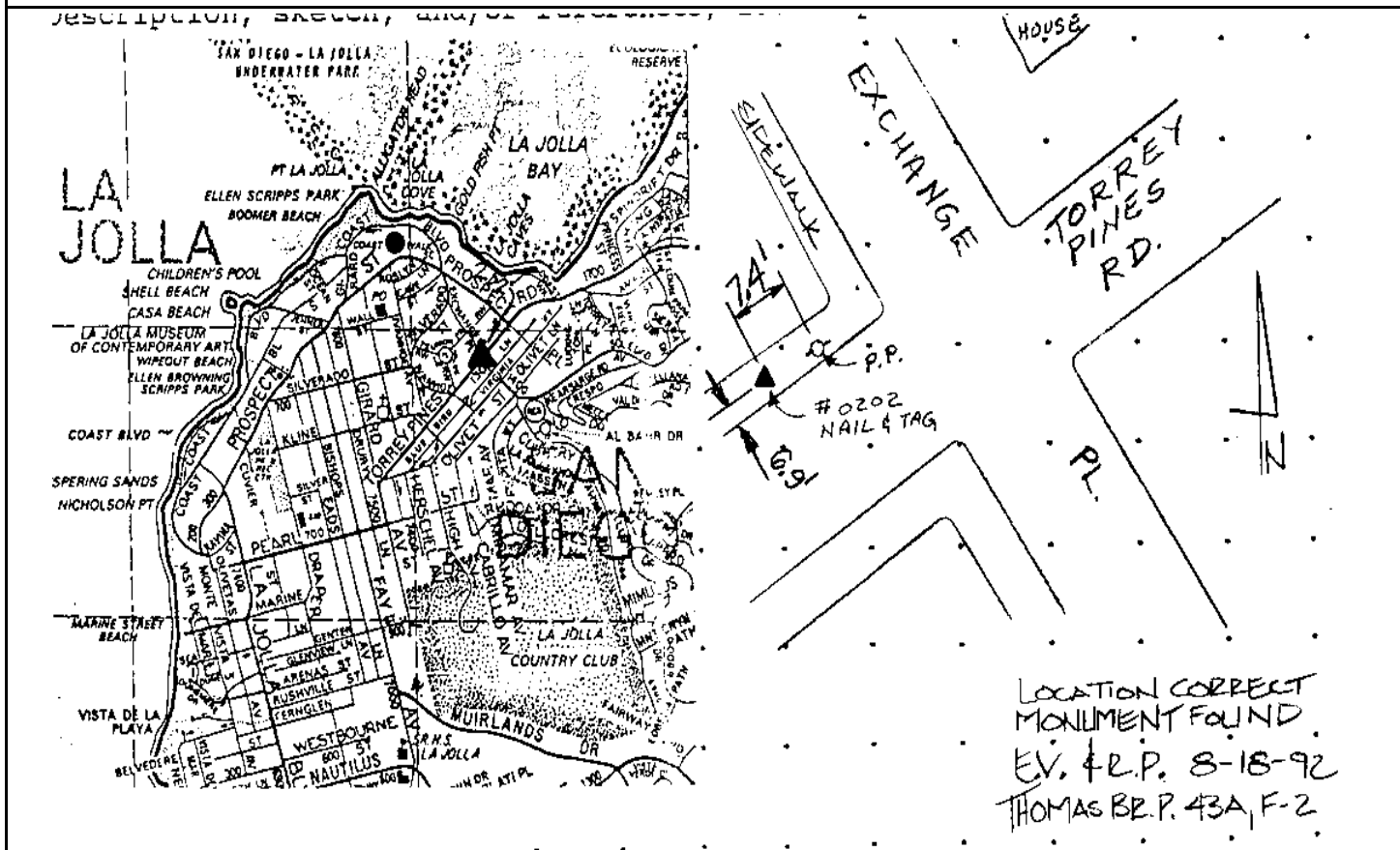

Reproduced with permission granted by THOMAS BROS. MAPS. This map is copyrighted by THOMAS BROS. MAPS. It is unlawful to copy or reproduce all or any part thereof, whether for personal use or resale, without permission.