

CITY OF SAN DIEGO

GPS CONTROL MONUMENT DATA SHEET

| | | |
|---|---|---|
| Point No./Name: 209 | Date: AUG 1992 | See Sheet 2 for Visibility Diagram <input type="checkbox"/> |
| Station/Mon. Name: SEMPRE VIVA @ ROLL | Year: UNKNOW | Agency Set By: UNKNOWN |
| Type of Monument: FOUND LEAD & BRASS DISK IN CONC WALK Stamped: LS 4324 | Latitude: 32-33-24.34546 Longitude: 116-56-15.55095 | NAD 83 (91.35) |
| Elevation 176.378 * NAVD 88 (meters) Elevation 576.62 * NGVD 29 (feet) * Note: Not to be used as a City benchmark | Acc.Horiz.: 1 Order | |
| Acc. Vert.: NAVD88: GPS 2-II NGVD29: GPS 3-I | CCS Zone 6 Grid Coordinates NAD 83 (U.S. Feet) NAD 83 (Meters) N= 1783054.92 N= 543476.226 E= 6349773.24 E= 1935414.753 | |
| ROS: <input type="checkbox"/> ROS Number: | Combined Factor at Station: 1.0000231 | |

| To Station | Grid Distance | Bearing or Azimuth | G.S.F. of Line |
|------------|---------------|--------------------|----------------|
| | | | |
| | | | |
| | | | |

Monument Description: NW SIDE OF SIEMPRE VIVA RD @ ROLL DR

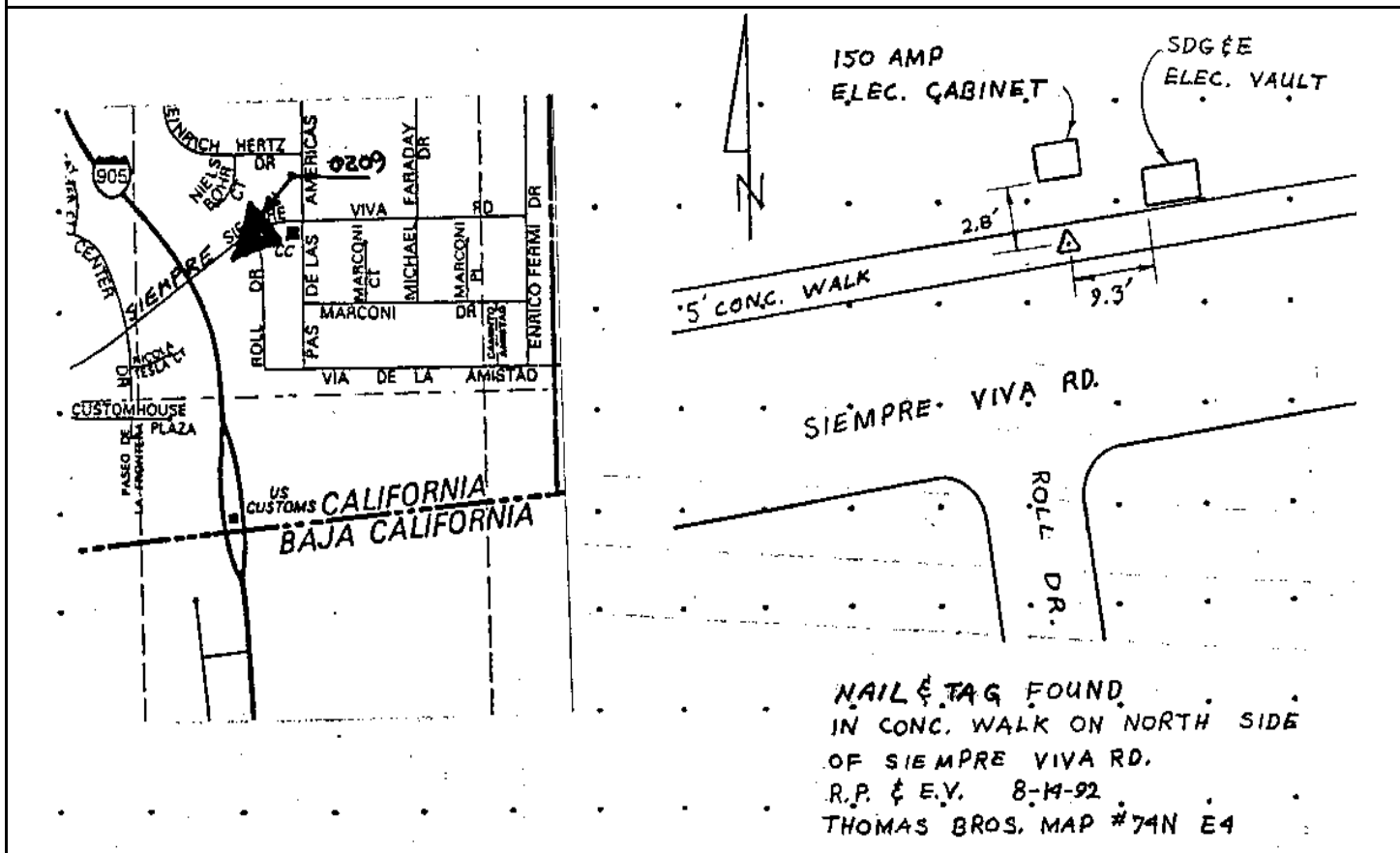

Reproduced with permission granted by THOMAS BROS. MAPS. This map is copyrighted by THOMAS BROS. MAPS. It is unlawful to copy or reproduce all or any part thereof, whether for personal use or resale, without permission.