

CITY OF SAN DIEGO

GPS CONTROL MONUMENT DATA SHEET

Point No./Name: 214		Date: AUG 1992	See Sheet 2 for Visibility Diagram <input type="checkbox"/>
Station/Mon. Name: NIMITZ & FAMOSA		Year: UNKNOW	Agency Set By: CITY SD
Type of Monument: FOUND LEAD & BRASS DISK IN CONC BRIDGE Stamped: CITY SD ENG		Latitude: 32-44-40.53585 Longitude: 117-13-59.20956	NAD 83 (91.35)
Elevation 20.774 * NAVD 88 (meters) Elevation 65.93 * NGVD 29 (feet) * Note: Not to be used as a City benchmark		Acc.Horiz.: 1 Order	
Acc. Vert.: NAVD88: GPS 2-II NGVD29: GPS 3-I		CCS Zone 6 Grid Coordinates NAD 83 (U.S. Feet) NAD 83 (Meters) N= 1852123.11 N= 564528.252 E= 6259376.63 E= 1907861.813	
ROS: <input type="checkbox"/>	ROS Number:	Combined Factor at Station: 1.0000089	
To Station	Grid Distance	Bearing or Azimuth	G.S.F. of Line

Monument Description: CENTER OF FAMOSA BL BRIDGE @ CENTER OF NIMITZ BL

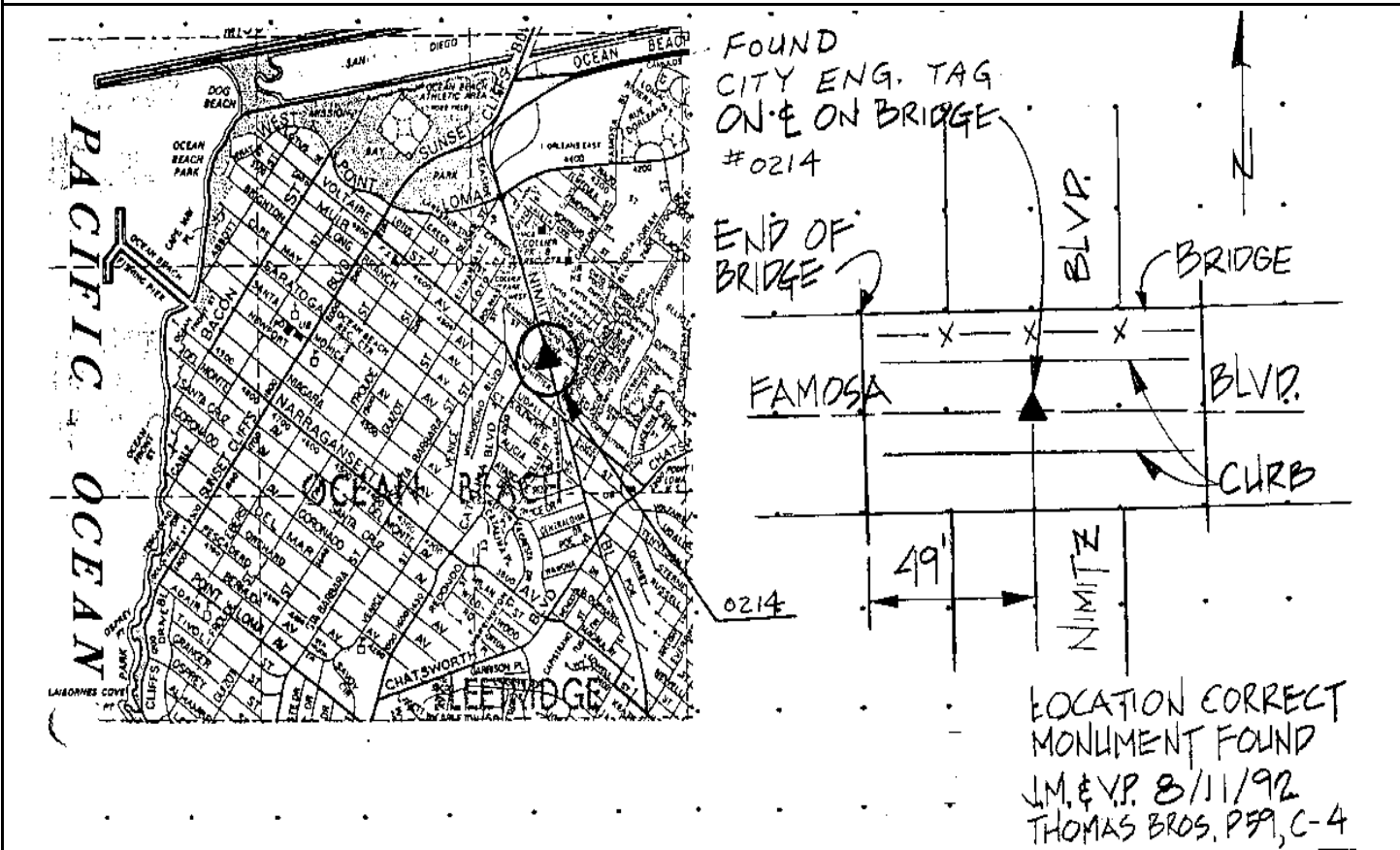

Reproduced with permission granted by THOMAS BROS. MAPS. This map is copyrighted by THOMAS BROS. MAPS. It is unlawful to copy or reproduce all or any part thereof, whether for personal use or resale, without permission.