

CITY OF SAN DIEGO

GPS CONTROL MONUMENT DATA SHEET

Point No./Name: 215		Date: AUG 1992	See Sheet 2 for Visibility Diagram <input type="checkbox"/>
Station/Mon. Name: S CLIFFS & PT LOMA		Year: UNKNOW	Agency Set By: CITY SD
Type of Monument: FOUND 3" BRASS DISK IN MON WELL Stamped: NONE		Latitude: 32-44-10.69655	NAD 83
Elevation 8.088 * NAVD 88 (meters) Elevation 24.29 * NGVD 29 (feet) * Note: Not to be used as a City benchmark		Longitude: 117-15-17.50202	(91.35)
Acc. Vert.: NAVD88: GPS 2-II NGVD29: GPS 3-I		Acc.Horiz.: 1 Order	
ROS: <input type="checkbox"/> ROS Number:		CCS Zone 6 Grid Coordinates NAD 83 (U.S. Feet) NAD 83 (Meters) N= 1849171.18 N= 563628.504 E= 6252660.68 E= 1905814.786	
		Combined Factor at Station: 1.0000124	
To Station	Grid Distance	Bearing or Azimuth	G.S.F. of Line

Monument Description: CENTER OF SUNSET CLIFFS BL & POINT LOMA AVE

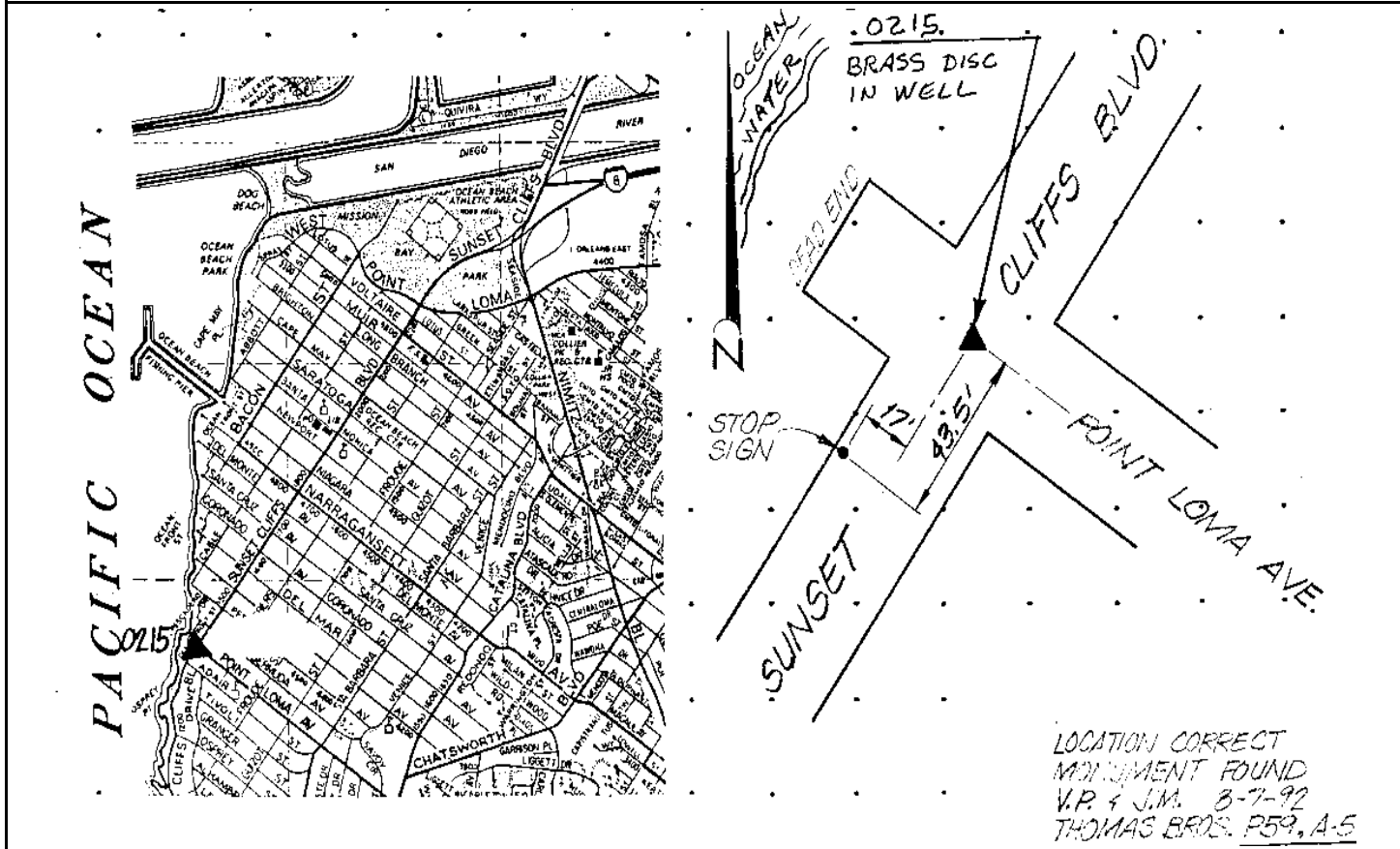

Reproduced with permission granted by THOMAS BROS. MAPS. This map is copyrighted by THOMAS BROS. MAPS. It is unlawful to copy or reproduce all or any part thereof, whether for personal use or resale, without permission.