

CITY OF SAN DIEGO

GPS CONTROL MONUMENT DATA SHEET

Point No./Name: 219		Date: AUG 1992	See Sheet 2 for Visibility Diagram <input type="checkbox"/>
Station/Mon. Name: MURRAY PARK DR		Year: UNKNOW	Agency Set By: UNKNOWN
Type of Monument: FOUND LEAD & BRASS DISK IN CONC WALK Stamped: RCE 8195		Latitude: 32-47-31.56878 Longitude: 117-02-56.74247	NAD 83 (91.35)
Elevation 175.926 * NAVD 88 (meters) Elevation 575.09 * NGVD 29 (feet) * Note: Not to be used as a City benchmark		Acc.Horiz.: 1 Order	
Acc. Vert.: NAVD88: GPS 2-II NGVD29: GPS 3-I		CCS Zone 6 Grid Coordinates NAD 83 (U.S. Feet) NAD 83 (Meters) N= 1868925.05 N= 569649.495 E= 6316090.34 E= 1925148.186	
ROS: <input type="checkbox"/> ROS Number:		Combined Factor at Station: 0.9999763	
To Station	Grid Distance	Bearing or Azimuth	G.S.F. of Line

Monument Description: S SIDE OF MURRAY PARK DR @ BONNIE VIEW DR 200 FT E OF CASELBERRY WY

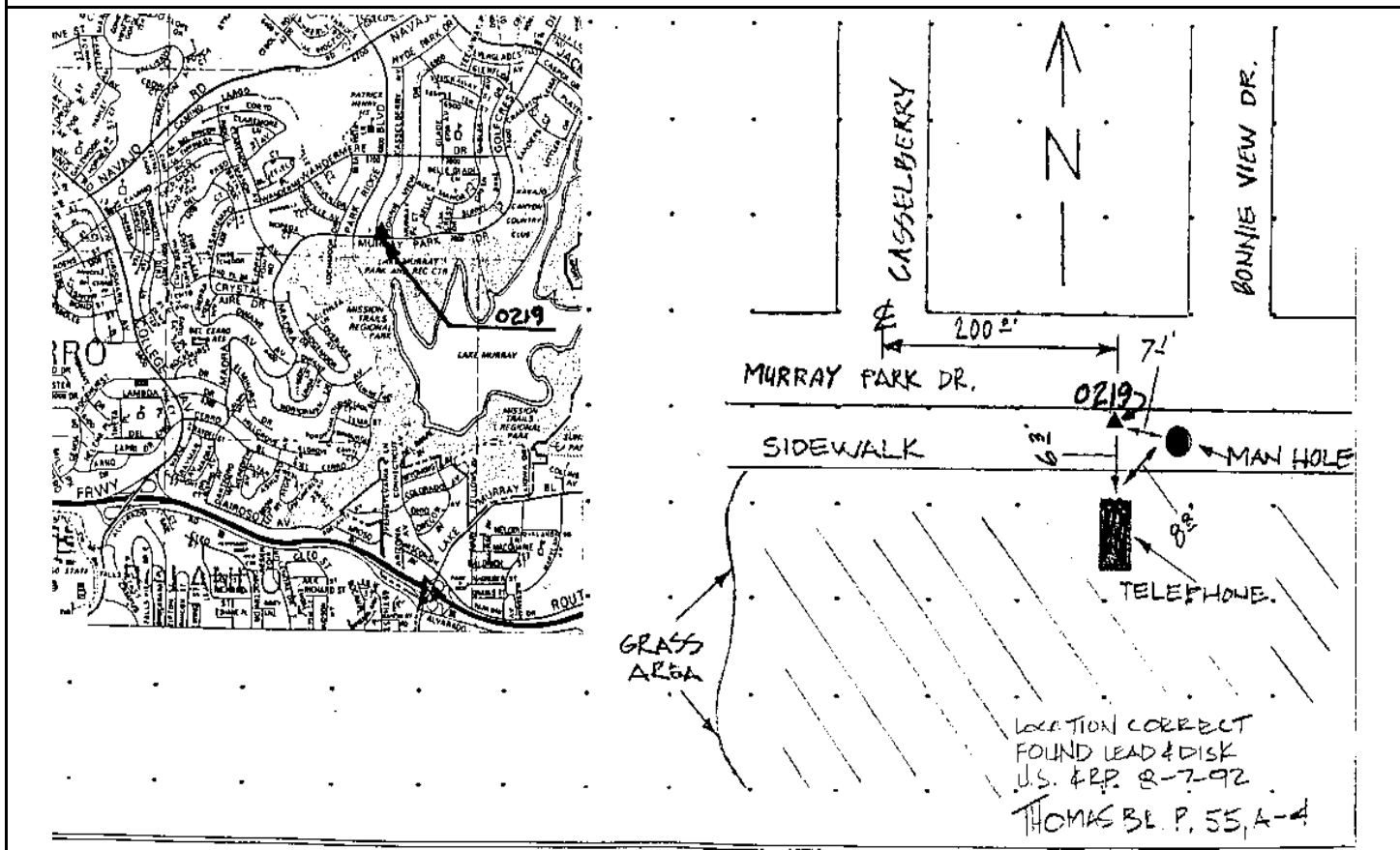

Reproduced with permission granted by THOMAS BROS. MAPS. This map is copyrighted by THOMAS BROS. MAPS. It is unlawful to copy or reproduce all or any part thereof, whether for personal use or resale, without permission.