

Point No./Name: 426	Date: SEP 1992	See Sheet 2 for Visibility Diagram <input type="checkbox"/>
Station/Mon. Name: AQUADUCT 3538+88	Year: SEP 1992	Agency Set By: RBF
Type of Monument: SET 0.75" IP & BRASS DISK IN DIRT Stamped: SD CITY ENG	Latitude: 32-59-34.94650 Longitude: 117-08-17.54367	NAD 83 (91.35)
Elevation 204.926 * NAVD 88 (meters) Elevation 670.19 * NGVD 29 (feet) * Note: Not to be used as a City benchmark	Acc.Horiz.: 2-1 Order	
Acc. Vert.: NAVD88: GPS 2-II NGVD29: GPS 3-I	CCS Zone 6 Grid Coordinates NAD 83 (U.S. Feet) NAD 83 (Meters) N= 1942254.77 N= 592000.437 E= 6289328.22 E= 1916991.075	
ROS: <input type="checkbox"/> ROS Number:	Combined Factor at Station: 0.999944875	

To Station	Grid Distance	Bearing or Azimuth	G.S.F. of Line

Monument Description: E SIDE OF RD @ 2ND SD AQUEDUCT STA 3538+88.43 0.7 MI N BLACK MTN RD

Description, sketch, and/or references, access problems, ect.:

3 LEG PANEL T SHAPE
WHITE TIEBOW
OPEN VISIBILITY

MARKED M.H. 3538+88.43
WATER STRUCTURE

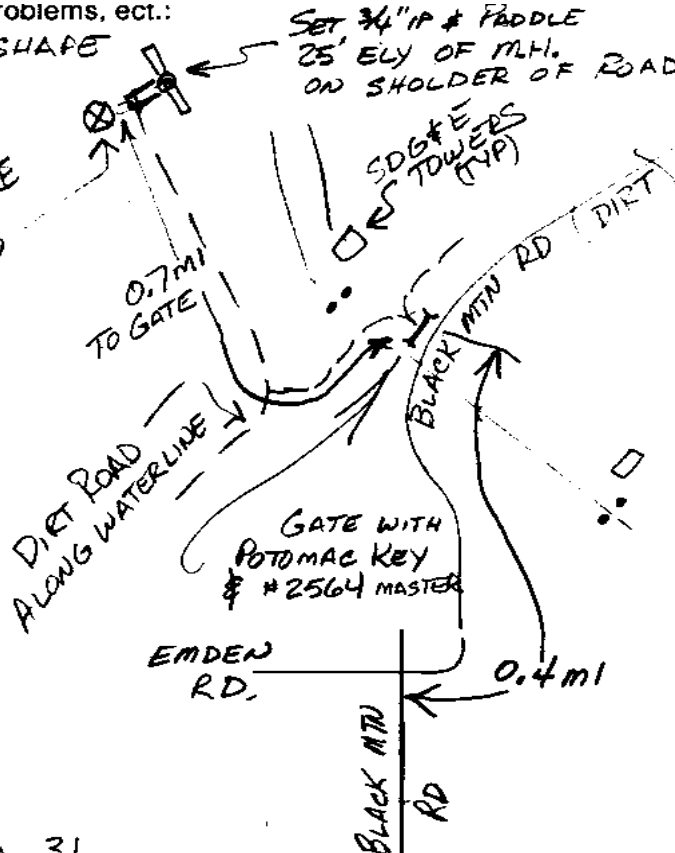

NOTE: FROM PT # 406
GO NLT ALONG DIRT
ROAD 0.75 = TO # 412
THEN 0.75 = TO # 393

A. GIFFIN, O RINNER Pg 31