

CITY OF SAN DIEGO

GPS CONTROL MONUMENT DATA SHEET

Point No./Name: 475	Date: AUG 1992	See Sheet 2 for Visibility Diagram <input type="checkbox"/>	
Station/Mon. Name: WORLD TRADE @ STONEY	Year: UNKNOW	Agency Set By: UNKNOWN	
Type of Monument: FOUND 1.75" BRASS DISK IN MON WELL Stamped: LS 5023	Latitude: 32-58-45.95999 Longitude: 117-04-34.23579	NAD 83 (91.35)	
Elevation 216.859 * NAVD 88 (meters) Elevation 709.39 * NGVD 29 (feet) * Note: Not to be used as a City benchmark	Acc.Horiz.: 2-1 Order		
Acc. Vert.: NAVD88: GPS 2-II NGVD29: GPS 3-I	CCS Zone 6 Grid Coordinates NAD 83 (U.S. Feet) NAD 83 (Meters) N= 1937147.55 N= 590443.753 E= 6308307.96 E= 1922776.112		
ROS: <input type="checkbox"/> ROS Number:	Combined Factor at Station: 0.999944386		
To Station	Grid Distance	Bearing or Azimuth	G.S.F. of Line

Monument Description: PC WORLD TRADE DR 200 FT N STONEY PEAK DR

3 LEG PANEL
WHITE PAINT
OPEN VISIBILITY

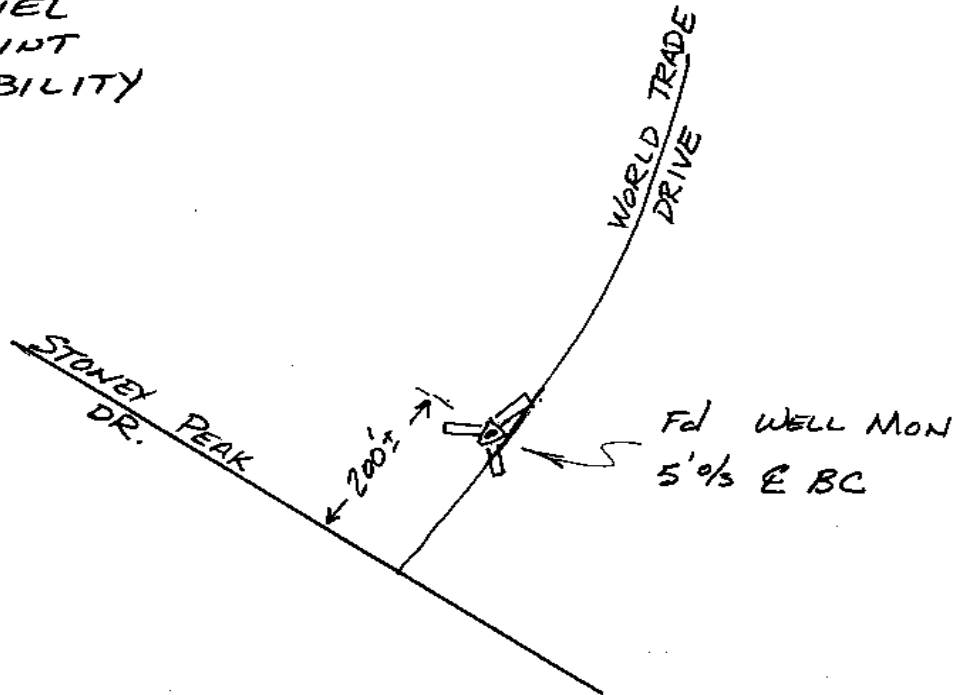

AG, DR