

Point No./Name: 496	Date: AUG 1992	See Sheet 2 for Visibility Diagram <input type="checkbox"/>
Station/Mon. Name: PI OVIEDO WY	Year: UNKNOW	Agency Set By: UNKNOWN
Type of Monument: FOUND 3" BRASS DISK IN MON WELL Stamped: RCE 13862	Latitude: 32-58-15.56742 Longitude: 117-07-22.85173	NAD 83 (91.35)
Elevation 197.470 * NAVD 88 (meters) Elevation 645.74 * NGVD 29 (feet) * Note: Not to be used as a City benchmark	Acc.Horiz.: 2-1 Order	
Acc. Vert.: NAVD88: GPS 2-II NGVD29: GPS 3-I	CCS Zone 6 Grid Coordinates NAD 83 (U.S. Feet) NAD 83 (Meters) N= 1934192.95 N= 589543.190 E= 6293919.11 E= 1918390.381	
ROS: <input type="checkbox"/> ROS Number:	Combined Factor at Station: 0.999948388	

To Station	Grid Distance	Bearing or Azimuth	G.S.F. of Line

Monument Description: PI CENTER OVIEDO WY E OVIEDO ST

3 LEG PANEL
WHITE PAINT

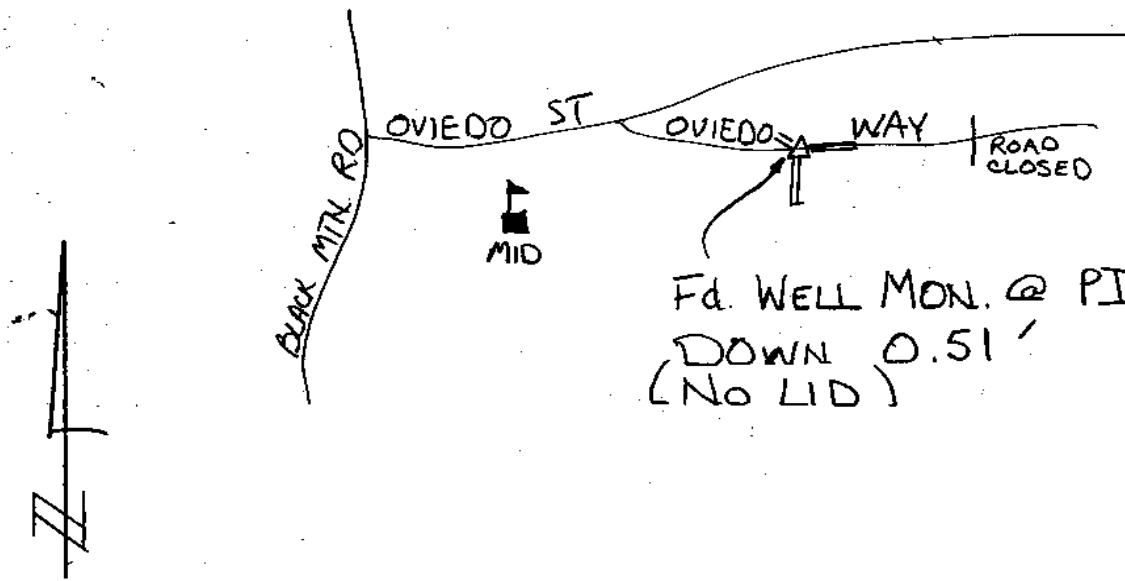

R. NOBLE