

CITY OF SAN DIEGO

GPS CONTROL MONUMENT DATA SHEET

Point No./Name: 497	Date: AUG 1992	See Sheet 2 for Visibility Diagram <input type="checkbox"/>	
Station/Mon. Name: CARMEL & BLACK MT	Year: UNKNOW	Agency Set By: UNKNOWN	
Type of Monument: FOUND 2" IP & BRASS DISK Stamped: RCE 13862	Latitude: 32-57-47.90477 Longitude: 117-07-35.89625	NAD 83 (91.35)	
Elevation 165.567 * NAVD 88 (meters) Elevation 541.07 * NGVD 29 (feet) * Note: Not to be used as a City benchmark	Acc.Horiz.: 2-1 Order		
Acc. Vert.: NAVD88: GPS 2-II NGVD29: GPS 3-I	CCS Zone 6 Grid Coordinates NAD 83 (U.S. Feet) NAD 83 (Meters) N= 1931406.54 N= 588693.891 E= 6292784.33 E= 1918044.501		
ROS: <input type="checkbox"/> ROS Number:	Combined Factor at Station: 0.999954256		
To Station	Grid Distance	Bearing or Azimuth	G.S.F. of Line
Monument Description: CENTER BLACK MOUNTAIN RD & CARMEL MOUNTAIN RD (OPEN IP 1.22 N'LY)			

3 LEG PANEL
WHITE PAINT

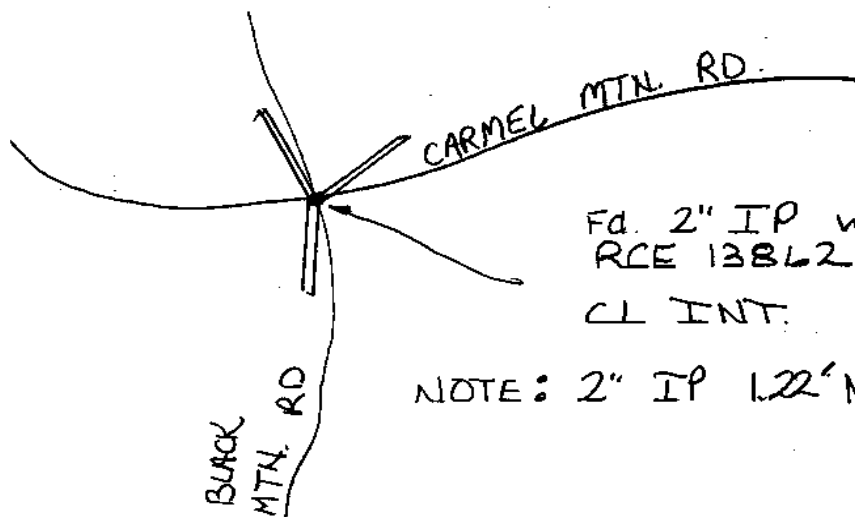

Fd. 2" IP w/ TAG
RCE 13862
CL INT.

NOTE: 2" IP 1.22' NLY - NO TAG

R. NOBLE