

214.19

314.60

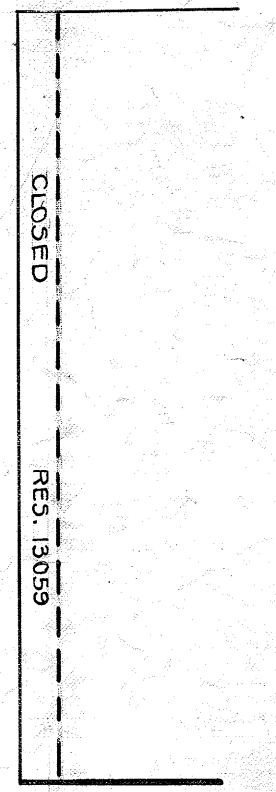

75

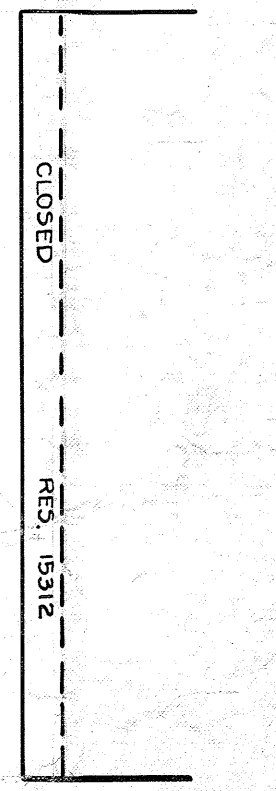

MICROFILMED
JAN 24 1963



213.77

66.00

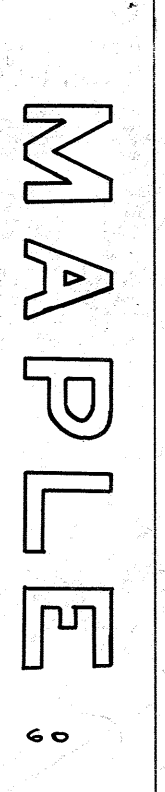

75

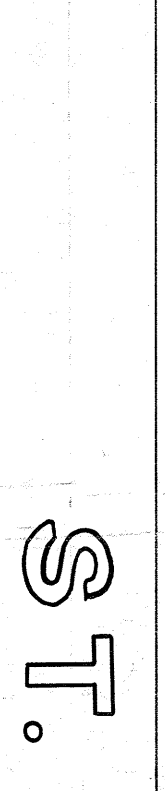

MICROFILMED
JAN 24 1963



ST.

ST.

ST.

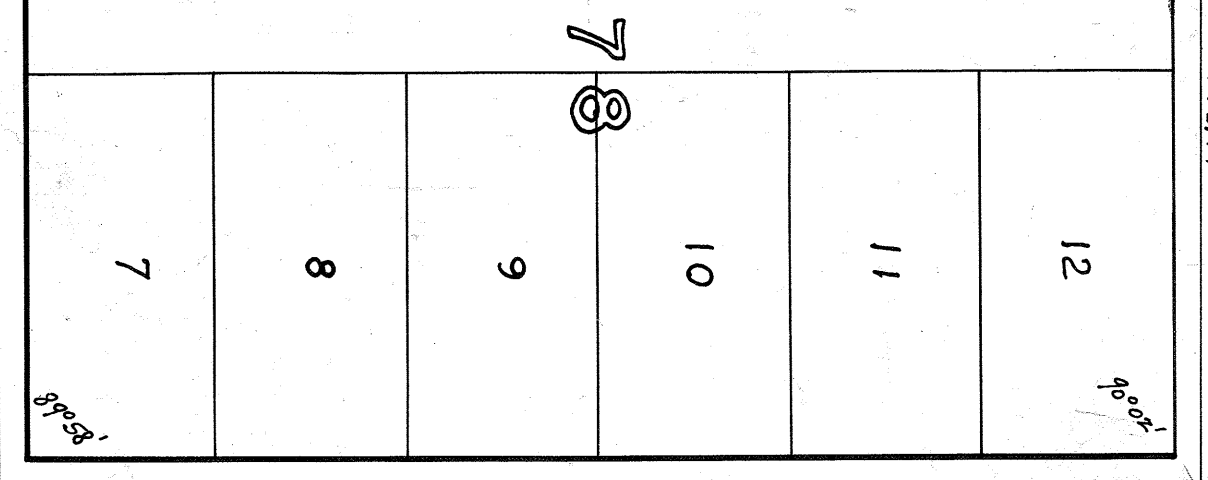

314.89

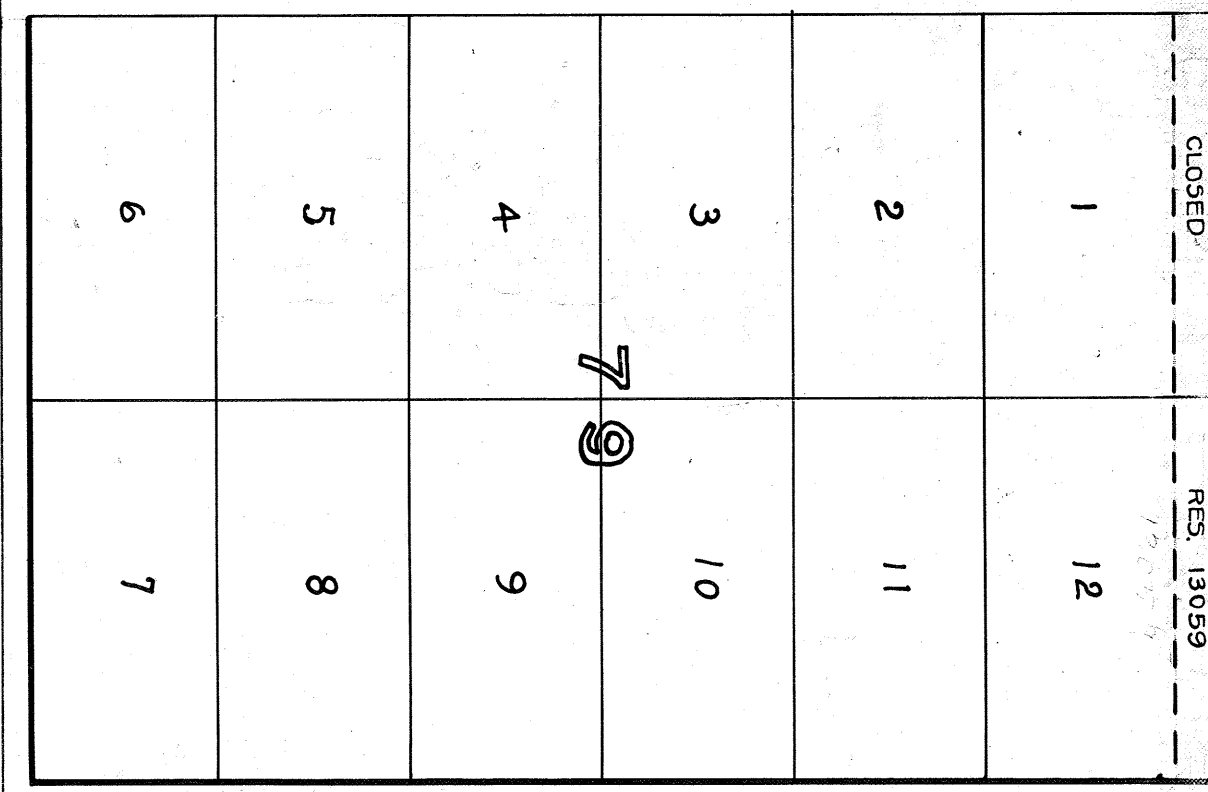

61

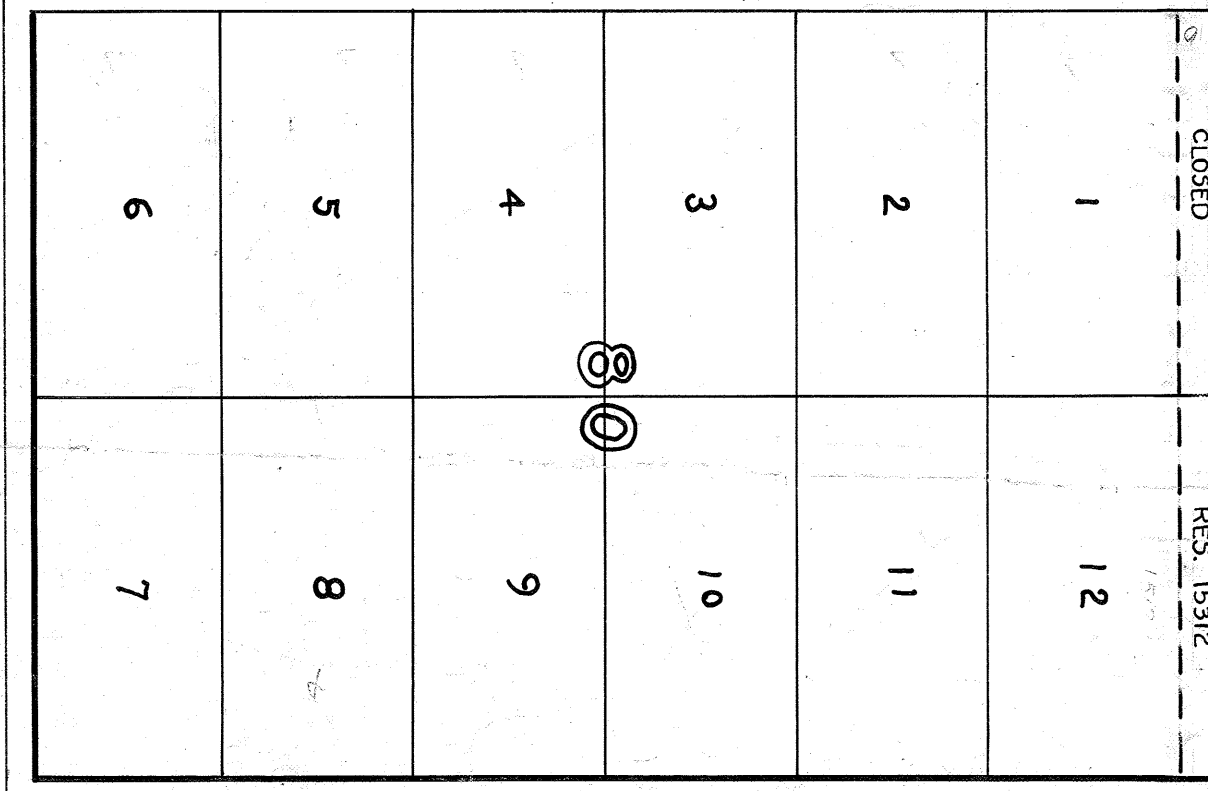

MICROFILMED
JAN 24 1963



Set Nail
1/2 Box

LAUREL

ST.

214.13

314.48



61

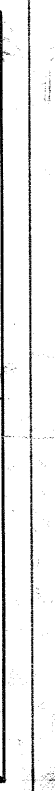

MICROFILMED
JAN 24 1963

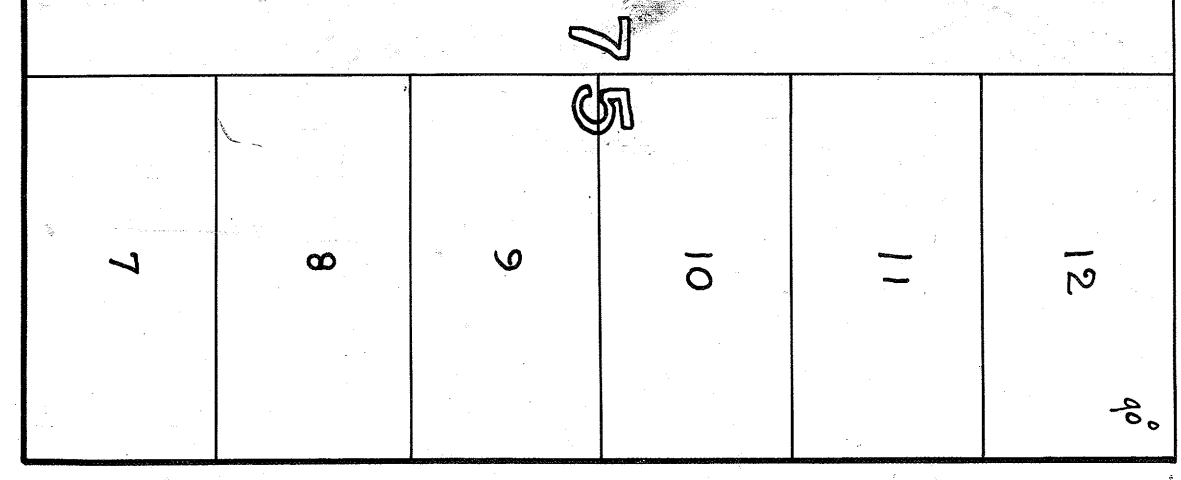

314.48

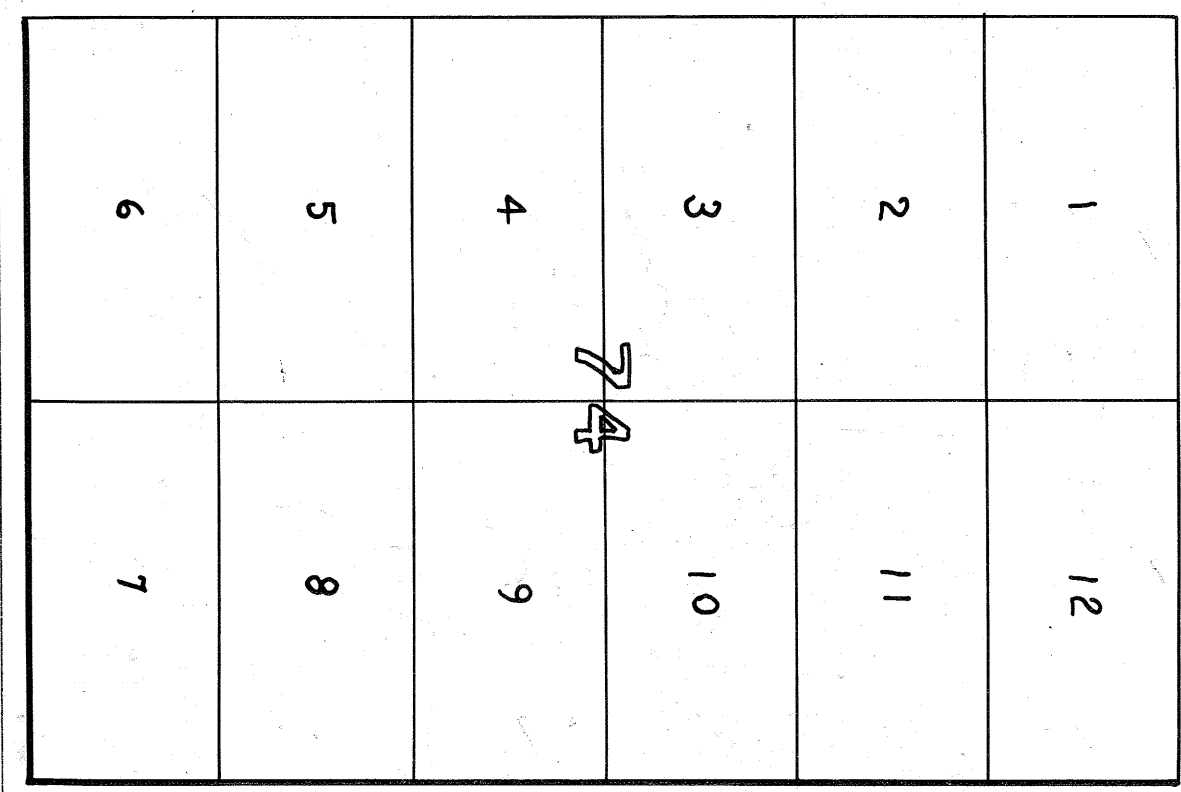

61

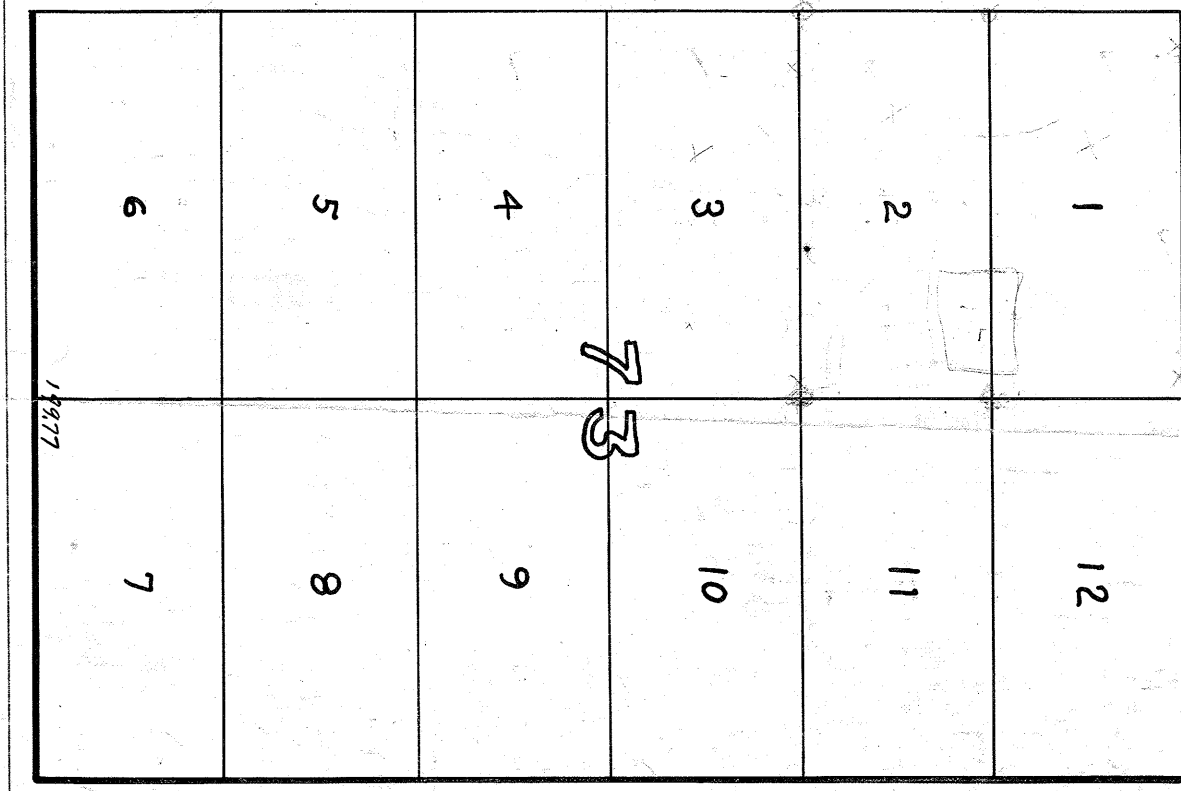

MICROFILMED
JAN 24 1963

KALMIA

ST.

214.30

314.69



61



MICROFILMED
JAN 24 1963

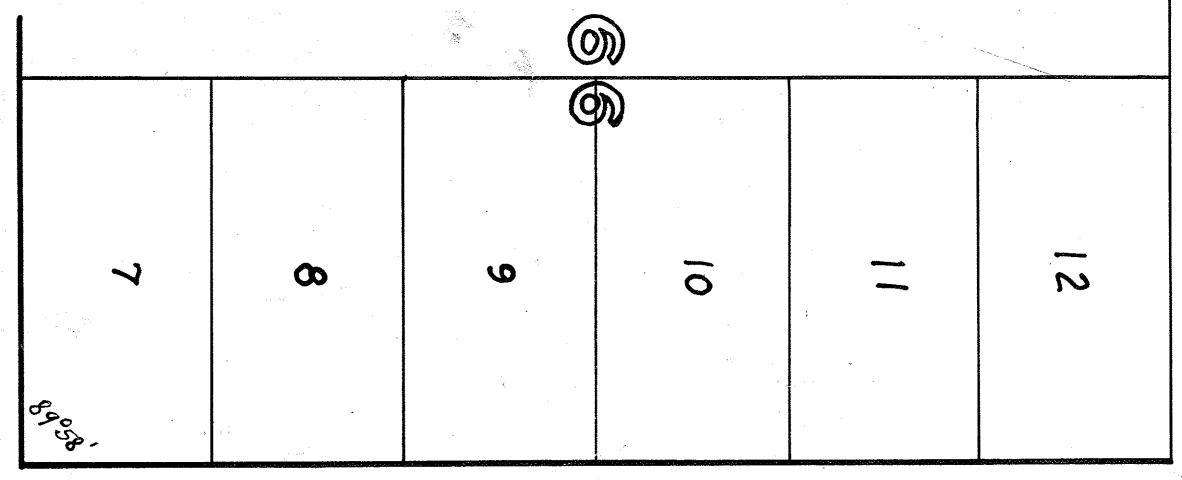

314.69

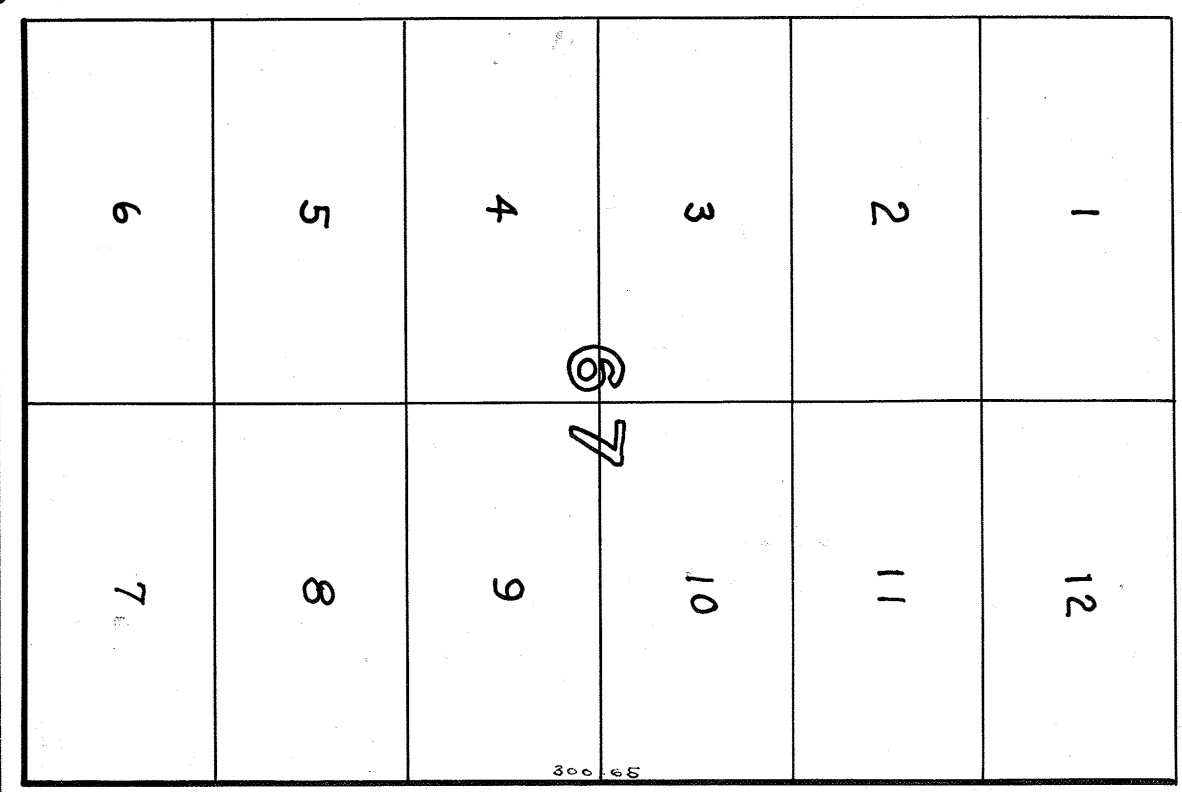

61

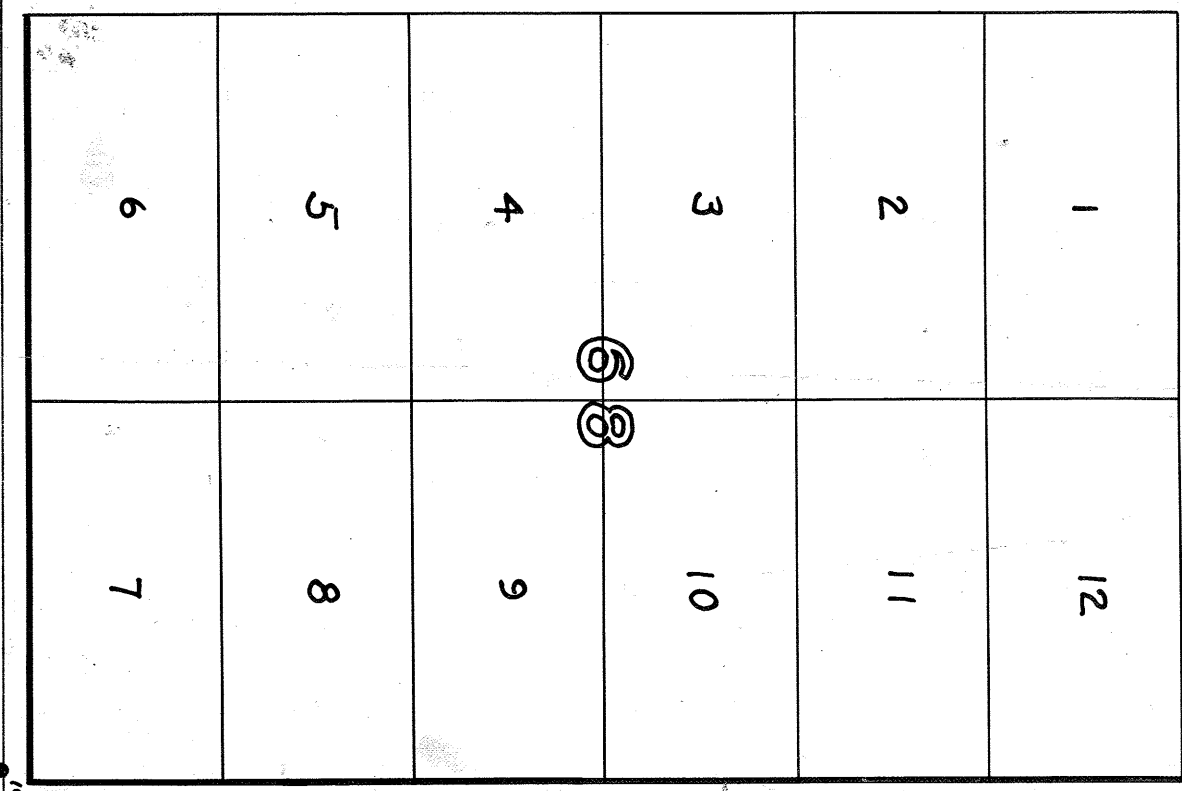

MICROFILMED
JAN 24 1963

INDIA

COLUMBIA

STATE

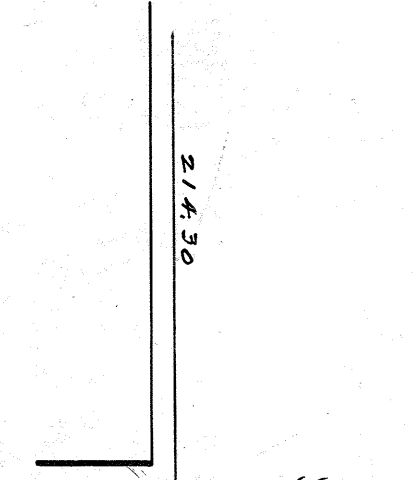

314.20

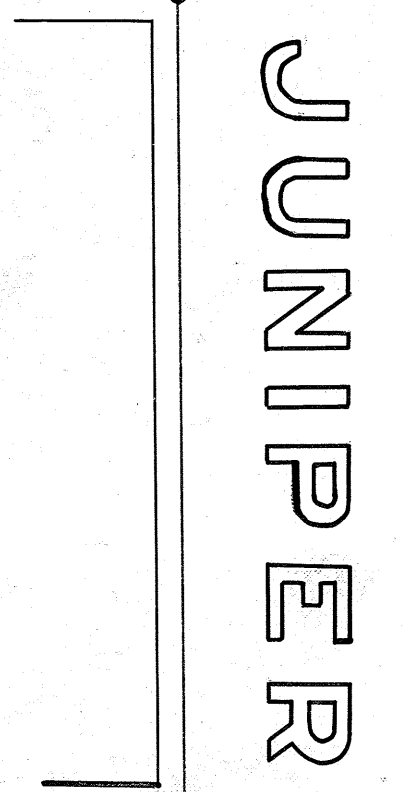

314.43

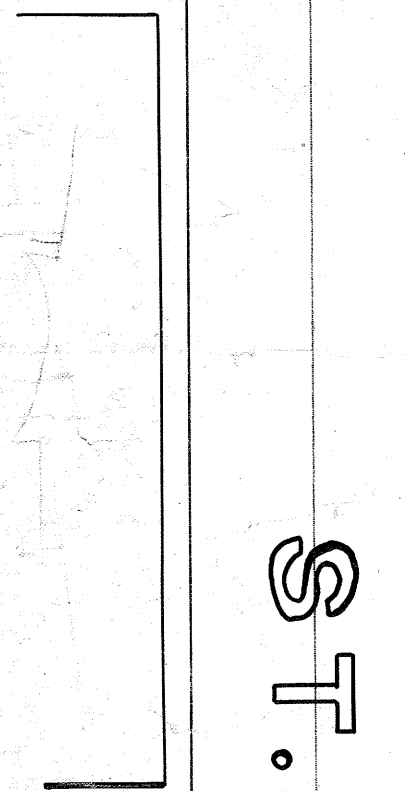

MICROFILMED
JAN 24 1963

JUNIPER

ST.

214.30

314.20



30.5



MICROFILMED
JAN 24 1963