

A

ST.

29TH

30TH

31ST

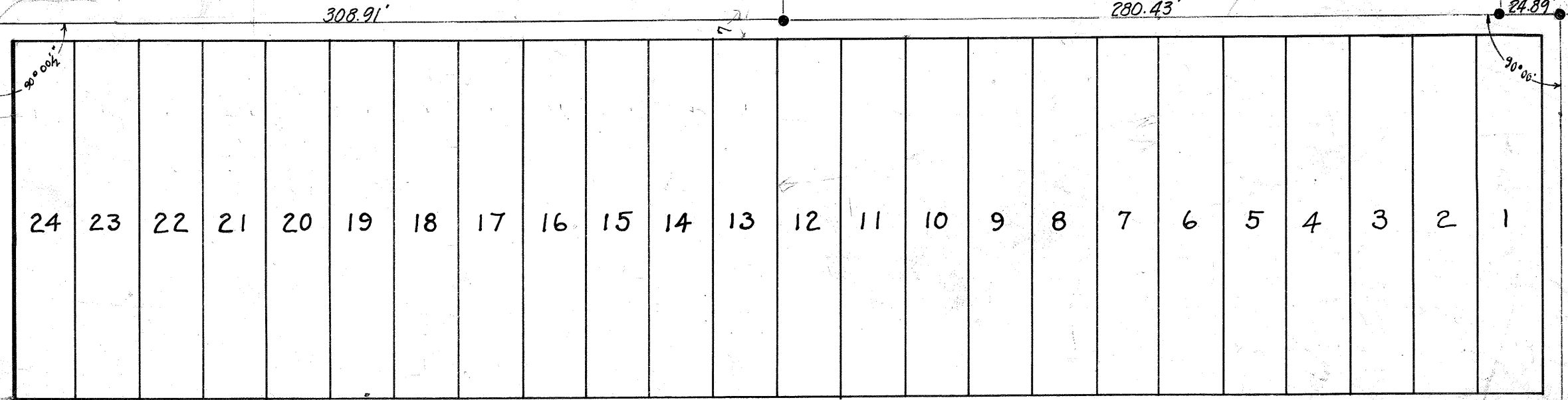
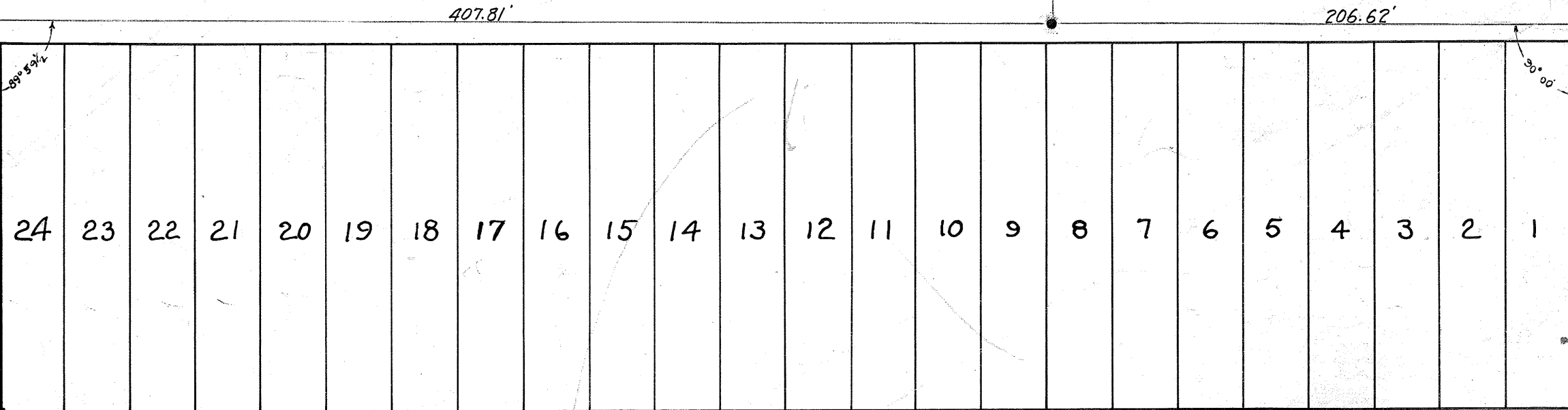

89

92

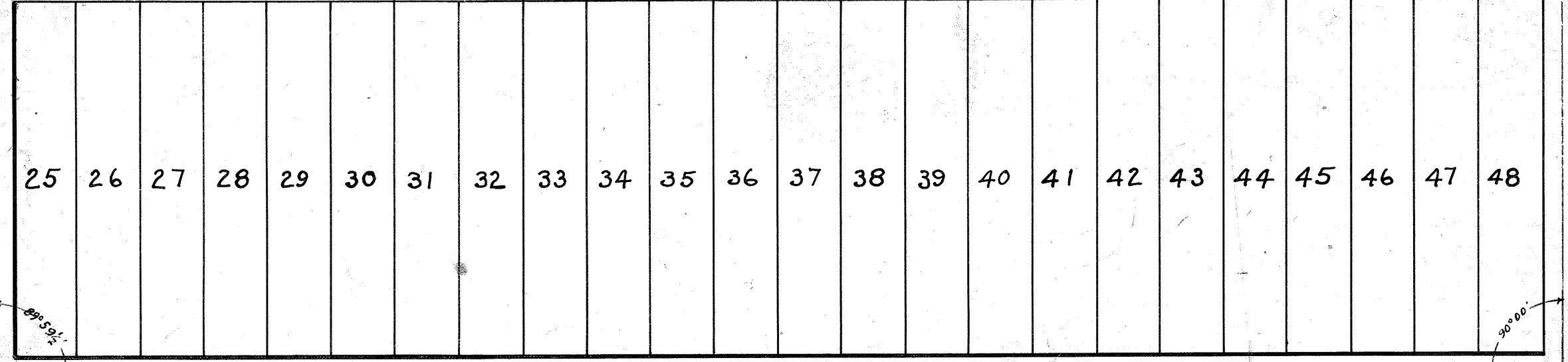
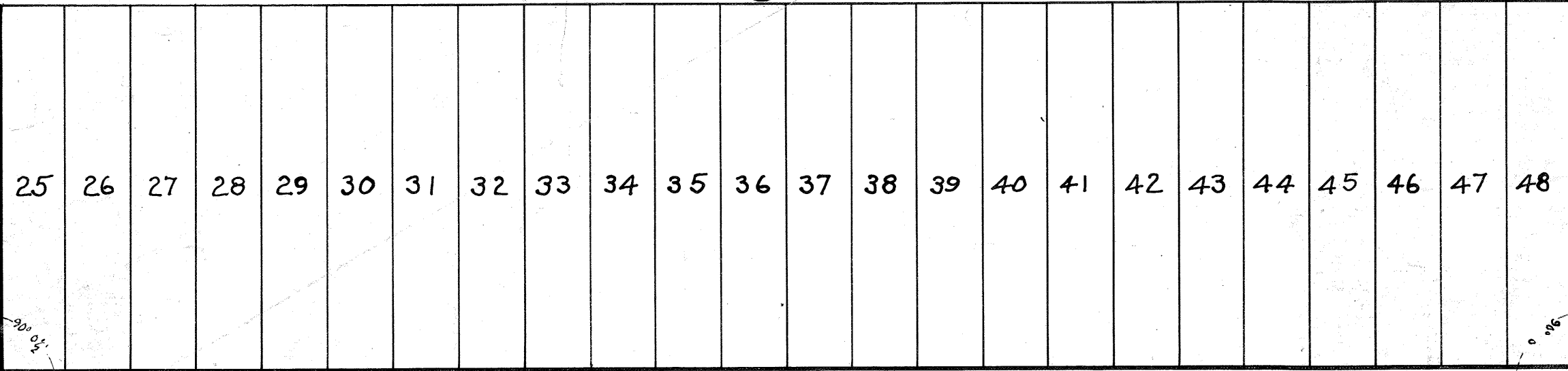

B

ST.

ST.

ST.

ST.

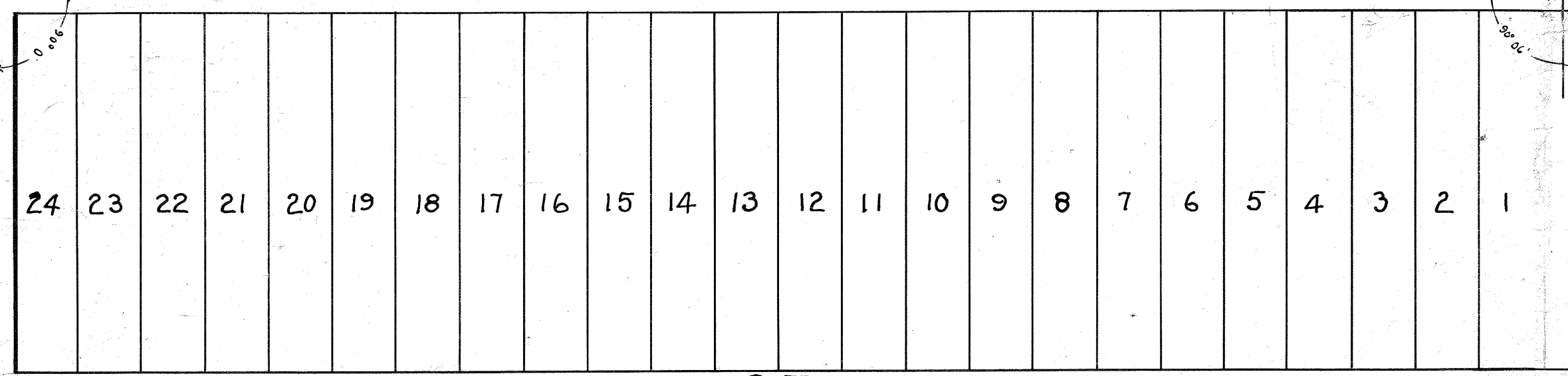
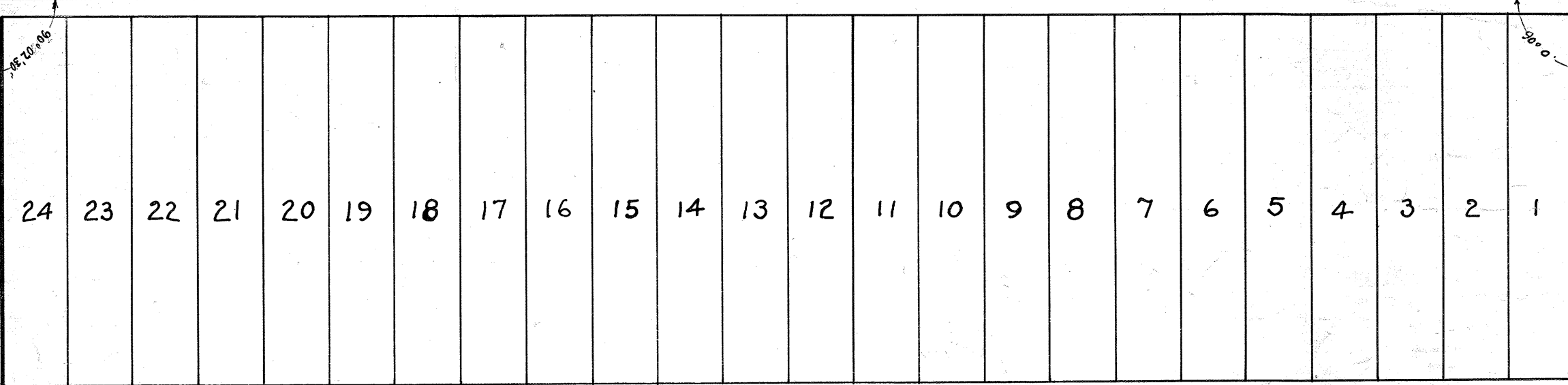

88

93

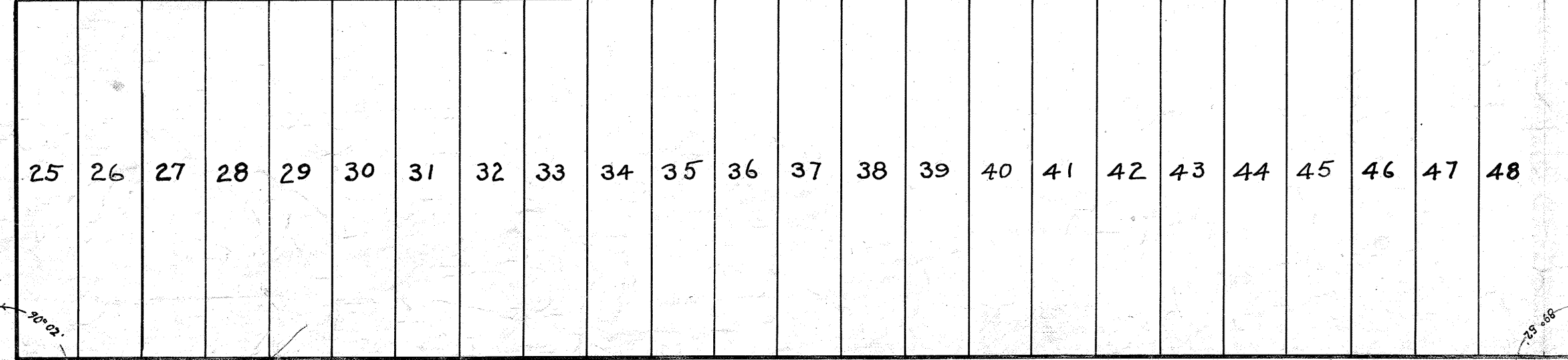
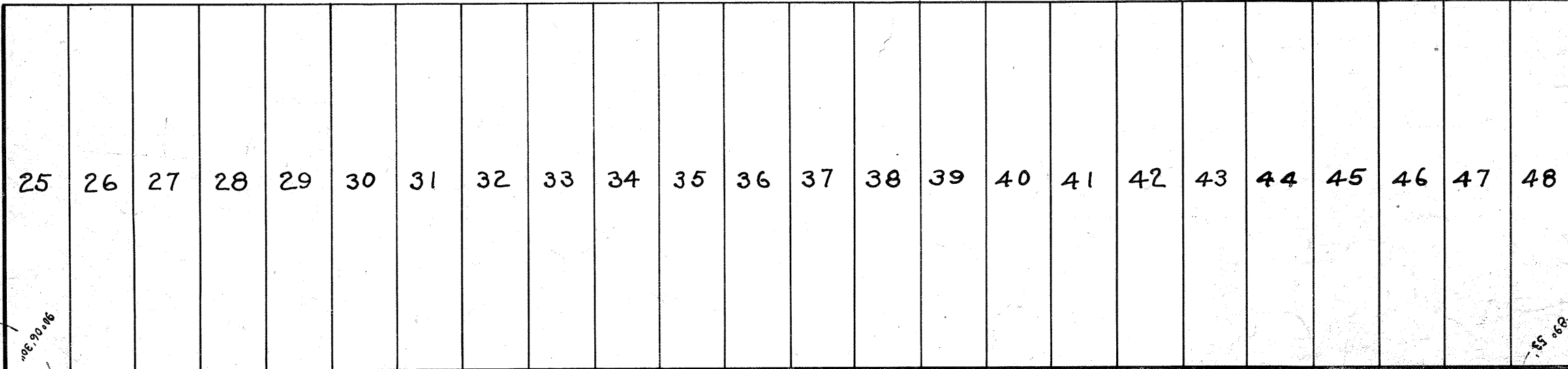

C

ST.

MICROFILMED
JAN 24 1963

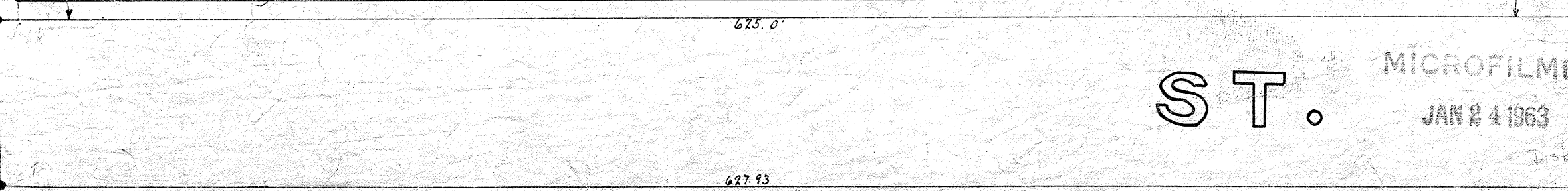
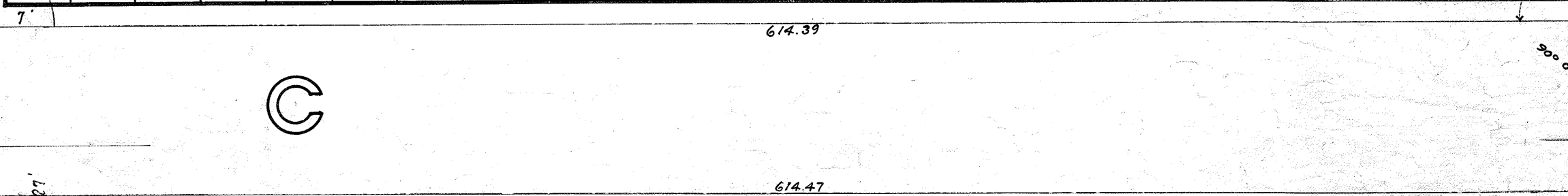

A

ST.

29TH

30TH

31ST

24 23 22 21 20 19 18 17 16 15 14 13 12 11 10 9 8 7 6 5 4 3 2 1

24 23 22 21 20 19 18 17 16 15 14 13 12 11 10 9 8 7 6 5 4 3 2 1

89

92

25 26 27 28 29 30 31 32 33 34 35 36 37 38 39 40 41 42 43 44 45 46 47 48

25 26 27 28 29 30 31 32 33 34 35 36 37 38 39 40 41 42 43 44 45 46 47 48

B

ST.

ST.

ST.

ST.

24 23 22 21 20 19 18 17 16 15 14 13 12 11 10 9 8 7 6 5 4 3 2 1

24 23 22 21 20 19 18 17 16 15 14 13 12 11 10 9 8 7 6 5 4 3 2 1

88

93

25 26 27 28 29 30 31 32 33 34 35 36 37 38 39 40 41 42 43 44 45 46 47 48

25 26 27 28 29 30 31 32 33 34 35 36 37 38 39 40 41 42 43 44 45 46 47 48

C

ST.

102A

FD 7x7 4x4
28 OCT 91

5x5
OUT

FD 7x7 4x4
28 OCT 91

FD 7x7 4x4
28 OCT 91

105

