

JOSEPHINE ST.

1 SILVER	8
TERRACE	
58618	

BRUNNER ST.

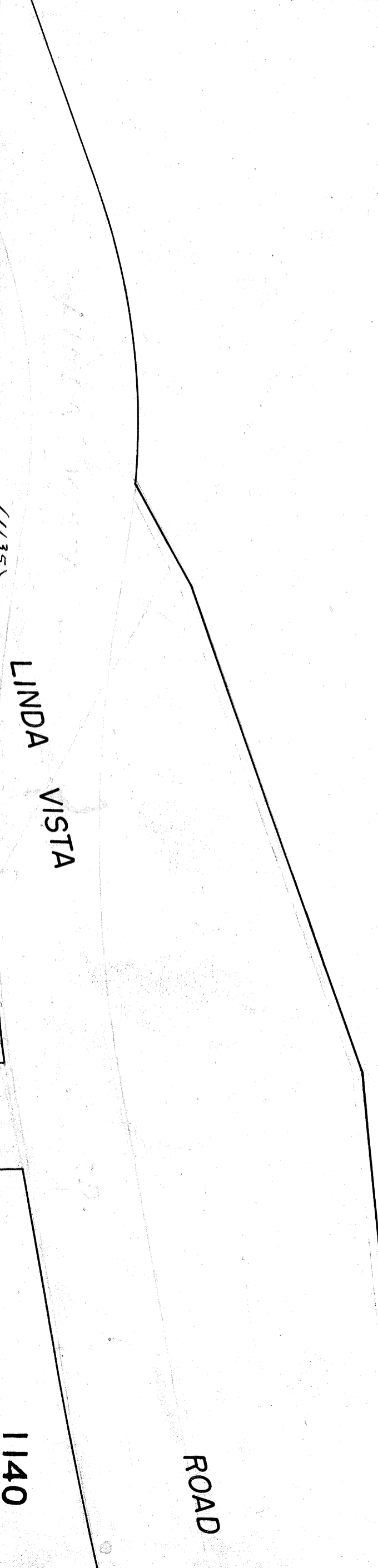

1140

ROAD

PORTION
P.L. 1177

<1139>

<1141>

P.L. 1177
R.G.B.

P.L. 1177
R.G.B.

<1140>

<1132>

<1143>

1140

MICROFILMED
JAN 20 1983

