

MICROFILMED
JAN 25 1963

PL. 316

PL. 317

273.24

MIDWAY

DRIVE

STREET

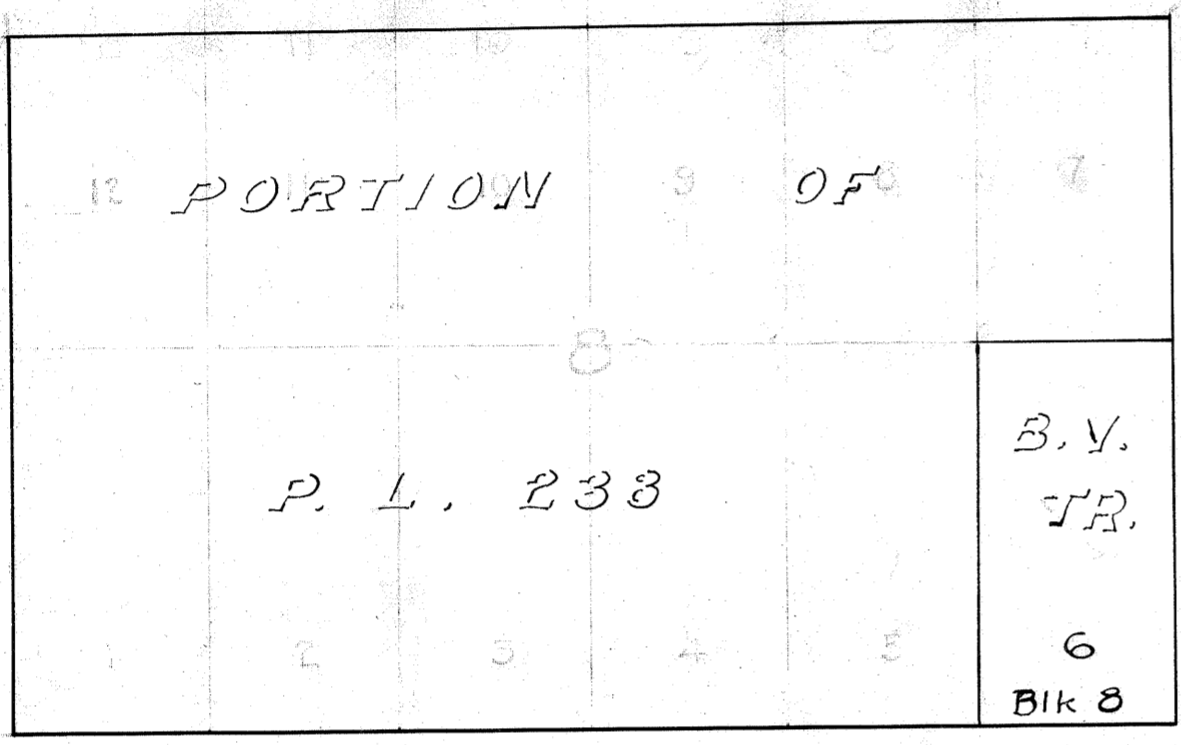

STREET

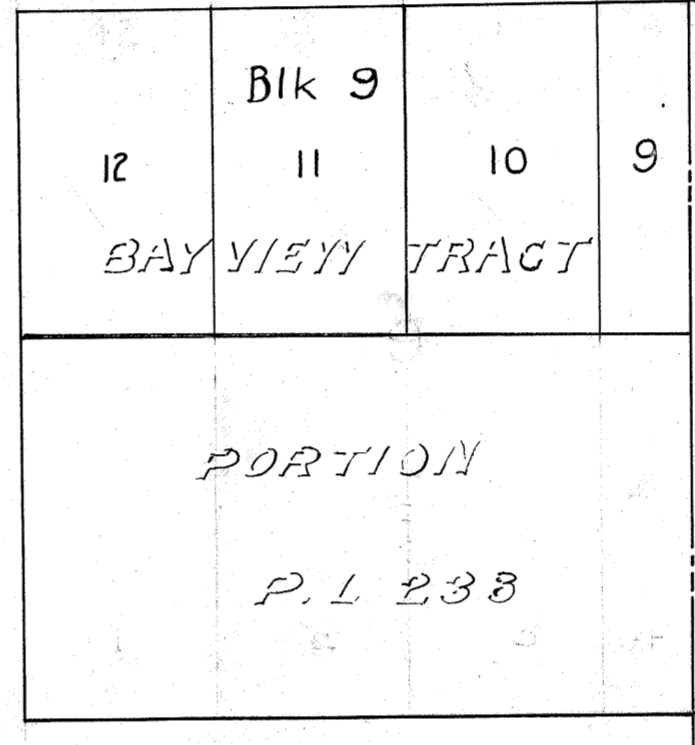

BUELL

STREET

STREET

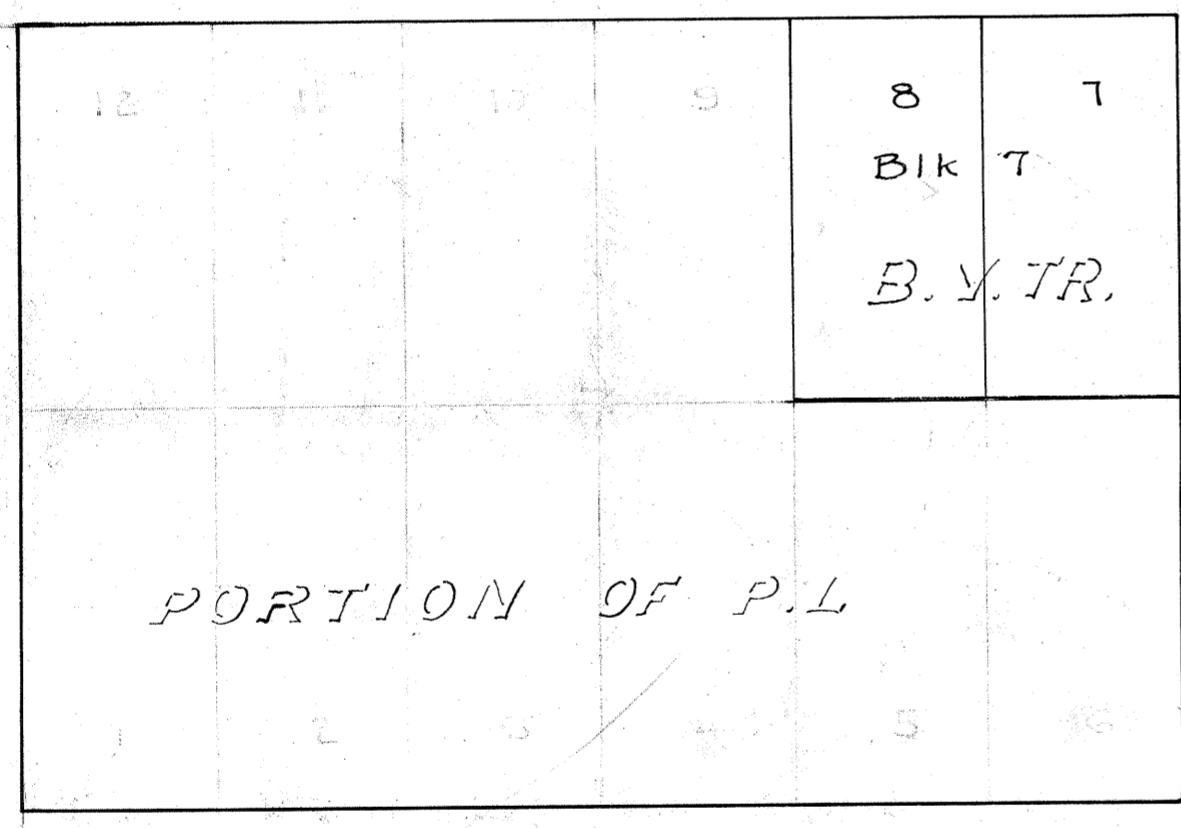

WALLACE

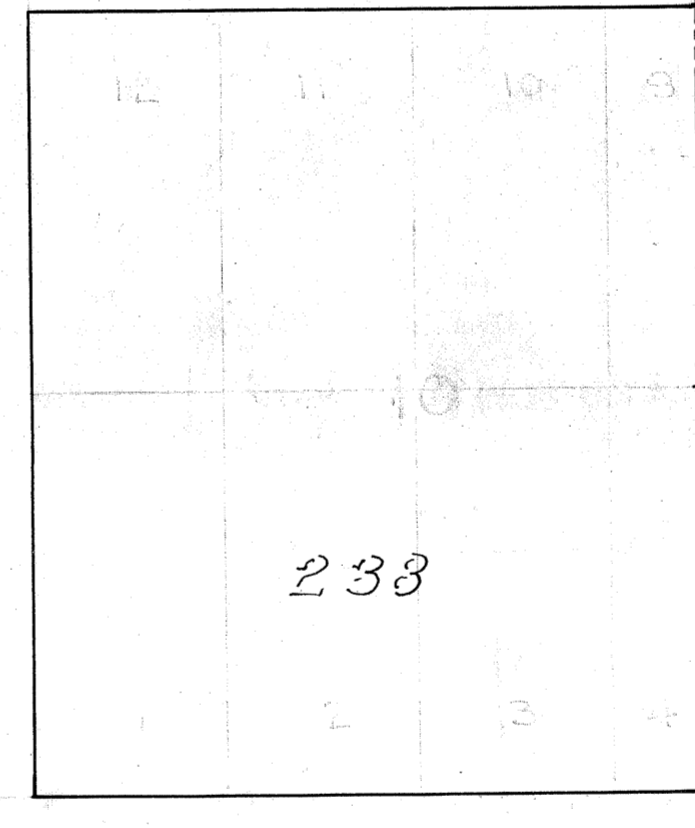

PL. 237

GAUBY

STREET

TAYLOR

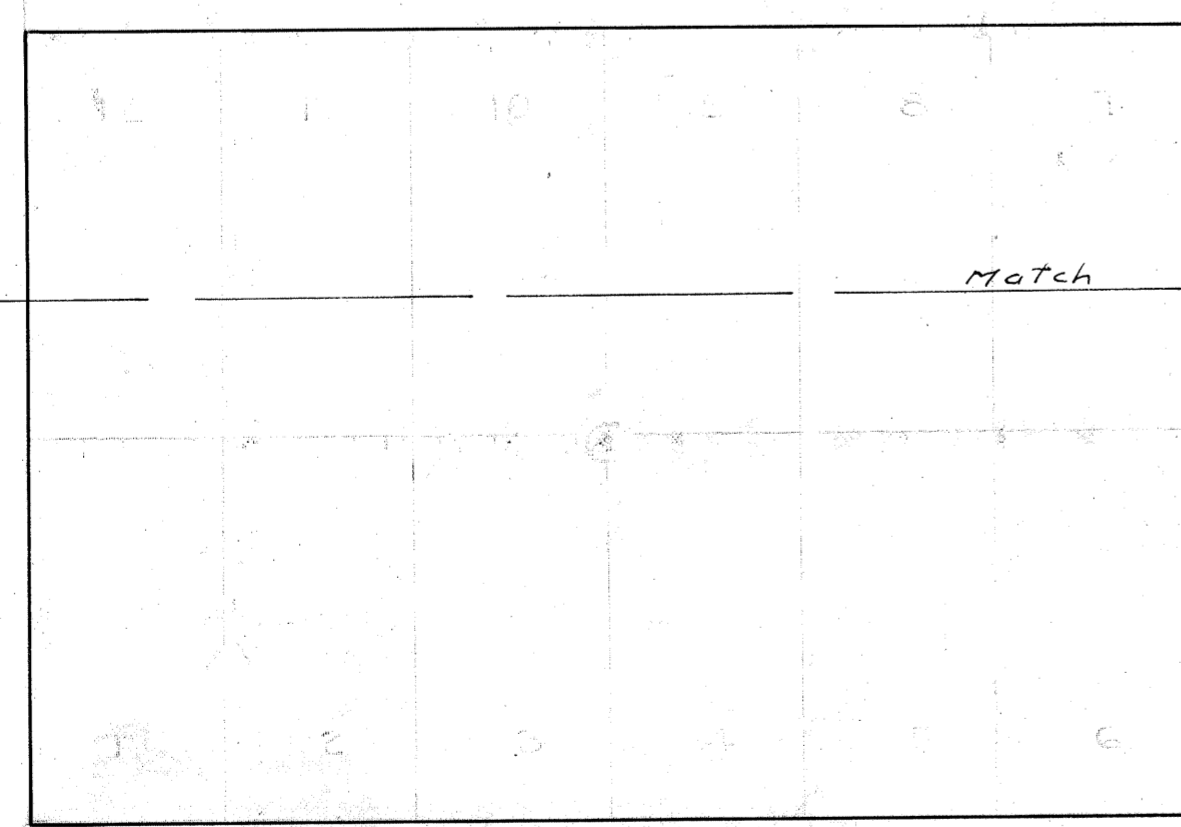

WALLACE

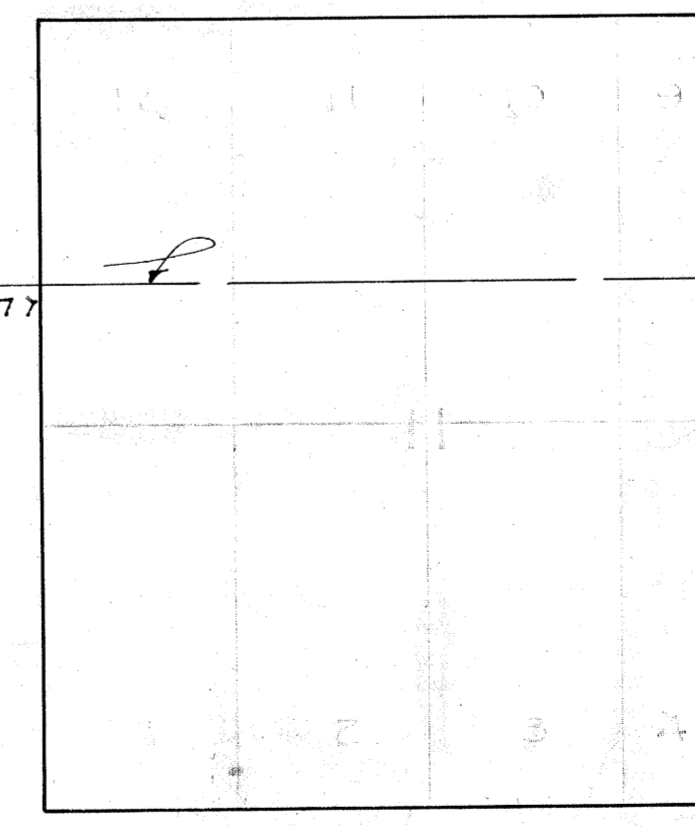

DAVIS

STREET

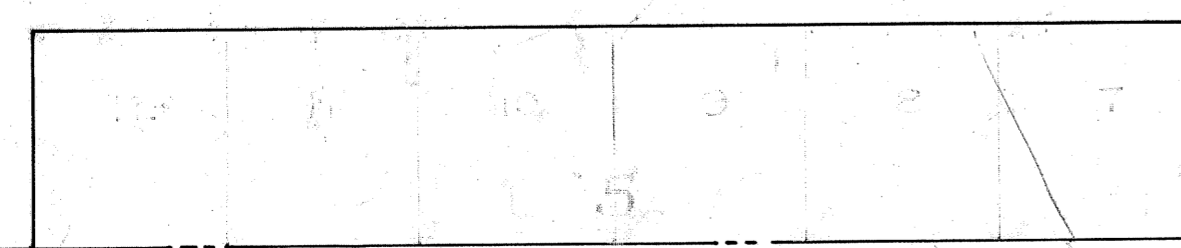

PL. 223

608

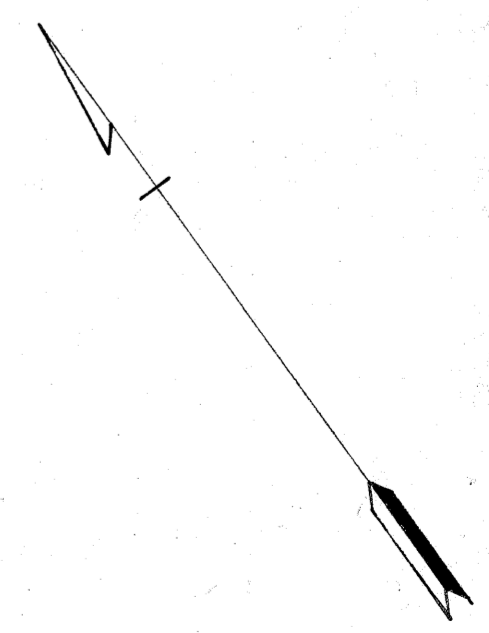

Neg. 9-# 30

Kodak