

1194

EAST

FIELD BOOK

No. 385

MICROFILMED
DEC 22 1964

No. 380 7/17/30 RR

Our Leather Bound Engineers Note Books are carried in the following rulings:

- No. 380 LEVEL BOOK. Left and Right Hand Page the same as Left Hand Page of this Book.
- No. 382 FIELD BOOK. Left Hand Page as in this Book, Right Hand Page 4 x 4 to the inch, Center Line Red.
- No. 384 MINING TRANSIT BOOK. Left Hand Page as in this Book, Right Hand Page 8x8 to the inch, Center Line Red.
- No. 385 FIELD BOOK. Left Hand Page as in this Book, Right Hand Page 8 vertical and 4 horizontal lines to the inch, Center Line Red.

We also carry the Note Books listed above, bound in extra strong Fabri-Hide (otherwise the same quality of book), which can be furnished at a somewhat lower price.

In ordering Fabri-Hide covered books, add the letter "F" to catalog number.

THE FREDERICK POST CO.
ENGINEERING and DRAFTING SUPPLIES
IRVING PARK STATION
CHICAGO, ILL.

Ms. Dir. 16pp 74 7/17/30 RR

Hawthorne - Grape	37-9-2	①
Sydney Pt		3
Market St. at Chollas Cr		6
alley - 37 th - Bidry		8
Felton - Gregory - & etc		10
Estrella		12
Lincoln at Bidry		13
alley - Gregory - Felton		14
Olive - India		14 1/2
Palm - ✓	16-15	
Quine - ✓		15 1/2
Gilard - Genter	18 1/2 - 17	
Eads - Kay		18
Trojan - Euclid - 48 th St.		20
Alabama S - Union -		22
Gregory - Upes	25 - 24	
Front & Bth. Bay	27	
Pac. Beh. Sags -		34
Millon St		35
Essex Robinson		36
Pac. Beh -		38
X Sec. 35 th Paring to End		48
X Sec. Wilshire Drive 35 th End		64

+	T	-	
+3.4	147.4		144.-
		2.2	140.2 ✓
Q.D	140.2		
		3.6	136.6
			5.6
			131.0-

278	146.78		144.-
		7.18	139.60
1.64	141.24		
		11.1	130.1
		13.4	127.8

Hanthorne

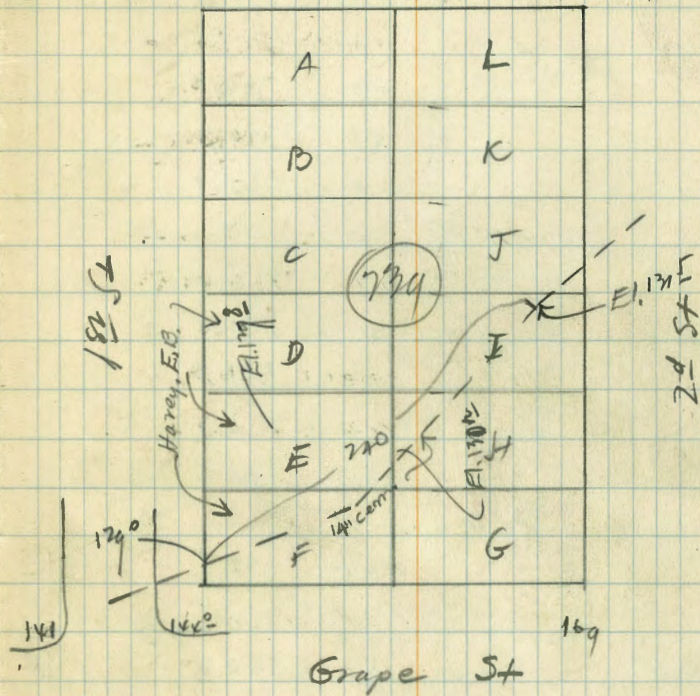

X. Section of Open Gutter 6' Wide
 End
 EAST of Sydney Place

Elev. of South
 top of curb

	3.65	384.65	381.00
	+0.00 on Flow line of existing pipe		
		5.87	378.78
	4'E		
		3.9	380.7
		5.4	379.2
		3.8	380.8
	22'E		
-5		0.9	375.7
-3		12.6	372.0
		13.3	371.3
		11.4	373.2
		10.5	374.1
	28'E		
S		13.5	371.1
N		14.1	370.5
N		15.0	369.6
+1		13.1	371.5
	34'E		
-3		15.8	368.8
N		16.9	367.7
N		19.9	364.7
S		17.9	366.7
+1		16.3	368.3
	51'E		

Newman

A.H. Barnes
 Am. Ry. Exp. S. Fe. Dept.

(3)

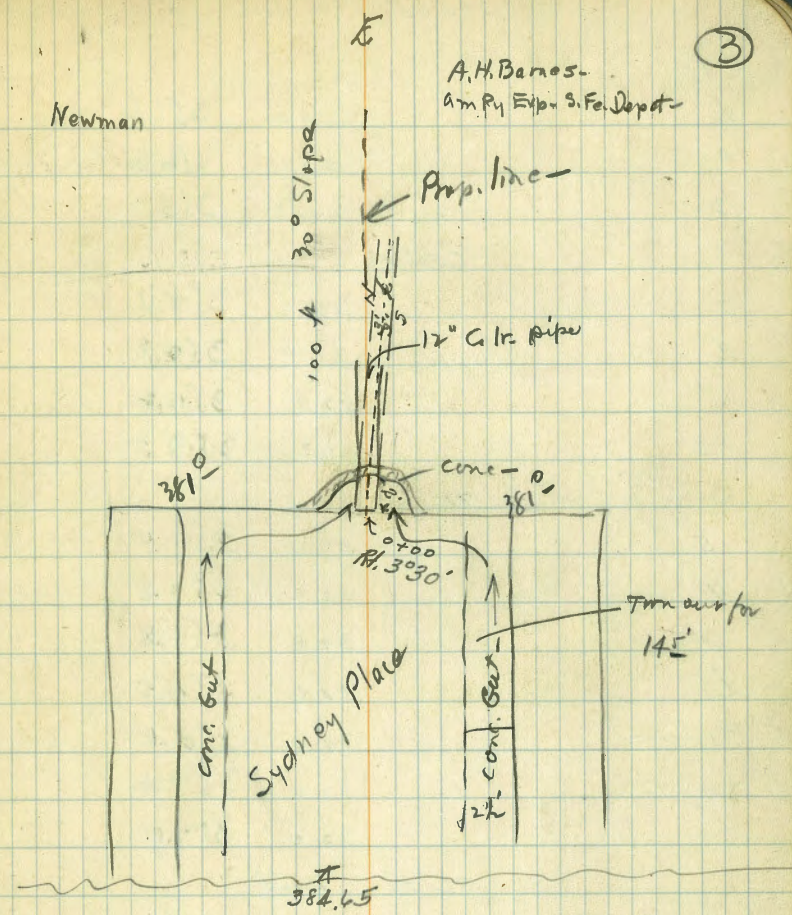

		384.65	
S		24.3	360.3
N		25.3	359.3
N		25.6	359.0
+1		25.6	359.0
+2		24.3	360.3
	54'E		
-3		26.1	358.5
-2		26.8	357.8
N		27.2	357.4

2	28.0	356.6
+1	28.0	356.6
5	26.8	358.3

69'E

5	32.2	357.4
2	31.8	357.8
N	32.0	357.6
+5	31.3	358.3

71'E

-5	32.2	357.4
N	32.8	351.8
+1	32.8	351.8
2	34.6	350.0
+1	34.0	350.6
+2	32.0	357.6
5	32.0	357.6

86'E = End

-4	39.6	345.0
-2	41.4	342.2
5	41.4	343.2
+2	41.4	343.2
2	39.8	345.0
N	38.0	346.6
+5	36.3	348.3

2/24/27

(5)

28th St -

Place Intake - Mt St
to Island -

Long 30 to 36" Pipe from J. St

36" Pipe - at K is $\frac{1}{2}$ full of sand,
Place Intake - S. R. W. 28th St

Station 100

1/8/27

434.0 + E.L. 33.0 ft.

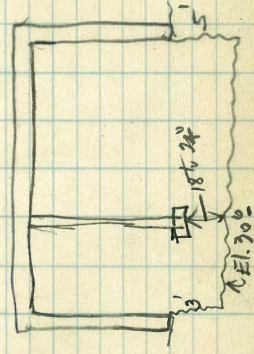
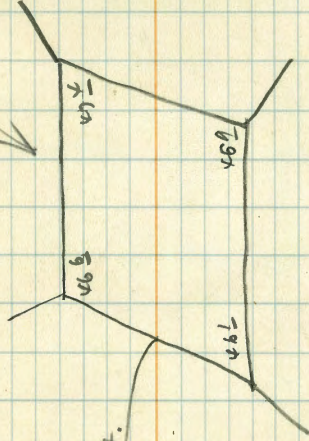

4 Market St.

N. W. 31 ² + Thorn -

219.00

N. E. Grim & Upst.

322.90

(7)

Walker
2-16-77

(8)

Levels in Alley
Bet 3rd + Boundary St.
From N.W. Lincoln to N.W. Boundary of E. of Alley

SE BP
P.O.K. 1st rd 177 354.81 353.04
T.P. 4.74 352.80 6.25 347.86

0+00 = N.W. Lincoln Ave

E top cb 7.03 343.8
E on Ground 8.5
W top cb 8.99
0+25 = d 6.1
+75 5.4
1+00 5.0 347.8
+35 4.8
+85 4.6 348.2
2+50 4.9 347.9
3+00 5.2 347.6
+50 5.3
4+00 6.0 346.8
+70 6.4
5+00 6.9 345.9

5+40 = N.W. Boundary End of Alley

5 top cb 6.19
E of Alley on Ground 6.8
N top of cb 5.72
T.P. 8.70 355.37 6.33 346.47
chk on 2nd P.O.K. + 3rd 7.32 353.65
353.04 = 817
0.01

MAR 27
1862
S.E. 1/4
P.M. 4
T.P.
5
8
11
14
17
20
23
26
29
32
35
38
41
44
47
50
53
56
59
62
65
68
71
74
77
80
83
86
89
92
95
98
101
104
107
110
113
116
119
122
125
128
131
134
137
140
143
146
149
152
155
158
161
164
167
170
173
176
179
182
185
188
191
194
197
200

171

70

Hawthorne

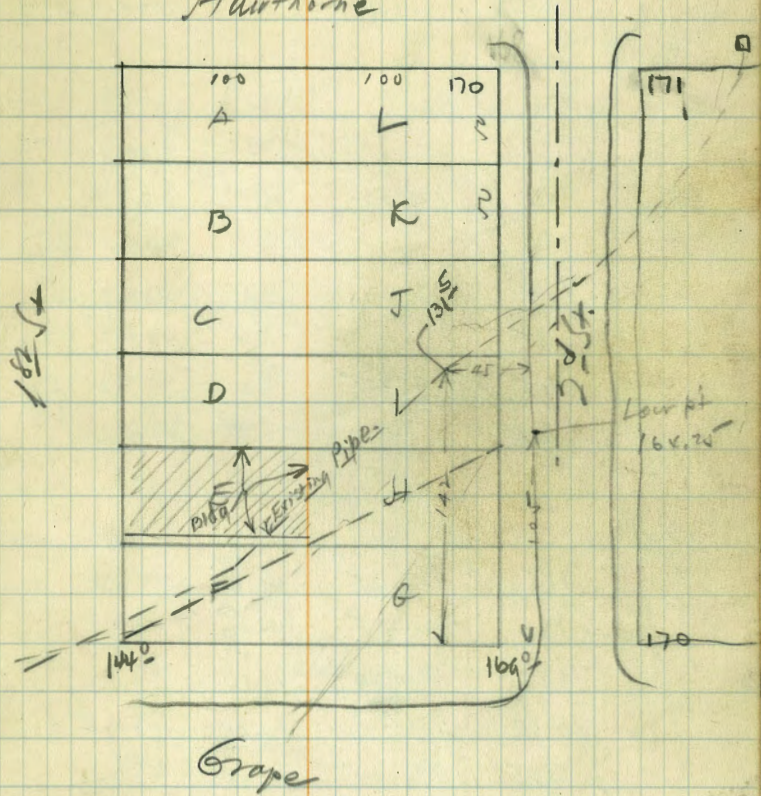

306.12

7.17	311.27		3x10
Dist.	az.	-	
248	176-15	4.2	307.1 curb-
		7.-	304.3 F.L. hole
203	129-00	8.7	302.6 to
		4.1	307.2 curb-
120	176-30	4.8	306.5
85	116.-	8.2	303.1 M.P.L. upas
65	98-15	8.0	303.3 S.P.L.
64	✓	10.7	300.6
		12.6	298.7

306.1

		8.2V	302.93	curb-
		8.0	297.8	F.L. 33" Pipe at Gregory-
115	327-45	-4-10	297.8	F.L. 24" 4" Top Pipe
180	328-45	-4-00	293.5	
375	327-30	-2-14	287.7	
490	326-	-2-30	284.8	
535	325-30	-2-30	282.8	

150

0+10	F.L. Felton-	307 ² F.L. 307 ²	
1+20	306.5		1+10 262 ⁸
1+60	305.5		7+15 262 ⁸
2+01	307.2		
	300.2		
2+90	Buy 33" Pipe.		
3+60	and		
4+70	241.5		
6+70	241.2		

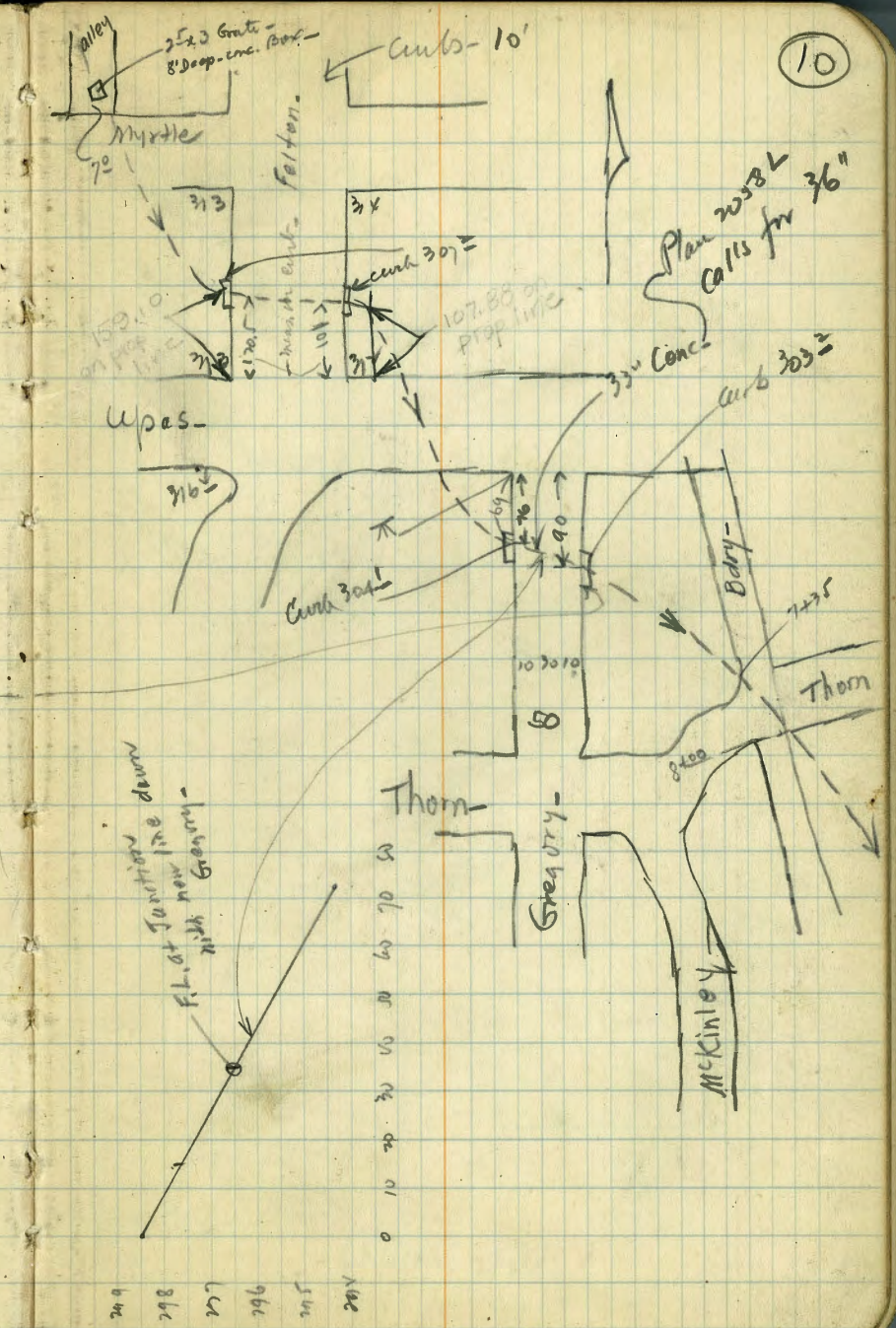

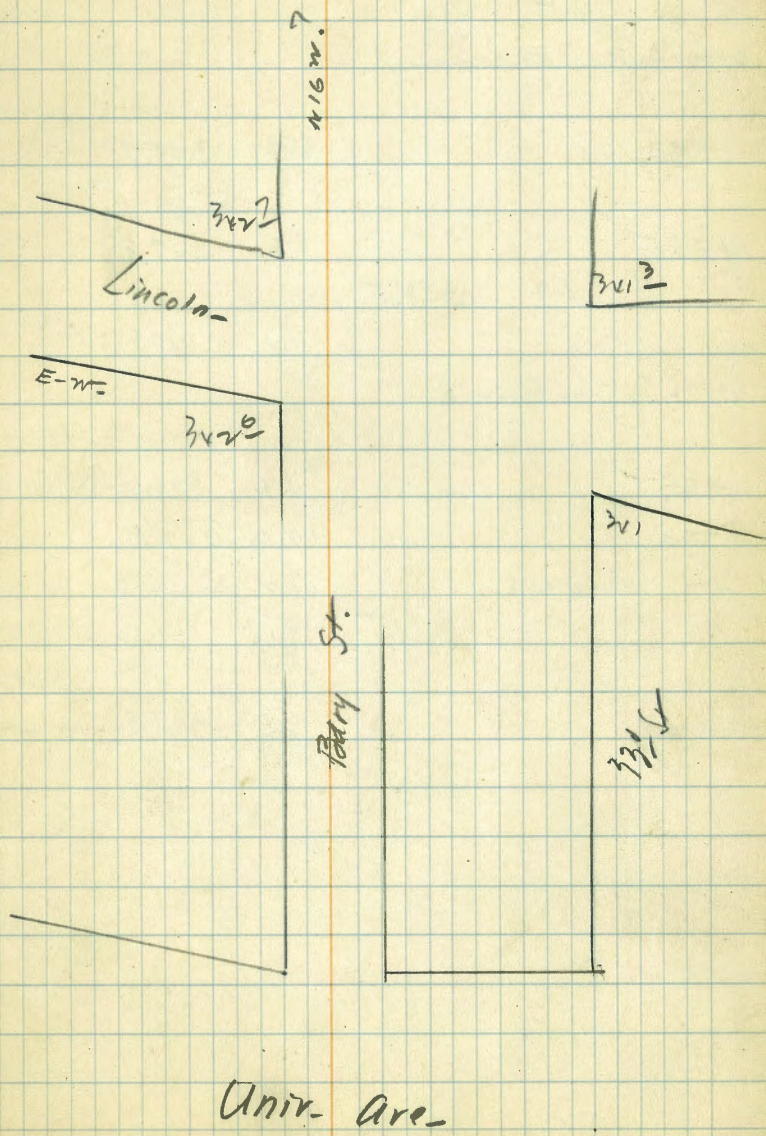

7. C6 - Estrella

+ π -

351.4

5. - 356.4

0+00 S. P. L. El Cajon -

1+90 6.7 349.7

4+35 8.6 347.8

5.7 353.5

4.1 349.4

0+00 - S. P. L. Florence -

+95 4.1 349.4

2+70 10.6 342.9

2+ End of curb - 2.2 346.3

348.45 2.5

1+10 13.1 335.3

(12)

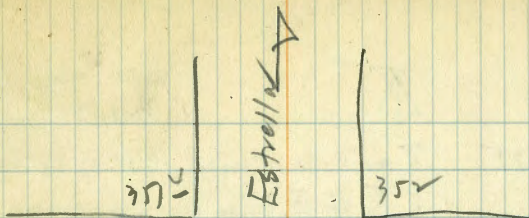

El Cajon

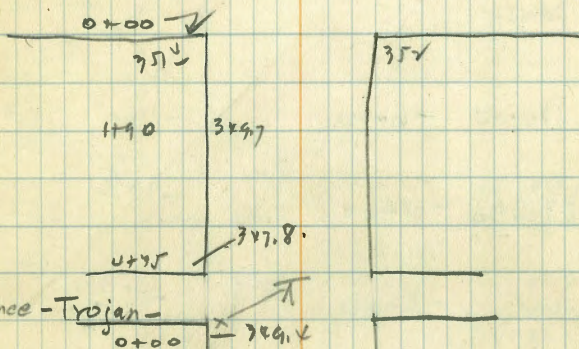

Florence - Trojan -

near to E of cut line.
H. 348.45

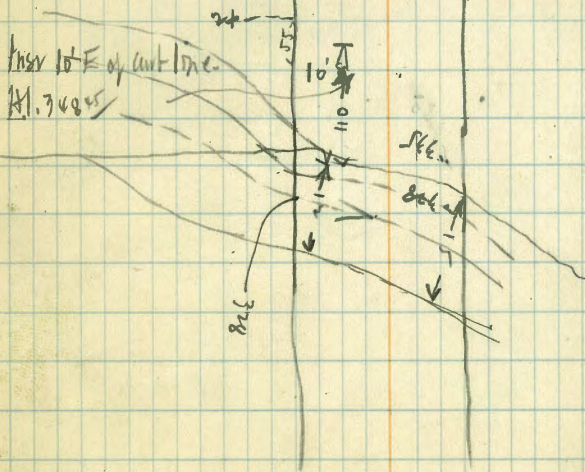

351.4
110
365

(70)

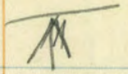

341.7

6.75 T on E. S. York. Bldg. St. 10' N. of N.P.L. Lincoln
5' E. of E. cut line.

(342.6)

A200 Ptg. Sfy down Bldg St 347.85 16.4 331.4 FL 48" Pipe

108 330-00 -6-00 -10.4 332.4

145 ²⁰ 330-20 -4-00 N.P.L. Lincoln -13.6 329.0

285 ²⁶ 330-18 -3-00 -15.0 327.6

(13)

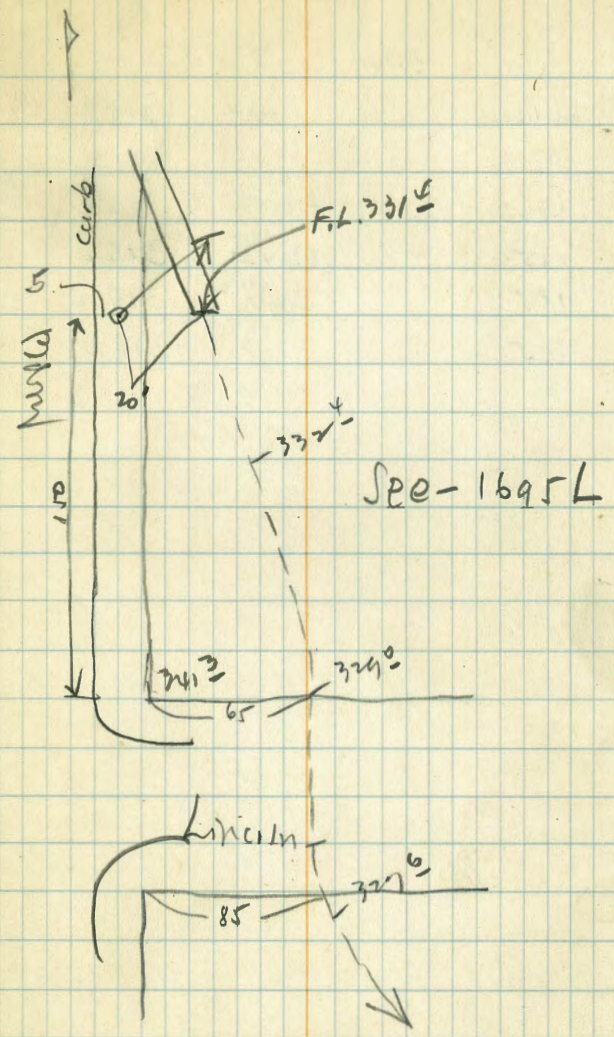

306-

Alley S. of Aprs - bet Gray + Holton -

(74)

311.7

0710 = S. C. L. Aprs -

200

309.3

0710 132

^{26.7}
+2-55

312.8

1 155

^{29.9}
+3-48

316.0

+10 185

^{33.2}
+3-55

318.2

2 225

^{36.7}
+3-50

319.8

$\frac{8.5}{170} = 7\%$
 70" Con. Pipe = 40 g.f.s.

N.E. B.P.		
Exist 14" drain	5.15	99.38
= 0+00 = Flow line	5.37	99.1
+35' = Junction with proposed drain	5.1	99.4
+25' N.W. of " = H of Proposed drain	4.5	100.0
0+50	5.4	99.1
+19.4" on top of 2'x2' Grate	8.06	96.4
+19.6" Flow line 20" Con Pipe	17.90	86.6
Flow line at B	26.42	78.1

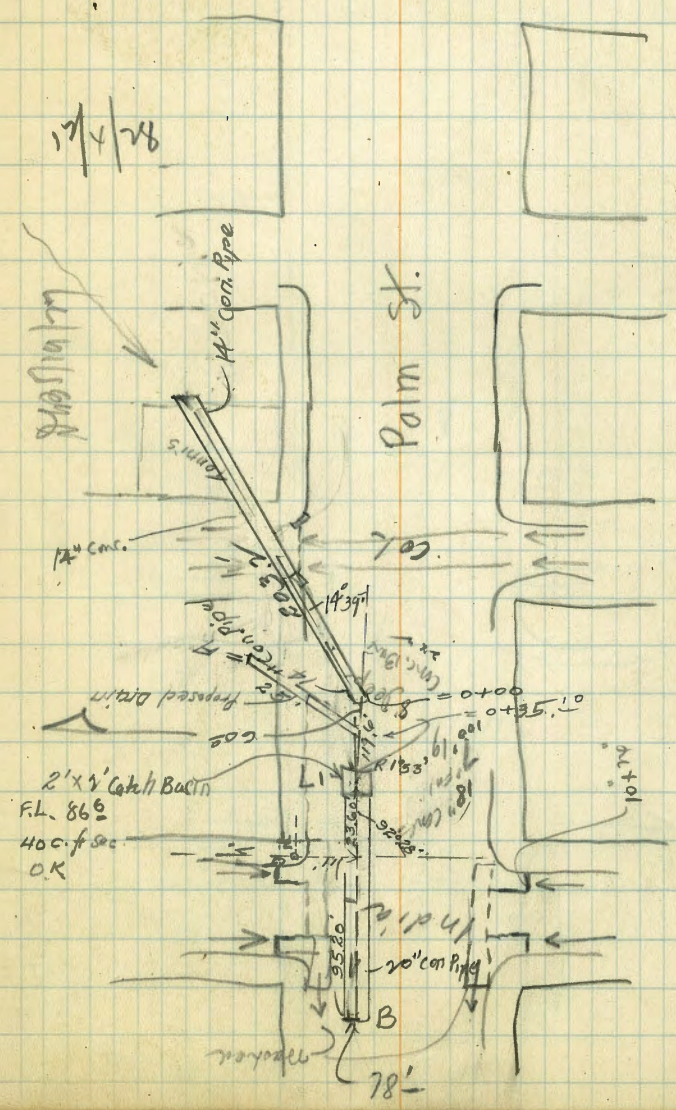
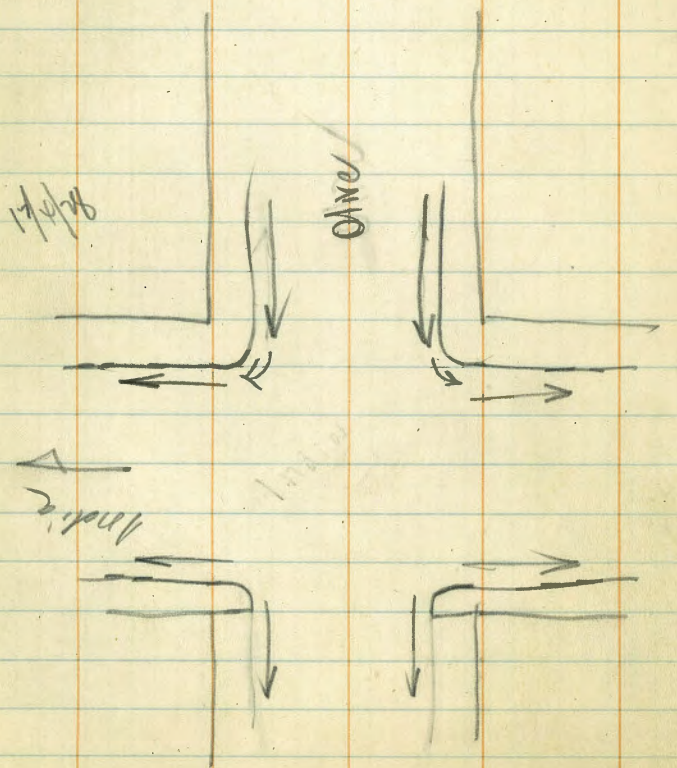

2'x2' Catch Basin
 F.L. 86.6
 400 f.s.
 OK

17/4/26

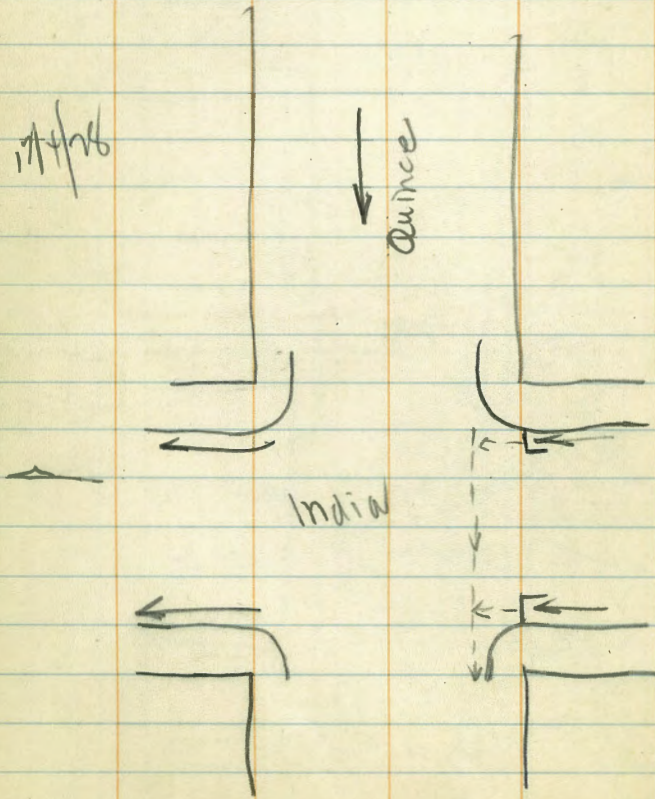

Handwritten scribble

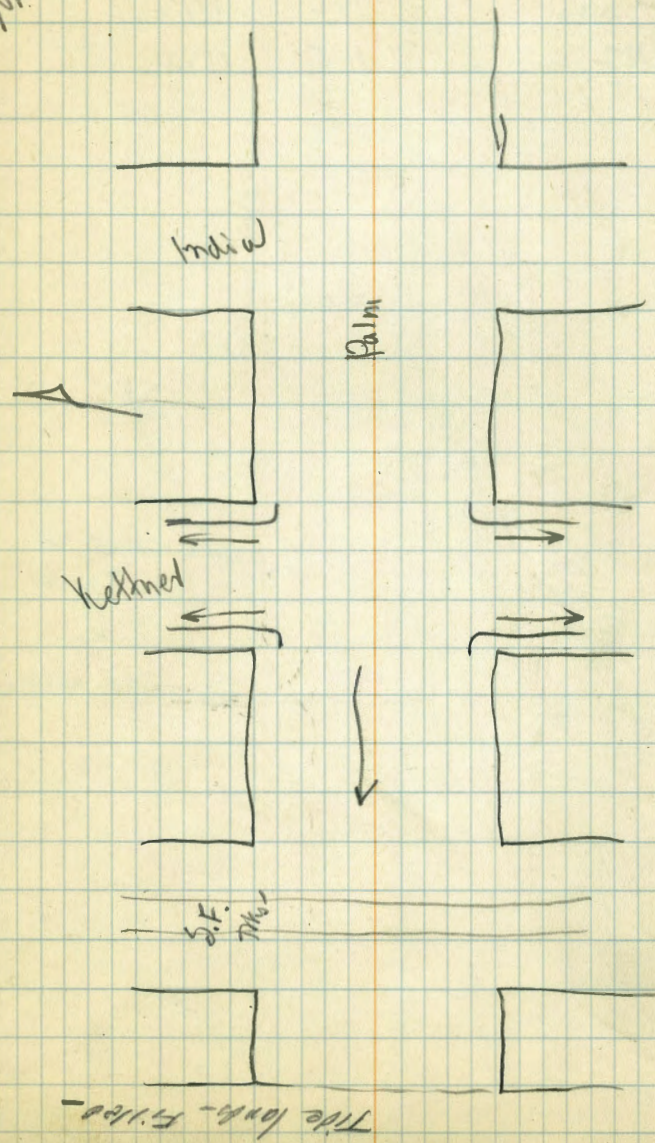

8/13/2017
AM

	+	π	-	E1.
	460	163.60		159.00
① 110	262.30		126	151.0
② 140	287		11.5	152.1

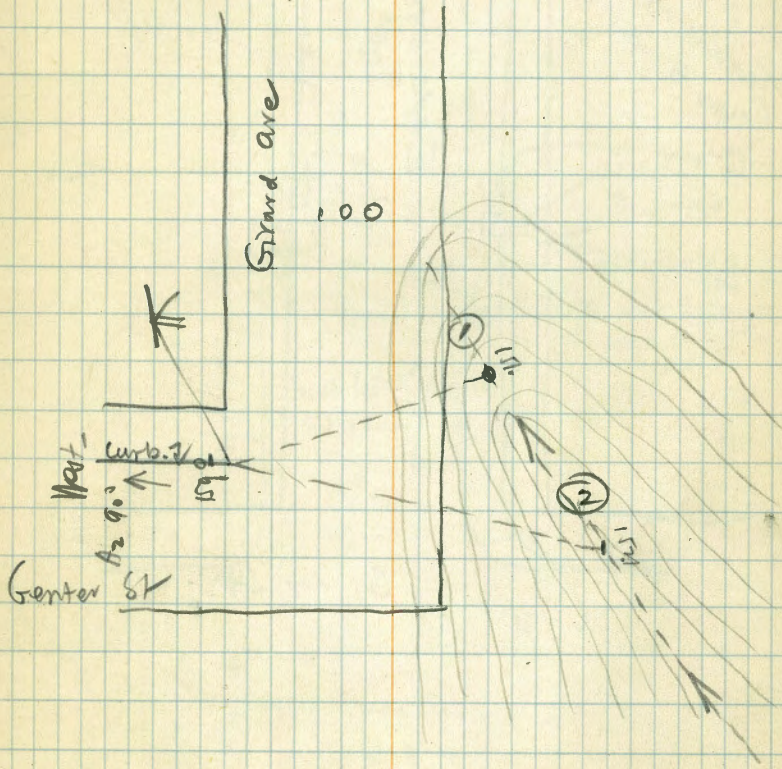

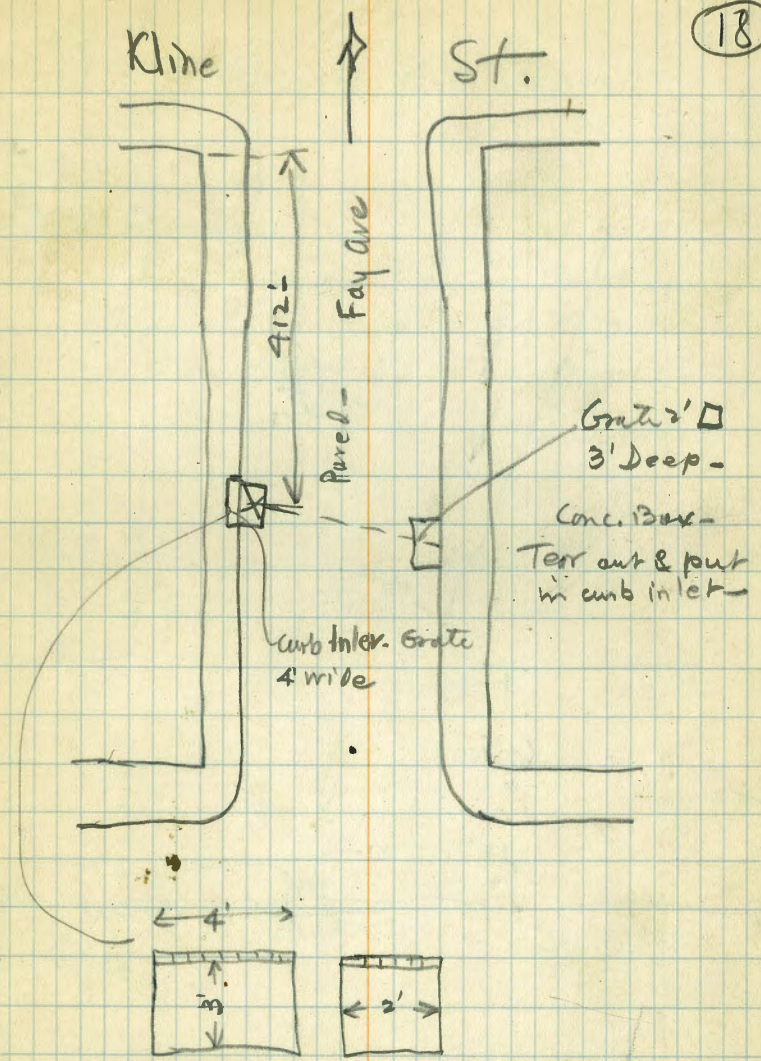
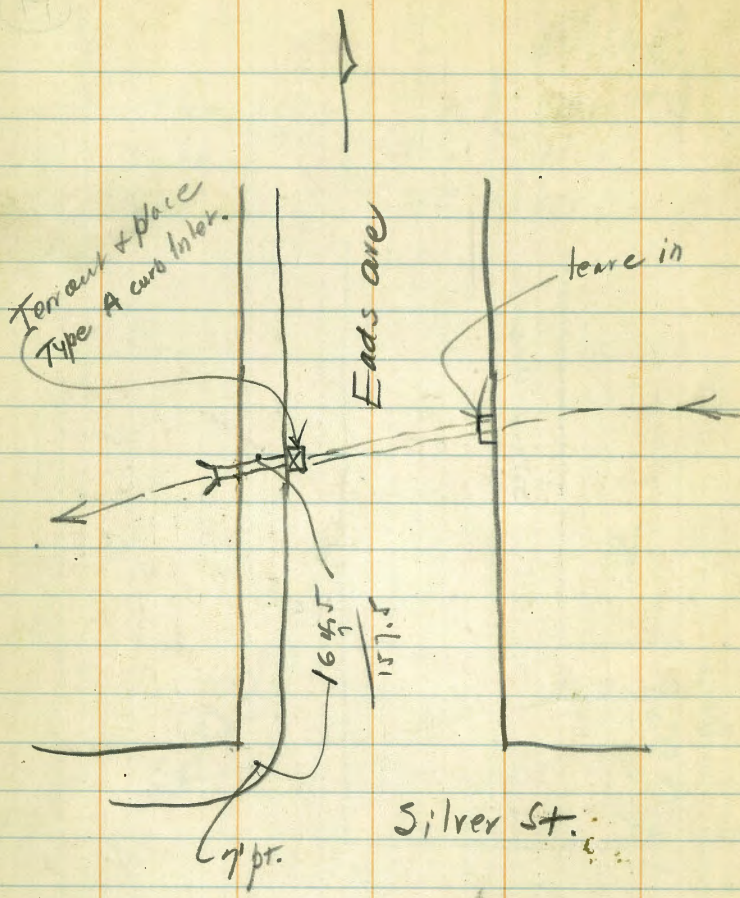

6/4/27 Mission Beach Sea Wall

Driving Piles-

1 Foreman -	10.-
2 Eng. men -	16.-
4 - on Piles -	20.-
Penney Drive -	10.-
Exc -	5.-
<hr/>	
	61.-

Drive 40 per day = 15' each

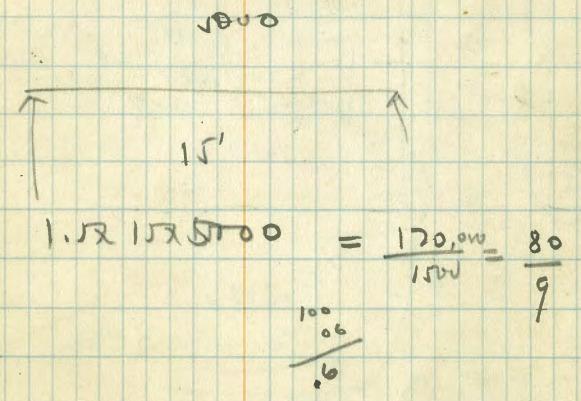
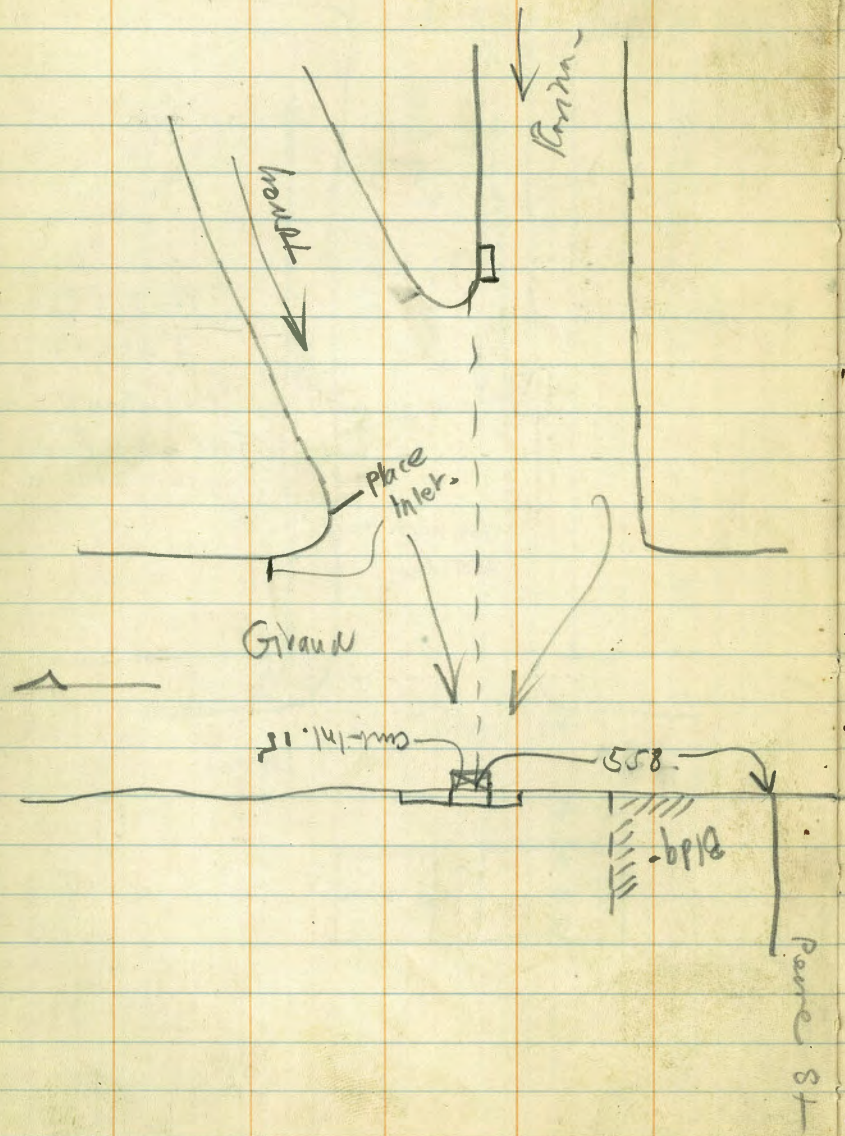

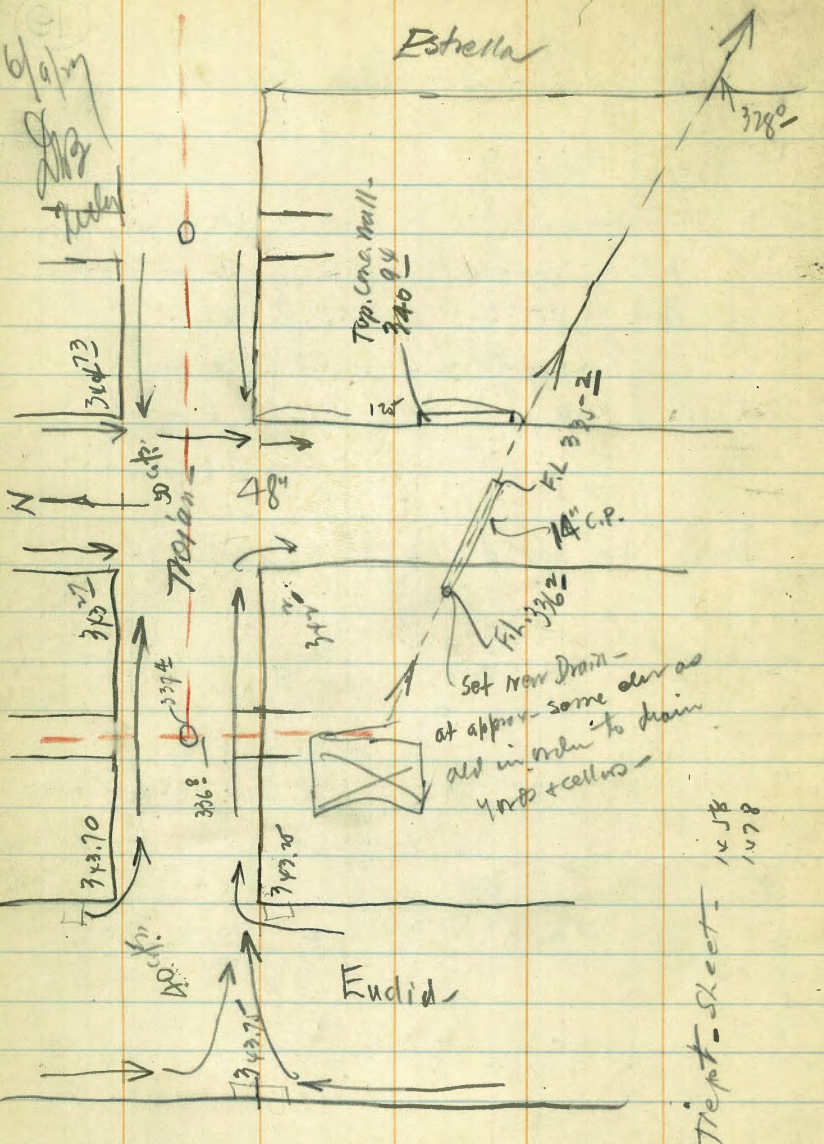

Mm. N.E. E.C. & Euclid - 3482

Next Sheet - 1478
 1478

(50)

E. St	347.50	340.94	
4.13	343.37	N.W. cor Trojan	N.W. cor Trojan
7.66	344.84	N.E. cor 48°	N.E. cor 48°
3.80	342.70	N.E. cor Euclid & Trojan	N.E. cor Euclid & Trojan
4.25	343.25	S.E. cor do	S.E. cor do
3.75	343.75	S.W. cor do	S.W. cor do

(344)

Dir. Inst. S. N. cor Trojan & 48° St.

80.	49°	9.4	338.1
70.	16.0°	9.9	337.6
75.	350°	F.L. Pipe 11.2	336.3 ✓
100.	320	fr - 2-20" 7	- 7.0 335.-
180	326	- 2-07" 3	9.8 332.2

3.64	346.89	343.20
5.34	341.55	M.H. Top -
+ 4.7	336.8	F.L. Sewer No
+ 4.1	337.4	✓ East

See page 42
 1207

Solar Obs. - R.L. Date St -
Jun-9-1927 3-05 P.M.

Horiz. Vert.

R 0°-33' 45°-45'

0°-53' 45°-12'

(21)

~~Mrs Seidel - 3792 Ala. St.~~

~~Lat 36 & S. 15 37-~~

~~257 W. H.~~

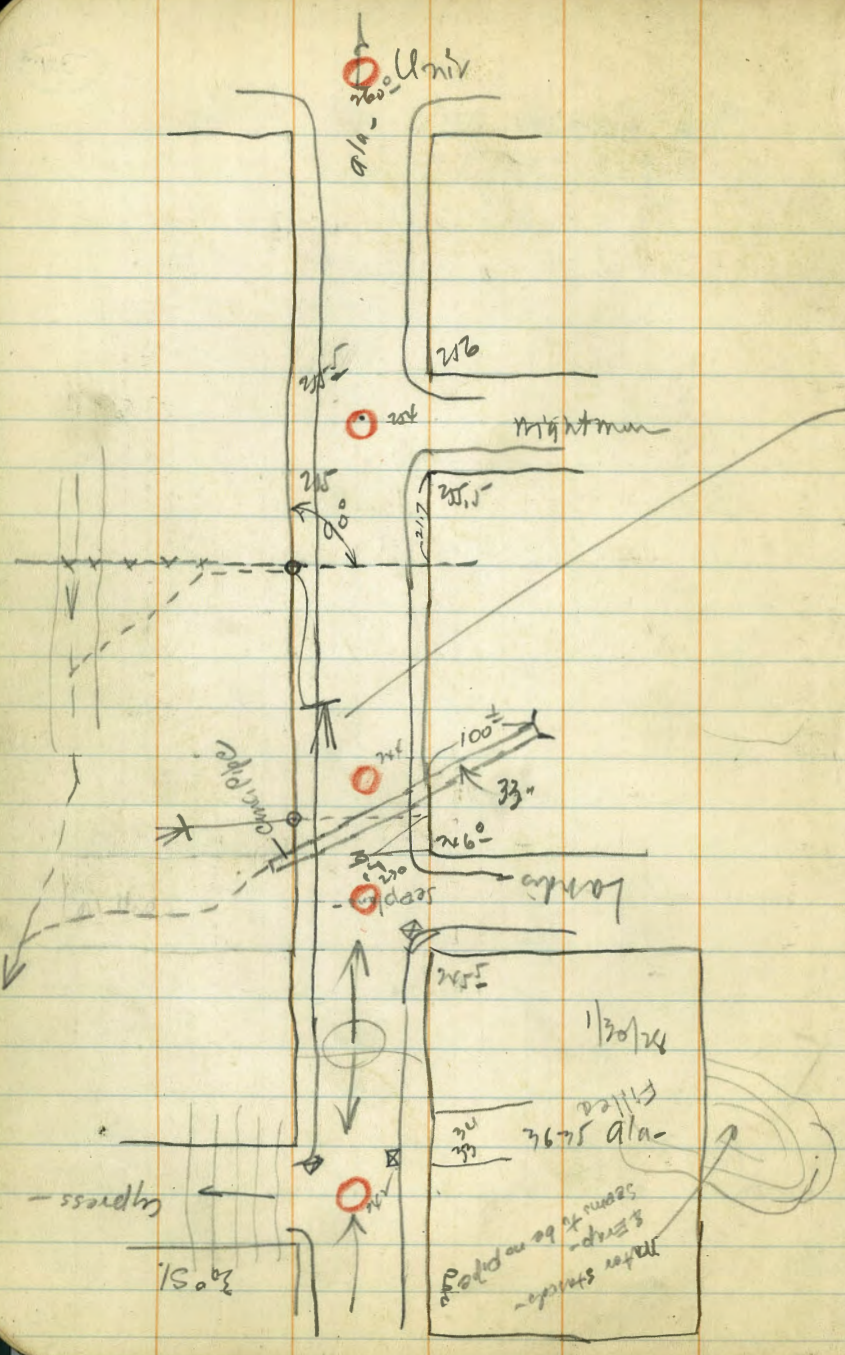

(50)

497 260.43

255.0

4.40 256.03

(255.4)

Dist	Az.	V.A.		
25	90-	-18-20	-7.4	248.0
65	90-	-16-	-17.2	238.2
120	90-	-8-20	-17.2	235.2
143-	90-	-8- Eq	-19.7	235.7
147	90-	-8-25 Bk	-21.5	233.9
156	90-	-6-88 Edg	-16.7	238.7
100	74-	-10-32	-18.0	237.4
140	68-	-8-40	-20.8	234.6
150	64 1/2	-8-25	-21.7	233.7

(52)

5.33 251.32

246.1

164	249°-00	-1-06 up 4 ft 33° cut	-7.1	239.0
32	29-20	-22-45 da	-13.2	232.9
65	54-30	-15-15	-17.2	228.9
150	84-30	-7-35	-19.6	226.5
200	85-	-5-15 Main Str.	-22.8	223.3

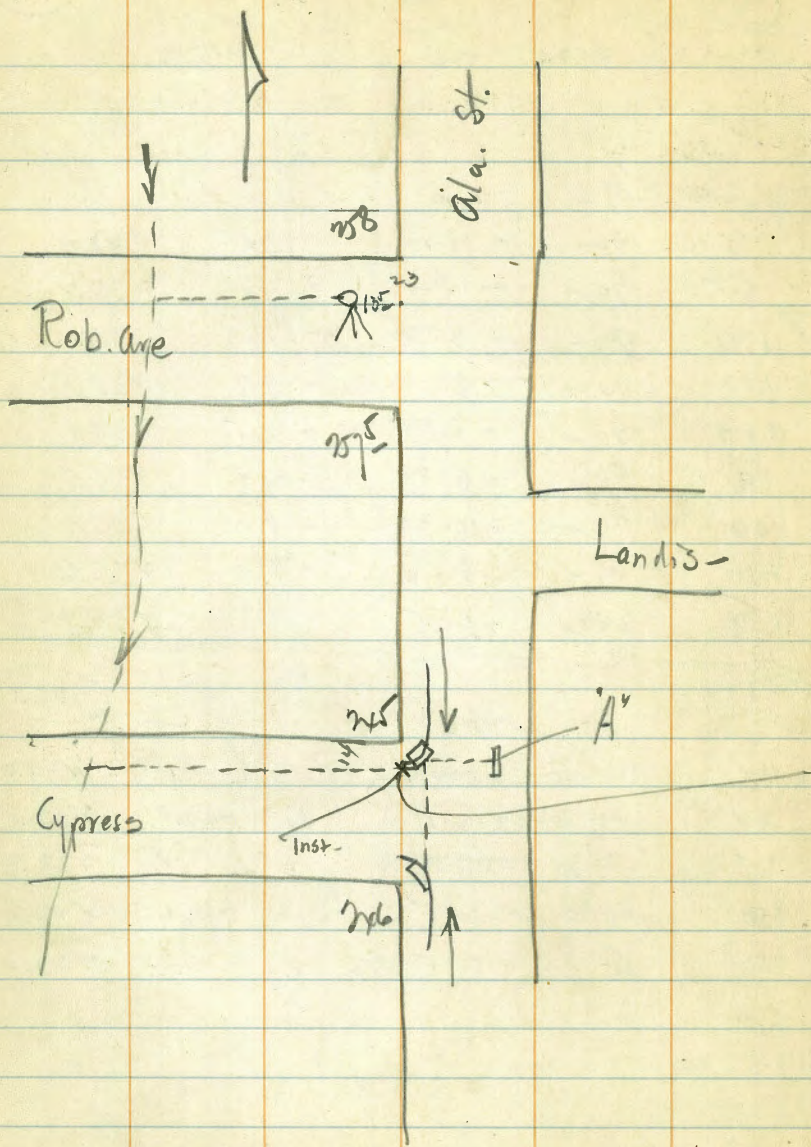

(53)

Dist	4.90			258.-
257.3		262.90		
160.20			7.3	255.6
96.110		-12.40	-20.7	237.0
130.144		-11.-	-26.4	233.3
155.159		-10.35	-26.7	231.5 Edge
155.169		-11.-	-26.0	228.7 channel

(23)

(114)

Insr.	4.9	249.90		265.-
37.		-29.15	-15.8	229.2 15" pipe
127		-13.-	-27.8	219.2 Edge
136		-13.05	-30.0	215.0 ch-

27.2
14.7
41.9

(24)

UPAS ST

GREGORY ST.

1623

419
HOUSE

CENTERLINE OF EASE-
MENT FOR STORM DRAIN
IN BLOCK "E" ALTADENA
SEE DRAWING N^o1294B

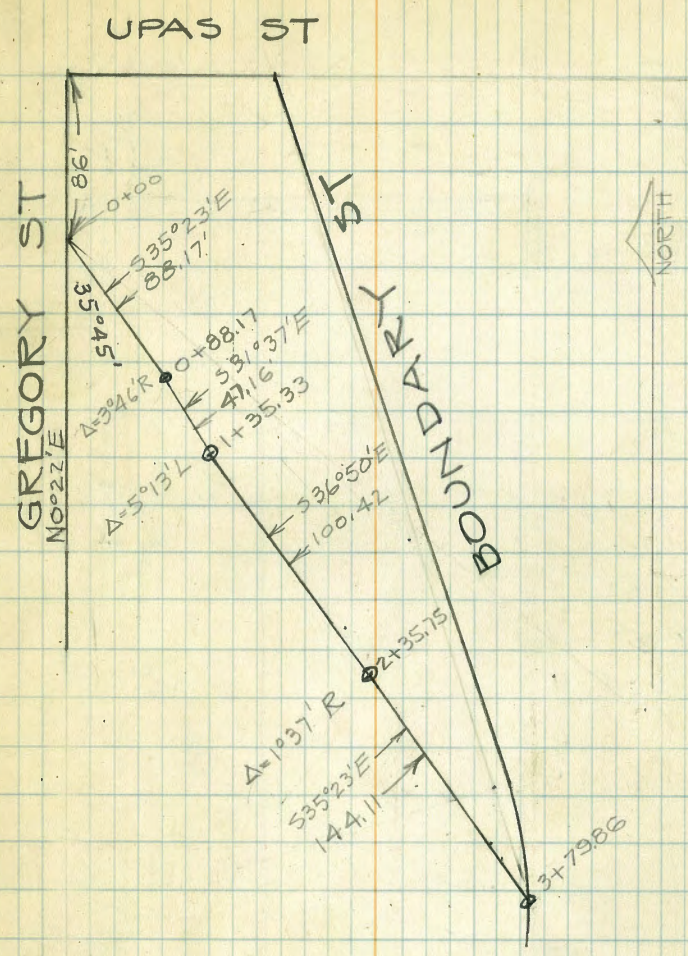

Bear	Dist	N	S	E	W
N 7° 31' W	25.42	25.20			3.33
N 16° 07' W	385.65	370.49			107.05
N 89° 55' 30" W	108.47	0.14			108.47
S 0° 22' W	86.00		86.00		0.55
S 35° 23' E	88.17		71.88	51.05	
S 31° 37' E	47.16		40.16	24.72	
S 36° 50' E	100.42		80.37	60.20	
S 35° 23' E	144.11		117.49	83.45	
		395.83	395.90	219.42	219.40

Dimensions from filed map No. 1663

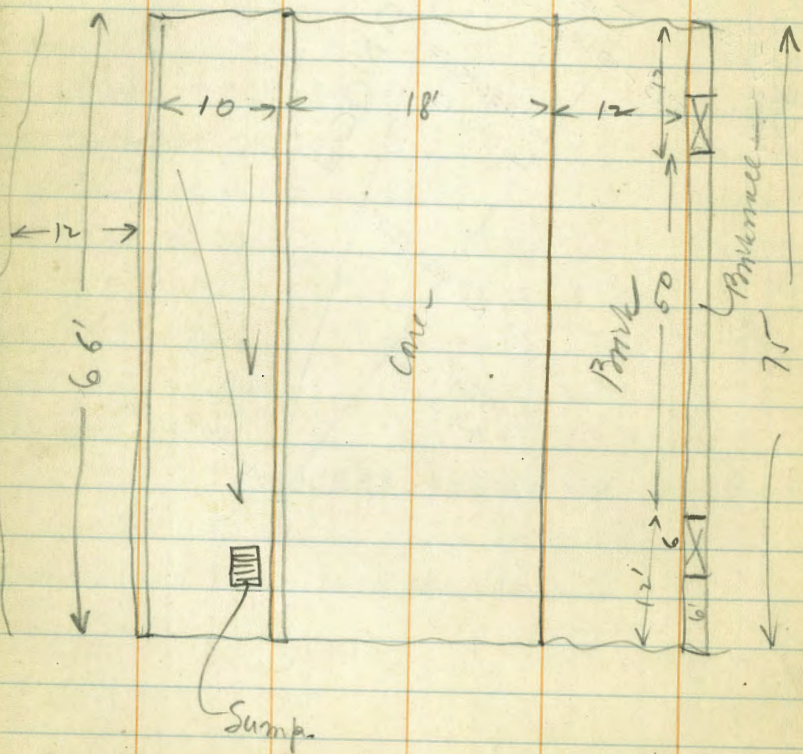
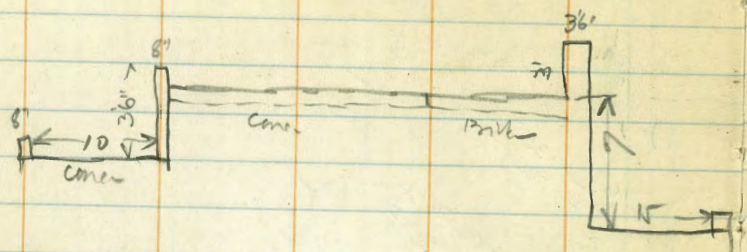

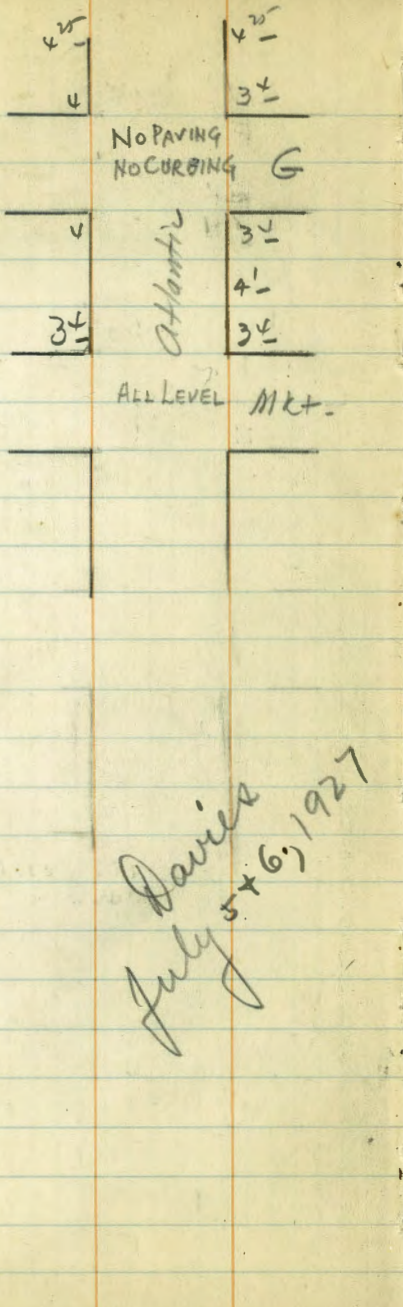
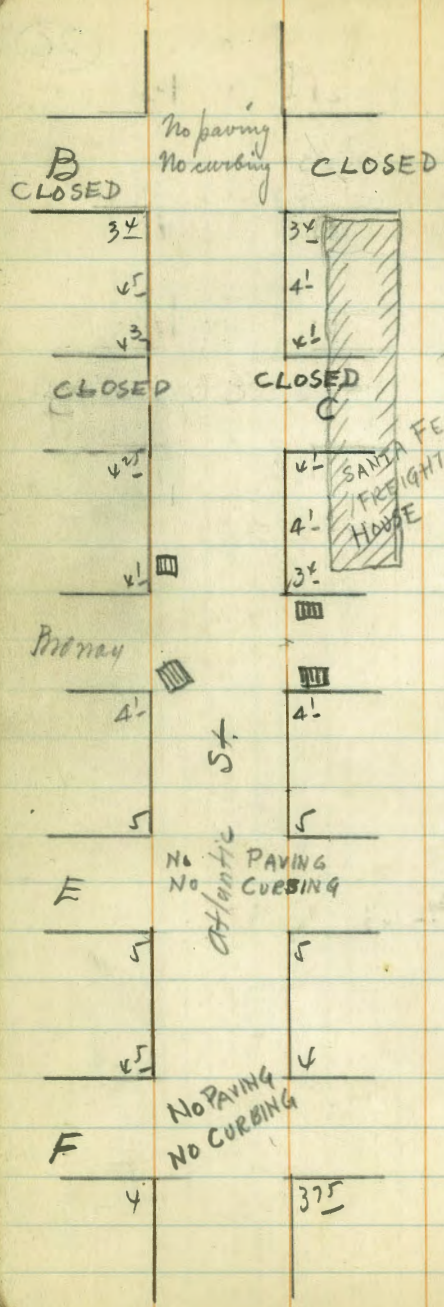

*Davis
July 5 + 6, 1927*

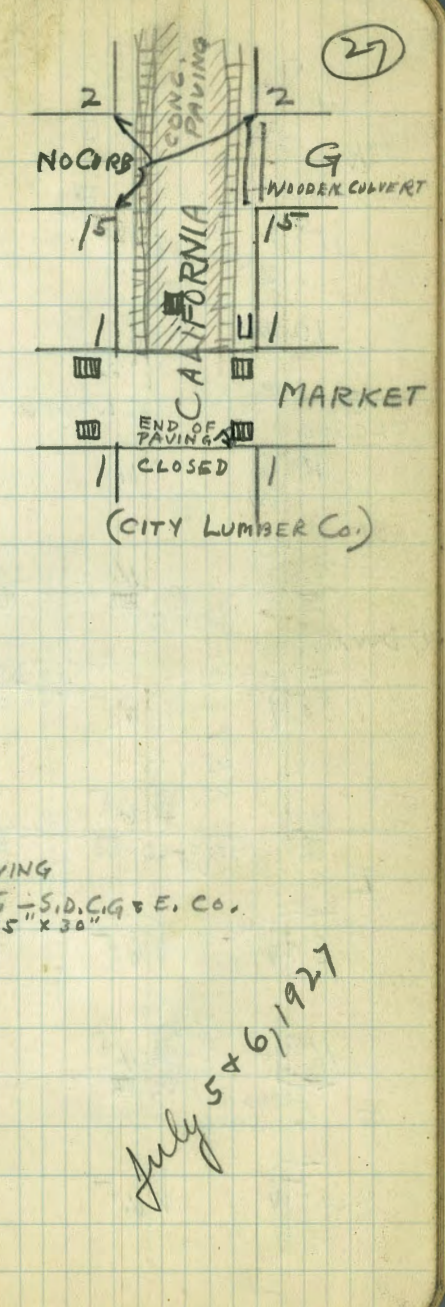
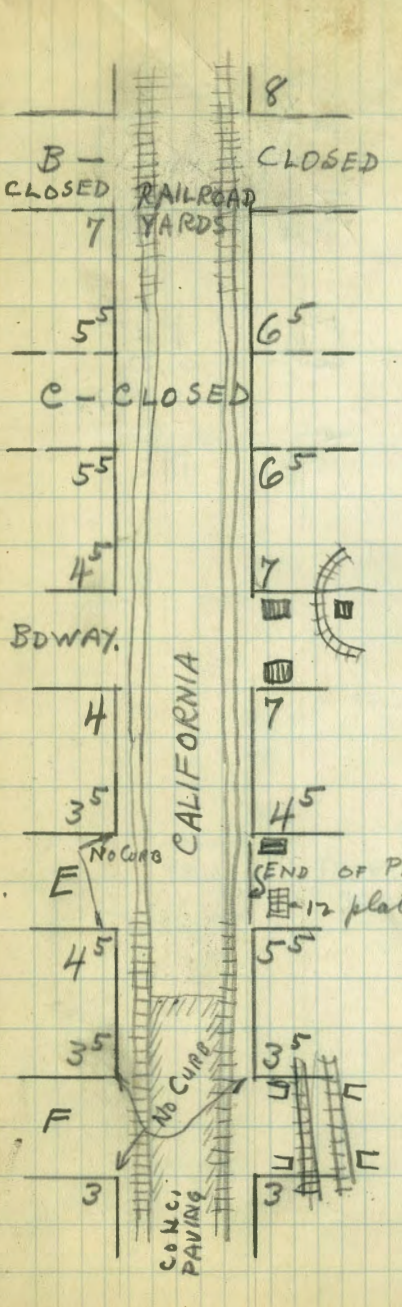

July 5 + 6, 1927

END OF PAVING
12 plates - S.D.C. & E. CO.
15" x 30"

(27)

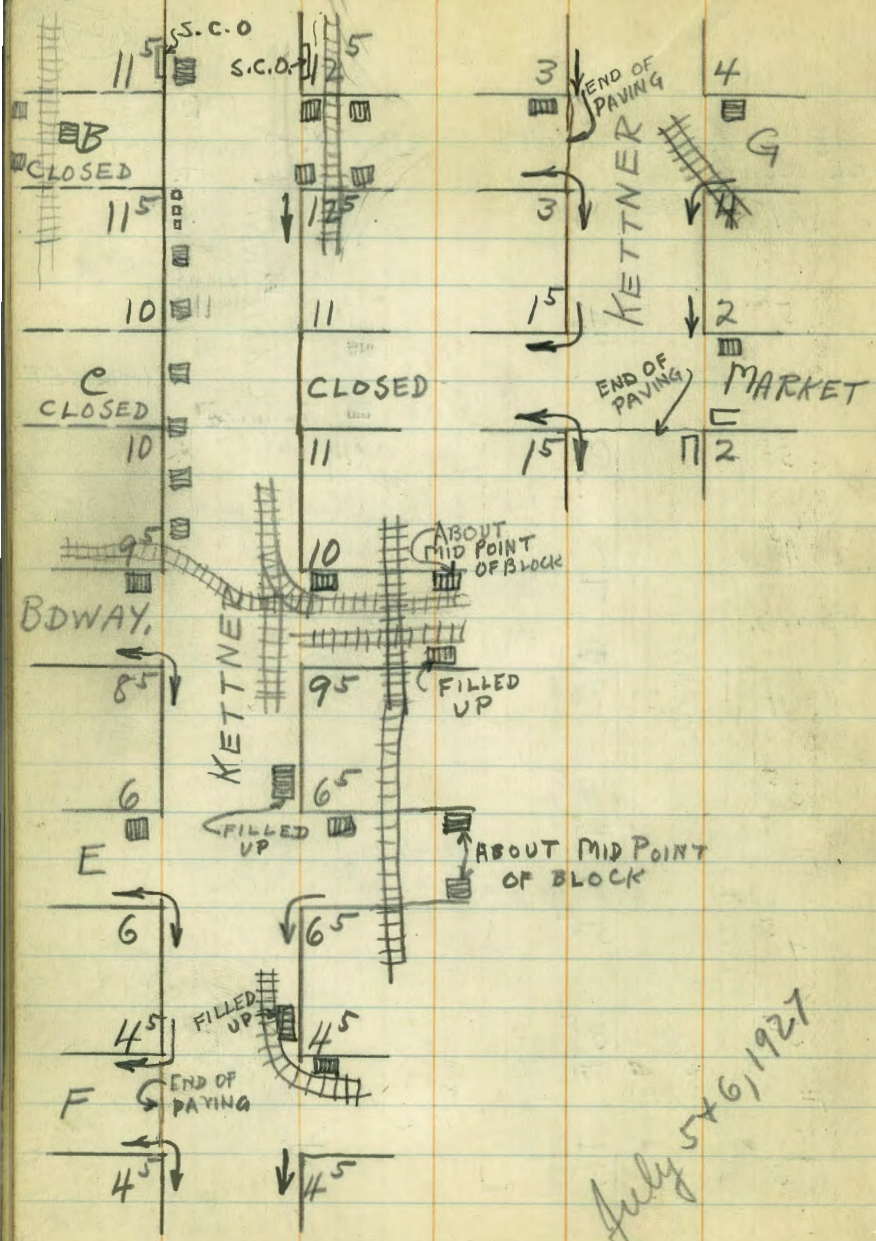

July 5+6, 1927

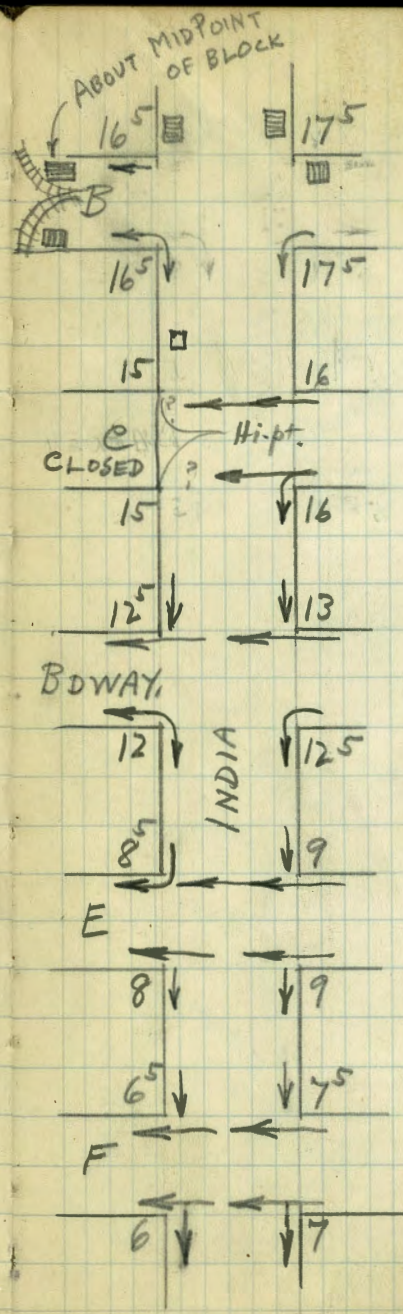

July 5+6, 1927

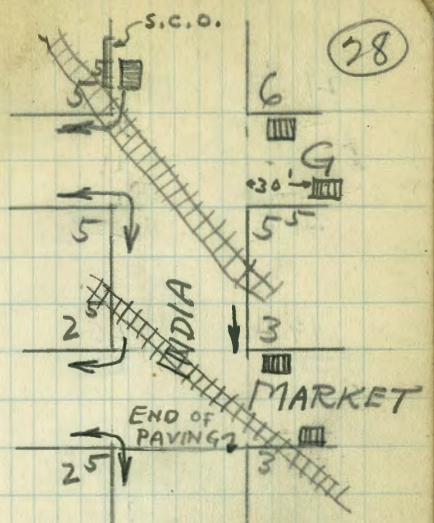

28

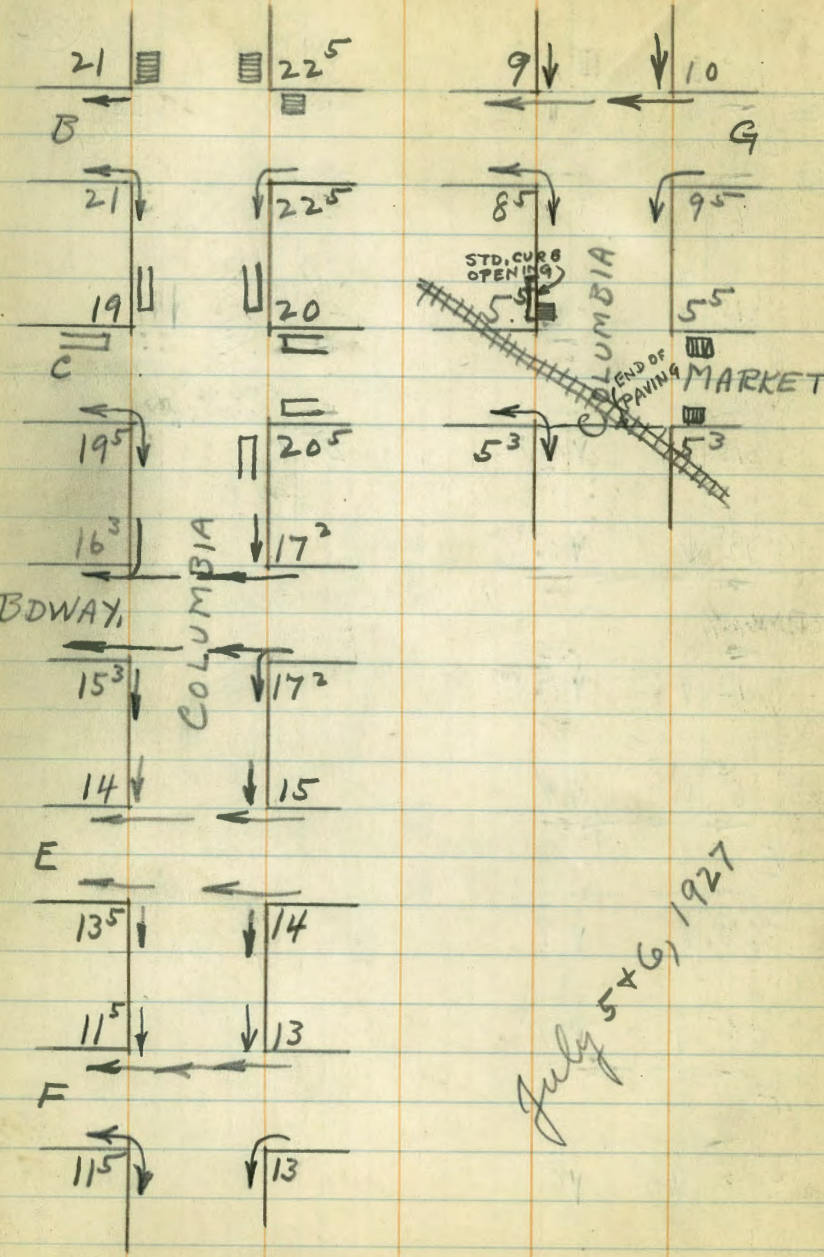

July 5+6, 1927

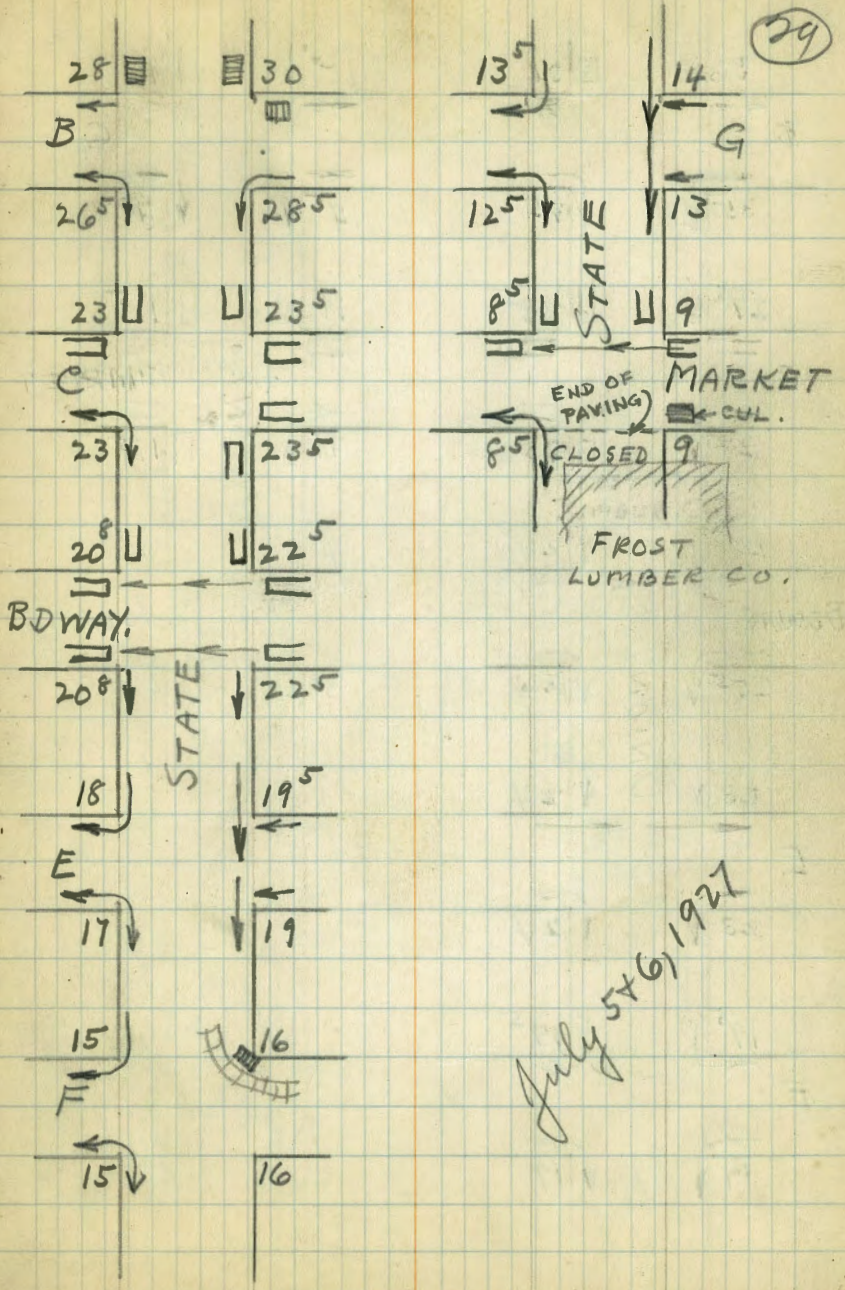

July 5+6, 1927

29

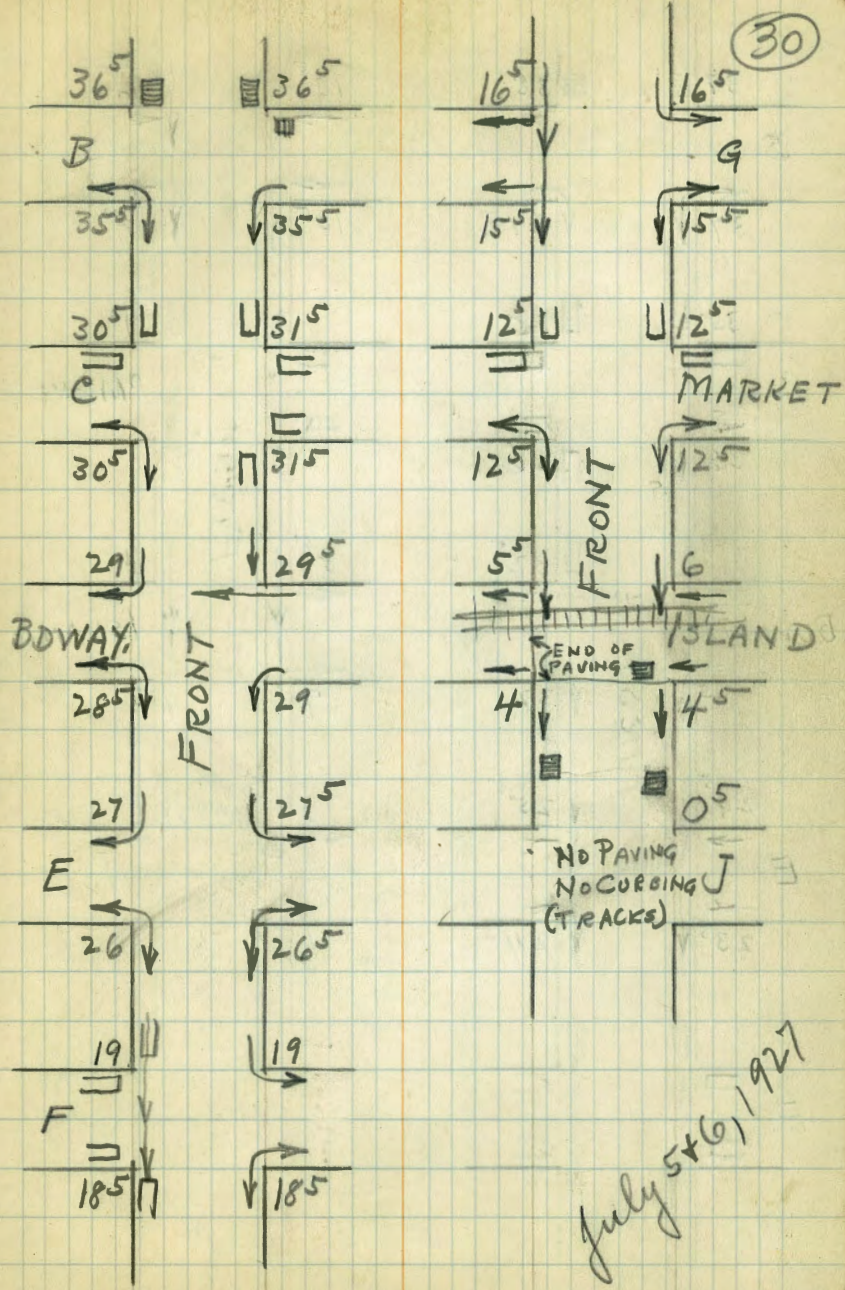
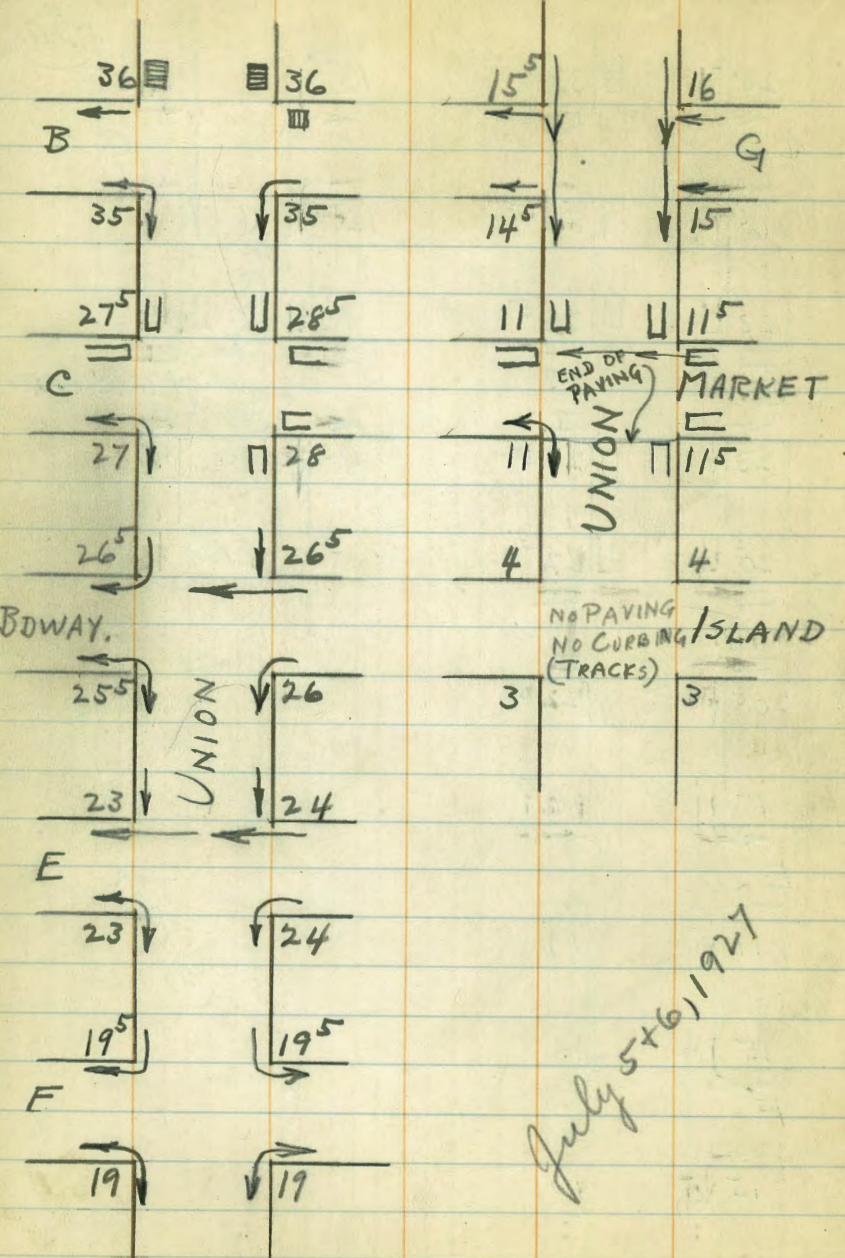

Check elev. on Atlantic + California

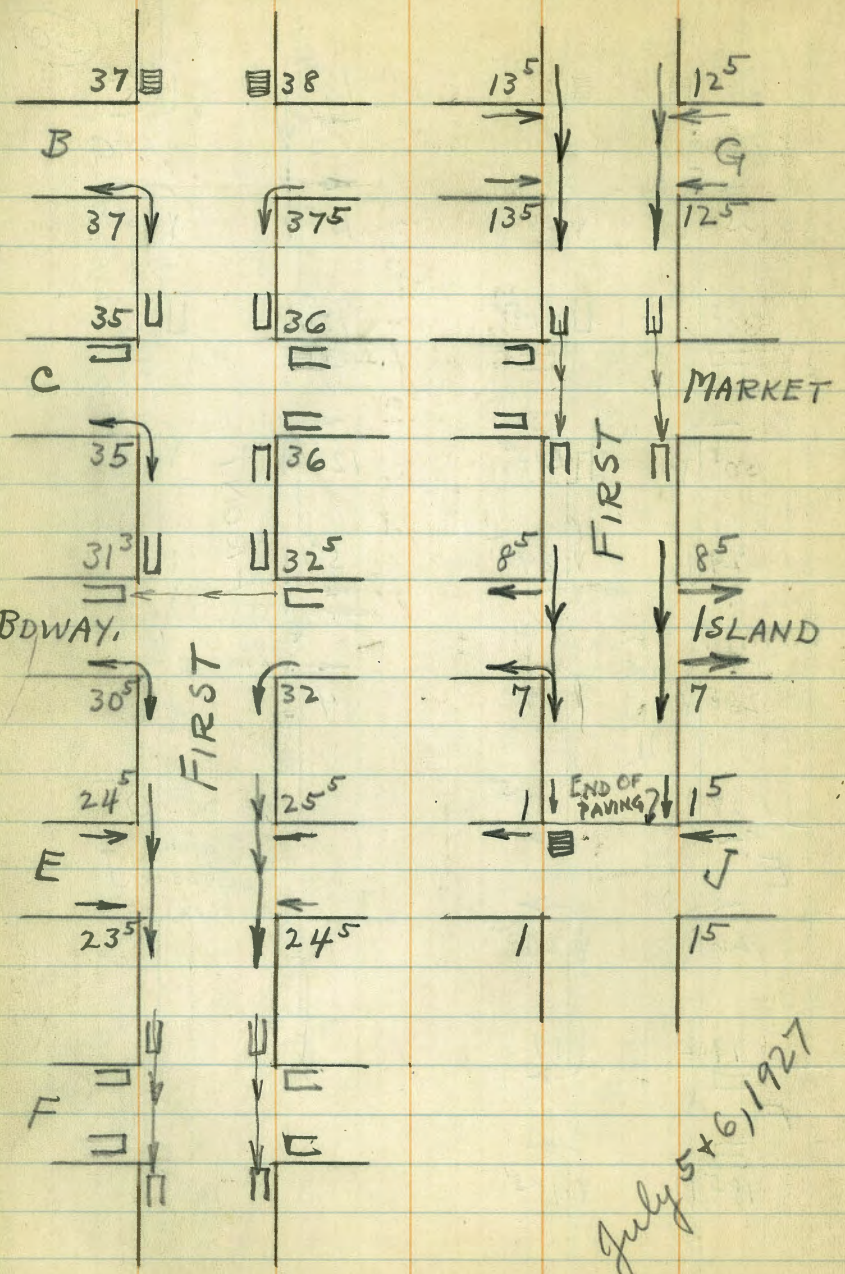

29

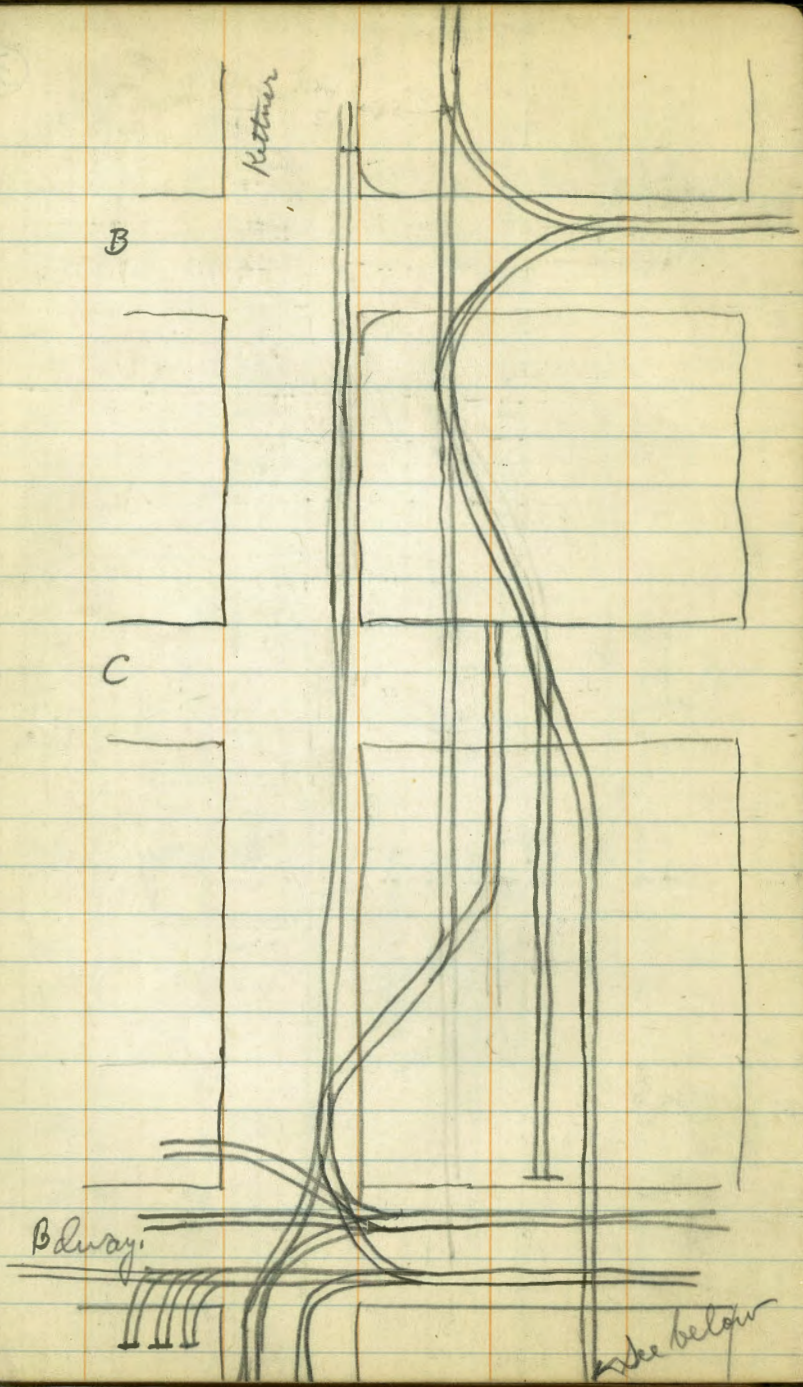

32

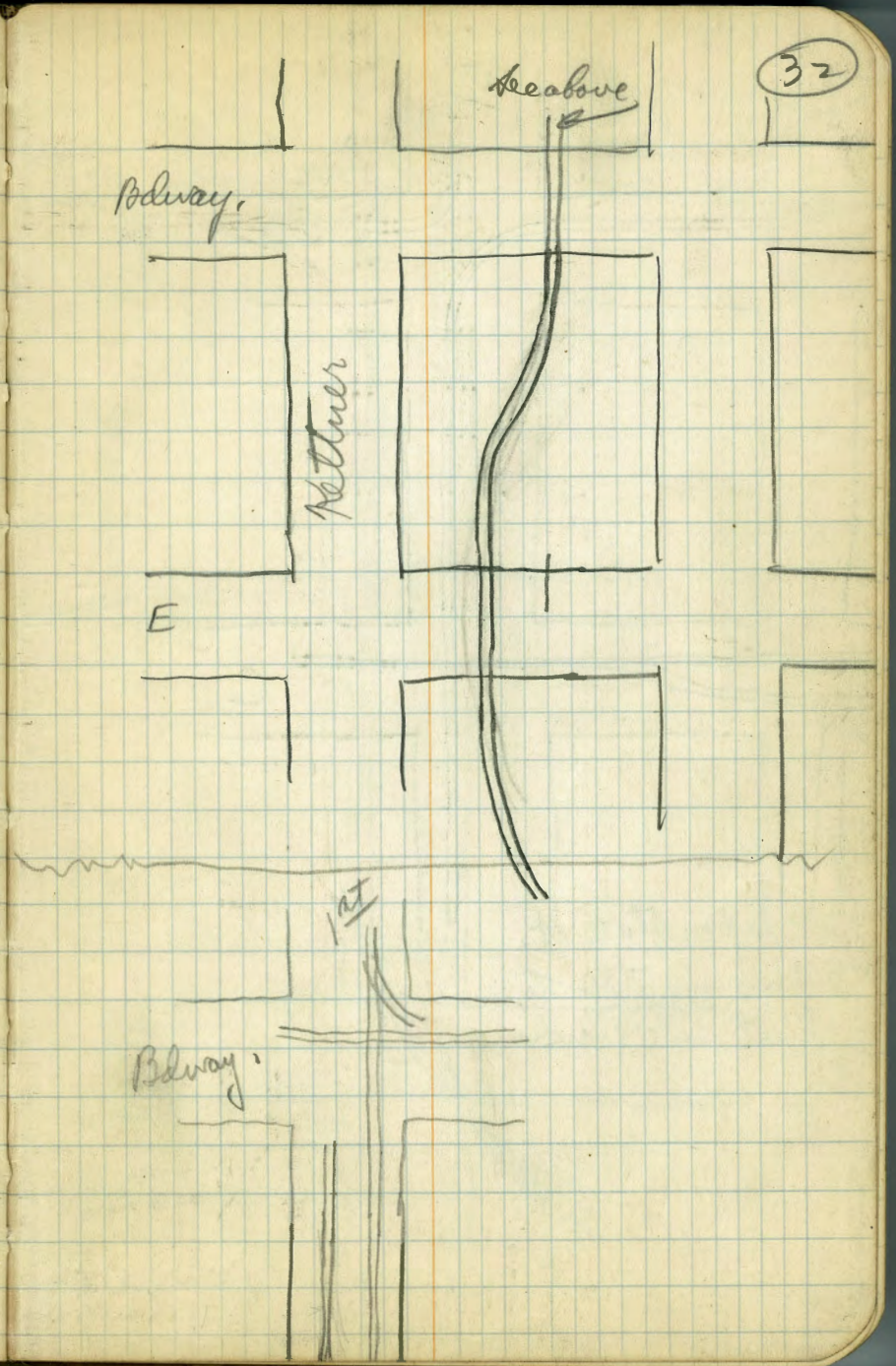

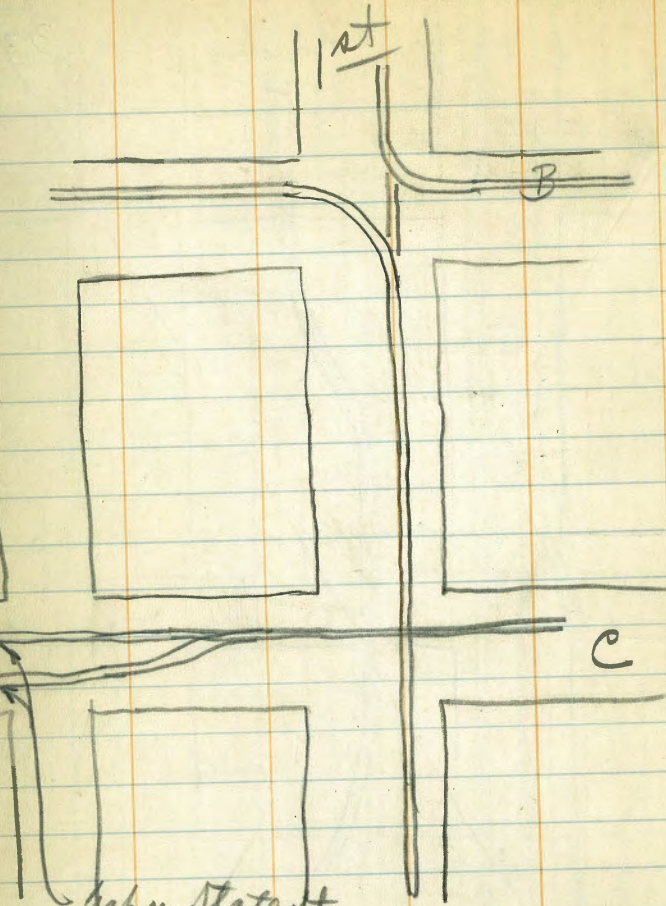

gap on State st,
then runs thru to,
West Side India

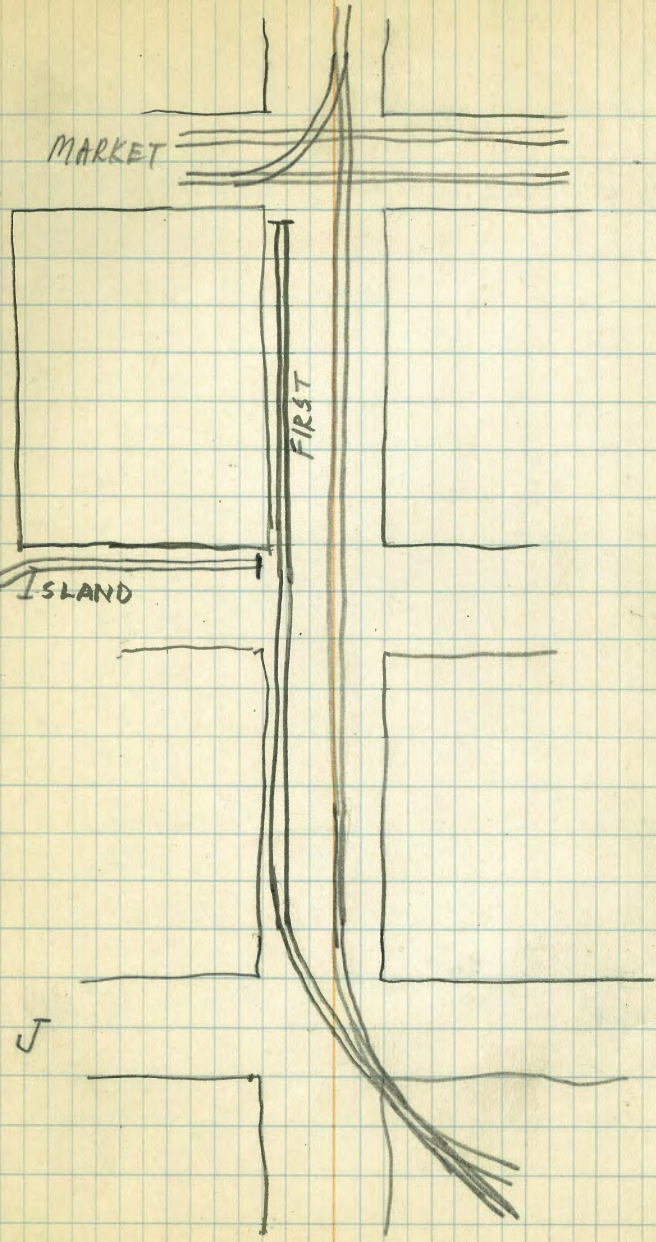

Map
Hmcc.

7/17/27

(34)

Sounding - Pac. Beach -

Inst #2.

Angle R. from Base line -

Shot

#1 56-07 @ 9⁰⁰ am

2 57-03

3 61-27

4 64-17

5 65-29

6 67-19

7 68-43

8 69-54

9 70-24

10 71-57

11 72-14

12 74-10

13 75-21

14 76-03 10⁰⁰ am



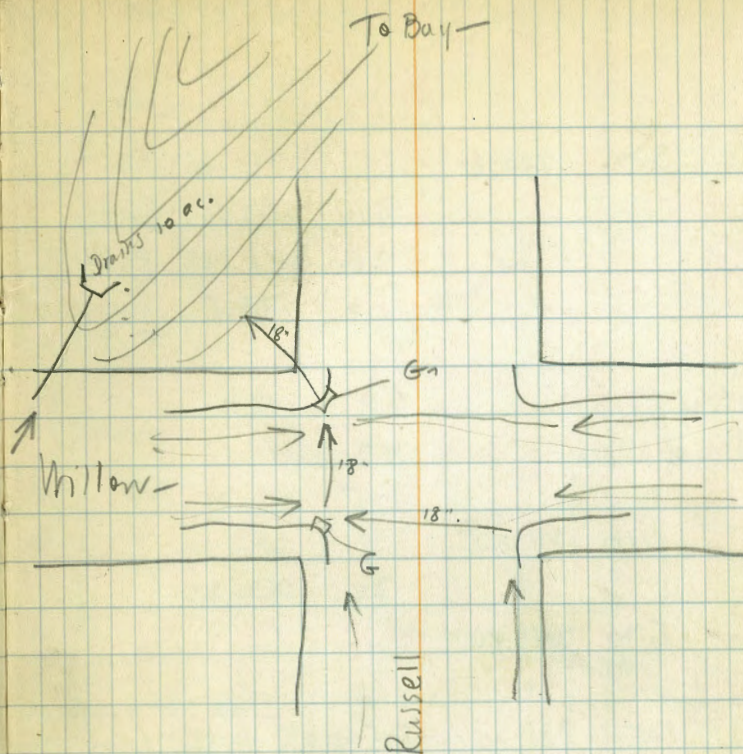
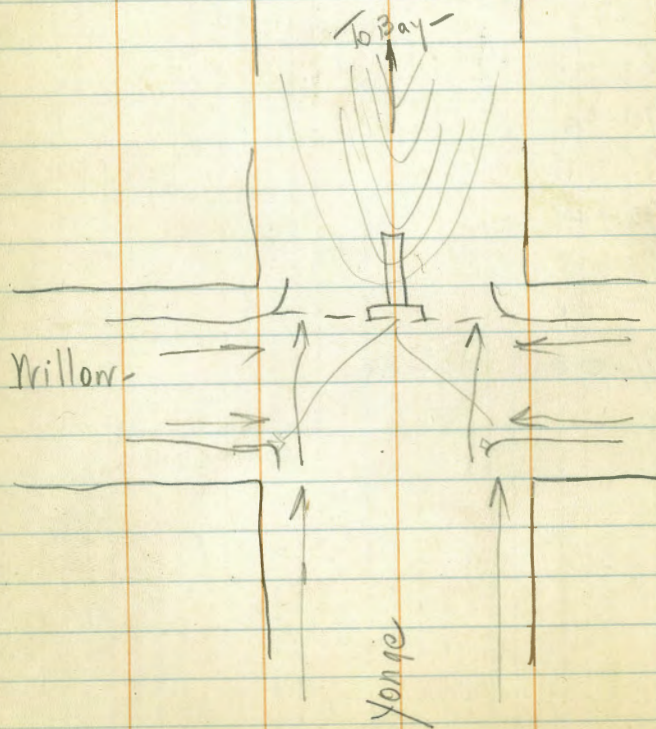
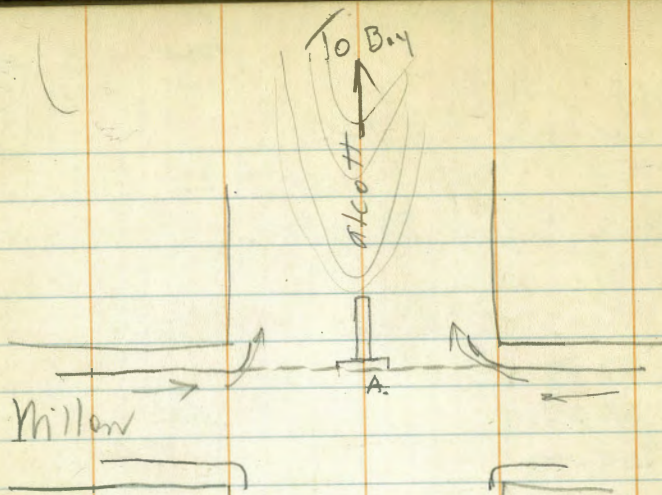

6.5
58

3.30	298.80	295.10	
6.14	292.66	292.66	Gate
7.64	291.16	291.16	F.L. 12" Pipe
5.3	293.5	293.5	Curb at Inlet

100' S. of Essex	6.7	292.1	
Int. of Allens	4.3	294.5	
	7.45	291.35	T.P.
1.10	292.45	284.60	
7.9			

5.30	289.90		
Dist.	A2		
135	338-30	-5-15 up 2"	-1.46 290.0
			entr. 12" Curb
128	339-30	-5-00 up 2"	-1.16 290.0
110	✓	-4-30	-0.86 296.0
		10.3	294.6

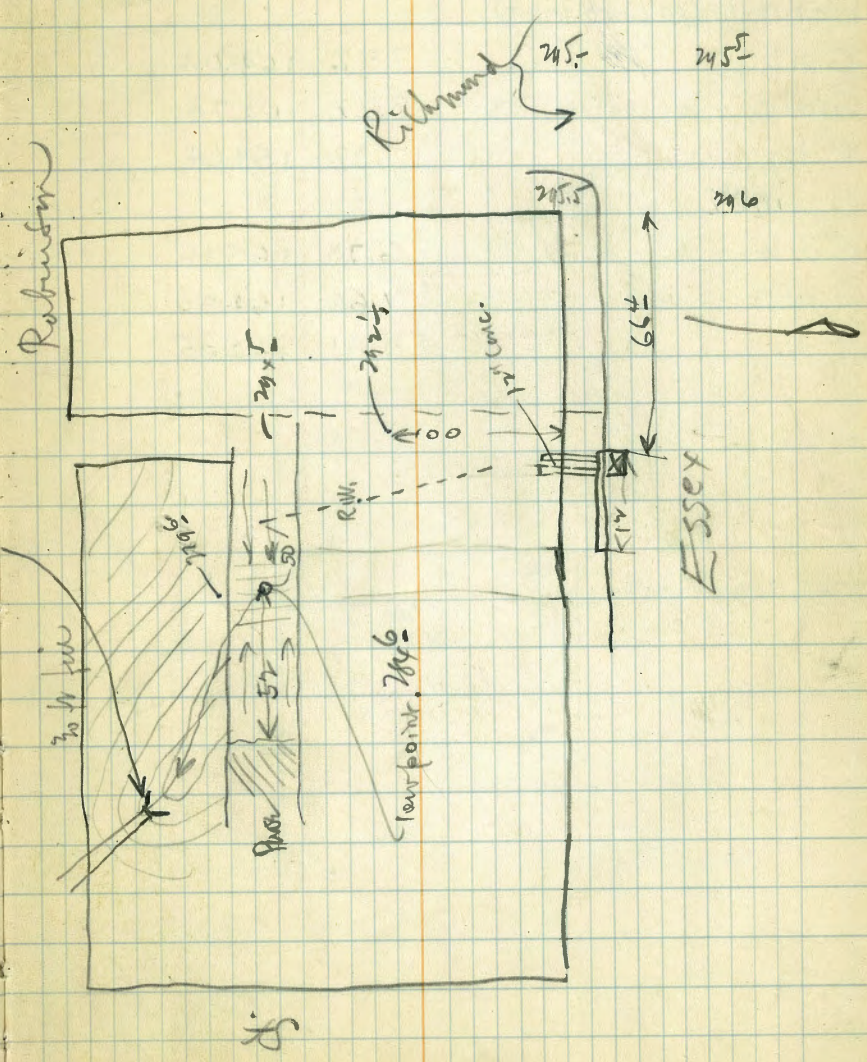

12.3
2.3
11.6

6/19/27

N.W. Cor	2.96	171.96	169.00
Inlet No. 1 (10' Curb Inlet)			
Curb	7.92	164.04	
Grate	9.22	162.74	
F.L.	12.32	159.64	
Basin #2			
Curb	6.78	165.16	
Grate	7.66	164.30	
F.L.	9.91	162.05	

7.92	7.66	13
11.30	2.25	8
9.22		104
3.10	9.91	2
12.32		106

(37)

Hawthorne

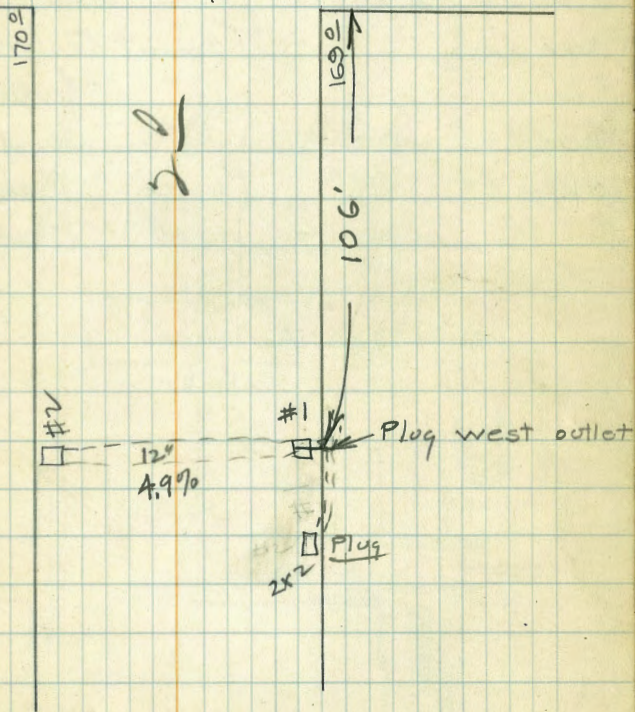

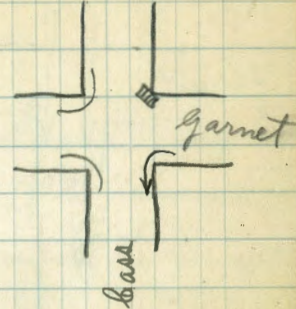
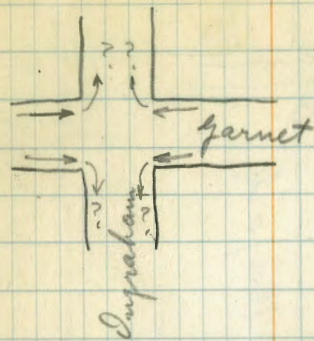
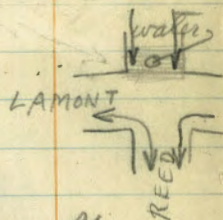

Lamont St. paved garnet around Brown Pt.
 Reed Ave. " Lamont to Jewell
 Oliver " " " Jewell LAMONT
 Pacific " " " Jewell
 Kendall " " Pacific " Reed
 Jewell " " Reed " Pacific

Ingraham paved Diamond to Brown Pt.
 Diamond St. paved from ocean to past Morrell
 Oliver St. " Dawes to Allison
 Pacific Ave. " Dawes to Allison
 bass St. " Pacific to La Jolla

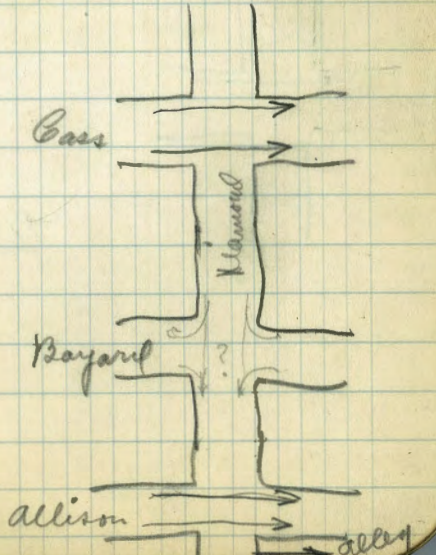
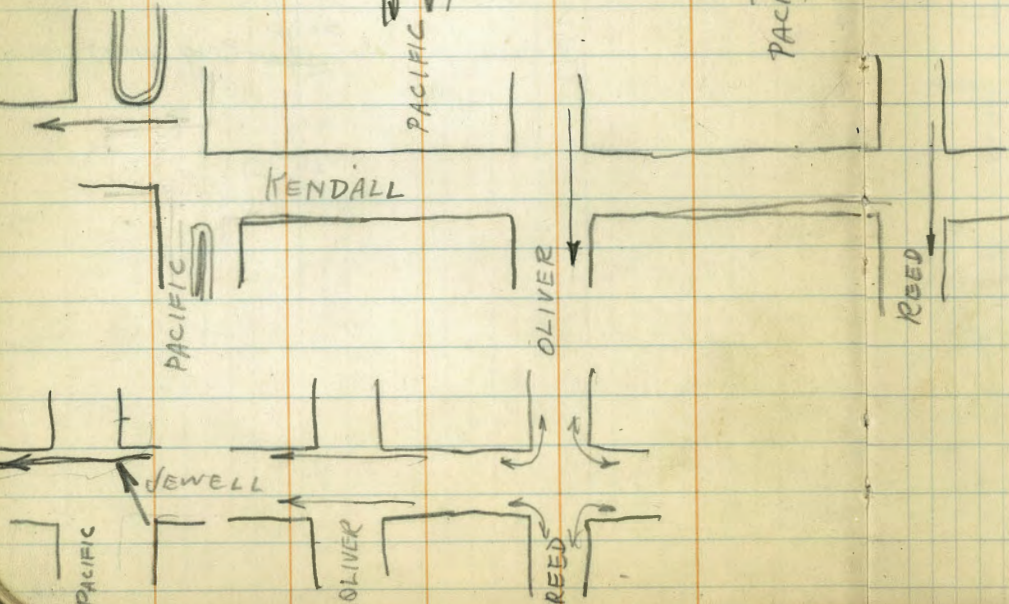
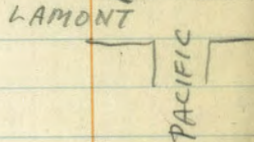
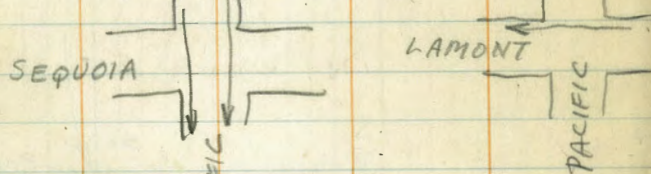

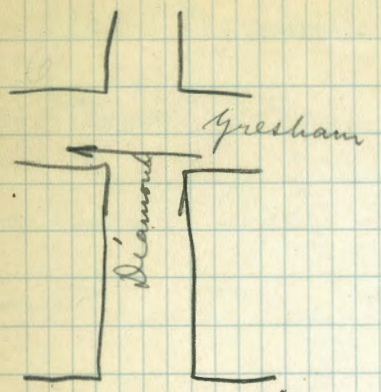
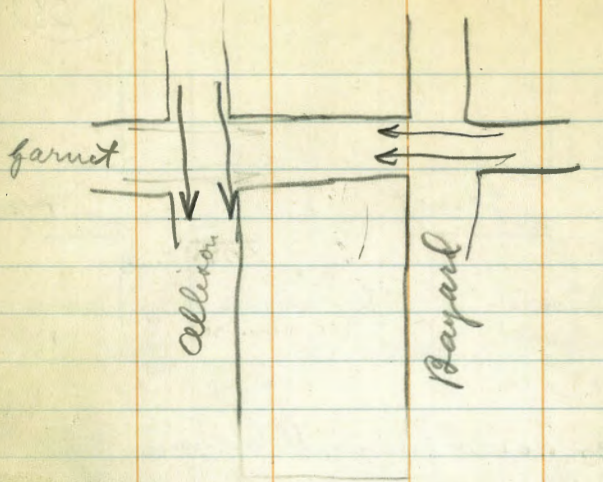

Academy grounds
Jewell to Lamont
Diamond to garnet

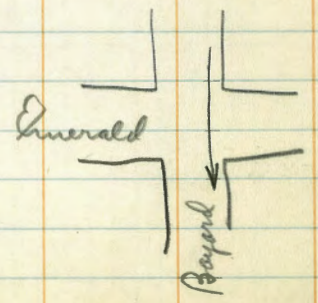
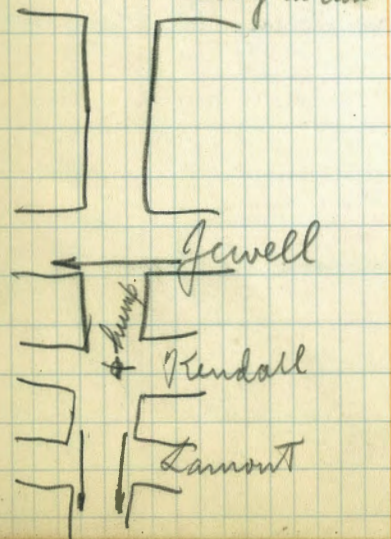
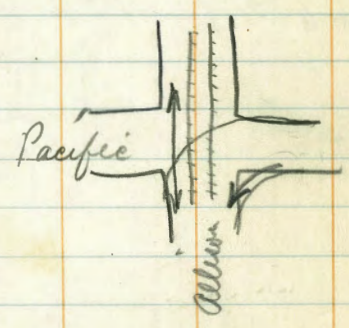
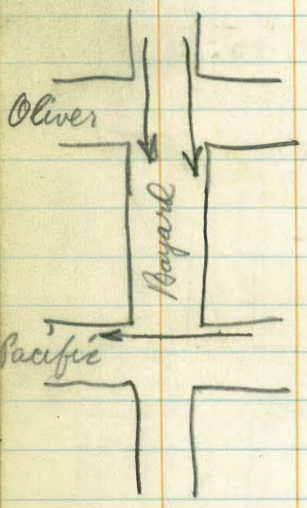
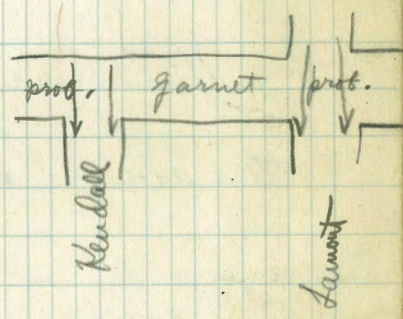
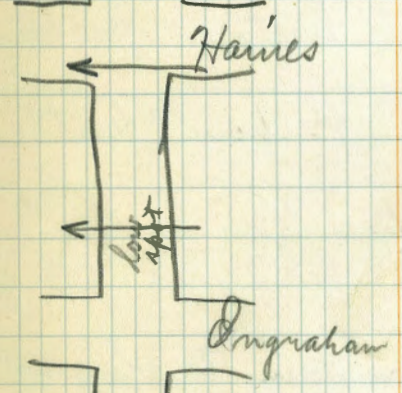

Paving along ocean front

- (Paving Loring from Haines to ocean — (hill at Haines)
- " Wilbur " " " Everts — Cass to ocean
- " Beryl " Cass " ocean — Everts to Ingraham —
- " Law " " " " — Haines to Everts
- " Chalcedony " Everts " Gresham
- " Missouri " Gresham " Everts

Gutters along Cass

No paving on Haines

- Paving Gresham from Loring to Diamond
- " Daniel " " " "
- " Everts " " " "
- No " Dawes

Paving Bayard from Diamond to Garnet

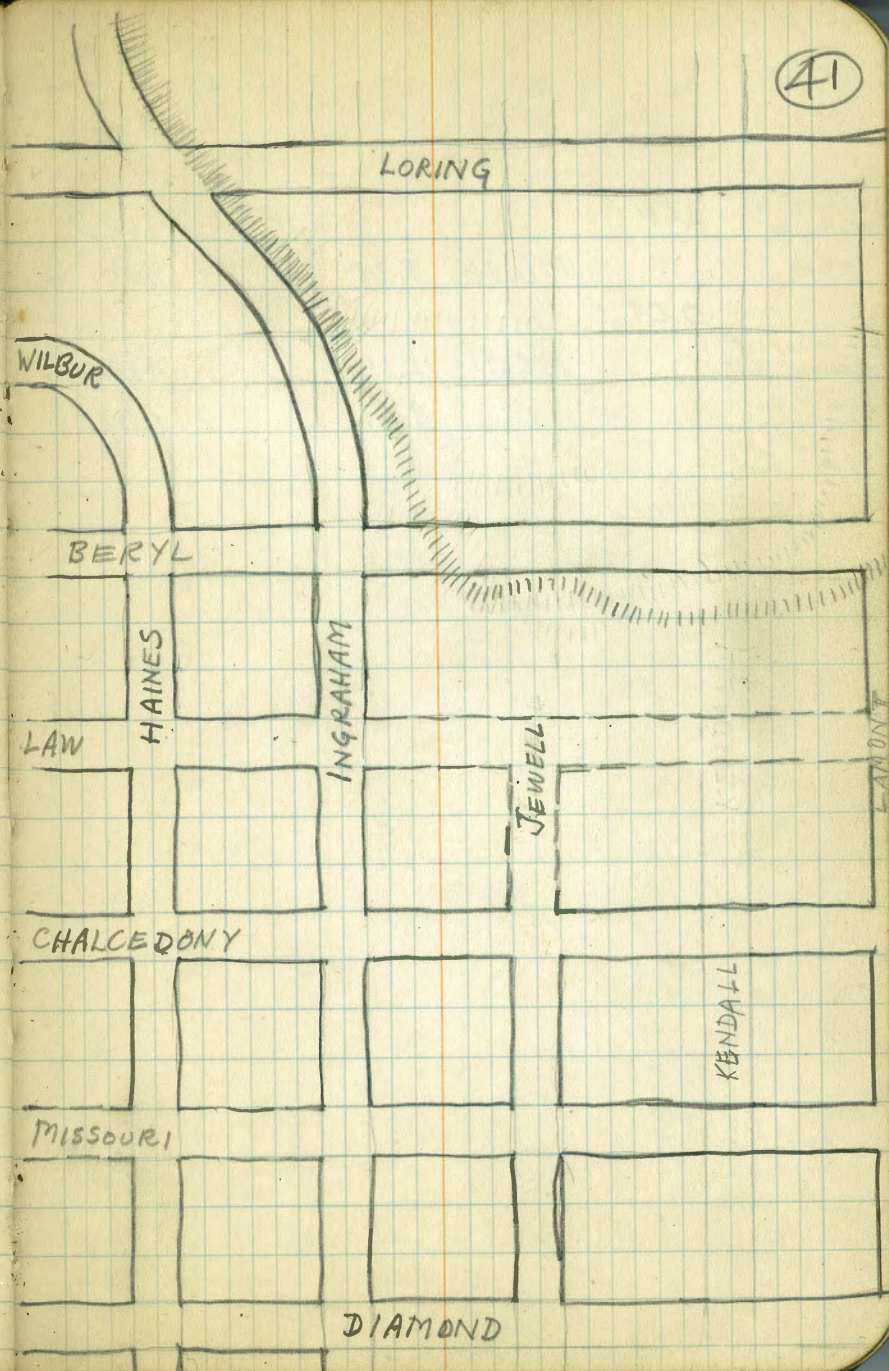

Sept. 28, 1927

Butzine π

Davies - Rod

(42)

Sta.	+	H. I.	-	Elev
Corner 1st & Grape	2.26			144.0
T. P.		146.26	5.94	140.32
	0.09			
N.W. Corner Lot Lowest Point		140.91	12.13	128.28
Top Pipe Near Joint			9.01	131.40

20' wide See Alley BIK 172 211.
Lincoln to Polk
Bet Louisiana & Texas

11-5-27
mills

SE Texas &
Lincoln

BM 2.22 319.13 ✓ 316.91

10' S. of original N. line of Lincoln = N. edge cont walk + Alley cont. ch. Returns

E	10.47	308.66	N. End. cont. ch. Return
C	11.1	308.0	
W	11.70	307.43	N. End. cont. ch. Return

5' N of Above

W	8.6	310.5	
+4	10.4	308.7	
C	10.0	309.1	
+8	9.6	309.5	
E	8.8	310.3	

5' N. of above = original N. line of Lincoln = 0100

C	7.5	311.6	
+4	8.9	310.2	
C	9.0	310.1	
+6	9.0	310.1	
+7	8.0	311.1	
W	8.0	311.1	

15' N of 00

W	7.9	311.2	
C	7.7	311.4	
E	7.1	312.0	
T.P	5.35	317.08 ✓	7.40 311.73 ✓

{ 24' N = S.W. cor of Garage on E. 0.7 in Alley } no Door on Alley
38' N = NW " " " " 0.8 " " }

327.95 SE. T. & Polk

317.08 ✓

{ 62' N = S.W. cor of Garage on E 0.8 in Alley } no Door on Alley
{ 74' N = NW " " " " 0.7 " " } on Alley

(43)

65' N

E	4.6	312.5	
C	5.0	311.1	
W	5.6	311.5	

110' N

W	5.6	311.5	
C	4.9	312.2	
E	4.5	312.6	

161' N & Double Garage on E 3 1/2 Back cont floor

-3 1/2	4.2	312.9	
C	4.5	312.6	
C	4.9	312.2	
W	5.0	312.1	

{ 179' N = S.W. cor shack on E. 1.4 in Alley } no entrance
{ 198' N = NW " " " " 1.4 " " } on Alley

200' N

W	5.4	311.7	
C	5.0	312.1	
C	4.3	312.8	
258' N = Garage = on E & W dirt floor = E 15 1/4 in Alley W 15 1/2 Back			
E	4.4	312.7	
C	5.0	312.1	
W	5.2	311.9	

317.08 ✓

268 Garage on W end floor 1.5 Back

W	5.1	312.0	floor
E	5.0	312.1	
E	4.4	312.7	

293' N Garage on W end floor 10.7 Back

E	4.1	313.0	
E	4.8	312.3	
W	5.9	311.2	
+10.7	6.3	310.8	floor

332' N Garage on W end floor 10' Back

W-10	6.6	310.5	floor
------	-----	-------	-------

338' N Double garage on E end floor 11.14 Alley

W	5.9	311.2	
E	5.5	311.6	

+8.9 Front of garage

4.8	312.3	ground
-----	-------	--------

+8.8

4.4	312.7	floor
-----	-------	-------

From 350' N. to 362' N Shack on E 1.3 14 Alley - No Entrance

362' N Garage on W end floor 9.2 Back

E	4.5	312.6	
C	5.4	311.7	

W	6.1	311.0	
---	-----	-------	--

+9.2

6.6	310.5	floor
-----	-------	-------

388' N Double garage on E dirt floor 11 in Alley

W	6.4	310.7	
C	5.6	311.5	

+8.9 Front of garage

4.7	312.4	
-----	-------	--

Alley BIK 172 2H.

317.08

415' N Garage on W end floor 7' Back

E	4.9	312.2	
C	5.8	311.3	
W	6.2	310.9	
+7.	6.6	310.5	

457' N Garage on W dirt floor 5.4 Back

- ^{5.4}	5.9	311.2	
W	5.8	311.3	
C	5.3	311.8	
E	4.5	312.6	

From 465' N to 494' N Double garage on E. Dirt floor 2.5 in Alley

508' N Garage on E dirt floor 1.5 in Alley

E+15 Front of garage

5.3	311.8		
E	5.8	311.3	
W	6.2	310.9	

T.P. 5.01 316.92 5.17 311.91

519' N Garage on W dirt floor 6' Back

W-6	5.4	311.1	floor
W	5.9	311.0	
C	5.6	311.3	
E	5.2	311.7	

From 419' N to 443' N House on E 0.6 in Alley

537' N Garage on W 6' Back dirt floor

E	5.1	311.8	
C	5.2	311.7	
W	6.0	310.9	
+6	6.7	310.2	floor

44

314.92 ✓
560' N

N-5	6.5	310.4
W	5.8	311.1
E	5.2	311.7
E	4.2	312.7
600' N = S. Line Polk Ave Ungraded		
E	4.3	312.6
+5	5.3	311.6
E	5.4	311.5
W	5.6	311.3
+5	6.1	310.8 ✓
T.P. 11.00	327.25 ✓	0.67
		316.25 ✓
ok on BM SE Polk Texas	2.25	325.00 = 324.95

1 sec.
Plotted
Nov. 23
7.11.11 miles

20' wide X Sec #11111's B/K 117 L.H. 10-5-27
 Howard & El. Cajon Miller
 Ohio & Illinois
 E & W Alley
 S.E. Ohio
 4 El. Cajon

B.M. 5.30 368.40 ✓ 363.10

N.B. Alley Returns at OHIO

are wrong set 142.25 S. of El. Cajon should be 140.00

Alley Returns at Illinois wrong

set 142.0 S. of El. Cajon should be 140.00

00 = E. Line Ohio St

N	4.6	363.8	
12.25 N. end of Return	4.65	363.75	
12.25 parent	4.74	363.62	
1/2 "	4.88	363.52	
S. "	4.68	363.72	
12.25 S. end of Return	4.56	363.84	
	20'E		
S	4.3	364.1	
V	4.8	363.6	
+7	4.7	363.7	
N	3.9	364.5	
garage on S. end floor 4.0 Back			
70'E garage on N. end floor 5.6 Back			
N-2	4.0	364.4	ent apron
N	4.3	364.1	
C	4.6	363.8	
S	4.4	364.0	
+4	4.3	364.1	floor

Ohio & Howard SE 364.47

368.40 ✓

(46)

104'E garage on N. end floor 3.2 Back

S	4.6	363.8	
C	4.3	364.1	
N	4.2	364.2	ent apron
+32	3.6	364.8	floor
	SW line N & S Alley		
	140'E garage on N. end floor 3.3 Back		
N-33	4.1	364.3	floor
N	4.5	363.9	ent apron
C	4.6	363.8	
S	4.5	363.9	
	160'E = E. Line N & S Alley		
S	4.7	363.7	
C	4.7	363.7	
N	4.5	363.9	

179'E garage on N. end floor 3.3 Back

N-33	4.1	364.3	floor
N	4.5	363.9	ent apron
C	4.5	363.9	
S	4.6	363.8	

216'E garage on N. end floor 3.3 Back

S	4.8	363.6	
C	4.8	363.6	
N	4.7	363.7	ent apron
+33	4.4	364.0	" floor

368.40 ✓

254' E garage on N. cnt floor 3.2 Back

N- 3.2	4.4	364.0	cnt floor
N	4.4	363.6	" apron
E	5.0	363.4	
S	5.0	363.4	

270' E garage on N cnt floor 3.3 Back

S	5.1	363.3	
E	5.2	363.2	
N	4.9	363.5	cnt apron
T 33	4.5	363.9	" floor

285' E

N	5.1	363.3	
T 2	5.7	362.7	
E	5.9	362.5	
S	5.7	362.7	

600' E = W. Line Illinois

5.2 S cnt of Return	6.50	361.90	
S	6.70	361.70	Pavmt
E	6.97	361.43	"
T 8	6.83	361.57	"
T 8 = N. cnt of T Turn	6.62	361.78	
N	6.5	361.9	

368.40

Alley BIK 117 U.H.

N. 45 Alley

oo = S. Line E. & W. Alley

(47)

W	4.5	363.9	
E	4.5	363.9	
E	4.7	363.7	
T.P.	2.97	366.93 ✓	

50' S

E	3.8	363.1	
E	3.8	363.1	
W	3.8	363.1	

100' S

W	3.9	363.0	
E	4.2	362.7	
E	4.2	362.7	

140' S

E	4.5	362.4	
E	4.4	362.5	
W	4.6	362.3	

177' S = N. Line Howard Ave

W No. yardage	4.08	362.85	cnt of
W	4.7	362.2	dirt
E	4.6	362.3	
E	4.9	362.0	dirt
E No. yardage	4.41	362.57	cnt of
chk on B.M. S.E. Howard + OHIO	2.52	364.41 = 364.47	

Bliss
Isaiah
Mason
Washer
B.M. SW Mt. View Dr
Drive & Arthur

X Sections 35th St from paving South
Mt View Drive to end.

605fs.
12lbs
4/20

	+	x	-	Elev
B.M. SW Mt. View Dr Drive & Arthur	5.21	397.01		391.80
Paving South of Mt View Drive = 00				
W		3.8		393.2
+1.5		4.3		392.7
Topcb		4.97		392.54
Gutter		4.87		392.14
1/4		4.09		392.97
1/2		3.60		393.41
3/4		3.63		393.34
Gutter		3.90		393.11
Topcb		3.53		393.48
E		3.1		393.9
17' North				
E		3.7		393.3
cb		3.8		393.2
1/4		3.9		393.1
1/2		4.2		392.8
3/4		4.5		392.5
17		4.8		392.2
Gutter		5.1		391.9
Topcb		4.58		392.43
W		4.2		392.8
50' North				
W		4.4		392.6
Topcb		4.64		392.37
Gutter		5.1		391.9

For Yardage
see
Blk 16
T.R.

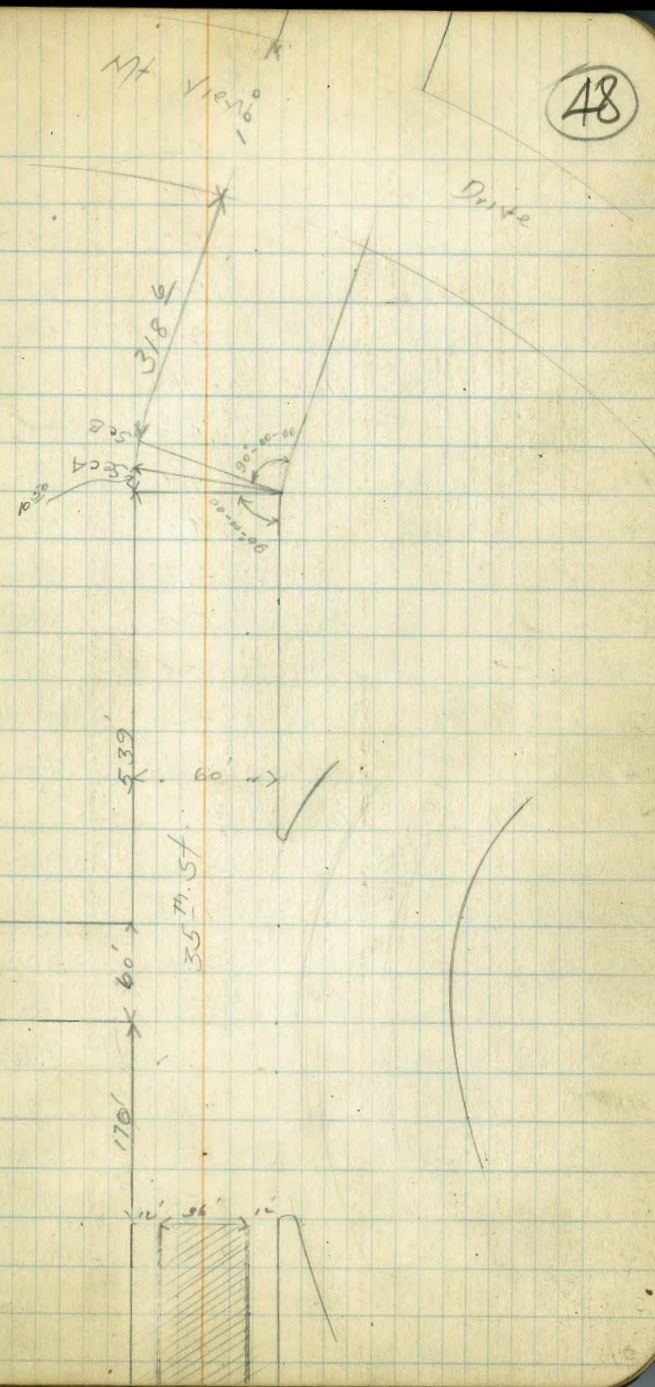

	X 397.01	-	E/O-1
1/4		4.7	392.3
1/2		4.4	392.6
1/4		4.1	392.9
cb		4.0	393.0
E		3.8	393.2

100' North

E		4.7	392.3
cb		4.4	392.6
1/4		4.5	392.5
1/2		4.7	392.3
1/4		5.0	392.0
Gutter		5.9	391.6
Top cb		4.79	392.22 ✓
W		4.6	392.4

150' North

W		4.8	392.2
Top cb		5.13	391.88 ✓
Gutter		5.9	391.1
1/4		5.3	391.7
1/2		5.0	392.0
1/4		4.9	392.1
cb		4.6	392.2
E		5.1	392.9

(170' North) S. line of Arthur

E		5.4	392.6
cb		4.8	392.2

+ JUL 26

	X 397.01	-	E/O-1
1/4		4.8	392.2
1/2		4.9	392.1
1/4		5.2	391.8
Gutter		5.9	391.1
Top cb		5.52	391.49 ✓
W		5.0	392.0

S Curb

Top cb		5.18	391.83 ✓
W in Gutter		6.1	390.9
W		5.2	391.8
cb		5.2	391.8
1/4		5.0	392.0
1/2		4.9	392.1
1/4		4.9	392.1
cb		5.0	392.0
E		5.4	391.6

S 1/4

E		5.4	391.6
cb		4.9	392.1
1/4		4.8	392.2
1/2		4.9	392.1
1/4		4.9	392.1
cb		4.9	392.1
(E) W		5.2	391.8

S Arthur + 35th St.

W		4.8	392.2
---	--	-----	-------

(49)

397.01

Elev

cb	4.8	392.2
1/4	4.8	392.2
2	4.9	392.1
1/4	5.0	392.0
cb	5.0	392.0
E	5.4	391.6
N 1/4		
E	5.5	391.5
cb	5.0	392.0
1/4	4.8	392.2
2	4.7	392.3
1/4	4.8	392.2
cb	5.0	392.0
W	4.9	392.1
N. cb		
W in G. Th. of Drain of	6.15	390.5
W Top cb	5.33	391.68
W	5.3	391.7
cb	5.3	391.7
1/4	5.0	392.0
2	4.8	392.2
1/4	4.6	392.4
cb	4.9	392.1
E	5.5	391.5
N line of Arthur		
E	5.3	391.7

4.5 4.9 on Mn Hole

397.01
2.0-
Read on Top 5.32
along line 6.96

(50)

cb	4.8	392.2
1/4	4.7	392.3
2	4.9	392.1
1/4	5.1	391.9
4.8 on concrete	5.3	391.78
+85 in E of hole	6.06	390.95
Cutter	6.1	390.9
Top cb	5.29	391.77
W	5.0	392.0
50' North of North Line of Arthur		
W	4.6	392.4
Top cb	5.13	391.88
Cutter	5.6	391.4
1/4	5.3	391.7
2	4.9	392.1
1/4	5.0	392.0
cb	5.0	392.0
E	5.0	392.0
100' North		
E	5.2	391.8
cb	5.2	391.8
1/4	5.1	391.9
2	5.0	392.0
1/4	5.1	391.9
Cutter	5.5	391.5
Top cb	4.90	392.1

397.01

Elev

397.01

Elev

(51)

119' North on curb Radius on East

250' North

300' North

150' North

200' North

W	4.5	392.5
W	4.5	392.5
Top cb	4.81	392.20
Gutter	5.5	391.5
1/4	5.0	392.0
1/4	4.9	392.1
1/4	5.1	391.9
Gutter	5.6	391.4
Top cb	5.10	391.91
E	4.9	392.1
E	4.8	392.2
Top cb	5.13	391.88
Gutter	5.6	391.4
W	5.3	391.7
1/4	5.1	391.9
1/4	4.8	392.2
1/4	4.9	392.1
Gutter	5.2	391.8
Top cb	4.69	392.32
W	4.3	392.7
W	4.3	392.7
Top cb	4.54	392.57
o	5.1	391.9

1/4	4.7	392.3
1/4	4.7	392.3
1/4	4.9	392.1
Gutter	5.5	391.8
Top cb	4.88	392.13
E	4.6	392.4
E	4.2	392.8
Top cb	4.53	392.48
Gutter	5.0	392.0
1/4	4.6	392.4
1/4	4.3	392.7
1/4	4.5	392.5
Gutter	5.1	391.9
Top cb	4.26	392.75
W	4.0	393.0
W	3.6	393.4
Top cb	4.00	393.01
Gutter	4.6	392.4
1/4	4.2	392.8
1/4	3.9	393.1
1/4	4.2	392.8
Gutter	4.8	392.2
Top cb	4.23	392.78
E	3.8	393.2

(52)

397.01

350' North

E	3.5	393.5
Topcb	3.89	393.12
Gutter	4.4	392.6
1/4	4.2	392.8
E	3.9	393.1
1/4	4.1	392.9
Gutter	4.4	392.6
Topcb	3.79	393.22
W	3.2	393.8

402' North

W	3.0	394.0
+1.5	3.3	393.7
Topcb	3.50	393.51
Gutter	4.2	392.8
1/4	4.0	393.0
E	3.8	393.2
1/4	3.9	393.1
Gutter	4.4	392.6
Top	3.75	393.26
+10.5	3.4	393.6
E	2.9	394.1

450' North

E	2.8	394.2
+1.5	3.1	393.9
Topcb	3.37	393.64
Gutter	4.0	393.0

397.01

1/4	3.8	393.2	
E	3.5	393.5	
1/4	3.8	393.2	
T.P. 5.67	399.15	3.53	393.48
Gutter	6.2	393.0	
Topcb	5.52	393.63	
W	5.3	393.9	

500' North

W	4.4	394.3
Topcb	5.28	393.87
Gutter	6.1	393.1
1/4	5.5	393.7
E	5.4	393.8
1/4	5.5	393.7
Gutter	5.9	393.3
Topcb	5.20	393.95
+8	5.0	394.2
E	4.6	394.6

539' North P.C.

E	4.7	394.5
Topcb	5.05	394.10
Gutter	5.8	393.4
1/4	5.9	393.8
E	5.2	394.0
1/4	5.3	393.9
Gutter	5.9	393.3

T X 399.15 Elev 10.5 on Arch 70k

T X 399.15 Elev

Topcb	5.29	393.91
W	4.8	394.4
Sec A on A. Point		
W	1.8	394.4
Topcb	5.13	394.02
Gutter	5.7	393.5
1/4	5.3	393.9
E	5.1	394.1
1/4	5.3	393.9
Gutter	5.8	393.4
Topcb	5.07	394.08
E	4.7	394.5

Sec B

E	4.8	394.4
Topcb	5.00	394.2
Gutter	5.7	393.5
1/4	5.2	394.0
E	5.0	394.2
1/4	5.3	393.9
Gutter	5.6	393.6
Topcb	5.03	394.12
W	4.6	394.6
50' North of Sec B. See sketch		
	4.2	395.0
+15	4.5	394.7
Topcb	4.80	394.35

Gutter	5.5	393.7
1/4	5.1	394.1
E	4.9	394.3
1/4	5.2	394.0
Gutter	5.5	393.7
Topcb	4.78	394.37
+10.5	4.5	394.7
E	4.1	395.1

100' North

E	4.0	395.2
Topcb	4.48	394.67
Gutter	5.0	394.2
1/4	4.8	394.4
E	4.6	394.6
1/4	4.8	394.4
Gutter	5.1	394.1
Topcb	4.57	394.58
W	4.2	395.0

150' North

W	4.0	395.2
Topcb	4.90	394.75
Gutter	5.0	394.2
1/4	4.4	394.8
E	4.2	395.0
1/4	4.5	394.7
Gutter	4.9	394.3

399.15

Elev

Top cb	4.18	394.97
E	3.8	395.4
200' North		
E	3.8	395.4
Top cb	3.98	395.17
Gutter	4.6	394.6
1/4	4.2	395.0
¢	4.0	395.2
1/4	4.3	394.9
Gutter	4.9	394.3
Top cb	4.2	394.98
W	3.9	395.3
250' North		
W	3.8	394.4
Top cb	4.01	395.14
Gutter	4.8	394.4
1/4	4.2	395.0
¢	3.8	395.4
1/4	3.9	395.3
Gutter	4.3	394.9
Top cb	3.86	395.29
E	3.5	395.7
318 ¢ S. Line of Mt. View Drive		
E	3.1	396.1
Top cb	3.76	395.69
Gutter	4.0	395.2

240
654
399.15
318.6

Elev

5A

1/4	3.7	395.5
¢	3.5	395.7
1/4	3.7	395.5
Gutter	4.4	394.8
Top cb	3.75	395.45
W	3.6	395.6
B.M.	2.33	397.80
S. cb	3.68	395.47
395.42		
W Top cb	2.35	395.45
W in Gutter	2.7	395.1
cb	2.4	395.4
1/4	2.1	395.7
¢	2.0	395.8
1/4	2.0	395.8
cb	2.4	395.4
E	2.3	395.5
Top cb	2.09	395.76
S. 1/4		
E	2.1	395.7
cb	2.0	395.8
1/4	2.0	395.8
¢	2.0	395.8
1/4	2.0	395.8
cb	2.2	395.6
W	2.9	395.4

39780 - ELEV

2. Mt View Drive and 35th

W	2.2	395.6
cb	2.1	395.7
1/4	2.0	395.8
2	1.9	395.9
1/4	1.8	396.0
cb	1.8	396.0
E	1.8	396.0
	N 1/4	
E	2.0	395.8
cb	1.9	395.9
1/4	1.9	395.9
2	1.9	395.9
1/4	2.0	395.8
cb	2.2	395.6
W	2.6	395.2
	N 2/4	
W top cb	2.82	394.98
W in gutter	3.1	394.7
cb	2.7	395.1
1/4	2.1	395.7
2	1.9	395.9
1/4	1.9	395.9
cb	1.9	395.9
E	2.2	395.6
	N line Mt View	
E	1.7	396.1

39780 - ELEV

Top cb	1.81	395.99
Gutter	2.5	395.3
1/4	2.2	395.6
2	2.3	395.5
1/4	2.6	395.2
Gutter	3.3	395.5
Top cb	2.77	395.03
W	2.5	395.3
	50' North of the North line of Mt View Drive	
W	2.9	394.9
Top cb	3.14	394.66
Gutter	3.8	394.0
1/4	3.0	394.8
2	2.6	395.2
1/4	2.6	395.2
Gutter	3.1	394.7
Top cb	2.38	395.42
E	2.1	395.7
	100' North	
E	2.5	395.3
Top cb	2.84	394.96
Gutter	3.5	394.3
1/4	3.1	394.7
2	3.0	394.8
1/4	3.3	394.5
Gutter	4.1	393.7

	+	π 39780	Elev
Topcb		3.45	394.35
W		3.2	394.6
150' North			
W		3.7	394.1
Topcb		3.83	393.97
Gutter		4.6	393.2
1/4		3.8	394.0
♀		3.4	394.4
1/4		3.5	394.3
Gutter		3.9	393.9
Topcb		3.32	394.49
E		3.1	394.7
200' North			
E		3.5	394.3
Topcb		3.87	393.97
Gutter		4.4	393.4
1/4		4.0	393.8
♀		3.8	394.0
1/4		4.1	392.7
Gutter		4.9	392.9
Topcb		4.22	393.58
W		4.1	393.7
250' North			
W		4.4	393.4
Topcb		4.67	393.13
Gutter		5.3	392.8

	+	π 39780	Elev
1/4		4.5	393.3
♀		4.22	393.6
1/4		4.5	393.3
Gutter		4.9	392.9
Topcb		4.37	393.43
E		4.1	393.7
300' North			
E		4.6	393.2
Topcb		4.87	392.93
Gutter		5.7	392.1
1/4		5.0	392.8
♀		4.7	393.1
1/4		5.0	392.8
Gutter		5.6	392.2
Topcb		4.97	392.83
W		4.6	393.2
350' North			
W		4.9	392.9
Topcb		5.36	392.44
Gutter		6.1	391.7
1/4		5.6	392.2
♀		5.3	392.5
1/4		5.5	392.3
Gutter		6.0	391.8
Topcb		5.35	392.45
E		5.1	392.7

(56)

39780

400' North

T E	57	392.1
Topcb	596	391.84
Gutter	66	391.2
1/4	60	391.8
1/2	57	392.1
3/4	59	391.9
Gutter	65	391.3
Topcb	582	391.98
+105	55	391.3
W	49	392.9

450'

W	5.6	392.2
Topcb	6.25	391.55
Gutter	69	390.9
1/4	64	391.4
1/2	63	391.5
3/4	66	391.2
Gutter	71	390.7
Topcb	6.50	391.30
E	62	391.6

500' North

E	66	391.2
Topcb	7.06	390.74
Gutter	7.7	390.1
1/4	7.0	390.8
1/2	6.5	391.9

39780

550' North

1/4	6.7	391.1
Gutter	7.4	390.4
Topcb	6.56	391.24
W	5.9	391.9
W	6.3	391.5
+1.5	6.8	391.0
Topcb	6.97	390.83
Gutter	7.7	390.1
1/4	7.1	390.7
1/2	7.0	390.8
3/4	7.5	390.3
Gutter	8.1	389.7
Topcb	7.52	390.28
E	6.9	

600' North

E	7.6	390.2
Topcb	8.08	389.72
Gutter	8.8	389.0
1/4	7.9	389.9
1/2	7.4	390.4
3/4	7.5	390.3
Gutter	8.1	389.7
Topcb	7.40	390.40
+105	7.3	390.5
W	6.6	391.2

	+	N 39780	-	Elev
T.P.	1.92	392.38	7.34	390.46
		650 North		
W			2.0	390.4
Topcb			2.90	389.98
Gutter			3.0	389.4
1/4			2.6	389.8
℄			2.5	389.9
1/4			3.0	389.4
Gutter			3.7	388.7
Topcb			3.16	389.22
E			2.9	389.5
		700 North		
E			3.5	388.9
Topcb			3.78	388.60
Gutter			4.2	388.2
1/4			3.5	388.9
℄			3.0	389.4
1/4			2.9	389.5
Gutter			3.5	388.9
Topcb			2.73	389.65
W			2.5	389.9
T.P.	2.46	391.43	3.41	388.97
		761 ⁵⁰ North P.C.		
W			2.0	389.4
Topcb			2.25	389.18
Gutter			2.8	388.6

	+	-	Elev
	391.93		
1/4		2.9	389.0
℄		2.6	388.8
1/4		3.0	388.4
Gutter		3.8	387.6
Topcb		3.40	388.04
E		3.1	388.8
	Sec A	Sec 66.5°	
E		3.1	388.3
Topcb		3.91	388.02
Gutter		3.9	387.5
1/4		3.1	388.3
℄		2.9	388.5
1/4		2.6	388.8
Gutter		3.0	388.4
Topcb		2.46	388.97
N		2.3	389.1
	see sketch Page 11	Sec B	P.C. of Curve
N		2.6	388.8
Topcb		2.76	388.67
Gutter		3.4	388.0
1/4		3.0	388.4
℄		2.7	388.7
1/4		3.2	388.2
Gutter		3.9	387.5
Topcb		2.46	387.97
E		3.1	388.3

(58)

391.43

50' East

S	3.5	387.9
Topcb	3.79	387.64
Gutter	4.3	387.1
1/4	3.7	387.7
¢	3.4	388.0
1/4	3.5	387.9
Gutter	4.0	387.4
Topcb	3.29	388.14
N	3.4	388.0

100' East

N	3.8	387.6
Topcb	3.98	387.45
Gutter	4.7	386.7
1/4	4.1	387.3
¢	4.0	387.4
1/4	4.3	387.1
Gutter	4.6	386.8
Topcb	4.25	387.18
S	4.3	387.1

120' East White Venton Place

S	4.2	387.2
Topcb	4.49	386.99
Gutter	5.2	386.2
+0.5	4.5	386.9
1/4	4.5	386.9

391.43

59

¢	4.2	387.2
1/4	4.4	387.0
Gutter	5.0	386.4
Topcb	4.23	387.20
N	4.1	387.8

West cb

N	4.3	387.1
cb	4.32	387.11
Gutter	5.1	386.3
1/4	4.6	386.8
¢	4.3	387.1
1/4	4.5	386.9
cb	4.7	386.7
S	4.6	386.8

West 1/4

S	4.6	386.8
cb	4.7	386.7
1/4	4.6	386.8
¢	4.4	387.0
1/4	4.6	386.8
Gutter	5.2	386.2
Topcb	4.42	387.01
N	4.9	387.0

¢ Venton Place 13574

N	4.4	387.0
Topcb	4.53	386.90

	+	N 391.93	-	Elev
Gutter			5.2	386.2
1/4			4.7	386.7
℄			4.5	386.9
1/4			4.6	386.8
cb			4.5	386.9
S			4.9	387.0
East 1/4				
S			4.7	386.7
cb			4.6	386.8
1/4			4.7	386.7
℄			4.7	386.7
1/4			4.8	386.6
Gutter			5.3	386.1
Top Cb			4.61	386.82
N			4.5	386.9
East cb				
N			4.5	386.9
Top cb			4.70	386.73
Gutter			5.3	386.10
1/4			4.9	386.5
℄			4.8	386.6
1/4			4.8	386.6
cb			5.0	386.4 ^{5.00 red}
S			4.8	386.6
Top			4.77	386.66

	+	N 391.93	-	Elev
E Line of Venton Place				
S			4.5	386.9 ^{4.50 red}
Top Cb			4.80	386.63
Gutter			5.6	385.8
1/4			5.2	386.2
℄			4.8	386.6
1/4			5.0	386.4
Gutter			5.5	385.9
Top Cb			4.81	386.62
N			4.6	386.8
45° East of the East Line of Venton Place				
N			5.0	386.4
Top Cb in Auto Driveway			5.80	385.63
Gutter			5.9	385.5
1/4			5.9	386.0
℄			5.2	386.2
1/4			5.6	385.8
Gutter			6.1	385.3
Top Cb			5.32	386.11
S			5.1	386.3
90° East PC of Curve on North				
S			5.7	385.7
Top Cb			5.88	385.55
Gutter			6.8	384.6
1/4			6.2	385.9
℄			5.8	385.6
1/4			6.0	385.4

(60)

(61)

+ T 391.93 - Elev

+ T 391.93 - Elev

Gutter	6.5	384.9
Topcb	5.84	385.59
+10.5	5.6	385.8
N	5.1	386.3
120° W Line of W/shire Drive		
N on Topcb	5.77	385.66
+ 0.2 on Ground	6.9	385.0
cb	7.0	384.4
1/4	6.5	384.9
¢	6.3	385.1
1/4	6.6	384.8
Gutter	7.0	384.4
Topcb	6.28	385.15
S	5.9	385.5
W.Cb.		
S	5.9	385.5
Topcb	6.39	385.04
Gutter	7.0	384.4
1/4	6.8	384.6
¢	6.5	384.9
1/4	6.7	384.7
cb	6.9	384.5
N	6.5	384.9
W 1/4		
N	6.5	384.9
cb	7.1	384.3

20' st
5' cbs
75' gts

1/4	6.7	384.7
¢	6.5	384.9
1/4	6.9	384.5
+3	6.9	384.5
+9	7.2	384.2
Gutter	7.2	384.7
Top.Curb	6.45	384.98
S	6.1	385.3
¢ 35 24 W/shire Drive		
S	6.2	385.2
Topcb	6.56	384.87
Gutter	7.3	384.1
1/4	6.9	384.5
¢	6.5	384.9
1/4	6.7	384.7
+6	7.1	384.3
cb	7.1	384.3
N	6.7	384.7
E 1/4		
N	6.8	384.6
cb	7.2	384.2
1/4	6.8	384.6
¢	6.6	384.8
1/4	7.0	384.4
Gutter	7.3	384.1
Topcb	6.63	384.80

	+	x 39143	-	Elev
S			6.9	385.0
			E. cb.	
S			6.6	384.8
Topcb.			6.72	384.71
Gutter			7.3	384.1
1/4			7.1	384.3
¢			6.7	384.7
1/4			7.0	384.4
cb.			7.3	384.1
N.			6.8	384.6
			E. Prop line of Wilshire Drive.	
N			6.5	384.9
Topcb.			6.79	384.64
Gutter			7.3	384.1
1/4			7.0	384.4
¢			6.9	384.5
1/4			7.2	384.2
Gutter			7.3	384.1
Topcb			6.86	384.57
S			6.8	384.6
			36.50 East of East line Wilshire Drive	
S			6.9	384.5
Topcb			7.20	384.28
cb			7.7	383.7
1/4			7.2	384.2
¢			7.0	384.4

	+	39143	-	Elev
1/4			7.1	384.3
Gutter			7.4	384.0
Topcb			7.12	384.51
N			6.6	384.8
			54 East	
N			7.1	384.3
Topcb			7.42	384.01
Gutter			7.8	383.6
1/4			7.4	384.0
¢			7.2	384.2
1/4			7.4	384.0
¢			7.6	383.8
Gutter			8.3	383.1
Topcb			7.37	384.06
S			7.0	384.4
			59 East	
S			7.1	384.3
Topcb			7.48	383.95
			8.91	382.52
			7.3	384.1
			6.0	385.0
			5.8	385.6
			5.9	385.5
			6.6	384.8
			7.0	383.8
			7.6	383.8

	+	X 391.93	-	Elev
+8	♀ of 1.3" Drain		8.77	382.66
Gutter			8.7	382.6
Top cb			7.55	383.88
N			7.2	374.2
	62 East end cb on No. 14			
N			7.3	384.1
Top cb			7.71	383.72
Gutter			8.1	383.3
+3			8.3	383.1
+7			8.2	383.5
1/4			7.5	383.9
+6			6.6	384.8
♀			6.6	384.8
+5			6.7	384.7
1/4			7.1	384.3
+6			8.3	383.1
Gutter			8.5	382.9
Top cb			8.13	383.30
S			7.9	374.0
	64 East end cb on South			
			7.9	383.5
Top cb			8.45	382.98
Gutter			9.3	382.1
+5			9.1	382.3
1/4			8.0	383.4
+4			7.9	374.0

	+	X 391.43	-	Elev
♀			7.7	29.20 29.20 383.7
1/4			8.7	384.7
+6			10.4	381.0
+8 Top Drain Pipe			10.09	381.34
cb			10.4	381.0
+6			9.9	381.5
+9			8.2	383.2
N			8.9	383.0
	69 East			
N			11.3	380.1
cb			11.9	379.5
Top drain			11.11	380.31
+2			13.0	378.4
+5			12.8	378.6
1/4			10.5	380.9
+6			10.3	381.1
♀			10.3	381.1
+5			9.7	381.7
1/4			10.6	380.8
+6			11.8	379.6
+8 on Drain pipe			11.8	380.25
cb			12.1	379.3
+4			10.4	381.0
+8			9.9	381.5
S			10.2	380.9

63

+ X - Elevation

392.08

(64)

TP	7.13	392.08	698	384.95
X Sections Wilshire Drive from the				
North line of 35 th St to end				
N line 35 th St = 00				
W		7.0		385.1
cb		7.1		385.0
1/4		7.1		385.0
¢		7.3		384.8
1/4		7.4		384.7
Gutter		7.5		384.6
Top cb		7.00		385.08
E		7.1		385.0
25' North of the North line of 35 th St				
E		5.6		386.5
Top cb		5.65		386.43
Gutter		6.9		385.7
1/4		6.0		386.1
1/2		5.7		386.4
¢		5.5		386.6
1/4		5.4		386.7
1/2		5.4		386.7
Gutter		5.8		386.3
Top cb		5.45		386.65
W		5.3		386.8
38 th North P.C. of curve 14' out North				
W		4.8		387.3

Top cb	9.91	387.17
Gutter	5.2	386.9
1/4	7.8	387.3
¢	4.8	387.3
1/4	5.1	387.0
+1	5.3	386.8
Gutter	5.6	386.5
Top cb	4.93	387.15
E	4.7	387.14
Sec A		
E	3.9	388.2
Top cb	4.17	387.91
Gutter	5.00	387.1
1/4	4.5	387.6
¢	4.3	387.8
1/4	4.3	387.8
Gutter	4.6	387.5
Top cb	4.25	387.83
1/4	4.0	388.1
Sec B		
W	3.7	388.4
Top cb	3.93	388.15
Gutter	4.3	387.8
1/4	4.0	388.1
¢	4.1	388.0
1/4	4.5	387.6

for yardage see BC 16 T.R.

6 parts 14' out North 3 on South

392.08

Gutter	7.6	387.5
Topcb	3.82	388.26
E	3.6	388.5

Sec C

E	3.6	388.5
Topcb	3.82	388.26
Gutter	4.5	387.6
1/4	4.6	387.5
¢	4.1	388.0
1/4	4.2	387.9
Gutter	4.9	387.7
Topcb	3.87	388.21
W	3.7	388.4

Sec D

W	3.9	388.2
Topcb	4.05	388.03
Gutter	4.6	387.5
1/4	4.4	387.7
¢	4.2	387.9
1/4	4.6	387.5
Gutter	4.7	387.4
Topcb	3.99	388.09
E	3.8	388.3

Sec E

E	4.0	388.1
Topcb in driveway	4.64	387.44

392.08

65

Gutter	4.7	387.4
1/4	4.8	387.3
+	4.5	387.6
¢	4.4	387.7
1/4	4.7	387.4
Gutter	5.0	387.1
Topcb	4.25	387.83
W	4.1	388.0

1144 on West
Sec F P.T. of curve

W	4.3	387.8
Topcb	4.41	387.67
Gutter	5.0	387.1
1/4	4.9	387.2
¢	4.5	387.6
+5	4.4	387.7
1/4	4.7	387.4
Gutter	4.8	387.3
Topcb	4.43	387.65
E	4.3	387.8

25' East of PT

E	4.8	387.8
Topcb	4.96	387.12
Gutter	5.4	386.7
1/4	5.2	386.9
+4	4.6	387.5
¢	4.6	387.5

392.08

1/4	4.9	387.2
Gutter	5.4	386.7
Topcb	4.90	387.18
W	4.7	387.4
50' East		
W	5.3	386.8
Topcb	5.52	386.56
Gutter	5.7	386.4
1/4	5.2	386.9
♀	5.2	386.9
1/4	5.7	386.4
Gutter	6.1	386.0
Topcb	5.53	386.55
E	5.2	386.8
100' East		
E	6.5	385.6
Topcb	6.62	385.46
Gutter	7.0	385.1
1/4	6.7	385.4
♀	6.5	385.6
1/4	6.8	385.3
Gutter	7.2	384.9
Topcb	6.65	385.43
W	6.5	385.6
150' East		
W	7.6	384.5

392.08

(66)

Topcb	7.74	384.34
Gutter	8.2	383.9
1/4	7.8	384.3
♀	7.6	384.5
1/4	7.9	384.2
Gutter	8.4	383.7
Topcb	7.72	384.36
E	7.6	384.5
178.20 PC		
E	8.3	383.8
Topcb	8.90	383.68
Gutter	9.0	383.1
1/4	8.8	383.3
+3	8.5	383.6
♀	8.4	383.7
1/4	8.7	383.4
Gutter	9.4	382.7
Topcb	8.45	383.68
W	8.2	383.9
3 parts 673 on West		
Sec A.		
W	9.2	382.9
Topcb	9.38	382.70
Gutter	10.1	382.0
1/4	9.7	382.4
♀	9.3	382.8
1/4	9.6	382.5

392.08

Gutter	9.9	382.2
Top cb	9.36	382.74
S	9.2	381.9
Sec B	3. Part 1583 on East 27.25	
E	10.2	381.9
Top cb	10.37	381.71
Gutter	11.0	381.1
1/4	10.7	381.4
E	10.3	381.8
1/4	10.6	381.5
Gutter	11.1	381.0
Top cb	10.90	381.68
W	10.2	381.9
Sec C	P.T. of curve	
W	11.2	380.9
Top cb	11.33	380.75
Gutter	11.9	380.2
1/4	11.3	380.8
E	11.4	380.7
+3	11.4	380.7
1/4	11.9	380.2
Gutter	12.3	379.8
Top cb	11.97	380.61
E	11.3	380.8
E	12.2	379.9
41.2° N. of curve P.T. = Break in cb grade.		

392.08

150
115
25
190
1237

(67)

Top cb	12.37	379.71	115
Gutter	13.3	378.8	12.31 1.20 1.11
Flank line of 9" drain	14.27	377.81	
+2	13.1	379.0	
1/4	12.5	379.6	
+5.5	12.5	379.6	
E	12.6	379.5	
1/4	12.6	379.5	
+5.5	12.8	379.3	
Gutter	12.8	379.3	
Flank line of 9" drain	14.21	377.87	
Top	12.31	379.77	
W	12.1	380.0	
45 North			
W	12.0	380.1	
Top cb	12.2	379.86	
Gutter	12.8	379.3	
1/4	12.6	379.5	
E	12.6	379.5	
+4	12.4	379.7	
1/4	12.5	379.6	
Gutter	12.9	379.4	
Top cb	12.27	379.81	
E	12.0	380.1	
100 North			
E	9.1	383.0	

392.08

Topcb	9.16	382.92
Gutter	9.9	382.2
1/4	9.4	382.7
1/4	9.3	382.8
1/4	9.4	382.7
Gutter	9.6	382.5
Topcb	9.17	382.91
W	9.0	383.1
T.P.	8.99 39	392.38
	8.64	383.99
	12.5' North	
W	7.6	384.8
Topcb	7.82	384.56
Gutter	8.0	384.4
1/4	8.0	384.4
1/4	7.8	384.6
1/4	7.9	384.5
Gutter	8.2	384.2
Topcb	7.62	384.56
E	6.7	385.7
	1.50' North	
E	6.3	385.8
Topcb	6.39	385.99
Gutter	6.7	385.7
1/4	6.3	386.1
1/4	6.3	386.1
1/4	6.5	385.9

+

392.38

Elev

(68)

Topcb	6.35	386.03
E W	6.2	386.2
	158' North	
W	5.9	386.5
Topcb	5.99	386.39
Gutter	6.0	386.4
1/4	6.1	386.3
1/4	5.9	386.5
1/4	5.8	386.6
1/4	5.9	386.5
Gutter	6.2	386.2
Topcb	6.02	386.36
E	5.8	386.6
	166' N	
E	5.6	386.8
Topcb	5.74	386.64
Gutter	5.9	386.5
1/4	5.6	386.8
1/4	5.9	387.0
1/4	5.5	386.9
1/4	5.8	386.6
1/4	5.6	386.8
Gutter	5.7	386.7
Topcb	5.73	386.65
W	5.6	386.8

	T	X	Elev
		392.38	
		1+97.2	i.o.c.
T W		4.8	387.6
G Topcb		5.01	387.37
1 Gutter		4.9	387.5
2 +2		4.8	387.6
3 1/4		4.9	387.5
4 E		4.6	387.8
T +3		4.5	387.9
1 1/4		4.7	387.7
T Gutter		5.2	387.2
Topcb		5.02	387.36
E		4.9	387.5
		PG 21 ±	PRC 992
E		4.5	387.9
Topcb		4.71	387.67
Gutter		4.9	387.5
+8		4.4	388.0
1/4		4.3	388.1
E		4.4	388.4
1/4		4.5	387.9
Gutter		4.7	387.7
Topcb		4.65	387.63
T W		4.4	387.9
	Sec A		
		PC of Radius	8 parts cor - 139.00 24' head X 6.1 E X - 8' c/w 5.1
		4.0	388.4
Topcb		3.82	388.56
Gutter		4.2	388.2

	T	X	Elev
		392.38	
1/4		4.1	388.3
E		4.1	388.3
+5		4.2	388.2
1/4		4.4	388.0
Gutter		4.9	387.5
Topcb		4.71	387.67
E		4.5	387.9
	Sec B		
		4.3	388.1
Topcb		4.51	387.87
E		5.1	387.3
+2		5.0	387.4
+4		4.9	388.0
1/4		4.4	388.0
E		4.2	388.2
1/4		4.1	388.3
Gutter		4.3	388.1
Topcb in d.f.		3.81	388.57
E		4.0	388.4
	Sec C		
E		4.0	388.4
Topcb		3.84	388.54
Gutter		4.3	388.1
1/4		4.2	388.2
E		4.3	388.1
1/4		4.5	387.9

(64)

	+	Σ	-	Elev
		392.38		
		Sec F		
Prop		4.0		388.4
Topcb		4.16		388.22
Gutter		4.8		387.6
1/4		4.8		387.6
¢		4.7		387.7
1/4		4.5		387.9
+3		4.9		388.0
Gutter		4.5		387.9
Topcb		3.84		388.54
¢-banjo		4.0		388.4

Sec G

¢				
Topcb		3.84		388.54
Gutter		4.4		388.0
1/4		4.5		387.9
¢		4.5		387.9
1/4		4.7		387.7
Gutter		4.8		387.6
Topcb		4.30		388.08
Prop		4.2		388.2

Sec H

Prop		4.1		388.3
Topcb		4.44		387.94
Gutter		4.6		387.8
1/4		4.5		387.9
¢		4.9		388.0

	+	Σ	-	Elev
		392.38		
		Sec I		
1/4		4.5		387.9
Gutter		4.4		388.0
Topcb		3.84		388.54
¢		4.0		388.4
				end of banjo

Sec I

¢		4.0		388.4
Topcb		3.83		388.55
Gutter		4.3		388.1
1/4		4.4		388.0
¢		4.5		387.9
1/4		4.7		387.7
Gutter		4.7		387.7
Topcb		4.66		387.62
Prop		4.4		388.0
Set BM. Top fire Hydrant at end of Hillside Drive		1.86		390.52
T.P. 3.55		391.09	4.84	387.54
Set BM. BP in S.E. Peter Venton's 35 th		4.26		386.83
T.P. 7.70		394.53	4.26	386.83
T.P. 6.92		394.20	2.25	392.28
BM. S.W. 35 th Mt View Drive		3.62		395.58
BM. S.W. Arthur Mt View Drive		8.73		391.91
				391.80
				0.11 ✓

71

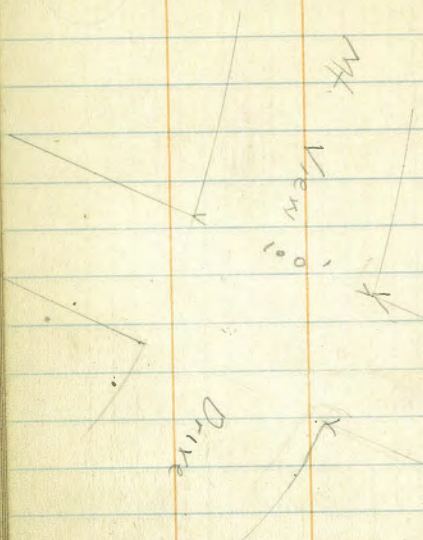

Note
 All distances used
 on this sketch are curb
 line distances

761.50

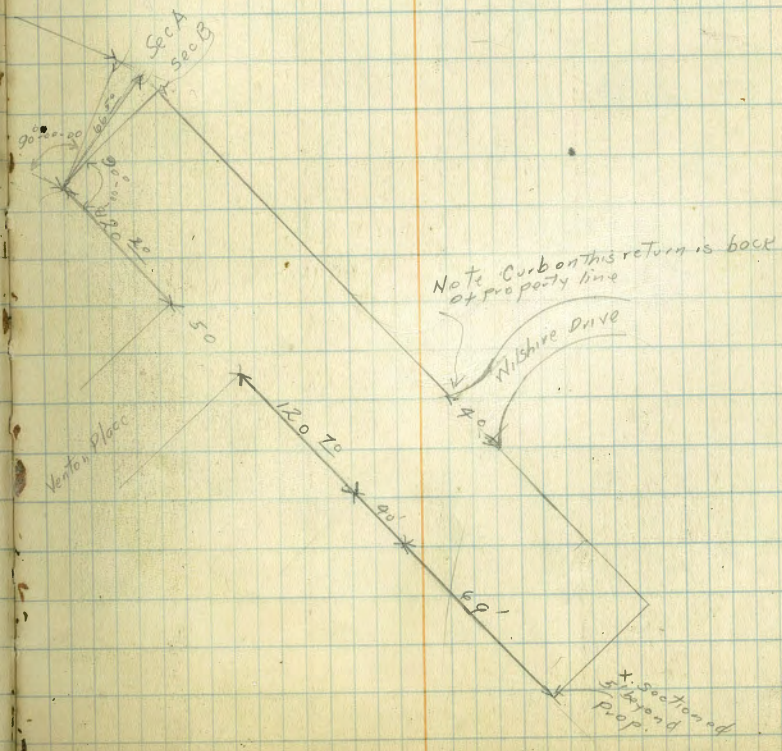

Note Curb on this return is back
 of property line

Nishire Drive

Venton Place

Prop. 50
 100

1/31/78

Nat + Stig kiland

assumed - r

6.06

46.66

40.0

128

74

154

31.0

F.L. 74" pipe

123

87

208

25.8

157

31.5

13.4

33.2

6.8
157

73

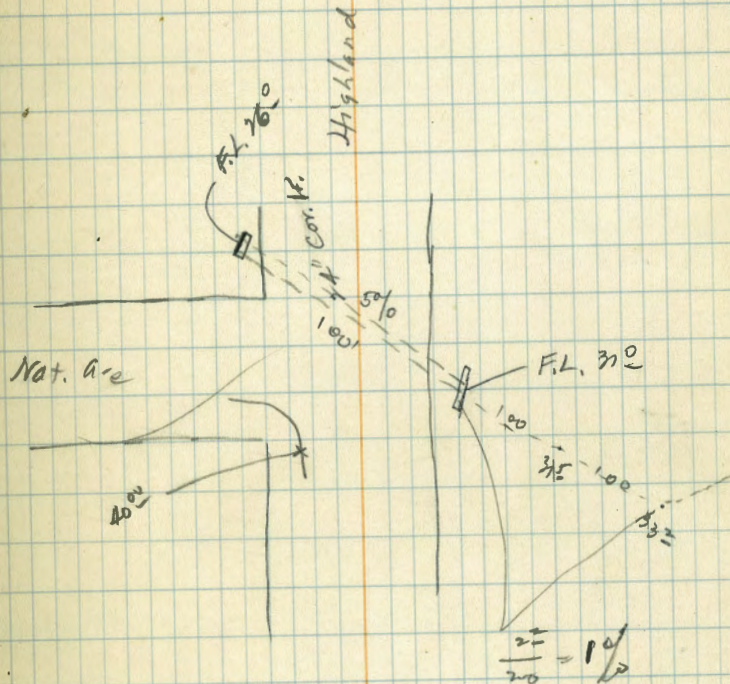

74

75

76

7

78

79

3

2499.57 / 840.29
 75X9K9 / 65387
 7388731
 1293
 203.2
 25
 2468
 1446 3500.00
 289
 680
 564
 1160

952
 236
 1188
 1196
 74
 806
 96
 17.66
 98
 8.06
 17.86
 164
 131
 33
 25
 8

11.75
 167
 13.42
 13
 164
 131
 33
 25
 8

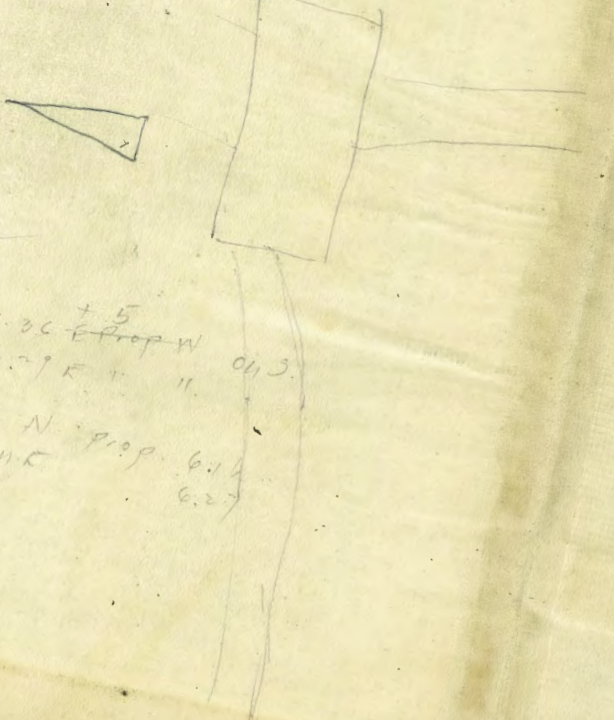

35
 9
 126
 H.I. for R. f. 30 E Prop W 04.5
 391.09 6.27 R. " "
 04 N Prop 6.14
 04 E 6.27

23
 Mt. View Drive
 33rd S.E.
 Mansfield S.E. 391.07
 394.83
 Mt. View Collier S.W.B.P. 391.37
 Arthur S.W.B.P. 391.80
 Hawley S.W.
 35th S.W. 399.01
 395.42

399.15
 368
 395.47
 2.33
 397.80

397.80
 7.39
 390.46
 392.38
 3.91
 388.97
 2.46

391.93
 6.98
 384.95
 7.13
 392.08

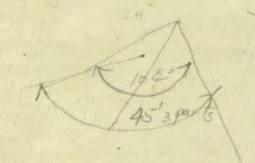

301
 90.6
 120