

1222

OSTS

FIELD BOOK

No. 335 F

MICROFILMED
DEC 22 1964

Mt. View Copy 393.91 SW
Mt. View S.W. 391.15
Colliero Mt. View Drive 391.37
370.87

Mt. View Drive N.E. 389.09
S.E. 385.80
S.E.

29
96.
32
70
108

39475
723
5.92 8.5 04 S. Side Belmont
902 25
1.80 3.40
08
Mt. View and
3279
399.01
399.75

ENGINEERING DEPARTMENT
CITY OF SAN DIEGO,
CALIFORNIA.

Our Leather Bound Engineers Note Books are carried in the following rulings:

- No. 380 LEVEL BOOK. Left and Right Hand Page the same as Left Hand Page of this Book.
Colliero Mt. View
S.W. 391.37
- No. 382 FIELD BOOK. Left Hand Page as in this Book, Right Hand Page 4 x 4 to the inch, Center Line Red.
- No. 384 MINING TRANSIT BOOK. Left Hand Page as in this Book, Right Hand Page 8x8 to the inch, Center Line Red.
- No. 385 FIELD BOOK. Left Hand Page as in this Book, Right Hand Page 8 vertical and 4 horizontal lines to the inch, Center Line Red.

We also carry the Note Books listed above, bound in extra strong Fabri-Hide (otherwise the same quality of book), which can be furnished at a somewhat lower price.

In ordering Fabri-Hide covered books, add the letter "F" to catalog number.

THE FREDERICK POST CO.
ENGINEERING and DRAFTING SUPPLIES
IRVING PARK STATION
CHICAGO, ILL.

Index

- X. Section Eugene Place Normal Hts 1-9
- X. Sections Sydney Place Normal Hts 10-16
- X. Sections Raymond Place Normal Hts 17-19
- X. Sections Mt View Drive from the
East Line of 35th to N. line of Adams 20-57
- X. Sections Copley St. Normal Hts from
Mt. View to Mt. View 58-76

8/15
 11/22/27
 SW Arthur
 & Mt View Drive

X Sections Eugene place

60'±
 12' cbs
 9'±

+	+	-	Elev
9.62	396.42		391.80

Sec A

Left this Section out.

396.42

0400 Sec sketch

S	5.6	390.8
+1.5 edge of walk	5.95	390.47
Top cb	6.21	390.21
Gutter	6.9	389.5
1/4	6.3	390.1
E	5.6	390.8
1/4	5.4	391.0
Gutter	5.9	390.5
Top cb	5.0	391.42
+1.5 N edge walk	4.69	391.73
N	4.7	391.7

Sketch of Eugene place showing extent of sections taken

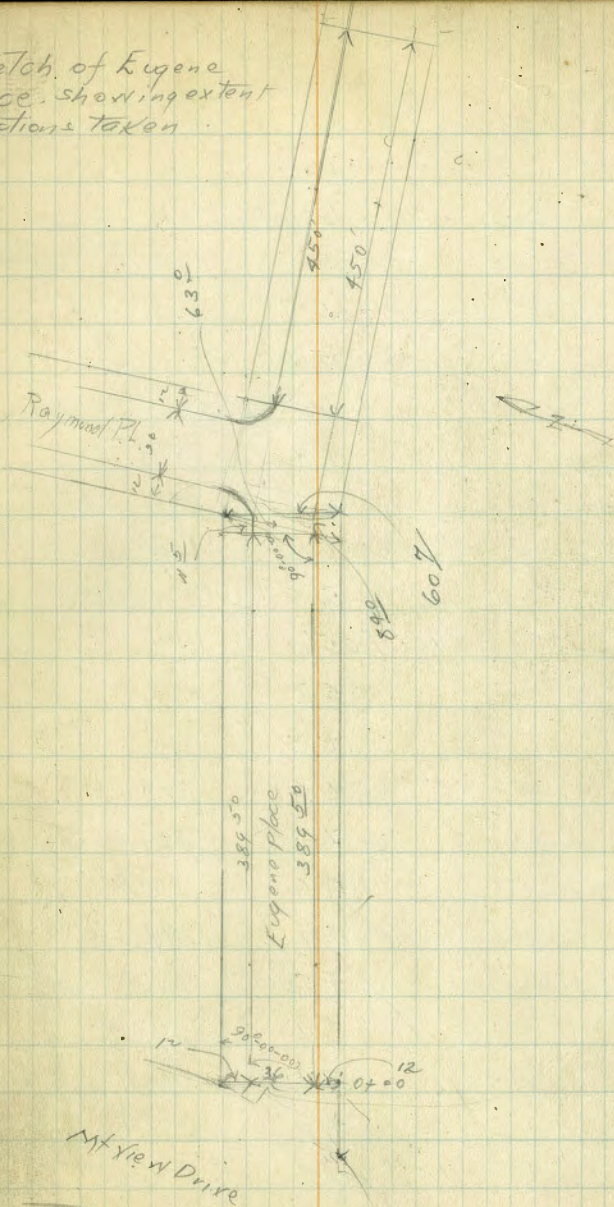

+

396.42

Elev

50'

N	5.0	391.4
Topcb	5.24	391.18
Gutter	6.0	390.4
1/4	5.7	390.7
£	5.9	390.5
1/4	6.5	389.9
Gutter	7.1	389.3
Topcb	6.42	390.00
+10.5	6.2	390.2
S	5.9	390.5
100' East		
S	5.8	390.6
+2	6.3	390.1
Topcb	6.60	389.82
Gutter	7.3	389.1
1/4	6.6	389.8
£	6.0	388.4
1/4	5.8	390.6
Gutter	6.1	390.3
Topcb	5.42	391.00
N	4.9	391.5
150' East		
N	4.7	391.7
Topcb	5.60	390.82
Gutter	6.9	390.0

396.42

Elev

1/4	6.0	390.4
£	6.1	390.3
1/4	6.8	389.6
Gutter	7.5	388.9
Topcb	6.70	389.7
S	6.3	390.1
T.P.	5.29	395.31
200 East		
S	5.3	390.0
Topcb	5.79	389.57
Gutter	6.4	388.9
1/4	5.8	389.5
£	5.0	390.3
+4	9.9	390.4
1/4	5.0	390.3
Gutter	5.2	390.1
Topcb	4.64	390.6.7
N	3.8	391.5
217 East W line of Alkyon North		
N	3.4	391.9
+3	4.1	391.2
Topcb	4.60	390.71
Gutter	5.0	390.3
1/4	5.0	390.3
£	5.0	390.3
1/4	5.8	389.5

	395.31	217' East	395.31
Gutter		6.6	388.7
Topcb		5.79	389.52
+10.5		5.5	389.8
S		5.0	390.3
		232' East	
S		5.1	390.2
+1.5		5.6	389.7
Topcb		5.88	389.43
Gutter		6.6	388.7
1/4		5.8	389.5
1/4		5.0	390.3
Gutter		5.0	390.3
Topcb		4.64	390.67
N		4.2	391.1
		250' East	
		4.0	391.3
+1.5 edge of walk		4.50	390.81
Topcb		4.79	390.52
Gutter		5.6	389.7
+1.3		5.2	390.1
1/4		5.1	390.2
1/4		5.0	390.3
1/4		5.2	390.1
1/4		5.9	389.4
Gutter		6.7	388.6

	395.31	Elev
Topcb	5.92	389.39
+10.5	5.6	389.7
S	5.1	390.2
	300' East	
S	5.9	389.4
Topcb	6.12	389.19
Gutter	6.8	388.5
1/4	6.2	389.1
1/4	5.6	389.7
1/4	5.9	389.4
Gutter	5.6	389.7
Topcb in auto driveway	5.52	389.79
+1.4	4.7	390.6 v
N	4.4	390.9
	350' East	
N	4.6	390.7
+1.5	4.9	390.4
Topcb	5.22	390.09
Gutter	5.8	389.5
1/4	5.6	389.7
1/4	5.6	389.7
+5	5.9	389.4
1/4	6.3	389.0
Gutter	6.9	388.4
Topcb	6.38	388.93
S	6.0	389.3

	T	Elev
	395.31	
T.P.	6.67	388.69
S	5.6	389.2
Topcb	5.87	388.99
Gutter	6.3	388.5
1/4	5.9	388.9
2	5.2	389.6
1/4	5.0	389.8
Gutter	5.9	389.4
Topcb	4.81	389.95
H 710.5	4.5	390.3
N	3.9	390.9
Sct B.M. on Pole NW Raymond & Eugene	4.21	391.10
	3+895 = 901 = 63	
N	4.5	390.3
Topcb	4.85	389.91
Gutter <i>flow line of drain</i>	5.90	388.86
+1.8	4.90	389.86
1/4	5.0	389.8
2	5.1	389.7
1/4	5.8	389.0
Gutter	6.9	388.4
Topcb	5.85	388.91
S	5.5	389.3
	Prop + 8.90 = 602	
S	5.6	389.2
Topcb	5.87	388.99
Gutter	6.5	388.3

	T	Elev
	399.76	
1/4	5.8	389.0
2	5.1	389.7
1/4	4.9	389.9
Gutter	4.8	390.0
Topcb	4.82	389.94
N	4.5	390.3
	W Cb	
N	5.0	389.8
cb	4.9	389.9
1/4	4.8	390.0
2	5.2	389.6
1/4	6.0	388.8
Gutter	6.6	388.2
Topcb	5.89	388.87
S	5.6	389.2
	W 1/4	
S	5.6	389.2
Topcb	6.02	388.74
Gutter	6.4	388.4
1/4	6.2	388.6
2	5.4	389.4
1/4	5.0	389.8
cb	4.7	390.1
N	4.8	390.0
	E. Raymond Place & Eugene	
	4.7	390.1

	+	-	Elev
			394.76
cb		4.9	389.9
1/4		5.1	389.7
+7		5.3	389.5
£		5.4	389.4
1/4		6.2	388.6
Gutter		6.5	388.3
Topcb		6.6	388.70
S		5.7	389.1
	E 1/4		
S		5.8	389.0
Topcb		6.10	388.66
Gutter		6.5	388.3
1/4		6.3	388.5
£		5.5	389.3
1/4		5.1	389.7
cb		5.0	389.8
N		5.0	389.8
	E. cb		
N		5.3	389.5
cb		5.2	389.6
1/4		5.2	389.6
£		5.5	389.3
1/4		6.2	388.6
+7		6.8	388.0
Gutter		6.7	388.1
Topcb in auto driveway		6.50	388.96

	+	-	Elev
			394.76
S		5.7	389.1
	E. Prop Raymond		
S		6.0	388.8
Topcb		6.26	388.50
Gutter		6.7	388.1
1/4		6.9	388.4
£		5.6	389.2
1/4		5.5	389.3
+75 edge of drain		5.1	389.7
Stone line		6.07	388.69
Gutter		6.1	388.7
Topcb		5.08	389.68
+10.5		4.8	390.0
N		4.3	390.5
	50 East of the East line of Raymond Place		
N		4.3	390.5
+1.5		5.3	389.5
Topcb		5.62	389.14
Gutter		6.4	388.4
1/4		6.0	388.8
£		5.9	388.9
1/4		6.5	388.3
Gutter		7.3	387.5
Topcb		6.39	388.37
S		6.1	388.7
T.P.	463	392.68	6.11
			388.05

39268

E104

100' East

S.	4.1	388.6
+1.5	4.5	388.2
Topcb	4.7	387.97
Gutter	5.1	387.6
+3	5.4	387.3
1/4	4.8	387.9
+3	4.9	388.3
♀	4.1	388.6
1/4	4.2	388.5
Gutter	4.5	388.2
Topcb	4.0	388.66
+10.5	3.7	389.0
N	3.4	389.3

150' East

N	3.7	389.0
+1.5	4.2	389.5
Topcb in Auto Driveway	5.13	387.55
Gutter	5.~	387.5
+3	5.2	387.5
1/4	4.8	387.9
♀	4.6	388.1
+7	4.9	387.8
1/4	5.1	387.6
+6	5.9	386.8
Gutter	5.9	386.8
Topcb	4.97	387.71

39268

E104

6

± 10.5	4.7	388.0
S.	4.9	388.3

200' East

S.	4.8	387.9
+1.5	5.0	387.7
Topcb	5.30	387.38
Gutter	5.8	386.9
+7	6.0	386.7
1/4	5.6	387.1
+3	5.3	387.4
♀	5.1	387.6
1/4	5.2	387.5
Gutter	5.8	386.9
Topcb	5.06	387.62
N	4.7	388.0

225' East

N	5.1	387.6
Topcb	5.90	387.28
Gutter	6.1	386.6
1/4	5.6	387.1
♀	5.3	387.4
+5	5.4	387.3
1/4	5.7	387.0
+3	6.1	386.6
Gutter	6.2	386.5
Topcb	5.91	387.27

	+	392.68	-	260
S			5.1	387.6
	236 East			Beginning of concrete gutter at 300'
S			5.3	387.4
Topcb			5.56	387.12
Concrete Gutter			6.3	386.36
+3.5			5.98	386.70
1/4			6.1	386.6
+4			5.6	387.1
ϕ			5.9	387.3
1/4			5.6	387.1
Gutter			6.2	386.5
Topcb			5.98	387.20
N			5.3	387.4
T.P.	300	388.92	6.76	385.92
			255' East	
S			1.8	387.1
Topcb			2.09	386.83
Concrete Gutter			2.87	386.05
+3.5			2.44	386.49
1/4			2.3	386.6
ϕ			2.0	386.9
1/4			2.2	386.7
Gutter			2.6	386.3
Topcb			2.05	386.87
N			1.9	387.0
			275' East	

	+	388.92	-	392.68
				6.76
				385.92
			275' East	
N			2.5	386.4
Topcb			2.57	386.35
Gutter			3.3	385.6
1/4			2.2	386.3
ϕ			2.5	386.4
1/4			2.9	386.0
+3			3.5	385.4
+3			3.4	385.5
+5			2.8	386.1
+5.5 edge gutter			2.91	386.01
Gutter			3.25	385.67
Topcb			2.95	386.47
S			2.0	386.9
			300' East	
S			3.1	385.8
Topcb			3.33	385.59
Gutter			4.09	384.83
+3.5			3.71	385.21
+7			4.3	384.6
1/4			4.2	384.7
17			3.4	385.5
ϕ			3.4	385.5
1/4			3.6	385.3
Gutter			4.3	384.6
Topcb			3.96	385.46
N			3.2	385.7

	+	-	Elev
			388.92
			325' East
S			
N		7.9	384.5
S Topcb		4.52	384.40
To Gutter		5.1	383.8
20 +4		5.3	383.6
+ +5		5.0	383.9
1/4 1/4		4.7	384.2
+4 2		4.5	384.4
2 +6		4.7	384.2
1/4 1/4		5.0	383.9
Gutter +1		5.0	383.9
Top +3		5.5	383.4
N +5		5.9	383.5
T.F. +5.5 edge concrete Gutter		4.87	384.03
Gutter		5.19	383.73
S Topcb		4.93	384.49
Top S		4.3	384.6
Com			350' East
+3 S		5.3	383.6
1/4 Topcb		5.61	383.31
2 Gutter		6.93	382.49
1/4 +3.5		6.09	382.88
Gutter +4		6.5	382.4
Top +7		6.5	383.4
N 1/4		6.0	383.9
2		5.7	383.2

	+	-	Elev	8
			388.92	
1/4		5.9	383.0	
+5		6.1	382.8	
Gutter		6.2	382.7	
Topcb Auto driveway		6.10	382.82	
N		5.9	383.5	
			375' East	
N		6.6	382.3	
Topcb		6.84	382.08	
Gutter		7.3	381.6	
+6		7.2	381.7	
1/4		7.0	381.9	
2		6.8	382.1	
+4		7.0	381.9	
1/4		7.5	381.4	
+1		7.4	381.5	
+5.5 edge concrete Gutter		7.09	381.83	
Gutter		7.62	381.30	
Topcb		6.83	382.09	
S		6.5	382.4	
			391' East	
S		7.0	381.9	
Topcb		7.54	381.38	
Gutter		8.37	380.55	
+3.5		7.94	380.98	
1/4		8.0	380.9	
2		7.9	381.0	

38892

Elev

1/4	7.9	381.0
+4	8.2	380.7
Gutter	8.2	380.7
Topcb	7.62	381.30
N	7.2	381.7
425' East		
N	8.8	380.1
Topcb	9.23	379.69
Gutter	10.0	378.9
+6	10.0	378.9
1/4	9.9	379.0
+4	9.5	379.4
N	9.8	379.1
K	9.7	379.2
+2	9.3	379.6
+4	9.3	379.6
1/4	9.2	379.7
+ 5.5 edge of concrete gutter	9.59	379.33
Gutter	9.98	378.94
+3	9.14	379.78
1/4	9.1	379.8
S		
450' East		
1/4	10.1	378.8
S	10.40	378.52
Topcb	11.30	377.62
Gutter	10.92	378.00
+3.5	10.8	378.1
1/4		

38892

Elev

9

K	10.7	378.2
1/4	11.1	377.8
Gutter	11.1	377.8
Topcb	10.43	378.49
N	10.2	378.7
* Note from 4450 to end at 5105 has been sectioned previously.		
B.M. Spiken pole S side of Eugene place at 425	8.00	380.92
K19M		320.90
		00.02

Bliss
Isabel
No. 904
11-9-27

B.M. SW
At Mt. View
Drive

X Sections Sydney Place Normal Hts

	+	x	-	Elev	60 Nicks 9 1/2
TP	5.20	397.00		391.80	
	2.14	396.18	2.96	394.09	
E Prop. Mt. View Drive = 00					
S		1.9		394.3	
± edge of Walk		2.00		394.2	
Top of		2.16		394.02	
Gutter		2.9		393.3	
1/4		2.5		393.7	
±		2.1		394.1	
1/4		2.3		393.9	
+5		2.5		393.7	
Gutter		2.9		393.3	
Top of		2.2		393.97	
+10		1.90		394.28	
N		1.9		394.3	
50' East					
N		2.6		393.6	
Top of	in auto driveway	3.3		392.83	
Gutter		3.6		392.6	
1/4		3.2		393.0	
±		2.9		393.3	
1/4		3.1		393.1	
Gutter		3.6		392.6	
Top of		2.86		393.32	
S		2.9		393.8	

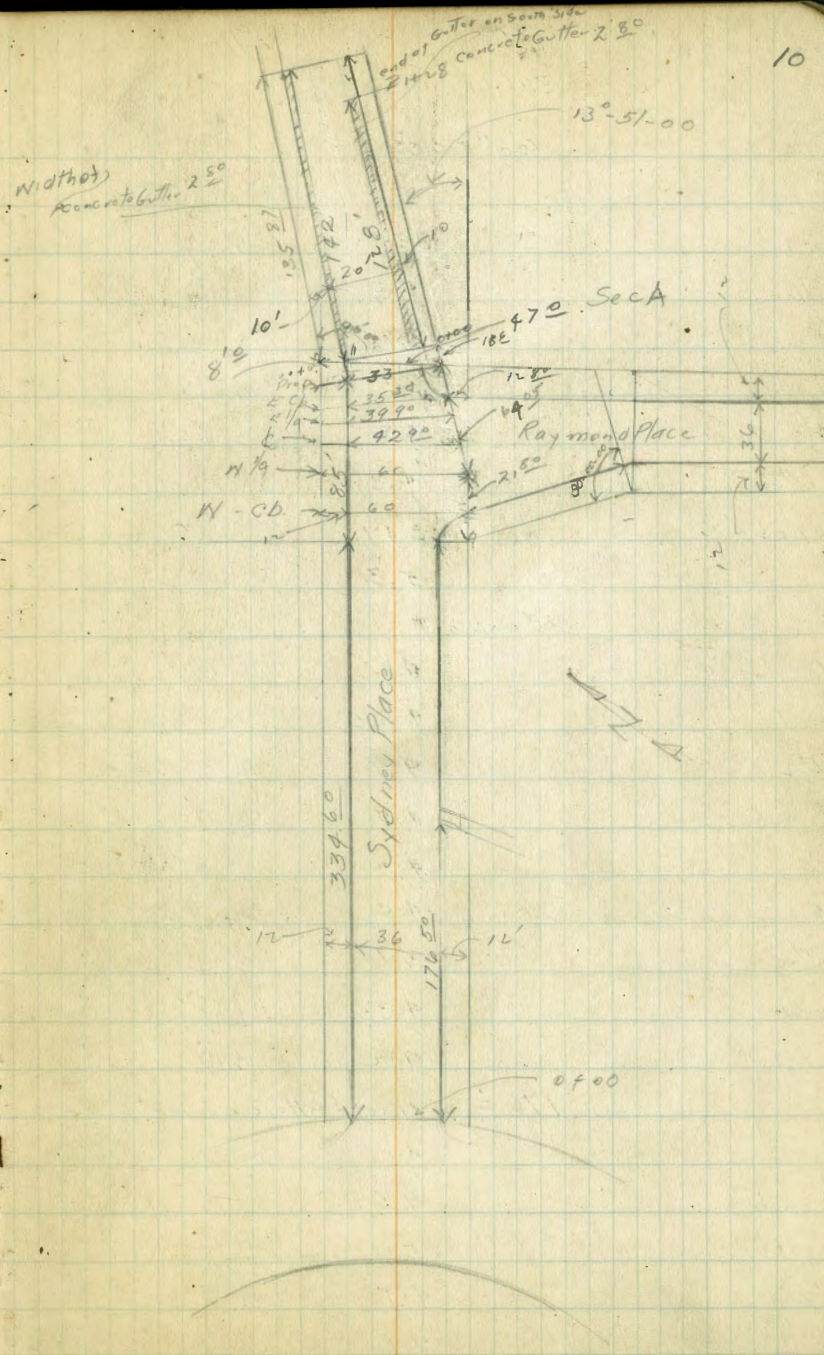

396.18

100' East

N	3.5	392.7
Topcb	3.68	392.50
Gutter	4.3	391.9
1/4	3.8	392.3
℄	3.5	392.7
1/4	3.7	392.5
Gutter	4.3	391.9
Topcb	3.47	392.71
N	3.3	392.9

150' East

N	4.0	392.2
Topcb	4.25	391.93
Gutter	4.9	391.3
1/4	4.4	391.8
℄	4.2	392.0
1/4	4.4	391.8
Gutter	5.1	391.1
Topcb	4.35	391.83
S	4.2	392.0

176 ⁵/₅ W line of Alley on South

S	4.5	391.7
Topcb	4.59	391.59
Gutter	5.1	391.1
1/4	4.7	391.5
℄	4.6	391.6

396.18

1/4

1/4	4.7	391.5
Gutter	5.2	391.0
Topcb	4.57	391.61
N	4.3	391.9

191'

N	4.5	391.7
Topcb	4.78	391.40
Gutter	5.5	390.7
1/4	5.0	391.2
℄	4.8	391.4
1/4	5.0	391.2
Gutter	5.6	390.6
Topcb	4.88	391.30
S	4.7	391.5

200' East

S	4.8	391.4
Topcb	5.01	391.17
Gutter	5.7	390.5
1/4	5.2	391.0
℄	4.9	391.3
1/4	5.1	391.1
Gutter	5.6	390.6
Topcb	4.84	391.29
N	4.6	391.6

250' East

N	5.5	390.7
---	-----	-------

	+	39618	-	Elev
Topcb			5.98	390.70
Gutter			6.2	390.0
1/4			5.7	390.5
ϕ			5.6	390.6
1/4			5.9	390.3
Gutter			6.5	389.7
Topcb in auto driveway			6.91	389.77
S			5.4	390.8
		300' East		
S			6.0	390.2
+1.5			6.3	389.9
Topcb			6.55	389.63
Gutter			7.1	389.1
1/4			6.6	389.6
ϕ			6.2	390.0
1/4			6.2	391.0
T.P.	022	390.28	6.12	390.06
Gutter			0.8	389.5
Topcb			0.14	390.14
N			0.0	390.3
		334 ⁶⁰		
		W. line of Raymond Place		
N			0.9	389.9
Topcb			0.65	389.53
Gutter			1.3	389.0
1/4			0.9	389.4
ϕ			0.6	389.7

	+	39028	-	Elev	12
1/4			1.0	389.3	
+7.5			1.05	389.23	
Flowline			1.98	388.30	
Gutter			1.9	389.4	
Topcb			1.05	389.23	
S			0.72	389.56	
		W. cb.			60'
S			2.0	388.3	
cb.			1.2	389.1	
1/4			0.8	389.5	
ϕ			0.7	389.6	
1/4			1.0	389.3	
Gutter			1.4	388.9	
Topcb			0.72	389.56	
N			0.5		
		W 1/4			60'
N			0.7	389.6	
Topcb			0.98	389.30	
Gutter			1.5	388.8	
1/4			1.2	389.1	
ϕ			0.9	389.4	
1/4			0.9	389.4	
cb			0.9	389.4	
S			1.1	389.2	
		ϕ Sydney Place & Raymond			54 ⁹⁰ sec set
S			1.2	389.1	

cb	1.1	389.2
1/4	1.2	389.1
2	1.1	389.2
1/4	1.9	388.9
Gutter	1.6	388.7
Topcb	1.13	389.15
N	0.9	389.4
	5 1/4	5190
N	1.1	389.2
Topcb	1.33	389.95
Gutter	1.8	388.5
1/4	1.6	389.7
2	1.4	389.9
1/4	1.5	388.8
cb	1.6	388.7
S	1.6	388.7
	E cb	91 30
S on ground	2.9	387.9
S on topcb	2.12	388.16
cb	2.9	387.9
1/4	1.9	388.4
2	1.7	388.6
1/4	1.8	388.5
Gutter	2.1	388.2
Topcb	1.55	388.73
N	1.4	388.9

E Prop. 45' Sec sketch

N	1.5	388.8
Topcb	1.69	388.59
Gutter	2.2	388.1
1/4	1.9	388.4
2	2.3	388.0
1/4	2.3	388.0
Gutter	2.1	388.2
Topcb	2.08	388.20
S	1.9	388.4

Sec A 470

S	1.9	388.4
Topcb	2.18	388.10
Gutter on concrete	3.03	387.26
+2.9 Nudge of Gutter	2.69	387.59
2	2.2	388.1
1/4	2.9	387.9
+2.7 edge of gutter	2.31	387.97
Gutter	2.62	387.66
Topcb	1.81	388.47
N	1.6	388.7

	+	390.28	Elev
+2.2			6.05 384.23
Gutter			6.33 383.95
Topcb			5.57 384.71
N			5.3 385.0

1700

N			7.0 383.3
Topcb			7.10 383.18
Gutter			7.87 382.41
+2.8			7.60 382.68
1/4			7.9 382.9
E			7.1 383.2
1/4			7.4 382.9
+2.2			7.62 382.66
Gutter			7.96 382.32
Topcb			7.16 383.12
S			7.1 383.2
T.P	3.69	385.87	8.10 382.18

1428 end of gutter on S.

S			4.5 381.4
Topcb			4.54 381.33
Gutter			5.21 380.66
+2.8			4.94 380.93
1/4			4.7 381.2
E			4.5 381.4
1/4			4.6 381.3
+2.2			4.93 380.94

	+	385.87	Elev	15
Gutter			5.16 380.71 ⁰	
Topcb			4.42 381.45	
N			4.3 381.6	

1432

N			4.5 381.4
5.6			4.6 381.3
Topcb in auto drive way			5.38 380.49
Gutter			5.42 380.45
+2.8			5.19 380.68
1/4			4.8 381.1
E			4.9 381.0
1/4			5.0 380.9
+2			5.1 380.8
T.B			5.7 380.2
Gutter			5.8 380.1
Topcb			4.81 381.06
S			4.7 381.2

1438

S			5.5 380.4
Topcb			5.27 380.60
Gutter			5.8 380.1
1/4			5.6 380.3
E			5.6 380.3
1/4			5.3 380.6
Gutter			5.2 380.7
Topcb			5.10 ? 380.77 ?

	+	K	-	Elev
		385.87		
N			49	381.0
		149		
N			48	381.1
Topcb			51.9	380.68
cutt.			53	380.6
1/4			59	380.5
12.5 edge			63.0	379.57
E			7.00	378.9
12.5			66	379.3
1/4			5.2	380.7
Gutter			5.5	380.4
Topcb			5.53	380.34
S			5.5	380.4
T.P.	7:97	393.70	0.14	385.73

used thro
T.P. for X section
of Raymond place
see next page

B. 1100
 Isabel
 Morgan
 11/29/27

X Section of Raymond Place

Normal Hts.

	+	x	-	Elev
	7.97	393.76	0.14	385.73

Sec A

E		4.9		388.8
Top cb		5.51		388.19
Gutter		6.0		387.7
1/4		5.2		388.5
E		4.7		389.0
1/4		4.6		389.1
Gutter		5.8		388.3
Top cb		4.53		389.17

W		4.1		389.6
---	--	-----	--	-------

T.P	6.02	394.56	5.16	388.54
-----	------	--------	------	--------

Sec B

78

crossed at 76

W		4.6		390.0
+1.5		5.0		389.6
Top cb		5.34		389.22
Gutter		6.0		388.6
1/4		5.6		389.0
E		5.5		389.1
1/4		6.0		388.6
Gutter		6.9		387.7
Top cb		6.25		388.91
E		5.9		388.7

Sec C

70

crossed at 58

E		5.8		388.8
Top cb		6.14		388.42
Gutter		6.7		387.9

394.56

Elev

17

1/4		6.0		388.6
E		5.6		389.0
1/4		5.7		388.9
Gutter		6.0		388.6
Top cb		5.26		389.30
+10.5		5.0		389.6
W		4.6		390.0
Sec D				
W		4.9		389.7
Top cb		5.29		389.32
Gutter		5.8		388.8
1/4		5.6		389.0
E		5.7		388.9
1/4		6.1		389.5
Gutter		6.6		389.0
Top cb		6.03		389.53
E		5.8		388.8
0+00 = 4				
E		5.6		389.0
Top cb in Driveway		6.39		388.17
Gutter		6.6		388.0
1/4		5.9		388.7
E		5.6		389.0
1/4		5.8		389.0
Gutter		5.8		388.8
Top cb		5.19		389.37

Yardage
 Book p 94
 Remarks

	K	K/ey
	39456	
W	4.9	389.7
	50' South	
W	4.6	390.0
Topcb	5.09	389.52
Gutter	5.7	389.9
1/4	5.5	389.1
£	5.4	389.2
1/4	5.8	388.8
Gutter	6.4	388.2
Topcb	5.81	389.75
E	5.9	389.2
	100' South	
E	5.2	389.4
TopCb.	5.58	388.98
Gutter	6.1	388.5
1/4	5.6	389.0
£	5.1	389.5
1/4	5.3	389.3
Gutter	5.5	389.1
Topcb	5.00	389.6
W	4.5	390.1
	150' South	
W	4.3	390.3
+1.5	4.6	390.0
Topcb	4.87	389.69
Gutter	5.6	389.0

	K	K/ey
	39456	18
1/4	5.1	389.5
£	5.0	389.6
1/4	5.5	389.1
Gutter	6.0	388.6
TopCb.	5.31	389.25
E	5.0	389.6
	200' South	
E	4.8	389.8
TopCb.	5.08	389.48
Gutter	5.6	389.0
1/4	5.2	389.4
£	4.8	389.8
1/4	5.0	389.6
Gutter	5.3	389.3
Topcb	4.75	389.81
+10.5	4.5	390.1
W	4.0	390.6
	247 1/2 South	
W	3.9	390.7
+1.5	4.3	390.3
Topcb	4.6	389.94
Gutter	4.9	389.7
1/4	4.7	389.9
£	4.5	390.1
1/4	4.9	389.7
Gutter	5.9	389.2

	+	X	-	Elev
		394.56		
Topch		49.0		389.6
+10.5		4.6		390.0
E		4.0		390.6
B.M. Polk Raymond Eugene NW		25.0	at South	
E		9.2		390.4
+1.5		9.6		390.0
Topch		9.87		389.69
Gutter		8.1		389.5
1/4		9.8		389.8
E		4.5		390.1
1/4		4.6		390.0
Gutter		4.7		389.9
Topch		4.62		389.94
N		4.3		390.3
B.M. set on Pole NW cor Raymond Place Eugene		4.00		390.56
				390.55 B.M. .01

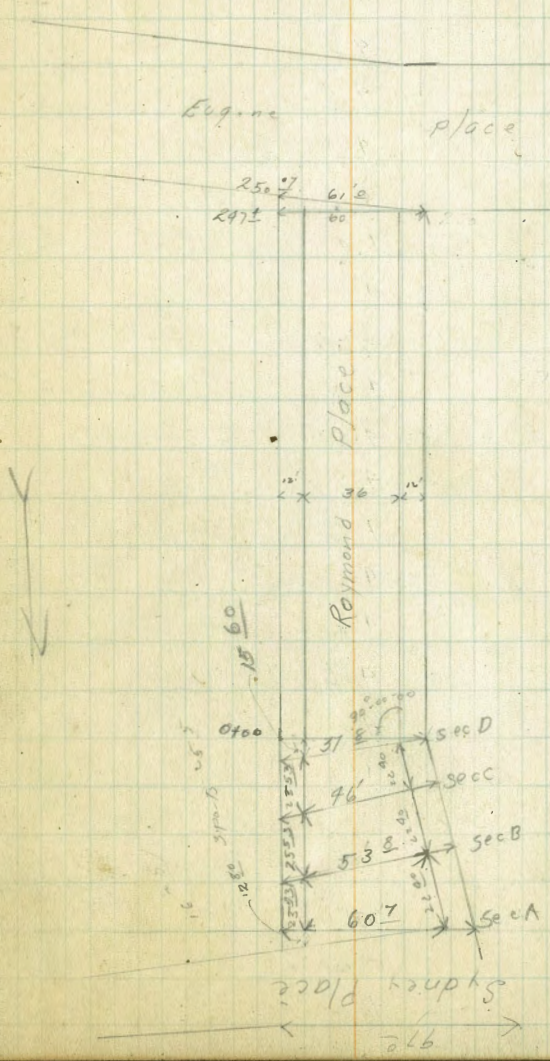

X-section Mt View Drive from the East end
of 35th To N line of Adams

BM SW
Mt View Drive
26 on N
22 11 on S

9.77 400.19 395.42
Cut this curve into 8 parts
Sec A = 00 Elev 35.74 8 parts

S	4.2	396.0
S	4.47	395.72
Top cb	4.7	395.5
Gutter	4.7	395.5
1/4	4.5	395.7
1/4	4.3	395.9
1/4	4.4	395.8
Gutter	4.7	395.5
Top cb	4.41	395.78
N	4.1	396.1

Sec B = A + 4

N	4.2	396.0
Top cb	4.95	395.74
Gutter	4.9	395.3
1/4	4.9	395.8
1/4	4.2	396.0
1/4	4.6	395.6
Gutter	4.7	395.5
Top cb	4.47	395.72
S	4.0	396.0

Sec C

S	4.0	396.0
Top cb	4.41	395.78
Gutter	5.0	395.2
1/4	4.6	395.6

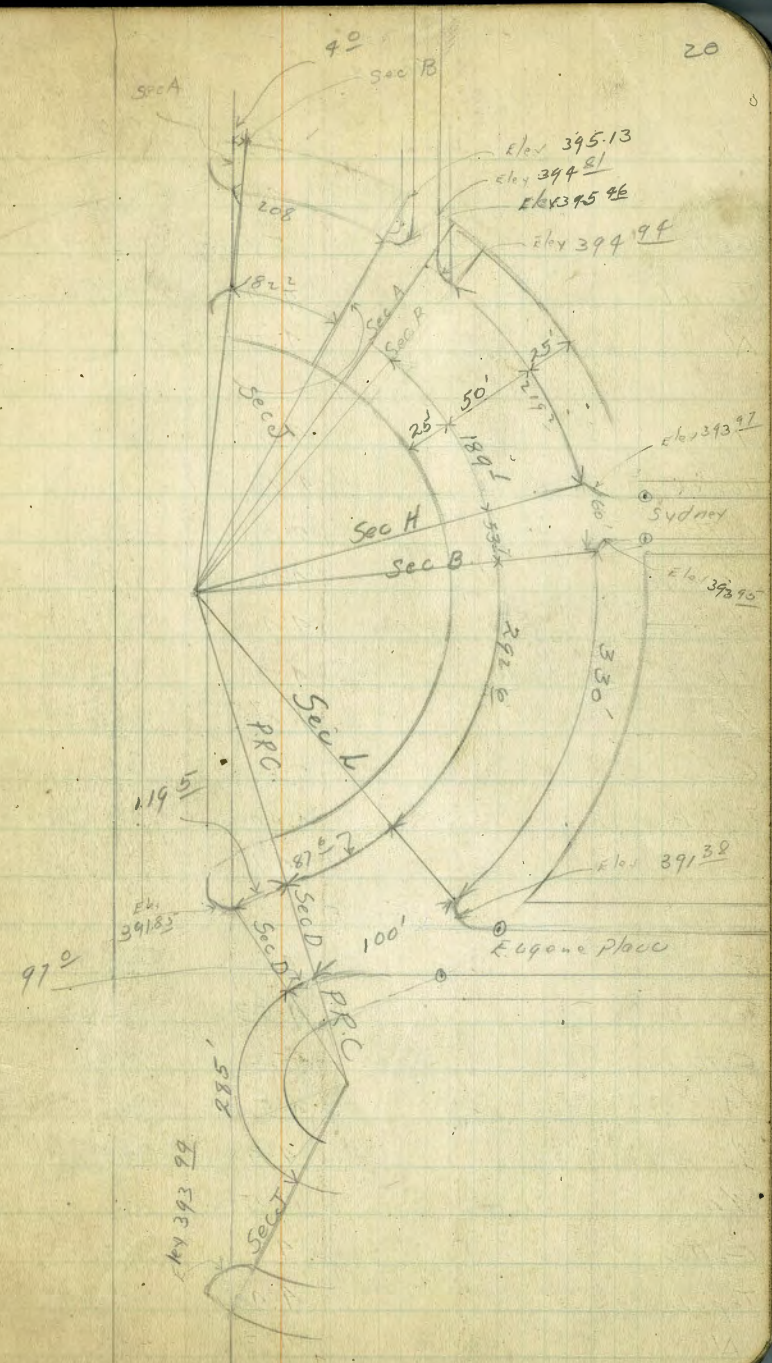

	+	X 400.19	-	Elv
Q			4.3	9.5 395.9
1/4			4.4	395.8
Gutter			5.1	395.1
Topcb			4.99	395.70 ✓
N			4.3	395.9
Sec D				
N			4.5	395.7
Topcb			4.92	395.27 ✓
Gutter			5.0	395.2
1/4			4.5	395.7
K			4.0	395.8
+10			4.3	395.9
1/4			4.4	395.8
Gutter			5.2	395.0
Topcb			4.49	395.70 ✓
S			4.1	396.1
Sec E				
S			4.3	395.9
Topcb			4.53	395.66 ✓
Gutter			5.2	395.0
1/4			4.5	395.7
Q			4.4	395.8
1/4			4.5	395.7
Gutter			4.9	395.3
Topcb			4.45	395.74 ✓
N			4.3	395.9

	+	X 400.19	-	Elv
21				
Sec F				
N			4.4	395.9
Topcb			4.63	395.86 ✓
Gutter			5.0	395.2
1/4			4.6	395.6
Q			4.5	395.7
1/4			4.7	395.5
Gutter			5.4	394.9
Topcb			4.69	395.50 ✓
S			4.2	396.0
Sec G				
S			4.12	396.07
Topcb			4.75	395.42 ✓
Gutter			5.4	394.8
1/4			4.9	395.3
Q			4.6	395.6
1/4			4.6	395.6
Top			5.1	395.1
Topcb			4.63	395.56 ✓
N			4.6	395.6
Sec G + 15.2 Alley on South				
N			4.5	395.7
Topcb			4.69	395.50
Gutter			5.2	395.0
1/4			4.6	395.6
Q			4.7	395.5
1/4			4.9	395.3

	+	700.19	Elev.
Gutter		5.9	394.8
Topcb		9.77	395.49 ✓
S.		4.1	396.1
	Sec H		
S.		9.2	396.0
cb. in alley		5.4	394.8
Gutter		5.4	394.8
1/4		4.8	395.4
£		4.6	395.6
1/4		4.6	395.6
Gutter		5.2	395.0
Topcb		4.72	395.49 ✓
N.		4.5	395.7
	Sec H + 10	E Line of alley	
N.		9.9	395.8
Topcb		4.70	395.49
Gutter		5.1	395.1
1/4		4.8	395.4
£		4.6	395.6
1/4		4.7	395.5
Gutter		4.5	395.7
cb. in E of Return		4.94	395.25 ✓
S.		4.5	395.7
	Sec I		
S.		4.6	395.6
Topcb		5.09	395.15 ✓

	+	400.19	Elev.
Gutter		5.8	394.4
1/4		4.7	395.5
£		4.8	395.4
1/4		4.9	395.3
Gutter		5.3	394.9
Topcb		4.79	395.40 ✓
N.		4.6	395.6
T.D.	4.48	399.82	485 395.34
	Sec I + 18	PT of Proprietary Venton Place at View Drive	
N.		4.4	395.4
Topcb		4.56	395.26
Gutter		4.9	394.9
1/4		4.6	395.2
£		4.5	395.3
1/4		4.5	395.3
Gutter		5.4	394.4
Topcb		4.68	395.14
S.		4.3	395.5
	Sec J		
S.		4.5	395.3
Topcb		4.73	395.09 ✓
Gutter		5.9	394.4
1/4		4.6	395.2
£		4.5	395.3
1/4		4.6	395.2
Gutter		4.9	394.9

	N	E
Top cb	9.48	395.34 ✓
2 parts		
Sec A		
N	5.3	394.5
cb	9.5	395.3
1/4	4.5	395.3
2	9.5	395.3
1/4	4.8	395.0
Gutter	5.6	394.2
Top cb	4.83	394.99
S.	4.5	395.3
	Sec B.	
S.	4.7	395.1
Top cb	5.01	394.81
Gutter	5.7	394.1
1/4	5.1	394.7
2	4.5	395.3
1/4	5.0	394.8
Gutter	5.2	394.6
Top cb	5.00	394.80
N	4.7	
This section in 8 parts 2304 on West Sec A		
N	4.8	395.0
Top cb	5.08	394.74
Gutter	5.7	394.1
1/4	5.1	394.7
2	5.0	394.8

	N	E
Top cb	5.2	394.6
Gutter	5.9	393.9
Top cb	5.08	394.74
S.	4.8	395.0
	Sec B	
S	9.7	395.1
Top cb	5.22	394.60 ✓
Gutter	5.8	394.0
1/4	5.3	394.5
2	5.1	394.7
1/4	5.2	394.6
Gutter	5.7	394.1
Top cb	5.11	394.71 ✓
N	4.9	394.9
	Sec C	
N	5.1	394.7
Top cb	5.37	394.45 ✓
Gutter	6.0	393.8
1/4	5.4	394.4
2	5.3	394.5
1/4	5.6	394.2
Gutter	6.0	393.8
Top cb	5.29	394.53 ✓
S	4.8	395.0
	Sec D	
VY	4.5	395.3

X
39982

21.47
E 9.46
Redness 4.64
1.00

E-Prop 5.01
Str. Return 4.88

39982

E 10-1

23

399.82

xVoy

+

399.82

Elev

29

Top cb	5.33	394.49 ✓
Gutter	6.1	393.7
1/4	5.7	394.1
1/4	5.3	394.5
1/4	5.6	394.2
Gutter	6.1	393.7
Top cb	5.97	394.35 ✓
E	5.9	394.4
Sec h		
E	5.3	394.5
Top cb	5.57	394.25 ✓
Gutter	5.9	393.9
1/4	5.6	394.2
1/4	5.3	394.5
1/4	5.7	394.1
Gutter	6.1	393.7
Top cb	5.51	394.31 ✓
N	4.9	
Sec E + 8		
W	4.8	395.0
Top cb	5.55	394.27 ✓
Gutter	6.2	393.6
1/4	5.7	394.1
1/4	5.3	394.5
1/4	5.6	394.2
Gutter	6.0	393.8

Top cb	5.46	394.36 ✓
E	5.4	394.4
Sec F		
E	5.3	394.5
Top cb	5.64	394.78 ✓
Gutter	6.2	393.6
1/4	5.6	394.2
1/4	5.3	394.5
1/4	5.8	394.0
Gutter	6.1	393.7
Top cb	5.57	394.25 ✓
N	4.9	394.9
TP 909	397.91	5.95 393.87
Sec G		
N	3.1	394.9
Top cb	3.68	394.23 ✓
Gutter	4.2	393.7
1/4	2.9	395.0
1/4	3.4	394.5
1/4	3.7	394.2
Gutter	4.5	393.4
Top cb	3.90	394.01 ✓
E	3.6	394.3
Sec H		
N line of Sydney		
E	3.9	394.0
Top cb	3.92	393.99 ✓

+

397.91

Red oak return

Elev

N. Line Sy 399-393.97

5 392-393.99

Gutter	4.3	393.6
1/4	3.6	394.3
1/2	2.9	395.5
3/4	3.9	394.0
Gutter	4.3	393.6
Topcb	3.80	394.11 ✓
W	2.1	395.8
Sec A 1/2 Sydney		
W	2.1	395.8
Topcb	3.95	393.96
Gutter	4.5	393.4
1/4	3.9	394.0
1/2	3.7	394.2
1/4	3.7	394.2
Cb	3.7	394.2
E	4.0	393.9
Sec B sim. Sydney ✓		
E	3.6	394.3
Topcb	4.00	393.91 ✓
Gutter	4.1	393.5
1/4	4.1	393.8
1/2	3.9	394.0
1/4	4.2	393.7
Gutter	4.6	393.3
Topcb	3.99	393.92 ✓
W	3.3	394.6

+

397.91

Elev

25

Sec A

This section is in parts
27.50 on East side
29.38 on West "

W	3.4	394.5
7.3	3.8	394.1
Topcb	4.13	393.78 ✓
Gutter	4.8	393.1
1/4	4.4	393.5
1/2	4.0	393.9
1/4	4.2	393.7
Gutter	4.7	393.2
Topcb	4.19	393.72 ✓
7.5	3.9	394.0
E	3.0	394.9
Sec B		
E	3.2	394.7
7.10	4.1	393.8
Topcb	4.49	393.49 ✓
Gutter	4.8	393.1
1/4	4.3	393.6
1/2	4.2	393.7
1/4	4.6	393.3
Gutter	5.0	392.9
Topcb	4.32	393.59 ✓
W	3.7	394.2
Sec C		
W	2.8	395.1
7.10	4.1	393.8

	+	397.91	-	Elev
Top cb		4.99		393.47 ✓
Gutter		5.0		392.9
1/4		4.7		393.2
♀		4.4		393.5
1/4		4.6		393.3
Gutter		5.2		392.7
Top cb		7.61		393.30 ✓
+15		4.3		393.6
E		3.2		394.7
	Sec D			
E		3.9		394.0
+5		4.4		393.5
Top cb		4.85		393.06 ✓
Gutter		5.3		392.6
1/4		4.9		393.0
♀		4.6		393.3
1/4		4.7		393.2
Gutter		5.1		392.8
Top cb		4.99		393.42 ✓
W		3.9		394.0
	Sec E			
W		3.9		394.0
Top cb		4.59		393.32 ✓
Gutter		5.2		392.7
1/4		4.8		393.1
♀		4.7		393.2

	+	397.91	-	Elev
1/4		5.1		392.9
Gutter		5.6		392.3
Top cb		5.02		392.89 ✓
E		4.6		393.3
	Sec F			
E		4.6		393.3
Top cb		5.18		392.73 ✓
Gutter		5.9		392.0
1/4		5.2		392.7
♀		4.8		393.1
1/4		4.9		393.0
Gutter		5.3		392.6
Top cb		4.70		393.21 ✓
+15		4.3		393.6
W		3.3		394.6
	Sec G			
W		2.9		395.1
+10		4.8		393.1
Top cb		4.87		393.04 ✓
Gutter		5.4		392.5
1/4		5.1		392.8
♀		5.1		392.9
1/4		5.6		392.3
Gutter		6.1		391.8
Top cb		5.91		392.50 ✓
E		4.3		393.6

397.91

Elev

Sec H

E	46	393.3
+4	53	392.6
Topcb	575	392.16 ✓
Gutter	63	391.6
1/4	57	392.2
2	52	392.7
1/4	52	392.7
+9	52	392.7
Gutter	35	392.4
Topcb	9.97	392.94 ✓
+15	47	393.2
W	33	394.6

Sec I

W	35	394.4
+10	46	393.3
Topcb	511	392.80 ✓
Gutter	57	392.2
+2	58	392.1
+4	53	392.6
1/4	59	392.0
2	55	392.4
1/4	59	392.0
Gutter	64	391.5
Topcb	586	391.03 ✓
+24	53	392.6

397.91

Elev

27

4.9

393.5

Sec J

E	47	393.2
+5	56	392.3
Topcb	601	391.90 ✓
Gutter	66	391.3
1/4	61	391.8
2	56	392.3
1/4	56	392.3
+7	55	392.4
Gutter	60	391.9
Topcb	521	392.70 ✓
W	42	393.7

Sec K

W	44	393.5
Topcb	540	392.51 ✓
Gutter	61	391.8
+5	57	392.9
1/4	57	392.2
2	58	392.1
1/4	62	391.7
Gutter	68	391.1
Topcb	631	391.60 ✓
+20	59	392.0
E	51	392.8

397.91

Elev

Sec L on curb radius N White Eugene

E	6.3	391.6
Top cb	6.96	391.45 ✓
Gutter	7.0	390.9
1/4	6.3	391.6
1/2	5.9	392.0
1/4	5.9	392.0
Gutter	6.2	391.7
Top cb	5.98	392.43 ✓
W	4.9	393.0

T.P. 991 396.78 6.04 391.87

This Section 4 parts
219 on W
252 on W
Sec A

E	5.7	391.1
cb	5.4	391.4
1/4	5.0	391.8
1/2	4.8	392.0
1/4	4.9	391.9
Gutter	5.1	391.7
Top cb	4.95	392.33 ✓
W	3.7	393.1

Sec B

W	3.8	393.0
Top cb	4.57	392.21 ✓
Gutter	5.3	391.5
1/4	5.0	391.8
1/2	5.0	391.8

+

396.78

Elev

28

1/4	5.2	391.6
cb	5.5	391.3
E	6.1	390.7

Sec B + SE on W Alley

E	4.6	390.9
+15	5.8	391.0
cb	5.5	391.3
5.2	5.2	391.6
5.1	5.1	391.7
5.0	5.0	391.8
Gutter	5.1	391.7
Top cb	4.95	392.33 ✓
W	3.7	393.1

Sec C

W	3.9	392.9
cb in alley	5.2	391.6
1/4	5.0	391.8
1/2	5.1	391.7
1/4	5.3	391.5
cb	5.9	391.0
+13	6.6	390.2
+2.9	6.92	390.36
E	6.3	390.5

Sec C 23 White of Alley

E	6.3	390.5
+3 Top cb	6.92	390.36

	+	X 396.78	-	Elev.
+ 19			6.5	390.3
cb			5.7	391.1
1/4			5.3	391.5
£			5.1	391.7
1/4			5.0	391.8
Gutter			5.3	391.8
Topcb			4.55	392.23
W			4.0	392.8
		Sec D P.R.C.		
W			4.0	392.8
Topcb			4.78	392.00 ✓
Gutter			5.5	391.3
1/4			5.1	391.7
£			5.2	391.6
1/4			5.4	391.4
cb			6.0	390.8
+ 10 Gutter			6.7	390.1
Topcb			6.30	390.48 ✓
E			6.0	390.8
		29.25 on East 29.87 on West		
		Sec A		This section 4 points ^{see} SKETCH
E			5.9	390.9
r.r. crossed curb of Eugene			6.16	390.62 ✓
+ 22			6.7	390.1
cb			6.6	390.2
1/4			5.7	391.1
£			5.0	391.6

	+	X 396.78	-	Elev.	29
1/4			5.3	391.5	
Gutter			5.5	391.3	
Topcb			4.78	392.00 ✓	
W			4.1	392.7	
		Sec A + r.r.		P.R.C. at curb on Skirt of Eugene	
Topcb			6.19	390.59	
		Sec B			
W			4.2	392.6	
Topcb			5.00	391.88 ✓	
Gutter			5.8	391.0	
1/4			5.3	391.5	
£			5.3	391.5	
1/4			5.7	391.1	
Gutter			6.5	390.3	
Topcb			6.09	390.69 ✓	
E			5.8	391.0	
		Sec C			
E			5.8	391.0	
Topcb			6.02	390.76 ✓	
Gutter			6.4	390.4	
1/4			5.9	390.9	
£			5.5	391.3	
1/4			5.9	391.4	
Gutter			5.7	391.1	
Topcb			5.08	391.70 ✓	
W			4.6	392.2	

396.78

Elev

Return 493
N. End 496

391.85
391.82

396.78

Elev

30

Sec D. on cb Roduc 35th M+View

Sec C ③

W	47	392.1
Top cb	516	391.62 ✓
Gutter	57	391.1
+2	51	391.7
1/4	59	391.4
2	59	391.4
1/4	56	391.2
Gutter	6.5	390.3
Top cb	5.87	390.91 ✓
E	54	391.4

E	51	391.7
Top cb	529	391.49 ✓
Gutter	6.0	390.8
+3	56	391.2
1/4	53	391.5
+9	51	391.7

Sec D ④

1/4 + 4	53	391.5
Gutter	57	391.1
Top cb	518	391.60 ✓
E	4.9	391.9

28.5 on Roof
This section read to
P. 17 intersection with E. line
at 25th

Sec A

This Section 10 par. B ①
Sec. 5K. 104

Sec K ⑤

E	55	391.3
Top cb	569	391.09 ✓
Gutter	6.1	390.7
1/4	54	391.4
2	49	391.9
1/4	50	391.8 ?
T 75 Inter. with Prop line at 25 th	50	391.8 ?

E	49	391.9
Top cb	515	391.63 ✓
Gutter	56	391.2
+6	52	391.6

Sec F ⑥

1/4 + 55	49	391.9
+ 8	49	391.9
Gutter	5.6	391.2
Top cb	503	391.75 ✓
E	4.6	392.2

Sec B ②

1/4 + 10 with section with 35 th	48	392.0
2	48	392.0
1/4	53	391.5
Gutter	6.3	390.5
Top cb	5.52	391.26 ✓
E	53	391.5

Sec G ⑦

E	44	392.4
Top cb	483	391.95 ✓
Gutter	53	391.5

+		N	-	Elev
		396.78		
+5			5.0	391.8
1/4	Pat Zn		4.8	392.0
		Sec H	④	
2+2			4.3	392.5
1/4			4.5	392.3
+11			4.8	392.0
Gutter			5.1	391.7
Topcb			4.66	392.12
E			4.3	392.5 ✓
TP	563	397.84	4.57	392.21
		Sec I	④	
W 1/4 PT			4.7	392.1
2			4.9	392.9
1/4			5.0	392.8
+5			5.2	392.6
Gutter			6.0	391.8
Topcb			5.52	392.32 ✓
E			5.4	392.4
		⑩ Sec J	cb Radius on West	PI of Pion - 73.0
E			5.2	392.6
Topcb			5.37	392.47 ✓
Gutter			5.9	391.9
1/4			5.0	392.8
2			4.5	393.3
1/4			4.7	393.1
Gutter			4.9	392.9

+		N	-	Elev
		397.84		
				Red & Return 9.90
				31
Topcb			4.36	393.48 ✓
W			4.4	393.4
		25.30 on East 30' on West		Sec A
				3. parts
W			3.8	394.0
+10			4.5	393.3
Topcb			4.49	393.35 ✓
Gutter			5.1	392.7
1/4			4.6	393.2
2			4.9	393.4
1/4			4.9	392.9
Gutter			5.7	392.1
Topcb			5.19	392.65 ✓
E			4.8	393.0
		Sec R		
E			4.1	393.7
+3			4.4	393.2
Topcb			5.07	392.77 ✓
Gutter			5.6	392.2
1/4			4.9	392.9
2			4.5	393.3
1/4			4.8	393.0
Gutter			5.3	392.5
Topcb			4.65	393.19 ✓
+15			4.6	393.2
W			3.3	394.5

39784
Sec C P.R.C

5/27

W	3.3	394.5
+10	4.4	393.4
Topcb	4.77	393.07 ✓
Gutter	5.3	392.5
1/4	4.8	393.0
♀	4.6	393.2
1/4	5.0	392.8
Gutter	5.5	392.5
Topcb	5.02	392.82 ✓
E	5.0	392.5

This section is parts
2453 on West
2620 on East

Sec A ①

E	5.0	392.8
+10	4.9	392.9
Topcb	5.08	392.76
Gutter	5.7	392.1
1/4	5.1	392.7
♀	4.7	393.1
1/4	5.0	392.8
Gutter	5.3	392.5
Topcb	4.80	393.04
+15	4.5	393.3
W	3.4	394.4

Sec B ②

W	3.8	394.0
+10	4.7	393.1
Topcb	4.93	392.91 ✓

39784

5/27

32

Gutter	5.5	392.3
1/4	5.0	392.8
♀	4.7	393.1
1/4	5.2	392.6
Gutter	5.8	392.0
Topcb	5.21	392.63 ✓
E	5.0	392.8

Sec C ③

E	5.0	392.8
Topcb	5.21	392.63
Gutter	5.7	392.1
1/4	5.2	392.6
♀	5.0	392.8
1/4	5.1	392.7
Gutter	5.5	392.3
Topcb auto drive way	5.96	392.38
+15	4.8	393.0
W	3.8	394.0

Sec D ④

W	3.7	394.1
+10	4.9	392.9
Topcb	5.09	392.75 ✓
Gutter	5.8	392.0
1/4	5.2	392.6
♀	4.9	392.9
1/4	5.1	392.7

+
T
39784

Elev

Gutter	57	392.1
Topcb	5.28	392.56 ✓
E	5.3	392.5
Sec E ⑤		
E	5.2	392.6
Topcb	5.33	392.51
Gutter	5.9	391.9
1/4	5.3	392.5
E	5.0	392.8
1/4	5.2	392.6
Gutter	5.8	392.0
Topcb	5.18	392.66
+15	4.9	392.9
W	3.7	394.1
TP	480	39735
5.29	392.55	

Sec F ⑥

W	3.3	394.0
+10	4.4	392.9
Topcb	4.76	392.59 ✓
Gutter	5.4	392.0
1/4	4.7	392.7
E	4.5	392.9
1/4	4.9	392.5
Gutter	5.2	392.2
Topcb	4.90	392.45 ✓
E	4.6	392.8

+
T
39629?
397.35
Sec C

Elev

33

W	4.7	392.7
Topcb	5.00	392.35
Gutter	5.9	392.0
1/4	5.0	392.4
E	4.7	392.7
1/4	4.7	392.7
Gutter	5.9	392.0
Topcb	4.85	392.50
+15	4.7	392.7
W	3.6	393.8

Sec H ⑧

W	3.5	393.9
+10	4.6	392.8
Topcb	4.92	392.43 ✓
Gutter	5.2	392.1
1/4	4.9	392.5
+9	4.6	392.8
E	4.7	392.7
1/4	5.1	392.3
Gutter	5.5	391.9
Topcb	5.09	392.26 ✓
E	4.9	392.5

Sec I ⑨

E	5.5	391.9
+10	5.0	392.4
Topcb in auto driveway	5.50	391.95

397.35

Elev

Gutter	5.5	391.9
1/4	5.2	392.2
E	4.8	392.6
1/4	4.9	392.5
Gutter	5.5	391.9
Topcb	5.02	392.33
+15	4.7	392.7
W	3.3	394.1

Sec J

	⑩	
	3.4	394.0
+10	4.8	392.6
Topcb	5.09	392.26
Gutter	5.9	391.5
1/4	4.8	392.6
E	4.8	392.6
1/4	5.3	392.1
Gutter	5.7	391.7
Topcb	5.23	392.12 ✓
+15	5.0	392.4
E	5.4	392.0

Sec K

	⑪	
E	5.3	392.1
+10	3.0	392.4
Topcb	5.32	392.05
Gutter	5.8	391.6
1/4	5.3	392.1

397.35

Elev

39

E	4.9	392.5
+5	4.8	392.6
1/4	5.0	392.4
Gutter	5.8	391.6
Topcb auto downray	5.62	391.73
+15	4.9	392.5
W	3.5	393.9

Sec L

	⑫	
W	3.5	393.9
+10	5.0	392.4
Topcb	5.26	392.09 ✓
Gutter	5.8	391.6
1/4	5.3	392.1
E	5.1	392.3
1/4	5.5	391.9
Gutter	5.8	391.6
Topcb	5.36	391.99 ✓
+15	5.1	392.3
E	5.4	392.0

Sec M

	⑬	
E	5.9	391.5
Topcb	5.42	391.93 ✓
Gutter	5.8	391.6
1/4	5.6	391.8
E	5.2	392.2
1/4	5.4	392.0

397.35

60

5.95

5.0

9.0

Sec M + 5 ~ N Line of Alley

9.1

5.1

5.49

5.9

5.4

5.2

5.6

6.0

5.44

5.9

Sec M + 5 ~ S Side alley

5.6

5.3

5.5

6.0

5.7

5.3

5.6

6.0

5.46

5.3

391.90

391.86

391.91

391.83

391.89

397.35

3.7

Sec N Left out (B)

Sec O (B)

3.8

5.4

5.57

6.0

5.7

5.3

5.7

6.0

5.57

5.6

Sec P (B)

6.0

5.6

5.77

6.3

5.8

5.3

5.7

6.3

5.62

5.4

4.4

391.78

391.78

391.58

391.73

35

Sec 9 + 5 (17+5)

W	3.6
+10	5.5
Top cb	5.75
Gutter	6.3
1/4	5.8
R	5.4
+5	5.4
1/4	5.7
Gutter	6.2
Top cb	5.77
+15	5.5
E	6.0
Sec R	Ⓟ
E	6.3
+10	5.7
Top cb	5.76
Gutter	6.4
1/4	5.9
R	5.6
1/4	5.8
Gutter	6.4
Top cb	5.78
+15	5.5
YV	4.0

391.57 ✓

391.57 ✓

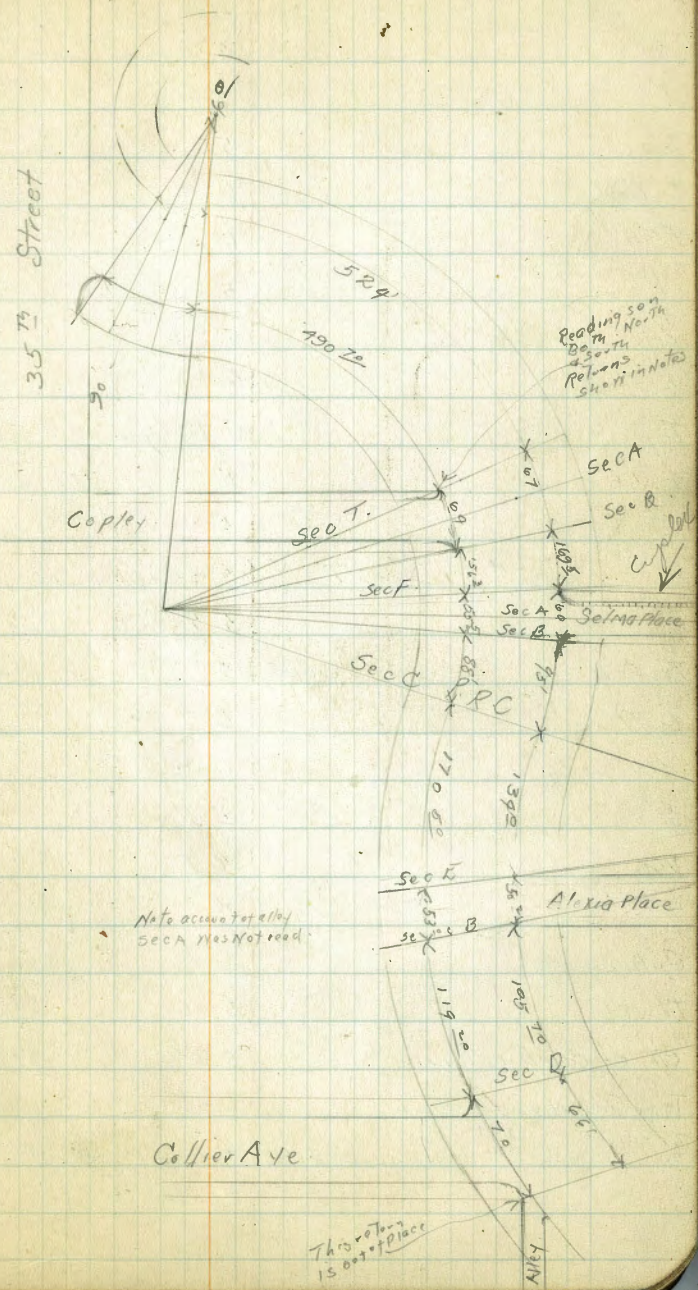

39735

Elev

Sec S

W 45
 +10 56
 Top cb 58.2
 Gutter 66
 1/4 60
 1/4 57
 1/4 59
 Gutter 64
 Top cb 59.9
 +15 59
 E 58

Sec T N. line of Copley

E 5.9
 Top cb 5.98
 Gutter 6.5
 1/4 6.2
 E 5.9
 1/4 6.0
 +11 6.1
 Gutter 6.7
 Top cb 5.96
 ctr of curb return 5.99

Top cb on W end of return 6.05
 1 P. on E. 4.55
 SW. ME 4110 + Mt. View Drive 395.63 6.27

391.39

391.36

391.30

391.08

391.15 Elev
391.08 Elev

39563

Elev

Sec A

2 parts

31.5 West side
33.5 East Side

37

W 4.4
 cb 4.20
 1/4 4.3
 1/4 4.2
 1/4 4.6
 Gutter 5.1
 Top cb 4.61
 E 4.5
 Reading on W. line Mt. View + Copley S. side 4.44
 ctr. cb return 4.49

Sec B

E 4.7
 Top cb 4.89
 Gutter 5.3
 1/4 4.9
 1/4 4.5
 1/4 4.5
 +11 4.6
 Gutter 5.1
 Top cb 4.56

391.43

391.02

391.19

391.14

390.74

391.07

Sec 0

This section 6 parts
26.05 on West
28.25 on East

W 4.1
 Top cb 4.74
 Gutter 5.3
 1/4 4.4

390.89

39563

Elev

℄	4.7	
1/4	5.0	
Gutter	5.6	
Top cb	5.19	390.49 ✓
E	4.9	

Sec B

E	5.1	
Top cb	5.32	390.31 ✓
Gutter	5.8	
1/4	5.3	
℄	5.0	
1/4	5.0	
Gutter	5.7	
Top cb	4.89	390.74 ✓
W	4.5	

Sec C

W	4.5	
Top cb	5.1	390.53 ✓
Gutter	5.9	
1/4	5.3	
℄	5.2	
1/4	5.5	
Gutter	6.0	
Top cb	5.50	390.13 ✓
E	5.0	

39563

Elev

38

Sec D

E	5.3	
Top cb	5.79	389.84 ✓
Gutter	6.1	
1/4	5.6	
℄	5.4	
1/4	5.9	
Gutter	5.8	
Top cb	5.26	390.37 ✓
W	4.6	

Sec E

W	4.5	
Top cb	5.90	390.23 ✓
Gutter	6.1	
1/4	5.5	
℄	5.5	
1/4	5.8	
Gutter	6.2	
Top cb	6.00	389.63 ✓
E	5.5	

Sec E + 6²⁵ N line of Alley on West

E	5.8	
Top cb	6.03	
Gutter	6.3	
1/4	5.9	
℄	5.7	
1/4	5.5	

+

39563

Elev

Gutter	5.9	
Topcb	5.9~	390.21
W	4.8	

Sec E + 19° 45' S line of alley ^{Return about 15'}

W	4.8	
Topcb	5.90	390.24
Gutter	5.9	
1/4	5.6	
E	5.5	
1/4	5.7	
+9	6.1	
Gutter	6.4	
Topcb	6.15	
E	5.9	

Sec F

E	5.8	
Topcb 6.25	6.25	389.38 ✓
Gutter	6.5	
+2	6.2	
1/4	5.7	
E	5.5	
+8	5.4	
1/4	5.6	
Gutter	6.0	
Topcb	5.50	390.13 ✓
W	5.9	

+

39563

Elev

39

Readings around return on the east
Side of Mt. View and the North line of Selma place

ctr. return	6.30	
E Prop	6.27	389.36 ✓
Gutter	7.09	
+2.5 s. edge	6.68	

Sec A

W	5.0	2. parts 30' on East 27.75 on West
Topcb	5.99	
Gutter	6.2	
1/4	5.6	
E	5.4	
1/4	5.6	
cb	5.8	
E	6.5	

Readings on South Return <sup>E line of Mt. View
and the South line of Selma</sup>

E Prop Top cb	6.31	
R.C.	6.28	
ctr. return	6.31	389.32

Sec B

E	6.1	
Top cb	6.19	389.44 ✓
Gutter	6.4	
1/4	5.8	
E	5.3	
+3	5.2	
1/4	5.0	

395.63

Eye

F. 9.6

Gutter	6.1	
Topcb	5.40	390.23 ✓
W	4.8	
	This section 3 parts 29.20 on West 31.46 on East	
	Sec A	
W	4.7	
Topcb	5.38	390.25 ✓
Gutter	6.2	
1/4	5.5	
£	5.2	
1/4	5.7	
Gutter	6.4	
Topcb	5.92	389.71 ✓
E	5.6	
	Sec B	
E	5.5	
Topcb	5.61	390.02 ✓
Gutter	5.9	
+2	5.5	
1/4	5.3	
£	5.0	
1/4	5.3	
Gutter	5.7	
Topcb	5.20	390.43 ✓
W	4.3	

395.63

Eye

40

Sec C P.R.C

W	4.1	
Topcb	4.97	390.66 ✓
Gutter	5.6	
+10	4.9	
1/4	4.9	
£	4.8	
+7	4.7	
1/4	5.1	
+10	5.7	
Gutter	5.9	
Topcb	5.23	390.40 ✓
E	4.8	
	Sec A	This section 5 parts 24.10 on East 27.90 on West
E	4.5	
Topcb	5.04	390.64 ✓
Gutter	5.5	
1/4	5.0	
£	4.8	
1/4	4.9	
Gutter	5.6	
Topcb	4.92	390.71 ✓
T15	4.6	
W	3.9	
	Sec B	
W	3.3	

395.63

Elev

+10	4.9	
Topcb	4.79	390.84 ✓
Gutter	5.5	
1/4	4.9	
2	4.7	
1/4	4.7	
Gutter	5.3	
Topcb	4.86	390.77 ✓
E	4.6	

Sec C

E	4.3	
	4.72	390.91 ✓
Gutter	5.3	
1/4	4.6	
2	4.6	
1/4	4.9	
+7	5.0	
Gutter	5.2	
Topcb	4.68	390.95 ✓
+15	4.2	
W	3.2	
TP	4.63	395.75
	4.51	391.12

Sec D

W	3.3	
+10	4.4	
Topcb	4.70	391.05 ✓

395.75

91

Gutter	5.3	
1/4	4.8	
2	4.5	
1/4	4.7	
Gutter	5.2	
Topcb	4.61	391.14 ✓
E	4.2	

Sec E N. line of Alexia Place

E	4.1	
Topcb	4.33	391.42 ✓
Gutter	4.7	
1/4	4.5	
2	4.3	
1/4	4.6	
Gutter	5.2	
Topcb	4.63	391.12 ✓
W +15	4.4	
W	3.3	

Readings around return East side of
N. line of Alexia Place

at return	4.27	391.48 ✓
on road	4.3	
on Prop	4.91	391.34 ✓

+ 195 N. line of Alley

W	3.7	
Topcb	4.65	391.10
Gutter	4.9	

395.75

2 Nats Section A Log 10 J T
Divided this section into 2 parts
26.1 on East
26.50 on West

1/4	4.9
£	4.0
1/4	4.1
cb	4.2
E	4.8
+35 ² #5 Line of Alley	
E	5.0
cb.	4.2
1/4	4.2
£	4.1
1/4	4.5
Gutter	4.9
Top cb	4.44
+15 on end of cb	4.05
W	3.1

Top. of cb Readings ground Return on line Alexis

E. Prop 1	4.46	391.29 ✓
end of Radius	4.42	391.33 ✓
ctr. Return	4.45	391.30 ✓

Sec B.

W	2.5
+10	4.1
Top cb	4.26
Gutter	5.0
1/4	4.4
£	4.2

395.75

Elev

1/4	4.3
Gutter	4.9
Top cb	4.40
Sec A - Sof. Alexis	
E	4.2
Top cb.	4.44
Gutter	4.9
1/4	4.5
£	4.1
1/4	4.3
Gutter	4.7
Top cb	4.25
+15	3.8
W	2.6
Sec B.	
W	2.2
+10	3.7
Top cb	4.17
Gutter	4.9
1/4	4.3
£	4.2
1/4	4.4
Gutter	4.9
Top cb	4.50
+15	4.2
E	3.4

391.35 ✓
4 parts
26.40 on East
29.80 on West

391.31 ✓

391.50 ✓

391.58 ✓

391.25 ✓

+

395.75

Elev

Sec C

K	3.7	
+10	4.3	
Top cb	4.51	391.24 ✓
Gutter	5.0	
1/4	4.4	
1/4	4.1	
1/4	4.2	
Gutter	4.5	
Top cb	4.02	391.73 ✓
+15	3.6	
W	2.4	

Sec D. end of cb return on N line of Collier Ave.

Top of cb	3.88	391.87 ✓
Gutter	4.3	
1/4	4.1	
1/4	4.0	
1/4	4.6	
Gutter	5.2	
Top cb	4.59	391.16 ✓
K	4.0	

Reading s around Cb. Return on N line of Collier

ctr	3.79	391.96
W. end of Return	3.77	391.78
on W Prop. Mt View Drive	3.75	392.00 ✓

+

395.75

Elev

Sect. 2 Collier

This section cuts
33' on East
35' on West

43

K	3.9
Top cb	4.72
Gutter	5.0
1/4	4.6
1/4	3.9
1/4	3.9
cb	3.9
W	3.8

Cb. Readings around Return on S Side Collier

on West Prop	4.33	391.42 ✓
cb radius	4.35	391.10
ctr	4.47	391.28

Sec B. S line of Collier

W	3.5	
T 3	4.0	
+185 ^{1/4 cb}	4.93	391.32 ✓
Gutter	4.6	
cb	5.1	
1/4	4.9	
1/4	4.3	
1/4	4.7	
Gutter	5.3	
Top cb	4.75	391.00 ✓
T 10	4.3	
K	3.5	
BM SW Collier Mt View Drive	4.93	391.3 ✓
		391.27 BM

395.75

4100

193
45-90

+18±

S. side of alley return on cb	9.72	
Sec A S. of Collier		This Section 2 parts 232 on East 288 on West
To E	3.9	
G + 10	4.5	
Top of cb	4.82	390.93 ✓
Gutter	5.3	
1/4	9.6	
G 2	4.4	
1/4	9.7	
Gutter	5.4	
Top cb	4.85	390.90 ✓
+6 crosses Alley rd	4.63	
W	4.1	
Sec B N. line of Collier		
N	4.4	
Top cb	4.85	390.90 ✓
Gutter	5.4	
1/4	4.9	
G 2	4.5	
1/4	4.7	
Gutter	5.1	
Top cb	4.79	390.96 ✓
N + 15	4.5	
of	3.7	

395.75

4100

44

Reading around return N. Side Collier
E. line of Mt View Drive

of Return	4.78	390.97 ✓
end cb. Radius	4.76	390.99 ✓
Concrete Gutter	5.60	390.15
cb + 2.5 s. edge	5.23	390.52
Top cb on Prop.	4.98	390.77 ✓
Gutter	5.84	389.91
+ 2.5 s. edge Gutter	5.90	390.35
Sec A		This Section 3 parts 29.18 on West 26.50 on East Collier
E	5.5	
cb	4.7	
1/4	4.7	
2	4.7	
1/4	4.9	
Gutter	5.4	
Top cb	4.72	391.03 ✓
W	4.3	
Sec B		
W	4.2	
Top cb	4.62	391.13 ✓
Gutter	5.3	
1/4	5.0	
2	4.8	
1/4	4.6	
cb	4.4	
E	5.5	

+	395.75	-	Elev
Readings around Return			
E Prop Top cb	5.82		Skine of Collier. E. Skine of Mt. Veer N 389.93 ✓
Gutter concrete	6.61		
+2.5 S. Side	6.29		
eb. end of Radius	5.61		390.14 ✓
ctr Return	5.50		390.25

Sec C of cb Radius & Collier

Top cb	5.37		390.38 ✓
Gutter	5.7		
1/4	5.0		
E	9.9		
1/4	5.1		
Gutter	5.6		
Top cb	4.87		390.88 ✓
+2.0	4.5		
W	3.7		

Sec A

2 parts 30.25 on East
32.75 on West

W	4.0		
+10	4.6		
Top cb	5.00		390.75 ✓
Gutter	5.7		
1/4	5.2		
E	5.1		
+6	5.1		
1/4	5.7		
Gutter	6.2		
Top cb	5.72		390.03 ✓

+	395.75	-	Elev
E	5.2		

Sec B, Whine 36th St

E	5.6		
Top cb	6.19		389.56 ✓
Gutter	6.7		
1/4	5.9		
+10	5.1		
E	5.1		
1/4	5.5		
Gutter	5.7		
Top cb	5.09		390.66 ✓
W	9.9		

Readings around Return on West line 36th S. line of Mt Veer

ctr	5.22		390.53
end of radius	5.22		390.53 ✓
Prop	5.27		390.48 ✓

Sec A

3 parts 29.5 on South
21.7 on North

S	5.2		
+9 Crosses	5.25		
+4.1	5.5		
cb	5.5		
1/4	5.4		
E	5.6		
1/4	6.9		
Gutter	7.0		
Top cb	6.98		389.27 ✓

+ T - Eley
395.75

T 20	6.2	
N	5.8	
Sec B P.C.C		
N	6.2	
Topcb	6.81	388.94 ✓
Gutter	7.4	
1/4	6.7	
2	6.0	
1/4	5.8	
cb	5.7	
S	5.6	

Sec C, on cb Radius		
S	6.5	
125	6.05	
Topcb	5.99	389.76 ✓
Gutter	6.4	
1/4	6.2	
2	6.3	
1/4	6.8	
Gutter	7.7	
Topcb	7.19	388.56 ✓
N	6.7	

Readings Around Return, E side of		
S. Prop.	6.03	389.72 ✓
cb Radius	5.98	389.77
otr Return	5.88	389.87 ✓

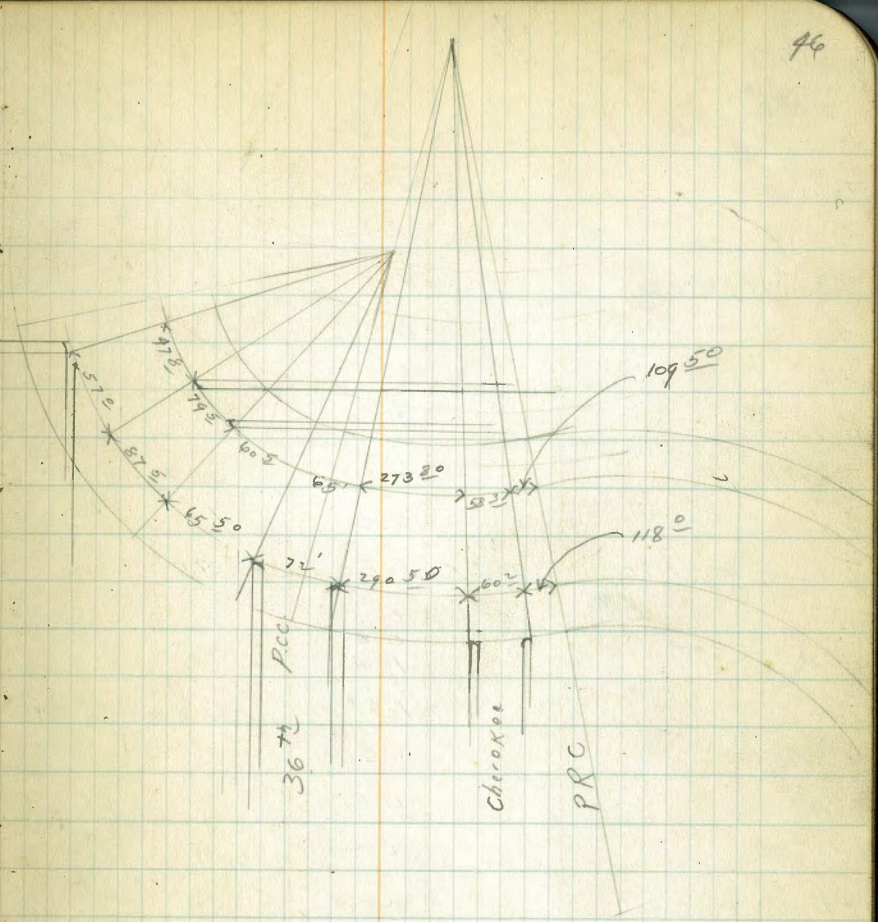

395.75
Sec 0 A East 36th

Elev
st
This section 11 points
2489 on North
2637 on South

N		6.9	
Top cb		7.62	388.13 ✓
Gutter		8.1	
1/4		7.3	
¢		6.8	
1/4		6.8	
Gutter		7.1	
Top cb		6.35	389.40 ✓
S		6.0	
T.P	170	390.65	6.80 388.95
		Sec 0 B	
29		0.9	
		1.4	
Top cb		1.81	388.84 ✓
Gutter		2.6	
1/4		2.1	
¢		2.2	
+10.5		2.2	
1/4		2.4	
Gutter		3.4	
Top cb		2.89	387.81 ✓
N		2.5	
		Sec 0 C	
N		3.1	
Top cb		3.36	387.29 ✓
Gutter		3.9	
1/4		2.8	

390.65

Elev

47

¢		2.7	
1/4		2.6	
Gutter		3.3	
Top cb		2.38	388.27 ✓
+15		2.0	
S		1.8	
		Sec 0 A	
S		1.7	
7.10		2.9	
Top cb		2.79	387.86 ✓
Gutter		3.6	
+16		3.1	
1/4		3.1	
¢		3.1	
1/4		3.5	
Gutter		4.3	
Top cb		3.87	386.78 ✓
N		3.7	
		Sec 0 B	
		4.0	
Top cb		4.31	386.34 ✓
Gutter		4.7	
1/4		3.7	
¢		3.7	
1/4		3.7	
+3		3.7	

	+	π	-	Elev
		390.65		6.3
Gutter		9.2		
Top cb		3.38	387.27	
+15		3.1		
S		2.1		
	Sec E + g	West Line Alley		
		2.4		
+10		3.2		
Top cb		3.57	387.08	
Gutter		4.4		
1/4		3.8		
ϕ		3.8		
1/4		3.9		
Gutter		4.8		
Top cb		4.44	386.21	
N		4.0		
	Sec F	East Line Alley		
N		4.2		
Top cb		4.68	385.97	
Gutter		5.3		
1/4		4.0		
ϕ		4.2		
1/4		4.2		
Gutter		4.4		
Top cb alley return		4.06	386.59	
+16		3.7		
S		3.4		

	+	π	-	Elev
		390.65		48
		Sec G		
S		3.6		
Top cb		4.49	386.16	
Gutter		5.1		
1/4		4.6		
ϕ		4.6		
4 1/2		4.7		
1/4		4.8		
Gutter		5.6		
Top cb		5.14	385.51	
N		4.9		
	Sec G			
N		5.3		
Top cb		5.55	385.10	
Gutter		6.2		
1/4		5.5		
+3		5.2		
ϕ		5.2		
1/4		5.2		
Gutter		5.8		
Top cb		5.03	385.62	
+15		4.8		
S		3.9		
	Sec H			
S		4.3		
+10		5.3		
Top cb		5.64	385.01	

390.65

Elev

Gutter 6.3

1/4 5.7

2 5.6

+9 5.5

1/4 5.8

Gutter 6.6

Top cb 6.06 384.59 ✓

N 5.6

Sec I. ⑩

N 6.2

Top cb 4.98 384.17 ✓

Gutter 6.9

1/4 6.3

2 6.1

1/4 6.2

+3 6.3

Gutter 6.6

Top cb 6.17 384.48 ✓

+15 5.8

S 4.7

Sec II. White Cherokee

S 5.6

+10 6.2

Top cb 6.60 384.05 ✓

Gutter 7.1

1/4 6.5

+

390.65

Elev

49

2 6.3

1/4 6.7

Gutter 7.5

Top cb 6.88 ✓ 383.77 ✓

N 6.7

Readings around return White Cherokee

ct. Return 6.73 383.9 ✓

end of cb. Radius 6.77 383.88 ✓

Prop line 6.80 383.85 ✓

T.P. 0.69 384.74 6.60 384.05

Sec A. 2

This section 2 parts
31.0 on South
29.25 on North

S 0.9

cb 0.6

1/4 0.5

2 0.9

1/4 1.5

Gutter 2.1

Top cb 1.50 383.24

N 1.3

Readings around Return E. Side Cherokee

S Prop 1.13 383.61 ✓

cb. Radius 1.20 383.57 ✓

ct. return 1.29

Sec B. E Prop Cherokee

N 2.1

Top cb 2.09 382.65 ✓

+

389.79

-

E/W

Gutter	2.8	
1/4	2.2	
1/4	1.6	
1/4	1.5	
+ 4	1.5	
+ 6	1.8	
+ 9.5 N edge concrete Gutter	1.63	383.11 ✓
Gutter	2.17	382.57 ✓
Top cb	1.23	383.51 ✓
S	1.00	

Sec A

This section 4 parts
27.37 on North
19.50 on South

S	0.7	
+ 5	1.8	
Top cb	1.04	382.70 ✓
Gutter	2.82	381.92 ✓
+ 3	2.59	382.20 ✓
1/4	2.4	
1/4	2.5	
1/4	3.0	
Gutter	3.4	
Top cb	3.06	381.68 ✓
N	3.0	

Sec B

N	3.8	
Top cb	3.96	380.78 ✓
Gutter	4.5	

+

389.79

-

E/W

50

1/4	3.9	
1/4	3.5	
1/4	3.5	
+ 9.5 edge gutter	3.81	380.93 ✓
Gutter	9.00	380.74 ✓
Top cb	3.29	381.45 ✓
+ 15	3.0	
+ 21	1.3	
S	0.9	

Sec C

S	1.5	
+ 5	2.0	
+ 10	4.2	
Top cb	4.51	380.23 ✓
Gutter	4.27	380.47 ✓
+ 3	4.97	379.77 ✓
1/4	4.7	
1/4	4.6	
1/4	4.8	
Gutter	5.6	
Top cb	4.87	379.87 ✓
N	4.4	

Sec D

N	5.5	
Top cb	5.85	378.89 ✓
Gutter	6.3	

	T	T	Elev
		384.79	
1/4		5.9	
E		5.6	
1/4		5.6	
+9.5 edge gutter		6.18	378.56 ✓
Gutter		6.47	378.27 ✓
Top cb.		5.68	379.06 ✓
+15		5.4	
+23		3.0	
S.		3.0	
		Sec D. +23.	
S.		4.5	
+10		6.5	6.33 Top cb.
Top cb.		6.57	378.17 ✓
Gutter		7.40	377.34 ✓
+3.0 edge gutter.		7.10	377.64 ✓
1/4		6.6	
E		6.5	
1/4		6.7	
Gutter		7.1	
top cb.		6.80	377.94 ✓
N.		6.4	
		This section 6 parts 25.00 on N 27.00 on S.	
		Sec A. +14 E line of Alley	
N		6.8	
TopCb		7.52	377.22 ✓
Gutter		8.0	
1/4		7.5	

	T	T	Elev
		384.79	
E		7.1	
1/4		7.2	
+9.5 edge gutter		7.63	377.11 ✓
Gutter		7.98	376.76 ✓
Top cb.		7.18	377.56 ✓
+2 gutter runs back		7.74	377.00 ✓
+15		6.8	
S.		6.0	
		Sec B	
S.		7.0	
TopCb		7.61	377.13 ✓
Gutter		8.94	376.30 ✓
+3		8.11	376.63 ✓
1/4		7.6	
E		7.7	
1/4		8.0	
Gutter		8.9	
TopCb		7.98	376.76 ✓
N		7.6	
T.P	2.37	378.45	8.66 376.08
		Sec C.	
N		2.9	
TopCb		2.83	375.64 ✓
Gutter		3.5	
1/4		2.8	
E		2.9	

378.95

1/4	2.9	
+9.5 edge gutter	2.75	375.170 ✓
Gutter	3.05	375.10 ✓
Topcb	2.23	376.22 ✓
S	1.6	
Sec D		
S	1.5	
+10	2.9	
+14	3.0	
Topcb. Drive way	3.99	374.16 ✓
Gutter	3.99	374.16 ✓
+3	3.69	374.76 ✓
1/4	3.5	
1/4	3.4	
1/4	3.8	
Gutter	4.6	
Topcb	3.81	374.64 ✓
N	3.7	
Sec E		
N	4.6	
Topcb	9.86	373.59 ✓
Gutter	5.4	
1/4	4.7	
1/4	4.3	
1/4	4.5	
+9.5 edge con gutter	9.64	373.81

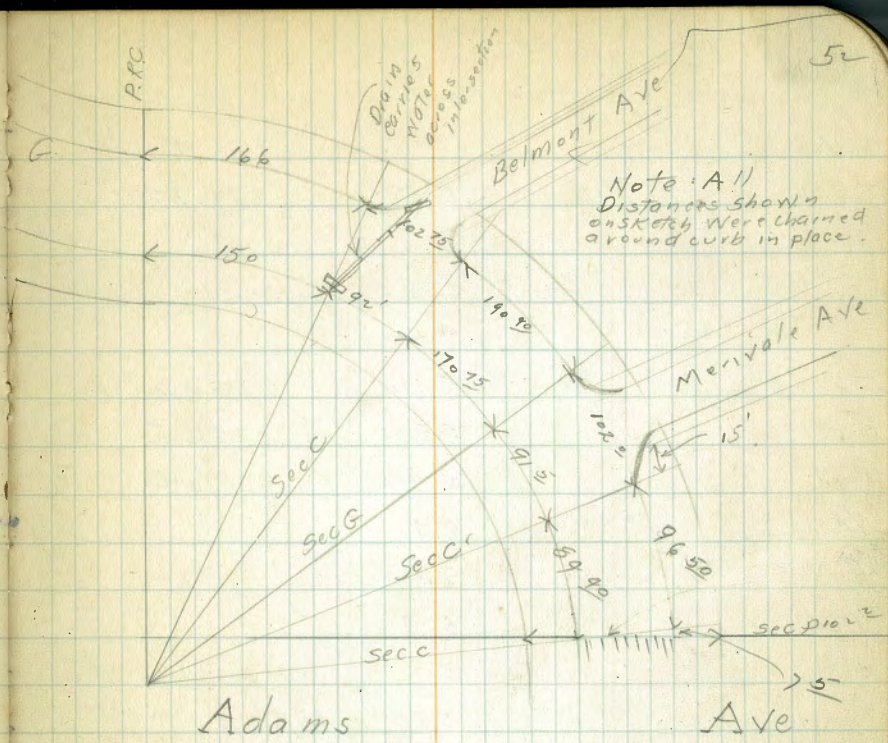

378.45 Elev 60' Pipe 1.1

Section E

Gutter	9.97	373.48 ✓
Top cb	9.13	374.32 ✓
S.	3.7	
20' North	Sec F	Curb P.R. Co. North
S	9.5	
Top cb	5.02	373.43 ✓
Gutter	5.80	372.65 ✓
+3	5.93	373.02 ✓
1/4	5.4	
2	9.9	
1/4	5.9	
Gutter	5.2	
Top cb	5.80	372.65 ✓
N	5.3	

Readings on Return Nline Belmont ^{53'}

2	6.28	372.17 ✓
Iron Prop	6.85	371.60 ✓
Edge of gutter	7.41	371.21 ✓
3	7.10	
Flow line of Pipe End	7.73	
Flow line of Pipe Wlead	6.70	371.75
Top cb at Break	5.54	372.91

378.45 Elev This section 39.25 on North 53 30.66 on South

Sec A

S	6.7	
+4.5	6.6	
+5	7.6	
+10	7.8	
+11	6.41	372.04
cb	5.9	
1/4	5.2	
2	5.2	
1/4	5.3	
+8	5.3	
Gutter	6.0	
Top cb	5.98	372.97 ✓
+15	4.8	
S.	3.9	

Sec B.

S	4.5	
+10	4.8	
Top cb	5.33	373.12 ✓
Gutter	6.0	
1/4	5.4	
2	5.3	
1/4	5.6	
cb	6.0	
+20	6.6	
Top cb	5.85	372.60
2	5.8	

Readings around Return S. Side Belmont

ctz on s Prop Belmont	5.82	372.63	
E Prop	5.91	372.54 ✓	
31' 500	Sec. C	at P.R.C. of cb Radius	
E	5.5		
Top cb	5.98	373.0	372.97 ✓
Gutter	6.0		
1/4	5.4		
E	4.9		
1/4	5.2		
Gutter	5.6		
Top cb	4.96	373.49 ✓	
+15	4.7		
W	3.8		
T.P.	5.17	378.71	4.91 373.54
	Sec A	This section 7 parts 29.3905 27.20.04 N	
W	4.2		
+10	4.8		
Top cb	5.23	373.48 ✓	
Gutter	5.8		
E 1/4	5.4		
E	5.0		
1/4	5.4		
Gutter	6.0		
Top cb	5.45	373.26 ✓	
E	5.3		

Sec B

E	5.2		
Top cb	5.16	373.58 ✓	
Gutter	5.8		
1/4	5.1		
E	4.8		
1/4	5.1		
Gutter	5.6		
Top cb	5.06	373.65 ✓	
W	4.1		

Sec C

W	4.2		
Top cb	4.80	373.91 ✓	
Gutter	5.5		
1/4	4.9		
E	4.5		
1/4	5.0		
Gutter	5.4		
Top cb	4.82	373.89 ✓	
E	4.5		

Sec D

E	4.1		
Top cb	4.55	374.16 ✓	
	5.2		
Gutter	4.6		
E	4.2		
1/4	4.5		

	+	⊗	-	Elev
		378.71		
Gutter			5.2	
Topcb			4.65	374.06 ✓
W			4.0	
		Sec E		
W			3.4	
+10			4.1	
Topcb			4.40	374.31 ✓
Gutter			5.1	
1/4			4.4	
♀			4.0	
1/4			4.3	
Gutter			4.9	
Topcb			4.46	374.25 ✓
E			4.0	
		Sec F		
E			3.6	
Topcb			3.92	374.79 ✓
Gutter			4.5	
1/4			4.0	
♀			3.8	
1/4			4.2	
Gutter			5.0	
Topcb			4.28	374.43 ✓
+15			3.9	
W			3.4	

	+	⊗	-	Elev
		378.71		7-1 Topcb 3.72
				55
		Sec G		
W			3.3	
+10			3.8	
Topcb			4.11	374.60 ✓
Gutter			4.9	
1/4			4.1	
♀			3.5	
1/4			3.7	
Gutter			4.4	
Topcb			3.78	374.93 ✓
E			3.2	
		Readings around Curb return N. line of 33' North Prop F.K.C.		
		Menivale Ave.		
E Prop			3.77	374.94 ✓
At end			3.96	374.75 ✓
Dr Return			3.81	374.90 ✓
		Sec G 247 N. line Alley on South side		
E			3.6	
+11 across curb			3.83	374.86
cb			3.7	
1/4			3.4	
♀			3.5	
1/4			3.8	
Gutter			4.5	
Topcb			3.99	374.72 ✓
+15			3.7	

	+	T	-	3.62 Elev	040/100 7.1
GW		2.8			39'0" on East
T		This sec. 3 Parts			30'5" " West
		Sec A	+11.4	Side of alley	
W		2.9			
+10		3.6			
Top cb		3.80		374.91	
Gutter		4.3			
1/4		3.6			
¢		3.3			
1/4		3.3			
cb		3.3			
+15		3.3			
E		3.5			
		Readings around Return			
S. Side Merivale					
E Prop		3.62		375.09 ✓	
ctr return		3.52		375.19 ✓	
		Sec B.			
E		3.5			
+6? Crosses curb		3.57		375.14	
cb		3.3			
1/4		3.2			
¢		3.2			
1/4		3.5			
Gutter		4.3			
Top cb		3.69		375.07 ✓	
+15		3.9			

	+	T	-	Elev	56
				378.71	
W		2.5			
T		15' 50" Prop Merivale			
		Sec C	P.R.C. of Return S. of Merivale		
W		1.9			
+33		3.3			
Top cb		4.46		379.92	
Gutter		4.65		375.46	
1/4		5.3			
¢		4.7			
1/4		4.3			
Gutter		4.6			
Top cb		5.3			
E		4.59		375.33 ✓	
		4.3			
		Sec A This section 3 parts 26.13 on West 32.16 on East			
E		4.3			
Top cb		4.73		375.19 ✓	
Gutter		5.3			
1/4		4.6			
¢		4.4			
1/4		4.5			
Gutter		5.1			
Top cb		4.48		375.94 ✓	
+15		4.4			
W		3.3			
		Sec B.			
W		4.0			

+ π 379.92 - Elev

Top cb	4.29	375.63 ✓
Gutter	4.9	
1/4	4.6	
2	4.4	
1/4	4.7	
Gutter	5.5	
Top cb	4.89	375.03 ✓
E	4.4	

Sec C.

E	4.5	
Top cb	5.05	374.87 ✓
Gutter	5.4	
1/4	4.9	
2	4.4	
1/4	4.3	
Gutter on Paving	4.30	375.62 ✓
Top cb	4.07	375.85 ✓
W	3.6	

Sec D. 102

W on Paving	3.5	
Top cb	4.07	375.85
Gutter	4.30	375.62
1/4	4.39	375.53
2	4.61	375.31
1/4	4.96	374.96
Gutter	5.55	374.37 ✓

Top cb	5.04	374.88
E	4.8	
BM S.E. 39 th + Adams	9.09	370.83 ✓
		370.87

Bl. 100
 300 ft
 Morgan
 11/12/27
 to Mt View
 B.M.S.W.
 Copley + Mt View
 600 397.15
 elev 391.15
 60 ft
 width
 9.95
 see sketch

S.	5.3	391.9
Topcb	5.70	391.45
Gutter	6.6	390.6
1/4	5.8	391.4
1/2	5.6	391.6
3/4	5.7	391.5
Gutter	6.1	391.1
Topcb	5.59	391.56
+10.5	5.3	391.9
N	5.2	392.0
50' West		
N	4.9	392.8
+1.5	9.8	392.4
Topcb	5.06	392.09
Gutter	5.8	391.4
1/4	5.2	392.0
1/2	5.0	392.2
3/4	5.4	391.8
Gutter	5.9	391.3
Topcb	5.42	391.73
+10.5	4.9	392.3
S	4.2	393.0
100' West		
S	3.9	394.3

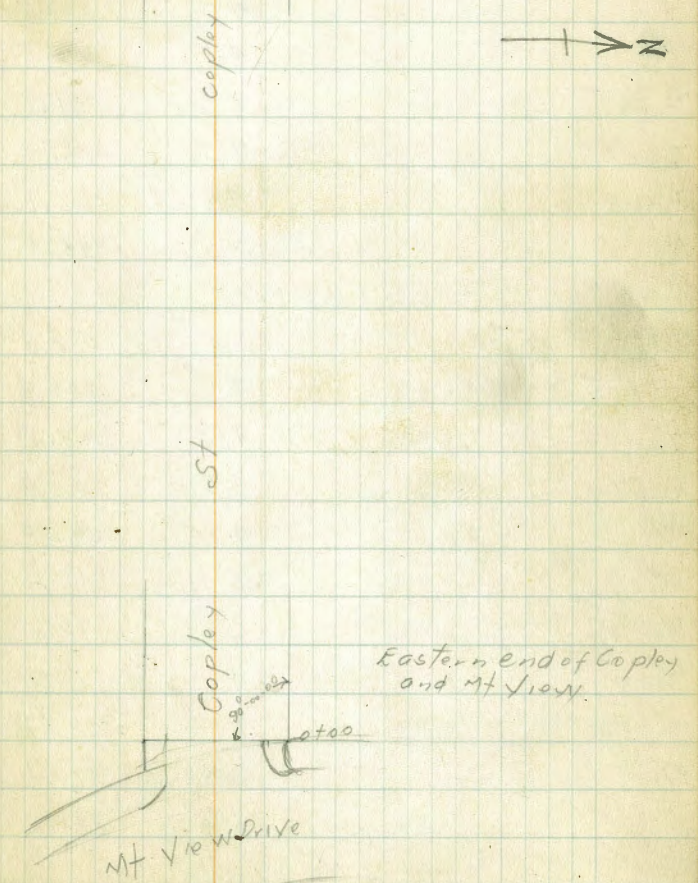
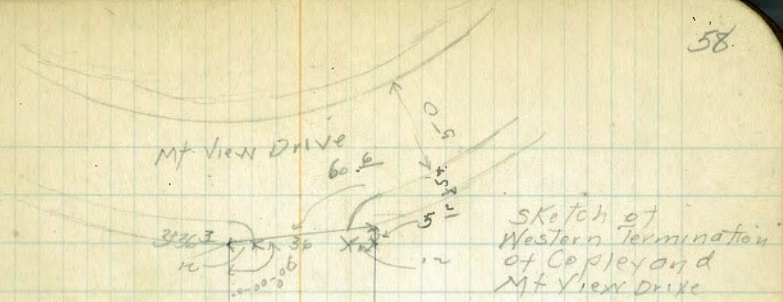

2008
 52

	+	X	-	Elev
		397.15		
+1.5			4.4	392.8
Topcb			4.70	392.45
Gutter			5.4	391.8
1/4			4.8	392.4
1/4			4.5	392.7
1/4			4.7	392.5
Gutter			5.3	391.9
Topcb			4.58	392.57
+10.5			4.3	392.9
N			3.9	393.3
		150' West		
N			3.4	393.8
+1.5			3.8	393.4
Topcb			4.08	393.07
Gutter			4.8	392.4
1/4			4.2	393.0
1/4			3.9	393.3
1/4			4.2	393.0
Gutter			4.9	392.3
Topcb			4.18	392.97
+10.5			3.6	393.4
S			3.6	393.6
		2.00 West		
S			3.0	394.2
+1.5			3.4	393.8
Topcb	Guto Driveway		4.29	392.86

	+	X	-	Elev
		397.15		
			4.4	392.8
1/4			3.8	393.4
1/4			3.5	393.7
1/4			3.6	393.6
Gutter			4.2	393.0
Topcb			3.59	393.56
+10.5			3.2	394.0
N			3.0	394.2
		250' West		
N			2.5	394.7
+1.5			2.8	394.4
Topcb			3.11	394.04
Gutter			3.5	393.7
1/4			3.3	393.9
1/4			3.1	394.1
1/4			3.3	393.9
Gutter			3.8	393.4
Topcb			3.4	393.81
+10.5			2.9	394.3
S			2.9	394.8
		300' West		
S			2.2	395.0
+1.5			2.9	394.7
Topcb			2.68	394.47
Gutter			3.1	394.1
1/4			2.9	394.3

	+	-	Elev
	397.15		
♀		2.6	394.6
1/4		2.8	394.4
Gutter		3.3	394.9
Top cb		2.61	394.54
+10.6		2.5	394.7
N		1.9	395.3
	393.6	5' West	
N		1.7	395.5
1.5		2.1	395.1
Top cb		2.36	394.79
Gutter		2.9	394.3
1/4		2.6	394.6
♀		2.4	394.8
1/4		2.5	394.7
Gutter		2.7	394.5
Top cb		2.91	394.74
S +10.5		2.2	395.8
S		1.7	395.5
	396.5	West: E line of 35 th	
S on Paring		1.9	395.3
Top cb		2.26	394.89
Gutter		2.60	395.55
1/4		2.29	394.86
♀		2.25	394.90
1/4		2.34	394.81
Gutter		2.57	394.58

	+	-	Elev
	397.15		60
Top cb		2.21	394.94
N		1.9	395.3
T.P	5.19	400.01	2.33 394.85
		W line of 35 th = 00	
N on Paring		5.9	394.6
Top cb		5.94	394.07
Gutter		6.30	393.71
1/4		5.88	394.13
♀		5.81	394.20
1/4		6.05	393.96
Gutter		6.33	393.68
Top cb		5.92	394.09
+10.5		5.6	394.4
S		5.4	394.6
		14' West	
S		5.1	394.9
+1.5		5.5	394.5
Top cb		5.88	394.13
Gutter		6.5	393.5
1/4		6.0	394.0
♀		5.9	394.1
1/4		5.9	394.1
Gutter		6.4	393.6
Top cb		5.93	394.08
+10.5		5.7	394.3
N		5.2	394.8

35' West

N	5.2	394.8
+1.5	5.7	394.3
Topcb	5.81	394.20
Gutter	6.6	393.4
1/4	6.0	394.0
2	6.0	394.0
1/4	6.2	393.8
Gutter	6.5	393.5
Topcb	5.89	394.17
+10.5	5.6	394.4
S	5.2	394.8

50' West

S	5.1	394.9
+1.5	5.5	394.5
Topcb	5.79	394.22
Gutter	6.9	393.6
1/4	6.0	394.0
2	5.8	394.2
1/4	6.0	394.0
Gutter	6.6	393.4
Topcb	5.79	394.22
+10.5	5.6	394.4
N	5.0	395.0

100' West

N	4.9	395.1
---	-----	-------

+1.5	5.9	394.6
Topcb	5.55	394.46
Gutter	6.3	393.7
1/4	5.9	394.6
2	5.6	394.4
1/4	5.8	394.2
Gutter	6.3	393.7
Topcb	5.57	394.44
+10.5	5.9	394.6
S	5.0	395.0

125' E Line Alley

S	4.9	395.1
Topcb	5.96	394.55
Gutter	6.1	393.9
1/4	5.8	394.2
2	5.6	394.4
1/4	5.7	394.3
Gutter	6.0	394.0
Topcb	5.55	394.46
N	5.1	394.9

140'

S	5.1	394.9
Topcb	5.94	394.57
Gutter	6.0	394.0
1/4	5.6	394.4
2	5.5	394.5

	+	900.01	Elev
1/4		5.8	394.2
Gutter		6.2	393.8
Topcb. & alley return		5.98	394.53
S.		5.1	394.9
		150 West	
		5.1	394.9
Top cb		5.99	394.52
Gutter		6.2	393.8
1/4		5.7	394.3
¢		5.5	394.5
1/2		5.6	394.4
Gutter		6.1	393.9
Topcb		5.96	394.55
N		5.2	394.8
		200	
N		4.7	395.3
+1.5		5.1	394.9
Topcb		5.27	394.74
Gutter		5.9	394.1
1/4		5.5	394.0
¢		5.3	394.7
1/4		5.5	394.5
Gutter		5.7	394.3
Topcb		5.26	394.75
+10.5		5.0	395.0
S		4.7	394.3

	+	900.01	Elev
		250'W	
S		4.8	395.2
Topcb		5.16	394.85
Gutter		5.5	394.5
1/4		5.2	394.1
¢		5.1	394.9
1/4		5.9	394.6
Gutter		5.7	394.3
Topcb		5.07	394.94
+10.5		5.0	395.0
N		4.6	395.4
		265 SW. Eline Mansfield	
N on paving		4.7	395.3
+1.5		4.9	395.1
Topcb		5.13	394.7
Gutter		5.65	394.36
1/4		5.23	394.78
¢		5.11	394.90
1/4		5.21	394.80
Gutter		5.61	394.40
Topcb		5.16	394.4
S		4.7	395.3
T.P. 4.79		399.64	5.16
		0.00 = Wline	
		4.9	394.7
Topcb		5.12	394.52

	+	399.69	-	Elev
Gutter		5.57		394.07
1/4		5.18		394.46
1/2		4.97		394.67
3/4		5.04		394.60
Gutter		5.42		394.22
Topcb		4.96		394.68
N		4.8		394.8
	10' West			
N		4.8		394.8
Topcb		5.02		394.62
Gutter		5.6		394.0
1/4		4.9		394.7
1/2		4.9		394.7
3/4		5.3		394.3
Gutter		5.7		393.9
Topcb		5.19		393.7
S		4.9		394.7
	50' West			
S		5.2		394.4
Topcb		5.29		394.35
Gutter		6.2		393.4
1/4		5.5		394.1
1/2		5.2		394.4
3/4		5.9		394.2
Gutter		6.0		393.6
Topcb		5.20		394.44

	+	399.69	-	Elev	63
N		5.0		394.6	
	100' West				
N		5.0		394.6	
Topcb		5.31		394.33	
Gutter		6.1		393.5	
1/4		5.4		394.0	
1/2		5.9		393.7	
3/4		5.7		393.9	
Gutter		6.3		393.3	
Topcb		5.98		394.16	
S		5.3		394.3	
	125' W. E. Line Alley				
S		5.1		394.5	
Topcb		5.52		394.12	
Gutter		6.1		393.5	
1/4		5.6		394.0	
1/2		5.5		394.1	
3/4		5.6		394.0	
Gutter		6.0		393.0	
Topcb		5.91		394.23	
N		4.9		394.7	
	140' W. E. Line Alley				
N		5.0		394.6	
Topcb		5.60		394.04	
Gutter		5.9		393.7	
1/4		5.6		394.0	

	+	π	-	Elev
		399.64		
℄			5.5	394.1
1/4			5.8	393.8
Gutter			6.0	393.6
Topcb			5.64	394.00
S			5.9	394.2
	200	11.5		
S			5.7	393.9
Topcb			5.88	393.76
Gutter			6.5	393.1
1/4			6.0	393.6
℄			5.7	393.9
1/4			5.9	393.7
Gutter			6.2	393.4
Topcb			5.70	393.94
N			5.9	394.2
	250'	West		
N			5.2	394.4
Topcb			5.88	393.76
Gutter			6.4	393.24
1/4			6.0	393.6
℄			5.7	393.9
1/4			5.9	393.7
Gutter			6.6	393.0
Topcb			6.04	393.60
S			5.8	393.8

	+	π	-	Elev	
		399.64			64
					265' West E. line Hawley Blvd.
				5.9	394.2
				6.03	393.61
Topcb				6.95	393.19
Gutter				6.04	393.60
1/4				5.87	393.77
℄				5.99	393.65
1/4				6.28	393.36
Gutter				5.90	393.74
Topcb				5.5	394.1
N				6.25	393.39
T.P.	483	398.22			
					White Hawley Blvd = 00
				4.3	393.9
N				4.78	393.44
Topcb				5.29	392.98
Gutter				9.88	393.34
1/4				9.83	393.39
℄				5.09	393.13
1/4				5.65	392.57
Gutter				5.20	393.02
Topcb				4.7	393.5
S					10' West
S				4.6	393.6
Topcb				5.21	393.01
Gutter				5.7	392.5
1/4				5.1	393.1

Q	48	393.4
1/4	49	393.3
Gutter	5.6	392.6
Topcb	48'	393.4
N	4.3	393.9

50' West

N	44	393.8
Topcb	489	393.38
Gutter	5.6	392.6
1/4	5.2	393.0
Q	5.0	393.2
1/4	5.3	392.9
Gutter	5.8	392.4
Topcb	5.23	392.99
S	4.8	393.4

100' West

S	5.0	393.2
Topcb	5.42	392.80
Gutter	6.0	392.2
1/4	5.6	392.6
Q	5.2	393.0
1/4	5.4	393.0
Gutter	5.1	393.1
Topcb	5.16	393.06
N	4.8	393.4

139' West E Lincoln Alley

N	4.8	393.4
Topcb	5.20	393.02
Gutter	5.9	392.3
1/4	5.9	392.8
Q	5.2	393.0
1/4	5.9	392.8
Gutter	5.7	392.5
Topcb	5.6	392.6
S	5.0	393.2

Return out on south

149' West

S	5.2	393.0
Topcb	5.67	392.55
Gutter	5.9	392.3
1/4	5.5	392.7
Q	5.9	392.8
1/4	5.5	392.7
Gutter	5.5	392.7
Topcb	5.26	392.96
N	4.5	393.7

200' West

+ 1.5	4.7	393.5
	5.0	393.2
Topcb	5.39	392.83
Gutter	6.2	392.0
1/4	5.7	392.5

	+	398.22	-	Elev
¢			5.7	392.5
1/4			6.0	392.2
Gutter			6.5	391.7
Topcb			5.84	392.38
+10.5			5.5	392.7
S			5.2	393.0
250' West				
			5.9	392.8
+1.5			5.6	392.6
Topcb			6.05	392.17
Gutter			6.5	391.7
1/4			6.0	392.2
¢			5.8	392.4
1/4			5.8	392.4
Gutter			6.2	392.0
Topcb			5.60	392.62
+10.5			5.3	392.9
N			5.1	393.1
282' West				
N			5.4	392.8
Topcb			5.73	392.49
Gutter			6.22	392.00
1/4			5.79	392.43
¢			5.72	392.60
1/4			6.06	392.16
Gutter			6.56	391.66

	+	398.22	-	Elev	66
Topcb			6.10	392.12	
S			5.8	392.4	
T.P.	5.74	397.87	6.09	392.13	
		Wline of 34 th St = 00			
S	on Paving		5.5	392.4	
Topcb			5.84	392.03	
Gutter			6.21	391.66	
1/4			5.72	392.15	
¢			5.22	392.65	
1/4			5.15	392.72	
Gutter			5.36	392.67	
Topcb			4.82	393.05	
N			4.4	393.5	
15' West					
			4.2	393.7	
			4.9	393.5	
Topcb			5.01	392.86	
Gutter			5.7	392.2	
1/4			3.5	392.4	
¢			5.9	392.5	
1/4			5.7	392.2	
Gutter			6.2	391.7	
Topcb			5.66	392.21	
S+			5.3	392.5	
50' N					
			4.9	393.0	

397.87

Elev

+1.5	5.3	392.6
Topcb	5.67	392.20
Gutter	6.3	391.6
1/4	5.6	392.3
£	5.5	392.4
1/4	5.4	392.5
Gutter	5.7	392.2
Topcb	5.00	392.9
N	4.4	393.5
100' West		
N	4.6	393.3
Topcb	5.06	392.81
Gutter	5.6	392.3
1/4	5.5	392.4
£	5.3	392.6
1/4	5.6	392.3
Gutter	6.2	391.7
Topcb	5.59	392.28
S	5.2	392.7
133 West. E. Line of alley		
S	4.7	393.2
+1.5	4.9	393.0
Topcb	5.39	392.48
Gutter	5.8	392.1
1/4	5.9	392.5
£	5.2	392.6

397.87

Elev

67

1/4	5.9	392.5
Gutter	5.8	392.1
Topcb	5.17	392.70
+10.5	4.9	393.0
N	4.6	393.3
148' West W. Line of Alley		
N	4.8	393.1
+1.5	5.0	392.9
Topcb	5.27	392.60
Gutter	6.0	391.9
1/4	5.5	392.4
£	5.3	392.6
1/4	5.9	392.5
Gutter	5.9	392.0
Topcb	5.30	392.57
+10.5	4.9	393.0
S	4.6	393.3
200' West		
S	4.5	393.4
Topcb	5.10	392.77
Gutter	5.7	392.2
1/4	5.9	392.5
£	5.2	392.7
1/4	5.9	392.5
Gutter	5.8	392.1
Topcb	5.39	392.48

+
X
39787-
Elev

N	5.1	392.8	
250' West			
N	5.3	392.6	
Topcb	5.54	392.33	
Gutter	5.9	392.0	
1/4	5.6	392.3	
1/4	5.3	392.6	
1/4	5.2	392.7	
Gutter	5.7	392.2	
Topcb	4.98	392.89	
+10.5	4.6	393.3	
S.	4.9	393.5	
281' West E Line of Feltan			
S	4.5	393.4	
Topcb	4.78	393.09	✓
Gutter	5.2	392.7	
1/4	5.2	392.7	
1/4	5.2	392.7	
1/4	5.6	392.3	
Gutter	6.2	391.7	
Topcb	5.59	392.28	
+10.5	5.3	392.6	
N	5.0	392.9	
Ecb			
N	5.1	392.8	
+1.5	5.3	392.6	

+
X
39787-
Elev

68

Topcb	5.55	392.32	
Gutter	6.3	391.6	
1/4	5.6	392.3	
1/4	5.1	392.8	
1/4	5.3	392.6	
cb	5.0	392.9	
S. on Paving	5.10	392.77	
S. Topcb	4.72	393.15	✓
1/4 of return	4.75	393.2	
E 1/4			
S. on Paving	4.94	392.93	
cb	4.9	393.0	✓
1/4	5.1	392.9	
1/4	5.2	392.7	
1/4	5.7	392.2	
Gutter	6.2	391.7	
Topcb	5.59	392.28	
+10.5	5.3	392.6	
N	4.9	393.0	
1/4			
	5.0	392.9	
+1.5	5.3	392.6	
Topcb	5.65	392.22	
Gutter	6.2	391.7	
1/4	5.8	392.1	
1/4	5.2	392.7	

	+	X 39787	-	Elev
1/4			5.1	392.8
cb			4.9	393.0
S on paving			4.87	393.00
			W 1/4	
S on paving			5.15	392.72
cb			5.2	392.7
1/4			5.1	392.8
¢			5.3	392.6
1/4			5.9	392.0
Gutter			6.2	391.7
Top cb			5.74	392.13
+10.5			5.3	392.6
N			4.9	393.0
			Wcb.	
N			5.0	392.9
+1.5			5.4	392.5
Topcb			5.77	392.10
Gutter			6.2	391.7
1/4			5.9	392.0
¢			5.3	392.6
1/4			5.2	392.7
cb			5.9	392.0
S on paving			5.65	392.22
Topcb			5.21	392.66
dr return			5.14	392.73

	+	X 39787	-	Elev
			W line of gutter = 00	
S			4.6	393.3
Topcb			5.29	392.63
Gutter			5.6	392.3
1/4			5.9	392.5
¢			5.3	392.6
1/4			5.9	392.0
Gutter			6.5	391.4
Topcb			5.79	392.08
+10.5			5.6	392.3
N			5.0	392.9
			15' West	
N			5.0	392.9
+1.5			5.6	392.3
Topcb			5.90	391.97
Gutter			6.5	391.4
1/4			5.9	392.0
¢			5.5	392.4
1/4			5.7	392.2
Gutter			6.0	391.9
Topcb			5.23	392.64
S			5.0	392.9
T.P.	5.10	397.16	5.81	392.06
	on BM 9.92	396.05		
T.P.	4.23	397.36	6.03	391.13
			50' West	
S			3.4	392.7

Topcb	3.72	392.33
Gutter	4.4	391.7
1/4	4.0	392.1
¢	3.9	392.2
1/4	4.1	392.0
Gutter	4.6	391.5
Topcb	4.12	391.93
+10.5	3.8	392.3
N	3.9	392.7
100' West		
N	3.7	392.4
+1.5	4.0	392.1
Topcb in auto driveway	4.78	391.27
Gutter	4.9	391.2
1/4	4.3	391.8
¢	4.2	391.9
1/4	4.2	391.9
Gutter	4.5	391.6
Topcb	3.95	392.10
S	3.7	392.4
133' West E. line of alley		
S	3.8	392.3
Topcb	4.11	391.94
Gutter	4.4	391.7
1/4	4.4	391.7
¢	4.4	391.7

1/4	4.5	391.6
Gutter	4.9	391.2
Topcb	4.35	391.70
+10.5	4.1	392.0
N	3.8	392.3
148' West. W. line of alley		
N	3.9	392.2
+10.5	4.2	391.9
Topcb	4.39	391.66
Gutter	5.0	391.1
1/4	4.5	391.6
¢	4.5	391.6
1/4	4.4	391.7
Gutter	4.5	391.6
Topcb <small>This alloy is/uro is broken should be replaced</small>	4.32	391.73
S	3.9	392.2
200' West		
S	4.1	392.0
Topcb in auto driveway	5.05	391.00
Gutter	5.0	391.1
1/4	4.7	391.4
¢	4.5	391.6
1/4	4.6	391.5
Gutter	4.8	391.3
Topcb	4.93	391.62
+10.5	4.2	391.9

	396.05	Elev.
N	3.2	392.9
	256' West	
N	3.8	392.3
+1.5	4.2	391.9
Topcb	4.56	391.49
Gutter	5.2	390.9
1/4	4.9	391.2
⊕	4.8	391.3
1/4	4.8	391.3
+9	4.9	391.2
Gutter	5.4	391.7
Topcb	4.85	391.20
S	4.6	391.5
	281' West = E line of 33 ^d	
S	4.7	391.4
Topcb	4.95	391.10
Gutter	5.36	390.69
1/4	4.92	391.15
⊕	4.67	391.38
1/4	4.69	391.36
Gutter	5.05	391.00
Topcb	4.53	391.52
+16.5	4.5	391.6
N	3.8	392.3

	396.05	Elev.
N	3.9	392.2
Topcb	4.20	391.75
Gutter	4.62	391.43
1/4	4.29	391.77
⊕	4.20	391.86
1/4	4.98	391.57
Gutter	4.69	391.36
Topcb	4.31	391.74
S	4.0	392.1
	15' West	
S	3.8	392.3
Topcb	4.91	391.64
Gutter	4.7	391.4
1/4	4.1	392.0
⊕	4.2	391.9
1/4	4.9	391.7
Gutter	4.7	391.4
Topcb	4.18	391.87
N	3.7	392.4
	50' West	
N	3.6	392.5
Topcb	4.03	392.02
Gutter	4.5	391.6
1/4	4.3	391.8
⊕	4.0	392.1
+4	4.0	392.1

	T	Elev
	396.05	
1/4	9.3	391.8
Gutter	9.8	391.8
Topcb	9.12	391.93
S	3.6	392.5
100' West		
S	3.4	392.7
Topcb	3.98	392.27
Gutter	4.5	391.6
1/4	4.1	392.0
+6	3.6	392.5
Q	3.6	392.5
1/4	3.9	392.2
Gutter	4.4	391.7
Topcb	3.92	392.13
N	3.9	392.7
125' West E Line of Alley		
N	3.9	392.7
Topcb	3.89	392.21
Gutter	4.3	391.8
1/4	4.0	392.1
Q	3.7	392.4
+5	3.7	392.4
1/4	3.9	392.2
Gutter	4.2	391.9
Topcb	3.87	392.18
S	3.2	392.9

* Note these alley returns run back 10' from face of cb.

	T	Elev
	396.05	72
140' West. W Line of Alley		
S	3.2	392.9
Topcb	3.95	392.10
Gutter	4.2	391.9
1/4	3.8	392.3
Q	3.7	392.4
1/4	4.0	392.1
Gutter	4.1	392.0
Topcb	3.79	392.26
N	3.2	392.9
147.5' West		
N	3.2	392.9
Topcb	3.70	392.35
Gutter	4.1	392.0
1/4	3.9	392.2
Q	3.6	392.5
1/4	3.9	392.2
Gutter	4.3	391.8
Topcb	3.70	392.35
S	3.2	392.9
200' West		
S	3.1	393.0
Topcb	3.51	392.54
Gutter	4.1	392.0
1/4	3.7	392.4
Q	3.9	392.7
1/4	3.5	392.6

	+	X 396.05	-	Elev
Gutter			3.9	392.2
Top cb			3.90	392.55
N			2.9	393.2
T.P.	573	398.18	3.60	392.45
			250' West	
N			5.1	393.1
Top cb			5.44	392.74
Gutter			6.0	392.2
1/4			5.6	392.6
¢			5.3	392.9
1/4			5.6	392.6
Gutter			6.0	392.2
Top cb			5.44	392.74
S			5.1	393.1
			265 5° W. E line Bancroft	
S			5.0	393.2
Top cb			5.28	392.80
Gutter			5.7	392.5
1/4			5.3	392.9
¢			5.2	393.0
1/4			5.4	392.8
Gutter			5.9	392.3
Top cb			5.39	392.79
N			5.1	393.1
			E cb	
N			5.2	393.0

	+	X 398.18	-	Elev
Top cb			5.91	392.77
Gutter			5.9	392.8
1/4			5.9	392.8
¢			5.1	393.1
1/4			5.1	392.1
cb			5.5	392.7
S on Ground			5.8	392.4
Top cb on Shine			5.94	392.74
			E 14	
S			5.4	392.8
cb			5.2	393.0
1/4			5.3	392.9
¢			5.1	393.1
1/4			5.4	392.8
			5.9	392.3
Gutter			5.31	392.87
Top cb			4.9	393.3
N			¢	
			N	
			4.8	393.4
Top cb			5.20	392.98
S			5.8	392.4
1/4			5.9	392.8
¢			5.1	393.1
1/4			5.2	393.0
cb			5.0	393.2
S			5.2	393.0

	39818	Elev
	W 1/4	
S	54	392.8
cb	52	393.0
1/4	50	393.2
¢	49	393.3
1/4	53	392.9
Gutter	58	392.4
Topcb	511	393.07
N	47	393.5
	W cb	
N	47	393.5
Topcb	513	393.05
Gutter	57	392.5
1/4	59	392.8
¢	49	393.3
1/4	50	393.2
cb	59	392.8
S. on ground	56	392.6
S. on end of cb rotary	513	393.05
	W. line of Bancroft	
S	4.6	393.6
Topcb	510	393.08
Gutter	55	392.7
1/4	52	393.0
¢	51	393.1
1/4	54	392.8
Gutter	57	392.5

	39818	Elev
Topcb	511	393.07
N	4.6	393.6
	12' West	
N	4.5	393.7
Topcb	5.06	393.12
Gutter	5.6	392.6
1/4	5.1	393.1
¢	5.1	393.1
1/4	5.3	392.9
Gutter	5.6	392.6
Topcb	5.07	393.11
S	9.4	393.8
	50' West	
S	4.5	393.7
Topcb	5.01	393.17
Gutter	5.5	392.7
1/4	5.2	393.0
¢	5.0	393.2
1/4	5.2	393.0
Gutter	5.5	392.7
Topcb	4.95	393.20
N	4.5	393.7
	100' West	
N	4.9	393.8
Top	4.83	393.35
Gutter	5.5	392.7

	+	*	-	Elev
		39818		
1/4			5.2	393.0
♀			5.0	393.2
1/4			5.2	393.0
Gutter			5.6	392.6
Topcb			4.94	393.24
S			4.6	392.6
		160' W. E. line of Alley		
S			4.9	393.8
Topcb			4.78	393.40
Gutter			5.2	393.0
1/4			5.0	393.2
♀			4.7	393.5
1/4			4.8	393.4
Gutter			5.1	393.1
Topcb			4.68	393.50
N			4.4	393.8
T.P	4.53	39833 396.20	4.38	393.80 391.67
		175' W. W. line of Alley		
N			4.2	394.1
Topcb			4.64	393.69
Gutter			5.1	393.2
1/4			4.9	393.4
♀			4.6	393.7
1/4			5.1	393.2
Gutter			5.9	392.4
Topcb			4.79	393.54

	+	*	-	Elev
		39833		75
S			4.5	393.8
		200' West		
			4.5	393.8
Topcb			4.78	393.55
Gutter			5.5	392.8
1/4			5.1	393.2
♀			4.6	393.7
1/4			5.0	393.3
Gutter			5.3	393.7
Topcb			4.99	393.84
N			4.0	394.8
		250' West		
N			3.8	394.5
Topcb			4.51	393.82
Gutter			5.1	393.2
1/4			5.0	393.3
♀			4.7	393.6
4.5			4.7	393.6
1/4			5.0	393.3
Gutter			5.9	392.9
Topcb			4.63	393.70
S			4.2	394.1
		300' West		
S			4.2	394.1
Topcb			4.60	393.73
Gutter			5.2	393.1

+
398 33

Elev

1/4	7.8	393.5
¢	9.5	393.8
1/4	9.8	393.5
Gutter	5.0	393.3
Top cb	4.32	394.01
N	3.9	394.4

3 + 36 = 5 Prop

N. 3.9 394.4

Top cb 4.12 394.21 ✓

Gutter 4.8 393.5

1/4 4.9 393.4

¢ 9.5 393.8

+5 4.9 393.9

1/4 9.8 393.5

Gutter 5.0 393.3

Top cb 4.95 393.88

S. 7.2 394.1

341.5 W 51' see sketch

S 4.2 394.1

Top cb 4.95 393.88

Gutter 5.0 393.3

1/4 9.8 393.5

+5 4.9 393.9

¢ 4.6 393.7

1/4 4.9 393.4

Gutter 4.9 393.4

+
398 33

Elev

76

Top cb	4.15	394.18 ✓
N	3.9	394.4 ✓
BM S.E. Copht v. Mt. View Drive	4.90	393.93 ✓
		393.80
		BM 393.91 ✓

Top of Curb Levels
Mountain View Dr. Adams South to Cherokee

BM	0.74	386.52	385.78	S.F.B.P Adams St Cherokee
TP	1.30	377.61	10.21	376.31
S.L. Adams				
W Top Cb	①	1.63		375.98
E "		2.74		374.87
		35.16 S on E		
		30.8 S on W		
F	②	2.34		374.27
W		2.23		375.38
		70.38 S on E		
		66.6 S on W		
W	③	2.75		374.86
F		3.99		373.62
		105.48 S on E		
		92.4 S on W		
F	④	4.53		373.08
W		3.38		374.23
		140.64 S on E		
		123.2 S on W		
W	⑤	4.10		373.51
F		5.22		372.39
		107.5 S on E = H.L. Alley		
F		5.28		372.33
F		167.6 S on E = S.L. Alley		371.95
		5.66		
		129.6 S on W = H.L. Alley		
W		4.24		373.37
		146.6 S on W = S.L. Alley		
W		4.34		373.27

Elev. top of existing pavement

8-11-24
S. L. Adams
Mountain View
Adams St
Cherokee
77

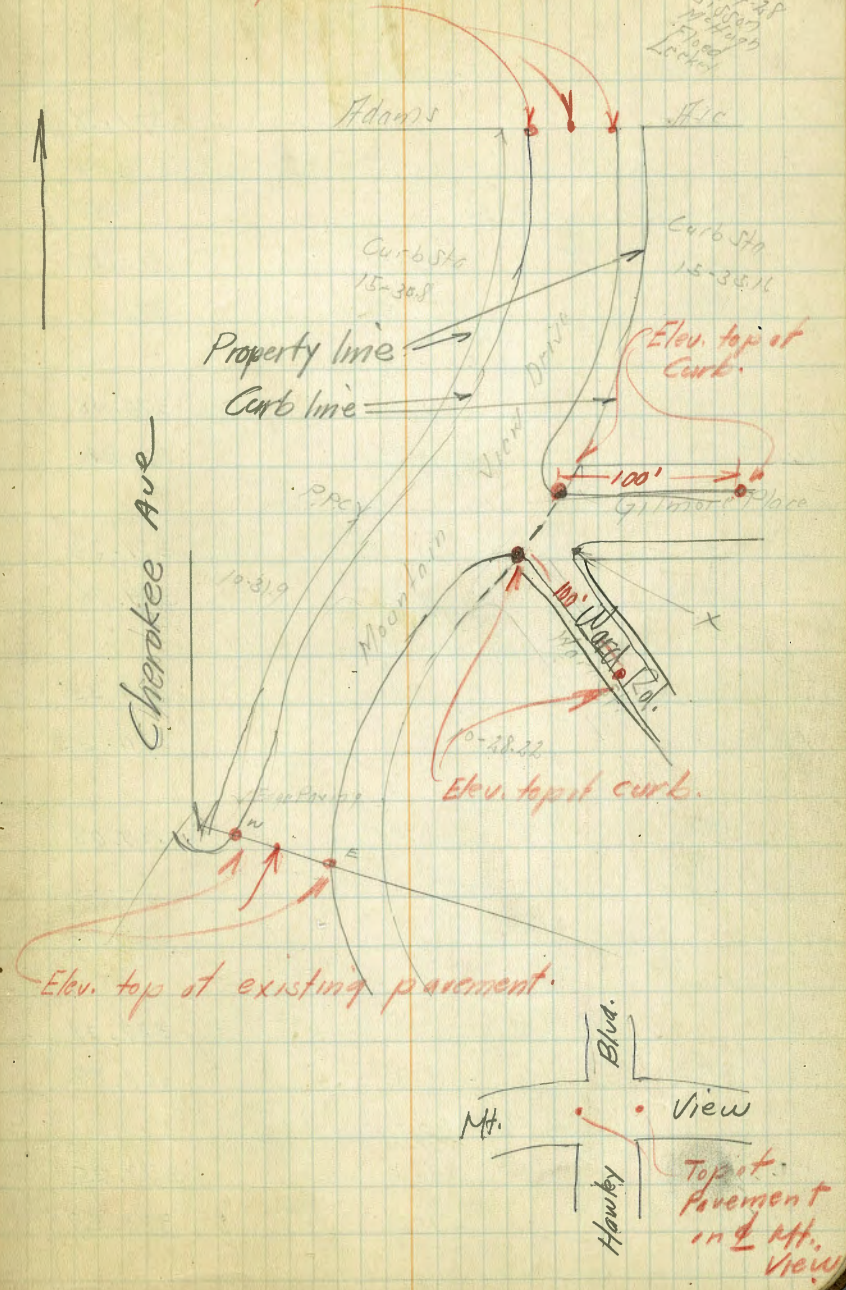

377.61

175.80 S 07 E
154.0 S 07 W

E 5.90 371.71

W 4.57 473.04

216.96 S 07 E
184.8 S 07 W

W 5.25 372.36

E 6.55 371.06

246.18 S 07 E
215.6 S 07 W

E 7.13 370.48

W 5.77 371.84

271.28 S 07 E
244.4 S 07 W

W 6.37 371.24

E 7.83 369.78

316.44 S 07 E
277.2 S 07 W

E 8.38 369.23

W 6.98 370.63

330.9 S 07 E - N End of Refuse
At Gilmore

E 8.53 369.08

368 S 07 W

W 7.61 370.00

338 S 07 W opposite on E

W 7.84 369.77

E 8.73 368.88

319.6 S 07 W opposite on E

E 7.36 370.25

W 7.02 370.59

457.08 S 07 E - P.R.C.
400.4 S 07 W

377.61

W 5.97 371.64

E 6.00 371.61

TP 12.99 386.24 4.36 373.25

498.21 S 07 E
431.8 S 07 W

E 13.40 372.84

W 13.56 372.68

527.45 S 07 E - P.R.C.
462.0 S 07 W

W 12.28 373.96

E 12.32 373.92

555.12 S 07 E
498.9 S 07 W

W 11.30 374.94

E 11.20 375.04

583.84 S 07 E
525.8 S 07 W

W 10.10 376.14

E 10.37 375.87

612.06 S 07 E
557.7 S 07 W

E 9.24 377.00

W 9.10 377.14

629.78 S 07 E - N.L. Hiller

E 8.62 377.62

647.70 S 07 E - S.L. Hiller

E 8.02 378.22

589.6 S 07 W

W 8.02 378.22

606.2 S 07 W - N.L. Hiller

W 7.97 378.27

Mountain View Dr

		384.24		
		624.95 on W = NL E/W		
W		6.57	379.67	
		661.50 on E		
E		7.37	378.87	
		696.72 on E		
	(19)	653.45 on W		
F		6.21	380.03	
N		5.67	380.57	
		734.91 on E		
	(20)	695.35 on W		
W		4.61	381.63	
E		5.31	380.93	
		753.16 on E		
		717.35 on W		
E	(21)	4.31	381.93	
W		3.50	382.74	
		781.38 on E		
		749.15 on W		
N	(22)	2.41	383.83	
E		3.44	382.80	
		809.60 on E = N Edge Parking at Cherokee		
		781.0 on W		
F		2.69	383.55	
N		1.43	384.81	
TP	5132	390.21	1.85	384.99
BM		9.55	385.76	SEBP Adams Cherokee 385.78

5009-28 Cb & Pavement levels Mt View 79

London
T. P. Hill Martin
Sundermyer

Mt View at SL Adams SE BP
Adams Cherokee

BM	1.05	386.83	✓	385.78
T.P.	1.82	377.89	10.76	376.07 ✓
w gut		2.37		375.52 ✓
¢		2.53		375.36 ✓
E gut		3.45		374.44 ✓
T.P.	5.23	374.70	8.42	369.47 ✓
Top cb E.L. Mt View - N.L. Gillmore Place				
		5.70		369.00 ✓
100' E on Ncb Gillmore Pl.				
		5.46		
Sch Gillmore rt LS.				
		5.73		368.97
X Int. Sch Gillmore 2 NEcb Ward St				
		5.89		
SW cb line ward st E.L. Mt View				
		5.81		368.90
100' South on SW cb Ward St.				
		7.04		
NE cb rt LS				
		7.03		
T.P.	12.88	387.46	0.12	374.58
Mt View at Cherokee End Pav.				
E gut		4.43		383.03
¢		3.41		381.05
w gut		3.75		367.21
T.P.	5.61	390.83	2.24	385.22
BM Beginning.		5.05		385.78

B.P.S.W.
Hawley Blvd.
& Mt View.

Hawley Blvd & Mt View.

B.M. 5.53 399.54 394.01

E Mt View w.l. Hawley

5.63 393.91

E Mt View E.L. Hawley.

5.53 394.01

DIRECTIONS FOR USE OF TABLES

TABLE No. 1.

Distance of slope stake from side or shoulder stake for any width roadway, slope 1% to 1%. If ground is nearly level, the cut or fill at side stake is located by the double entry method in left column and top row. The number in body of table in same row and column gives distance

from side stake to slope stake. If ground is not

level, correct the distance in table by adding or subtracting the amount it cut, elevate it fill. Add this amount

to cut or fill and find in table. Set up rod at this point, and line of sight should cut target.

TABLE No. 2.

To find tangent and external for curve of any other degree, divide by degree of curve and add connection found in column of connection.

Degree of curve with a given L may be found by dividing tangent (or external), opposite L by given tangent (or external).

The distance from a point on the tangent to the curve is very nearly the square of the tangent length divided by twice the radius.

9-8 04 N.
62 on 20074

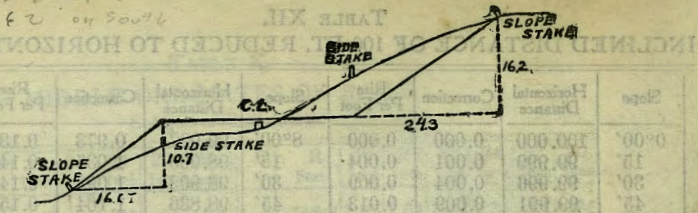

DISTANCES FROM SIDE STAKES FOR CROSS-SECTIONING.

SLOPE 1 1/2 TO 1. ROADWAY OF ANY WIDTH.

	0	.1	.2	.3	.4	.5	.6	.7	.8	.9	
0	0.00	0.15	0.30	0.45	0.60	0.75	0.90	1.05	1.20	1.35	0
1	1.50	1.65	1.80	1.95	2.10	2.25	2.40	2.55	2.70	2.85	1
2	3.00	3.15	3.30	3.45	3.60	3.75	3.90	4.05	4.20	4.35	2
3	4.50	4.65	4.80	4.95	5.10	5.25	5.40	5.55	5.70	5.85	3
4	6.00	6.15	6.30	6.45	6.60	6.75	6.90	7.05	7.20	7.35	4
5	7.50	7.65	7.80	7.95	8.10	8.25	8.40	8.55	8.70	8.85	5
6	9.00	9.15	9.30	9.45	9.60	9.75	9.90	10.05	10.20	10.35	6
7	10.50	10.65	10.80	10.95	11.10	11.25	11.40	11.55	11.70	11.85	7
8	12.00	12.15	12.30	12.45	12.60	12.75	12.90	13.05	13.20	13.35	8
9	13.50	13.65	13.80	13.95	14.10	14.25	14.40	14.55	14.70	14.85	9
10	15.00	15.15	15.30	15.45	15.60	15.75	15.90	16.05	16.20	16.35	10
11	16.50	16.65	16.80	16.95	17.10	17.25	17.40	17.55	17.70	17.85	11
12	18.00	18.15	18.30	18.45	18.60	18.75	18.90	19.05	19.20	19.35	12
13	19.50	19.65	19.80	19.95	20.10	20.25	20.40	20.55	20.70	20.85	13
14	21.00	21.15	21.30	21.45	21.60	21.75	21.90	22.05	22.20	22.35	14
15	22.50	22.65	22.80	22.95	23.10	23.25	23.40	23.55	23.70	23.85	15
16	24.00	24.15	24.30	24.45	24.60	24.75	24.90	25.05	25.20	25.35	16
17	25.50	25.65	25.80	25.95	26.10	26.25	26.40	26.55	26.70	26.85	17
18	27.00	27.15	27.30	27.45	27.60	27.75	27.90	28.05	28.20	28.35	18
19	28.50	28.65	28.80	28.95	29.10	29.25	29.40	29.55	29.70	29.85	19
20	30.00	30.15	30.30	30.45	30.60	30.75	30.90	31.05	31.20	31.35	20
21	31.50	31.65	31.80	31.95	32.10	32.25	32.40	32.55	32.70	32.85	21
22	33.00	33.15	33.30	33.45	33.60	33.75	33.90	34.05	34.20	34.35	22
23	34.50	34.65	34.80	34.95	35.10	35.25	35.40	35.55	35.70	35.85	23
24	36.00	36.15	36.30	36.45	36.60	36.75	36.90	37.05	37.20	37.35	24
25	37.50	37.65	37.80	37.95	38.10	38.25	38.40	38.55	38.70	38.85	25
26	39.00	39.15	39.30	39.45	39.60	39.75	39.90	40.05	40.20	40.35	26
27	40.50	40.65	40.80	40.95	41.10	41.25	41.40	41.55	41.70	41.85	27
28	42.00	42.15	42.30	42.45	42.60	42.75	42.90	43.05	43.20	43.35	28
29	43.50	43.65	43.80	43.95	44.10	44.25	44.40	44.55	44.70	44.85	29
30	45.00	45.15	45.30	45.45	45.60	45.75	45.90	46.05	46.20	46.35	30
31	46.50	46.65	46.80	46.95	47.10	47.25	47.40	47.55	47.70	47.85	31
32	48.00	48.15	48.30	48.45	48.60	48.75	48.90	49.05	49.20	49.35	32
33	49.50	49.65	49.80	49.95	50.10	50.25	50.40	50.55	50.70	50.85	33
34	51.00	51.15	51.30	51.45	51.60	51.75	51.90	52.05	52.20	52.35	34
35	52.50	52.65	52.80	52.95	53.10	53.25	53.40	53.55	53.70	53.85	35
36	54.00	54.15	54.30	54.45	54.60	54.75	54.90	55.05	55.20	55.35	36
37	55.50	55.65	55.80	55.95	56.10	56.25	56.40	56.55	56.70	56.85	37
38	57.00	57.15	57.30	57.45	57.60	57.75	57.90	58.05	58.20	58.35	38
39	58.50	58.65	58.80	58.95	59.10	59.25	59.40	59.55	59.70	59.85	39
40	60.00	60.15	60.30	60.45	60.60	60.75	60.90	61.05	61.20	61.35	40
41	61.50	61.65	61.80	61.95	62.10	62.25	62.40	62.55	62.70	62.85	41
42	63.00	63.15	63.30	63.45	63.60	63.75	63.90	64.05	64.20	64.35	42
43	64.50	64.65	64.80	64.95	65.10	65.25	65.40	65.55	65.70	65.85	43
44	66.00	66.15	66.30	66.45	66.60	66.75	66.90	67.05	67.20	67.35	44
45	67.50	67.65	67.80	67.95	68.10	68.25	68.40	68.55	68.70	68.85	45
46	69.00	69.15	69.30	69.45	69.60	69.75	69.90	70.05	70.20	70.35	46
47	70.50	70.65	70.80	70.95	71.10	71.25	71.40	71.55	71.70	71.85	47
48	72.00	72.15	72.30	72.45	72.60	72.75	72.90	73.05	73.20	73.35	48
49	73.50	73.65	73.80	73.95	74.10	74.25	74.40	74.55	74.70	74.85	49
50	75.00	75.15	75.30	75.45	75.60	75.75	75.90	76.05	76.20	76.35	50

Computed by L. Leland Locke.

C
0-1
0-20
0-40
1-0
1-20
1-40
2-0
2-20
2-40
3-0
3-20
3-40
4-0
4-20
4-40
5
6
7

To fit

27.9
 19 1.8
 25.8
 217.2
 2.15
 27
 10
 57
 36 388
 5.06
 20/5
 1195
 498

ENGINEERING DEPARTMENT
 CITY OF CALIFORNIA
 SAN FRANCISCO

630 Flow
 5.70 Top
 8 | 2022
 24
 52
 48
 46
 40
 40
 10
 10 | 2926
 2438
 2926
 52
 48
 46
 36
 100

990 7° to N line of McKinley - 20 parts
 524 " " East - 26.70 - 20

397.87
 3.10

12 332
 5.70

10 111

From 300

7.5

47

29.31

was

25.3

30.5