

1270

1270
1270
1270
1270
1270

ENGINEERING DEPARTMENT,
CITY OF SAN DIEGO,
CALIFORNIA.

Our Leather Bound Engineers Note Books are carried in the following rulings:

- No. 380 LEVEL BOOK. Left and Right Hand Page the same as Left Hand Page of this Book.
- No. 382 FIELD BOOK. Left Hand Page as in this Book, Right Hand Page 4 x 4 to the inch, Center Line Red.
- No. 384 MINING TRANSIT BOOK. Left Hand Page as in this Book, Right Hand Page 8x8 to the inch, Center Line Red.
- No. 385 FIELD BOOK. Left Hand Page as in this Book, Right Hand Page 8 vertical and 4 horizontal lines to the inch, Center Line Red.

We also carry the Note Books listed above, bound in extra strong Fabri-Hide (otherwise the same quality of book), which can be furnished at a somewhat lower price.

In ordering Fabri-Hide covered books, add the letter "F" to catalog number.

THE FREDERICK POST CO.
ENGINEERING and DRAFTING SUPPLIES
IRVING PARK STATION
CHICAGO, ILL.

MICROFILMED

2 1964

No. 380 to 385 3/5/20 H.H.

BM 72.01 ^{off B.P.}
3rd Ave + La Jolla

X Sec. La Jolla Blvd.	S.L. Bird Rock	- Prospect	
Levels - Sherman School			48
X Sec. 32 nd St.	Boston to Main		49
" " REDWOOD	Mile to Boundary-		52
" " QUINCE	Redwood to "		55
" " Alley Blk 50	Olive Hill ^{E/C} to Meade	Central to 41 st	60
Cd levels of "T" st.	38 th to Jewell		63
X Sec Alley Blk 3	Hillcrest		67

No. 1 in 6 pages 7/1 3/5/20 H.H.

X-Section La Jolla Blvd. from S.L. Bird Rock

Addition to Prospect Street.

JAEGER }
Dailey } August 13th
Clarey }

STA.	+	H.I.	-	Elev.
SW. B.P. La Jolla Blvd. & Colima				77.98
	4.17	82.15		
0+00	E. Curb			
	Top	8.95		73.20
	Bot.	9.70		72.35
	¢	9.07		73.08
	Bot. W. Curb	9.48		72.67
	Top	8.72		73.43
0+23 ⁶⁰				
	E. Curb Top	8.44		73.71
	✓ Bot.	9.10		73.05
	¢	8.78		73.37
0+50				
	E. Curb Top	7.80		74.35
	✓ Bot.	8.45		73.70
	¢	8.12		74.03
	W. Curb Bot.	8.75		73.40
	✓ Top	8.01		74.14
1+10 ⁸⁵				
	W. Curb Top	6.30		75.85
	✓ Bot.	7.08		75.07
	¢	6.39		75.76
	E. Curb Bot.	7.06		75.09
	✓ Top	6.25		75.90

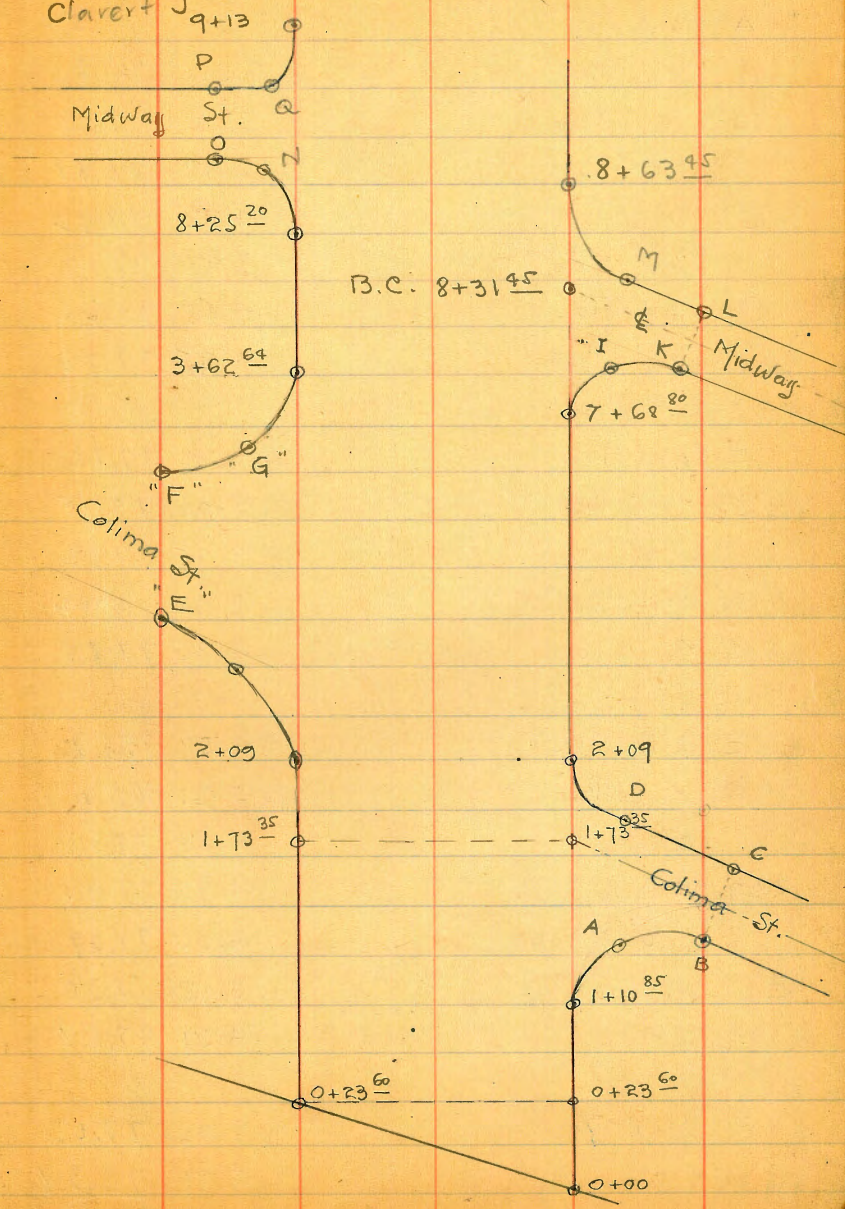

			STA	+	H. I.	-	Elev.
"A"	✓ Curb Top	5.51	77.64	⊥		5.18	76.97
	✓ Bott.	6.31	76.84	"F"	W. Curb Top } W.L. La Jolla Blvd.	4.64	77.51
"B"	✓ Top	5.09	77.06		✓ Bott.	5.38	76.77
	✓ Bott.	5.77	76.38	"G"	W. Curb Top	5.18	76.97
"C"	✓ Bott.	4.73	77.42		✓ Bott.	5.85	76.30
	✓ Top	3.98	78.17	3+62	64		
"D"	✓ Top	4.15	78.00		W. Curb Top	5.85	76.30
	✓ Bott.	4.95	77.20		✓ Bott.	6.48	75.67
2+09					⊥	5.92	76.23
	E. Curb Top	4.29	77.86		E. Curb Top	5.88	76.27
	✓ Bott.	5.00	77.15		✓ Bott.	6.61	75.54
	⊥	4.45	77.70	4+00			
	W. Curb Bott.	5.03	77.12		E. Curb Top	6.33	75.82
	✓ Top	4.30	77.85		✓ Bott.	7.05	75.10
2+50					⊥	6.36	75.79
	E. Curb Top	4.57	77.58		W. Curb Bott.	7.01	75.14
	✓ Bott.	5.31	76.84		✓ Top	6.28	75.87
	⊥	4.57	77.58		T.P.	6.01	76.14
+ 28.7	W. Curb Bott.	4.75	77.40			1.48	<u>77.62</u> ✓
	✓ Top	4.06	78.09	4+50			<u>77.62</u>
"E"	W. Curb Top } W.L. La Jolla	3.85	78.30		W. Curb Top	2.34	75.28
	✓ Bott.	4.57	77.58		✓ Bott.	3.08	74.54
3+00					⊥	2.46	75.16
	E. Curb Top	5.03	77.02		E. Curb Bott.	3.04	74.58
	✓ Bott.	5.77	76.38		✓ Top	2.38	75.24

77.62

77.62

STA	+	H.L.	-	Elev.
5+00				
E. Curb Top			2.90	74.72
✓ Bottom			3.66	73.96
⊘			3.05	74.57
W. Curb Bottom			3.65	73.97
✓ Top			2.90	74.72
5+50				
W. Curb Top			3.50	74.12
✓ Bottom			4.19	73.43
⊘			3.60	74.02
E. Curb Bottom			4.16	73.46
✓ Top			3.46	74.16
6+00				
E. Curb Top			4.09	73.53
✓ Bottom			4.82	72.80
⊘			4.20	73.42
W. Curb Bottom			4.80	72.82
✓ Top			4.13	73.45
6+50				
W. Curb Top			4.66	72.96
✓ Bottom			5.37	72.25
⊘			4.80	72.82
E. Curb Bottom			5.39	72.23
✓ Top			4.63	72.99

STA	+	H.L.	-	Elev.
7+00				
E. Curb Top			5.20	72.42
✓ Bottom			5.96	71.66
⊘			5.33	72.29
W. Curb Bottom			5.89	71.73
✓ Top			5.19	72.43
7+68 ⁸⁰				
W. Curb Top			5.95	71.67
✓ Bottom			6.75	70.87
⊘			6.21	71.41
E. Curb Bottom			6.62	71.00
✓ Top			5.88	71.74
"I" Curb Top			5.39	71.23
✓ Bottom			6.28	70.34
"K" ✓ Bottom			5.49	72.13
✓ Top			4.85	72.77
8+25 ²⁰				
W. Curb Top			6.60	71.02
✓ Bottom			7.48	70.14
8+31 ⁴⁵ B.C.				
W. Curb Top			6.72	70.90
✓ Bottom			7.55	70.07
⊘			7.41	70.21
+ 20'			7.33	70.29

STA	+	H.I.	-	Elev.
"L"	✓		5.12	72.50
	✓		5.79	71.83
"M"	✓		6.65	70.97
	✓		7.35	70.27
"N"	✓		7.46	70.16
	✓		8.36	69.26
"O"	✓		9.38	68.24
	✓	W.L. La Jolla Blvd.	10.10	67.52
8+63 ⁴⁵				
E. Curb Top			6.64	70.98
	✓		7.41	70.21
"P"	✓		9.01	68.61
	✓		9.72	67.90
"Q"	✓		7.64	69.98
	✓		8.45	69.17
9+00				
E. Curb Top			6.40	71.22
	✓		7.16	70.46
⊕			6.58	71.04
+20'			7.54	70.08
+23 ²⁰		W. Curb Bolt.	7.74	69.88
	✓	Top	6.95	70.69
9+13				
W. Curb Top			6.50	71.12
	✓		7.23	70.39

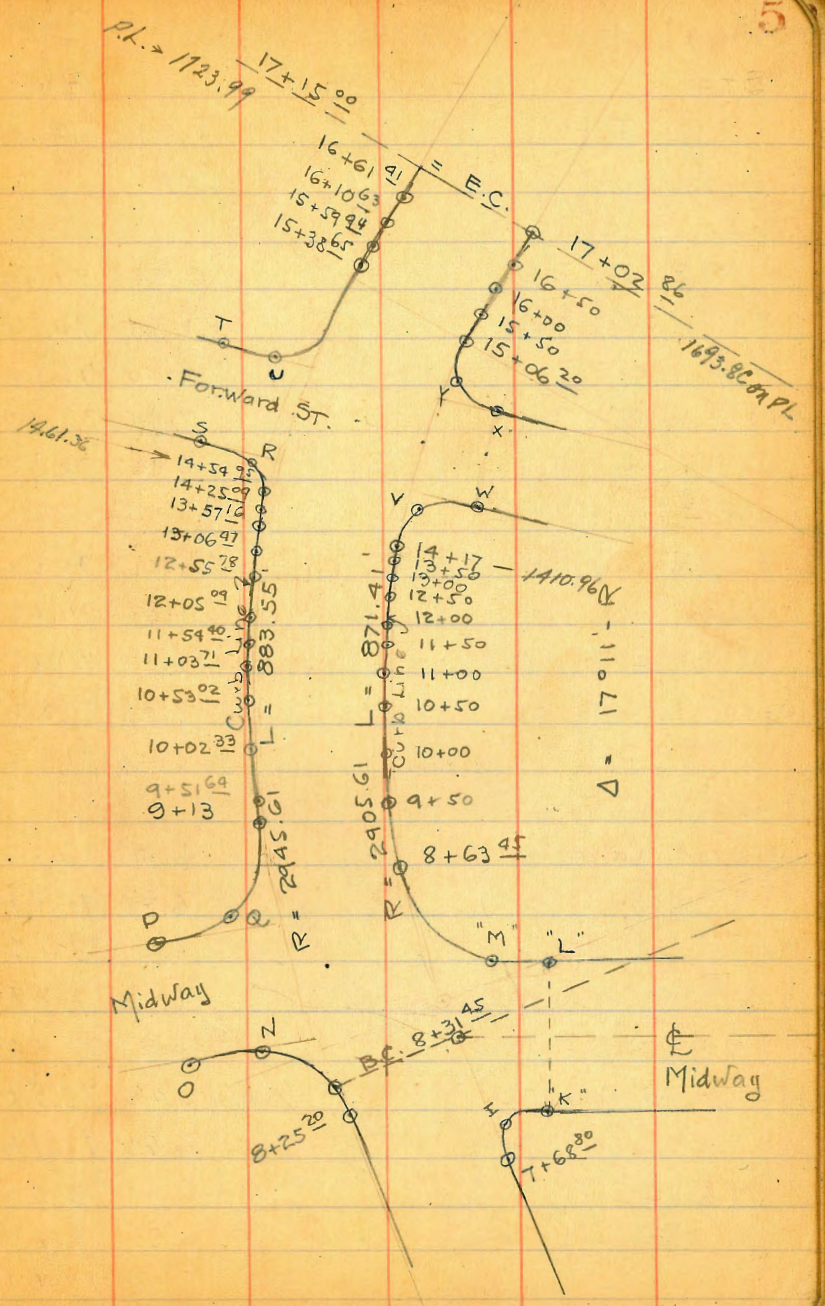

STA	+	H.I.	-	Elev.	STA	+	H.I.	-	Elev.
				<u>78.43</u>					<u>78.43</u> ⁶
	T.P.		5.09	72.53	11+50				
9+50	5.90	78.43			E. Curb Top			5.38	73.05
			6.94	71.49	✓ Bottom			6.15	72.28
	E. Curb Top		7.64	70.79	11+54 ⁴⁰ W. Curb Bottom			5.55	72.88
	✓ Bottom		7.00	71.43	✓ Top			6.30	72.13
9+51 ⁶⁴	W. Curb Bottom		7.74	70.69	12+05 ⁰⁹			5.51	72.92
	✓ Top		6.96	71.47	W. Curb Top			5.18	73.25
10+02 ³³			6.61	71.82	✓ Bottom			5.97	72.46
	W. Curb Top		7.37	71.06	12+00 E. Curb Bottom			5.18	73.25
	✓ Bottom		6.57	71.86	✓ Top			5.83	72.60
10+00	E. Curb Bottom		7.21	71.22	12+50			5.09	73.34
	✓ Top		6.49	71.94	E. Curb Top			4.75	73.68
10+50			6.17	72.26	✓ Bottom			5.51	72.92
	E. Curb Top		6.88	71.55	12+55 ⁷⁸ W. Curb Bottom			4.83	73.60
	✓ Bottom		6.26	72.17	✓ Top			5.58	72.85
10+53 ⁰²	W. Curb Bottom		7.06	71.37	13+06 ⁴⁷			4.79	73.64
	✓ Top		6.24	72.19	W. Curb Top			4.41	74.02
11+03 ²¹	W. Curb Top		5.93	72.50	✓ Bottom			5.19	73.24
	✓ Bottom		6.69	71.74	13+00 E. Curb Bottom			4.50	73.93
			5.89	72.54	✓ Top			5.11	73.32
	E. Curb Bottom		6.55	71.88				4.31	74.12
	✓ Top		5.82	72.61					

STA	+	H.I.	-	<u>78.43</u> Elev.
13+50				
E. Curb Top			4.05	74.38
✓ Bottom			4.77	73.66
ϕ			4.17	74.26
13+57 ¹⁶ W. Curb Bottom			4.89	73.54
✓ Top			4.09	74.34
14+25 ⁰⁹				
W. Curb Top			3.62	74.81
✓ Bottom			4.38	74.05
ϕ			3.63	74.80
14+17 ⁰⁰ E. Curb Bottom			4.35	74.08
✓ Top			3.61	74.82
T.P.			3.61	74.82
	5.43	80.25		<u>80.25</u>
V" Curb Top			4.71	75.54
✓ Bottom			5.56	74.69
W" ✓ Top			3.80	76.45
✓ Bottom			4.41	75.84
X" ✓ Top			3.77	76.48
✓ Bottom			4.45	75.80
Y" ✓ Top			4.95	75.30
✓ Bottom			5.63	74.62
15+54 ⁹⁵ ✓ Top			5.28	74.97
✓ Bottom			5.94	74.31

STA	+	H.I.	-	<u>80.25</u> ¹⁷ Elev.
R" Top			5.70	74.55
Bottom			6.44	73.81
S" Top Driveway			7.04	73.21
✓ Bottom			7.22	73.03
T" Top Driveway			7.56	72.49
Bottom			7.56	72.69
U" Top			6.11	74.14
Bottom			6.90	73.35
15+06 ²⁰				
E. Curb Top			5.15	75.10
✓ Bottom			5.75	74.50
ϕ			5.30	74.95
15+38 ⁶⁵				
W. Curb Top			5.14	75.11
✓ Bottom			6.01	74.24
ϕ			5.25	75.06
15+50				
E. Curb Top			5.10	75.15
✓ Bottom			5.64	74.61
ϕ			5.13	75.12
15+59 ⁹⁴ W. Curb Bottom			5.94	74.31
✓ Top			5.07	75.18

STA.	H.I.	Elev.
16+10 ⁶³		
W. Curb Top	4.94	75.31
✓ Bott.	5.75	74.50
Φ	5.01	75.24
16+00 E. Curb Bott.	5.49	74.76
✓ Top	4.92	75.33
16+50		
E. Curb Top	4.76	75.49
✓ Bott.	5.33	74.92
Φ	4.80	75.45
16+61 ⁴¹ W. Curb Bott.	5.55	74.70
✓ Top	4.65	75.60
17+15 ⁰⁰ E.C.		
W. Curb Top	4.67	75.58
✓ Bott.	5.41	74.84
Φ	4.67	75.78
17+02 ⁸⁶ E. Curb Bott.	5.22	75.03
✓ Top	4.62	75.63
T.P.	4.61	75.64
	5.40	81.04 ✓
		<u>81.04</u>
17+50		
E. Curb Top	5.27	75.77
✓ Bott.	5.85	75.19
Φ	5.31	75.73
W. Curb Top	5.31	75.73
✓ Bott.	6.04	75.00

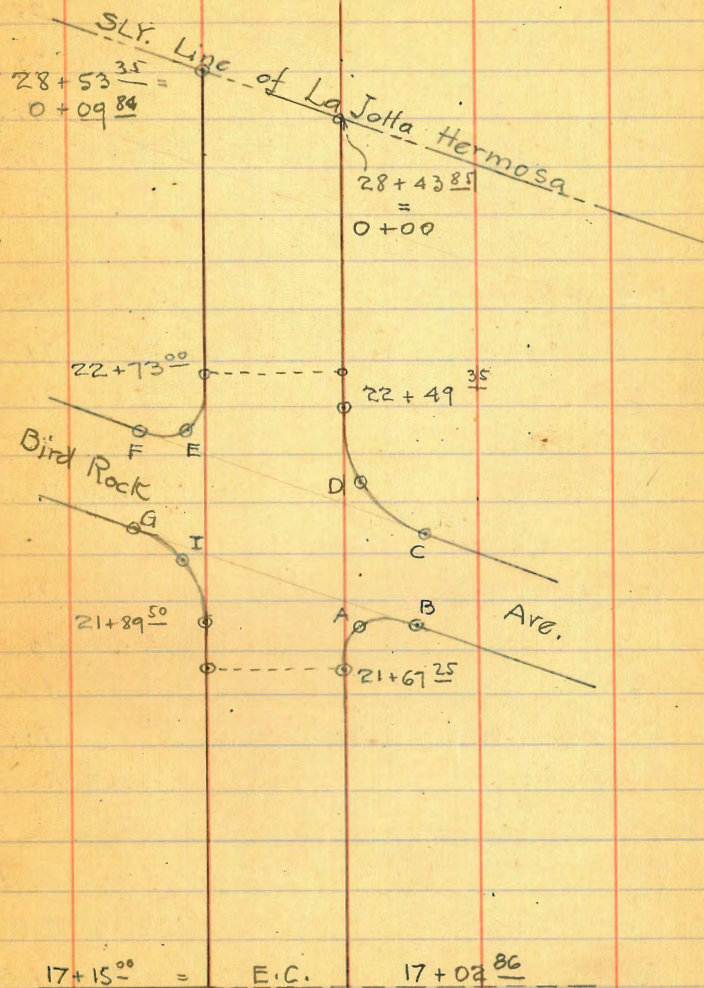

81.04

Sta.	+	H.I.	-	Elev.
18+00				
W. Curb Top			5.14	75.90
✓ Bottom			5.88	75.16
⊕			5.20	75.84
E. Curb Bottom			5.64	75.40
✓ Top			5.04	76.00
18+50				
E. Curb Top			4.87	76.17
✓ Bottom			5.52	75.52
⊕			5.02	76.02
W. Curb Bottom			5.67	75.37
✓ Top			5.00	76.04
19+00				
W. Curb Top			4.80	76.24
✓ Bottom			5.55	75.49
⊕			4.86	76.18
E. Curb Bottom			5.36	75.68
✓ Top			4.67	76.37
19+50				
E. Curb Top			4.44	76.60
✓ Bottom			5.19	75.85
⊕			4.70	76.34
W. Curb Bottom			5.38	75.66
✓ Top			4.59	76.45

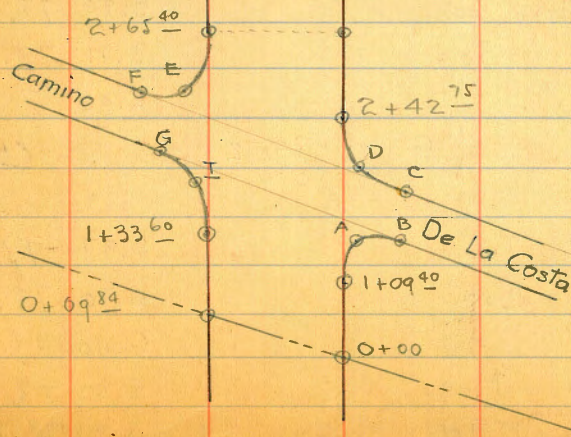
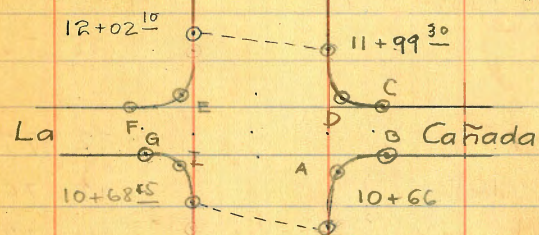

81.04

Sta.	+	H.I.	-	Elev.
20+00				
W. Curb Top			4.34	76.70
✓ Bottom			5.10	75.94
ϕ			4.34	76.70
E. Curb Bottom			4.98	76.06
✓ Top			4.25	76.79
20+50				
E. Curb Top			3.72	77.32
✓ Bottom			4.42	76.62
ϕ			3.72	77.32
W. Curb Bottom			4.46	76.58
✓ Top			3.72	77.32
21+00				
W. Curb Top			3.06	77.98
✓ Bottom			3.81	77.23
ϕ			3.14	77.90
E. Curb Bottom			3.90	77.14
✓ Top			3.11	77.94
T.P.			2.46	78.58
	6.14	84.72 ✓		<u>84.72</u>
21+67 ²⁵				
E. Curb Top			5.97	78.75
✓ Bottom			6.70	78.02
ϕ			6.00	78.72
W. Curb Bottom			6.63	78.09
✓ Top			5.91	78.81

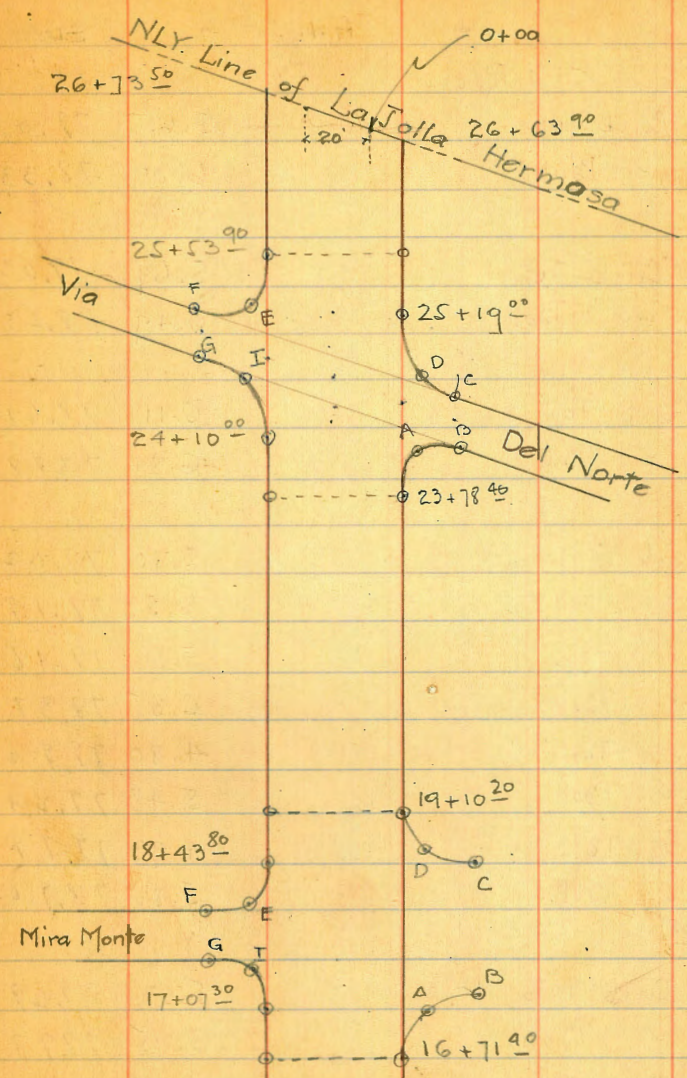

84.72

84.72
Elev.

Sta	+	H.I.	-	Elev.
21+89 ⁵⁰	Bird Rock			
	W. Curb Top		5.65	79.07
	✓ Bot.		6.39	78.33
"I"				
	W. Curb Top		5.69	79.03
	✓ Bot.		6.49	78.23
"G"				
	Curb Top		6.11	78.61
	✓ Bot.		6.84	77.88
"A"				
	Curb Top		5.70	79.02
	✓ Bot.		6.53	78.19
"B"				
	✓ Top		5.56	79.16
	✓ Bot.		6.35	78.37
"C"				
	✓ Top		4.80	79.92
	✓ Bot.		5.48	79.24
"D"				
	✓ Top		4.93	79.79
	✓ Bot.		5.82	78.90
22+49 ³⁵				
	E. Curb Top		5.03	79.69
	✓ Bot.		5.75	78.97
"F"				
	Curb Top		5.35	79.37
	✓ Bot.		6.22	78.50
"E"				
	Curb Top		5.16	79.56
	✓ Bot.		5.94	78.78

Sta	+	H.I.	-	Elev.
22+73 ⁰⁰				
	W. Curb Top		4.93	79.79
	✓ Bot.		5.77	78.95
	♀		5.05	79.67
	E. Curb Bot.		5.74	78.98
	✓ Top		4.92	79.80
	T.P.		2.59	82.13
		2.75	84.88	
	S.W. B.P. Bird Rock & La Jolla	79.06	5.80	79.08
				79.06
		5.80	84.86	<u>84.86</u>
23+00				
	E. Curb Top		4.90	79.96
	✓ Bot.		5.73	79.13
	♀		5.01	79.85
	W. Curb Bot.		5.81	79.05
	✓ Top		5.03	79.83
23+50				
	W. Curb Top		4.80	80.06
	✓ Bot.		5.60	79.26
	♀		4.88	79.98
	E. Curb Bot.		5.52	79.34
	✓ Top		4.77	80.09

84.86

12
84.86
Elev.

Sta.	+	H.I.	-	Elev.
24+00				
E. Curb Top			4.79	80.07
✓ Bott.			5.55	79.31
φ			4.96	79.96
W. Curb Bott.			5.62	79.24
✓ Top			4.87	79.99

Sta.	+	H.I.	-	Elev.
26+00				
E. Curb Top			6.45	78.41
✓ Bott.			7.27	77.59
φ			6.61	78.25
W. Curb Bott.			7.35	77.51
✓ Top			6.55	78.31

24+50				
W. Curb Top			5.21	79.65
✓ Bott.			5.97	78.89
φ			5.30	79.56
E. Curb Bott.			5.88	78.98
✓ Top			5.13	79.73

26+50				
W. Curb Top			6.98	77.88
✓ Bott.			7.75	77.11
φ			7.10	77.76
E. Curb Bott.			7.68	77.18
✓ Top			6.95	77.91

25+00				
E. Curb Top			5.55	79.31
✓ Bott.			6.37	78.49
φ			5.75	79.11
W. Curb Bott.			6.38	78.48
✓ Top			5.70	79.16

27+00				
E. Curb Top			7.45	77.41
✓ Bott.			8.14	76.72
φ			7.55	77.31
W. Curb Bott.			8.28	76.58
✓ Top			7.50	77.36
T.P.			7.28	77.58 ✓

25+50				
W. Curb Top			6.13	78.73
✓ Bott.			6.87	77.99
φ			6.21	78.65
E. Curb Bott.			6.75	78.11
✓ Top			6.04	78.82

	1.70	79.28 ✓		<u>79.28</u>
27+50				
W. Curb Top			2.35	76.93
✓ Bott.			3.15	76.13
φ			2.42	76.86
E. Curb Bott.			3.01	76.27
✓ Top			2.31	76.97

79.28

13

79.28
Elev.

Sta	+	H.I.	-	Elev.	Sta	+	H.I.	-	Elev.
28+00					"A" Curb Top			4.64	74.64
E. Curb Top			2.75	76.53	✓ Bottom			5.19	74.09
✓ Bottom			3.44	75.84	"B" ✓ Top			4.21	75.07
♀			2.84	76.44	✓ Bottom			4.58	74.70
W. Curb Bottom			3.64	75.64	"C" ✓ Top			5.24	74.04
✓ Top			2.88	76.40	✓ Bottom			5.66	73.62
28+53 ³⁵ = 0+09 ⁸⁴					"D" ✓ Top			6.00	73.28
W. Curb Top			3.46	75.82	✓ Bottom			6.53	72.75
✓ Bottom			3.93	75.35					
♀			3.36	75.92	E. Curb Top			6.66	72.62
E. Curb Bottom			3.68	75.60	✓ Bottom			7.24	72.04
✓ Top = 0+00			3.13	76.15	♀			6.81	72.47
28+43 ⁸⁵					1+33 ⁶⁰ Camino de la Costa				
0+50					W. Curb Top			5.58	73.70
E. Curb Top			4.02	75.26	✓ Bottom			6.10	73.18
✓ Bottom			4.65	74.63	♀			5.51	73.77
♀			4.06	75.22	"I." Curb Top			6.93	72.35
W. Curb Bottom			4.61	74.67	✓ Bottom			7.42	71.86
✓ Top			4.14	75.14	"G" ✓ Top			8.35	70.93
1+09 ⁴⁰					✓ Bottom			8.92	70.36
W. Curb Top			5.16	74.12	"F" ✓ Top			9.95	69.33
✓ Bottom			5.64	73.64	✓ Bottom			10.36	68.92
♀			5.09	74.19	"E" ✓ Top			8.43	70.85
E. Curb Bottom			5.52	73.76	✓ Bottom			8.89	70.39
✓ Top			4.90	74.38					

Sta.	+	H.I.	-	<u>79.28</u> Elev.	Sta.	+	H.I.	-	<u>79.28</u> Elev.
2+65 ⁴⁰					4+50				
W. Curb Top			7.04	72.24	W. Curb Top			7.43	71.85
✓ Bott.			7.52	71.76	✓ Bott.			7.94	71.34
φ			6.97	72.31	φ			7.38	71.90
E. Curb Bott.			7.41	71.87	E. Curb Bott.			7.76	71.52
✓ Top			6.81	72.47	✓ Top			7.11	72.17
					T.P.			6.97	72.31
3+00						6.31	78.62 ✓		<u>78.62</u>
E. Curb Top			7.04	72.24					
✓ Bott.			7.65	71.63	5+00				
φ			7.16	72.12	E. Curb Top			6.12	72.50
W. Curb Bott.			7.72	71.56	✓ Bott.			6.78	71.84
✓ Top			7.24	72.04	φ			6.38	72.24
					W. Curb Bott.			6.85	71.77
3+50					✓ Top			6.40	72.22
W. Curb Top			7.48	71.80					
✓ Bott.			7.98	71.30	5+50				
φ			7.45	71.83	W. Curb Top			6.00	72.62
E. Curb Bott.			7.91	71.37	✓ Bott.			6.50	72.12
✓ Top			7.29	71.99	φ			6.05	72.57
					E. Curb Bott.			6.50	72.12
4+00					✓ Top			5.85	72.77
E. Curb Top			7.39	71.89					
✓ Bott.			8.16	71.12	6+00				
φ			7.65	71.63	E. Curb Top			5.53	73.09
W. Curb Bott.			8.10	71.18	✓ Bott.			6.17	72.45
✓ Top			7.65	71.63	φ			5.69	72.93
					W. Curb Bott.			6.11	72.51
					✓ Top			5.63	72.99

78.62

78.62

Sta + H.I. - Eler.

Sta + H.I. - Eler.

6+50

W. Curb Top 5.34 73.28

✓ Bolt 5.80 72.82

ϕ 5.33 73.29

E. Curb Bolt 5.73 72.89

✓ Top 5.12 73.50

8+50

W. Curb Top 3.97 74.65

✓ Bolt 4.49 74.13

ϕ 3.93 74.69

E. Curb Bolt 4.26 74.36

✓ Top 3.60 75.02

7+00

E. Curb Top 4.79 73.83

✓ Bolt 5.42 73.20

ϕ 4.99 73.63

W. Curb Bolt 5.38 73.24

✓ Top 4.93 73.69

9+00

E. Curb Top 3.38 75.24

✓ Bolt 4.00 74.62

ϕ 3.55 75.07

W. Curb Bolt 4.22 74.40

✓ Top 3.74 74.88

7+50

W. Curb Top 4.52 74.10

✓ Bolt 5.06 73.56

ϕ 4.65 73.97

E. Curb Bolt 4.91 73.71

✓ Top 4.25 74.37

9+50

W. Curb Top 3.50 75.12

✓ Bolt 4.03 74.59

ϕ 3.38 75.24

E. Curb Bolt 3.83 74.79

✓ Top 3.15 75.47

8+00

E. Curb Top 3.87 74.75

✓ Bolt 4.53 74.09

ϕ 4.28 74.34

W. Curb Bolt 4.64 73.28

✓ Top 4.15 74.47

10+00

E. Curb Top 2.97 75.45

✓ Bolt 3.61 75.01

ϕ 3.17 75.45

W. Curb Bolt 3.80 74.82

✓ Top 3.31 75.31

T.P. 3.13 75.49

STA	+	H.I.	-	<u>80.86</u> Elev
	5.37	80.86	✓	
10+68 ¹⁵ La Canada				
W. Curb Top		5.25		75.61
✓ Bolt.		5.78		75.08
♀		5.13		75.73
10+66 E. Curb Bolt.		5.53		75.33
✓ Top		4.94		75.92
10 "A" Curb Top		4.20		76.66
✓ Bolt.		4.77		76.09
"B" ✓ Top		3.35		77.51
✓ Bolt.		3.80		77.06
"C" ✓ Top		3.43		77.43
✓ Bolt.		3.94		76.92
"D" ✓ Top		4.01		76.85
✓ Bolt.		4.61		76.25
11+99 ³⁰				
E. Curb Top		4.39		76.47
✓ Bolt.		4.96		75.90
♀		4.49		76.37
12+02 ¹⁰ W. Curb Bolt.		5.15		75.71
✓ Top		4.68		76.18
"E" Curb Top		5.69		75.17
✓ Bolt.		6.11		74.75
"F" ✓ Top		6.96		73.90
✓ Bolt.		7.40		73.46

STA	+	H.I.	-	<u>80.86</u> Elev
"G" Curb Top		6.97		73.89
✓ Bolt.		7.35		73.51
"I" ✓ Top		5.98		74.88
✓ Bolt.		6.48		74.38
12+50				
W. Curb Top		4.54		76.32
✓ Bolt.		5.01		75.85
♀		4.28		76.58
E. Curb Bolt.		4.89		75.97
✓ Top		4.32		76.54
13+00				
E. Curb Top		4.12		76.74
✓ Bolt.		4.72		76.14
♀		4.08		76.78
W. Curb Bolt.		4.82		76.04
✓ Top		4.35		76.51
13+50				
W. Curb Top		4.14		76.72
✓ Bolt.		4.60		76.26
♀		3.88		76.98
E. Curb Bolt.		4.61		76.25
✓ Top		3.97		76.89

STA	+	H.I.	-	80.86 Elev.
14+00				
E. Curb Top			3.74	77.12
✓ Bott.			4.35	76.57
φ			3.65	77.21
W. Curb Bott.			4.42	76.24
✓ Top			3.95	76.91
14+50				
W. Curb Top			3.71	77.15
✓ Bott.			4.16	76.70
φ			3.38	77.48
E. Curb Bott.			4.21	76.65
✓ Top			3.57	77.29
15+00				
E. Curb Top			3.40	77.46
✓ Bott.			4.00	76.86
φ			3.21	77.65
W. Curb Bott.			3.98	76.88
✓ Top			3.52	77.34
15+50				
W. Curb Top			3.36	77.50
✓ Bott.			3.84	77.02
φ			2.97	77.89
E. Curb Bott.			3.81	77.05
✓ Top			3.19	77.67
T.P.			3.24	77.62

STA	+	H.I.	-	82.67 Elev.
16+00	5.05	82.67		
E. Curb Top			4.80	77.87
✓ Bott.			5.40	77.27
φ			4.57	78.10
W. Curb Bott.			5.47	77.20
✓ Top			5.01	77.66
16+71 ⁴⁰				
W. Curb Top			4.75	77.92
✓ Bott.			5.25	77.42
φ			4.51	78.16
E. Curb Bott.			5.21	77.46
✓ Top			4.56	78.11
"A" Curb Top			4.19	78.48
✓ Bott.			4.85	77.82
"B" ✓ Top			3.35	79.32
✓ Bott.			4.98	77.69
"C" ✓ Top			3.25	79.42
✓ Bott.			3.84	78.83
"D" ✓ Top			3.77	78.90
✓ Bott.			4.38	78.29
19+10 ²⁰				
E. Curb Top			4.10	78.57
✓ Bott.			4.71	77.96
φ			4.25	78.42
W. Curb Bott.			4.81	77.86
✓ Top			4.35	78.32

Page 2/10

82.67

83.42 18

STA	+	H.I.	-	Elev.
18+43 ⁸⁰				
W. Curb Top			4.38	78.29
✓ Bolt.			4.88	77.79
"E" Curb Top			4.77	77.90
✓ Bolt.			5.25	77.42
"F" ✓ Top			5.48	77.19
✓ Bolt.			5.92	76.75
"G" ✓ Top			5.47	77.20
✓ Bolt.			5.93	76.74
"I" ✓ Top			4.95	77.72
✓ Bolt.			5.43	77.24

17+07 ³⁰ Mira Monte				
W. Curb Top			4.64	78.03
✓ Bolt.			5.11	77.56

19+50				
W. Curb Top			4.31	78.36
✓ Bolt.			4.79	77.88
♀			4.20	78.47
E. Curb Bolt.			4.73	77.94
✓ Top			4.03	78.64

20+00				
E. Curb Top			4.01	78.66
✓ Bolt.			4.67	78.00
♀			4.13	78.54
W. Curb Bolt.			4.75	77.92
✓ Top			4.31	78.36

STA	+	H.I.	-	Elev.
T.P.			4.16	78.51 ✓

20+50				
W. Curb Top	4.91	83.42		

W. Curb Top			4.82	78.60
✓ Bolt.			5.26	78.16
♀			4.75	78.67
E. Curb Bolt.			5.27	78.15
✓ Top			4.62	78.80

21+00				
E. Curb Top			4.55	78.97
✓ Bolt.			5.23	78.19
♀			4.69	78.73
W. Curb Bolt.			5.22	78.20
✓ Top			4.79	78.63

21+50				
W. Curb Top			4.71	78.71
✓ Bolt.			5.16	78.26
♀			4.65	78.77
E. Curb Bolt.			5.13	78.29
✓ Top			4.45	78.97

22+00				
E. Curb Top			4.42	79.00
✓ Bolt.			5.05	78.37
♀			4.55	78.87
W. Curb Bolt.			5.09	78.33
✓ Top			4.66	78.76

83.42

83.42

STA	+	H.I.	-	Elev
22+50				
W. Curb Top			4.53	78.89
✓ Bottom			4.93	78.49
⊕			4.50	78.92
E. Curb Bottom			5.01	78.41
✓ Top			4.38	79.04
23+78 ⁴⁰				
E. Curb Top			4.14	79.28
✓ Bottom			4.78	78.64
⊕			4.41	79.01
W. Curb Bottom			4.85	78.57
✓ Top			4.41	79.01
24+10 ⁰⁰ Via del Norte				
W. Curb Top			4.40	79.02
✓ Bottom			4.84	78.58
"I" Curb Top			4.73	78.69
✓ Bottom			5.19	78.23
"G" ✓ Top			5.15	78.27
✓ Bottom			5.60	77.82
"F" ✓ Top			5.14	78.28
✓ Bottom			5.57	77.85
"E" ✓ Top			4.48	78.94
✓ Bottom			4.90	78.52

STA	+	H.I.	-	Elev
25+53 ⁹⁰				
W. Curb Top			3.85	79.77
✓ Bottom			4.27	79.15
⊕			3.72	79.70
E. Curb Bottom			4.15	79.27
✓ Top			3.55	79.87
25+19 ⁰⁰				
E. Curb Top			3.61	79.81
✓ Bottom			4.21	79.21
"D" Curb Top			3.09	80.33
✓ Bottom			3.70	79.72
"C" ✓ Top			2.45	80.97
✓ Bottom			2.95	80.47
"B" ✓ Top			2.39	81.03
✓ Bottom			2.81	80.61
"A" ✓ Top			3.26	80.16
✓ Bottom			3.76	79.66
26+00				
E. Curb Top			3.37	80.05
✓ Bottom			4.00	79.42
⊕			3.47	79.95
W. Curb Bottom			4.04	79.38
✓ Top			3.60	79.82
T.P.			3.20	80.22

6.26 86.48 ✓

86.48

86.48

Elev

STA + H.I. - Elev.

STA + H.I. - Elev

0+00 Intersection Nly. Line La Jolla Hermosa & E.L. Pavement

E.L. Pavement

5.76 80.72

W.L. 7.25 79.23

+20'

5.60 80.88

+25 W.L. Side Walk 6.29 80.19

E.L.

4.80 81.68

+30 W. Curb Top 6.38 80.10

1+50

✓ Bott. 6.84 79.64

E.L.

4.3 82.18

+40 W.L. Pavement 6.35 80.13

+20'

5.5 80.98

+50 ♣ " 6.24 80.24

E.L. Pavement

5.44 81.04

+60 E.L. " 6.35 80.13

♣ "

5.33 81.15

+70 E. Curb Bott. 6.83 79.65

W.L. "

5.42 81.06

✓ Top 6.25 80.23

+15'

6.90 79.58

+75 E.L. Side Walk 6.12 80.36

+20'

6.40 80.08

+100 E.L. 5.10 81.38

W.L.

6.50 79.98

0+50 On Radial Line

2+00

E.L. 4.8 81.68

W.L.

6.6 79.88

+20' 5.3 81.18

+20'

6.2 80.28

+40' E.L. Pavement 6.08 80.40

+25'

6.8 79.68

+50' ♣ " 5.96 80.52

W.L. Pavement

5.10 81.32

+60' W.L. " 6.05 80.43

♣ "

5.05 81.43

+80' 7.2 79.28

E.L. "

5.15 81.33

+100 W.L. 7.0 79.48

+20'

5.0 81.48

1+00

E.L.

4.2 82.28

W.L. 6.5 79.98

+20' 6.5 79.98

W.L. Pavement 5.76 80.72

♣ " 5.66 80.82

STA	+	H.I.	-	<u>86.48</u> Elev.
2+50				
E.L.			4.5	81.98
+20'			5.0	81.48
E.L. Pavement			4.85	81.63
¢ "			4.73	81.75
W.L. "			4.79	81.69
+15'			6.5	79.98
+20'			6.3	80.18
W.L.			6.6	79.88
3+00				
W.L.			6.8	79.68
+20'			6.2	80.28
W.L. Pavement			4.53	81.95
¢ "			4.43	82.05
E.L. "			4.54	81.94
+20'			5.4	81.08
E.L.			4.8	81.68
3+50				
E.L.			4.4	82.08
+20'			5.5	80.98
E.L. Pav.			4.26	82.22
¢ "			4.14	82.34
W.L. "			4.26	82.22
+20'			5.9	80.58
W.L.			6.1	80.38

STA	+	H.I.	-	<u>86.48</u> Elev.
4+00				
W.L.			5.5	80.98
+20'			5.0	81.48
W.L. Pav.			3.96	82.52
¢ "			3.86	82.62
E.L. "			3.92	82.56
+20'			4.7	81.58
E.L.			3.8	82.68
4+50				
E.L.			2.7	83.78
+20'			3.0	83.48
E.L. Pav.			3.65	82.83
¢ "			3.53	82.95
W.L. "			3.65	82.83
+20'			4.0	81.88
W.L.			4.8	81.68
5+00				
W.L.			4.1	82.38
+20'			4.0	82.48
+25'			3.0	83.48
+30'			3.6	82.88
W.L. Pavem.			3.33	83.15
¢ "			3.21	83.27
E.L. "			3.36	83.12
+20'			2.2	84.28

STA	+	H.I.	-	Elev.
E.L.			1.8	84.68
T.P.			0.2	86.28
5+50	1.63	87.91 ✓		<u>87.91</u>
E.L.			2.5	85.41
+20'			2.0	84.91
+28'			3.3	84.61
+31'			4.0	83.91
E.L. Parament			4.45	83.46
⊕ "			4.37	83.54
W.L. "			4.52	83.39
+12'			4.7	83.21
+14'			4.3	83.61
+20'			4.4	83.51
W.L.			5.3	82.61
6+00				
W.L.			5.5	82.41
+20'			4.4	83.51
W.L. Parament			4.36	83.55
⊕ "			4.25	83.66
E.L. "			4.34	83.57
+20'			3.20	84.71
E.L.			2.70	85.21

STA	+	H.I.	-	Elev.
6+50				
E.L.			3.0	84.91
+20'			3.5	84.41
+25'			3.7	84.21
+26'			4.2	83.71
E.L. Parament			4.53	83.38
⊕ "			4.40	83.51
W.L. "			4.51	83.40
+20'			4.9	83.01
W.L.			5.4	82.57
7+00				
W.L.			5.8	82.11
+20'			5.4	82.51
+28'			4.9	83.01
+29'			5.4	82.57
W.L. Parament			5.03	82.88
⊕ "			4.91	83.00
E.L. "			5.02	82.89
+12'			4.9	83.01
+20'			3.8	84.11
E.L.			3.8	84.11

STA	+	H.L.	-	<u>87.91</u> Elev.
7+50				
E.L.			4.3	83.57
+20'			4.7	83.21
+28'			5.4	82.51
E.L. Pavement			5.71	82.20
☐ "			5.61	82.30
W.L. "			5.69	82.22
+20'			6.2	81.71
W.L.			6.8	81.11
8+00				
W.L.			8.3	79.61
+20'			7.7	80.21
W.L. Pavement			6.48	81.43
☐ "			6.38	81.63
E.L. "			6.45	81.46
+12'			6.40	81.51
+12'			6.0	81.91
+20'			5.7	82.21
E.L.			5.1	82.81
T.P.			6.46	81.45
	2.09	83.54		<u>83.54</u>
8+50				
E.L.			1.7	81.84
+20'			2.7	80.84
E.L. Pavement			2.85	80.69

STA	+	H.L.	-	<u>83.54</u> Elev.
☐ Pavement			2.73	80.81
W.L. "			2.84	80.70
+10'			3.4	80.14
+15'			4.6	78.94
+20'			4.7	78.84
W.L.			5.0	77.94
9+00				
W.L.			7.2	76.34
+20'			6.0	77.54
+25'			6.1	77.44
+30'			4.7	79.84
W.L. Pavement			3.55	79.99
☐ "			3.46	80.08
E.L. "			3.60	79.94
+20'			3.50	80.04
E.L.			3.20	80.34
9+50				
E.L.			4.0	79.54
+20'			4.2	79.34
E.L. Pavement			4.35	79.19
☐ "			4.23	79.31
W.L. "			4.34	79.20
+12'			5.3	78.24
+15'			6.0	76.94
+20'			6.9	76.64
W.L.			7.2	76.34

83.54

82.33

STA	+	H.I.	-	Elev.
10+00				
W.L.			7.8	75.74
+20'			7.3	76.24
+25'			7.1	76.44
+29'			5.8	77.74
W.L. Pavement			4.94	78.60
☒ "			4.85	78.69
E.L.			4.97	78.57
+20'			5.0	78.54
E.L.			4.6	78.94

STA	+	H.I.	-	Elev.
11+00				
W.L.			7.1	75.23
+20'			6.80	75.53
+25'			6.90	75.43
+30'			5.40	76.93
W.L. Pavement			4.25	78.08
☒ "			4.15	78.18
E.L.			4.27	78.06
+13'			3.40	78.93
+20'			4.80	77.53
E.L.			4.70	77.63

STA	+	H.I.	-	Elev.
10+50				
E.L.			5.4	78.14
+20'			5.6	77.94
+18'			4.9	78.64
E.L. Pavement			5.21	78.33
☒ "			5.13	78.41
W.L.			5.21	78.33
+11'			6.0	77.54
+15'			7.2	76.34
+20'			7.4	76.14
W.L.			8.2	75.34
T.P.			6.03	77.51

STA	+	H.I.	-	Elev.
11+50				
E.L.			4.80	77.53
+20'			5.00	77.33
E.L. Pavement			4.49	77.84
☒ "			4.38	77.95
W.L.			4.47	77.86
+15'			5.20	77.13
+20'			6.30	76.03
W.L.			7.20	75.13
12+00				
W.L.			7.00	75.33
+20'			6.20	76.13
+27'			7.30	75.03
+31'			5.20	77.13

4.82 82.33 ✓

STA	+	H.L.	-	Elev.
W.L. Pavement		4.69		77.64
¢ "		4.61		77.72
E.L. "		4.72		77.61
+20'		4.60		77.73
E.L.		4.60		77.73
12+34.30		S.L. Pavement Palomar		
E.L. Pavement		3.96		78.37
+20'		4.80		77.53
E.L. Pavement		4.85		77.48
¢ "		4.74		77.59
W.L. "		4.85		77.48
+20'		6.2		76.13
WE.L. Pavement		6.87		75.46
NE. B.P. Palomar	87.22 (Wrong)	4.03		78.30
Checked twice from SW. B.P. Bird Rock				
<u>79.06</u>				
NE. B.P. Palomar & La Jolla				78.30
	2.19	80.49		
NW. B.P. Gravilla & La Jolla	68.86	11.53		68.96
				68.86
	4.04	72.90		
0+00	Intersection of Gravilla & E.L. Pavement La Jolla Blvd.			
+39.85		1.70		71.20
+19.85		2.70		70.20
		3.26		69.64

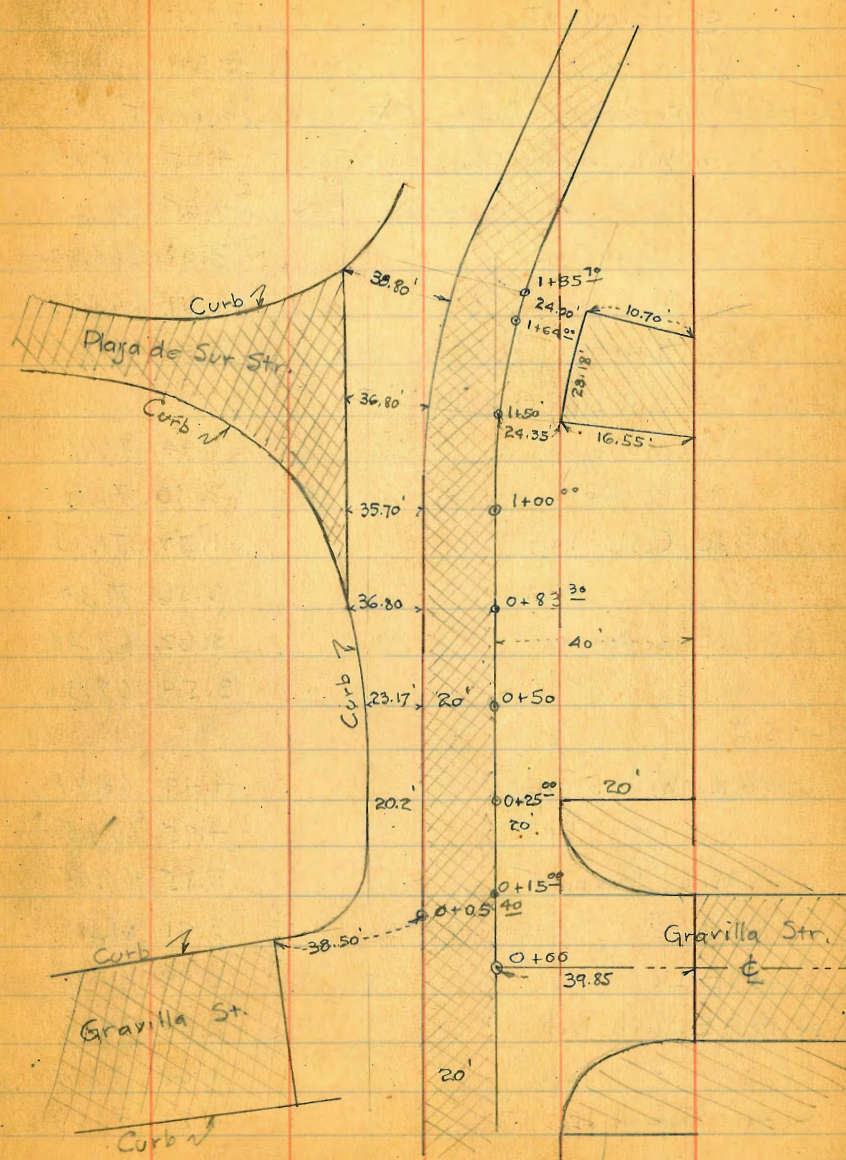

72.90

26

72.90

STA	+	H.I.	-	Elev.	STA	+	H.I.	-	Elev.
	⊥	Pavement	3.22	69.68	0+50				
	W.L.	"	3.31	69.59		E.L.		3.3	69.6
0+05 ⁴⁰		Intersection N. Curb Line Gravilla & W.L. Pavement				+25'		3.6	69.3
+38.50	W.L. La Jolla Blvd.	Curb Top	4.05	68.85		+30'		5.1	67.8
		✓ Bott.	4.65	68.25		E.L. Pavement		4.98	67.92
	Center	Curb Top	3.98	68.92		⊥ "		4.75	68.15
	✓	Bott.	4.37	68.53		W.L. "		4.59	68.31
	W.L.	Pavement	3.41	69.49		+23.17	W. Curb Bott. (Driveway)	6.0	66.9
0+15 ⁰⁰		N. Curb Line Gravilla			0+83 ³⁰				
	N. Curb	Top	1.44	71.46		+36.80	Curb Top	6.9	66.0
	✓	Bott.	2.10	70.86			✓ Bott.	7.79	65.11
	⊥	Curb Top	1.57	71.33		W.L. Pavement		5.66	67.24
	✓	Bott.	2.56	70.34		⊥ "		6.00	66.9
	E.L.	Pavement	3.62	69.28		E.L. "		6.41	66.49
	⊥	"	3.59	69.36		+15'		6.8	66.10
0+25 ⁰⁰						+16'		5.8	67.1
+20.2'	W. Curb	Top	4.49	68.41		E.L.		4.3	68.6
	✓	Bott.	4.95	67.95	1+00				
	W.L.	Pavement	3.85	69.05		E.L.		4.1	68.8
	⊥	"	3.91	68.99		+25'		5.9	67.0
	E.L.	"	3.99	68.91		+26'		7.4	65.5
+20'	E. Curb	Bott.	2.60	70.30		E.L. Pavement		7.07	65.83
	✓	Top	1.60	71.30		⊥ "		6.57	66.33
+40'	Top of	Side Walk	1.27	71.63		W.L. "		6.17	66.73
						+35.70		8.48	64.42

STA	+	H.I.	-	Elev.
1+50				72.90
+36.80			10.29	62.66
W.L. Pavement			7.70	65.20
☒			8.08	64.82
E.L.			8.68	64.22
+24.35 E. Curb Bott.			7.96	64.94
✓ Top			7.96	64.94
E.L. Side Walk			7.51	65.39
1+64 ⁰⁰				
E.L. Pavement			9.13	63.77
☒			8.64	64.26
W.L.			8.18	64.72
+38.80' W. Curb Bott.			10.84	62.06
✓ Top			10.29	62.61
1+85 ²⁰				
E.L. Side Walk			8.50	64.40
+10.70 E. Curb Top.			8.88	64.02
✓ Bott.			9.40	63.50
E.L. Pavement			9.85	63.05
☒			9.37	63.53
W.L.			8.91	63.99
+48'			10.10	62.80
+54'			13.0	59.90
T.P.			10.12	62.78 ✓
	5.25	68.08		

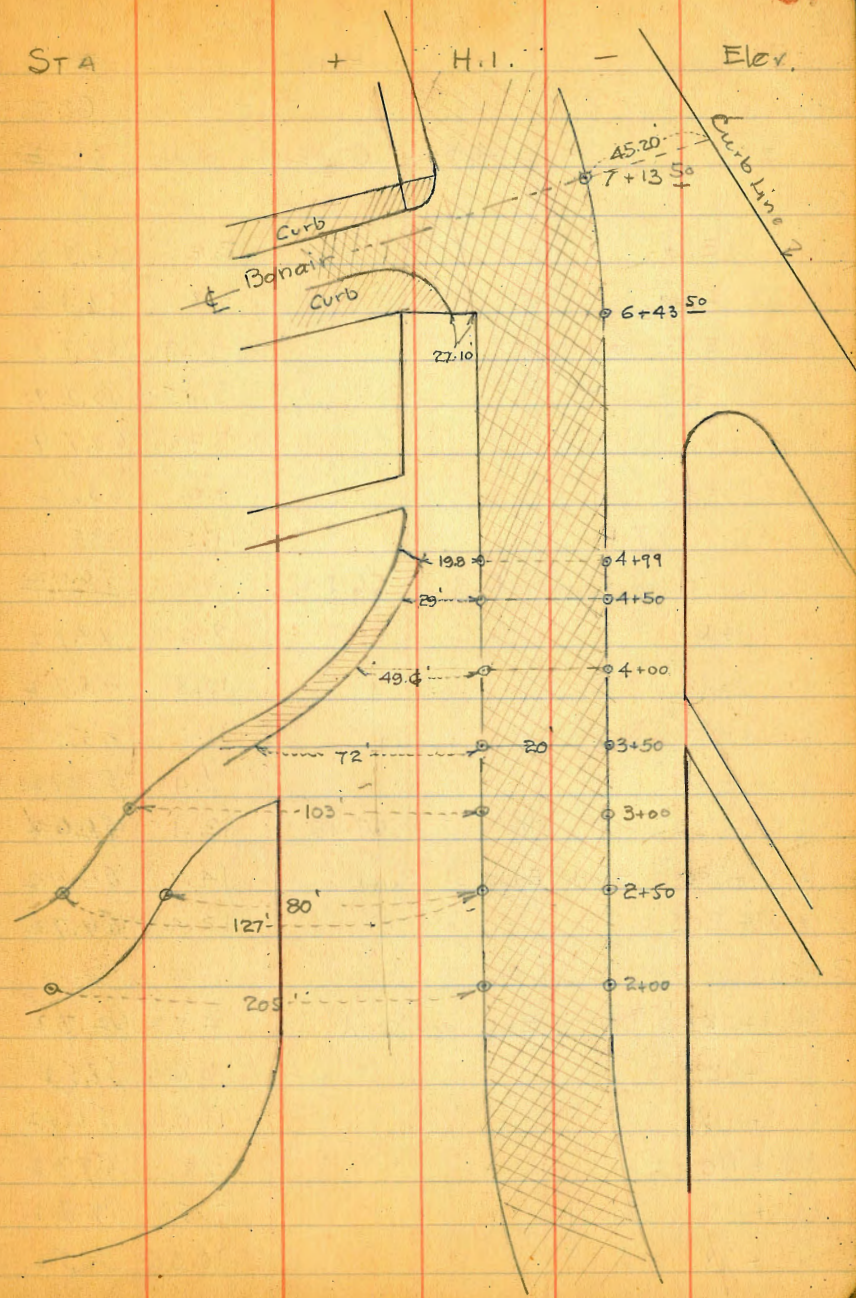

67.12

78.00

29

STA	+	H.I.	-	Elev.	STA	+	H.I.	-	Elev.
+98'			6.1	61.02	4+50				
+103'	North Edge Road		4.0	63.12	+29'	W. Curb Top		11.83	66.17
3+50'						✓ Bott.		12.40	65.60
+72'	N. Curb Top		4.45	62.67		W.L. Pavement		11.42	66.58
	✓ Bott.		4.80	62.32		☐ "		11.28	66.72
+18'			3.50	63.62		E.L. "		11.38	66.62
+16'			6.5	60.62	+12'			11.8	66.20
+12'			4.6	62.52	+14'			11.2	66.80
+8'			2.6	64.52	+17'			11.7	66.30
	W.L. Pavement		2.79	64.33	+28'			16.6	61.40
	☐ "		2.74	64.38	+40'			16.6	61.40
	E.L. "		3.00	64.12	4+99				
+20'			3.1	64.02	+46'			12.6	65.40
+40'			11.6	55.52	+38'			9.5	68.50
	T.P.		0.9	66.22	+20'			10.0	68.00
	11.79	78.01 ✓		<u>78.00</u>	+10'			10.4	67.60
4+00						E.L. Pavement		10.13	67.87
+48'			13.5	64.5		☐ "		10.04	67.96
+40'			12.6	55.4		W.L. "		10.04	67.96
+20'			13.2	64.8	+19.8'	W. Curb Bott.		10.40	67.60
	E.L. Pavement		12.66	65.34		✓ Top		9.95	68.05
	☐ "		12.60	65.40	5+50				
	W.L. "		12.66	65.34	+40'			8.1	69.90
+49.6'	W. Curb Top		13.5	64.50	+20'			8.6	69.40
	✓ Bott.		14.3	63.70	+19'			9.9	68.10

STA	+	H.I.	-	Elev.
				78.00
+15'			8.9	69.10
W.L. Pavement			8.65	69.35
¢			8.53	69.47
E.L.			8.68	69.32
+12'			8.8	69.20
+13'			8.2	69.80
+20'			8.4	69.60
+40'			7.2	70.80
6+00				
+40'			7.1	70.90
+20'			6.9	71.10
E.L. Pavement			7.20	70.80
¢			7.24	70.76
W.L.			7.58	70.42
+14'			7.7	70.30
+17'			8.5	69.50
+18'			7.3	70.70
+40'			5.7	72.30
6+43 ⁵⁰				
+27.10	W. Curb Top		6.42	71.58
	✓ Booth.		6.94	71.06
+10'			6.86	71.14
W.L. Pavement			6.71	71.29
¢			6.31	71.69
E.L.			5.76	72.24

STA	+	H.I.	-	Elev.
				78.00 ³⁰
+11'			5.7	72.30
+12'			5.2	72.80
+20'			4.9	73.10
+40'			4.6	73.40
7+13 ⁵⁰				
+45.20	E. Curb Top		2.47	75.53
	✓ Booth.		3.00	75.00
+34'			3.15	74.85
	E.L. Pavement		3.6	74.40
+12.2'			4.44	73.56
+24.4'			5.34	72.66
+33.4'			5.57	72.43
+47.4'			5.39	72.61
For Stations & Sketch see Pg. 78				
"A"	Curb Top		5.02	72.98
	✓ Booth.		5.61	72.39
"B"	✓ Top		4.66	73.34
	✓ Booth.		5.27	72.73
"C"	✓ Top		4.07	73.93
	✓ Booth.		4.80	73.20
"D"	✓ Top		4.0	74.00
	✓ Booth.		4.7	73.30
	T.P. Fire Hydrant		2.10	75.91
		5.31	81.22	
"E"	End of Island		6.51	74.71

STA	+	H.I.	-	81.22 Elev.
"F"	N. End of Island		6.57	74.65
0+00	N.W. Cor La Jolla Blvd & Bonair		6.74	74.48
	+10' Curb Top		7.22	74.00
	✓ Bott.		7.93	73.29
	+20 ¹⁵ & La Jolla Blvd.		7.13	74.09
	+30 ³⁰ E.L. " "		6.39	74.83
	+61 ⁸⁰ E. Curb " " or Tyrion Str.			
	Curb Bott. Driveway		6.02	75.20
	✓ Top & S.W.		5.34	75.88
0+6 ³⁵			6.70	74.52
	+12' W.L. Pavement		7.81	73.41
0+24 ⁶⁵			6.50	74.72
	+19' W.L. Pavement		7.53	73.49
	+29' & " "		6.68	74.54
	+39' E.L. " "		6.01	75.21
	+61 ¹⁰ E. Curb Bott. } E.L. La Jolla Blvd.	5.80	75.42	
	✓ Top	5.25	75.97	
Beginning of Previous Stationing				
7+98	S.L. Alley			
	W.L.		6.25	74.97
	+22' W.L. Pavement		7.11	74.11
	& " "		6.24	74.98
	E.L. " "		5.55	75.67
	+18 ⁶⁰ E. Curb Bott.		5.30	75.92
	✓ Top		4.93	76.29

Sta	+	H.I.	-	81.22 Elev.
8+18	N.L. Alley			
	W.L.		5.9	76.32
	+22' W.L. Pavement		6.69	74.53
	& " "		6.04	75.18
	E.L. " "		5.48	75.74
	+12' E. Curb Bott.		5.2	76.0
	✓ Top		4.8	76.4
8+50				
	E. Curb Top		4.72	76.50
	✓ Bott.		5.1	76.1
	+12' E.L. Pavement		5.22	76.00
	& " "		5.68	75.54
	W.L. " "		6.18	75.04
	+22' W.L.		5.4	75.8
9+00				
	+22' W.L.		4.2	77.0
	+7'		3.7	77.5
	+5'		5.6	75.6
	W.L. Pavement		5.39	75.83
	& " "		5.06	76.16
	E.L. " "		4.96	76.26
	+12' E. Curb Bott.		4.90	76.32
	✓ Top		4.30	76.92

8/22

8/22

STA	+	H.I.	-	Elev.
9+50				
+12'	E. Curb Top		3.98	77.24
	✓ Bott.		4.25	76.97
	E.L. Pavement		4.45	76.77
	♀ "		4.56	76.66
	W.L. "		4.73	76.49
+7'			4.70	76.52
+10'			2.9	78.3
+22'			3.8	77.4
9+96 ⁵⁰				
	W.L. Side Walk		3.98	77.24
+10'	W. Curb Top		4.12	77.10
	✓ Bott.		4.2	77.02
+22'	W.L. Pavent		4.22	77.00
	♀ "		4.10	77.12
	E.L. "		4.19	77.03
+12'	E. Curb Bott.		4.0	77.22
	✓ Top		3.67	77.55
10+23 ⁷⁰	E.L. Nautilus = 0+00			
	E. Curb Top		3.47	77.75
	✓ Bott. Pavement		3.83	77.39
+12'	E.L. Pavement		3.7	77.52
	♀ "		3.78	77.44
	W.L. "		3.84	77.40

STA	+	H.I.	-	Elev.
+12'	W. Curb Bott. Pavement		4.32	76.90
	✓ Top		3.83	77.39
+22'	W.L.		3.94	77.28
	F.P.		4.08	77.14
		5.94	83.08	✓
0+60	N.L. Nautilus			
+22.35'	W.L.		5.15	77.93
+12.35'	W. Curb Top		5.15	77.93
	✓ Bott.		5.36	77.72
	W.L. Pavement		5.13	77.95
	♀ "		5.06	78.02
	E.L. "		5.13	77.95
+12.35'	E. Curb Bott.		5.36	77.72
	✓ Top		4.78	78.30
+22.35'	E.L.		4.60	78.48
1+00				
	E.L.		3.90	79.18
+2'	S.W.		4.45	78.63
	E. Curb Top.		4.67	78.41
	✓ Bott.		4.90	78.18
	E.L. Pavement		4.97	78.11
	♀ "		4.90	78.18
	W.L. "		5.03	78.05
	W. Curb		4.70	78.38
	W.L.		4.70	78.38

STA	+	H.I.	-	Elev.
1+50		83.08		
W.L.			4.40	78.28
W. Curb			4.40	78.68
W.L. Pavement			4.79	78.29
☒ "			4.70	78.38
E.L. "			4.81	78.27
E. Curb Bott.			4.60	78.48
✓ Top			4.51	78.57
E.L.			4.30	78.78
1+85	S.L. Alleg			
W.L. Pavement			4.71	78.37
W. Curb			4.40	78.68
W.L.			4.40	78.68
2+04 ⁵⁰				
W.L.			4.40	78.68
W. Curb			4.50	78.58
W.L. Pavement			4.63	78.45
☒ "			4.49	78.59
E.L. "			4.63	78.45
E. Curb Bott.			4.30	78.78
✓ Top			4.24	78.84
E.L.			3.96	78.12
2+50				
E.L.			3.91	79.17
E. Curb Top			4.12	78.96

STA	+	H.I.	-	Elev.
		83.08	4.20	78.88
E. Curb Bott.			4.47	78.61
E.L. Pavement			4.29	78.79
☒ "			4.39	78.69
W.L. "			4.20	78.88
W. Curb			4.30	78.78
3+00				
W.L.			4.20	78.88
W. Curb			4.00	79.08
W.L. Pavement			4.22	78.86
☒ "			4.10	78.98
E.L. "			4.23	78.85
E. Curb Bott.			4.25	78.82
✓ Top			3.96	79.12
E.L.			3.69	79.39
3+39 ⁵⁰	S.L. Westbourne str.			
W.L. Pavement			4.17	78.91
W. Curb			3.9	79.18
W.L.			3.9	79.18
3+49 ⁵⁰	S. Curb Westbourne			
W.L.			4.0	79.08
W. Curb			4.0	79.08
W.L. Pavement			4.2	78.88
3+59 ⁵⁰	S 1/4 Westbourne			
W.L. Pavement			4.18	78.90

STA	+	H.I.	-	Elev.
W. Curb		83.08	4.0	79.08
W.L.			4.2	78.88
3+69 ⁵⁰ & Westbourne				
W.L.			4.3	78.78
W. Curb			4.0	79.08
W.L. Pavement			4.36	78.72
3+79 ⁵⁰ N/4 Westbourne				
W.L. Pavement			4.46	78.62
W. Curb			4.20	78.88
W.L.			4.50	78.58
3+89 ⁵⁰ N. Curb Westbourne				
W.L.			4.7	78.38
W. Curb			4.3	78.78
W.L. Pavement			4.50	78.58
3+99 ⁵⁰ N.L. Westbourne				
W.L. Pavement			4.56	78.52
W. Curb			4.50	78.58
W.L.			4.90	78.18
4+06 ⁹⁰ S.L. Westbourne				
E.L.			3.94	79.14
E. Curb Top			4.23	78.85
✓ Bott.			4.75	78.33
E.L. Pavement			4.58	78.50

STA	+	H.I.	-	Elev.
83.08				
4+16 ⁹⁰ S. Curb Westbourne				
Top } on E.L. La Jolla Blvd.			4.06	79.02
Bott. }			4.71	78.37
4+56 ⁹⁰ N. Curb Westbourne				
Top } on E.L. La Jolla Blvd.			4.93	78.15
Bott. }			5.40	77.68
4+66 ⁹⁰ N.L. Westbourne				
T.P. SE. B.P. Westbourne	79.01		4.04	79.04
✓	✓			79.01
	3.37	82.38	✓	
E.L.			4.05	78.33
E. Curb Top			4.27	78.11
✓ Bott.			4.87	77.51
E.L. Pavement			4.83	77.55
& "			4.70	77.68
W.L. "			4.86	77.52
W. Curb Bott.			5.59	76.79
✓ Top			4.88	77.40
4+68 ⁹⁰				
E.L.			2.1	80.28
+9'			2.5	79.88
+12'			4.7	77.68
E.L. Pavement			4.84	77.54

STA	+	H.I.	-	Elev.
5+00		82.38		
W. Curb Top			5.40	76.98
✓ Bolt			6.50	75.88
W. L. Pavement			5.36	77.02
⊕ "			5.22	77.16
E. L. "			5.31	77.07
+6'			5.20	77.18
+7'			2.70	79.68
+14'			2.0	80.38
+17'			2.6	79.78
E. L.			2.7	79.68
5+50				
E. L.			3.6	78.78
+13'			3.3	79.08
+15'			3.9	78.48
+17'			6.1	76.28
E. L. Pavement			6.09	76.29
⊕ "			6.04	76.34
W. L. "			6.17	76.21
W. Curb Bott.			7.25	75.13
✓ Top			6.20	76.18
6+00				
W. Curb Top			6.95	75.43
✓ Bott.			7.90	74.48
W. L. Pavement			6.97	75.41

STA	+	H.I.	-	Elev.
				⊕ Pavement
			6.8w	75.56
			6.90	75.48
			7.0	75.38
			4.4	77.98
			4.6	77.78
			4.2w	78.18
				E. L.
6+30 ³⁰				S. L. Belvedere & S. L. Alley
				E. L.
			4.5	77.88
			4.6	77.78
			3.9	78.48
			8.0	74.38
			7.44	74.94
				⊕ "
			7.31	75.07
			7.43	74.95
			7.89	74.49
			7.35	75.03
6+40 ³⁰				S. Curb Belvedere
				Curb Top
			7.34	75.04
			8.1	74.28
				✓ Bott. } W. L. Blvd.
6+50 ³⁰				N. L. Alley
				E. L.
			4.9	77.48
			6.5	75.88
			8.4	73.98
			7.78	74.60
				E. L. Pavement

82.38

82.38

STA		+ H.I.	- Elev.
6+80 ³⁰	N. Curb Bolredore		
	Curb Top } W.L. Blvd.	8.34	74.04
	✓ Bott.	8.90	73.48
6+90 ³⁰			
	W. Curb Top	8.33	74.05
	✓ Bott.	8.87	73.51
	W. L. Pavement	8.47	73.91
	φ " "	8.39	73.99
	E.L. " "	8.49	73.89
	+8'	9.40	72.98
	+9'	7.40	74.98
	E.L. " "	6.1	76.28
7+50			
	E.L. " "	7.7	74.68
	+10'	8.7	73.68
	+15'	10.2	72.18
	E.L. Pavement	9.8	72.58
	φ " "	9.74	72.64
	W. L. " "	9.84	72.54
	W. Curb Bott.	10.60	71.78
	✓ Top	9.8	72.58
8+00 ³⁰	S.L. Fern & Glenn		
	W. L. " "	11.1	71.28
	W. Curb Top	11.08	71.30
	✓ Bott.	11.20	71.18

STA		+ H.I.	- Elev.
	W. L. Pavement	10.99	71.39
	φ " "	10.88	71.50
	E.L. " "	11.01	71.37
	+9'	11.20	71.18
	+15'	10.20	72.18
	E.L. " "	9.50	72.88
	T.P.	10.42	71.96
		4.69	76.65
8+15 ³⁰	S. Curb Glen		
	Curb Top } E.L. Blvd.	4.69	71.96
	✓ Bott.	5.18	71.47
	+11'	5.6	71.05
	E.L. Pavement	5.42	71.23
	φ " "	5.32	71.33
	W. L. " "	5.40	71.25
	W. Curb	5.6	71.05
	W. L. " "	5.5	71.15
8+30 ³⁰	φ Glen		
	W. L. " "	5.6	71.05
	W. Curb	5.8	70.85
	W. L. Pavement	5.48	71.17
	φ " "	5.35	71.30
	E.L. " "	5.42	71.23
	+10'	5.80	70.85
	E.L. " "	5.50	71.15

76.65

76.65

STA		+	H.I.	-	Elev.
8+45 ³⁰	N. Curb	Glen			
	Curb Top	} E.L. Blvd.	5.10	71.55	
	✓ Bott.		5.60	71.05	
+11'			6.0	70.65	
	E.L. Pavement		5.58	71.07	
	☒ "		5.45	71.20	
	W.L. "		5.56	71.09	
	W. Curb		5.9	70.75	
	W.L.		5.9	70.75	
8+45 ³⁰	N.L. Glen				
	W.L.		5.7	70.95	
	W. Curb		5.2	71.45	
	W.L. Pavement		5.66	70.99	
	☒ "		5.55	71.10	
	E.L. "		5.63	71.02	
+10'			6.20	70.45	
	E.L.		4.60	72.05	
8+46 ³⁰					
	E.L.		3.3	73.35	
+8'			4.5	72.15	
+10'			5.9	70.75	
+12'			6.2	70.45	
	E.L. Pavement		5.63	71.02	
	☒ "		5.55	71.10	
	W.L. "		5.69	70.96	

STA		+	H.I.	-	Elev.
	W. Curb		5.1	71.55	
	W.L.		5.8	70.85	
9+06 ³⁰	N.L. Fern				
	W.L.		5.8	70.85	
	W. Curb Top		5.94	70.71	
	✓ Bott.		6.00	70.65	
	W.L. Pavement		5.97	70.68	
	☒ "		5.85	70.85	
	E.L. "		5.96	70.69	
+11'			6.6	70.05	
+13'			6.4	70.25	
+14'			5.6	71.05	
	E.L.		4.1	72.55	
9+50					
	E.L.		4.0	72.65	
+9'			5.3	71.35	
+11'			6.6	70.05	
	E.L. Pavement		6.27	70.38	
	☒ "		6.19	70.46	
	W.L. "		6.30	70.35	
	W. Curb Bott.		6.84	69.81	
	✓ Top		6.32	70.32	

Sta		+ 76.65 H.I.	-	Elev.
10+17				
	E.L.		3.8	72.85
	+9'		5.2	71.45
	+10'		6.7	70.95
	E.L. Pavement		6.83	69.82
10+24 ⁵⁰	S.L. Rushville			
	S. Curb Top } ✓ Bolt } E.L. Blvd.		6.29	70.36
			6.72	69.93
	E.L. Pavement		6.88	69.77
	☐ " "		6.77	69.88
	W.L. " "		5.89	70.76
	W. Curb Bolt.		7.24	69.41
	✓ Top		7.10	69.55
10+27 ⁰⁰	☐ Rushville			
	E.L.		6.73	69.92
	+13'		7.30	69.35
	E.L. Pavement		6.75	69.90
10+39 ⁵⁰	N.L. Rushville			
	E.L.		7.21	69.44
	+15'		7.5	69.15
	E.L. Pavement		6.96	69.69
	☐ " "		6.94	69.71
	W.L. " "		7.04	69.61
	W. Curb Bolt.		7.67	68.98
	✓ Top		7.29	69.36

Stationing

Sta		+ 76.65 H.I.	-	Elev.
10+44				
	E.L.		4.8	71.85
	+4'		5.0	71.65
	+6'		7.1	69.55
	+15'		7.8	68.85
	E.L. Pavement		6.99	69.66
11+00				
	E.L.		5.2	71.45
	+10'		6.2	70.45
	+13'		7.7	68.95
	E.L. Pavement		7.47	69.18
	☐ " "		7.35	69.30
	W.L. " "		7.49	69.16
	W. Curb Bolt.		8.10	68.55
	✓ Top		7.70	68.95
11+50				
	W. Curb Top		8.09	68.56
	✓ Bolt.		8.70	68.95
	W.L. Pavement		7.85	68.80
	☐ " "		7.71	68.94
	E.L. " "		7.82	68.83
	+9'		8.10	68.55
	+12'		7.0	69.65
	E.L.		4.5	72.15
	T.P.		7.38	69.27

STA	+	H.I.	-	Elev.
	5.16	74.43	✓	
12+08 ⁴⁰	S.L. Arenas			
	E.L.	4.3		70.13
	+10'	5.1		69.33
	+12'	6.3		68.13
	E.L. Pavement	6.06		68.39
	φ	5.95		68.48
	W.L. "	6.10		68.33
	W. Curb Bott.	6.90		67.53
	✓ Top	6.38		68.05
12+23 ⁴⁰	S. Curb Arenas			
	S. Curb Top } E.L. Blvd.	5.78		69.15
	✓ Bott. }	5.85		68.58
	E.L. Pavement	6.43		68.20
12+38 ⁴⁰	φ Arenas			
	E.L.	6.23		68.20
	E.L. Pavement	6.30		68.13
12+53 ⁴⁰	N. Curb Arenas			
	N. Curb Top } E.L. Blvd.	5.75		68.68
	✓ Bott. }	6.32		68.11
	E.L. Pavement	6.40		68.03
12+60 ³⁰	S.L. Arena W. of Blvd.			
	W. Curb Top	6.68		67.75
	✓ Bott.	7.21		67.22
	W.L. Pavement	6.76		67.67

STA	+	H.I.	-	Elev.
		74.43		
12+68 ⁴⁰	N.L. Arena E. of Blvd.			
	E.L.	4.8		69.63
	+2	4.6		69.83
	+3	5.9		68.53
	E.L. Pavement	6.37		68.06
12+70 ³⁰	S. Curb Arena			
	S. Curb Top } W.L. Blvd.	6.86		67.57
	✓ Bott. }	7.70		66.73
13+00 ³⁰	N. Curb Arena			
	N. Curb Top } W.L. Blvd.	6.83		67.60
	✓ Bott. }	6.49		67.94
13+10 ³⁰	N.L. Arena W. of Blvd.			
	W. Curb Top	6.75		67.68
	✓ Bott.	7.07		67.36
	W.L. Pavement	6.45		67.98
	φ "	6.31		68.12
	E.L. "	6.42		68.01
	+17'	6.00		68.43
	+18'	4.40		70.03
	E.L.	3.90		70.53
13+50				
	E.L.	5.0		69.43
	+12'	5.8		68.63
	+15'	6.5		67.93
	E.L. Pavement	6.29		68.14

74.43

74.47

STA	+	H.I.	-	Elev.
♀ Pavement			6.15	68.28
W.L. "			6.26	68.17
W. Curb Bott.			6.80	67.63
✓ Top			6.74	67.69
T.P. N.W. B.P. Arenas	67.74		6.73	67.70
✓				67.74
	6.72	74.47 ✓		
14+08 ⁴⁰	S.L. Alley			
W. Curb Top			6.59	67.88
✓ Bott.			6.80	67.67
W.L. Pavement			6.12	68.35
♀ "			6.01	68.46
E.L. "			6.13	68.34
+12'			6.4	68.07
+18'			4.5	69.97
E.L.			4.3	70.17
14+28 ⁴⁰	N.L. Alley			
E.L.			4.8	69.67
+9'			5.3	69.17
+12'			6.5	67.97
E.L. Pavement			6.15	68.32
14+35 ³⁰	S.L. Barbers Pl.			
W. Curb Top			6.46	68.01
✓ Bott.			6.85	67.62
W.L. Pavement			6.00	68.47

STA	+	H.I.	-	Elev.
14+45 ³⁰	S. Curb Barbers Pl.			
	S. Curb Top ?			
	W.L. Blvd.	6.59		67.88
	✓ Bott.	7.16		67.31
14+75 ³⁰	N. Curb Barbers Pl.			
	N. Curb Top ?			
	W.L. Blvd.	6.44		68.03
	✓ Bott.	7.00		67.47
14+85 ³⁰	N.L. Barbers Pl.			
	W. Curb Top	6.28		68.19
	✓ Bott.	6.70		67.77
	W.L. Pavement	5.95		68.52
	♀ "	5.81		68.66
	E.L. "	5.88		68.59
	+10'	6.10		68.37
	+12'	5.10		69.37
	E.L.	4.10		70.37
	T.P.	2.32		72.15
		3.02	75.17 ✓	
15+69 ⁰⁰	S.L. Genter = 0+00			
	E. Curb Top	5.78		69.39
	✓ Bott.	6.50		68.67
	♀	6.18		68.99
	W. Curb Bott.	7.32		67.85
	✓ Top	6.72		68.45
0+10 ⁰⁰	S. Curb Genter Top	5.73		69.44
	✓ Bott.	6.37		68.40

STA		75.17 + H.I.	-	E.L.
0+30 ⁰⁰	¢ Center		5.83	69.34
0+50 ⁰⁰	N. Curb Center, Top		5.32	69.75
	✓ Bot.		5.95	69.22
0+60 ⁰⁰	N.L. Center			
	E. Curb Top		5.38	69.79
	✓ Bot.		5.98	69.19
	¢		5.81	69.36
	W. Curb Bot.		6.96	69.21
	✓ Top		6.45	69.72
1+00 ⁰⁰				
	W. Curb Top		6.28	68.89
	✓ Bot.		6.77	68.40
	¢		5.61	69.56
	E. Curb Bot.		5.81	69.36
	✓ Top		5.26	69.91
1+50				
	E. Curb Top		5.08	70.09
	✓ Bot.		5.62	69.55
	¢		5.43	69.74
	W. Curb Bot.		6.60	68.57
	✓ Top		6.06	69.11
1+99 ⁸⁵	S.L. Sea Lane			
	W. Curb Top		5.82	69.35
	✓ Bot.		6.38	68.79
	¢		5.30	69.87

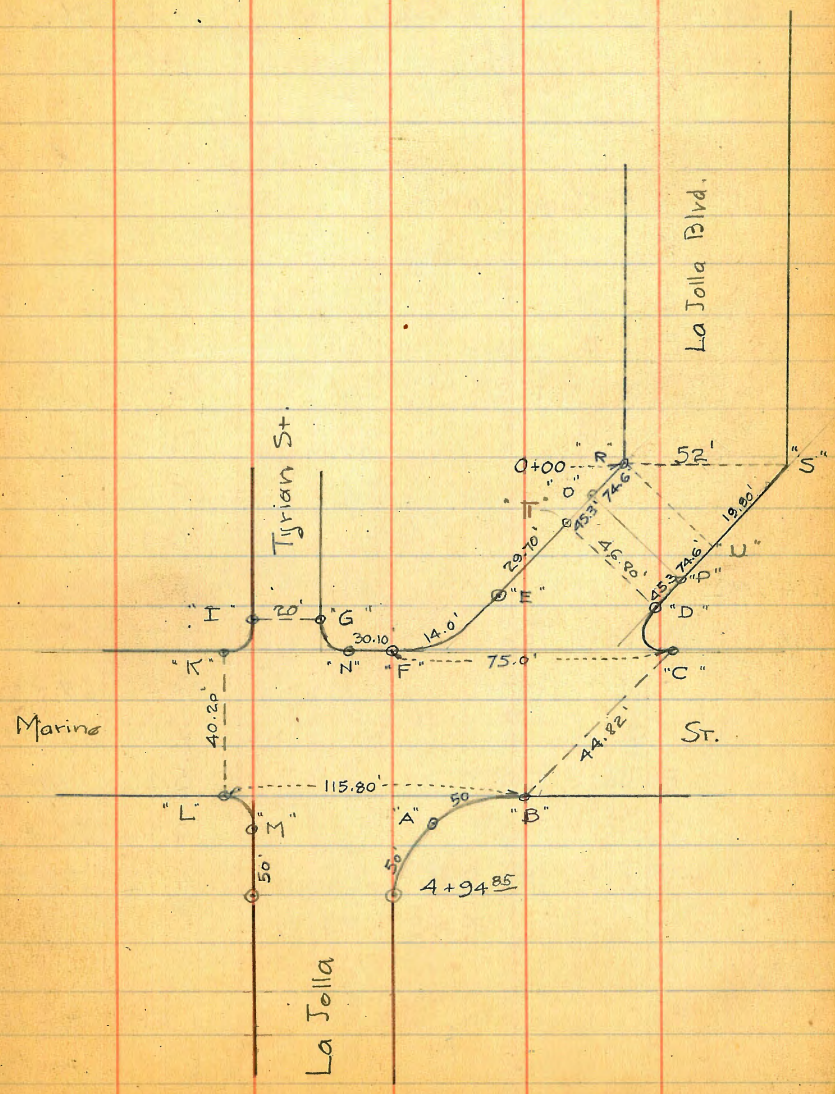

74.88

H.I.

STA	+	H.I.	-	Elev.
ϕ			4.88	70.00
W. Curb Bot.			6.06	68.82
✓ Top			5.54	69.34
3+00				
W. Curb Top			5.67	69.21
✓ Bot.			6.14	68.74
ϕ			5.03	69.83
E. Curb Bot.			5.20	69.68
✓ Top			4.68	70.20
3+77 ³⁵				
S.L. Alley				
E.L.			4.64	70.24
E. Curb Top			4.85	70.03
✓ Bot.			5.39	69.49
ϕ			5.38	69.50
W. Curb Bot.			6.45	68.43
✓ Top			6.00	68.88
3+79 ⁸⁵				
W.L.			5.57	69.31
3+87 ³⁵				
ϕ Alley				
W.L.			5.85	69.03
W. Curb Line			6.43	68.45
ϕ			5.31	69.57
E. Curb Line			5.37	69.51
3+87 ³⁵				
E.L.			4.84	70.04

74.88

H.I.

STA	+	H.I.	-	Elev.
3+97 ³⁵				
N.L. Alley				
E.L.			4.64	70.24
E. Curb Top			4.84	70.04
✓ Bot.			5.41	69.47
ϕ			5.31	69.57
W. Curb Bot.			6.40	68.48
✓ Top			5.90	68.98
3+94 ⁸⁵				
W.L.			5.65	69.23
4+50				
W. Curb Top			6.11	68.77
✓ Bot.			6.63	68.25
ϕ			5.52	69.36
E. Curb Bot.			5.70	69.18
✓ Top			5.04	69.84
4+94 ⁸⁵				
E. Curb Top			5.25	69.63
✓ Bot.			5.83	69.05
ϕ			5.75	69.13
W. Curb Bot.			6.75	68.13
✓ Top			6.28	68.60
"A" Curb Top			5.18	69.70
✓ Bot.			5.77	69.11
ϕ			6.10	68.78
"M" Curb Top			6.41	68.47
✓ Bot.			6.95	67.93

STA	+	74.88 H.I.	-	Elev.
"B"	Curb Top		3.93	70.95
	✓ Bot.		4.50	70.38
♀			5.80	69.08
"L"	Curb Top		6.38	68.50
	✓ Bot.		7.15	67.73
♀	Marino Str.		6.25	68.63
"K"	Curb Top		6.41	68.47
	✓ Bot.		6.86	68.02
"I"	Curb Top		6.38	68.56
	✓ Bot.		6.90	67.98
♀	Tyrian St.		6.40	68.48
"G"	Curb Top		5.70	69.18
	✓ Bot.		6.20	68.68
"N"	✓ Top		5.78	69.10
	✓ Bot.		6.10	68.78
"F"	✓ Top		4.90	69.98
	✓ Bot.		5.55	69.33
♀	La Jolla Blvd.		4.26	70.62
"C"	Curb Top		3.30	71.56
	✓ Bot.		3.89	70.99
♀	Marino Str. East of Blvd.		3.65	71.23
"D"	Curb Top		3.42	71.46
	✓ Bot.		3.95	70.93
♀	La Jolla Blvd.		4.11	70.77

STA	+	74.88 H.I.	-	Elev.
"E"	Curb Top		4.80	70.08
	✓ Bot.		5.38	69.50
"T"	✓ Top		4.59	70.29
	✓ Bot.		5.16	69.71
"O"	✓ Top		4.50	70.36
	✓ Bot.		5.07	69.81
♀	La Jolla Blvd.		3.78	71.10
"D"	Curb Top		3.30	71.58
	✓ Bot.		3.80	71.06
"U"	✓ Top		2.54	72.34
	✓ Bot.		3.10	71.78
♀	La Jolla Blvd.		3.13	71.75
"R"	Curb Top		3.95	70.93
	✓ Bot.		4.45	70.43
♀	La Jolla Blvd.		3.09	71.79
"S" = 0+00	Curb Top		2.30	72.58
	✓ Bot.		2.95	
	T.P.		3.59	71.29
		2.25	73.54	✓
0+50				
E.	Curb Top		1.80	71.72
	✓ Bot.		4.46	69.08
♀			2.55	70.99
W.	Curb Bot.		4.05	69.49
	✓ Top		3.95	70.09

73.54
H.I.

73.54
H.I.

STA	+	H.I.	-	Elev.
1+00				
W. Curb Top			4.31	69.23
✓ Bottom			4.90	68.64
¢			3.40	70.14
E. Curb Bottom			3.37	70.17
✓ Top			2.66	70.88
1+50				
E. Curb Top			3.51	70.03
✓ Bottom			4.24	69.30
¢			4.30	69.29
W. Curb Bottom			5.78	67.76
✓ Top			5.20	68.24
2+00				
W. Curb Top			6.04	67.50
✓ Bottom			6.66	66.88
¢			5.20	68.34
E. Curb Bottom			5.17	69.17
✓ Top			4.51	69.03
2+50				
E. Curb Top			5.38	68.16
✓ Bottom			6.01	67.53
¢			6.02	67.52
W. Curb Bottom			7.44	66.10
✓ Top			6.84	66.70

STA	+	H.I.	-	Elev.
3+00				
W. Curb Top			7.76	65.78
✓ Bottom			8.31	65.23
¢			6.91	66.63
E. Curb Bottom			6.78	66.76
✓ Top			6.19	67.35
3+50				
E. Curb Top			6.98	66.56
✓ Bottom			7.73	65.81
¢			7.85	65.69
W. Curb Bottom			9.19	64.35
✓ Top			8.58	64.96
4+00				
S.L. Pearl				
W. Curb Top			9.40	64.14
✓ Bottom			10.00	63.54
¢			8.63	64.91
E. Curb Bottom			8.49	65.05
✓ Top			7.75	65.79
4+14				
S. Curb Pearl				
S. Curb Top			7.75	65.79
✓ Bottom			8.39	65.15
S			9.52	64.02
✓ Top			10.22	63.32
✓ Bottom				

E.L. Blvd.

W.L. Blvd.

STA	+	H.I.	-	Elev.
73.54				
4+40	¢ Pearl.			
	W.L.	9.61		63.93
	W. Curb	9.46		64.08
	¢	8.92		64.62
	E. Curb	8.88		64.66
	E.L.	8.37		65.17
4+66	N. Curb Pearl			
	N. Curb Top	8.46		65.08
	✓ Bott. } E.L. Blvd.	9.09		64.45
	✓ Top } W.L. "	9.93		63.61
	✓ Bott. }	10.58		62.96
4+80	N.L. Pearl			
	W. Curb Top	9.89		63.65
	✓ Bott.	10.60		62.94
	¢	9.02		64.52
	E. Curb Bott.	9.24		64.30
	✓ Top	8.49		65.05
	T.P. NE.B.P. Pearl	8.47		65.07
	1.54	66.61	✓	
5+50				
	E. Curb Top	2.05		64.56
	✓ Bott.	2.82		63.79
	¢	2.84		63.77
	W. Curb Bott.	4.35		62.26
	✓ Top	3.77		62.84

STA	+	H.I.	-	Elev.
66.61				45
6+00				
	W. Curb Top		4.18	62.43
	✓ Bott.		4.74	61.87
	¢		3.22	63.39
	E. Curb Bott.		3.13	63.48
	✓ Top		2.43	64.18
6+50				
	E. Curb Top		2.71	63.90
	✓ Bott.		3.43	63.18
	¢		3.62	62.99
	W. Curb Bott.		5.27	61.34
	✓ Top		4.59	62.02
7+00				
	W. Curb Top		5.03	61.58
	✓ Bott.		5.68	60.93
	¢		4.04	62.57
	E. Curb Bott.		3.74	62.87
	✓ Top		3.12	63.49
7+58 ⁰⁰				
	E. Curb Top		3.86	62.75
	✓ Bott.		4.35	62.26
	¢		4.58	62.03
	W. Curb Bott.		6.23	60.38
	✓ Top		5.55	61.06

STA	+	H.I.	-	Elev.
2+00		68.88		
E. Curb Top			3.87	65.01
✓ Bott.			4.43	64.45
⊥			3.60	65.28
W. Curb Bott.			4.70	64.18
✓ Top			3.46	65.42
T.P.			2.12	66.76
	7.50	74.26 ✓		

2+67				
E. Curb Top			6.19	68.07
✓ Bott.			6.82	67.44
⊥			6.25	68.01
W. Curb Bott.			6.82	67.44
✓ Top			6.34	67.92
"M" W. Curb Top			5.39	68.87
✓ Bott.			5.90	68.36
⊥			5.13	69.13
"N" E. Curb Bott.			5.69	68.57
✓ Top			4.88	69.38
"S" ✓ Top			4.84	69.42
✓ Bott.			5.57	68.69
"O" ✓ Top			4.75	69.51
✓ Bott.			5.48	68.78
⊥			5.10	69.16

STA	+	H.I.	-	Elev.
		74.26		
"P" Curb Top			5.19	69.07
✓ Bott.			5.85	68.41
"T" ✓ Top			5.18	69.08
✓ Bott.			5.70	68.56
T. Top Fire Hydrant			2.40	71.86
Prospect & La Jolla Blvd.				240
				74.26

3/1/9 Cross Section of 32' med. For 1/200.
 Boston to Main 60' wide
 10' abs
 10' 1/2
 38.59 Main
 32' med

SW Mon. V. 1 44.10

SL Post of 00
 Yardage at 12.15 246.301
 2-2-29 F.C.

E	3.9	40.2
cb	4.3	39.8
1/4	4.5	40.6
c	3.4	40.7
1/4	3.3	40.8
gut	3.2	40.7
cb	2.7	41.4
w	2.2	41.7
0+50		
w	3.1	41.0
cb	3.3	40.8
gut	3.7	40.4
1/4	3.7	40.4
c	3.7	40.4
1/4	3.9	40.2
gut	4.2	39.9
cb	4.0	40.1
E	4.2	39.9
+5	4.1	40.0
0+75		
-4	4.4	39.7
E	4.3	39.8
cb	4.5	39.6
gut	4.9	39.2
1/4	4.0	40.1

44.10

49

C	3.9	40.2
1/4	3.8	40.3
cb	3.5	40.6
w	2.8	41.3
1x00		
w	2.8	41.3
cb	3.1	41.0
gut	4.0	40.1
1/4	3.7	40.4
c	3.9	40.2
1/4	4.4	39.9
gut	4.8	39.3
cb	4.5	39.6
E	4.1	40.0
+5	6.9	37.2
+15	12.0	32.1
1+25		
-5	4.8	39.3
E	5.4	39.7
cb	4.6	39.5
gut	5.0	39.1
1/4	4.1	40.0
c	3.9	40.2
1/4	3.8	40.3
gut	4.2	39.9
cb	3.3	40.8
w	2.9	41.2

w	3.6	40.5
cb	4.0	40.1
gut	4.3	39.8
1/4	4.0	40.1
c	4.1	40.0
1/4	4.4	39.9
gut	5.0	39.1
cb	4.6	39.5
E	4.7	39.4
+5	4.8	39.3
2+00		
-5	5.1	39.0
E	4.8	39.3
cb	4.8	39.3
gut	5.4	38.9
1/4	4.5	39.6
c	4.2	39.9
1/4	4.2	39.9
gut	4.5	39.6
cb	3.8	40.3
w	3.6	40.5
+5	3.4	40.1
2+50		
-4	3.9	40.2
w	3.9	40.2
cb	4.0	40.1

gut	4.7	39.4
1/4	4.4	39.7
c	4.5	39.6
1/4	4.7	39.4
gut	5.5	38.6
cb	5.0	39.1
E	5.0	39.1
+4	5.1	39.0
3+00		
-4	4.7	39.4
E	5.0	39.1
cb	5.4	38.7
gut	5.9	38.2
1/4	5.1	39.0
c	4.7	39.4
1/4	4.7	39.4
gut	5.2	38.9
cb	4.6	39.5
w	4.3	39.8
+4	4.2	39.9
3+50		
-3	4.2	39.9
w	4.2	39.9
cb	4.4	39.7
gut	5.2	38.9
1/4	5.0	39.1

4410

c	4.9	39.2
1/4	5.2	38.9
gut	5.5	38.6
cb	5.4	38.7
E	5.3	38.8

4400

E	5.4	38.7
cb	5.7	38.4
gut	5.9	38.2
1/4	5.5	38.6
c	5.4	38.7
1/4	5.3	38.8
gut	5.4	38.7
cb	4.7	39.4
w	4.4	39.7

4421 = Sec A = NL MAIN ON WEST

w	4.7	39.4
cb	4.7	39.4
gut	5.5	38.6
1/4	5.5	38.6
c	5.5	38.6
1/4	5.7	38.4
cb	5.9	38.2
E	5.9	38.2

4410

34 md

51

Sec B = diag. line = NL MAIN ON PAVING

E	6.47	37.63
cb	6.30	37.80
1/4	5.69	38.41
c	5.65	38.45
1/4	5.61	38.49
gut	5.63	38.47
cb	4.7	39.4
w	4.7	39.4

3-19-29 X-section Redwood Street
 J.C. Bliss Mile to Boundary - 60' wide
 Drebert 10' cbs
 Pauner 10' 1/4's

H.I. 29314

52

B.M. NE B.P. Mile and Thorn

303.69 1/4

3.1 290.0

+0.75 304.44

cb

3.1 290.0

T.P. -11.89

292.55 +5

3.6 289.5

+0.59 H.I. 293.14

5

4.3 288.8

W.L. Mile = 3107.5 - Paved

2+35

N Tpcb 0.59 292.55

5

5.4 287.7

G 1.20 291.94

cb

5.4 287.7

1/4 1.18 291.96

1/4

5.6 287.5

1/4 1.33 291.81

1/4

4.1 288.0

1/4 1.66 291.48

+5

3.2 289.9

G 2.07 291.07

1/4

2.9 290.2

5 Tpcb 1.59 291.55

cb

2.6 290.5

2+75

1

2.1 291.0

5 3.3 289.8

2+25

cb 2.6 290.5

N

5.2 287.9

1/4 2.1 291.0

cb

6.5 286.6

1/4 2.3 290.8

1/4

7.8 285.3

1/4 2.0 291.1

1/4

9.0 284.1

cb 1.6 291.5

1/4

10.1 293.0

N 0.9 292.2

cb

10.3 282.8

2+50

5

11.0 282.1

N 2.2 290.9

2+00

cb 2.2 290.9

5

21.0 272.1

1/4 2.8 290.3

cb

19.9 273.2

1/4 2.9 290.2

1/4

18.0 275.1

3/26/29
 P/O H/d
 1/4

H.I. 293.14

¢	16.2	276.9	
1/4	14.6	278.5	
cb	13.0	280.1	
N	11.4	281.7	
T.P.		-12.99	280.15

+ 0.46

H.I. 280.61

1475

N	30	277.6	
cb	4.8	275.8	
1/4	7.9	272.7	
¢	10.6	270.0	
1/4	13.2	267.4	
cb	15.8	264.8	
S	18.4	262.2	
Out 15	19.6	261.0	

1450

Out 15	22.7	257.9	
S	21.1	259.5	
cb	19.3	261.5	
1/4	17.7	262.7	
¢	14.8	265.8	
1/4	12.0	268.6	
cb	9.4	271.2	
N	5.5	275.1	

H.I. 280.61

53

1425

1	14.2	266.4	
cb	12.7	267.9	
1/4	16.3	264.3	
¢	19.1	261.5	
1/4	20.5	260.1	
cb	21.3	259.3	
S	22.3	258.3	
Out 15	23.5	257.1	

1400

Out 15	24.5	256.1	
S	23.5	257.1	
cb	22.6	258.0	
1/4	21.0	259.6	
¢	20.9	259.7	
1/4	19.0	261.6	
cb	17.8	260.8	
+4	20.6	260.0	
+5	22.3	258.3	
N	22.0	258.6	
Out 15	20.8	259.8	

0475

Out 15	20.0	260.4	
N	20.8	259.8	
cb	20.9	259.7	
1/4	22.5	258.1	

H.I. 280.61

+4	23.0	257.6
¢	22.3	258.3
1/4	22.4	259.2
cb	23.3	257.3
S	24.1	256.5
Out 6	24.0	256.6
Out 10	21.5	259.1
0+50		
S	10.4	270.2
cb	12.2	268.4
1/4	13.0	267.6
¢	14.0	266.6
1/4	15.3	265.3
cb	15.5	265.1
N	13.1	266.9

Line of levels for Culvert

Crossing N.L. Redwood at 1+14 & S.L.
at 1+00

0+00	20.7	259.9
0+15 = N.L. Redwood	21.3	259.3
0+30 = Bottom drain	22.0	258.6
0+36	21.5	259.1
0+50	21.4	259.2
0+60	22.1	258.5
0+80 = S.L. Redwood	22.4	258.2

H.I. 280.61

54

1+00	24.5	256.1
0+75		
N	3.1	277.5
cb	0.0	280.6
T.P.		-0.62
+ 1248		
H.I. 292.47		
1/4	9.5	283.0
¢	7.8	284.7
1/4	6.4	286.1
cb	7.9	284.6
S	10.6	281.9
0+12		
S	6.5	286.0
cb	0.9	291.6
1/4	0.1	292.4
¢	40.3	292.8
1/4	0.4	292.1
cb	2.8	289.7
N	5.7	286.8
0+00 = E.L. Boundary		
N	1.6	290.9
Top cb - Existing	2.46	290.01
¢	2.5	290.0
1/4	2.1	290.4

279.99

H.I. 29247

4	2.7	289.8	
114	2.6	289.9	
G	2.2	290.3	
Top existing	2.00	290.47	
S	2.0	290.5	
T.P.		-4.64	287.83
+3.49	291.30		
B.M. - SE. 7' Tack Boundary & Quince	-0.52	290.78	

3-20-29 X-section - Quince street
 J.C. Bliss Boundary to Redwood - 60' wide
 Drebert
 Rauner

55

B.M. S.E. 7' Tack Quince & Boundary		290.78	
+2.42			
S			H.I. 293.20 ✓
			E.L. Boundary = 20' 00" - Paved
S	2.3	290.9	
Top existing	2.37	290.83	
G	3.08	290.12	
114	3.09	290.11	
4	3.24	289.96	
14	3.68	289.52	
G	4.25	288.95	
Top existing	3.61	289.59	
A	3.9	289.3	
			0+05 - Top dirt dump
A	11	292.1	
+5	14	291.8	
cb	3.0	290.2	
+5	1.9	291.3	
14	14	291.8	
4	1.6	291.6	
1/4	1.5	291.7	
cb	2.5	290.7	
S	2.7	290.5	
			0+19
S	8.3	284.9	

Plotted 3/26/29

H.I. 293.20

cb	7.4	285.8
1/4	6.6	286.6
♀	7.1	286.1
1/4	6.8	286.4
cb	8.1	285.1
N	9.0	284.2
T.P	-13.0	280.13

+0.11

H.I. 280.24

0.50

N	3.3	276.9
cb	3.0	277.2
1/4	3.1	277.1
♀	2.8	277.4
1/4	2.6	277.6
cb	1.4	278.8
S	2.0	278.2

0.75

S	6.9	273.3
cb	6.2	274.0
1/4	7.1	273.1
♀	8.1	272.1
1/4	8.2	272.0
cb	7.8	272.4
N	8.4	271.8

H.I. 280.24

56

1.00

N	16.8	263.4
cb	16.8	263.9
1/4	16.6	263.6
♀	16.3	263.9
1/4	16.1	264.1
cb	16.0	264.2
S	16.0	264.2
T.P	-13.18	267.06

+0.21 267.27

T.P.

-12.92 254.35

+0.61

H.I. 254.96

1.25

S	3.9	251.1
cb	1.6	253.4
1/4	1.4	253.6
♀	1.3	253.7
1/4	0.5	254.5
cb	1.0	254.0
N	0.3	254.7
0.020	15.4	239.6
N	15.8	239.2
cb	16.2	238.8
1/4	16.0	239.0
♀	16.9	238.1

1.50

N. 1/2 Section 40 S 31 E
 slope H.I. 254.96

75	15.6	239.4
1/4	15.2	239.8
cb	16.4	238.6
S	17.0	238.0
Out 20	18.3	236.7
1475		
Out 20	20.2	234.8
S	19.7	235.3
cb	20.0	235.0
1/4	20.2	234.8
♀	20.7	234.3
1/4	20.5	234.5
cb	19.0	236.0
N	18.5	236.5

Bottom of drain = 1490 - Will do for Culvert levels

Out 20 - Bottom of drain	22.8	232.2
N - " " "	23.0	232.0
cb " " "	22.8	232.2
4 - Line crosses onto East bank	21.0	234.0
1/4	21.2	233.8
♀	20.6	234.4
1/4	21.2	233.8
cb - In bottom of drain	24.3	230.7
S " " " "	24.7	230.3
Out 20 " " " "	25.4	229.6

H.I. 254.96

57

2400

Out 20	21.0	234.0
S	20.2	234.8
cb	20.0	235.0
1/4	19.0	236.0
♀	18.8	236.2
1/4	18.4	236.6
cb	18.5	236.5
N	17.7	237.3
Out 20	16.7	238.3

2425

N	11.1	243.9
cb	12.0	243.0
1/4	12.5	242.5
♀	13.2	241.8
1/4	12.5	242.5
cb	13.4	241.6
S	12.4	242.6

2450

S	2.6	252.4
cb	3.4	251.6
1/4	2.3	252.7
♀	1.6	253.9
1/4	1.1	253.9
cb	0.5	254.5
N	0.0	255.0

H.I. 254.96

T.P. -0.35 25461

+1290

H.I. 267.51

2+75

N	3.3	264.2
cb	4.2	263.3
1/4	5.2	262.3
¢	6.6	260.9
1/4	6.3	261.2
cb	6.7	260.8
S	7.2	260.3
T.P.	-0.20	267.31

+1289

H.I. 280.20

2+10

S	13.0	267.2
cb	12.6	267.6
1/4	11.5	268.7
¢	12.1	268.1
1/4	10.2	270.0
cb	8.8	271.4
N	7.5	272.7
2+10 = W.L. Nile - ^{60' wide} _{100' deep} W 1145		
N	2.8	277.4
cb	4.4	275.8

Note: Nile Pared to N.L. Source

58

H.I. 280.20

+5	6.7	273.5
1/4	7.0	273.2
¢	6.7	273.5
1/4	6.9	273.3
cb	9.6	270.6
S	10.0	270.2
W cb Nile - Pared to N.L. Source		
S	5.3	274.9
cb	3.4	276.8
1/4	2.6	277.6
¢	1.8	278.4
1/4	1.5	278.7
cb	2.0	278.2
N - Gutter	2.25	277.95
Top cb	1.62	278.58
W 1/4 Nile		
N - Paving	1.67	278.53
cb	1.4	278.8
1/4	1.5	278.7
¢	1.8	278.4
1/4	2.0	278.2
cb	2.7	277.5
S	3.1	277.1

H.I. 280.20

W. Nile

S	3.0	277.2	
cb	2.6	277.6	
1/4	2.4	277.8	
£	2.2	278.0	
1/4	1.5	278.7	
cb	1.7	279.0	
N-Paving	1.33	278.87	
E 1/4 Mile			
N-Paving	1.13	279.07	
cb	1.0	279.2	
1/4	1.3	278.9	
£	1.8	278.4	
1/4	2.1	278.1	
cb	2.4	277.8	
S	2.7	277.5	
E cb Nile			
S	2.6	277.6	
cb	2.2	278.0	
1/4	0.9	279.3	
£	0.2	280.0	
T.P.		-0.64	279.56

+11.72

H.I. 291.28

1/4	10.3	281.0	
cb	9.9	281.4	

H.I. 291.28

59

N-Gutter Paving	12.28	279.00	
Tp cb	11.61	279.67	
E.L. Nile			
N	10.4	279.9	
+8	7.9	283.4	
cb	8.2	283.1	
1/4	8.6	282.7	
£	8.9	282.4	
1/4	9.4	281.9	
cb	9.7	281.6	
S	10.1	281.2	
T.P.		-2.58	288.70
	+11.53	300.23	
T.P.		-1.96	298.27
	+7.06	305.33	
B.M. N.E.S.P. Nile & Thoro			
		-1.58	303.75 ✓
		Correct	303.69 ✓
		Error	.06

15' wide.

X 510. Alley BK 50 Olive Hill
El Cajon to Meade Bet Central & 41st St4-24-29
Miller.

369.89

113' N. garage on W. cnt floor 19.5 Back

60

B.M.	5.26	369.92	364.66	S.M. Central & El Cajon
B.M.	5.47	369.89	364.42	S.M. 41st & El Cajon
		oo = N. line El. Cajon Ave.		
W. cnt. ch.	369.89	4.65	365.24	
W. part		4.74	365.11	
E " paving Sunk Reading Take M. line		5.29	364.60	
E "		4.99	364.90	
E. cnt. ch.		4.81	365.08	
		15' N		
E	3619	4.7	365.2	
E		4.5	65.4	
W		4.7	65.2	
		40' N		
W-50'		4.3	65.6	
W		4.9	65.0	
E		4.9	65.0	
E		4.7	65.2	
E + 25'		4.6	65.3	
		100' N		
E-50		4.9	65.0	
E		5.0	64.9	
E		5.0	64.9	
W		4.9	65.0	
W+50		4.2	65.7	
15' N. of above in yard.		4.6	65.3	

Plotted 5-7-29 - G.M.T.

W-19.5 garage floor	4.6	365.3
W	4.6	65.3
E	4.8	65.1
E	5.0	64.9
		160' N
E-50	4.5	65.4
E	4.8	65.1
E	4.7	65.2
W	4.8	65.1
W+40	4.6	65.3
		200' N
W-60	4.7	65.8
W	4.5	65.4
E	4.5	65.4
E	4.5	65.4
E + 40	4.3	65.6
		220' N
E on M.H.	4.50	65.4
		250' N.
E-35	4.6	65.3
E	4.5	65.4
E	4.5	65.4
W	4.3	65.6
+40	4.0	65.9

369.89
300' N

W-40	4.4	365.5
W	4.4	65.5
⊕	4.5	65.4
E	4.3	65.6
E+40	4.2	65.7

325' N

E-50	4.5	65.4
E	4.4	65.5
⊕	4.5	65.4
W	4.2	65.7
W+40	4.4	65.5

T.P.	1.53	370.98	0.44	369.45
------	------	--------	------	--------

355' N

N-40	4.8	366.2
W	5.0	66.0
⊕	5.1	65.9
E	5.2	65.8
E+40	5.2	65.8

400' N

E-40	5.2	65.8
E	5.1	65.9
⊕	5.2	65.8
W	5.0	66.0
W+40	4.9	66.1

Alley BK 50 Olive Hill

370.98
450' N

61

W-40	4.9	366.1
W	4.9	66.1
⊕	5.0	66.0
E	4.9	66.1
+40	4.5	66.5

466' N garage on E. dist floor 4.4 Back

E-4.5	4.5	66.5 floor
E	4.7	66.3
⊕	5.0	66.0
W	4.8	66.2

500' N

W-40	4.2	66.8
W	4.5	66.5
⊕	4.5	66.5
E	4.5	66.5
+35	4.3	66.7

513' N garage on E. ent. floor 12.2 Back

E-12.2	4.0	67.0 floor
--------	-----	------------

548' N garage on E. ent. floor 12.3 Back

E-50	3.5	67.5
E-12.3	3.55	67.4 floor
E	3.9	67.1
⊕	3.8	67.2
W	3.9	67.1
W+40	4.2	66.8

370.98
5 80' N

Alley BK 50. Olive Hill.

62

W-60	3.6	367.3
W-2.5	4.1	66.9
N.	3.4	67.6
±	3.3	67.7
E.	3.2	67.8

600' N

E	3.0	68.0
±	3.1	67.9
W.	3.2	67.8
+20	3.6	67.4

607' N. = S. Line Meade Ave

W. cut. elev.	2.93	368.05
ch. cut. for pav't. grade	3.01	367.97
±	3.0	368.0
E. cut. elev.	2.6	368.38
ch. cut. for pav't. grade	2.80	368.18
T.P. 4.40	369.92	5.46 365.52
chk on original BM.	5.50	364.42 = 364.42

8 W. 4125 +

El Cajon.

+

HI
97.69

-

Elev

1775.

S Top cb 9.24 88.45

N " " 9.11 88.58

2700

N Top cb 9.69 88.00

S " " 9.78 87.91

2725

S Top cb 10.27 87.42

N " " 10.38 87.31

TP 0.93 8752 11.10 86.59

2750

N Top cb 0.80 86.72

S " " 0.63 86.89

2775

S Top cb 1.16 86.36

N " " 1.42 86.10

3400

N Top cb 2.04 85.48

S " " 1.60 85.92

3425

S Top cb 2.14 85.38

N " " 2.68 84.84

3450

N Top cb 3.33 84.19

S " " 2.65 84.87

+

I 87.52

64

2760.1

S Top cb 2.84 84.68

N " " 3.54 83.98

2780

N Top cb 4.02 83.50

S " " 3.34 84.18

4400

S Top cb 3.97 83.55

N " " 4.60 82.92

4420

N Top cb 5.33 82.19

S " " 4.69 82.83

4440

S Top cb 5.56 81.96

N " " 6.12 81.40

4460

N Top cb 7.12 80.40

S " " 6.54 80.98

4480

S Top cb 7.77 79.75

N " " 8.13 79.39

5400

N Top cb 9.26 78.26

S " " 9.08 88.44

5420

S " " 10.49 77.03

N Top cb 10.45 77.07

	+	HI 8752	-	Elev
			5+40	
N Top cb			11.78	75.74
S " "			11.93	75.59
TP	0.48	75.00	13.00	74.52
			5+60	
S Top cb			0.90	74.10
N " "			0.49	74.51
			5+80	
N Top cb			1.80	73.20
S Top cb			2.44	72.56
			4+00 E line of 38 ^D	
S Top cb			3.97	71.03
N " "			3.05	71.95
			Levels Around N.E. Return	
N Prop			3.00	72.00
			Levels Around S.E. Return	
E Prop			3.97	71.03
S "			4.00	71.00
S+15			4.19	71.81
			Levels Around S.W. Return	
S-15			5.15	69.85
S			5.00	70.00
N			5.17	69.83
			Levels Around N.W. Return	
N			3.87	71.13
N			4.02	70.98

		75.00	
			65
			0+00 W line of 37 th
N Top cb			4.02
S " "			5.17
			0+25
S Top cb			5.84
N " "			4.80
			0+50
N Top cb			5.50
S " "			6.51
			0+75
S Top cb			7.27
N " "			6.83
			1+00
N Top cb			7.03
S " "			8.00
			1+25
S Top cb			8.82
N " "			7.83
			1+50
N Top cb			8.57
S " "			9.60
			1+75
S Top cb			10.34
N " "			9.41
			2+00 E line of Jewell
N Top cb			10.00
S " "			10.98

Walker
Kunag
Mattoon
1-25-30

Cross Section 15' Alley Block 3

Hillcrest

bet 4th & 5th

from Sta Lewis to M.Hillcrest Dr

S.M. DP

Sta. Lewis st. 1.26 284.38 282.13 Lewis 4th
= 0+00

M. top ch 3.21 280.47
Gut on Ground. 4.0 280.4
% 3.6 280.8
E. Gut. " 3.9 280.5
E top ch 3.57 280.81

0+10

E 2.0 282.4
% 2.6 281.8
M 2.6 281.8

0+26

M 2.1 282.3
% 2.1 282.3
E 1.8 282.6

T.P. 7.22 230.41 1.12 282.12

0+405 = 2' lower M.H.

E 7.3 283.1
% on Tim M.H. 6.83 283.58 ✓

M 7.5 282.9

0+50

M 7.1 283.3
% 7.1 283.3
E 6.9 283.5

Plotted 1/28/30
C.B.H.

67

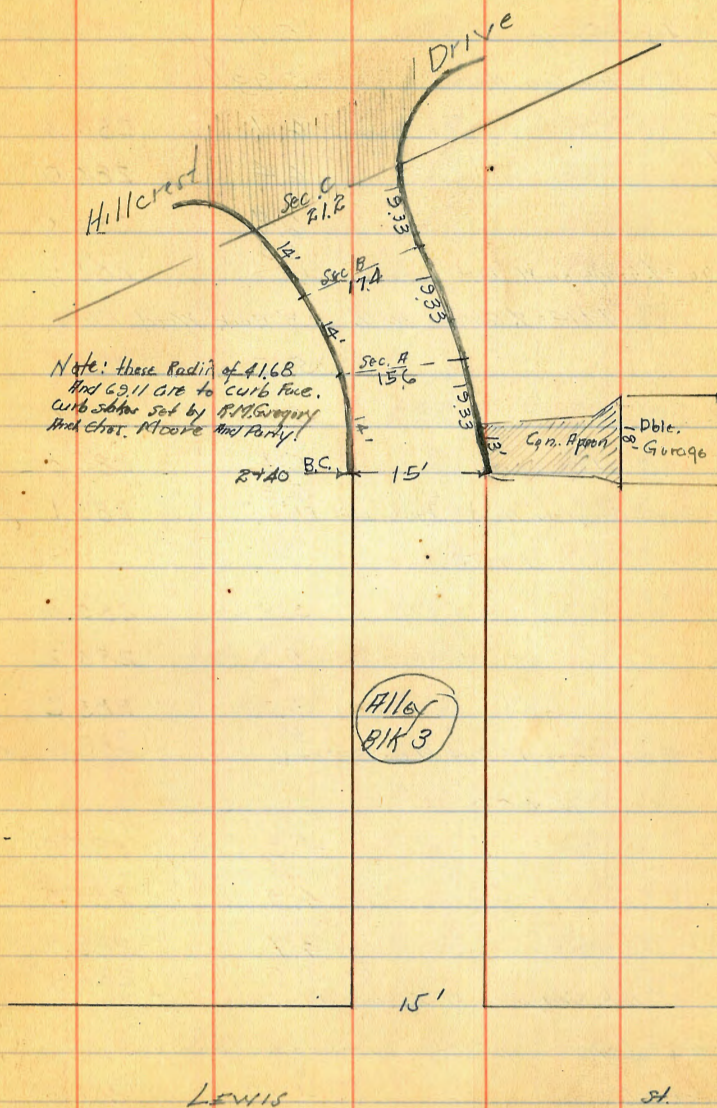

29041

0+87 = $\frac{1}{2}$ Garage on E 4.5' Back. Con. Floor With Con Floor.		
E - 4.5' = Garage	5.72	284.69 ✓
E - 2.5' = toe Con Apron	5.93	284.48 ✓
E	6.1	284.3
$\frac{1}{2}$	6.4	284.0
W	6.4	284.0
	6.3	
0+90 = $\frac{1}{2}$ Garage on W Dirt Floor 4.5' Back		284.1 ✓
X+14 = $\frac{1}{2}$ Garage on E 0.3' Back Wood Floor ✓		
W	5.5	284.9
$\frac{1}{2}$	5.8	284.6
E + 0.3' of Garage	5.4	285.0
	5.3	
1+30 = $\frac{1}{2}$ Garage on W 3.8' Back Dirt Floor		285.1 ✓
1+50		
W	5.0	285.4
$\frac{1}{2}$	5.2	285.2
E	5.2	285.2
	5.0	
1+66 = $\frac{1}{2}$ Garage on W Dirt Floor 3.3' Back		285.4 ✓
2+00		
E	4.9	285.5
$\frac{1}{2}$	4.9	285.5
W	4.7	285.7
	R = 4.5	285.9
2+08 = $\frac{1}{2}$ Dirt Garage on W A.L. Back Dirt Floor 16.5' Wide		
2+40 = Long curbing. Each curb 1' on East & West. Also North side. Data Garage on W.		
W top cb	4.10	286.31 ✓
" Gult. on Pav.	4.53	285.88 ✓
$\frac{1}{2}$	4.5	285.9

29041

68

$\frac{1}{2}$ + 7.5' = Face curb. on ground	4.4	286.0
+ 7.5' = " " " curb.	4.09	286.32 ✓
Section A = 15.6'		
E top cb	4.34	286.07
" Gult.	4.7	285.7
$\frac{1}{2}$	4.4	286.0
W Gult.	4.5	285.9
W top cb	4.19	286.22
Section B = 17.4'		
W top cb	4.31	286.10
" Gult.	5.0	285.4
$\frac{1}{2}$	4.8	285.6
E Gult.	4.2	285.5
E top cb	4.48	285.93
Section C = 21.8' = N. side Hillcrest Dr.		
T.P. 6.00 291.11	5.30	285.11
E top cb	5.45	285.66
E Gult. on Pav.	5.93	285.18
$\frac{1}{2}$ " "	5.96	285.15
W " " "	5.67	285.44
W top cb	5.20	285.91
T.P. 3.36 290.43	4.04	287.07
chk. S.V.V. B.P. Washington + 5.4	6.38	284.05
		284.02 = B.M.
		403 = Error

311.62
0+30' N. (con)

W. gutter	5.86
+ 4	5.78
"	5.71
⊕	5.79
"	6.39
gutter	7.26
E. ent. cl.	6.79

0+50' N

E. ent. cl.	6.50
gutter	6.99
"	6.17
⊕	5.68
"	5.58
+ 6	5.75

W. gutter in driveway No curb	5.64
+ 7.5 = W. edge walk	4.90
W. Line	4.9

0+65' N

W. line	4.8
+ 2.5 = W. edge walk	4.80
W. gutter in drive No curb.	5.60
+ 2	5.63
"	5.45
⊕	5.57
"	6.00
gutter	6.80
E. ent. cl.	6.25

311.62
0+75' N

E. curb	6.12
gutter	6.63
"	5.92
⊕	5.50
"	5.39
+ 6	5.63
W. gutter in drive No curb	5.61
+ 7.5 = W. edge walk	4.83
W. Line	4.7

0+78' = N End Drive

W.	4.7
+ 2.5 = W. edge walk	4.80
+ 7.5 = E " "	5.03
W. ent. cl.	5.04
gutter pavnt.	5.66

0+90' N

W.	4.6
+ 2.5 = W. edge walk	4.54
+ 7.5 = E " "	4.74
W. cl.	4.91
gutter	5.54
+ 4	5.37
"	5.25
⊕	5.31
"	5.78
gutter	6.43
E. ent. cl.	5.88

32nd St X Sec

70

311.62
1+00 N.

E. ent. cl	5.64
gutter	6.60
"	5.55
♀	5.12
"	5.10
gutter	5.33
W. ent. cl.	4.68
+2.5 E. edge walk	4.51
+7.5 W. " "	4.40
W. line	4.5

1+20' N.

W	3.8
+2.5 W. edge walk	3.71
+7.5 E	3.80
W. ent. cl.	3.91
gutter	4.47
+4	4.46
"	4.45
♀	4.39
"	4.77
gutter	5.43
E. ent. cl.	4.85

311.62
1+50' N.

E. ent. cl	3.66
gutter	4.26
"	3.64
♀	3.40
"	3.38
gutter	3.63
W. ent. cl.	2.99
+2.5 E. edge walk	2.97
+7.5 W. " "	2.82
W. line	2.9

32nd St. X Sec

71

X sec Hemlock St.
3676 to Olive wood Ter.

NW. BP.	4.23	58.87	54.49	Hemlock olive wood
T.P.	0.15	<u>45.92</u>	13.05	45.77
	0+00 W.L. 3674			
S		11.3	34.6	
E		9.6	36.3	
N		10.0	35.9	
	0+10			
N		10.4	35.5	
E		10.0	35.3	
S		10.0	35.9	
	0+20			
S		5.0	40.3	
+10		5.9	40.0	
E		8.5	37.4	
+20		10.0	35.3	
N		10.9	35.0	
	0+30			
N		6.7	39.2	
E		6.1	39.8	
S		5.8	40.1	
	0+54			
S		6.0	39.9	
E		6.1	39.8	
N		6.4	39.5	

C. Moore
Soldier Meyer
W.F.M.
9-13-45.

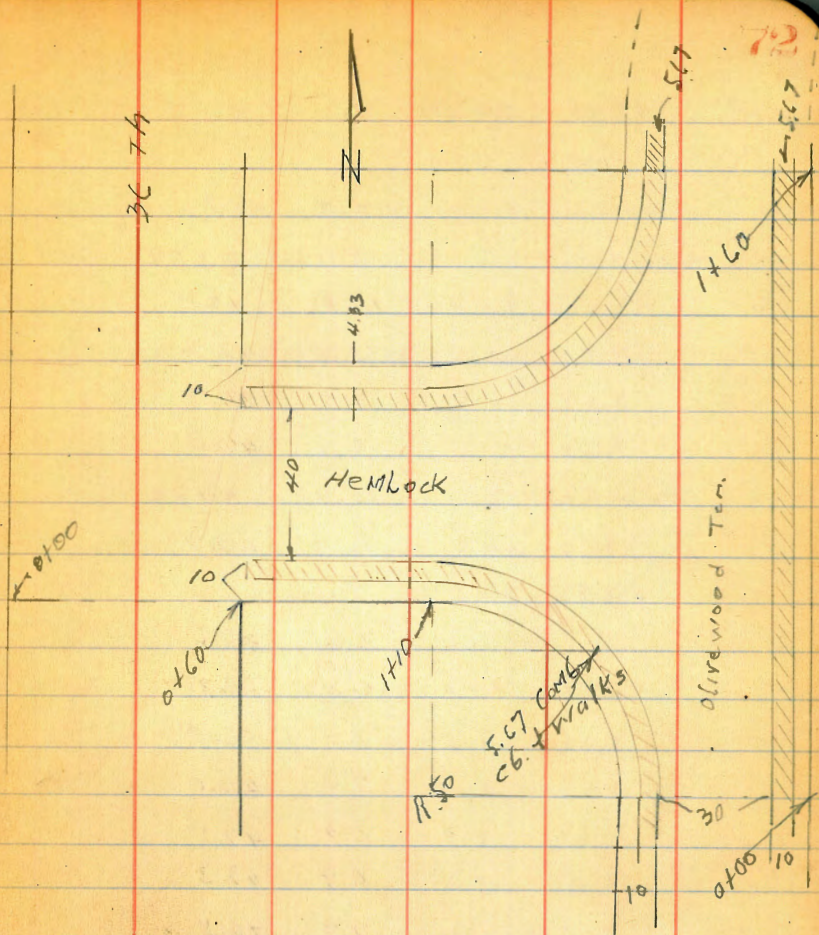

45.92

T.P.	11.62	<u>54.21</u>	3.33	42.59
	0+100	EL. 3676		
N			12.3	41.9
cb Top			11.42	42.79
9T			11.8	42.4
1/4			11.0	43.2
C			9.5	44.7
1/4			9.9	44.3
cb Top			10.49	43.72
S			10.3	43.9
	0+85			
S			6.6	47.6
cb			6.83	47.38
9T			7.5	46.2
1/4			7.2	47.0
C			6.7	42.5
1/4			6.9	47.3
9T			7.7	46.5
cb			7.23	46.98
N			7.4	46.8
	1+10	cb BC.		
1/4			2.0	51.2
cb			3.17	52.04
1/4			3.3	50.9
C			3.3	50.9
1/4			3.4	50.8

5421

73

S cb			3.51	50.70
S			3.6	50.6
T.P.	8.60	<u>60.64</u>	2.17	52.04
	1+35			
S	on walk		7.08	53.56
+5	cb Top = Hump	1/4 cb	7.21	53.43
9T			8.0	52.6
E			7.7	52.9
+20	9T		7.6	53.0
"	cb		7.00	53.64
N	on walk		6.73	54.41
	1+44			
N-1	Top cb.	Hump	6.14	54.52
9T			6.8	53.8
E			6.8	53.8
S	9T		7.8	53.1
S	Top cb		6.92	53.72
	1+60 = WL	olive wood Ten		
S-104	Top cb.		6.64	54.0
"	9T		7.0	53.6
S			6.4	54.2
E			5.9	54.7
N			5.8	54.8
N +17.2	9T		6.2	54.4
"	Top cb		5.81	54.83

Co. L₁

Levels on N.W. Cb Ret, in 5 eq. parts

1+10 = Part #1 = B.C. on sketch	9.60	51.04	Top cb
#2	7.66	52.98	"
#3	6.05	54.59	"
#4	5.82	54.82	"
#5	5.69	54.95	"
#C = E.C.	5.80	54.84	"

Levels S.W. Cb Return, in 5 eq. parts

1+10 = Part #1 = B.C.	9.94	50.70	Top cb.
#2	7.79	52.85	"
#3	6.89	53.25	"
#4	6.69	53.95	"
#5	6.69	53.95	"
#C = E.C.	6.97	53.77	"

Levels on Olivewood Ten

Co. L₁

0+00 See sketch

W cb Top	6.97	53.67
9T	7.7	52.9
E	7.1	53.5
9T	6.6	54.0
E cb Top	5.95	54.69
0+25		
E cb Top	5.09	55.55
9T	6.0	54.6
E	6.3	54.3
W cb Line	6.7	53.9
0+50		
W cb Line	5.8	54.8
E	5.5	55.1
9T	5.3	55.3
E cb Top	4.57	56.07
0+75		
E cb Top	4.51	56.13
9T	5.0	55.6
E	5.1	55.5
W cb Line	5.4	55.2
1+00		
W cb Line	5.5	55.1
E	5.1	55.5

60.64

1400

9T 5.0 55.6

E c b Top 4.53 56.11

1425

E c b Top 4.96 55.68

9T 5.7 54.9

Q 5.14 55.2

W c b Line 5.7 54.9

1460

W c b Top = EC 5.80 54.8

9T 6.4 54.2

Q 6.0 54.6

9T 6.8 54.2

E c b Top 5.63 55.01

8MT starting 6.15 54.49 54.49

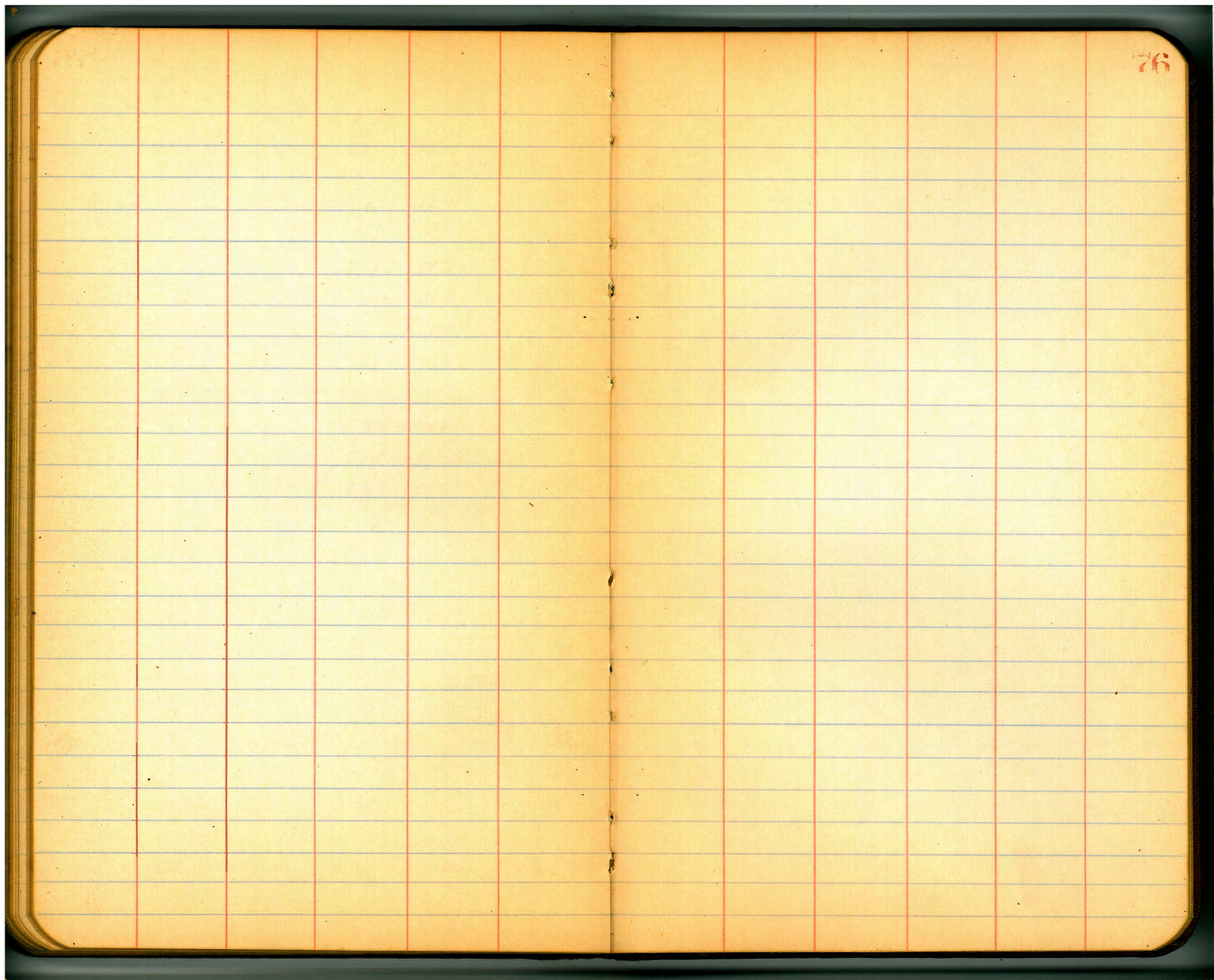

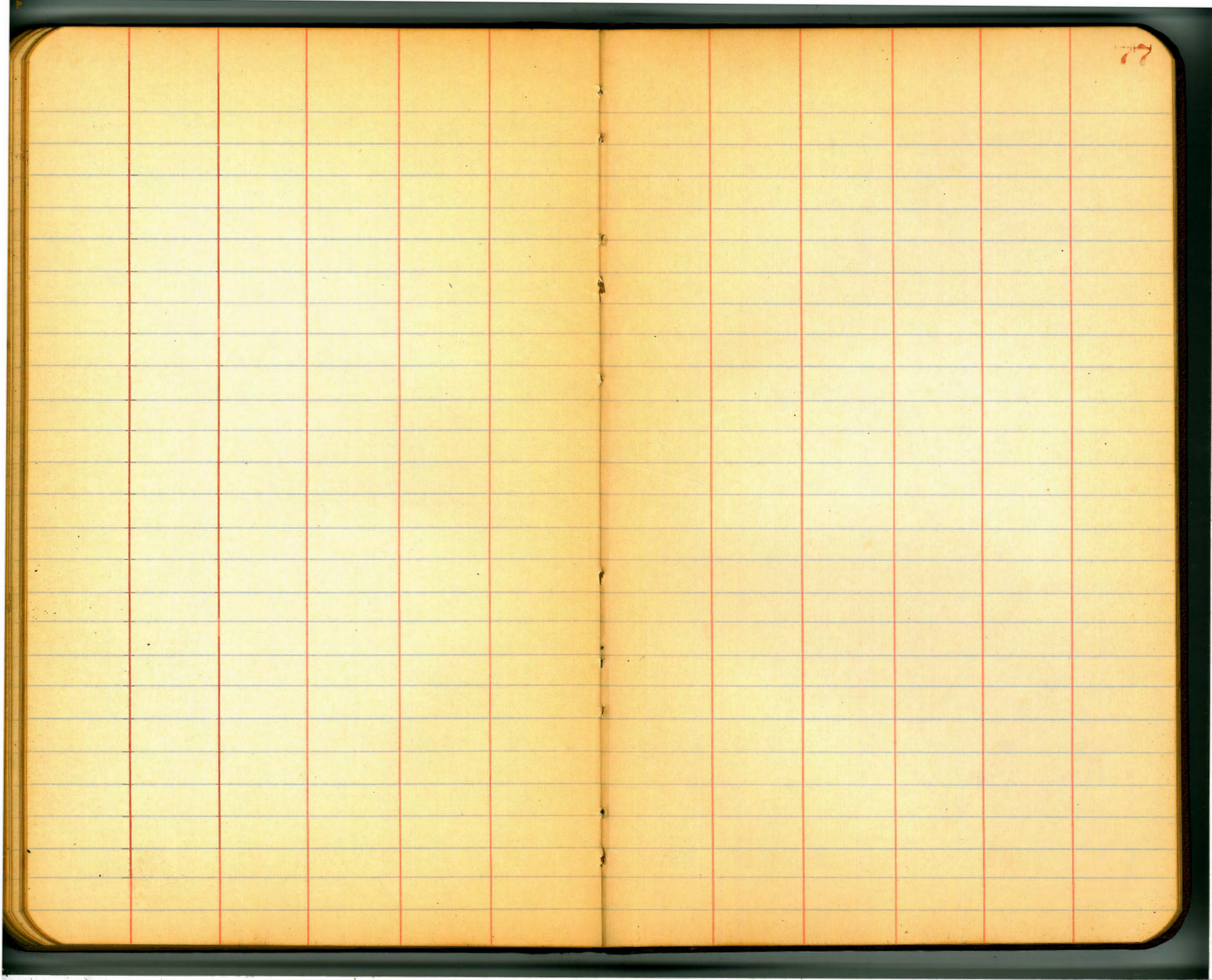

DIRECTIONS FOR USE OF TABLES

TABLE No. 1.

Distance of slope stake from side or shoulder stake for any width roadway, slope $1\frac{1}{2}$ to 1. If ground is nearly level, the cut or fill at side stake is located by the double entry method in left column and top row. The number in body

IMPROVED TABLES

AND

INFORMATION

TABLE No. 2.

To find Tangent and External for curve of any other degree, divide by degree of curve and add correction found in column of corrections.

Degree of curve with a given L may be found by dividing tangent (or external), opposite L by given tangent (or external).

The distance from a point on the tangent to the curve is very nearly the square of the tangent length divided by twice the radius.

DIRECTIONS FOR USE OF TABLES

TABLE No. 1.

Distance of slope stake from side or shoulder stake for any width roadway, slope $1\frac{1}{2}$ to 1. If ground is nearly level, the cut or fill at side stake is located by the double entry method in left column and top row. The number in body of table in same row and column gives distance from side stake to slope stake. If ground is not level estimate the difference in elevation between the side stake and slope stake, lower target by this amount if cut, elevate if fill. Add this amount to cut or fill and find distance in table. Set up rod at this point, and line of sight should cut target. If it does not make the slight adjustment necessary.

TABLE No. 9.

To find Tangent and External for curve of any other degree, divide by degree of curve and add correction found in column of corrections.

Degree of curve with a given I may be found by dividing tangent, (or external), opposite I by given tangent, (or external).

The distance from a point on the tangent to the curve is very nearly the square of the tangent length divided by twice the radius.

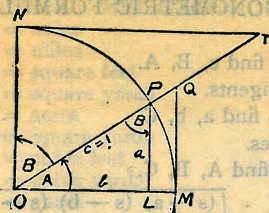

TABLE II

TRIGONOMETRIC FORMULÆ.

$$\begin{aligned} \angle A &= \angle MOP & \angle B &= \angle PON = \angle OPL \\ R &= OB = c = 1 \\ \sin A &= \frac{a}{c} = \frac{a}{1} = a = \cos B = LP \\ \cos A &= \frac{b}{c} = \frac{b}{1} = b = \sin B = OL \\ \tan A &= \frac{a}{b} = \frac{MQ}{OM} = \frac{MQ}{1} = MQ = \cot B = MP \\ \cot A &= \frac{NT}{ON} = \frac{NT}{1} = NT = \tan B = NP \\ \sec A &= \frac{OQ}{OM} = \frac{OQ}{1} = OQ = \csc B = OQ \\ \csc A &= \frac{OT}{ON} = \frac{OT}{1} = OT = \sec B = OT \\ \text{vers } A &= \frac{LM}{OP} = LM = \text{covers } B \end{aligned}$$

$$\begin{aligned} \text{covers } A &= \frac{OP - LP}{OP} = OP - LP = \text{vers } B \\ \text{exsec } A &= PQ = \text{coexsec } B \\ \text{coexsec } A &= PT = \text{exsec } B \end{aligned}$$

$$\sin \frac{1}{2} A = \sqrt{\frac{1 - \cos A}{2}} \qquad \cos \frac{1}{2} A = \sqrt{\frac{1 + \cos A}{2}}$$

$$\sin 2A = 2 \sin A \cos A \qquad \cos 2A = \cos^2 A - \sin^2 A$$

$$\text{Law of Sines} \quad \frac{\sin A}{a} = \frac{\sin B}{b} = \frac{\sin C}{c}$$

$$\text{Law of Cosines} \quad c^2 = a^2 + b^2 - 2ab \cos C$$

$$\text{Law of Tangents} \quad \frac{a+b}{a-b} = \frac{\tan \frac{1}{2}(A+B)}{\tan \frac{1}{2}(A-B)}$$

TABLE X.
MIDDLE ORDINATES OF RAILS
Length of Rail (feet)

C	R	30	28	26	24	22	20	C	R	30	28	26	24	22	20
o	Feet	Inch	Inch	Inch	Inch	Inch	Inch	o	Feet	Inch	Inch	Inch	Inch	Inch	Inch
0-20	17189	.08	.07	.06	.05	.04	.03	8	716.8	1.88	1.64	1.42	1.20	1.01	.84
0-40	8594	.16	.14	.12	.10	.08	.07	9	637.3	2.12	1.84	1.60	1.35	1.14	.94
1-0	5730	.24	.20	.18	.15	.13	.10	10	573.7	2.36	2.05	1.78	1.50	1.27	1.04
1-20	4297	.31	.27	.23	.20	.17	.13	11	521.7	2.59	2.26	1.95	1.65	1.39	1.15
1-40	3438	.39	.34	.29	.25	.21	.17	12	478.3	3.83	2.47	2.15	1.81	1.54	1.26
2-0	2865	.47	.41	.35	.30	.25	.20	13	441.7	3.05	2.66	2.30	1.96	1.66	1.36
2-20	2456	.55	.48	.41	.35	.29	.23	14	410.3	3.30	2.87	2.48	2.10	1.78	1.46
2-40	2149	.63	.55	.47	.40	.33	.27	15	383.1	3.54	3.08	2.68	2.26	1.91	1.57
3-0	1910	.71	.62	.53	.45	.38	.31	16	359.3	3.76	3.28	2.83	2.40	2.04	1.67
3-20	1719	.78	.68	.59	.50	.42	.35	17	338.3	4.00	3.48	3.02	2.57	2.16	1.78
3-40	1563	.86	.75	.65	.55	.46	.38	18	319.6	4.21	3.67	3.18	2.70	2.28	1.87
4-0	1433	.94	.82	.71	.60	.50	.42	19	302.9	4.45	3.89	3.36	2.86	2.41	1.98
4-20	1323	1.02	.89	.77	.65	.55	.45	20	287.9	4.70	4.09	3.55	3.00	2.54	2.09
4-40	1228	1.10	.96	.83	.70	.59	.48	22	262.0	5.16	4.44	3.84	3.30	2.80	2.29
5	1146	1.18	1.03	.89	.75	.63	.52	24	240.5	5.64	4.92	4.20	3.59	3.04	2.50
6	955.3	1.41	1.23	1.06	.90	.76	.62	26	222.3	6.07	5.29	4.58	3.88	3.29	2.70
7	819.0	1.65	1.44	1.24	1.05	.89	.73								

TABLE XI.
SHORT RADIUS CURVES

Radius Feet	Chord Feet	Central Angle	Deflection Angle	Deflection for 1 Foot
35	10	16-26	8-13	49.3
45	10	12-46	6-23	38.3
50	15	17-16	8-38	34.5
60	15	14-22	7-11	28.8
75	15	11-30	5-45	23.0
100	20	11-30	5-45	17.3
120	20	9-34	4-47	14.3
150	20	7-39	3-49	11.5
190	25	7-32	3-46	9.15
200	25	7-10	3-35	8.6
225	25	6-25	3-12	7.7
240	25	5-58	2-59	7.2
250	25	5-44	2-52	6.9
275	25	5-12	2-36	6.2
288	50	9-58	4-59	6.0
300	50	9-32	4-46	5.7
350	50	8-12	4-06	4.9
376	50	7-40	3-50	4.6
400	50	7-10	3-35	4.3
410	50	7-00	3-30	4.2

To find length of curve divide angle from P. C. to P. T. by central angle of chord and multiply by length of chord.

Logan + 37 72 TACKS ON NXX + SW CORNERS
Haywire by 215
TABLE XII.
INCLINED DISTANCE OF 100 FT. REDUCED TO HORIZONTAL

Slope	Horizontal Distance	Correction	Rise Per Foot	Slope	Horizontal Distance	Correction	Rise Per Foot
0°00'	100.000	0.000	0.000	8°00'	99.027	0.973	0.139
15'	99.999	0.001	0.004	15'	98.965	1.035	0.143
30'	99.996	0.004	0.009	30'	98.902	1.098	0.148
45'	99.991	0.009	0.013	45'	98.836	1.164	0.152
1 00	99.985	0.015	0.017	9 00	98.769	1.231	0.156
15	99.976	0.024	0.023	15	98.700	1.300	0.161
30	99.966	0.034	0.026	30	98.629	1.371	0.165
45	99.953	0.047	0.031	45	98.556	1.444	0.169
2 00	99.939	0.061	0.035	10 00	98.481	1.519	0.174
15	99.923	0.077	0.039	15	98.404	1.596	0.178
30	99.905	0.095	0.044	30	98.325	1.675	0.182
45	99.885	0.115	0.048	45	98.245	1.755	0.187
3 00	99.863	0.137	0.052	11 00	98.163	1.837	0.191
15	99.839	0.161	0.057	15	98.079	1.921	0.195
30	99.813	0.187	0.061	30	97.992	2.008	0.199
45	99.786	0.214	0.065	45	97.905	2.095	0.204
4 00	99.756	0.244	0.070	12 00	97.815	2.185	0.208
15	99.725	0.275	0.074	15	97.723	2.277	0.212
30	99.692	0.308	0.078	30	97.630	2.370	0.216
45	99.657	0.343	0.083	45	97.534	2.466	0.221
5 00	99.619	0.381	0.087	13 00	97.437	2.563	0.225
15	99.580	0.420	0.092	15	97.338	2.662	0.229
30	99.540	0.460	0.096	30	97.237	2.763	0.233
45	99.497	0.503	0.100	45	97.134	2.866	0.238
6 00	99.452	0.548	0.105	14 00	97.030	2.970	0.242
15	99.406	0.594	0.109	15	96.923	3.077	0.246
30	99.357	0.643	0.113	30	96.815	3.185	0.250
45	99.307	0.693	0.118	45	96.705	3.295	0.255
7 00	99.255	0.745	0.122	15 00	96.593	3.407	0.259
15	99.200	0.800	0.126	15	96.479	3.521	0.263
30	99.144	0.856	0.131	30	96.363	3.637	0.267
45	99.087	0.913	0.135	45	96.246	3.754	0.271

TABLE XIII.
MINUTES IN DECIMALS OF A DEGREE.

0 30"	.00833	10 30"	.17500	20 30"	.34167	30 10"	.50833	40 30"	.67500	50 10"	.84167
1 00	.01667	11 00	.18333	21 00	.35000	31 00	.51667	41 00	.68333	51 00	.85000
30	.02500	30	.19167	30	.35833	30	.52500	30	.69167	30	.85833
2 00	.03333	12 00	.20000	22 00	.36667	32 00	.53333	42 00	.70000	52 00	.86667
30	.04167	30	.20833	30	.37500	30	.54167	30	.70833	30	.87500
3 00	.05000	13 00	.21667	23 00	.38333	33 00	.55000	43 00	.71667	53 00	.88333
30	.05833	30	.22500	30	.39167	30	.55833	30	.72500	30	.89167
4 00	.06667	14 00	.23333	24 00	.40000	34 00	.56667	44 00	.73333	54 00	.90000
30	.07500	30	.24167	30	.40833	30	.57500	30	.74167	30	.90833
5 00	.08333	15 00	.25000	25 00	.41667	35 00	.58333	45 00	.75000	55 00	.91667
30	.09167	30	.25833	30	.42500	30	.59167	30	.75833	30	.92500
6 00	.10000	16 00	.26667	26 00	.43333	36 00	.60000	46 00	.76667	56 00	.93333
30	.10833	30	.27500	30	.44167	30	.60833	30	.77500	30	.94167
7 00	.11667	17 00	.28333	27 00	.45000	37 00	.61667	47 00	.78333	57 00	.95000
30	.12500	30	.29167	30	.45833	30	.62500	30	.79167	30	.95833
8 00	.13333	18 00	.30000	28 00	.46667	38 00	.63333	48 00	.80000	58 00	.96667
30	.14167	30	.30833	30	.47500	30	.64167	30	.80833	30	.97500
9 00	.15000	19 00	.31667	29 00	.48333	39 00	.65000	49 00	.81667	59 00	.98333
30	.15833	30	.32500	30	.49167	30	.65833	30	.82500	30	.99167
10 00	.16667	20 00	.33333	30 00	.50000	40 00	.66667	50 00	.83333	60 00	1.00000

C
0 / F
0-20 17
0-40 8
1-0 5
1-20 4
1-40 3
2-0 2
2-20 2
2-40 2
3-0 1
3-20 1
3-40 1
4-0 1
4-20 1
4-40 1
5 1
6 8
7 9

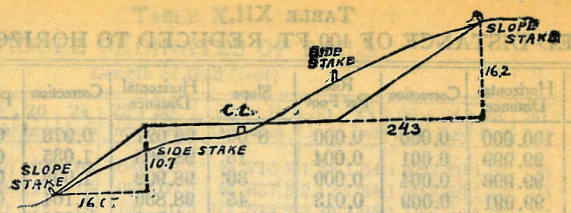

DISTANCES FROM SIDE STAKES FOR CROSS-SECTIONING:

SLOPE 1 1/2 TO 1. ROADWAY OF ANY WIDTH.

	0	.1	.2	.3	.4	.5	.6	.7	.8	.9	
0	0.00	0.15	0.30	0.45	0.60	0.75	0.90	1.05	1.20	1.35	0
1	1.50	1.65	1.80	1.95	2.10	2.25	2.40	2.55	2.70	2.85	1
2	3.00	3.15	3.30	3.45	3.60	3.75	3.90	4.05	4.20	4.35	2
3	4.50	4.65	4.80	4.95	5.10	5.25	5.40	5.55	5.70	5.85	3
4	6.00	6.15	6.30	6.45	6.60	6.75	6.90	7.05	7.20	7.35	4
5	7.50	7.65	7.80	7.95	8.10	8.25	8.40	8.55	8.70	8.85	5
6	9.00	9.15	9.30	9.45	9.60	9.75	9.90	10.05	10.20	10.35	6
7	10.50	10.65	10.80	10.95	11.10	11.25	11.40	11.55	11.70	11.85	7
8	12.00	12.15	12.30	12.45	12.60	12.75	12.90	13.05	13.20	13.35	8
9	13.50	13.65	13.80	13.95	14.10	14.25	14.40	14.55	14.70	14.85	9
10	15.00	15.15	15.30	15.45	15.60	15.75	15.90	16.05	16.20	16.35	10
11	16.50	16.65	16.80	16.95	17.10	17.25	17.40	17.55	17.70	17.85	11
12	18.00	18.15	18.30	18.45	18.60	18.75	18.90	19.05	19.20	19.35	12
13	19.50	19.65	19.80	19.95	20.10	20.25	20.40	20.55	20.70	20.85	13
14	21.00	21.15	21.30	21.45	21.60	21.75	21.90	22.05	22.20	22.35	14
15	22.50	22.65	22.80	22.95	23.10	23.25	23.40	23.55	23.70	23.85	15
16	24.00	24.15	24.30	24.45	24.60	24.75	24.90	25.05	25.20	25.35	16
17	25.50	25.65	25.80	25.95	26.10	26.25	26.40	26.55	26.70	26.85	17
18	27.00	27.15	27.30	27.45	27.60	27.75	27.90	28.05	28.20	28.35	18
19	28.50	28.65	28.80	28.95	29.10	29.25	29.40	29.55	29.70	29.85	19
20	30.00	30.15	30.30	30.45	30.60	30.75	30.90	31.05	31.20	31.35	20
21	31.50	31.65	31.80	31.95	32.10	32.25	32.40	32.55	32.70	32.85	21
22	33.00	33.15	33.30	33.45	33.60	33.75	33.90	34.05	34.20	34.35	22
23	34.50	34.65	34.80	34.95	35.10	35.25	35.40	35.55	35.70	35.85	23
24	36.00	36.15	36.30	36.45	36.60	36.75	36.90	37.05	37.20	37.35	24
25	37.50	37.65	37.80	37.95	38.10	38.25	38.40	38.55	38.70	38.85	25
26	39.00	39.15	39.30	39.45	39.60	39.75	39.90	40.05	40.20	40.35	26
27	40.50	40.65	40.80	40.95	41.10	41.25	41.40	41.55	41.70	41.85	27
28	42.00	42.15	42.30	42.45	42.60	42.75	42.90	43.05	43.20	43.35	28
29	43.50	43.65	43.80	43.95	44.10	44.25	44.40	44.55	44.70	44.85	29
30	45.00	45.15	45.30	45.45	45.60	45.75	45.90	46.05	46.20	46.35	30
31	46.50	46.65	46.80	46.95	47.10	47.25	47.40	47.55	47.70	47.85	31
32	48.00	48.15	48.30	48.45	48.60	48.75	48.90	49.05	49.20	49.35	32
33	49.50	49.65	49.80	49.95	50.10	50.25	50.40	50.55	50.70	50.85	33
34	51.00	51.15	51.30	51.45	51.60	51.75	51.90	52.05	52.20	52.35	34
35	52.50	52.65	52.80	52.95	53.10	53.25	53.40	53.55	53.70	53.85	35
36	54.00	54.15	54.30	54.45	54.60	54.75	54.90	55.05	55.20	55.35	36
37	55.50	55.65	55.80	55.95	56.10	56.25	56.40	56.55	56.70	56.85	37
38	57.00	57.15	57.30	57.45	57.60	57.75	57.90	58.05	58.20	58.35	38
39	58.50	58.65	58.80	58.95	59.10	59.25	59.40	59.55	59.70	59.85	39
40	60.00	60.15	60.30	60.45	60.60	60.75	60.90	61.05	61.20	61.35	40
41	61.50	61.65	61.80	61.95	62.10	62.25	62.40	62.55	62.70	62.85	41
42	63.00	63.15	63.30	63.45	63.60	63.75	63.90	64.05	64.20	64.35	42
43	64.50	64.65	64.80	64.95	65.10	65.25	65.40	65.55	65.70	65.85	43
44	66.00	66.15	66.30	66.45	66.60	66.75	66.90	67.05	67.20	67.35	44
45	67.50	67.65	67.80	67.95	68.10	68.25	68.40	68.55	68.70	68.85	45
46	69.00	69.15	69.30	69.45	69.60	69.75	69.90	70.05	70.20	70.35	46
47	70.50	70.65	70.80	70.95	71.10	71.25	71.40	71.55	71.70	71.85	47
48	72.00	72.15	72.30	72.45	72.60	72.75	72.90	73.05	73.20	73.35	48
49	73.50	73.65	73.80	73.95	74.10	74.25	74.40	74.55	74.70	74.85	49
50	75.00	75.15	75.30	75.45	75.60	75.75	75.90	76.05	76.20	76.35	50

Computed by L. Leland Locke.

6
12 + 68.40
1 40
20
1 40

15 + 68.40

15 + 69⁰⁰ = 0 + 00

To find

369.92
364.42
5.50

303.69
49.75

π 304.94
- 11.89

79
50
19

π 292.55
+ 0.59

254.96

π 293.24
- 1.11

- 0.35

2+79.85
7.50

π 292.13
+ 0.10

π 254.61
12.90

3+87.35
7.50

π 292.63
+ 0.10

257.51
0.20

ENGINEERING DEPARTMENT
CITY OF CALIFORNIA, SAN DIEGO.

π 292.73
+ 0.10

267.31
1.28

π 287.83
- 4.64

280.20
0.64

π 291.50
+ 3.47

279.56
11.72

π 290.78
+ 0.52

291.28
2.58

290.78
2.42

288.64
11.58

π 293.20
+ 1.96

300.18
4.96

1307
π 280.13
+ 0.11

298.21
7.06

π 280.24
+ 13.18

305.27
1.58

267.06
0.21

303.69

π 267.27
- 12.90

254.35
0.61

π 254.96

10.24.50 314.80
1.04

315.84
11.54

68.70

80

304.30
7.32

35

52

311.62
4.38

33.70

28

307.24

3+79.85
15

394.85

149.60

99.60

50

149.60

29.70

119.90

74.60

45.30