

1382

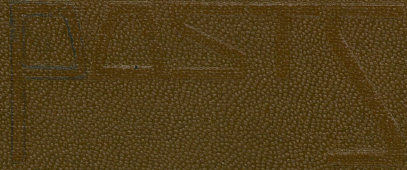

LEVEL BOOK

No. 380

S.W. 38th & Monroe - 374.50

MICROFILMED
DEC 23 1964

Our Leather Bound Engineers Note Books are carried in the following rulings.

- No. 380 LEVEL BOOK. Left and Right Hand Page the same as Left Hand Page of this Book.
- No. 382 FIELD BOOK. Left Hand Page as in this Book, Right Hand Page 4 x 4 to the inch, Center Line Red.
- No. 384 MINING TRANSIT BOOK. Left Hand Page as in this Book, Right Hand Page 8x8 to the inch, Center Line Red.
- No. 385 FIELD BOOK. Left Hand Page as in this Book, Right Hand Page 8 vertical and horizontal lines to the inch, Center Line Red.

We also carry the Note Books listed above, bound in extra strong Fabri-Hide (otherwise the same quality of book), which can be furnished at a somewhat lower price.

In ordering Fabri-Hide covered books, add the letter "F" to catalog number.

THE FREDERICK POST CO.
ENGINEERING and DRAFTING SUPPLIES
 IRVING PARK STATION
 CHICAGO, ILL.

ENGINEERING DEPARTMENT,
UNIVERSITY OF CHICAGO, CHICAGO, ILL.

X Sec	39 th St	Monroe to N. end	4
" "	Morena and Sherman		1
	Grain levels on Anna		3
" "	Intersection of 6 th and Upas		12
" "	Upas	6 th to 7 th	17
" "	7 th	Upas North	22
Survey	for St. opening from 6 th & Thorn to 7 th St.		42
X. Sec.	29 th St.	MAIN St. - COLTON AVE.	43
" "	Felton St	Adams to Madison	48
" "	ALLEY Bk. "C"	PLUMOSA PARK	50
" "	6 th St.	Lauret to Upas	51
" "	Landis	Fairmount to 44 th	70
" "	Alley Bk. 10	City Heights Annex No. 1.	73
" "	Dnight	Fairmount to 44 th	76

L 28-30

C. Bliss

Drebert π

Favner

Clavert

Levels at Moreno + Sherman

1

S. M. Pueblo Mon. Page 5-1368

7.28

+ 863

 π 15.91

S.W. P.C. Sherman + Moreno - See Plans for Improvement

W.L. Moreno 10.2 57

+ 8 8.9 7.0

+ 19 5.8 10.1

+ 26 1.2 14.7

+ 32 = West edge paving 13.7 14.54

+ Paving 1.19 14.72

East edge Paving 1.41 14.50

Section at S.W. Cor Sherman + Moreno

East edge paving 1.38 14.53

+ 1.20 14.71

West edge paving 1.43 14.48

+ 6 1.2 14.7

+ 15 6.6 9.3

+ 23 7.2 8.7

+ 30 9.9 6.0

+ 32 = S.W. Cor Sherman + Moreno 10.2 57

1591

Section at Intersection of & Sherman

* W.L. Morena		
W.L. Morena	10.7	5.2
+11	7.1	8.8
+16	6.1	9.8
+26	1.0	14.9
+32 = West edge paving	1.38	14.53
& Paving	1.17	14.74
East edge paving	1.42	14.49

0+00 Section at N.W. Cor. Morena + Sherman

East edge paving	1.40	14.51
&	1.09	14.82
West edge paving	1.31	14.60
+5	1.1	14.8
+12	6.1	9.8
+17 = W.L. Morena	6.9	9.0

0+25.45

W.L. Morena	6.9	9.0
+5	6.1	9.8
+12	1.2	14.7
+17 = West edge paving	1.26	14.65
&	1.05	14.86
East edge paving	1.30	14.61

1591

2

0+50.91 - PC. See Improvement Plans

East edge paving	1.20	14.71
&	0.99	14.92
West edge paving	1.16	14.75
+5	1.4	14.5
+12	5.3	10.6
+17 = W.L. Morena	6.5	9.4

All sections at Right Angle
to Morena Blvd

Drain Levels on Anna (Sherman)

On Line 5' West of W.L. Moreno
South of Sherman + parallel to it

0+00	12.3	3.6
0+25	11.6	4.3
0+50 = N.L. Sherman	12.0	3.9
0+75	11.3	4.6
1+09 = S.L. Sherman	11.0	4.9
1+25	10.6	5.3
1+50	10.4	5.5

On Line crossing N.L. Sherman

at 6+58 and S.L. at 6+75 (See section Notes)

B.M. Pueblo Mori - Page 5-1368
+400

	Σ 11.28	
0+00	10.0	1.28
+25	12.0	-0.72
+38	13.1	-1.82
+50 = N.L. Sherman	11.6	-0.3
+70	6.4	4.9
1+04 = S.L. Sherman	6.5	4.8
1+50	6.9	4.4
2+00	5.7	5.6

Note - Depression North of Sherman
has no outlet and is a sump-hole

On Line 35' East of + Parallel to East
Rail of Santa Fe R.R.

Top Rail Intersection St. Anna West Rail S.F.R.R. 14.28
+208

	Σ 16.36	
0+00 = 100'S of St. Anna	9.7	6.7
0+50	9.3	7.1
1+00 = S.L. Anna	9.8	6.6
1+50.5 = N.L. Anna	10.7	5.7
2+00	11.0	5.4
2+50	11.3	5.1

On a Line 32' West of West Rail and
Parallel to it

0+00 = 100'S of St. Anna	10.4	6.0
0+50	11.7	4.7
1+00 = S.L. Anna	12.1	4.3
1+50.5 = N.L. Anna	12.1	4.3
2+00	12.3	4.1
2+50	12.1	4.3

1-28-30 X-section 39th Street -
 J.C. Bliss 60' wide
 Drebert & Monroe to North End. 12' cbs
 Rauner 9' 1/2 cbs
 Clavert

B.M. S.W.B.P. 38th + Monroe 374.50

0.77

T 375.27

50' West of W.L. 39th on North cb Line Monroe

Top cb 463
 G 517

West end N.W. Return 39th + Monroe

Top cb 6.24 369.03
 G 6.68 368.59

East end N.E. Return 39th + Monroe

Top cb 6.75 368.52
 G 7.25 368.02

50' East of E.L. 39th on North cb Line Monroe

Top cb 6.30
 G 6.77

N.L. Monroe = 0+00

E Top cb 6.82 368.45 ✓
 G 7.46 367.81 ✓

1/4 6.98 368.29
 1/4 6.76 368.51 ✓

1/4 6.78 368.49
 G 6.95 368.32 ✓

W Top cb 6.32 368.95 ✓

Plotted 1/30/30
 C.B.H.

T 375.27

4

0+25

W Top cb 6.62 368.65

G 7.0 368.3

1/4 6.7 368.6

1/4 6.7 368.6

G 7.0 368.3

G 7.6 367.7

E Top cb 6.90 368.37

0+50

E Top cb 7.04 368.23

G 7.8 367.5

1/4 7.1 368.2

1/4 6.9 368.4

G 7.1 368.2

G 7.4 367.9

W Top cb 6.76 368.51

0+75

W Top cb 6.90 368.37

G 7.5 367.8

1/4 7.3 368.0

1/4 7.0 368.3

G 7.2 368.1

G 7.9 367.4

E Top cb 7.19 368.08

π375.27

+100

E Tpcb	7.28	367.99
G	7.9	367.4
1/4	7.3	368.0
⊕	7.1	368.2
1/4	7.3	368.0
G	7.6	367.7
W Tpcb	7.02	368.25

+25

W Tpcb	7.20	368.07
G	7.1	367.6
1/4	7.4	367.9
⊕	7.2	368.1
1/4	7.4	367.9
G	8.0	367.3
E Tpcb	7.42	367.85

+50

E Tpcb	7.55	367.72
G	8.1	367.2
1/4	7.6	367.7
⊕	7.4	367.9
1/4	7.6	367.7
G	8.0	367.3
W Tpcb	7.40	367.87

π375.27

+75

5

W Tpcb	7.60	367.67
G	8.1	367.2
1/4	7.8	367.5
⊕	7.5	367.8
1/4	7.8	367.5
G	8.1	367.2
E Tpcb	7.66	367.61

+100

E Tpcb	7.78	367.49
G	8.3	367.0
1/4	8.0	367.3
⊕	7.7	367.6
1/4	7.9	367.4
G	8.2	367.1
W Tpcb	7.70	367.57

+25

W Tpcb	7.88	367.39
G	8.4	366.9
1/4	8.1	367.2
⊕	7.8	367.5
1/4	8.1	367.2
G	8.4	366.9
E Tpcb	7.91	367.36

T 375.27

2450

E Tpcb	7.94	367.33
G	8.5	366.8
1/4	8.2	367.1
£	7.9	367.4
1/4	8.1	367.2
G	8.4	366.9
W Tpcb	7.92	367.35

2475

W Tpcb	8.15	367.12
G	8.6	366.7
1/4	8.2	367.1
£	8.0	367.3
1/4	8.2	367.1
G	8.6	366.7
E Tpcb	8.08	367.19

T.P.

8.00 367.27

+4.30

T 371.57

3415 S.L. Mission on West abline 3975

E Tpcb	7.54	367.03
G	5.0	366.6
1/4	4.5	367.1
£	4.4	367.2
1/4	4.7	366.9
G	5.2	366.4
W Tpcb	4.62	366.95

T 371.57

100' wide - 25' cb - 12 1/2' 1/4

6

S.L. Mission T-3415 West ab line + 3425 East ab line

W Tpcb	4.62	366.95
1/4	4.7	366.8
£	4.4	367.2
1/4	4.6	367.0
G	5.1	366.5
E Tpcb	4.60	366.97

Section between ends of returns South

Side Mission - 3425.4 West ab line 3975
+ 3448.5 East ab line Mission

E Tpcb	4.63	366.94
G	5.1	366.5
1/4	4.6	367.0
£	4.4	367.2
1/4	4.5	367.1
G	5.0	366.6
W Tpcb	4.66	366.91

Note - Split Roadway of Mission on W.L.
3975 into 4 parts (59') + on E.L. (19') and took
sections between these divisions - Sketch Page 11

5 cb Mission

W.L. Tpcb	4.81	366.76
G	5.1	366.5
cb	5.1	366.5
1/4	4.6	367.0
£	4.5	367.1

T 371.57

1/4		47	3669
cb		5.0	3666
E.L. Top cb		4.64	36693
G		4.9	3667
	5 1/4		
E		4.8	3668
cb		5.0	3666
1/4		4.8	3668
♀		4.6	3670
1/4		4.8	3668
cb		5.2	3664
w		4.7	3669
	♀ Mission		
w		4.9	3667
cb		5.4	3652
1/4		5.0	3666
♀		4.7	3669
1/4		4.9	3667
cb		5.4	3662
E		4.6	3670
	N 1/4		
E		5.0	3666
cb		5.5	3661
1/4		5.1	3665
♀		5.1	3665

T 371.57

1/4		5.3	3663
cb		5.6	3660
w		5.2	3664
	N cb		
w.L. Top cb		5.40	36617
G		5.7	3658
cb		5.8	3658
1/4		5.4	3662
♀		5.0	3666
1/4		5.2	3664
cb		5.6	3660
E.L. Top cb		5.07	36650
G		5.5	3661

Section between ends of returns North side
of Mission - 5' South of N.L. on East side + 11.8' South
of N.L. on West side

E Top cb		5.20	36631
G		5.1	3657
1/4		5.3	3663
♀		5.2	3664
1/4		5.6	3660
G		5.9	3657
w Top cb		5.62	36595

↑ 371.57

N.L. Mission = 3425.5 on W obline 39th + 2493.75 on Eccline

W Tpcb 570 365 87

G 6.0 365 6

1/4 57 365 9

⊕ 53 366 3

1/4 54 366 2

G 59 365 7

ETpcb 522 366 35

2493.75

E Tpcb 522 366 35

G 59 365 7

1/4 54 366 2

⊕ 52 366 4

1/4 57 365 9

G 6.2 365 4

W Tpcb 582 365 75

2450

W Tpcb 595 365 62

G 6.4 365 2

1/4 59 365 7

⊕ 54 366 2

1/4 56 366 0

G 6.1 365 5

E Tpcb 540 366 17

↑ 371.57

8

2425

E Tpcb 555 366 02

G 6.4 365 2

1/4 58 365 8

⊕ 55 366 1

1/4 6.0 365 6

G 6.5 365 1

W Tpcb 599 365 58

2400

W Tpcb 6.06 365 51

G 6.6 365 0

1/4 6.1 365 5

⊕ 5.7 365 9

1/4 5.9 365 7

G 6.5 365 1

E Tpcb 570 365 87

1475

E Tpcb 582 365 75

G 6.6 365 0

1/4 5.8 365 8

⊕ 5.8 365 8

1/4 6.0 365 6

G 6.8 364 8

W Tpcb 6.19 365 38

π 371.57

1+50

W Tpcb	6.22	365.35
G	6.8	364.8
1/4	6.2	365.4
ϕ	5.9	365.7
1/4	6.0	365.6
G	6.6	365.0
E Tpcb	5.92	365.65

1+25

E Tpcb	6.04	365.53
G	6.8	364.8
1/4	6.1	365.5
ϕ	5.9	365.7
1/4	6.4	365.2
G	6.8	364.8
W Tpcb	6.32	365.25

1+00

W Tpcb	6.43	365.14
G	6.9	364.7
1/4	6.5	365.1
ϕ	6.1	365.5
1/4	6.3	365.3
G	7.0	364.6
W Tpcb	6.17	365.40

π 371.57

0+75

9

E Tpcb	6.28	365.29
G	6.9	364.7
1/4	6.3	365.3
ϕ	6.1	365.5
1/4	6.6	365.0
G	7.1	364.5
W Tpcb	6.54	365.03

0+23 = End of concrete gutter both sides

3' East side
4' West

W Tpcb	6.60	364.97
G	7.09	364.48
Edge gutter	6.78	364.79
1/4	6.6	365.0
ϕ	5.9	365.7
1/4	6.4	365.2
Edge Gutter	6.80	364.77
G	7.02	364.55
E Tpcb	6.53	365.04

0+03 = Edge gutter across N end 39"

E	6.68	364.89
G	7.33	364.24
1/4	7.23	364.34
ϕ	7.20	364.37
1/4	7.20	364.37
Gutter-Driveway	7.42	364.15 ✓

7371.57

0+00 = N. End 39th - Curb across end st

W-gutter in Driveway	7.48	364 09	✓
1/4-G	7.55	364 02	
Tpcb	6.81	364 76	✓
1/4-G	7.53	364 04	✓
Tpcb	6.76	364 81	✓
1/4-G	7.55	364 02	
Tpcb	6.80	364 77	
E-G	7.53	364 04	✓
E Tpcb	6.75	364 82	✓

N cb. Mission 50' W of W.L. 39th

Tpcb	4.83	
G	5.3	

S cb Line Mission 50' West of W.L. 39th.

Tpcb	4.10	
G	4.5	

S cb Line Mission 50' East of E.L. 39th

Tpcb	4.25	
G	4.5	

N cb Line Mission 50' East of E.L. 39th

Tpcb	4.88	
G	5.3	
T.P.	4.19	367.38

+7.90 375 28

B.M.S. W. B.P. 38th + Monroe	0.77	374 51
------------------------------	------	--------

Detail North
End 39th
Curb Line Distances
are Approximate

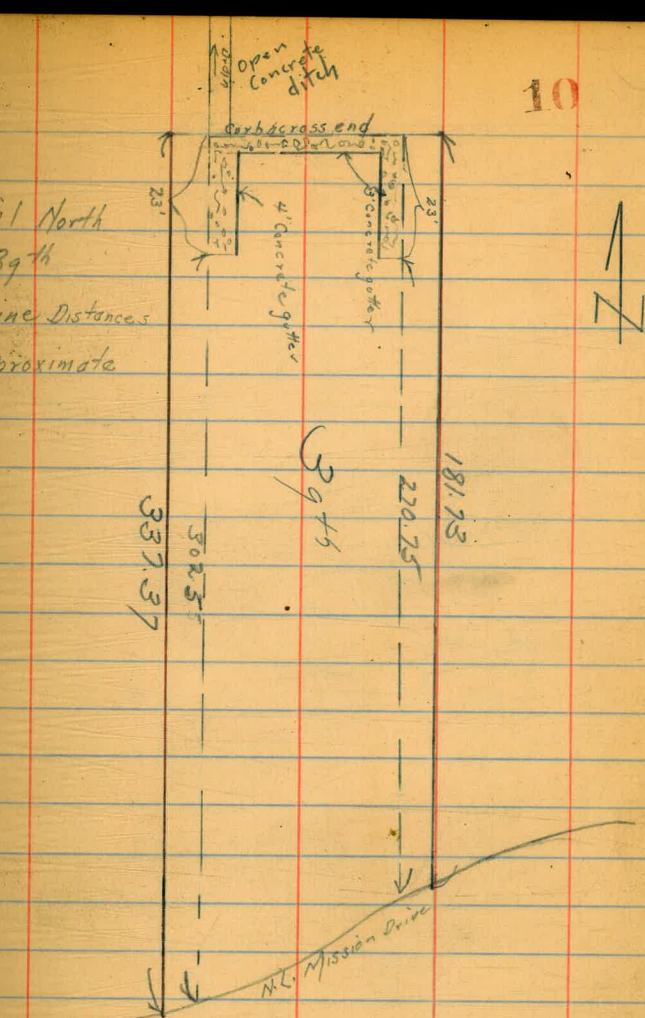

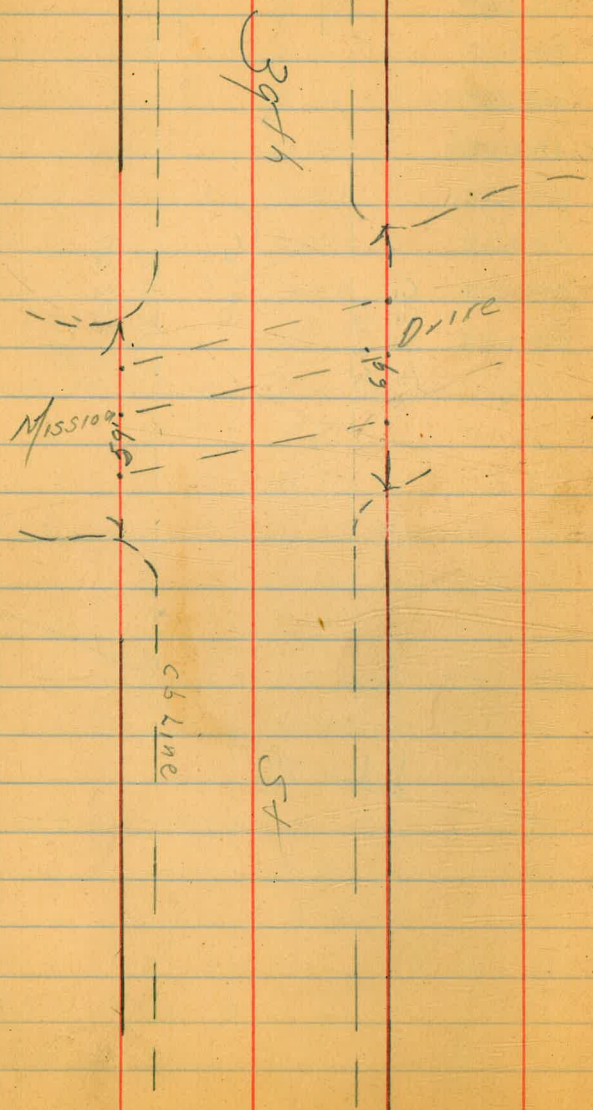

	R95.13		
+ 59 gutter pavmt.	S. line - Upas (20h) 6.36	288.77	
+ 59 dirt to S.	6.1	289.0	
+ 59 S. End S. ent. cl.	5.86	289.27	
+ 60 on Lawn.	5.8	289.3	

5' N. of S. line - Upas

S. ent. cl.	5.76	289.37
gutter Pavmt.	6.18	288.95
+ 14 E "	5.90	289.23
+ 29 "	5.85	289.21
+ 44 "	5.94	289.19
+ 59 gutter pavmt	6.40	288.73

w. ent. cl. = 20' E. of w. line - Park.	6.07	289.06
---	------	--------

Upas on W. { 52' Rdw
13' Ups
14' cl. } 2 Upas on E. into Park { 46' Rdw.
11.5' Ups
15.5' sel. ons. }

Sections taken from { S. side on W. to S. cl. on E.
4' on W. to 4' " E.
" " " " " E.
N. 1/4 " W. " N. 1/4 " "
W. cl. " " N. cl. on E. }

S. cl.

70' W. of w. cl. gutter pavmt	7.33	287.80
32' " " " " "	6.74	288.39
20' " " " " " "	6.56	288.57
20' " " " " = w. line to S. ent. cl.	6.08	289.05
w. cl.	6.21	288.92
+ 15	5.80	289.33
+ 30	5.65	289.48
+ 44 E	5.66	289.47
+ 59 = E. cl. line	5.80	289.33
+ 74 E edge pavmt. in gutter + dirt to E.	5.53	289.60
+ 74 E End. ent. cl.	5.29	289.84

295.13
- 5.47

6" + 2 Upas.

13

E. edge pavmt. + dirt to E	5.12	290.01
E. cl. line	5.15	289.98
+ 14.5	5.30	289.83
+ 29	5.35	289.78
+ 44	5.56	289.57
+ 59 = w. cl. line to S.	5.94	289.19
20' W = w. line - Park	6.18	288.95
32' W	6.31	288.82
70' W	6.96	288.17

6" + 2 Upas

70' W. of w. cl.	6.90	288.23
32' " " " "	6.11	289.02
20' " " " " = w. line - Park	5.94	289.19
w. cl. line	5.76	289.37
+ 15	5.47	289.66
+ 30	5.16	289.97
+ 44.5	5.00	290.13
+ 59 = E. cl. line	4.86	290.27
15' E. = E. edge pavmt.	4.84	290.29
16' E dirt	4.7	290.4

N. 1/4

E. edge pavmt + dirt to E.	4.87	290.26
E. cl. line	4.86	290.27
+ 14.5	5.02	290.11
+ 29	5.20	289.93
+ 44	5.48	289.65

295.13		
9.3 N. of S. ch. 2 pas to E. = W. Line Park.		
R.R. W. of W. line Park = w. ch on curve	6.02	289.11
" " " " gutter	6.73	288.40
W. line Park	6.58	288.60
10' E	6.19	288.94
20' E = W. ch Line produced from S.	5.91	289.22
23' E = E. ch line 6 th " " N.	5.86	289.27
33' E. E. line 6 th " " N.	5.76	289.37
35' E.	5.74	289.39
+ 50	5.51	289.62
+ 64.5	5.30	289.83
+ 79. = E. ch. produced from S.	5.04	290.09
+ 94 = E. line 6 th " " "	5.03	290.10
7.9 N. of N. Line Park		
E. Line 6 th	5.03	290.10
E. ch line	5.10	290.03
+ 14.5	5.39	289.74
+ 29	5.60	289.53
+ 44	5.85	289.28
+ 46 E. line 6 th Produced from N	5.90	289.23
+ 56 " ch line 6 th " " "	5.94	289.19
+ 59	5.97	289.16
+ 69	6.17	288.96
+ 79 = W. line Park produced N.	6.66	288.47
6.4 W. of W. line Park = gutter	6.82	288.31
" " " " " = cent. ch.	6.14	288.99
158 N. of Park Line		
9.4 W. of W. line Park = w. cent. ch	6.39	288.74
" " " " " gutter	6.94	288.17
W. line Park Produced N.	6.58	288.55
10' E	6.18	288.75

295.13		6 th + 2 pas.	15
20' E = W. ch Produced from S.	6.04	289.09	
23' E = E. " 6 th Produced from N.	6.01	289.12	
33' " = E. line 6 th " " "	6.00	289.13	
35' E.	5.99	289.14	
50' E	5.80	289.33	
64.5	5.63	289.50	
79' E = E. ch Produced	5.37	289.76	
94' E = E. line produced from S.	5.24	289.87	
24' N of N. Line Park = N. ch 2 pas to E. on E. line 6 th to N.			
23.7 N. of N. line Park = N. ch. 2 pas to E. on E. line 6 th to S.			
E. line 6 th produced from S.	5.72	289.41	gutter ↓
" " " " " " "	5.13	290.00	N. cent. ch ↓
E. ch line " " " "	5.85	289.28	gutter
" " " " " " "	5.23	289.90	N. cent. ch.
14.5 W	6.01	289.12	gutter
14.5 W	5.39	289.75	N. cent. ch.
29' W.	6.15	288.98	gutter
29' W	5.49	289.64	N. cent. ch.
46 W = E. line 6 th to N	6.28	288.85	gutter ↓
" " = " " " " "	5.64	289.49	N. cent. ch. ↓
56 W = E. ch " " " "	6.20	288.93	parmt.
69 " " " " " "	6.15	288.98	"
79 " = W. line Park Produced.	6.54	288.59	"
89 " = W. ch. of 6 th to N	7.02	288.11	gutter drive No cent. ch.

295.13

6' N. of N. ch. Upas to E. = N. line Upas to E.

10' W. W. line Park = W. emt. ch. 6th to N. 6.78 288.35

" " " " " = gutter. 7.09 288.04

W. line Park produced N. 6.48 288.65

10' E 6.24 288.89

23' E = gutter. 6.38 288.75

23' E = E. emt. ch. of 6th to N 5.59 289.54

50' N. of N. line Upas

E. emt. ch. 5.90 289.23

gutter 6.66 288.47

13' W 6.50 288.63

23' W 6.89 288.24

33' W = gutter 7.48 287.65

" " W. emt. ch 7.10 288.03

Upas 5th X Sec. 6th To 7th7/7/30
gutters.w. 6th

+ Upas

294.61

17

B.M.	5.54	294.61	289.07	15.6 N	4.70	294.6
00 = E. line 6 th Produced from S. 74' E. of N. line Park.				23.4 N of Park Line = gutter	4.80	289.91
N. eb.	4.60	290.01	" " " " = New. eb.	4.35	290.26	
gutter	5.20	289.41	58' E			
+ 7.9	4.74	289.87	39.5 S. of N. line Park Palm 30" Diam			
+ 15.8	4.51	290.10	70' E			
+ 23.7 = N. line Park	4.52	290.09	23.3 N. of Park line = N. cont. eb.	5.00	289.61	
9.3 S = gutter	4.73	289.88	" " " " = gutter	5.50	289.11	
4.1 " = S. cont. eb.	4.31	290.30	15.6 " " " "	5.26	289.35	
15 S	4.1	290.5	7.8 " " " "	5.18	289.43	
50 S	4.2	290.4	N. line Park	5.23	289.38	
	4.5 E		9.7 S " " " = gutter	5.50	289.11	
28' S. of N. line Park Palm 20" Diam			" " " " " = " " cont. eb.	5.09	289.52	
	19.5 E		15.6 " " " " dirt walk	4.9	289.7	
32.5 S. of N. line Park Palm 30" Diam			15.6 " " " " Top wall	3.67	290.94	
	22.5 E		30. " " " " "	3.3	291.3	
52.3 S. of N. line Park Palm 28" Diam			50. " " " " "	3.3	291.3	
	39. E Brk in cbs.					
50' S. of N. line Park	3.6	291.0	76' E			
30 " " " " "	3.5	291.1	21.5 S. N. line Park Cypress Tree 40" Diam			
15.5 " " " " "	3.73	290.9	85' E			
154 " " " " " dirt walk	4.4	290.2	50.5 S. of N. line Park Mesquite Tree 24" Diam			
9.6	4.50	290.1	100' E			
gutter	4.97	289.64	50' S. of N. line Park	3.1	291.5	
N. line park	4.69	289.92	30 " " " " "	3.1	291.5	
7.4 N	4.60	290.01	15.7 " " " " " Top wall	3.50	291.11	
			15.7 " " " " " dirt walk	5.5	289.1	

294.61		100' E (con)		294.6
9.8 S. of N. Line Park	s. ent. el	5.67	288.94	4" curb
9.8 " " " "	gutter	6.08	288.53	
" " " "		5.82	288.79	
7.7 N " " "		5.77	288.84	
15.4 N " " "		5.89	288.72	
23.1 N " " "	gutter	6.13	288.48	
23.1 N " " "	N. ent. el.	5.65	288.96	

111.5 E

25.5 S. of N. Line Park Pepper Tree 20" Diam
 52.5 S " " " Pine " 26" Diam

120.8

23' N. of Park Line	N. ent. el.	6.08	288.53
23' " " " "	gutter	6.52	288.09
15.4 " " " "		6.29	288.32
7.7 " " " "		6.18	288.43
" " " "		4.23	288.38
10' S " " "	gutter	6.43	288.18
10' S " " "	s. ent. el.	6.05	288.56
15.7 " " " "	dirt walk	5.9	288.7
15.8 " " " "	Top wall	3.59	291.02
30' " " " "		3.1	291.5
50' " " " "		3.1	291.5

138.8

25' S. of Park Line Cypress Tree 34" Diam

294.61		140' E. Box cbs		294.61	Upas St. 6" to 7"	18
50' S. of Park Line		3.2	291.4			
30' S " " "		3.3	291.3			
16' S " " "	Top wall	4.06	290.55			
16' S " " "	dirt walk	6.5	288.1			
10' S " " "	s. ent. el.	6.60	288.01		4" db.	
10' S " " "	gutter	6.98	287.63			
" " " "		6.80	287.81			
7.6 N " " "		6.74	287.87			
15.2 N " " "		6.88	287.73			
23' N " " "	gutter	7.06	287.55			
23' N " " "	N. ent. el.	6.49	288.12			
		160.8				
22.8 N. of Park Line	N. ent. el.	7.41	287.20			
22.8 N " " "	gutter	8.09	286.52			
15.4 N " " "		7.74	286.87			
7.6 N " " "		7.58	287.03			
" " " "		7.63	286.98			
10.2 S " " "	gutter	7.85	286.76			
10.2 S " " "	s. ent. el.	7.40	287.21			
16.1 S " " "	dirt walk	7.4	287.2			
16.1 S " " "	Top wall	5.22	289.39			
30' S " " "		4.2	290.4			
50' S " " "		3.4	291.2			

		294.61		
		180' E.		
50' S of Park line		4.7	289.9	
30' S "	" "	5.5	289.1	
16.2 S "	" "	Top wall	6.70	287.91
16.1 S "	" "	dirt walk	8.4	286.2
10.2 S "	" "	S. ent. cb	8.37	286.24
		gutter	8.82	285.79
	" "		8.53	286.08
7.6 N "	" "		8.53	286.08
15.2 N "	" "		8.67	285.94
22.7 N "	" "	gutter	9.02	285.59
22.7 N "	" "	N. ent. cb	8.38	286.23
		200' E.		
22.5 N of Park line	N. ent. cb	9.40	285.21	
	gutter	10.06	284.55	
15.1 N "	" "	9.70	284.91	
7.5 N "	" "	9.46	285.15	
	" "	9.49	285.12	
10.3 S "	" "	gutter	9.77	284.84
10.3 S "	" "	ent. cb	9.36	285.25
16.3 S "	" "	dirt walk	9.2	285.4
16.4 S "	" "	Top wall	8.20	286.41
30' S "	" "		7.9	286.7
50' S "	" "		7.9	286.7
		214' E.		
26.5 S. of Park Line	Cypress Tree 36" Diam.			
T.P.	2.69	284.55	12.75	281.86

		284.55		
		233' E. = E. End wall		
16.6 S. of Park line	Top wall	0.18	284.37	
" S "	" "	dirt walk	0.7	283.9
		239' E = W. line 7 th St		
50' S. of Park line			0.8	283.8
30' S "	" "		0.6	284.0
17' S "	" "		0.7	283.9
16' S "	" "	dirt walk	1.0	283.6
10.5 S "	" "	S. ent. cb	1.10	283.45
		gutter	1.57	282.98
	" "		1.30	283.25
7.4 N "	" "		1.31	283.24
14.8 N "	" "		1.57	282.98
22.3 N "	" "	gutter	1.83	282.72
22.3 N "	" "	N. ent. cb	1.24	283.31
		6 N. of N. cb = N. line dirt walk	1.21	283.34
		14' E. of W. line =		
		P.C. Variable Radius cb. Return on N.		
		P.E. Variable Radius curb curve on S.		
22.1 N of Park line	ent. cb	1.79	282.76	
	gutter	2.35	282.20	
14.8 "	" "	1.96	282.59	
7.4 "	" "	1.85	282.70	
	" "	1.90	282.65	
10.7 S "	" "	gutter	2.31	282.24
10.7 S "	" "	S. ent. cb	1.71	282.84
17' S "	" "		1.6	283.0
18' S "	" "		1.2	283.4
30 S "	" "		1.3	283.3
50 S "	" "		1.3	283.3

Upas St 6" to 7"

on 14" x 16" grating

284.55
7.8 of W. line 7th St (should be before last section)

46.5 of	Park Line	Cedar Tree 26" Diam		
20.8 of W. line = W. of line of 7 th St.				
50.5 of	Park line		1.5	283.1
30.5 "	" "		1.5	283.1
18.5 "	" "		1.5	283.1
17.5 "	" "	dirt walk	1.9	282.7
9.85 "	" "	s. ent. cl	1.89	282.66 on curve
		gutter	2.29	282.26
		" "	2.13	282.42
7.4 N	" "	" "	2.06	282.49
14.8 N	" "	" "	2.07	282.48
22.2 N	" "	{ N. of line on parmt	2.39	282.16
28.2 N	" "	{ N. line gutter	2.56	281.99
28.2 N	" "	{ N. line ent. cl	1.99	282.56
W. 1/4 of 7 th				
28.2 N. of	Park Line	N. line	2.61	281.94
22.2 N	" "	N. of line	2.45	282.10
7.4 N	" "	" "	2.30	282.25
14.8 N	" "	" "	2.32	282.23
		" "	2.44	282.11
7.25 "	" "	gutter	2.46	282.09
7.25 "	" "	s. ent. cl	2.08	282.47 on curve
17.5 "	" "	" "	2.1	282.5
18.5 "	" "	" "	1.8	282.8
30.5 "	" "	" "	1.9	282.7
50.5 "	" "	" "	1.7	282.9

284.55
E 7th St.

Upas St. 6th lot
20

50.5 of	Park Line		1.9	282.7
30.5 "	" "		2.1	282.5
18.5 "	" "		2.0	282.6
17.5 "	" "	dirt walk	2.4	282.2
3.75 "	" "	s. ent. cl	2.24	282.31 on curve
3.7 "	" "	gutter	2.60	281.95
	" "	" "	2.64	281.91
7.4 N	" "	" "	2.60	281.95
14.8 N	" "	" "	2.60	281.95
22.2 N	" "	N. of line	2.72	281.83
28.2 N	" "	N " "	2.82	281.73
E. 1/4 7 th St.				
28.2 N of	Park Line	N. line	3.18	281.37
22.2 N	" "	N. of "	3.08	281.47
14.8 N	" "	" "	2.88	281.67
7.4 N	" "	" "	3.01	281.54
0.5 N	" "	gutter	2.92	281.63
0.5 N	" "	s. ent. cl	2.57	281.96 on curve
	" "	" "	2.6	282.0
17.5 "	" "	dirt walk	2.7	281.9
18.5 "	" "	" "	2.3	282.3
30.5 "	" "	" "	2.3	282.3
50.5 "	" "	" "	2.2	282.4
2.5 E. of E. 1/4				
22.5 S. of	Park Line	Cedar Tree 36" Diam.		

		284.55		
E. cl. line 7 th St				
50' S. of	Park Line	2.6	282.0	
30' S "	" "	2.7	281.9	
18' S "	" "	2.7	281.9	
17' S "	" "	3.0	281.6	
	" "	2.8	281.8	
5.0 N "	" " s. ent. cl.	2.81	281.74	on curve
	" " gutter	3.22	281.33	
7.4 N "	" "	3.26	281.29	
14.8 N "	" "	3.40	281.15	
22.2 N "	" " Pavmt. N. cl. Line	3.56	280.99	
22.2 N "	" " { E. ent. cl. of 7 th St N. ent. cl. of drive E	3.14	281.41	
28.2 N "	" " gutter	3.64	280.91	
28.2 N "	" " E. ent. cl. of 7 th St	3.22	281.33	
8.8' E. of E. cl Line				
28.1 N of	Park Line N. line	3.52	281.03	on N. ent. cl. of drive
28.0 N "	" " gutter	4.07	280.48	drive
22.1 N "	" " on drive	3.85	280.70	
11.8 N "	" " Pavmt gutter	3.64	280.91	
11.8 N "	" " s. ent. cl.	3.22	281.33	on curve
	" "	3.4	281.1	
17' S "	" " s. edge dirt walk	3.5	281.0	
18' " "	" "	3.2	281.3	
30' S "	" "	3.2	281.3	
50' S "	" "	3.0	281.5	

		284.55	21pas. St.	6 th to 7 th
13' E. of E. cl. Wedge Walk				
50' S. of	Park Line dirt walk	3.7	280.9	21
30' S "	" " " "	3.8	280.8	
17' S "	" " " "	4.0	280.6	
	" " " "	4.0	280.6	
10.3 N of	" " S. End ent cl. on S.	3.39	281.16	
10.3 N "	" " s. edge cur drive	3.85	280.70	
22' N "	" " N. cl. line on drive	4.00	280.55	
28' N "	" " N. Line on drive	4.17	280.38	
3.4 N. of N. line =	N. line Drive	4.29	280.26	
20' E. of E. cl = E. Line 7 th St.				
9' N. of N. line =	N. edge drive on drive	4.78	279.77	
28' N. of	Park Line = N. line on drive	4.44	280.11	
22' N "	" " = N. cl. line	4.25	280.30	
21.5 N "	" " = S. edge drive	4.25	280.30	
	" "	4.3	280.30	
17' S of	" "	4.4	280.2	
30' S "	" "	3.8	280.8	
50' S "	" "	3.8	280.8	

6.6' wide
20' cbs
6.5' 1/4"

X Sec 7th St 21 pas North

5/8/30
Miller

284.55

22

284.55 Page 21

0+00 N. hinall pas.

W. Top wall	+0.36	284.91
W. on W. edge dirt walk	1.2	283.3
+6.5 E " " "	1.5	283.1
W. ent. el	1.99	282.56 -
gutter	2.56	281.99 -
" "	2.61	281.94.
" "	2.82	281.73 -
" "	3.18	281.37
gutter	3.63	280.92 ✓
E. ent. el	3.22	281.33 ✓
+8.8 N. el. of drive	3.52	281.03
+8.8 on drive	4.07	280.48
+13 " "	4.17	280.38
E " "	4.44	280.11

0+2.2

1.6 W. of W. el. Iron Light post

0+3.4

E.	4.53	280.02
+7. { gutter N. edge drive	4.29	280.26
+7. Top el. { W. side drive	3.71	280.84
E. el	3.23	281.32

0+9.

E on N. edge drive	4.78	279.77
+0.3 E. " " ent walk to N	4.78	279.77

+7. W. edge ent. walk	4.24	280.31
+7. el. on W. edge walk	3.77	280.78
E. el	3.27	281.28

0+12.5

7. E. of E. el. Pepper Tree	33" Diam
7. W. " " " " "	32" Diam
0+25 = N. End ent. el on W. side ent. walk on 2	

E	4.1	280.5
+0.3 E. edge ent. walk	4.15	280.40
+7. W " " " "	4.00	280.55 ent. el. at N. End
E. el	3.54	281.01 -
gutter	3.95	280.60 ✓
" "	3.44	281.11
E	3.07	281.48
" "	2.91	281.64
gutter	2.90	281.65 -
W. ent. el	2.26	282.29 ✓

+13.5 E. edge dirt walk	1.7	282.9
W.	1.4	283.1
+0.2 Top ent. wall	+0.40	284.9

Laurel Walk & Curb on E & W.

0+50

W-0.2 Top wall	+0.40	284.9
W. W. edge dirt walk	1.6	283.0
+6.5 E " " "	1.8	282.7
W. ent. el	2.52	282.03

284.55

0+50 N (cont)

W. gutter	3.25	281 30
"	3.21	281 34
⊥	3.34	281 21 ✓
"	3.75	280 80
gutter	4.22	280 33 ✓
E. cl	3.81	280 74 ✓
+13.5 wedge emt. walk	4.26	280 29
+19.78 " " "	4.40	280 15
⊥	4.4	280 1

0+53

7' E of E. cl. Pepper Tree 24" Diam.

7.5 W " W " " " 24" Diam.

0+94

6.5 W. of W. cl Pepper Tree 24" Diam.

7' E. " E. " " " 24" Diam.

1+00

E.	4.9	279 7
+0.3 E. edge emt. walk	4.87	279 68
+7' W " " "	4.71	279 84
E. cl	4.40	280 15 ✓
gutter	4.83	279 72 ✓
"	4.27	280 28
⊥	3.85	280 70 ✓
"	3.62	280 93
gutter	3.75	280 80 ✓
W. emt. cl.	3.03	281 52 ✓

284.55

7th St 1890

23

+13.5 E. edge dirt walk	2.1	282 5
W - W " " "	1.9	282 6
+0.2 Top emt. walk	+0.3	284.8
	1+33.5	
6.2 W. of W. cl. Pepper Tree 20" Diam		
7' E " E " " " 20" "		
	1+40 S. line Alley to W.	
W. on Top emt. walk	+0.4	284.9
W. Top Alley curb + wedge dirt walk	2.10	282 45 ✓
W. Alley Parmit.	2.60	281 95 ✓
+6.5 E. Top emt. cl + E. edge dirt walk	2.39	282 16
+6.5 Alley parmit.	2.95	281 60
E. emt. cl	3.31	281 24
gutter + Alley parmit.	4.17	280 38
"	4.20	280 35
⊥	4.41	280 14 ✓
"	4.80	279 75
gutter	5.29	279 26 ✓
E. emt. cl	4.87	279 68 ✓
+13.5 Wedge emt. walk	5.16	279 39
+19.78 " " "	5.26	279 29
⊥	5.2	279.4

Levelson Alley

+593

π 288.38

Bm 282.45

40' W on Alley

S

⊥

N

-4.40

-4.73

-4.39

283.98

283.65

283.99

284.55		1+55 = N. Line Alley		s. end, Hardpan Wall on Whiteline 1.5 High	
E	5.5	279	0		
+0.3 = E. edge emt. Walk	5.47	279	08		
+7' W " " "	5.28	279	27		
E. emt. cl.	5.10	279	45 ✓		
gutter	5.49	279	06 ✓		
"	4.92	279	63		
⊥	4.63	279	92		
"	4.40	280	15		
gutter	4.38	280	17 ✓		
W. emt. cl.	3.70	280	85 ✓		
+13.5E edge dirt walk Topel	2.50	282	05		
+13.5 Alley parvt.	3.05	281	50		
W. emt. cl. + W. edge dirt walk	2.29	282	26 ✓		
W. Alley parvt.	2.72	281	83		
1+61					
2.3 W. of N. cl. Iron Light Post.					
1+74					
7' W. of N. cl. Pepper Tree 2" Diam					
7' E. " E. " " " 2" "					
1+88					
Meter Box Iron cover 2' x 7' E & W. E. of E. cl.					
2+00					
W. on W. edge dirt walk	2.8	281	7		
+6.5E " " "	2.9	281	7		
+17' Lawn	3.8	280	8		
W. emt. cl.	4.55	280	00 ✓		

284.55		7 th St X Sec	
gutter	5.15	279	40 ✓
"	5.11	279	44
⊥	5.33	279	22 ✓
"	5.65	278	80
gutter	6.22	278	33 ✓
E. emt. cl.	5.78	278	77 ✓
+13 W. edge emt. walk	6.02	278	53
+19.7 E. " " "	6.14	278	41
E.	6.2	278	4
2+12.5			
7' E. of E. cl. Pepper Tree	20" Diam		
7' W. " W. " " "	24" Diam		
2+40.4 ⊥ 5' emt. walk from W. cl. to W. Line			
W. emt. cl.	5.16	278	39
+13	3.73	280	82
W.	3.40	281	15
2+50			
E.	7.0	277	6
+0.3 E. edge emt. walk	7.04	277	51
+7 = W. " " "	6.87	277	68
E. emt. cl.	6.50	278	05 ✓
gutter	6.73	277	62 -
"	6.38	278	17
⊥	6.08	278	47 -
"	5.88	278	67
gutter	5.90	278	65 -

284.55
2+50' N. con

W. ent. cl.	5.31	279 24 ✓
+3	4.6	280 0
+13.6 E. edge dirt walk	3.8	280 8
W W " " "	3.6	281 0
2+54		
7' W. of W. cl. Pepper Tree		22" Diam
7' E " E cl		22" Diam
2+93 ^E		
6.3 W. of W cl. Peppertree		12" Diam
7' E. of E cl		30" Diam
2+98 ^L		
2' W. of W. cl. Iron Light Pole		
3+00		
W W edge dirt walk	4.7	279 9
+6.4 E " " "	4.8	279 8
+17	5.6	279 0
W ent. cl.	6.03	278 52 ✓
gutter	6.65	277 90 ✓
"	6.64	277 91
⊕	6.82	277 73 ✓
"	7.17	277 38
gutter	7.72	276 83 ✓
E. ent. cl.	7.28	277 27 ✓
+13 W. edge ent. walk	7.75	276 80
+19.7 E " " "	7.91	276 64
E.	7.9	276.7

284.55
3+34

7th St X Sec

25

7' E. of E cl. Pepper Tree	24" Diam	
7' W " W " " "	10" "	
3+40		
E	8.7	275 9
+0.3 E. edge ent. walk	8.70	275 85
+7' W " " "	8.60	275 95
W. ent. cl.	7.87	276 68 ✓
gutter at s. end catch basin inlet	8.40	276 15 ✓
+2. S.W. cor " "	8.19	276 36
"	7.60	276 95
⊕	7.31	277 24 ✓
"	7.22	277 33
gutter	7.25	277 30 ✓
W. ent. cl.	6.69	277 86 ✓
+3	6.2	278 3
+13.7 E. edge dirt walk	5.4	279 2
W W " " "	5.2	279 3
3+44.5 P.C. cl. Return to E		
W. W. edge dirt walk	5.2	279 3
+6.3 E " " "	5.4	279 1
+17	6.3	278 3
W. ent. cl.	6.78	277 77
gutter	7.34	277 21
"	7.34	277 21
⊕	7.40	277 15
"	7.59	276 96
+5.5 N.W. Cor Catch Basin pavm't to N+W	7.87	276 68

	284.55 3+44 ^E (con)		
E. 1/4 +55 N.W. Cor Catch Basin	9.31	275.24	Bottom sand trap
" +6.0 F.L. 8" vitrified Pipe	8.80	275.75	
+6.5 gutter Bottom sand Trap	9.31	275.24 ✓	
+6.5 emt. cl. & parmt to N.W.	7.87	276.68 ✓	
T.P.	3.79	280.51	7.83 276.22
+13 Top 3' emt. cl. on W. side walk	4.60	275.91	
+13 W. edge emt. walk	4.77	275.74	
+19.78 " " "	4.90	275.61	
E.	4.9	275.6	
	3+53 ^E		E. Edge Fall width parmt. on S.
E	5.8	274.7	
+0.3 N. End - E. edge emt. walk	5.49	275.02	
+0.3 E. edge S. End parmt.	5.82	274.69	
+7' { W. edge N. End emt. walk S. " " parmt	5.30	275.21	
+7' { 3' emt. cl. on W. side walk to S E. End 8' emt. cl. Ret.	4.82	275.69	
E. cl. line on parmt.	4.02	276.49 ✓	
"	3.60	276.91	
⊥	3.49	277.02	
"	3.42	277.09	
gutter	3.51	277.00 ✓	
W. emt. cl.	2.88	277.63 ✓	
+13.88 E. edge dirt walk	1.5	279.0	
W. W. " " "	1.4	279.1	
	3+62 ^E ⊥		4' emt. walk from N. cl. to W. line
W	1.48	279.03	
+6.2	1.62	278.89	
W. emt. cl.	3.03	277.48	

	280.51		7 th 57 th Sec
	3+74		26
7' W. of W. cl. Peppertree	36" Diam		
	3+80		
W. wedge dirt walk	1.6	278.9	
+6 E. " " "	1.8	278.7	
W. emt. cl.	3.29	277.22 ✓	
gutter	3.89	276.62 ✓	
"	3.85	276.66	
⊥	3.88	276.63 ✓	
"	3.97	276.57	
E. cl. line on parmt.	4.34	276.17 ✓	
+1.3. " " "	5.21	275.30	
E. " " "	5.61	274.90	
+4. E. edge " "	5.81	274.70	
	4+00		
E. - 23. E. edge parmt. garage	5.77	274.74	
E. " " "	5.39	275.12.	
+7. " " "	5.18	275.33	
E. cl. line	4.63	275.88 ✓	
"	4.25	276.26	
⊥	4.09	276.42	
"	4.05	276.46	
gutter	4.17	276.34 ✓	
W. emt. cl.	3.55	276.96 ✓	
+14 E. edge dirt walk	2.0	278.5	
W. W. " " "	1.8	278.7	

280.51		4+15	
7' W. of W. cl. Pepper tree	18" Diam		
4+29 ^E N. end full width pavmt on E.			
W. End Hard pan wall on W. line		2.0	278.5
W edge dirt walk			
+6 E " " "		2.2	278.3
W. emt. cl.		4.00	276.51 ✓
gutter		4.62	275.89 ✓
"		4.47	276.04
⊥		4.45	276.03 ✓
"		4.65	275.86
E. emt. cl. and gutter pavmt.		5.15	275.36 ✓
+13 W. edge S. End emt. walk		5.64	274.87
+13 pavmt. to S.		5.48	274.83
E. E. edge S. End. emt. walk		5.87	274.64
E pavmt. to S.		5.90	274.61
4+45 ^Z			
2.6 E. of E. cl. Fire Plug.			
4+49 ^E			
7' E. of E. cl. Pepper Tree	18" Diam		
7' W " " " " "	22" "		
4+54 ^E S. line Alley cl. on N & S. on E. side 7" st.			
E. E. Edge N. End emt. walk on emt. cl.		6.08	274.43
E. Alley pavmt.		6.21	274.30
+7 W. edge N. end walk on Alley cl.		5.85	274.66
+7 Alley pavmt		5.95	274.56
E. emt. cl. & pavmt.		5.40	275.11 ✓
"		4.99	275.52

280.51		7 th St	
			27 ✓
⊥		4.82	275.69 ✓
"		4.80	275.71
gutter		4.92	275.59 ✓
W. emt. cl.		3.92	276.59 ✓
+14 E. edge dirt walk		2.2	278.3
W. W " " "		1.8	278.7
4+63 ^E			
1.6 W. of W. cl. Iron Light Pole			
4+69 ^E N. side Alley on E.			
W. W edge dirt walk		1.9	278.6
+6 E " " "		2.2	278.3
W. emt. cl.		3.95	276.56 ✓
gutter		5.15	275.36 ✓
"		5.02	275.49
⊥		5.05	275.46 ✓
"		5.22	275.29
E. emt. cl. & pavmt. & emt. cl. to E. line		5.49	275.02 ✓
+13 W. edge S. End emt. walk & Alley cl.		5.90	274.61
+13 Alley Pavmt.		5.97	274.57
E. E. edge S. End. emt. walk & Alley cl.		6.18	274.33
E. on Alley pavmt.		6.24	274.27
4+75			
6.62 E. of E. cl. Pepper tree	3/8" Diam.		

	280.51		
E. edge. emt. walk	4+76	6.06	274 45
+7 W " " "		5.88	274 63
E. emt. cl. + Pavmt. to S + W.		5.58	274.93
gutter to N. out/let of 8" culvert to S.		6.36	274.15 ^{inlet at station}
+1 " " " " " " " "		6.36	274.15 _{3+44.5}
+1 Top Head wall pavmt to S + W + N.		5.56	274 95
1/4		5.39	275 12
1/4		5.14	275.37
1/4		5.08	275.43
gutter		5.21	275.30
W. emt. cl.		3.94	276 57
+14' E. edge dirt walk		2.2	278 3
W. W " " "		1.8	278 7
	4+80		
W. W. edge dirt walk		1.9	278 6
+6. E " " "		2.3	278 2
W. emt. cl.		3.93	276 58 ✓
gutter		5.26	275 25 ✓
1/4		5.09	275 42
1/4		5.15	275 36
1/4		5.49	275 02
+4.5 ^{same cor outlet} Pavmt to N. W + S		6.15	274 36
+6.5 gutter		6.31	274 20 ✓
E. emt. cl.		5.60	274 91 ✓
+13 wedge emt. walk		5.89	274 62
E. E. " " "		6.06	274 45

	280.51	714 St.	
4+95 E. emt. walk from W. cl. 14' west. 5' wide	5+00		28
E. on E. edge emt. walk		6.01	274 50
+7 W " " "		5.94	274 57
E. emt. cl.		5.74	274 77 ✓
gutter		6.34	274 17 ✓
1/4		5.85	274 66
1/4		5.46	275 05 ✓
1/4		5.34	275 17
gutter		5.46	275 05 ✓
W. emt. cl.		3.90	276 61 ✓
+14 E. edge dirt walk		2.1	278 4
W. W " " "		1.8	278 7
	5+06		
6.6 E. of E. cl Pepper Tree 1/2" Diam.			
	5+46		
6.6 E. of E. cl Pepper Tree 24" Diam			
6.6 W. " " " " " 16" "			
	5+50		
W. wedge dirt walk		2.2	278 3
+6. E " " "		2.3	278 2
W. emt. cl.		3.78	276 73 ✓
gutter		6.82	274 49 ✓
1/4		5.87	274 64
1/4		5.92	274 59 ✓
1/4		6.16	274 35
gutter		6.62	273 89 ✓

280.51

5+50 (con)

E. ent. cl.	6.03	274 48
+ 13. W edge ent. walk	6.07	274 44
E. E " " "	6.14	274 37

5+63

6' W. of W. cl. cedar tree 2" Diam
 5+63.8 to 5+75 ent. steps from W. cl. 5' West
 5+70 & 6' ent. walk from E. cl. to E. line

5+75⁵

6' W. of W. cl. cedar tree 3" Diam

5+91⁵

7' W. of W. cl. Pepper Tree 18" Diam

7' E " E. " " " 24" "

6+00.

E. on E. edge ent. walk	6.37	274 14
+ 7' W " " "	6.32	274 19
E. ent. cl.	6.33	274 18 ✓
gutter	6.78	273 73 ✓
"	6.45	274 06
⊕	6.35	274 16 ✓
"	6.45	274 06
gutter	6.67	273 84 ✓
W. ent. cl.	3.61	276 90 ✓
+ 14 E. edge dirt walk	2.9	277 6
W. W " " "	2.7	277.8

280.51

7th ST.

29

6+11 = step in W. ent. cl.

W. ent. cl. to S	3.57	276 94
W. " " to N	4.21	276 30

6+14

1.5 W. of W. cl. Lion Light Post.

6+28. = P.C. E+W. ent. cl. for Banjo pavnt.

W. on W. edge dirt walk	3.4	277.1
+ 6 E. " " "	3.6	276 9
W. ent. cl.	4.07	276 44 ✓
gutter pavnt.	6.94	273 53 ✓
"	6.79	273 72
⊕	6.68	273 83
"	6.80	273 71
gutter	7.07	273 44 ✓
E. ent. cl.	6.58	273 93 ✓
+ 13. W. edge ent. walk	6.40	274 11
E. E " " "	6.41	274 10
T.P.	4.93	278.94
	6.50	274.01

6+37⁵

6' W. of W. cl. Line Pepper Tree 18" Diam
 7' E " E " " " " 22" "

278.94

See. C. Sta. 6+63.2

E. on emt. drive to garage	4.88	274.06	✓
+ 9 W. edge drive E. edge pavmt.	5.46	273.48	
+ 20 = E. ch. Line Produced	5.73	273.21	
" 1/4 "	5.90	273.04	
24' curb Radius ¢ Ctr. 2' x 2' catch basin grating	6.10	272.84	full of dirt ✓
" 1/4 "	5.90	273.04	
W. ch. Line Produced	5.75	273.19	
+ 11 gutter	5.40	273.57	✓
+ 11 W. emt. ch.	4.77	274.17	✓
W.	4.2	274.7	

see. D. Sta. 6+82

W.	7.0	271.9	
+ 10	6.4	272.5	
+ 17.6 Top emt. ch.	4.96	273.98	✓
+ 17.6 ground + W. edge pavmt	5.46	273.48	✓
+ 20 = W. ch. Line Produced	5.48	273.46	
" 1/4 "	5.52	273.42	
¢ "	5.54	273.40	✓
+ 1.6 ¢ M.H.	5.50	273.44	
" 1/4 "	5.53	273.41	
E. ch. Produced	5.45	273.49	
SE gutter pavmt + 3. W. edge emt. drive	5.50	273.44	✓
+ 3. Top emt. ch.	5.05	273.89	✓
+ 10 on emt. drive	5.27	273.67	
E. " " "	4.91	274.03	

278.94

6+84

7th St

31

E. on N. edge emt. drive	4.93	274.01	¢ dirt to N.
+ 10. W. " " " "	5.13	273.81	¢ " " "

Nedgedrive Angles from hereto (E. ch. + 3) station 6+82

See. E. Sta. 6+87.2

From Here North 7th St 66' wide 12.5' chs 41' Adv. 10.25' 4s

E.	5.4	273.5
ch	5.3	273.6
1/4	5.1	273.8
¢ Face curb at N. End Banjo	5.09	273.85
¢ gutter pavmt. 10s.	5.55	273.39
" 1/4 "	5.1	273.8
+ 6	5.5	273.4
ch.	6.6	272.3
W.	7.3	271.6
+ 5	7.3	271.6

→ 6+85.5 This should be B. face above section

13.5 E of W. Line Pepper Tree 20" Diam

13.5 W " E " " " 8" "

6+89

2.5 E. of W. Line gum Tree 3" Diam

6+95

¢ 7th St Pepper Tree 5" Diam

T.P. 3.40 277.41 4.93 274.01

277.41 277.41
6+98

277.41

7th St.

32

N-10	8.7	268.7
N.	9.1	268.3
cb	9.4	268.0
1/4	7.0	270.4
±	4.8	272.6
1/4	3.1	274.3
cb	4.0	273.4
E	4.4	273.0
+5	4.6	272.8

7 E. of W. Line Gum 12" Diam	7+14
7 W " W Line " 14" "	
	7+16
23' E. of W. Line Gum 6" Diam.	
	7+22
4' N. of E. Line Gum Tree 3" Diam	
	7+25

7+01		
3' E. of W. Line Gum Tree 16" Diam		
7+05		
E.-20	10.6	266.8
E	7.6	269.8
cb	6.0	271.4
1/4	4.0	273.4
±	5.0	272.4
1/4	10.1	267.3
cb	11.0	266.4
W	11.7	265.7
+10	11.4	265.8

N-30	21.4	256.0
W-18 Gum Tree 15" Diam		
W.	21.2	256.2
cb.	21.0	256.4
1/4	20.0	257.4
+8 Gum Tree 3" Diam.		
± " " 5" "		

±	19.6	257.8		
T.P	0.23	264.84	12.80	264.61
1/4	6.3	258.5		
cb.	6.8	258.0		
E.	7.3	257.5		
+1	8.2	256.6		
+30	11.4	253.4		
T.P.	0.05	251.75	13.14	251.70

7+06		
18' E. of W. Line Gum Tree 6" Diam.		
7+08		
2' E. of E. Line Gum Tree 5" Diam.		
7+11		
19' W. of E. Line Gum Tree 3" Diam.		

7+33				
18' W. of E. Line Gum Tree 12" Diam				
7+35				
9' W. of W. Line Gum 6" Diam				

251.75

7+44

17' W. of E. Line Gum Tree 10" Diam

7+50

E-45	9.0	2427
E	9.0	242.7
cl.	6.2	245.5
1/4	5.0	246.7
1/4	5.3	246.4
1/4	5.5	246.2
cl.	5.5	246.2
W.	5.5	246.2
+15	4.7	247.0
+40	9.0	242.7

7+57

13' E. of W. Line Gum Tree 8" Diam.

7+65

W-55	12.7	239.0
W-30	10.0	241.7
W.	11.8	239.9
cl.	12.6	239.1
1/4	13.2	238.5
1/4	13.7	238.0
1/4	14.5	237.2
cl.	16.2	235.5
E.	13.7	238.0
+25	14.0	235.7
+55	18.0	233.7

251.75

7+75

7th St

33

E-60	21.5	230.2
E-	16.2	235.5
+4	17.4	234.3
cl.	15.6	236.1
1/4	14.8	236.9
1/4	14.0	237.7
1/4	13.4	238.3
cl.	12.4	238.9
W.	13.0	238.7
+40	15.5	236.2
+60	16.3	235.4

7+80 N. of Upas = 5. Line Brooks

 $\left\{ \begin{array}{l} 60' \text{ dia} \\ 10' \text{ dia} \\ 10' \text{ dia} \end{array} \right.$

W-60	18.5	233.2
W-45	17.5	234.2
W.	16.0	235.7
cl.	14.5	237.2
1/4	15.6	236.1
1/4	16.0	235.7
T.P.	4.26	243.55
1/4	12.46	239.29
1/4	8.1	235.5
cl.	8.9	234.6
E.	10.3	233.3
+30	12.5	231.0
+60	15.5	228.0

243.55

7+90 = 5. el Line Brooks

E-65	17.5	2260
E-30	17.1	2264
E.	15.4	2281
el	14.2	2293
1/4	13.3	2302
⊕	13.2	2303
1/4	12.2	2313
el.	12.0	2315
W	11.8	2317
+30	13.0	2306
+70	15.0	228.5
8+00 = 5.14		
W-75	17.8	2257
W-40	19.2	2243
W.	15.6	2280
el	14.8	2287
1/4	14.7	2288
⊕	14.1	2274
1/4	14.8	2267
el	18.0	225.5
E	19.6	2240
+30	22.0	221.6
+75	22.0	2216
8+10 ⊕		
E-75	25.2	2184
E-35	27.0	2166 Wash

243.55

E-20	24.8	2188
E	22.8	2208
el	21.2	2223
1/4	20.2	223.3
⊕	18.4	225.2
2.8 E. of d. 7 th 1.5 W. of ⊕ Brooks	26.9	216.7 Flow Line
1/4	18.4	225.2
el.	18.5	2250
W	19.8	223.8
+15	20.5	2230
+40	22.0	221.6 Wash
+75	18.0	225.6 6 N. of ⊕ Wash
8+20 = N 1/4		
W-75	15.4	2282
W-40	18.5	2251
W-6	21.3	222.3
W	23.5	2200 Wash
el	22.3	221.3
1/4	22.0	221.5
⊕	21.4	222.0
1/4	22.6	221.0
el	23.3	220.3
E	24.3	219.3
+20	27.0	216.6 Wash
+35	25.8	217.8
+61	29.5	214.1 Wash
+80	28.0	215.6

8+03 should be on page 35

13' E. of W. Line Gum Tree 24" Diam

243.55

8+30 = N. of line Brooks St

E-90	30.0	213.6	Wash
E-75	26.5	217.1	
E-35	24.0	219.6	
E	26.5	217.1	Wash
ch	25.2	218.4	"
1/4	24.0	219.6	
3' S. of above = ♀ Wash	26.0	217.6	Wash
♀	23.2	220.4	
3' S. of above = ♀ wash	25.0	218.6	Wash
1/4	24.7	218.9	Wash
ch	22.8	220.8	
W	20.9	222.7	
+30	17.4	226.2	
+60	13.2	230.4	

8+32

15' W. of W. Line Gum Tree 22" Diam

8+38

5' W of White Gum Tree 16" Diam

8+39

30' W of W. Line Gum Tree 8" Diam

38' W " " " " 8" "

243.55

8+40 N = N. Line Brooks

35

W-45	12.0	231.6
21' W. of W. line Gum Tree 10" Diam		
W-10	18.5	225.0
W	19.0	224.6
ch.	20.1	223.5
1/4	20.7	222.9
♀	21.3	222.3
1/4	21.4	222.2
ch	22.6	221.0
E	21.2	222.4
+10	22.4	221.2
+25	21.5	222.0
+60	23.6	220.0

8+43

on W. line Gum Tree 16" Diam

8+47

8' E. of W. Line Gum Tree 5" Diam

8+48

14' W. of W. Line Gum Tree 6" Diam

8+49

26' W. of W. line Gum Tree 10" Diam

8+52

1' W. of W Line Gum Tree 26" Diam

14' E " " " " 8" "

8+58

30' W. of W. line Gum Tree 12" Diam

R43.55

8459

17' W. of W. line Gum Tree 10" Diam

8461

13' E. of W. line Gum Tree 8" Diam

8462

19' W. of W. line Gum Tree 12" Diam

25' W " W " " " 10" DIAM

8465

E-50 14.1 229.5

E-25 12.5 231.1

E 12.8 230.8

d 12.0 231.6

14 13.0 230.6

E 13.0 230.6

14 13.2 230.4

d 13.6 230.0

W. 14.3 228.3

+25 12.7 230.8

W#37 Gum Tree 1' Diam

+45 5.1 238.5

8467

11' E. of W. line Gum Tree 10" Diam

8469

9' W. of W. line Gum Tree 18" Diam

on W. line " " 4" "

8' W. of E. line Pepper " 4"

243.55

8475

35' W. of W. line Gum Tree 10" diam.

8476

7' E. of E. line Pepper Tree 12" Diam

8490

W-40 2.0 241.6

W-25 9.3 234.3

W. 5.6 238.0

d 2.4 241.2

14 1.9 241.7

E 2.0 241.6

14 2.0 241.6

d 1.6 242.0

E 1.1 242.5

+5 2.2 241.4

+25 1.7 241.8

+45 4.0 239.6

8492

39' W. of W. line Gum Tree 10" Diam

8494

29' W. of W. line Gum Tree 22" Diam

10' E " W " " " 12" "

8495

on W. line Gum Tree 12" Diam

8498

20' W. of W. line Gum Tree 6" Diam

7th St.

36

243.55

9+01
11' E of W. Line Gum Tree 14" Diam

9+04

35' W of W. Line Gum Tree 6" Diam

From sta 8+96 to 9+03 N.

from 8' to 16' E. of E. Line childrens Play House

Set B.M. Nail in Tree 12.60 230.95 ✓

T.P. 13.07 256.20 0.42 243.13

9+10

E-30 8.7 247.5

E 5.2 251.0

eb 3.4 252.4

"4 4.0 252.2

E 4.1 252.1

-14 4.2 252.0

eb 4.5 251.7

10' E of W. Line Gum Tree 7" Diam

W 7.5 248.7

W+30 18.4 237.8

W+39 Gum Tree 12" Diam

+50 7.1 249.1

9+12

9' E of E. Line Acacia Tree 5" Diam

9+14

2' E of W. Line Gum Tree 12" Diam

9+16

14' E of E. Line Acacia Tree 6" diam

132
52

256.20

9+17

5' E of E. Line Tree 6" Diam

4' N " E " " 10" "

9+22

11' E. of W. Line gum Tree 12" Diam

9+23

35' W. of W. Line Gum Tree 5" Diam

9+24

2' W. of W. Line Gum Tree 10" Diam

T.P. 12.60 268.44 0.36 255.84

9+30

W-50 18.7 249.7

W-42 Gum Tree 3" Diam

W-42 25.2 243.2

W-30 25.0 243.4

W-10 15.0 253.4

W 10.2 258.2

eb 6.3 262.1

"4 4.6 263.8

E 3.1 265.3

"4 4.0 264.4

eb 5.6 262.8

E 7.7 260.7

+20 11.4 257.0

9+36

46' W of W. Line Gum Tree 6" Diam

37

268.44

33' W. of W Line	9+38	Gum Tree 10" Diam	
W of E "		Pepper Tree 14" "	
	9+40	S End {curb on E Parment Curb + ent walk on W.	
E	3.7		2647
E. ent. dr S. end	3.42		265.02 ✓
Stake line E End Culvert intake	3.57		264.87 Headwall
gutter F.L. 8" Iron Pipe Culvert	4.50		263.94
+ 1.6 " " " "	4.50		263.94
+ 1.7 W End Culvert intake	3.57		264.87 Headwall
+ 2.1 parvtr	3.57		264.87
1/4 "	3.17		265.27
1/4 "	2.73		265.71
1/4 "	2.61		265.83
+ 8.2 " + Headwall	2.56		265.88
+ 9.6 F.L. catch Basin	3.55		264.89 8" Iron Pipe
Stake line W. end Headwall	2.54		265.90 ✓
W. ent. dr S. End.	2.38		266.06 ✓
+ 5.1 E. edge S. End ent. walk	2.34		266.10
+ 10. W " " " "	2.35		266.09
+ 12.5 = W. Line	2.4		265.8
W + 3	3.3		265.1
	9+43	N. End catch Basin	
W. ent. dr	2.16		266.28
gutter	2.89		265.55
+ 1.6 at N.E. cor catch basin	2.81		265.63
1/4	2.49		265.95

268.44

7th St

38

4			2.60	265.84
1/4			2.94	265.50
+ 8.6 N.W. cor catch basin			3.74	264.70
gutter			3.82	264.62
E. ent. dr			3.25	265.19
+ 12.5 = E. line			3.4	265.0
	9+66	4" H' ent. walk from E. dr East		
E. line on walk			1.32	267.12
E. ent. dr			1.68	266.76 ✓
gutter			2.12	266.32 ✓
1/4			1.40	267.04
4			0.97	267.47 ✓
1/4			0.90	267.54
T.P.	11.78	279.03	1.19	267.25
gutter			11.85	267.18 ✓
W. ent. dr			11.19	267.84 ✓
	9+88			
	6' E. of E. dr line	Pepper Tree 16" Diam		
	10+00			
W. ent. dr			8.85	270.18 ✓
gutter			9.52	269.51 ✓
1/4			9.21	269.82
4			9.25	269.78 ✓
1/4			9.64	269.39
gutter			10.38	268.65 ✓
E. ent. dr			9.85	269.18 ✓

279.03

10+0 ON (Con)

286.86

7th St

E. el + 5.5 Pepper Tree 15" Diam

E. Line 9.4 269.6

10+13

6' E. of E. el Pepper Tree 16" Diam

Brk. $8+20 = 42014$ S. of S line Penn ArcE ¹⁰ 8.1 270.9

E. ent. el 8.48 270.55

gutter 9.00 270.03

" 8.42 270.61

E 7.98 271.05 ✓

" 7.95 271.08

gutter 8.16 270.87 ✓

W. ent. el 7.53 271.50 ✓

¹⁰ $8+40 = 40$ S. End ent walk on E

E. ent. el 7.56 271.47

+5.3 E = Wedge S end ent walk 7.38 271.65

+10.6 E = E " S " " " 7.24 271.79

E. 7.3 271.7

T.P. 5.77 284.10 0.70 278.33

T.P. 8.67 291.98 0.79 283.31

5.10 286.88 = 286.86 B.M.

N.W. 6th Penn

39

Culvert in Brooks St.
from 6th St East of 7th

7th St
40

B.M.	0.42	231.37	230.95	Page 37
0+00 F.L. Outlet Existing 30" Culvert		3.10	228.3	
0+30		2.4	229.0	
2' S. of 0+30 & Wash		3.5	227.9	at 90° from & Culvert
0+45 & Wash		3.7	227.7	
0+63 [±]		3.3	228.1	
6' N. of 0+63 [±] = & Wash.		4.8	226.6	"
13' N. of 0+63 [±] = & M.H. F.L.		7.06	224.31	"
0+80		3.7	227.7	
7' N. of 0+80 = & Wash		5.0	226.4	"
1+00 = & Wash.		5.8	225.6	
1+25		5.5	225.9	
4' S. of 1+25 = & Wash		6.0	225.4	"
1+50 N. edge wash		7.6	223.8	
1' N. of 1+50		6.2	225.2	"
2' S. " 1+50		7.6	223.8	"
1+75		7.3	224.1	
3' S. of 1+75 = & Wash		10.3	221.1	"
R+00		8.9	222.5	
3' S. of R+00		11.1	220.3	"
R+20 = & Wash		11.6	219.8	
R+30		10.4	221.0	
5' N. of R+30 = & Wash		12.4	219.0	"
R+45 & A 13' S. of N. Line Brooks		11.12	220.25	Δ 9° 11' RT.
T.P.	4.27	224.52	11.12	220.25

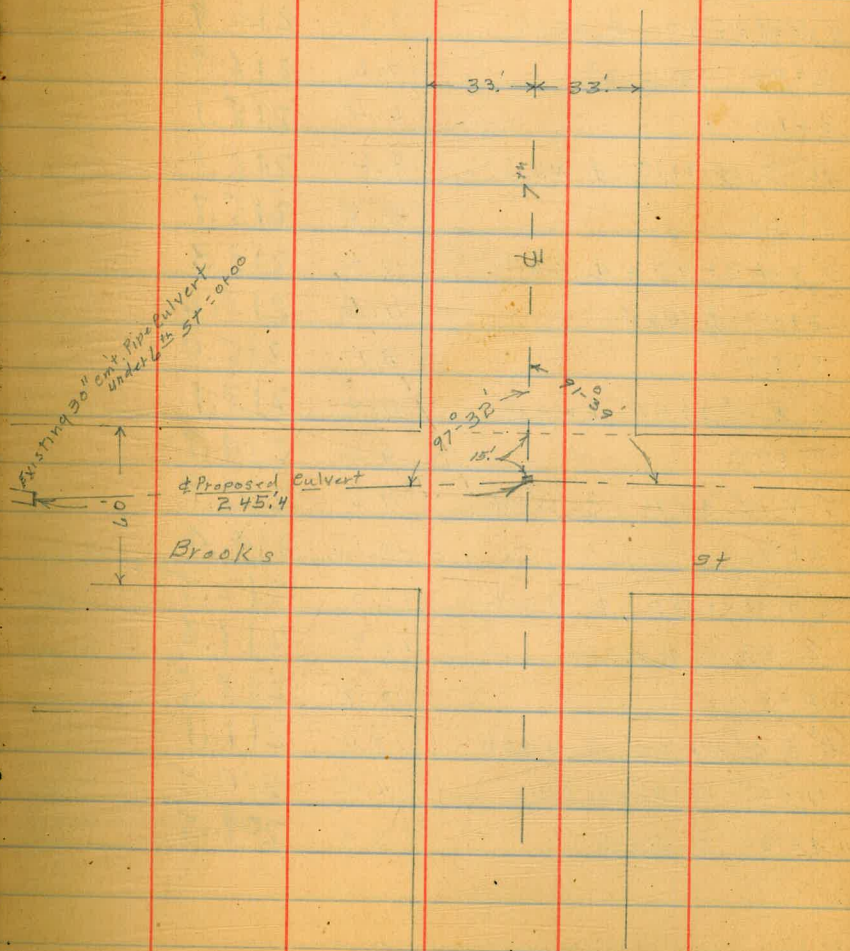

2' N of 2+45# = ϕ wash	6.3	218.2	at 90 ^o 00'
2+54 ⁵ 4" Water Main	5.6	218.9	Top Pipe
2+60 - Wash	6.5	218.0	
2+80	5.4	219.1	
5' N of 2+80 = ϕ wash	7.6	216.9	at 90 ^o 00'
2+93 ϕ wash	7.6	216.9	
3+15	6.4	218.1	
12' S. of 3+15 = ϕ wash	8.4	216.1	"
3+43	8.8	215.7	
3' S of 3+43 = ϕ wash	11.2	213.3	"
3+47 ϕ Wash	11.3	213.2	
3+57	9.1	215.4	
2' N of 3+57 ϕ wash	11.4	213.1	"
3+70	9.6	219.9	
6' N of 3+70 ϕ wash	11.6	212.9	"
3+80	10.1	219.4	
3' N of 3+80 = ϕ wash	12.0	212.5	"
3+87 = ϕ wash	12.9	211.6	
4+00	10.9	213.6	
6' S of 4+00 ϕ wash	13.4	211.1	"
4+27 ⁷ 6" Sewer Pipe	14.0	210.5	Top Pipe
4+30 ϕ Wash.	15.0	209.5	

Survey for ST. Opening from bth 5/14/50
 + Thorn. to 7" + 2 pas.

0100 for Tree Location = Hub of 7" St + 50's. of N. Boundary of Park

3' N.E. of 0100	15' S.E. "	Acacia	24" Diam
18' S.W. "	0100 39' S.E. "	Cedar	36" Diam
53' S.W. "	" 23' N.W. "	"	36" "
54' S.W. "	" 15' S.E. "	"	34" "
77' S.W. "	" 6' N.W. "	"	48" "
81' S.W. "	" 32' S.E. "	"	48" "
116.55' S.W. "	" 7' S.E. "	Acacia	24" "
132' S.W. "	" 23' S.E. "	Cedar	40" "
252' S.W. "	" 5' N.W. "	"	48" "
258' S.W. "	" 34' S.E. "	"	48" "
271' S.W. "	" 36' N.W. "	"	36" "
283' S.W. "	" 51' N.W. "	Pate Palm	36" "
295' S.W. "	" 2' S.E. "	Cedar	42" "
297' S.W. "	" 39' S.E. "	"	30" "
314' S.W. "	" 38' N.W. "	"	48" "
334' S.W. "	" 34' S.E. "	"	40" "
331' S.W. "	" 46' N.W. "	Cocos Palm	14" "
359' S.W. "	" 17' N.W. "	"	14" "
370' S.W. "	" 16' S.E. "	Cedar	48" "
370' S.W. "	" 28' N.W. "	Cocos Palm	16" "
388' S.W. "	" 12' S.E. "	"	14" "
391' S.W. "	" 27' S.E. "	Bush	12" "
397' S.W. "	" 1' S.E. "	Cocos Palm	16" "
415' S.W. "	" 40' S.E. "	"	18" "
426' S.W. "	" 30' S.E. "	"	18" "

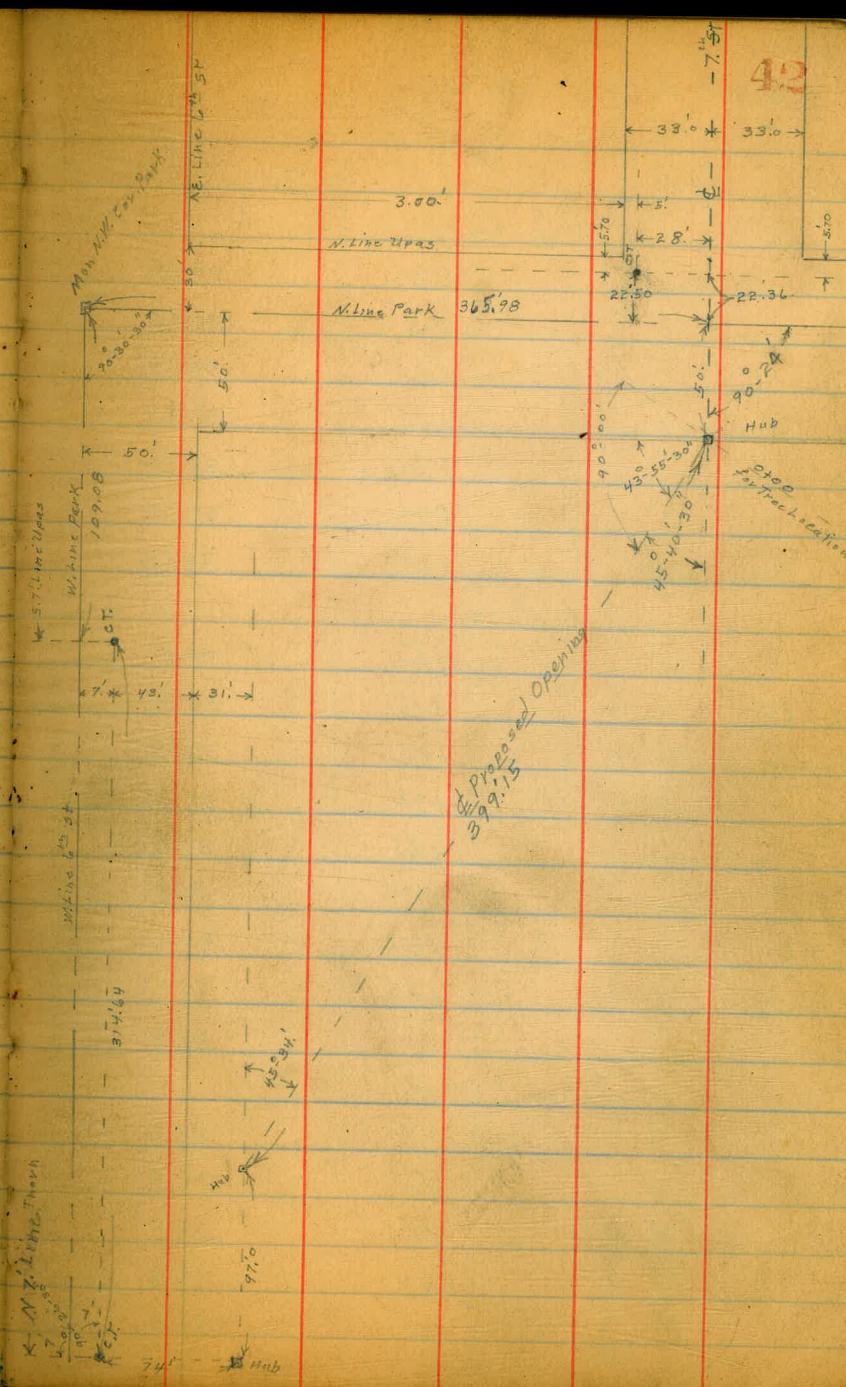

29th St. Cross Section
Main St to Cotton Ave.

60' W. side
18' Cb
10' Q1

BM 306 41.06 38.00 5th BP. Main x 29th R.

5' Cb of Main S

H on Pav 29	3.77	37.29
Cb " "	3.64	37.42
1/4 " "	3.53	37.53
1/2 " "	3.42	37.64
3/4 " "	3.56	37.50
Cb " "	3.70	37.36
F " "	3.78	37.28

S. L. Main

F	3.1	38.0
Cb Top	3.15	37.91
Gutter on Pav 29	3.94	37.12
1/4 " "	3.70	37.36
1/2 " "	3.62	37.44
3/4 " "	3.70	37.36
Gutter " "	3.92	37.14
Cb Top	3.09	37.97
H	2.9	38.2

25' S of S. L. Main

H	3.8	37.3
Cb	4.2	36.9
1/4	4.6	36.5
1/2	4.2	36.9
3/4	3.9	36.2

Plotted
6-12-30

6-11-30

43
S. L. Main
Cotton Ave

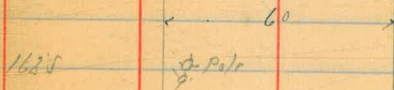
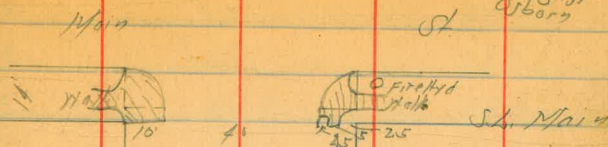

9' of 211' S = Large Pepper Tree
8' of 260' S = " " "

10' of 292' S = Large Pepper Tree

Cotton

Pole

0+00 1/27

Proposed Drain

140

29th St

41.06

41.06

44

1/4	4.3	368
1/1	5.0	361
cb	3.9	372
F	3.5	376
50' S of S. 6. Main		
r	4.6	365
cb	4.9	362
+2	5.7	354
1/4	5.1	350
1/2	4.8	363
1/4	5.0	361
+9	5.5	366
cb	5.0	361
1/1	4.5	366
75' S		
1/1	5.5	356
cb	6.2	349
1/4	6.0	351
1/2	5.7	354
1/4	5.8	353
+6	6.6	345
cb	5.6	355
F	5.4	357
+12 = H. L. DeGorey 5177 Flood	5.4	357
100' S		
F	6.3	348

96.5 =
D. DeGorey
5177 Flood
1850.5 =
55 = 356

cb	6.6	345
+3	7.4	337
1/4	6.9	342
1/2	6.6	345
1/4	6.9	342
cb	7.1	340
1/1	6.4	347
125' S		
1/1	7.5	336
+9	7.8	333
cb	8.4	327
1/4	7.8	333
1/2	7.5	336
1/4	7.8	333
1/1	8.1	330
+7	9.1	320
cb	7.6	335
F	7.4	337
140' S		
r	8.9	322
+5	8.5	326
cb	9.0	321
1/4	8.2	329
1/2	8.2	329
1/4	8.4	327
cb	8.9	322

39th St

41.06

+1		83	328
H		99	332
	160'S		
H		95	316
19		92	319
Cb		98	313
1/4		96	315
1/2		93	318
1/4		94	317 1/2 N-Pln
+6		97	314 9 E of Hk
+8		105	30.6
Cb		93	318
F		93	318 1/2 N - Conc Walk or Front Porch
	180'S		
F		109	302 on Hk 1055/32.51
Cb		111	30.0
+2		119	29.2
+1		112	29.9
1/4		109	30.2
1/2		106	30.5
1/4		109	30.2
Cb		116	29.5
+1		108	30.3
H		109	30.2
+0.8	= Conc. Walk	1056	30.50
	200'S		

41.06

45

H		120	29.1
19		125	28.6
Cb		132	27.9
1/4		124	28.7
1/2		122	28.9
1/4		121	28.5
+4		121	28.0
+5		138	27.3
Cb		127	28.4
F		123	28.8
TP	0.50	1860	1291 28.10
		225'S	
F		19	26.7 111'S - Conc Walk or Landing
Cb		21	26.5 13' W of Hk
+2		22	26.4 14' = 27.19
+3		22	25.4
+6		24	26.2
1/4		21	26.5
1/2		18	26.8
1/4		21	26.5
Cb		26	26.0
H		23	26.3
	2.50'S		
H		37	24.9 2.53'S = Conc. Steps Fin
17		42	24.4 32' W of Hk
Cb		49	23.7 2.9' 25.69

29th St

28.60

1/4	15	24.1
1/2	4.3	24.3
1/4	4.3	24.3
cb	4.5	24.1
F	4.1	24.5

2255

F	6.4	22.2
cb	6.6	22.0
+5	7.2	21.4
1/4	6.7	21.9
1/2	6.5	22.1
1/4	6.7	21.9
cb	6.6	22.0
+3	6.7	21.9
1/4	5.0	23.6

300 S = 11.6 Coll/02

1/4	7.3	21.3
+3	8.0	20.6
cb	7.8	20.8
1/4	8.0	20.6
1/2	8.4	20.2
1/4	8.7	19.9
cb	8.8	19.8
F	8.9	19.7

1/4 cb of Cotton

-10	11.3	16.3
-----	------	------

Cotton
80% yield
11 cb
13 0/1

28.60

46

F	10.4	18.2
cb	9.7	18.9
1/4	9.6	19.0
1/2	9.3	19.3
1/4	9.2	19.4
cb	8.4	20.2
1/4	8.1	20.5

11/1

-10	8.9	19.7
1/4	12.0	16.6
cb	13.0	15.6
1/4	12.4	16.2
1/2	11.3	17.3
1/4	12.7	15.9
cb	14.2	14.4
F	16.3	12.3
+15	16.2	12.4

2137

19.41

12.56

16.04

1/2 Cotton

-20	10.2	9.2
F	9.7	9.7
cb	9.6	9.8
1/4	9.9	9.5
1/2	8.5	10.9
1/4	7.8	11.6
cb	6.5	12.9

29th St.

1941

N		1.3	15.1
+10		0.5	18.9
	5 1/4		
-10		0.8	18.6
N		1.3	15.1
+3		5.1	14.3
+7		7.6	11.8
Cb		8.4	11.0
1/4		9.1	10.3
1/2		10.5	8.9
1/4		11.1	8.3
Cb		11.6	7.8
F		11.8	7.6
+20		10.7	8.7
	5 Cb		
-20		13.0	6.4
F		12.9	6.5
Cb		12.6	6.8
1/4		12.6	6.8
1/2		12.7	6.7
1/4		11.7	7.1
Cb		9.3	10.1
N		5.3	14.1
+10		3.3	16.1
	SL Cotton		
-10		11.4	8.0

- 1941

47

N		12.4	7.0	
Cb		14.0	5.4	
1/4		14.4	5.0	
1/2		13.7	5.7	
1/4		13.6	5.8	
Cb		13.7	5.7	
F		13.7	5.7	
+20		14.3	5.1	
TP	1.80	8.78	12.43	6.98

Proposed Drain 12" W of L.L. of 29th
South of SL Cotton

0+0 = SL Cotton		3.0	5.8	
+20		4.9	3.9	
+50		8.1	0.7	
+70		10.0	- 1.2	
+90		10.7	- 1.9	
TP	12.59	21.18	0.19	2.59
TP	12.32	33.11	0.39	20.79
TP	8.17	41.05	0.23	32.88
BM		3.05	38.00	

SWBP
Main 129th
38.00

Walker.
Bliss
Dredge
11-18-30

FELTON ST.
Elev. of East Gutter Line Exist. Paving
Bet. Adams and Madison Aves.

391.94

48

St. Adams	3.62	391.94	388.32	N.Y. SP. Adams & Felton
= 0+00			5.08	386.86
+10			5.10	.84
+20			5.10	.84
+30			5.10	.84
+40			5.07	.81
+60			5.13	.81
+70			5.18	.76
+80			5.14	.80
+90			5.17	.77
1+00			5.14	.80
+10			5.06	.88
+20			5.06	.88
+23 = P.C. Alley Ret.			5.08	86.86
K.C. " "			4.85	87.09
+32.5			5.10	86.84
P.C. " " on Sect 4.			4.80	87.14
1+41 = K.C. " " "			5.00	86.94
+50			5.09	.85
+60			5.11	.83
+70			5.15	.79
+80			5.18	.76
+90			5.16	.78
2+00			5.35	.59
+10			5.31	.59

2+20	5.37	.57
+30	5.29	.65
+40	5.28	.66
+50	5.25	.69
+60	5.29	.65
+70	5.22	.72
+80 = 86.5	5.28	.66
+90	5.30	.64
3+00	5.42	.52
+10	5.43	.51
+20	5.40	.54
+30	5.35	.59
+40	5.41	.53
+50	5.57	.37
TP	4.68	391.07
3+60	4.70	86.37
+70	4.63	.44
+80	4.64	.43
+90	4.63	.44
4+00 = 86.5	4.68	.39
+10	4.73	.34
+20	4.75	.32
+30	4.82	.25
+40	4.79	.28
+50	4.79	.28
+60	4.80	86.27

388.32-81
3887
391.80-7

391.07

4+70	4.83	86.74
+80	4.84	.73
+90	4.91	.16
5+00	4.92	.15
+10	4.94	.13
+20	4.91	.16
+30	4.90	.17
+40	4.91	.16
+50	4.98	.09
+60	4.93	.14
+70	4.94	.13
+80	4.89	.18
+90 = Bk	4.93	.14
6+00	5.05	.02
+10	5.06	.01
+20	5.11	85.96
+30	5.08	85.99
+40	5.10	85.97
+50	5.20	85.87
+60	5.25	.82
+70	5.23	.84
+80	5.19	.88
+90	5.25	.82
7+00	5.30	.77
+10	5.30	.77
+20	5.22	.85

391.07

49

7+30	5.27	85.80
+40	5.23	.84
+50	5.29	.78
+60	5.26	.81
+70 = Bk	5.28	.79
+80	5.32	.75
7+90.7-N	5.40	.67
cb.	5.37	.70
Q = Bk	5.36	.71
Top Ob shine	5.40	.67
Gutter shine	5.57	85.50
check BM	2.77	388.30

Walker
Bliss
Drebert
Osborn
11-14-30

ROSS SECTION ^{30'} ALLEY Bk. C
IN PLUMOSA PARK
Bet. Azalea & Hyacinth Drive
From N.W. Azalea to Public lot

0.29 128.42 128.13
310
C.P. 80
Chapman St. 80
& 511th St.

T.P. 4.48 121.28 11.62 116.80

Stations are from N.W. Azalea on N.W. Alley.

Start top ch.	10.66	110.62
" Gut on Pav.	11.09	110.19
" " "	11.62	109.64
" " "	11.62	109.66
E on Drive way of A	11.48	109.80
0+12 = opp. B		
B. on Drive way = East Line	10.95	110.33
∠	10.4	110.9
M	9.4	111.9
0+25		
M	9.1	112.2
∠	9.9	111.4
E	9.6	111.7
0+50 = opp. C.		
B on Drive way	8.94	112.34
E	8.9	112.4
∠	9.1	112.2
M	8.6	112.7
+1	7.2	114.1
+5	7.0	114.3
0+66		
-5	6.6	114.7

Plotted
11/18-30
C.B.H.

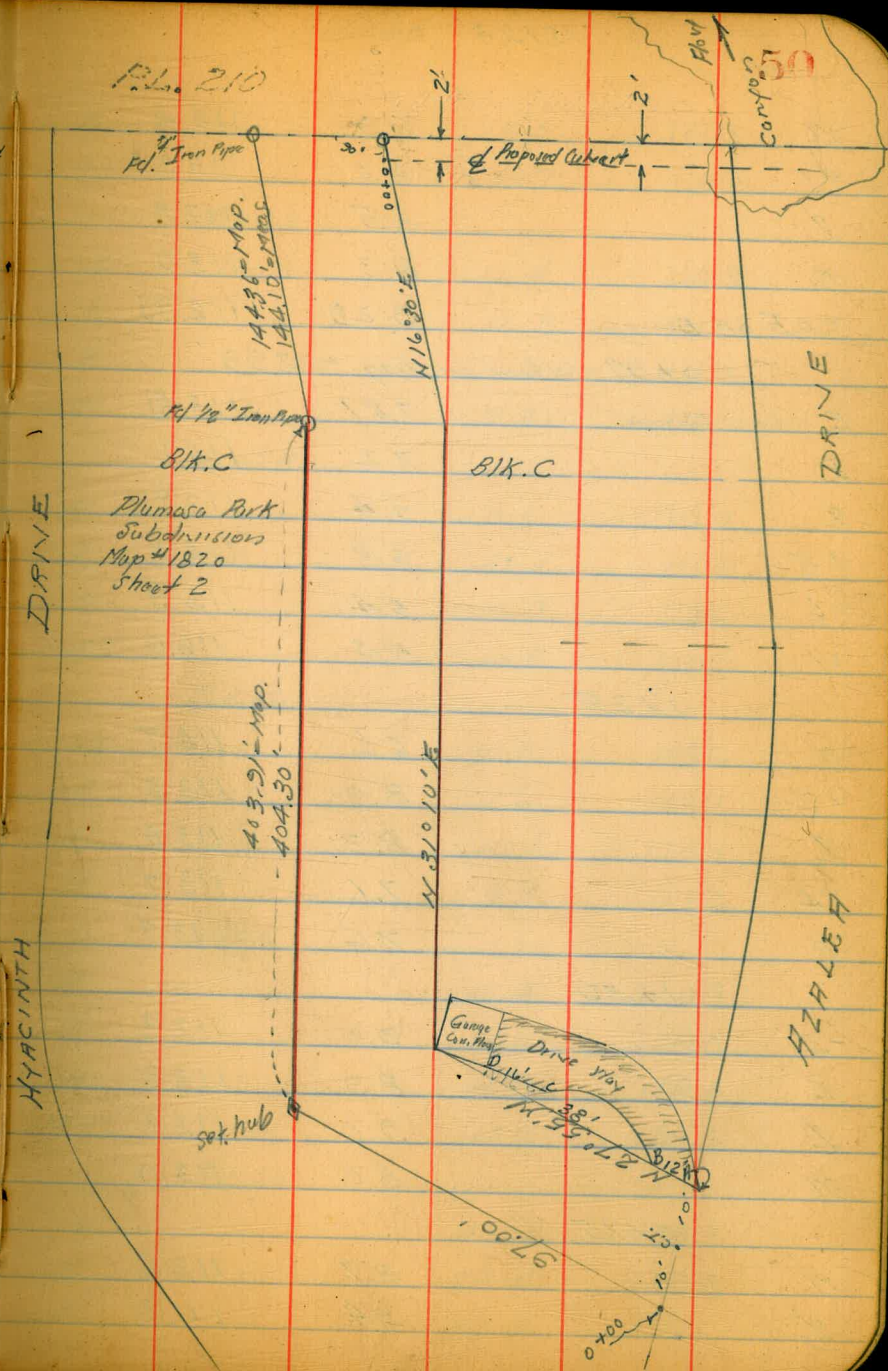

Plan 210

1/2" Iron Pipe
1473.6 Map.
144.10
1/2" Iron Pipe
Bk. C
Plumosa Park
Subdivisions
Map #1820
Sheet 2

403.9 Map.
404.30

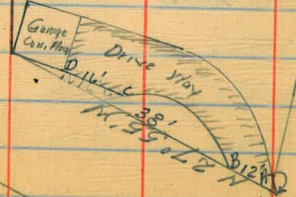

12/28

12/28

51

M	6.9	114.4
+1	8.0	113.3
L	8.5	112.8
E	8.3	113.0
+0.5 on Drive	8.29	112.99
0+97 = Section on diag. = 23.99'		
E = Base Gauge	7.87	113.41
E	7.2	114.1
L	7.4	113.9
+5	6.8	114.5
+6	5.4	115.9
M	5.3	116.0

1+25

M	6.6	114.7
+2	8.0	113.3
L	8.3	113.0
+4	7.6	113.7
E	7.6	113.7

1+50

-5'	9.0	112.3
E	8.9	112.3
L	9.0	112.3
M	8.3	113.0

1+75

M	8.7	112.6
L	9.4	111.9

E	10.0	111.3
+5'	10.7	110.6
2+00		
-5'	10.4	110.9
E	10.3	111.0
L	10.0	111.3
M	9.3	112.0
2+25		
M	9.6	111.7
L	10.1	111.2
E	10.7	110.6
+5	10.8	110.5

2+50

-5'	11.7	109.6
E	11.6	109.7
L	10.6	110.7
M	9.7	111.6
2+75		

M	10.4	110.9
L	11.3	109.0
E	11.9	109.4
+5'	12.0	109.3

3+00

-5'	12.8	108.5
E	12.5	108.8
L	12.2	109.1

N		11.0	110.3
	3+25		
N		12.0	109.3
E		12.7	108.6
E		13.2	108.1
+5		13.5	107.8
T.P.	223 110.59	12.92	108.36
	3+50		
-5'		3.1	107.1
E		3.2	107.4
E		2.9	107.7
N		1.8	108.8
	3+75		
N		3.9	106.7
E		4.2	106.4
E		4.3	106.3
+5'		4.5	106.1
	4+00		
-5'		5.2	105.4
E		5.5	105.1
E		5.2	105.4
N		3.6	107.0
	4+25		
N		5.1	105.5
E		5.7	104.9
E		5.9	104.7

+5		6.0	104.6
	4+50		
-5'		6.1	104.5
E		5.8	104.8
E		5.5	105.7
N		4.9	105.7
	4+51 - S. Sewer M.H. on E. See Plumosa Park Plans		
	E +4.6 on Rim M.H.	5.62	104.97
	+4.6 " Floor	9.8 15.50	95.09
	4+75		
N		5.3	105.3
E		6.0	104.6
E		6.6	104.0
+5		7.0	103.6
	5+01.3 = A L. 14'40" Section on diag.		
-5'		8.0	102.6
E		7.1	103.5
E		6.7	103.9
	N on 1/2" Iron Pipe	5.97	104.62
	5+25		
N		6.3	104.3
E		7.4	103.2
E		8.4	102.2
+5		8.9	101.7
	5+50		
-5		9.1	101.5

11059

E	8.5	102.1
ℓ	7.3	103.3
W	6.6	104.0

5+75

W	7.5	103.1
ℓ	8.3	101.7
E	9.4	101.2
+5	10.2	100.4

6+00

-5'	10.5	100.1
E	9.4	101.2
ℓ	8.4	102.2
W	7.8	102.8

6+25

W	8.4	102.2
ℓ	9.0	101.6
E	9.9	100.7
+5	10.3	100.3

6+45.4 = End Job. Section on diag.

-5'	9.8	100.8
E	9.5	101.1
ℓ	8.2	102.4
W	7.8	102.8

Levels For Culvert See P-50

0+00	9.5
+25	11.4

11059

53

0+50	14.7		
+85	19.0		
1+00	23.3		
+25	28.5		
1+36 - W. P. 100	30.1		
+70	36.2		
TP 13.08	121.44	2.25	108.36
TP 11.56	129.31	2.69	117.75
check starting BM	1.19	128.12	

128.13 - BM.
0.01 = Error.

100' wide
20' els
15' 1/4
W. 1/2 of Roadway Paved.

6th St X Sec. Laurel to 21pas

1-7-31
Miller
Sommermeier
Osborne

N.W. 6th &
Laurel

Ⓟ

257.30

54

B.M.	5.37	257.30	251.93
		00 = N. Line Laurel	
W. gutter pavmt.		5.82	251.48
1/4 "	"	5.50	251.80
1/2 "	"	5.35	251.95
1/4 "	"	5.38	251.92
E. gutter "	"	5.81	251.49
E. ent. ch.		5.24	252.06
	9.4 N	{ S. End ent. curtain wall 0.7 wide = N. End Full width asphalt Pavmt.	
E. ent. ch.		5.17	252.13
gutter pavmt.		5.76	251.54
1/4 "		5.40	251.90
{ S. End pavmt. on E. half 1/2 E. edge " to N.		5.28	252.02
	10' N	= N. edge ent. curtain wall	
E. ent. ch.		5.17	252.13
gutter		5.76	251.54
1/4 "		5.40	251.90
{ W. end. curtain wall 1/2 E. edge pavmt. to N.		5.28	252.02
1/4 on pavmt.		5.43	251.87
gutter "		5.83	251.47
	12' 3 N	= 12" x 20" iron grating on catch Basin	
E. gutter on grating		5.75	251.55
F.L. 12" outlet pipe to S.		8.06	249.24
	31.3 N	= N. End ent. ch. on E.	
W. gutter pavmt.		5.55	251.75
1/4 "		5.16	252.14

Plotted Jan 13-31
CBA

1/2 = E. edge pavmt. + dirt	4.86	252.44
1/4 "	5.2	252.1
gutter	5.6	251.7
E. ent. ch. N. End	4.90	252.40
E. ch. line on lawn to N.	4.8	252.5
	50' N.	
E. ch. on lawn	4.6	252.7
+ 0.5 gutter	5.4	251.9
1/4 "	5.1	252.2
1/2 dirt.	4.8	252.5
1/2 pavmt.	4.27	252.63
1/4 "	4.86	252.44
W. gutter "	5.36	251.94
	100' N.	
W. gutter pavmt	4.76	252.54
1/4 "	4.23	253.07
1/2 "	4.11	253.19
1/2 dirt.	4.0	253.3
1/4 "	4.4	252.9
+ 14	5.0	252.9
E. ch. on lawn	4.1	253.2
	150' N.	
E. ch. on lawn	3.6	253.7
+ 1	4.5	252.8
1/4 "	4.0	253.3
E. pavmt. + dirt	3.54	253.76

		257.30	
		150' N. (con)	
W. '14	paymt.	3.72	253.58
W gutter	"	4.17	253.13
		200' N.	
W gutter	paymt.	3.61	253.69
'14	"	3.18	254.12
⊕	" + dirt	3.00	254.30
'14	"	3.5	253.8
+14'	"	3.8	253.5
E. db. on lawn	"	3.0	254.3
		250' N.	
E. db. on lawn	"	2.4	254.9
+1'	"	3.3	254.0
'14	"	2.7	254.6
⊕	paymt + dirt.	2.49	254.81
'14 "	"	2.54	254.76
W gutter "	"	3.04	254.26
		300' N = S. line	
W. ent. db	"	1.83	255.47
gutter paymt.	"	2.43	254.87
'14	"	2.02	255.28
⊕	" + dirt	1.79	255.51
'14	"	1.9	255.4
+14'	"	2.8	254.5
E. db. on lawn.	"	1.8	255.5

		257.30	
		S. db.	
E. db. on lawn	"	1.4	255.9
+1'	"	2.5	254.8
'14	"	1.8	255.5
⊕	paymt. + dirt.	1.54	255.76
'14	"	1.70	255.6
W gutter "	"	2.09	255.21
		S. '14	
W gutter paymt.	"	1.83	255.47
'14	"	1.51	255.79
⊕	" + dirt	1.36	255.94
'14	"	1.7	255.6
+14'	"	2.4	254.9
E. db. on lawn	"	1.4	255.9
		⊕	
E. db. on lawn	"	1.2	256.1
+1'	"	2.3	255.0
'14	"	1.5	255.8
⊕	paymt. + dirt.	1.20	256.10
'14	"	1.35	255.95
W gutter "	"	1.68	255.62
		N. '14	
W gutter paymt.	"	1.54	255.76
'14	"	1.21	256.09
⊕	" + dirt	1.06	256.24
'14	"	1.4	255.9
+14'	"	2.2	255.1
E. db. on lawn.	"	1.1	256.2

6th 5th
55

257.30
N. ch. Line Maple

E. ch. on Lawn	1.0	256.3
+1'	2.1	255.2
1/4	1.3	256.0
⊕ parmt + dirt	0.91	256.29
1/4 "	1.17	256.13
W gutter "	1.43	255.87

00 = N. Line Maple.

N. emb. ch.	0.68	256.62
gutter parmt	1.28	256.02
1/4 "	0.83	256.47
⊕ " + dirt	0.65	256.65
1/4 "	0.9	256.4
+14'	1.9	255.4
E. ch. Lawn - s. edge dirt path to E.	0.9	256.4

T.P. BM. 6.39 261.87 1.82 255.48 ✓ ^{s.w. 6th} + Maple

Bet 00 & 8' N. dirt Path from E. ch. line East.

50' N.

E. ch. Lawn	5.1	256.8
+1'	5.9	256.0
1/4	5.0	256.9
⊕ parmt + dirt	4.75	257.13
1/4 "	4.94	256.93
W. gutter "	5.36	256.51

84' N. 24" X 24" grating over catch basin full of dirt

1.5 W. of E. ch. line ctr. grating 5.35 256.52

261.87
100' N.

W. gutter parmt.	4.90	256.97
1/4 "	4.49	257.38
⊕ " + dirt	4.27	257.60
1/4 "	4.6	257.27
+14'	5.4	256.5
E. ch. Lawn	4.6	257.3

150' N.

E. ch. Lawn	4.2	257.7
+1'	4.8	257.1
1/4 "	4.3	257.6
⊕ parmt + dirt	3.79	258.08
1/4 "	3.95	257.92
W. gutter "	4.39	257.48

200' N.

W. gutter parmt.	3.91	257.96
1/4 "	3.48	258.39
⊕ " + dirt	3.32	258.55
1/4 "	3.8	258.1
+14'	4.4	257.5
E. ch. Lawn	3.6	258.3

250' N.

E. ch. Lawn	3.1	258.8
+1.0	3.8	258.1
1/4	3.2	258.7
⊕ parmt + dirt	2.84	259.03
1/4 "	2.96	258.91
W. gutter "		

6th St

56

261.87
300' N = S. line + Nutmeg

80' wid.
14' elev.
13' 1/2

W. cont. el.	2.23	259.64
W. gutter pavmt.	2.90	258.97
1/4 "	2.46	259.41
♀ " + dirt	2.28	259.59
1/4	2.6	259.3
+ 14'	3.2	258.7
E. el. on lawn	2.6	259.3
Bet 1. + 8' No. + S. line = dirt path to E.		
S. el.		
E. el. on lawn	2.4	259.5
+ 1'	3.1	258.8
1/4	2.4	259.5
♀ pavmt. + dirt	2.11	259.76
1/4 "	2.28	259.59
W. gutter "	2.70	259.17
S. 1/4		
W. gutter pavmt.	2.35	259.52
1/4 "	2.00	259.87
♀ " + dirt	1.87	260.00
1/4	2.1	259.8
+ 14'	2.8	259.1
E. el. on lawn.	2.2	259.7
♀		
E. el. on lawn	2.0	259.9
+ 1'	2.7	259.2
1/4	2.0	259.9

261.87

6th ST
57

♀ pavmt + dirt	1.64	260.23
1/4 "	1.74	260.13
W. gutter "	2.05	259.82
N. 1/4		
W. gutter pavmt.	1.84	260.03
1/4 "	1.60	260.27
♀ " + dirt	1.39	260.48
1/4	1.6	260.3
+ 14'	2.5	259.4
E. el. on lawn	1.8	260.1
N. el.		
E. el. on lawn	1.6	260.3
+ 1.0	2.2	259.7
1/4	1.5	260.4
♀ pavmt. + dirt	1.18	260.69
1/4 "	1.35	260.52
W. gutter "	1.75	260.12
00 = N. line + Nutmeg		
W. cont. el.	0.95	260.92
W. gutter pavmt.	1.56	260.31
1/4 "	1.12	260.75
♀ " + dirt	0.95	260.92
1/4	1.4	260.5
+ 14'	2.0	259.9
E. el. on lawn	1.3	260.6
T.P.	6.78	267.68
	0.97	260.90

		267.68	
50' N.			
E. ch. on lawn		6.5	261.2
+ 1.0		7.1	260.6
1/4		6.5	261.2
1/4 Pavmt + dirt		5.84	261.84
1/4 "		5.98	261.70
W. gutter "		6.47	261.21
100' N.			
W. gutter pavmt.		5.40	262.22
1/4 "		5.00	262.68
1/4 " + dirt		4.92	262.76
1/4 "		5.6	262.1
+ 1/4'		6.3	261.4
E. ch. Lawn		5.6	262.1
150' N.			
E. ch. Lawn		4.7	263.0
+ 1.0		5.4	262.3
1/4		4.8	262.9
1/4 Pavmt. + dirt		4.00	263.68
1/4 "		4.10	263.58
W. gutter "		4.54	263.14
200' N			
W. gutter pavmt		3.55	264.13
1/4 "		3.17	264.51
1/4 " + dirt		3.04	264.64
1/4 "		3.8	263.9
+ 1/4'		4.5	263.2

		267.68		6 th St.
				58
250' N				
E. ch. Lawn		3.8	263.9	
E. ch. Lawn		2.8	264.9	
+ 1.0		3.7	264.0	
1/4		2.8	264.9	
1/4 Pavmt + dirt		2.10	265.58	
1/4 "		2.10	265.58	
W. gutter "		2.50	265.18	
300' N = S. line				80' wide
W. ch. cl.	olive St	0.70	266.98	14' chs
W. gutter pavmt		1.50	266.18	13' chs.
1/4 "		1.20	266.42	
1/4 " + dirt		1.17	266.51	
1/4 "		1.9	265.8	
+ 1/4'		2.8	264.9	
E. ch. Lawn		1.8	265.9	
S. ch				
E. ch. lawn		1.5	266.2	
+ 1.0		2.6	265.1	
1/4		1.8	265.9	
1/4 Pavmt + dirt		0.91	266.77	
1/4 "		1.02	266.66	
W. gutter "		1.35	266.33	

		267.68		
		S ¹ / ₄ Olive		
W. gutter	parvnt.	1.21	266.47	
" ¹ / ₄	"	0.89	266.79	
♀	" + dirt	0.78	266.90	
" ¹ / ₄		1.5	266.2	
+14'		2.3	265.4	
E. cl. on lawn		1.2	266.5	
		♀		
E. cl. on lawn		0.9	266.8	
+1'		2.1	265.6	
" ¹ / ₄		1.2	266.5	
♀	parvnt. + dirt	0.51	267.17	
" ¹ / ₄	"	0.71	266.97	
W. gutter	"	1.09	266.59	
		N. " ¹ / ₄		
W. gutter	parvnt.	0.97	266.71	
" ¹ / ₄	"	0.60	267.08	
♀	" + dirt	0.35	267.93	
" ¹ / ₄		0.8	266.9	
+14'		1.8	265.9	
E. cl. on lawn		0.7	267.0	
		N. cl.		
E. cl. on lawn		0.3	267.4	
+1.0		1.5	266.2	
" ¹ / ₄		0.7	267.0	
♀	parvnt. + dirt	0.22	267.46	
" ¹ / ₄	"	0.50	267.18	
W. gutter	"	0.88	266.80	

		267.68		
		267.68		
		00 = N. line Olive St		
		6 th St		
		59		
W. cont. cl.		0.11	267.57	
gutter parvnt.		0.76	266.92	
" ¹ / ₄	"	0.32	267.36	
♀	" + dirt	0.07	267.61	
" ¹ / ₄		0.5	267.2	
+14'		1.2	266.5	
E. cl. on lawn		0.1	267.6	
T.P. B.M.	8.36	275.38	0.66	267.02
		50' N.		
E. cl. on lawn		6.9	268.5	
+1'		8.0	267.4	
" ¹ / ₄		7.3	268.1	
♀	parvnt. + dirt	6.71	268.67	
" ¹ / ₄	"	6.90	268.48	
W gutter	"	7.34	268.04	
		100' N.		
W. gutter parvnt.		6.17	269.21	
" ¹ / ₄	"	5.78	269.60	
♀	" + dirt	5.68	269.70	
" ¹ / ₄		6.2	269.2	
+14'		6.9	268.5	
E. cl. on lawn		6.0	269.4	

S. W. 6th + Olive

275.38
150' N.

E. ch. on lawn	5.0	270.4
+ 1.0	6.0	269.4
"	5.4	270.0
♀ pavmt. & dirt	4.67	270.71
"	4.78	270.60
W. gutter	5.09	270.29

200' N.

W. gutter pavmt.	3.90	271.48
"	3.68	271.70
♀ " & dirt	3.62	271.76
"	4.3	271.1
+ 14' 0	5.1	270.3
E. ch. on lawn	3.9	271.5

250' N.

E. ch. on lawn	3.1	272.3
+ 1.0	4.2	271.2
"	3.3	272.1
♀ pavmt.	2.60	272.78
"	2.60	272.78
W. gutter	2.82	272.56
W. cnt. ch.	0.88	274.50
W. gutter pavmt.	1.65	273.73
"	1.51	273.87
♀ " & dirt	1.67	273.71
"	2.2	273.2
+ 14' 0	3.1	272.3
E. ch. on lawn	2.0	273.4

301' N. = S. Line Palm St.

80' width
14' ch. s.
13' 1/4 s.

275.38
S. d.

E. ch. on lawn	1.7	273.7
+ 1.0	2.8	272.6
"	2.1	273.3
♀ pavmt. & dirt	1.39	273.99
"	1.31	274.07
W. gutter	1.52	273.86

S. '14

W. gutter pavmt.	1.27	274.11
"	1.12	274.26
♀ " & dirt	1.18	274.20
"	1.8	273.6
+ 14' 0	2.6	272.8
E. ch. on lawn	1.5	273.9

♀

E. ch. on lawn	1.2	274.2
+ 1.0	2.3	273.1
"	1.6	273.8
♀ pavmt. & dirt	0.98	274.40
"	0.90	274.48
W. gutter	1.10	274.28

N. '14

W. gutter pavmt.	0.93	274.45
"	0.75	274.63
♀ " & dirt	0.78	274.60
"	1.3	274.1
+ 14'	2.2	273.2
E. ch. on lawn	0.9	274.5

6th St
60

275.38

N. cl.

E. cl. on lawn		0.7	274.7
+ 1.0		1.9	273.5
1/4		1.2	274.2
♀ pavmt. & dirt		0.53	274.85
1/4 "		0.57	274.81
W. gutter "		0.84	274.54
	00 = N. line Palm		
W. emt. cl		0.08	275.30
W. gutter pavmt.		0.71	274.67
1/4 "		0.38	275.00
♀ " & dirt		0.35	275.03
1/4 "		0.9	274.5
+ 1/4		1.7	273.7
E. cl. on lawn		0.5	274.9
T.P. B.M.	6.29	281.59	0.08
	50' N.		275.30 =
			N.W. 6 ²³ + Palm 275.27
E. cl. on lawn		6.0	275.6
+ 1.0		7.1	274.5
1/4		6.3	275.3
♀ pavmt. & dirt		5.80	275.79
1/4 "		5.86	275.73
W. gutter "		6.30	275.29
	100' N.		
W. gutter pavmt.		5.65	275.94
1/4 "		5.22	276.37
♀ " & dirt.		5.08	276.51

281.59

6²⁰ 5+

61

1/4		5.4	276.2
+ 1.0		6.2	275.4
E. cl. on lawn		5.1	276.5
	150' N.		
E. cl. on lawn		4.4	277.2
+ 1.0		5.5	276.1
1/4		4.8	276.8
♀ pavmt.		4.29	277.30
1/4 "		4.48	277.11
W. gutter "		4.99	276.60
	200' N.		
W. gutter pavmt.		4.12	277.47
1/4 "		3.65	277.94
♀ " & dirt		3.48	278.11
1/4 "		3.7	277.9
+ 1.0		4.5	277.1
E. cl. on lawn		3.5	278.1
	250' N.		
E. cl. on lawn		2.7	278.9
+ 1.0		3.6	278.0
1/4		2.9	278.7
♀ pavmt. & dirt		2.58	279.01
1/4 "		2.76	278.83
W. gutter "		3.26	278.33

R81.59

			80' wide 14' cl. s 13' 1/2' s	
W. emb. cl	300.7N = S. line Quince	1.73	279.86	
W. gutter Pavmt.		2.39	279.20	
"	"	1.94	279.65	
⊥	" + dirt	1.67	279.92	
"		2.0	279.6	
+ 14' 0		2.6	279.0	
E. cl. on Lawn		1.7	279.9	
T.P.	3.99 284.87	0.71	280.88	
20' E. of E. cl. on lawn	S. cl.	4.8	280.1	
E. cl. line in gutter		5.4	279.5	
"		4.9	280.0	
⊥ pavmt. + dirt		4.72	280.15	
"		4.97	279.90	
W. gutter "		5.49	279.38	
	1' 0 N. of S. cl = S. gutter of Quince E. of 6 th			
E. cl. Line 6 th		5.4	279.5	
+ 20' E		5.6	279.3	
+ 70' E		6.5	278.4	
120' E		7.2	277.7	
170' E		7.9	277.0	
210' E. of E. cl. of 6 th = W. line 7 th		8.1	276.8	
	S. 1/4			
210' E. of E. cl. of 6 th		8.0	276.9	
170' E.		7.7	277.2	
120' E.		7.0	277.9	
70' E.		6.1	278.8	

284.87

6th St

62

20' E. of E. cl. of 6 th	5.5	279.4
E. cl. line 6 th	5.1	279.8
"	4.7	280.2
⊥ pavmt + dirt	4.60	280.27
"	4.81	280.06
W. gutter "	5.25	279.62
	⊥	
W. gutter pavmt.	5.04	279.83
"	4.65	280.22
⊥ " + dirt	4.39	280.48
"	4.5	280.4
E. cl. line	4.8	280.1
20' E.	5.1	279.8
70' E.	5.9	279.0
120' E.	6.8	278.1
170' E.	7.5	277.4
210' E. of E. cl. of 6 th	7.9	277.0
	N. 1/4	
210' E. of E. cl. line 6 th	7.9	277.0
170' E. " " " "	7.5	277.4
120' E.	6.9	278.0
70' E.	6.2	278.7
20' E. of E. cl. line	5.1	279.8
E. cl. line	4.7	280.2
"	4.2	280.7
⊥ pavmt. + dirt	4.27	280.60

		284.87	
N. 1/4 Quince (con)			
1/4 pavmt.		4.56	280.31
W. gutter "		4.90	279.97
10' N. of N. 1/4 = N. gutter of Graded st. E. of 6 th			
E. ch. of 6 th		4.9	280.0
20' E		5.4	279.5
70' E		6.7	278.2
120' E		7.5	277.4
170' E		8.0	276.9
210' E. of E. ch. of 6 th		8.0	276.9
N. ch.			
20' E. of E. ch. on lawn		4.2	280.7
E. ch		4.9	280.0
1/4		4.1	280.8
⊕ pavmt. + dirt		4.15	280.72
1/4 "		4.34	280.53
W. gutter "		4.77	280.10
00 = N. line Quince			
W. emt. ch.		4.93	280.84
W. gutter pavmt.		4.66	280.21
1/4 "		4.21	280.66
⊕ " + dirt		3.96	280.91
1/4		4.0	280.9
+14' 0		4.8	280.1
E. ch. on lawn		3.8	281.1
T.P.	5.81	286.69	3.99 280.88

		286.69	6 th St
			63
50' N.			
E. ch. on lawn		5.3	281.4
+1		6.1	280.6
1/4		5.5	281.2
⊕ pavmt + dirt		5.30	281.39
1/4 "		5.53	281.16
W. gutter "		6.07	280.62
100' N.			
W. gutter pavmt		5.62	281.07
1/4 "		5.11	281.58
⊕ " + dirt.		4.90	281.79
1/4		5.0	281.7
+14' 0		5.7	281.0
E. ch. on lawn		4.9	281.8
150' N			
E. ch. on lawn		4.4	282.3
+1' 0		5.3	281.4
1/4		4.7	282.0
⊕ pavmt. + dirt		4.46	282.23
1/4 "		4.70	281.99
W. gutter "		5.16	281.53
200' N			
W. gutter pavmt		4.68	282.01
1/4 "		4.25	282.44
⊕ " + dirt		4.05	282.64
1/4		4.4	282.3
+14' 0		4.9	281.8
E. ch. on lawn		4.0	282.7

286.69		250' N.	
E. cl. on lawn	3.6	283.1	
+1.0	4.5	282.2	
1/4	3.9	282.8	
⊕ paint + dirt	3.59	282.10	
1/4 "	3.74	282.95	
W. gutter "	4.25	282.44	
W. emt. cl.	3.15	283.54	301'4" N = S. line Redwood <small>80' wide 20' deep 10' high</small>
W. gutter paint	3.80	282.89	
1/4 "	3.36	283.33	
⊕ " + dirt	3.11	283.58	
1/4	3.5	283.2	
+14'0	4.1	283.6	
E. cl. on lawn	3.0	283.7	
S. cl.			
E. cl. on lawn	3.0	283.7	
+1.0	3.9	282.8	
1/4	3.2	283.5	
⊕ paint + dirt	2.98	283.71	
1/4 "	3.21	283.48	
W. gutter "	3.65	283.04	
S. 1/4			
W. gutter paint.	3.61	283.08	
1/4 "	3.12	283.57	
⊕ " + dirt	2.88	283.81	
1/4	3.2	283.5	
+14'0	3.9	282.8	

286.69		6 th ST	
E. cl. on lawn	2.9	283.8	64
⊕			
E. cl. on lawn	2.8	283.9	
+1.0	3.8	282.9	
1/4	3.1	283.6	
⊕ paint, & dirt	2.88	283.81	
1/4 "	3.04	283.65	
W. gutter "	3.53	283.16	
N. 1/4			
W. gutter paint.	3.42	283.27	
1/4 "	3.00	283.69	
⊕ " + dirt	2.79	283.90	
1/4	3.0	283.7	
+14'0	3.7	283.0	
E. cl. on lawn	2.7	284.0	
N. cl.			
E. cl. on lawn	2.5	284.2	
+1.0	3.7	283.0	
1/4	3.0	283.7	
⊕ paint.	2.76	283.93	
1/4 "	2.93	283.76	
W. gutter	3.34	283.35	

		286.69		
00 = N. Line Redwood.				
W. emt. cl.		2.67	284.02	
W. gutter	pavmt.	3.27	283.42	
"	"	2.83	283.86	
♀	" + dirt	2.61	284.08	
"	"	3.0	283.7	
+14.0		3.5	283.2	
E. cl. on lawn		2.4	284.3	
T.P. Pole	4.64	289.06	2.27	284.42
		50' N		
E. cl. on lawn		4.4	284.5	
+1.0		5.5	283.6	
"		5.1	284.0	
♀	pavmt. & dirt	4.70	284.36	
"	"	4.93	284.13	
W. gutter	"	5.41	283.65	
		100' N		
W. gutter	pavmt.	5.17	283.89	
"	"	4.68	284.38	
♀	" + dirt	4.45	284.61	
"	"	4.7	284.4	
+14.0		5.3	283.8	
E. cl. on lawn		4.4	284.7	
		150' N		
E. cl. on lawn		4.1	285.0	
+1.0		4.9	284.2	
"		4.5	284.6	

S.W. 6th +
Redwood

		289.06		
♀	pavmt.	4.17	284.89	
"	"	4.41	284.65	
W. gutter	"	4.93	284.13	
		200' N		
W. gutter	pavmt.	4.73	284.33	
"	"	4.18	284.88	
♀	"	3.94	285.12	
"	"	4.1	285.0	
+14.0		4.5	284.6	
E. cl. on lawn		3.7	285.4	
		250' N		
E. cl. on lawn		3.4	285.7	
+1.0		4.2	284.9	
"		3.8	285.3	
♀	pavmt	3.64	285.42	
"	"	3.87	285.19	
W. gutter	"	4.44	284.62	
		300' N = S. Line Spruce		
W. emt. cl.		3.56	285.50	
W. gutter	pavmt.	4.20	284.86	
"	"	3.66	285.40	
♀	"	3.36	285.70	
"	"	3.6	285.5	
+14.0		4.0	285.1	
E. cl. on lawn		3.2	285.9	
T.P. F. H	2.99	290.99	1.06	288.00

S.W. 6th +
Spruce.

90' wide
20' deep
10' high

6th St

65

290.99

S. cl. of Spruce

E. cl. on lawn	5.0	286.0
+ 0.5	5.8	285.2
"	5.3	285.7
♀ pavmt. + dirt	5.18	285.81
"	5.44	285.55
W. gutter "	5.83	285.16
	S. 1/4	
W. gutter pavmt.	5.55	285.44
"	5.38	285.61
♀ " + dirt	5.12	285.87
"	5.2	285.8
+ 14.5	5.7	285.3
E. cl. on lawn	4.9	286.1
	♀	
E. cl. on lawn	4.9	286.1
+ 0.5	5.7	285.3
"	5.2	285.8
♀ pavmt. + dirt	5.08	285.91
"	5.28	285.71
W. gutter "	5.42	285.57
	N. 1/4	
W. gutter pavmt.	5.46	285.53
"	5.28	285.71
♀ " + dirt	5.02	285.97
"	5.1	285.9
+ 14.5	5.6	285.4

290.99

6th St

66

E. cl. on lawn	4.8	286.2
	N. cl.	
E. cl. on lawn	4.7	286.3
+	5.6	285.4
"	5.0	286.0
♀ pavmt. + dirt	4.97	286.02
"	5.27	285.72
W. gutter "	5.72	285.27
	9. N. of N. cl. to 17. N. of N. cl. dirt Path from E. cl. East	
	oo = N. line Spruce	
W. cut. cl	5.11	285.88
W. gutter pavmt.	5.67	285.32
"	5.17	285.82
♀ " + dirt	4.88	286.11
"	4.9	286.1
+ 14.5	5.5	285.5
E. cl. on lawn	4.4	286.4
	50' N.	
E. cl. on lawn	4.4	286.6
+ 0.5	5.3	285.7
"	4.7	286.3
♀ pavmt. + dirt	4.62	286.37
"	4.95	286.04
W. gutter "	5.47	285.52

290.99
100' N

w. gutter pavmt.	5.17	285.82
"	4.66	286.33
⊕ " + dirt	4.39	286.60
"	4.6	286.4
+14.5	5.1	285.9
E. eb. on lawn	4.2	286.8

150' N.

E. eb. on lawn	3.9	287.1
+0.5	4.9	286.1
"	4.3	286.7
⊕ pavmt + dirt	4.12	286.87
"	4.43	286.56
w. gutter "	4.89	286.10

200' N.

w. gutter pavmt.	4.64	286.35
"	4.14	286.85
⊕ " + dirt	3.88	287.11
"	4.2	286.8
+14.5	4.6	286.4
E. eb. on lawn	3.8	287.2

250' N

E. eb. on lawn	3.6	287.4
+0.5	4.5	286.5
"	4.0	287.0
⊕ pavmt + dirt	3.67	287.32
"	3.88	287.11
w. gutter "	4.39	286.60

290.99
301.4N. = S. Line Thorn St
$$\begin{cases} 80' \text{ wide} \\ 20' \text{ els} \\ 10' \text{ els} \end{cases}$$
6th ST

67

w. pmt. eb.	3.47	287.52
w. gutter pavmt.	4.10	286.89
"	3.62	287.37
⊕ " + dirt	3.39	287.60
"	3.7	287.3
+14.5	4.2	286.8

E. eb. on lawn 3.3 287.7

T.P. BM 5.09 292.51 3.57 287.42 ← S.W. 6th & Thorn h.

S. d

E. eb. on lawn	4.7	287.8
+0.5	5.6	286.9
"	5.2	287.3
⊕ pavmt + dirt	4.77	287.72
"	5.02	287.49
w. gutter "	5.45	287.06

S. "4

w. gutter pavmt	5.09	287.42
"	4.92	287.59
⊕ " + dirt	4.73	287.78
"	5.1	287.4
+14.5	5.6	286.9
E. eb. on lawn	4.6	287.9

292.51

☒ Thorn St.

E. cl. on lawn	4.7	287.8
+ 0.5	5.4	287.1
"	5.0	287.5
☒ pavmt. + dirt	4.66	287.85
"	4.79	287.72
W. gutter "	4.91	287.60
	N. 1/4	
W. gutter pavmt.	4.93	287.58
"	4.80	287.71
☒ " + dirt	4.60	287.91
"	4.9	287.6
+ 14.5	5.6	286.9
E. cl. on lawn	4.5	288.0
	N. cl.	
E. cl. on lawn	4.5	288.0
+ 0.5	5.6	286.9
"	4.9	287.6
☒ pavmt. + dirt	4.53	287.98
"	4.71	287.80
☒ W. gutter "	5.10	287.41
	10' N. of N. cl. to 17' N. of N. cl. dirt walk from E. cl. East.	
	00 = N. Line Thorn St.	
W. cont. cl.	4.48	288.03
W. gutter pavmt.	5.05	287.46
"	4.60	287.91
☒ " + dirt	4.37	288.14
"	4.8	287.7

292.51

6th St.

68

+ 14.5	5.4	287.1
E. cl. on lawn	4.4	288.1
	50' N.	
E. cl. on lawn	4.2	288.3
+ 0.5	5.1	287.4
1/4	4.6	287.9
☒ pavmt.	4.21	288.30
"	4.34	288.17
W. gutter "	4.82	287.69
	100' N.	
W. gutter pavmt.	4.66	287.85
1/4 "	4.22	288.29
☒ " + dirt	4.00	288.51
1/4	4.4	288.1
+ 14.5	4.9	287.6
E. cl. on lawn	4.0	288.5
	150' N.	
E. cl. on lawn	3.8	288.7
+ 0.5	4.7	287.8
1/4	4.3	288.2
☒ pavmt. + dirt	3.80	288.71
"	4.01	288.50
W. gutter "	4.49	288.02

292.51

200' N

W. gutter pavmt.	4.33	288.18
"	3.81	288.70
☿ " + dirt	3.60	288.91
"	4.0	288.5
+14.5	4.4	288.1
E. cl. on lawn	3.7	288.8

250' N

E. cl. on lawn	3.6	288.9
+0.5	4.2	288.3
"	3.7	288.8
☿ pavmt & dirt	3.40	289.11
"	3.62	288.89
W. gutter "	4.16	288.35

290' N

W. gutter pavmt.	4.01	288.50
"	3.56	288.95
☿ " + dirt	3.32	289.19
"	3.3	289.2
+14.5	3.7	288.8
E. cl. on lawn	3.2	289.3
300.5' N = { S. End, Fullwidth pavmt. S. line = 2 pas		
E. cl. line on lawn	3.2	289.3
+1.0 = S. End Existing 4" cl.	3.26	289.25
gutter pavmt. Low	3.77	288.74
"	3.54	288.97
☿ " to E. Low.	3.43	289.08

292.51

6th ST
69

☿ pavmt. to W. OK	3.38	289.13
"	3.49	289.02
W. gutter "	3.94	288.57
W. emt. cl.	3.48	289.03
5' N of S. line		
W. gutter pavmt. O.K.	3.81	288.70
"	3.36	289.15
☿ " O.K.	3.26	289.25
"	3.33	289.18
+14.0 = gutter pavmt O.K.	3.59	288.92
+14. = E. emt. cl. 4"	3.17	289.34
chk BM.	3.46	289.05 - 289.07

SW 6th ↓
2 pas.

80' w. d.
14' c.b.s
13' 1/4 s.

X Sec Landis St. Fairmont to 44th

4-8-37
Miller
Schnitzer
22 Berne
N.W. Landis
& Fairmont.
349.15

B.M. B.P.	5.34	354.49
00 = E. line Fairmont.		
N.	4.9	349.6
+1.67 = N. edge emt. walk	4.95	349.54
+7' = S " " "	5.02	349.47
+14 = emt. ch. & pavmt.	5.11	349.38
gutter, F.H. inlet 8" Pipe Culvert	5.90	348.59
+1/2 Top emt. Head wall to E. & pavmt.	5.05	349.44
1/4 Pavmt. & Dirt.	5.47	349.02
ϕ " " "	5.68	348.81
1/4 " " "	5.93	348.56
+11.9 Top emt. head wall to E. & Pavmt.	6.08	348.41
gutter - F.H. inlet 8" culvert.	6.99	347.50
S. emt. ch & pavmt.	6.07	348.42
+7 = N. edge emt. walk	5.85	348.64
+12:33 S " " "	5.87	348.62
S.	5.9	348.6
4.3 E = E. End Headwalls		
S. ch.	6.04	348.45
gutter - E. End apron catch basin	6.83	347.66
+1.1 = E. End. emt. Head wall	6.83	347.66
1/2 S. of N. ch. = E. End. " "	5.80	348.69
gutter E. end. emt. apron of catch basin	5.93	348.56
N. ch.	5.15	349.34

Reduced by AEB 1/9/51
Plotted by C.A.H. 1/10/51

15.58. walk on N. N. G.

70

HI = 354.49	
N+1.67 = N. edge walk to W.	4.79 349.70
N+1.67 = N " " to E	4.62 349.87
+7' = S " "	4.84 349.65
emt. ch.	5.05 349.44
gutter	5.7 348.8
1/4	5.5 349.0
ϕ	5.3 349.2
1/4	5.7 348.8
gutter	6.3 348.2
S emt. ch	5.89 348.60
Walk on S. OK.	
20' E.	
N+1.67 = N. edge walk to W.	4.47 350.02
N " " " " " E	4.53 349.96
N+7 = S " "	4.74 349.75
26' E	
N+1.67 = N. edge walk to W.	4.62 349.82
N+ " " " " " E	4.66 349.83
N+7' = S " "	4.80 349.69
N. emt. ch	4.84 349.65
44' E	
N+1.67 = N. edge walk	4.50 349.99
N+7' = S " "	4.66 349.83
50' E	
N+1.67 = N. edge walk to W	4.27 350.22
" " " = " " " E	4.13 350.36

50' E. con

HI 354.49

N. + 7' = S. edge. Walk to W.	4.44	350.05
" " " " " " " E.	4.60	349.89
N. cl.	4.62	349.82
gutter	5.4	349.1
" "	5.0	349.5
♀	5.0	349.5
" "	5.5	349.0
gutter	6.0	348.5
S. cl.	5.41	349.08

58' E.

N + 1.67 = N. edge walk	3.63	350.86
N + 7.0	4.08	350.41

64.8' E

N + 1.67 = N edge walk to W.	4.01	350.48
" " " " " " " E	4.28	350.24
N + 7' = S " " " W	4.44	350.05
" " " " " " " E	4.40	350.09

Walk to E. of 64.8' E. is O.K.

100' E.

S. cl.	4.77	349.72
gutter	5.6	348.9
" "	4.8	349.7
♀	4.4	350.1
" "	4.5	350.0
gutter	4.5	350.0
N. cl.	4.03	350.46

125' E. = W. line Alley

H.I. = 354.49

N. on N. End. emt. cl. Return + dirt	3.55	350.94
N emt. cl.	3.72	350.72
gutter	4.3	350.2
" "	4.0	350.5
♀	4.0	350.5
" "	4.4	350.1
gutter	5.1	350.4
S. emt. cl.	4.46	350.03
S. on S. end emt. cl. Return + dirt	4.20	350.29

145' E. = E. line Alley

S. dirt	4.0	350.5
+ 1.67 = S. End. emt. cl. Return	3.85	350.64
S. emt. cl. sunk	4.19	350.30
gutter	4.8	349.7
" "	4.2	350.3
♀	3.7	350.8
" "	3.8	350.7
gutter	4.0	350.1
N. emt. cl.	3.53	350.96
N = N. End. emt. cl. Return + dirt	3.24	351.25
155' E. Bad crack in S. cl.		
S. emt. cl.	4.00	350.49
170' E.		
S. emt. cl.	3.77	350.72
185' E.		
S. emt. cl.	3.64	350.95

200' E.
H1 354.49

N. cnt. db	2.86	351.63
gutter	3.5	351.0
"	3.2	351.3
⊥	3.1	351.4
"	3.5	351.0
gutter	4.1	350.4
s. cnt. db.	3.34	351.15

235' E.

s. cnt. db	2.83	351.66
gutter	3.6	350.9
"	3.0	351.5
⊥	2.6	351.9
"	2.8	351.7
gutter	3.3	351.2
N. cnt. db.	2.50	352.0

270' E. = W. line 44th st

N. cnt. db	2.10	352.4
gutter pavmt. & dirt	2.45	352.04
"	2.55	351.94
⊥	2.61	351.88
"	2.64	351.85
gutter	2.78	351.71
s. cnt. db	2.43	352.06

12' E. of W. line = W. db Line 44th st.
H1 = 354.49

s. line cnt. db	2.39	352.10
" " gutter pavmt.	2.98	351.51
s. db	2.93	351.56
"	2.88	351.61
⊥	2.84	351.65
"	2.67	351.82
N. db	2.55	351.94
N. line	2.45	351.84
" " cnt. db.	2.07	352.47

72

20' wide X Sec Alley BIK 10, City Hls Annex
Landis to Dwight bet Fairmont & 44th

H1 = 354.49

Page 7R.

4-8-31
Miller
Sommeringer
Osborne

Ⓢ

H1 = 354.79

73

14' N. of S. line S. curb line of Landis.		
W. emt. ch.	4.46	350.03
W. gutter	5.1	349.4
⊕	4.9	349.6
E. "	4.8	349.7
E. emt. ch. N.G. sunk	4.19	350.30
1.67' N. of S. line = S. edge emt. walk		
E. line + 0.15 = S. End. ch. Return	3.85	350.84
⊕	4.2	350.3
⊕ + 9.90 = W. emt. ch. Return	4.24	350.25
00 = S. line Landis St.		
W. + 0.10 = S. End. emt. ch. Return	4.20	350.29
⊕	4.0	350.5
E	4.0	350.5
10's + garages.		
N. End. line of sheds on E. 0.2 in Alley. at N. End		✓
15's		
E	4.1	350.4
⊕	3.9	350.6
W.	4.1	350.4
55' S. garage on E. Board. floor 0.40 in Alley ✓		
W	4.8	349.7
⊕	4.8	349.7
+ 9.6	4.5	350.0

Reduced by AEB 4/9-31
 Plotted by CBH 4-10-31

60's garage on W. dirt floor	2.3 Back	
W. - 2.3 floor	4.8	349.7
100's. Shed on E. 1.0 in Alley ✓		
E + 1.0	5.6	348.9
⊕	5.7	348.8
W.	5.8	348.7
130's. garage on W. floor 3.2 Back ✓		
W. - 3.2 floor	6.20	348.29
W. = E. End. emt. apron N.G.	6.0	348.5
⊕	5.7	348.8
+ 8.8 Fence	5.7	348.8
144's. garage on E. dirt floor 3.0 Back ✓		
E. - 3.0	6.3	348.2
E	6.3	348.2
⊕	6.3	348.2
W.	6.5	348.0
167's. garage on W. emt. floor 3.0 Back ✓		
W - 3.0 floor	6.60	347.89
W	6.6	347.9
⊕	6.6	347.9
E	6.6	347.9
206's. garage on E. dirt floor 3.3 Back ✓		
E - 3.3 floor	6.8	347.7
E	6.9	347.6
⊕	7.1	347.4
W	7.1	347.4

H.I. = 35449			
W-13. floor	218' S. garage on W. dirt floor	13' Back ✓	
	7.4	347.1	✓
250' S.			
W.	7.9	346.6	
☉	7.8	346.7	
E	7.8	346.2	
259' S. garage on E. Board floor 3' Back ✓			
E-3. floor	7.0	347.5	✓
E	7.5	347.0	
☉	8.0	346.5	
W.	7.8	346.7	
281' S. garage on W. dirt floor 1'0 Back ✓			
W-1. floor	8.0	346.5	✓
300' S.			
W.	8.0	346.5	
☉	8.3	346.2	
E	8.0	346.5	
T.P.	2.87	349.96	7.40 347.09 347.09
332' S. garage on W. dirt floor 5.4 Back			
E	3.9	346.1	
☉	4.1	345.9	
W	4.2	345.8	
W+5.4 floor	4.2	345.8	
383' S garage on W. dirt floor 5.4 Back ✓			
W-5.4 floor	4.4	345.6	✓
W	4.5	345.5	
☉	4.5	345.5	
E	4.3	345.7	

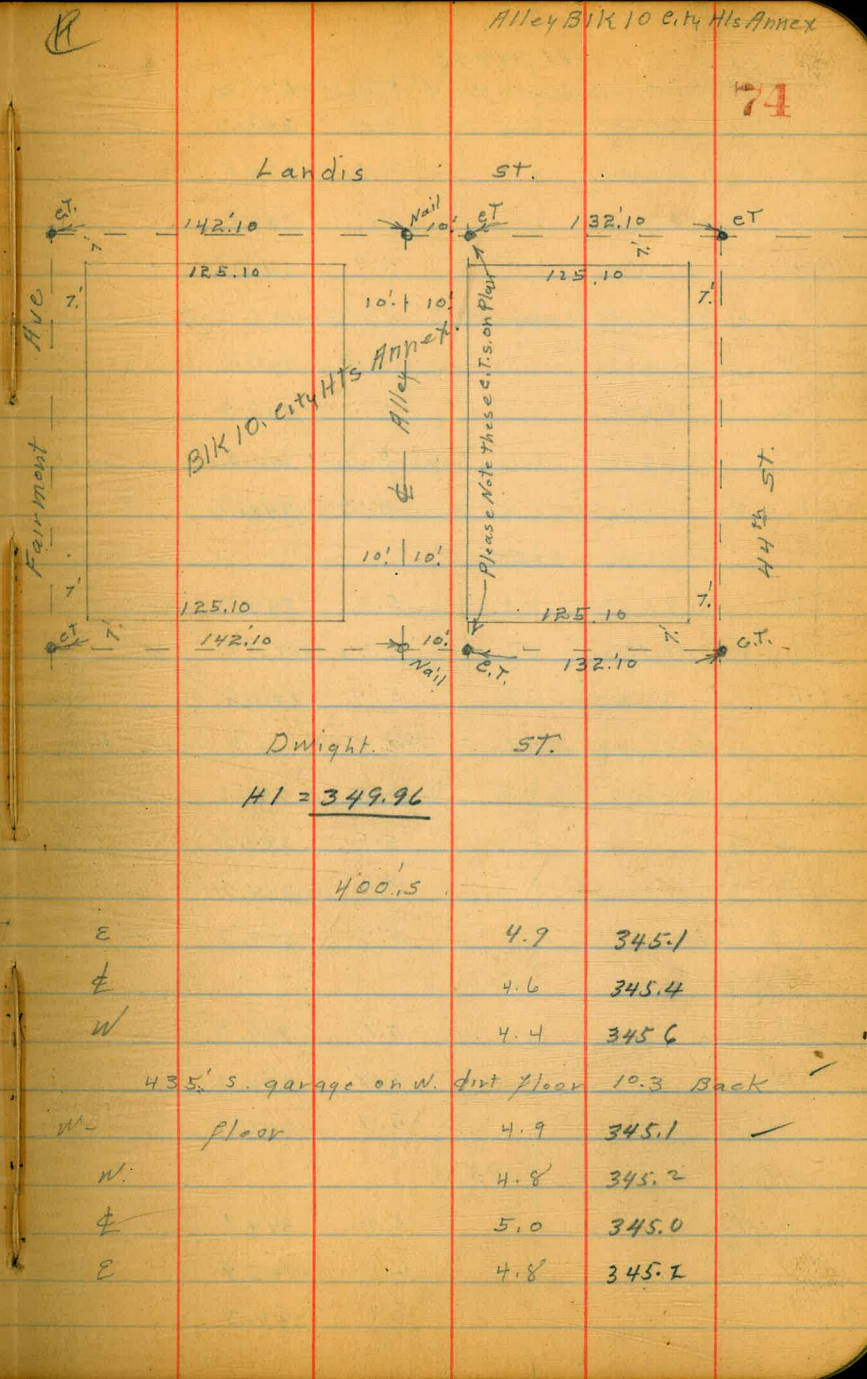

E	4.9	345.1
☉	4.6	345.4
W	4.4	345.6
435' S. garage on W. dirt floor 10.3 Back ✓		
W	4.9	345.1
W.	4.8	345.2
☉	5.0	345.0
E	4.8	345.2

H1 349.96

460' S. garage on W. dirt floor 11' Back ✓

E	5.0	345.0	
φ	5.2	344.8	
W	5.1	344.9	
+ 11. floor	4.9	345.1	✓

4 93' S. garage on E. dirt floor 2.5 Back ✓

W	5.4	344.6	
φ	5.3	344.7	
E	5.2	344.8	
E + 2.5	5.3	344.7	✓

500' S.

E	5.3	344.7	
φ on M.H.	5.3 ✓	344.58	✓
W	5.4	344.6	

518' S. garage on E. dirt floor 2.8 Back ✓

W	5.5	344.5	
φ	5.5	344.5	
E	5.3	344.7	
+ 2.8 floor	5.3	344.7	✓

550' S

E	5.7	344.3	
φ	5.8	344.2	
W	5.7	344.3	

575' S

W	5.9	344.1	
φ	6.1	343.9	
E	5.7	344.3	

H1 = 349.96 ^{598' S.}

E	6.3	343.3	
+ 5	7.0	343.0	
φ	7.4	342.6	
W	6.9	343.1	

600' S. = N. Line Dwight.

W. on N. End, cont. db. Return + dirt	7.26	342.90	
φ	7.4	342.6	
E. on N. end cont. db. Return + dirt	7.31	342.65	

14' S. of N. line = N. db. line

E. cont. db.	7.44	342.52	
E. gutter	8.1	341.9	
φ "	8.1	341.9	
W. "	8.2	341.8	
W. cont. db.	7.48	342.48.	
T.P.	2.36	346.74	5.58 344.38

80' wide
14' cbs.
13' 1/4 s.

Dwight St. X Sec
Fairmont to 44th St.

H1 = 346.74

Page 75

00 = E. line Fairmont.

N. cmt. cl. + parmt	5.05	341.69
gutter F.L. 8" pipe culvert	5.99	340.75
+ 1.1 = Top wing wall to E parmt	5.10	341.64
+ 6 parmt + dirt	5.50	341.24
1/4 " " " "	5.53	341.21
⊕ " " "	5.80	340.94
1/4 " " " "	6.20	340.54
+ 8. " " " "	6.46	340.28
+ 11.9 Top wing wall to E parmt	6.27	340.47
gutter F.L. 8" pipe culvert	7.11	339.63
S. cmt. cl.	6.33	340.41
4.8 E. = E. End catch Basins		
S. cmt. cl.	6.28	340.46
gutter - E. End apron	7.03	339.71
+ 1.1 " " wing wall	7.00	339.74
+ 2. " " " "	6.5	340.2
1/4 " " " "	6.2	340.5
⊕ " " " "	5.9	340.8
1/4 " " " "	5.4	341.3
+ 11 " " " "	5.4	341.3
+ 11.9 E. End wing wall	5.60	341.14
gutter " " apron	5.71	341.03
N. cmt. cl.	5.05	341.69

Plotted & BH
Reduced 0.68

4-8-31
Miller

Ⓟ

H1 = 346.74 25' E.

76

N. cmt. cl.	4.91	341.83
gutter	5.9	340.9
1/4 " " " "	5.5	341.2
⊕ " " " "	5.5	341.2
1/4 " " " "	6.1	340.6
gutter	6.7	340.0
S. cmt. cl.	6.11	340.63
75' E.		
S. cmt. cl.	5.66	341.08
gutter	6.3	340.4
1/4 " " " "	5.7	341.0
⊕ " " " "	5.2	341.5
1/4 " " " "	5.2	341.5
gutter	5.4	341.3
N. cmt. cl.	4.62	342.12
125' E = W. line Alley		
N. line = N. End cmt. cl. Returns	4.06	342.68 + dirt
N. cmt. cl.	4.28	342.46
gutter	5.0	341.7
1/4 " " " "	4.8	341.9
⊕ " " " "	4.7	342.0
1/4 " " " "	5.1	341.6
gutter	5.9	340.8
S. cmt. cl.	5.15	341.59
S. Line = S. End cmt. cl. Returns	4.92	341.82 + dirt

H1 = 346.74

145'.2 = E. Line #110.4

S. Line = S. end. cmt. el. Return	4.65	342.08	+ dirt
S. cmt. el.	4.95	341.99	
gutter	5.5	341.2	
"4	5.0	341.7	
⊕	4.5	342.2	
"4	4.6	342.1	
gutter	4.9	341.8	
N. cmt. el.	4.23	342.51	
N. Line = N. End cmt. el. Return	4.10	342.64	
148'.5 E. Busted el. ows.			
S. cmt. el to W	5.01	341.23	
S. " " " E	5.06	341.68	
195'.E.			
N. cmt. el.	4.14	342.60	
gutter	4.7	342.0	
"4	4.2	342.5	
⊕	4.1	342.6	
"4	4.5	342.2	
gutter	5.2	341.5	
S. cmt. el.	4.60	342.14	
245'.E.			
S. cmt. el.	4.17	342.57	
gutter	4.9	341.8	
"4	4.1	342.6	
⊕	3.8	342.9	
"4	4.0	342.7	

H1 = 346.74

gutter	4.4	342.3	
N. cmt. el.	3.85	342.89	
270'.E. = W. line 44 th st.			
N. cmt. el.	3.66	343.08	
gutter pavmt. + dirt	3.95	342.79	
"4 " " "	4.04	342.70	
⊕ " " "	4.14	342.60	
"4 " " "	4.07	342.67	
gutter " " "	4.07	342.67	
S. cmt. el.	3.90	342.84	
12'.E. = W. el line 44 th st.			
S. line cmt. el.	3.87	342.87	
S. " gutter pavmt.	4.46	342.28	
S. el " "	4.42	342.32	
"4 " "	4.42	342.32	
⊕ " "	4.33	342.41	
"4 " "	4.19	342.55	
N. el " "	4.16	342.58	
N. line " "	4.15	342.59	
" " cmt. el.	3.56	343.18	
T.P.B.P.	10.09	350.98	
chk original B.M.	1.83	349.15	

 W. Dwight
 & Fairmont
 340.89

3-5-32 ϕ Levels Alley from El Cajon to S.L. Meade
 Miller Bet 42nd & Copeland
 Walker Bilk W Wilshire Pl
 Bliss.

B.M. B.P.	4.60	369.74		365.14	
✓ 0+00 = N. line El Cajon		4.33		363.41	Neud. pavmt.
✓ 0+20 North		5.1		64.6	
✓ 0+50		4.9		64.8	
✓ 1+00		5.2		64.5	
T.P.	4.57	369.39 ^v	4.92	364.82 ^v	
✓ 1+05		4.9		364.5	
7.5' W. of (1+05) = W. line Alley		5.2		364.2	
25' W. of sta. 1+05		5.1		364.3	
50' W. of sta. 1+05		4.9		364.5	
75' W. " " sta. 1+05		4.8		364.6	
100' W. " " " 1+05		4.7		364.7	
T.P.	4.43	369.25	4.57	364.82	
✓ 1+40 ϕ Alley		4.9		364.4	
7.5' W. of sta 1+40 = W. line Alley		4.9		364.4	
25' " " " " "		4.9		364.4	
50' " " " " "		4.9		364.4	
75' " " " " "		5.0		364.3	
90' " " " " "		4.7		364.6	
✓ 2+00		4.8		364.5	
✓ 2+50		4.7		364.6	
✓ 3+00		5.4		364.9	
✓ 3+20		5.0		364.3	
✓ 3+50		5.4		363.9	
✓ 3+75		5.1		364.2	
✓ 4+00		5.2		364.1	

Indexed
 circ. K.

369.25

78

S.W. Marlboroughs	✓ 4+25	5.0	364.3	
+ El Cajon.	✓ 4+50	5.1	364.2	
	✓ 4+75	5.2	364.1	
	✓ 5+00	5.1	364.2	
	✓ 5+50	5.1	364.2	
	✓ 6+00	4.5	364.8	
	4+09 = S. line Meade	5.00	364.25	edge Pavmt.
	S. ch. line of Meade.	5.32	363.93	on "
	T.P.	3.86	368.96	4.15 365.10
	ch. original B.M.	3.82	365.14	✓

 21.53
 21.63
 14.62

DIRECTIONS FOR USE OF TABLES

TABLE No. 1.

Distance of slope stake from side or shoulder stake for any width roadway, slope 1 1/2 to 1. If ground is nearly level, the cut or fill at side stake is located by the double entry method in left column and top row. The number in body

of table in same row and column gives distance from side stake to slope stake. If ground is not the side stake and slope stake, lower table by this amount if cut, or higher if fill. Add this amount to cut or fill and find distance in table. Set up rod at this point and line of sight should cut target.

IMPROVED TABLES AND INFORMATION

TABLE No. 2.

The distance from a point on the tangent to the curve is very nearly the square of the tangent length divided by twice the radius. Degree of curve with a given L may be found by dividing tangent (or external) opposite L by given tangent (or external). To find Tangent and External for curve of any other degree, divide by degree of curve and add correction found in column of corrections.

494
50

66
59
14
0

87
72
15
43
29

8.75
48.25
43
109.08
73
36.24

232
77 3 | 23.7
7.9

3 | 23
7.6

123.4
7.8
15.6
122.8
7.6

22.5
7.5 3 | 22.7
7.4

3 | 22
7.4

391 07
2.77

398 .30

255.48
5.44
260.90

501 30
77
204.30

255.48
1.83
257.31
255.44
5.44
5.8

251.93
5.37
257.30
251.93
8.91
200.84

267.02
0.46
267.68

287.07
3.87
292.94
5.50
287.44
3.57
291.01

19.6
7.5
27.1
9
36.1

ENGINEERING DEPARTMENT,
SAN DIEGO,
CITY OF
CALIFORNIA.

7.00
433
1.67

25.5
19
42.5
59
77
79
23
56
3

4.6
188.56
301.30
695.66

645.40
301.30
144.10