

- 1417 -

NAME ROSEVILLE

Class _____ Course _____ Party _____

Topo.

525

ENGINEERING DEPARTMENT,
CITY OF SAN DIEGO,
CALIFORNIA.

FIELD NOTES

No. 403P

ESPECIALLY ADAPTED

TO THE USE OF

ENGINEERING STUDENTS

EUGENE DIETZGEN Co.

MANUFACTURERS

DRAWING MATERIALS

MATHEMATICAL AND SURVEYING INSTRUMENTS

MEASURING TAPES

CHICAGO SAN FRANCISCO NEW YORK
NEW ORLEANS PITTSBURGH

MICROFILMED

DEC 23 1964

INDEX

Page

Topog -	"HUGO" - - - -	1 - 5
Topog -	"INGELON" - - - -	6 - 8
Topog -	"JARVIS" - - - -	9 - 10 - 11
Topog -	"KEATS" - - - -	12 - 13 - 14
LOWELL - -	Topog - - - -	15 - 16 - 17 - 18
Macaulay -	Topog - - - -	19 - 20 - 21 - 22
NEWELL -	" - - - -	23 - 24

"HUGO"

579

Mar. 1 - 1929

{ O.S. Thompson
Anderson
de la Vaux

3+00 Assumed

0+00 Assumed

3+70

"PLUM"

57.70'

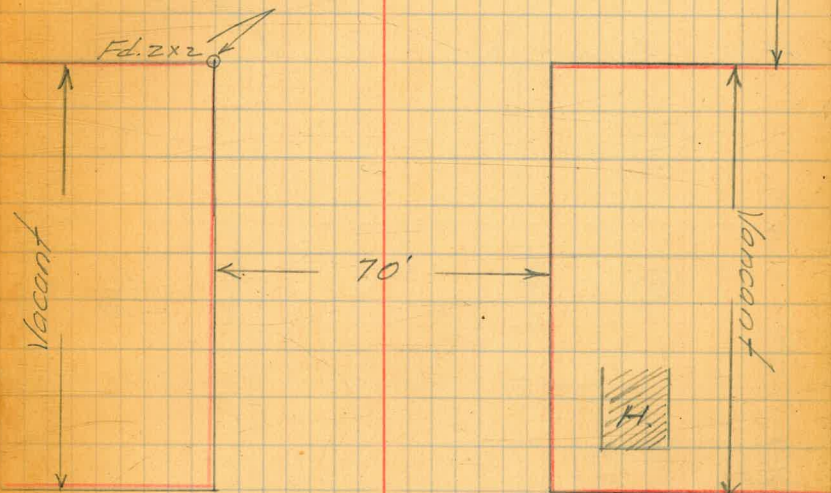

"CLOVE"

{ Graded to base
57.70'

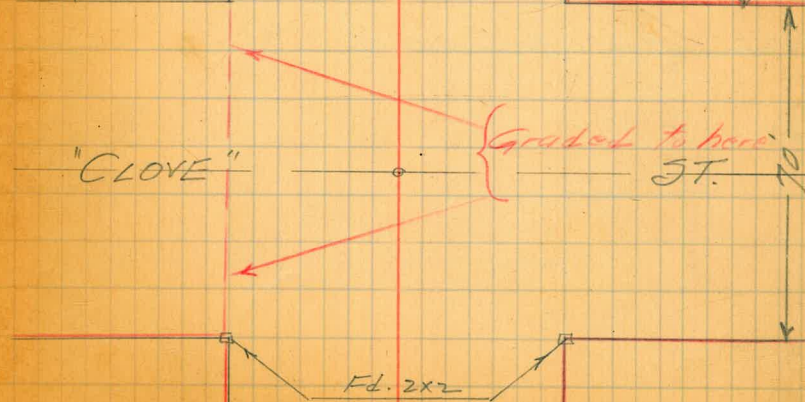

"HUGO"

Sta.

- Note -
 { 30° Gutter - Unless
 otherwise noted

6+70 Assumed

5+20 End Improvement

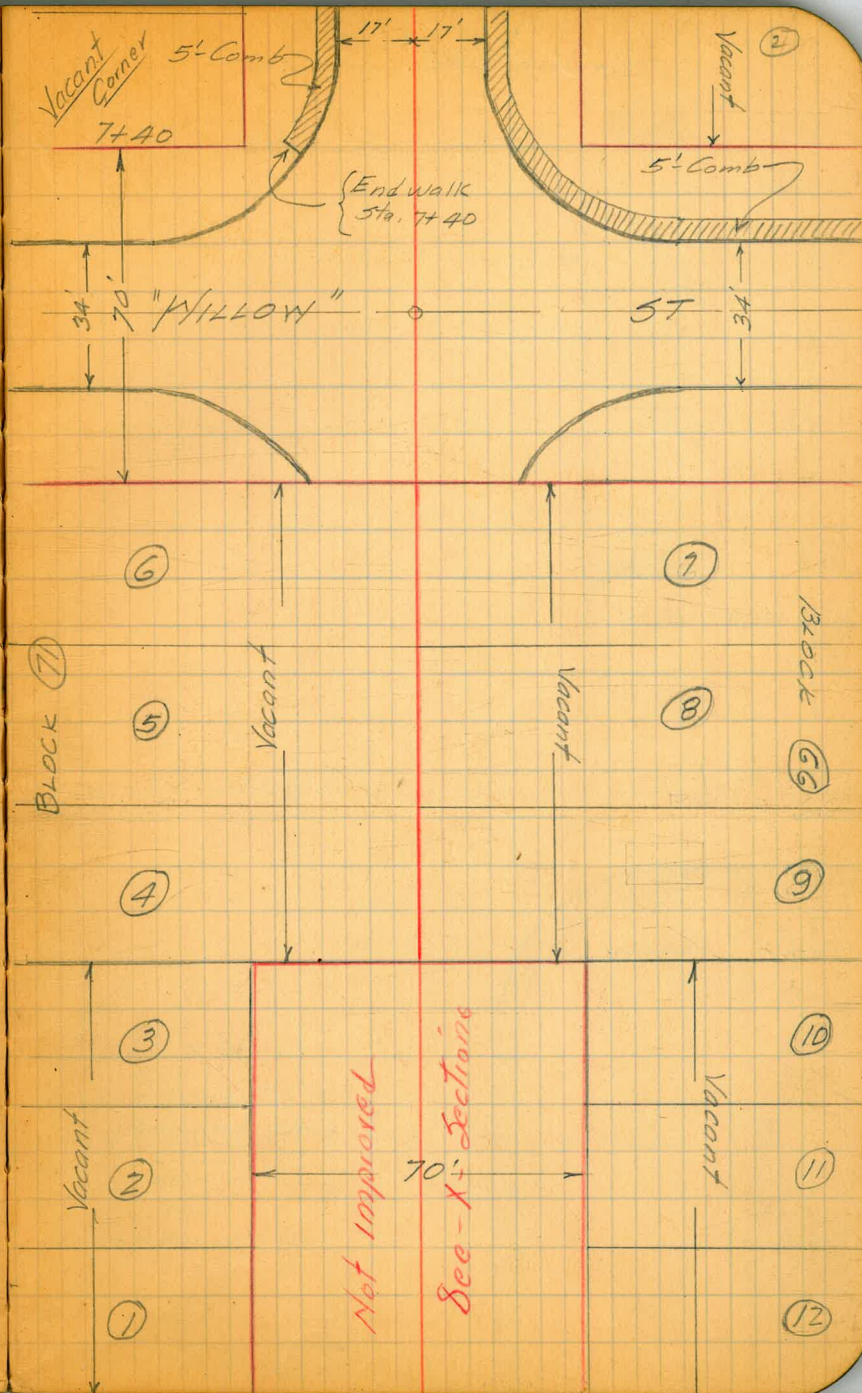

"HUGO"

Water Meters Gas

5th.

11+10 Assumed.

10+40 Assumed.

- Note -

{ 30° Gutters unless
otherwise noted.

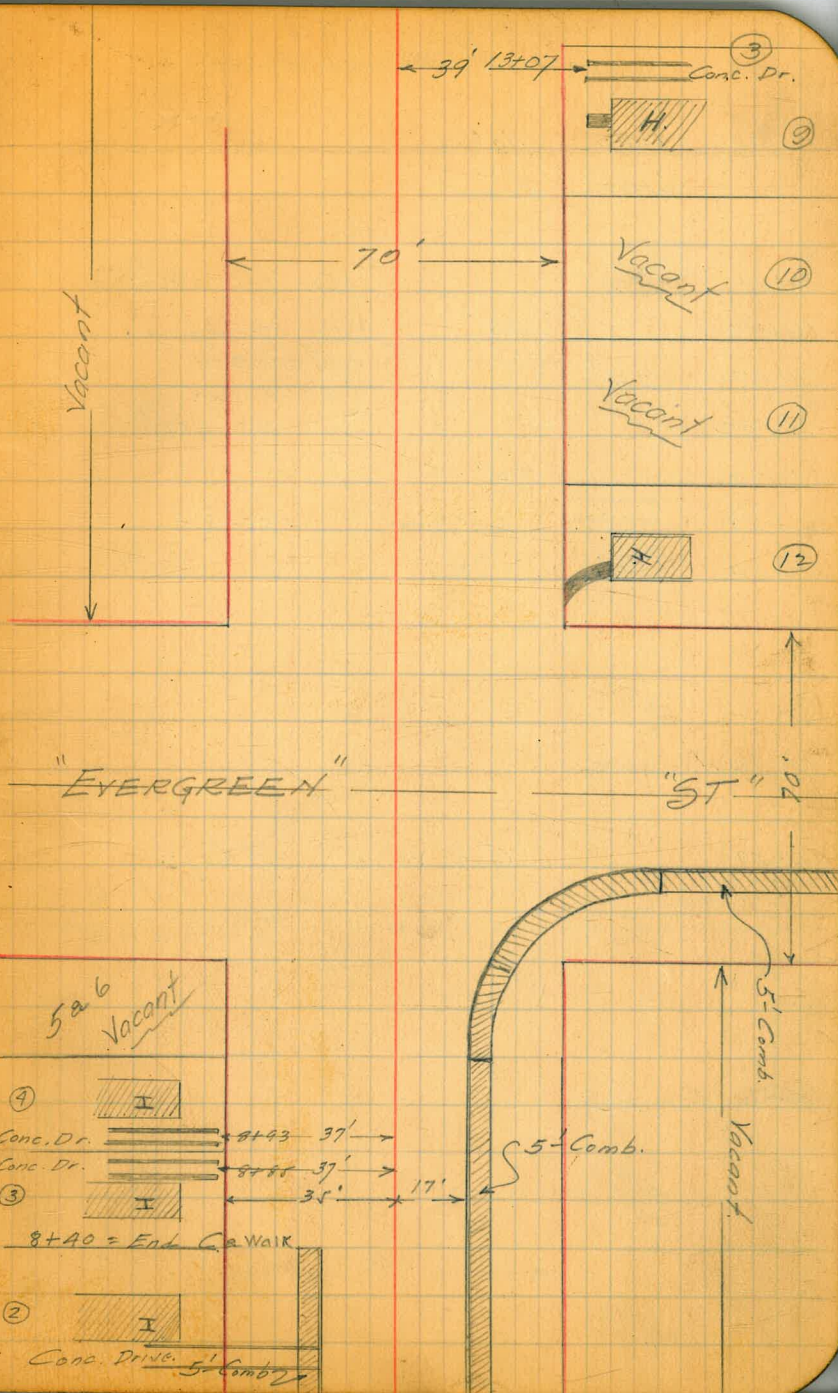

"HUGO"

Sta.	Water	Meters	Gas
	Left	Right	
16+65	32'		Mar. 1st. 1929
16+50		24'	{ O.V. Thompson Anderson
16+07	24'		
16+02			do la Vaux
15+60		24'	25' Left.
15+58			25' Lt.
15+54	26'		

14+80 Assumed

14+59 Gate Valve - 35' Left

14+10 Assumed

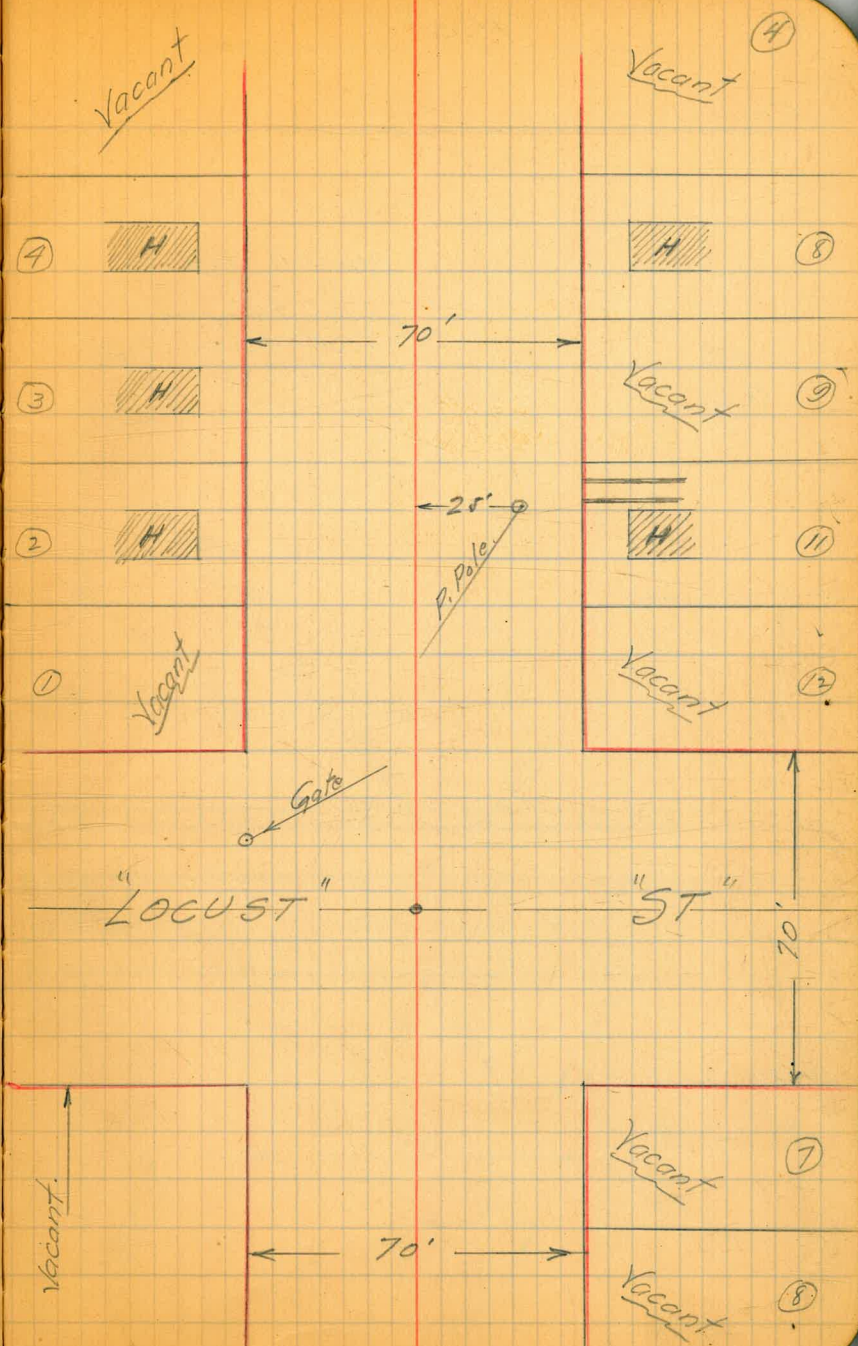

"Hugo"

Sta.

Mar. 1st 1929

{ O.S. Thompson
Anderson
de la Yaux

18+80 Assumed

17+80 Assumed

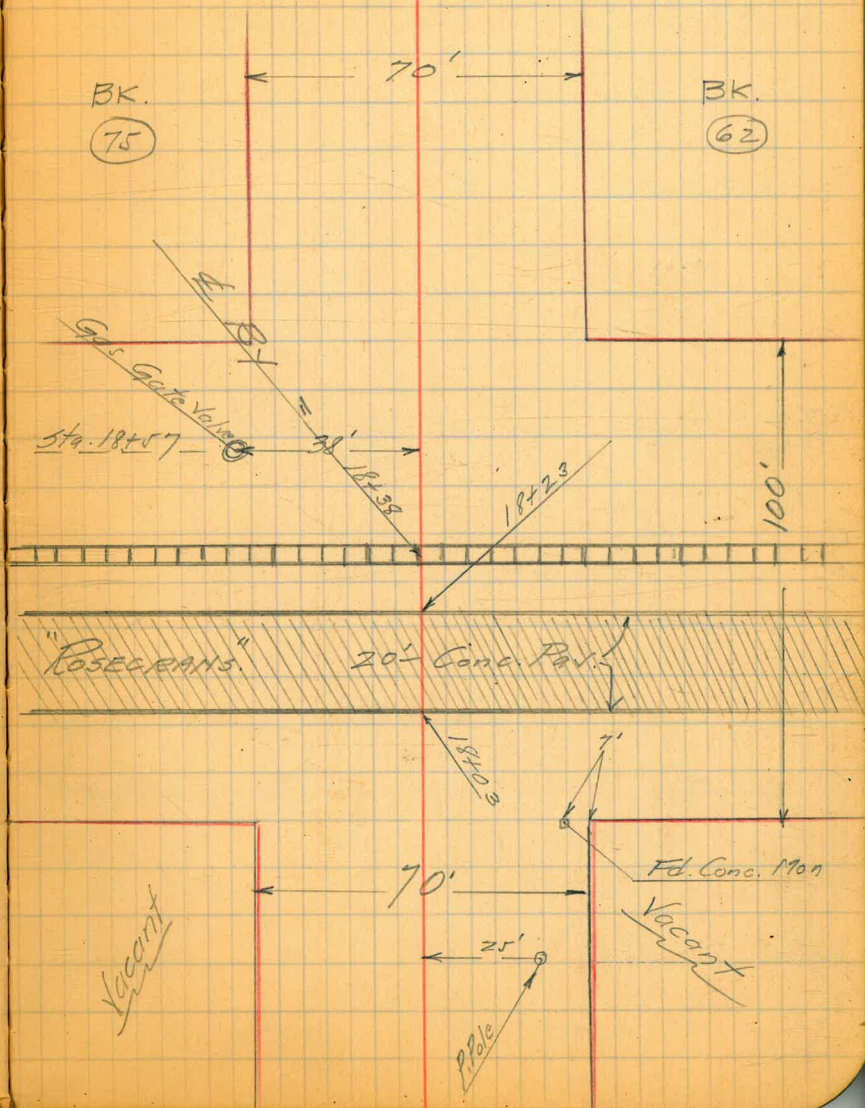

"INGELW"

Sta.	Water.	Meters	Gas.
	Left.	Right.	

4+40 22'

3+70 Assumed

Mar. 1st. 1929

{ C. Thompson
Anderson
de la Vaux

[No Meter for this house]
on Lot 10

0+70 Assumed

0+00 Assumed

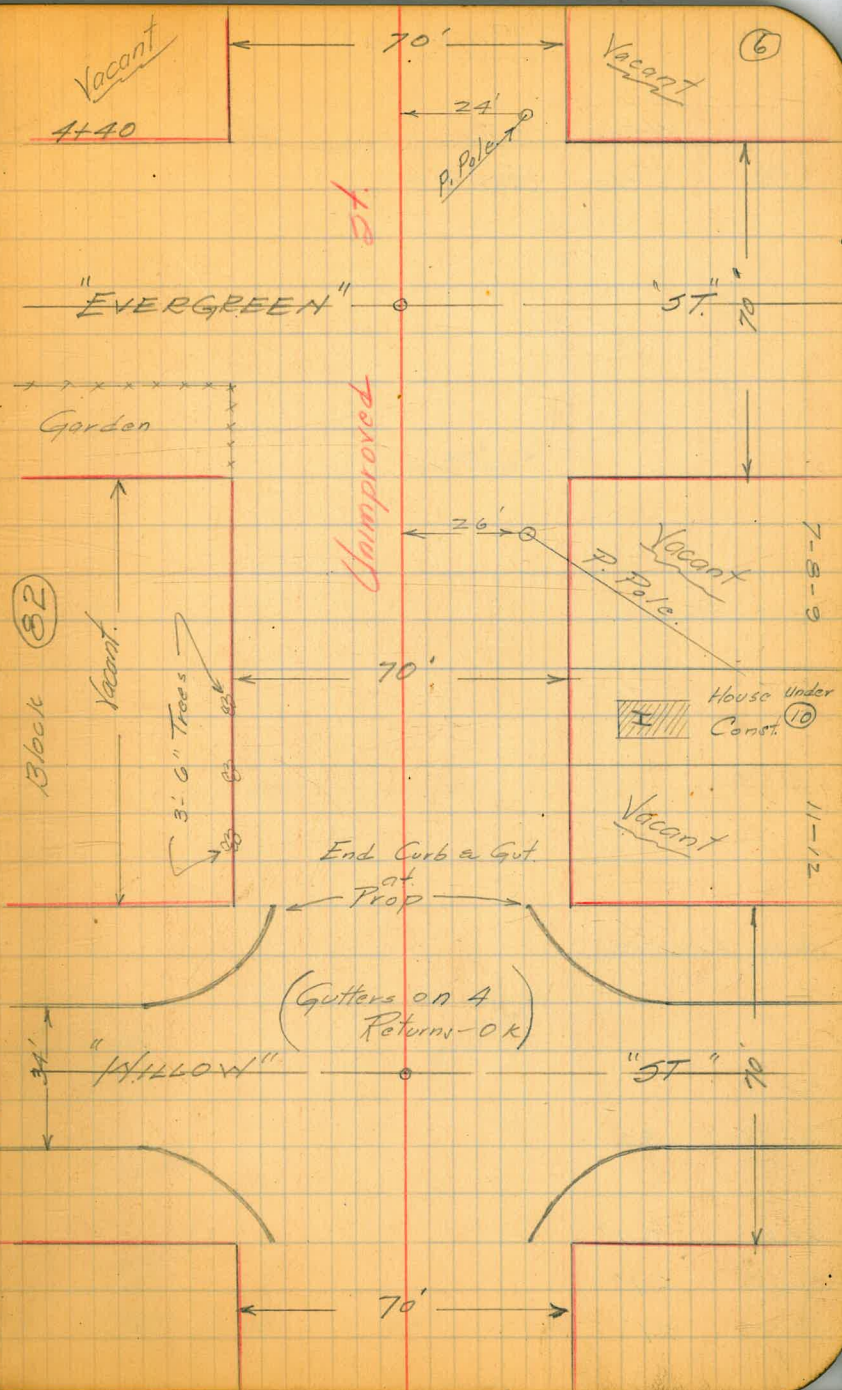

"INGELOW"

	Water Meters	Gas.
Sta.	Left	Right

8+10 Assumed

7+40 Assumed

6+65 30'

6+19 24'

5+64 24'

5+10 24'

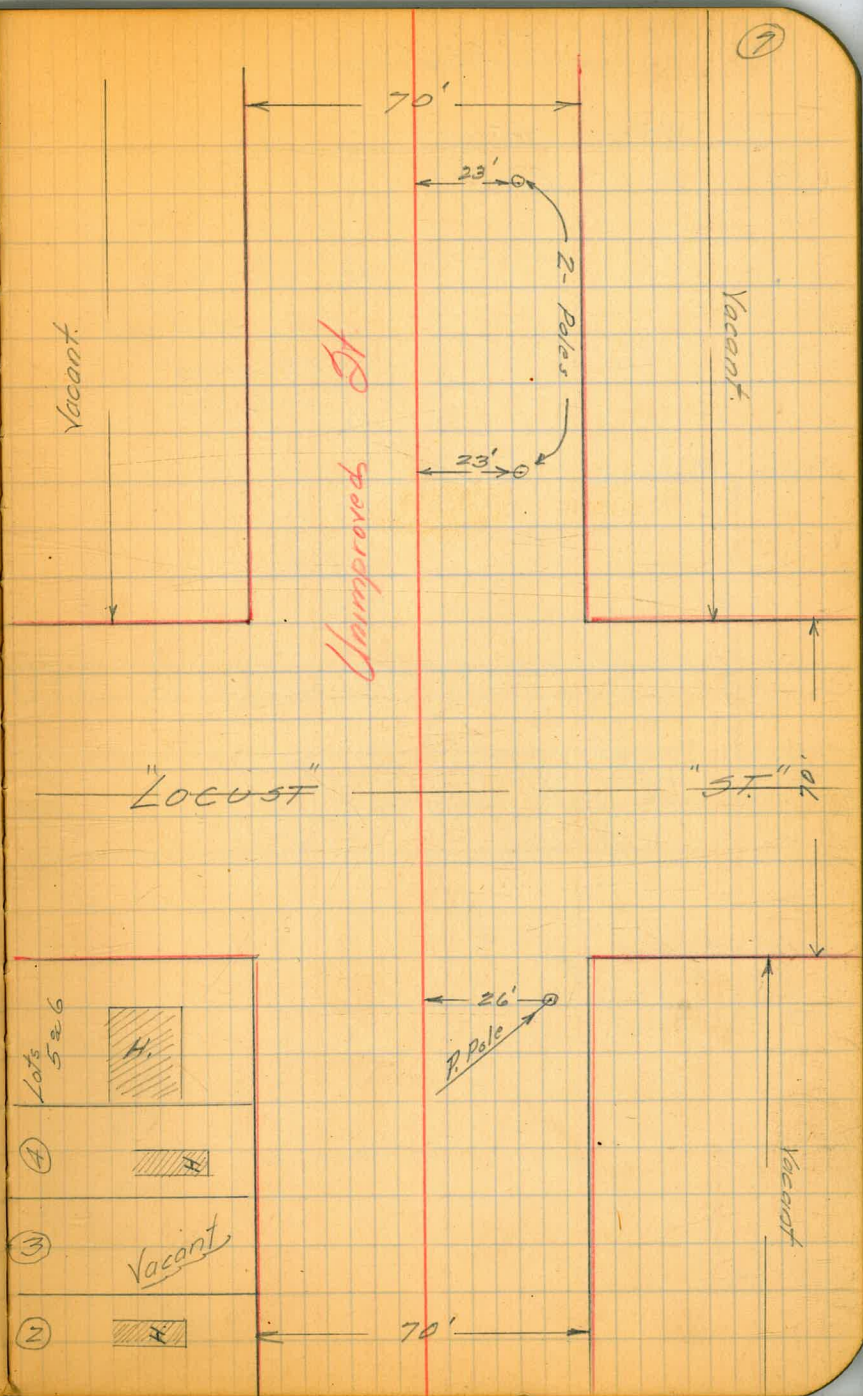

"INGELOW"

8

Sta.	Water	Meters	Gas.
	Left.	Right	

Mar. 1st 1929

{ O.L. Thompson
Anderson
de la Vaux

12+10 Assumed

11+10 Assumed

[No Meter here]

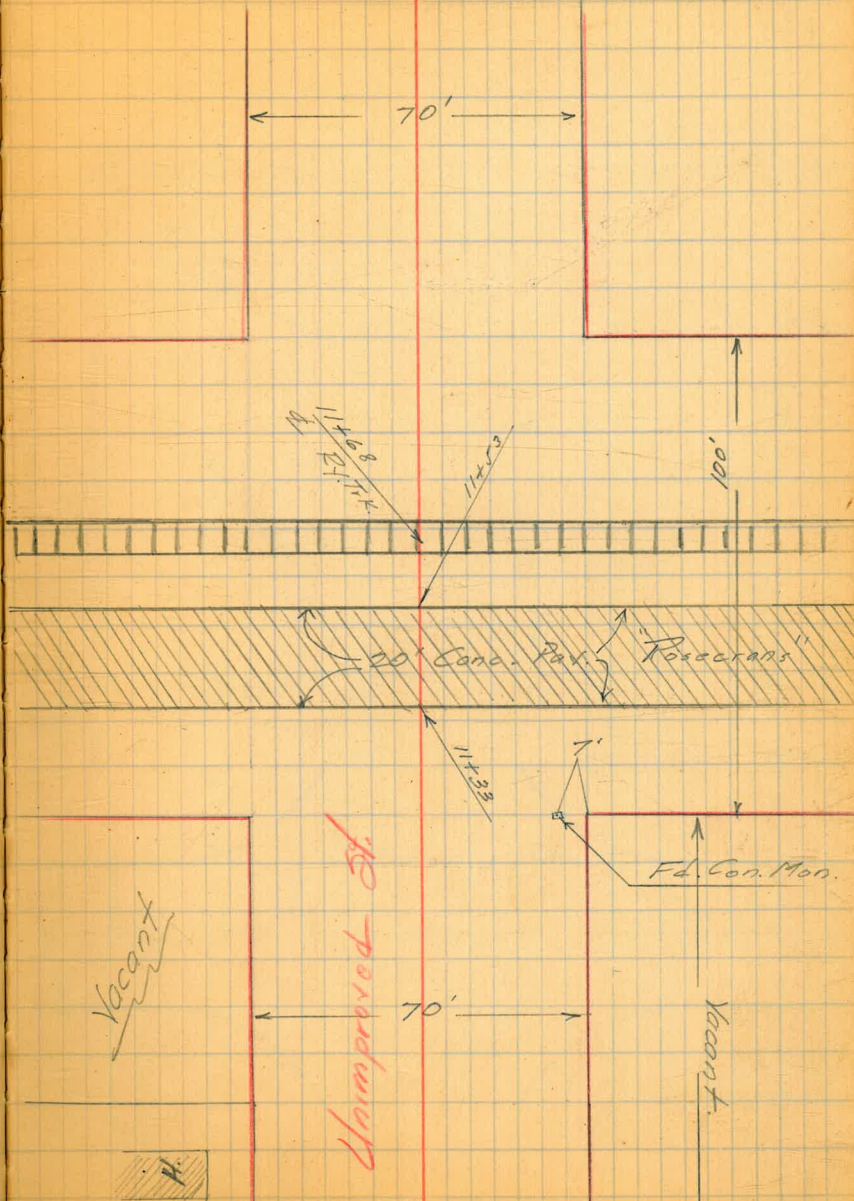

"JARVIS"

579

Mar - 4 - 29

{ O.S. Thompson
Anderson
4 to Vaux

3+70 Assumed

0+70 Assumed

0+00 Assumed

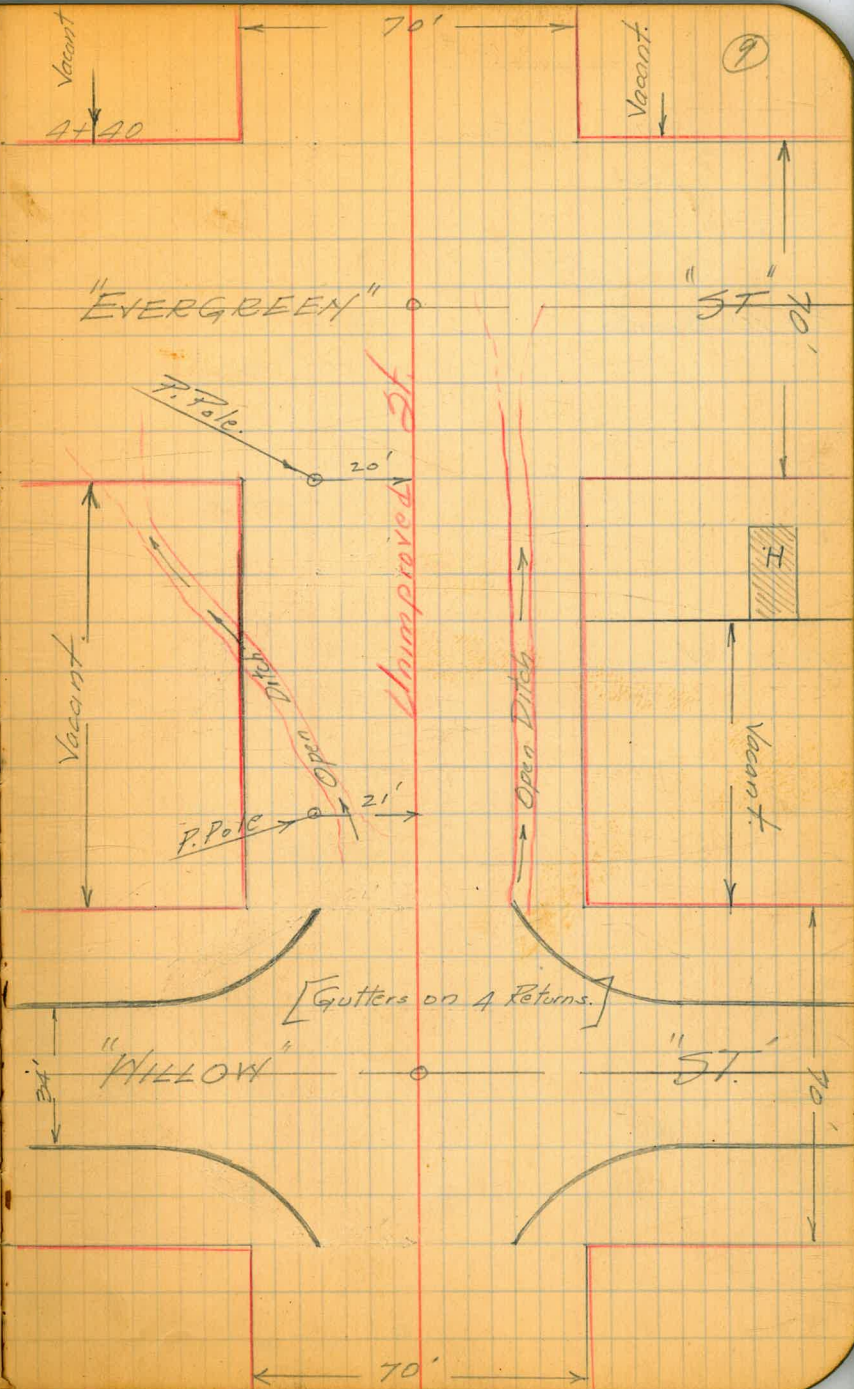

"JARVIS"

Water Meters

Sta. Left
8+53 25'

8+10 Assumed

7+40 Assumed

②



①

Vacant

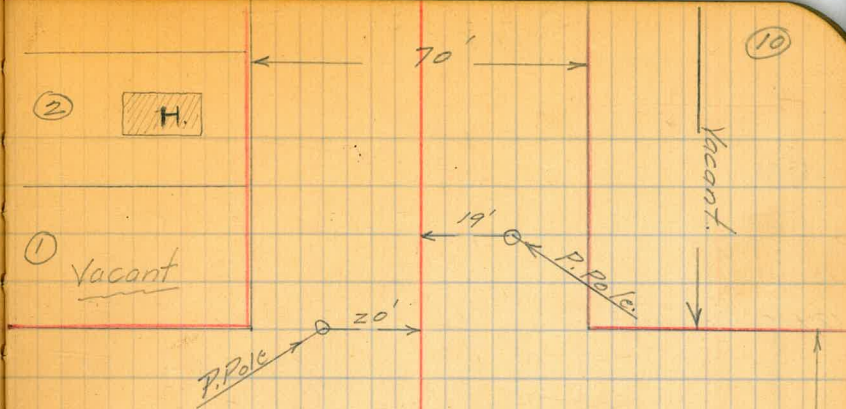

"Locust"

"ST"

70'

Vacant.



Claim proved 25'

70'

"JARVIS"

(11)

Sta.

12+10 Assumed

Mar. 4 - 1929

{ O.S. Thompson
Anderson
de la Vaux

11+10 Assumed

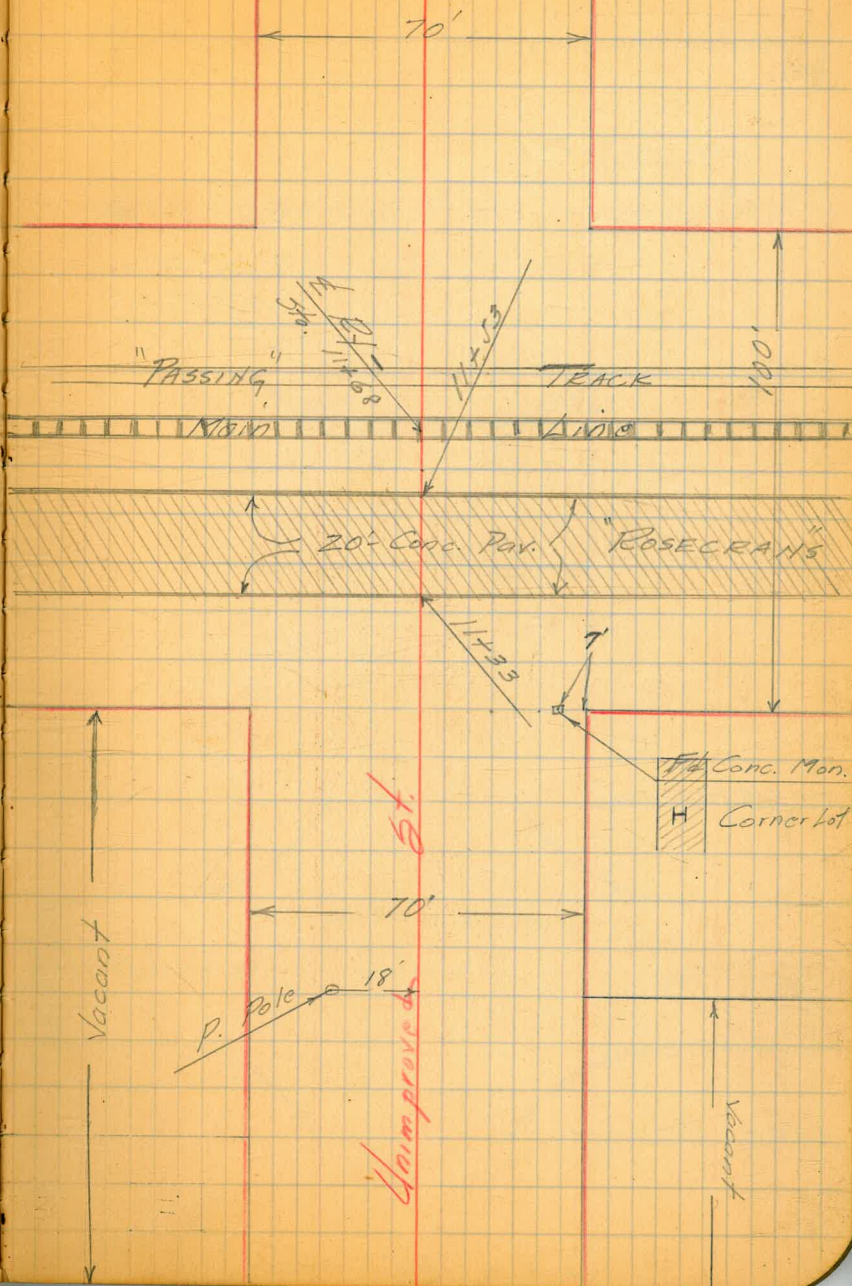

"KEATS"

5th

Mar. 4 1929

{ O.J. Thompson
Anderson
do to Vaux

3+70 Assumed

- Note -

{ No Poles on
this Street

0+70 Assumed

0+00 Assumed

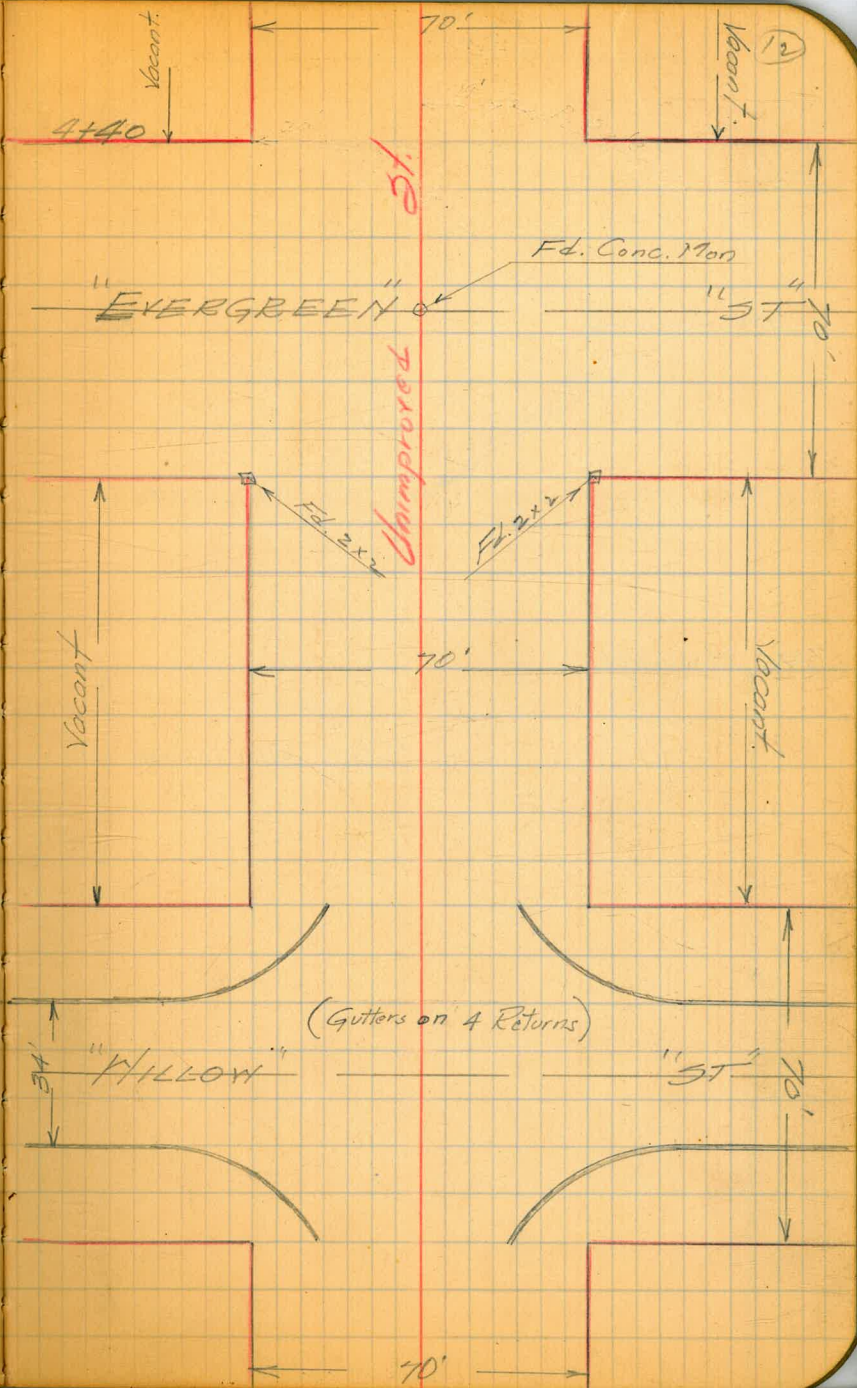

"KEATS"

Sta.

8+10 Assumed

7+40 Assumed

- Note -
① No Poles on this St.

Vacant.

70'

13

Vacant.

"Locust"

Fd. Conc. Mon.

"ST"

70'

Vacant.

Unimproved St

Vacant.

70'

"KEATS"

Sto.

Mar. 4-1929
{ C.W. Thompson
Anderson
de la Vaux

11+10 Assumed

- Note -
No Poles on this St.

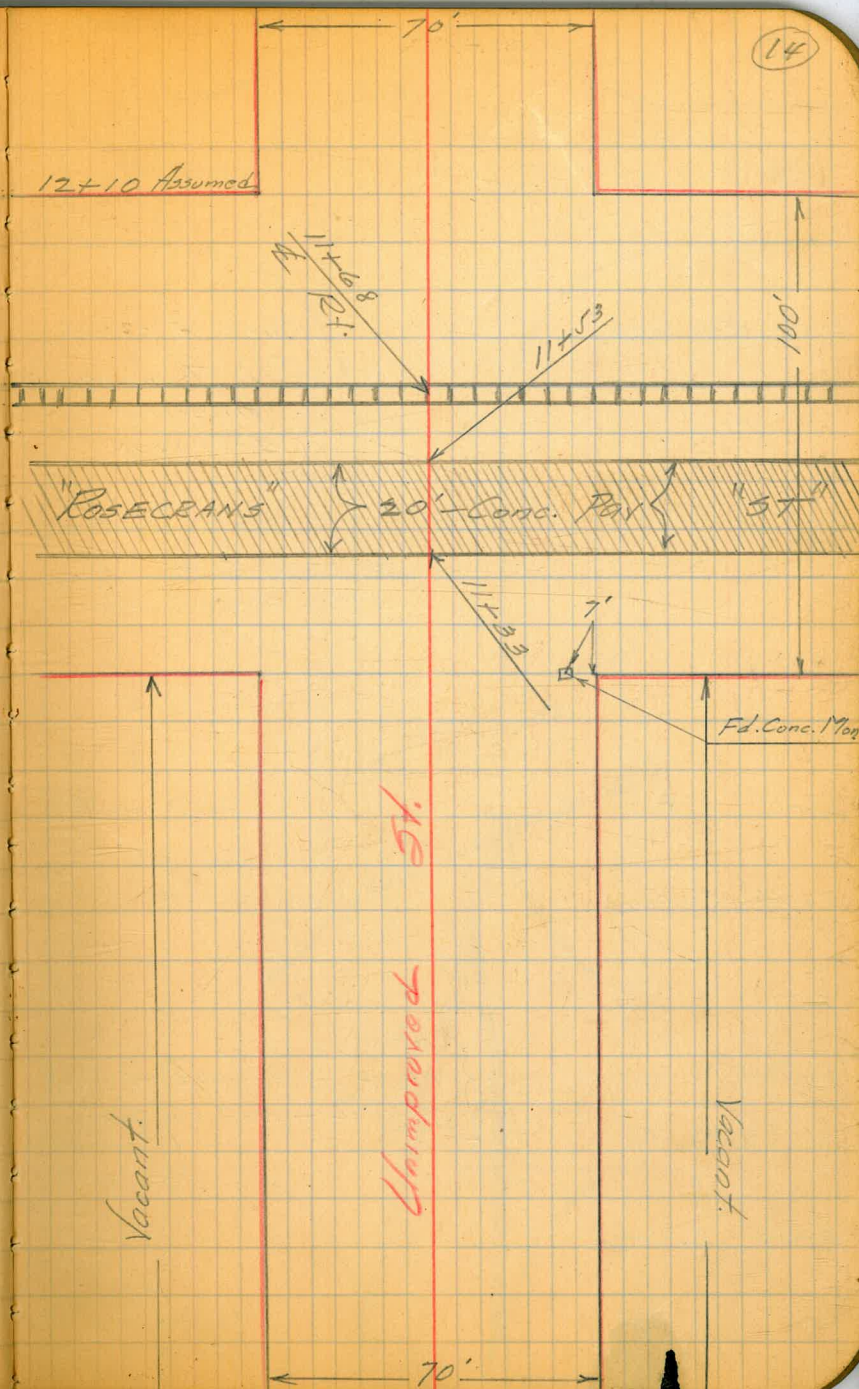

"LOWELL"

	Water Meters	Gas.
Sta.	Left.	Right.

3+70 Assumed

Mar - 5 - 1929

C. S. Thompson
Anderson
de la Vaux

- Note -

{ 30" Conc. Gutters
Unless otherwise noted

1+00 18"

0+70 Assumed

- Note -

{ 12" Conc. Pipe
Might be located as
sketched - Not certain

0+00 Assumed

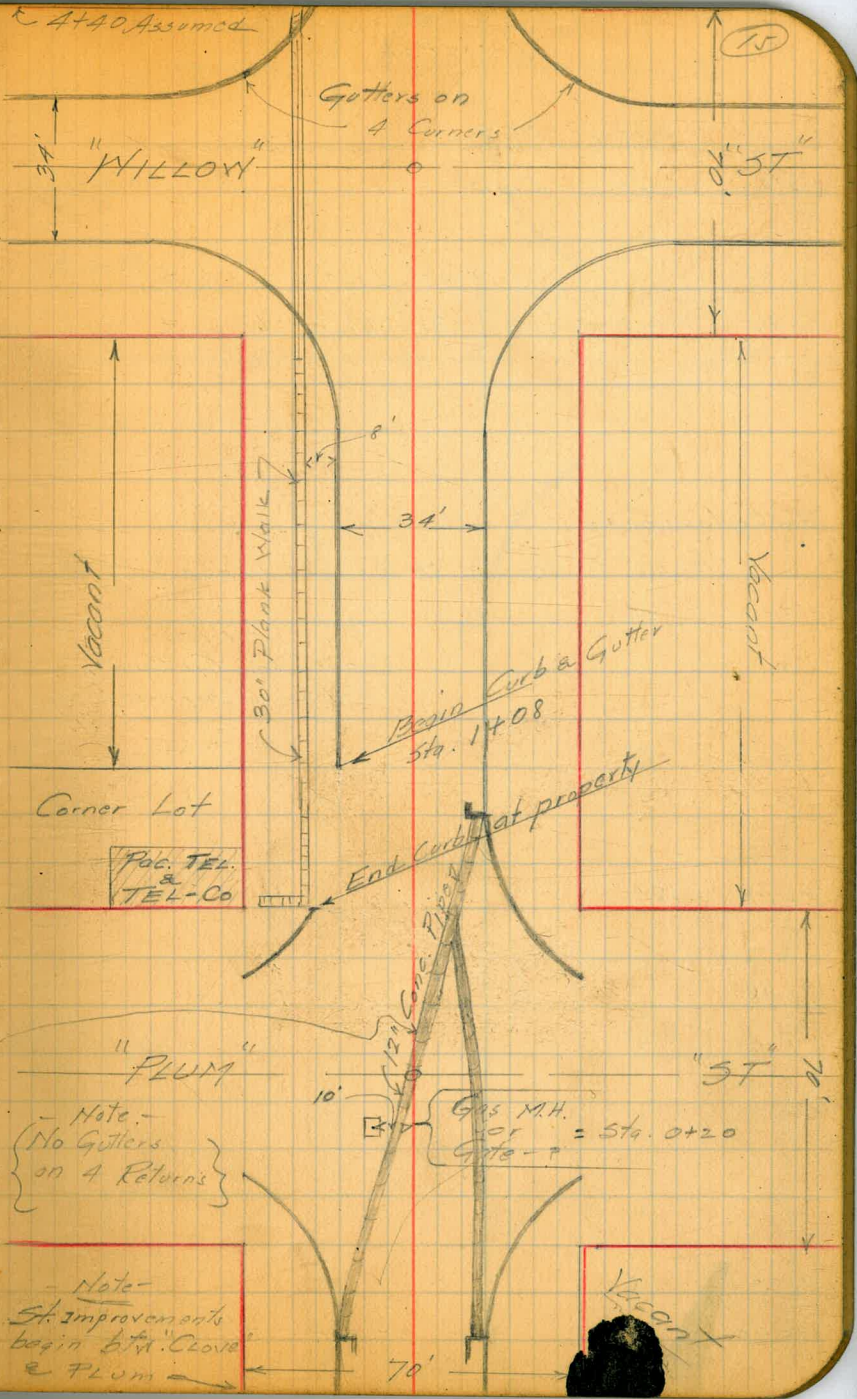

"LOWELL"

Sta.	Water Meters		Gas.
	Left.	Right.	
7+85			{ 35'-Left = 6" Gate. 35'-Right = 6" Gate.
7+85			

7+20 Assumed

Unable to locate Meter for house (Lot #6.)

- Note -
{ 30" Conc. Gutters
Unless Otherwise Noted

5+99 18'

5+77 18'

5+48 18'

4+83 18'

4+40

25' Rt. - 2 1/2" F.H.H.

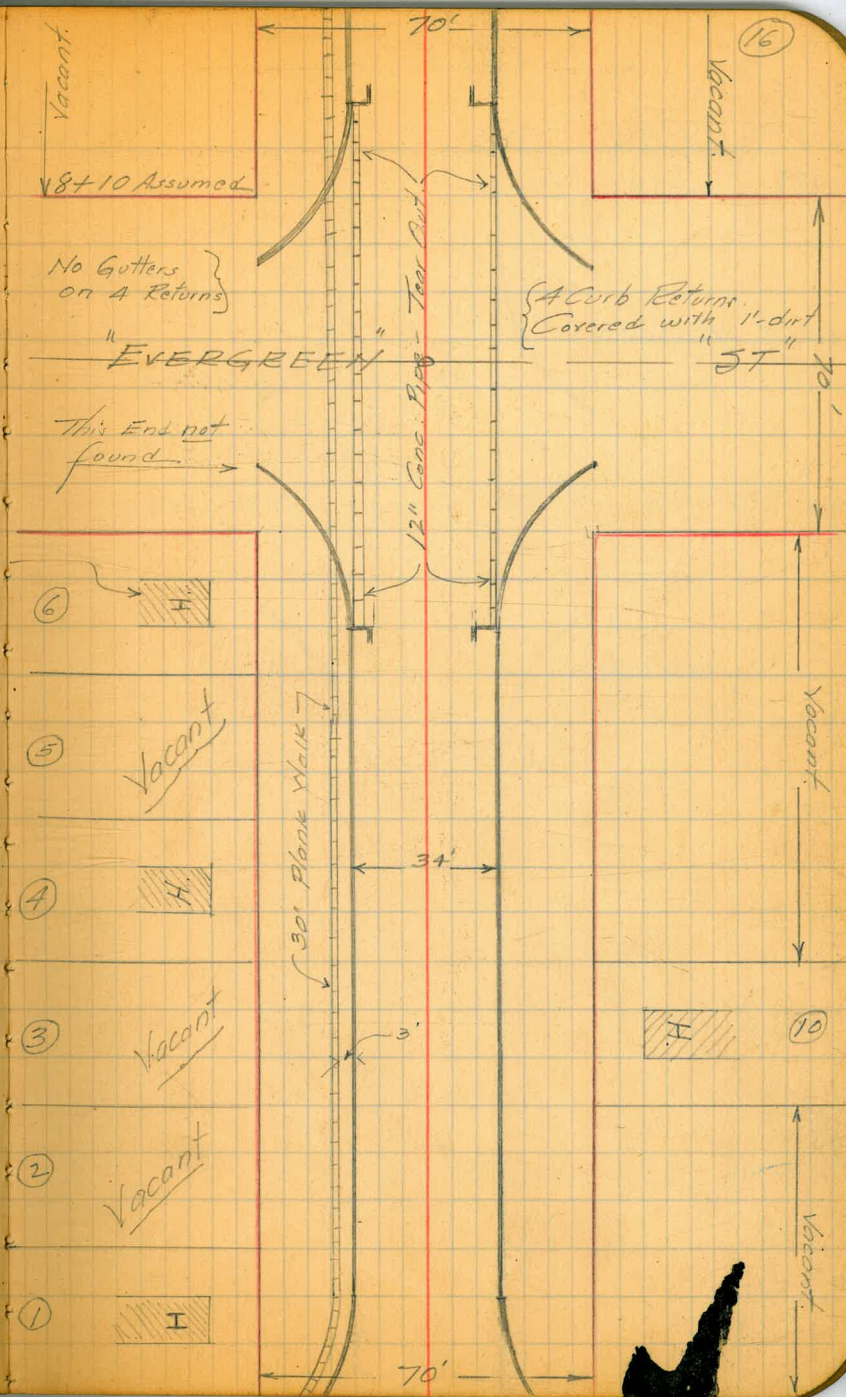

"LOWELL"

	Water Meters	G.W.
Ho.	Left	Right

11480 Assumed

- Note -

{ 30" Conc. Gutter
Unless otherwise noted

11410 Assumed

② Vacant

① H

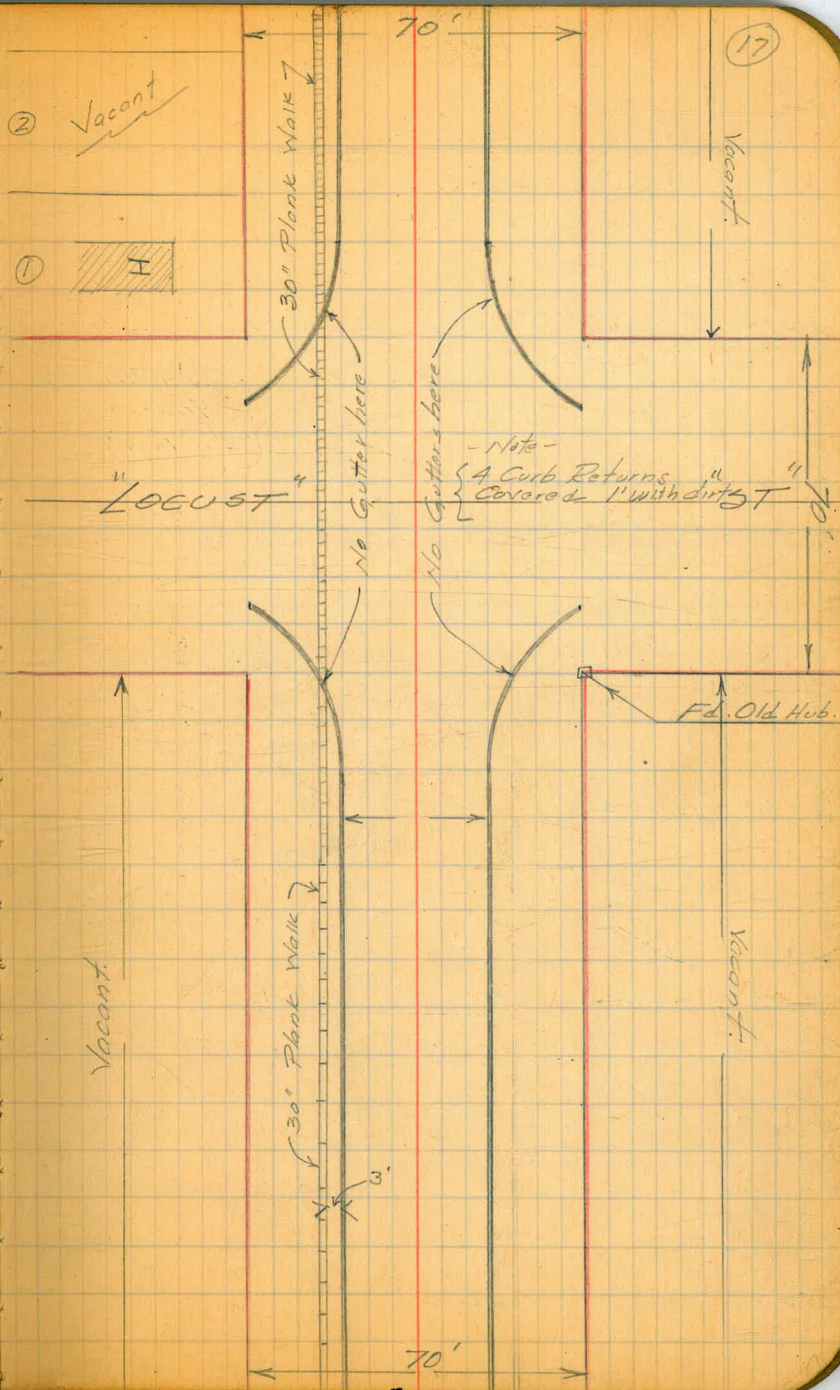

"LOWELL"

(18)

	Water	Meters	
Sta.	Left	Right	Gas

15780 Assumed

14778 18'

Mar. 4 - 1929

{ O.J. Thompson
Anderson
de la Vaux

- Note -

{ 30" Conc. Gutter
Unless Otherwise Noted

14780 Assumed

12788 18'

12783

P

12715 18'

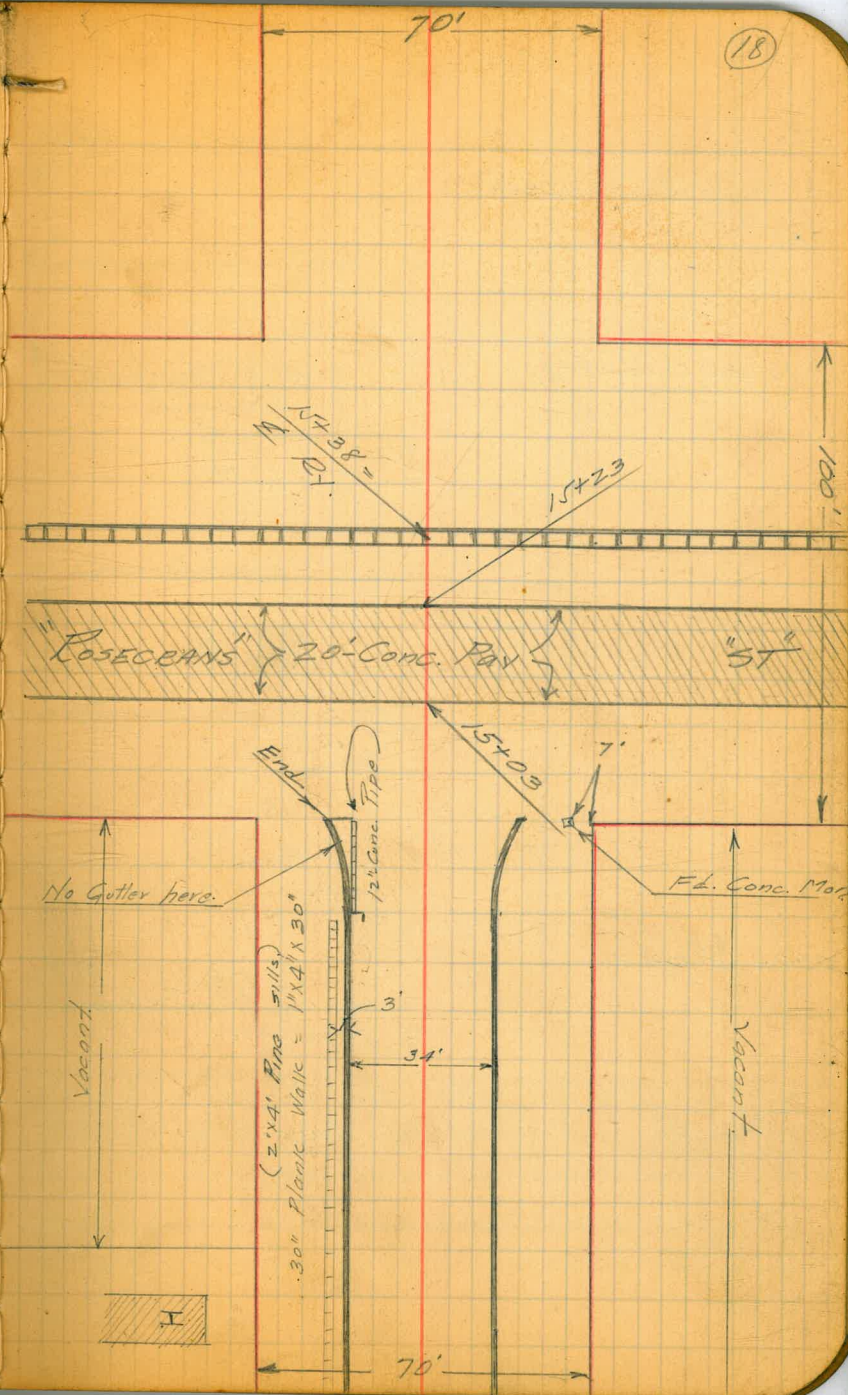

"MACAULAY"

Sta.

2+44.20 = Curb Line

Mar. 5 1929

O. S. Thompson
Anderson
de la Vaux

1+30+ = East Line of Alley

= Note -

- ① E of Macaulay is assumed as 25' distance from H. Prop. Line as found.
- ② Fence is 50' southerly of Prop. Line.
- ③ See Record Maps of Subdivision -

0+00 Assumed

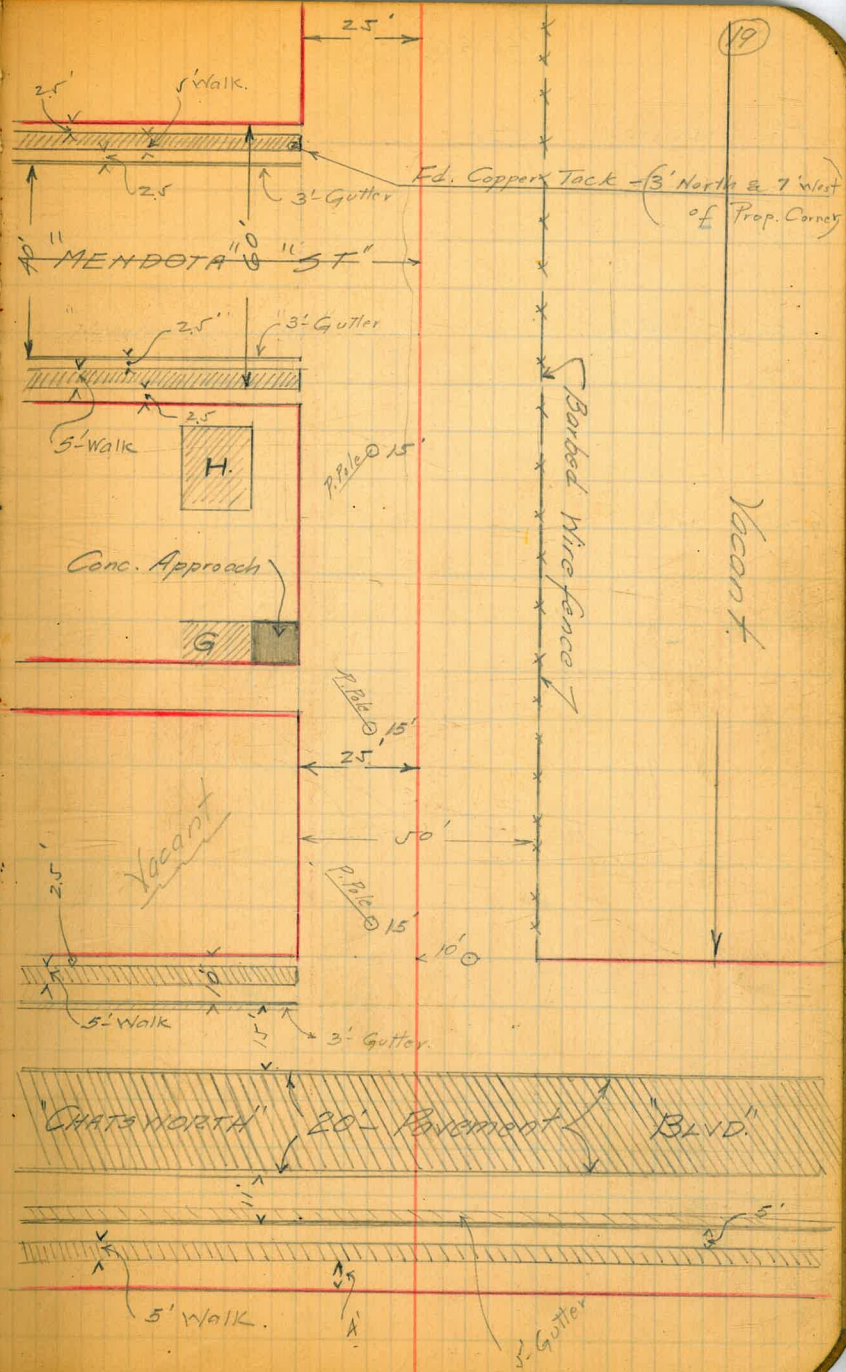

(19)

Vacant

"MACAULAY"

Sta.	Water	Meters
7+92	Left	Right
	15'	

6+99.65 - Alley Line

6+50 13'

5+29.63 - Curb Line

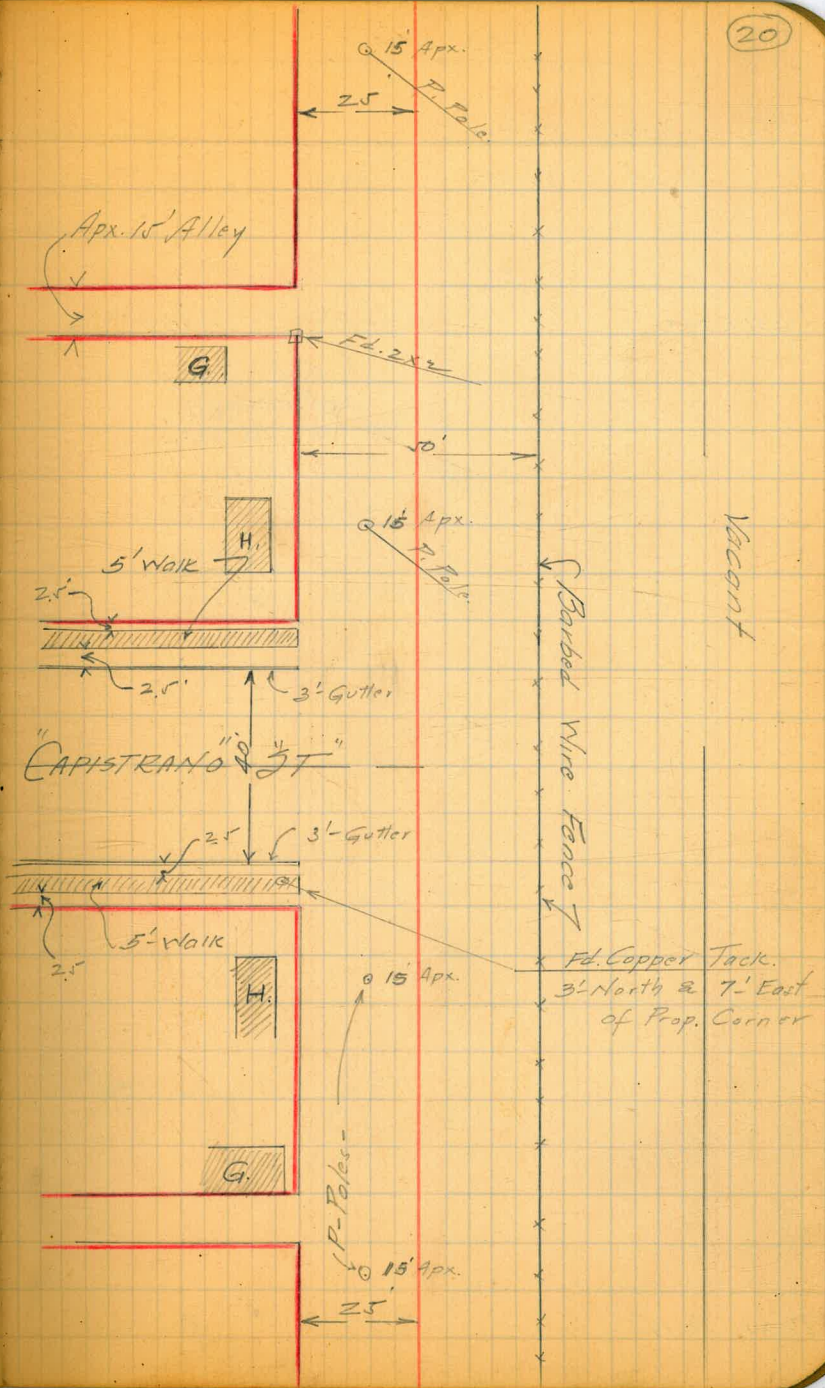

"MACAULAY"

Sta.	Water	Meters
	Left	Right

~~11+49.50±~~ P

Mar. 5 - 1929
 { O.S. Thompson
 Anderson
 de la Vaux.

8+31 14'

Some Grading

"CLOVE" ST.

has been done
 on Clove.

11+49.50± = Fence Line

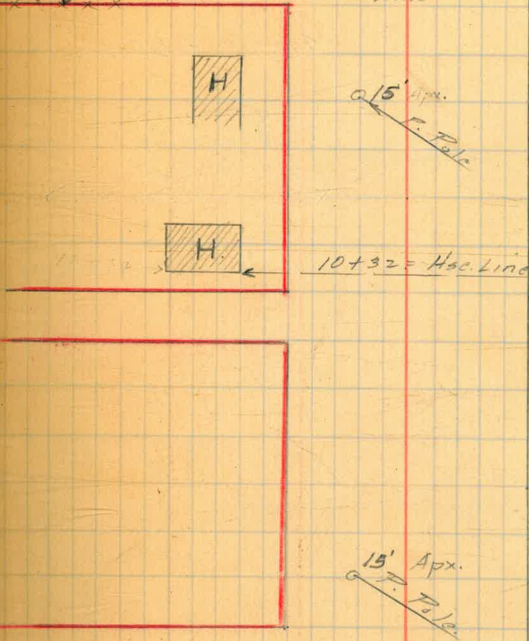

Vacant

"JUSTIN" ST.

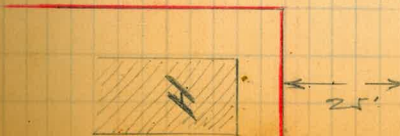

V

MACAULAY

Sta.

15458.27 = Prop. Line

Mar. 5 - 1929

Ol. Thompson
Anderson
de la Vaux

22

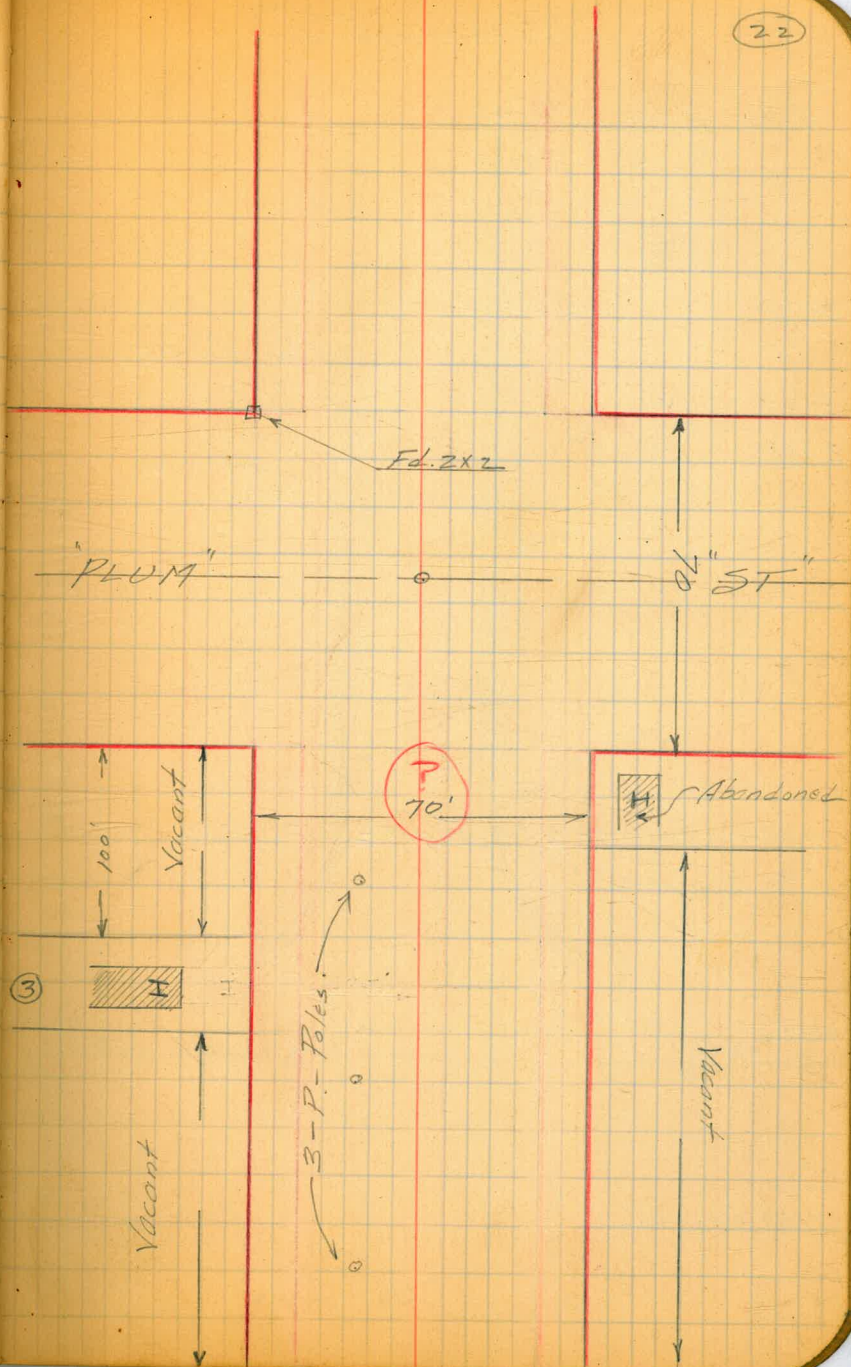

"NEWELL ST"

Sta.	Water	Meters.
	Left	Right

3470		26'
3429	18'	
2488	18'	
2454		18'
2446	18'	

Mar. 5 - 1929
 { O. Thompson
 Anderson
 de la Vaux

0495 → 25' Right = F. Hyd.
 0470 Assumed

0418 35'

0400 Assumed

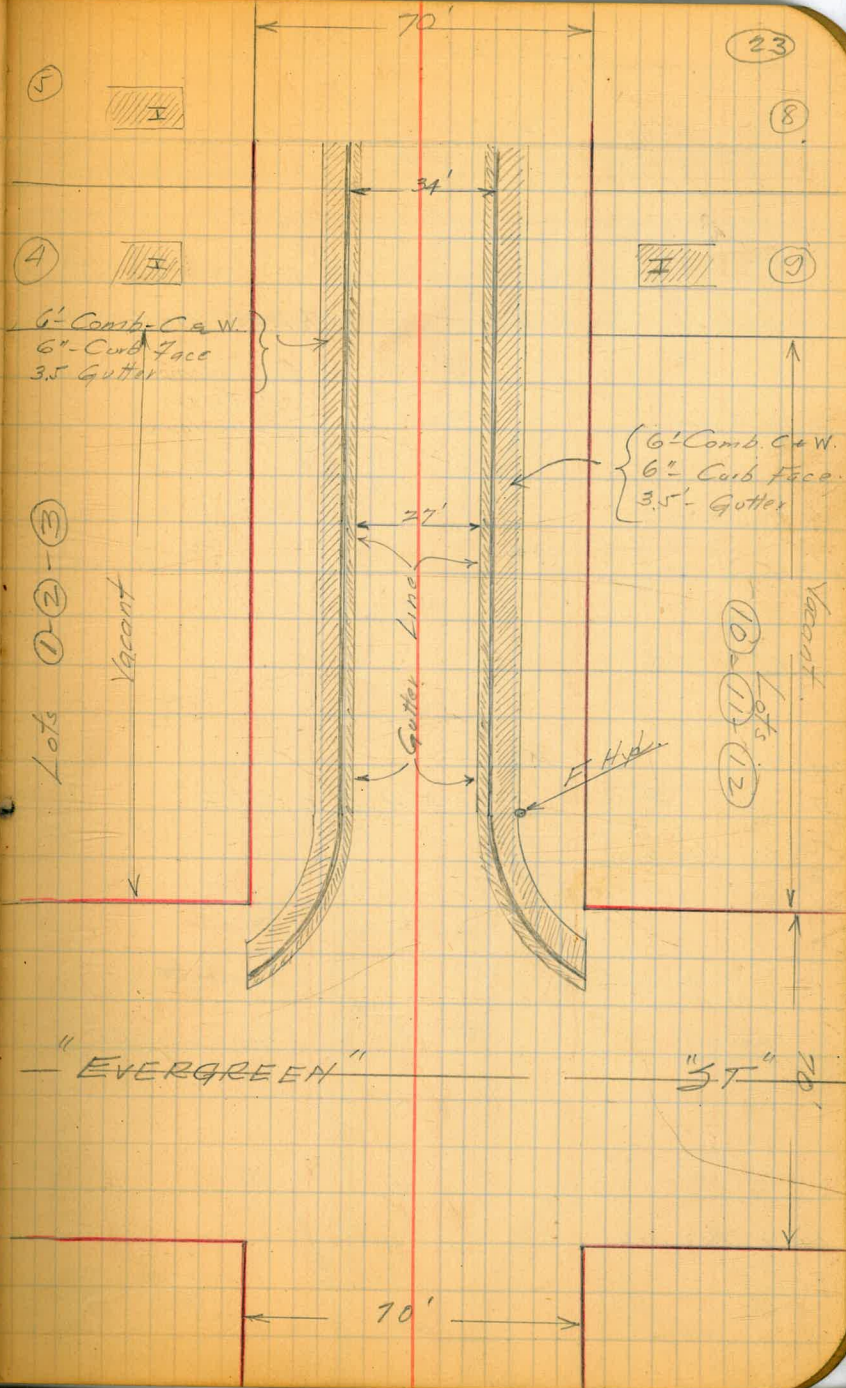

(23)

(8)

(9)

(5)

(4)

(3)

(2)

(1)

(10)

(11)

(12)

Lots 1-2-3 Vacant

Lots 10-11-12 Vacant

"Howell" St

Sta. Water Meters
Left Right

Mar. - 5 - 1929

O.S. Thompson
Anderson
d'Artois

7+40 Assumed

6+15 18'

5+55 18'

4+71 18'

4+65 F.Hyd. 25' Rt.

4+90 Assumed

3+70 Assumed

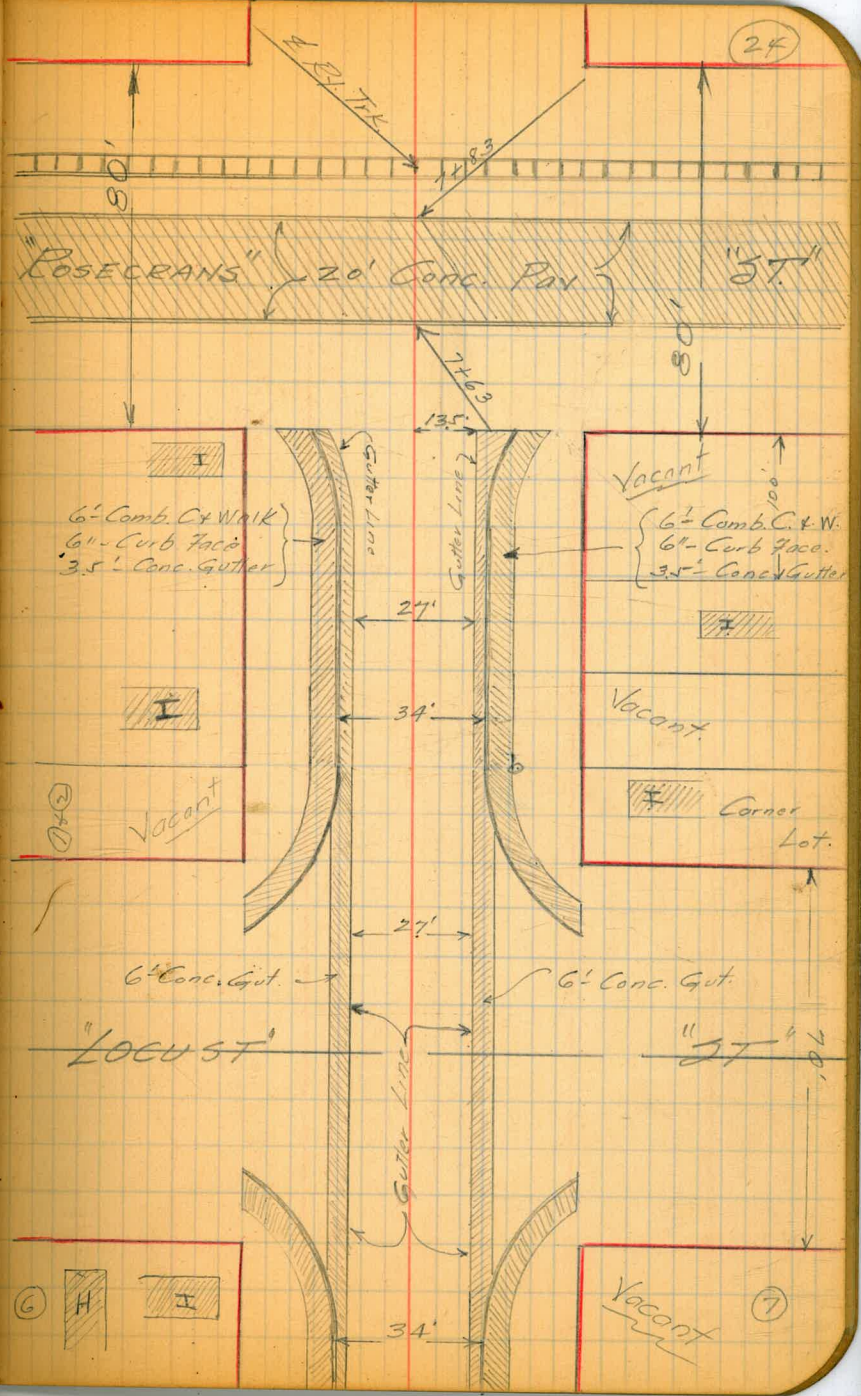

25

27

28

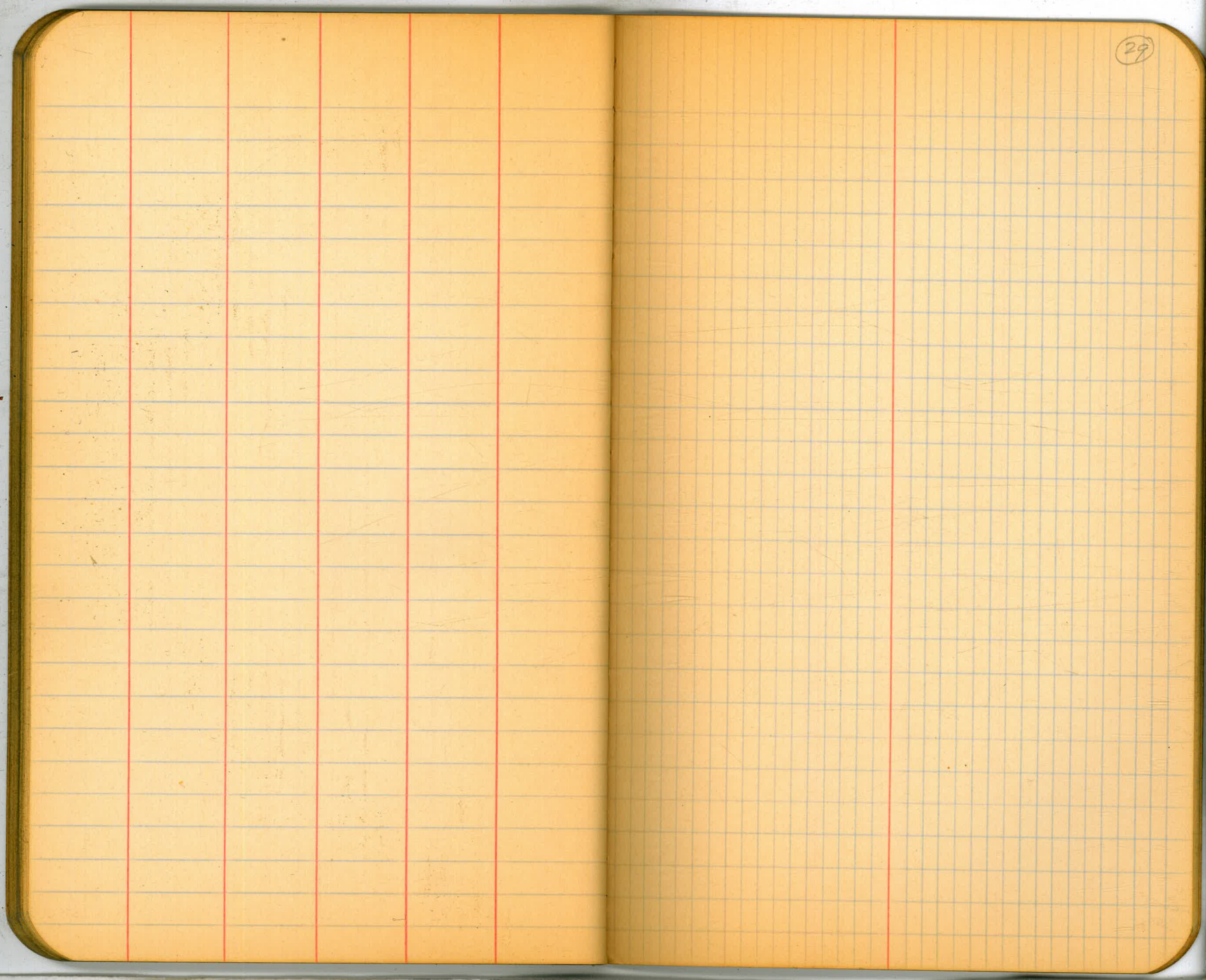

30



37



32

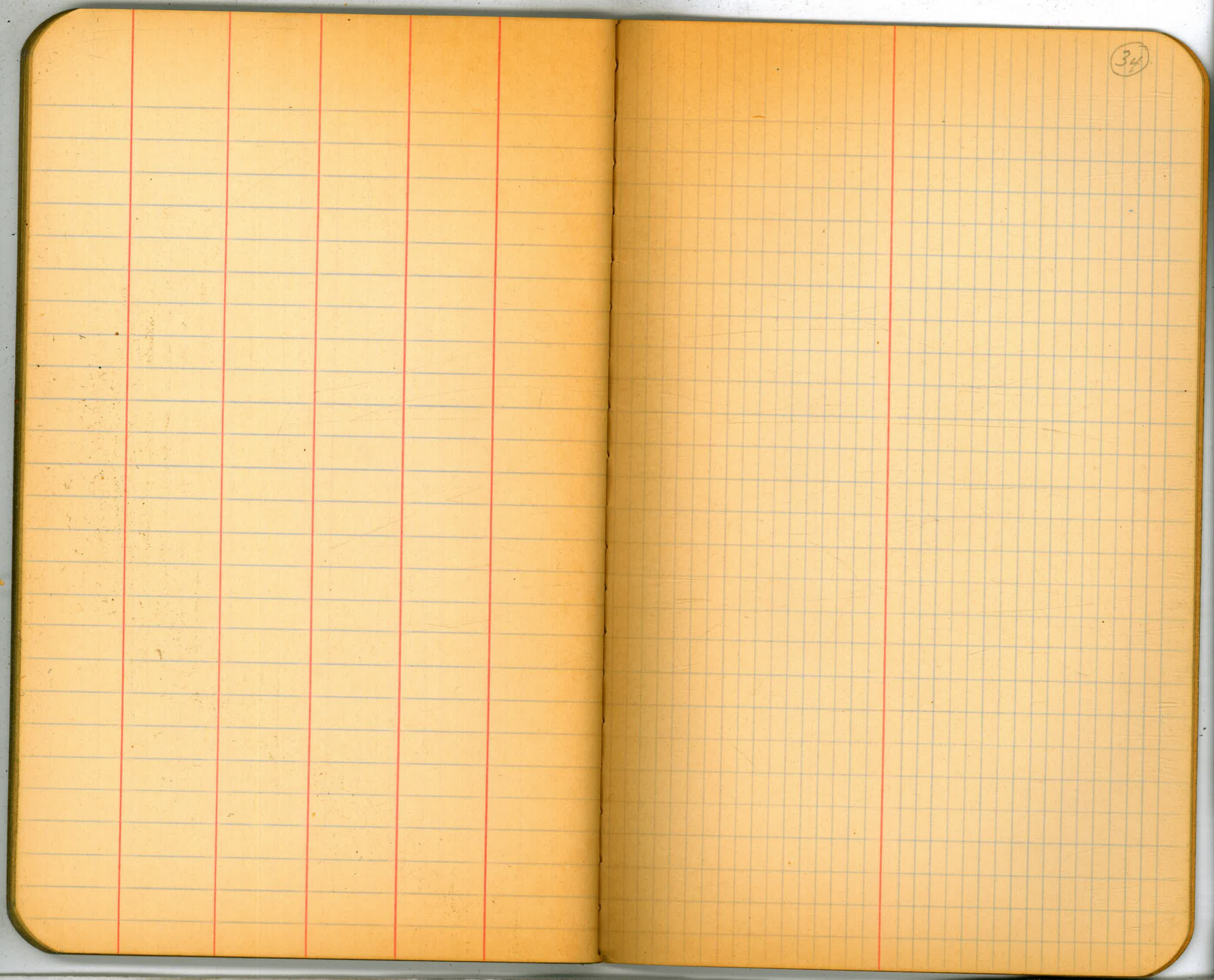

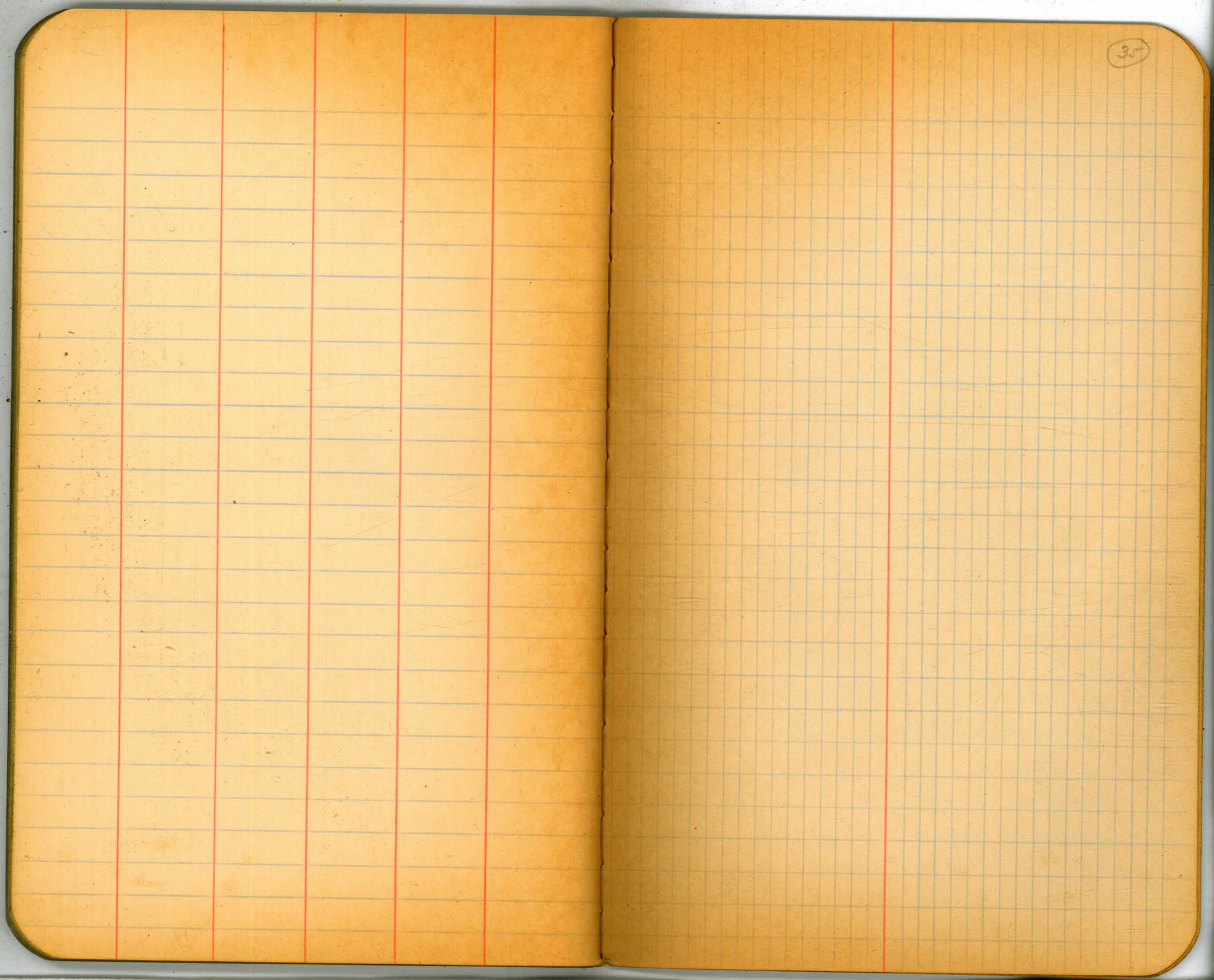

Work to be done. 10/15/29

X-Section Garrison St.-Clove to Willow
Elevations on Curb Returns (13.5' arcs)

Evergreen & Garrison - ✓
Evergreen & Fenelon - ✓
Locust & Garrison ✓

Location & Elevations ✓
Sidewalk & Curb on S. side ✓
Evergreen between Hugo & ✓
Garrison ✓

Locate existing sidewalk. ✓
Garrison St.- between Evergreen & Locust ✓
Fenelon St.- " " ✓

X-Section - Plum - Garrison to Hugo
X-Section - Garrison - Rosecrans to
bag for putting in storm drain.

Completed
Oct. 20 - 1929
[Signature]