

1431

PASTS

LEVEL BOOK

No. 380

2104 June 15-1945  
# 319

Print Lot B B/k 140  
Mission Beach

MICROFILMED

DEC 23 1964

Our Leather Bound Engineers Note Books are carried in the following rulings:

- No. 380 LEVEL BOOK. Left and Right Hand Page the same as Left Hand Page of this Book.
- No. 382 FIELD BOOK. Left Hand Page as in this Book, Right Hand Page 4 x 4 to the inch, Center Line Red.
- No. 384 MINING TRANSIT BOOK. Left Hand Page as in this Book, Right Hand Page 8x8 to the inch, Center Line Red.
- No. 385 FIELD BOOK. Left Hand Page as in this Book, Right Hand Page 8 vertical and 4 horizontal lines to the inch, Center Line Red.

We also carry the Note Books listed above, bound in extra strong Fabri-Hide (otherwise the same quality of book), which can be furnished at a somewhat lower price.

In ordering Fabri-Hide covered books, add the letter "F" to catalog number.

**THE FREDERICK POST CO.**  
*ENGINEERING and DRAFTING SUPPLIES*  
IRVING PARK STATION  
CHICAGO, ILL.

Francis St X Secs. 67



Cross Section Strand Way  
 1/2 Toulon Court to Braemar Place

30' wide

BM 179 8.92 7.13  
 TP 549 1132 3.09 5.83

SW BP  
 1/2 Braemar Pl  
 1/2 Strand

1/2 Toulon Court

E Top Board Walk 528 6.04

L 57 5.6

L 57 5.6

H 57 5.6

H Top Board Walk 538 5.94

1/8 H of 1/2 Toulon

H 56 5.7

L 55 5.8

L 57 5.6

+3 = 1/2 Garage 1st Floor 56 5.7

63' H

L 56 5.7

L 55 5.8

H 56 5.7

100' H

H 55 5.8

L 54 5.9

L 54 5.9

125.95 = 1/2 Vanitie Court

E Top Board Walk 507 6.25

L 54 5.9

L 54 5.9

1132

H 55 5.8  
 H Top Board Walk 507 6.25

176' H

H 53 6.0

L 52 6.1

E = 1/2 Garage Conc Floor 530 6.02

190' H of 1/2 Alley

L 52 6.11

L 51 6.2

H 52 6.1

250' H

H 51 6.2

L 50 6.3

L 51 6.2

246.95 = S.L. San Rafael Place

E 49 6.4

L 45 6.6

H 41 6.7

270.95 = N.L. San Rafael Place

H 49 6.4

L 51 6.2

L 55 5.8

300' H

L 57 5.6

L 57 5.6

H 55 5.8

Aug 5-31  
 Floor  
 1132  
 Northern

2

## Strand May

11.32

	3161		
H	= Garage Board Floor	5.30	6.0
H		5.6	5.7
L		5.8	5.5
F	= Garage Dirt Floor	5.8	5.5
	33011 = L Alley		
F		6.0	5.3
L		5.9	5.4
H		5.8	5.5

34311

H	= Garage Dirt Floor	5.9	5.4
L		6.0	5.3
F		6.2	5.1

3919511 = L Venice Court

F	= Top Board Walk	6.05	5.25
F		6.4	4.9
L		6.3	5.0
H		6.4	4.9
H	Top Board Walk	6.10	5.22

40011

H		6.4	4.9
L		6.4	4.9
F		6.4	4.9

44211

F	= Garage Conc. Apron	6.48	4.84
L		6.5	4.8

11.32

H		6.6	4.7
	4549511 = L Alley		
H		6.6	4.7
L		6.6	4.7
F		6.6	4.7
JP	3.82	8.62	6.52
	47011		

F		4.0	4.6
L		3.9	4.7
H	= Garage Conc. Apron	4.07	4.55

50011

H		4.1	4.5
L		4.1	4.5
F		4.1	4.5

51795 = L Verona Court

F	Top Board Walk	3.85	4.77
F		4.2	4.4
L		4.2	4.4
H		4.2	4.4
H	Top Board Walk	4.00	4.62

55011

H		4.3	4.3
L		4.2	4.4
F		4.3	4.3

3

580.95 N - 1/2 Hillier

E	4.4	4.2
1/2	4.4	4.2
N	4.4	4.2

600 N

N	4.6	4.0
1/2	4.6	4.0
E	4.6	4.0

643.95 = 1/2 Whitling Court

E Top Board Walk	4.61	4.01
E	4.9	3.7
1/2	4.9	3.7
N	4.8	3.8
N Top Board Walk	4.10	4.52

692 N

N - 1/2 Garage Jit Floor	4.85	3.77
1/2	4.9	3.7
E	4.9	3.7

707.77 = E.C. = 0.10 Hybrid

E	5.2	3.4
1/2	5.0	3.6
N	5.0	3.6

6.5 N of E.C. 1/2 Middlemore Court

N Top Board	4.50	4.12
N	5.0	3.6
1/2	5.0	3.6

Note: g  
Stationing  
From E.C. to  
Graeme M. Str  
Approximate  
No. Hubs 10

E	5.0	3.6
E Top Board Walk	4.80	3.82

100 N of E.C.

E	4.8	3.8
1/2	4.9	3.7
N	5.0	3.6

115 N

N - 1/2 Garage Conc Floor	4.93	3.69
1/2	4.8	3.8
E	4.9	3.7

1/2 = 1/2 Garage Jit Floor	4.9	3.7
----------------------------	-----	-----

128 N - 1/2 Hillier

E	5.1	3.5
1/2	4.9	3.7
N	4.9	3.7

142 N

N	5.0	3.6
1/2	4.9	3.7
E	5.1	3.5

1/2 = 1/2 Garage Jit	4.8	3.8
----------------------	-----	-----

192 N - 1/2 Yarmouth Court

E Top Board Walk	4.80	3.82
E	5.0	3.6
1/2	4.9	3.7
N	4.9	3.7
N Top Board Walk	4.44	4.18

200' N

N	50	3.6
E	49	3.7
F	50	3.6

243' N

F = Garage Conc Floor	501	3.62
E	49	3.7
N	47	3.9

256' N = S Hill

N	48	3.8
E	50	3.6
F	51	3.5

300' N

F	51	3.5
E	50	3.6
N	51	3.5

TP	145	8.05	503	3.60
----	-----	------	-----	------

319' N = York Court

N Top Board Walk	383	4.22
N	44	3.6
E	43	3.7
F	45	3.5

F Top Board Walk	417	3.88
------------------	-----	------

384' N = S Hill

F	47	3.3
E	46	3.4

N	46	3.4
N	400' N	
N	45	3.2
E	46	3.4
F	47	3.3

446' N = S Langdon Court

F Top Board Walk	468	3.37
F	50	3.0
E	48	3.2
N	49	3.1
N Top Board Walk	481	3.84

492' N

N	46	3.4
E	46	3.4
F = Garage Conc Floor	475	3.30

531' N = S L Braemar Place

F	45	3.5
E	42	3.8
N	42	3.8

TP	194	8.97	102	7.03
BM			190	7.07

S.W. BP  
York Ct  
S.W. Hill  
7.08



Cross Section Boyside Lane

Seagirt Court to Alley North of Verona 15.75' wide

356

Aug 53 6

Note: Stationing Approximate As to Hubs in SW 3P

BM	3.00	10.08	7.08	Seagirt + Scornal
TP	3.35	2.56	9.87	0.21
		1/2 Seagirt Court		
W		4.35	-0.79	
W		4.9	-1.3	
L		4.9	-1.3	
F		4.9	-1.3	
		25 N of 1/2 Seagirt		
F		4.8	-1.2	
L		4.8	-1.2	
W		4.9	-1.3	
		40 N		
W		4.9	-1.3	
L		4.8	-1.2	
F		4.8	-1.2	
L		4.8	-1.2	
		66 N = 1/2 Alley		
F		4.9	-1.3	
L		4.8	-1.2	
W		4.8	-1.2	
		100 N		
W		4.8	-1.2	
L		4.9	-1.3	
L		4.8	-1.2	

		116 N		
-2	1/2 Garage Driv	4.8	-1.2	
F		4.8	-1.2	
L		4.7	-1.1	
W		4.7	-1.1	
		128.16 = 1/2 Sunset Court		
W	Top Board Walk	4.08	-0.52	
W		4.7	-1.1	
L		4.7	-1.1	
F		4.7	-1.1	
F	Top Board Walk	4.04	-0.48	
		191.56 N = 1/2 Alley		
F		4.5	-0.9	
L		4.5	-0.9	
W		4.5	-0.9	
		255.58 N = 1/2 Taggers Court		
W	Top Board Walk	4.48	-0.92	
W		4.8	-1.2	
L		4.7	-1.1	
F		4.7	-1.1	
F	Top Board Walk	4.47	-0.91	
TP	4.46	3.35	4.67	-1.11
		302 N		
-2	1/2 Dr. Garage Conc. Apron	4.33	-0.98	
F		4.4	-1.0	
L		4.5	-1.1	

H		47	-1.3
	320 N = 1/2 Alley		
H		46	-1.2
L		44	-1.0
L		45	-1.1
	334 N		
L		47	-1.3
L		46	-1.2
H	Garage Conn. Apron	470	-1.35
	383.6 = 1/2 Toulon Court		
H	Top Board Walk	450	-1.15
H		49	-1.5
L		48	-1.4
L		50	-1.6
L	Top Board Walk	450	-1.15
	400 N		
L		51	-1.7
L		49	-1.5
H		53	-1.6
	430 N		
H		51	-1.7
L		50	-1.6
L	Garage Conn. Apron	500	-1.65
	448 N = 1/2 Alley		
L		50	-1.6
L		47	-1.3

H		49	-1.5
	461 N		
H		50	-1.6
L		49	-1.5
L		49	-1.5
	43 = 1/2 Garage Dist	48	-1.3
	500 N		
L		49	-1.4
L		48	-1.3
H		49	-1.4
	510.7 = 1/2 Vanitie Court		
H	Top Board Walk	437	-1.02
H		49	-1.5
L		48	-1.4
L		49	-1.5
L	Top Board Walk	437	-1.02
	573.5 = 1/2 Alley		
L		44	-1.0
L		43	-0.9
H		44	-1.0
	600 N		
H		49	-1.5
L		44	-1.0
L		48	-1.4

631 N = S. L. San Rafael Place

F	48	-1.4
♂	44	-1.0
W	4.6	-1.2

655 N = N. L. San Rafael Place

W	46	-1.2
♂	4.3	-0.9
F	48	-1.4

700 N

F	46	-1.2
♂	4.3	-0.9
W	4.6	-1.2

713.5 N = ♂ Alley

W	46	-1.2
♂	4.3	-0.9
F	46	-1.2

722 N

F	46	-1.2
♂	44	-1.0
W = S. L. Garage Concrete Apron	4.50	-1.15

W 5.05 3.90 4.50 -1.15

760 N

W = N. L. Garage Concrete Apron	5.16	-1.26
♂	5.0	-1.1
F	54	-1.5

3.90

777 N = ♂ Venice Court

F Top Board Walk	49	-1.6
------------------	----	------

F	54	-1.5
---	----	------

♂	50	-1.1
---	----	------

W	52	-1.3
---	----	------

W Top Board Walk	487	-0.97
------------------	-----	-------

800 N

W	51	-1.2
---	----	------

♂	50	-1.1
---	----	------

F = ♂ Garage Concrete Apron	518	-1.28
-----------------------------	-----	-------

842 N = ♂ Alley

F	53	-1.4
---	----	------

♂	50	-1.1
---	----	------

W	51	-1.2
---	----	------

906 N = ♂ Verona Court

W Top Board Walk	493	-1.03
------------------	-----	-------

W	53	-1.4
---	----	------

♂	51	-1.2
---	----	------

F	53	-1.4
---	----	------

F Top Board Walk	491	-1.01
------------------	-----	-------

927.27 = BG on West

F	50	-1.1
---	----	------

♂	49	-1.0
---	----	------

W	51	-1.2
---	----	------

Boyside Lane

390

96527 - S.L.H./w/B/K/234

H			43	-0.4
L			44	-0.5
F			46	-0.7
TP	969	963	396	-0.06
BM			250	7.12

SW BP  
307/10/14  
Sawyer  
7.12

Cross Section Bayside Lane  
Nahant Court to Ventura Place

16 Wide

281

Map 631  
Moore  
Dixon  
Northway

West Line Stationing		Notes - Sections #1 Courts Taken on Court / Lign on Prop	
BM	0.90 779	7.09	SM, BP E, Carmel + Steeple
TP	4.47 2.81 945	-1.66	
S.W. Nahant = 0+0			
W	Top Board Walk	4.53	-1.72
W		4.9	-2.1
L		4.7	-1.9
F		4.8	-2.0
L	Top Board Walk	4.58	-1.77
41' S of S.W. Nahant			
-	Garage Case	4.66	-1.85
F	Case Apron	4.83	-2.02
L		4.8	-2.0
W		4.9	-2.1
89.515 = L Alley			
W		4.6	-1.8
L		4.5	-1.7
F		4.8	-2.0
100' S			
F		4.9	-2.1
L		4.5	-1.7
W		4.8	-2.0
126' S			
W	Case Walk	4.7	-1.9
W		4.9	-2.1
L		4.6	-1.8

I		5.0	-2.2
	150' S		
I		5.0	-2.2
L		4.7	-1.9
W		5.0	-2.2
183.19 S = L Monterey Court			
W	TOP	4.38	-1.57
W		4.9	-2.1
L		4.7	-1.9
I		5.0	-2.2
I	TOP	4.4	-1.6
200' S			
I		4.9	-2.1
L		4.6	-1.8
W		4.8	-2.0
235' S			
W		4.8	-2.0
L		4.7	-1.9
F		4.9	-2.1
275.55 = L Alley			
I		4.7	-1.9
L		4.6	-1.8
W		4.5	-1.7

24.55 W - 10 db. gar dirt - 1.3  
2+94 W - 8 " " " " " " " "

10

2.81

300'S

H	4.6	-1.8
L	4.5	-1.7
F	4.7	-1.9

335'S

F	4.6	-1.8
L	4.4	-1.6
H	4.6	-1.8

363.73 S = N.E. / Carmel Place

H	4.3	-1.5
L	4.4	-1.6
F	4.5	-1.7

387.76 = S.L. / Carmel Place

F	4.2	-1.4
L	4.3	-1.5
H	4.2	-1.4

400'S

H	4.4	-1.6
L	4.4	-1.6
F	4.3	-1.5

438'S

F	4.4	-1.6
L	4.3	-1.5
H	4.4	-1.6

2.81

475.71'S = 1/2 Alley

H	4.2	-1.4
L	4.3	-1.5
F	4.5	-1.7

500'S

F	4.5	-1.7
L	4.4	-1.6
H	4.4	-1.6

520'S

H	4.4	-1.6
L	4.4	-1.6
F = 1/2 De Garage Court	4.4	-1.6

548.67 S = 1/2 Manhattan Court

F = Top Board Walk	4.2	-1.39
F	4.4	-1.6
L	4.4	-1.6
H	4.5	-1.7
H = Top Board Walk	4.2	-1.39

600'S

H	4.5	-1.7
L	4.4	-1.6
F	4.6	-1.8

419 2.85 4.15 -1.34

625'S

- 1/2 Garage Driv	4.28	-1.43
F	4.5	-1.7

474.97 E.L. db. garage Court - 1.00  
" approx 1.5' in alley - 1.35

L		44	-1.6
H		44	-1.6
	644'S		
H	Do Garage Conc Apron	427	-1.46
L		44	-1.6
F		4.6	-1.8
	651'S		
F	Do Garage Conc	43	-1.5
F		4.6	-1.8
L		43	-1.5
H		42	-1.4
	66178'S = 2 Alley		
H		42	-1.4
L		43	-1.5
F		4.6	-1.8
	700'S		
F		47	-1.9
L		45	-1.7
H		47	-1.9
	75522 = 1/2 Liverpool		
H	Top Board Walk	424	-1.39
H		46	-1.8
L		48	-2.0
F		48	-2.0
L	Top Board Walk	427	-1.42

BVI - 1179  
LMI - 1141  
NORV B I 3 77  
L 110 21 2 99

F		51	-2.2
L		48	-2.0
H	Do Garage Conc Apron	468	-1.83
	84855 = 1/2 Alley		
H		47	-1.8
L		49	-2.1
F		49	-2.1
	900'S		
F		5.0	-2.1
L		51	-2.2
H		50	-2.1
	94259 = 1/2 Lido		
H	Top Board Walk	437	-1.82
H		49	-2.0
L		49	-2.0
F		5.0	-2.1
F	Top Board Walk	430	-1.45
	995'S		
F		5.0	-2.1
L		48	-1.9
H	Do Garage Conc Apron	467	-1.82
	103718 = 1/2 Alley		
H		5.0	-2.1
L		49	-2.0
F		5.1	-2.3

8460 E.L. E do. gar Conc. - 1.84

-2.09  
 -2.22  
 -1.37  
 EL. +3 Hedge apron  
 " +3.5 " "  
 EL. -8 Gar. Fl.

1100 S

F	51	-2.2
L	50	-2.1
H	52	-2.3

112734 S = 1/2 San Luis Obispo Plac

H	49	-2.0
L	50	-2.1
F	51	-2.2

115207 S = 1/2 San Luis Obispo Pl

F	49	-2.0
L	49	-2.0
H	50	-2.1

4.75 3.21 4.34

1200 S

H	53	-2.0
L	54	-2.1
F	53	-2.0

124155 = 1/2 Flr

F = Conc Apron De Garage	520	-1.94
L	50	-1.8
H	51	-1.8

1258 S

H	52	-1.9
L	51	-1.8
F	51	-1.8

+3.5 = 1/2 De Garage Conc Floor 492

492	-1.66
-----	-------

10 + 46  
 10 + 76  
 10 + 21  
 Sp Co  
 Boarded  
 Prod Linc Obispo

1300 S

F	52	-1.94
L	50	-1.7
H	52	-1.9

1341.38 S = 1/2 N. 1st of Court

H on Conc Walk	457	-1.31
H	50	-1.7
L	51	-1.8
F	50	-1.7
L on Conc Walk	456	-1.30

1400 S

F	52	-2.0
L	52	-2.0
H	51	-1.9

1440.93 S = 1/2 Flr

H	49	-1.6
L	48	-1.5
F	51	-1.8

1457 S

-3.5 = 1/2 De Garage Conc Floor	452	-1.26
F on Conc Apron	500	-1.74
L	48	-1.5
H	50	-1.7

1496 S

H	49	-1.6
L	47	-1.4



E	07 Conc Apron	492	-1.66
+ 4	2 Do Garage Floor	480	-1.54
	1541 325 = 2	Kennebeck Court	
E	07 Conc Walk	438	-1.12
F		48	-1.15
L		49	-1.16
H		48	-1.15
H	07 Conc Walk	437	-1.11
	1600'S		
H		49	-1.16
L		47	-1.14
F		49	-1.16
	1641'S = 2	Hill	
F		48	-1.15
L		46	-1.13
H		47	-1.14
	169381'S = FC		
H		49	-1.16
L		48	-1.15
F		48	-1.15
	174681'S = 2	Jersey Court	
F	07 Conc Walk	425	-0.99
F		46	-1.13
L		46	-1.13
H		46	-1.13

18' apron - 1.50  
 15' + 7.5' EL. - 1.12  
 17' + 10' EL. Sedge apron - 1.15  
 16' + 8' EL. - 1.12  
 16' + 8' EL. - 1.12

H	07 Conc Walk	413	-0.89		
TP		4.38	3.77	3.87	-0.61
	1800'S				
H		50	-1.12		
L		50	-1.12		
F		51	-1.13		
	1850'S				
F		51	-1.13		
L		48	-1.10		
H		48	-1.10		
	1900'S				
H		47	-0.9		
L		50	-1.12		
F		51	-1.13		
	1948 21'S = N.L. Santa Barbara Place				
F		50	-1.12		
L		47	-0.9		
H		48	-1.10		
	1975 12'S = S.L. Santa Barbara Place				
-10	07 Conc Curb	425	-0.98		
H		47	-0.9		
L		47	-0.9		
F		48	-1.0		
	2000'S				
F		49	-1.1		
L		48	-1.0		

19' + 13' = EL. Cell apron - 1.10  
 EL + 1' = 1.090  
 18' + 70' EL. 2' Conc apron - 0.95

M		47	-0.9
+1.3 Top Case Cb		431	-0.59
	2034 S		
-1' - 1/4 Case Apron		490	-1.13
M on Iron Grating		5.05	-1.28
L		4.7	-0.9
F		1.8	-1.0
	2061 S		
F		4.8	-1.0
L		4.7	-0.9
M		4.7	-0.9
+1' - 1/4 Case Apron		4.84	-1.07
	2072 S - L 1/16		
M		4.7	-0.9
L		4.6	-0.8
F		4.8	-1.0
	2100 S		
F		5.0	-1.2
L		4.9	-1.1
M		5.0	-1.2
	2150 S		
M		5.0	-1.2
L		5.1	-1.3
F		5.1	-1.3

	2177.77 S - L Jamaica Court		
F	on Case Walk	4.70	-0.93
F		5.0	-1.2
L		5.0	-1.2
M		5.1	-1.3
M	on Case Walk	4.72	-0.95
	2200 S		
M		5.1	-1.3
L		5.1	-1.3
L	22 + 15 E 16 99	5.2	-1.4
	2250 S		
F		5.3	-1.5
L		5.1	-1.3
M		5.2	-1.4
	2279.01 S - BC		
M		5.1	-1.3
L		5.0	-1.2
F		5.3	-1.5
	2300 S		
F		5.2	-1.4
L		5.2	-1.4
M		5.2	-1.4
+1' on Case Floor North Entrance		4.62	-0.85

Com 1/16  
L Back  
of E.L.

3.77

23225

E	07 Core Walk	4.75	-0.98
H		5.2	-1.4
L		5.3	-1.5
F		5.4	-1.6

23505

E		5.4	-1.6	
L		5.4	-1.6	
H		5.4	-1.6	
TP	4.53	2.86	5.44	-1.67

+1.8 07 Top Core Cb. 3.88 -1.02

23805 = 2 1st hmsur Court

H	07 Top Core Walk	4.13	-1.27
H	Wedge of Walk Cb. 1st from	4.5	-1.6
L		4.5	-1.6
F		4.5	-1.6
E	07 Top Core Walk	4.10	-1.24

24005

E		4.5	-1.6
L		4.5	-1.6
H		4.5	-1.6

24355

H		4.7	1.8
L		4.6	1.7
F		4.6	1.7

2.86

24745 = 2 Alley

E	Garage Core Floor	4.22	-1.36
F		4.4	-1.5
L		4.5	-1.6
H		4.6	-1.7

25005

H		4.9	-2.0
L		4.9	-2.0
F		5.0	-2.1

25305

E		5.0	-2.1
L		4.9	-2.0
H		5.0	-2.1

25684 = 2 Island Court

H	07 Core Walk	4.55	-1.69
H		4.7	-1.8
L		4.7	-1.8
F		4.8	-1.9
E	07 Core Walk	4.65	-1.79

26005

F		4.6	-1.7
L		4.6	-1.7
H		4.7	-1.8

26595 = 2 Alley

H		3.9	-1.0
L		3.8	-0.9

26 + 21 = 47 16' Gar. Cern. H. - 1.09

24781 E.C. Wedge Cern. 246 - 1.36  
25714 " " " " - 1.44

West Line Stationing

F 40 -1.1

2700 S

F 37 -0.8

F 38 -0.9

H 38 -0.9

2749.43 S: H. Ventura Place

H 31 -0.2

F 31 -0.2

F 33 -0.4

2773.43 S: J. L. Ventura Place

F 28 +0.1

F 28 +0.1

H 29 00

TP 454 -1.68

on Ct.  
H. L. Bayside Lane  
+ Island Ct

Cross Section Strand Way  
 Nahant Court to Ventura Place 20th di

9.38

Aug 27 1888  
 Moore  
 Sisson  
 Hartman

Stationing	BM	9.38	7.09	J.M.B.P. E. Carmel + S. Hall
Stationing	229	9.38	7.09	
Nahant Court				
E Top Board Walk		4.17	5.21	
E		4.4	5.0	
E		4.4	5.0	
W		4.5	4.9	
40 S of Nahant Court				
W		4.5	4.9	
E		4.4	5.0	
E		4.4	5.0	
93 S of Alley				
E		4.5	4.9	
E of M.H. River		4.3	5.1	
W		4.5	4.9	
124 S				
W		4.7	4.7	
E		4.5	4.9	
E		4.6	4.8	
E of Board Walk		4.73	4.96	
1150 S				
E		4.6	4.8	
E		4.4	5.0	
W		4.6	4.8	

1858 S - Monterey Court

W		4.5	4.9
E		4.4	5.0
E		4.4	5.0
E of Board Walk		4.06	5.32
300 S			
E		4.5	4.9
E		4.5	4.9
W		4.6	4.8
236 S			
W		4.7	4.7
E		4.6	4.8
E		4.6	4.8
44.5 Doghouse Ditch Floor		4.50	4.88
279.5 S of Alley			
E		4.7	4.7
E		4.6	4.8
W		4.9	4.5
300 S			
W		5.0	4.4
E		4.8	4.6
E		4.8	4.6
366.5 S - N.E. Carmel Place			
E		5.0	4.4
E		4.9	4.5
W		4.9	4.5

Strand Hwy

9.38

3908 S. S. L. F. Carmel Place

H	5.0	4.4
L	5.0	4.4
F	5.0	4.4
400'S		
F	5.1	4.3
L	5.0	4.4
H	5.1	4.3
435'S		
H	5.1	4.3
L	5.0	4.4
F	5.0	4.4
472.52 = B.C.		
F	4.9	4.5
L	4.9	4.5
H	5.0	4.4
500'S		
H	5.0	4.4
L	4.9	4.5
F	4.9	4.5
523'S		
F	4.8	4.6
L	4.9	4.5
H on Case Apron	4.82	4.56
L = L Do Garage Case Floor	4.40	4.98

4855'S  
 MH of Floor  
 28' on Floor

190

9.38

57187 = L Manhattan Court

H on Board Walk	4.82	5.16
H	4.6	4.8
L	4.5	4.9
F	4.5	4.9
E on Board Walk	3.83	5.55
600'S		
F	4.6	4.8
L	4.4	5.0
H	4.7	4.7
TP	4.89	9.82
621.93 S. F.C.		
H	5.1	4.7
L	4.9	4.9
F	4.9	4.9
674'S = L Hill		
F	5.0	4.8
L on MH Rim	4.9	4.9
H	5.1	4.7
700'S		
H	5.1	4.7
L	5.0	4.8
F	5.0	4.8
757.32 S. L Liverpool Court		
E Top Board Walk	4.51	5.31
F	5.1	4.7

982

L	50	4.8
W	51	4.7
W on Board Walk	452	5.30
	800'S	
W	52	4.6
L	50	4.8
F	52	4.6
	850'S - L Alley	
F	52	4.6
L on M.H. Room	51	4.7
W	53	4.5
	900'S	
W	51	4.7
L	50	4.8
F	50	4.8
	943.69'S - L Lido Court	
F on Board Walk	460	5.22
F	48	5.0
L	47	5.1
W	49	4.9
	977'S	
W on Conc Apron	479	5.03
W	48	5.0
L	47	5.1
F	47	5.1

982

30

	1000'S	
F	48	5.0
L	47	5.1
W	47	5.1
W on Conc Cb	440	5.42
	1027'S	
- 4 - L Garage Drt Floor	455	5.27
W	47	5.1
L	46	5.2
F	48	5.0
	1037'S - L Alley	
F	48	5.0
L	46	5.2
W	45	5.3
+ 2 - M.H. Do. Garage Conc Apron	461	5.21
	1055'S	
- 2 - M.H. Do. Garage Conc Apron	456	5.26
W	47	5.1
L	48	5.0
F	49	4.9
	1075'S	
F	49	4.9
L	47	5.1
W on Conc Apron	49	4.9
14 - M.H. Do. Garage Conc	457	5.25

1094'S

-4 - Sly De Garage Conc.	4.56	5.26
W on Conc Apron	4.88	4.94
L	4.7	5.1
F	4.9	4.9

1125.01 - H.L. San Luis Obispo Place

F on Black Pavmg	5.0	4.8
L	4.7	5.1
W	4.7	5.1

1149.03'S - S.L. San Luis Obispo Place

W	4.7	5.1
L	4.7	5.1
F on Black Pavmg	5.0	4.8

1175'S

F	4.7	5.1
L	4.7	5.1
W - Sly Conc Apron	4.58	5.24

125 on Entrance to Plaza	4.26	5.56
--------------------------	------	------

1198'S

-2.5 on Conc Apron	4.40	5.42
W - Sly Conc Apron	4.60	5.22
L	4.7	5.1
F	4.7	5.1

1238'S - L Alley

F	4.5	5.3
L on W.H. Paving	4.5	5.3

W	4.1	5.2
1282'S		
W	4.4	5.4
L	4.4	5.4
F	4.5	5.3
17 - L De Garage Dirt Floor	4.16	5.66

1300'S

F	4.4	5.4
L	4.4	5.4
W	4.4	5.4

1330.11 - L Kingston Court

W on Conc Walk	3.52	6.30
W	4.3	5.5
L	4.4	5.4
F	4.3	5.5
F on Conc Walk	3.65	6.17
TP	4.83	10.94
3.71	6.41	

1360'S

F	5.6	5.3
L	5.6	5.3
W	5.6	5.3

1400'S

W	5.6	5.3
L	5.5	5.4
F	5.6	5.3

11/15/54  
K1300 on +  
Strand Hwy



Strand Wy

10.94

1423 S = 1/2 Alley

F	55	5.4
1/2	54	5.5
W	55	5.4

1460 S

W	55	5.4
1/2	54	5.5
F	54	5.5

1516.25 S = 1/2 Hancock Court

F on Conc Walk	455	6.39
F	51	5.8
1/2	51	5.8
W	52	5.7
W on Conc Walk	452	6.42

1541 S

W on Conc Apron 1/2	530	5.64
1/2	52	5.7
F	53	5.6

1579 S

F	53	5.6
1/2	52	5.7
W = 1/4 3 Garages on Conc Apron	507	5.87
+ 1 Garage Floor	485	6.09

1588 S

2 F of 1/4 3 Garages Conc Apron	533	5.61
---------------------------------	-----	------

10.94

1605 S

- 1 - 1/4 3 Garages Conc Floor	470	6.24
W on Conc Apron	502	5.91
1/2	51	5.8
F	51	5.8

1650 S

F	52	5.7
1/2	53	5.6
W	51	5.8

1702.29 S = 1/2 Jersey Court

W on Conc Walk	430	6.64
W	49	6.0
1/2	48	6.1
F	47	6.2
F on Conc Walk	425	6.69

1750 S

F	50	5.9
1/2	49	6.0
W	50	5.9

1795 S = 1/2 Alley

W	50	5.9
1/2	49	6.0
F	49	6.0

1850 S

F	50	5.9
1/2	49	6.0

1094

M	50	5.9
	1883 53 S - N 2 Santa Barbara Place	
M	49	6.0
L	48	6.1
L	49	6.0
	1907 53 S - S 2 Santa Barbara Place	
L	50	5.9
L	48	6.1
M	48	6.1
	1950 S	
M	50	5.9
L	48	6.1
L	49	6.0
	1996 S - L Alley	
L	46	6.3
L	45	6.4
M	47	6.2
	2022 S	
-1 = L	Do Garage Conc Floor	4.33 6.61
M	27 Conc Floor	4.60 6.34
L		4.6 6.3
L		4.7 6.2
	2050 S	
L	46	6.3
L	46	6.3
M	45	6.4

1094

23

	2088 67 S - L Jamaica Court	
M	27 Conc Walk	3.75 7.19
M		4.5 6.4
L		4.4 6.5
L		4.4 6.5
L	27 Conc Walk	3.72 7.22
TP	4.43 11.63	3.74 7.20
	2100 S	
L		5.2 6.4
L		5.2 6.4
M		5.3 6.3
	2135 S	
M		5.1 6.5
L		5.1 6.5
L		5.1 6.5
	2183 S - L Alley	
L		5.2 6.4
L		5.2 6.4
M		5.3 6.3
	2225 S	
M		5.3 6.3
L		5.1 6.5
L = Conc Floor		5.05 6.58
+5 = L	Do Garage Conc Floor	4.73 6.90

99 CT  
Jamaica  
Strand Way

Strand Way

11.63

22748 S - 2 1st house Court

E on Conc Walk	4.8	7.45
E	4.9	6.7
L	5.1	6.5
H	5.0	6.6
H on Conc Walk	4.20	7.43

2300 S

H	5.0	6.6
L	4.9	6.7
E	4.8	6.8

2336 S

L	4.8	6.8
L	4.8	6.8
H	4.8	6.8

2369 = 2 Alley

H	5.0	6.6
L	5.0	6.6
E	5.0	6.6

2400 S

E	5.3	6.3
L	5.2	6.4
H	5.2	6.3

2430 S

H	5.5	6.1
L	5.5	6.1
E	5.6	6.0

11.63

2460.95 S - 2 Island Court

E on Conc Walk	4.80	6.83
E	5.5	6.1
L	5.6	6.0
H	5.6	6.0
H on Conc Walk	4.73	6.90

2500 S

H	5.9	5.7
L	5.9	5.9
E	6.0	5.6

2525 S

L	6.2	5.4
L	6.1	5.5
H	6.0	5.6

2553 S - 2 Alley

H	6.1	5.5
L	6.1	5.5
E	6.2	5.4

2600 S

L	6.6	5.0
L	6.5	5.1
H	6.1	5.5

2627.09 S: 1/4 line of Conc Walk on Venture

H Top of Conc Walk	5.97	5.66
H	6.6	5.0
L	6.6	5.0

Strand Way

11.63

25

E 6.6 5.0

E 0.7 Top Ck + Walk 6.17 5.46

264209 S: 1/2 Venture Place - 1/4 Edge Paring

E 0.7 1/4 Edge Conc Paring 6.87 4.96

T " " 6.80 4.83

H 6.78 4.85

BM 4.61 7.02

STOP  
Sight on  
Strand Way  
7.03

Cross Section Alley Between Ventura Place and Island Ct  
From Strand Way to Bay Side Walk

16' Wide

1095

Aug 27-31 26

11.63 Bl Ford BIR 96-97

TP 5.50 10.95 6.18 5.45

EL Strand Way

S 5.7 5.3

L 5.5 5.5

H 5.5 5.5

50' E of EL Strand Way

H 7.3 3.7

L 7.3 3.7

S 7.3 3.7

75'

S 8.2 2.8

L 8.2 2.8

H 8.2 2.8

110'

-2 Do Garage Conc Floor 8.58 2.37

H 8.8 2.2

L 9.0 2.0

S 9.0 2.0

150'

S 10.0 1.0

L 10.1 0.9

H 10.3 0.7

175'

H 11.1 0.1

L 10.9 0.1

Plotted  
2-23-37  
JER

S

10.8 0.2

200'E

S

11.7 -0.7

L

11.8 -0.8

H

11.8 -0.8

TP

4.30 334 11.91 -0.96

240'E

H

4.8 -1.5

L

4.8 -1.5

S

4.8 -1.5

270'E

S

4.9 -1.6

L

5.0 -1.7

H

5.0 -1.7

300'E

H

5.1 -1.8

L

5.0 -1.7

S

5.06 -1.72

L

5.03 -1.69

330'E

-2

EL of 3 Garages Conc 4.97 -1.63

S

0.7 Conc Apron 5.00 -1.66

L

5.0 -1.7

H

5.0 -1.7

334

370' E of N.L. Mission Blvd.

N on Curb	497	-1.63
N on Paving	499	-1.65
S " "	491	-1.57
S " "	475	-1.41
S on Curb	470	-1.36

N Cb of Mission Blvd.

S on Pav.	522	-1.88
S on Grating Jump	527	-1.93
N on Pav.	521	-1.87

E Cb of Mission Blvd.

N on Paving	538	-2.04
S " "	541	-2.07
S " "	542	-2.08

E.L. Mission Blvd.

S on Cb of Conc. Apron	508	-1.74
S " Paving	513	-1.79
S " "	501	-1.67
N " "	495	-1.61
N " Cb	495	-1.61

45' E of E.L. Mission Blvd.

N	55	-2.2
S	50	-1.7
S = E End of Conc. Apron	505	-1.71

334

27

75'

S	51	-1.8
S	51	-1.8
N	54	-2.1

100'

N	52	-1.9
S	51	-1.8
S	51	-1.8

150'

S	50	-1.7
S	50	-1.7
N	51	-1.8

200'

N	50	-1.7
S	47	-1.4
S	49	-1.6

215'

S on Garage Conc. Floor	394	-0.60
S	47	-1.4
S	47	-1.4
N	48	-1.5

234'

N = S Do Garage Conc. Apron	463	-1.29
S	45	-1.2
S	47	-1.4

334

270' E

S	4.7	-1.4
<del>E</del>	4.6	-1.3
H	4.6	-1.3

300' E

H	4.6	-1.3
<del>E</del>	4.6	-1.3
S	4.6	-1.3

344.6' E - H.L. Bayside Lane

S	4.2	-0.9
<del>E</del>	4.3	-1.0
H	4.4	-1.1

F.L. Bayside Lane

H	4.6	-1.3
<del>E</del>	4.4	-1.1
S	4.3	-1.0

25' E of F.L. Bayside Lane

S	4.5	-1.2
<del>E</del>	4.6	-1.3
H	4.7	-1.4

52.75' E - H.L. Bayside Walk

H	4.8	-1.5
<del>E</del>	4.7	-1.4
S	4.8	-1.5

TP	4.83	321	4.96	-1.62
----	------	-----	------	-------

Check on Ct. Island Ct			4.85	-1.64
Bayside Lane 768				

Cross Section Along Bayshore Road at 10th Street  
 From Bay Side Lane to Street

81K99-100 16 Yds

Stationing	321 Bl Ford		
	N.L. Bay Side Lane		
S	50	-1.8	
L	49	-1.7	
H	48	-1.6	
	50' N of N.L. Bay Side Lane		
H	52	-2.0	
L	51	-1.9	
S	52	-2.0	
	100' N		
S	51	-1.9	
L	50	-1.8	
H	50	-1.8	
	150' N		
H	50	-1.8	
L	50	-1.8	
S	50	-1.8	
	198' N		
L	Do Garage Conc Floor	4.80	-1.6
S	on Conc Floor	5.11	-1.9
L		4.8	-1.6
H		5.0	-1.8
	240' N		
H		5.0	-1.8
L		4.8	-1.6
S	on Conc Floor	4.99	-1.78

Plotted  
 2-24-37  
 JER

	321		
-4	Do Garage Conc	4.70	-1.49
	273' N		
-4	Do Garage Conc	4.80	-1.59
S	on Conc Floor	4.94	-1.73
L		4.8	-1.6
H		4.9	-1.6
	300' N		
H		4.9	-1.7
L		4.9	-1.7
S		4.9	-1.7
	340' N		
S		5.0	-1.8
L		4.8	-1.6
H		5.0	-1.8
	383' N = E.L. Mission Blvd		
H	Top Cb	4.32	-1.12
H	on Pav 199	4.39	-1.18
L	" "	4.40	-1.19
S	" "	4.50	-1.29
S	Top Cb	4.40	-1.19
	E.Cb Mission Blvd		
S	on Pav 199	4.88	-1.67
L	" "	4.88	-1.67
H	" "	4.87	-1.66



321

H of Mission Blvd.

H on Parking 4.64 -1.43

+ 8 on Grating 4.71 -1.50

S on Parking 4.68 -1.42

H of Mission Blvd.

S on Top Cb. 3.94 -0.73

S on Parking 4.04 -0.83

S on " 4.05 -0.84

H on " 4.04 -0.83

H on top Cb. 3.93 -0.72

40' H of H.L. Mission Blvd.

H 4.8 -1.6

S 4.8 -1.6

S 5.0 -1.8

TP 12.13 10.23 5.11 -1.90

80' H

S - Fly of 3 Garage  
Conc Floor 12.03 -1.80

S 12.1 -1.9

H 12.3 -2.1

110' H

H 12.2 -2.0

S 12.2 -2.0

S - Fly of 3 Garage  
Conc Floor 12.00 -1.8

S 12.2 -2.0

S 12.2 -2.0

S 12.2 -2.0

S 12.2 -2.0

10.23

30

H 12.3 -2.1

175' H 12.2 -2.0

H 12.1 -1.9

S 12.1 -1.9

S 12.1 -1.9

200' H 11.6 -1.4

S 11.7 -1.5

S 11.8 -1.6

H 11.8 -1.6

225' H 10.5 -0.3

H 10.4 -0.2

S 10.3 -0.1

S 10.3 -0.1

250' H 8.6 +1.6

S 8.8 +1.4

S 8.9 +1.3

H 8.9 +1.3

275' H 7.1 +3.1

H 7.1 +3.1

S 7.0 +3.2

S 7.0 +3.2

295' H 5.8 +4.4

S 5.9 +4.3

H 5.6 +4.6

H 5.4 +4.8

+ 4 - 2 Garage Div Floor 5.4 +4.8

10.23

3.25 //

H 4.4 +5.8

L 4.4 +5.8

J 4.5 +5.7

3494 // = EL Strand May

S 3.7 +6.5

L 3.6 +6.6

H 3.6 +6.6

3.35 6.88

TP 4.04 11.29 2.98 7.25

BM 4.20 7.09

o'  
Hail Pole  
Strand May  
Fly  
S.M. B.P.  
S.M. B.P. Barbat  
S.M. B.P.  
7.03

Cross Section Along Between 1st and 2nd Ave. San Francisco

From Strand Way to Bayside Lane

Station 129

BK 5103-104

16' Ht.

SW BR

San Francisco

BM 316 10.19 7.03

EL Strand Way

S 3.8 16.4

L 3.8 16.4

H 3.8 16.4

40' E of EL Strand Way

H 5.4 14.8

L 5.6 14.6

S 5.6 14.6

65' E

S 6.5 3.7

L 7.1 3.1

H on Conc Apron 7.08 3.11

+1 = 1/4 Do Garage Conc Floor 7.05 3.14

83' E

-1 = 1/4 Do Garage Conc Floor 7.10 3.09

H on Conc Apron 7.66 2.53

L 8.1 2.1

S 8.0 2.2

100' E

S 9.2 1.0

L 9.2 1.0

H 9.3 0.9

132' E

H 10.7 -0.5

Plotted  
2-25-37  
JER

10.19

Aug. 28 '31

32

S - 1/4 Do Garage Conc Floor 10.38 -0.17

165' E

S 11.7 -1.5

L 11.7 -1.5

H 11.6 -1.4

200' E

H 12.2 -2.0

L 12.2 -2.0

S 12.1 -2.1

250' E

S 11.9 -1.7

L 11.8 -1.6

H 12.0 -1.8

292' E

H 11.3 -1.1

L 11.2 -1.0

S 11.2 -1.0

+1 = 1/4 Garage Conc Floor 10.70 -0.5

324' E = 1/4 Miss 107 Blvd

S on Top Cb 10.59 -0.90

S on Paving 10.70 -0.51

L " " 10.70 -0.51

H " " 10.53 -0.34

H Top Cb. 10.50 -0.31

10.18

N.C. of Mission Blvd

H	on Paving	11.23	-1.04	
+4.2	on Grating Sump	11.32	-1.13	
L	on Paving	11.20	-1.01	
S	" "	11.17	-0.98	
TP	4.15	3.72	10.62	-0.43

E.C. of Mission Blvd

S	on Paving	5.00	-1.28
L	" "	5.02	-1.30
H	" "	5.00	-1.28

E.L. Mission Blvd.

H	Top Cb	4.38	-0.66
H	on Paving	4.46	-0.74
L	" "	4.46	-0.74
S	" "	4.50	-0.78
S	Top Cb	4.45	-0.73

37' E of E.L. Mission Blvd.

-2.5	-W. of 2 Garages	4.43	-0.71
S	on Conc Apron	4.82	-1.10
L	" "	4.8	-1.1
H	" "	4.7	-1.0

67' E

-2.5	-W. Garage Conc Apron	4.40	-0.68
H	" "	4.6	-0.9
L	" "	4.7	-1.0
S	on Conc Apron	4.85	-1.13

3.72

33

-2.5	-W. of 2 Garages	4.42	-0.72
	102' E		

-4	-W. Garage Dirt Floor	4.7	-1.0
S	" "	5.0	-1.3
L	" "	4.7	-1.0
H	" "	5.0	-1.3

154' E

-2	-W. Garage Conc Apron	4.70	-0.98
H	" "	4.7	-1.0
L	" "	4.9	-1.2
S	" "	5.0	-1.3

200' E

S	" "	4.9	-1.2
L	" "	4.8	-1.1
H	" "	4.8	-1.1

231' E

-4	-W. of 2 Garages Dirt Floor	4.5	-0.8
H	" "	4.8	-1.1
L	" "	5.0	-1.3
S	" "	4.8	-1.1

255' E

-4	-W. Garage Conc Floor	4.47	-0.75
S	on Conc Apron	4.93	-1.21
L	" "	4.8	-1.1
H	" "	4.8	-1.1

872

300 F

H	48	-1.1
L	48	-1.1
S	48	-1.1

335 F

S	51	-1.4
L	49	-1.2
H	50	-1.3

369.3 F - 11/6 Bayside Lane

H	50	-1.3
L	50	-1.3
S	51	-1.4
P	46	-0.94

Cross Section Alley (Between Sombrero + Santa Barbara Pl)  
From Bayside Lane to Strandway

16' wide

370

35

Stat 102129 BIK 107-108 From Page 34

TP	4.64	3.70	-0.94
	H.L. Bayside Lane		
S		4.8	-1.1
L		4.7	-1.0
H		4.6	-0.9
	22' N of H.L. Bayside		
H		4.8	-1.1
L		4.8	-1.1
S on Conc Apron		4.90	-1.10
71.5 - L Garage		4.90	-1.10
	43' N		
-0.8 - L Do Garage Conc Floor		4.90	-1.20
S on Conc Apron		4.93	-1.23
L		4.7	-1.0
H		4.7	-1.0
	70' N		
H		4.8	-1.1
L		4.6	-0.9
S		4.7	-1.0
	100' N		
S		4.6	-0.9
L		4.6	-0.9
H		4.6	-0.9

plotted

141' N

H		4.7	-1.0
L		4.5	-0.8
S on Conc Apron		4.72	-1.02
74 - L Garage		4.52	-0.82
	165' N		
S		4.6	-0.9
L		4.5	-0.8
H		4.7	-1.0
	200' N		
H		4.6	-0.9
L		4.5	-0.8
S		4.6	-0.9
	250' N		
S		4.5	-0.8
L		4.3	-0.6
H		4.5	-0.8
	308' N - E.L. Mission Blvd		
H Top Cb		4.13	-0.43
H on Paving		4.20	-0.50
L		4.15	-0.45
S		4.11	-0.44
S Top Cb		4.06	-0.36
	FCb Mission Blvd		
S on Paving		4.57	-0.87
L		4.56	-0.86

370

H	07 Paving	4.55	-0.85	
TP	9.31	9.33	3.68	0.02
	H.C.B. Mission Blvd.			
H	07 Paving	9.91	-0.60	
+44	02 Grating Sump	9.99	-0.68	
L	07 Paving	9.96	-0.65	
S	"	9.91	-0.60	
	H.L. Mission Blvd.			
S	Top cb	9.28	+0.03	
S	07 Paving	9.31	0.00	
L	"	9.28	+0.03	
H	"	9.23	+0.08	
H	Top cb	9.16	+0.15	
	25' H of H.L. Mission Blvd.			
H		9.9	-0.6	
L		9.9	-0.6	
S		9.9	-0.6	
	50' H			
S		10.1	-0.8	
L		10.1	-0.8	
H		10.3	-1.0	
	75' H			
H		10.4	-1.1	
L		10.3	-1.0	
S		10.4	-1.1	

9.33

36

	100' H		
S		10.5	-1.2
L		10.4	-1.1
H		10.5	-1.2
	125' H		
H		10.4	-1.1
L		10.3	-1.0
S		10.4	-1.1
	146.5' H		
-3'	Garage Conc Appro	9.75	-0.42
S		9.8	-0.6
L		10.1	-0.8
H		10.3	-1.0
	175' H		
H		9.6	-0.3
L		9.5	-0.2
S		10.5	-1.2
	207' H		
S		8.3	+1.0
L		8.2	+1.1
H	H.L. Garage Conc Floor	8.15	+1.18
	216' H		
H	H.L. Garage Conc Floor	7.48	+1.85
L		7.7	+1.6
S		7.8	+1.5

9.33

270.11

S 6.3 +3.0

S 6.4 +2.9

H 6.3 +3.0

275.11

H 4.3 +5.0

S 4.2 +5.1

S 4.2 +5.1

74 1/2 Garage Plank Floor 4.00 +5.33

290.8 1/2 - F.L. Strand Way

S 3.0 +6.3

S 3.1 +6.2

H 3.1 +6.2

B/M 3.30 7.03

SX BP  
 Santa Barbara  
 45th Hall  
 7.03



Cross Section Alley Between Santa Barbara & Jensen Court  
From Strand Way to Mission Blvd. 1.6 Miles

70939-38

Stationing	BIKS III	W.P.	W.P.	W.P.	W.P.	W.P.	W.P.
BM 367	10.70	7.03	10.70	10.9	-0.2		
E. of Strand Way							
S	46	6.1		11.0	-0.3		
S	46	6.1		11.0	-0.3		
H	48	5.9		11.0	-0.3		
48' E of E. of Strand Way							
S	672	3.98	200'	11.1	-0.4		
H	72	3.5		11.2	-0.5		
S	71	3.6		11.2	-0.5		
S	71	3.6					
75'							
S	89	1.8		10.87	-0.19		
S	88	1.9		10.95	-0.25		
H	88	1.9		10.99	-0.29		
H	88	1.9		10.99	-0.29		
100'							
H	100	0.7		10.93	-0.23		
S	100	0.7					
S	100	0.7					
125'							
S	105	0.2		11.45	-0.75		
S	105	0.2		11.54	-0.74		
H	105	0.2		11.57	-0.87		
S	105	0.2		11.49	-0.79		
160'							
S	1088	-0.18					
H	109	-0.2					

Plat

250' E. of Mission Blvd

N. of Mission Blvd

S Top Cb 10.87 -0.19  
 S on Paving 10.95 -0.25  
 S " " 10.99 -0.29  
 H " " 10.99 -0.29  
 H Top Cb 10.93 -0.23  
 H on Paving 11.45 -0.75  
 S " " 11.54 -0.74  
 S Grating Sump 11.57 -0.87  
 S on Paving 11.49 -0.79

Cross Section Santa Barbara Place  
Ocean Front Walk to Bayside Walk

24/11/41

10.70

Plotted  
E.H.P.  
4-11-38

39

Stationing

10.70 B Ford

35' E of E.L. Strand Way

N.L. Ocean Front Walk - Ely Edge Core Walk

N	07 Core Walk	6.07	4.63
S		6.01	4.69
S		6.08	4.62

N		6.5	4.2
S		6.4	4.3
S		6.3	4.4

E.L. Ocean Front Walk

S		6.7	4.0
S		6.9	3.8
N		6.8	3.9

75' F

S	Core Walk	8.46	2.24
S		8.6	2.1
N		8.7	2.0

25' F of E.L. Ocean Front Walk

N		6.2	4.5
S		5.3	5.4
S		5.5	5.2

100' F

N		9.9	0.8
S		9.8	0.9
S		9.8	0.9

50' F

S		5.0	5.7
S		4.9	5.8
N		5.1	5.6

135' F

S		10.9	-0.2
S		10.9	-0.2
N		11.2	-0.5

80' F = N.L. Strand Way

N		4.7	6.0
S		4.6	6.1
S		4.6	6.1

160' F

N		11.5	-0.8
S		11.3	-0.6
S		11.3	-0.6

E.L. Strand Way

S		4.7	6.0
S		4.6	6.1
N		4.7	6.0

200' F

S		11.4	-0.7
S		11.3	-0.6
N		11.5	-0.8

335 F

N		11.4	-0.7
S		11.2	-0.5
S		11.4	-0.7

370.49 F = H.L. Mission Blvd

S	Top Cb	10.75	-0.05
S	07 Paving	10.84	-0.14
S	" "	10.76	-0.06
H	" "	10.86	-0.16
H	Top Cb	10.81	-0.11

H Cb of Mission Blvd

H	07 Paving	11.33	-0.63
S	" "	11.31	-0.61
S	" "	11.34	-0.64

FCB of Mission Blvd

S	07 Paving	11.65	-0.95
S	" "	11.65	-0.95
H	" "	11.65	-0.95
TP	1.37 3.83	11.24	-0.54

FL Mission Blvd

H	Top Cb	4.42	-0.59
H	07 Paving	4.44	-0.61
S	" "	4.32	-0.49
S	" "	4.44	-0.61
S	Top Cb	4.37	-0.54

35 F of FL Mission Blvd

S		4.7	-0.9
S		4.6	-0.8
H		4.6	-0.8

70 F

H		4.7	-0.9
S		4.6	-0.8
S		4.8	-1.0

100 F

S		4.9	-1.1
S		4.7	-0.9
H		4.9	-1.1

135 F

-1	= Top of Bottom Stop Core to School	4.10	-0.3
H		4.7	-0.9
S		4.8	-1.0
S		4.9	-1.1

170 F

S		4.8	-1.0
S		4.7	-0.9
H		4.8	-1.0

200 F

H		4.9	-1.1
S		4.7	-0.9
S		4.9	-1.1

383

212 E

S	074 Code Walk	483	-1.00
S		47	-0.9
H		50	-1.2

228 E

H		50	-1.2
S		48	-1.0
S		47	-0.9
S	= Wly of Cb Top	4.08	-0.25

278.35 = W.L. Boyside Lane

S	= Fly of Cb Top	428	-0.45
S		47	-0.9
S		47	-0.9
H		48	-1.0

E.L. Boyside Lane

H		49	-1.1
S		47	-0.9
S		48	-1.0

85 E of E.L. Boyside Lane

S		49	-1.1
S		44	-0.6
H		48	-1.0

50 E

H		46	-0.8
S		45	-0.7
S		47	-0.9

383

41

89.5 E = W.L. Boyside Walk

S	07 Beard Walk	413	-0.30
S		46	-0.8
S		43	-0.5
H		44	-0.6
H	07 Beard Walk	395	-0.12

Cross Section of Hwy Between Jersey City Kennel Club Ct.  
From Strandway to Bayside Lane 16 W. side

9.52

Aug 23 1942  
Moore  
Survey  
North 3000

Stationing	Blks. 115-116	5th St	6th St
BM 2.49	9.52	9.03	5th St South Side 15th St
E.L. Strandway			
S	3.7	5.8	
S	3.7	5.8	
H	3.7	5.8	
35' E of E.L. of Strandway			
H	5.6	3.9	
S	5.4	4.1	
S	5.5	4.0	
73' E			
-4.5 = E of Garage Core	6.80	2.72	
S	7.6	1.9	
S	7.6	1.9	
H	7.6	1.9	
91' E			
H	8.7	0.8	
S	8.5	1.0	
17 = W of Core Appro	8.20	1.32	
S	8.10	1.42	
73 = W of Garage Core Floor	7.90	1.62	
107.0' E			
-4 = E of Garage Core Floor	7.90	1.62	
S Ground	9.10	0.42	
41 = E of Core Appro	8.85	0.67	
S	9.2	0.3	

P.M. Head

See p 76

H	9.4	0.1
135' E		
H	10.1	-0.6
S	9.9	-0.4
S	9.9	-0.4
170' E		
S	10.3	-0.8
S	10.2	-0.7
H	10.3	-0.8
202.80 = W.L. Mission Blvd		
H Top Curb	9.97	-0.45
H on Paving	10.00	-0.48
S " "	10.05	-0.53
S " "	10.03	-0.51
S Top Curb	9.97	-0.45
W.C. of Mission Blvd		
S on Paving	10.55	-1.03
+5.50 = Grating Sump	10.63	-1.11
S on Paving	10.58	-1.06
H	10.55	-1.03
E.C. of Mission Blvd		
H on Paving	10.88	-1.36
S " "	10.86	-1.34
S " "	10.86	-1.34

952

## E.L. Mission Blvd.

S	Top Curb	10.37	-0.85
S	on Pav 199	10.42	-0.90
L	"	10.36	-0.84
H	"	10.43	-0.91
H	Top Curb	10.36	-0.84

## 35' E of E.L. Mission Blvd.

H		10.8	-1.3
L		10.7	-1.2
S		10.8	-1.3

## 75' E

S		10.9	-1.4
L		10.8	-1.3
H		10.9	-1.4

## 98' E

H		10.9	-1.4
L		10.8	-1.3
S	114 36 Garage Plank Floor	10.8	-1.3

## 127' E

S	114 36 Garage Plank Floor	10.9	-1.4
L		10.9	-1.4
H		10.9	-1.4

## 160' E

H		11.1	-1.6
L		11.1	-1.6
S		11.0	-1.5

952

43

## 202.5 E. W. Broadway

S		11.0	-1.5	
L		10.9	-1.4	
H		11.0	-1.5	
TP	9.51 1.04 1.02	8.12	10.91	-1.39

Cross Section of Alley Between Kennelbark Ct & Kingston Ct  
From Bayside Lane to Street Way

812

44

Stationing	812 Bl Ford	BHS 119-120
N.L. Bayside Lane		
S	9.7	-1.6
L	9.7	-1.6
H	9.7	-1.6
12' W of N.L. Bayside Lane		
H	9.6	-1.5
L	9.6	-1.5
S	9.77	-1.65
L	9.47	-1.35
83' W		
L	9.18	-1.06
S	9.67	-1.55
L	9.5	-1.4
H	9.6	-1.5
100' W		
H	9.6	-1.5
L	9.5	-1.4
S	9.5	-1.4
112' W		
S	9.5	-1.4
L	9.4	-1.3
H	9.28	-1.16
148' W		
L	8.95	-0.73

Plotted

H	9.4	-1.3
L	9.5	-1.4
S	9.4	-1.3
173.5' W of E.L. Mission Blvd		
S Top Cb	9.20	-1.08
S on Paving	9.23	-1.11
L " "	9.26	-1.14
H " "	9.32	-1.20
H Top Cb	9.27	-1.15
E Cb of Mission Blvd		
H on Paving	9.71	-1.59
L " "	9.73	-1.61
S " "	9.71	-1.59
W Cb of Mission Blvd		
S on Paving	9.42	-1.30
15.5 on Grating Sump	9.54	-1.42
L on Paving	9.52	-1.40
S " "	9.44	-1.32
N.L. Mission Blvd		
H Top Cb	8.71	-0.62
H on Paving	8.77	-0.65
L " "	8.83	-0.71
S " "	8.78	-0.66
S Top Cb	8.71	-0.59

8/2

25 W of W.L. Mission Blvd

S	89	-0.8
<del>S</del>	87	-0.6
N	87	-0.6

50 W

N	84	-0.3
<del>S</del>	84	-0.3
S	84	-0.3

75 W

S	76	+0.5
<del>S</del>	76	+0.5
N	74	+0.7

100 W

N	61	+2.0
<del>S</del>	61	+2.0
S	62	+1.9

125 W

S	45	+3.6
<del>S</del>	44	+3.7
N	45	+3.6

151.90 W - E.L. Strand road

N	27	+5.4
<del>S</del>	26	+5.5
S	27	+5.4



Cross Section Hwy. Behind Kingfisher Washin. 06/19/09  
 From Strand Hwy to Bay side Lane

7.22

46

Stationing 812 St Ford Blks 123-124

91 E

TP	1.67	7.22	2.57	5.55
	E.L. Strand Hwy			
S		3.0		+5.2
L		1.9		5.3
H		3.0		5.2
	25' E of E.L. Strand Hwy			
H		3.5		3.7
L		3.3		3.9
S		3.3		3.9
	45' E			
-4	Hwy Garage Conc Floor	4.70		2.52
S	Hwy Conc Apron	4.85		2.37
L		4.3		2.9
H		4.9		2.3
	57' E			
H		5.6		1.6
L		5.4		1.8
S	Hwy Conc Apron	5.52		1.70
+4	Hwy Garage Conc Floor	4.13		2.54
	65' E			
S		6.0		1.2
L		6.0		1.2
H	Conc Apron	5.93		1.29
+2	L Garage Conc Floor	5.29		1.95

P/W Road

H		7.5		-0.3
L		7.5		-0.3
S	Hwy Conc Apron	7.57		-0.35
+1	Hwy Garage Conc Floor	7.44		-0.22
	110.02' E of H. N. 107 Blvd			
-1	Hwy Garage Conc Floor	7.38		-0.16
S	Top Cb	7.97		-0.75
S	on Paving	8.07		-0.85
L	"	8.07		-0.85
H	"	8.07		-0.85
H	Top Cb	8.04		-0.82
	H Cb Mission Blvd			
H	on Paving	8.57		-1.35
+5.5	Grating Sump	8.66		-1.44
S	on Paving	8.59		-1.37
	E.C. Mission Blvd			
S	on Paving	9.04		-1.82
L	"	9.08		-1.86
+2.5	Grating Sump	9.13		-1.91
H	on Paving	9.05		-1.83
	E.L. Mission Blvd			
H	Top Cb	8.53		-1.31
H	on Paving	9.13		-1.91
L	"	9.11		-1.89
S	"	9.11		-1.89

7.22

S	Top 66	8.57	-1.35
	10' F of EL Mission Blvd		
S		8.6	-1.4
L		8.7	-1.5
H		8.5	-1.3
	52' F		
H		8.9	-1.7
L		8.8	-1.6
S		8.9	-1.7
+2	- 1/2 Do Garage Dirt Floor	8.6	-1.4
	75' F		
S		8.8	-1.6
L		8.8	-1.6
H		8.7	-1.5
	100' F		
H		8.9	-1.7
L		9.0	-1.8
S		9.1	-1.9
	117' F		
-1	- 1/4 Do Garage Dirt Floor	9.1	-1.9
S		9.1	-1.9
L		9.0	-1.8
H		8.9	-1.7
	143' F		
H		8.9	-1.7
L		8.9	-1.7

7.22

47

S		8.9	-1.7
11	- 1/4 of 3 Garage Dirt Floor	8.9	-1.7
	153.7 - H.L. Bay Side Lane		
S		9.0	-1.8
L		9.0	-1.8
H		9.1	-1.9

Cross Section San Luis Obispo  
 Bayside Walk to Ocean Front Walk

24/1/40

7.63

Plotted  
 EFB  
 4-4-38

48

Stationing	7.22 Bl Ford		
IP	9.70	7.63	9.29 -2.07
H.L. Bayside Walk			
S	07 Board Walk	7.60	+0.03
L	"	7.80	-0.17
H	"	7.75	-0.12
10 ft of H.L. Bayside Walk			
H		8.1	-0.5
L		8.2	-0.6
S		8.5	-0.9
50 ft			
S		9.3	-1.7
L		9.2	-1.6
H		9.3	-1.7
82.55 ft - E.L. Bayside Lane			
H		9.7	-2.1
L		9.6	-2.0
S		9.7	-2.1
H.L. Bayside Lane			
S		9.7	-2.1
L		9.6	-2.0
H		9.7	-2.1
40 ft of H.L. Bayside Lane			
H		9.6	-2.0
L		9.4	-1.8
S		9.5	-1.9

90 ft of H.L. Bayside Lane			
S		9.4	-1.8
L		9.3	-1.7
H		9.4	-1.8
100 ft			
H		9.2	-1.6
L		9.2	-1.6
S		9.2	-1.6
145.07 ft - E.L. Mission Blvd			
S	Top Cb	8.50	-0.87
S	on Pavine	8.61	-0.98
L	"	8.55	-0.92
H	"	8.55	-0.92
H	Top Cb	8.49	-0.85
FCB of Mission Blvd			
H	on Pavine	8.87	-1.24
L	"	8.90	-1.27
S	"	8.98	-1.35
H.Cb of Mission Blvd			
S	on Pavine	8.58	-0.95
L	"	8.54	-0.91
H	"	8.49	-0.86
H.L. Mission Blvd			
H	on Top Cb	7.86	-0.23
H	on Pavine	7.93	-0.30
L	"	8.00	-0.37

7.63

S	on Paving	8.14	-0.51	
S	Top 66	8.08	-0.45	
12' of H.L. Mission Blvd				
S	on Top 3' Conc Walk	7.12	0.50	Note: -
S	on Paving	7.64	-0.01	3rd year
L	...	7.45	0.18	H.L. Mission
H	...	7.70	-0.07	Blvd & E.L. Strand Hwy
40' H				
H	on Paving	6.05	1.58	Strikes Obscure
L	...	5.49	2.14	Paved Walk
S	...	5.89	1.74	2' Block Spring
65' H				
S	on Paving	4.23	3.40	
L	...	3.73	3.90	
H	...	4.50	3.13	
91.36' = E.L. Strand Hwy				
H	on Paving	2.80	4.83	
L	...	2.50	5.13	
S	...	2.84	4.79	
H.L. Strand Hwy				
S	...	2.5	5.1	
L	...	2.4	5.2	
H	...	2.5	5.1	
30' of H.L. Strand Hwy				
H	...	2.6	5.0	
L	...	2.1	5.5	

7.63

49

S		2.6	5.0	
70' H				
S		2.7	4.9	
L		2.6	5.0	
H		2.8	4.8	
80' H: E.L. Ocean Front Walk				
H		3.1	4.5	
L		3.3	4.3	
S		3.3	4.3	
H.L. Ocean Front Walk: E.L. Edge Conc Walk				
S	on Conc Walk	3.03	4.60	
L	...	3.04	4.59	
H	...	3.03	4.60	
BM		0.63	7.00	

JW BP  
 Ind. 06,000  
 + 5000  
 6.98

Cross Section of Bay Balboa Suburb Prospect Lido Court  
 Strand Way to Bayside Lane  
 16' wide

Stationing 763 of Ford Blks 127-128

EL Strand Way

S	2.6	5.0
L	2.5	5.1
H	2.6	5.0

25' E of EL Strand Way

H	4.3	3.3
L	4.2	3.4
S	4.3	3.3

50' E

S	6.1	1.5
L	6.1	1.5
H	6.2	1.4

746' E = W. L. Mission Blvd

H TopCb	7.43	0.20
H on paving	7.48	0.15
L " "	7.60	0.03
S " "	7.61	0.02
S TopCb	7.53	0.10

W. Cb of Mission Blvd

S on paving	8.04	-0.41
L " "	8.08	-0.45
L originating ramp	8.11	-0.48
H on paving	7.99	-0.36

Plotted

763

50

FCb of Mission Blvd

H on paving	8.32	-0.69
L " "	8.35	-0.72
S " "	8.40	-0.77

EL Mission Blvd

S TopCb	7.93	-0.30
S on paving	8.04	-0.41
L " "	7.95	-0.32
H " "	7.87	-0.24
H TopCb	7.79	-0.16

35' E of EL Mission Blvd

H	8.8	-1.2
L	8.7	-1.1
S	8.9	-1.3

75' E

S	9.3	-1.7
L	9.4	-1.8
H - 2 Do Garage Driv. Elev	9.1	-1.5

100' E

H	9.5	-1.9
L	9.6	-2.0
S	9.6	-2.0

13722 = W. L. Bayside Lane

S	9.7	-2.1
L	9.8	-2.2
H	9.7	-2.1

Cross Section Along Bottom Side of + 1/2 in pool etc.  
 From Strand Way to Bayside Lane 16.71 ft

8.31

Stationing	763	BKs 131-132	
TP	758	836	685 0.78
E.L. Strand Way			
S			3.9 4.5
S			3.8 4.6
H			3.8 4.6
35' E of E.L. Strand Way			
H			61 2.3
S			6.3 2.1
S			5.9 2.5
71'	Do Garage Jct Floor		565 2.71
49.85' E - H.L. Mission Blvd.			
S Top Cb			717 1.19
S on Paving			723 1.13
S " "			724 1.12
H " "			720 1.16
H Top Cb.			710 1.26
H Cb of Mission Blvd.			
H on Paving			783 0.53
75' Grading			792 0.44
S on Paving			789 0.47
S " "			782 0.49
E Cb of Mission Blvd.			
S on Paving			825 0.11
S " "			821 0.15
H " "			814 0.22

Pl. H. 2.0

	E.L. Mission Blvd.	
H Top Cb	765	0.71
H on Paving	781	0.55
S " "	781	0.55
S " "	791	0.45
S Top Cb	798	0.58
15' E of E.L. Mission Blvd		
S - Do Garage Core Floor	827	0.09
S	85	-0.1
H	85	-0.1
50' E		
H	93	-0.9
S	91	-0.7
S	92	-0.8
68' E		
S - Wly of 3 Garage Core Floor	945	-1.09
S	95	-1.1
H	96	-1.2
95' E		
H	10.0	-1.6
S	9.9	-1.5
S - Wly of 3 Garage Core Floor	9.54	-1.18
128.45' E - H.L. Bayside Lane		
S	10.2	-1.8
S	10.1	-1.7
H	10.2	-1.8

Cross Section Alley Between Liverpool St & Manhattan St.  
From Bay side Lane to Strand Way 167 ft

Stationing	836	BKs 135-136	
T	8.7	8.26	8.81 -0.45
	W. Bay side Lane		
S			9.7 -1.4
L			9.6 -1.3
H			9.6 -1.3
	25' W of W. Bay side Lane		
N			9.5 -1.2
L			9.3 -1.0
S	- Conc. Apron		9.50 -1.24
+4	- Garage Conc Floor		9.25 -0.99
	51' W		
-4	- Garage Conc Floor		8.72 -0.46
S	- Conc Apron		8.91 -0.65
L			8.8 -0.5
H			9.2 -0.9
	100' W		
N			7.9 0.4
L			7.6 0.7
S			7.7 0.6
	123.2' W - E. L. Mission Blvd		
S	Top Cb		6.68 1.58
S	on Pav		7.33 0.93
L	" "		7.27 0.99
H	" "		7.32 0.94
H	Top Cb		6.69 1.57

R/W Road

836

52

E. Cb of Mission Blvd

H	on Pav	7.31	1.05
L	" "	7.20	1.06
S	" "	7.22	1.03
	W. Cb of Mission Blvd		
S	on Pav	6.83	1.43
+6	- Grating	6.85	1.41
L	on Pav	6.80	1.46
H	" "	6.75	1.51
	W. L. Mission Blvd		
H	Top Cb	6.10	2.16
H	on Pav	6.13	2.13
L	" "	6.18	2.08
S	" "	6.16	2.10
S	Top Cb	6.10	2.16
	356' W of W. L. Mission Blvd - E. L. Strand Way		
S		3.5	4.8
L		3.5	4.8
H		3.5	4.8

Cross Section Fly Between Manhattan Ct. & E. Carmel Place  
From Strand Way to Bayside Lane 16' wide

Stationing	8.26 Bl Ford	BKS 139-140
IP	460	9.12 3.74 4.52
	E.L. Strandway	
S		4.9 4.2
L		4.8 4.3
H		4.8 4.3
	1' E of E.L. Strandway	
H		4.8 4.3
L		4.9 4.2
S	Fly of Conc Apron	4.95 4.17
+1	Fly of Garage Conc Floor	4.91 4.21
	8' E	
-1	Fly of Garage Conc Floor	4.91 4.21
S	Fly of Conc Apron	5.46 3.66
L		5.1 3.7
H		5.5 3.6
	32.5' E - E.L. Mission Blvd	
H	Top Cb	6.93 2.19
H	on Paving	7.00 2.12
L	"	7.05 2.07
S	"	7.08 2.04
S	Top Cb	7.00 2.12
	H Cb Mission Blvd	
S		7.66 1.46
+6	= Grating	7.73 1.39
L	on Paving	7.70 1.42

Bldg Foot

9.12

H	on Paving	7.70	1.42
	E.Cb of Mission Blvd		
H	on Paving	8.11	1.01
L	"	8.11	1.01
S	"	8.13	.99
	E.L. Mission Blvd		
S	Top Cb	7.52	1.60
S	on Paving	8.15	.97
L	"	8.10	1.02
H	"	8.16	.96
H	Top Cb	7.70	1.42
	37' E of E.L. Mission Blvd		
H		8.9	0.2
L		8.7	0.4
S	on Conc Apron	8.55	0.57
+3	L Garage Conc	8.04	1.08
	65' E		
S	on Conc Apron	9.66	-0.54
L		9.4	-0.3
H	on Conc Apron	9.45	-0.33
+1	Fly of Garage	9.44	-0.32
	91' E		
-1	Fly of Garage	9.30	-0.18
H	on Conc Apron	9.82	-0.70
L		10.0	-0.88



	9.12			
S		10.1		-1.0
	102 F			
S		10.3		-1.2
S		10.2		-1.1
H		10.2		-1.1
+7	↳ Garage Dirt Floor	9.8		-0.7
	120.59 F - H.L. Bayride Lane			
H		10.4		-1.3
S		10.4		-1.3
S		10.5		-1.4
TP	8.73	8.31	9.54	-0.42

Cross Section Ft. Carmel Place  
From Bayside Walk to Ocean Front Walk 31' W. d.

Station	831 Bl. Ford	
	W.L. Bayside Walk	
S on Board Walk	8.83	-0.52
S Ground	9.0	-0.7
L on Board Walk	8.85	-0.54
L Ground	8.9	-0.6
H on Board Walk	8.70	-0.39
H Ground	8.9	-0.6

10' W of W.L. Bayside Walk

H = L 4' Conc Walk	9.22	-0.91
L	9.2	-0.9
S	9.3	-1.0

50' W

S	9.7	-1.4
L	9.7	-1.4
H	9.8	-1.5

80.9' W - I.L. Bayside Lane

H	9.9	-1.6
L	9.7	-1.4
S	9.7	-1.4

W.L. Bayside Lane

S	9.7	-1.4
L	9.6	-1.3
H	9.7	-1.4

8.31

Platted  
E.C.B.  
4-2-38

15' W of W.L. Bayside Lane

H	9.7	-1.4
L	9.5	-1.2
S = L 3' Conc Walk	9.67	-1.36
	35' W	
S = L 3' Conc Walk	8.73	-1.42
S Ground	9.3	-1.0
L	9.0	-0.7
H	9.3	-1.0

11' W

H	9.2	-0.9
L	8.9	-0.6
S = L 3' Conc Walk	8.58	-0.27
S Ground	9.1	-0.8

59' W

S = L 4' Conc Walk	8.43	-0.12
S Ground	8.7	-0.4
L	8.6	-0.3
H	8.9	-0.6
H = L 11' Conc Walk	8.3	0.00

85' W

H	8.2	+0.1
L	8.0	+0.3
S	8.1	+0.2

8.31

120.56 N. E.L. Mission Blvd

S	Topcb	6.80	1.51
S	07 Pav 199	7.39	0.92
L	" "	7.33	0.98
H	" "	7.37	0.94
H	Topcb	6.85	1.46

F. Cb of Mission Blvd

H	07 Pav 199	7.25	1.06
L	" "	7.26	1.09
S	" "	7.25	1.06

N.Cb of Mission Blvd

S	07 Pav 199	6.90	1.61
L	" "	6.66	1.65
H	" "	6.75	1.56

N.L. Mission Blvd

H	Topcb	6.18	2.13
H	07 Pav 199	6.24	2.07
L	" "	6.18	2.13
S	" "	6.27	2.04
S	Topcb	6.20	2.11

35.68 N of N.L. Mission Blvd. E.L. Strand Hwy

S		3.9	4.4
L		3.7	4.6
H		4.0	4.3

8.31

N.L. Strand Hwy

H		3.9	4.6
L		3.5	4.8
S		3.6	4.7

30' N of N.L. Strand Hwy

S		4.1	4.2
L		3.5	4.8
H		4.2	4.1

40' N

H		4.7	3.6
L		4.5	3.8
S		4.5	3.8

80' N - E.L. Ocean Front Walk

S		4.8	3.5
L		4.8	3.5
H		4.8	3.5

N.L. Ocean Front Walk - Fly Edge Cove Walk

H	07 Cove Walk	3.65	4.66
H	Ground	4.1	4.2
L	07 Cove Walk	3.66	4.65
	Ground	4.6	3.7
S	07 Cove Walk	3.63	4.68
S	Ground	4.6	3.7
BM		1.20	7.11

S.M. B.P.  
E. Carmel  
Sea Wall  
7.09

56

Aug 31-31

Cross Section Hwy Between I/Carmel Pt & Monterey Ct  
From Strand Way to Bayside Lane 16 yds.

Stationing	Blks 143-144	SM BR El Carmel Pt 1300/1307
BM 0.27	7.36	7.09
E.L. Strand Way		
S	2.8	4.6
L	2.7	4.7
H of Conc Walkway End	2.80	4.56
13 E of E.L. Strand Way		
H - Fly of Conc Walk	3.17	3.69
L	3.5	3.9
S	3.7	3.7
12 E of Mission Blvd		
S - Top Cb + Pavine	5.30	2.06
L of "	5.28	2.08
H Top Cb +	5.23	2.13
H Cb of Mission Blvd		
H of Pavine	6.03	1.33
L "	6.04	1.32
H Grating Sump	6.06	1.30
S of Pavine	5.97	1.39
E Cb of Mission Blvd		
S of Pav 129	6.34	1.02
L "	6.36	1.00
H "	6.40	0.96
E.L. Mission Blvd		
H of Top Cb	6.08	1.28
H of Pavine	6.13	1.23

Do Not  
4-20-37

7.36

Sept 57

L of Pavine	5.97	1.39		
S "	5.90	1.46		
S Top Cb	5.84	1.52		
26 E of E.L. Mission Blvd				
S - Fly of L Car Garage Dirt Floor	6.55	0.81		
L	7.0	0.4		
H	7.0	0.4		
555 E				
H	7.8	-0.4		
L	7.5	-0.1		
S - Garage Floor	7.6	-0.2		
85 E				
S - Fly of L Car Garage Dirt Floor	7.9	-0.5		
L	8.1	-1.0		
H	8.5	-1.1		
1237 LI - N.L. Bayside Lane				
H	9.1	-1.7		
L	9.0	-1.6		
S	9.0	-1.6		
TP	8.36	6.87	8.85	-1.49

Cross Section Alley Between Monterey St + Hayward St  
From Boyside Lane to Strand Key 12' wide

Stationing 687 Bl. Ford BKS 147-148

W. L. Boyside Lane

S	8.7	-1.8
S	88	-1.9
H	88	-1.9

31' W of W. L. Boyside Lane

H	8.6	-1.7
S	8.3	-1.4
S	8.4	-1.5
+4	Do Garage Duff Floor 8.3	-1.4

59' W

S	8.4	-1.5
S	78	-0.9
H	09 Core Approx 8.08	-1.21
+3	Do Garage Core Floor 79.5	-1.08

76' W

-2	Do Garage Core Floor 76.4	-0.77
H	79	-1.0
S	77	-0.8
S	78	-0.9

100' W

S	72	-0.5
S	71	-0.3
H	74	-0.5

6.87

58

133.8' W = E. L. Mission Blvd

H	Top Cb	6.27	+0.60
H	07 Pav 129	6.40	+0.47
S	" "	6.30	+0.57
S	" "	6.31	+0.56
S	Top Cb	6.20	+0.67

E. Cb of Mission Blvd

S	07 Pav 129	6.74	+0.13
S	" "	6.79	+0.08
H	" "	6.80	+0.07

W. Cb of Mission Blvd

H	07 Pav 129	6.50	+0.37
S	" "	6.52	+0.35
+1.5	07 Grating Sump	6.54	+0.33
S	07 Pav 129	6.41	+0.36

W. L. Mission Blvd

S	Top Cb	5.62	+1.14
S	07 Pav 101	5.68	+1.19
S	" "	5.72	+1.15
H	" "	5.67	+1.20
H	Top Cb	5.61	+1.26

25' W of W. L. Mission Blvd

H		4.4	+2.5
S		4.3	+2.6
S		4.2	+2.7

6-87

471

-1 - Garage Conc Floor 216 +421

S 26 +4.3

S 27 +4.2

H 29 +4.0

57531 - El Strand Hwy

H 22 +4.7

S 20 +4.9

S 20 +4.9

TP. 0.34 721 0.00 6.87

Cross Section Alley Between N. 1st St. & N. 2nd St.  
From Strand Way to Boyside Lane 18' wide

Stationing 721 Bl. Ford Blks 151-152  
E.L. Strand Way 721 = HI

S - W. of Conc Apron	2.40	4.81
L	2.3	4.9
H	2.1	4.7

31' E of E.L. Strand Way

H	4.7	2.5
L	4.3	2.9
S - E. of Conc Apron	4.25	2.95

53' E

S	5.6	1.6
L	5.7	1.5
H	5.8	1.4

73.5' E - W. L. Mission Blvd

H Top Ch	6.92	0.29
H on Paving	7.04	+0.15
L " "	7.01	0.20
S " "	7.00	0.21
S Top Ch	6.88	0.33

W.C. of Mission Blvd

S on Paving	7.73	-0.52
L on Grating Sump	7.90	-0.69
L	7.86	-0.65
L on Grating Drain	7.83	-0.62
H on Paving	7.77	-0.56

721

E.C. of Mission Blvd

H on Grating Drain	8.12	-0.91
L on Paving	8.02	-0.81
S on Grating Drain	8.07	-0.86

E.L. Mission Blvd

S on Top Ch	7.51	-0.31
S on Paving	8.09	-0.88
L " "	8.12	-0.91
H " "	8.21	-1.00
H Top Ch	7.74	-0.53

10' E of E.L. Mission Blvd

-2 - L on Garage Dirt Floor	7.8	-0.6
H	7.8	-0.6
L	7.7	-0.5
S	7.6	-0.4

56' E

-1 - W. 3 Car Garage Conc. Floor	8.34	-1.13
S	8.3	-1.1
L	8.3	-1.1
H	8.7	-1.5

80' E

H	9.1	-1.9
L	8.6	-1.4
S	8.8	-1.6
-1 - E. 1/3 Car Garage Conc. Floor	8.27	-1.06

7:21

100 F

N		90	-1.8
S		88	-1.6
H		94	-2.2

130 F

N		93	-2.1
S		88	-1.6
S		92	-2.0

1567 F - H.L. Boyside Lane

S		93	-2.1	
S		91	-1.9	
H		92	-2.0	
TP	8:31	767	785	-0.64



Cross Section Along Bldg. Part of Sketch + Set of 3000 Place  
From Bayside Lane to Strand Way

62

Stationing 767 Bl Ford Bldgs 155-156

16' W d

14' W d

H	98	-2.1
L	97	-2.0
S	97	-2.0

7' W of 14' Bayside Lane

S	96	-1.9
L	96	-1.9
H	101	-2.4
H	990	-2.2

40' W

H	97	-2.0
L	95	-1.7
S	97	-2.0

60' W

-5	Garage Conc Floor	926	-1.59
S	on Conc. Apron	950	-1.83
L		94	-1.7
H		96	-1.9

100' W

H	92	-1.5
L	91	-1.4
S	90	-1.3

121.5' W

-2	Garage Conc Floor	890	-1.03
S	on Conc. Apron	890	-1.23
L		89	-1.2

767

H	91	-1.4
---	----	------

144' W

H	89	-1.2	
L	86	-0.7	
S	87	-1.0	
+2	Garage Dirt Floor	87	-1.0

182.87' W - E.L. Mission Blvd

S	Top Ch	784	-0.17
S	on Paving	866	-0.99
L	"	859	-0.97
H	"	863	-0.96
H	Top Ch	797	-0.30

E Ch of Mission Blvd

H	on Paving	861	-0.94
L	"	860	-0.93
+6	on Grating Sump	864	-0.97
S	on Paving	861	-0.94

W Ch of Mission Blvd

S	on Paving	825	-0.58
+55	on Grating Sump	830	-0.63
L	on Paving	820	-0.53
H	"	817	-0.50

W.L. Mission Blvd

H	Top Ch	751	+0.16
H	on Paving	761	+0.06
L	"	751	+0.16

7.67

S 07 PAV 129 7.49 +0.18

S Top C6 7.41 +0.23

25' N of 1/2 Mission Blvd.

S 6.4 +1.3

S 6.2 +1.5

H 6.2 +1.4

55' N

H 4.4 +3.3

S 4.3 +3.4

S 4.5 +3.2

84.46' = E. Strand Hwy

S 3.5 +5.2

S 3.5 +5.2

H 3.4 +5.3

TP 6.71 10.01 4.87 3.30

BM 2.94 7.07

S.M.B.P.  
Sag Harbor Place  
+ Strand Hwy  
7.07

50' wide  
10' els  
7.8' 1/4

Francis St. X Sec

N line Ocean View Blvd - North.

indexed  
CSK.

12.5-31  
Miller  
Walker  
Bliss  
S.E. 35th +  
Ocean View

BM Top Hydt	0.47	68.85	68.38
		S. ch line Ocean View	65.99
E. line 35 <sup>th</sup>	Top cmt. el.	2.86	65.99 Profile 66.00
W. " 35 <sup>th</sup>	" " "	2.86	" 66.00
T.P.	0.30	56.24	55.94
		N. ch. line Ocean View	
E cmt. el		10.40	46.04
E gutter parmt		10.80	45.44
el "	"	10.92	45.32
1/4 "	"	11.04	45.20
1/4 "	"	11.22	45.02
1/4 "	"	11.49	44.75
el "	"	11.70	44.54
W "	"	12.02	44.22
W cmt. el		11.20	45.04
		O O = N. line Ocean View	
W		10.8	45.4
W. ch.		11.16	45.08
gutter parmt		11.74	44.50
1/4 "	"	11.17	45.07
1/4 "	"	10.72	45.52
1/4 "	"	10.72	45.52
gutter "	"	10.85	45.39
E. ch "	"	10.19	46.06
E. "	"	7.9	48.34
		H'N	
E		6.4	49.8
+5		8.7	47.6

56.24

el		2.8	48.4
+4		7.9	48.3
+5		9.3	46.9
1/4		9.6	46.6
1/4		9.4	46.8
1/4		10.0	46.2
+2		10.2	46.0
+4		7.9	48.3
el		6.6	49.6
W		5.9	50.3
		14. N.	
W		3.2	53.0
el		3.1	53.1
+2		5.6	50.6
1/4		6.6	49.6
1/4		6.1	50.1
1/4		6.0	50.2
+4		4.5	51.7
el		2.3	53.9
E		1.4	54.8
T.P.	10.37	66.34	0.27
		50' N.	55.97
E		8.8	57.5
1/4		10.0	56.3
1/4		10.1	56.2
E		10.2	56.1

66.34

50' N. (cont.)

1/4	10.5	55.8
+5	10.7	55.6
cl	9.9	56.4
+9	9.7	56.6
W	8.3	58.0
82' N		
W	6.4	59.5
cl	7.5	58.8
1/4	7.3	59.0
cl	7.2	59.1
1/4	7.3	59.0
+6	7.7	58.6
cl	6.8	59.5
E	6.4	59.9
100' N		
E	4.7	61.6
+2	5.7	60.6
cl	6.0	60.3
+1	6.4	59.9
1/4	6.2	60.1
cl	6.2	60.1
1/4	6.4	59.9
+6	6.7	59.6
cl	6.4	59.9
+9	6.4	59.9
W	5.7	60.6

66.34

Francis St 45cc.

135' N.

W	5.1	61.2
cl	5.5	60.8
+1	5.9	60.4
1/4	5.5	60.8
cl	5.3	61.0
1/4	5.4	60.9
+6	5.4	60.7
cl	5.2	61.1
+7	4.7	61.6
E	3.7	62.6
145' N.		
E	2.8	63.5
+3	4.0	62.3
cl	4.7	61.6
1/4	4.9	61.4
cl	4.8	61.5
1/4	5.0	61.3
+6.5	5.4	60.9
cl	5.0	61.3
+8	4.9	61.4
W	3.8	62.5
200' N		
W	4.0	62.3
+3	5.0	61.3
cl	5.2	61.1
+1	5.7	60.6

65

66.34

200' N. (con)

'14	5.2	61.1
±	4.7	61.6
'14	4.7	61.6
+6	4.8	61.5
cl	4.2	62.1
+6	3.5	62.8
±	2.6	63.7
235' N		
±	3.0	63.3
+4	4.0	62.3
cl	4.5	61.8
'14	4.4	61.8
±	4.9	61.4
'14	5.4	60.9
+6	5.9	60.4
cl	5.6	60.7
+7	5.5	60.8
W	4.4	61.9
265' N		
W	5.0	61.3
+2	6.0	60.3
cl	6.2	60.1
'14	5.4	60.5
±	5.3	61.0
'14	5.3	61.0
cl	5.2	61.1

66.34

Francis St 2 Sec.

66

+7	4.6	61.7
±	3.4	62.9
300' N		
±	4.9	61.4
+9	5.4	61.9
cl	5.9	60.4
'14	5.8	60.5
±	5.7	60.6
'14	6.2	60.1
cl	6.6	59.7
W	6.4	59.9
350' N		
W	4.7	59.6
+9	6.5	59.8
cl	7.0	59.3
'14	6.6	59.7
±	6.2	60.1
'14	6.2	60.1
+6	4.3	60.0
cl	5.9	60.4
±	5.4	60.9
390' N = S. Line Franklin Ave		
±	5.3	61.0
+1	5.7	60.6
cl	6.1	60.2
'14	6.1	60.2

50' width  
10' chs  
7.5' 1/4 s.

66.34  
S. line Frankl'n Ave

±	6.4	59.9
"4	6.5	59.8
el	6.6	59.7
W	6.9	59.4
S. el		
W	7.1	59.2
el	6.8	59.5
"4	6.4	59.7
±	6.4	59.9
"4	6.2	60.1
el	5.9	60.4
E	5.8	60.5
S. "4		
E	5.7	60.6
el	5.9	60.4
"4	6.2	60.1
±	6.4	59.9
"4	6.6	59.7
el	7.0	59.3
W	7.2	58.1
±		
W	7.4	58.9
el	7.0	59.3
"4	6.6	59.7
±	6.4	59.9
"4	6.1	60.2

66.34

Francis St. 2 Sec

67

el	6.0	60.3
E	5.9	60.4
N. "4		
8	5.9	60.4
el	6.0	60.3
"4	6.2	60.1
±	6.5	59.8
"4	6.6	59.7
el	6.7	59.4
W	7.5	58.8
N. el		
W	7.5	58.8
el	7.1	58.2
"4	6.7	59.6
±	6.6	59.7
"4	6.3	60.0
el	6.1	60.2
E	6.0	60.3
00 = N. line Frankl'n Ave		
E	5.7	60.6
el	6.3	60.0
"4	6.4	59.9
±	6.7	59.6
"4	6.9	59.4
el	7.1	59.2
W	7.5	58.8
+ 5	7.9	58.4

66.34

50' N,

-5	8.1	58.2
W	7.7	58.6
cl.	7.8	58.5
14	7.6	58.7
±	7.1	59.2
14	7.1	59.2
cl	6.9	59.4
+8	6.3	60.0
E	5.3	61.0

100' N.

E	6.6	59.7
+2	7.1	59.2
cl	7.5	58.8
14	7.8	58.5
±	7.8	58.5
14	8.1	58.2
+3	8.5	57.8
cl	8.5	57.8
W	8.7	57.6
+10	10.4	55.8

150' N

-10	11.4	54.9
W	9.5	56.8
cl	8.4	57.5
14	8.4	57.5
±	8.4	57.9

66.34

Francis St 7 Sec.

68

14	8.4	57.9
cl	8.4	57.9
E.	7.7	58.6

164' N

5' W of W. Line

9.00 57.3

ent wall to house

205' N

-10	9.20	54.3
E	8.4	57.9
cl	8.5	57.8
11	9.2	57.1
14	8.8	57.5
±	8.9	57.4
14	9.2	57.1
cl	9.3	57.0
W. = Front garage	9.4	56.9

Int. Floor

212' N

-10	11.3	55.0
W	9.3	57.0
cl	9.4	56.9
14	9.2	57.1
±	9.0	57.3
14	9.3	57.0
+3	9.7	56.6
cl	9.3	57.0
E	9.2	57.1
+10	9.4	56.9
T.P.	9.01	57.33

Indexed C.S.R.	Levels at Univ + Euclid		12-15-31 Miller Walker Bliss N.W. Univ & Euclid
B.M.	5.71	346.39	340.68
	50' N. of N. Line Univ.		
E. line	5.8		340.6
+ 3.5 = E. edge cnt. walk.	5.95		340.44
+ 8.5 = W. " " "	6.10		340.29
+ 12' = E. ed. line	6.20		340.19
gutter	6.85		339.54
+ 5.	6.69		339.70
	N. line Univ.		
E. line	5.3		341.09
+ 3.5 = E. edge cnt. walk	5.44		340.95
+ 8.5 = W. " " "	5.60		340.79
+ 12' = cnt. ed.	5.67		340.72
gutter	6.32		340.07
+ 5	6.20		340.19
	0.5 S. of N. line Univ = S. end. cnt. walk		
	5.0 S. of N. line Univ = P.C. 10' Rad. Ret		
E. ed.	5.61		340.78
gutter	6.21		340.18
+ 5' W.	6.12		340.27
	10' S. of N. line Univ.		
5' W. of E. ed. line	5.99		340.40
" " " produced	6.11		340.28
1.2 E. of E. ed. line = gutter	6.13		340.26
1.2 " " " = cnt. d.	5.51		340.88

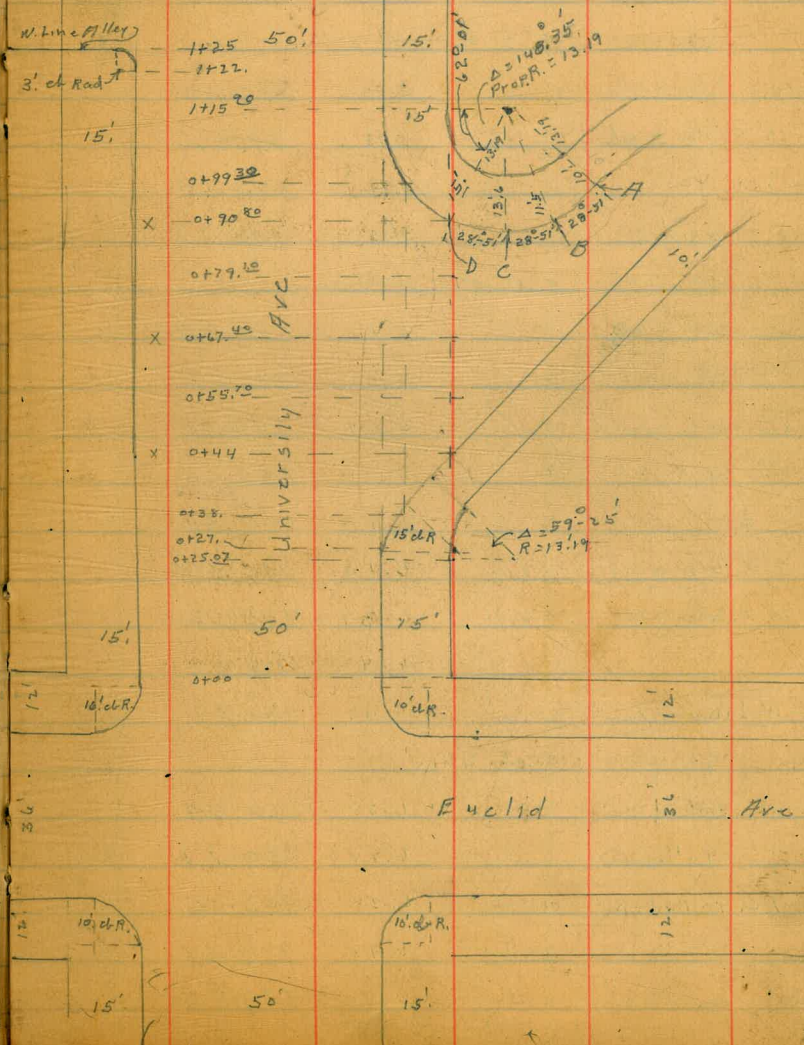

P.M. 12-15-31



346.39

15' S. of N. Line Univ = N. ch. Line

E. line Euclid. cnt. ch	5.32	341.07
" " " gutter	5.79	340.60
+2' W = P.C. 10' Rad. Ret. ch	5.32	341.07
+2' " " " " "	5.47	340.52
+12' W E. ch	5.96	340.43
+17' W	5.87	340.52

5' S. of N. ch. of Univ

17' W. of E. line	5.73	340.66
12' W " " " = E. ch	5.73	340.66
2' " " " "	5.71	340.68
E. line Euclid	5.63	340.76

5' N. of S. ch. Univ

E. line	5.41	340.98
+2	5.57	340.82
+12 = E. ch	5.64	340.75
+21' = E. '4	5.74	340.65
+30' = $\Phi$	5.89	340.50
+39 = W '4	6.10	340.29
+48 = W. ch	6.37	340.02
+58	6.47	339.92
+60 = W. Line	6.47	339.92

S. ch. Univ

W. line cnt. ch	6.35	340.04
" " gutter	6.78	339.61
+2' S = P.C. 10' Rad. Ret. cnt. ch	6.33	340.06
" " " " gutter	6.78	339.61
ch	6.54	339.85

346.39

Euclid

70

"4	6.24	340.15
$\Phi$	6.00	340.39
"4	5.85	340.54
ch	5.73	340.66
+10. = 10' Rad Ret gutter	5.58	340.81
" " " " cnt. ch	5.13	341.26
E. line " "	5.14	341.25
E. " gutter	5.50	340.89

5' S. of S. ch. line

1.2 E. of E. ch. line Top ch	5.25	341.14
1.2 " " " " gutter	5.83	340.56
E. ch. line	5.85	340.54
"4	6.01	340.38
$\Phi$	6.09	340.30
"4	6.33	340.06
W. ch. line	6.78	339.61
+1.2 = gutter	6.83	339.56
+1.2 = Top ch	6.36	340.03

10' S. of S. ch. = P.C. 10' Rad Ret.

W. ch	6.35	340.04
gutter	6.87	339.52
"4	6.48	339.91
$\Phi$	6.18	340.21
"4	6.13	340.26
gutter	5.94	340.45
E. ch.	5.35	341.04

346.39

15's. of S. ch. = S. line Univ.

E. Line	5.14	341.25
#7. on cmt walk	5.26	341.13
E. ch. Nacl. in cmt. drive	5.94	340.45
1/4	6.13	340.26
⊕	6.31	340.08
1/4	6.53	339.86
gutter	6.89	339.50
W. ch.	6.29	340.10
W. line	6.22	340.17
0+27' S = S. end. cmt. drive on E.		
E. ch. line No. ch. in cmt. drive	6.58	339.81
5' E. on cmt. walk	5.96	340.43
0+29' S		
W. ch.	6.79	339.60
gutter	7.20	339.19
1/4	6.67	339.72
⊕	6.27	340.12
1/4	6.41	339.98
gutter	6.60	339.79
cmt. ch	6.14	340.25
E. line solid walk - ch to Prop.	5.87	340.52
0+52		
E.	6.32	340.07
ch	6.73	339.66
gutter	7.29	339.10
1/4	6.86	339.53

346.39

Enclid

71

⊕	6.68	339.71
1/4	7.04	339.35
gutter	7.53	338.86
W. cmt. ch	7.16	339.23
0+55		
E. ch. line No. ch. N. end cmt. drive	7.40	338.99
5' E. on walk	6.57	339.82
0+69		
E. ch. line No. ch. S. end - cmt. drive	7.67	338.72
5' E. on walk	6.87	339.52
0+71		
W. ch	7.50	338.89
gutter	7.89	338.50
1/4	7.37	339.02
⊕	7.02	339.37
1/4	7.29	339.10
gutter	7.69	338.70
E. ch.	7.08	339.31
E. line	6.81	339.58
0+93		
E	7.30	339.09
ch	7.67	338.72
gutter	8.19	338.20
1/4	7.83	338.56
⊕	7.58	338.81
1/4	7.89	338.50

346.39

0493 (204)

w gutter	8.41	337.98
w. cl.	7.92	338.49
1408		
w. cl.	8.15	338.24
gutter	8.74	337.65
"	8.28	238.11
⊕	8.04	338.35
"	8.33	338.06
gutter	8.73	337.66
cl.	8.20	338.19
E.	7.65	338.74

1415

E	7.75	338.64
cl.	8.38	338.01
gutter	9.08	337.31
"	8.65	337.74
⊕	8.28	338.11
"	8.50	337.89
gutter	8.96	337.43
w. cl.	8.31	338.08

1418

E. ch. hino No. cl. in emt. drive	9.25	337.14
S.E. on walk	8.32	338.07

346.39

1423

Euclid

72

w. cl.	8.44	337.95
gutter	9.80	337.09
"	8.88	337.51
⊕	8.54	337.85
"	9.06	337.33
gutter nod	9.48	336.91
+5.	8.88	338.01
E. hino	7.71	338.68

1430

E. gutter ho cl. S. end emt drive	9.73	336.66
S.E. on walk	8.39	338.00

1434 on E cl. } N. End cl. in hets  
 1434 " W " }

E	8.09	338.30
cl.	8.70	337.69
gutter	9.83	336.56
"	9.34	337.05
⊕	8.82	337.57
"	9.27	337.12
gutter	9.88	336.51
w. cl.	8.61	337.78

1439.5 on W } = ⊕ ch. in hets  
 1441.5 " E }

w. cl.	8.61	337.78
gutter	9.95	336.44
+3'	9.90	336.49
"	9.44	336.95
⊕	9.05	337.34
"	9.55	336.84

346.39

gutter	9.97	336.42
ch.	8.70	337.69
E. line	8.30	338.09
	1+47 on W. ch. 1+49 " E "	S. end ch inlets
E.	8.31	
ch	9.72	337.67
gutter	9.84	336.55
1/4	9.34	337.05
ch	8.83	337.56
1/4	9.30	337.09
gutter	9.93	336.46
W. ch	8.61	337.78
	1+61	
W. ch	8.53	337.86
gutter	9.40	336.99
1/4	8.91	337.48
ch	8.00	337.79
1/4	8.91	337.48
gutter	9.43	336.96
E. ch	8.61	337.78
E. line	8.31	338.08
	1+90 = S. end Full width walk on E	
E	8.04	338.34
+2 = E. edge walk to S.	8.12	338.27
+7 = W " " " S.	8.22	338.17
ch	8.39	338.00

346.39

Euclid

73

gutter	8.84	337.50
1/4	8.45	337.94
ch	8.08	338.31
1/4	8.36	338.03
gutter	8.74	337.61
W. ch.	8.34	338.01
T.P.	7.24	347.96
	5.71	340.68
	University Ave	
	N. side Univ. No. Walk East. of Euclid	
S "	" Full width walk Euclid to Reno. St.	
S "	" No walk E. of Reno. St. - No Return S.E. Univ Ave + Reno.	
	or 00 = E. line Euclid	
N. ch.	6.84	341.08
gutter	7.35	340.61
+ 5' S of N ch	7.23	340.73
5' N of S. ch	7.00	340.96
gutter	7.07	340.89
S. ch	6.71	341.25
+ 5. on walk	6.65	341.31
S. " "	6.65	341.31
	+ 25 <sup>21</sup> P.C. 13.19 Prop. Rad. on S.	
S on walk	5.90	342.06
+ 10 " "	5.98	341.98
ch	6.07	341.89
gutter	6.85	341.11
+ 5' N. of S. ch.	6.73	341.23

347.96

0+250<sup>7</sup> E.

5' s. of N. ch	6.89	341.07
gutter	6.98	340.98
N. ch.	6.56	341.40

0+27. P.C. 15' Rad. Return 15. W. Univ. Reno

5' N. of s. ch.	6.70	341.26
gutter	6.78	341.18
S. ch.	6.07	341.89
+ 5 on walk	5.96	342.00
+ 15 = S. Line "	5.87	342.09

0+38 E.

S. Line on walk	5.71	342.25
+ 10 Top ch. on 15' ch. Rad.	5.97	341.99
+ 10 gutter	6.69	341.27
S. ch. line	6.68	341.28
5' N.	6.56	341.40

0+44 E.

S. line = N. ch. line Reno Ind. Ave	6.47	341.49
+ 10	6.55	341.41
+ 15 = s. ch. line	6.61	341.35
+ 20	6.49	341.48
+ 60	6.55	341.41
+ 65 = N. gutter	6.75	341.21
N. cent. ch	6.25	341.71

347.96

0+5520 E.

20' N. of S. line	6.27	341.69
15' N. " " " = ch. line	6.37	341.59
10' " " " "	6.16	341.80
S. line	6.01	341.95

0+67.40 E.

S. line	5.81	342.15
10' N. of S. line	5.98	341.98
15' " = ch	6.17	341.79
20' "	6.07	341.89
60' N	6.31	341.65
65' N = N. gutter	6.43	341.53
N. ch.	5.71	342.05

0+79.60 E.

20' N. of S. line	6.01	341.95
15' " " " " = ch. line	6.04	341.88
10' " " " "	5.90	342.06
S. line	5.65	342.31

Sec. A. Plat Page 69.

23.19 from Prop. Rad. on curb	4.2	343.76	Top 90°
" " " " gutter	4.88	343.08	
28.19 " " " on pavmt.	4.79	343.17	
Sec. B.			
24.69 from Prop Rad. on ch.	4.6	343.36	Top 90°
" " " " gutter	5.13	342.83	
29.69 " " " pavmt.	5.14	42.82	

Univ Ave

74

347.96

Sec. C.

26.79	from Prop Rad.	on curb	4.9	43.1	Top gene	N. ch.	5.05	42.91
"	"	"	gutter	5.45	42.51		5.65	42.31
31.79	"	"	parmit	5.44	42.52	+5's.	5.45	42.51

0+90<sup>20</sup> E

5. line	Univ. at Sec D.	on curb	5.1	42.19	Top gene	20' s. of N. line	5.45	42.51
"	"	"	gutter	5.62	42.34	15' s. " " = N. ch. line	5.53	42.43
10' N. of s. line		on paymt.	5.79	42.17		12' s. " " = E.C. 3' Rad. ch. Rd.	4.95	43.01
15' " " "		= s. ch.	6.03	41.93		12' " " " = " " " "	5.41	42.55
20' " " " "			5.85	42.11		10' s. " " " cnt. ch	4.93	43.03
60' " " " "			6.00	41.96		10' s. " " " gutter	5.30	42.66
65' " " " "		= N. gutter	6.12	41.84		N. line cnt. ch	4.77	43.19
N. ch.			5.53	42.43		" " gutter	4.91	43.05

0+89.30

20' N. of s. line			5.71	42.25		s. ch.	4.47	43.49
15' " " "		= s. ch. line	5.95	42.01		gutter	5.10	42.86
10' " " "		= gutter	5.79	42.17		+5' N.	4.92	43.04
10' " " "		= cnt. ch.	5.3	42.7	Top gene			

1+15<sup>20</sup> = E.C. Ret. ons.

5. ch			5.04	42.85		s. ch	3.89	44.07
gutter			5.60	42.36		gutter	4.44	43.52
+5.			5.53	42.43		+5' N.	4.22	43.74
5' s. of N. ch.			5.61	42.35		chk original B.M.	7.28	340.68
gutter			5.75	42.21				
N. ch.			5.18	42.75				

347.96

Univ Ave

75

1+22' E

5.05	42.91
5.65	42.31
5.45	42.51

1+25' E

5.45	42.51	
5.53	42.43	
4.95	43.01	cnt. ch
5.41	42.55	gutter
4.93	43.03	
5.30	42.66	
4.77	43.19	
4.91	43.05	

1+65<sup>20</sup>

4.47	43.49
5.10	42.86
4.92	43.04

2+15<sup>20</sup>

3.89	44.07
4.44	43.52
4.22	43.74
7.28	340.68

Moore  
5-27-36

Alley 115-116 Mission Beach  
Garage floor. El. <sup>c</sup>

76

See p 42

BM. BP	3-27	10.30	703	Seawall Santa Barbara	
0+00 = Ely Strandway p 42 this Book					
0+33					
N	wly edge	Con. Apron	6.22	4.08	
0+57					
N	Ely	" " "	6.65	3.65	
0+66					
S	wly edge	Bd. Apron	8.07	2.23	
+5	"	Conc. floor	7.62	2.67	Garage
0+81.5					
-5	Ely	" " "	7.65	2.65	"
S	"	Bd Apron	8.95	1.35	
0+91					
1.2'	in alley	Conc. Apron	9.02	1.28	wly edge
S+2.3	Conc.	Gar. floor	8.71	1.59	" "
1+07					
1.2'	in alley	Conc. Apron	9.67	0.63	Ely "
S+2.2	Conc.	Gar. floor	8.71	1.59	" "
1+83					
S-2.2	wly edge	Con. Apron	10.20	-0.10	
S-4.2	"	" fl. Gar	10.12	0.18	
1+98					
S-2.2	Ely edge	Con. Apron (10#)		-0.11	
S-4.2	"	" fl. garage	10.12	0.18	

Xsec Santa Barbara Pl. 2' wide  
M. Blvd. To Bayside walk

Santa Barbara  
Seawall

SWSP	2.45	9.68	7.00	
T.P.	4.63	4.06	10.25	-0.57
0-10	+ E 907. M. Blvd.			
S Pav		5.05		-0.99
N "		5.04		-0.98
00				
N Pav.		4.70		-0.64
0 "		4.59		-0.53
S. "		4.64		-0.58
0+05				
S		4.65		-0.59
c		4.44		-0.38
N		4.35		-0.29
0+30				
N		4.68		-0.62
c		4.56		-0.50
S		4.78		-0.72
0+50				
S		4.85		-0.79
c		4.67		-0.61
N		4.67		-0.61
0+75				
N		4.80		-0.74
c		4.70		-0.64
S		4.95		-0.89

4.00

77

1+00	S	4.95	-0.89
	c	4.74	-0.68
	N	4.87	-0.81
1+30	N	4.89	-0.83
	c	4.76	-0.70
	S	4.90	-0.90
1+65	S	4.95	-0.89
	c	4.84	-0.76
	N	4.78	-0.72
2+00	N	4.96	-0.90
	c	4.88	-0.82
	S	5.05	-0.99
2+12	S E 4' walk	5.08	-1.02
	c	4.89	-0.83
	N	5.05	-0.99
2+28	N	5.13	-1.07
	c	4.89	-0.83
	S	4.90	-0.87
	S beg curb	4.33	-0.27



4.00

2 + 50				
S cb	4.43	-0.37		
S pay	4.93	-0.87		
c "	4.84	-0.76		
N "	5.00	-0.94		
2 + 78.55				
W + Bayside Lane				
N	4.75	-0.69		
c	4.75	-0.69		
S	5.06	-1.00		
S cb	4.54	-0.48		
E.L. B.S. Lane = 00				
S pay end	5.05	-0.99		
c "	5.03	-0.97		
N "	5.09	-1.03		
0 + 22				
N E 3' Cent. mt	5.11	-1.05		
c dirt	4.6	-0.5		
S "	5.0	-0.9		
W + Bayside walk				
S dirt	4.6	-0.5		
N "	4.5	-0.4		
T.P.	4.44	3.96	4.54	-0.48

XSec Bayside Lane  
Santa Barbara N. Sly to Ja  
3.96

78

SL S.B. Pl. 000				
0 + 30				
E	4.87	-0.93		
c	4.87	-0.91		
W	5.08	-1.12		
W cb	4.58	-0.62		
0 + 50				
W cb	4.57	-0.61		
W 2.5 x 2.5 grate	5.24	-1.30		
c	4.95	-0.99		
E	4.84	-0.88		
0 + 81				
E	4.84	-0.88		
c	4.88	-0.92		
W	5.02	-1.06		
1 + 00 end pav.				
W	4.98	-1.02		
c S.M.H. Rim	4.78	-0.82		
E	4.80	-0.84		
1 + 40				
E N edge Cent. Apron	5.06	-1.10		
c	5.5	-1.5		
W	5.3	-1.3		
1 + 70				
W	5.4	-1.2		

396

c	5.5	-1.5
E Sedge Cent April	5.02	-1.06

79

