

CROWN POINT  
SEWERS

NAME.....

Class..... Course..... Party.....

WATSON, VALLE & COUGH, INC

~~383~~

# FIELD NOTES

No. 403P

ESPECIALLY ADAPTED

TO THE USE OF

ENGINEERING STUDENTS

1463

EUGENE DIETZGEN Co.

MANUFACTURERS

DRAWING MATERIALS

MATHEMATICAL AND SURVEYING INSTRUMENTS

MEASURING TAPES

CHICAGO SAN FRANCISCO NEW YORK  
NEW ORLEANS PITTSBURGH



MICROFILMED

DEC 23 1964

M.H.#7

7

B



E.P. Chilton  
 J. Thompson  
 E. Rodier  
 7-9-1927

FRONTERA & MOORLAND

			19.07	Guinea	4' South M.H. #59 set previously	
	619	25.26				
0+00	Boundary Line	-7.90	17.36	7 <sup>7</sup>	+9.66	Riser Plug.
0+26		7.45	17.81	7.81	+10.00	stakes offset 4'
0+60		6.56	18.70	7.95	+10.75	
0+98		6.14	19.12	8.10	+11.02	
1+21 <sup>60</sup>	M.H. #59	6.19	19.07	8.20	+10.87	South Guinea
		6.51	18.75	8.20	+10.55	West "
1+59		3.61	21.65	8.31	+13.34	
1+89 <sup>30</sup>	D.M.H. #47	1.86	23.40	8.40	+15 <sup>00</sup>	North Guinea 8" Sewer
				19.00	+4.40	" "
		1.53	23.73	8.40	+15.23	East Guinea 8" "
				19.01	+4.73	" "
2+14 <sup>30</sup>	P.L.	1.16	24.10	8.50	+15.60	8"
				19.18	+4.92	6"



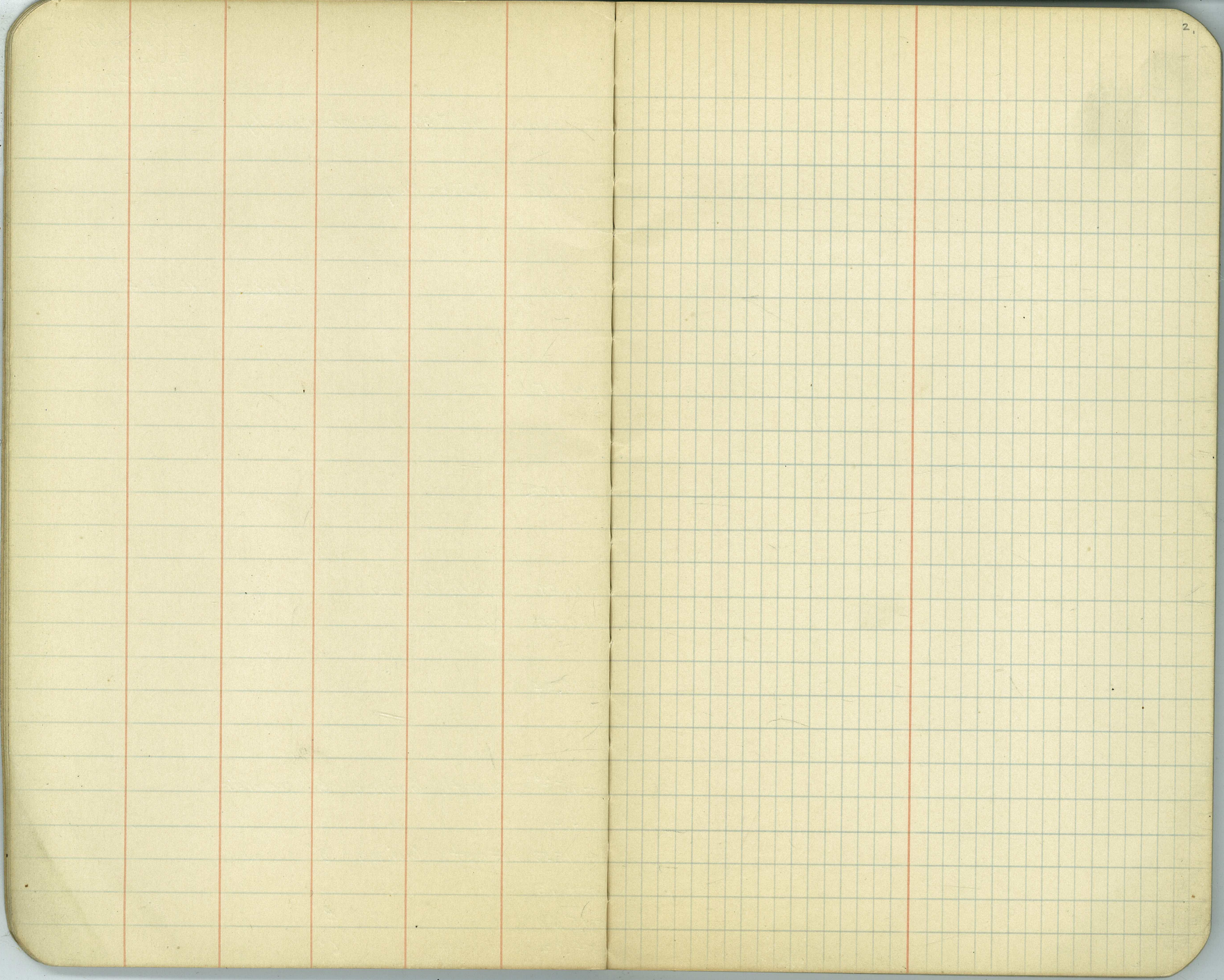







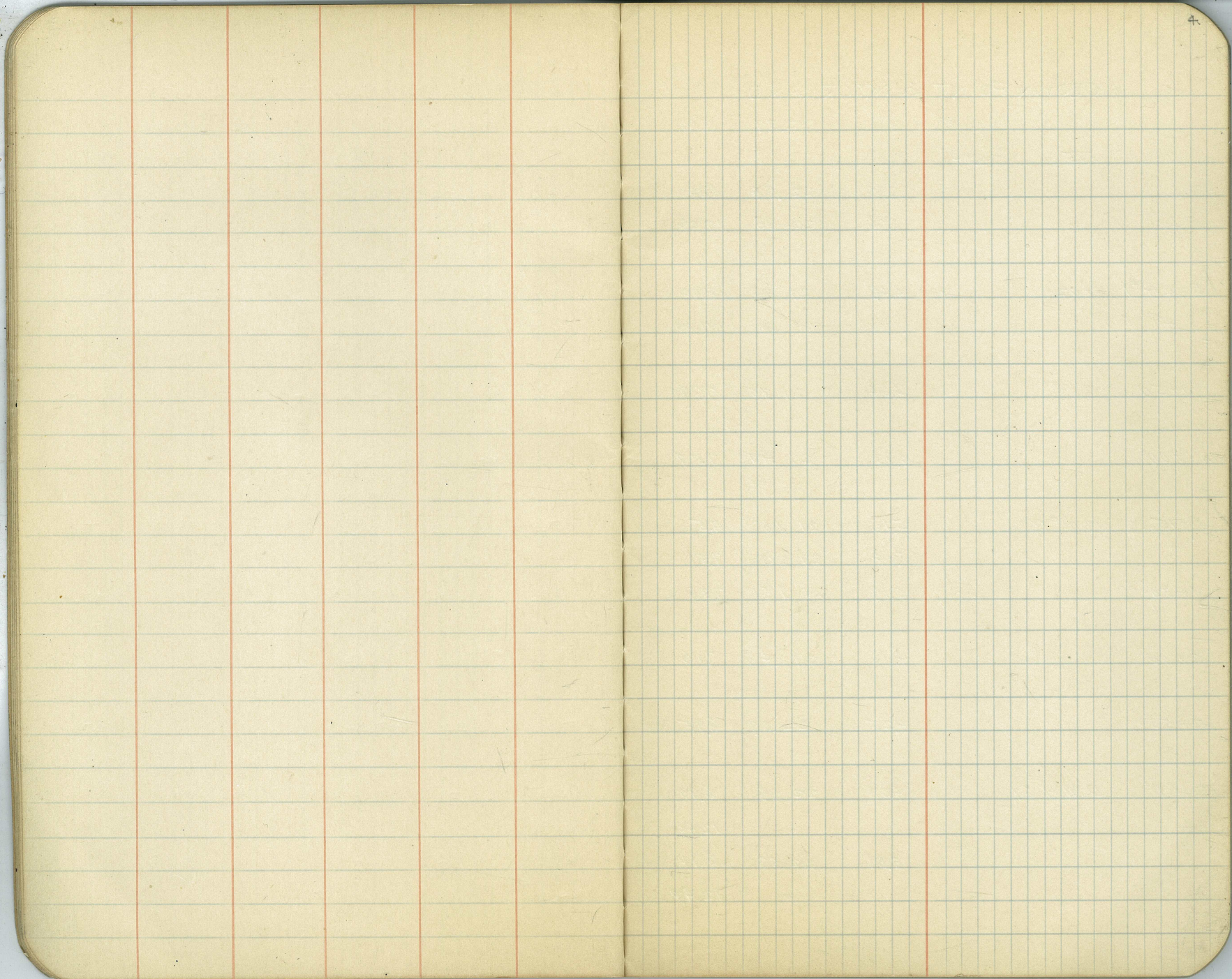



E.P. Chilton  
 J. Thompson  
 E. Rodier  
 6-17-1927

CROWN POINT & MOORLAND

			22.39	B.M.		Iron pipe P.C. on Crown Point Drive
	395	2634				
P.L.			3.66	22.68	8.10	+14.58 Bottom
P.L.			3.66	22.68	17.23	+5.45 Top
D.M.H.#1	0702		4.46	21.88	8.00	+13.88 North Guinea Bottom
					17.00	+4.88 North Guinea Top
						No Elev. West Guinea
0+50			4.64	21.70	7.79	+13.91
1+00			4.93	21.41	7.57	+13.84
1+15	M.H.#66		5.16	21.18	7.5	+13.68 South
			5.14	21.20	7.5	+13.70 East
1+50			5.19	21.15	7.36	+13.79
2+00			4.86	21.48	7.16	+14.32
2+50			4.25	22.09	6.95	+15.14
2+61 <sup>1/2</sup>	D.M.H.#67		4.08	22.26	6.90	+15.36 East Guinea Bottom
			"	"	12.40	+9.86 Top
			3.81	22.53	6.90	+15.63 North " Bottom
			"	"	12.40	+10.13 " " Top



46 00

26.34

M.H. #65

3.79	22.55	12.70	+9.85	Top Sewer
"	"	18.00	+4.55	Bottom

33.75

2.68	23.66	18.25	+5.41
------	-------	-------	-------

D.E. 67<sup>s</sup>

<del>3.00</del>	<del>23.34</del>	<del>18.50</del>	<del>+4.84</del>	Replaced 826-1927 EKC
-----------------	------------------	------------------	------------------	-----------------------

23.66

3.99 27.65

D.E #

4.34	23.31	18.50	+4.81	EKC
------	-------	-------	-------	-----



J.D. Clark  
 F.P. Chilton  
 H. Thompson  
 E. McGowan  
 10-5-1927

			24.13	T.P.	Cut	
	2.85	26.98				
Center	West	7.51	19.47	14.97	+4.50	
Center	East	3.03	18.95	14.97	+3.98	
South		6.62	20.36	15.25	+5.11	
North		6.97	20.01	14.87	+5.14	
		0.07	26.91	BM.		
				Top Fire Hydrant Jewell & La Cima		

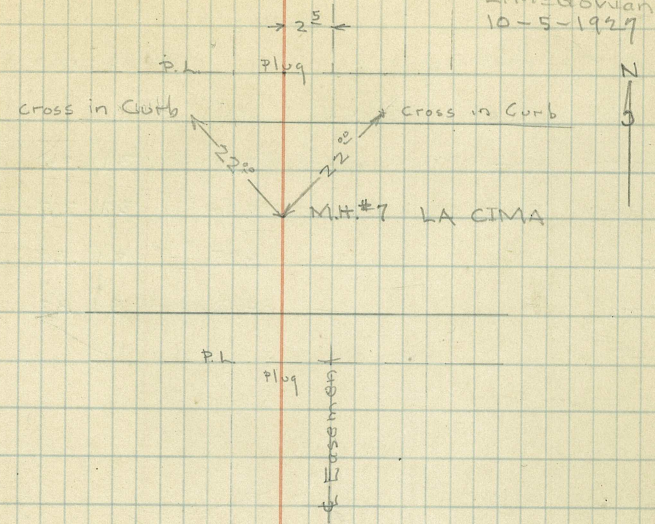

			31.34	P		
	2.46	33.80				
Center	West	6.59	27.21	20.60	+6.61	
Center	East	7.07	26.73	20.60	+6.13	
South		5.90	27.90	20.78	+7.12	
North		5.88	27.92	20.42	+7.50	

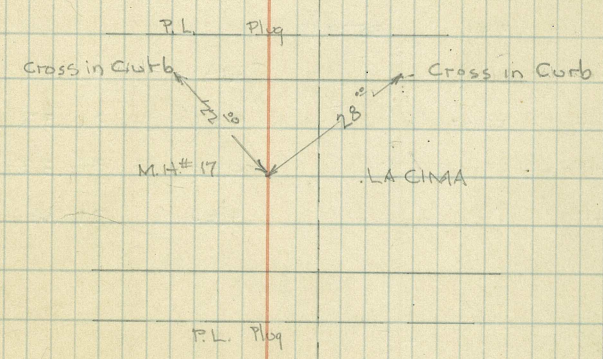



32.75 B.M.

	3.80	36.55				
Center West		520	31.35	24.66	+6.69	
Center East		530	31.25	24.66	+6.59	
South		495	31.60	24.84	+6.76	
North		472	31.83	24.48	+7.35	

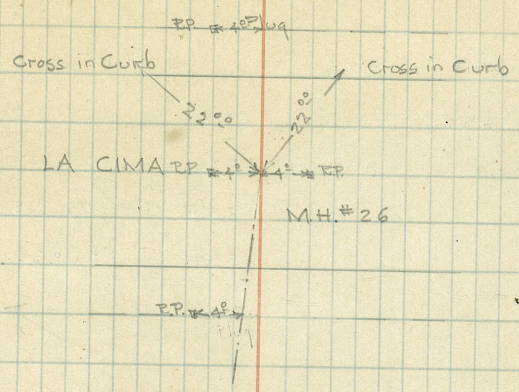

32.75 B.M.

	3.16	35.91			
Center West		474	31.17	25.00	+6.17
Center East		459	31.32	25.00	+6.32
South		458	31.33	25.18	+6.15
North		426	31.65	25.18	+6.47

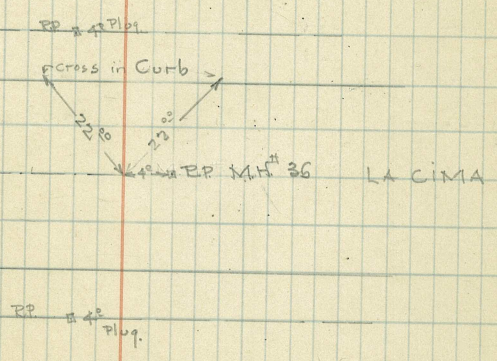



	29.69				
Center N-West	3.57	26.12	18.0	+ 8.13	
Center N-East	3.20	26.49	18.0	+ 8.49	
South	3.04	26.65	18.18	+ 8.47	
North	3.39	26.30	18.25	+ 8.05	

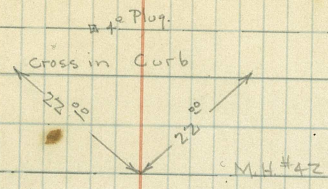

# 4\" Plug



	29.69				
Center West	10.58	19.11	14.00	+ 5.11	
South	10.06	19.63	14.10	+ 5.53	
North	10.03	19.66	13.90	+ 5.76	

LA CIMA

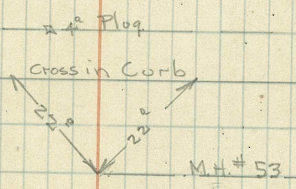

# 4\" Plug



32.75 B.M. Cross in Curb - Mid Curve South end Block 11  
at Promontory + Ingraham

3.16 35.91

0+00 25.00

0+50 4.94 30.97 23.50 +7.47

1+00 5.40 30.51 22.00 +8.51

1+50 6.60 29.31 20.5 +8.81

6.60 29.31

0.38 29.69

2+00 2.21 27.48 19.0 +8.48

2+50 4.08 25.61 17.66 +7.95

3+00 5.93 23.76 16.81 +6.95

3+50 7.87 21.82 15.96 +5.86

4+00 9.44 20.25 15.10 +5.15

8.16 21.53 B.M. Cross in Curb S.W. Cor. LaCima + Buena Vista.



## INGRAHAM

11

32.75 BM 588 R.10

208 34.83 6.31 28.52

07:00 3.50 32.02

07:00 MH #45 4.46 27.56 23.70 +3.86 East Stake

07:50 4.37 27.65 +3.95 South "

08:50 3.95 28.07 +4.37 East Curb

09:50 4.96 27.06 24.05 +3.01 Stake

10:50 4.45 27.57 +3.52 Curb

11:00 5.39 26.63 24.40 +2.23 Stake

11:50 4.75 27.27 +2.87 Curb

12:50 5.17 26.85 24.75 +2.10 Stake

13:00 MH #46 4.87 27.15 24.96 +2.19 East Stake

5.05 26.97 24.96 +2.01 West "

4.98 27.04 +2.08 " Curb

21:00 4.67 27.35 25.10 +2.25 Stake

3.72 28.30 +3.20 Curb

21:50 4.23 27.79 25.45 +2.34 Stake

3.47 28.55 +3.10 Curb

34:00 3.89 28.13 25.80 +2.33 Stake

3.10 28.92 +3.12 Curb



32.02

34.60

D.E.

3.50

28.52

26.22

+ 2.30

stake

2.70

29.32

+ 3.10

curb

0-27.5

4.04

27.98

23.50

+ 4.48

on Inner Edge of S.W. of  $\phi$  of Sewer

5.27

34.78

2.51

29.51

2.05

32.73 = 32.75



LA MANCHA & Jewell

B.M.

26.91

Top Fire Hydrant Jewell & La Cima

0.76 27.67

9.66 18.01

6.15 24.16

2.39 21.77

Top Fire Hydrant Jewell & La Mancha

+28.8 M.H. #13

14.80

2+00

3.70 20.46 14.37

+ 6.09

+50

4.24 19.92 13.63

+ 6.29

1+00

4.95 19.21 12.89

+ 6.32

+50

5.38 18.78 12.15

+ 6.63

0+00

M.H. #4

2.39 24.16

11.41

21.77

Top Fire Hydrant

Station 00 + offset  
 LA MANCHA

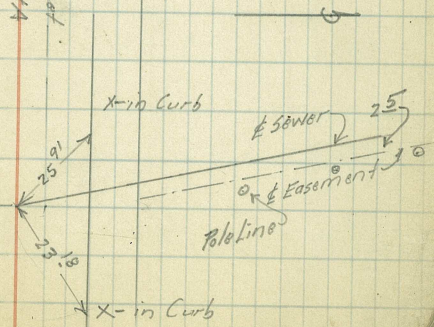



(Block # 1)

Sta.	+	H.I.	-	Elev.	Low Line Grade	High Line Grade	Low Cut	High Cut
DMH.#1 0+00					Actual = 07.95 8.00	17.15 = Actual 17.00		It will flow - ?
0+30			6.31	22.58	8.11	17.27	14.47	5.31
0+50		28.89	5.99	22.90	8.19	17.45	14.71	5.45
0+80			6.14	22.75	8.30	17.72	14.45	5.03
1+10		28.89	5.91	22.97	8.41	17.99	14.55	4.98
1+40			5.49	23.40	8.53	18.26	14.87	5.14
1+70			4.89	24.00	8.65	18.53	15.35	5.47
2+00			5.33	23.56	8.76	18.80	14.80	4.76
+30			5.30	23.59	8.88	19.07	14.71	4.52
+60			5.05	23.84	8.99	19.34	14.85	4.50
DMH#2 2+89.20		28.89	5.22	23.67	9.10	19.60	14.57	4.07
3+15			5.41	23.48	9.21	19.80	14.27	3.68



(Block #1)

Sta.	+	H.I.	-	Elev.	Low line Grade	High Line Grade	Low Cut	High Cut
Dead End 3+41.80		28.89	5.45	23.44	9.34	20.00	14.12	3.44
	6.03	28.89						
T.P. 3+70.0		24.04	1.16	22.88	9.44	—	13.44	—
4+00			1.64	22.38	9.56	—	14.82	—
Dead End 4+30.50			2.07	21.95	9.69	19.20	14.26	2.95
		24.04						
4+60			2.43	21.59	9.81	18.74	11.78	2.87
4+90			3.24	20.80	9.94	18.40	10.86	2.36
5+20			3.25	20.77	10.06	18.15	10.71	2.62
		24.04						
5+50			3.45	20.57	10.19	17.87	10.38	2.70
D.M.H.#3 5+78.20			3.66	20.36	10.30	17.60	10.06	2.76
6+00			4.20	19.84	10.38	—	9.44	—
Dead End 6+36.40			4.89	19.13	10.54	17.08	8.61	2.05
		24.04						
6+70			5.10	18.92	10.65	16.78	8.27	2.14



(Block # 1)

Sta.	+	H.I.	-	Elev.	Low Line Grade	High Line Grade	Low Cut	High Cut
7400		2402	4.45	19.57	1076	16.51	C-8.81	C-3.06
7430			4.10	19.92	1087	16.24	C-9.05	C-3.68
7460			3.76	20.26	1099	15.97	C-9.27	C-4.29
7490		2402	3.51	20.51	1110	15.70	C-9.41	C-4.81
8420			3.54	20.48	1123	15.43	C-9.25	C-5.05
DMH#4 8467.40			5.60	18.42	11.41	15.00	C-7.21	C-3.42

0 2.25 24.02

B.M. 21.77

Top F.H. LA MANCHA E. JEWELL



[Block # 2]

Sta.	+	H.F.	-	Elev.	Grade	Cuts.
M.H.# 13 0+00			5.57	21.04	14.80	6.24
+30			4.90	21.71	15.13	6.58
+60			4.20	22.41	15.46	6.95
+90			4.17	22.44	15.79	6.65
+120			4.16	22.45	16.14	6.33
+150			4.01	22.60	16.45	6.15
+180			4.01	22.60	16.76	5.82
2+10			3+86	22.75	17.11	5.64
M.H.# 12 2+48.0			3.51	23.19	17.53	5.57
2+70			3.06	23.55	17.77	5.78
253. (26.61)						
3+00 <sup>o</sup>			7.78	24.08	18.10	5.98
(3186)						
3+30			7.47	24.39	18.43	5.96



[Block # 2]

Sta.	H.I.	Elev.	Grade	Cuts.
3+60		6.98	24.88 18.76	6.14
3+90		6.56	25.30 19.09	6.21
	31.86			
4+20		5.93	25.93 19.44	6.51
4+50		5.53	26.33 19.75	6.58
4+75		5.13	26.73 20.04	6.71
	31.86			
M.H.#11 4+96		4.79	27.07 20.26	6.81
5+20		4.51	27.35 20.52	6.83
5+50	31.86	4.46	27.40 20.85	6.55
5+80		4.57	27.49 21.18	6.11
6+10		4.38	27.48 21.51	5.97
	31.86			
6+40		4.13	27.73 21.84	5.89
6+70		4.23	27.63 22.17	5.46



[Block # 2]

Sta.	+	H.I.	-	Elev.	Grade	Cuts.
700		31.86	4.35	27.51	22.51	5.00

Dead End.						
7+44			4.58	27.28	23.00	4.28

8.01	31.86			23.84		
------	-------	--	--	-------	--	--



Crown Point Drive.

Sta.	+	H.I.	-	Elev.	Grade	Cut
DMH #67 0+00					6.90	
+		27.52	4.53	22.99	6.70	16.29
1+00		27.52	4.42	23.10	6.50	16.60
+		27.52	4.22	23.30	6.30	17.00
2+00		27.52	4.35	23.17	6.10	17.07
+		27.52	3.65	23.87	5.90	17.97
3+00		27.52	3.96	23.56	5.70	17.86
3+25	<hr/>				5.60	<hr/>
MH #69 3+50.50		28.87	4.84	24.03	5.50	18.53
4+00		28.87	4.76	24.11	5.31	18.80
+		28.87	4.73	24.14	5.12	19.02
5+00		28.87	4.59	24.28	4.94	19.34

23.56  
 5.40  
 ---  
 19.06



CROWN POINT DRAIN

Sta.	+	H.I.	-	Elev.	Grade	Cut
M.H.#70 5+42.00		29.11	4.84	24.27	4.78✓	19.49
5+60					4.7✓	19.50
6+00					4.57✓	19.55
6+50					4.39	19.60
7+00					4.21	19.97
M.H.#71 7+32.00		29.11	4.85	24.26	4.10	20.16
=						
M.H.#1						

Springing a new plan  
therefore the Equation of M.H.s



INGRAHAM ST.

26.91 = B.M.  
Top F.H. - Jewell + La Cima -

Sta.	+	HI.	-	Elev.	Grade	Cuts.
B.M.	11.44	32.97		21.53		(See Page # 10) Cross in Curb S.W. Cor. La Cima + Buena Vista
T.P.	1.60	34.29	0.28	32.69		
T.P.			6.53	27.76		
	4.11	(31.87)				
0+00 = M.H.#45			4.44	27.43	23.70	3.73
0+40			4.81	27.06	23.98	3.08
0+80		(31.87)	5.40	26.67	24.26	2.41
1+20			5.43	26.64	24.54	+2.10
1+50		(31.87)	5.01	26.86	24.75	+2.11
1+80 = M.H.#46			4.76	27.11	24.96	+2.15
2+20		(31.87)	4.34	27.53	25.24	+2.29
2+50			4.14	27.75	25.45	+2.30
2+75 = Lat #3			3.94	27.93	25.65	+2.31
2+91 = Lat #2		(31.87)	3.85	28.04	25.73	+2.29

Dec. 11-29

(- Some Man-Hole)

26.14 = Cut - 2.15

26.23 = Cut - 2.36



INGRAHAM St.

Sta.	+	HI.	-	Elev.	Grade.	Cuts.	Lat. Grades - Cuts
3+18 = Lot #5		(31.87)	3.69	28.18	25.92	2.26	26.42 = Cut 3.68
(3+53) Lot #1		(25.0)	Lateral	29.37	26.16	—	26.66 = Cut 2.71
3+58 = Lot #4		(1.63)	(on lot)	30.24	26.19	—	26.69 = Cut 3.55
3+60 = End		(31.87)	3.45	28.42	26.20	2.22	—
0+22 = M.H. #45		(31.87)	4.27	27.60	23.70	3.90	
0+30			3.55	28.32	23.49	4.83	
0+50		(31.87)	3.44	28.43	23.35	5.08	
↓							
1+895 = M.H. #44					22.32		



