

CIVIC CENTER
SURVEY

+3

1509

SETTING
TRANSFER BOOK

384

X - SECTIONS

MICROFILMED
DEC 24 1964

ENGINEERING DEPARTMENT,
CITY OF SAN DIEGO,
CALIFORNIA.

Aug 14-1934
Walter de Berard
Instrument Recorder

East Pole

Stake Line

Paravent No Edge Ash St.

Paravent West Edge Atlantic

7.21

4.22

11.43

A Line Left to Atlantic

0+00	6.20	5.2
L 11	6.20	5.2
L 19	6.50	4.9
L 30	6.80	4.6
East 10 of L 11.0	6.80	4.6
" 34	7.00	4.4

B - Line

0+00	6.10	5.3
L 17	5.90	5.5
L 24	6.40	5.0
L 30.6	6.60	4.8

C. Line

0+00	6.30	5.1
L 30.6	6.30	5.1

0+00	D Line	5.80	5.6
L 30.6		5.90	5.5

E Line

0+00		5.60	5.8
L 30.6		5.50	5.9

	F	Line		
0+00			5.20	6.20
L 30.6			5.20	6.20
	G	Line		
0+00			4.90	6.5
L 30.6			4.90	6.50
	H	Line		
0+00			4.90	6.50
L 30.9			4.60	6.80
	I	Line		
0+00			5.10	6.30
L 30.8			4.60	6.80
	J	Line		
0+00			5.00	6.40
L 30.9			4.60	6.80
	K	Line		
0+00			4.90	6.50
L 30.8			4.70	6.70
	L	Line		
0+00			4.80	6.60
L 30.9			4.80	6.60
	M	Line		
0+00			4.20	7.20
L 31.0			4.90	6.50

Stake Line
North Edge Ash St Pavement

	N	Line		
0+00			4.60	6.80
L 31.0 ^d			5.00	6.40
	O	Line		
0+00			4.30	7.10
L 31.0 ^v			5.10	6.30
	P	Line		
0+00			4.30	7.10
L 31.0			5.10	6.30
	Q	Line		
0+00			4.30	7.10
L 31.0			5.20	6.20
	R	Line		
0+00			4.70	6.70
L 31.0			5.30	6.10
	S	Line		
0+00			4.80	6.60
L 31.0			5.40	6.00
	T	Line		
0+00			4.70	6.70
L 31.0			5.40	6.00

d.

Stake Line

Edge Pavement No Edge Ash St.

Stake Line

North Edge Ash St Pavement

4

67.5

6.50 4.90

B.M. J Line

4.90

1140
"A" Line

Fence.

4700

0+00	6.60	4.80
R02	6.30	5.10
R05	5.40	6.00
R13	5.10	6.30
0+13	6.40	5.00
R02	6.20	5.20
R05	5.60	5.80
R09	5.10	6.30
R13	5.20	6.20
0+25	6.50	4.90
R02	5.90	5.50
R05	5.30	6.10
R13	5.10	6.30
0+37	6.50	4.90
R02	5.90	5.50
R05	5.30	6.10
R13	5.10	6.30
0+50	6.60	4.80
R02	6.10	5.30
R05	5.10	6.30
R13	5.00	6.40

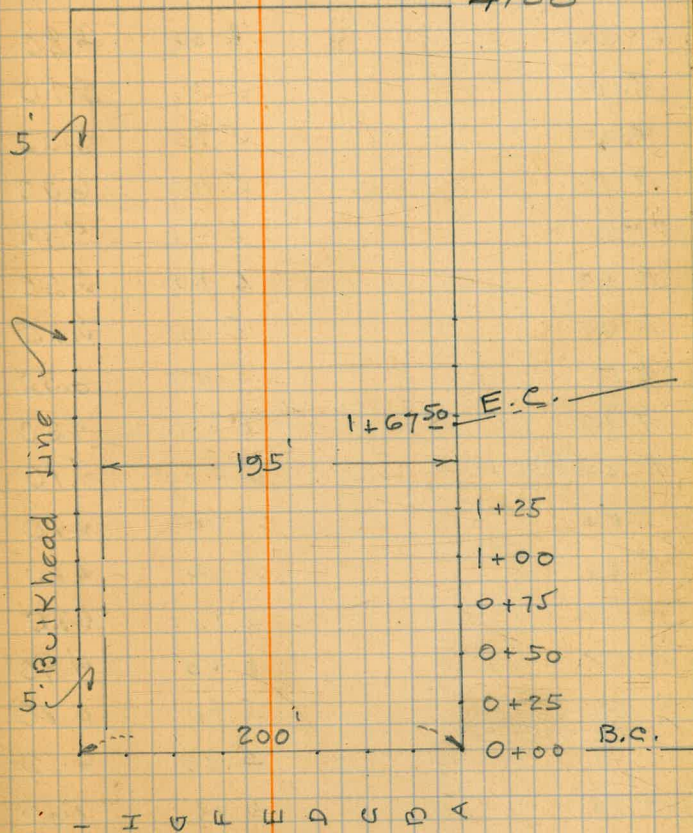

3.

0+63	6.60	4.80
R02	5.90	5.50
R05	5.20	6.20
R13	5.00	6.40
0+75	6.50	4.90
R02	5.90	5.50
R05	5.30	6.10
R13	5.00	6.40
0+87	6.70	4.70
R02	5.80	5.60
R05	5.30	6.10
R13	5.00	6.40
1+00	6.80	4.60
R02	6.30	5.10
R05	5.30	6.10
R13	5.00	6.40
1+13	6.80	4.60
R02	6.50	4.90
R06	5.30	6.10
R13	4.90	6.50
1+25	6.80	4.60
R02	6.40	5.00
R06	5.20	6.20
R13	5.10	6.30

1+37	6.80	4.60
R 02	6.40	5.00
R 06	5.10	6.30
R 13	5.10	6.30
1+50	6.80	4.60
R 02	6.60	4.80
R 06	5.20	6.20
R 13	5.10	6.30
1+63	6.80	4.60
R 02	6.50	4.90
R 06	5.30	6.10
R 13	5.20	6.20
1+75	6.80	4.60
R 02	6.40	5.00
R 06	5.50	5.90
R 13	5.20	6.20
1+87	6.70	4.70
R 02	6.20	5.20
R 05	5.40	6.00
R 13	5.20	6.20
2+00	6.70	4.70
R 02	6.40	5.00
R 05	5.40	6.00
R 13	5.30	6.10

7

2+13	6.80	4.60
R 04	6.40	5.00
R 06	5.10	6.30
R 13	5.40	6.00
2+25	6.80	4.60
R 06	6.40	5.00
R 09	5.30	6.10
R 13	5.40	6.00
2+37	6.80	4.60
R 13	6.50	4.90
2+50	6.70	4.70
R 13	6.90	4.50
2+63	6.70	4.70
R 13	6.70	4.70
2+75	6.60	4.80
R 13	6.70	4.70
2+87	6.60	4.80
R 13	6.50	4.90
3+00	6.80	4.60
R 13	6.60	4.80
3+13	6.80	4.60
R 13	6.90	4.50
3+25	6.70	4.70
R 13	6.70	4.70
3+37	6.30	5.10
R 05	6.40	5.00

6.

8

R09	6.70	4.70
R13	6.70	4.70
3+50	6.30	5.10
R05	6.40	5.00
R09	6.70	4.70
R13	6.80	4.60
3+63	6.60	4.80
R13	6.80	4.60
3+75	6.60	4.80
R13	6.80	4.60
3+87	6.50	4.90
R13	6.60	4.80
4+00	6.70	4.70
R13	6.50	4.90
4+16.5	6.60	4.80
R13	6.40	5.00

B Line

0+00	6.60	4.80
R13	6.60	4.80
0+13	6.80	4.60
R13	6.70	4.70
0+25	6.70	4.70
R13	6.60	4.80
0+37	6.60	4.80
R13	6.60	4.80

9

0+50	6.60	4.80
R13	6.60	4.80
0+63	6.60	4.80
R13	6.60	4.80
0+75	6.70	4.70
R13	6.70	4.70
0+87	6.80	4.60
R13	6.70	4.70
1+00	6.80	4.60
R13	6.80	4.60
1+13	6.80	4.60
R13	6.90	4.50
1+25	6.80	4.60
R13	6.90	4.50
1+37	6.80	4.60
R13	6.80	4.60
1+50	6.80	4.60
R13	6.80	4.60
1+63	6.90	4.50
R13	6.80	4.60
1+75	7.00	4.40
R13	6.90	4.50
1+87	6.90	4.50
R13	6.90	4.50
2+00	6.70	4.70
R13	6.90	4.50

2+13	6.80	4.60
R 13	6.90	4.50
2+25	6.90	4.50
R 13	6.70	4.70
2+37	6.70	4.70
R 13	6.90	4.50
2+50	6.70	4.70
R 13	6.80	4.60
2+63	6.70	4.70
R 13	6.60	4.80
2+75	6.70	4.70
R 13	6.70	4.70
2+87	6.90	4.50
R 13	6.70	4.70
3+00	6.90	4.50
R 13	6.80	4.60
3+13	6.90	4.50
R 13	6.80	4.60
3+25	6.80	4.60
R 13	6.80	4.60
3+37	6.40	5.00
R 13	6.30	5.10
3+50	6.60	4.80
R 13	6.40	5.00
3+63	6.90	4.50
R 13	6.80	4.60

11

3+75	6.80	4.60
R13	6.80	4.60
3+87	6.70	4.70
R13	6.60	4.80
4+00	6.60	4.80
R13	6.60	4.80

C LIND

0+00	6.80	4.60
R13	6.80	4.60
0+13	6.80	4.60
R13	6.80	4.60
0+25	6.80	4.60
R13	6.70	4.70
0+37	6.80	4.60
R13	6.70	4.70
0+50	6.70	4.70
R13	6.60	4.80
0+63	6.70	4.70
R13	6.60	4.80
0+75	6.60	4.80
R13	6.60	4.80
0+87	6.70	4.70
R13	6.60	4.80
1+00	6.70	4.70
R13	6.60	4.80

1+13	6.70	4.70
R13	6.60	4.80
1+25	6.70	4.70
R13	6.60	4.80
1+37	6.70	4.70
R13	6.70	4.70
1+50	6.70	4.70
R13	6.80	4.60
1+63	6.70	4.70
R13	6.90	4.50
1+75	6.80	4.60
R13	7.00	4.40
1+87	6.80	4.60
R13	6.90	4.50
2+00	6.80	4.60
R13	7.00	4.40
2+13	6.80	4.60
R13	6.80	4.60
2+25	6.80	4.60
R13	6.80	4.60
2+37	6.80	4.60
R13	6.80	4.60
2+50	6.80	4.60
R13	6.80	4.60
2+63	6.90	4.50
R13	6.90	4.50

2+75	6.90	4.50
R13	6.80	4.60
2+87	7.10	4.30
R13	6.90	4.50
3+00	7.00	4.40
R13	7.00	4.40
3+13	7.00	4.40
R13	6.90	4.50
3+25	7.00	4.40
R13	6.90	4.50
3+37	6.40	5.00
R13	6.40	5.00
3+50	6.50	4.90
R13	6.50	4.90
3+63	7.00	4.40
R13	6.90	4.50
3+75	6.90	4.50
R13	6.90	4.50
3+87	6.90	4.50
R13	6.90	4.50
4+00	6.90	4.50
R13	6.90	4.50

D Line

0+00	7.00	4.40
R13		

14

0+13	6.90	450
R13	7.00	440
0+25	7.00	440
R13	7.00	440
0+37	6.90	450
R13	7.00	440
0+50	6.90	450
R13	6.80	460
0+63	6.70	470
R13	6.60	480
0+75	6.70	470
R13	6.60	480
0+87	6.70	470
R13	6.60	480
1+00	6.80	460
R13	6.60	480
1+13	6.80	460
R13	6.70	470
1+25	6.80	460
R13	6.70	470
1+37	6.80	460
R13	6.60	480
1+50	6.90	450
R13	6.70	470
1+63	6.90	450
R13	6.80	460

15

1775	6.90	450
R13	6.80	460
1787	7.00	440
R13	6.90	450
2700	7.00	440
R13	6.90	450
2713	7.00	440
R13	6.90	450
2725	6.90	450
R13	6.90	450
2737	6.80	460
R13	6.90	450
2750	6.80	460
R13	6.90	450
2763	7.00	440
R13	6.90	450
2775	7.10	430
R13	7.00	440
2787	7.00	440
R13	7.10	430
3700	7.10	430
R13	7.00	440
3713	7.10	430
R13	7.00	440
3725	7.00	440
R13	7.00	440

16

3+37	6.80	460
R13	6.60	480
3+50	6.90	450
R13	6.60	480
3+63	7.10	430
R13	7.00	440
3+75	7.00	440
R13	7.00	440
3+87	7.00	440
R13	7.00	440
4+00	7.30	410
R13	7.20	420
4+13	7.00	440
R13	7.20	420

E Line

0+00	7.10	430
R13	7.00	440
0+13	7.20	420
R13	7.10	430
0+25	7.10	430
R13	7.10	430
0+37	7.10	430
R13	7.10	430
0+50	7.00	440
R13	7.00	440

17

0+63	7.00	4.40
R13	6.90	4.50
0+75	7.00	4.40
R13	6.90	4.50
0+87	7.10	4.30
R13	6.90	4.50
1+00	7.00	4.40
R13	6.90	4.50
1+13	7.00	4.40
R13	6.90	4.50
1+25	7.00	4.40
R13	7.00	4.40
1+37	7.00	4.40
R13	7.00	4.40
1+50	7.10	4.30
R13	6.90	4.50
1+63	7.00	4.40
R13	6.90	4.50
1+75	7.00	4.40
R13	6.90	4.50
1+87	7.00	4.40
R13	7.00	4.40
2+00	7.00	4.40
R13	7.00	4.40
2+13	7.00	4.40
R13	7.00	4.40

18

2+25	7.00	440
R13	6.90	450
2+37	7.00	440
R13	6.90	450
2+50	7.00	440
R13	6.90	450
2+63	6.90	450
R13	7.00	440
2+75	7.10	430
R13	7.00	440
2+87	7.10	430
R13	7.10	430
3+00	6.90	450
R13	7.10	430
3+13	7.00	440
R13	7.10	430
3+25	7.00	440
R13	7.00	440
3+37	7.10	430
R13	6.90	450
3+50	7.10	430
R13	7.10	430
3+63	7.30	410
R13	7.10	430
3+75	7.20	420
R13	7.10	430

3+87	7.30	4.10
R13	7.20	4.20
4+00	7.40	4.00
R13	7.20	4.20
4+13	7.50	3.90
R13	7.40	4.00

F Line

0+00	7.00	4.40
R13	7.10	4.30
0+13	7.00	4.40
R13	7.10	4.30
0+25	7.00	4.40
R13	7.20	4.20
0+37	7.20	4.20
R13	7.10	4.30
0+50	7.10	4.30
R13	7.10	4.30
0+63	7.00	4.40
R13	7.10	4.30
0+75	7.00	4.40
R13	7.00	4.40
0+87	7.10	4.30
R13	7.10	4.30
1+00	7.00	4.40
R13	7.00	4.40

1+13	7.00	440
R13	7.10	430
1+25	7.10	430
R13	7.00	440
1+37	7.10	430
R13	7.10	430
1+50	7.10	430
R13	7.10	430
1+63	7.20	420
R13	7.10	430
1+75	7.20	420
R13	7.10	430
1+87	7.10	430
R13	7.20	420
2+00	7.00	440
R13	7.10	430
2+13	6.90	450
R13	7.10	430
2+25	7.00	440
R13	7.20	420
2+37	6.90	450
R13	7.20	420
2+50	6.90	450
R13	6.90	450
2+63	7.00	440
R13	6.90	450

2+75	7.10	4.30
R13	7.10	4.30
2+87	7.20	4.20
R13	7.20	4.20
3+00	7.20	4.20
R13	7.10	4.30
3+13	7.10	4.30
R13	7.10	4.30
3+25	7.10	4.3
R13	7.00	4.4
3+37	7.10	4.3
R13	7.10	4.3
3+50	7.20	4.2
R13	7.20	4.2
3+63	7.40	4.0
R13	7.20	4.2
3+75	7.40	4.0
R13	7.30	4.1
3+87	7.40	4.0
R13	7.40	4.0
4+00	7.50	3.9
R13	7.40	4.0
4+13	7.70	3.7
R13	7.70	3.7

22

Elev.

G Line

0+00	7.00	4.4
R13	7.10	4.3
0+13	7.00	4.4
R13	7.00	4.4
0+25	7.00	4.4
R13	7.00	4.4
0+37	7.00	4.4
R13	7.10	4.3
0+50	7.00	4.4
R13	7.00	4.4
0+63	7.00	4.4
R13	7.00	4.4
0+75	6.90	3.5
R13	7.00	4.4
0+87	7.00	4.4
R13	7.10	4.3
1+00	7.00	4.4
R13	7.00	4.4
1+13	7.10	4.3
R13	7.10	4.3
1+25	7.10	4.3
R13	7.00	4.4
1+37	7.10	4.3
R13	7.20	4.1

23

Elev.

1750	7.10	4.3
R13	7.20	4.2
1763	7.10	4.3
R13	6.90	3.5
1775	7.10	4.3
R13	7.20	4.2
1787	7.00	4.4
R13	7.00	4.4
2+00	6.90	3.5
R13	7.00	4.4
2+13	6.80	4.6
R13	6.90	4.5
2+25	6.80	4.6
R13	6.80	4.6
2+37	7.00	4.4
R13	6.80	4.6
2+50	7.00	4.4
R13	7.00	4.4
2+63	7.10	4.3
R13	7.00	4.4
2+75	7.30	4.1
R13	7.10	4.3
2+87	7.20	4.2
R13	7.10	4.3
3100	7.10	4.3
R13	7.10	4.3

24

Elev.

3+13	7.10	4.3
R13	7.00	4.4
3+25	7.20	4.2
R13	7.10	4.3
3+37	7.20	4.2
R13	7.20	4.2
3+50	7.30	4.1
R13	7.30	4.1
3+63	7.30	4.1
R13	7.40	4.0
3+75	7.60	3.8
R13	7.50	3.9
3+87	7.70	3.7
R13	7.60	3.8
4+00	7.70	3.7
R13	7.60	3.8
4+13	7.70	3.7
R13	8.10	3.3

H- Line

0+00	7.00	4.4
R13	7.00	4.4
0+13	7.00	4.4
R13	7.00	4.4
0+25	7.00	4.4
R13	7.00	4.4

25

Elev.

0+37	7.10	4.3
R13	7.10	4.3
0+50	7.10	4.3
R13	7.10	4.3
0+63	7.10	4.3
R13	7.20	4.2
0+75	7.10	4.3
R13	7.00	4.4
0+87	7.00	4.4
R13	7.00	4.4
1+00	7.00	4.4
R13	7.10	4.3
1+13	7.10	4.3
R13	7.10	4.3
1+25	7.00	4.4
R13	7.00	4.4
1+37	7.10	4.3
R13	7.00	4.4
1+50	7.00	4.4
R13	7.00	4.4
1+63	7.10	4.3
R13	7.00	4.4
1+75	7.10	4.3
R13	6.90	4.5
1+87	7.10	4.3
R13	6.90	4.5

26

26

Elek

2+00	7.10	4.3
R13	6.90	4.5
2+13	7.10	4.3
R13	7.00	4.4
2+25	7.10	4.3
R13	7.20	4.2
2+37	7.20	4.2
R13	7.20	4.2
2+50	7.10	4.3
R13	7.10	4.3
2+63	7.20	4.2
R13	7.10	4.3
2+75	7.20	4.2
R13	7.20	4.2
2+87	7.20	4.2
R13	7.20	4.2
3+00	7.20	4.2
R13	7.20	4.2
3+13	7.20	4.2
R13	7.20	4.2
3+25	7.20	4.2
R13	7.20	4.2
3+37	7.20	4.2
R13	7.20	4.2
3+50	7.20	4.2
R13	7.30	4.1

27

Elev.

3+63	7.20	4.2
R13	7.40	4.0
3+75	7.10	4.3
R13	7.50	3.9
3+87	7.20	4.2
R13	7.60	3.8
4+00	7.30	4.1
R13	7.70	3.7
4+13	7.20	4.2
R13	7.70	3.7

I. Line

0+00	7.50	3.9
0+13	7.40	4.4
0+25	7.40	4.0
0+37	7.40	4.0
0+50	7.40	4.0
0+69	7.40	4.0
0+75	7.40	4.0
0+87	7.40	4.0
1+00	7.50	3.9
1+13	7.50	3.9
1+25	7.50	3.9
1+37	7.50	3.9
1+50	7.50	3.9

Bulkhead Rail

28

Elev

1+63	7.50	3.9
1+75	7.40	4.0
1+87	7.50	3.9
2+00	7.40	4.0
2+13	7.40	4.0
2+25	7.50	3.9
2+37	7.40	4.0
2+50	7.40	4.0
2+63	7.40	4.0
2+75	7.40	4.0
2+87	7.40	4.0
3+00	7.50	3.9
3+13	7.40	4.0
3+25	7.50	3.9
3+37	7.50	3.9
3+50	7.40	4.0
3+63	7.50	3.9
3+75	7.50	3.9
3+87	7.50	3.9
4+00	7.30	4.1
4+13	7.30	4.1

29

Elev.

H. 1

6.64

3.24

9.88

2.85

7.03

2.83

9.86

3.37

6.49

3.39

6.50

9.89

A1-to A2 Line

0+00

5.40

4.5

R 06

5.90

4.0

R 13

5.90

4.0

R 21

6.00

3.9

R 34

5.50

4.9

0+13

5.10

4.8

R 04

4.50

5.4

R 09

6.30

3.6

R 13

5.90

4.0

R 21

6.00

3.9

R 35

6.30

3.6

0+25

5.30

4.6

R 04

5.10

4.8

R 09

5.70

4.2

R 13

6.00

3.9

R 35

5.60

4.3

B.M.
S.E. Cor. Grape + AtlanticB.M.
10 Penny TEL Pole East 150' Robbins Marine Shed

B.M. J Line 6.50 From Ash St

West Edge Atlantic St. Paveruan'

Pars

Pars

30

Elev.

0+37	5.40	4.5
R04	5.30	4.6
R09	5.10	4.8
R13	5.90	4.0
R21	6.00	3.9
R35	5.70	4.2
0+50	5.40	4.5
R06	5.60	4.3
R13	6.00	3.9
R21	6.00	3.9
R35	5.70	4.2
0+63	5.40	4.5
R05	5.10	4.8
R09	6.00	3.9
R13	6.10	3.8
R21	6.00	3.9
R35	5.70	4.2
0+75	5.50	4.4
R08	5.40	4.5
R13	6.20	3.7
R21	6.10	3.8
R35	5.80	4.1
0+87	5.50	4.4
R05	5.20	4.7
R09	6.50	3.4
R13	6.40	3.5

Pave

31

E/B ✓

R 21	6.20	3.7
R 35	5.80	4.1
1+00	5.40	4.5
R 06	5.90	4.0
R 13	6.50	3.4
R 27	6.20	3.7
R 34	5.80	4.1
1+13	5.50	4.4
R 06	5.30	4.6
R 09	6.60	3.3
R 13	6.50	3.4
R 21	6.40	3.5
R 35	5.90	4.0
1+25	5.30	4.6
R 06	5.00	4.9
R 13	6.50	3.5
R 21	6.51	3.4
R 35	6.00	3.9
1+37	5.50	4.4
R 05	4.90	5.0
R 09	6.60	3.3
R 13	6.40	3.5
R 21	6.50	3.4
R 35	6.00	3.9
1+50	5.40	4.5
R 13	5.76	4.2

32

Elev

R 21	6.90	3.0
R 35	6.00	3.9
1+ 63	5.20	4.7
R 05	5.00	4.9
R 13	6.60	3.3
R 21	6.90	3.0
R 35	6.00	3.9
1+ 67	5.20	4.7
R 04	4.70	5.2
R 09	6.40	3.5
R 13	6.60	3.3
R 21	6.50	3.4
R 35	6.00	3.9

B¹ - B² Line

0+00	5.90	4.0
R 13	5.30	4.6
0+13	5.30	4.6
R 13	5.60	4.3
0+25	5.50	4.4
R 13	5.50	4.4
0+37	5.60	4.3
R 13	5.40	4.5
0+50	5.50	4.4
R 13	5.30	4.6

33

Elev

0+63	5.20	4.7
R13	5.20	4.7
0+75	5.30	4.6
R13	5.40	4.5
0+87	5.10	4.8
R13	5.20	4.7
1+06	5.30	4.6
R13	5.10	4.8
1+13	5.40	4.5
R13	5.50	4.4
1+25	5.40	4.5
R13	5.60	4.3
1+27	5.50	4.4
R13	5.50	4.4
1+50	5.50	4.4
R13	5.40	4.5
1+63	5.40	4.5
R13	5.20	4.7
1+67	5.40	4.5
R13	5.10	4.8

C₁ - C₂ Line

0+00	5.00	4.9
R13	5.00	4.9
0+13	4.70	5.2
R13	5.00	4.9

34

Elev.

0+25	4.80	5.1
R13	5.40	4.5
0+37	5.10	4.8
R13	5.40	4.5
0+50	5.20	4.7
R13	5.40	4.5
0+63	4.90	5.0
R13	5.30	4.6
0+75	5.00	4.9
R13	5.10	4.1
0+87	5.30	4.6
R13	5.00	4.9
1+00	5.40	4.5
R13	5.30	4.6
1+13	5.20	4.7
R13	5.40	4.5
1+25	5.20	4.7
R13	5.30	4.6
1+37	5.30	4.6
R13	5.40	4.5
1+50	5.30	4.6
R13	5.50	4.4
1+63	5.20	4.7
R13	5.30	4.6
1+67	5.10	4.8
R13	5.30	4.6

35

Elev

D₁ - D₂ Line

0+00	4.90	5.0
R13	4.90	5.0
0+13	4.80	5.1
R13	4.90	5.0
0+25	4.80	5.1
R13	4.70	5.2
0+37	4.70	5.2
R13	4.70	5.2
0+50	4.80	5.1
R13	5.00	4.9
0+63	5.00	4.9
R13	5.20	4.7
0+75	5.20	4.7
R13	5.10	4.8
0+87	5.10	4.8
R13	5.20	4.7
1+00	5.10	4.8
R13	5.20	4.7
1+13	5.00	4.9
R13	5.30	4.6
1+25	4.90	5.0
R13	5.10	4.8
1+37	5.20	4.7
R13	5.20	4.7
1+50	5.10	4.8

36

Elev.

R13	510	4.8
1+63	510	4.8
R13	520	4.7
1+67	520	4.7
R13	520	4.7

E₁ - E₂ Line

0+00	4.80	5.1
R13	5.00	4.9
0+13	4.80	5.1
R13	4.90	5.0
0+25	4.80	5.1
R13	4.90	5.0
0+37	4.70	5.2
R13	4.40	5.5
0+50	4.60	5.3
R13	4.60	5.3
0+63	4.50	5.4
R13	4.80	5.1
0+75	4.60	5.3
R13	4.80	5.1
0+87	4.70	5.2
R13	5.00	4.9
1+00	4.80	5.1
R13	4.90	5.0
1+13	4.50	5.4

37

Elev

R13	4.80	5.1
1+25	4.70	5.7
R13	4.90	5.0
1+37	5.10	4.8
R13	5.10	4.8
1+50	5.20	4.7
R13	5.20	4.7
1+63	5.30	4.6
R13	5.20	4.7
1+67	5.30	4.6
R13	5.20	4.7

F1 - F2 line

0+00	4.80	5.1
R13	4.60	5.3
0+13	5.10	4.8
R13	5.00	4.9
0+25	4.80	5.1
R13	4.80	5.1
0+37	4.40	5.5
R13	4.60	5.3
0+50	4.50	5.4
R13	4.50	5.4
0+63	4.60	5.3
R13	4.50	5.4
0+75	4.60	5.3

R13	4.50	5.4
0+8.7	4.60	5.3
R13	4.60	5.3
1+00	4.60	5.3
R13	4.60	5.3
1+13	4.80	5.1
R13	4.90	5.0
1+25	5.10	4.8
R13	4.80	5.1
1+37	4.80	5.1
R13	4.90	5.0
1+50	4.90	5.0
R13	5.10	4.8
1+63	5.00	4.9
R13	5.10	4.8
1+67	5.00	4.9
R13	5.20	4.7

G₁ - G₂ Line

0+00	4.10	5.8
R13	4.50	4.4
8+13	4.30	5.6
R13	4.70	5.2
0+25	4.20	5.7
R13	4.50	5.4
0+39	4.20	5.7

39

Elev.

R13	4.40	5.5
0+50	4.40	5.5
R13	4.40	5.5
0+63	4.50	5.4
R13	4.40	5.5
0+75	4.60	5.3
R13	4.50	5.4
0+87	4.80	5.1
R13	4.70	5.2
1+00	4.80	5.1
R13	4.70	5.2
1+13	4.90	5.0
R13	4.90	5.0
1+25	5.00	4.9
R13	4.90	5.0
1+37	5.10	4.8
R13	5.10	4.8
1+50	5.20	4.7
R13	4.90	5.0
1+63	5.20	4.7
R13	4.90	5.0
1+67	5.20	4.7
R13	5.00	4.9

H₁ - H₂ Line

0+00

3.70

6.2

30

Elev

R13	3.90	6.0
0+13	3.90	6.0
R13	4.00	5.9
0+25	4.20	5.7
R13	4.00	5.9
0+37	4.50	5.4
R13	4.20	5.7
0+50	4.60	5.3
R13	4.50	5.4
0+63	4.70	5.2
R13	4.60	5.3
0+75	4.80	5.1
R13	4.70	5.2
0+87	4.90	5.0
R13	4.70	5.2
1+00	4.90	5.0
R13	4.90	5.0
1+13	5.00	4.9
R13	5.10	4.8
1+25	5.20	4.7
R13	5.20	4.7
1+37	5.30	4.6
R13	5.20	4.7
1+50	5.20	4.7
R13	5.30	4.6
1+63	5.30	4.6

41

Elev.

R13	5.30	4.6
1+67	5.20	4.6
R13	5.20	4.6

I₁ - I₂ line

0+00	4.30	5.6
R13	4.00	5.9
0+13	4.40	5.5
R13	4.30	5.6
0+25	4.30	5.6
R13	4.50	5.4
0+37	4.40	5.5
R13	4.40	5.5
0+50	4.40	5.5
R13	4.50	5.4
0+63	4.50	5.4
R13	4.60	5.3
0+75	4.70	5.2
R13	4.70	5.2
0+87	4.70	5.2
R13	4.80	5.1
1+00	4.90	5.0
R13	4.90	5.0
1+13	5.10	4.8
R13	5.00	4.9
1+25	5.10	4.8

42

Elev.

R13	5.10	4.8
1+37	5.10	4.8
R13	5.10	4.8
1+50	5.00	4.9
R13	5.20	4.7
1+63	5.00	4.9
R13	5.20	4.7
1+67	5.10	4.8
R13	5.20	4.7

S. - Jr line

0+00	4.20	5.7
R13	4.20	5.7
0+13	4.20	5.7
R13	4.30	5.6
0+25	4.20	5.7
R13	4.40	5.5
0+37	4.10	5.8
R13	4.30	5.6
0+50	4.20	5.7
R13	4.40	5.5
0+63	4.20	5.7
R13	4.50	5.4
0+75	4.50	5.4
R13	4.60	5.3
0+87	4.50	5.4

43

Elev.

R13	4.60	5.3
1+00	4.50	5.4
R13	4.60	5.3
1+13	4.70	5.2
R13	4.90	5.0
1+25	4.80	5.1
R13	4.90	5.0
1+37	4.80	5.1
R13	4.80	5.1
1+50	4.90	5.0
R13	4.70	5.2
1+63	4.80	5.1
R13	5.00	4.9
1+67	4.70	5.2
R13	4.80	5.1

K1 - K2 June

0+00	4.10	5.8
R13	4.20	5.7
0+13	4.30	5.6
R13	4.10	5.8
0+25	4.20	5.7
R13	4.10	5.8
0+37	4.10	5.8
R13	4.10	5.8

44

Elev.

0750	4.00	5.9
R13	4.10	5.8
0+63	4.10	5.8
R13	4.10	5.8
0+72	4.30	5.6
R13	4.30	5.6
0+87	4.50	5.4
R13	4.50	5.4
1+00	4.50	5.4
R13	4.50	5.4
1+13	4.70	5.2
R13	4.70	5.2
1+25	4.80	5.1
R13	4.80	5.1
1+37	5.00	4.9
R13	4.90	5.0
1+50	4.80	5.1
R13	4.90	5.0
1+63	4.70	5.2
R13	4.70	5.2
1+67	4.70	5.2
R13	4.70	5.2
1+75	4.60	5.3
R13	4.70	5.2
1+87	4.50	5.4
R13	4.50	5.4

45

			Elev.
2+00		4.60	5.3
R13		4.70	5.2
2+13		4.70	5.2
R13		4.90	5.0
2+25		4.50	5.4
R13		4.70	5.2
2+29		4.50	5.4
R13		4.70	5.2
R17.3		4.70	5.2

L1 - Lr Line

0+00		4.20	5.7
R13		4.10	5.8
0+13		4.20	5.7
R13		4.20	5.7
0+25		4.20	5.7
R13		4.20	5.7
0+37		4.10	5.8
R13		4.10	5.8
0+50		4.20	5.7
R13		4.00	5.9
0+63		4.20	5.7
R13		4.20	5.7
0+75		4.30	5.6
R13		4.40	5.5

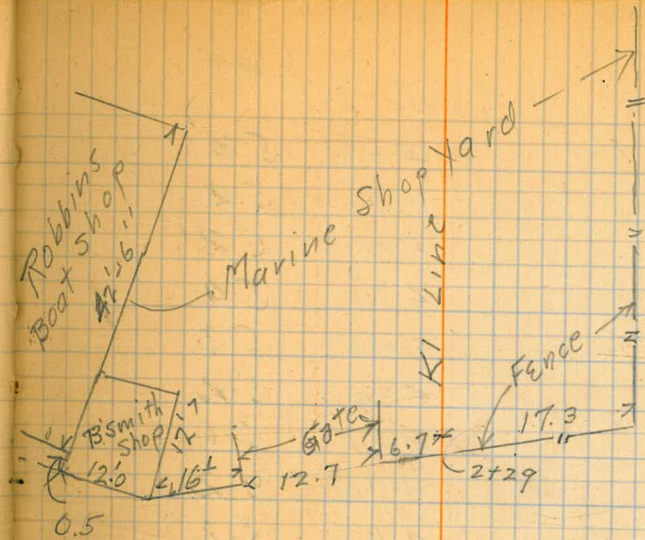

46

Elev

0+87	4.30	5.6
R13	4.50	5.4
1+00	4.50	5.4
R13	4.50	5.4
1+13	4.60	5.3
R13	4.70	5.2
1+25	4.90	5.0
R13	4.70	5.2
1+37	4.80	5.1
R13	4.80	5.1
1+50	4.60	5.3
R13	4.70	5.2
1+63	4.60	5.3
R13	4.70	5.2
1+67	4.50	5.4
R13	4.60	5.3
1+75	4.20	5.7
R13	4.30	5.6
1+87	4.10	5.8
R13	4.30	5.6
2+00	4.40	5.5
R13	4.40	5.5
2+13	4.30	5.6
R13	4.50	5.4
2+21.0	4.40	5.5
R13	4.50	5.4

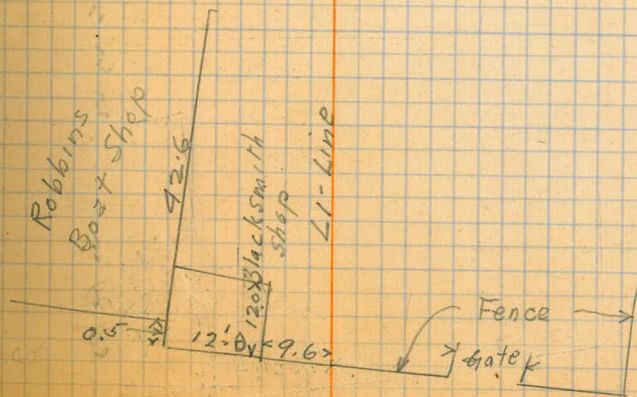

47

Elev.

M₁-M₂ Line

0+00	3.90	6.0
R13	4.00	5.9
0+13	3.80	6.1
R13	4.20	5.7
0+25	3.90	6.0
R13	4.20	5.7
0+37	4.10	5.8
R13	4.10	5.8
0+50	4.00	5.9
R13	4.10	5.8
0+63	4.10	5.8
R13	4.10	5.8
0+75	4.10	5.8
R13	4.20	5.7
0+87	4.30	5.6
R13	4.20	5.7
1+00	4.40	5.5
R13	4.40	5.5
1+13	4.70	5.2
R13	4.80	5.1
1+25	4.70	5.2
R13	4.80	5.1
1+37	4.60	5.3
R13	4.60	5.3

48

Elev.

1+50	4.60	5.3
R13	4.60	5.3
1+63	4.20	5.7
R13	4.30	5.6
1+67	4.20	5.7
R13	4.20	5.7
1+75	4.10	5.8
R13	4.10	5.8
1+87	4.10	5.8
R13	4.10	5.8
2+00	4.10	5.8
R13	4.30	5.6
2+13	4.10	5.8
R13	4.30	5.6
2+21.4	4.30	5.6
R13	4.30	5.6

N1 - N2 Line

0+00	3.70	6.2
R13	3.80	6.1
0+13	3.90	6.0
R13	3.80	6.1
0+25	3.80	6.1
R13	3.80	6.1
0+37	4.10	5.8
R13	4.10	5.8

Robbins Boat Shop

N1-Line

4.20

Blksmith shop

4.10

12.0

2+21.4

49

Elev

0+50	4.20	5.7
R13	4.00	5.9
0+63	4.20	5.7
R13	4.00	5.9
0+75	4.10	5.8
R13	4.10	5.8
0+87	4.40	5.5
R13	4.10	5.8
1+00	4.30	5.6
R13	4.50	5.4
1+13	4.60	5.3
R13	4.60	5.3
1+25	4.60	5.3
R13	4.60	5.3
1+37	4.50	5.4
R13	4.50	5.4
1+50	4.40	5.5
R13	4.50	5.4
1+63	4.40	5.5
R13	4.30	5.6
1+67	4.40	5.5
R13	4.30	5.6
1+75	4.30	5.6
R13	4.20	5.7
1+87	4.30	5.6
R13	4.20	5.7

50

Elev.

2+00	4.30	5.6
R13	4.20	5.7
2+13	4.50	5.4
R13	4.30	5.6
2+25.9	4.50	5.4
R13	4.40	5.5

01-02 Line

0+00	3.70	6.2
R13	3.70	6.2
0+13	3.60	6.3
R13	3.50	6.4
0+25	3.80	6.1
R13	3.80	6.1
0+37	3.90	6.0
R13	3.90	6.0
0+50	4.00	5.9
R13	4.00	5.9
0+63	4.30	5.6
R13	4.20	5.7
0+75	4.20	5.7
R13	4.40	5.5
0+87	4.30	5.6
R13	4.30	5.6
1+00	4.60	5.3
R13	4.50	5.4

N1-Line

Boat Shop
 Boat Shop
 2+25.9

51

Elev.

1+13	4.70	5.2
R13	4.60	5.3
1+25	4.60	5.3
R13	4.60	5.3
1+37	4.70	5.2
R13	4.50	5.4
1+50	4.60	5.3
R13	4.70	5.2
1+63	4.60	5.3
R13	4.50	5.4
1+67	4.60	5.3
R13	4.50	5.4
1+75	4.50	5.4
R13	4.50	5.4
1+87	4.60	5.3
R13	4.60	5.3
2+00	4.60	5.3
R13	4.50	5.4
2+13	4.60	5.3
R13	4.50	5.4
2+25	4.60	5.3
R13	4.60	5.3
2+30.0	4.70	5.2
R13	4.60	5.3

01-Line

Boat Shop

2+30.0

5v

Elev.

v2

P₁ - P₂ line

0+00	3.70	6.2
R13	3.80	6.1
0+13	3.80	6.1
R13	3.80	6.1
0+25	4.00	5.9
R13	3.70	6.2
0+37	4.20	5.7
R13	4.00	5.9
0+50	4.10	5.8
R13	3.90	6.0
0+63	4.10	5.8
R13	4.10	5.8
0+75	4.10	5.8
R13	4.20	5.7
0+87	4.40	5.5
R13	4.20	5.7
1+00	4.60	5.3
R13	4.70	5.2
1+13	4.50	5.4
R13	4.60	5.3
1+25	5.00	4.9
R13	4.80	5.1
1+37	4.80	5.1
R13	4.80	5.1

53

Elev

1+50		4.80	5.1
R13		4.70	5.2
1+63		4.90	5.0
R13		4.70	5.2
1+67		4.90	5.0
R13		4.70	5.2
1+75		4.90	5.0
R13		4.70	5.2
1+87		4.80	5.1
R13		4.70	5.2
2+00		4.70	5.2
R13		4.70	5.2
2+13		4.80	5.1
R13		4.60	5.3
2+25		4.90	5.0
R13		4.70	5.2
2+34.7		4.90	5.0
R4.5		4.80	5.1
R13		4.80	5.1

Q1 Line

0+00		3.60	6.3
R13		3.60	6.3
0+13		3.80	6.1
R13		3.70	6.2

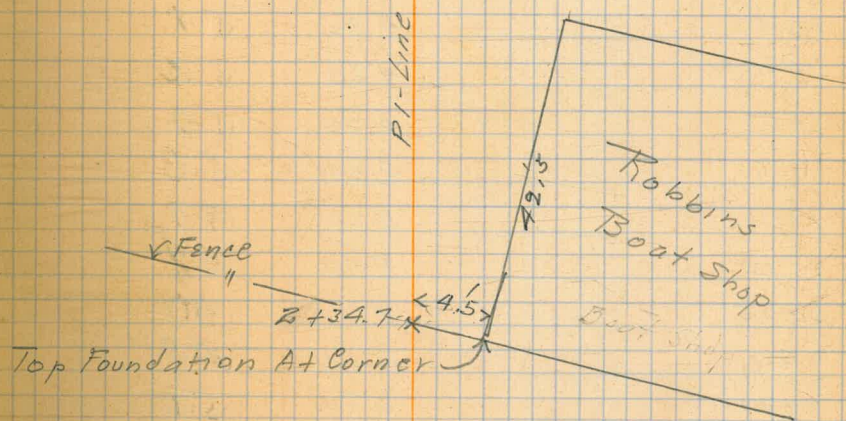

54

Elev.

0+25	3.90	6.0
R13	3.90	6.0
0+37	4.10	5.8
R13	4.20	5.7
0+50	4.30	5.6
R13	4.30	5.6
0+63	4.40	5.5
R13	4.20	5.7
0+75	4.60	5.3
R13	4.40	5.5
0+87	4.80	5.1
R13	4.60	5.3
1+00	4.90	5.0
R13	4.80	5.1
1+13	5.20	4.7
R13	5.00	4.9
1+25	5.00	4.9
R13	5.00	4.9
1+37	4.90	5.0
R13	4.90	5.0
1+50	5.00	4.9
R13	4.90	5.0
1+63	5.10	4.8
R13	5.00	4.9
1+67	5.00	4.9
R13	5.00	4.9

55

Elev.

1+75	5.00	4.9
R13	5.10	4.8
1+87	5.00	4.9
R13	4.90	5.0
2+00	4.90	5.0
R13	4.90	5.0
2+13	4.80	5.1
R13	4.80	5.1
2+25	4.80	5.1
R13	4.90	5.0
2+37	5.00	4.9
R13	4.90	5.0
2+39.2	5.10	4.8
R13	5.10	4.8

R1 - Rv Line

0+00	3.50	6.4
R13	3.40	6.5
0+13	3.60	6.3
R13	3.60	6.3
0+25	3.60	6.3
R13	3.50	6.4
0+37	3.90	6.0
R13	3.80	6.1
0+50	4.00	5.9
R13	4.30	5.6

FENCE 7

← 2+39.2

Fence ↓

Robbins
Boat Shop

56

Elev.

0+63	4.30	5.6
R13	4.50	5.4
0+75	4.60	5.3
R13	4.50	5.4
0+87	4.60	5.3
R13	4.80	5.1
1+00	5.30	4.6
R13	5.00	4.9
1+13	5.10	4.8
R13	5.30	4.6
1+25	5.00	4.9
R13	4.90	5.0
1+37	5.00	4.9
R13	5.00	4.9
1+50	5.20	4.7
R13	5.20	4.7
1+63	5.00	4.9
R13	5.00	4.9
1+67	5.00	4.9
R13	5.00	4.9
1+75	5.00	4.9
R13	5.00	4.9
1+87	5.00	4.9
R13	5.10	4.8
2+00	5.00	4.9
R13	5.00	4.9

57

Elev.

2+13	5.00	4.9
R13	5.00	4.9
2+25	4.90	5.0
R13	4.80	5.1
2+37	4.90	5.0
R13	4.90	5.0
2+43.5	5.00	4.9
R13	4.90	5.0

S1 - Svc Line

0+00	3.50	6.4
R13	3.50	6.4
0+13	3.60	6.3
R13	3.60	6.3
0+25	3.60	6.3
R13	3.60	6.3
0+37	3.80	6.1
R13	3.70	6.1
0+50	3.90	6.0
R13	3.90	6.0
0+63	4.30	5.6
R13	4.40	5.5
0+75	4.90	5.0
R13	4.90	5.0
0+87	5.40	4.5
R13	4.80	5.1

R1 Line

End Fence

15.4

2+43.5

58

Elev.

1+00	5.20	4.7
R13	5.30	4.6
1+13	4.90	5.0
R13	5.00	4.9
1+25	5.00	4.9
R13	4.90	5.0
1+37	5.20	4.7
R13	5.10	4.8
1+50	5.20	4.7
R13	5.30	4.6
1+57.6	5.30	4.6
R13	5.20	4.7

I
7.67 9.70

A2 - A3 Line

7.03

0+00	5.00	4.7
R04	4.60	5.1
R10	6.60	3.1
R13	6.60	3.4
R35	5.90	3.8
0+13	5.00	4.7
R04	4.70	5.0
R13	6.60	3.1
R21	6.30	3.4
R35	5.90	3.8

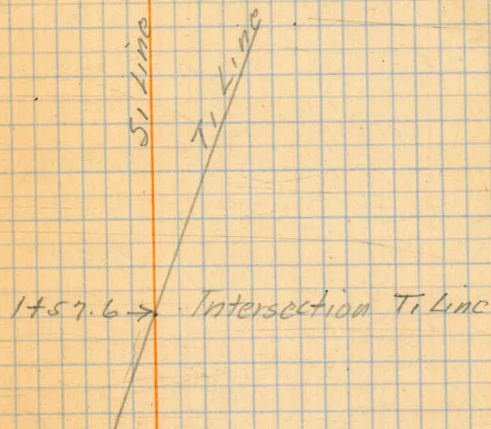

BM - 10 Penny - Tel Pole

59

Elev.

0+25	4.90	4.8
R 04	4.90	4.8
R 13	6.30	3.4
R 21	6.30	3.4
R 35	5.90	3.8
0+37	5.00	4.7
R 04	4.80	4.9
R 08	5.90	3.8
R 14	6.60	3.1
R 35	6.00	3.7
0+50	5.50	4.2
R 05	6.10	3.6
R 13	6.70	3.0
R 27	6.40	3.3
R 35	6.00	3.7
0+63	6.30	3.4
R 13	6.80	2.9
R 35	6.10	3.6
0+75	6.50	3.2
R 13	6.50	3.2
R 35	6.10	3.6
0+87	6.80	2.9
R 13	6.90	2.8
R 35	6.20	3.5
0+94	7.10	2.6
R 13	6.90	2.8

! Curb Line
0+94

60

Elev

R 35	6.40	3.5
1+00	6.30	3.4
R 06	7.20	2.5
R 13	6.80	2.9
R 35	6.20	3.5
1+13	5.60	4.1
R 04	5.70	4.0
R 10	7.10	2.6
R 13	7.00	2.7
R 35	6.20	3.5
1+25	7.40	2.3
R 13	7.00	2.7
R 35	6.20	3.5
1+37	5.70	4.0
R 08	7.80	1.9
R 13	7.20	2.5
R 35	6.20	3.5
1+50	5.70	4.0
R 08	7.00	2.7
R 13	7.30	2.4
R 35	6.30	3.4
1+63	5.50	4.2
R 07	5.50	4.2
R 13	7.20	2.5
R 35	6.30	3.4

Gutter

← X Curb
6.5

61

Elev.

1+75	5.90	3.8
R 14	7.00	2.7
R 35	6.20	3.5
1+87	5.90	3.8
R 13	7.10	2.6
R 17	7.10	2.6
R 35	6.20	3.5
2+00	5.90	3.8
R 17	6.90	2.8
R 35	6.20	3.5
2+13	6.10	3.6
R 13	6.70	3.0
R 35	6.20	3.5
2+25	6.00	3.7
R 13	6.60	3.1
R 35	6.20	3.5
2+37	5.60	4.1
R 13	6.60	3.1
R 35	6.00	3.7
2+50	5.40	4.3
R 13	6.50	3.2
R 35	6.00	3.7
2+63	5.30	4.4
R 13	6.50	3.2
R 35	5.90	3.8

62

Elev.

2775	5.40	4.3
R13	6.40	3.4
R35	5.80	3.9
2487	5.40	4.3
R13	6.40	3.3
R15	6.40	3.3
R35	5.70	4.0
3700	5.20	4.5
R04	5.20	4.5
R13	6.40	3.3
R15	6.70	3.0
R35	5.60	4.1
3713	5.70	4.0
R13	6.30	3.4
R15	6.60	3.1
R35	5.60	4.1
3725	5.90	3.8
R13	6.20	3.5
R15	6.50	3.2
R35	5.50	4.2
3737	5.60	4.1
R13	6.20	3.5
R15	6.50	3.2
R35	5.40	4.3
3750	5.10	4.6
R05	5.30	4.4

63

Elev

R 13	6.30	3.4
R 15	6.40	3.3
R 35	5.40	4.3
3+63	4.80	4.9
R 06	5.10	4.6
R 13	6.20	3.5
R 15	6.40	3.3
R 35	5.20	4.5
3+75	4.90	4.8
R 06	5.30	4.4
R 13	6.10	3.6
R 15	6.40	3.4
R 35	5.20	4.5
3+87	4.80	4.9
R 13	6.00	3.7
R 15	6.30	3.4
R 35	5.10	4.6
4+00	5.20	4.5
R 05	4.90	4.8
R 13	6.00	3.7
R 15	6.30	3.4
R 35	5.10	4.6
4+13	4.60	5.1
R 05	4.80	4.9
R 13	6.20	3.5
R 15	6.20	3.5

64

Elev

R35	4.90	4.8
4+25	4.60	5.1
R05	4.80	4.9
R13	6.20	3.5
R15	6.20	3.5
R35	4.90	4.8
4+37	4.60	5.1
R05	4.60	5.1
R13	6.00	3.7
R15	6.20	3.5
R35	4.80	4.9
4+50	4.50	5.2
R04	4.60	5.1
R13	5.80	3.9
R15	6.10	3.6
R35	4.80	4.9
4+63	4.40	5.3
R04	4.50	5.2
R13	5.80	3.9
R15	6.00	3.7
R35	4.70	5.0
4+75	4.20	5.5
R04	4.60	5.1
R13	5.70	4.0
R15	6.00	3.7
R35	4.60	5.1

65

Elev.

4+87	4.10	5.6
R04	4.20	5.5
R13	5.70	4.0
R15	5.90	3.8
R35	4.60	5.1
5+00	4.00	5.7
R04	4.40	5.3
R13	5.70	4.0
R15	5.90	3.8
R35	4.50	5.2
5+13	4.40	5.3
R05	4.50	5.2
R13	5.70	4.0
R15	5.80	3.9
R35	4.40	5.3
5+25	4.50	5.2
R05	4.60	5.1
R13	5.40	4.3
R15	5.70	4.0
R35	4.30	5.4
5+37	4.30	5.4
R04	4.40	5.3
R13	5.50	4.2
R15	5.80	3.9
R35	4.30	5.4

66

Elev.

5+50	4.00	5.7
R13	5.60	4.1
R15	5.70	4.0
R33	4.30	5.4
5+63	3.70	6.0
R13	5.30	4.4
R15	5.80	3.9
R32	4.10	5.6
5+75	3.80	5.9
R04	4.00	5.7
R13	5.40	4.3
R15	5.60	4.1
R31	4.00	5.7
5+87	3.70	6.0
R04	3.80	5.9
R13	5.60	4.1
R29	3.90	5.8
5+97.9 PC	4.00	5.7
6+00	4.10	5.6
R04	5.50	4.2
R13	3.90	5.8
R29	4.10	5.6
6+13	4.50	5.2
R04	5.30	4.4
R13	3.80	5.9

69

Elev.

6+25	4.60	5.1
R04	4.60	5.1
R13	4.70	5.0
R 27	3.70	6.0
6+37	4.50	5.2
R10	4.90	4.8
R 13	4.50	5.2
R 26	3.70	6.0
6+50	4.40	5.3
R06	4.60	5.1
R13	4.30	5.4
R24	3.70	6.0
6+62	4.30	5.4
R13	4.70	5.0
R 23	3.60	6.1
6+75	4.40	5.3
R13	4.00	5.7
R21	3.60	6.1
6+87	4.30	5.4
R13	3.90	5.8
R20	3.50	6.2
7+00	4.30	5.4
R13	3.80	5.9
R 18	3.40	6.3

Edge Pavement Cline Grape St.* N. Line Grape
6+80

68

Elev.

B2 - B3 Line

0+00	5.20	4.5
R13	5.00	4.7
0+13	5.10	4.6
R13	4.90	4.8
0+25	5.10	4.6
R13	4.90	4.8
0+37	4.90	4.8
R13	4.90	4.8
0+50	5.20	4.5
R13	5.30	4.4
0+63	5.30	4.4
R13	5.70	4.0
0+75	5.50	4.2
R13	6.00	3.7
0+87	6.00	3.7
R13	6.90	2.8
1+00	5.90	4.3
R13	5.70	4.0
1+13	5.10	4.6
R13	5.10	4.6
1+25	4.50	5.2
R13	6.60	3.1
1+37	6.80	2.9
R13	5.40	4.3

69

Ebv.

1+50	6.50	3.2
R13	6.40	3.3
1+63	4.80	4.9
R13	5.20	4.5
1+78	4.80	4.9
R13	5.00	4.7
1+87	4.30	5.4
R13	4.90	4.8
2+00	3.90	5.8
R13	3.50	6.2
2+13	4.50	5.2
R13	4.90	3.8
2+25	4.70	5.0
R13	4.80	4.9
2+37	4.80	4.9
R13	4.80	4.9
2+50	4.90	4.8
R13	4.90	4.8
2+63	5.10	4.6
R13	5.20	4.5
2+75	5.40	4.3
R13	5.30	4.4
2+87	5.20	4.5
R13	5.40	4.3
3+00	5.10	4.6
R13	5.50	4.2

70

3+13	4.90	4.8
R13	5.20	4.5
3+25	5.00	4.7
R13	4.90	4.8
3+27	5.00	4.7
R13	4.90	4.8
3+50	4.70	5.0
R13	4.80	4.9
3+63	4.70	5.0
R13	4.80	4.9
3+78	4.90	4.8
R13	4.90	4.8
3+87	5.10	4.6
R13	4.70	5.0
4+00	5.10	4.6
R13	5.00	4.7
4+13	5.00	4.7
R13	5.10	4.6
4+25	5.10	4.6
R13	5.20	4.5
4+37	5.10	4.6
R13	5.40	4.3
4+50	5.00	4.7
R13	5.10	4.6
4+63	5.10	4.6
R13	5.40	4.3

71

4+75	5.20	4.5
R13	5.20	4.5
4+87	5.20	4.5
R13	5.00	4.7
5+06	5.30	4.4
R13	5.00	4.7
5+13	5.20	4.5
R13	5.10	4.6
5+25	5.10	4.6
R13	5.10	4.6
5+37	5.40	4.3
R13	5.20	4.5
5+50	5.30	4.4
R13	4.40	5.3
5+63	5.00	4.7
R13	5.00	4.7
5+75	5.00	4.7
R13	5.00	4.7
5+87	4.70	5.0
R13	4.80	4.9
6+00	4.40	5.3
R13	4.20	5.5
6+13	4.00	5.7
R13	4.30	5.4
6+25	4.20	5.5
R13	4.40	5.4

72

6+34	4.20	5.5
R13	4.30	5.4
6+50	4.20	5.5
R13	4.40	5.4
6+63	4.00	5.7
R13	4.30	5.4
6+75	3.90	5.8
R13	3.80	5.9
6+87	2.60	7.1
R13	3.20	6.5
7+00	2.70	7.0
R13	4.00	5.7

DIRECTIONS FOR USE OF TABLES

TABLE No. 1.

Distance of slope stake from side or shoulder stake for any width roadway, slope 1 $\frac{1}{2}$ to 1. If ground is nearly level, the cut or fill at side stake is located by the double entry method in

left column and top row. The number in body of table in same row and column gives distance

to cut or fill and find distance in table. To estimate the difference in elevation between the side stake and slope stake, lower target by this amount if cut, elevate if fill. Add this amount

to cut or fill and find distance in table. To find cut rod at side stake, add distance in table to target. If it does not make the slight adjustment

necessary.

TABLE No. 2.

To find Tangent and External for curve of any other degree, divide by degree of curve and add correction found in column of corrections.

Degree of curve with a given T may be found by dividing tangent (or external), opposite T by given tangent (or external).

The distance from a point on the tangent to the curve is very nearly the square of the tangent length divided by twice the radius.

Aug. 14. 1934

de Barard.

Recorded to this point

B.M. East Pole

West " 8.62

Stanchion 5.09

St. Cor Ash-Atlantic 4.94

J Line 6.50

B.M. 10 Penny Nail Tel Pole 7.03
opposite Robbins Boat Shop