

1756



FIELD BOOK

1756

1756

MICROFILMED

DEC 29 1964

O CITY ENGINEER'S OFFICE
SAN DIEGO, CALIF.

MADE IN U. S. A.

1756

Our Leather Bound Engineers Note Books
are carried in the following rulings:

- | | |
|---------------------------------|--|
| No. 380 LEVEL BOOK. | Left and Right Hand Page
the same as Left Hand Page
of this Book. |
| No. 382 FIELD BOOK. | Left Hand Page as in this
Book, Right Hand Page 4x4
to the inch, Center Line Red. |
| No. 384 MINING TRANSIT
BOOK. | Left Hand Page as in this
Book, Right Hand Page 8x8
to the inch, Center Line Red. |
| No. 385 FIELD BOOK. | Left Hand Page as in this
Book, Right Hand Page 8 ver-
tical and 4 horizontal lines to
the inch, Center Line Red. |

We also carry the Note Books listed above,
bound in extra strong Fabri-Hide (otherwise
the same quality of book,) which can be fur-
nished at a somewhat lower price.

In ordering Fabri-Hide covered books, add
the letter "F" to catalog number.

THE FREDERICK POST CO.

ENGINEERING and DRAFTING SUPPLIES

P. O. Box 803

CHICAGO

INDEXED

to page 475

\$ Levels Santa Margarita	26-29
Weeks Ave - Cross Section	1-6
Haines St " "	7-13
Alley Bk 1 " "	14
Proposed Pump House Carleton & 14th St	30
Cross Section Alley Bk 41 Central & 14th St. + Pk 31-38	
Cross Section Garrison St. Willow to Clark	39-46

Cross Section Hecks Ave.
Cushman St. to Dorcas St.
Alignment #1753-1

indexed
c.s.K.

Lt-S

8

Dec. 5-46
S. 15007
McCoy
Model
F1100

1

Mo. 234

INDEXED

140

20.4

9.2
50

21.0

8.7
50

20.8

8.9
50

20.6

9.1
50

20.8

8.9

20.5

9.2
50

20.8

8.9
50

20.7

9.0
50

21.0

8.9
50

0+50

20.4

9.2
50

20.5

9.2
50

20.7

9.0

20.5

9.2
50

21.1

8.6
50

0+25

20.3

9.1
50

20.3

9.1
50

20.5

9.2

20.4

9.2
50

20.5

9.2
50

0+0 = H.L. Cushman

20.1

9.6
50

20.3

9.1
50

20.2

9.5

20.4

9.2
50

20.4

9.2
50

0-24.37 = Puckla Line

20.1

9.6
50

20.2

9.5
50

19.8

9.9

20.1

9.6
50

20.3

9.4
50

BM

10.26

19.43

H.L. McCoy
Hecks
T.P. Co.

BM

2.27

29.69

26.32

H.L. McCoy
Hecks
T.P. Co.
From
Note

29.69

1450

29.69

27

2

60 27.3

96

9.56

Q. 25.8

25.8

25.9

1959 94.5

5

7865

24.4

25. 20

65	74	4
----	----	---

22.6

22.8

九

7.5

22.3

23.0

66728

21.0

21.0

21.4

21.0

21.1
8.6

21.1
8.8

8. 214

8.212

Q. 21.2

29.69

2969

3

25.6	26.1	27.5	28.1	28.6	27.5
26.4	27.1	27.5	28.1	28.6	27.5
26.9	27.6	27.6	28.4	28.8	27.3
27.6	28.5	28.5	29.0	29.0	27.9
27.4	28.6	28.6	29.1	29.4	26.5
27.9	28.9	28.9	29.1	29.2	25.7
28.59	29.14	29.14	29.28	29.28	
28.83					

Necks Ave.

3+99.78 = E.L. Dorcas 245 H $\frac{1}{2}$ Sly Penn-Pok

TP 6.44 22.56 12.54 16.12

3+63

3+47

3+36.5

3+0 28.5 R $\frac{1}{2}$ of $\frac{1}{2}$ Wly Board Fence

2+70

28.66

Lt.

S

PL

5

12.4	13.7	14.2	15.0	15.6	16.7	16.9	17.1
102 50	89 30	84 20	76 15	70	59 12	58 20	55 30
13.3	15.6	16.2	17.4	22.56	17.6	17.7	
134 50	131 30	125 20	113		114 20	110 30	
12.37	16.29	17.79	18.87	19.9	19.4	19.6	20.01
237 50	237 30	237 20	237 15	237 12	237 10	237 8	237 6
17.2	17.8	18.1	18.9	19.4	19.6	20.01	
143 50	109 30	106 20	98	92 20	91 30	90 40	89 50
18.6	19.7	20.3	21.1	21.8	22.0	22.01	
181 50	99 30	84 20	76	69 20	67 30	66 40	65 50
21.92	20.6	21.2	21.4	22.6	23.4	23.1	
674 30	81 30	76 25	74 20	61	52 20	51 30	
28.66				28.66			

237 to 1000

1087 to 1000

237 to 1000

Lt

Z

PX

6

BM

6.34 16.22

SE No. 2
 OUSCOIN
 HAPKOS
 16.19
 H1681-64

4+50

22.56

10.7

11.9
50

12.4

12.4
30

12.8

9.8
20

13.7

8.9
14

14.3

8.3

15.4

7.2
20

15.8

6.8
30

22.58

X-Sect. of Haines - 75' wide
17' cbs. - from N.L. La Playa
to S. curb Mooreland Dr.

Osborne
Hardin
Worrell
Smith

W.O. 1031

See B. 1667 - P 51
for Previous Sections

Also X-Sect. 15' Alley in
Block 1 and Levels
on Prop. Drain across the
Block - 200' S. of La Playa.
Also Alternate line at 100' S.

12-19-46 Notes Reduced-
merry-

INDEXED

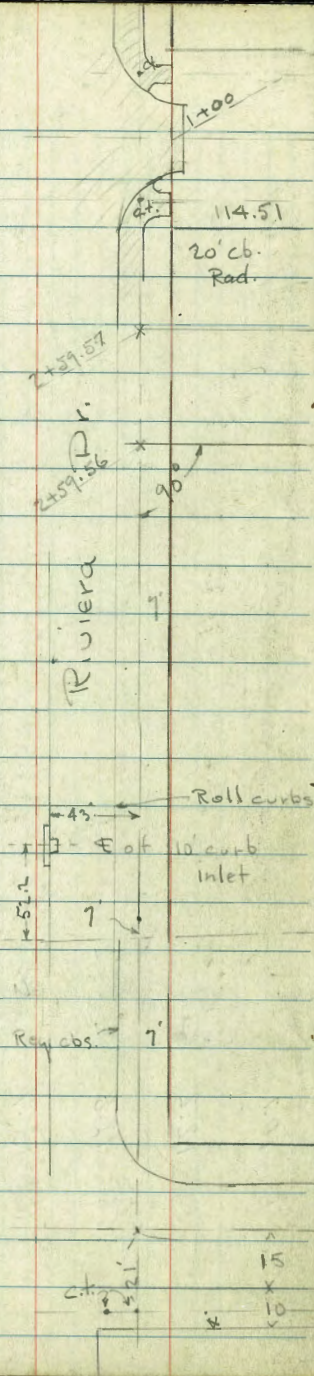

La Playa Ave.

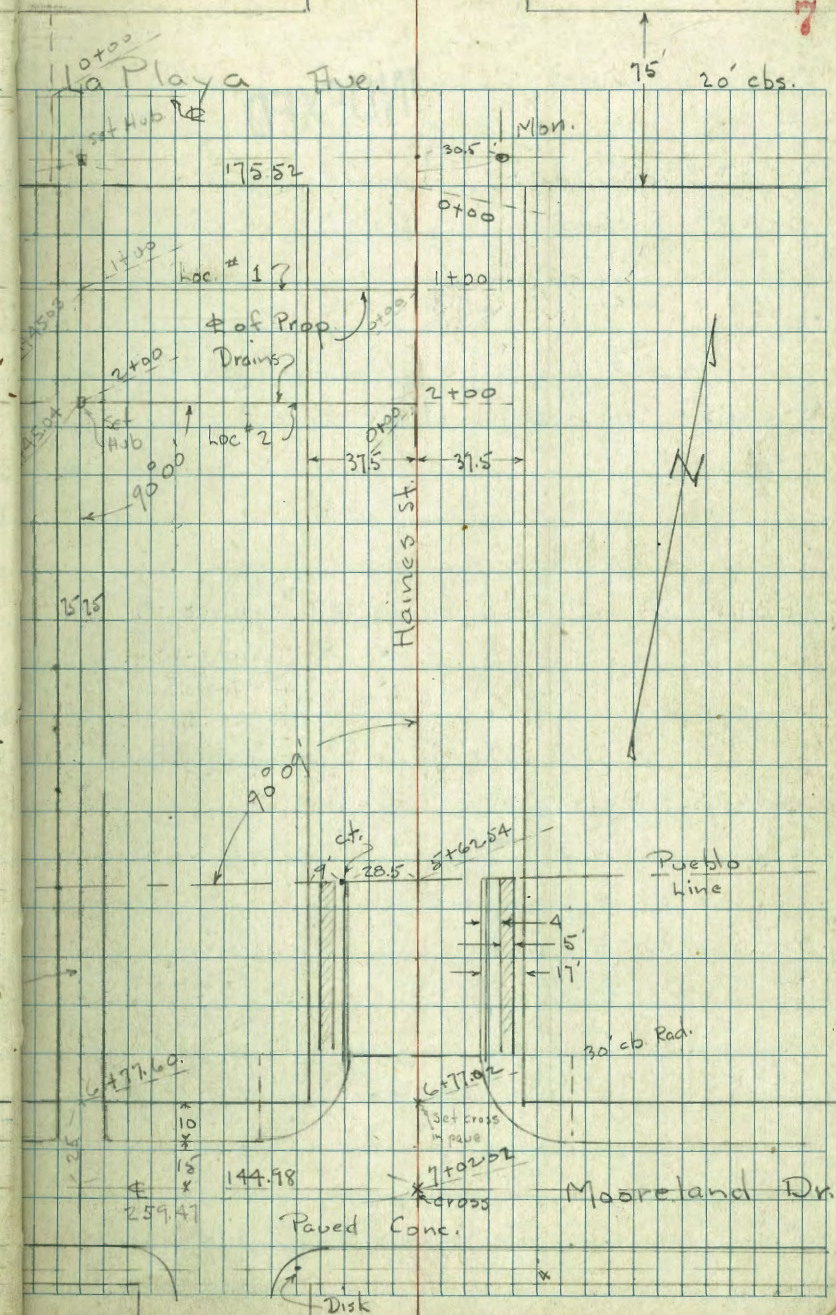

X-Sect Haines. -

INDEXED

Lt. = E.

Rt. = W

8

0-14- 30.8 Rt. = Tel pole

0-20- S. curb

20.5	21.3	21.6	21.2	21.0	21.3	21.1	21.6
1.9	3.2	3.9	4.3	4.6	5.2	5.4	7.9
37.5	20.5	10		10	20.5	37.5	37.5

0-28.75 - S 1/4 = S. side of AC Pave

20.9	20.8	20.6	20.5	20.0	21.3	21.5
3.51	3.69	3.85	4.0	4.5	5.2	6.0
37.5	37.5	31.7	20.5		20.5	37.5

edge pave

0-37.5 = E

20.92	20.8	20.89	20.5	21.7	21.0	21.5	21.7
3.56	3.50	3.59	4.0	4.8	5.5	6.0	7.8
37.5	37.5	31.5	20.5		20.5	37.5	37.5

edge pave

0-46.25 = N. 1/4

20.9	20.8	20.5	21.7	21.0	21.5
3.56	3.64	4.0	4.8	4.5	6.0
37.5	31.4	20.5		20.5	37.5

edge AC pave

0-55 = N. cb

20.5	21.8	20.69	20.5	21.0	21.4	21.8	21.9
3.33	3.30	3.79	4.0	4.5	5.3	5.7	7.6
37.5	37.7	37.7	20.5		20.5	37.5	37.5

into trap end curb out. edge of pave

0-75 = N.L. La Playa - on lawn

20.0	20.7	20.2	21.6	21.0
3.5	3.3	4.3	4.9	5.5
37.5	20.5		20.5	37.5

B.M.

13.02 32.48

19.46

N.E. B.P.
Riviera
+
La Playa

32.48

T.P. 7.40 35.23 4.65 27.83

2+00

1+98-337 = W. side Cedar Hedge - Beg

1+46 = Φ 3' Conc walk on Rt

only note new improvements

See 1667-P 53 for fences + Drives will

1+00 = 37.5 Lt = end picket fence + beg wire fence + Hedge.

0+92- 37.3 Lt = Φ Dr - 2-2' Conc strips

0+50-37.6 Lt = end wall +

0+49- 37.4 Rt = end fence

0+12- 37.5 Lt = Beg 6" Conc wall + Picket Fence

0+08 = 38' Lt = Φ Dr = 2-2.5 Conc strips

0+00 = S.L. LaPlaya - 37.5 Rt = Beg picket fence

9

Lt

Rt

21.4	21.2	20.3	20.1	21.9	21.5	21.1	20.3	20.1
3.1	3.3	4.2	4.4	4.6	5.0	5.4	6.2	6.4
37.5	20.5	15	10	10	20.5	37.5	50	

21.3	21.4	20.5	20.1	21.9	21.6	21.2	20.6	20.6	20.90	20.9
3.2	3.1	4.0	4.4	4.6	4.9	5.3	5.9	6.58		5.56
37.5	20.5	17	10	10	20.5	37.5	37.8	52.3		52.3

Top wall floor house

21.8	21.4	20.5	20.1	21.9	21.5	21.5	20.3	20.3
2.7	3.1	4.0	4.4	4.6	5.0	5.0	5.7	6.2
37.5	20.5	17	10	10	20.5	37.5	50	

21.95
2.53
37.3 on Dr.

30.18	30.0	20.5	20.7	20.4	20.0	21.7	21.5	21.5	20.7	20.5
2.30	2.5	3.0	3.8	4.1	4.5	4.8	5.0	5.0	5.8	6.0
37.6	37.5	20.5	17	10	10	17	20.5	37.5	50	

Top wall

30.14
2.34
37.5 Top wall
30.04
2.44
38-Dr

30.0	21.6	20.5	20.1	21.7	21.7	20.8
2.5	2.9	4.0	4.4	4.8	4.8	5.7
37.5	20.5	10	32.48	10	20.5	37.5

$4+24 = \$35$ Conc. walk + Conc. step in street.
not connected.

11

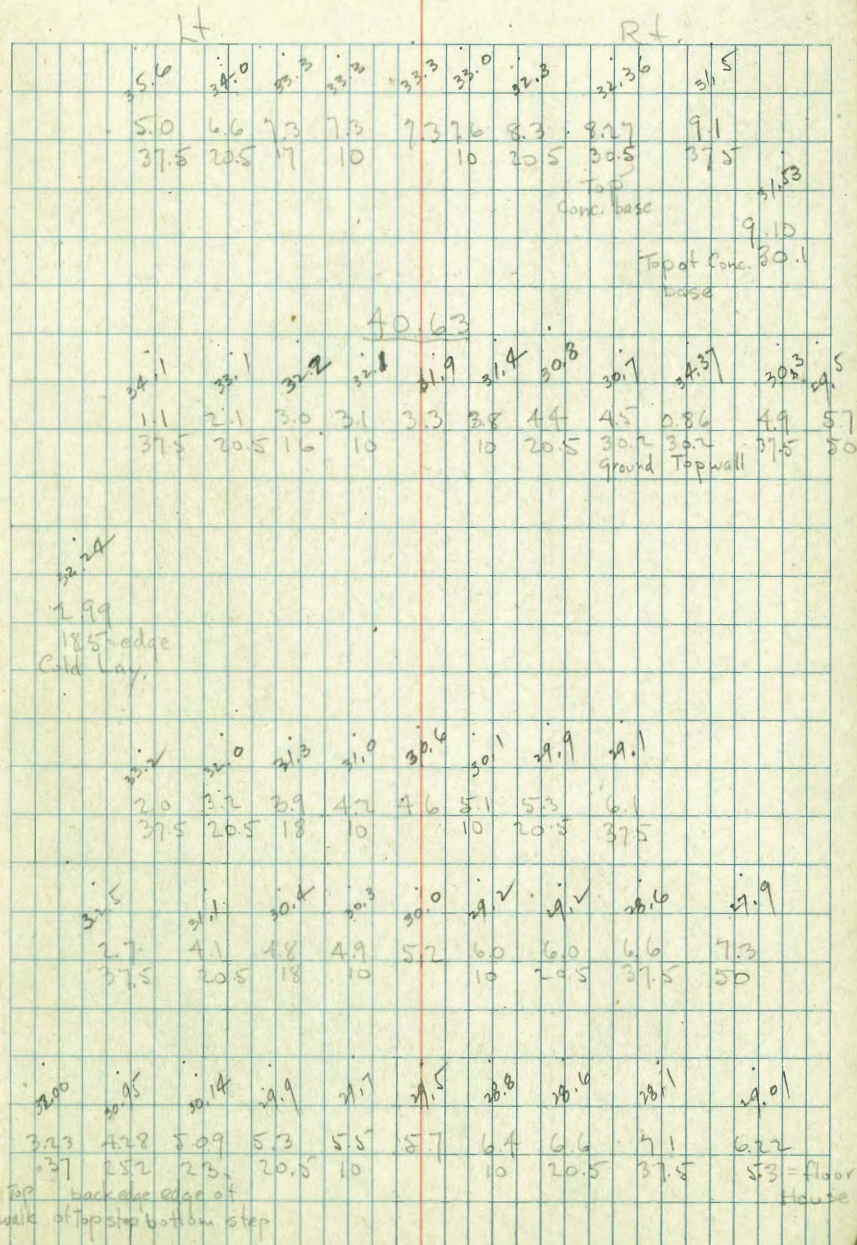

35.23

5+42.5 = N. edge of Cold Bay extension to Dr.
is shown.

[illegible]

Lt.

Rt.

T.P. for check at Alley 11.65 28.98

7+02.02 = Φ = end for add. sections along
Mooreland Sec 1467-42

6+82.02 = N. cb Line

36.19	36.00	35.47	35.18	34.09	34.54	33.98
4.34	4.83	5.16	5.45	5.74	6.09	6.65
37.5	20.5	10.25		10.25	20.5	37.5
31.28	31.19	30.30	30.09	30.53	30.27	30.14
32.5	32.4	4.33	4.74	5.05	5.36	5.69
50.5	50.5	37.5	20.5	10.25	20.5	37.5
Top	Top		40.63	10.25	20.5	37.5
						50.5
						50.5
						94
						Top-PC

cb BC of Ret.

Re-X Sect See FB 20.75 - P-10

X- Sect. 15' Alley in Block 1

T.P. 4.61 26.8 22.20

$$2 + 27 - 7.6 \text{ Lt.} = \text{end wall}$$

2400 - 7.3 Rt. = Beg board fence

$2400 - 7.3 \text{ Rt} = \text{Req board fence}$

$2+00 - 76 \text{ Lt.} = 05' \text{ S. of N. side of 4' opening in wall}$

1+75 - 7.6 Lt. = beg 8" Conc. brick wall - 5' 5" High

1+54- 7.3 Lt. = end Lath fence

1750

$$1 + 49 - 5.6 R_f = \pm P. \text{ pole}$$

$1 + 25 - 7.4 \text{ L} = \text{beg. 5' Lath fence}$

1400

0 + 50 - 7.5 Lt. = end wall

0+35 - 75 ft = Beg. 8" Conc. brick wall 5' High

0+15- 7.4 Lt. = end wall

0 + 00 - 7.4 Lt = Conc. brick wall 8"

B.M. 7.37 26.83

19.46

N.E. Rivera

+ La Playa

12-16-46

70

 $h_t = E$
$$Rf = w$$

14

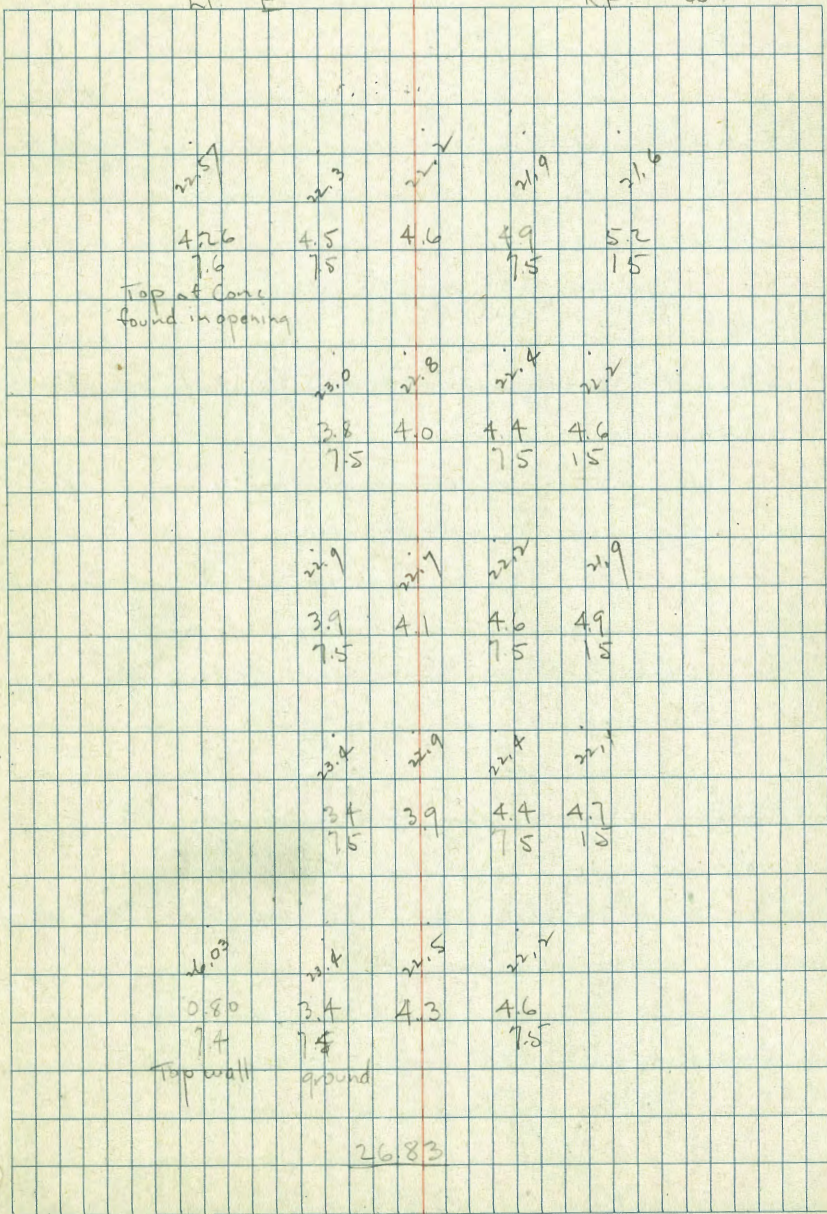

251.

6+06 1/2 S. side 3' Conc. walk along apron

6+03 = S. side Doub. Gar

6+00

5+86 - 7.8 Lt = N. side Double Gar. Conc. apron + floor

5+78

T.P. 10.01 33.06 3.76 23.05 Pipe on Rt. 5+00

5+64 - 7.8 = Lt. = end board fence

5+62 - 7.6 Rt. = beg. picket fence

5+50

5+25

5+00 - 7.5 Lt. = board fence

Lt.		Rt.	
28.96	20.63		
4.10	4.63		
10.2 - break in walk	7.5 - edge walk		
29.08	20.60		
3.98	4.20		
12.9	7.8		
floor	apron		
	20.7	21.7	21.1
	4.4	5.4	6.0
	7.5	7.5	15
29.12	20.62		
3.94	4.24		
12.9	7.8		
floor	apron		
	21.8	21.0	20.7
	5.7	6.1	6.4
	7.5	7.5	15
		33.06	
	5.8	5.8	5.3
	1.0	1.0	1.5
	7.5	7.5	15
	24.9	24.6	24.2
	1.9	2.2	2.6
	7.5	7.5	15
	24.2	23.6	23.2
	2.6	3.2	3.6
	7.5	7.5	15
	26.81		
		23.1	

check T.P.-P. 13

4.08 28.98 28.98

6+87.60 = N. cb Line

8' Rt. = end fence

6+77.60 = N.L. Mooreland + edge of Conc. pave

Note: Both curbs of Alley Ret are pushed out and broken.

6+50

6+25 - 7.6 Rt. = fence

6+12 - 6.2 Rt. = P. pole

Lt.

Rt.

29.17	28.68	28.16	27.66	28.09
3.89	4.38	4.90	5.40	4.97
7.5	7.5	7.5	7.5	7.5
Top cb.	gut.	gut.	gut.	Top
Ret.				

29.34	28.96	28.18	27.77	28.14
3.72	4.10	4.88	5.29	4.94
7.7	7.7	7.2	7.2	7.2
Top cb.	gut.	gut.	gut.	Top end Ret.

28.9	28.4	28.1	27.5
4.2	4.7	5.0	5.6
7.5		7.5	1.5

28.7	28.2	28.0	27.9
4.4	4.9	5.1	6.1
7.5		7.5	1.5

33.06

385 50%

12-17-46

7.0

18

levels on Nly of 2 prop. locations for
Drain across Blk. 1 - See sketch - 100 s of
S.L. La Playa - Loc # 1

1+80

INDEXED

1+52.5 - 0.1 Lt = beg. Row of 4"x4" posts for fence

1+45.03 = E Alley

1+00

1+00

0+76 - 29' Lt = NW Cor. House

0+70

0+52 - 29' Lt = NE Cor. House

0+37.5 = W.L.

0+20.5 = W. cb.

0+00 = E Haines - Sta. 1+00 on Haines

B.M. 9.33 28.79

19.46

NE - Rivera
La Playa

Lt. = S.

Rt. = N

1.3

7.5
2.5

1.3

7.5
2.5

1.4

7.4
2.0

2.8
6.0

1.1

4.7
2.5

1.1

5.0
2.5

1.1

4.7
2.5

1.4

3.4
2.0

1.3

3.5
2.0

1.3

3.5
2.0

1.9

1.87
29 = floor

1.1
2.1

1.5
1.3

1.9
0.9

28.79

2+56.8 = E. side + side walk + end of Dr.

T.P. 3.48 23.60 8.67 20.12

2+51

2+41.5 = end of walk along House on Lt.

2+37 = 5' Lt. = N.W. Cor. House + 8' Rt. = S.W. Cor.

2+30

2+09 = 5' Lt. = N.E. Cor. House + 8' Rt. = S.E. Cor. House

2+09 = on Lt. = end posts + beg. of S. side of 7' Conc. Drive on Rt.

2+02.5 = 1.5 Lt. = Cor. of 2' Conc. walk - both ways - w + s.

2+00

1+82 = 0.4 Lt. = N. end of 4' brick wall

Lt

Rt.

18.68	18.73	18.78	15.78	18.83
49.2	4.87	4.82	4.82	4.77
20	7.4 = N. side 3' conc. walk	walk + Dr.	7. walk + Dr.	20 + walk
	To House	23.60		
	19.4	19.46	19.47	
	9.4	9.34	9.37	
	5	on Dr.	7 = on Dr.	
20.11	20.12	20.01	20.11	
8.68	8.67	8.78	8.68	
5 = on edge N + S walk	1.5 = edge walk	on Dr.	7 = Dr.	
20.5	20.43	20.51	20.43	
8.3	8.31	8.28	8.36	
5 = ground along house	1.5 = edge walk	on 9. edge Dr.	7 = N. edge	
20.11	20.97	20.16	20.97	22.24
6.68	7.87	7.83	7.85	6.55
5 = floor House	1.5 = N. side walk	on Cor. Dr.	7 = N. Cor. Dr.	8 = floor House
	20.99			
	7.80			
	1.5 = cor. at wall			
20.9	20.9	20.9	20.9	
7.9	7.9	7.9	7.9	
20			20	
	20.96			
	5.83			
	0.4 = Top wall			
	28.79			

T.P. 10.94 29.12 5.42 18.18

Note: Gutters flow to S. to inlet on W. side near Pk.
or can carry across the street & to bay.
See sketch for loc at inlet.

2+81.4 = Φ Riviera

2+62.6 = Low point in gutter

2+61.1 = Top edge of Roll type curb at S. side of Dr.
thru curb

Lt.

Rt.

17.19

5.81
20

18.00

5.60
20 = gut.

18.6

5.0
20

17.30

5.72

18.07

5.53

18.70

4.90

17.98

5.62
20

18.18

5.42
20 inlet

18.71

4.80

18.80

4.80

8 = W. side
of Dr.

2360

check T.P.

6.55 18.18 18.18 P20

2+81.4 = \pm Riviera - Paved - Conc.

2+62.7 = low point in gutter

2+61.2 = Top edge of Roll curb & on S. side of 8' Dr.
thru cb.

2+57 = W. side of Side walk + 0.2 Lt = end Conc. wall
& end of Dr.

2+37 = 7.9 Rt. S.W. Cor. House

2+36 = 42 Lt. = ang. in walk - edge of 3' walk to W.

2+33 = 0.6 Lt = Ang. in edge of walk

2+31.5 = 5 Lt = N.W. Cor. House

23

Lt.

Rt.

17.37

17.48

17.53

7.36
20

7.25

7.20
20

17.51

17.57

17.65

7.22
20

7.16

7.08
20

18.12

18.14

18.23

18.29

6.61
20

6.59

6.50
8

6.44
20

18.16

18.21

18.24

18.29

18.33

6.57
20

6.52

6.49

6.44

6.40

42 = end of
edge of walk 3'

7 = walk +
end of Dr.

20 edge
walk

19.68

19.68

19.52

19.50

5.05

5.15

5.21

5.23

72

42

on Dr.

7 edge of
Dr

19.71

19.61

19.77

5.02

5.12

4.96

72

42

0.6 = edge
walk

walk

24.73

7.0 - 12 - 24 - 46

INDEXED

1 + 08.3 = Top or back

12-30-40

Notes Reduced Wherry -

1 + 00 = E.L. Pwiera

$0 + 97.5 =$ edge of Conc. Pavc

Note

0 + 85

 $6 + 50$

0+00 = 100' E. of E.L. of Riviera

\pm of La Playa = Base line

71.26	26.72
-------	-------

19.46

NE Riviera
+ La Playa

Handwritten: 11.45

9

$$Rt. = N$$

24

18.91	19.15	19.17	18.6	18.70	18.86	18.86	18.86	19.42	19.42	20.08
7.81	7.57	7.55	8.10	8.02	7.86	7.86	7.86	7.30	7.30	6.64
9.0	41.1	37.5	34	17.5	17.5	32	37.5	37.5	37.5	9.0
	PC. Ret	Top	gut			gut	Top	Top	Top	Top
	Top 20	Rad.						PC	Ret. 20	Rad.

19.1	19.43	19.44	19.44	18.83	19.03	19.17	19.24	19.28	19.24	19.04	19.64	19.65	19.71	19.7
7.0	7.29	7.28	7.28	7.89	7.69	7.55	7.48	7.44	7.48	7.68	7.08	7.07	7.01	7.0
37.5	34.4	29.4	25	23	17.5	8	8	17.5	22	23.7	28	33	37.5	37.5
	'edge'	Top	gut						gut	Top	'edge'	walk		
	walk		cb.							cb.				

19.9	19.49	19.90	19.08	19.25	19.35	19.37	19.39	19.14	19.17	20.0
6.8	7.23	7.82	7.64	7.7	7.37	7.35	7.43	7.58	7.00	6.7
37.5	23.8	22.3	17.5	8	8	17.5	21	22.3	37.5	37.5
	Top	low point	in gut					low point	Top	
	back edge							in Gut	Roll	curb - end.
	Roll cb.									

20.1	20.4	10.4	20.0	19.8	21.0	20.9
6.6	6.3	7.3	6.7	6.9	5.7	5.8
37.5	17.5	12	13	17.5	37.5	

21.0	21.1	21.0	21.3	21.0	21.3	21.4
5.7	5.6	5.7	5.4	5.7	4.9	4.3
37.5	17.5	13	13	17.5	37.5	

22.5	22.0	22.6	22.8	22.8	22.2
4.2	3.7	4.1	3.9	3.9	3.5
37.5	17.5	12	17.5	37.5	

26.72

Check B.M.

7.26 19.46

1+28.6 = \pm of Roadway on Riviera = end.

1+10 = Gutter - Low point in Roll curb.

Lt.				Rt.			
18.17	18.36	18.50	18.58	18.65	18.78	19.31	
8.60	8.34	8.22	8.14	8.07	7.94	7.41	
90	37.5	17.5		17.5	37.5	90	
18.53	18.56	18.56	18.67	18.80	18.83	18.86	18.88
8.39	8.16	8.16	8.05	7.92	7.89	7.86	7.84
90	41.2	37.5	17.5		17.5	37.5	39.8
	gut	gut				gut	gut
	PC	Ret.					PC
			26.72				

Santa Margarita

8-14-47

± Levels - Churchward to San Jacinto

W.O. #25001

Sommermeier
W Moore X
Sherman

See sketch F.B. 1712 Page 1.

INDEXED

1+35

1+00

0+62.5 = Edge conc. pav.

0+42.5 = N. cb. line Church ward on Paving

0+00 = ± Churchward + Santa Margarita

B.M. = ± L+T
Churchward 1.00 190.45 — 189.45
+ San Jacinto
F.B. 1712
P. 15

INDEXED m2
8-15-47

26

12.33
189.15

10.00
180.45

7.84
182.61

7.33
183.12

5.89
on task
184.56

190.45

+50

6.172.1
6.7

3+00

8.170.6
8.22+8609 B.C. Lt. $\Delta 8^{\circ} 15'$ (F.R. 1712 page 1)
R 1380 L = 199.118.170.1
8.7

2+43

8.170.3
8.5

2+00

6.172.6
6.2

1+70

3.175.3
3.5T.P. 1.05 178.83 1267 177.78
190.45

178.83

5+33

5+31

5+00

4+85.20 = E.C.

4+50

4+00

178.83

174.1
4.7174.5
4.3174.0
4.8173.6
5.2173.9
4.9173.3
5.5

178.83

Orig B.M. (189.45) 1.33 189.45

T.P. 12.93 190.78 0.98 177.85

5+51 L ♀ San Jacinto.

5+AA

178.83

1750

3.8

1748

4.0

178.83

Walker
Becker
Johnson
11-20-47

Location Proposed Pump House
Carleton o M.H. Tide Line

INDEXED

Indexed

30

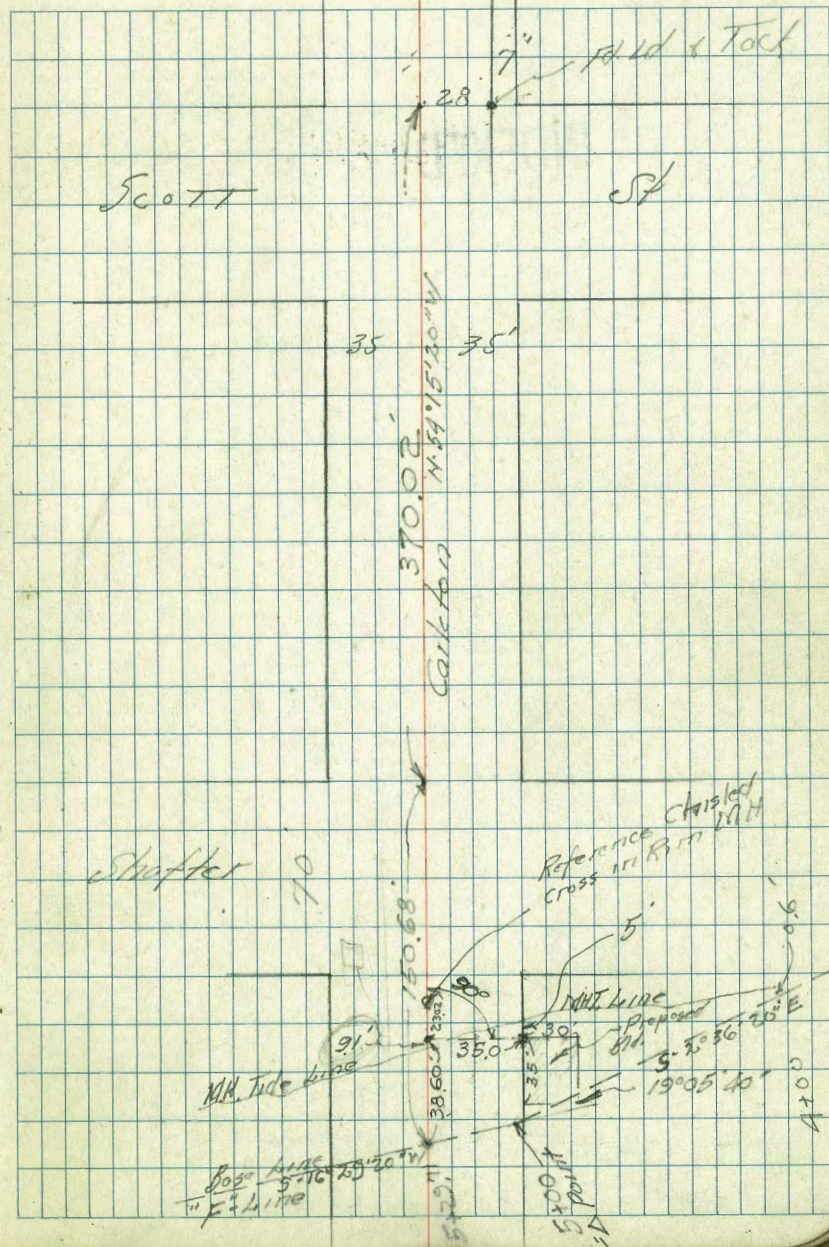

INDEXED

Ave.

2015

4

4

9

Indexed

31

41.54

Set Hub

257.

Cross
in wall.

115.96

10' 10' $\rightarrow 3 \times 10012$

6

check for 5. 7/05/09

Ave.

2/21/76

6

0700

Cross in wall

146.00'

CENTRAL

AVE.

Alley Blk 41 - Cont.

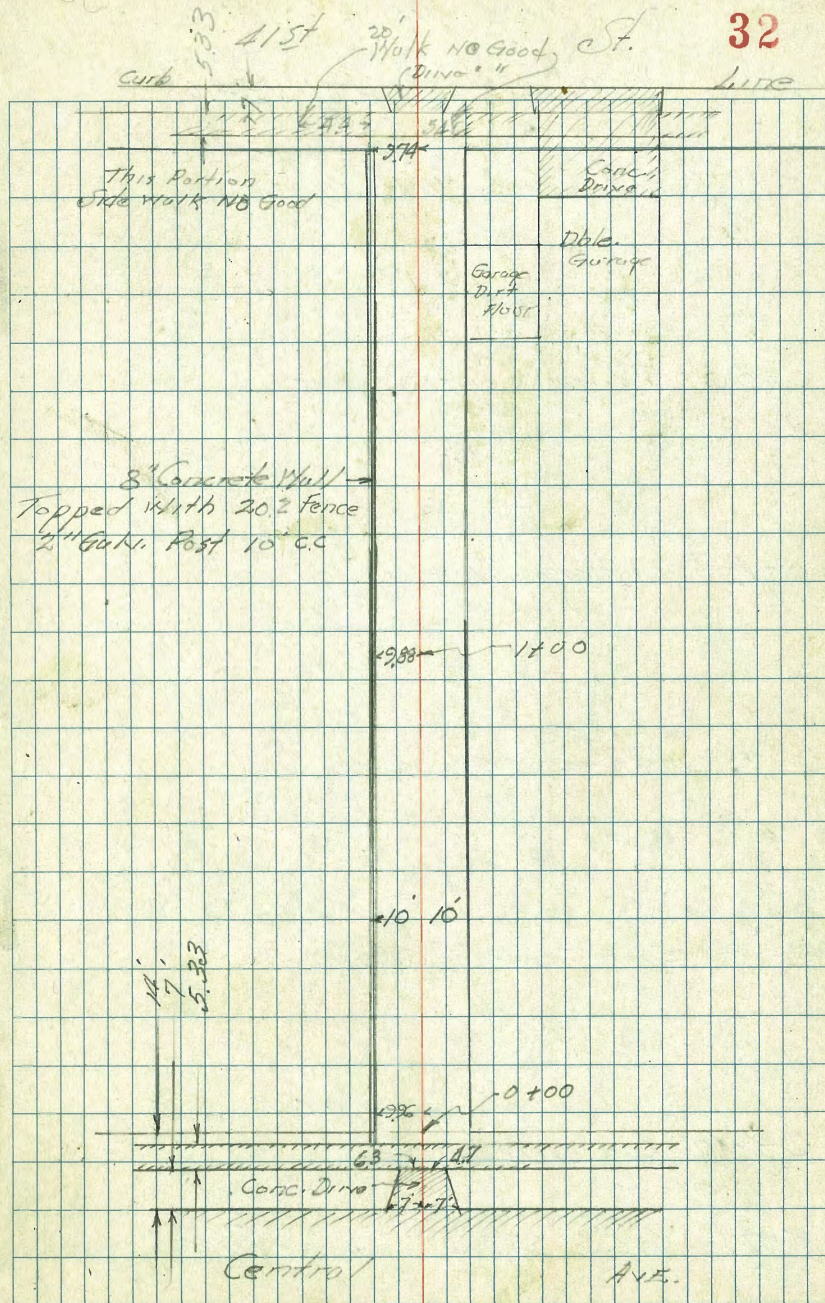

Alley - Blk 41

TP 5.60 359.68 4.07 354.08

0+07 = Brk in Conc. Wall on Lt.

0+00 = E. Line Central Ave

0-167 = East edge Side Walk

0-7 = West edge Side Walk

0-14 East Ch Line Central Ave

0-40 & Central Ave.

B.M. 6.22 358.15 351.93

385 50%

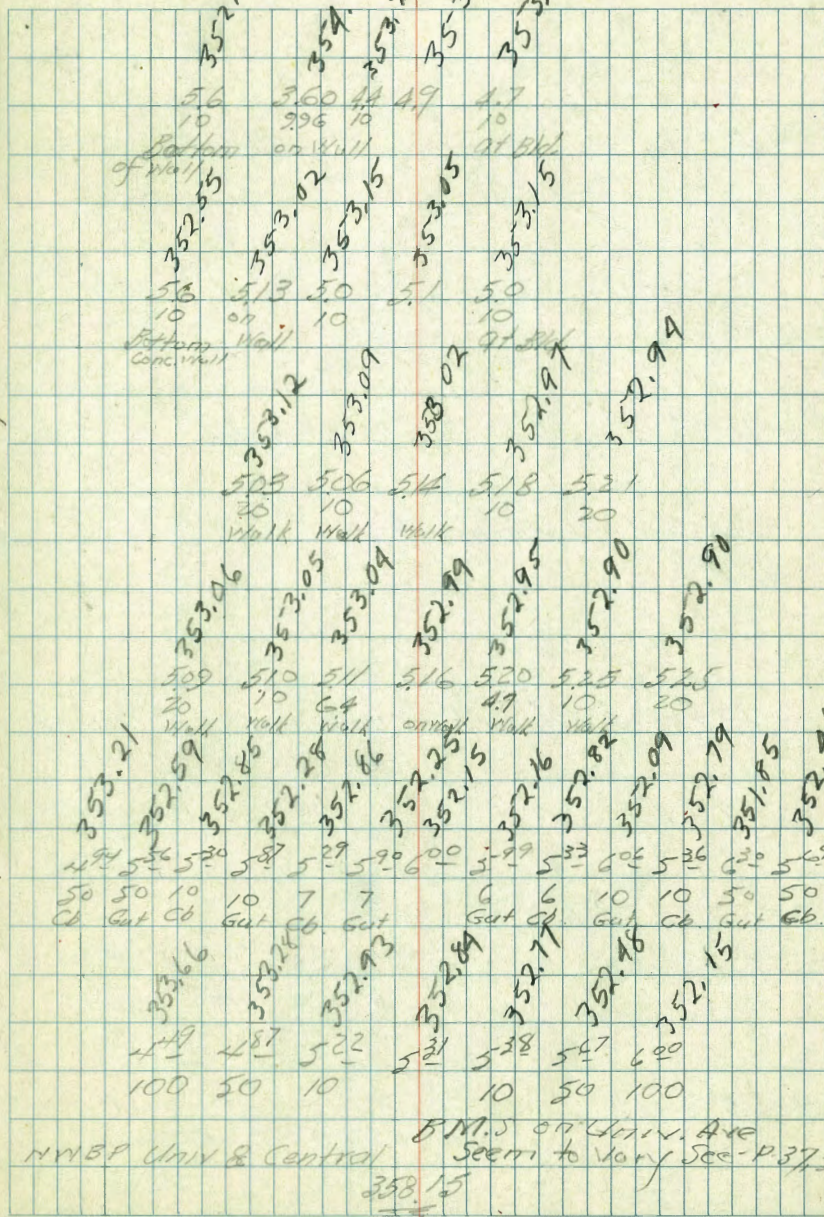

143 = Reg. Conc. April to Feb. 1914

1700

5+99 = 8" x 8" Gute Post 26 Lit. - N. edge

$0 + 80 = \text{East edge Bld. on Pt.}$

0+73.3 = 2' x 2' Vent to underneath Blvd. on Rt.

0 + 59 = 3.2' Conc. Walk

07 50

35968

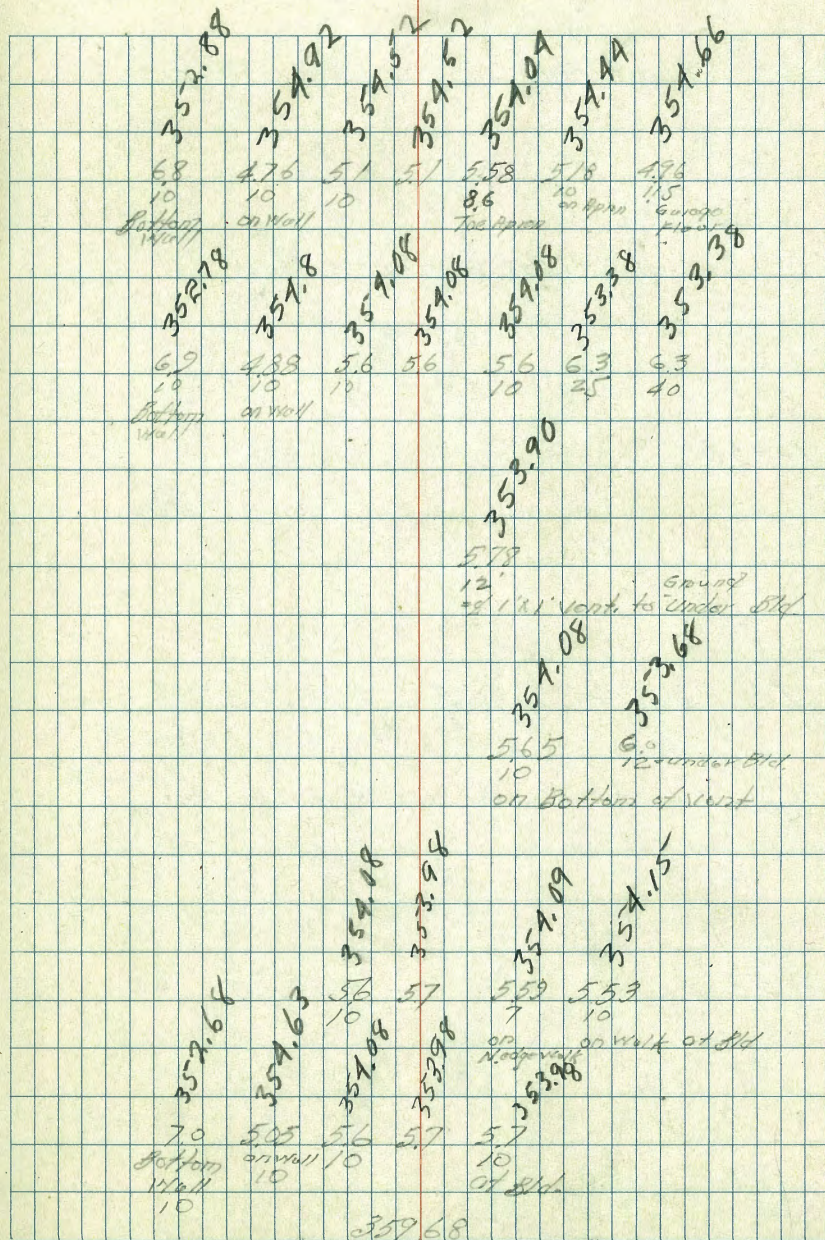

TR 393 359 24 4.74 355.31

3+00!¹² = West line 41st Street

2+93

2+80.5

2+50

2+49

2+33 = West edge doorway
360.95

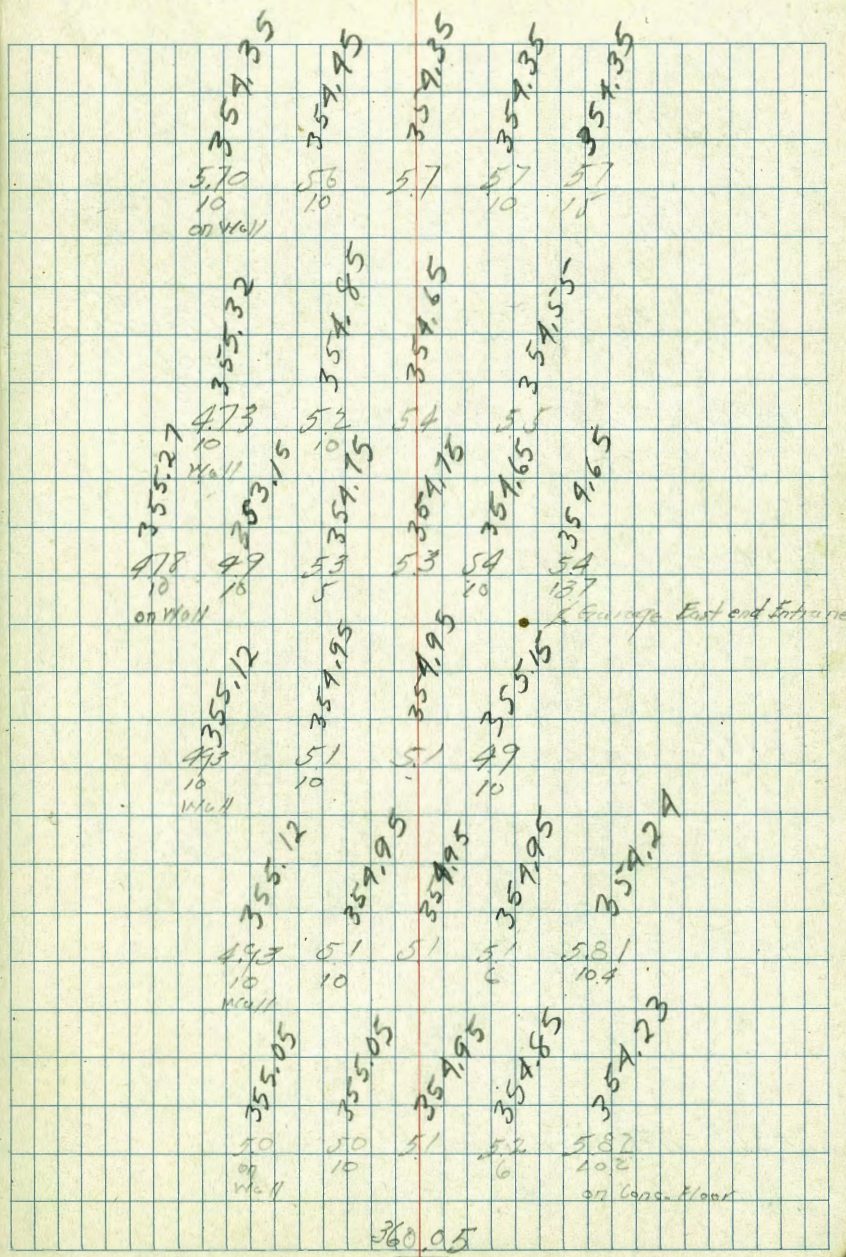

INDEXED

T.P.	5.69	362.01	0.80	356.32
chk. BM.	5		5.32	352.09 - Record
T.P.	8.51	357.12	2.45	351.80
T.P.	4.00			347.24 - BM Record
chk. BM.		351.06	6.07	347.06
T.P.	4.05	353.13	6.51	349.08
	3.66	355.59		351.93 - Starting B.M.
				0.01
TP Chk. Starting BM.			5.65	351.93
T.P.	3.50	357.57	5.17	354.07

$$3 + 40!2 = \angle 415$$

$3 + 14.4 = 17.4$ hours 4/15/14

3 ± 0.7' = East edge walk

340 p. 8 = West edge Side No 1 K
359 24

385 50%

N.Y.C. B.P. Univ. 437th

N.Y. B.P. Univ. 39th

N.W.S.P. 2714 & Central

[illegible]

Alley Block 41

Cont.

38

$\begin{array}{r} 0.07 \text{ diff} \\ 358.25 \text{ Record} \\ \hline \text{chk NW B.P.} \quad 5.22 \quad 358.18 \\ \text{T.P.} \quad 4.93 \quad 367.40 \quad 3.26 \quad 358.97 \\ \quad \quad \quad 9.09 \quad 352.64 \\ \text{T.D.} \quad 9.11 \quad 361.73 \quad 6.15 \quad 352.62 \\ \quad \quad \quad 6.84 \quad 358.77 \quad \quad \quad 351.93 \end{array}$

$\begin{array}{r} 0.25 \\ 357.64 \\ \hline \text{chk NW B.M.} \quad 4.70 \quad 357.39 \\ \quad \quad \quad 362.09 \end{array}$

Univ. & Van Dyke

N.W. B.P. Univ. & Marlborough Ave

N.W. B.P. Central & Univ.
= Starting B.P.

Brass Plug Univ. & Cherokee

Cross Section Garrison St.
Willow St to Clove St

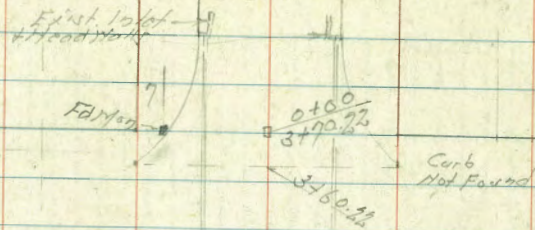

Plum St.

INDEXED

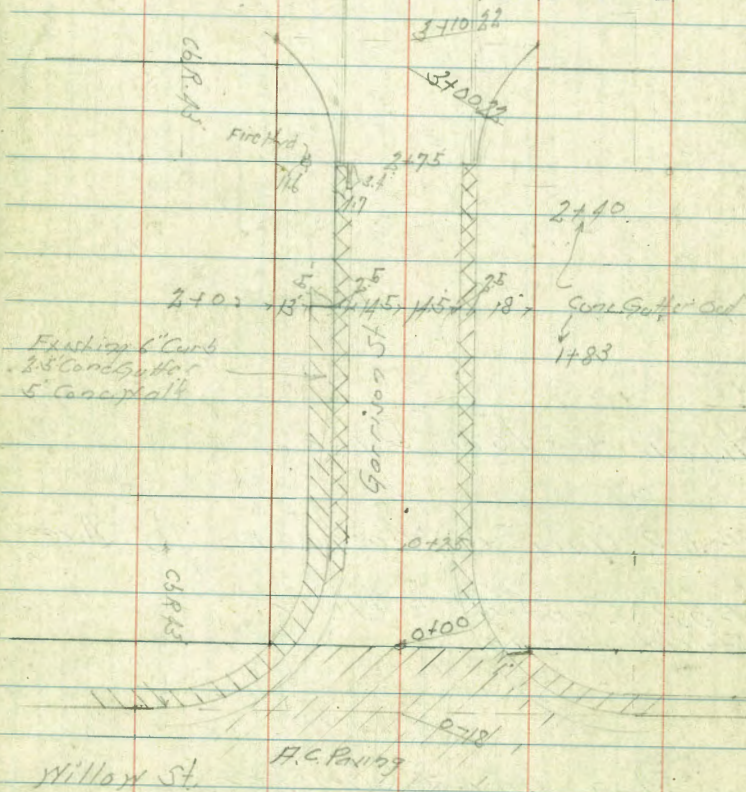

Willow St.

Indexed
B

Dec. 24. 47
S. 5502
H. 102
Smith

39

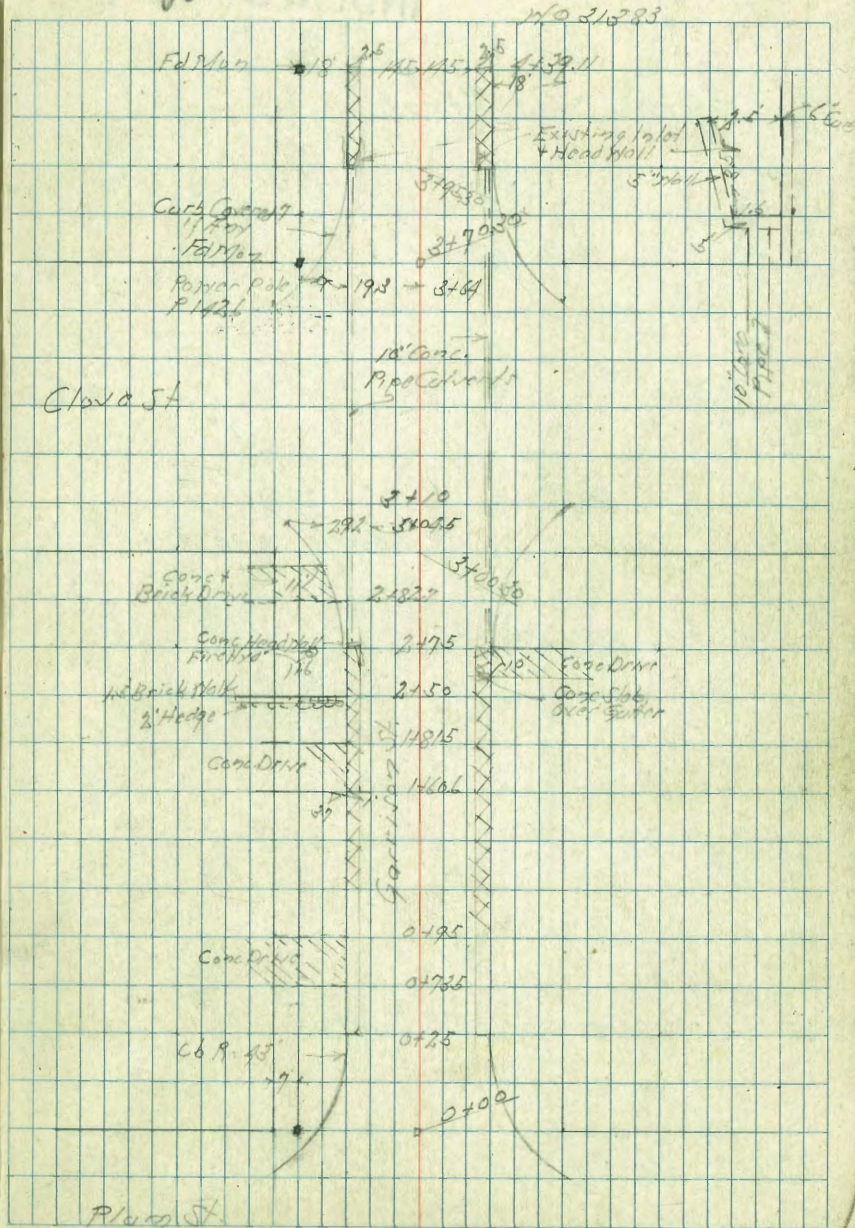

Clove St.

Plum St.

INDEXED

$$\begin{array}{r} 59.8 \\ 3.8 \\ \hline 35 \end{array}$$
$$\begin{array}{r} 59.3 \\ 4.3 \\ \hline 35 \end{array}$$
$$\begin{array}{r} 56.4 \\ 72 \\ \hline 35 \end{array}$$

7.2
35

7.2
35

57.69
1194
25.0

50.95

5/45

SW BP
Minnst &
Garrison

4th Society

Dec 26-47
Sidron
Hills
Roberts
Pt: North

40

Handwritten numbers and names on a 10x10 grid. The grid is divided into four quadrants by a vertical red line. The numbers are arranged in a pattern that suggests a multiplication table or a list of values. Names like 'Guthrie', 'Edgarson', and 'Guthrie' are written in some cells.

50.97	57.69	52.95	57.17	58.99	60.39	57.17	57.69	52.95	57.17
50.17	58.93	57.23	57.04	58.93	60.39	57.17	57.69	52.95	57.17
50.49	58.93	57.23	57.04	58.93	60.39	57.17	57.69	52.95	57.17
50.66	57.27	57.23	57.04	58.93	60.39	57.17	57.69	52.95	57.17
50.49	57.19	57.23	57.04	58.93	60.39	57.17	57.69	52.95	57.17
50.69	57.37	57.23	57.04	58.93	60.39	57.17	57.69	52.95	57.17
50.37	57.79	57.23	57.04	58.93	60.39	57.17	57.69	52.95	57.17
49.16	57.72	57.23	57.04	58.93	60.39	57.17	57.69	52.95	57.17
50.21	57.13	57.23	57.04	58.93	60.39	57.17	57.69	52.95	57.17

Names written in the grid include: Guthrie, Edgarson, Guthrie, Guthrie, Guthrie, Guthrie, Guthrie, Guthrie, Guthrie, Guthrie.

125

TP 12.05 88.37 0.08 76.32

2+01 18.1 bl of $\frac{1}{2}$ - NY Power Pole P3371

2+0

+7.5

+50

+25

TP 12.82 76.40 0.05 13.58

+01 18.1 bl of $\frac{1}{2}$ - NY Power Pole #3343

1+0

6563

H.S

2

Pt = N

41

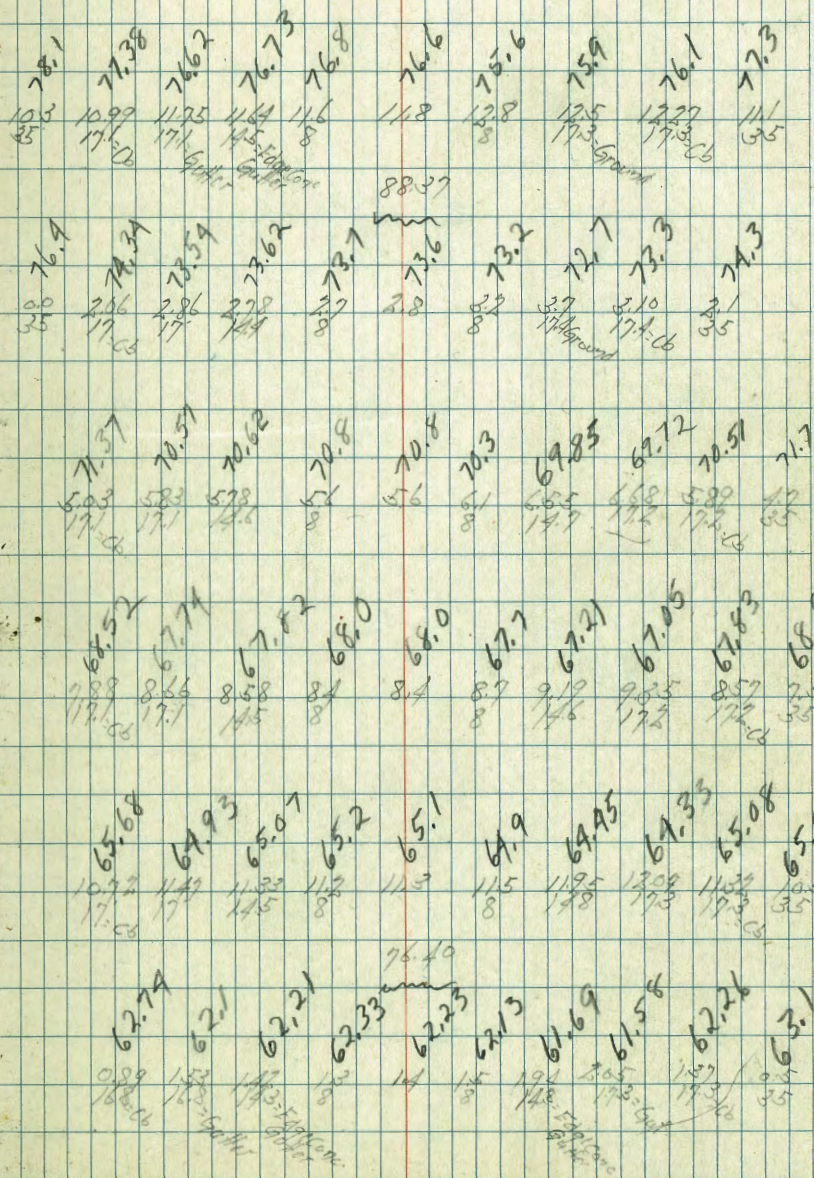

Garrison St

Dec. 29-17

Sutton
Hill
W Moore
Sherman

Lt

S

Pl

42

3+60.22 = Curb Ends Rt+Lt

3+35.22 = Pl

3+10.22 = Curb Ends Rt+Lt

3+00.22 = Fl Pl

2+75 = C.B.C Rt+Lt

TP 9.10 94.79 2.68 85.69

2+50

88.57

87.57	87.97	87.58	87.69	87.19	86.19	87.19	87.59		
727	728	729	730	731	732	733	734	No Curb	
75-60.22	75-60.22	75-60.22	75-60.22	75-60.22	75-60.22	75-60.22	75-60.22	75-60.22	
87.49	87.09	86.69	86.09	85.19	85.89	86.19			
728	727	721	727	726	725	728	728		
86.7	86.2	85.39	85.59	85.09	83.79	84.79	85.59	84.51	
899	88	94	87	97	110	100	92	1025	
86.2	85.79	85.59	84.59	84.89	84.39	84.09	84.29	83.61	84.79
86	900	93	102	89	103	114	107	106	118
725	725	728	728	728	728	728	728	728	728
83.79	83.29	82.14	82.07	82.5	82.3	82.1	81.1	80.33	80.13
110	110	1265	1372	122	125	127	127	1416	1426
29	17456	1711	1711	1711	1711	1711	1711	1711	1711
81.57	80.33	79.56	79.76	79.9	79.6	79.2	78.15	78.16	78.22
68	204	881	868	85	88	93	1027	1021	945
75	17456	17456	17456	17456	17456	17456	17456	17456	17456

88.57

1+25

104.35
5.30
3.5

0+95 Fly Conc Drive on Lt.

94.33
9.35
22
Cor. walk

0+735 Fly Conc Drive on Lt.

95.65
12.00
22
Cor. walk

TP 13.17 107.65 0.31 94.48

0+50

0+735 Carb EC

92.89
1.2
3.5

0+30 178 ft 1/2 Fly Power Pole P3401

0+6
327022 Fly Plum

94.79

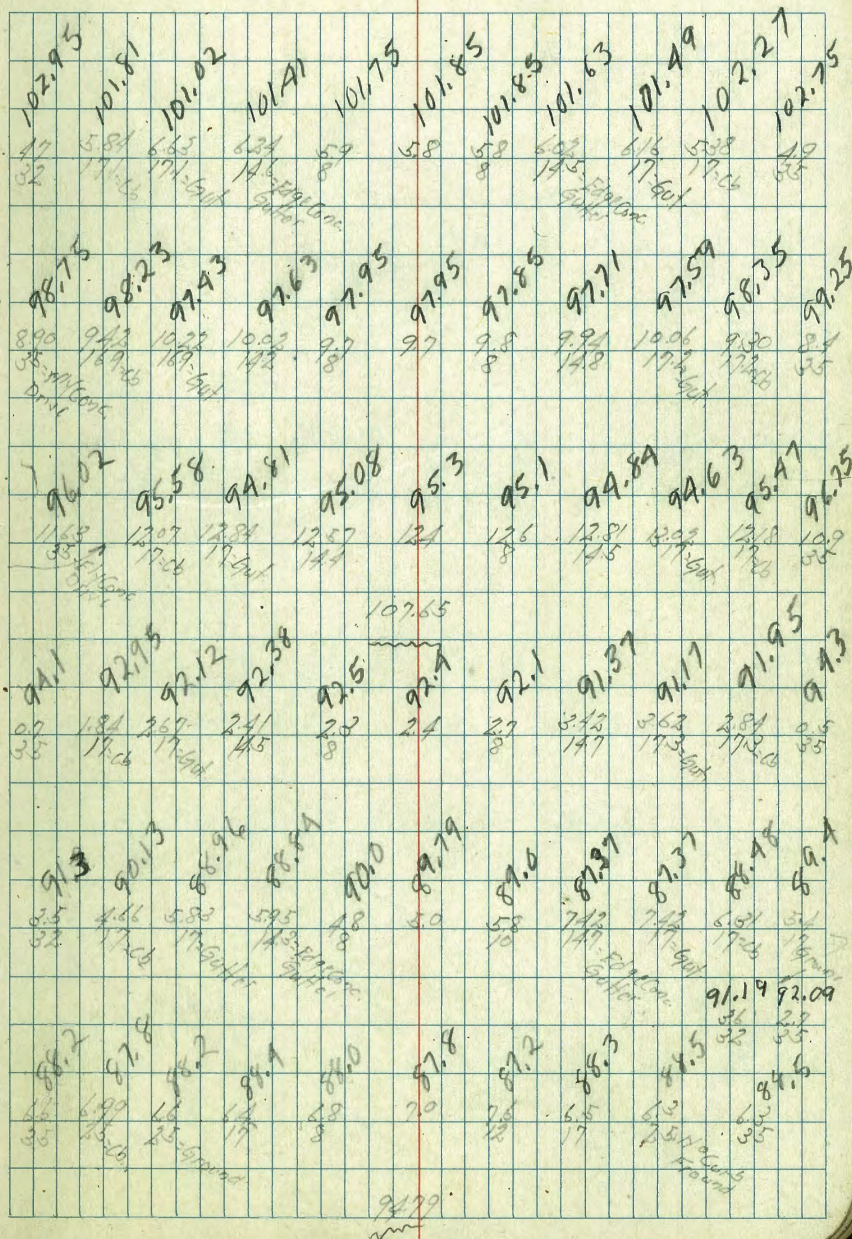

2150

+37 182.10/2 - Hly Power & Tel Pch * S.P. 3481

TP 10.98 128.72 0.35 117.94

2125

210

+815 = Hly Conc Drive 02/11

OK for ends. - E Dr. See P 53

+606 = Hly Conc Drive 02/11

TP 10.92 118.29 0.28 107.37

+50

107.65

LT

2

PT

44

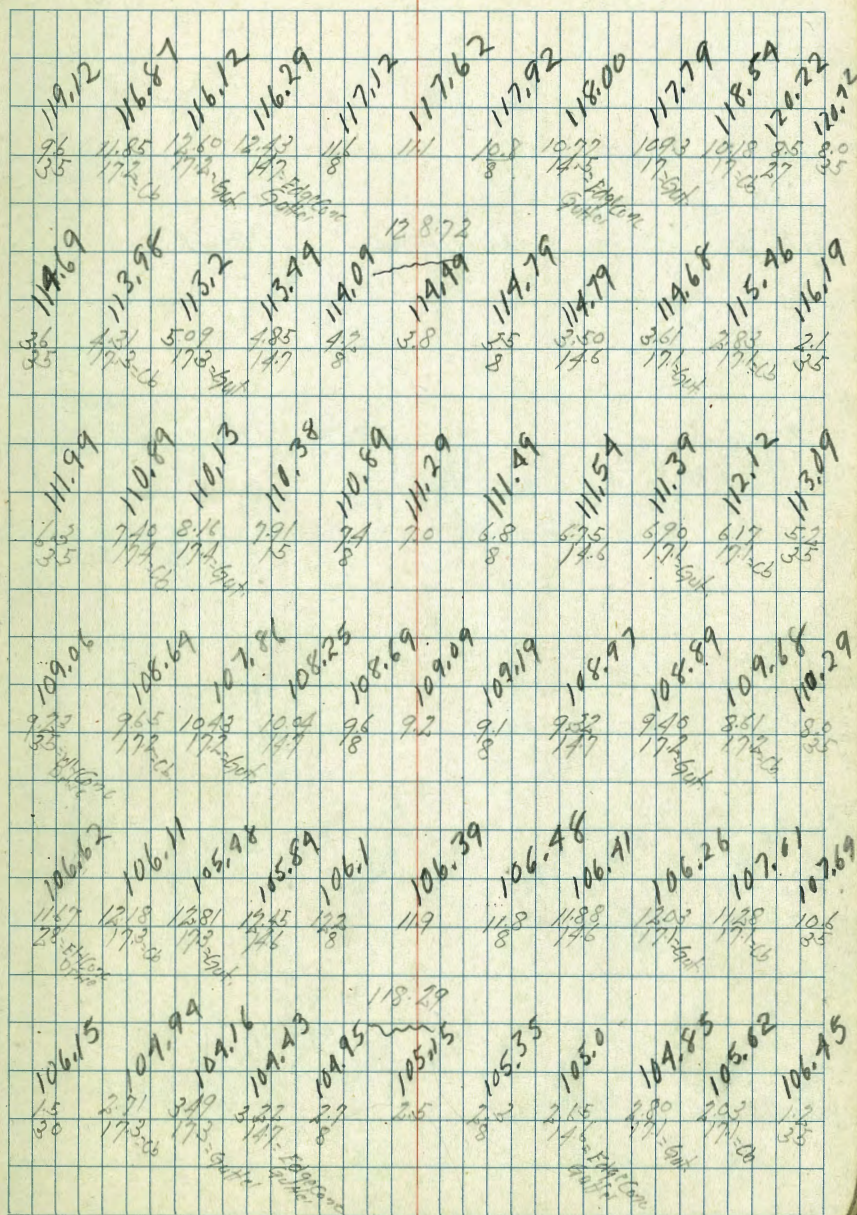

3+60.3 = Curb End of Rt.

TP 978 135.90 2.60 126.12

3+35.3 = 1/2 Clover

BM 3.32 125.40 NEBD
Clover
Garrison
125.47

3+10 = Curb End of Rt.

3+04.5 = Curb End of Lt.

3+00.30 = FL Clover

2+75 = Curb BC Rt & Lt

128.72

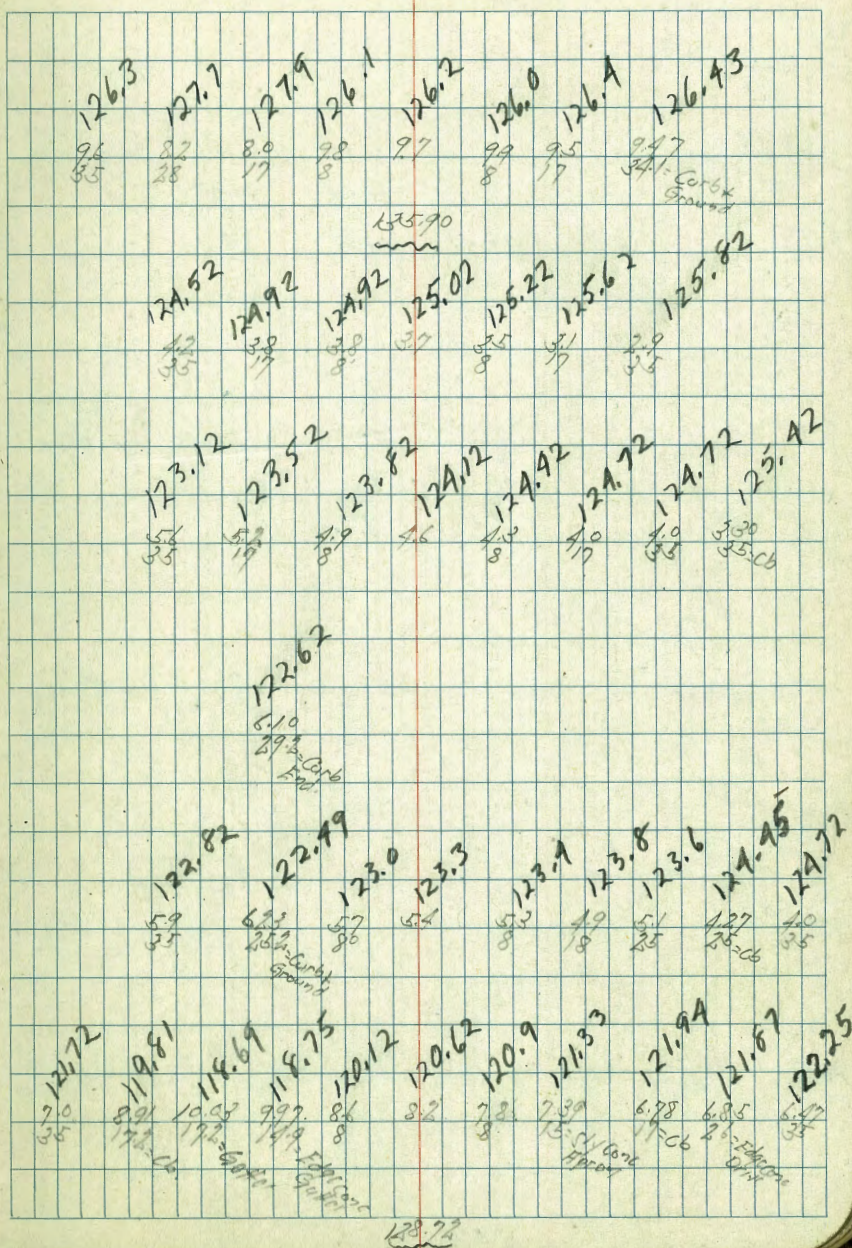

BM			11.15	51.47	58.80 Willow + Garrison 57.45
TP	0.39	62.62	13.18	62.23	
TP	0.08	75.41	13.15	75.33	
TP	0.14	88.48	13.05	88.34	
TP	0.26	101.39	13.09	101.13	
TP	0.52	114.22	12.67	113.60	
TP	0.87	126.27	10.50	125.40	12.87 Clover + Garrison

4+39.11 = W/4 Curb & Conc. Gutters R+L

45
35

4+203

3+95.30 = Curb FC R+L

80
35

3+70.30 = W/4 Clover St

135.90

137.2	133.22	132.41	132.67	133.5	133.6	133.8	133.53	133.36	134.15
27	348	346	333	24	23	21	237	254	175
32	17.2	17.2	14.0	8	8	8	14.0	10.0	10.0
131.2	130.87	130.07	130.23	132.2	131.9	131.0	131.32	131.1	131.86
47	52	52	52	27	40	19	458	490	404
35	17.2	17.2	17.2	8	8	8	14.0	17.2	17.2
126.03	127.08	126.95	128.1	129.8	129.9	129.0	129.7	127.69	127.9
787	832	825	78	61	60	69	72	821	830
17.2	17.2	15.5	15.5	8	8	8	14.0	10.0	10.0
126.2	128.3	128.2	128.9	127.7	127.0	126.7	126.79	127.5	127.5
97	76	77	70	82	83	97	97	84	84
35	27	17	8	3	3	3	3	3	3

135.90

W.O. 60229

1-19-48
7.0.

INDEXED
JAN-02 1948

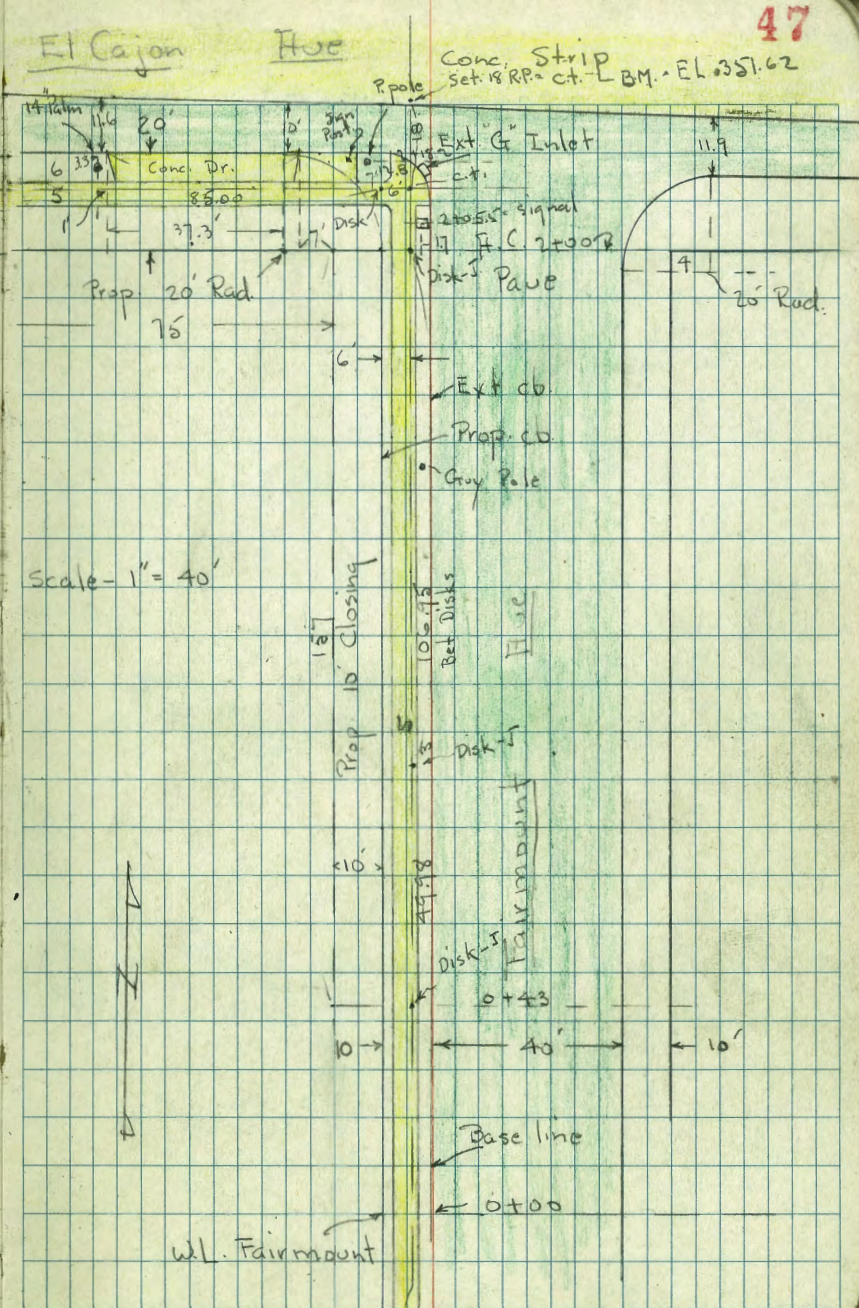
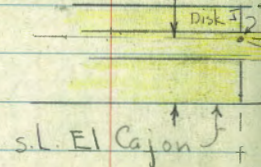

SW.B.P.
Fairmount
El Cajon

[illegible]

2+29.7 = Edge of Conc. Pavement
Base line prod. - Rods on edge of Pavement - see sketch

2+20 = along cb. Line of El Cajon

2+18.4 - 17.3 Lt = \pm 3"x3" Sign Post

2+18.2 - 12.8 Lt = \pm P. pole # 4349

Flow line of Box - on Ext. G Type Inlet

2+14 = along outside of walk

2+09 = along Line of Back of 5' walk along
El Cajon

2+05.5 - 1.7 Lt = \pm Signal Post.

2+02 = Top of cb. at N. end of Dr.

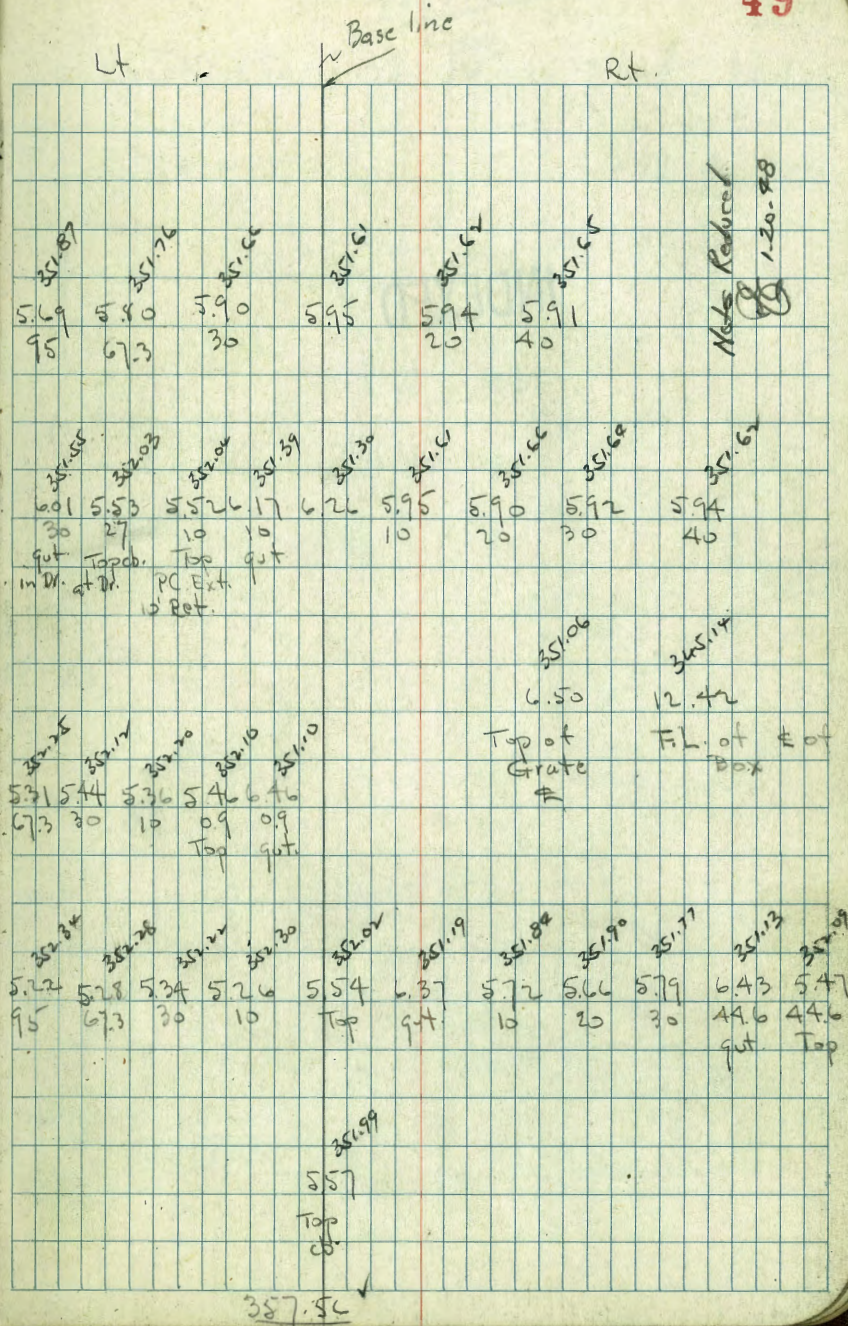

Add. Rods around Returns - Garrison
Willow + Plum.

W.O. 31383

2-4-48

7.0.

INDEXED

Indexed
of

50

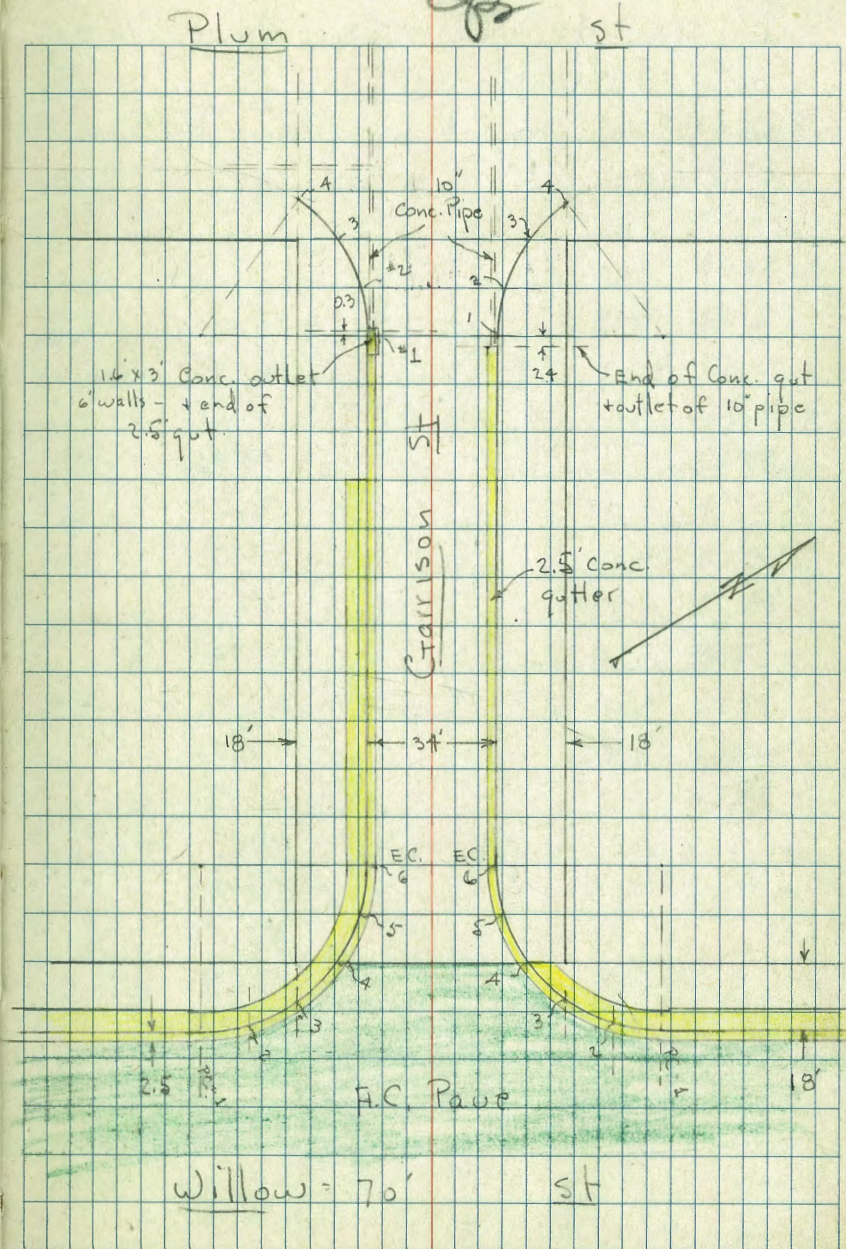

Rods Around N.W. + S.W. Returns at Willow + Garrison.

Rods taken on positions shown by numbers on sketch.

	7.78	59.23	51.45	sw. Willow + Garrison
SW. Ret.				
Req. #1 = P.C. on W. ch. Garrison	8.27	50.96	T = Top	
	9.03	50.20	q = gut.	
#2	8.36	50.87	T	
	9.03	50.20	q	
#3 = S.L. Garrison	8.09	51.14	T	
	8.77	50.46	q	
#4 = W.L. Willow	7.52	51.71	T	
	8.27	50.96	q	
on Radial Line outside of 25' Conc. gut.	8.11	51.12	E = outer	
#5	6.45	52.78	T	
	7.17	52.06	q	
	7.04	52.19	E	
#6 = E.C. = end.	5.28	53.95	T	
	6.06	53.17	q	
	5.90	53.33	E	

N.W. Ret. of Plum + Garrison.

	59.23			
#1 = P.C. on W. ch. Garrison	9.01	50.22	T	
	9.78	49.45	q	
#2	8.59	50.64	T	
	9.35	49.88	q	
#3 = N.L. Garrison	8.07	51.16	T	
	8.82	50.41	q	
#4 = W.L. Willow	7.56	51.67	T	
	8.27	50.96	q	
	8.09	51.14	E	
#5	6.49	52.74	T	
	7.19	52.04	q	
	7.12	52.11	E	
#6 = E.C. = end.	5.29	53.84	T	
	6.09	53.14	q	
	5.92	53.31	E	

Rods around Returns - N.E. + S.E.

Plum + Garrison

5.26 90.95

85.69 SE. FH.
P. 42

S.E. Ret. - see sketch for loc. of numbers

2.7 E. of P.C. (#1) = end of Conc gut. at end of

Conc outlet

8.00 82.95 T

8.99 81.96 q

outside edge of gut. 8.77 82.18 E

1 = P.C. 7.66 83.29 T

+ end of 10" pipe 8.91 82.04 q.

0.3 W. of P.C. = face of Head wall

7.63 83.32 Top cb.

F.L. end pipe 8.92 82.03

2.1 out - Top - outside Cor. 7.67 83.28

2 6.29 84.66 Top cb.

3 = E.L. Plum. 5.12 85.83 T

4 = S.L. Garrison = end of cb. 4.26 86.69 T

90.95

N.E. Ret.

2.4 E. of P.C. = end of Conc gut. + outlet of 10" pipe

9.42 81.53 Top cb.

10.63 80.32 gut

0.8 out = F.L. = 10" pipe

10.66 80.29

out side edge of end gut.

10.18 80.77 E

1 = P.C.

9.12 81.83 Top.

2

8.16 82.79 Top

3 = E.L. Plum.

7.34 83.61 Top

4 = N.L. Garrison = end cb.

6.43 84.52 Top

Add Rods on Garrison - See
Orig. Sections on P. 40

1+67.5 = \pm 16' Conc. Dr. on Lt.

on P. 43

0+86 = \pm 18' Conc. Dr. on Lt. - note both ends

0+00 = W.L. Plum.

Rest of Block O.K.

2+00

1+59.5 = \pm 10' Conc. Dr. on Lt.

T.P. 12.43 26.99 0.16 64.36

1+13 = \pm 18' Conc. Dr. on Lt.

0+92 = \pm 18' Conc. Dr. on Lt.

B.M. 13.07 64.52

51.45 willow
Garrison

10.20	11.20	12.02	11.65
35	22	17.2	14.6
on Dr.	put	edge	

118.29 P. 44

10.10	10.48	11.37	11.10
35	22.1	17	14.5
on Dr.	walk	put	edge

107.65 - P 43

2.56

22 - Back Cor.
end walk

6.75	7.47	8.23	8.22
35	19.8	16.8	14.3
on Dr.	walk	Dr.	edge

76.99

0.71	0.18	0.94	0.84
35	19.8	16.8	14.3
on Dr.	walk	put	edge

18.5	2.79	3.55	3.35
35	19.9	16.8	14.3
on Dr.	walk	put	edge

64.52

Reg. cb. - no Dr. Sect.
 1 + 88 = £ 11' Brick + Conc. Dr. on Lt.

6.46
 35
 Dr.

7.24 7.5
 19 19
 Top gut

128.72 P45

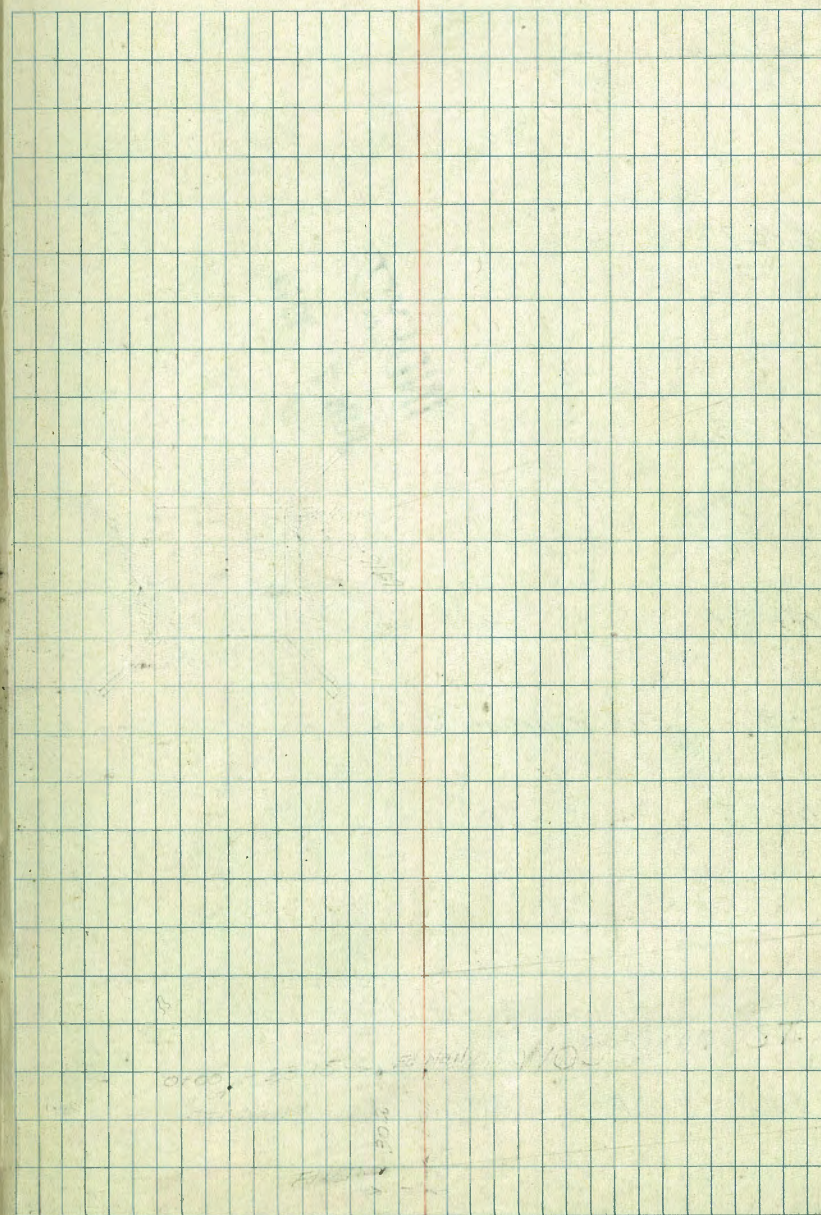

6-4-48 X Sects. to Determine Fill
Hendricks Needed for Bridge on Imperial
Walker Ave. East of Woodman
Becker
Oakley
WD#60110

56

See P 61 for sketch

0+67

INDEX
JUN 7 1948

0+53

221.3	222.4	222.4	227.5	229.0	229.00	229.16	229.35	229.9	220.9	220.2	220.3
12.7	11.5	11.5	6.5	5.9	5.0	4.8	4.6	4.6	13.1	13.8	13.7
50	30	21	14	10	9	7	9	14	26	50	(see p 61)

222.0	225.5	228.4	229.9	229.06	229.19	229.25	230.1	232.1	232.7	232.1
12.0	8.5	5.5	4.5	4.5	4.5	4.5	3.9	1.9	1.3	1.0
46	38	30	19	9	7	14	20	30	50	

0+34

228.9	229.9	229.4	230.5	229.1	229.06	229.15	229.17	229.4	230.0	232.6	235.4
5.5	4.6	4.5	5.5	4.5	4.5	4.5	4.5	4.5	4.5	1.5	1.5
50	42	30	24	19	10	7	17	19	26	50	

0+38 Fire Hydrant 20' RH

0+25

229.7	230.4	230.6	230.2	228.9	229.02	229.09	229.13	229.41	230.2	232.4
4.3	3.5	3.4	3.3	5.1	5.0	4.5	4.9	4.5	3.8	1.8
50	44	30	25	19	8	6	15	30	50	

0+00 E Woodman & Imperial

230.1	230.8	230.6	228.8	228.95	229.01	229.08	229.28	230.26	231.93
3.7	3.3	3.4	5.2	5.0	5.0	5.0	4.7	5.2	2.1
50	30	26	19	9	6	16	30	50	

BM 3.64 234.04

230.40

SW 7' L&T Imperial & Woodman FB 1688-59

Cont'd from P. 56

T.P. 253 23183 474 22930

2+00 Anchor Pole 19.3 Rt

1+92 Power Pole #410562H 22.1 Rt

1+86.5 6" Tree 22.8 Rt

1+50 (section)

1+60.5 9" Tree 21.5 Rt.

1+40 16" Tree 18.8 Lt.

1+15 (section)

1+36 14" Tree 21.2 Rt.

1+18 24" Tree 21.5 Rt.

1+00

0+91 End Conc Rail

0+82.67 Intersection of & Proposed Drain

0+71 Beg Conc Rail of Bridge 1.15 wide

23404

57

227.6	229.1	229.59	229.74	229.60	229.1	228.2	225.7	221.1	221.6
64	49	45	30	44	49	53	53	124	124
45	73	10		8	19	32	36	37	47
226.9	226.9	228.4	229.5	229.36	229.55	229.40	229.0	227.9	227.2
71	71	55	45	48	49	46	50	61	68
50	43	24	18	10		7	15	20	21
226.5	226.5	227.3	227.4	229.9	229.23	229.37	229.40	229.5	227.4
75	75	67	65	50	45	46	45	65	65
50	43	30	21	16	10		7	13	19
224.9	225.1	226.6	227.1	229.1	229.08	229.28	229.26	229.2	227.6
71	72	74	63	49	48	47	48	64	103
50	59	22	15	10	10		7	13	22
228.9	229.8	229.9	229.39	229.34	229.14	229.25	229.25	229.25	222.6
15	14	13	42	47	49	48	47	47	114
50	37	115	112	10	9		7	80	95
				Rail	Rail	Rail	Rail	Rail	39
229.33	229.33	229.08	229.18	229.27	229.25	229.25	229.25	229.25	221.2
47	47	46	46	47	47	47	47	47	128
112	10	10		80	80	9.5			
				Rail	Rail	Rail	Rail	Rail	

0+75

INDEXED

0+62.45

Opp. Abutment 7.12 to RT

0+45

0+20

0+00

0-18.3 Conc. Ret Wall 1.5 wide

23183 from P-57

220.3 219.9 218.7 219.9 219.6
115 112 131 124 123
11 5 5 10

217.3 227.0 224.8 220.8 219.5 220.9
45 48 70 119 123 114
37 28 22 15 7

226.2 225.8 223.9 219.4 219.3 220.1 220.1 222.1 222.6 228.8 230.3
56 60 84 124 125 117 117 92 93 89 15
33 24 21 18 7 4 7 12 21 29

226.3 225.1 222.3 219.4 219.4 220.2 221.5 221.7 226.1 229.2
55 67 95 126 126 116 103 101 57 25
42 22 26 18 6 6 13 22 32

222.1 219.6 222.95 218.9 218.7 220.1 220.9 222.6 226.2 226.5
97 122 978 129 131 997 109 93 56 52
27 21 145 14 7 Top of Pier 12 18 19 30
Top Pier

228.8v
3.01
Top of Rail

1273
219.10

1+16.20 Rt Ls to Forward Line

Fl 15" pipe (see P 15 for Location)

1+18.20 A 69°30' Lt Rt Ls to Back Line

0+93

0+91.69 MH 9' Rt to & MH (2.8 dia. on top)

0+90.1 6" Water Main Conc. Pier 2' Rt

0+87.71 Opp Abutment 561 to Lt.

23183

221.9
10.4
222.97
7.7
220.8
11.9
221.8
10.9
28

222.8
9.0
18
221.9
10.4 Gr.
10.7
21.9 Hub
220.3
11.5
23
220.3
11.5
30

223.7
8.1
7
221.8
10.9
7
221.0
10.8
7
220.7
11.5
19

221.78
10.5
Rim

226.70
51.3
Top of Pipe

221.7
10.1
56
220.4
11.4
220.9
10.9
5
219.0
12.8
11
222.2
9.5
20

B17

1.43 230 40 230 40

2439.69

2t 14 Bag Rock & Wire Ret. Wall

1482

1162

1442

231.83

5.17 Tack Imperial & Woodman

225.8	222.8	221.0	220.8	221.4	221.6
60	110	108	93	82	42
8	7		3	7	18

228.5	221.8	221.4	223.4	227.4
53	109	106	85	45
10	7		15	24

227.3	223.9	222.8	221.7	222.0	224.9	227.0
45	78	90	101	98	69	48
12	8	2		12	23	29
227.5	227.1	222.9	222.9	221.9	222.0	222.1
43	22	85	88	95	98	75
15	6	1	8	9	11	26
222.2	222.8	223.2	221.6	221.7	223.7	
46	10	86	102	89	21	
2	8		22	21		

Notes Reduced. G. T. 08

Location Proposed Culvert
Under Bridge on Imperial Ave
East of Woodman St.

IMPROVED

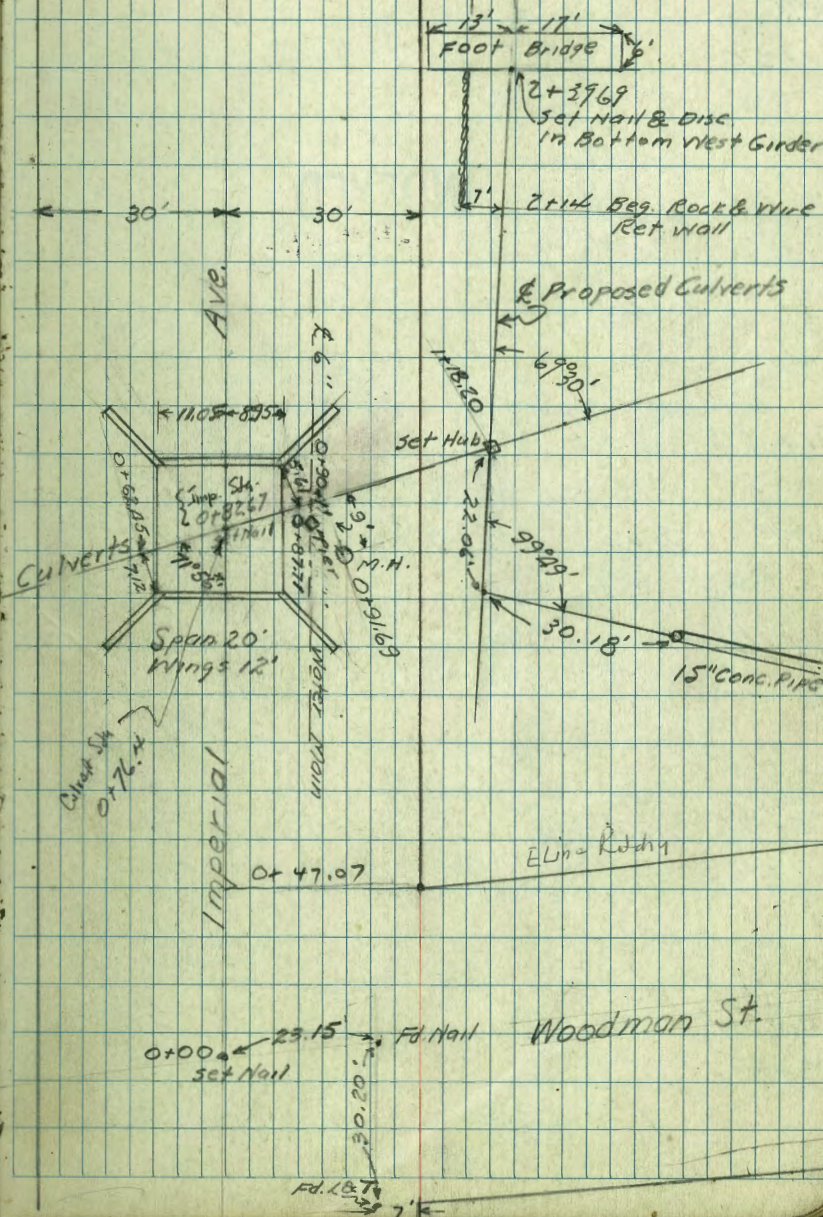
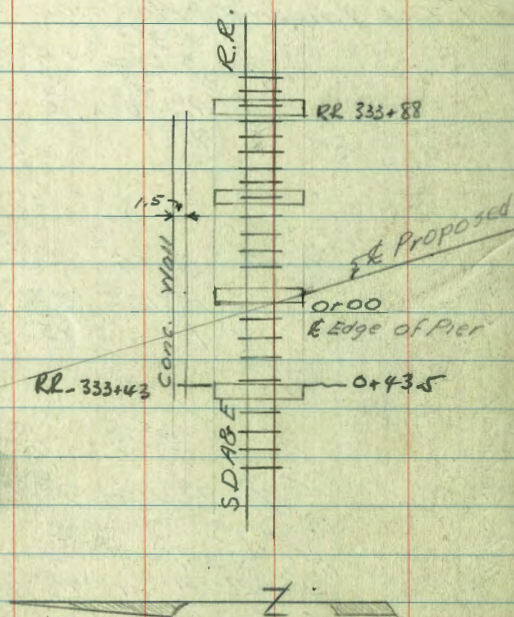

6-9-48 Extensions O+X Sections
Hendricks to Determine Fill for Bridge.
Roberts on Imperial East of Woodman
Greer
Rohr.

1+50

INDEXED

1+15

1+00

TP 3.05 232.49 10.46 229.44

0+91

0+71

0+67

9.50 239.90

230.40

5 W. 7' 48" T Woodman & Imperial

62

222 ²	227 ⁰	227 ⁸	230 ⁵
10 ³	5 ⁵	4 ⁷	2 ⁰
58	74	114	120

221 ⁷	230 ⁰	226 ¹	227 ⁸	238 ⁸
10 ⁸	9 ⁵	6 ⁴	4 ³	6 ³
66	71	77	86	100

222 ⁰	224 ⁸	236 ⁵	238 ²
10 ⁵	7 ⁷	4 ⁰	5 ⁷
68	70	87	93

221 ⁸	235 ⁶	239 ⁹
18 ⁴	4 ³	0 ⁹
67	75	100

220 ¹	220 ⁰	220 ⁸	221 ⁰	235 ⁴
19 ⁵	19 ⁸	19 ¹	8 ⁹	4 ⁵
10	50	61	67	82

220 ⁸	221 ⁷	226 ⁸	237 ³
19 ¹	12 ⁷	3 ¹	2 ⁵
65	77	90	100

B.M. 3.20 229.29 229.28

2+00

232.49

71

OK & Nail 1+00 P. 57

223	227	228
92	50	40
58	58	180

64

INDEXED
WK
APR 20 1949

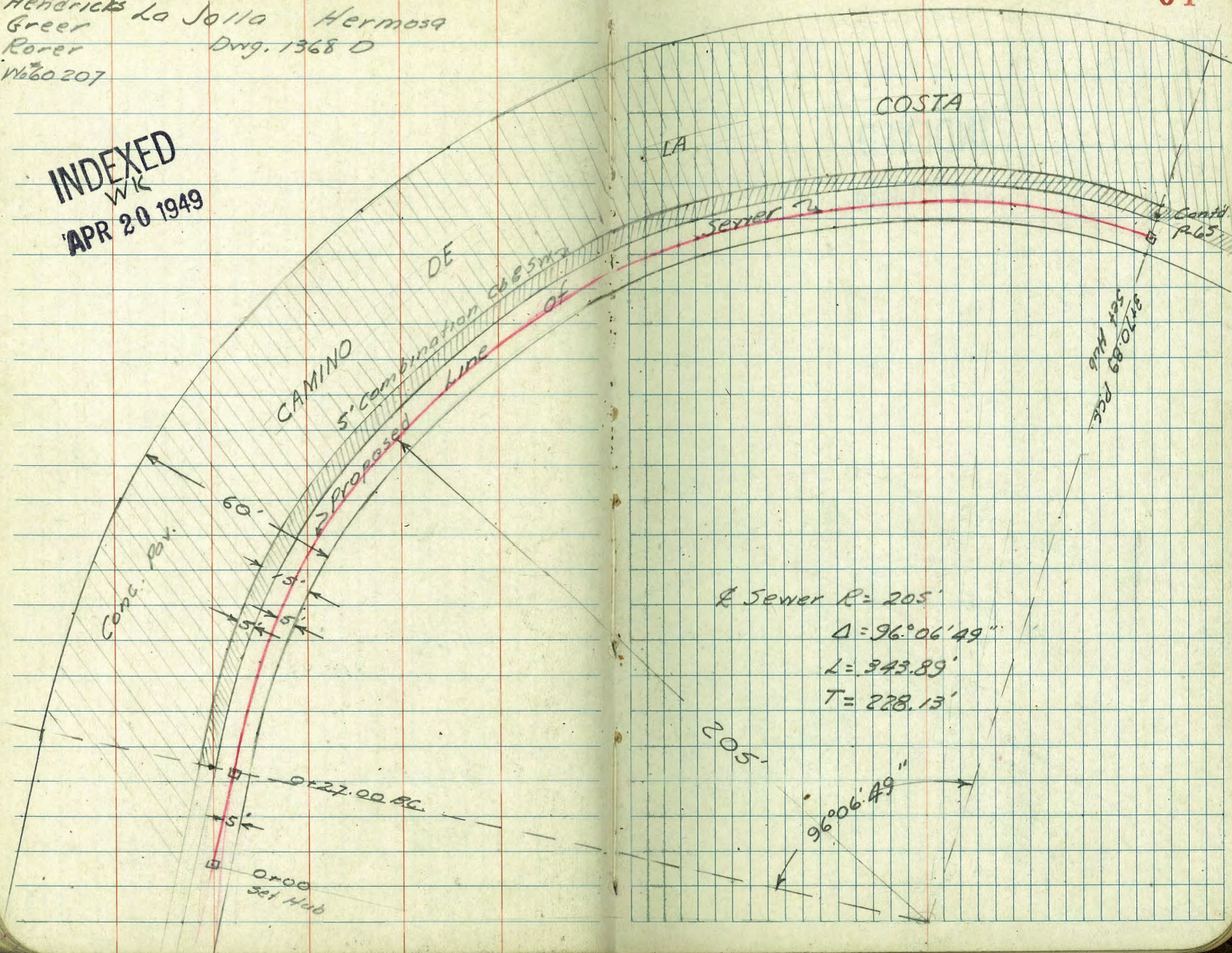

Proposed Sewer
La Jolla Hermosa

INDEXED
WK
APR 20 1949

VISTA DE LA

MESA

65
Cont'd.
P. 66

LA CANADA

COSTA

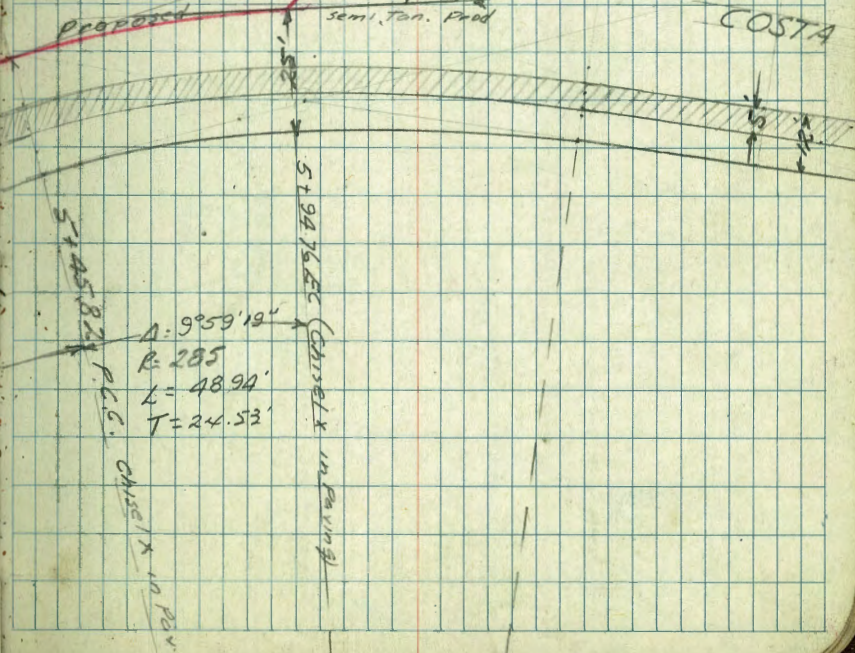
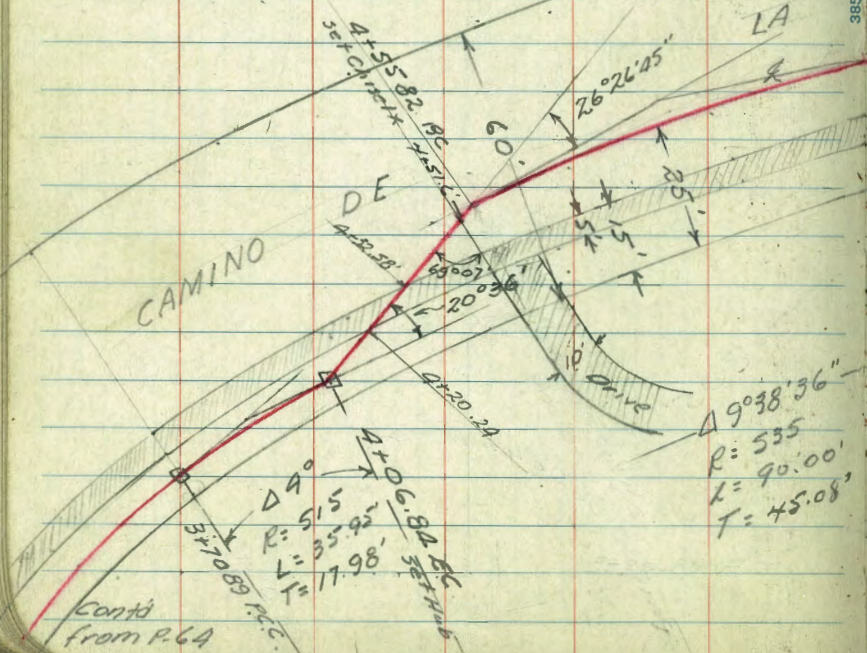

INDEXED

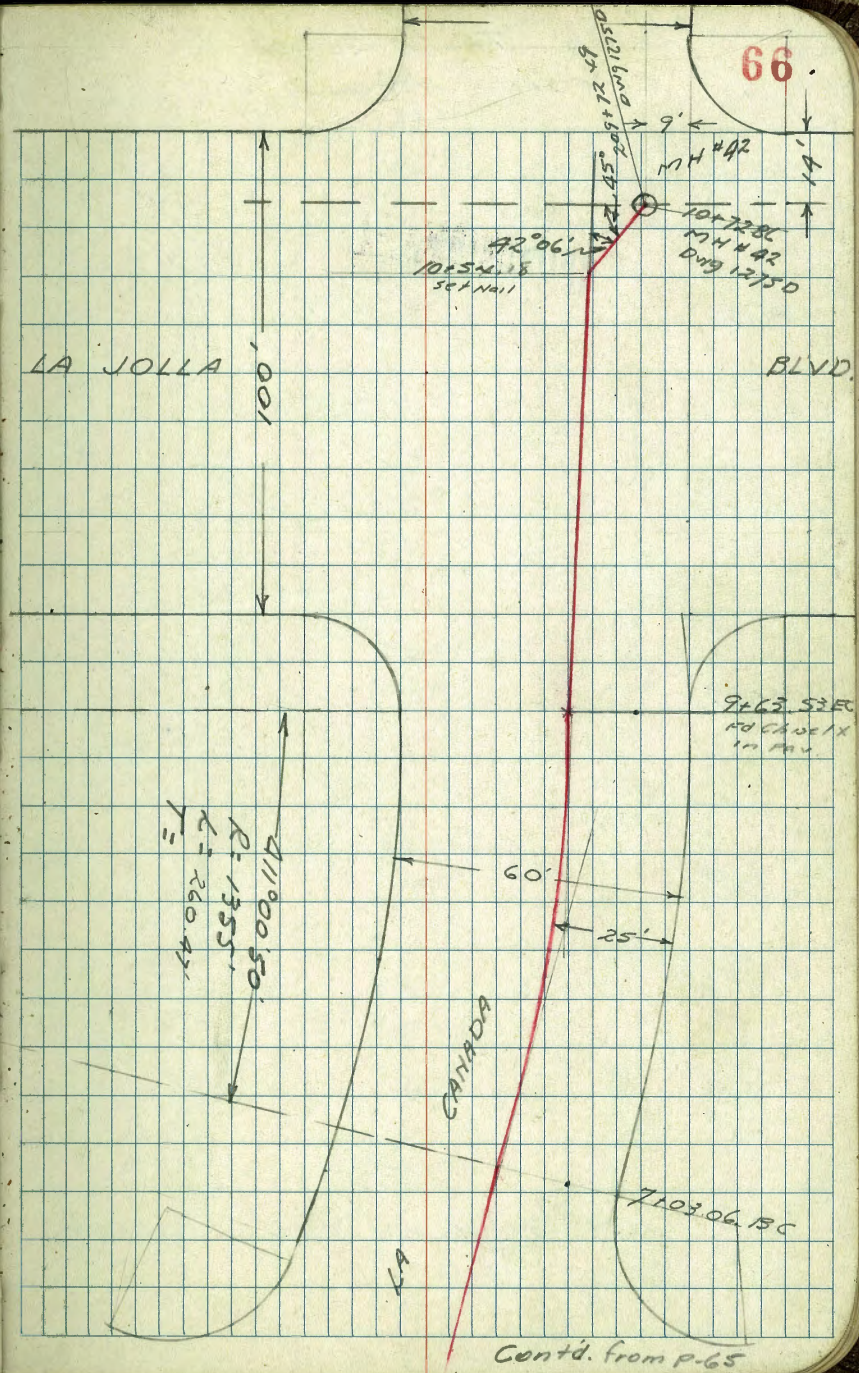

Levels Trunk Sewer No.
La Jolla Hermosa

1464.56

INDEXED

1130.17

0195.78

0161.39

Curve in 10 points.

0127⁰⁰ BC

0100

B17 11.83 34.01
↑

22.19

£

67

3381

10³

3071

5³

2801

6⁰

2641

7⁶

2501

9⁰

2381

10³

24.01
↑

On Stub 012283 FB 1646 P.32

3+70.89 P.C.

INDEXED

3+36.51

ADD 00 ...

3+02.12

2+67.73

T.P. 13.24 5783 0.96 4459

2+33.34

1+98.95

B.S. H.I. F.S. E.V.

T.P. 12.04 45.55 0.50 33.51

34.01

5384

399

144

5203

58

4953

82

4683

118

5283

4215

34

3845

71

45.55

5415.82

INDEXED

Curve in 390-15

4485.82

4455.82 BC.

T.P. 12.01 68.55 1.29 56.54

4432.58 Intersection Cb.

4420.24 Edge Side walk

4406.84 EC.

57.83

61.09

7.46

59.67

8.88

58.23

10.33

68.55

55.90 55.45

0.83 1.38

Cb. Gut.

56.48

1.33

56.01

1.82

Hub

57.83

1

Levels La Jolla Hermosa Sevier
Cont'd.

£

70

6158

INDEXED

6147

6119

519476 E.C.

517029

514582 P.C.C.
2447

6855

6355

500

6359

496

6396

465

6348

507

6301

554

6246

609

6855

8+33.31

INDEXED

TP 1302 7715 442 64.13

8+07.26

7+81.21

7+55.16

Curve in 10 Parls

7+29.11

7+03.06 BC

68.55

£

71

6481

12.34

7715

5

6401

454

6370

485

6341

514

6300

555

6300

555

68.55

71

Levels La Jolla Hermosa Sewer
Cont'd

£

72

9+81.7 + ^{Beg Asp. Pav.} Edge Conc. Pav. (Approx W Line La Jolla Blvd)

7471

2⁴⁴

9+63.53 E.C.

7387

3²⁶

9+37.51

7181

5³⁶

9+11.46

6956

7⁵⁹

8+85.41

6744

9²¹

8+59.36

6588

11²⁷

77.15
K

77.15

K

INDEXED

B.M.

0.70 76.45 76.42

NEEP La Jolla Blvd & La Canada

201+72.49 Sta. 12750

10+72.86 Sewer M.H. #42

76.49

0.66

10+54.18 L 42°06' RT

76.10

1.05

10+51.3 E Cb line La Jolla Blvd

75.97

1.18

10+31.3 E La Jolla Blvd

76.24

0.91

75.74

1.41

10+11.3 W Cb line La Jolla Blvd

77.15

7

77.15

12-4-50 Locate & Stake 6" Sewer
 Hendricks Woodman & Imperial
 Shepard
 Crawford

INDEXED
 MK
 DEC 15 1950

1+35.09	Sky line	0.3	240.6	234.7	C51
1+07		1.8	239.1	232.3	C68
0+80		3.0	237.9	230.1	C78
0+53.86	B.K.	8.2	232.7	228.0	C42
0+04	(Back edge C.B. line)	11.3	229.1	222.7	C69
0+00			222.3		
0+00			246.1	216.29	F.L. Ex. M.H.
B.M.	10.50	240.90		230.40	

5W 768T
 Woodman
 & Imperial

74

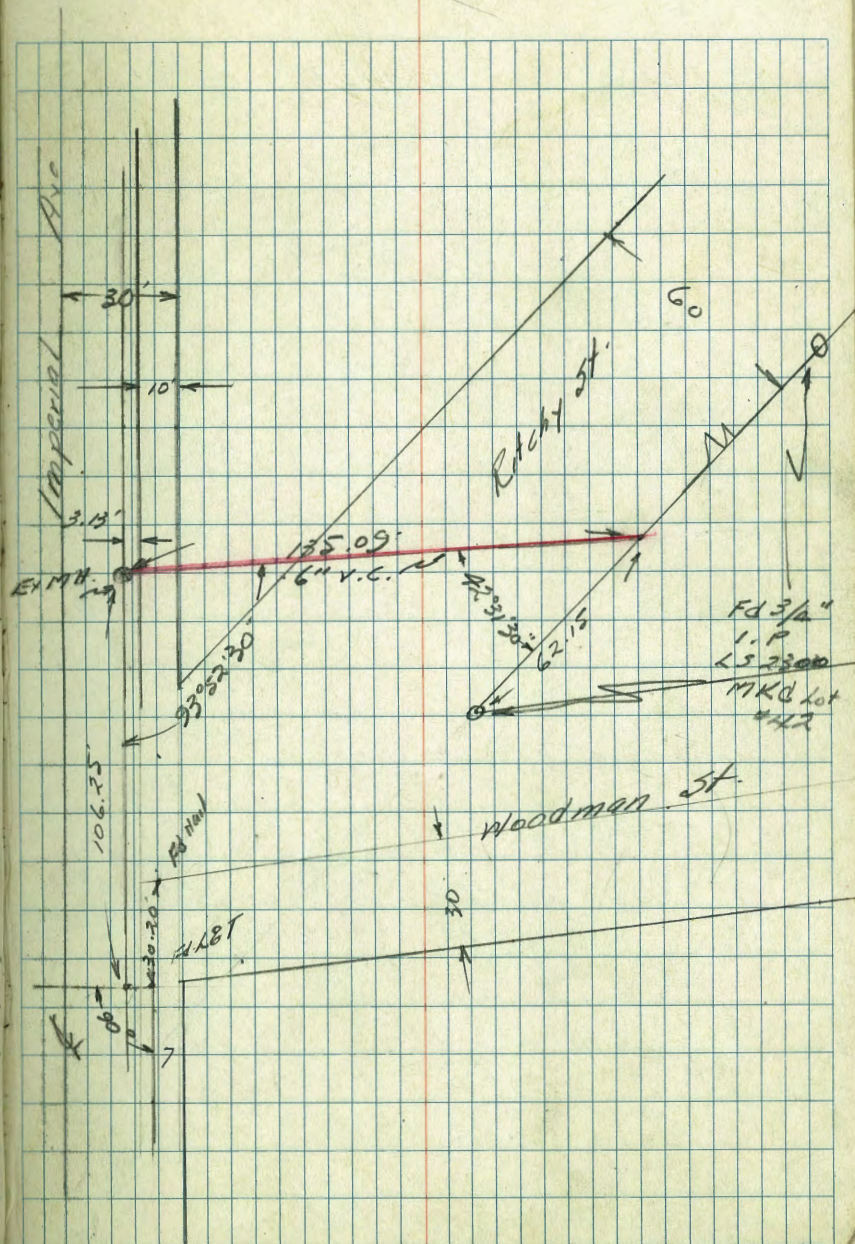

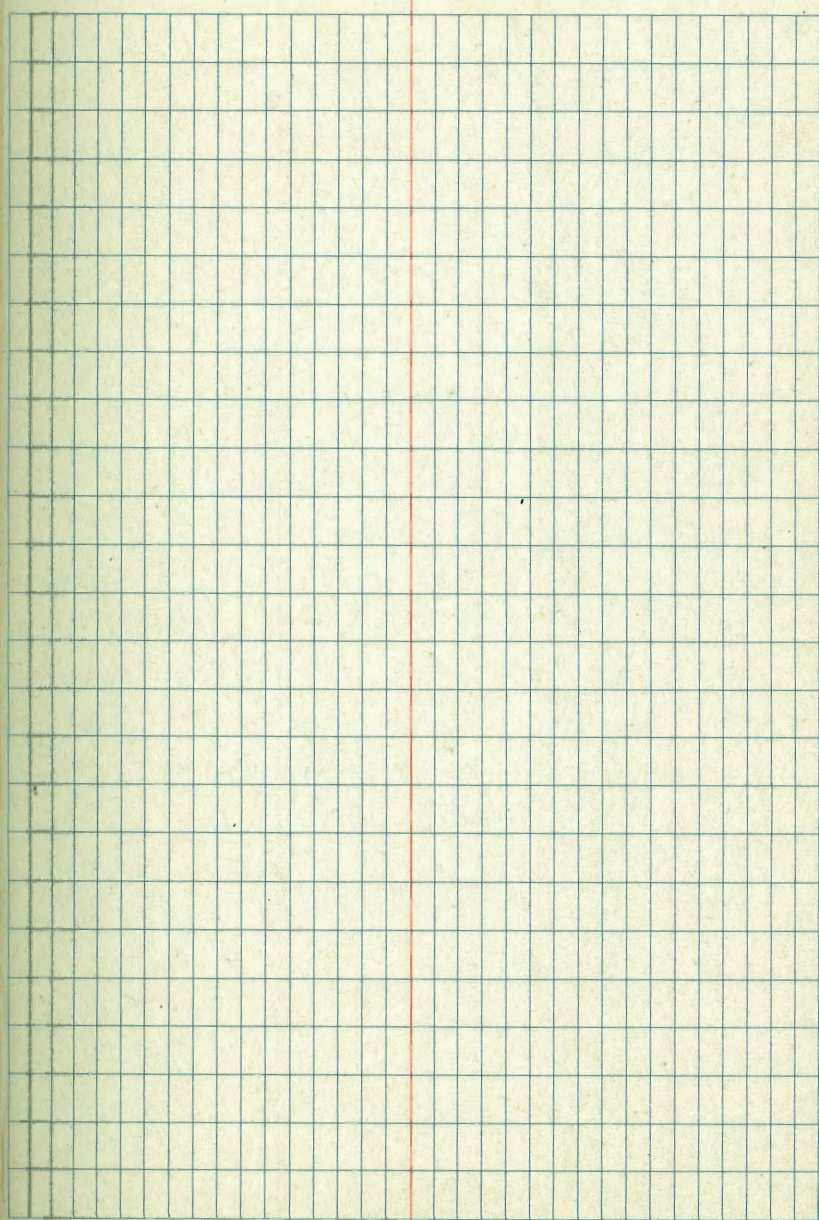
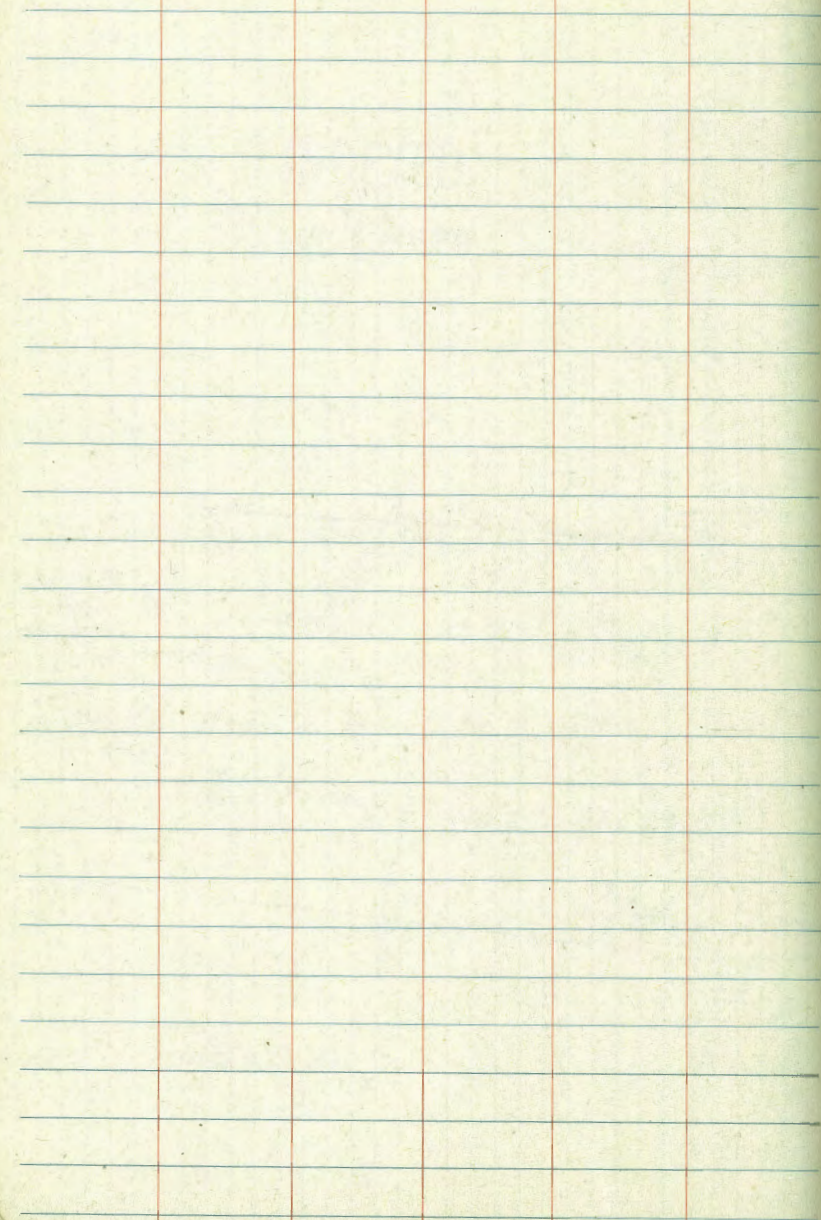

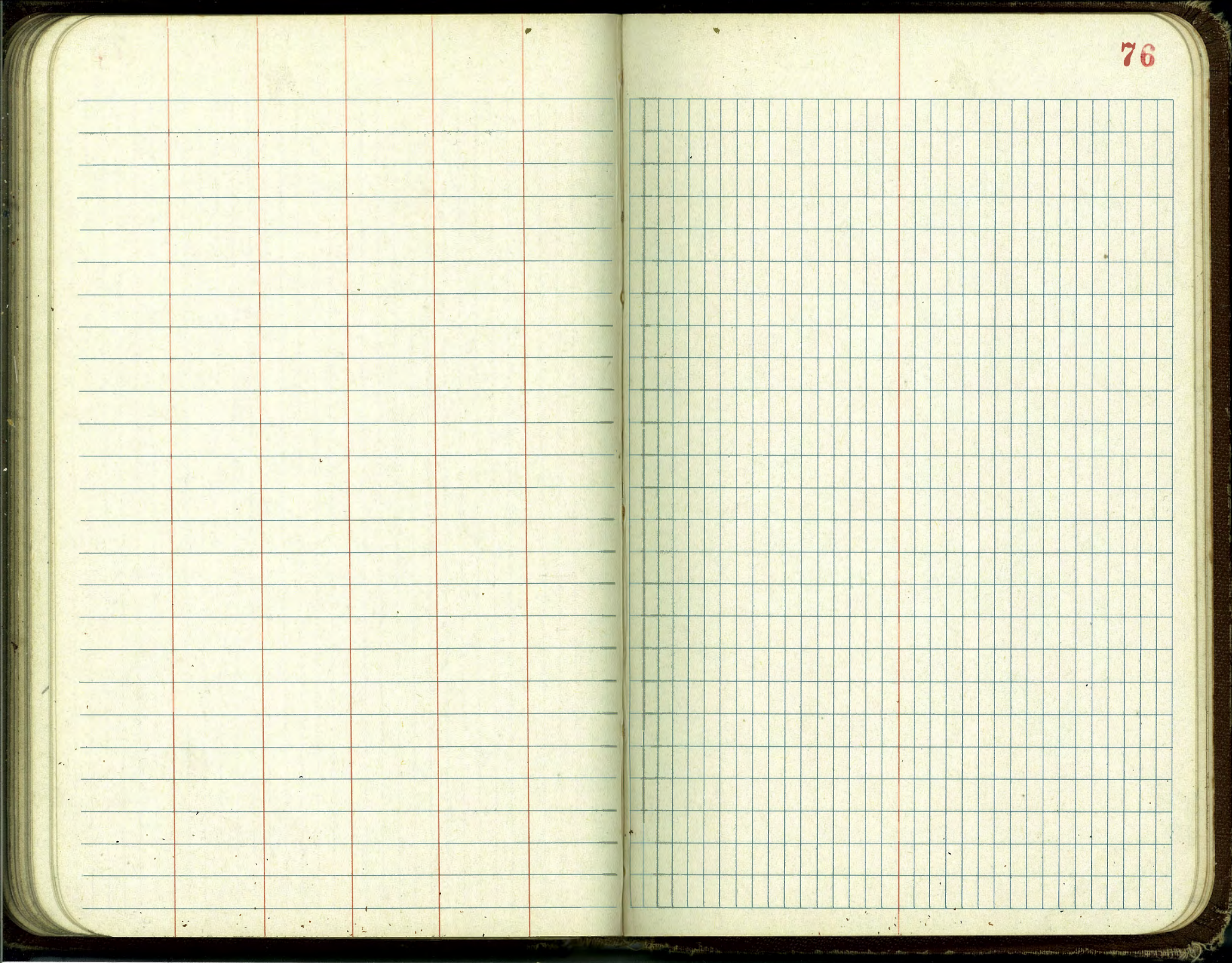

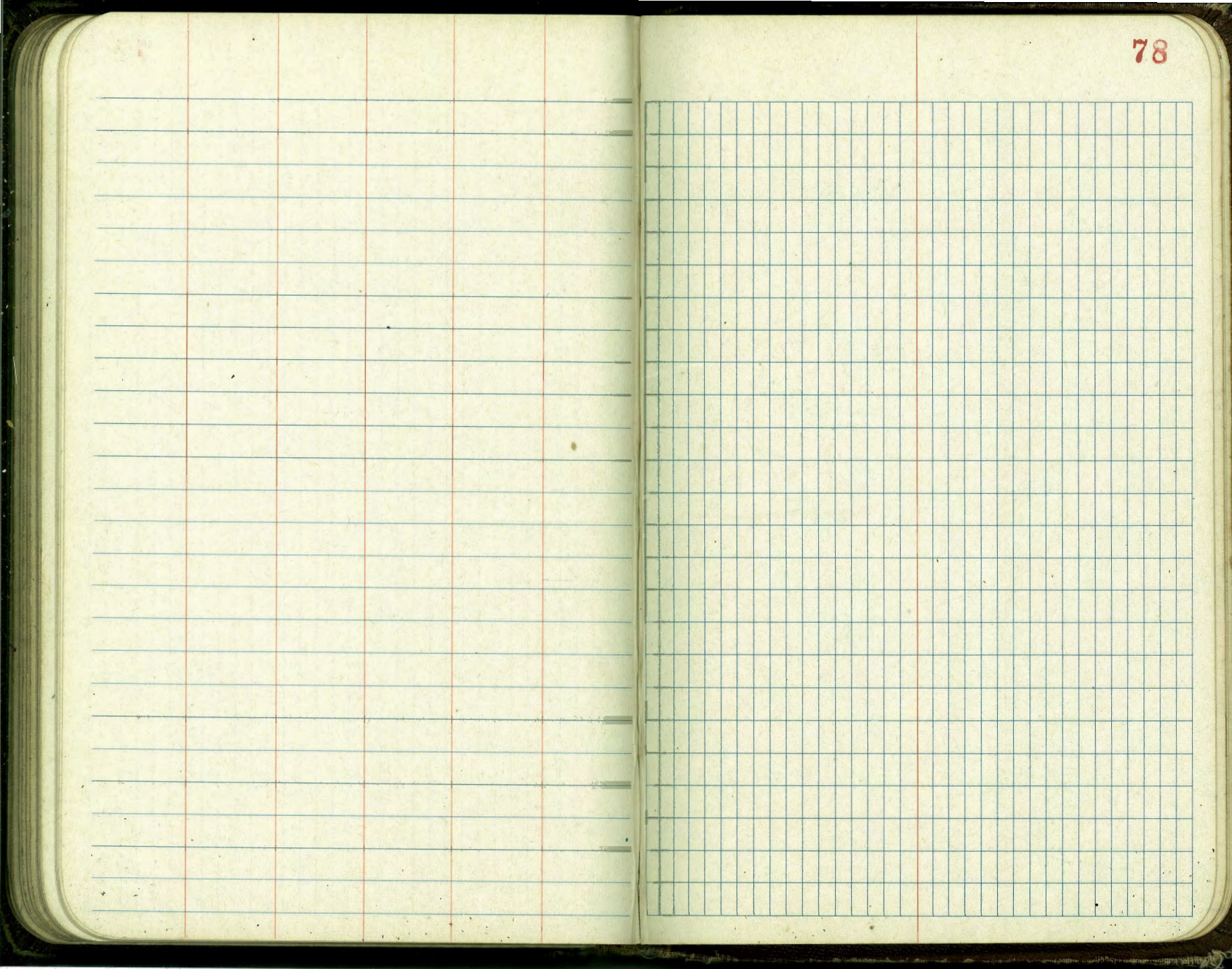

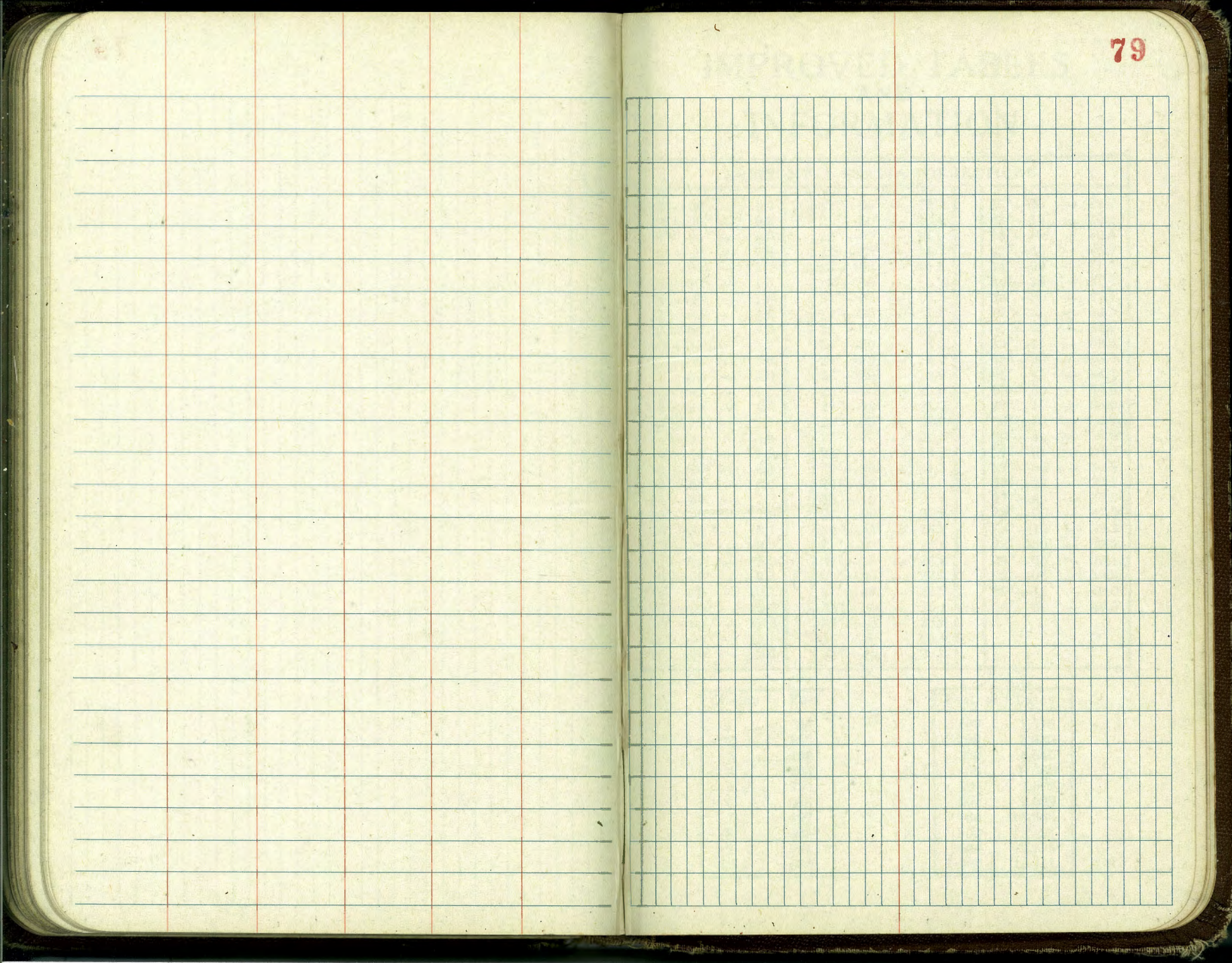

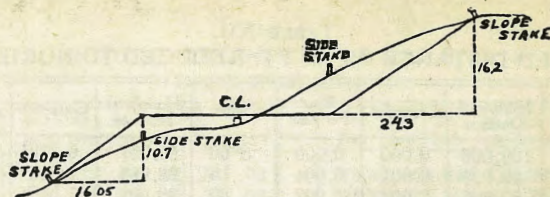

DISTANCES FROM SIDE STAKES FOR CROSS-SECTIONING.

SLOPE 1 1/4 TO 1. ROADWAY OF ANY WIDTH.

	0	.1	.2	.3	.4	.5	.6	.7	.8	.9	
0	0.00	0.15	0.30	0.45	0.60	0.75	0.90	1.05	1.20	1.35	0
1	1.50	1.65	1.80	1.95	2.10	2.25	2.40	2.55	2.70	2.85	1
2	3.00	3.15	3.30	3.45	3.60	3.75	3.90	4.05	4.20	4.35	2
3	4.50	4.65	4.80	4.95	5.10	5.25	5.40	5.55	5.70	5.85	3
4	6.00	6.15	6.30	6.45	6.60	6.75	6.90	7.05	7.20	7.35	4
5	7.50	7.65	7.80	7.95	8.10	8.25	8.40	8.55	8.70	8.85	5
6	9.00	9.15	9.30	9.45	9.60	9.75	9.90	10.05	10.20	10.35	6
7	10.50	10.65	10.80	10.95	11.10	11.25	11.40	11.55	11.70	11.85	7
8	12.00	12.15	12.30	12.45	12.60	12.75	12.90	13.05	13.20	13.35	8
9	13.50	13.65	13.80	13.95	14.10	14.25	14.40	14.55	14.70	14.85	9
10	15.00	15.15	15.30	15.45	15.60	15.75	15.90	16.05	16.20	16.35	10
11	16.50	16.65	16.80	16.95	17.10	17.25	17.40	17.55	17.70	17.85	11
12	18.00	18.15	18.30	18.45	18.60	18.75	18.90	19.05	19.20	19.35	12
13	19.50	19.65	19.80	19.95	20.10	20.25	20.40	20.55	20.70	20.85	13
14	21.00	21.15	21.30	21.45	21.60	21.75	21.90	22.05	22.20	22.35	14
15	22.50	22.65	22.80	22.95	23.10	23.25	23.40	23.55	23.70	23.85	15
16	24.00	24.15	24.30	24.45	24.60	24.75	24.90	25.05	25.20	25.35	16
17	25.50	25.65	25.80	25.95	26.10	26.25	26.40	26.55	26.70	26.85	17
18	27.00	27.15	27.30	27.45	27.60	27.75	27.90	28.05	28.20	28.35	18
19	28.50	28.65	28.80	28.95	29.10	29.25	29.40	29.55	29.70	29.85	19
20	30.00	30.15	30.30	30.45	30.60	30.75	30.90	31.05	31.20	31.35	20
21	31.50	31.65	31.80	31.95	32.10	32.25	32.40	32.55	32.70	32.85	21
22	33.00	33.15	33.30	33.45	33.60	33.75	33.90	34.05	34.20	34.35	22
23	34.50	34.65	34.80	34.95	35.10	35.25	35.40	35.55	35.70	35.85	23
24	36.00	36.15	36.30	36.45	36.60	36.75	36.90	37.05	37.20	37.35	24
25	37.50	37.65	37.80	37.95	38.10	38.25	38.40	38.55	38.70	38.85	25
26	39.00	39.15	39.30	39.45	39.60	39.75	39.90	40.05	40.20	40.35	26
27	40.50	40.65	40.80	40.95	41.10	41.25	41.40	41.55	41.70	41.85	27
28	42.00	42.15	42.30	42.45	42.60	42.75	42.90	43.05	43.20	43.35	28
29	43.50	43.65	43.80	43.95	44.10	44.25	44.40	44.55	44.70	44.85	29
30	45.00	45.15	45.30	45.45	45.60	45.75	45.90	46.05	46.20	46.35	30
31	46.50	46.65	46.80	46.95	47.10	47.25	47.40	47.55	47.70	47.85	31
32	48.00	48.15	48.30	48.45	48.60	48.75	48.90	49.05	49.20	49.35	32
33	49.50	49.65	49.80	49.95	50.10	50.25	50.40	50.55	50.70	50.85	33
34	51.00	51.15	51.30	51.45	51.60	51.75	51.90	52.05	52.20	52.35	34
35	52.50	52.65	52.80	52.95	53.10	53.25	53.40	53.55	53.70	53.85	35
36	54.00	54.15	54.30	54.45	54.60	54.75	54.90	55.05	55.20	55.35	36
37	55.50	55.65	55.80	55.95	56.10	56.25	56.40	56.55	56.70	56.85	37
38	57.00	57.15	57.30	57.45	57.60	57.75	57.90	58.05	58.20	58.35	38
39	58.50	58.65	58.80	58.95	59.10	59.25	59.40	59.55	59.70	59.85	39
40	60.00	60.15	60.30	60.45	60.60	60.75	60.90	61.05	61.20	61.35	40
41	61.50	61.65	61.80	61.95	62.10	62.25	62.40	62.55	62.70	62.85	41
42	63.00	63.15	63.30	63.45	63.60	63.75	63.90	64.05	64.20	64.35	42
43	64.50	64.65	64.80	64.95	65.10	65.25	65.40	65.55	65.70	65.85	43
44	66.00	66.15	66.30	66.45	66.60	66.75	66.90	67.05	67.20	67.35	44
45	67.50	67.65	67.80	67.95	68.10	68.25	68.40	68.55	68.70	68.85	45
46	69.00	69.15	69.30	69.45	69.60	69.75	69.90	70.05	70.20	70.35	46
47	70.50	70.65	70.80	70.95	71.10	71.25	71.40	71.55	71.70	71.85	47
48	72.00	72.15	72.30	72.45	72.60	72.75	72.90	73.05	73.20	73.35	48
49	73.50	73.65	73.80	73.95	74.10	74.25	74.40	74.55	74.70	74.85	49
50	75.00	75.15	75.30	75.45	75.60	75.75	75.90	76.05	76.20	76.35	50

Computed by L. Leland Locke.

2245
 2407
 69
 2240
 2
 47.8
 9635
 100113
 13509
 2407
 2340
 2163
 2347
 3594
 26.21
 6215
 1055
 21
 54
 54
 300
 270
 0
 1055
 21.0
 22155
 702.01
 25
 687.02

10170.86
10154.18
16.68

240.90
11.64
229.06
222.30
6.76