

NAME Euclid Ave

Class _____ Course _____ Party _____

Ref. Pts.

1885

FIELD NOTES

No. 403P

ESPECIALLY ADAPTED

TO THE USE OF

ENGINEERING STUDENTS

EUGENE DIETZGEN Co.

MANUFACTURERS

DRAWING MATERIALS

MATHEMATICAL AND SURVEYING INSTRUMENTS

MEASURING TAPES

CHICAGO SAN FRANCISCO NEW YORK
NEW ORLEANS PITTSBURGH

1885

MICROFILMED
DEC 30 1964

INDEX

		Page
R. P.	431066 P.C.	1
✓	4619220	1
	4615539	
✓	5215873	1
✓	5513696	1
	5514437	
	61134 ⁵⁹	2
	6411627	2
	6417387	2

Isleair Sewer

33

Header Grades

Sta.	£	Left	Right
64+16.22 BC	84.40		
64+00	84.56		
63+75	84.84		
63+50	85.14		
63+25	85.45		
63+00	85.85		
62+75	196.94	86.16	
62+50		86.47	9.27 ✓ 9.97 ✓
62+25		86.77	8.97 ✓ 9.67 ✓
62+00		87.08	8.66 ✓ 9.36 ✓
61+75		87.38	8.36 ✓ 9.06 ✓
61+65	196.44	87.50	8.24 ✓ 8.94 ✓
61+50		87.95	7.79 ✓ 8.49 ✓
61+34.59 BC		88.40	7.34 8.04
61+00		90.4 ✓	90.52 90.12
60+75	196.44	92.61	92.51 92.51
60+50		94.75	94.65 94.65
60+33.10		96.15	96.15 96.15
59+99.10	207.71	97.15	97.15 97.15
59+75		98.34	98.24 98.24
59+50		99.83	99.83 99.83
59+25		01.88	01.78 01.78
59+00		04.20	04.10 04.10

See Page #14 for Continuation

Left Right

7 Surveys

3 3

5.72 6.32

5.93 3.93

1.79 1.79

10.56 ✓ 10.56

10.56 ✓ 10.56 ✓

9.47 ✓ 9.47 ✓

7.88 ✓ 7.88 ✓

5.93 ✓ 5.93 ✓

3.61 3.61

Euclid AYC

Jan 6-1927
 Clark
 Orca
 spaulding

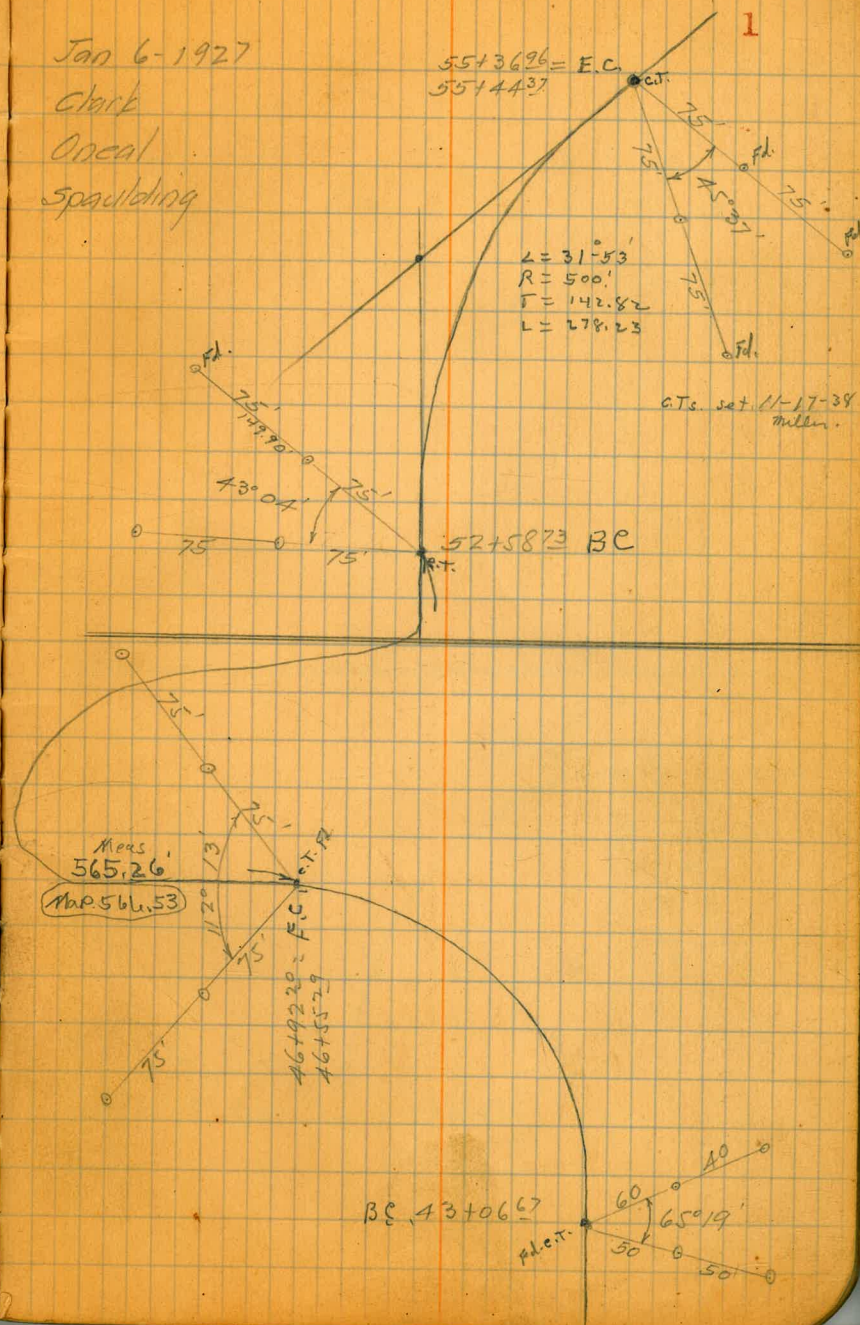

Euclid Ave

68.35
168.35

2
42°29'

Jan. 6-1927

Clark

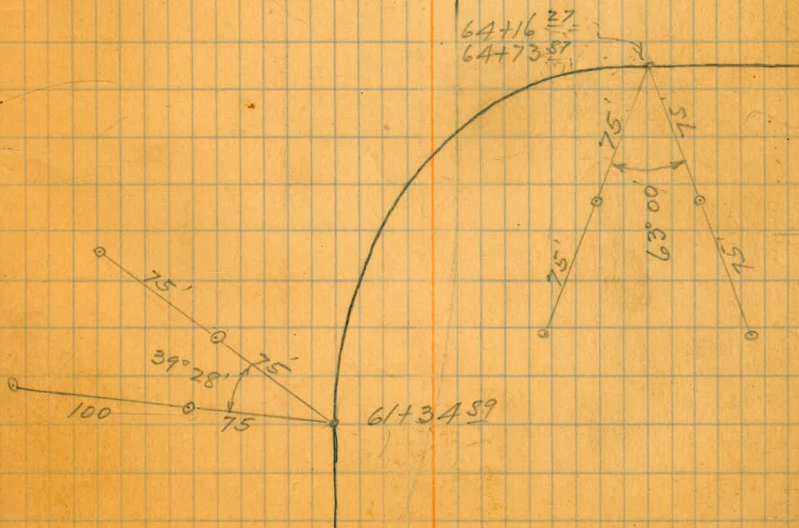
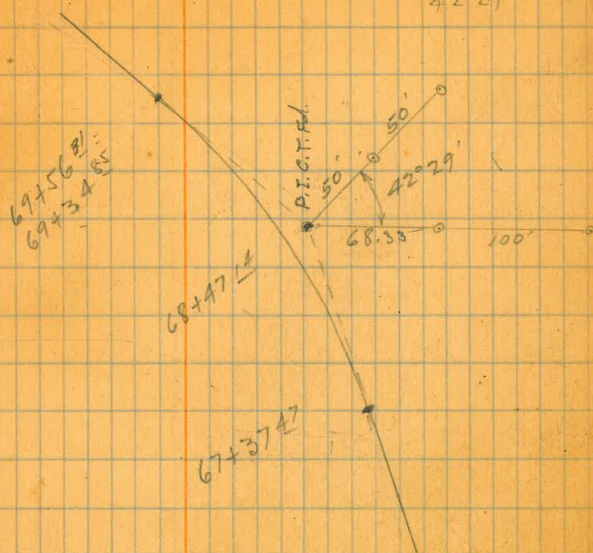

Euclid. Arc

Jan-6-1927

Clark

3

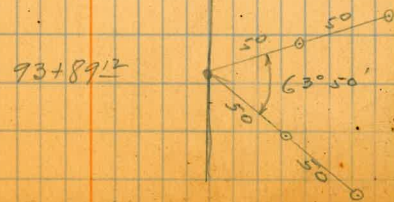
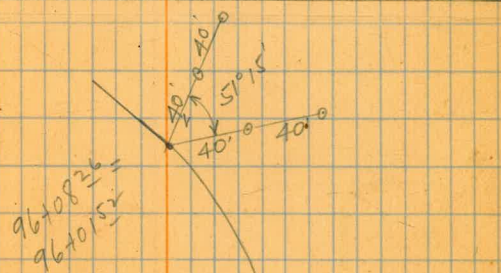

Euclid Arc

Jan-6-1927

Clark

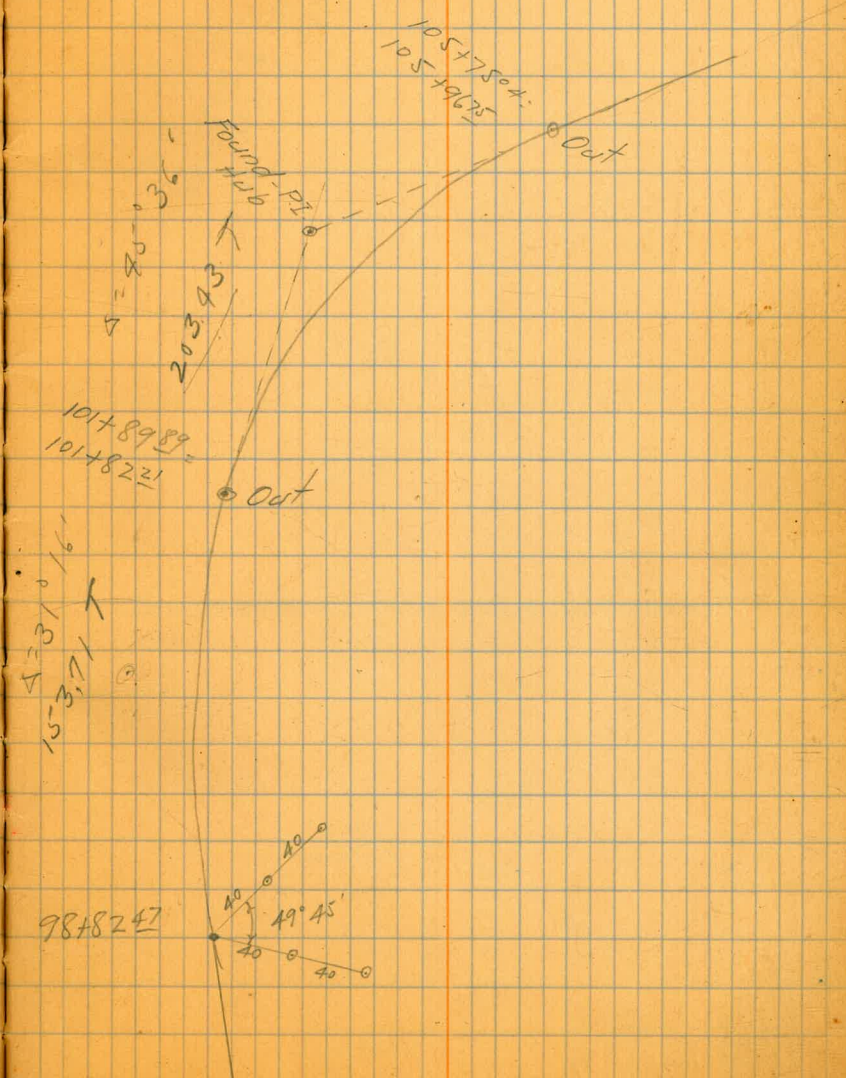

Euclid Ave

Jan 6-1927

Clark

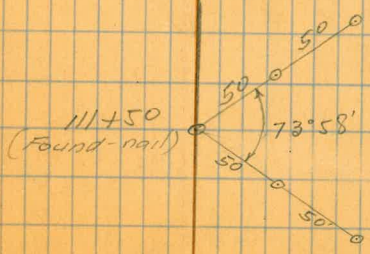
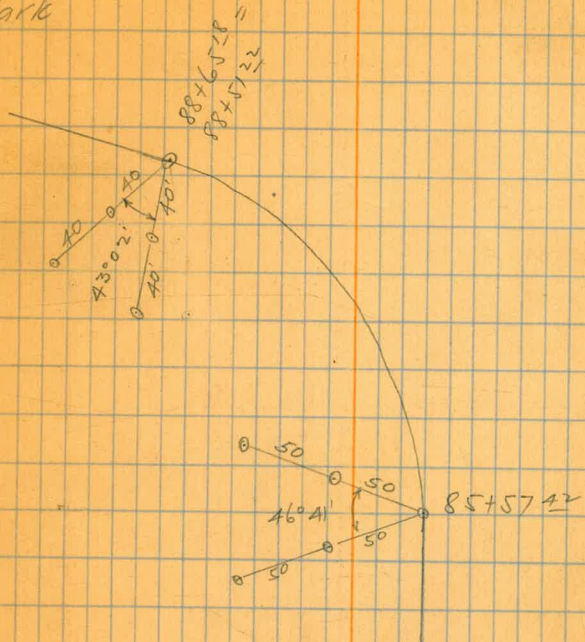

Euclid Ave

Jan-6-1927

Clark

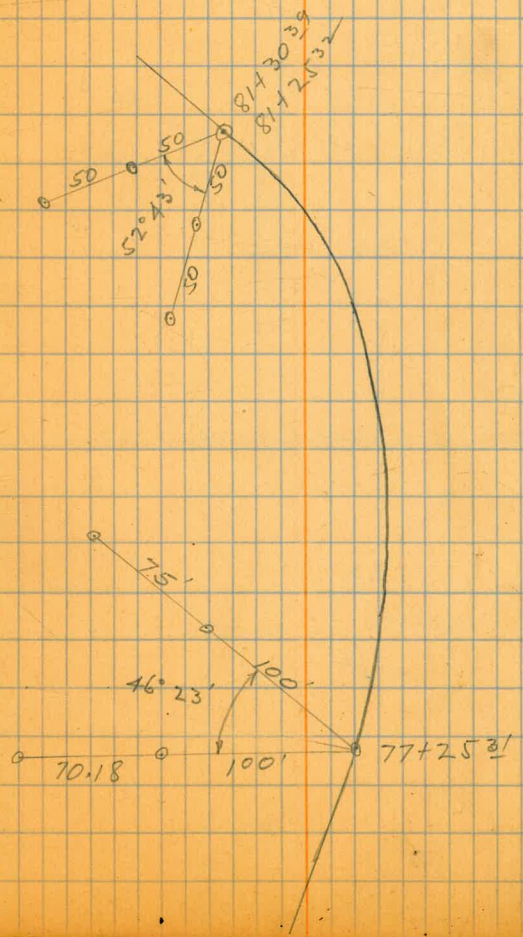

Euclid Ave

7

Jan 8 - 1927

Clark

Oncal

Spaulding

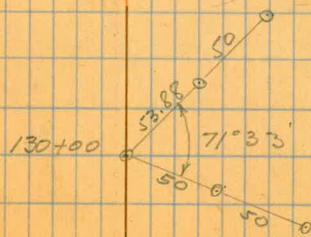
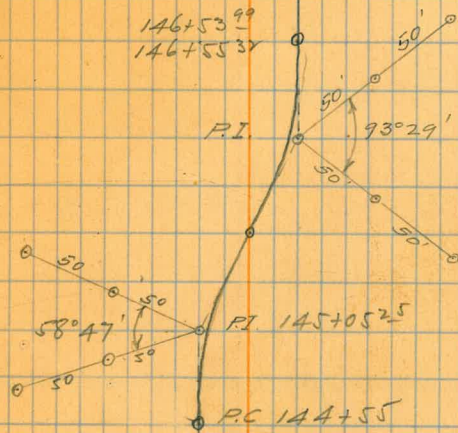

127+00

Euclid Ave

8

Jan 8-1927
Clark

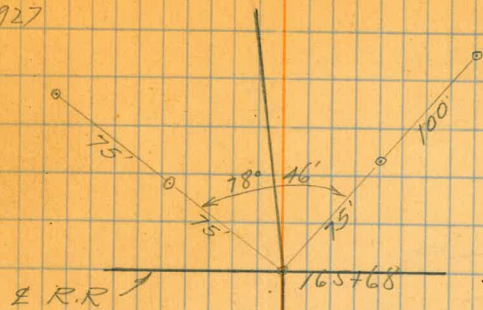

E Euclid Ave

163+00

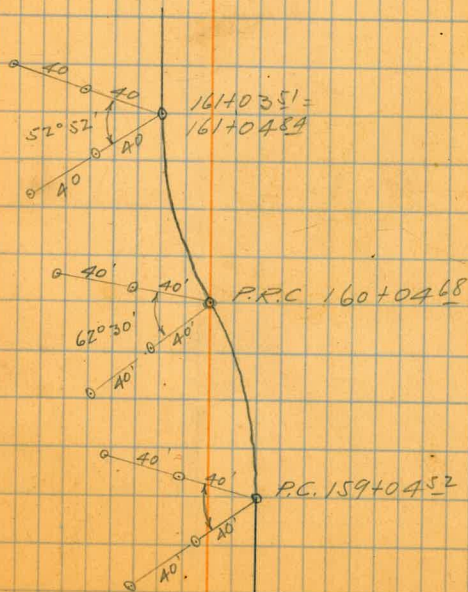

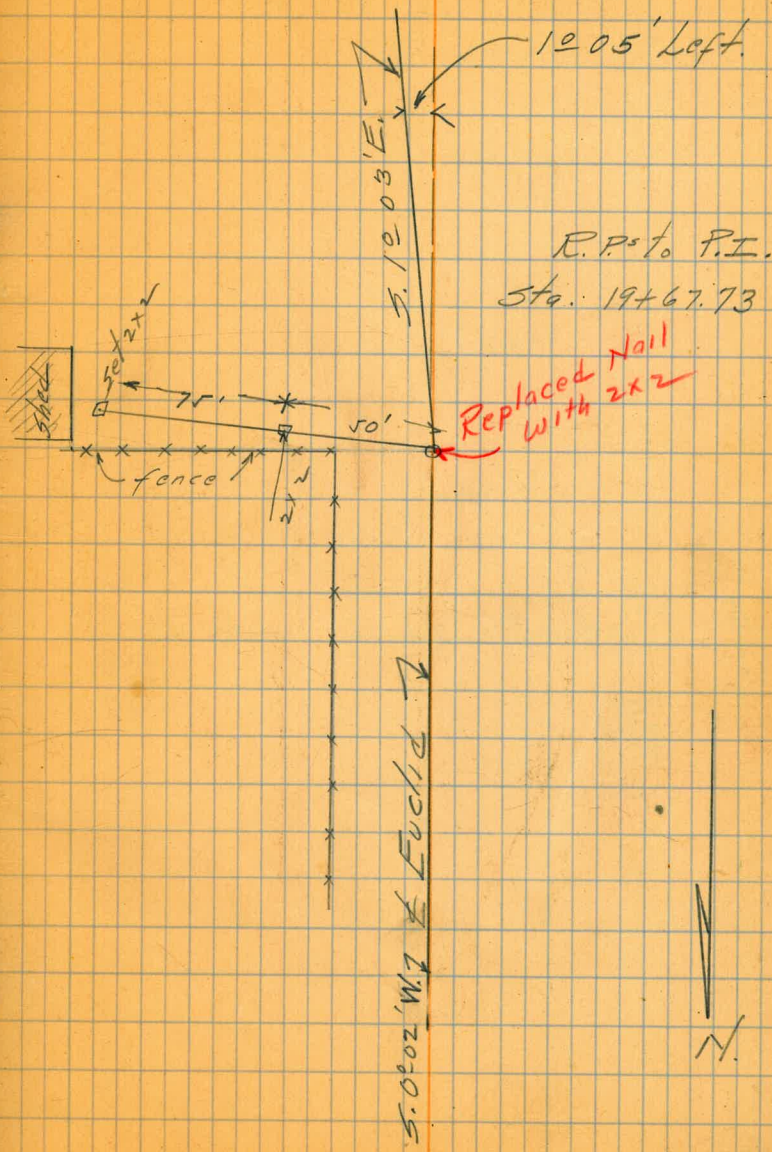

R. Pts. for P.O.T.
Sta. 24+00

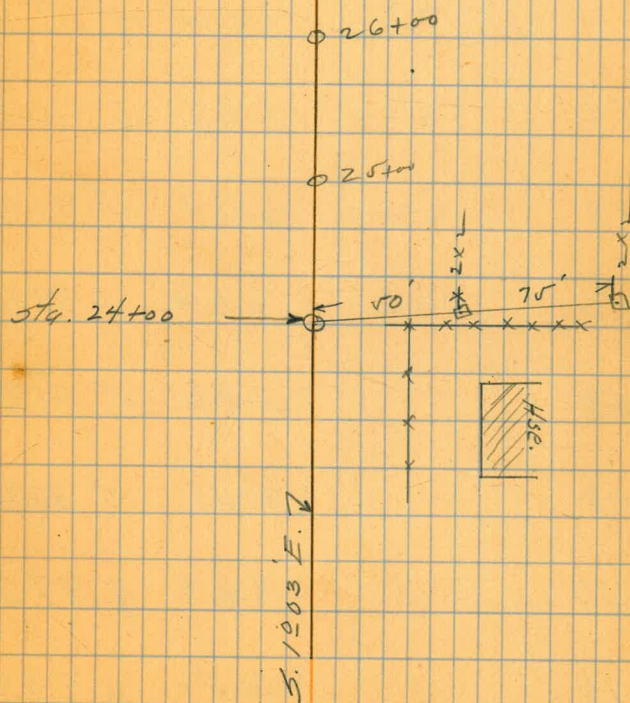

Euclid Ave Curb Grades

Sta	+ H.I	-	West Rod	West Elev
303	343.66			340.63
0+40		3.60		340.06
1+50		3.63	3.76	339.90
1+00		4.92	4.59	339.07
1+50		5.86	5.41	338.25
1+80		6.31	5.91	337.75
2+00		6.04	5.78	337.88
2+50		5.36	5.51	338.15
3+00		5.20	5.24	338.42
3+50		4.84	4.97	338.69
4+00		4.51	4.69	338.97
4+50		4.27	4.41	339.25
5+00		3.86	4.14	339.52

BM. N.W. Cor. Univ + Euclid.

Cut Fill
Elev. of Existing Curb.

+13

2

-33

-45

-40

-26

+15

+04

+13

+18

+14

+28

Euclid Ave Curb Grades
From University South

Sta	+ H.I	- Rod	West Elev	Cut Fill
T.P.			3.86 339.80	
	5.38 345.18			
5+50		5.37	5.41 339.77	+0.9
6+00		5.12	5.14 340.04	+0.2
6+40.22		4.71	4.93 340.25	+2.2
T.P.	5.23 345.29	5.12	340.06	
7+20 ²⁰		5.66	5.59 339.70	-0.7
7+50		5.80	5.80 339.49	Grade
8+00		7.66	8.22 339.14	+5.6
8+45 ⁴⁶		6.22	6.46 338.83	+2.4
8+93 ⁴⁰		6.42	6.79 338.50	+3.7
9+40 ²⁰		6.57	6.19 339.10	-0.38
9+50		6.30	6.06 339.23	-0.24
10+00		5.81	5.42 339.87	-0.39
10+37 ⁶⁶		4.68	4.94 340.35	+2.6
10+50	8.48 347.36	6.36	6.83 340.53	+4.7
T.P.			6.41 338.88	

Sta	+ H. I	-	West Rod	West Elev.	
	347.36				
11+00		6.65	6.19	341.17	-0.46
11+22 ²⁸		5.93	5.91	341.45	-0.02
11+50		5.37	5.56	341.80	+1.19
12+00		5.00	4.93	342.43	-0.07
12+50		4.10	4.29	343.07	+1.19
13+04 ¹¹	Ret. to Landis	3.30	3.61	343.75	

(See Page 20)

Header Grades

Sta.

Refer Back to First Page
d Left Right

58+50	219.41	09.20	09.10	09.10
58+00		14.20	14.10	14.10
57+50		19.20	19.10	19.10
57+00	232.08	24.20	24.10	24.10
56+50		29.20	29.10	29.10
56+00	243.45	34.20	34.10	34.10
55+44.27		39.76	40.06	39.25
55+36.96				
57+12	243.15	42.20	42.50	41.70
54+86.9	251.32	44.70	45.00	44.20
54+62		47.20	47.50	46.70
54+37		48.70	49.00	48.20
54+14		49.60	49.90	49.10
53+87	251.42	50.00	50.30	49.50
53+62		49.70	50.00	49.20
53+37		48.90	49.20	48.40
53+14		47.30	47.60	46.80
52+87		45.00	45.30	44.50
52+62.73		42.18	42.48	41.68
52+00	240.10	36.31	36.21	36.21
51+50		31.31	31.21	31.21
51+00	229.54	26.31	26.21	26.21
50+14		21.31	21.21	21.21
49+87	220.75	17.50	17.40	17.40
		16.10	16.00	16.00

18.31	✓	10.31	✓
5.31	✓	5.31	✓
31	✓	31	✓
7.98	✓	7.98	✓
2.98	✓	2.98	✓
9.15	✓	9.15	✓
3.09		3.90	
.65	✓	1.45	✓
6.32	✓	7.12	✓
3.82	✓	4.62	✓
2.32	✓	3.12	✓
1.42	✓	2.22	✓
1.12	✓	1.92	✓
1.42	✓	2.22	✓
2.22	✓	3.02	✓
3.82	✓	4.62	✓
6.12	✓	6.92	✓
8.94	✓	9.74	✓
3.89	✓	3.89	✓
8.89	✓	8.89	✓
3.33	✓	3.33	✓
8.33	✓	8.33	✓
12.14	✓	12.14	✓
4.75		4.75	

See Pg- 17 for continuation

Euclid Ave East Curb Grades

Sta	+ H.I. 343.66	-	East Rod	East Elev.
0+40		2.70		340.96
0+50				
1+00				
1+50		5.41		338.25
1+80		5.91	6.31	337.75
2+00		5.78	6.54	337.88
2+50		5.45	5.38	338.21
3+00		5.12	4.77	338.54
3+50		4.79	4.79	338.87
3+80 ²³		4.58		339.08
4+82 ¹⁶	345.18	4.03		339.63
5+00		5.31	5.48	339.70

Cut Fill

Curb in place

-40

-76

+07

+35

Grade

Curb in place

+17

Euclid Ave East Curb Grades
 From University South East

Sta	+ H.I.	- Rod.	East Elev.	Cwt Fill
	345.18			
5+50		5.14	5.28339.90	+14
6+00		4.95	5.09340.09	+14
	345.29			
6+40 ²⁰		4.97	5.04340.25	+07
7+00		5.13	5.45339.84	+32
7+20 ²⁰		5.20	5.59339.70	+39
7+38 ⁸¹		5.41	5.72339.57	+31
				8.39
8+45 ⁴⁰		5.94	6.46338.83	+51
	347.22			
8+93 ⁵⁰		8.86	8.72338.50	-14
9+40 ²⁰		8.49	8.12339.10	-37
9+50		8.17	7.99339.23	-18
10+00		7.54	7.35339.87	-19
10+37 ⁶⁶		6.62	6.87340.35	+25

Header Grades
from Page # 14

Sta.	Σ	Left	Right
49+62	220.75	14.90	14.80
49+37		14.10	14.00
49+12		13.70	13.60
48+87		13.60	13.50
48+62		13.80	13.70
48+37		14.30	14.20
48+12		15.00	14.90
48+00		15.36	15.26
47+75		16.11	16.01
47+50	226.81	16.86	16.86
46+94.20		18.50	
46+56.29	Identical	18.50	17.80
46+25		19.40	19.90
46+00		20.15	20.65
45+75		20.90	21.40
45+50		21.65	22.15
45+25		22.40	22.90
45+00		23.15	23.65
44+75		23.90	24.40
44+50		24.65	25.15
44+25		25.40	25.90
44+00	237.46	26.15	26.65
43+75		26.90	27.40
43+50		27.65	28.15

See Page # 25

Left Right

5.95	5.95
6.75	6.75
7.15	7.15
7.25	7.25
7.05	7.05
6.55	6.55
5.85	5.85
5.49	5.49
10.15	9.95
9.01	7.81
8.11	6.91
7.36	6.16
6.61	5.41
5.86	4.66
5.11	3.91
4.36	3.16
3.61	2.41
2.86	1.66
2.11	.91
12.01	10.81
11.26	10.06
10.51	9.31

E. Curb of Euclid Ave

East East
Rod Elev.

Sta	H.I		East Rod Elev.		
	347.22				
11+22 ²²		5.60	5.77 341.45		+17
11+50		5.40	5.42 341.80		+02
12+00		4.65	4.79 342.43		+14
12+50		4.24	4.15 343.07		-09
13+04		3.31	3.47 343.75		+16
+50		3.95	4.12 43.10 43.35		+17 F.08
13+95.37 Ret. to Castle	344.92	4.68	4.77 342.45 42.95		+09 F.41
14+99.99 Ret. to Castle		3.07	3.57 341.15		+50
15		4.00	3.89 340.83		-11
150		4.79	4.68 340.04		-11
16		5.65	5.47 339.25		-18
+50		6.31	6.26 338.46		-05
17		7.17	7.05 337.67		-12

End Curb of Euclid Ave.

Sta	+	H.I.	-	F. Rod	Grade	Cut	Fill
		344.72					
17+50			7.84	7.84	36.88		Grade.
18			8.93	8.63	36.09		-10
		339.89					
18+50			4.94	4.59	35.30		-35
19			5.61	5.38	34.51		-23
19+50			6.38	6.17	33.72		-21
19+67.73	1 pt.		6.34	6.45	33.44		+09
20+18.13	End Curb		6.76	7.25	34.64		+49
20+23.62	End Walk at prop. Intersect.				32.55		

W. Side of Euclid

Sta.	H.I.	-	G. Rod Elev.	Cut	Fill
	344.72				
13+67.81	South Rd. Landis	1.50	1.47 343.25 ₈₃		-03
14		2.19	2.00 41.72 ₈₂		-14
400		2.94	2.83 41.89 ₈₀		-11
15		3.70	3.67 41.05 ₈₀		-03
450		4.56	4.50 40.22 ₈₀		-06
	344.72				
16		5.54	5.33 39.39 ₈₄		-21
400		6.32	6.17 38.55 ₈₀		-15
17		6.98	7.00 37.72 ₈₀	+02	
450		7.91	7.83 36.89 ₈₄		-08
18	344.72	8.53	8.67 36.05	+14	
	339.89	4.20			
18+67.81	Pol. to Resclama (North)		4.14 335.75		-06
18+67.81	" " " (South)	5.25	4.64 335.25		-61

W. Corb Euclid

Sta	+	H.I.	-	G. Rd	Elev	Cut	Fill
		339.89					
19			5.30	5.26	34.63		-04
to			5.90	6.23	33.66	+33	
19+62.73	L Point		6.68	6.47	33.42		-21
19+96.41	Prop. Intersection	(Point Set)			332.75		
20+168.1	End Curve		6.72	7.24	37.65	+52	

E. Curb of Euclid

Sta	H.I.	Rod	G. Rod	Grade
23+80	337.08			31.10
24+00		5.72	5.58	31.31
24+06.12 <i>Elevation</i>	337.08	<u>Identical</u>		31.31
24+46.93 Ret	337.08	5.19	5.18	31.75
25+00 <i>Is. Vista Dr.</i>	337.08			32.48
25+44.80 Ret	337.08	3.91	3.68	33.25
26+00	336.05	4.16	4.18	32.75
26+50	336.05	5.04	4.73	32.20
	334.19			
27+00	336.05	2.65	2.54	31.65
27+46.27 BVC	336.05	3.43	3.04	33.15
27+71.27	336.05	4.64	3.64	33.55
27+96.27	336.05	5.54	4.54	32.65
28+21.27	336.05	6.64	5.44	32.75
28+46.27 EVC	336.05	7.12	6.74	32.25
29+00	329.77	9.95	9.83	32.30

Header
 30.80
 31.01
 Identical
 31.01
 Raised this grade 0.1' to get 0.3' to East side = Catch Basin
 of
 0.3' to East side = Catch Basin
 22

Header	Fill
30.80	6.28 - .44
31.01	- .10
31.01	6.07
31.45	5.63 - .01
32.18	4.90
32.95	4.13 - .23
32.45	3.60 + 0.2
31.90	4.15 - .31
31.35	4.70 - .11
30.85	5.20 - .39
30.25	5.80 - 1.00 ⁱⁿ Hole
29.35	6.70 - 1.00 "
28.45	7.60 - 1.20 "
32.7.15	8.90 - .38
24.06	71 - .12

E. Curb Euchs

Sta	+	H.I.	Rod	G. Rod	Grade	Header	Cut	Fill	
		323.73							H.I. 302.71
+50.		324.77	2.13	2.25	321.48	21.18	+12	3.59 ✓	1.02 301.69 11.34
30+00		324.77	4.98	5.13	318.60	18.30	+15	6.47 ✓	H.I. 313.03 4.9 Elev. 312.54 12.28 324.77 22
+50		324.77	8.19	8.01	315.74	15.44	9.35 ✓	-18	Elev. 324.65 11.50 336.45 3.10 Elev. 332.95 9.13 337.08
31+00		313.03	10.95	10.89	312.84	12.54	4.9 ✓	-06	
+50		313.03 313.00	3.35	3.04	309.96	09.66	3.37 ✓	-31	
32+00		313.03	6.39	5.92	307.08	06.78	6.25 ✓	-47	
+50		313.03	9.24	8.80	304.20	03.90	9.13 ✓	-44	
33+00		302.71 301.97	11.76	11.60	301.40	01.10	1.61 ✓	-16	
33+30.36 Ret		302.71	1.78	2.22	299.75	99.45	1.78	3.26	
- Thorne St -									
34+00.36 Ret		302.71	3.92	3.72	298.25	92.95	4.76	-20	
+50		302.71	4.91	4.68	297.29	97.00	5.71	-23	
35+00		302.71	6.04	5.64	296.33	96.03	6.68 ✓	-40	

F. Curb Euclid

Sta.	H.I.	Rod	S. Rod	Grade
	301.97			
35+50	302.71	6.98	6.62	296.35
35+75	302.71	7.63	7.22	294.75
36	302.71	8.77	8.22	293.75
+2.5	292.63	10.18	9.42	292.55
+50	292.63	11.92	11.22	290.75
+75	292.63 290.54	2.11	1.99	288.55
37	292.63	4.24	4.49	286.05
37+50	281.48	9.79	9.49	281.05
37+90.36 Bk.		10.50	13.54	277.00
37+94.02 Fwd.				277.00

Header

95.05

94.45

93.45

92.25

90.45

88.25

85.75

80.75

76.70

74.98

70.90

Cut Fill

7.66 -36

8.26 ✓ 41

9.26 -55

0.38 -26

2.18 -70

4.38 -12

6.88 (+25)

.73 -30

+3.64

7.00 ✓

10.58 ✓

24
280.94
54
181.48
280.94
11.69
492.63
38
264.92 25
12.46
302.71

S. Line "Isleair" - Stop -

38+14.14

281.48

38+50

281.48

Header Grades

From Pg. #17

Sta.		Left	Right
43+25	237.46	28.40	27.70 28.90
43+06.67 ^{BC}		29.00	28.30 29.50
42+75		30.20	29.74 30.46
42+50	237.36	31.70	31.42 31.78
42+25		33.70	33.60 33.60
42+00		36.00	35.90 35.90
41+50	248.87	41.00	40.90 40.90
41+25		46.00	45.90 45.90
40+50	259.63	51.00	50.90 50.90
40+25		56.00	55.90 55.90
39+50	269.65	61.00	60.90 60.90
39+25		66.00	65.90 65.90
38+50	276.39	71.00	70.90 70.90
38+25		76.00	75.90 75.90

Left Right

9.76 ✓	8.56 ✓
9.16 ✓	7.96 ✓
7.62 ✓	6.80 ✓
5.94 ✓	5.58 ✓
3.76 ✓	3.76 ✓
1.46 ✓	1.46 ✓
7.97 ✓	7.97 ✓
2.97 ✓	2.97 ✓
8.73 ✓	8.73 ✓
3.73 ✓	3.73 ✓
8.75 ✓	8.75 ✓
3.75	3.75
5.49	5.49

Continued from Book 256-30

Enclid Header

26

Sta.	2	Left	Right	Left	Right
		122.70			
Face of Abut.					
156+22.50	114.50	114.50	114.50	8.20	8.20
156+75	116.20	116.10	116.10	6.60	6.60
157	116.96	116.86	116.86	5.84	5.84
150	118.48	118.38	118.38	4.32	4.32
158+00	120.00	119.90	119.90	2.80	2.80
+25	120.50	120.40	120.40	2.30	2.30
+50	120.60	120.50	120.50	2.20	2.20
+75	120.40	120.20	120.40	2.50	2.30
159+00	119.30	119.00	119.40	3.70	3.30
159+29.56	117.85	117.53	117.93	5.17	4.77
159+54.60	116.35	116.05	116.45	6.65	6.25
159+79.65	114.87	114.68	114.88	8.02	7.82
160+04.68	113.40	114.66	114.66	1.36	1.36
160+29.72	111.95	113.30	113.30	2.71	2.91
160+54.76	110.50	111.95	111.75	4.06	4.46
160+79.80	110.15	110.25	109.85	4.41	4.81
161+04.84	109.80	109.90	109.50	4.76	5.16
161+03.51		114.66			
161+50	109.10	109.00	109.00	5.66	5.66
162+00	108.35	108.25	108.25	6.41	6.41
162+46.24	107.70	107.60	107.60	7.06	7.06
163	105.89	105.79	105.79	8.87	8.87
163+50	104.20	104.10	104.10	10.56	10.56

Header Grader

Euclid

← Left. Right.

108.91

Sta.		Left.	Right.
163+75		103.65	103.50
+75		103.40	103.30
164+25		103.40	103.30
164+50		03.60	103.50
165+00	108.91	104.00	104.00
+50		104.00	104.00
165+25		104.00	104.00
Top Rail			
165+68		104.55	104.55
+50		04.37	04.27
+50		04.09	03.99
167+00	108.81	03.81	03.71
+50		03.53	03.43
167+75		103.40	103.30
168+00		103.40	103.30
+25		103.80	103.70
+50		104.40	104.30
+75		105.50	105.40
169+00		107.00	106.90
+25		108.70	108.60
+50	119.29	110.50	110.40
169+75		112.80	112.70

Let R+

6

11.16 ✓	11.16 ✓
5.61 ✓	5.61 ✓
5.61 ✓	5.61 ✓
5.41 ✓	5.41 ✓
4.91 ✓	4.91 ✓
4.91 ✓	4.91 ✓
4.36 ✓	4.36 ✓
4.64 ✓	4.64 ✓
4.82 ✓	4.82 ✓
5.10 ✓	5.10 ✓
5.38 ✓	5.38 ✓
5.51 ✓	5.51 ✓
5.51 ✓	5.51 ✓
5.11 ✓	5.11 ✓
9.51 ✓	9.51 ✓
9.41 ✓	9.41 ✓
1.91 ✓	1.91 ✓
0.21 ✓	0.21 ✓
8.89 ✓	8.89 ✓
6.59 ✓	6.59 ✓

Enclid Headers

Sta.		Left	Right
	119.29		
170		115.30	115.20
+50	130.29	120.30	120.20
171		125.30	125.20
171 ^{BVC}		127.80	127.70
171 ^W		130.00	129.90
171 ^W	139.00	131.30	131.20
172 ^W		132.20	132.10
172 ^W		132.80	132.70
+50		133.10	133.00
173		133.70	133.60
+50		134.30	134.20
174		134.90	134.80
+50		135.50	135.40
175		136.10	136.00
+50		136.70	136.60
176		137.30	137.20
+50		137.90	137.80
177	144.82	138.50	138.40
+50		139.10	139.00
178		139.70	139.60
+50		140.30	140.20
179 ^{BVC}		140.90	140.80

4.09	4.09
10.09	10.09
5.09	5.09
2.59	2.59
0.39	0.39
7.80	7.80
6.90	6.90
6.30	6.30
6.00	6.00
5.40	5.40
4.80	4.80
4.20	4.20
3.60	3.60
3.00	3.00
2.40	2.40
1.80	1.80
1.20	1.20
6.42	6.42
5.82	5.82
5.22	5.22
4.62	4.62
4.02	4.02

Euclid Headers

Sta.		Left	Right
179+25	144.82	141.40	141.30
450		142.10	142.00
+75		142.90	142.80
180		144.10	144.00
425	156.14	145.50	145.40
180+50		147.60	147.50
-181		152.60	152.50
450	166.68	157.60	157.50
185		162.60	162.50
450	178.16	167.60	167.50
183		174.60	172.50
183+56	182.14	178.25	178.15

Let + Right

29

3.52	✓ 3.52 ✓
2.82	✓ 2.82 ✓
2.02	✓ 2.02 ✓
0.82	✓ 0.82 ✓
10.74	✓ 10.74 ✓
8.64	✓ 8.64 ✓
3.64	✓ 3.64 ✓
9.18	✓ 9.18 ✓
4.18	✓ 4.18 ✓
10.66	✓ 10.66 ✓
5.66	5.66
5.97	

178.96 edge pavement
& at Imperial
(H)

Euclid Ave Brq.

1 - Top of Cap Dope

30

Bent No.	Pier # 1	€ Roadway	Pier # 4
	Elev	Elev.	Elev.
N. Abut.	330.25	30.22	330.25 30.19
			330.25 30.25
1	330.18	30.26	330.18 30.15
			330.18 30.10
2	330.11	30.15	330.11 30.09
			330.11 30.12
3	330.04	30.01	330.04 30.02
			330.04 29.98
4	329.97	29.84	329.97 29.91
			329.97 29.98
5	329.90	29.96	329.90 29.96
			329.90 29.92
6	329.77	29.74	329.77 29.72
			329.77 29.75
7	329.64	29.63	329.64 29.61
			329.64 29.63
8	329.51	29.48	329.51 29.48
			329.51 29.54
9	329.38	29.41	329.38 29.42
			329.38 29.40
S. Abut	329.25	29.20	329.25 29.22
			329.25 29.20

Euclid

Ave.

31

BRIDGE

1

BENT No	PIER # 1			PIER # 2			PIER # 3			PIER # 4		
	Elev. Hub	Footing Elev	Cut	Elev. Hub	Footing Elev	Cut	Elev. Hub	Footing Elev	Cut	Elev. Hub	Footing Elev	Cut
1	326.12	315.18	10.94	313.32	312.18	1.14	313.32	307.18	6.14	304.14	303.18	0.96
2	315.34	308.11	7.23	303.46	301.11	2.35	303.46	297.11	6.35	295.12	293.11	2.01
3	306.11	299.04	7.07	299.32	295.04	4.28	299.32	290.04	9.28	291.52	289.04	2.48
4	295.14	291.97	3.17	293.76	291.97	1.79	293.76	288.97	4.79	292.23	285.97	6.26
5	291.68	286.90	4.78	290.62	286.90	3.72	290.62	285.90	4.72	296.40	286.90	9.50
6	287.53	284.77	2.76	289.16	285.77	3.39	289.16	287.77	1.39	303.14	294.77	8.37
7	294.72	293.64	1.08	302.84	298.04	4.80	302.84	301.64	1.20	312.06	307.64	4.42
8	302.34	301.51	0.83	309.92	305.51	4.41	309.92	308.51	1.41	319.36	313.01	6.35
9	311.62	310.38	1.24	318.62	314.38	4.24	318.62	317.88	0.74	325.93	320.88	5.05

Piers Numbered from East to West

Euclid Ave.

— Bridge # 1 —

Figures in Red

Jan. 28 1927

O. J. Thompson

32

— Top of Dowel —

Bent No.	Pier # 1			Pier # 2			Pier # 3			Pier # 4		
	Elev. Top Footing	Elev. Top Pier	Fill	Elev. Top Footing	Elev. Top Pier	Fill	Elev. Top Footing	Elev. Top Pier	Fill	Elev. Top Footing	Elev. Top Pier	Fill
1	316.83	318.18	318.81 1.35	313.05	318.18	318.73 5.13	308.20	318.18	318.70 9.98	304.11	318.18	318.66 14.09
2	309.98	311.11	311.62 1.43	302.81	311.11	311.64 8.30	297.80	311.11	311.56 13.31	293.91	311.11	311.50 17.20
3	298.87	304.04	304.49 7.17	297.07	304.04	304.62 6.97	292.07	304.04	304.58 11.97	290.20	304.04	304.47 13.84
4	292.20	297.97	298.42 5.77	292.52	297.97	298.40 5.45	289.92	297.97	298.43 8.05	288.54	297.97	298.52 9.43
5	288.26	297.90	298.44 9.64	287.90	297.90	298.54 10.00	287.19	297.90	298.50 10.71	287.57	297.90	298.45 10.33
6	286.90	297.77	298.17 10.87	287.45	297.77	298.05 10.32	290.44	297.77	298.29 7.33	295.77	297.77	298.38 2.00
7	294.55	313.64	13.89 19.09	299.07	313.64	14.07 14.57	302.60	313.64	14.11 11.04	307.01	313.64	14.28 6.63
8	305.23	317.51	18.01 15.18	305.87	317.51	18.07 11.64	309.11	317.51	17.87 8.40	312.84	317.51	17.93 4.67
9	312.68	328.38	28.74 15.70	314.72	328.38	28.78 13.66	317.78	328.38	28.66 10.60	320.40	328.38	328.77 7.98
Abutment	331.00	331.00	0.0							332.00	331.00	+1.00

Jan. 18, 1927
 C. S. Thompson 33

Islenair Sewer
 Easements Blks. #1 & #2

Sta.	H.I.	Grade.		Elev.	Cut
	308.42				
0+00 M.H. #15		292.00	10.42	298.00	6.00
+50		93.35	8.61	99.81 ✓	6.46 ✓
1+00		94.70	6.61	01.81 ✓	7.11 ✓
+50		96.05	4.90	03.55 ✓	7.47 ✓
2+00 M.H. #16		297.40	3.45	04.97 ✓	7.57 ✓
+50		98.75	1.48	06.94 ✓	8.19 ✓
3+00		300.10	0.38	08.04 ✓	7.94 ✓
+50	318.71	01.45	9.38	09.33 ✓	7.88 ✓
4+00	318.77	02.80			
4+25 #17	-0.12	303.48	10.86	07.91	4.43 ✓
+50	318.65	04.74	5.97	12.80	8.06 ✓
	9.82				
5+00		06.63	4.30	14.47	7.84
+50	328.47	08.73	2.80	15.97	7.24
	-0.13				
6+00	328.34	10.83	1.12	17.65	6.82
	10.91				
+50	339.25	12.90	8.63	19.84	6.91
7+00 M.H. #18		315.03	6.44	22.03	7.00
+50		17.13	4.53	23.94	6.81
8+00		19.23	2.30	26.17	6.94
+50		21.33	0.13	28.34	7.01
9+00		23.43	9.29	29.96	6.53
+50		25.53	7.35	31.90	6.37
10+00 M.H. #19		327.63	5.89	33.36	5.73

Jan. 18 1927
O.S. Thompson

34

Tolenoir Sewer
Easements Blks. #1 & #2

Sta.	339.25	Grade	-	Elev.	Cut
10+50		28.88	4.05	35.20	6.32
11+00		30.13	2.58	36.67	6.54
+50		31.38			
12+00		32.63	3.32	35.93	3.30
12+10 Dead End		332.88	3.31	35.94	3.06

Easements Along So. Line

	304.32	Grade	-	Elev.	Cut.		
0+00 M.H. #15		292.00					
0+05	304.67	91.97	6.52	497.80	5.83		
+50		91.65	5.47	99.24	99.20	7.59	7.55
1+00		91.30	5.08	99.79	98.98	8.49	7.68
1+25 M.H. #14	30.10	291.13	4.53	99.64	98.84	8.51	7.71
+50		90.96	5.83	99.81	99.39	8.85	8.43
2+00		90.60	4.68	300.8	300.71	10.23	10.11
2+50 D.M.H. #10 = 0+00		290.25	5.28	03.27	01.22	13.02	10.97
3+00			3.45				
0+00	297.73	89.20	5.83	04.23	99.14	15.03	9.94
3+50			5.53				
1+00		88.15	6.72	98.37	97.95	10.22	9.80
1+25		87.63	10.73	93.89		6.26	
3+95			7.35				
1+45		87.21	6.67	89.64	91.06	2.52	3.85
4+08			11.60				
1+88 M.H. #3		286.30	6.41	91.30	91.32	5.00	5.02

Revised Feb 25-27
O.S.

Elevations

Bent	East	☿	West
#1	326.12	313.32	304.14
#2	315.34	303.46	295.12
#3	306.11	299.32	291.52
#4	295.14	293.76	292.23
#5	291.68	290.62	296.40
#6	287.53	289.16	303.14
#7	294.72	302.84	312.06
#8	302.34	309.92	319.36
#9	311.62	318.62	325.93

Isle aux Sewer

Sta.	+	H.I.	-	Grade	Cut
		309.13			
0+00	M.H. #4			309.00	4.80
+25				97.78	9.12
+50				93.56	11.28
0+93	M.H. #3			86.30	5.00

Feb. 25-1927

[Signature]

343.66

36.00

340.06

8.48

345.29

6.41

338.88

8.48

347.36

347.36

81

396.55

347.36

39.14

8.22