

NAME National Ave Ext.

Class _____ Course _____ Party _____

Alignment Book No 4

Alignment Book No 4

1900

182
FIELD NOTES

No. 403P

ESPECIALLY ADAPTED
TO THE USE OF
ENGINEERING STUDENTS

EUGENE DIETZGEN Co.

MANUFACTURERS

DRAWING MATERIALS

MATHEMATICAL AND SURVEYING INSTRUMENTS

MEASURING TAPES

CHICAGO SAN FRANCISCO NEW YORK
NEW ORLEANS PITTSBURGH

NAT'L AVE. EXT.
Alignment Book #4

MICROFILMED

DEC 30 1964

INDEX:

	Page.
Re-Location Alignment Sta. 0+00 to 38+65.26= 22+65.44	1-9
Change in B-Line	11-12
G-Line \neq Survey	13-22
G-Line Line Chg 75+73.84 to 85+63.36= 74+18.53	23-24

Sta. Dist. Angle Az. Def. Ties-

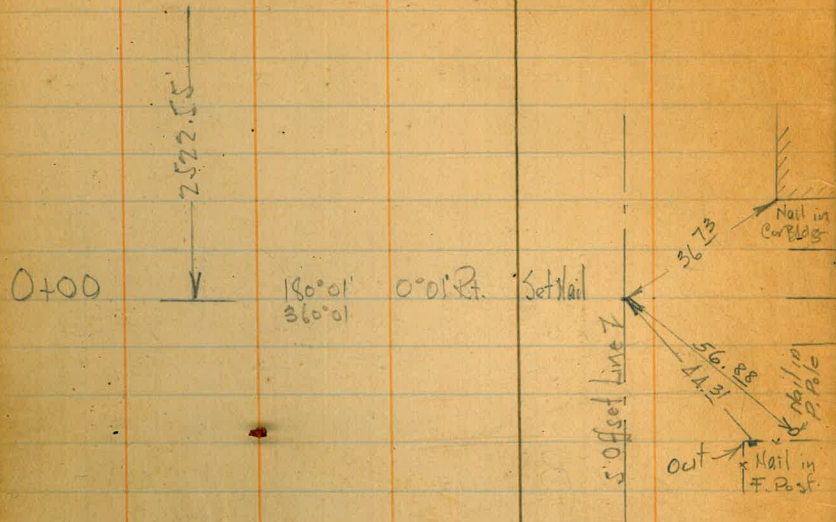

X-Secs in Bk #

Relocation

NATIONAL AVE. EXT.

0+00 to 38+65.26 = 22+65.44

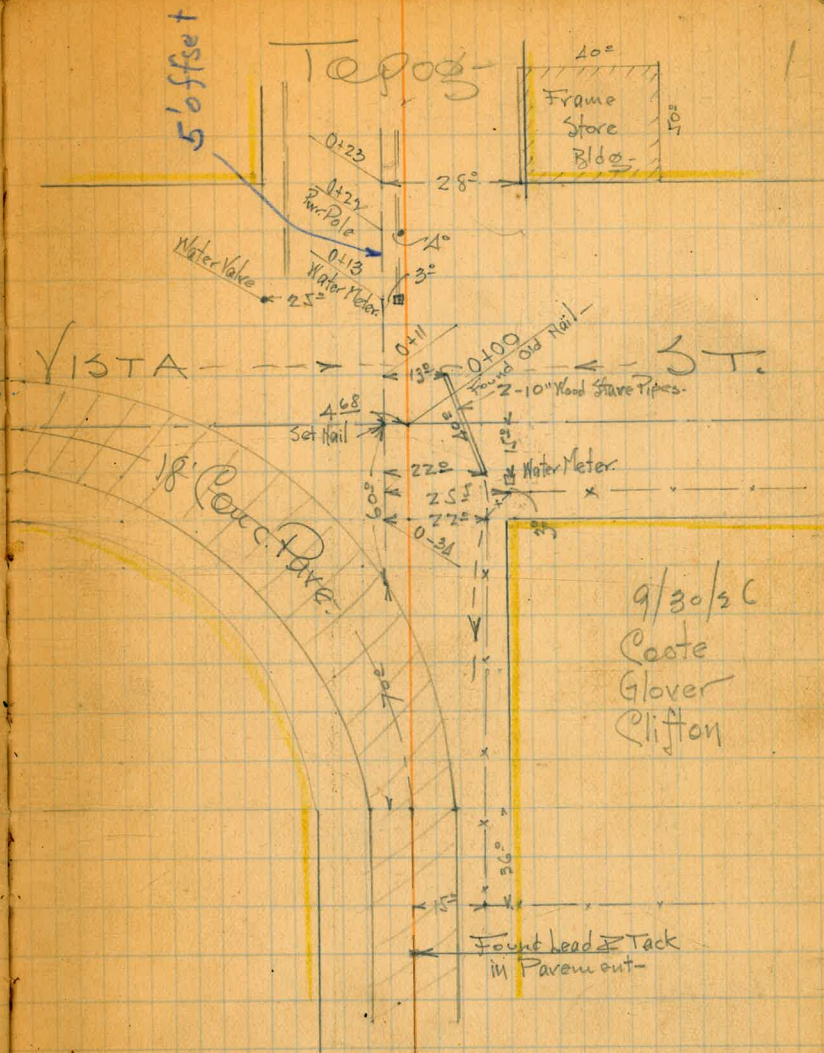

Found 2x2 Hub with Tack

Sta. Dist. Angle Az. Def. Ties

6+34
R.O.T.

2522.55

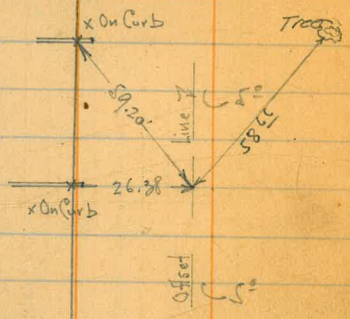

Topog.

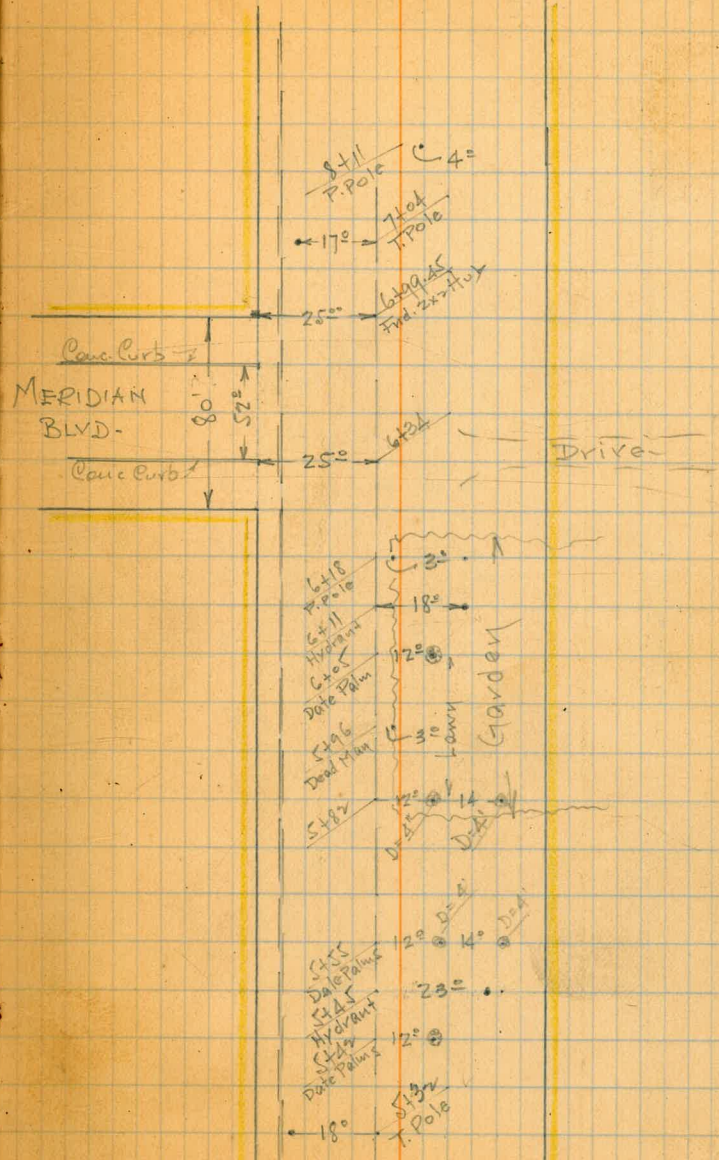

Sta. Dist. Angle Az. Def. *Ties

2522.55

Topog.

4

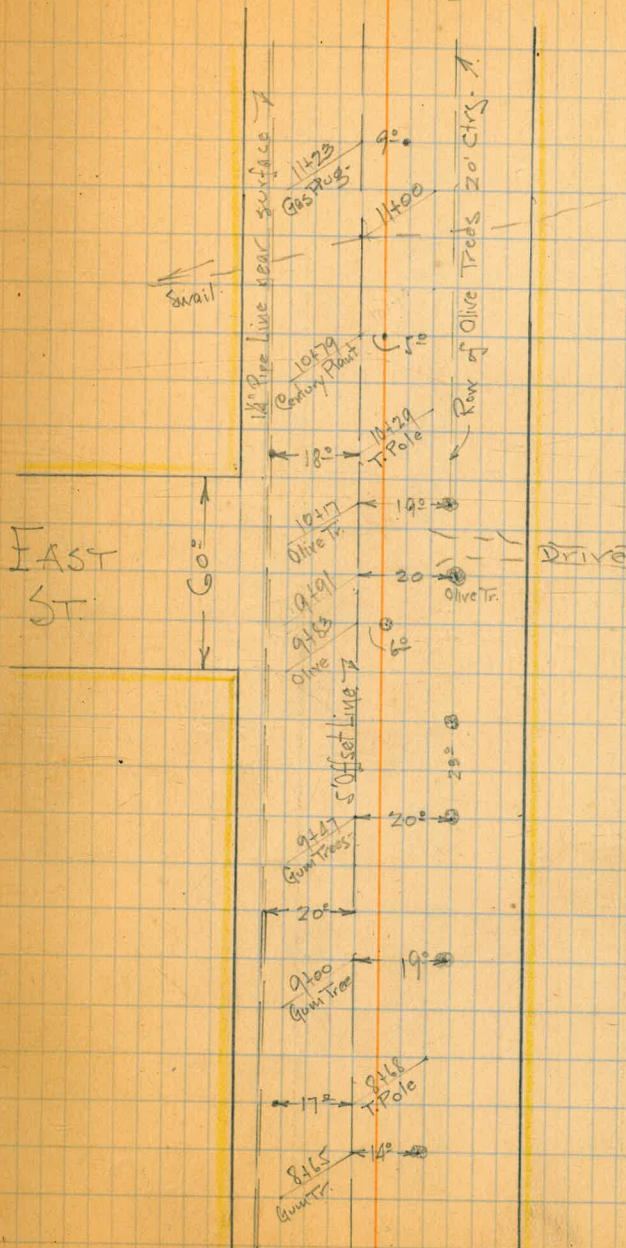

Sta. Dist. Angle Az. Def. E. Ties-

Topog-

5

1340.50
P.O.T.

2522.55

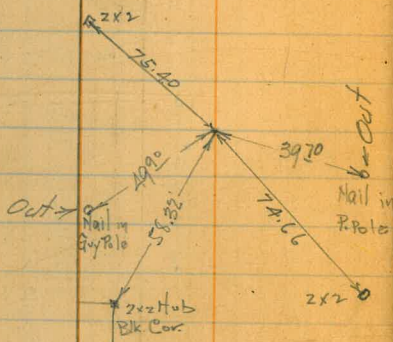

22° → 154.00
T. Pole

5° → 14.28
P. Pole

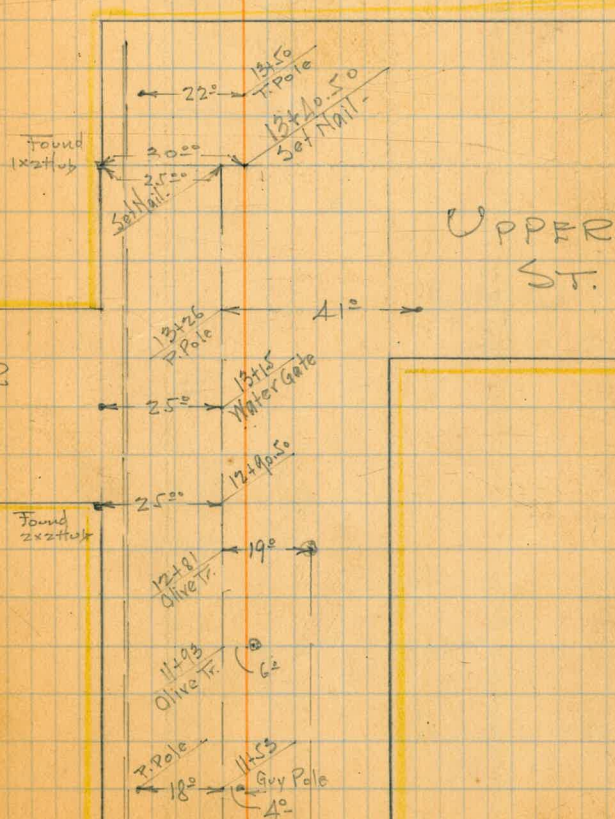

Sta.	Dist	Angle Az.	Def.	± Ties
------	------	--------------	------	--------

552252

Topog.

6

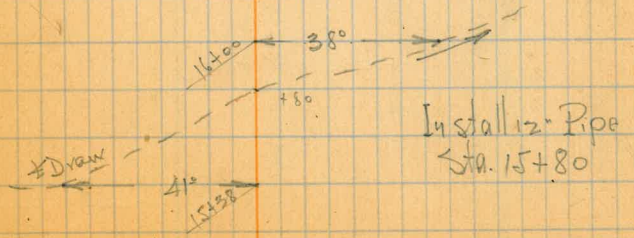
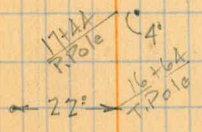
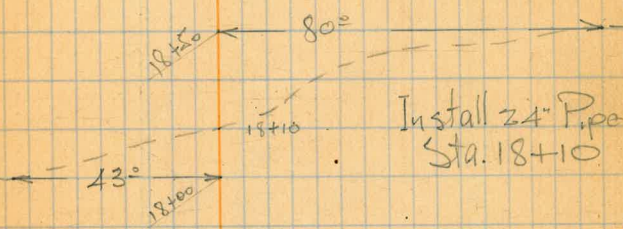
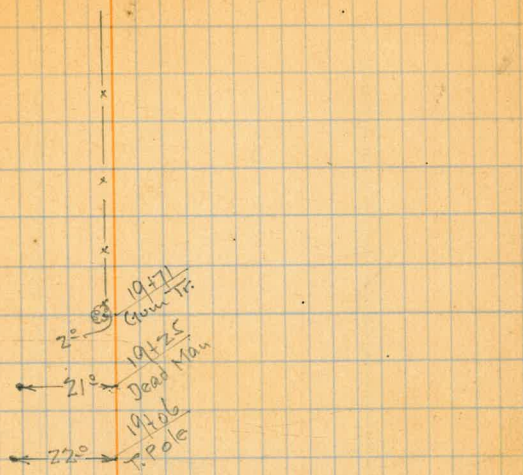

Sta.	Dist.	Angle.	Def.	Ties
		Az.	Def.	

2522.55

20450
ROT

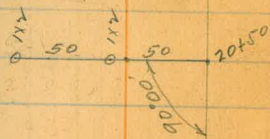

Topog-

7

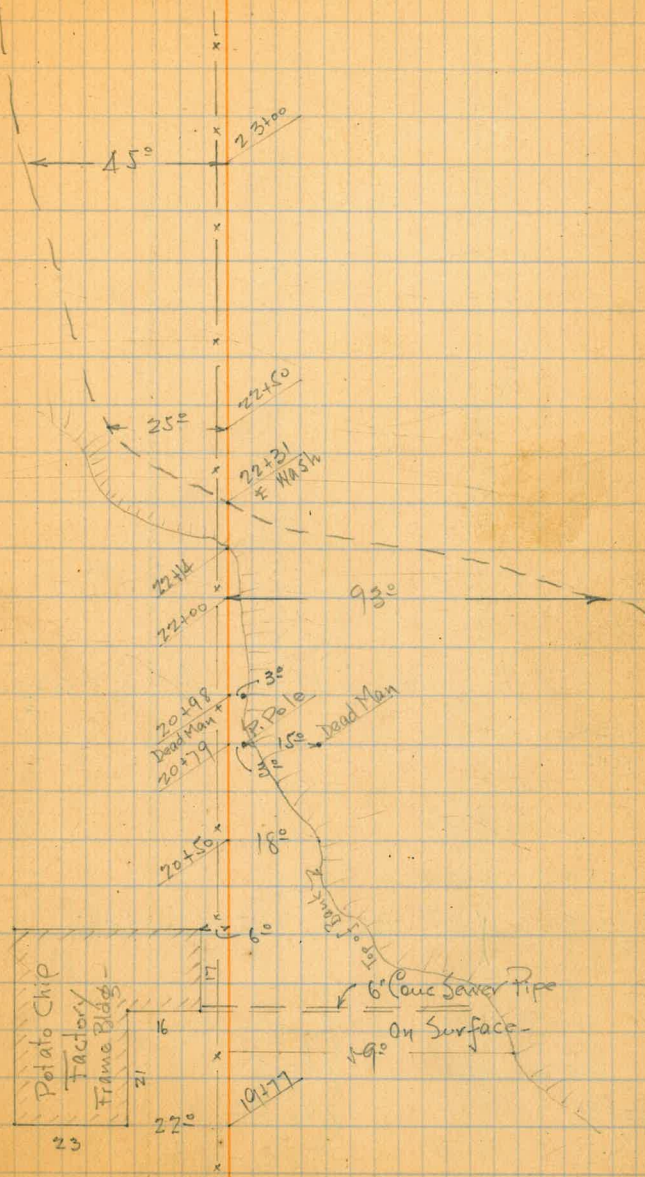

Sta. Dist. Angle Az. Def. Ties

1133.05

27108.30
P.T.

25422.55
P.V.

23415.36
P.C.

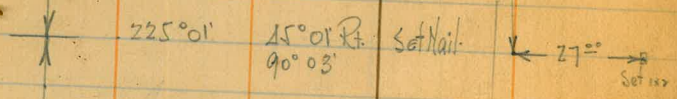

$A = 45^{\circ}01'$
 $R = 500$
 $T = 207.19$
 $L = 392.84$

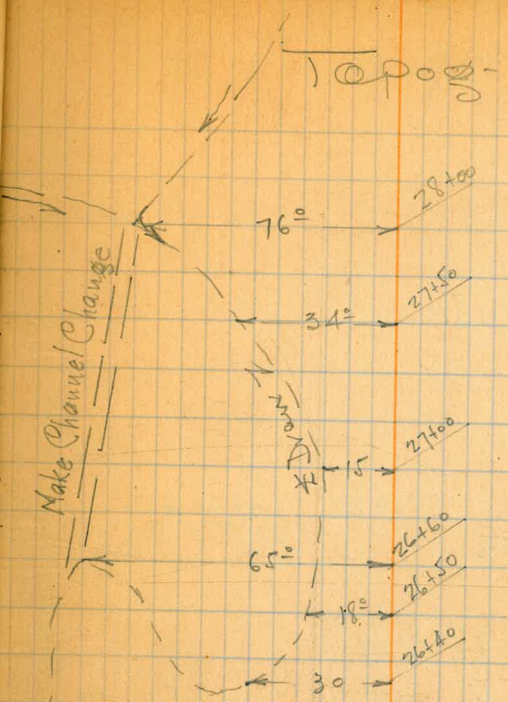

See Pg. 13 for 'G' Line.

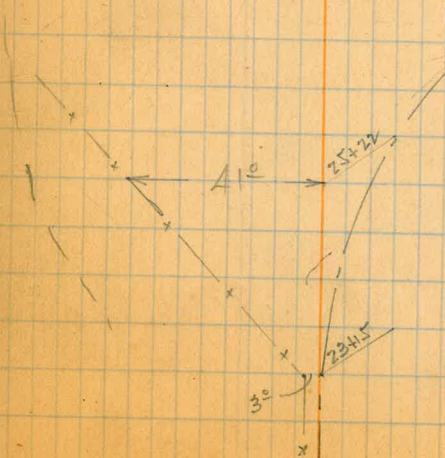

Deflections:

- 23+50 = 10°59'
- 24 = 4°51'
- +50 = 7°43'
- 25 = 10°35'
- +50 = 13°27'
- 26 = 16°18.5'
- +50 = 19°10.5'
- 27 = 22°02.5'
- to 8.30 = 22°30.5'

Sta. Dist. Angle Az. Def. ± Ties

22+65.44
38+65.26 =
P.T.

2802.01

Equation

36+34.06
P.I.

171°16'
242°32½'

58°44' Lt
1x2 Hub
(old P.T.)



33+52.71
P.C.

L = 58°44'
R = 500'
T = 281.35
L = 512.55

1133.05

Topog-

9

Cont'd in F.B. # 124/2

Deflections:

- 34 = 2°42½'
- +50 = 5°34½'
- 35 = 8°26½'
- +50 = 11°18'
- 36 = 14°10'
- +50 = 17°02'
- 37 = 19°54'
- +50 = 22°46'
- 38 = 25°38'
- +50 = 28°29½'
- 465.44 = 29°22'

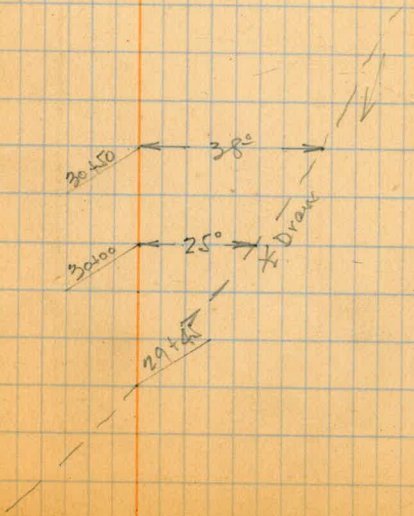

10

Sta. Dist. Angle Az. Def. Ties-

228+13.39
P.P.

225+31.57
P.P.

Post
(Old T.I.)

222+1383
P.P.

$\alpha = 32^\circ 38'$
 $R = 1000'$
 $T = 292.74'$
 $L = 569.56'$

Change in
B LINE.



Topog-

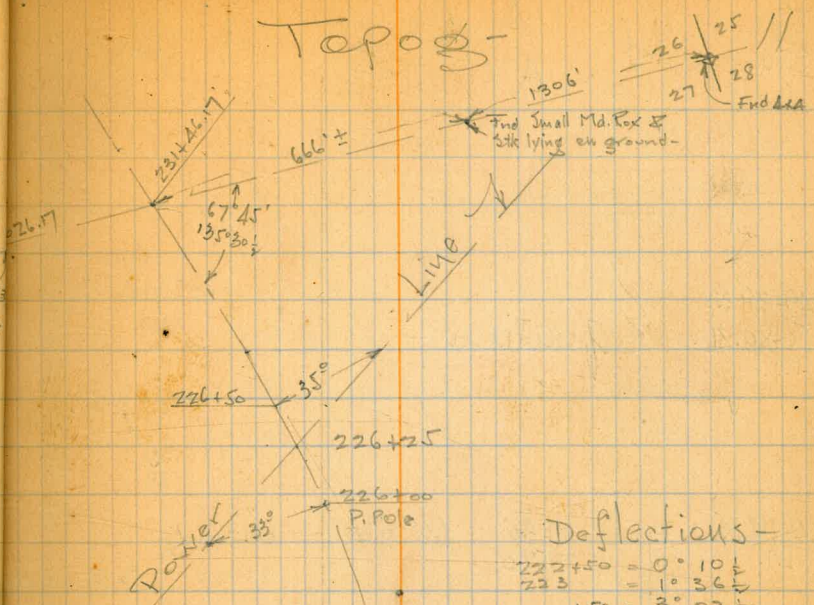

Deflections-

222+50	=	0° 10'
223	=	1° 36'
+50	=	3° 02'
224	=	4° 28'
+50	=	5° 54'
225	=	7° 20'
+50	=	8° 46'
226	=	10° 12'
+50	=	11° 38'
227	=	13° 04'
+50	=	14° 30'
228	=	15° 56'
+13.39	=	16° 19'

X-Secs in Bk#

Cont'd from Bk#

Sta. Dist. Angle
Az. Def

249+39.33
250+80.46
P.T.

Equation

248+86.8
P.I.

17°30' 62°30' Lt.
235°00'

246+44.3
P.C.

$\Delta = 62^\circ 30'$
 $R = 400$
 $T = 247.72$
 $L = 436.33$

240+50
P.O.T.

± Ties

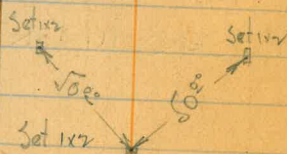
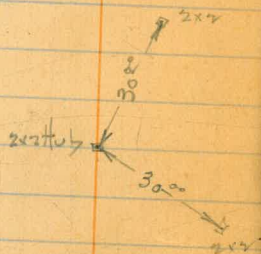

NARRAGANSET

Topog

12

Cont'd in Bk # 124/24

Deflections

246+50 = 0° 25'
47 +50 = 4° 00'
48 +50 = 7° 35'
49 +50 = 11° 10'
49 +50 = 14° 44'
49 +50 = 18° 19'
50 +50 = 21° 54'
50 +50 = 25° 29'
50 +50 = 29° 04'

250+80.46 = 31° 15'

SWEET WATER AVE.

10/1/26

Coote
Glover
Clifton
Key

Install 18" C.M.P.
Sta. 244+42

35'

244+42

Install 18" C.M.P.
Sta. 234+50

Sta. Dist. Angle
Az. Def.

26+41.21
P.I.
179°54'
359°47' 0°06' Lt. 50 50

25+22.5
P.O.T.

See Pg 8 for ties.

23+15.36
P.O.T.
23+15.36
P.C.

NATIONAL AVE. EXT

"G" Line

Topog.

13

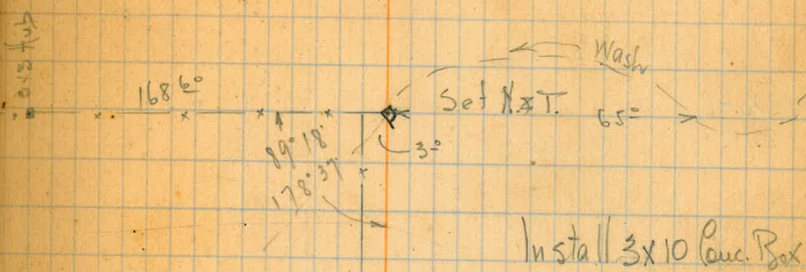

12/4/26

Coote
Clifton
Key

For B.T. & X-Sections
See 184/20

Cont'd from Pg. 8 this book

Sta.	Dist.	Angle		Ties
		Az.	Def.	

Topo 14

31190.20
P.O.T.

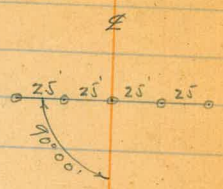

28759.20
P.O.T.

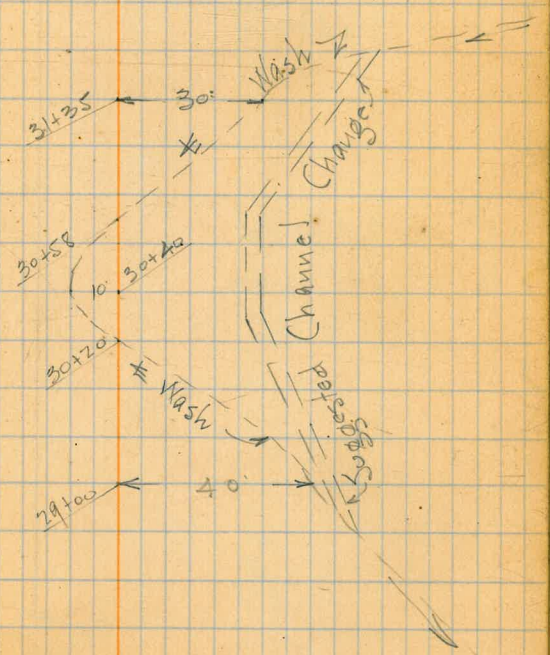

Sta. Dist. Angle Az. Def. # Ties

39+54.8
39+46.2 RT

38+51.71
PI.

37+49.24 PC.

142° 17'
294° 33' 1/2 37° 43' Lt.

A = 37° 43'
R = 300
T = 102.47
L = 197.48



Topog. 15

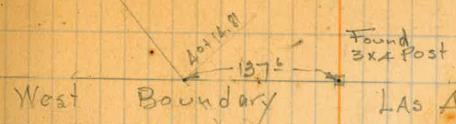

LAS ALTURAS TR.

38+00 4-50-50
38+50 9-37-19
39+00 14-23-48
39+46.2 18-51-20
39+54.18

Use R = 300'

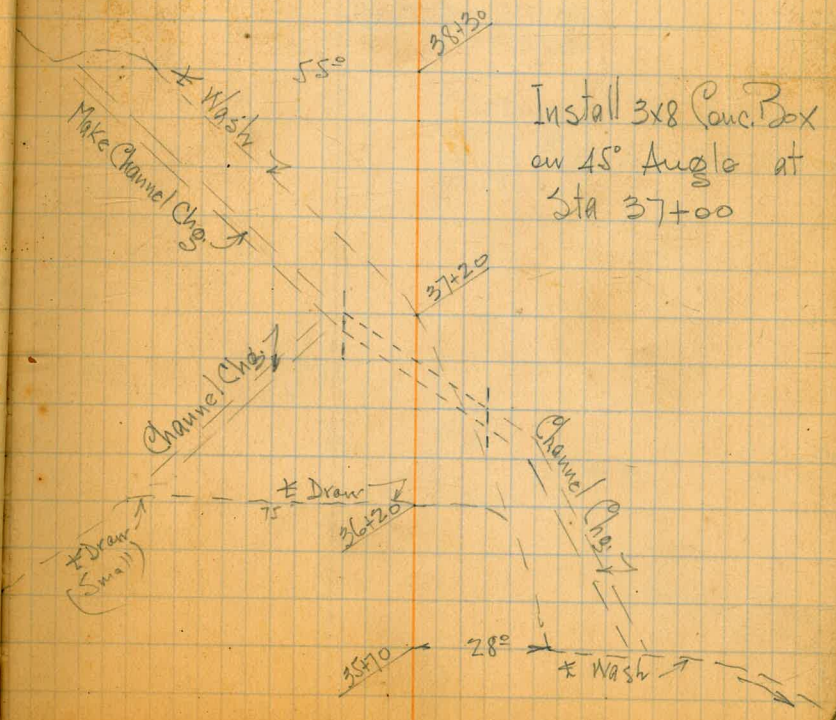
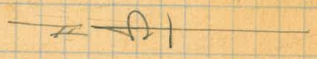

Install 3x8 Conc. Box
on 45° Angle at
Sta 37+00

Sta. Dist. Angle Az. Def. \pm Ties-

Topog- 16

39
39
~~43+77.55~~
P.O.T

38
43+77.25
3) 43+75.25
PT

42+77.95
P.I. 198°53'
+ 37°45' 18°53' Pt.

41+78.17 PC
 $\Delta = 18.53$
 $R = 600.0$
 $T = 99.78$
 $L = 197.75$

40+14.8
P.O.T.

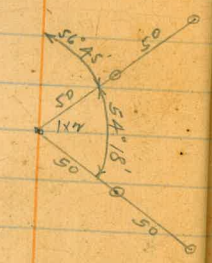

42-77-95
99.78
42-78.17

177-03
56.75
54-18

Find Old 244
25.34
Set 124
On Split of Angle

42+00 = 1°02'32"
42+50 = 3°25'46"
43+00 = 5°49'00"
43+50 = 8°12'14"
43+75.25 = 9°26'30"
43+77.25

Install 12" CMP
Sta 41+70

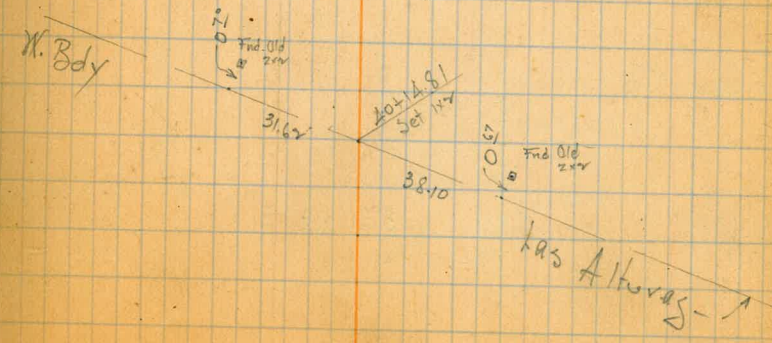

Sta Dist Angle Az. Def. ± Ties

48+92.94
48+91.5 PT.

47+84.77
P.I.
195°24' +30°49' 15°24' R
Δ=15°24'
R=800
T=108.17
L=215.01



Topog-

17

- 47+00 - 0-50-17
- 47+50 - 2-37-40
- 48+00 - 4-25-09
- 48+50 - 6-12-35
- 48+91.5 - 7°42'

Find Old track with track
Set 1st on split of angle

93.19
53.25
39.50

45+51.21
45+51.2 PT.

Δ=3°31'
R=2825.40
T=86.74
L=173.39
D.I.=0.6073

44+64.47
P.I.
183°31' +7°02' 3°31' R

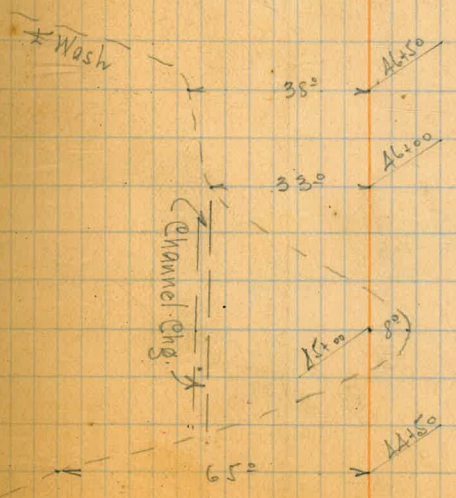
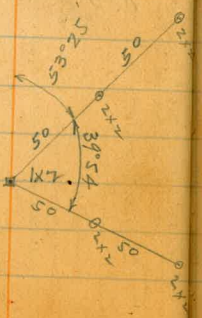

- 44+00 = 0-13-21
- 44+50 = 0-43-53
- 45+00 = 1-14-15
- 45+51.21 = 1-45-30
- 45+51.21

43+77.21
43+75.22 P.C.

Sta.	Dist	Angle Az. Def.	Ties-
------	------	-------------------	-------

52+71.95
E.C.

52+02.80
F.I.

166°44'
333°27'

13°16'15" Lt.

51+32.98
B.C.

$L = 13^{\circ}16'15"$
 $R = 600$
 $T = 69.82$
 $L = 138.97 \checkmark$

50+91.60
P.O.T. X

18

Topog.

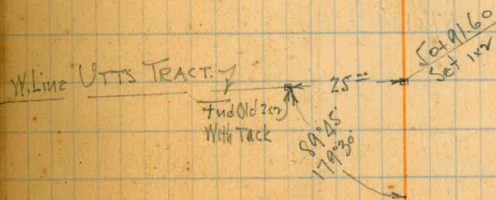
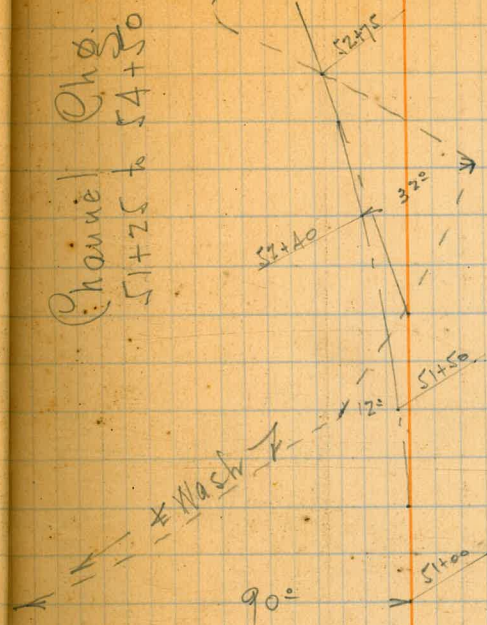

Sta. Dist. Angle Az. Def. ± Ties.

57+00.32
P.O.P.

1x2

54+84.55
F.C.

54+16.15
P.I.

152° 59' 27" 01' 15" Lt
305° 57' 1/2

1x4

53+43.07
B.C.

A = 27° 01' 15"
R = 300'
T = 72.08
L = 141.48' ✓

Topog.

19

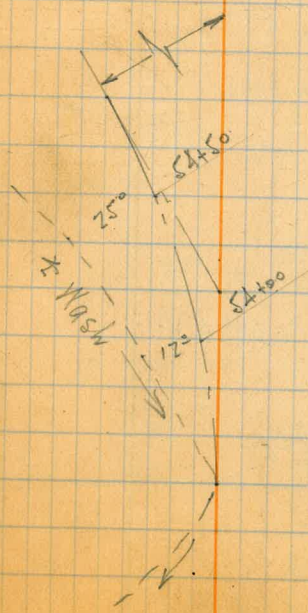
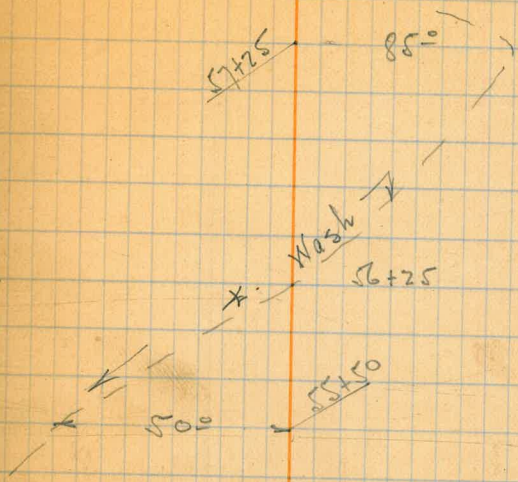

Sta Dist. Angle Az. Def. # Ties-

61+55.64 Pot. 1x5

6+04.48 F.C.

58+71.12 P.I. 219°54' +79°48' 39°54' Rt. 1x2

57+25.93 S.C. 1x2

A=39°54'
R=400
T=145.19 ✓
L=278.55 ✓

Topog- 20

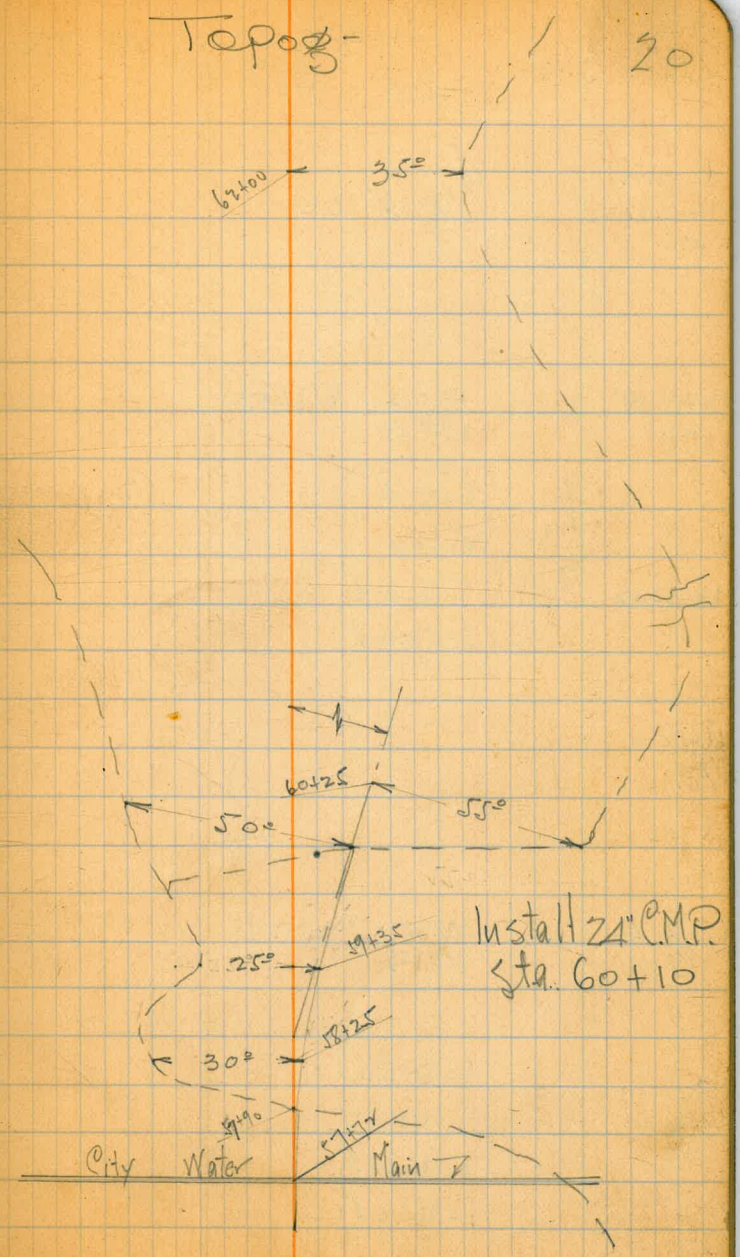

Sta.	Dist.	Angle Az. Def.	≠ Tres-
------	-------	-------------------	---------

Topog-

21

71+52.02
71+02.02=
F.C.

Equation-

70+17.59
P.I.

196° 14' 16" 14' R.
+32° 27'

□ 1x2

60

L = 16° 14'

R = 600

T = 85.57' ✓

L = 170.00' ✓

69+32.02

≠ Draw

66+94.19
F.C.

65+14.14
P.I.

159° 08' 20" 52' L.
318° 15'

□ 1x2

L = 20° 52'

R = 1000

T = 184.14' ✓

L = 364.19' ✓

63+30.00
B.C.

Sta Dist Angle
Az. Def.

± Ties -

Topog -

69+37.50 D Line
81+16.24 G = Equation -

80+28.15
E.C.

79+14.02
P.I.

90° 51' 89° 09' Lt.
181° 12'

$\Delta = 89^{\circ} 09'$
 $R = 200$
 $T = 197.06$
 $L = 311.19$

77+16.96
B.C.

75+73.84
P.I.

184° 38' 40° 38' Rt.
+ 9° 17'

fail

fail

fail

73+50

50°

± Draw

Install 12" C.M.P.
Sta. 71+77

71+77

± Draw

sta Dist. Angle Az. Def # Ties

Topog-

23

80±18.0'
F.C.

Deflections-

79±04.73
P.I.

84°28'
95°31' 84°29' Lt
191°02'

Set up

77±23.14

L = 84°28'30"

12/30/26

X-Secs in Bk 230/17

72±23.14
B.C.

R = 200

Coote

T = 181.59'

Gilow

L = 294.87'

Leed

King

716.91L

75±73.84
P.I.
75±73.84
P.I.

1x2

G LINE
Line Change

Cont'd from Pg. 22

1+70.20 Pt. Churchward Ave

74+18.53 Pt. Nail Ave No 1

85+63.36

0
|

85+13.36
Pt.

270°04'
180°08'

90°04' Pt.

144

25

26

27

28

29

30

31

32

33

34

35

7%
18) 125
126

3' x 10

179-60
142-17
37-43

99.5
35.1
137.6

85+53.36
80+18.01
535.35
181.59
716.94

① ~~289-52~~
150
109-56
② ~~249-19-12~~

270.00
150
90.00
150.00

62-21

13+40.50
50
12+90.5