

1998



# EUGENE DIETZGEN CO.

DRAWING MATERIALS, MATHEMATICAL and  
SURVEYING INSTRUMENTS

Chicago New York San Francisco New Orleans Pittsburg Toronto

Distances from Center of Roadway for Cross-Sectioning  
Roadway 16 feet wide. Side Slopes 1 on 1.  
For Single Track Embankment.

H	0	.1	.2	.3	.4	.5	.6	.7	.8	.9	H
0	8.0	8.1	8.2	8.3	8.4	8.5	8.6	8.7	8.8	8.9	0
1	9.0	9.1	9.2	9.3	9.4	9.5	9.6	9.7	9.8	9.9	1
2	10.0	10.1	10.2	10.3	10.4	10.5	10.6	10.7	10.8	10.9	2
3	11.0	11.1	11.2	11.3	11.4	11.5	11.6	11.7	11.8	11.9	3
4	12.0	12.1	12.2	12.3	12.4	12.5	12.6	12.7	12.8	12.9	4
5	13.0	13.1	13.2	13.3	13.4	13.5	13.6	13.7	13.8	13.9	5
6	14.0	14.1	14.2	14.3	14.4	14.5	14.6	14.7	14.8	14.9	6
7	15.0	15.1	15.2	15.3	15.4	15.5	15.6	15.7	15.8	15.9	7
8	16.0	16.1	16.2	16.3	16.4	16.5	16.6	16.7	16.8	16.9	8
9	17.0	17.1	17.2	17.3	17.4	17.5	17.6	17.7	17.8	17.9	9
10	18.0	18.1	18.2	18.3	18.4	18.5	18.6	18.7	18.8	18.9	10
11	19.0	19.1	19.2	19.3	19.4	19.5	19.6	19.7	19.8	19.9	11
12	20.0	20.1	20.2	20.3	20.4	20.5	20.6	20.7	20.8	20.9	12
13	21.0	21.1	21.2	21.3	21.4	21.5	21.6	21.7	21.8	21.9	13
14	22.0	22.1	22.2	22.3	22.4	22.5	22.6	22.7	22.8	22.9	14
15	23.0	23.1	23.2	23.3	23.4	23.5	23.6	23.7	23.8	23.9	15
16	24.0	24.1	24.2	24.3	24.4	24.5	24.6	24.7	24.8	24.9	16
17	25.0	25.1	25.2	25.3	25.4	25.5	25.6	25.7	25.8	25.9	17
18	26.0	26.1	26.2	26.3	26.4	26.5	26.6	26.7	26.8	26.9	18
19	27.0	27.1	27.2	27.3	27.4	27.5	27.6	27.7	27.8	27.9	19
20	28.0	28.1	28.2	28.3	28.4	28.5	28.6	28.7	28.8	28.9	20
21	29.0	29.1	29.2	29.3	29.4	29.5	29.6	29.7	29.8	29.9	21
22	30.0	30.1	30.2	30.3	30.4	30.5	30.6	30.7	30.8	30.9	22
23	31.0	31.1	31.2	31.3	31.4	31.5	31.6	31.7	31.8	31.9	23
24	32.0	32.1	32.2	32.3	32.4	32.5	32.6	32.7	32.8	32.9	24
25	33.0	33.1	33.2	33.3	33.4	33.5	33.6	33.7	33.8	33.9	25
26	34.0	34.1	34.2	34.3	34.4	34.5	34.6	34.7	34.8	34.9	26
27	35.0	35.1	35.2	35.3	35.4	35.5	35.6	35.7	35.8	35.9	27
28	36.0	36.1	36.2	36.3	36.4	36.5	36.6	36.7	36.8	36.9	28
29	37.0	37.1	37.2	37.3	37.4	37.5	37.6	37.7	37.8	37.9	29
30	38.0	38.1	38.2	38.3	38.4	38.5	38.6	38.7	38.8	38.9	30
31	39.0	39.1	39.2	39.3	39.4	39.5	39.6	39.7	39.8	39.9	31
32	40.0	40.1	40.2	40.3	40.4	40.5	40.6	40.7	40.8	40.9	32
33	41.0	41.1	41.2	41.3	41.4	41.5	41.6	41.7	41.8	41.9	33
34	42.0	42.1	42.2	42.3	42.4	42.5	42.6	42.7	42.8	42.9	34
35	43.0	43.1	43.2	43.3	43.4	43.5	43.6	43.7	43.8	43.9	35
36	44.0	44.1	44.2	44.3	44.4	44.5	44.6	44.7	44.8	44.9	36
37	45.0	45.1	45.2	45.3	45.4	45.5	45.6	45.7	45.8	45.9	37
38	46.0	46.1	46.2	46.3	46.4	46.5	46.6	46.7	46.8	46.9	38
39	47.0	47.1	47.2	47.3	47.4	47.5	47.6	47.7	47.8	47.9	39
40	48.0	48.1	48.2	48.3	48.4	48.5	48.6	48.7	48.8	48.9	40

Example—If point is 22.6 ft. above grade, how far should it be from center line to be a slope stake point? Ans. from Table 30.6. For same slopes but other widths of roadbed, correct above figures by one-half difference in width of roadbed; thus in example above, for 20 ft. roadbed distance will be  $30.6 + (20 - 16) \div 2$  or 2 ft. added to  $30.6 = 32.6$ . For slopes of 1 on  $1\frac{1}{2}$  see inside of back cover.  
Copyright, 1914, by Eugene Dietzgen Co.

1998  
**1998**

~~CITY~~  
**CITY ENGINEER**

INDEXED  
to page # 76  
except pages # 77 to 79

This Field Book is manufactured of a High Grade 50% Rag Paper having a WATER RESISTING SURFACE, and is sewed with Bing Special Enamel Waterproof thread.

Made in U. S. A.



INDEX

1

Page 1-60 X Sect. Hornblend St. Cass to Marcell

Page 61- X Sect. Hornes St. Garnet to Roosevelt.







115549

3

Events

80' 51.

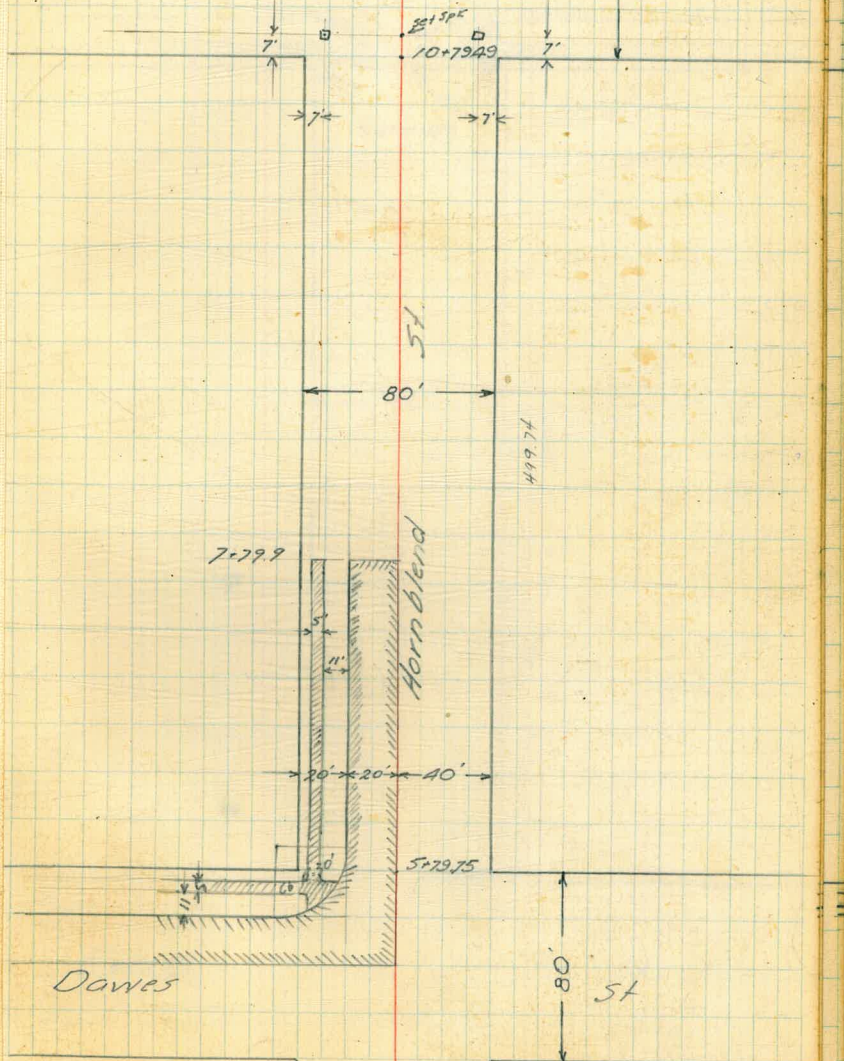







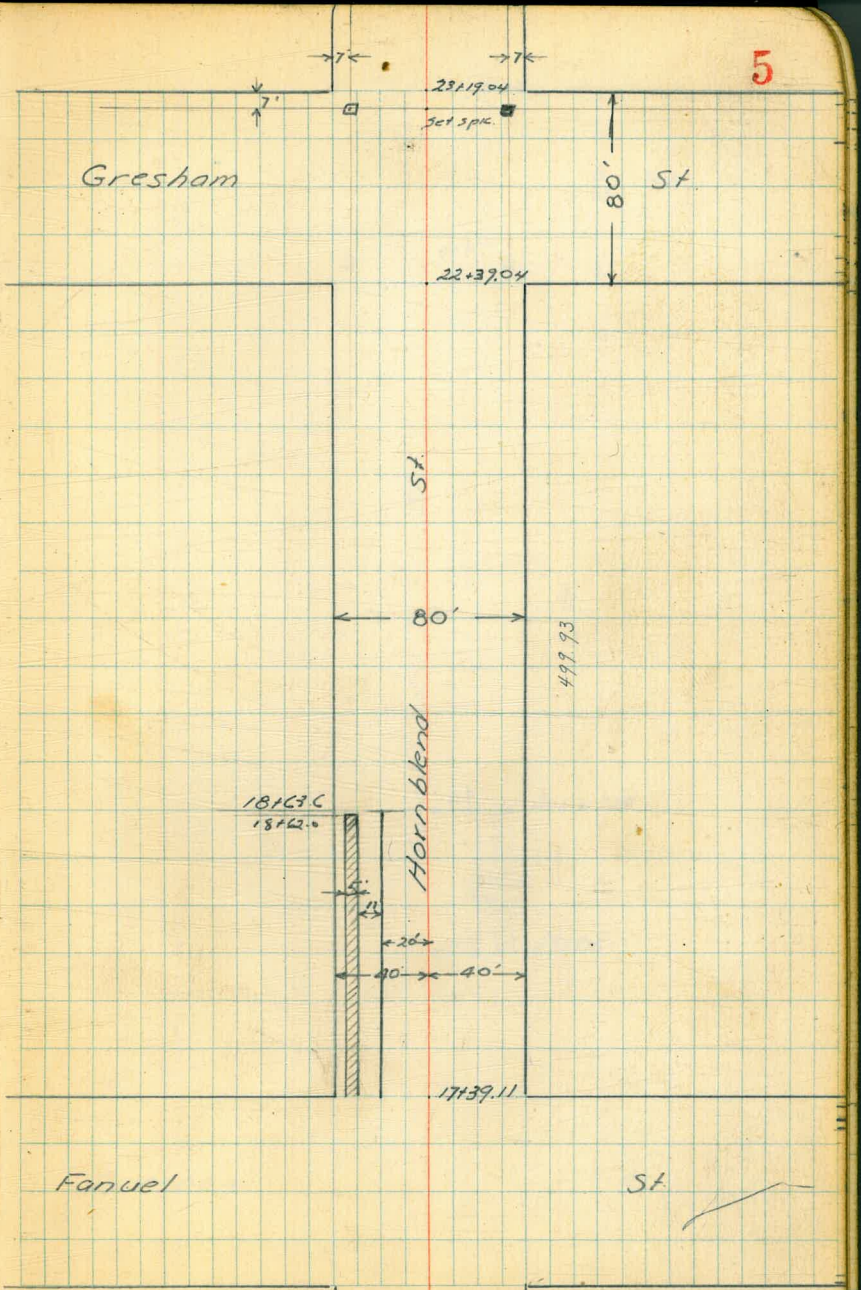



Haines

28+98.98

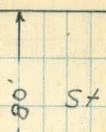

set SPR.  
28+18.98

St

80'

46694

Hornblend

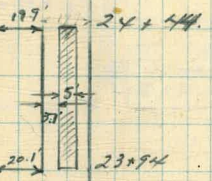

23+17.04

Gresham

St



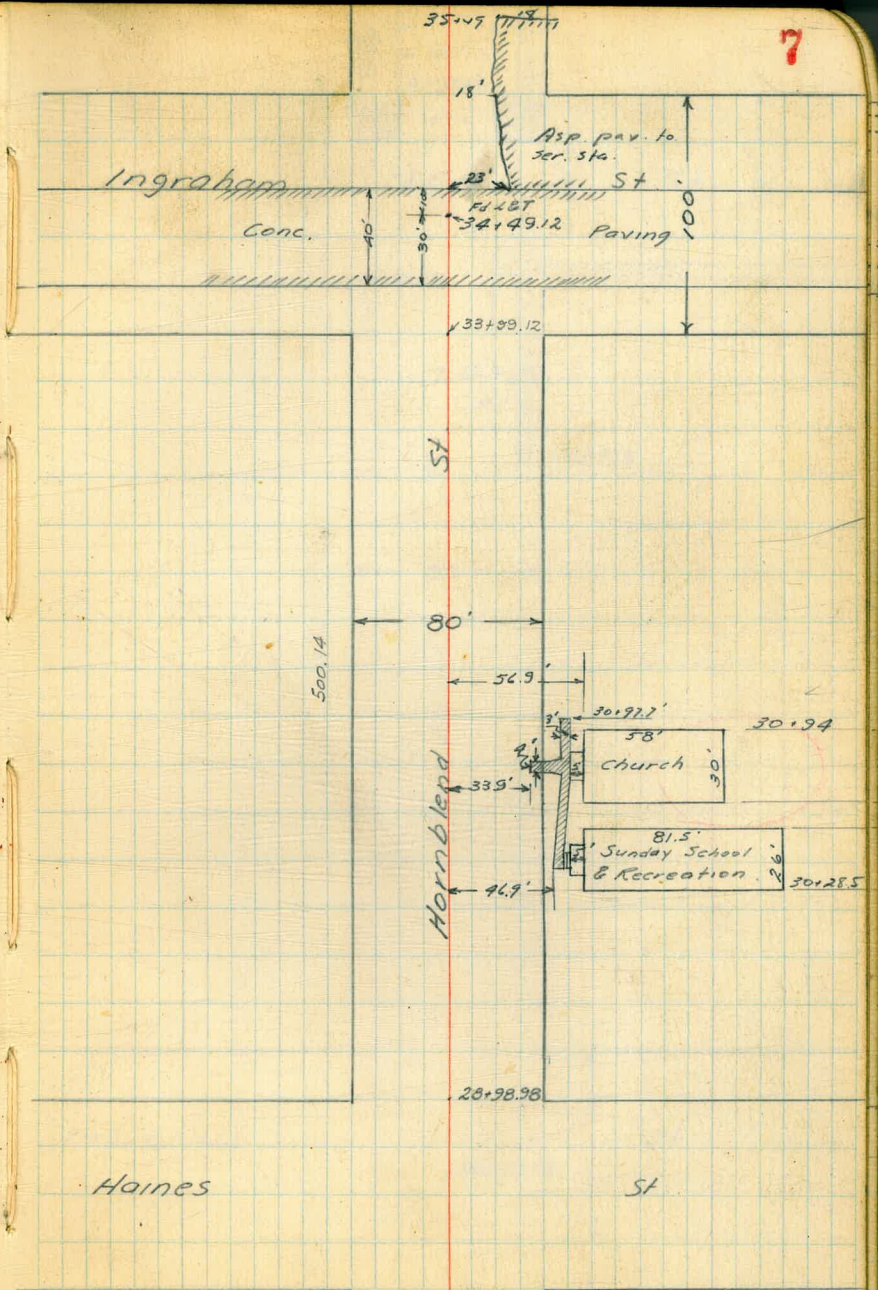



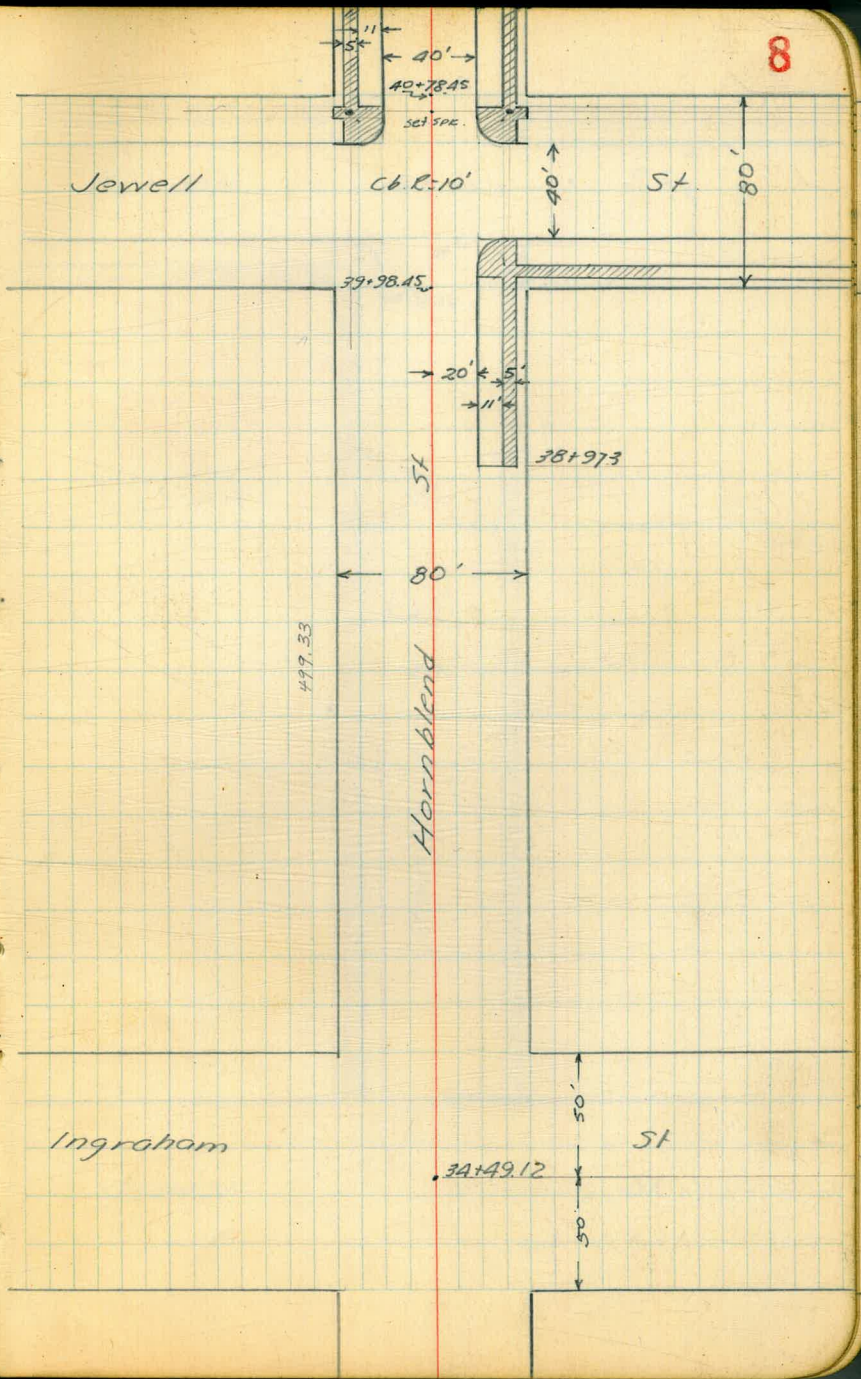



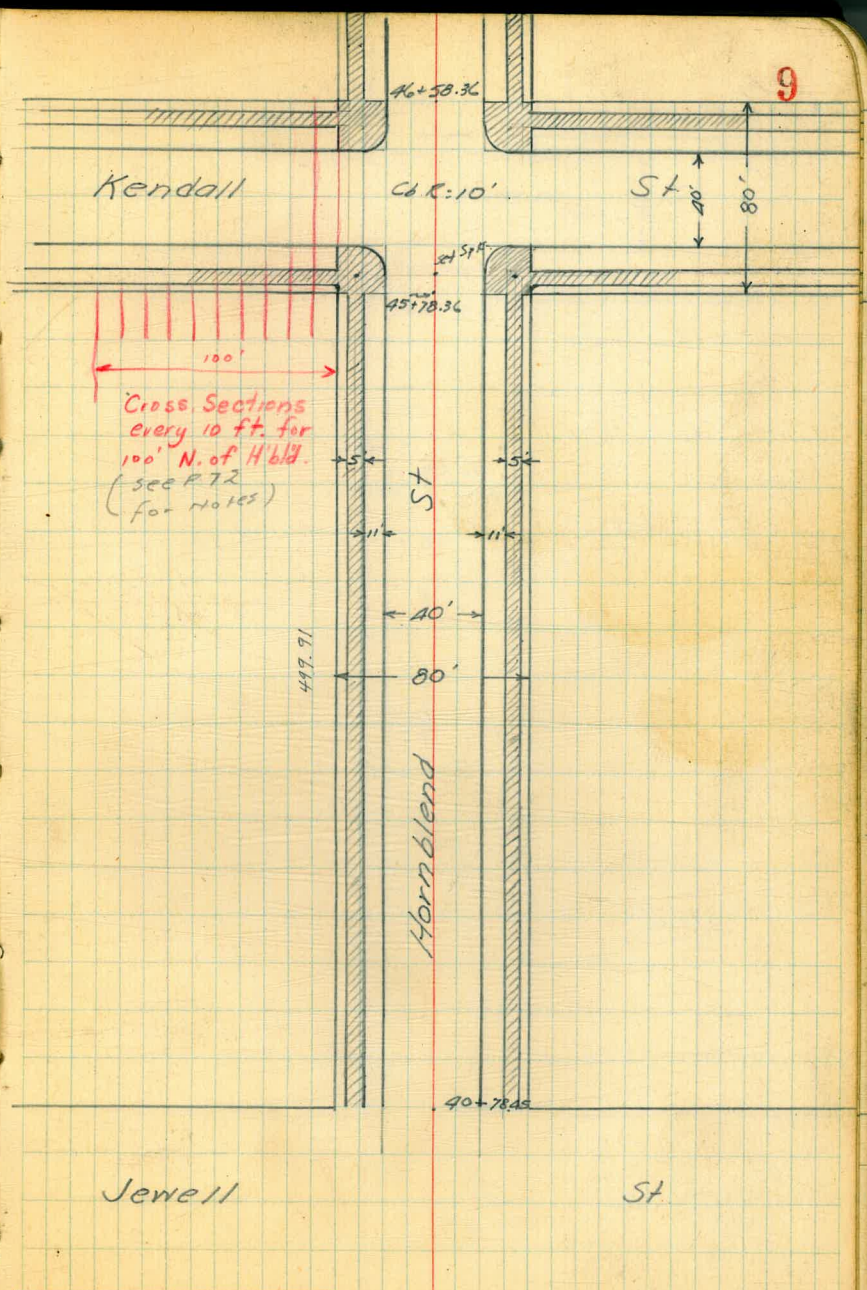



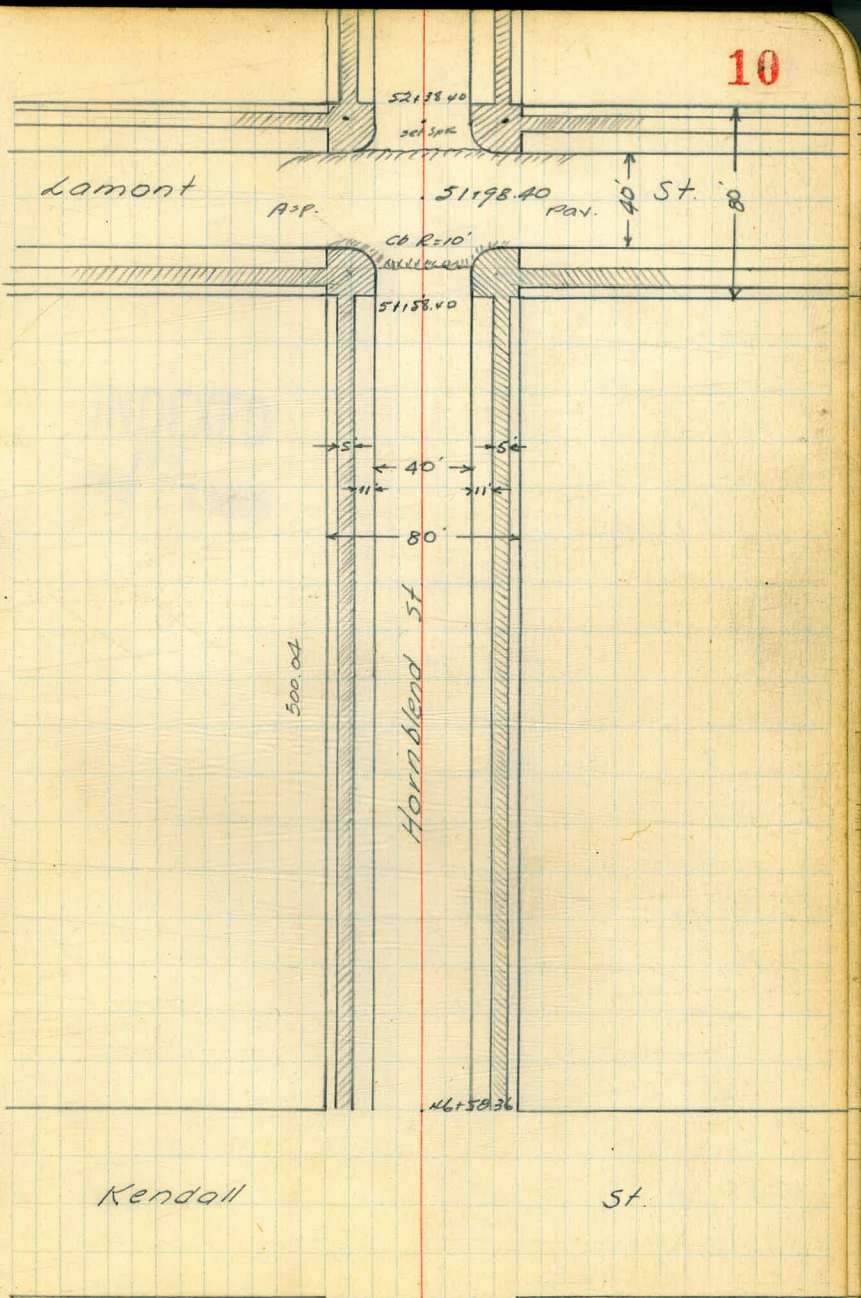



Morrell

St.

INDEXED  
WIK  
FEB 1 1949

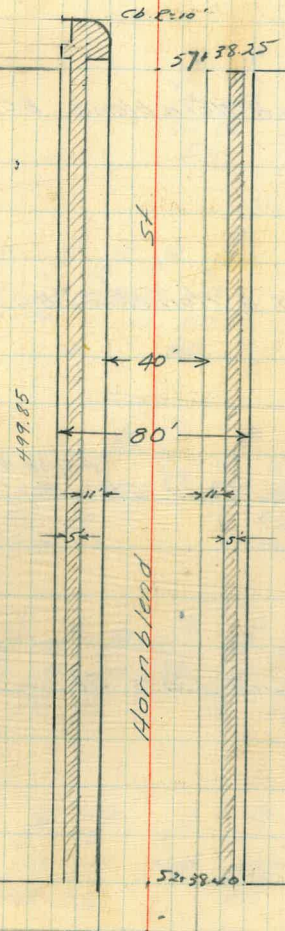

Lamont

St.



Levels Hornblend St.

Cass to

0+50 End of Cbs Rt & Lt

S.E. Cb Ret Cass & Hornblend BC on Cass St. (3pts)

N.E. Cb Ret Cass & Hornblend BC on Cass St. (3pts)

0+00 E Line Cass St. (Edge Asphalt Paving)  
Beg Cobblestone Cb Lt.

0-14 E Cb Line Cass St.

0-40 E Cass St

TP 3.59 27.67 4.72 24.08

B.M 0.95 28.80 27.85

12

23.00  
4.27 5.3 5.5 5.6 5.5 5.8 5.5 5.5 5.32 6.0 6.5  
26.3 25.5 13 9 12 14 26 26 40 50  
Cb Gut Cb Gut Cb Gut Cb Gut Cb

21.31 22.08 21.40 22.09 21.51 22.16 21.65 22.19  
6.36 5.57 6.27 5.58 6.5 5.5 6.2 5.48  
Gut Cb Gut Cb Gut Cb Gut Cb  
BC ① ② EC

23.00 22.77 22.96 22.16 22.92 22.24 21.93 22.24  
4.27 5.40 4.21 5.51 4.75 5.45 4.74 5.43  
Cb Gut Cb Gut Cb Gut Cb Gut  
EC ② ① BC

23.12 23.06 23.00 22.27 22.23 22.10 22.06 21.70 22.22 22.36 21.32  
4.25 4.4 4.4 5.40 5.44 5.57 5.61 5.97 5.45 5.31 5.35  
3.6 3.1 2.6 2.6 1.9 1.3 2.6 2.6 3.1 3.6  
S.W. S.W. Cb Gut Gut Cb S.W. S.W.

23.06 22.79 22.94 22.25 22.11 21.95 21.79 21.62 21.44 21.30 21.07 20.98 21.77  
4.4 5.35 4.72 5.42 5.52 5.22 5.88 6.05 6.22 6.37 5.60 6.69 5.90  
4.4 4.4 3.6 3.6 2.6 1.3 1.3 2.6 3.6 3.6 5.0 5.0  
Cb Gut Cb Gut Gut Cb Gut Cb  
BC BC

22.71 22.61 22.42 22.03 21.68 21.53 21.34  
4.86 5.06 5.25 5.64 5.99 6.14 6.33  
4.7 4.0 2.6 2.6 4.0 5.0

27.67

SEBP Garnett & Cass



2+41 24" Palm Tree 26' Lt. ← take out

2+19.6 & 3' Conc. Walk 21.7' Lt.

2+08.5 & 8' Conc. Drive 40' Rt.

2100

24.1  
3.5  
50

23.9  
3.8  
26

23.5  
4.2  
19

22.8  
4.9  
17

23.0  
4.7  
11

23.0  
4.7  
4.7

22.6  
5.1  
9

22.0  
4.7  
13

23.3  
4.4  
20

23.0  
4.2  
40

22.9  
4.8  
50

1450

24.0  
3.7  
50

23.6  
4.1  
23

22.6  
5.1  
17

22.7  
5.0  
5.0

22.4  
5.3  
12

22.6  
4.9  
13

22.8  
4.9  
22

22.4  
5.3  
50

1100

23.6  
4.1  
50

23.4  
4.2  
38

23.1  
4.5  
37

22.8  
4.9  
18

22.4  
5.3  
17

22.5  
5.2  
5.2

22.1  
5.5  
11

22.4  
5.3  
13

22.9  
4.9  
21

22.4  
5.3  
23

22.0  
5.7  
40

22.0  
5.7  
50

0+98.5 & 3' Conc. Walk 39.8' Lt.

23.68  
3.99  
50

23.52  
4.15  
39.8

27.67

π

27.67



3+00

2+61.1 &amp; 2' Conc. Split Drive 39.7 Rt.

2+56.3 &amp; 2' Conc. Split Drive 39.7 Rt.

2+71.4 End Conc. Drive 35.2 Lt.

2+52 Beg. 19.4 Conc. Drive 35.4 Lt.

2+50

27.67  
11

24.5	24.2	24.4	23.6	23.7	23.7	23.5	25.0	23.9	23.4	23.1
32	35	33	41	40	4.0	42	27	38	43	46
50	40	17	16	8		12	13	21	40	50

23.30	23.22
437	445
397	50

23.21	23.20
440	447
397	50

25.19	24.66
248	301
55	35.2

25.17	24.69
250	228
55	35

24.5	24.2	23.8	23.2	23.4	23.3	23.1	23.2	23.4	23.6	23.1	23.4	23.2
30	35	39	45	43	44	46	45	43	41	46	43	45
50	22	18	17	7		6	11	13	19	35	40	50

27.67  
11



4+92 9" Pepper Tree 24' Rt. out

4+85.5 2 3' Conc. Walk 18.7 Ft.

4+65 10" Pepper Tree 23.2 Rt. out

4+50

4+00

3+79 2 2.5' Conc. Walk 41.8 Lt.

3+55 2 2.5' Conc. Walk 41.6 Lt.

T.P. 6.10 30.70 3.07 24.60

3+50

27.67  
↑25.03  
5.67  
18.7  
25.12  
5.58  
40

25.7	25.5	25.1	24.7	24.9	24.7	24.4	24.4	25.1	24.6	24.4
5.0	5.2	5.5	6.0	5.8	6.0	6.3	6.3	5.8	6.1	6.3
50	40	14	12	5	10	14	16	18	40	50

25.3	25.2	24.7	24.2	24.4	24.2	24.4	23.9	23.6	23.5
5.4	5.5	6.0	6.5	6.3	6.5	6.3	6.8	7.1	7.2
50	40	15	13	6	15	22	25	40	50

24.98  
5.72  
50  
24.92  
5.78  
41.524.97  
5.73  
50  
24.84  
5.86  
41.6

24.4	24.4	24.3	23.8	24.0	24.0	23.9	24.2	24.0	23.6	23.3	23.1
5.2	5.3	5.4	5.9	5.7	5.7	5.8	5.5	5.7	5.1	5.4	5.6
50	40	16	15	7	27	13	16	22	25	40	50

30.70  
↑

27.67  
↑



5+3975 & Dawes St. (Intersection Asphalt Paving)

5+28

5+21

5+19

4+99.75 W. line Dawes St.

4+99.1 & 1.8 Conc. Work 25.4 ft.

30.70

26.06  
 $\frac{5.4}{40}$   $\frac{5.05}{20}$   $\frac{5.31}{22}$   $\frac{5.5}{20}$   
 25.65 25.39 25.1 25.1

25.6  
 $\frac{5.1}{40}$   $\frac{5.5}{16}$   $\frac{5.29}{23}$   $\frac{5.47}{20}$   $\frac{5.5}{20}$   
 25.1 24.9 24.7 24.5

25.3  
 $\frac{5.4}{40}$   $\frac{5.7}{20}$   $\frac{5.8}{14}$   $\frac{5.49}{21}$   $\frac{5.29}{26}$   $\frac{5.5}{40}$   
 24.8 24.9 24.9 25.2 25.1

26.5  
 $\frac{4.3}{40}$   $\frac{4.8}{16}$   $\frac{5.7}{13}$   $\frac{5.29}{19}$   $\frac{5.5}{21}$   $\frac{5.5}{40}$   
 25.9 25.0 24.9 25.0 25.5 25.2

26.2  
 $\frac{4.5}{50}$   $\frac{4.5}{40}$   $\frac{4.9}{22}$   $\frac{5.3}{11}$   $\frac{5.5}{12}$   $\frac{5.5}{12}$   $\frac{5.2}{19}$   $\frac{5.4}{20}$   $\frac{5.4}{20}$   $\frac{5.8}{40}$   $\frac{5.7}{50}$   
 26.1 25.8 25.4 25.5 25.2 24.8 25.4 24.9 25.0

26.31  
 $\frac{4.39}{50}$   $\frac{4.80}{25.4}$   
 25.90

30.70



6131.7 227' Conc. Walk

6100

5184 F.H. 23.1 Rt.

N.E. Cb Ret. Dawes & Hornblend  
BC on Dawes (6 parts)

5179.75 E. Line Dawes St.

5174 Bell Tel. 17 H. 24' Rt.

5159.75 E.Cb Line Dawes.

5155

3070  
T26.48  
42.22  
39.9  
26.36  
42.34  
50

27.0	26.97	26.94	26.80	26.74	26.17	25.8	25.5	26.2	26.3	26.0
37	37.2	37.6	37.0	42.56	42.32	42.9	42.5	42.5	42.4	42.7
40	36	31	20	20	7	20	21	31	40	
		SW	CB	Gut						

26.08	26.70	25.95	26.64	25.84	26.53	25.78	26.44	25.81	26.46	25.88	26.56	25.97	26.68
42.2	42.0	42.5	42.6	42.8	42.7	42.2	42.2	42.9	42.4	42.2	42.4	42.3	42.2
Gut CB	Gut CB	Gut CB	Gut CB	Gut CB	Gut CB	Gut CB	Gut CB	Gut CB	Gut CB	Gut CB	Gut CB	Gut CB	Gut CB
BC	①	②	③	④	⑤							E.C.	Hornblend

26.7	26.74	26.68	26.57	25.91	25.87	25.52	26.1	25.8
42.0	42.6	42.2	42.8	42.7	42.93	42.5	42.5	42.9
40	36	31	22	22	20	21	40	
	SW	SW	CB	Gut				

26.70	26.08	26.19	25.80	25.52	26.02	26.2	26.1	25.6
42.0	42.2	42.3	42.9	42.8	42.5	42.5	42.5	42.5
50	50	40	20	21	22	25	40	
CB	Gut							
CB	BC							

26.06	25.76	25.48	25.2	25.1	24.7
42.4	42.4	42.2	42.5	42.5	42.0
40	20	12	22	40	

3070  
T



7+70 2 3' Conc. Walk 40' Rt.

26.51
21.9
40
28.58
21.7
50

7+50

29.1	28.98	28.94	28.81	28.15	28.20	27.6	28.2	28.3
15	122	17	189	255	259	21	25	24
40	36	31	20	20	20	19	21	40
	SW	SW	CB	Gut				

27.95
27.5
20.2
28.00
27.0
50

7+13.8 2 3' Conc. Walk 40.2' Rt.

26.4	26.29	26.27	26.14	27.46	27.54	26.9	27.7	27.5
2.2	241	202	255	324	316	38	30	33
40	36	31	20	20	20	20	21	40
	SW	SW	CB	Gut				

26.98
27.2
40
26.95
27.5
50

7+00

6+64.5 2 2.4' Conc. Walk 40' Rt.

27.8	27.68	27.59	27.45	26.85	26.88	26.6	26.3	26.6
22	302	311	325	385	382	41	44	41
40	36	31	20	20	20	9	19	21
	SW	SW	CB	Gut				40

6+50

30.70

30.70



8+91.5 & 2.6 Brick Walk 39.8 RT.

30.59  
6.36  
39.8

30.46  
6.49  
50

8+67 & 3' Conc Walk 40.1 RT.

30.34  
6.63  
40.1

30.35  
6.60  
50

8+50

30.6	30.5	30.2	29.6	29.8	29.2	29.8	29.8	29.9
6.14	6.2	6.7	7.3	7.1	7.7	7.1	7.1	7.0
50	40	20	13		17	28	40	50

8+18 & 3' Conc. Walk 40' RT.

29.41  
7.54  
40.1

29.44  
7.51  
50

TP. 772 36.95 1.47 29.23

Top of Cb Lt 7+79.9 36.95

8+00

30.1	30.1	29.8	28.6	29.1	28.2	28.7	29.1	29.4
0.6	0.6	0.9	1.3	1.6	2.2	2.0	1.6	1.3
40	23	20	15		18	20	27	40

7+79.9 End S.W. & Cb. & Paving on Lt

29.6	29.45	29.40	29.22	28.59	28.66	28.0	28.6	28.8	28.7
1.1	1.25	1.30	1.4	1.21	1.20	2.2	2.1	1.9	2.0
40	36	31	20	20		19	21	28	40

SW SW Cb Gut



10+00

9+97.5 2 3' Conc. Walk 40' Rt.

9+77.4 2 2' Conc. Walk 39.8 Rt.

9+50

9+38 2 3' Conc. Walk 39.7 Rt.

9+00

36.95

31.9	31.8	31.6	31.4	31.4	31.1	31.4	31.2	31.3
40	42	43	55	52	58	55	57	58
45	40	27	18		14	19	40	50

31.47	31.47
548	548
40	50

31.28	31.12
567	553
39.8	50

31.2	31.5	31.3	30.5	30.9	30.3	31.1	31.3	31.0
47	44	45	64	60	65	58	56	57
50	40	24	13		16	24	40	50

31.02	30.85
593	610
39.7	50

31.1	31.2	31.1	30.1	30.3	29.7	30.2	31.5	30.5	30.4
58	57	58	68	65	72	67	64	64	65
50	40	23	14		15	19	30	40	50

36.95



11+00

34.0	33.8	33.7	32.5	32.8	32.6	32.5	32.5
29	35	32	44	44	43	44	44
50	40	24	15		18	40	50

10+79.49 W. Line Everts St.

33.6	33.3	33.1	32.2	32.3	32.2	32.3	32.1	31.9
37	35	38	47	46	47	46	48	50
50	40	25	15		14	31	40	50

10+50 R 3.5' Conc Walk 40.3 Rt.

33.3	33.1	32.6	31.9	31.0	31.6	31.9	31.7	31.81
35	38	42	50	47	52	50	52	54
50	40	22	15		15	18	20	50
							Walk	Walk

10+23.5 L 2' Conc Split Drive 40.4 Rt.

31.46	31.34
54	56
40	50

10+19 L 2' Conc Split Drive 40.4 Rt.

31.51	31.33
54	55
40	50

10+07 R 2.5' Conc Walk 40' Lt.

33.07	32.92
38	40
50	40

36.95

36.95



11+64.5 E Bell Tel. MH 292 Rt.

11+63 Fire Plug 23' Rt.

11+59.49 E. Line Everts St.

11+37

11+36

11+19.49 E Everts St.

11+10

36.95

34.08  
287  
292  
Rim

34.9	34.8	34.9	33.7	33.9	33.5	33.9	33.7	33.7
20	21	20	22	20	22	20	22	22
50	40	22	17		16	18	40	50

34.5	34.4	34.8	33.4	33.5	33.1	33.6	33.4	33.4
22	25	21	25	24	28	22	25	25
50	40	22	16		15	22	40	50

33.9	33.8	33.3	33.5	33.1	32.7	32.7
30	32	35	32	28	22	22
50	40	18		15	40	50

33.6	33.3	33.1	32.7	32.6
32	35	38	42	42
50	40		40	50

32.9	32.7	31.5	31.9	32.5	32.6	32.6
20	42	44	42	44	42	42
50	40	22		27	40	50

36.95  
11



12+72 @ 2.5' Conc. Split Drive 40.2 Rt.

36.24  
94.6  
40.2

36.24  
94.8  
50

12+67.5 @ 2.5' Conc. Split Drive 40.2 Rt.

36.30  
94.0  
40.2

36.15  
94.5  
50

T.P. 973 45.70 0.98 3597

12+50

36.9  
0.0  
50

37.1  
10.0  
40

36.7  
0.0  
24

35.5  
1.0  
18

35.8  
1.0  
17

45.70  
1.0  
20

35.7  
1.0  
25

35.9  
1.0  
40

36.1  
0.8  
50

36.0  
0.8  
50

12+37.5 @ 2' Conc. Split Drive 40.5 Rt.

35.73  
1.22  
40.5

35.67  
1.28  
50

12+33 @ 2' Conc. Split Drive 40.5 Rt.

35.69  
1.26  
40.5

35.57  
1.28  
50

12+00

35.9  
1.0  
50

35.7  
1.0  
40

35.8  
1.0  
24

34.4  
2.5  
17

34.9  
2.0  
17

34.7  
2.0  
18

35.1  
1.8  
25

35.3  
1.5  
35

35.0  
1.8  
40

34.8  
2.0  
50

36.95

36.95



14+03 & 4' Conc. Steps to House 36.6 Rt.

14+00

13+50

13+20 & 2.5' Conc. Split Drive 40.1 Rt.

13+15 & 2.5' Conc. Split Drive 40.1 Rt.

13+00

45.70  
T

39.1	39.68	39.68	40.11	40.11
65	602	602	557	557
36.6	36.6	37.9	37.8	40
gr.	step.			

39.2	39.0	39.0	38.0	38.6	38.4	38.7	38.5	38.3
65	67	67	77	71	73	70	72	74
50	40	26	16		16	22	40	50

38.4	38.1	37.9	37.1	37.8	37.6	38.0	37.6	37.6
73	76	78	85	77	81	77	81	81
50	40	21	17		17	19	40	50

37.03	37.08
867	862
40.1	50

37.05	37.05
865	865
40.1	50

37.8	37.5	37.3	36.7	36.8	36.9	37.2	36.9	37.0
79	82	84	95	89	88	85	88	87
50	40	22	17		16	20	40	50

45.70  
T



16+59.11 W. Line Faniel St. Edge Conc. Pav.

16+45

16+00

15+50 R 8' Conc Drive 40211.

15+00

14+50

45.70

41.52	41.41	41.05	40.39	40.48	40.44	40.14	39.75	40.36	40.50	40.55
41.18	40.29	40.65	53.1	52.22	52.26	52.55	52.25	53.24	52.20	51.5
36	31	20	20	10		10	20	20	31	36
SW	SW	CB	G				G	CB	SW	SW

42.6	42.7	42.3	41.1	40.7	40.3	41.0	41.7	41.9	41.8
31	30	24	42.5	50	54	47	40	33	39
50	40	23	16		17	21	22	40	50

42.3	42.2	42.1	40.9	41.1	40.6	41.7	42.0	41.9
34	35	36	42.8	45	51	40	37	38
50	40	26	18		16	26	40	50

41.87	41.60	41.0	40.5	40.7	40.2	40.4	41.3	41.0	40.9
35.2	41.0	47.5	50	50	55	53	44	42	48
50	40.2	29	17		16	17	23	40	50
	Drive								

40.9	40.9	40.6	39.6	40.2	39.8	40.4	40.0	39.8
48	48	51	61	55	59	53	57	59
50	40	23	17		17	28	40	50

39.6	39.7	40.0	38.6	39.4	39.1	39.7	39.4	39.2
61	60	53	71	63	66	60	63	65
50	40	23	17		18	26	40	50

45.70



S.W. Ret. Fanuel & Hornblend BC on Hornblend (4pts)

39.75	40.36	39.85	40.34	39.89	40.41	39.86	40.36	39.74	40.34
525	524	525	525	521	529	524	524	526	525
G	CB	G	CB	G	CB	G	CB	G	CB
BC		①		②		③			BC

N.W. Ret. Fanuel & Hornblend BC on Hornblend (4pts)

41.55	40.91	41.36	40.79	41.26	40.64	41.11	40.65	41.04	40.38
425	429	424	421	424	525	429	525	425	525
CB	G	CB	G	CB	G	CB	G	CB	G
BC		③		②		①			BC

17+39.11 E. Line Fanuel St.

42.24	42.19	42.09	41.41	41.46	41.40	40.97	40.58	41.21	41.07	40.99
325	351	351	429	424	420	423	522	429	423	421
36	31	20	20	10		10	20	20	31	36
S.W.	S.W.	CB	G				G	CB	S.W.	

17+9.11 E. Ch Line Fanuel St.

42.18	41.57	42.04	41.44	41.09	41.16	41.15	40.85	40.61	40.22	40.84	40.04	40.65
352	428	366	426	424	427	455	485	509	548	486	522	505
50	50	40	40	20	10		10	20	40	40	50	50
CB	G	CB	G						G	CB	G	CB

16+99.11 Q. Fanuel St.

41.70	41.34	40.90	40.97	40.94	40.76	40.61	40.34	40.17
420	426	420	427	426	494	509	526	552
50	40	20	10		10	20	40	50

16+79.11 W. CB Line Fanuel St.

41.64	40.98	41.55	40.91	40.58	40.74	40.70	40.46	40.19	39.75	40.34	39.57	40.18
424	422	425	429	522	428	500	524	521	525	526	613	522
50	50	40	40	20	10		10	20	40	40	50	50
CB	G	CB	G						G	CB	G	CB



17+79 & 2' Conc. Walk No. 1 Rt.

17+55 & 2' Conc. Walk on Rt. (See sketch)

17+50 BC 2' Conc. Walk

17+44 & Bell Tel. MH. 29' Rt.

T.P. 7.08 48.11 4.67 41.03

S.E. Ret. Hornblend & Faniel BC on Faniel (4 pts.)

N.E. Ret. Hornblend & Faniel BC on Faniel 4 pts

4570

27

41.77  
C 34  
201

41.61  
C 50  
50

41.82  
C 29  
34

41.80  
C 31  
40

42.29	42.25	42.18	41.4	41.6	40.8	41.5	41.79	41.73	41.8	41.9
582	586	573	C7	C5	73	C5	C32	C38	C3	C10
36	21	20	20		17	22	22.7	34.7	40	50
SW	SW	CB	G				SW	SW		

41.15

C 96

29

Rim

48.11

S.E. 7' L& Disc. Faniel & Hornblend

41.41	40.58	41.09	40.56	41.04	40.50	40.97	40.38	40.83	40.43
445	512	421	515	448	520	473	532	470	527
CB	G	CB	G	CB	G	CB	G	CB	G
EC		③		③		①		BC	

41.44	42.06	41.34	41.94	41.31	41.88	41.36	41.96	41.44	42.11
426	364	426	376	432	382	424	374	428	359
G	CB	G	CB	G	CB	G	CB	G	CB
BC		①		②		③		EC	

4570



18+90 R 48" Euc. Tree (32' Lt. to R Tree) out

18+81 R 2' Conc. Split Drive 40 S Rt.

18+77.5 R 2' Conc. Split Drive 40 S Rt.

18+66 60" Euc. Tree (32' Lt. to R Tree) out

18+63.6 End Ch on Lt

18+66

18+62 End SW on Lt

18+50

18+00

48.11

42.22	42.30
589	581
405	50

42.22	42.30
589	581
405	50

42.89	42.4
522	52
20	20
Ch.	

43.03	43.07
508	504
36	31
SW	SW

42.87	42.86	42.81	42.4	42.6	41.7	42.3	42.3
524	526	520	52	52	59	58	58
36	31	20	20	20	20	40	50
SW	SW	Ch.					

42.60	42.57	42.50	41.7	42.4	41.9	42.3	42.0	41.6
527	524	521	64	52	62	58	61	57
36	31	20	20	16	32	40	50	
SW	Ch							

48.11



19+89 End Brick & Conc Wall 28.3 Lt.

44.21	43.91	43.5
390	420	410
40	28.3	28.3
	Wall	Gr

19+73 E 3' Conc Wall 28.3 Lt.

44.34	43.89	43.76
377	422	435
50	30	28.3

19+59.5 E 2' Conc Wall 28.1 Lt.

42.54	41.53
55	55
28.1	50

19+50

44.5	44.1	44.04	43.6	42.9	42.8	42.2	42.4	41.3
36	40	40.9	45	52	52	57	52	58
50	40	28.3	28.3	17	17	22	40	50
		Wall	Gr					

19+38 Beg Conc. & Brick Ret Wall 28.2 Lt.

44.41	44.04	43.3
370	409	48
399	282	282
Wall	Wall	Gr

19+00

43.8	44.1	43.5	42.6	42.7	42.2	42.2	41.6	41.5
42	40	45	52	52	59	59	63	65
50	40	29	17	17	15	31	40	50



20+77 @ 15' Conc Drive 40.4 Lt.

$$\begin{array}{r} 44.78 \\ 332 \\ \hline 50 \end{array} \quad \begin{array}{r} 44.63 \\ 348 \\ \hline 40.4 \end{array}$$

20+63 @ 9.5' Conc Walk 40.5 Lt.

$$\begin{array}{r} 44.74 \\ 339 \\ \hline 50 \end{array} \quad \begin{array}{r} 44.44 \\ 367 \\ \hline 40.5 \end{array}$$

20+50

$$\begin{array}{r} 44.5 \\ 36 \\ \hline 50 \end{array} \quad \begin{array}{r} 44.3 \\ 38 \\ \hline 40.24 \end{array} \quad \begin{array}{r} 44.1 \\ 40 \\ \hline 24 \end{array} \quad \begin{array}{r} 43.3 \\ 48 \\ \hline 16 \end{array} \quad \begin{array}{r} 43.5 \\ 45 \\ \hline 15 \end{array} \quad \begin{array}{r} 43.1 \\ 50 \\ \hline 16 \end{array} \quad \begin{array}{r} 43.3 \\ 48 \\ \hline 31 \end{array} \quad \begin{array}{r} 43.4 \\ 47 \\ \hline 40 \end{array} \quad \begin{array}{r} 42.8 \\ 53 \\ \hline 50 \end{array} \quad \begin{array}{r} 42.1 \\ 52 \\ \hline 50 \end{array}$$

20+305 @ 8' Conc Drive 41 Lt.

$$\begin{array}{r} 44.36 \\ 375 \\ \hline 50 \end{array} \quad \begin{array}{r} 44.32 \\ 379 \\ \hline 41 \end{array}$$

20+07 @ 3.5' Conc Walk 33.2 Lt.

$$\begin{array}{r} 44.29 \\ 382 \\ \hline 41 \end{array} \quad \begin{array}{r} 44.06 \\ 405 \\ \hline 33.2 \end{array}$$

20+00

$$\begin{array}{r} 44.4 \\ 37 \\ \hline 50 \end{array} \quad \begin{array}{r} 44.2 \\ 39 \\ \hline 40 \end{array} \quad \begin{array}{r} 43.7 \\ 42 \\ \hline 26 \end{array} \quad \begin{array}{r} 43.0 \\ 51 \\ \hline 17 \end{array} \quad \begin{array}{r} 43.0 \\ 51 \\ \hline 15 \end{array} \quad \begin{array}{r} 42.6 \\ 55 \\ \hline 20 \end{array} \quad \begin{array}{r} 42.8 \\ 53 \\ \hline 32 \end{array} \quad \begin{array}{r} 42.8 \\ 53 \\ \hline 40 \end{array} \quad \begin{array}{r} 42.2 \\ 59 \\ \hline 50 \end{array} \quad \begin{array}{r} 42.2 \\ 59 \\ \hline 50 \end{array}$$

48.11

48.11



22 + 3904 W. Line Gresham St.

TP. 9.20 56.29 1.02 47.09

22+00

21+50

21+39 Beg Lath fence 32.7 Rt.  
End Pickett fence 36' Lt Beg wire fence 19.11

21+36 30" Pepper 27' Rt. (& Tree) ✓

21+32 3" Pine Tree 35.2 Rt. ✓

21+00

20+95 18" Pepper 26.5 Lt. ✓

20+91 12" Cypress 34' Lt. out

20+89 Beg Pickett fence 35.8 Lt.

48.11

47.4	47.4	47.3	46.9	45.9	46.0	46.0	46.5	46.3	46.1
8 <sup>9</sup>	8 <sup>9</sup>	9 <sup>0</sup>	9 <sup>4</sup>	10 <sup>4</sup>	10 <sup>3</sup>	10 <sup>3</sup>	9 <sup>8</sup>	10 <sup>0</sup>	10 <sup>3</sup>
50	40	25	15	13		20	32	40	50

SE 7' Men Hornblend  
& Gresham 56.29

46.1	46.0	45.8	45.3	45.0	45.4	45.6	45.1	45.6	45.5	45.4
2 <sup>0</sup>	2 <sup>1</sup>	2 <sup>2</sup>	2 <sup>8</sup>	3 <sup>1</sup>	2 <sup>7</sup>	2 <sup>5</sup>	3 <sup>0</sup>	2 <sup>5</sup>	2 <sup>6</sup>	2 <sup>9</sup>
50	40	18	15	14	9		20	28	40	50

45.2	45.0	45.1	44.4	44.6	44.3	44.0	44.0
2 <sup>9</sup>	3 <sup>1</sup>	3 <sup>0</sup>	3 <sup>2</sup>	3 <sup>5</sup>	3 <sup>8</sup>	4 <sup>1</sup>	4 <sup>1</sup>
50	40	21	14		15	40	50

44.8	44.6	44.4	43.7	43.9	43.6	43.7	43.8	43.8	43.4	43.4	43.2
3 <sup>3</sup>	3 <sup>5</sup>	3 <sup>7</sup>	4 <sup>4</sup>	4 <sup>3</sup>	4 <sup>5</sup>	4 <sup>4</sup>	4 <sup>3</sup>	4 <sup>3</sup>	4 <sup>2</sup>	4 <sup>2</sup>	4 <sup>2</sup>
50	40	23	15		16	18	32	35	36	40	50

48.11



23100

22197

22179.04 £ Gresham St.

22167

22164

22157 End wire fence 17.5 ft.

22155 End Pickett fence 33' Rt.

5629

32

46.7	48.7	48.5	47.9	48.1	47.7	47.4	47.9	47.7	47.6
7.5	7.5	7.8	8.4	8.2	8.5	8.9	8.4	8.6	8.7
50	40	23	16		14	18	23	40	50

48.2	48.1	47.8	48.0	47.7	47.3	46.9	46.7
8.1	8.2	8.4	8.3	8.5	9.0	9.4	9.5
50	40	18		13	17	40	50

48.0	47.9	47.7	47.5	47.3	46.9	46.7
8.3	8.4	8.6	8.8	9.0	9.4	9.6
50	40	20		20	40	50

47.4	47.2	46.6	46.9	47.1	46.9	46.7	46.5
8.9	9.1	9.7	9.4	9.2	9.4	9.6	9.8
50	40	17	12		20	40	50

46.2	46.0	47.3	46.5	47.0	46.7	46.7	46.6
8.1	8.3	9.0	9.8	9.3	9.5	9.6	9.7
50	40	17	12		20	40	50

5629  
71



24+00

23+94 Beg. Cb. & Sidewalk Rt. & Beg. Board fence 286 Rt.

23+68.0 End Board fence 33.2 Rt.

23+51.5 & 2.5' Conc. Walk 34.4 Rt.

23+50

23+45 & 3' Conc. Walk 278 Lt.

23+245 Fire Plug 23.5 Rt.

23+1904 E Line Gresham St.

23+10 Beg. Board fence 34.1 Rt.

56.29  
T

51.0	50.5	50.2	49.7	49.7	49.5	49.6	49.65	49.81	49.90	50.0
5.4	5.8	6.1	6.6	6.6	6.8	6.7	6.54	6.28	6.29	6.3
50	40	21	14	16	15	20.1	20.1	23.8	28.8	40
					G.	Cb.	S.W.	S.W.	S.W.	

49.54	49.66	49.78
6.77	6.63	6.51
20.1	23.75	28.75
Cb.	S.W.	S.W.

48.73	48.43
7.53	7.86
34.4	50

50.3	50.0	49.6	48.9	49.2	48.9	48.6	48.9	48.8	48.6	48.5
6.0	6.3	6.7	7.4	7.1	7.4	7.7	7.4	7.5	7.7	8.0
50	40	27	16	17	11	17	21	34	40	50

50.03	49.73
6.26	6.45
40	27.5

49.7	49.5	49.2	48.2	48.5	47.9	48.2	48.1	48.1	48.0
6.5	6.8	7.1	8.1	7.8	8.4	8.1	8.2	8.2	8.3
50	40	26	13	18	21	34	40	50	

57.29  
T



24+52.5 & 8' Conc Drive 39.8 Rt.

52.1	52.0	51.9	51.9	51.0	50.9	50.7	51.2	50.87	50.74
23	23	24	44	53	54	55	51	542	555
50	40	30	16	12		17	27	398	50
								Drive	

24+44 End. Ck SW & Board Fence Rt.

50.91	51.08	51.05
538	521	524
199	237	28.7
CO.	SW.	SW.

24+32 & 3' Conc. Walk 20' Rt.

50.23	50.46	50.33
606	583	595
20	28.7	40
CO		

24+11 & 8' Conc Drive 40' Lt.

51.43	51.28
486	501
50	40

24+42 8" Pepper tree 22.5 Rt. ✓

24+33 10" Pepper Tree 22.5 Rt. ✓

24+10 8" Pepper 22.5 Rt. ✓

24+01.5 6" Pepper 22.5 Rt. ✓

56.29  
7

56.29  
7



25+52 3' Conc. Walk 40.2 Lt.

T.P. 10.31 66.05 0.55 5574

25+38 3' Conc. Walk 40.5' Lt.

25+12 10" Euc. Tree 25' Lt. ✓

25+00

24+99 6" Euc. Tree 25' Lt. ✓

24+93 3' Conc. Walk 21' Lt. & End. Board Fence Rt. 287

24+87 10" Euc. Tree 25' Lt. ✓

24+76 3.5' Conc. Walk 20.6 Rt.

24+75 10" Euc. Tree 25' Lt. ✓

24.58 Beg. Board Fence 28.6 Rt.

56.29

56.37	56.13	55.5	55.1	54.6	54.7	54.4	55.1	55.0	54.4
96.8	99.2	105	109	114	113	115	109	112	116
50	40.2	23	13	9	11	17	27	22	50
	Walk								

66.05  
 55.84  
 0.55  
 50  
 40.5

54.0	54.0	53.3	52.8	52.4	52.4	52.3	52.8	52.8	52.3	52.0
21.4	21.4	21.0	20.4	20.0	20.0	20.0	20.4	20.4	20.0	20.0
50	40	22	18	11	11	18	21	30	20	50

53.36  
 27.2  
 50  
 53.04  
 21

51.78  
 20.6  
 51.43  
 50

56.29



26+98.5 & 4 Conc. Walk 39.2 Lt.

26+90 8" Acacia Tree 21' Lt.

26+50

26+48 & 4' Conc. Walk 40.2 Lt.

26+00

25+98 & 3' Conc. Walk 40.5 Lt.

25+85 & 3' Conc. Walk 40.6 Lt.

66.05

62.55  
550 328  
50 39.2

60.9 60.6 60.5 60.4 60.1 60.1 58.9 59.5 59.5 59.1 59.0  
55 55 55 55 60 60 71 65 65 69 70  
50 40 25 13 11 19 24 34 40 50

60.79 60.75  
526 520  
50 40.2

58.6 58.2 58.1 57.5 56.9 56.9 56.6 57.2 57.4 57.1 56.9  
74 78 79 85 91 91 94 88 84 89 91  
50 40 21 13 9 20 22 33 40 50

58.54 58.29  
751 776  
50 40.5

57.70 57.46  
835 859  
50 40.6

66.05



27+94.5 & 3' Conc. Walk 401 Rt.

62.94  
3.11  
401  
62.85  
3.20  
50

27+88 & 4' Conc. Walk 388 Lt.

64.65  
1.40  
50  
64.54  
1.51  
388

27+50

63.5	63.4	63.5	63.3	62.1	62.1	62.0	62.4	62.4	62.2	62.2
25	25	25	27	39	39	40	36	36	38	38
30	40	28	17	12		18	22	35	40	50

27+26 & 8' Conc. Drive 406 Rt.

61.73  
1.32  
406  
61.75  
1.30  
50

27+08 & 8' Conc. Drive 422 Rt.

61.41  
1.62  
422  
61.35  
1.70  
50

27+00

62.5	62.2	62.1	60.8	60.8	60.6	61.1	61.1	61.1
35	38	39	52	52	54	49	49	49
50	40	15	12		19	23	40	50

66.05

66.05



28+74

28+5898 & Haines St

28+44

28+38 Power Pole & P 4448 35' Rt.

28+35

28+18.98 N. Line Haines St.

28+13 & Bell Tel M.H. 288 Rt

28+00

6605

63.9	63.0	62.1	63.3	63.5	63.2	63.0	62.8
25	30	33	27	25	28	30	32
40	23	13	7		25	40	50

63.7	63.9	63.5	62.7
23	21	25	32
40	20		40

63.8	63.4	63.2	63.5	63.1	61.5	62.4
22	26	28	25	29	35	35
40	27	15		17	30	40

64.7	64.2	64.8	63.3	63.5	62.7	63.0	63.1
13	18	22	27	25	33	30	28
40	30	18	13		21	26	40

64.7	64.5	64.5	63.1	63.3	62.9	63.2	63.2	63.0	62.9
13	15	15	22	27	25	28	28	30	31
50	40	15	12		19	23	35	40	50

64.8	64.2	64.4	62.9	63.0	62.7	63.0	62.8	62.7
13	18	15	31	30	33	30	32	33
40	35	15	12		21	25	40	50

63.0  
303  
28.8  
Lim M.H.

66.05  
↑



29+40 R 8' Conc Drive 40.1 Rt.

29+34 R 4' Conc Walk 40.3 Lt.

29+17 R 3.8 Conc Walk 40.2 Rt.

TP 3.60 66.47 3.18 62.87

29+00 Power Pole # 1503 25.8 Rt.

28+98.98 E Line Haines St.

28+96 R 18" Palm Tree 25' Lt. ✓

28+85 R 36" Pepper Tree 25' Lt. ✓

28+77

66.05

62.69  
3.78  
40.1  
62.44  
40.3  
50

64.07  
3.40  
50  
63.77  
2.70  
40.3

63.79  
2.65  
40.2  
63.51  
2.56  
50

66.47

Ext. 7' Conc Man Haines & Hornblend St.

64.4  
1.6  
50  
64.2  
1.8  
40  
63.5  
2.5  
17  
63.9  
3.1  
12  
61.9  
3.1  
25  
63.0  
2.0  
18  
63.5  
2.5  
27  
63.4  
2.6  
22  
63.0  
3.0  
40

64.6  
1.4  
40  
63.8  
2.2  
23  
62.6  
3.2  
13  
63.1  
2.9  
6  
63.5  
2.5  
6  
63.4  
2.6  
25  
63.4  
2.6  
33  
63.1  
2.9  
40

66.05



30+50

30+41.5 Rec. Bldg. 56.9 Rt.

30+14.5 8' Conc. Drive 39.8 Lt.

30+00

29+91 8' Conc. Walk 40.1 Rt.

29+66.5 8' Conc. Walk 40' Rt.

29+50

66.47

40

62.8	62.6	61.7	61.4	61.4	61.1	61.0	60.7	61.5
37	39	48	51	51	54	55	58	60
50	40	14	12		20	29	40	48

63.17	62.76
530	371
50	398

568	565	425	417	374
47.9	50	519	569	569
SW	SW	Porch	Porch	Floor

63.0	62.8	62.2	61.9	61.9	61.6	61.9	61.6	61.3
34	37	43	46	46	49	46	49	52
50	38	15	12		18	34	40	50

61.92	61.58
455	489
40.1	50

62.31	62.36
416	411
40	50

63.8	63.6	63.0	62.9	62.7	62.5	62.1	61.4	62.5	62.3
27	29	35	36	38	40	43	41	40	44
50	40	38	15	11		12	21	35	40

66.47



3450

31+47 Power Pole #1545 26.4 Rt.

31+14 R 8' Conc Drive 399 Lt.

31+00

30+97.7 End 3' Conc Walk 41.9 Rt.

30+93 R 2' Conc Walk 398 Lt.

30+79 R Church Bldg 56.9 Rt.  
R 4' Conc Walk 339 Rt.

30+63 R 8' Conc Drive 398 Lt.

Get Notes  
on Church

66.47

D

61.9	61.4	61.2	61.0	61.0	60.8	61.0	61.4	61.1	62.6
X 51	53	55	55	55	57	55	51	44	39
50	37	14	12		19	20	35	40	50

62.64	62.22
X 83	425
50	399

62.6	62.2	61.7	61.4	61.3	61.1	60.9	60.7	61.1	60.9
X 19	42	48	51	52	54	55	58	54	55
50	40	28	14	12		20	27	40	50

62.62	62.21
X 85	426
50	398

509	529
489	519
3W	5W

60.65	60.69	61.22	61.27
X 82	528	525	520
339	519	519	569
3W	5W	Porch	Floor

62.79	62.39
X 68	408
50	398

66.47

D



33+50

T.P. 6.58 66.74 6.31 60.16

33+00

32+68 30" Pepper tree 26' Lt.

32+50

32+47 &amp; 24" Peppertree 26' Lt. ✓

32+40 &amp; 13' Asp Drive 40' Rt.

32+025 &amp; 25' Conc. Walk 40' Lt.

32+00

66.47

61.0	60.9	60.8	61.1	61.7	61.6	61.1	61.4	61.3	63.6	63.5
52	54	53	56	50	51	55	50	54	51	50
50	40	30	14	12	19	21	34	36	50	

→ (66.74) ←

&amp; L&amp;T Ingraham &amp; Hornblend

61.1	61.1	61.1	61.2	61.4	61.4	62.4	62.8	63.2	63.7	63.9
54	54	54	52	51	51	41	39	33	28	26
50	40	25	11	19	25	34	35	40	50	

61.7	61.4	61.4	61.1	61.1	61.3	61.6	62.4	63.0
48	51	51	54	54	52	49	41	34
50	40	13	10	20	30	40	50	

62.04	62.87
40	50

62.22	62.22
42	42
50	40

62.1	61.4	61.3	61.2	61.0	60.9	61.2	62.2	62.1
44	51	52	53	55	55	53	43	36
50	27	14	12	18	36	40	50	

66.47



34+59.12 E Edge Paving Ingraham St.

34+39.12 E Paving Ingraham

34+19.12 W. Edge Paving Ingraham

34+11

33+99.12 W. Line Ingraham St.

33+92 Power Pole # 1595 26' Rt.

33+85 Bell Tel. MH. 29' Rt.

66.74

60.47 60.41 60.25 60.12 59.99 59.88 59.74  
 62 62 64 62 62 68 70  
 50 40 20 20 40 50

60.39 60.34 60.23 60.08 59.93 59.81 59.68  
 62 64 65 65 68 68 70  
 50 40 20 20 40 50

59.97 59.95 59.86 59.43 59.28 59.08 58.96  
 62 62 71 71 74 76 78  
 50 40 20 20 40 50

60.5 60.4 60.2 59.6 59.7 59.3 60.1 60.5 60.2 59.9  
 62 63 65 71 70 74 65 68 65 65  
 50 40 22 15 20 19 23 34 40 50

60.7 60.6 60.4 60.1 60.2 60.2 60.8 60.3 60.8 60.0  
 60 61 63 65 65 65 59 65 59 67  
 50 40 14 10 18 21 29 40 50

60.58  
 61  
 29  
 MH Lim.

66.74



36+45 18" Pepper tree 248 Rt. out

36+34 E 3' Conc Walk 40' Rt.

36+15 18" Pepper tree 26' Lt. out

36+08 E 2' Conc Walk 40' Rt.

36+05 Power Pole # 631 25 Rt.

T.P. 594 69.09 3.60 63.14

36+00

35+90 6" Olive Tree 25' Lt. out

35+49 End of Asp. Pav. on Rt.

34+99.12 E Line Ingraham

66.74

670 672 643 644 644 635 639 628 624 635 638 639  
 10 10 24 23 23 32 38 37 40 40 29 28  
 50 42 39 28 22 17 10 18 32 40 50

65.9 63.0 62.4 61.2 61.4 61.1 61.7 60.9 60.8  
 08 37 43 55 53 55 50 52  
 41 36 21 15 18 33 40 50

65.6 65.7 62.0 60.8 59.9 59.7 59.93 60.26 60.11 59.97  
 1 10 47 52 68 70 68 648 663 677  
 50 46 37 26 20 18 25 40 50

66.74



37+35 12" Pepper tree 26' Lt ✓

37+32 9" Pepper tree 25' Lt out

37+04 18" Pepper tree 25' Rt ✓

37+00

36+92 & 2' Conc Walk 40.3 Rt.

36+90 18" Pepper tree 25' Lt out

36+75 24" Pepper 25' Rt ✓

36+64 & 3' Conc Walk 40.2 Rt

36+54 18" Pepper 24.5 Lt out

36+50 Dead Man to Pole 2x' Rt.

6908

68.9	68.9	65.9	65.4	65.8	65.0	64.9	64.1	64.9	64.6	64.0
02	03	33	27	32	11	10	10	10	11	11
50	44	33	19	15	12			18	26	40
										50

64.38	64.27
12.4	12.1
40.3	50

11.11

64.11	63.94
12.97	51.4
40.2	50

68.3	68.1	65.4	65.8	65.7	65.0	64.8	64.4	64.0	63.5	63.7	64.1	63.9	63.7
08	12	37	33	34	41	43	47	51	58	57	50	52	54
50	42	35	28	21	19	18	13		15	20	25	40	50

6908



38+97.3 Beg. Cb. & SW on Rt.

38+50

38+45 24" pepper tree 27' Lt. out

38+00

37+75 20" pepper tree 25' Lt. out  
37  $\frac{32}{43}$

37+69 8" Pepper Tree 25' Rt. ✓

37+55 R & Cong. Drive 40.4 Rt.

37+50

69.08

46

61.33  
77.5  
198

61.52  
75.6  
30.8

61.67  
74.5  
35.8

64.9  
42  
50

64.6  
43  
40

63.5  
55  
12

67.9  
62  
10

67.2  
69

61.5  
76  
18

67.7  
69  
22

67.8  
63  
28

67.5  
66  
40

62.3  
68  
50

66.5  
26  
50

64.9  
42  
35

64.6  
45  
22

63.8  
55  
10

63.3  
51  
18

63.3  
68  
18

63.3  
58  
26

63.7  
54  
22

63.6  
55  
40

63.6  
53  
50

64.01  
507  
40.4

63.88  
520  
50

68.2  
09  
50

68.1  
09  
45

65.4  
37  
34

64.9  
42  
16

64.3  
48  
11

64.3  
48  
18

63.1  
60  
18

64.3  
48  
30

64.0  
51  
40

64.0  
51  
50

69.08  
80  
79



40+25

40+18.45 W Cb line Jewell

39+98.45 W line Jewell St.

39+52 24" Palm tree 24.5 ft. out

39+50

39+15 24" Palm Tree 25.5 ft. out

38 45  
76

T.P. 520 65.41 8.87 60.21

39+00 24" Cypress 26' Rt. ✓

6908

61.6	61.4	60.9	60.5	60.6	60.2	59.6	59.1
38	42	45	42	48	52	58	62
50	40	30	18		14	30	50

63.2	62.7	62.0	60.5	60.3	60.4	60.0	59.4	59.3	59.0	59.0	60.00	59.6	59.7
22	27	34	45	51	50	54	60	61	55	62	54	62	57
50	40	25	15	11		14	22	30	30	40	40	50	50
								G	CB	G	CB	G	CB
									BC				

62.80	62.60	62.2	61.2	61.4	60.9	60.4	59.6	59.70	60.0	60.78	60.35
26	28	32	32	40	45	50	58	52	540	52	506
50	40	34	25	15	11		18	199	199	31	36
								G	CB	SW	SW

63.7	63.1	62.7	62.2	61.7	61.0	60.4	60.1	60.66	60.91	60.99
12	23	27	32	37	44	50	53	475	450	422
50	40	28	14	11		13	198	198	308	358
							G	CB	SW	SW

65.41  
7

SW 7' L&T Hornblend @ Jewell

64.0	64.0	63.4	63.1	62.2	61.6	61.1	60.8	61.30	61.50	61.57
51	51	57	60	69	75	80	82	778	758	751
50	40	38	14	9		13	198	198	308	358
							G	CB	SW	

6908



T.P. 193 62.14 5.20 60.21

N.E. Ret. Jewell & Hornblend. (BC on Jewell 8pts)

S.E. Ret. Jewell & Hornblend (BC on Jewell 7pts)

S.W. Ret. Jewell & Hornblend (BC on Hornblend 3pts)

40+78.45 E line Jewell

40+58.45 E.Cb line Jewell

40+38.45 E Jewell

65.41

S.W. 7' LBT Hornblend & Jewell

60.8	61.79	60.9	61.75	60.9	61.74	60.6	61.67
48	562	45	362	45	367	48	359
G	Cb	G	Cb	G	Cb	G	Cb
	BC		①		②		EC

60.0	59.3	59.97	59.7	59.87	59.7	59.96	59.6
54	61	549	53	554	52	545	52
Cb	G	Cb	G	Cb	G	Cb	G
	(EC)		②		①		BC

59.6	59.96	59.5	59.97	59.6	59.97	59.3	59.89
58	545	59	544	58	549	61	552
G	Cb	G	Cb	G	Cb	G	Cb
	BC		①		②		EC

62.23	62.13	61.84	60.5	60.1	59.7	59.1	59.93
36	37	357	42	53	52	63	528
	SW	1985	1985		11	1985	1985
		Cb	G			G	Cb

61.6	61.84	61.7	61.79	60.9	60.4	60.4	60.6	60.4	60.1	59.7	59.6	59.96	59.6	59.87	59.4
38	357	43	362	45	50	50	48	50	52	57	53	545	58	552	60
50	40	40	30	30	20	15	7		11	18	30	30	40	40	50
	Cb	G	Cb	G							G	Cb	G	Cb	

62.0	61.8	61.3	61.4	60.7	60.3	59.8	59.5
24	36	41	42	47	51	55	52
50	40	20	12		20	40	50

65.41

Start ↑



43+00

56.31	55.6	54.8	53.8	54.35
<del>55.3</del>	6.5	7.3	8.3	7.29
19.5	19.5		20.3	20.3
CB	G		G	CB

42+63 £ 8' Conc Drive 20.1 Rt

54.70	55.46
<del>7.44</del>	6.58
20.1	20.6

42+50

57.51	56.4	55.9	55.5	54.9	55.56
<del>4.53</del>	5.7	6.3	6.5	7.3	6.55
19.7	19.7		10	20.1	20.1
CB	G		G	CB	CB

42+00

59.11	59.09	58.80	58.0	57.2	56.4	56.97
<del>3.6</del>	<del>3.1</del>	3.24	4.1	4.9	5.2	5.22
19.7	19.7				20	20
CB	G				G	CB

SW

41+50

60.34	60.39	60.06	59.3	58.3	57.9	57.3	58.19
<del>2.98</del>		2.98	2.8	3.8	4.2	4.8	3.25
19.75	19.75			10	20	20	
CB	G			G	G	CB	

SW

41+00

61.63	61.59	61.26	60.3	59.7	58.7	59.44
<del>0.88</del>		0.88	1.8	2.4	3.4	2.20
19.8	19.8			19.9	19.9	
CB	G			G	CB	

SW

62.14

62.14



44+58 £ Double Drive (21' opening) 20.3 Rt.

44+50

44+00

T.P 4.68  $\frac{58.77}{\lambda}$  8.05 54.09

43+61 £ 8' Conc Drive 20.2 Rt.

43+50

43+12 £ 8' Conc Drive 20.2 Rt.

$\frac{62.14}{\lambda}$

50.

53.60  
57 53.51  
20.2 308

55.61 55.59 55.34 54.6 53.9 57.80 53.53  
242 43 49 57 524  
196 196 20.3 307  
Cb G Drive SW

55.54 54.5 54.0 53.1 53.57  
222 23 28 57 530  
196 196 20.4 20.4  
Cb G G Cb

$\frac{58.77}{\lambda}$

53.14 53.86  
520 828  
20.2 306

55.69 54.6 54.3 53.2 53.75  
645 73 75 88 837  
196 196 20.2 20.2  
Cb G G Cb

53.57 54.34  
557 780  
20.2 20.6  
SW

$\frac{62.14}{\lambda}$



4519836 West Ch Line Kendall St.

4517836 West Line Kendall St.

45150

45124 R 10' Conc Drive 20.4 Ct.

45119 R 7' Conc Drive 19.6 Lt.

45100

58.77

√ 5

35.17	54.5	54.87	54.7	54.81	53.9	53.5	53.4	52.8	52.5	52.87	52.1	52.84	52.7	52.83
360	42	385	45	37	48	52	52	60	62	58	62	58	65	57
50	50	40	40	30	30	20		20	30	30	40	40	50	50
Ch.	G	Ch.	G	Ch.	G			G	Ch.	G	G	G	G	Ch.

55.12	55.02	54.81	53.9	53.1	52.3	52.84
36	31	37	48	52	65	58
		199	199		20	20
SW		Ch.	G		G	Ch.

55.19	55.07	54.89	54.1	53.4	52.5	52.97
36	31	38	42	52	62	58
		195	195		202	202
SW		Ch.	G		G	Ch.

52.63	53.30
64	547
20.4	20.9
	SW

55.29	54.37	54.17
348	445	460
30.4	196	196
SW	Conc. Drt.	

55.40	55.46	55.17	54.3	53.8	52.6	53.27
36	31	360	45	50	60	55
		195	195		20.5	20.5
SW		Ch.	G		G.	Ch.

58.77



NE Ret Kendall & Hornblend BC on Kendall (3pts)

SW Ret Kendall & Hornblend BC on Hornblend (3pts)

NW Ret Kendall & Hornblend BC on Hornblend (3pts)

46+58.36 East Line Kendall

46+38.36 East Ch. Line Kendall St.

46+18.36 Kendall

58.77

54.0	54.80	54.2	54.75	53.9	54.78	53.7	54.82
4.8	3.97	4.5	4.02	4.9	3.97	5.1	3.97
G	CB	G	CB	G	CB	G	CB
	BC						EC

52.4	52.84	52.4	52.86	52.4	52.84	52.5	52.84
6.4	5.93	6.2	5.91	6.4	5.93	6.3	5.93
G	CB	G	CB	G	CB	G	CB
	BC						EC

54.81	53.9	54.81	53.9	54.79	54.0	54.84	53.8
3.96	4.9	3.96	4.9	3.98	4.8	3.96	5.0
CB	G	CB	G	CB	G	CB	G
	EC						BC

55.21	54.84	53.8	53.4	52.4	52.83
3.6	3.92	5.0	5.4	6.4	5.94
	CB	G	G	G	CB

55.20	54.6	54.84	54.8	54.80	54.1	53.6	53.1	52.6	52.6	52.85	52.5	52.85	52.4	52.81
3.97	4.2	3.97	4.4	3.97	4.7	5.2	5.7	6.2	6.2	5.92	6.2	5.92	6.4	5.96
50	50	40	40	30	30	20		20	30	30	40	40	50	50
CB	G	G	G	CB	G			G	CB	G	CB	G	G	CB

55.0	54.8	54.2	53.6	53.3	53.1	52.9
3.8	4.0	4.5	5.2	5.5	5.7	5.7
50	40	20		20	40	50

58.77



48+04 &amp; 6' Conc Drive 20' Rt.

48+00

47+54 &amp; 7' Conc Drive 20' Rt.

47+50

47+00

SE Ret. Kendall &amp; Hornblend EC on Kendall (3pts)

58.77

$$\begin{array}{r} 18 \\ 4 \\ \hline 16 \end{array}$$

53.71

$$\begin{array}{r} 506 \\ 20 \end{array}$$

55.58	55.54	55.32	54.6	54.5	53.6	54.33
36	31	34.5	42	43	50	44.4
		20	20		199	199
		cb.	G		G	cb.

SW

SW

53.24	54.07
553	470
200	20

55.47	55.48	55.14	54.5	54.3	53.3	53.81
36	31	36.5	43	45	55	48
		199	199		200	200
		cb.	G		G	cb.

SW

SW

55.43	55.30	55.00	54.3	53.9	53.9	53.32
36	31	37	45	49	59	54.5
		199	199		201	201
		cb.	G		G	cb.

SW

SW

52.44	52.6	52.84	52.6	52.85	52.5	52.85	52.6
592	63	592	63	592	63	592	63
cb.	G	cb.	G	cb.	G	cb.	G
EC		②		①		BC	

58.77



49+93

49+50

49+00

48+64 R Conc Drive 199' Rt.

T.P. 8.35 63.06 4.06 54.71

48+53 R Conc Drive 199' Rt.

48+50

58.77.

55.84	55.7	56.0	55.3	55.88
722	74	71	78	718
20	20		199	199
CB				CB

SW

Sul

55.78	55.3	55.6	55.0	55.48
728	78	75	81	758
20	20		199	199
CB				

55.60	55.1	55.0	54.5	55.06
726	80	81	86	800
199	199		199	199
CB			G	CB

54.09	54.89
897	817
199	302

63.06  
7

54.17
465
199

55.46	54.9	54.7	54.09
721	79	41	469
20	20		199
CB	G		DRIVE

58.77



51+70 (Beg Asp Paving) (Jagged edge)

51+58.40 West Line Lamont

51+33 to 51+41 Cb out on Lt.

51+00

50+70

50+49 & Cong Drive 199 Rt

50+33

6306

59.84	59.81	59.59	59.88
322	325	347	318
203		203	203
cb			cb
59.83	59.3	59.6	59.7
322	328	335	339
199	199	20	20
			cb

SW

SW

58.44	57.6	58.7	57.5	58.45
422	55	42	55	461
199	199	20	20	
cb			cb	

SW

SW

57.64	56.9	57.5	56.8	57.67
542	63	56	63	539
199	199	20	20	
			cb	

SW

SW

56.66	57.03
640	603
199	234

56.64	56.7	56.8	56.7	56.72
622	69	63	69	624
20	20	199	199	
cb			cb	

SW

SW

6306



11E Ret. Hornblend & Lamont 13.C on Lamont 3pts

5.VV Ret. Hornblend & Lamont BC on Hornblend 3pts

11.VV Ret. Hornblend & Lamont 13C on Hornblend 3pts

BM 3.41 63.29 3.18 59.88 60.03

52+18.40 East Cb line Lamont

51+98.40 E Lamont

51+78.40 West Cb line Lamont

6306

59.75	59.87	59.83	59.86	59.8	59.87	59.8	59.81
346	343	346	343	345	347	345	348
G	Cb	G	Cb	G	Cb	G	Cb
BC		①		②		EC	

59.4	59.89	59.69	59.88	59.28	59.87	59.17	59.86
347	340	360	344	421	342	412	342
G	Cb	G	Cb	G	Cb	G	Cb
BC		①		②		EC	

59.85	59.47	59.81	59.44	59.83	59.83	59.85	59.6
344	387	348	385	346	346	344	37
Cb	G	Cb	G	Cb	G	Cb	G
EC			②	63.29	①	B.C	

SW 13P Lamont & Hornblend

60.09	59.60	59.88	59.59	59.87	59.77	59.61	59.60	59.45	59.70	59.90	58.91	59.86	58.75	59.45
277	344	318	342	319	329	345	346	361	386	316	412	320	421	351
53	53	40	40	30	30	20		20	30	30	40	40	50	50
Cb	G	Cb	G	Cb	G			G	Cb	G	G	Cb		

60.06	59.90	59.79	59.81	59.81	59.67	59.35
300	316	327	325	325	344	321
50	40	20		20	40	50

60.00	59.44	59.87	59.47	59.64	59.47	59.48	59.46	59.30	59.16	59.86	59.07	58.88	58.81	59.56
306	362	324	324	322	364	358	360	376	370	320	404	318	422	350
50	50	40	40	30	30	20		20	30	30	40	40	50	50
Cb	G	Cb	G	Cb	G			G	Cb	G	G	Cb	G	Cb

6306



54+00

53+49 & 7' Conc Drive 199 Rt.

53+00

52+78 & 8' Conc Drive 198 Rt.

52+38.40 E Line Lamont

80  
18

SE Ref. Hornblend & Lamont. BC on Lamont 3pts

63.29

57

58.13	58.08	57.86	57.7	56.6	55.6	55.4	56.33
36.	31	542	61	61	77	79	696
		199	199		15	199	199
		cb					cb

SW

58.54	57.6	57.4	57.7	57.5	56.6	56.87	57.64
477	57	59	55	58	67	642	555
20	20	18	14		16	198	306
cb.						Drive	

59.66	58.4	58.5	58.7	58.7	58.7	57.7	56.57
471	49	48	46	46	51	55	472
199	199	14			10	15	199
cb							cb

58.31	59.71
498	408
198	307

59.63	59.3	59.6	59.3	59.84
246	40	35	40	245
20	20		199	199
cb.				cb.

59.84	59.5	59.81	59.7	59.84	59.40	59.89	59.15
245	38	248	35	245	389	240	414
cb.	G	cb.	G	cb.	G	cb.	G
EC.		⊙		⊙		BC	

63.29



55+34 & 7' Conc. Drive 20' Rt.

55+00

54+85 & Conc Drive Lt

54+77 to 54+82 Cb out on Rt.

54+66 to 54+71 Cb out on Rt.

54+55

54+49 & 7' Conc Drive 19.9 Rt.

54+34 & 5' Conc Drive 19.9 Rt.

63.29

57.13  
36

57.09  
37

56.81  
648  
199  
Cb

56.2  
71  
199

55.6  
72

54.7  
91  
20

54.59  
870  
20  
Cb

S.W.

57.08  
621  
209

56.30  
699  
199

54.7  
71  
199

61

57.35  
36

57.31  
37

57.11  
618  
199  
Cb

56.5  
68  
199

55.9  
71

54.6  
87  
199

55.01  
828  
199  
Cb

S.W.

54.53  
876  
199

55.30  
799  
30.6

54.90  
839  
199

55.54  
777  
30.7

63.29  
71

53.74  
955  
20



57+58.25 W. Cb Line Morrell

Anchor Pole 365 Rt.  
57+38.25 W. Line Morrell St. End Cb & SW on Rt

57+00

56+50

T.P. 345 59.09 765 5564

56+00

55+50

63.29

55.9	55.87	55.6	55.95	54.9	53.8	53.3	52.1	52.2	52.8	52.8	52.2
32	322	35	314	42	53	58	70	69	63	63	69
50	40	40	30	30	20		17	20	21	40	50
	cb		cb								

56.16	56.14	56.00	55.0	53.6	52.4	52.95	53.13	53.24
36	31	309	41	55	67	64	576	587
	SW	199	199	20	20	20	308	36
		cb			cb	SW	SW	SW

56.33	56.28	56.14	55.2	54.9	54.0	53.1	52.5	53.71
36	31	297	39	42	51	60	65	588
	SW	199	199	11		14	199	199
		cb					cb	cb

56.50	56.38	56.31	55.7	54.4	53.1	53.63
36	31	278	34	47	60	546
	SW	199	199	199	199	199
		cb				cb

56.65	56.52	56.44	55.6	54.7	53.5	53.84
36	31	687	75	86	98	945
	SW	20	20	20	20	20
		cb				cb

56.91	56.86	56.63	56.0	55.1	53.7	54.23
36	31	660	73	82	96	906
	SW	20	30	19.9	19.9	19.9
		cb				cb

63.29



B.M. 7.09 62.16 62.02  
 T.P. 10.47 69.25 0.31 58.78

57478.25 & Merrell

57166

59.09

N. V. B. P. Hoyer & Garnett

55.5	55.2	54.5	53.6	52.7	51.7	51.4
30	29	46	58	64	74	79
50	40	20		20	40	50

55.1	54.4	53.8	52.2	51.1	50.3	50.8
40	47	53	59	70	78	83
50	40	20		20	40	50

59.09



12.20-48 X Section Haines St  
 Hendricks Garnet to Roosevelt  
 Bramby (See FB 1871 for Sketch)  
 Greer  
 Rorer  
 WO# 31568

So East Cb. Ret. Garnet & Haines B.C. on Garnet (3 pts)

INDEXED

FEB 1 1949

So west Cb. Ret. Garnet & Haines B.C. on Garnet (3 pts)

0+00 So. Line Garnet. (Edge Paving)

0-14 So. Cb Line Garnet.

0-40 & Garnet St.

T.P 11.59 72.42 0.59 60.83

B.M 9.00 61.42 52.42

67.33 50.9 G	67.87 46.0 CB	67.77 51.5 G	67.75 46.7 CB	67.17 52.5 G	67.68 47.4 CB	67.14 52.8 G	67.66 47.8 CB
	BC		①		2		EC

67.97 44.5 CB	67.43 47.9 G	67.06 43.6 CB	67.51 47.1 G	67.19 42.3 CB	67.60 48.2 G	67.13 47.9 CB	67.61 48.1 G
	EC		②		①		BC

68.09 33.3 35.9 SW	67.94 44.0 30.6 SW	67.71 47.1 20 CB	67.07 52.5 20 G	67.66 47.8 10	67.97 48.0 10	67.79 46.3 20 G	67.38 50.4 20 CB	68.06 47.6 30.6 SW	68.45 32.7 35.9 SW	68.61 48.1 35.9 SW
-----------------------------	-----------------------------	---------------------------	--------------------------	---------------------	---------------------	--------------------------	---------------------------	-----------------------------	-----------------------------	-----------------------------

67.34 50.8 90 Cb.	66.84 51.5 90 G	67.86 47.5 40 CB	67.34 50.8 40 G	67.87 46.0 30 CB	67.33 50.9 30 G	67.43 47.9 20 G	67.94 47.8 10	68.06 43.6 10	67.97 44.5 10	67.70 47.2 20	67.61 48.1 30 G	67.13 47.9 30 CB	67.66 47.8 40 G	68.18 48.1 40 CB	68.33 48.1 40 CB	68.45 32.7 40 G	68.61 48.1 40 G
----------------------------	--------------------------	---------------------------	--------------------------	---------------------------	--------------------------	--------------------------	---------------------	---------------------	---------------------	---------------------	--------------------------	---------------------------	--------------------------	---------------------------	---------------------------	--------------------------	--------------------------

67.86 45.5 90	68.31 47.1 40	68.61 38.1 20	68.79 36.3 20	68.75 36.7 20	68.58 35.4 40	67.17 51.5 90
---------------------	---------------------	---------------------	---------------------	---------------------	---------------------	---------------------

72.42  
 (SW) LBT Gresham & Garnet)



2+86	48"	pepper	24.5 Lt.	
2+73	30"	Palm	25 Lt.	13
2+655	Anchor Pole	25.3 Lt.	}	37
2+44	Dead Man to Pole	24.6 Lt.		
2+36	24"	pepper	24 Lt.	
2+12	36"	Cypress	24.2 Lt.	24
2+06	24"	Cypress	25 Lt.	6
2+00	14"	Cypress	25 Lt.	6
1+87	36"	Cypress	23.9 Lt.	13
1+81	24"	Cypress	24.4 Lt.	6
1+74	18"	Cypress	24.8 Lt.	7
1+70	24"	Cypress	24.5 Lt.	54
1+14	18"	Cypress	24.5 Lt.	6
0+95	18"	Cypress	24.4 Lt.	19
0+83	18"	Cypress	24.2 Lt.	14
0+65	24"	Cypress	24.5 Lt.	18
0+53	16"	Cypress	24.5 Lt.	14
0+38	24"	Cypress	24 Lt.	18
0+29	36"	Cypress	23.5 Lt.	6
0+16	18"	Cypress	24 Lt.	13
0+10	30"	Cypress	23.5 Lt.	6
0+04	30"	Cypress	23.5 Lt.	6
0-02	14"	Cypress	24 Lt.	

72.42

72.42



2+43 Power Pole # JP 4466 20' Rt.

2+00

1+50 8' Conc Drive 36.4 Lt.

1+45 Power Pole # P-4474 19.8 Rt.

1+35

TP 2.80 69.04 6.18 66.24

1+00

0+99 Power Pole # D11827 21' Rt.

0+80 Dead Man to Pole 21.5 Rt.

0+50

0+20

72.42

65.2	65.5	65.4	64.6	64.7	65.0	66.0	65.6	65.5
50	40	21	15	X	X	10	10	10
						17	21	40
								50

66.12	66.06	66.0	65.4	65.5	65.7	66.8	66.2	66.2
292	298	30	36	31	32	23	21	21
39	36.4	20	14	14	16	20	40	50
FL.	Ramp							

65.3	65.8	66.0	65.6	66.2	66.3	66.2
33	33	30	32	23	27	21
50	40	20	20	40	50	

66.1	66.3	66.5	67.1	66.2	66.1	66.2	67.1	67.0	66.9
63	63	53	53	63	63	53	53	53	53
50	40	25	20	14	16	19	40	50	50

66.9	66.9	67.3	66.7	66.6	66.5	67.4	67.9	67.4	67.2
53	53	53	53	53	53	53	53	53	53
44	40	20	14	18	16	20	30	40	50

67.5	67.5	67.4	67.1	66.9	67.0	67.7	67.5	67.8
43	43	50	53	53	53	43	43	43
50	40	20	16	14	18	20	40	50

72.42



4+46 @ 9.5' Conc. Walk 23' Rt.

4+03.5 @ 13.6 Conc. Dr. 28.2 Rt.

4+00

3+49.42 50 line Hornblend

3+45 Power Pole # P-4448 19.8 Rt.  
(see p. 38 for intersection)

2+69.42 110 line Hornblend

2+50

61.35
7.69
23

61.58
7.46
40

61.88
7.16
28.2

62.07
6.97
31

62.14
6.92
40.2

61.9	61.9	61.9	61.6	61.3	60.9	67.0	62.1
7.1	7.1	7.1	7.4	7.1	8.1	7.0	6.9
50	40	30	20		15	30	40

62.7	62.9	63.1	62.8	62.6	62.4	63.0	62.9	62.8
6.3	6.1	5.9	6.2	6.1	6.6	6.0	6.1	6.3
50	40	20	15		13	20	40	50

63.8	63.7	64.4	63.7	63.7	63.8	64.6	64.5	64.5
5.3	5.3	4.6	5.3	5.3	5.3	4.4	4.5	4.5
50	40	17	15		16	24	40	50

64.5	64.5	64.5	64.1	64.1	64.2	64.4	65.1	65.0	64.9
4.5	4.5	4.5	4.2	4.2	4.8	3.6	3.9	4.0	4.1
50	40	11	15		16	20	23	40	50



6x17 Power Pole # 4403 25' RT.

6x14 Power Pole # 4402 20' RT.

6x00

5x50

T.P. 1.45 64.25 6.24 62.80 (62.87)  
P39

5x00

4x96 Power Pole # P4424 20' RT.

4x84.5 Sewer M.H. 1.2 RT (1/2 Alley)

4x50

6904

56.5	56.7	55.8	55.0	54.8	54.6	55.0	56.7	56.8	56.7
77	80	85	92	94	95	92	75	74	75
50	40	38	20		9	13	18	40	50

57.1	57.1	57.0	56.1	55.6	55.3	55.1	57.7	56.9	56.8
71	71	72	81	85	82	91	70	72	74
45	40	37	32	18		10	18	40	50

57.9	58.0	57.9	57.5	57.1	56.4	56.5	58.0	58.1	
63	63	63	62	71	78	52	62	61	
50	40	18	16	64	25	13	19	40	50

5x7' Man Hornblend & Haines

58.6	58.6	58.7	58.9	58.8	58.6	58.8	59.4	59.6
94	94	98	101	102	104	92	95	94
50	40	20	9		12	18	40	50

59.0	59.4	59.5	59.34	59.10	59.6	59.6	59.9
100	95	95	920	99	94	94	91
50	40	20	E. Rim	9	20	40	50

60.3	60.3	60.7	60.1	59.4	60.9	61.2
87	87	800	82	95	81	78
50	40	10		11	21	40



6+85.7 End. Conc. Slab.

54.7	54.03
1008	1022
21	49

6+81.10 to Grand.

54.4	54.4	54.13	53.4	53.7
98	98	1012	108	112
50	40	slab	40	50

6+78.3 Beg. Conc. Slab Containing (M.H. & Gate Valve)

54.10	54.01
1015	1024
21	49

6+57

54.1	53.9	54.1	54.1	53.5	53.1	53.9
1010	100	100	101	107	111	113
50	40	24		17	40	50

6+52

54.4	54.1	54.4	54.4	53.7	54.8	53.4	55.1	54.7
100	101	100	100	105	98	88	94	95
50	40	20		13	22	33	40	50

6+18.60 No. Line Grand

53.1	55.2	54.9	54.7	54.7	55.9	55.1	54.3	54.3
91	90	93	95	95	83	91	92	92
50	40	19		13	17	23	40	50

6+25

6+25



8+50

57.9	57.9	57.3	56.5	56.4	56.3	56.5	55.3	53.9	53.6	53.6
X	X	X	X	X	X	X	X	X	X	X
50	40	25	16	18	10	16	37	38	40	50

8100

58.0	57.1	57.4	57.0	55.6	55.0	55.0	54.4	54.4	53.1	53.0
X	X	X	X	X	X	X	X	X	X	X
47	40	32	25	17	10	14	31	38	40	50

T.P. 6.14 62.31 808 56.17

62.31

7+72

57.8	57.3	57.0	56.7	54.9	54.5	54.5	54.3	54.6	53.8	53.8	53.6
X	X	X	X	X	X	X	X	X	X	X	X
47	40	30	25	17	9	8	17	30	40	50	50

7+67 to 8+62 4 small pine trees 22.5 Rt.

7+45 Power Pole # P4398 20.6 Rt.

7+4360 So. line Grand

55.1	54.9	55.2	54.9	54.1	53.8	53.7	54.3	53.7	53.4	53.7
X	X	X	X	X	X	X	X	X	X	X
50	40	35	25	17	10	11	15	25	40	50

7+28

55.4	55.3	54.3	54.0	53.7	53.8	53.2	53.4	54.0	54.2	54.1
X	X	X	X	X	X	X	X	X	X	X
50	41	40	33	24	10	11	15	28	40	50

7+20

53.9	53.8	53.8	53.9	53.8
X	X	X	X	X
50	40	24	40	50

6x25

6x25



10+00

10+00

9+88 Power Pole # P4312 218 Rt.

9+83 24" Pine 25' Lt. ✓

9+57 Pine Sapling 269 Lt. ✓

9+50

9+37 12" Acacia Tree 26' Lt. ✓

9+12 Pine Sapling 27.5 Lt. ✓

9+07 Power Pole # 4345 257 Lt.

8+98 to 10+18 Row small trees & shrubs <sup>on 16' centers</sup> 23' Rt. ✓

9+00

8+89 Power Pole # P4350 199 Rt.

8+76 <sup>(5068E)</sup>  
Approx & Alley. (MH in 2.5' x 2.5' conc. slab)  
Rt.

62.31

57.3	57.3	57.1	56.9	55.9	55.9	55.7	56.4	55.4	54.7	54.6
50	50	52	54	64	64	66	59	69	76	77
50	40	30	24	15		9	17	39	40	50

57.9	57.9	56.9	56.5	56.1	56.6	56.2	55.0	54.6
44	44	54	58	62	57	61	72	78
50	40	16		9	13	24	40	50

58.54	57.9	57.1	56.8	56.6	56.6	55.3	55.3
37	44	52	55	57	58	70	70
40	24	13		9	18	38	40
DRIVE							

56.0	57.6	57.8	57.2	56.6	56.45	56.39	56.6	55.0	54.4
43	47	45	51	55	58	59	57	72	78
50	40	25	17		(83	108)	17	40	50
					CONC.	5146			

62.31



10+28 Lemon Tree 25' Rt.

10193.80 So line Thomas

10+65

10153.80 E Thomas

10+36

T.P. 1.47 57.45 6.27 56.04

10+28

10113.80 No. line Thomas 6' pepper tree 2444

62.31

55.0	55.2	55.3	54.6	54.3		54.5	53.6	53.5
24	22	21	28	31	31	29	32	39
50	40	22	11	16	19	40	50	

55.6	55.7	55.4	54.9	54.6	54.6	55.2	54.6	53.9
18	17	20	25	28	26	28	28	35
50	40	23		16	20	25	40	50

55.7	55.7	55.0	54.6	54.1	53.7
17	17	24	28	33	37
50	40		23	40	50

56.1	55.9	55.5	55.3	54.4	53.6	53.7
13	15	19	25	30	36	43
50	40	26		21	40	50

57.45

NE 7' Mon. Haines & Thomas

56.6	56.6	55.7	55.5	55.4	55.0	55.2	54.6	53.9
57	57	64	68	69	73	71	72	84
50	39	26	18		12	25	40	50

57.0	57.1	56.7	55.8	55.7	55.5	55.9	55.2	54.6	54.4
52	52	55	65	68	67	64	71	77	79
50	40	24	15		11	15	39	40	50

62.31



13+02 Bell Tel MH 277 Lt. ✓

13+00

12+87 15" Tree 25' Rt. ✓

12+62 24" pepper Tree 24.5 Rt. ✓

12+50 R Garage

12+37 30" Pepper Tree 24.8 Rt. ✓

12+26 Power Pole # P4276 21.6 Rt.

12+24 2.5' x 2.5' Conc. Slab 3068 EMH. 10.2 Rt.

12+22 24" Tree 24.5 Rt. ✓

12+00

11+83 Power Pole # 4277 25.7 Lt.

11+50

11+48 Lemon Tree 25' Rt. ✓

57.45

50.51  
693  
277  
50.2 50.4 50.6 49.9 50.2 50.7 49.9 49.8  
72 70 68 75 72 62 75 76  
50 40 27 6 18 40 50

52.03 51.74 51.7 50.9 51.1 51.5 51.0 51.3 51.3  
52 52 52 65 63 59 64 61 61  
40 388 21 3 15 30 40 50  
Fl. Camp

51.81 51.85  
55K 550  
10.2 12.7

52.2 52.4 52.4 52.2 51.9 51.8 52.4 52.1 52.0  
52 50 50 50 55 55 50 52 52  
50 40 32 15 12 22 40 50

53.7 53.9 54.2 53.6 53.2 53.1 53.6 53.5 53.0 53.7  
32 55 32 38 42 42 38 32 42 42  
50 40 26 16 15 18 31 40 50

57.5



(Cont'd. FB 1871 P. 59)

9.55 47.90 47.98

Power Poles 511313H 322 Rt.  
 13+63.40 No. Line Reed.

13+52 15" Pepper Tree 25 Rt. ✓

13+50

13+34 24" Pepper Tree 245 Rt. ✓

13+10 30" Pepper Tree 249 Rt. ✓

57.45

NE 7' Mon Haines &amp; Reed.

46.6	46.6	49.3	46.7	48.6	46.8	48.9	49.5	49.3	49.1
8 <sup>8</sup>	8 <sup>8</sup>	8 <sup>1</sup>	8 <sup>2</sup>	8 <sup>6</sup>	8 <sup>6</sup>	8 <sup>5</sup>	7 <sup>9</sup>	8 <sup>1</sup>	8 <sup>3</sup>
50	40	23	10	7		10	16	20	50

49.0	49.7	49.6	49.5	49.1	48.9	49.1	49.7	48.9	49.5	49.1	49.7
8 <sup>8</sup>	8 <sup>2</sup>	7 <sup>8</sup>	7 <sup>2</sup>	8 <sup>3</sup>	8 <sup>5</sup>	8 <sup>3</sup>	8 <sup>2</sup>	8 <sup>5</sup>	7 <sup>9</sup>	8 <sup>3</sup>	8 <sup>2</sup>
50	40	24	15	7	4		5	10	17	40	50

57.45



2-24-49 X Sect. Kendall St.  
Hendrick  
Bramby from No. Line Hornblend to  
Greer 100' North.  
Korer

INDEXED  
W.K.  
AUG 10 1949

0+40

0+30

0+20

0+10

0+00 No. Line Hornblend

BM 5.56 60.40

5484

56.51	56.43	56.29				56.26	56.46	56.55
389	327	411	419	414	419	412	384	385
36	30.7	20	20		20	20	30.7	36
SW	SW	CB	G		G	CB	SW	SW

56.13	56.06	55.96				55.91	56.06	56.19
427	424	424	531	48	520	449	434	421
36	30.7	20	20		20	20	30.7	36
SW	SW	CB	G		G	CB	SW	SW

55.78	55.70	55.54				55.56	55.69	55.84
422	420	486	55	51	55	484	421	458
36	30.7	20	20		20	20	30.7	36
SW	SW	CB	G		G	CB	SW	SW

55.44	55.34	55.18				55.19	55.31	55.41
496	503	522	60	54	59	521	509	499
36	30.7	20	20		20	20	30.7	36
SW		CB	G		G	CB	SW	SW

55.16	55.13	55.04	54.83			54.81	55.03	55.16	55.24
522	527	536	537	65	57	62	539	537	524
40	36	30.7	20	20		20	20	30.7	36
SW	SW	SW	CB	G		G	CB	SW	SW

60.40  
/

Top of CB Lt 549 46+58.36 (P52 This Book)



B.M. 13.95 54.80 54.81  
 T.P. 10.09 68.75 1.74 58.66  
 1+00

0+90

0+80

0+70

0+60 R DRIVE

0+50

60.40  
 /

Top of Cb. LI Sta. 45+78.36 (p 51 this Book)

<sup>58.80</sup> 160 <sup>58.21</sup> 167 <sup>58.56</sup> 184 26 20 27 190 <sup>58.60</sup> 171 <sup>58.69</sup> 161 <sup>58.79</sup> 161  
 36 307 20 20 20 20 30.7 36  
 SW SW Cb. G G Cb. SW SW

<sup>58.74</sup> 198 <sup>58.34</sup> 206 <sup>58.15</sup> 225 30 25 30 229 <sup>58.11</sup> 221 <sup>58.29</sup> 202 <sup>58.38</sup> 202  
 36 307 20 20 20 20 30.7 36  
 SW SW Cb. G G Cb. SW SW

<sup>58.01</sup> 240 <sup>57.96</sup> 244 <sup>57.76</sup> 265 36 29 34 267 <sup>57.73</sup> 246 <sup>57.94</sup> 240 <sup>57.93</sup> 240  
 36 30.7 20 20 20 20 30.7 36  
 SW SW Cb. G G Cb. SW SW

<sup>57.62</sup> 278 <sup>57.69</sup> 281 <sup>57.39</sup> 301 38 33 37 303 <sup>57.37</sup> 284 <sup>57.56</sup> 274 <sup>57.66</sup> 274  
 36 30.7 20 20 20 20 30.7 36  
 SW SW Cb. G G Cb. SW SW

<sup>57.71</sup> 313 <sup>57.21</sup> 319 <sup>56.36</sup> 404 37 41 341 317 308 <sup>57.37</sup> 308  
 36 30.7 20 G 20 20 30.7 36  
 SW SW DRIVE G Cb. SW SW

<sup>56.86</sup> 354 <sup>56.43</sup> 357 <sup>56.66</sup> 374 45 40 46 377 <sup>56.63</sup> 358 <sup>56.64</sup> 358 <sup>56.96</sup> 358  
 36 30.7 20 20 20 20 30.7 36  
 SW SW Cb. G G Cb. SW SW

60.40  
 /



La Jolla Shores Drive - See Title next page  
ERH

74

La Jolla Shores Dr.

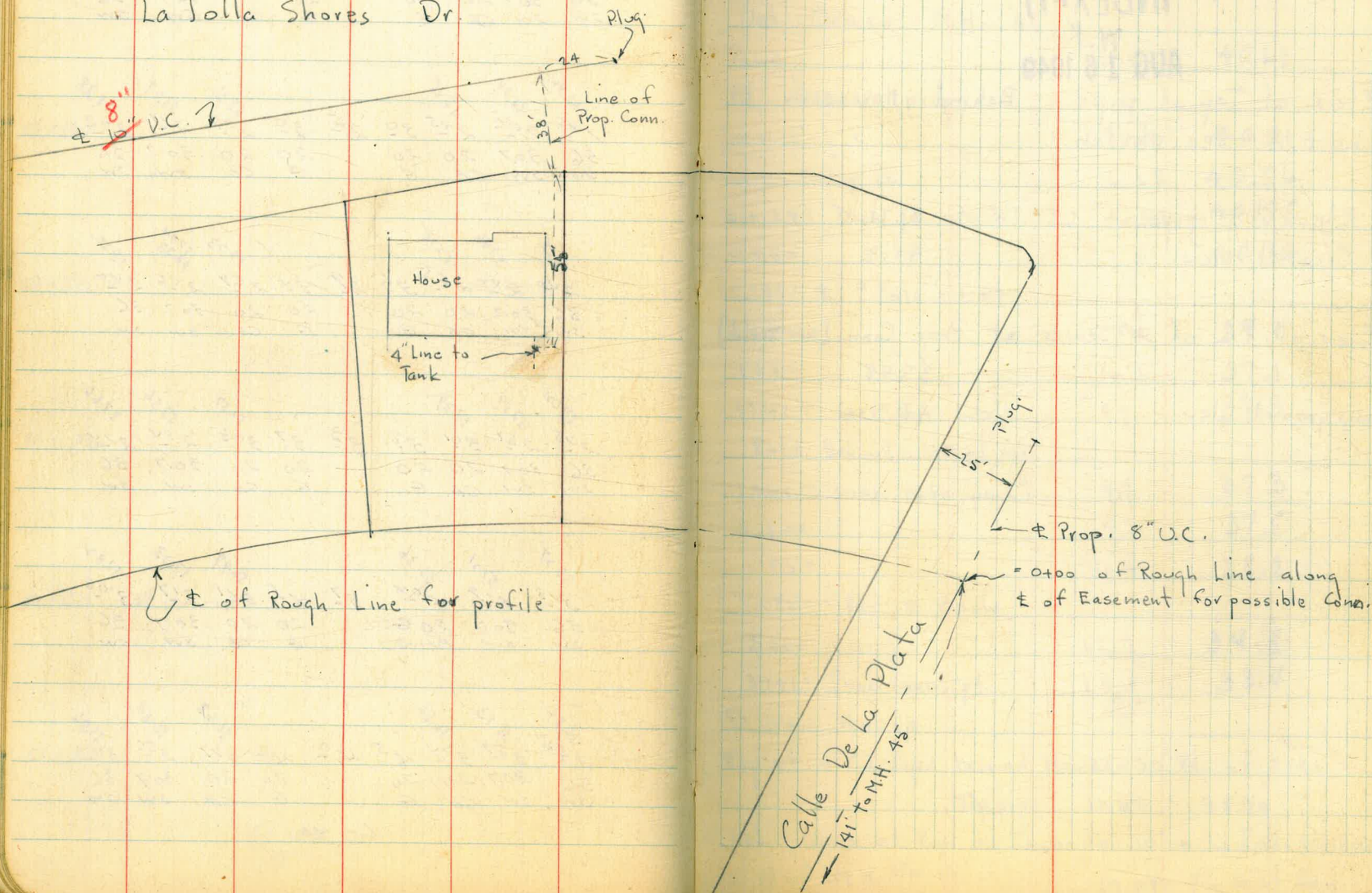



Survey to check Possibility of  
Sewer Serving Lot 14 - 16 Block 4  
La Jolla Shores.

W.O. 31339

**INDEXED**

8-15-49 - 7.0.

<sup>N.K.</sup>  
**AUG 16 1949**

Elev. of Top of pipe - Behind House in  
lot 14 - See sketch.

Elev. Top pipe - 4" CI 37.71 ✓  
Ground elev. 41.3

Elev. of FL of <sup>8"</sup> Sewer at Prop. Conn. (see sketch)  
38.48  
ground elev. 48.3

Profile along  $\pm$  of Rough Line along  
Easement in Block 4 75

47.24 = H.I. from cut stake

0+00 =  $\pm$  De La Plata - 141 S. of  $\pm$  Paseo  
Del Ocaso = M.H. 45

Pave 6.56 40.68

FL. Sewer (prop.) 7.23 40.01

0+18 = gut 6.68 40.56  
= Top cb.

0+24 = Back of walk 6.69 40.55

0+50 7.0 40.24

0+99 =  $\pm$  P. Pole - 1' Rt.

1+00 8.1 39.1

1+50 10.1 37.1

1+61 = Cor. Conc. Wall 9.9 37.3 = ground

Pole Behind Wall at Cor.

1+68 = pass. conn point 9.9 37.3

2+00 9.7 37.5

+50 11.4 35.8

2+85 = 1' Rt. -  $\pm$  P. pole

3+00 12.7 34.5

3+41 = Pass. Conn. pt 13.8 33.4

To New House

Top of 4" CI. Pipe behind House - 30' Rt. of 3+41

Top pipe 11.54 = 35.70

126' - Length of Run to Conn. to 10" in La Jolla Shores.

6' N of M.H. No. 19

(Can Make Conn. easy)

32.08 = FL. 10" at Conn.



Change Cuts  
M.H. #19 to D.E.  
See P. 75

W/O 31339

La Solla Shores Drive - Change of grade

425

33.97

18.33

7.34

C 10.99

INDEXED

W.K.

AUG 16 1949

33.62

18.68

7.84

C 10.84

475

33.27

19.03

8.51

C 10.52

0450

32.92

19.38

9.01

C 10.37

0425

32.57

19.73

9.62

C 10.11

M.H. 19

20.08

52.30

32.22

fd stub

C 9.80

9.80  
10.28  
20.08

Moore  
Bc 99  
Shannon  
S. 55

8-15-49

76

M.H. 19 to D.E. near Torrey Pines Road. GRH  
Change Noted on 1383-D

2432 D.E.

35.47

18.83

3.22

C 13.21 ✓

2

35.02

17.26

4.88

C 12.40

1475

34.67

17.63

5.85

C 11.78

1450

34.32

17.98

6.64

C 11.30







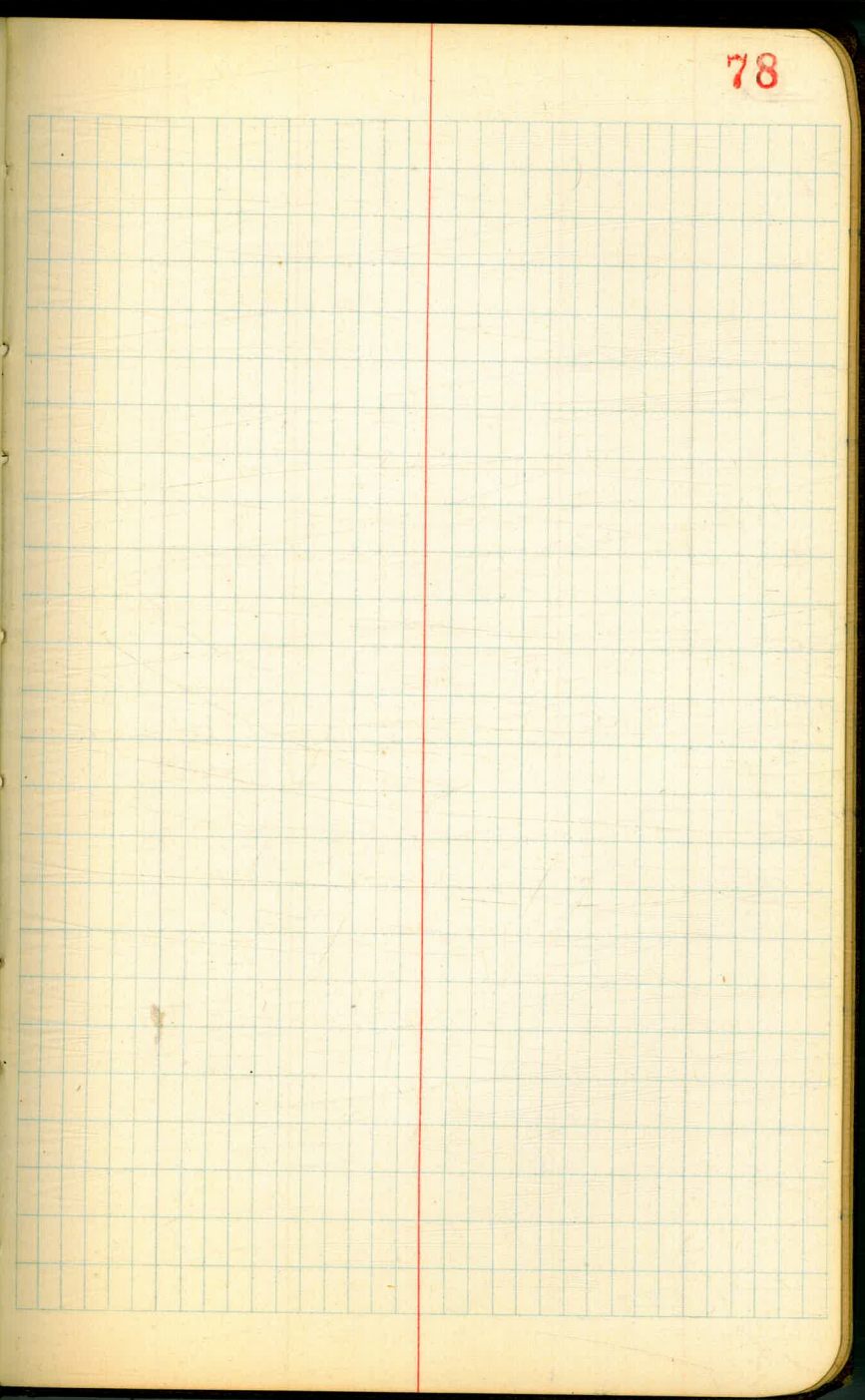
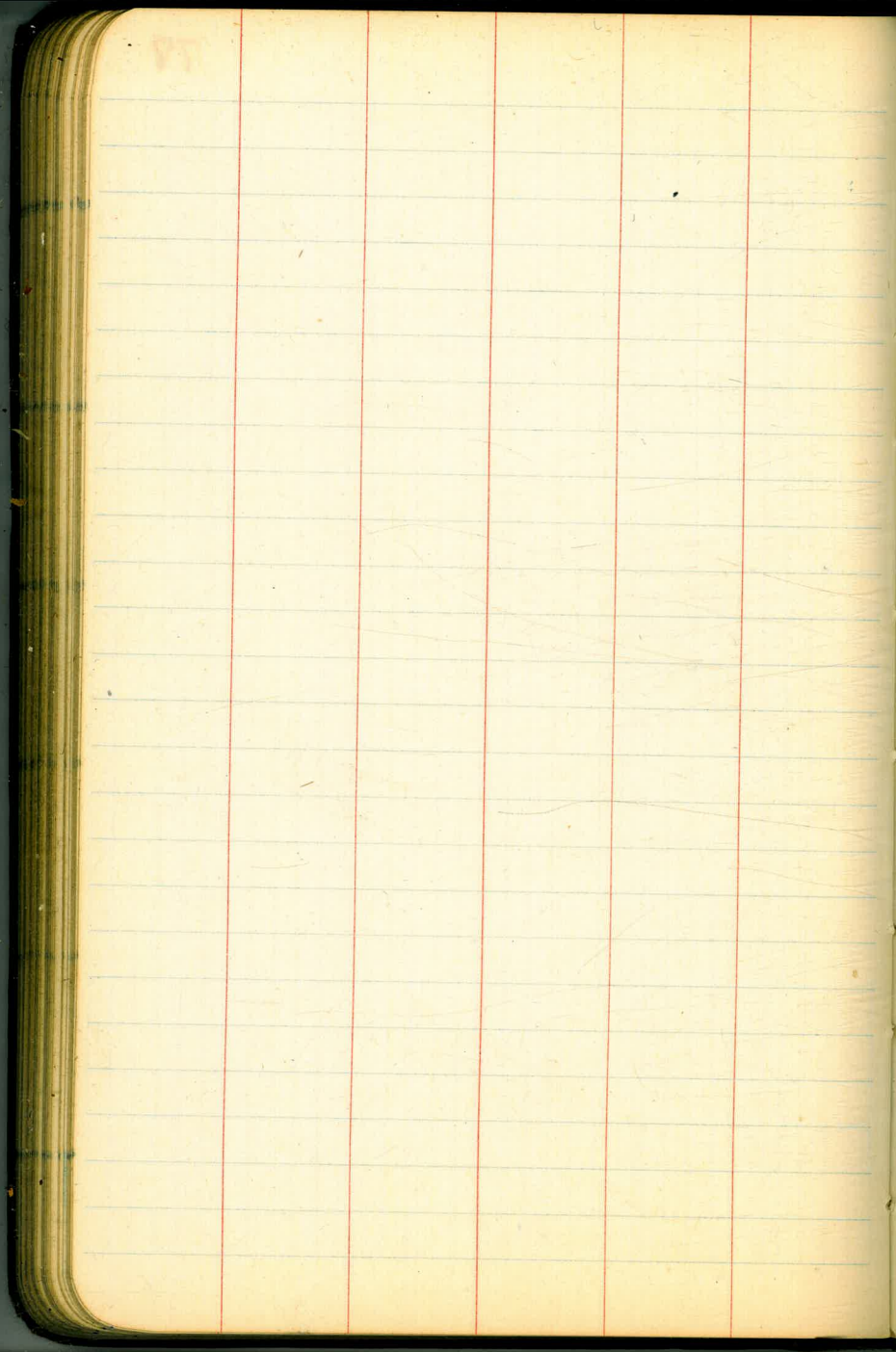



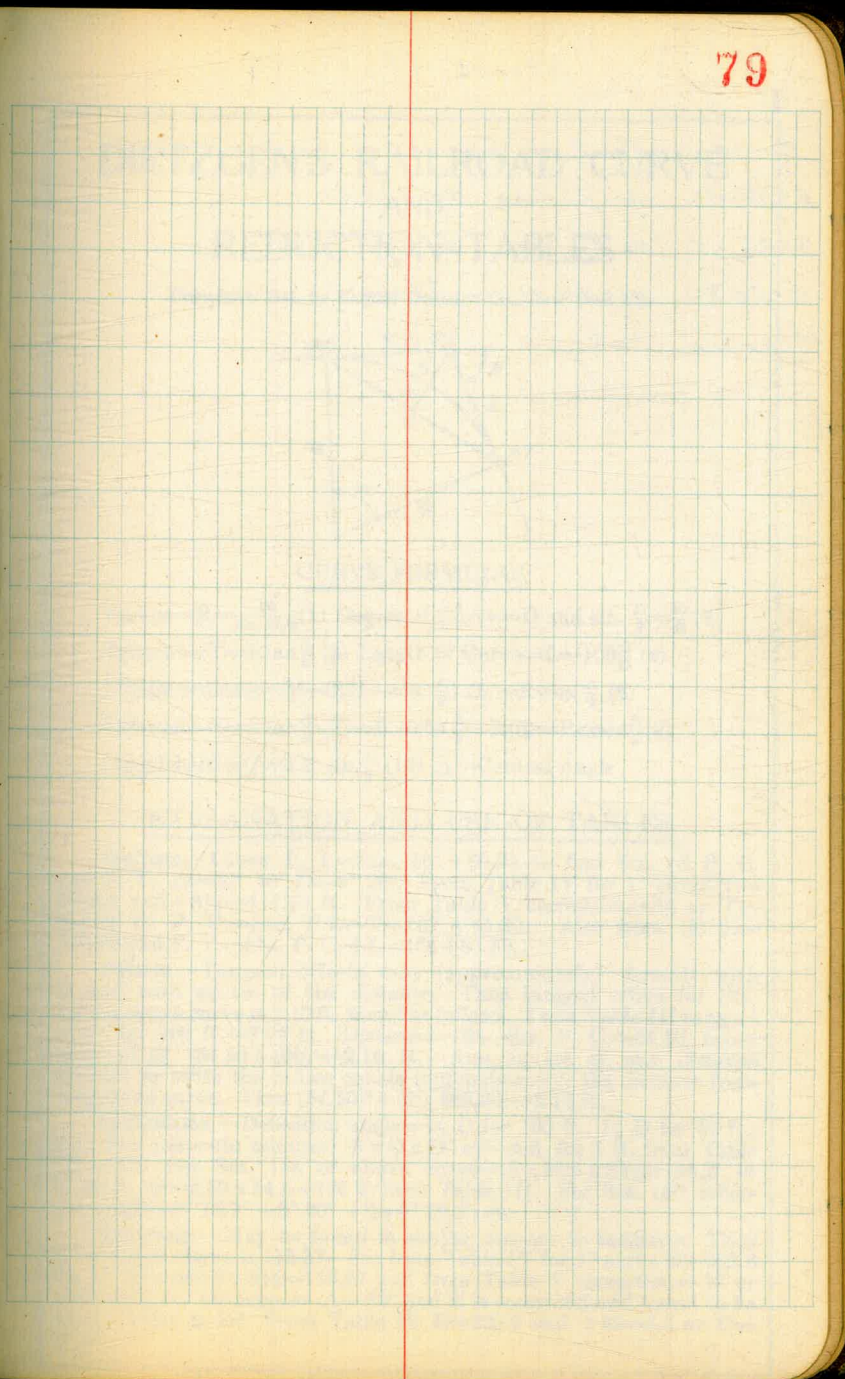
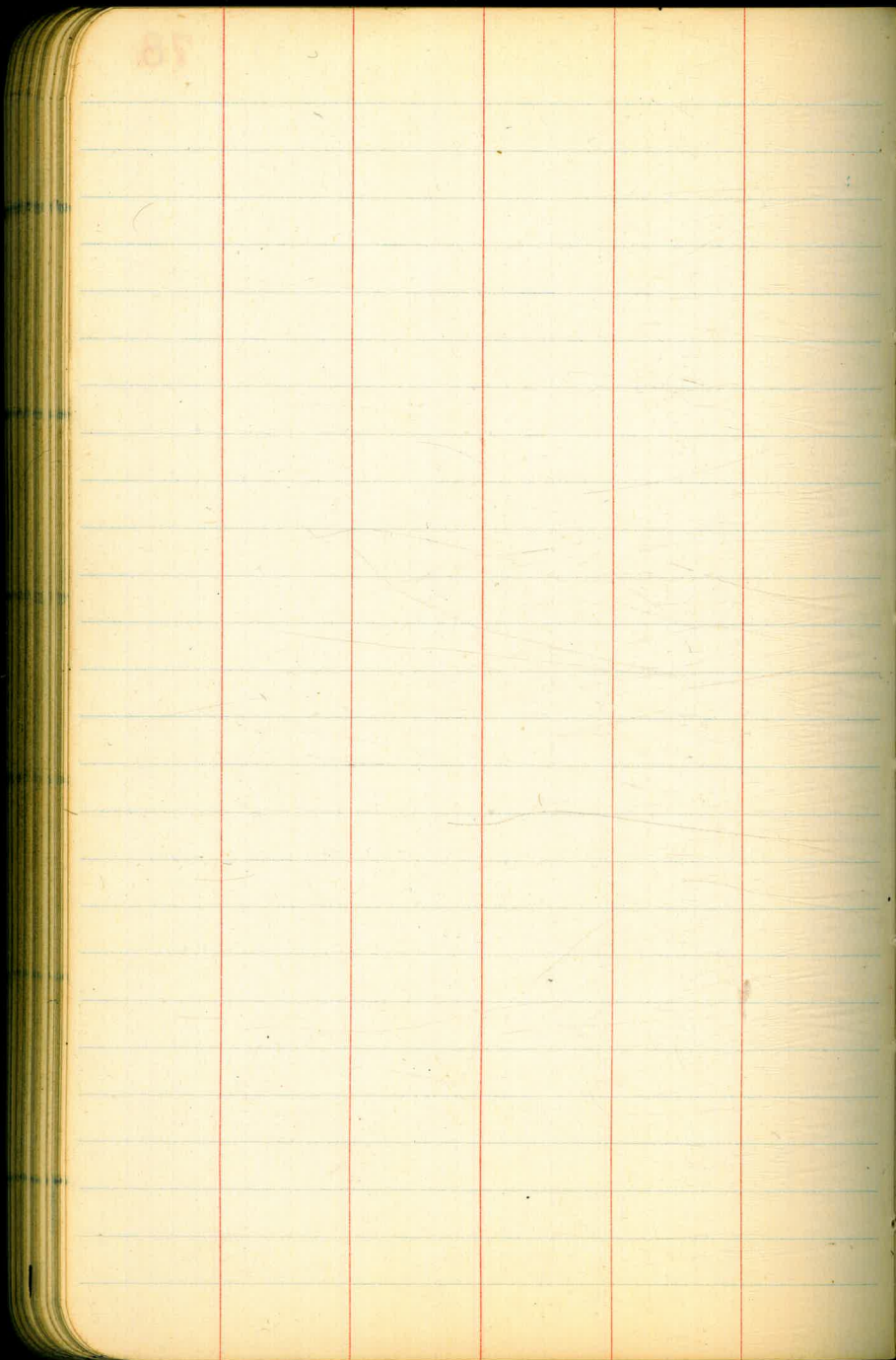







31.4  
 28.11  
 102  
 47.09 SEMON Gresham & Hornblend  
 5213940  
 607  
 5824730  
 10+2080  
 64560  
 39526  
 7  
 16/110  
 69  
 31.4  
 72  
 26942  
 13477  
 716  
 8+62  
 7+67  
 95

DISTANCES FROM CENTER OF ROADWAY FOR  
CROSS-SECTIONING.

Roadway 16 feet wide. Side Slopes 1 on 1½  
For Single Track Embankment.

H	0	.1	.2	.3	.4	.5	.6	.7	.8	.9	H
0	8.0	8.2	8.3	8.5	8.6	8.8	8.9	9.1	9.2	9.4	0
1	9.5	9.7	9.8	10.0	10.1	10.3	10.4	10.6	10.7	10.9	1
2	11.0	11.2	11.3	11.5	11.6	11.8	11.9	12.1	12.2	12.4	2
3	12.5	12.7	12.8	13.0	13.1	13.3	13.4	13.6	13.7	13.9	3
4	14.0	14.2	14.3	14.5	14.6	14.8	14.9	15.1	15.2	15.4	4
5	15.5	15.7	15.8	16.0	16.1	16.3	16.4	16.6	16.7	16.9	5
6	17.0	17.2	17.3	17.5	17.6	17.8	17.9	18.1	18.2	18.4	6
7	18.5	18.7	18.8	19.0	19.1	19.3	19.4	19.6	19.7	19.9	7
8	20.0	20.2	20.3	20.5	20.6	20.8	20.9	21.1	21.2	21.4	8
9	21.5	21.7	21.8	22.0	22.1	22.3	22.4	22.6	22.7	22.9	9
10	23.0	23.2	23.3	23.5	23.6	23.8	23.9	24.1	24.2	24.4	10
11	24.5	24.7	24.8	25.0	25.1	25.3	25.4	25.6	25.7	25.9	11
12	26.0	26.2	26.3	26.5	26.6	26.8	26.9	27.1	27.2	27.4	12
13	27.5	27.7	27.8	28.0	28.1	28.3	28.4	28.6	28.7	28.9	13
14	29.0	29.2	29.3	29.5	29.6	29.8	29.9	30.1	30.2	30.4	14
15	30.5	30.7	30.8	31.0	31.1	31.3	31.4	31.6	31.7	31.9	15
16	32.0	32.2	32.3	32.5	32.6	32.8	32.9	33.1	33.2	33.4	16
17	33.5	33.7	33.8	34.0	34.1	34.3	34.4	34.6	34.7	34.9	17
18	35.0	35.2	35.3	35.5	35.6	35.8	35.9	36.1	36.2	36.4	18
19	36.5	36.7	36.8	37.0	37.1	37.3	37.4	37.6	37.7	37.9	19
20	38.0	38.2	38.3	38.5	38.6	38.8	38.9	39.1	39.2	39.4	20
21	39.5	39.7	39.8	40.0	40.1	40.3	40.4	40.6	40.7	40.9	21
22	41.0	41.2	41.3	41.5	41.6	41.8	41.9	42.1	42.2	42.4	22
23	42.5	42.7	42.8	43.0	43.1	43.3	43.4	43.6	43.7	43.9	23
24	44.0	44.2	44.3	44.5	44.6	44.8	44.9	45.1	45.2	45.4	24
25	45.5	45.7	45.8	46.0	46.1	46.3	46.4	46.6	46.7	46.9	25
26	47.0	47.2	47.3	47.5	47.6	47.8	47.9	48.1	48.2	48.4	26
27	48.5	48.7	48.8	49.0	49.1	49.3	49.4	49.6	49.7	49.9	27
28	50.0	50.2	50.3	50.5	50.6	50.8	50.9	51.1	51.2	51.4	28
29	51.5	51.7	51.8	52.0	52.1	52.3	52.4	52.6	52.7	52.9	29
30	53.0	53.2	53.3	53.5	53.6	53.8	53.9	54.1	54.2	54.4	30
31	54.5	54.7	54.8	55.0	55.1	55.3	55.4	55.6	55.7	55.9	31
32	56.0	56.2	56.3	56.5	56.6	56.8	56.9	57.1	57.2	57.4	32
33	57.5	57.7	57.8	58.0	58.1	58.3	58.4	58.6	58.7	58.9	33
34	59.0	59.2	59.3	59.5	59.6	59.8	59.9	60.1	60.2	60.4	34
35	60.5	60.7	60.8	61.0	61.1	61.3	61.4	61.6	61.7	61.9	35
36	62.0	62.2	62.3	62.5	62.6	62.8	62.9	63.1	63.2	63.4	36
37	63.5	63.7	63.8	64.0	64.1	64.3	64.4	64.6	64.7	64.9	37
38	65.0	65.2	65.3	65.5	65.6	65.8	65.9	66.1	66.2	66.4	38
39	66.5	66.7	66.8	67.0	67.1	67.3	67.4	67.6	67.7	67.9	39
40	68.0	68.2	68.3	68.5	68.6	68.8	68.9	69.1	69.2	69.4	40

Example—If point is 22.6 ft. above grade, how far should it be from center line to be a slope stake point? Ans. from Table 41.9. For same slopes but other widths of roadbed correct above figures by one-half difference in width of roadbed; thus in example above for 20 ft. roadbed distance will be 41.9 + (20-16) ÷ 2 or 2 ft. added to 41.9 = 43.9. For slopes of 1 on 1 see inside of front cover.

MADE IN U.S.A.