

2034

THE END

MICROFILMED
DEC 31 1964

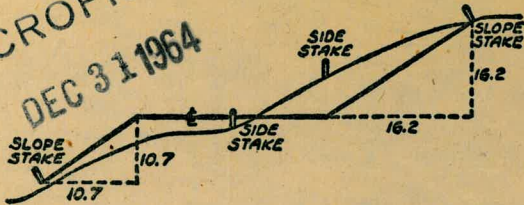

DISTANCES FROM SIDE STAKES FOR CROSS-SECTIONING
SLOPE 1 TO 1. ROADWAY OF ANY WIDTH

	0	.1	.2	.3	.4	.5	.6	.7	.8	.9	
0	0.00	0.10	0.20	0.30	0.40	0.50	0.60	0.70	0.80	0.90	0
1	1.00	1.10	1.20	1.30	1.40	1.50	1.60	1.70	1.80	1.90	1
2	2.00	2.10	2.20	2.30	2.40	2.50	2.60	2.70	2.80	2.90	2
3	3.00	3.10	3.20	3.30	3.40	3.50	3.60	3.70	3.80	3.90	3
4	4.00	4.10	4.20	4.30	4.40	4.50	4.60	4.70	4.80	4.90	4
5	5.00	5.10	5.20	5.30	5.40	5.50	5.60	5.70	5.80	5.90	5
6	6.00	6.10	6.20	6.30	6.40	6.50	6.60	6.70	6.80	6.90	6
7	7.00	7.10	7.20	7.30	7.40	7.50	7.60	7.70	7.80	7.90	7
8	8.00	8.10	8.20	8.30	8.40	8.50	8.60	8.70	8.80	8.90	8
9	9.00	9.10	9.20	9.30	9.40	9.50	9.60	9.70	9.80	9.90	9
10	10.00	10.10	10.20	10.30	10.40	10.50	10.60	10.70	10.80	10.90	10
11	11.00	11.10	11.20	11.30	11.40	11.50	11.60	11.70	11.80	11.90	11
12	12.00	12.10	12.20	12.30	12.40	12.50	12.60	12.70	12.80	12.90	12
13	13.00	13.10	13.20	13.30	13.40	13.50	13.60	13.70	13.80	13.90	13
14	14.00	14.10	14.20	14.30	14.40	14.50	14.60	14.70	14.80	14.90	14
15	15.00	15.10	15.20	15.30	15.40	15.50	15.60	15.70	15.80	15.90	15
16	16.00	16.10	16.20	16.30	16.40	16.50	16.60	16.70	16.80	16.90	16
17	17.00	17.10	17.20	17.30	17.40	17.50	17.60	17.70	17.80	17.90	17
18	18.00	18.10	18.20	18.30	18.40	18.50	18.60	18.70	18.80	18.90	18
19	19.00	19.10	19.20	19.30	19.40	19.50	19.60	19.70	19.80	19.90	19
20	20.00	20.10	20.20	20.30	20.40	20.50	20.60	20.70	20.80	20.90	20
21	21.00	21.10	21.20	21.30	21.40	21.50	21.60	21.70	21.80	21.90	21
22	22.00	22.10	22.20	22.30	22.40	22.50	22.60	22.70	22.80	22.90	22
23	23.00	23.10	23.20	23.30	23.40	23.50	23.60	23.70	23.80	23.90	23
24	24.00	24.10	24.20	24.30	24.40	24.50	24.60	24.70	24.80	24.90	24
25	25.00	25.10	25.20	25.30	25.40	25.50	25.60	25.70	25.80	25.90	25
26	26.00	26.10	26.20	26.30	26.40	26.50	26.60	26.70	26.80	26.90	26
27	27.00	27.10	27.20	27.30	27.40	27.50	27.60	27.70	27.80	27.90	27
28	28.00	28.10	28.20	28.30	28.40	28.50	28.60	28.70	28.80	28.90	28
29	29.00	29.10	29.20	29.30	29.40	29.50	29.60	29.70	29.80	29.90	29
30	30.00	30.10	30.20	30.30	30.40	30.50	30.60	30.70	30.80	30.90	30
31	31.00	31.10	31.20	31.30	31.40	31.50	31.60	31.70	31.80	31.90	31
32	32.00	32.10	32.20	32.30	32.40	32.50	32.60	32.70	32.80	32.90	32
33	33.00	33.10	33.20	33.30	33.40	33.50	33.60	33.70	33.80	33.90	33
34	34.00	34.10	34.20	34.30	34.40	34.50	34.60	34.70	34.80	34.90	34
35	35.00	35.10	35.20	35.30	35.40	35.50	35.60	35.70	35.80	35.90	35
36	36.00	36.10	36.20	36.30	36.40	36.50	36.60	36.70	36.80	36.90	36
37	37.00	37.10	37.20	37.30	37.40	37.50	37.60	37.70	37.80	37.90	37
38	38.00	38.10	38.20	38.30	38.40	38.50	38.60	38.70	38.80	38.90	38
39	39.00	39.10	39.20	39.30	39.40	39.50	39.60	39.70	39.80	39.90	39
40	40.00	40.10	40.20	40.30	40.40	40.50	40.60	40.70	40.80	40.90	40
41	41.00	41.10	41.20	41.30	41.40	41.50	41.60	41.70	41.80	41.90	41
42	42.00	42.10	42.20	42.30	42.40	42.50	42.60	42.70	42.80	42.90	42
43	43.00	43.10	43.20	43.30	43.40	43.50	43.60	43.70	43.80	43.90	43
44	44.00	44.10	44.20	44.30	44.40	44.50	44.60	44.70	44.80	44.90	44
45	45.00	45.10	45.20	45.30	45.40	45.50	45.60	45.70	45.80	45.90	45
46	46.00	46.10	46.20	46.30	46.40	46.50	46.60	46.70	46.80	46.90	46
47	47.00	47.10	47.20	47.30	47.40	47.50	47.60	47.70	47.80	47.90	47
48	48.00	48.10	48.20	48.30	48.40	48.50	48.60	48.70	48.80	48.90	48
49	49.00	49.10	49.20	49.30	49.40	49.50	49.60	49.70	49.80	49.90	49
50	50.00	50.10	50.20	50.30	50.40	50.50	50.60	50.70	50.80	50.90	50

Distance of slope stake from side or shoulder stake for any width roadway, slope 1 to 1. If ground is nearly level, the cut or fill at side stake is located by the double entry method in left column and top row. The number in body of table in same row and column gives distance from side stake to slope stake. If ground is not level estimate the difference in elevation between the side stake and slope stake, lower target by this amount if cut, elevate if fill. Add this amount to cut or fill and find distance in table. Set up rod at this point, and line of sight should cut target. If it does not make the slight adjustment necessary.

INDEXED

to page # 77

TABLE XIII—CORRECTIONS FOR TANGENTS AND EXTERNALS

These corrections are to be added to the approximate values, found by dividing the tangent, or external, for a 1° curve (Table VIII) by the degree of curve, in order to obtain the true tangents, or externals. Intermediate values may be obtained by interpolation.

FOR TANGENTS ADD

Central Angle	DEGREE OF CURVE													
	5°	10°	15°	20°	25°	30°	35°	40°	45°	50°	55°	60°	65°	70°
10°	.03	.06	.09	.13	.16	.19	.22	.25	.28	.31	.34	.38	.42	.46
15°	.04	.10	.14	.19	.24	.29	.34	.39	.45	.51	.53	.58	.63	.68
20°	.06	.13	.19	.26	.32	.39	.45	.51	.58	.65	.72	.79	.84	.90
25°	.08	.16	.24	.33	.40	.49	.58	.67	.75	.83	.90	.99	1.06	1.14
30°	.10	.19	.29	.39	.49	.59	.69	.79	.89	.99	1.09	1.20	1.29	1.39
35°	.11	.22	.34	.47	.58	.69	.79	.81	.92	1.04	1.29	1.42	1.54	1.66
40°	.13	.26	.40	.53	.67	.80	.93	1.06	1.20	1.34	1.49	1.64	1.79	1.94
45°	.15	.30	.44	.60	.76	.91	1.06	1.21	1.37	1.52	1.70	1.87	2.04	2.21
50°	.17	.34	.51	.68	.85	1.02	1.19	1.36	1.54	1.72	1.91	2.10	2.29	2.48
55°	.19	.38	.57	.76	.95	1.14	1.32	1.52	1.72	1.92	2.14	2.35	2.56	2.77
60°	.21	.42	.63	.84	1.05	1.27	1.49	1.71	1.94	2.17	2.38	2.60	2.83	3.07
65°	.23	.46	.69	.93	1.16	1.40	1.64	1.88	2.13	2.38	2.63	2.88	3.13	3.39
70°	.25	.51	.76	1.02	1.28	1.54	1.80	2.06	2.33	2.60	2.88	3.16	3.44	3.72
75°	.27	.56	.83	1.12	1.40	1.69	1.98	2.27	2.57	2.87	3.16	3.47	3.78	4.09
80°	.30	.61	.91	1.22	1.53	1.84	2.15	2.46	2.78	3.10	3.44	3.78	4.12	4.46
85°	.33	.66	1.00	1.33	1.68	2.02	2.36	2.70	3.05	3.40	3.77	4.14	4.55	4.89
90°	.36	.72	1.09	1.45	1.83	2.20	2.57	2.94	3.32	3.70	4.10	4.50	4.91	5.32
95°	.39	.79	1.19	1.55	2.00	2.40	2.80	3.20	3.61	4.02	4.40	4.98	5.38	5.83
100°	.43	.86	1.30	1.74	2.18	2.62	3.06	3.50	3.95	4.40	4.88	5.37	5.85	6.34
110°	.51	1.03	1.56	2.08	2.61	3.14	3.67	4.21	4.76	5.31	5.86	6.43	7.01	7.60
120°	.62	1.25	1.93	2.52	3.16	3.81	4.45	5.11	5.77	6.44	7.12	7.80	8.50	9.22

FOR EXTERNALS ADD

Central Angle	DEGREE OF CURVE														
	5°	10°	15°	20°	25°	30°	35°	40°	45°	50°	55°	60°	65°	70°	
10°	.001	.003	.004	.006	.007	.008	.009	.011	.012	.014	.015	.017	.018	.020	
15°	.003	.007	.010	.014	.018	.023	.027	.029	.032	.035	.039	.043	.047	.051	
20°	.006	.011	.017	.022	.028	.034	.038	.045	.051	.057	.063	.070	.076	.083	
25°	.009	.018	.027	.036	.046	.056	.065	.074	.083	.093	.106	.120	.127	.135	
30°	.013	.025	.038	.051	.065	.078	.090	.103	.116	.129	.149	.170	.179	.188	
35°	.018	.035	.054	.072	.086	.109	.131	.153	.175	.197	.213	.230	.247	.264	
40°	.023	.046	.070	.093	.117	.141	.172	.203	.234	.265	.277	.290	.315	.341	
45°	.030	.060	.093	.119	.153	.184	.216	.254	.289	.325	.351	.378	.411	.445	
50°	.037	.075	.116	.151	.189	.227	.266	.305	.345	.384	.425	.467	.508	.550	
55°	.046	.093	.142	.188	.236	.283	.332	.381	.420	.479	.530	.582	.641	.700	
60°	.056	.112	.168	.225	.283	.340	.398	.457	.516	.575	.636	.697	.774	.851	
65°	.067	.135	.204	.273	.343	.412	.483	.554	.625	.697	.711	.845	.922	1.01	
70°	.080	.159	.240	.321	.403	.485	.568	.652	.735	.819	.906	.994	1.08	1.17	
75°	.095	.182	.266	.353	.440	.528	.617	.707	.777	.877	.977	1.07	1.18	1.29	1.39
80°	.110	.220	.332	.445	.558	.671	.787	.903	1.02	1.13	1.25	1.38	1.50	1.62	
85°	.128	.259	.391	.524	.657	.790	.926	1.06	1.20	1.34	1.47	1.62	1.76	1.91	
90°	.149	.299	.450	.603	.756	.910	1.07	1.22	1.38	1.54	1.70	1.87	2.03	2.20	
95°	.174	.350	.522	.706	.885	1.06	1.25	1.43	1.62	1.80	1.99	2.18	2.38	2.58	
100°	.200	.401	.604	.809	1.01	1.22	1.43	1.64	1.85	2.06	2.28	2.50	2.73	2.96	
110°	.268	.536	.806	1.08	1.35	1.63	1.91	2.20	2.48	2.76	3.05	3.35	3.66	3.96	
120°	.360	.721	1.08	1.45	1.82	2.19	2.57	2.95	3.33	3.72	4.11	4.50	4.91	5.32	

X-sec.
 Draper Center to Marine 35-41
 water line
 STORK ST. IMP. AVE - TO BROOKLYN 42
 60th St X Sec 49-67
 Rose lawn X Sec 68-73
 Lexington PK. drain 76

D. Smith
W. Moore
J. Clark
F. Acung

Cross Section Alley BIK 138

Univ. Hts

INDEXED

W.K.

JUN 13 1949

Ref. Tie Point Sheet
#273

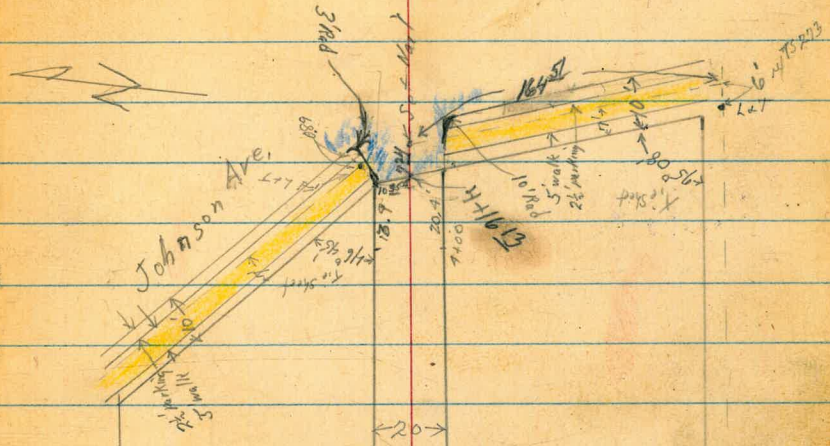

Hayes Ave.

BIK 138

Lincoln Ave.

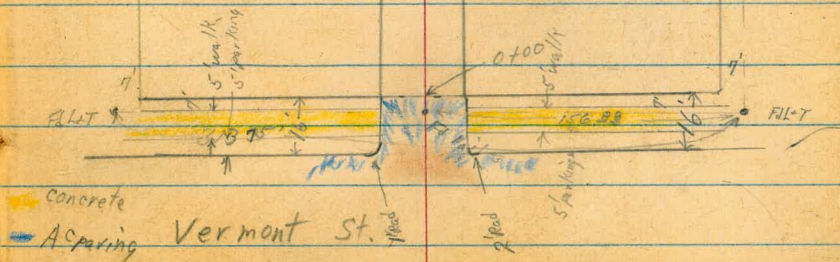

concrete
AC paving

Vermont St.

WO # 60253

June 9 1949

2

X Sec Alley B/K 138 Univ Hts

Lt = North

±

Rt = South

0435 105 Lt SE cor aptst garage Begin 4' high wire fence

0428 82 Lt E Power Pole # JPA1265

0425

294.2	294.1	294.0	293.9
33	34	35	35
10	10	10	14

0414 14° Rt NW cor House

04135 105 Lt SW cor aptst garages Vermont's con floor opens to West

0400 East Prop Vermont 110° Lt Begin 8" con retaining wall

292.5	292.61	292.87	292.56	292.57	292.47	292.67	292.77	293.1
50	48	47	48	49	50	44	44	47
10	10	10	10	10	5	10	10	25
hoting wall	prop	prop	prop	prop	prop	prop	prop	prop
292.27	291.69	292.96	291.81	291.82	291.85	292.50	291.96	
50	50	50	50	50	50	50	50	
10	10	10	10	10	10	10	10	
curb	curb	curb	curb	curb	curb	curb	curb	

0-16 East curb line Vermont

BM 467 297.51

SEBP Lincoln Vermont 292.84

297.51

cont.

LT & RT

TP 580 301⁴³ 188 295⁶³

1717 92 RT NE cor shed also Begin 5' picket fence

1700 21⁵ LT garage dirt floor

1700 99 RT NW cor shed

1700 116 RT End con brick wall 8" wide 6' high

295.4	295.0	295.1	295.3	294.9	294.5	300.26	294.5
21	25	24	22	26	30 + 25	300	30
21 ⁵	10		10	99	110	110	25
Floor				Floor	Footing	Top wall	

0778 95 LT End 4' wire fence

0750 106 RT Begin con brick wall 6' high 8" wide

295.4	295.2	294.5	294.9	294.4	300.23	294.00	294.2
21	23	30	31	31	278	35	33
25	10	6		10	106	106	25
					Top wall	Footing	

0748 89 RT E 3 1/2' con walk

294.3	295.44	294.3	295.44
32	20	33	20
1	5	9	9
Footing	Top	Footing	Top

0745 75 LT & 3 1/2' con platform for trash etc

0742 142 RT NE cor House

297.51

cont

1791^{1/2} 9^{1/2} Lt End 5^{1/2} fence

1791^{1/2} 8^{1/2} Lt SW cor 2 ear garage con Floor apron

1786 7^{1/2} Lt E 2^{1/2} con walk

1775 8^{1/2} Lt Begin con slab yard also 9^{1/2} Lt Begin 5^{1/2} fence

SP 597 301⁶⁰ 580 295⁶³

1750

1735 9^{1/2} RT End 5' picket fence

1731 6^{1/2} Lt E garage coll by floor 2 apron

1725 8^{1/2} Lt E power pole # JPA 1223

LT E RT

295.78
582
92
looking

296.33
527
70
10' walk

296.02
558
82
base

296.63
487
91
floor

510
296.80
81
apron

301⁶⁰

52 296.2
15

54 296.0
10

56 295.8

55 295.9
10

52 296.2
15

296.52
491
80
floor

295.85
559
62
apron

301⁴³

cont.

Lt.

S

Rt

6

2150 10³ Lt SW cor shed + garage dirt floor

4 ⁸	4 ⁵	4 ⁹	4 ⁹
102	10		10
Floor			

2150 8⁰ Lt E Power Pole JPA 1341

297.35	297.14
4 ²⁵	4 ⁴⁶
16 ⁴	12 ⁸
Floor	Apron

2147 12⁸ Lt SE cor double garage + con floor + apron

2145 11⁰ Rt E garage dirt floor

296.8
4 ⁸
11 ⁰
Floor

2129 12³ Lt SW cor double garage con floor + apron

297.34	297.10
4 ²⁵	4 ⁶⁰
16 ⁵	12 ²
Clwy	Apron

2109⁵ 8¹ Lt SE cor 2 car garage con floor + apron

296.84	296.68
4 ⁷⁶	4 ⁹²
9 ¹	8 ¹
Floor	Apron

2100

296.73	296.54	296.2	296.3	296.8	296.8
4 ⁸³	5 ⁰³	5 ⁴	5 ²	4 ⁸	4 ⁸
9 ¹	8 ¹		7	10	10
Floor	Apron				
		30	160		

cont

2

RT
29792
308
102
walk

3+12 10² RT & 3' con walk with rough pour in alley 4'

3+06 10² LT Begin point set & planting

3+02 10² LT Begin 5' Board Fence

3+00 10² RT Begin 7' Fence + Lattice green house.

29722
44
10
4L
29715
32
10
29717
40
15
29716

2+96 10³ LT & garage dirt floor

29714
42
102
floor

2+91 10² LT End Lattice Fence

2+82 10² LT & 1 1/2' con walk

29713
423
104

2+70 10³ LT Begin 4 1/2' Fence Lattice

2+70 10³ LT SE cor shed & garage dirt floor

29711
42
102
floor

3D/60

cont

LT

E

RT

8

3164 9⁶ RT Begin 4' picket fence (concrete set in 2x2) con slab

3162 11⁶ LT End 5' Board Fence

3160 9⁴ LT & Power Pole # JPA. 1259

3157 23⁴ RT E garage + con. floor + apron

3150

3148 9² RT NE cor comb Bldg + garage + con floor

3128 7³ RT End apron + garage doors

3115 7⁶ RT NW cor comb. garage + bldg con floor ^{apron}

297.65	297.98
3 97	3 62
23 4	26 6
apron	Floor

116	297.5	297.4	297.6	297.7
45	44	42	40	37
15	10		10	13

297.80
3 80
9 2
Floor

298.0	298.2
3 6	3 4
9 3	10 0
apron	floor
297.7	297.98
3 83	3 63
9 4	10 2
apron	Floor

301 60

cont

4416¹³ West Prop Johnson Ave sec 11² prop to south
AC paving 1' short

293.33	293.17	293.09	293.55	293.85	294.4
789	805	813	767	737	68
100	100	102	102	102	25
246	241	24	24	24	

4410

292.9	293.2	296.3	295.9	294.0	294.1	294.4	296.7	296.8	296.9
80	80	42	53	72	71	68	45	44	43
30	18	10	8	6	7	5	7	10	15

TP 5⁹⁶ 301²² 6³⁴ 298²⁶

4400

296.9	296.8	296.6	295.2	295.4	295.6	295.6	296.7	296.8	296.9
42	48	50	64	6	2	60	50	48	42
15	10	8	6	6	5	6	6	10	15

3484 92²⁴ E dead man

3482 98²⁴ E dead man

3480

296.7	296.9	296.5	297.0	297.0	297.2
42	42	52	46	46	44
15	10	7	10	10	15

3477 2⁰ RT E MH

297.20
4⁴⁰
20
rim

3465 11⁰ LT root Lim+ of 3' wide hedge

3.01⁶⁰

cont

Lt

R

RT

10

BM starting

882 292⁸⁷ ✓
SE BP
Lincoln Vermont

TP 5³⁵ 301⁶⁹ 488 296³⁴

BM

380 297⁸⁷
E2T NW
cor John
Lincoln

4+31 10⁹ RT curb line to South + Alley return which
is on 10' Rd

894 292.28
10 884 292.38
10 843 292.77
94 772 293.50
Curb

4+22 16⁶ Lt Curb line to North + Alley return

293.06 816 890
16⁶ 16⁶ 10
Curb 94

292.32 807 292.55
10 840 292.82
94 774 293.48
98 98 745 293.77
94 Curb

301²²

W.O. 22014

7-18-49-

7.0.

Final X-Sections of Borrow Area
for Imperial Ave - Realignment.
Sections taken on Same Sta. + outs
shown are from \perp of Row at 90°

INDEXED
N.K.
JUL 20 1949

8+00

7+50

7+00

6+50

6+00 - Same

B.M.

5.22

147.63

142.41 =

11

all outs Lt. of \perp

142.9	140.0	136.6	131.9	131.7	132.0
4.7	7.6	11.0	15.7	15.9	15.6
400	350	296	281	221	218
Same		Top	c	c	Same

134.2	134.1	131.0	130.8	132.4
13.4	13.5	16.6	16.4	15.2
300	294	2915	235	231
Same	Top	c	c	Same

137.9	137.4	130.6	130.6	130.5	133.6
9.7	10.2	17.0	17.0	17.1	14.0
335	309	301	270	243	223
Same	Top	c	c	c = channel	Same

136.5	135.6	130.6	130.8	131.1
11.1	12.0	17.0	16.8	10.5
350	310	297	260	250
Same		edge channel	edge of channel	Top bank

Top Sewer M.H.

147.63

Sections of Drainage Ditch from Culvert
 To Main channel - Ignored Ditch on Reg.
 Sections - Bottom of Ditch is 3' wide

Lt. = W.

Rt. = E. 13

one Rod for Bottom + Dist. out from E
 for Top.

1+55 = Int. of Toes on Lt. = end

134.0
 13.6
 = Toes 1.5

1+48 = Int. of Tops on Lt. - Toe on Rt.

134.9
 2.7
 12

134.9
 12.7

134.9
 12.7
 1.5 = Toes

1+21 = Int. of Tops on Rt

145.7
 1.9
 10.5

134.8
 12.8

145.4
 2.2
 13

1+00

145.4
 2.2
 10.5

135.4
 12.2

146.1
 1.5
 12.5

0+50

143.6
 4.0
 9 = Top

135.8
 11.8
 3/4 Level

145.1
 2.5
 10 = Top

Consider 0+00 as Vert. bank

0+00 = outlet of Culvert

142.1
 5.5
 7 = Top

136.51
 11.12 = F.L.
 Pipe

143.1
 3.5
 9 = Top

14+50					157.4	150.3	150.0	149.0	141.5	141.2	142.7	143.6	144.4
					+1.3	5.8	6.1	7.1	14.6	14.9	13.4	12.5	11.7
					218	201	175	153	14	120	84	82.5	55
					Top	Toe		Top	c	c	c	Top	

T.P 7.03 156.12 4.55 149.09 156.12

14+00					157.1	149.0	149.2	141.2	140.5	141.5	149.1	144.9
					+3.5	4.6	4.4	12.4	13.1	12.1	4.5	8.7
					235.5	219	165	155	125	92.5	82.5	51
					Top	Toe			c	c	Top	51 ^{Toe}

13+50					157.1	148.9	148.4	140.4	140.9	140.3	152.6	149.1
					+3.5	4.7	5.2	13.2	13.7	13.3	1.0	3.9
					253.5	238	175	165	135	104	87	40
					Top	Toe	Top	c	c	c	Top	

Pile - 100yds - Left for Pole

13+00					156.7	148.0	147.2	139.3	139.1	139.8	152.6	151.2	149.3
					+3.1	5.6	6.4	14.3	14.5	13.8	1.0	2.4	4.3
					272	254	185	176	145	115	96	65	40
					Top	Toe	Top	c	c	c	Top		

12+50		156.0			147.2	145.5	146.5	138.4	138.6	138.4	152.1	150.1	148.1	148.1
		+2.4			6.4	8.1	7.1	15.2	15.0	15.2	1.5	3.5	5.5	5.5
		291			171.5	201	196	187	155	124	106	65	52	40
		Top			Toe		Top	c	c	c	Top			

12+00		155.5	146.0		144.9	144.1	145.2	137.6	137.7	138.2	151.2	149.3	150.1	147.1
		+1.9	7.6		8.7	9.5	8.4	16.0	15.9	15.4	2.4	4.3	3.5	6.5
		309	289.5		250	210	206	197	165	135	116.5	.85	60	40
		Top	Toe				Top	c	c	c	Top			

153.64

Use old sect. for Rest - No more borrow

17+50

149.3	147.4	147.5
6.8	8.7	8.6
101 Top =	98 c	75 = Toe Rock
Same		

17+00

150.4	146.4	146.2
5.7	9.7	9.9
113 Top =	106 c	76 = Toe c Rock
Same		

16+50

150.0	145.4	144.9
6.1	10.7	11.2
116 Top =	111 c	73 = Toe of c Rock
Same		

16+00

147.1	144.1	144.6	144.1
8.4	11.4	11.5	12.0
119 Top =	114 c	75 c	71 = Toe of Rock
Same			

15+50

146.3	144.5	144.2	143.4
9.8	11.6	11.9	12.7
127.5 Top =	124.5 c	72 c	65.5 Toe of Road slope + edge of channel
Same			

15+00

151.2	148.5	144.3	142.6	142.1	142.6	145.6	145.5
4.9	7.6	8.8	13.5	13.4	13.5	10.5	10.6
143 Same	155	139.5 Top	133 c	100 c	76 c	70.5 Top	57 Toe

156.12

D. Smith
W. Clark

Levels Proposed Sewer 66' Akins + Brook 1/4

INDEXED

W.K.
AUG 30 1949

1750

1700 5' RT & House

0756 5' RT & House

0750

0730

0425 at Bulkhead

0700 Existing M.H.

BM

10⁹²

231⁵⁰

220⁵¹

0700 Existing M.H. FB/664-93

1765 5' RT & House

106225.9
94 222.1 RT East
93222.2
220.1
221.2
221.1
222.26
112 103 104 934
10 10 10 57
Floor

925
57
Floor
220.6
220.7
221.0
102 108 105
10 10 10

219.7
118
10
221.5
102 102
10 10

216.3
152
10
216.0
155
215.8
152
10

220.57
206.90
213.8
10.93 24.60 17.7
10m Fl. Ground

3425

3400 L.H.

2475

TP

12⁹²

244¹²

2450 40 RT & House

2425

2400

LT RT
238.5
56 52
7 10
236.9 238.9
73 85 72
10 on Hub 10 10
236.07 236.2
9mm

233.8
103
10
232.9
112
10
233.2
102
10

020 231³⁰

228.9
26
10
229.5
20
10
229.8
20
40
Floor
229.32

222.7
82 74
10 5
224.1
53 53
10 10
226.2
226.3

221.8
92 86 75 75
10 5 10
222.9
224.0
224.0

827
51
Floor
223.43

231⁵⁰

Cont.

47
 225.3
 12⁵ 11³ 72 7L
 10 5 10

237.1
 102 85 46 43
 10 5 10

240.6
 72 72 19
 10 2 10

242.2
 10 3 10
 244.3
 10 3 10
 245.0
 10 3 10
 245.9

242.0
 20 10 0 3 10.5
 10 6 10

240.5
 35 20 16 14
 10 6 10

240.3
 38 31 22
 10 6 10

244^R

3700

4775

4450

4125

TP₂393 247⁸²033 243⁸⁹

410

3775

3750

0700 East + West
 25

7124²¹ L. RT up Maderast

7105²⁸ on Mon & Brookly, H
 West 10' line 66⁴³

7100

6150

6700

TP₃

5750

232.27
 1092 102
 09 Had ground

232.52
 1069 232⁵² ✓
 232.52
 232.52
 232.9
 103 102 104
 10 10 10
 233.0
 232.8

FB# 1664-10, 73
 232.52 232.52

231.7
 115 102 105
 10 10 10
 232.3
 232.7

231.5
 112 110 95 98
 10 3 10
 232.2
 233.7
 233.8

830 243²¹ 12⁹¹ 234²¹

232.9
 149 136 120 112
 10 3 10
 234.2
 235.8
 236.1

247⁸²

Levels Proposed Sewer

Brooklyn 66th to 67th

lt North 259.4
 92 82 72 261.5
 10 10 10

INDEXED

W.K.
 AUG 30 1949

13³⁰ 268⁶²

027 255⁴²

252.3 251.8 252.9
 34 32 28
 10 10 10

1762 2' Lt E 10" pepper tree

12⁹⁶

255⁶⁹

043 242²⁸

243.98 241.9 241.8 241.9
 40 12 14 12
 10 10 10

1750 25' Lt E House

1725 3' Lt E 12" pepper tree

236.4 237.3 237.2
 68 52 62
 10 10 10

233.1 233.2 234.0
 10 10 92
 10 10 10

233.8 233.7 233.3
 94 95 92
 10 10 10

232.29 232.5
 10 10
 MH Stub Ground

243²¹

4700 End

3788 2' Lt E 12" pepper tree

3750

3742 31' Lt E House

3735 2' Lt E 12" pepper tree

3710 MH stub

3708 2' Lt E 12" pepper tree

TP

928

291²³

0³²

281⁴⁵

side shot 2705³² on West line P.O.T. 446

2775

2750

TP

13²³

281²²

0⁰⁸

268⁵⁴

2725

265.6 266.0 266.9
 30 28 12
 10 10 10

268⁶²

lt E 289.4
 18 24 32 288.0
 10 10 10

286.6 286.3 286.0
 46 42 52
 10 10 10

288.09

314

31

floor

282.6 283.6 284.2
 76 76 70
 10 10 10

291²³

3737.4 3737.3 3737.3
 34 35 35
 10 10 10

272.5 272.9 273.7
 93 82 81
 10 10 10

Levels Proposed Sewer
Brooklyn 66th to 65th St
W. South & Rt. North

TP 10.58 269.89 2.59 259.31

1+30 Sewer M.H. 258.9
32/10 24 259.5 261.6
0.5/10

INDEXED
N.K.
AUG 30 1949

1+00 82/10 74 254.5 72 254.9

TP 1212 261.20 0.53 249.78

0+75 247.3
30/10 13 249.0 0.2/10 250.1

0+50 236.9 229.3
13.2/10 11.2/5 10.1 240.2 7.8/10 242.4

TP 1285 250.31 0.71 237.46

0+25 233.5 234.3 235.7
4.2/10 3.2/10 2.5/10

↑ West

0+00

BM 5.65 238.17

235.52 Man Brook
West of Line 66th
1924 19

LT 259.8 260.1 RT
4+00 8' RT & Church 12.4/10 12.1/10 11.2/10 4.84/8.2100 262.35

3+50 261.2 261.3 261.9
11.8/5 10.2/10 9.5/10

3+00 263.5 263.7 244.4 265.1
8.2/10 8.5/10 7.8/10 7.1/10

2+75 96' RT & House 267.9 267.9 268.5 272.3
4.2/10 4.4/10 3.2/10 10.10/9.6/2.400

2+50 268.9 270.4 271.5
3.3/10 1.8/10 0.7/10

2+25

TP 2+05³² POTH 350 272.19 1.25 268.64
(23+20)

2+00 267.2 267.9 269.2
2.7/10 2.0/10 0.7/10

1+50 262.4 263.1 264.3
7.3/10 6.8/10 5.8/10

269.89

Cont.

Lt E Rt

INDEXED
N.Y.
AUG 30 1949

5440 DE stub

260.0
12^E 11^E 11^E 260.5
10 10 10 260.9

5700

259.4
12^E 12^E 12^E
10 10 10 259.7
259.7

4765 67' Lt & House

15th
67'
Floor

259.2
13^E 12^E 12^E 260.0
10 10 10

4450

272¹⁹

10420 MH stub

241.0
32 32 32
10 10 10

10400

236.2
82 42 4^E 240.9
16 10 10 240.8

9750

240.8
44 82 5^E 239.9
25 12 9 5^E 239.3

9700

239.6
53 95 65 72 237.9
20 10 6 10 237.9

8750

238.0
62 92 84 85 236.8
20 10 8 10 236.4
236.2

8400

238.5
64 116 93 95 235.4
20 10 5 10 234.9

7750

238.0
62 112 124 232.5
20 12 6 11^E 102
232.24

7724²² L:Rt

12⁶³
on 446

BM

12³⁵

244⁸⁷

232⁵²
S. Man. 664
& Brook 144

Levels Proposed Sewer Madera St.
Brooklyn to Winderlin

Lt E Rt
241.0
32 32 32
10 10 10

INDEXED
N.Y.
AUG 30 1949

cont.

Lt=South

Rt=North

4475 120' Rt & Hoase

147
120
Floor

4450 Extra outs on Lt are Elev.

287.6
6 1/2
10
287.8
6 1/2
10
288.4
5 1/2
10

4400

240
75

288.6
5 1/2
10
289.2
5 1/2
10
290.4
3 1/2
10

3784 73 POT Hub

277 1/2 = elev.

288.22
5 1/2

3750

75

286.4
7 1/2
10
286.6
7 1/2
10
287.1
7 1/2
10

ground to South falls away fast. from Here Beck

3725

283.0
11 1/2
10
284.1
10 1/2
10
285.1
9 1/2
10

TP

12 59

294 20

0 1/2 281 6 1/2

2790 MH stub

278.0
3 1/2
10
278.4
3 1/2
10
279.7
2 1/2
10

2745

272.2
9 1/2
10
272.6
9 1/2
10
273.7
8 1/2
10

281 7 1/2

8+60=end. Lt 279.41
8+00 11.0 10.6 75 6.5 283.5
7+20 49.6 75 273.39 281.8 6.7
7+00 floor 49.6 281.8 6.4 283.6
ground 6.2 283.8

5+60

6.2 283.8

5+20

6.2 282.9

1.12 290.01

BM

286.90
730 288.89 = POT Hub
286.20
286 20 65th + under 1/2

Req. Extended Line

5770 80' Rt & House
End stub
Ewash
in Avocado
grove
27 1/2
12 1/2
11 1/2
11 1/2
4 1/2
Floor

5735

282.8
11 1/2
10
282.9
11 1/2
10
283.2
11 1/2
10
289.7

2790 MH stub

5700

272.2
100

283.9
10 3/4
9 1/2
284.6
9 1/2
284.8

294 20

Rt.

24

Levels Proposed Sewer Wunderlin
 66th to 68th Lt-North & Rt-South

L.S. / E. / G. / 25

TP 13A1 299.08 0.60 285.67
 1+25 278.9 281.3 283.1
 $\frac{74}{10}$ 5.0 $\frac{32}{10}$
 1400 INDEXED W.K. AUG 30 1949
 271.6 275.5 277.5
 $\frac{142}{10}$ 10.8 $\frac{80}{10}$
 TP 1310 286.27 0.00 273.17
 0+77 269.4 265.6 266.3
 $\frac{83}{10}$ 7.6 $\frac{69}{10}$
 TP 1312 273.17 0.75 260.05
 0+50 251.4 252.8 252.9
 $\frac{94}{10}$ 8.2 $\frac{69}{10}$
 0+10 248.5 248.7 248.8
 $\frac{123}{10}$ 12.1 $\frac{122}{10}$
 0+00 & Mon 247.50 1330
 BM 1330 260.80 247.50
 & Mon Mader
 & Wunderlin

TP 12²⁰ 338.83 0.97 325.93
 2+90 316.3 318.6 320.8
 $\frac{105}{10}$ 8.3 $\frac{61}{10}$
 TP 13²¹ 326.20 1.25 313.89
 2+60 322.7 323.8 314.3
 $\frac{24}{10}$ 1.9 $\frac{05}{10}$
 2+40 307.2 308.6 310.1
 $\frac{79}{10}$ 6.5 $\frac{50}{10}$
 TP 12⁶⁰ 315.14 0.43 302.54
 2+00 299.3 300.4 302.1
 $\frac{32}{10}$ 2.6 $\frac{02}{10}$
 TP 12⁴³ 302.97 8.54 290.54
 1+75 293.0 294.5 296.0
 $\frac{61}{10}$ 4.6 $\frac{31}{10}$
 1+50 285.9 288.0 290.2
 $\frac{132}{10}$ 11.1 $\frac{09}{10}$
 299.08

Cont.

26

5+100

LT	E	RT
344.1	344.4	344.7
7°	6°	6°
10	10	10

4+90 65' Lt & Shed near doghouse

338.49		
12°		
10		
338.6	339.5	340.1
12°	11°	11°
10	10	10

6+30 Stub End

348.6	347.0
25°	41°
10	10
	44°
	346.7

4+50

TP

12°⁵³

351.4

0°²³ 338.6

6+10 78' Rt & House

344.21
6° ⁵⁷
28°
Floor

4+100 150' Rt & House

333.9	335.0	335.1	335.3
42°	32°	35°	53°
10	10	10	150
			Floor

3+70 75' Rt & House

328.5	331.6	332.3	338.63
9°	7°	6°	0° ²²
10	10	10	77
			Floor

6+100

340.1	348.5
7°	7°
10	10
	347.9
	32°

3+30 MH Stub

324.5	326.3	329.9
14°	12°	8°
10	10	10

5+60 58' Lt & House

346.46
4/68
Floor

3+25 75' Rt & House

322.6	325.6	327.7
16°	13°	11°
10	10	10

5+50

347.9	348.4	348.4
9°	2°	2°
10	10	10

3+20

322.6	325.6	327.7
16°	13°	11°
10	10	10

5+40 58' Rt & House

347.26	FB 16649
37°	
Floor	

338.83

351.44

Levels Proposed Sewer Madera St
Wunderlin + Bachor Broadway

Lt West 24' 3" RT East 25' 5" RT East 35' 5" RT East 31.0

INDEXED
W.K.
AUG 30 1949

16+50

16+00

15+50

15+12

15+00

14+50

14+00

13+70

13+56 32' Mon Madera + Wunderlin

BM 13+ 260.61

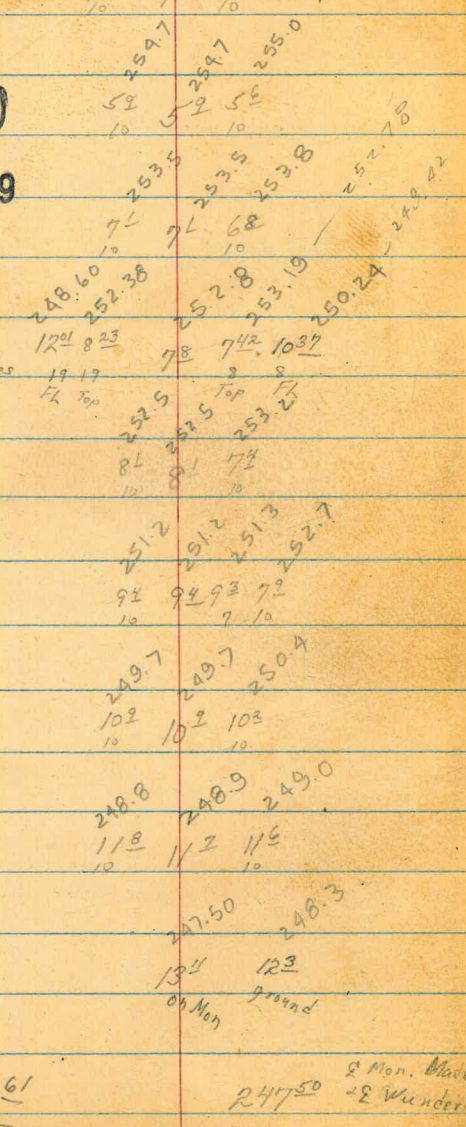

Lt West 269.74 5' 5 1/2" RT East 269.83 5' 4 1/2" RT East 270.11 5' 2 1/2"

19+55' edge con paving 10

19+52' 1' Lt & tel pole # 427423H 5' 3 1/2" 5' 4" 11' 6" 263.7 262.2 13' 20"

19+35' 7' 1/4 275.32 267.4 267.1 265.9 262.9 261.7 259.6

TP 19+00 0' 1 1/2" 2' 4" 5' 4" 6' 6" 8' 2" 10' 20"

18+50 263.4 263.1 262.6 259.9 256.7 4' 5" 5' 3" 5' 2" 8' 4" 11' 6" 10' 20"

18+00 261.5 261.3 261.3 258.3 256.1 6' 2" 7' 0" 7' 3" 10' 2" 12' 2" 10' 20"

17+85' 45' RT & House 6' 1 1/2" 4' 5" floor 260.3 260.0 260.4 8' 0" 8' 2" 7' 2" 10' 20"

17+50 258.6 258.6 258.3 259.3 9' 2" 9' 2" 10' 2" 9' 2" 10' 20"

17+00 268.08 268.08 268.08 268.08 10' 20" 8' floor

16+80 8' Lt & House 8' 20" 8' floor

TP 8' 8 1/2" 268.38 1' 15" 259.46

16+80 8' Lt & House 8' 20" 8' floor

16+80 8' Lt & House 8' 20" 8' floor

16+80 8' Lt & House 8' 20" 8' floor

16+80 8' Lt & House 8' 20" 8' floor

16+80 8' Lt & House 8' 20" 8' floor

16+80 8' Lt & House 8' 20" 8' floor

16+80 8' Lt & House 8' 20" 8' floor

16+80 8' Lt & House 8' 20" 8' floor

16+80 8' Lt & House 8' 20" 8' floor

D. Smith
W. Moore
J. Clark

Levels Proposed Sewer Broadway Madera to 65th St.

TP 12⁸²

307¹⁸

293.90 0.67 294.57
113 294.32 294.11
20 0.71 0.92
20 20

288.81 289.19 288.77
6²² 5⁸⁴ 6²⁶
20 20 20

283.90 284.36 283.97
11¹³ 10⁶⁷ 11⁰⁶
20 20 20

3700

INDEXED

W.K.
AUG 30 1949

2750

2700

TP

12⁶³

295⁰³

0¹⁸ 282⁴⁰

278.72 279.25 278.91
3⁰² 5²³ 3⁴⁷
20 20 20

273.81 274.25 273.78
8²⁷ 8³³ 8⁸⁰
20 20 20

270.65 270.87 270.47
11²³ 11²¹ 12¹¹
20 20 20

282⁵⁸

1750

1700

0750

0400 west on Bdy

75

12⁷² 282⁵⁸

(269²⁴)

209²⁸ 269²²

86 FB 1664-11

5⁴⁶ 269

19780 65 E 1st Broadway
Madera

275³²

Lt-South

B.M. 8 P.S.L. Broadway
1/2 East of West edge
Pairing 65th St

TP

7²⁶

326⁸³

5750

5725'

5700 50' Lt E House

4750

4740 80 Rt E House

TP

12²⁶

4700

3765 55' Rt E House

3750

WO #31187

Aug. 25, 1949 28

1465 Rt-North

312¹⁸

FB 7664-35
312¹⁴

020 319⁵²

318.21
146
20

318.67
140
20

318.27
140
20

316.11
355
20

316.64
303
20

316.25
372
20

309.24
10⁴³
20

313.94
523
20

314.50
517
20

314.02
565
20

308.95
10²²
20

309.47
10²⁰
20

309.05
10⁶²
20

319.11
056
80
Floor

319⁶⁷

027

306²¹

303.96
328
20

304.37
281
20

304.02
316
20

311.22

7404

299.00
818
20

299.32
786
20

299.03
815
20

307¹⁸

Weather - 90°

Levels Proposed Sewer
Madera St. Broadway to Hilger
Lt. West & Rt. East

INDEX
W.K.
AUG 30 1949

23+55.20	222.14	272.21	272.90
23+00	221.80	613	272.10
22+50	221.80	655	271.80
22+00	221.38	684	271.82
21+50	220.98	701	271.06
21+00	220.57	729	270.61
20+50	220.17	743	270.25
20+00	219.80	795	269.95

27+00	277.49	277.96	277.52
26+50	276.94	277.29	276.89
26+00	276.09	276.51	276.06
25+50	275.37	275.79	275.39
25+00	274.60	274.99	274.55
24+70	274.12	274.50	274.16
24+00	270.63	274.15	274.03
23+65	273.61	273.61	273.71
23+00	273.50	273.50	273.11
22+00	273.11	273.11	271.01
21+00	269.33	269.33	269.33

19+80 65 2 LT Broadway
Madera 9.18

279.04

269 86 Page 28

23+65 185 St. E House

279.04

+1.00
1.45
2.00

280.04

Curv

LEFT=WEST & RIGHT=East

INDEXED
W.K.
AUG 30 1949

Levels Proposed Sewer Bittern St 30
Madera Easterly
LEFT & RIGHT

TP 1307 308.41 0.21 295.34

INDEXED
W.K.
AUG 30 1949

1+50 $\frac{19}{10}$ 293.7 293.5 299.6 300.6
 $\frac{19}{10}$ 293.7 293.5 299.6 300.6

1+25 $\frac{6.3}{10}$ 289.3 288.9 295.3 296.2
 $\frac{6.3}{10}$ 289.3 288.9 295.3 296.2

1+00 $\frac{28.8}{10}$ 284.2 287.2 286.5
 $\frac{28.8}{10}$ 284.2 287.2 286.5

LIVE TREES on
EDGE of CUT BANKS

TP 1261 295.55 0.45 282.94

0+75 $\frac{3.3}{10}$ 280.1 279.7 281.7
 $\frac{3.3}{10}$ 280.1 279.7 281.7

0+50 $\frac{7.0}{10}$ 276.4 276.1 278.7 279.6
 $\frac{7.0}{10}$ 276.4 276.1 278.7 279.6

0+20 Edge of paving $\frac{27.52}{10}$ 275.2 275.2

27+16⁹³ L+T & MADRA'S HILGER
 $\frac{1.42}{20}$ 277.62 278.10 277.59
 $\frac{1.42}{20}$ 277.62 278.10 277.59

27+10 50' R. & HOUSE
 $\frac{1.25}{20}$ 278.01 278.01
 $\frac{1.25}{20}$ 278.01 278.01

279.04

0+00 West 10.29 283.39 272²⁰
 23+55²⁰

CONT.

LEFT = WEST &

RIGHT = EAST

31

LEFT = WEST & RIGHT = EAST

315.15 311.7 311.3 311.1 312.2

3+50 142' W. & House
Floor

$\frac{521}{142}$ $\frac{82}{10}$ 9- $\frac{93}{5}$ $\frac{82}{10}$

3+10 45' R. & House

311.72
 $\frac{864}{45}$
Floor

5+80 = Sub Lind

332.0
 $\frac{13}{10}$ 331.96
 $\frac{13}{10}$ 332.1
331.96

3+00

308.2
 $\frac{123}{10}$ 308.3
308.5
309.3
 $\frac{121}{5}$ $\frac{111}{10}$

5+40

327.5
 $\frac{58}{10}$ 327.4
 $\frac{63}{10}$ 327.1

TP

12.06 320.36 0.11 308.30

5+20 58' R. & House

324.70
 $\frac{866}{55}$
Floor

2+60 61' R. & House

309.11
+102
 $\frac{61}{10}$
Floor

5+00

323.3
 $\frac{102}{10}$ 323.3
 $\frac{103}{10}$ 323.0

2+50

304.5
 $\frac{32}{10}$ 304.8
 $\frac{36}{5}$ $\frac{25}{10}$
304.8
305.9

TP

13.17 333.30 0.23 320.13

2+25 78' R. & House

305.5
 $\frac{336}{78}$
Floor
301.2
300.8
300.6
302.5

4+50

318.8
 $\frac{16}{10}$ 318.7
 $\frac{16}{10}$ 318.8

2+00

72
 $\frac{72}{10}$ 76
 $\frac{78}{6}$ $\frac{59}{10}$
300.9

1+00

314.8
 $\frac{56}{10}$ 314.7
 $\frac{58}{10}$ 314.6
 $\frac{53}{10}$ 315.1

1+75

298.1
 $\frac{103}{10}$ 297.6
 $\frac{108}{5}$ $\frac{102}{10}$ $\frac{75}{10}$
300.9

3+85 42' R. & House

4.47
 $\frac{47}{10}$
Floor

308.41

320.36

Levels Proposed Sewer Broadway
Madera East to Evelyn and North on Evelyn to End
L to North R to South

INDEXED
N. K.
AUG 30 1949

2+40

273.5 274.0 274.1
7³ 7⁴ 7²
10 10 10

2+00

268.9 268.8 268.9
12³ 12³ 12³
10 10 10

1+50

265.6 265.6 265.7
15⁵ 15⁵ 15²
10 10 10

1+00

265.4 265.2 264.5
15² 15² 16⁵
10 10 10

0+70

267.2 267.3 265.1 264.4
13² 13³ 16⁰ 16²
10 10 10 10

1

270.2 266.4 264.8
10² 14² 16³
10 10 10

0+45

270.6 269.9 268.2 265.7
10⁵ 11³ 12² 15²
10 10 10 10

0+40

269.96 269.86 269.84
11⁴ 11² 11³
10 10 10

0+25 edge of paving

269.86
11²

0+00 East

BM. & L&T Broadway
Madera St.

11² 281⁰²

269⁸⁶

L to North R to South

4+30

297.8 298.2 298.5
8⁰ 7⁵ 7³
10 10 10

4+00 8⁵ RT & House

295.7 295.9 296.0 304.3
10⁶ 9² 9² 14⁶
10 10 10 8⁵

3+75

293.3 293.4 292.9
12⁵ 12⁴ 12²
10 10 10

TP

12⁵⁹ 305⁷⁹

0⁴⁹

293²⁰

3+50

290.7 291.0 290.5
13⁰ 12² 13³
10 10 10

3+25

287.6 287.6 287.4
6¹ 6¹ 6³
10 10 10

3+00

283.7 283.6 283.5
10⁰ 10¹ 10²
10 10 10

TP

12⁹⁷

293⁶⁹

0³⁵

280²²

2+70

278.6 278.9 278.8
2⁵ 2³ 2³
10 10 10

281⁰⁷

Cont

Lt=West & Rt=East

7450

307.3
5 1/2
10
301.9
5 1/2
10
323.9
10

TP 12⁵¹

312⁸⁶

544

300³⁵

2 Mon
Evelyn
Bldg

7400

6490 135 Lt & House

6470 65 Lt & House

6450

6400

5450

5400

4465⁰⁰ & Mon Broadway
& Evelyn St L.Lt

(300³⁵)

544

442

ground

305⁷²

304.4
1 1/2
10
305.3
0 5
10
306.7
+02
10
318.66
+12⁸²
1 1/2
Floor

430
Floor
301.5
302.2
302.6
304.4
305
33
1 1/2
10

300.8
300.6
302.4
5 1/2
3 1/2
10

299.9
5 1/2
2
300.5
4 1/2
10
301.9
4 1/2
10
301.6

299.3
6 1/2
10
301.6
5 1/2
10
301.0

300.9

465
51

33

Lt. & Rt

TP 13²⁰ 350⁷⁶ 337⁵⁶

10+00

334.1
3 1/2
10
334.4
3 1/2
10
334.7
3 1/2
10
337.4
0 04
10
+1 1/2
339.0
10

9475 85' Lt & House

9450

TP 12⁶⁵

9400

8450

TP on stub
8405

8410 70 Lt & House

8405 MH stub

20⁵²
Floor D
326.7
329.4
331.3
10 1/2
10 1/2
8 1/2
6 1/2
10

337⁶⁰ 0⁰² 324⁸⁵

320.7
42
10
320.3
42
10
323.7
326.4
13
10

315.0
10
10
314.8
8 1/2
10
316.9
6 1/2
10
318.9

12⁸¹ 324⁹⁷ 0⁷⁰ 312¹⁶

308.53
3 1/2
10
Floor

311.5
1 1/2
10
312.3
0 1/2
10
314.2
+1 1/2
10

312⁸⁶

Cross Section
Draper Ave.

Genter to Marine

11-9-49

W.O. # 31622

INDEXED

W.K.
JAN 9 1950

Sommer mayer
M & Coy
Allen
Rorer

15 ft. of \pm
Soil sample at 0+50

Taken from approx Sub. grade

to Approx. Sub. on -1'

soil thru-out block looks uniform.

147 E 26th Drive

from B.C. on Sea Lane
cb.

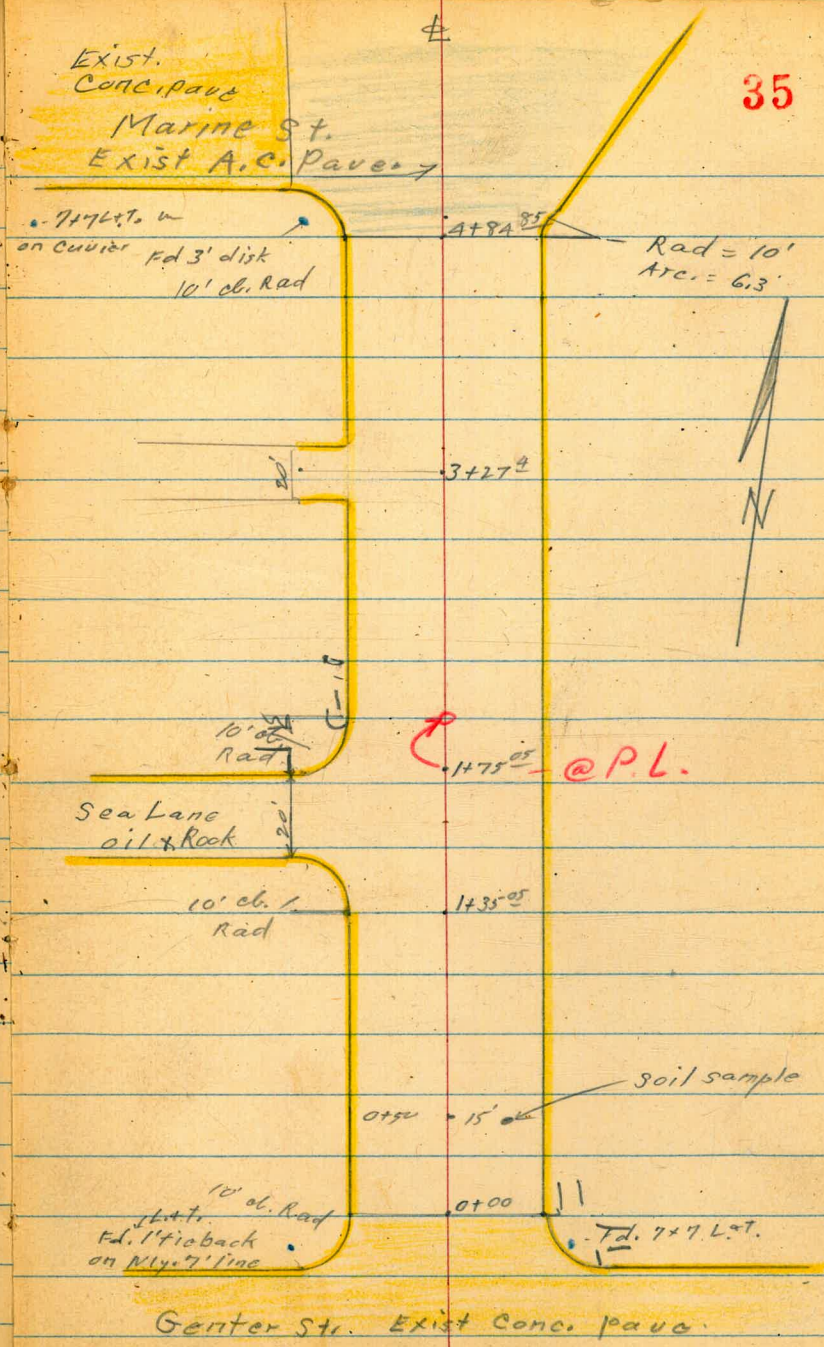

35

Exist.
Conc. pave
Marine St.
Exist. A.C. Pave.

7x7 L.S.T. on Curv. Rd 3' dist
10' cb. Rad

1+84.85
Rad = 10'
Arc = 6.3'

3+27.8

10' cb. Rad

1+75.05 @ P.L.

Sea Lane
oil & Rock

10' cb. Rad

1+35.05

0+50 15' Soil sample

10' cb. Rad
14 ft. Rd. 11' back
on My. 7' line

0+00

Td. 7x7 L.S.T.

Genter St. Exist Conc. pave.

Draper St. Levels
 0+00 = Nly. Line Center

±

36

0+50

^{104.61} 3.59	^{103.70} 4.5	^{104.4} 3.8	^{104.2} 3.5	^{104.2} 3.3	^{104.7} 3.5	^{105.7} 2.50
<u>20</u>	<u>20</u>	<u>20</u>		<u>20</u>	<u>20</u>	<u>20</u>
cl						cl

also = End Conc. Pavement
 0+00 = Nly. Draper - 20' Lt } Cl. Ret. E.C.

^{105.98} 2.22	^{105.37} 2.83	^{105.88} 2.32	^{106.17} 2.03	^{106.34} 1.86	^{106.40} 1.80	^{107.0} 1.20
<u>20</u>	<u>20</u>	<u>10</u>		<u>10</u>	<u>20</u>	<u>20</u>
cl	G				G	cl

0-07 ± 23' Lt. } = ctr. 10' Rad cl. Ret.

^{106.02} 2.18	^{105.26} 2.84	^{106.36} 1.84	^{107.04} 1.16
<u>23</u>	<u>G</u>	<u>G</u>	<u>22.9</u>
Top cl	23	22.9	Top cl

0-10 = Nly. Cl. line gutter 30' Lt } E.C. 10' Rad. cl. Ret.

^{103.06} 5.14	^{105.99} 2.21	^{107.02} 1.18	^{108.98} 1.70
<u>80</u>	<u>30</u>	<u>30</u>	<u>80</u>
Hand Level		cl. EC. 10' Rad Ret.	Hand Level

0-10 ± = Nly. Gutter Center

^{102.46} 5.74	^{105.26} 2.84	^{105.44} 2.72	^{105.72} 2.48	^{105.99} 2.21	^{106.09} 2.11	^{106.27} 1.93	^{106.48} 1.72	^{108.10} 0.10
<u>80</u>	<u>30</u>	<u>20</u>	<u>10</u>		<u>10</u>	<u>20</u>	<u>30</u>	<u>80</u>
Hand Level								Hand Level

0-30 = ± Center (Conc. Pavement)

^{103.30} 4.70	^{105.98} 2.22	^{106.15} 2.05	^{106.26} 1.84	^{106.58} 1.62	^{106.40} 1.45	^{106.42} 1.28	^{107.09} 1.11	^{109.21} 1.50
<u>80</u>	<u>30</u>	<u>20</u>	<u>10</u>		<u>10</u>	<u>20</u>	<u>30</u>	<u>80</u>
Hand Level				108.20				Hand Level

Draper +
 Center

1.88 108.20

— 106.32 S.W.
 B.R.

1+55⁰⁵ = 4 Sea Lane

30' L
1+45¹ = sly gutter line Sea Lane

Rough Cold Lay
20' Lt = oil + Rock pave. on Sealane

30' Lt = E.C. 10' Rad. cl. Rot.
1+45⁰⁵ = sly. cl. line Sea Lane

1+42^t 23' Lt. - Ctr. 10' Rad. Rot.

20' Lt. = cl. Rot. B.C.
1+35⁰⁵ = sly. line Sea lane

1+00

B.C. ONLY. 30' STREET NOT 40' STEVENS 11-13-47 P.L. 1+40⁰⁰

99.2	102.0	102.1	102.4	102.6	102.6	102.4	102.2
8.5	6.2	6.1	5.8	5.6	5.6	5.8	4.98
80	30	20	10	10	10	192	20
							cc
	100.20		102.45				
	8.00		5.75				
	80		30				
			Cl. E.C.				
99.41	102.06	102.0	102.5	102.1	102.8	102.1	102.34
8.56	6.15	6.2	5.6	5.4	5.4	5.7	4.86
80	30	20	10	10	10	199	20
	R.						cc
	102.47		102.10				
	5.73		6.1				
	23		oil + Rock				
	cc		pave				
	102.01	102.1	102.8	102.0	102.0	102.2	102.50
	5.69	6.1	5.4	5.2	5.2	5.6	4.70
	20	20	10	10	10	20	20
	cc, B.C.						cc
	102.31	102.6	102.3	102.7	102.2	102.1	104.41
	4.83	5.6	4.9	4.5	4.5	4.9	3.79
	20	20	10	10	10	20	20
	cc						cc

108.20

T.P. 5.02 105.82 7.40 100.80

2+50

$\frac{7.04}{20}$	$\frac{7.8}{192}$	$\frac{7.2}{10}$	6.9	$\frac{6.9}{10}$	$\frac{7.0}{192}$	$\frac{6.05}{20}$
cc						cc

2+00

$\frac{6.51}{20}$	$\frac{7.2}{20}$	$\frac{6.6}{10}$	6.3	$\frac{6.2}{10}$	$\frac{6.5}{192}$	$\frac{5.50}{20}$
cc						cc

1+75⁰⁵ = Nly. line Sea Lane

EC curb
1+70⁰⁵ P.L.

$\frac{6.20}{20}$	$\frac{6.6}{20}$	$\frac{6.1}{10}$	5.9	$\frac{5.9}{10}$	$\frac{6.1}{192}$	$\frac{5.23}{20}$
cc						cc

1+68-23' Lt. = Ctr. 10' Rad. cb. Rot.

11-17-49

$\frac{6.29}{23}$	$\frac{6.5}{23}$
cc.	oil pave

1+65⁰⁵ = Nly. cb line Sea Lane

3d Lt. = E.C. cb. Rot.

THIS IS NOT A 40' ST.
STEVENS

$\frac{8.48}{80}$	$\frac{6.22}{30}$	$\frac{6.3}{20}$	$\frac{5.9}{10}$	5.7	$\frac{5.7}{10}$	$\frac{6.0}{192}$	$\frac{5.15}{20}$
		oil pave					cc

1+65 = Nly gutter line Sea Lane

$\frac{9.0}{80}$	$\frac{6.40}{30}$
	cc

108.20

3+39⁴ = 20' Lt. = alley cl. E.C.

$$\begin{array}{r} 100 \text{ } 40 \\ 5.42 \\ \hline 20 \\ \text{Cl. E.C.} \end{array}$$

3+37⁴ = Nly line alley to west

$\frac{5.27}{100}$	$\frac{5.7}{100}$	$\frac{5.51}{100}$	$\frac{5.6}{100}$	$\frac{5.9}{99.9}$	$\frac{5.6}{100}$	$\frac{5.4}{100}$	$\frac{5.3}{100}$	$\frac{5.6}{100}$	$\frac{4.42}{10}$
30L	30	22	22	20	10	5.4	10	178	199
Top									cl
End									
cl									

3+27⁴ = Alley to west.

$\frac{8.4}{100}$	$\frac{5.6}{100}$	$\frac{5.4}{100}$	$\frac{5.8}{100}$	$\frac{5.4}{100}$	$\frac{5.3}{100}$	$\frac{5.2}{100}$	$\frac{5.5}{100}$	$\frac{4.35}{10}$
30L	30	22	20	10	5.3	10	195	192
Top								cl
End								
cl								

→ Cont.

3+17⁴ = sky line Alley to west.

$\frac{5.10}{100}$	$\frac{5.5}{100}$	$\frac{5.8}{100}$	$\frac{5.3}{100}$	$\frac{5.2}{100}$	$\frac{5.1}{100}$	$\frac{5.4}{100}$	$\frac{4.32}{10}$
22	22	20	10	5.2	10	195	197
cl. E.C.							top cl

3+15⁴ 20' Lt. = B.C. 2' Rad. Alley Cl. Rot

$$\begin{array}{r} 100 \text{ } 54 \\ 5.26 \\ \hline 20 \\ \text{Cl. B.C.} \end{array}$$

3+00

$\frac{5.1A}{100}$	$\frac{5.8}{100}$	$\frac{5.1}{100}$	$\frac{5.0}{100}$	$\frac{5.0}{100}$	$\frac{5.2}{100}$	$\frac{4.05}{10}$
20L	20	10	5.0	10	199	20
cl						cl

105.82

20' Lt. = cl. Rot. B.C. - 10' Rad.
 A+85² = Start, A.C. Pavc. Rods. on Pavc.

98.53	98.51	98.52	98.8	98.91	98.12	98.21
6.99	7.41	7.14	7.01	6.83	6.70	5.91
20	20	10		10	199	20
cl. B.C.	G				G.	cl.

192 Rt. = cl. B.C. (See sketch.)
 4+84⁸⁵ = Sly. Line Marine St.

98.22	98.4	98.2	98.8	98.0	99.1	99.21
7.10	7.4	7.1	7.0	6.8	6.7	5.91
20	20	10		10	199	19.9
cl.						cl. B.C.

20' Rt.
 Curb. produces across driveway.
 Note Rod. of 5.78 = where top of
 A+75 = 20' Lt. = Brk. 14 grade of cl.

98.96	98.5	98.0	98.5	98.3	99.44	100.04
6.86	7.4	6.8	6.4	6.5	6.4	5.78
20	20	10		10	199	20
cl						See Note Drive

4+50

99.12	98.5	99.3	98.5	99.2	99.5	100.25
6.65	7.3	6.5	6.2	6.1	6.4	5.43
20	20	10		10	193	199
cl						cl

A+00

99.66	99.0	99.7	100.01	99.9	99.2	100.24
6.16	6.8	6.1	5.8	5.9	6.1	5.08
20	20	10		10	20	20
cl						cl

3+50

100.21	99.2	100.1	100.1	100.1	100.2	101.29
5.55	6.1	5.7	5.5	5.5	5.6	4.53
20	20	10		10	193	20
cl						cl

105.82

Draper

S.W.D.P. Draper + Center 3.45 106.31 (106.32)

B.M. - P 36

T.P. 8.56 109.76 4.62 101.20

Set B.M. S.W. 3' Disk
Draper + Marine

6.79 99.03

4+95 = Sly Outer line Marine

$\frac{95.52}{80}$	$\frac{98.22}{30}$	$\frac{98.37}{20}$	$\frac{98.06}{10}$	$\frac{98.22}{10}$	$\frac{98.07}{10}$	$\frac{99.01}{20}$	$\frac{99.03}{20}$	$\frac{99.99}{20}$
10.30	7.60	7.45	7.26	7.10	6.95	6.81	6.79	5.83
80	30	20	10		10	20	20	20
							G	Tch. cc.

4+94⁸⁵ = Sly. Ch. line Marine

$\frac{92.16}{80}$	$\frac{98.84}{30}$		7.10	$\frac{6.95}{10}$	$\frac{6.81}{20}$	$\frac{6.79}{20}$	$\frac{5.83}{20}$
9.66	6.98						
80	30						
cc.	cc. E.C.					G	Tch. cc.

4+92 - 23^L Lt. = ctr. cb. Return

$\frac{98.86}{23^L}$	$\frac{98.52}{23}$
6.96	7.50
23 ^L	23
cc	G

4+90⁸ 21^R Rt. = E.C. of curb.
 see sketch p. 35

$\frac{99.00}{21^R}$	$\frac{99.21}{21}$
6.74	5.85
21 ^R	21
G	cc. E.C.

105.82

Levels for Water
Line on Stark St
Imp. Ave to

Brooklyn 1026-25

Begg
Sherman W.D. 600.60
Crawford
1-6-50

INDEXED
N.Y.
JAN 9 1950

42

Brooklyn

975.26

30
30

30 1020

Stark - Baseline

Proposed
Water
Line

0725.26

Akins

0100

1473.9

S.D. & A.R.R.

N. Rail = 1100
& R.R.

Imperial

0100

2.5 x 2.5
50 x 50
2.5 x 17

Stork

0 + 45

208.8
3.8

208.8
3.8
10.1

0 + 43 Wedge Pav

208.35
4.29

208.46
4.18
10.1

0 + 21 Pav.

209.17
3.47

209.30
3.34
10.1

0 + 00 = S cb of Imp. Ave

208.98
3.66
9.57

209.08
3.56
10.1
9.57

Set BM chisel <input type="checkbox"/>			2.93	209.71
TP	3.54	212.64	8.18	209.10
TP	3.00	<u>217.28</u>	7.28	214.28
BM - 65 th SEBP Imperial	0.42	<u>221.56</u>		221.14

of Imp Ave approx E of Stork

212.64

1+10

5.5
207.0

5.2
207.4
10.1

1+00 = N Rail

5.9
209.05

3.4
209.18
10.1

S Rail

5.3
209.0

3.5
209.1
10.1

0+90

5.6
208.0

5.5
208.9
10.1

Note!

Sec. 11 with
Alkins end of Ave
front S. 06 of
to N.L. Atkins St

0+70

4.9
207.2

4.0
207.4
10.1

0+69

3.9
208.2

3.9
208.2
10.1

212.4

212.4

1+25

1

0+50

T.P. 152 20318 1098 201.66

0+25.2 w/ AKING

0+00
1+73.4 = 18
AKING S.

1+50

212.64

ST
1968
4

1981
29

1991
BL

RT
1962
7.0
10

1978
5.4
10

1991
3.7
10

20318

2006
12.0

2006
12.0
10.1

2021
9.9

2021
9.9
10.1

2040
8.6

2041
8.5
10.1

212.64

3

T.P. 1235 212.02 352 199.66

2 + 60

4 + 30

2

1 + 78

1 + 50

20318E
10.1
2014R
10.1
2014
C
10212.021993
3.91995
3.7
101969
C.31972
C.0
101939
9.31946
8.6
101922
10.51928
10.4
101944
8.81943
8.9
1020318

6 + 50

T.P. 1199 24881 019 236,82

6

5 + 50

T.P. 1285 23701 019 22416

5

T.P. 1276 22435 043 211,59

4 + 50

4

3 + 50

21207

Stork
240
87

R+ 240
8.6
10

47

24881

2350
20

2352
18
10

2275
9.5

23701

2191
5.3

22435

2113
0.7

2062
5.8

2034
8.6

21207

2272
9.3
10

2192
5.2
10

2102
1.5
10

2052
5.1
10

2031
8.9
10

60th St. - CROSS SECTIONS
 Walker from Estelle Street
 F. Gregory To Carrol Street
 G. Pope
 R. Sisson
 3-3-50

NO 31768

INDEXED
 W.R.
 MAR 7 1950

Estelle

Fd. City Cap Disc
 PB 1188
 31

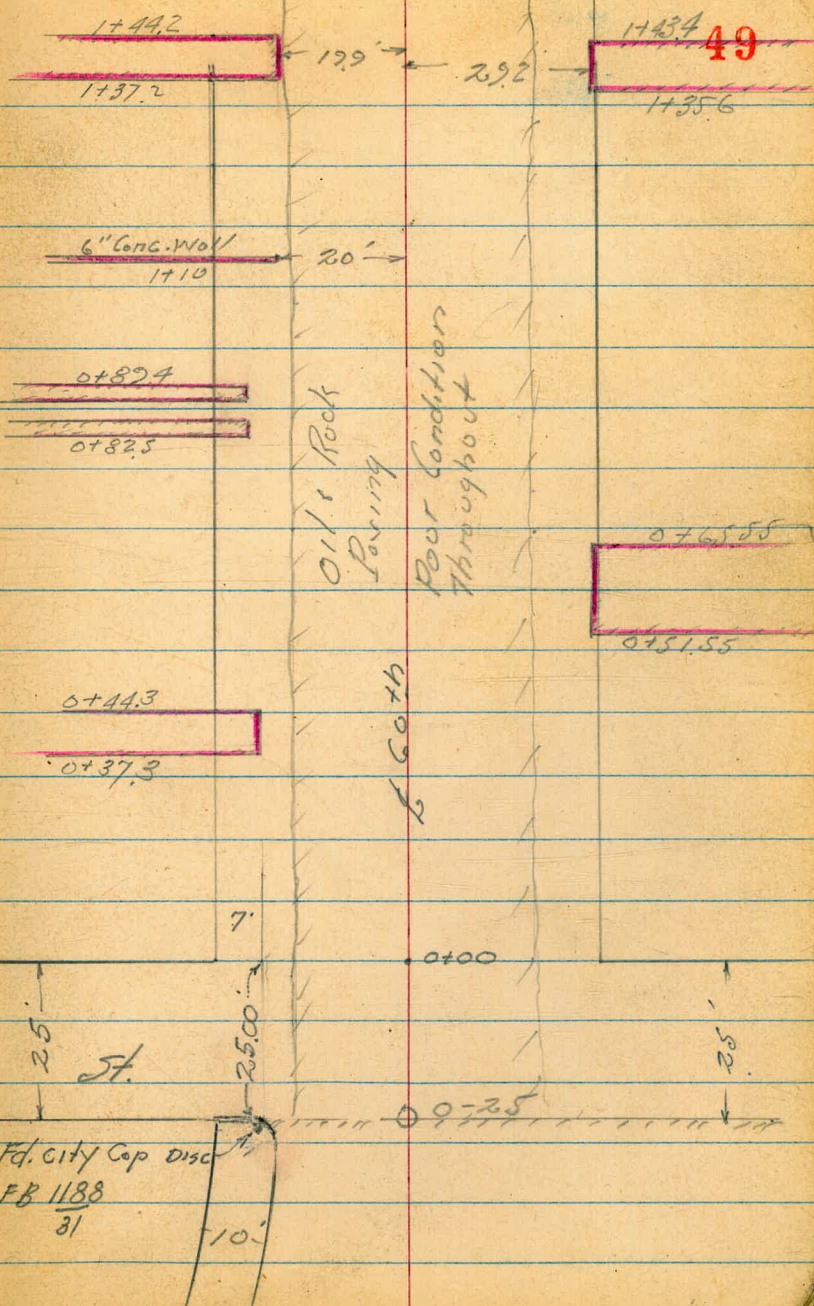

Oil & Rock
 Paring

Poor Condition
 Throughout

5' 60th

25'

7'

25.00'

10'

0+00

0+25

25'

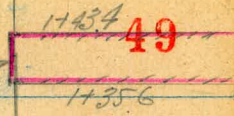
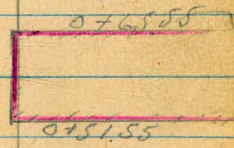

29.2'

19.9'

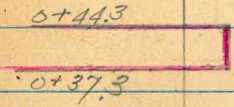
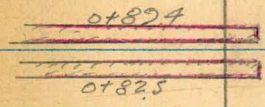

60th St. Cross Sections

50

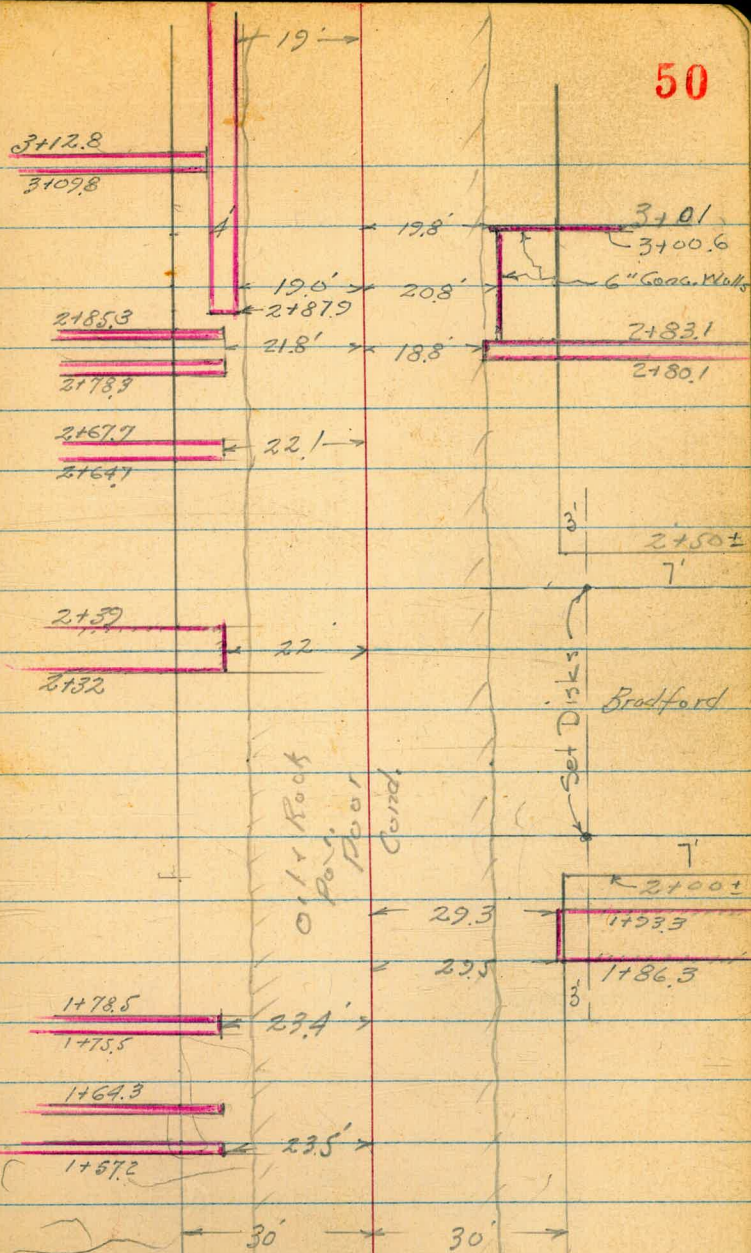

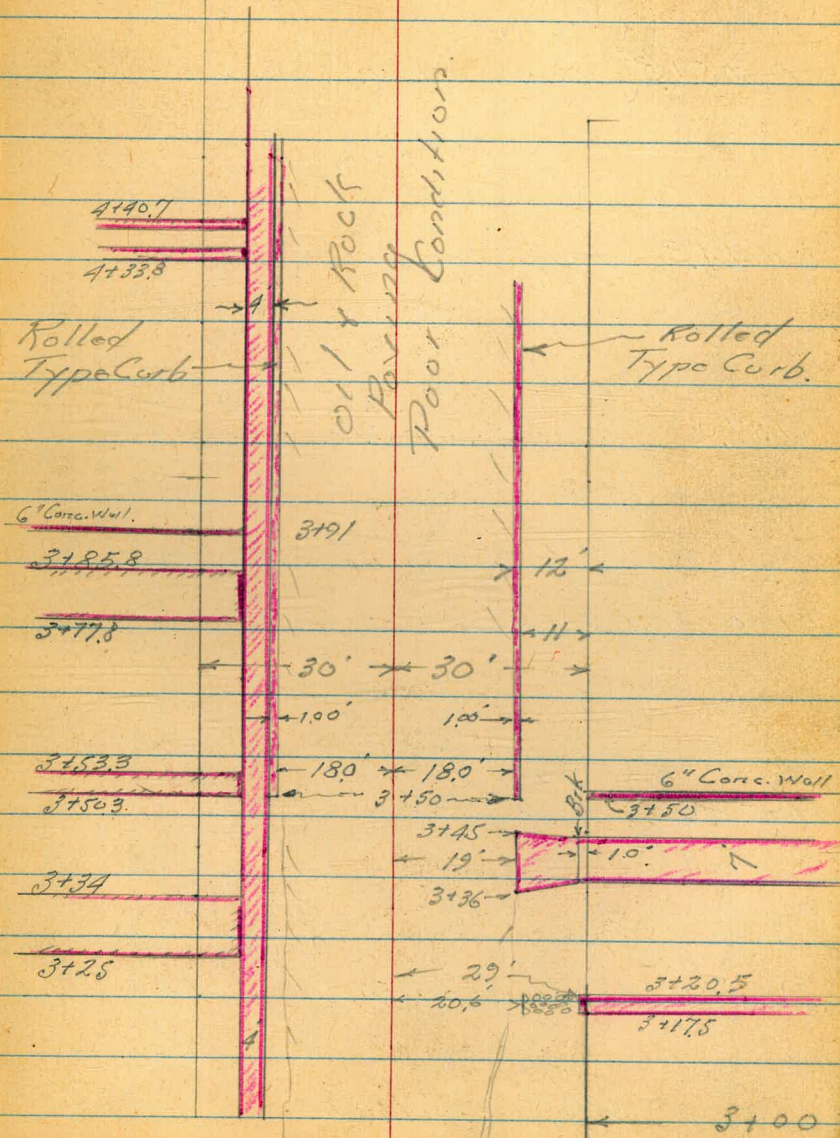

60th St.

Lt.

Rt.

Rt.

52

0 + 51.5⁵⁵ = Edge Drive on Rt

423.78	424.00
108	386
29	39

0 + 44.3 = N edge Drive

423.93	423.79	423.63
393	407	423
40	30	23
on Drive	on Drive	on Drive

0 + 37.5 = South edge Cons. Drive on Lt

423.76	423.60	423.54	423.5	423.8	423.4	422.9	423.4	423.5
410	426	432	53	56	54	49	44	43
40	30	23	15	15	15	17	30	25
on Drive	on Drive	on Drive				Lawn	Lawn	Lawn

0 + 00 = N. line Estelle St.

421.3	421.1	421.0	420.4	420.6	420.7	421.4	421.6	421.9
25	67	68	74	72	71	64	62	60
	30	19	17		17	20	30	35
						on Lawn	on Lawn	on Lawn

0 - 25 = North Edge existing Paving

419.76	419.64	419.15	419.54	420.00	420.31	420.57
810	822	871	832	786	755	739
25	21	21		30	50	75
	on Cb.	Gr.				

0 - 50 = Section on existing Paving

419.52	419.46	419.91	419.23	419.54	419.82
834	840	895	863	832	804
25	21.7	21.5		30	50
on Work	Cb.	Gr.			

9.20 427.86 418.66

B.M. N.W. Estelle < 60th FB 1138-32

60th Street
Cross Sections

Cont. P. 55

1+10

1+00

Nail in Pole on 1+00

T.P. 11.62 438.28 120 426.66

1+00 29' Rt. = Pole = J.T. 177807 Bay Fence on Rt 29' Rt

1+00 = Pole only 20.4' = P 177806

1+00 22.2' Lt Fence + Picket Rd Δ to 60th

0+82.4 = N edge Conc. Ribbon Drive

0+82.5 = S. edge Conc. " "

0+65.3 = N edge Conc Drive on Rt

427.86

53

Lt

Rt

427.64 427.54
10.64 10.74
30 21
on Wall on Top
Conc. Wall

426.3 426.2 426.2 425.8
11.9 12.0 12.0 13.4
35 30 17 15

438.28

426.0 425.8 426.2 425.9 426.0
18 30 16 19 18
15 17 30 35

426.02 425.80 425.69
18.4 20.6 21.7
40 30 24
on Dr. on Dr. on Drive

425.84 425.60 425.48
20.2 23.6 23.8
20 30 24
on Drive on Drive on Drive

425.0 424.9 424.5 424.1 424.1 423.6 424.04 424.18
2.8 2.9 3.3 3.7 3.7 4.2 3.82 3.68
35 30 17 15 15 18 29 39
Lowin Lowin on Drive on Drive

427.86

60TH Street
Cross Sections

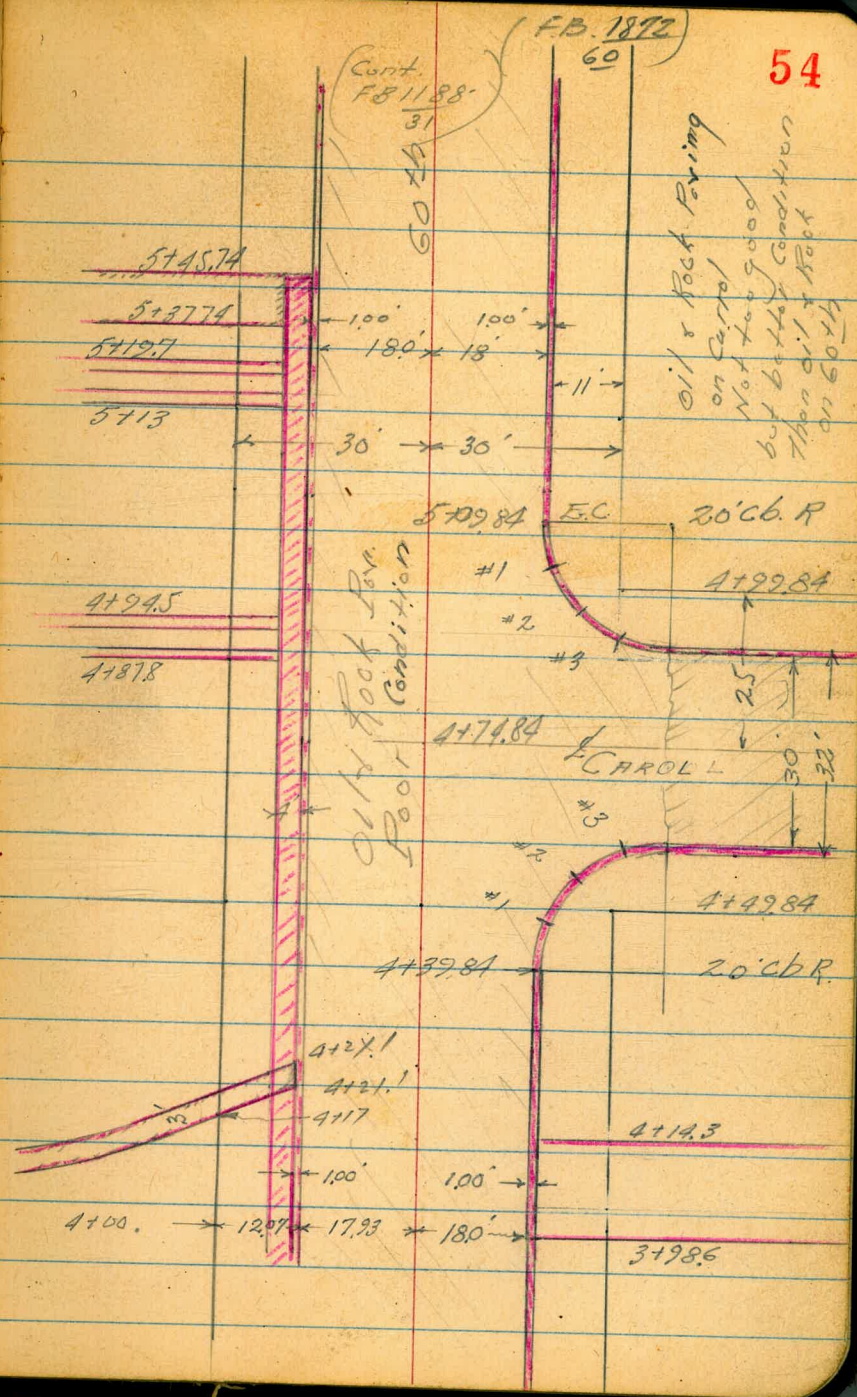

60th St.

Lt

Rt

Rt.

55

Cont. from p-53

1+57.2

430.21	430.21
8.7	8.01
33.5	23.5

1+50 = End 2.5' Picked Fence on Rt. 29.2

429.6	429.5	429.4	429.2	429.5	429.3	429.7	429.3	429.3
8.6	8.7	8.8	9.0	8.7	8.9	8.5	8.9	8.9
35	30	17.	14		18	20	30	35
	in Lawn						in Lawn	in Lawn

1+44.2

429.30	429.18
8.98	9.10
30	19.9
on Dr.	on Dr.

1+43.4 = N edge Conc. Dr.

428.74	428.59
9.54	9.69
39.2	40
on Dr.	on Drive

1+37.2 = S. edge Drive on Lt

429.07	428.89
9.21	9.39
30	19.9
on Dr.	on Drive

1+35.6 = S. edge Dr. on Rt

438.28

428.64	428.55
9.64	9.75
39.2	40
on Drive	on Drive

438.28

60TH St. Cross sections

Lt.

R

Rt

Top Fire Hydr. SE. Bradford 660th
 TP 245 446.58 115 437.13

2100

433.6	433.7	433.6	433.4	433.6	433.3	432.6	433.1	433.7
4.6	4.5	4.6	4.8	4.6	4.9	4.6	5.1	4.5
35	30	17	18		15	13	30	30

1793.3 N. edge Conc. Drive

432.99	433.03
529	525
223	40
Dr.	Dr.

1786.5 - S. edge Conc. Drive

432.96	432.88
532	540
295	40

1778.5 = N edge Walk
 Conc.

432.06	432.12
622	616
33.4	23.4
Walk	Walk

1775.5 = S. edge Conc. Walk

431.98	432.00
630	628
33.4	23.4
on walk	on walk

1764.3

430.99	430.70	438.28
7.79	7.58	
33.5	23.5	

60TH Street

Cross Sections

57

2+45

2+46

196' Lt = 177760 Elec. Pole

2+39 = Hedge Conc. Dr.

2+32 S. " " "

2+25 ± = Bradford Street

2+12

2+10

2+05

Lt.

\$

Rt.

437.1	437.1	437.1	437.1	436.8	436.6	436.8		
94	94	94	9.1	97	99	97		
25	30	14		16	30	80		
Low	Low							
	436.57	436.91						
	10.01	967						
	32	22						
	Drive	Drive						
	436.44	436.69						
	10.14	989						
	32	22						
	Drive	Drive						
435.6	435.8	435.8	435.4	435.76	435.5	435.6	435.1	
10.9	107	107	11.1	10.82	11.0	10.9	10.4	
38	30	17	14	Rim	22	30	80	
Low	Low			MM				
434.7	434.8	434.7	434.3	434.5	434.4	434.8	435.5	
11.8	11.7	11.8	12.2	12.0	12.1	11.7	11.0	
25	30	17	15		17	30	80	
	in low							
434.5	434.5	434.5	434.2	434.3	434.3	434.9	434.3	435.7
12.0	12.0	12.0	12.3	12.2	12.2	11.6	11.2	10.8
35	30	17	15		16	20	30	80
in low	in low							
433.9	434.0	434.0	433.7	433.9	433.9	434.4	434.6	435.4
12.6	12.5	12.5	12.8	12.6	12.6	12.1	11.9	11.1
35	30	17	15		15	20	30	80
in low	in low			446.58				

60th St. Cross sections

2+85.3

2+78.3 = South edge Conc. Ribbon Drive

2+67.7 = N. edge Conc. Walk

2+64.7 = South edge Conc. Walk

2+55

2+50 = N. side Bradford in Pt.

2+47

440.99	441.26
559	532
32	21.8
Drive	Drive

440.89	441.01
562	557
32	21.8
Drive	Drive

439.70	439.86
688	672
32	22.1
Walk	Walk

439.67	439.77
691	681
32	22.1
Walk	Walk

438.3	438.4	438.7	438.1	438.3	437.8	438.3	438.1	440.3	440.1	439.7
82	8.1	7.8	8.4	8.2	8.7	8.2	8.1	6.2	6.4	6.8
35	30	17	13		18	19	21	24	30	35
Low	Low						Low	Low		

437.7	437.7	438.2	437.6	437.9	437.4	437.8	437.6	437.7
8.8	8.8	8.3	8.9	8.6	9.1	8.7	8.9	8.8
35	30	17	14		17	19	30	80
Low	Low							

437.4	437.5	437.7	437.3	437.6	437.1	437.6	437.5	437.5
9.1	9.0	8.8	9.2	8.9	9.4	8.7	9.0	9.0
35	30	17	14		18	20	30	80
Low	Low							

446.58

60th St. Cross Sections

3+00

2+87.9 = Beg 4.0' Conc. Walk

~~3700~~

2+85.1 = Brk 17' Walk

2+83.1 = Beg 6" Conc. Walk

2+83.1

2+80.1 = South edge Conc. Walk

Lt

R

Brk

59

442.4

4.1

442.3

4.2

442.8

3.7

442.9

3.6

443.56

3.02

20.8

20.8

9d

on Walk

441.25

5.30

23.0

on Walk

441.25

5.33

19.0

on Walk

442.18

4.40

20.8

on Walk

442.48

4.10

20.8

on Walk

441.36

5.22

18.8

Walk

442.14

4.44

28.8

Walk

442.73

3.85

38.8

Walk

Brk

441.16

5.42

18.8

Walk

442.13

4.45

28.8

Walk

442.71

3.87

38.8

Walk

446.58

60th St - Cross Sections

3+25 = South edge Conc. Drive

3+19 = 3' Walk on Rt.

T.P. 11.75 456.54 172 444.72

3+12.8 = N. edge Conc. Walk

3+09.8 = South edge Conc. Walk

3+00.85 = 6" Conc. Wall

3+00 Cont.

Cont. from P-59 446.58

444.89 Lt. 11.65 33 Drive
 444.64 Rt. 11.90 23 Drive

Rt 60

444.99 11.55 206 017 Flag Stone Walk
 446.04 10.50 29 Conc. Walk
 456.54

443.69 2.89 30 Walk
 443.27 3.11 23 Walk

443.60 2.58 30 Walk
 443.24 3.34 23 Walk

443.72 2.86 19.8 on Wall
 444.59 1.99 30 on Wall

443.3 32 35 Lawn
 443.1 34 21.3 Lawn at Wall
 443.21 42.3 23 Lawn
 442.35 42.3 19.0 Walk
 441.9 4.6 15

443.1 34 21.3 Lawn at Wall
 443.6 2.9 30 Lawn
 443.9 2.6 35 Lawn

446.58

60th Street

3+50 20' H = Pole # 176987

3+50 288' RT = Pole # JP 17650X

3+50 = Beg. Rolled Curb (Both Sides)

3+48 19' 2" Pole # 176087

(1-9-51)

3+47 22' RT = 3" Plumosa Palm

3+45 = Beg. Conc. Drive

3+44

3+37

3+36

3+34

447.3
447.2
446.90
446.80
446.7
447.1
447.1
447.34
448.2
450.77

92 93 94 94 94 94 92.0 8.3 5.77
35 30 23 19 18 94 19 29.8 29.8
Top cb Ground Top cb Top Well

446.9A

9.60
19
DRIVE

447.79

8.75
29
DRIVE

448.09

8.45
39
DRIVE

447.61

8.95
29
DRIVE

447.99

8.55
39
DRIVE

446.31

10.23
19
DRIVE

445.30

11.24
39
DRIVE

445A3

11.11
29
DRIVE

This Drive Slopes West on North Side

456.54

60th Street-Cross Sections

1700

452.9
3.6
25
LAWN

452.8
37
38
LAWN

452.06
4.98
2293
WALK

452.09
4.45
1893
TOPG

451.8
4.7
18
GUT
Gravel

452.1
4.4
DRIVE

452.63
3.91
19
DRIVE

452.94
2.60
30
DRIVE
BIT

62
453.08
3.46
40
DRIVE

3798.6

452.99
4.05
15
DRIVE

452.86
3.68
30
DRIVE
BIT

3791 2/2 6" Conc. Wall

452.06

452.10

451.18

4.48
41
Wall

4.44
31
Wall

5.36
23
Conc. Wall

3785.8

450.35
6.12
33
DRIVE

450.51
5.27
23
DRIVE

3777.8

449.93
6.61
33
DRIVE

449.85
6.69
23
DRIVE

3753.3

447.68
8.86
33
WALK

447.23
9.31
28
WALK

3750.3

447.46
9.08
33
WALK

446.96
9.58
23
WALK

456.54

60th Street - Cross Sections

4+33.8 - South edge Conc. Drive

4+24.1

4+22.2

4+21.1

4+19.6

4+17

4+14

Lt. Lt. Lt.
 455.34 455.54 455.32
 20 102 122
 30 23 19
 Walk Topcb

454.41 454.16
 213 208
 19 19
 Topcb Walk

454.24
 230
 23
 Walk

454.14 454.18
 240 236
 19 19
 on Topcb Walk

454.24
 230
 23
 Walk

454.28
 236
 30
 Walk

454.01 454.16 453.20
 253 238 334
 19 305 44
 Drive 8'k Floor
 Topcb Drive Garage

456.54

4+74.84 = $\frac{1}{2}$ Corrol

459.1	459.6	458.57	458.23	458.6	458.9	459.1	459.1	458.7
70	68	7.87	8.21	7.8	7.5	7.3	7.3	7.7
35	30	19	18	19	30	30	55	80
		Top cb.	Conc. Gut	Toe Rolled Curb	Rock	Rock	Rock	Rock

4+72 = $\frac{1}{2}$ Sewer MH

458.82
792
Sewer MH

4+58.84 Corrt.

458.3	458.3	456.38	457.33	457.02	457.10	458.18	458.14	458.47	458.40	458.47
8.1	8.1	206	2.11	2.42	2.34	826	830	797	824	797
35	30	23	19	18	18	85	55	55	80	80
		Walk	Top cb.	Conc. Gut	Grav. Gut.	Toe Gut	Toe Gut	Top cb.	Toe Gut	Top cb.

4+58.84 = Back edge Rolled Curb on Rt.

457.5	457.6	457.9	458.08	458.40
8.9	8.8	8.5	836	804
17	30	30	38	38
			Gut. Oil + Rock	Top cb.

4+39.84 = B.C. 20' cb. R on Rt

on cb West side

T.P. 10.35 466.44 0.95 456.09

455.43	455.63	455.91	455.80	455.6	455.9	455.95	456.32	457.1	457.7	458.6
110	1081	1053	1064	108	10.5	1049	1012	93	87	78
35	30	23	19	16	18	18	19	38	30	35
Walk Drive	Walk Drive	Walk Drive	Top cb.	Top cb.	Toe Conc. Curb	Top cb.	Top cb.	Lawn	Lawn	Lawn

466.44

4+40.7

456.54

455.69	455.99	455.88
0.85	0.55	0.66
30	23	19 = cb.
Drive	Walk Drive	456.54

66th Street Cross

Lt.

Rt.

Rt.

65

5+09.84 = E.C. 20' Curb R 012 Rt.

461.1	461.0	460.80	460.80	460.44	460.8	460.77	461.10	461.9	462.4
59	54	564	564	6.00	5.6	567	534	45	40
38	30	23	19	18		18	19	30	25
	Low					Top Rolled Curb	Top Cb.	Low	Low

4+945 = H. edge Conc. Ribbon Dr

460.19	460.46	459.89
625	598	655
41	31	23
Dr.	Dr.	DRIVE

4+90.84 Cont.

459.94	459.03	459.31
650	741	713
55	80	80
on Cb.	Conc. Curb	Top Cb.

4+90.89 = Back edge Rolled Curb

460.4	459.69	459.61	459.5	459.7	459.7	459.73	460.11	459.63
630	675	683	69	67	67	671	633	681
30	23	19	18		30	38	38	55
Ground	Walk	Walk	Grave		Conc. Curb	Top Rolled Curb	Conc. Curb	

4+87.8

460.19	460.41	459.48
625	603	696
404	304	23
Drive	Bk. in Drive	Drive

466.44

60th St. Cross sections

Lt

Rt

Rt

66

Cont. P-67

7+71.4 = Sl. E. Canyon FB 1188-39

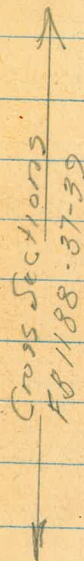

T.P. Cont. P67

0.80 464.05 463.25

FB 1188-37

0.02

463.27

chk Top cb 19'84 5+60.6 319

463.25

5+45.74 = End of Conc. Walk on Lt

462.69	462.64	462.52	462.57	462.13	462.44	462.92	462.71	463.2	463.44
37.5	38	29.2	39.7	43.1	4.0	40.2	37.3	3.2	30
35	30	27	19	18		18	19	30	35
Drive	Drive	Walk	cb	Top Rolled cb		Ent. Top Rolled cb	cb	Lowm.	

5+37.74 = South edge Conc. Drive

466.44

462.27
17
30
Drive

462.11
23
23
Drive

466.44

60th St.
Elevations Curb Returns
at Carroll

Completed 3-6-50

chk TP on cb West side P-64 797 $\frac{901}{456.09}$
456.08

N.E. Return

S.E. Return

67

460.75	460.48	460.26
3.30	3.57	3.79
#1	#2	#3
on cb	on cb	on cb

456.99	457.65	458.14
7.06	6.40	5.21
#1	#2	#3
on cb	on cb	on cb

464.05 from P-66

Moore
Begg
Sherman 3/30/50
Crawford

X Sec Rose Lawn

W 031830

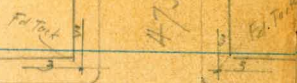

47 ft

INDEXED

MAR 31 1950

see 1715/69

47 ft

$\Delta 89^{\circ}58'$

Tan on $\phi = 59.97$

$L = 94.21$

$R = 60$

Mon. will be
taken out
by const.

ENTERED -
TP Sheet # 3646
3-8-51-MCQ
chis cross

68

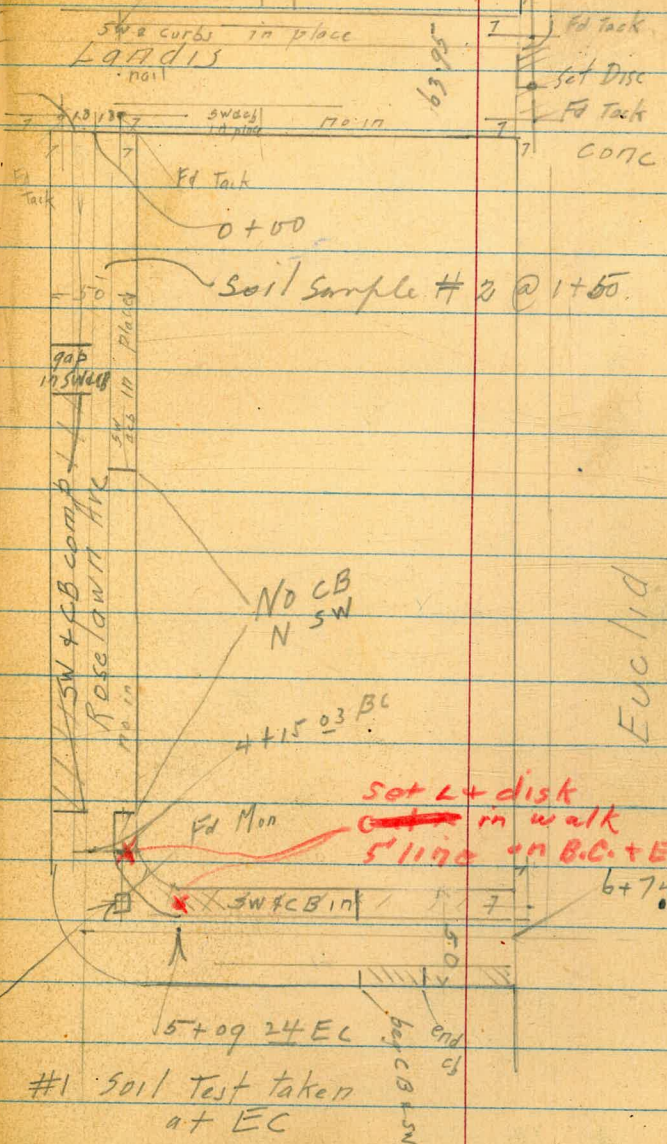

1 + 36 1/2' wide Drive RT

1 + 21 13' Drive Lt

1 + 00

0 + 91 13' Drive RT

0 + 85 13' Drive Lt

0 + 61 13' Drive Lt 15

0 + 50

0 + 00 S line Landis

619 342.33

342.14

Reduced by amount
4.50

338.53
380 4.25
19 15

338.85
348 4.3
26 15.9

339.15
318 5.71
19 15

339.47
326 3.34
19 15

339.58
275 3.4
CB 15 7

340.39
194 2.7
26 15

Hyd Rose lawn Landis

338.08

338.0

338.62

338.99

338.9

339.6

338.1

338.62

338.8

339.7

5.337.21

15-

337.7

337.93

4.40 15-

338.4

3.7 15-

339.2

3.1 15-

337.67

4.66 19

338.19

4.14 CB

3.91 19

338.96

3.7 15-

339.85

3.48 CB

342.37
175/71

Rose lawn

3+10

3' walk Lt

3+00

2+90 12' Drive Rt

2+50 MH beg SW & CB on Rt

2+41 Driveway

2+00 end of SW & CB on Rt

1+90 12' Drive Rt

1+50 end of cb & SW on the left

342.33



L

336.20
6.13

335.9
27
6.4
25

335.0
7.3
15

336.5
5.8
25

335.3
7.0
15

339.5
4.8
25

336.1
6.2
15

338.1
4.2
25

338.04
4.29
25

337.0
5.3
15

337.2
5.1
9

336.8
5.5
15

337.42
4.91
25

342.33

R

70

334.7
7.6

334.4
7.9
15

334.99
7.34
25

334.75
7.58
15

335.21
7.12
19

335.3
7.0
15

334.8
7.5
15

335.79
6.54
25

336.13
6.20
24
7.5 wide

336.0
6.3
15

335.9
6.4
15

336.68
5.65
25

336.16
5.7
25

336.42
5.91
15

337.87
4.46
19

Roselawn

71

#1

curve in 4 equal parts

333.78
4.37
cb
15

333.2
4.9
15

333.0
5.1

333.0
5.1
15

332.9
5.2
15

H + 15 03

BC

333.84
4.31
cb
15

333.4
4.7
15

333.2
4.9

333.2
4.9
15

333.6
4.5
15

TP 474 338.15 8.92 333 41

338 15

4+00 beg CB 0.5W on Lt
end CB 0.5W on R.

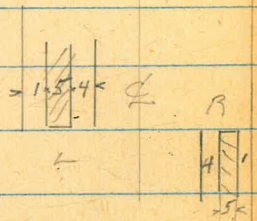

335.1
7.2
8.5

334.03
8.30
cb

333.7
8.6
15

333.5
8.8

333.3
9.0
15

333.50
8.83
15
cb

3+50

25' W Driveway RT

335.7
6.6
8.5

334.6
7.1
15

334.3
8.0

333.8
8.5
15

333.83
8.50
15
drive

334.40
7.93
19

3+39

drive 7.5 wide

336.09
6.24
26.5

335.9
6.4
8.5

334.9
7.4
15

334.5
7.8

334.0
8.3
15

334.49
7.84
cb
15

3+35

342.33

342.33

Rose lawn

6+00

5+74.6

beg CB & SW on Rt
end " " " Lt



5+24

5+09.24 EC

#3 cont'd

#3

#2

338.15

335.4
2.7
25

334.5
3.6
15

334.9
3.2
15

334.2
3.9
15

334.49
3.66
15

72

334.83
3.32
24
Swalk

334.69
3.48
15

334.2
3.9
15

334.4
3.7
15

333.9
4.2
15

334.20
3.95
15

334.34
3.81
24
Swalk

334.35
3.80
15

333.7
4.4
15

334.0
4.1
15

333.7
4.4
15

333.74
4.41
25
Swalk

333.96
4.19
15

333.8
4.8
15

333.2
4.9
15

332.9
5.2
15

332.9
5.2
25

333.79
4.36
15

333.1
5.0
15

332.8
5.3
15

332.5
5.6
15

332.5
5.6
25

330.9
7.8
40.55

324.5
13.6

314.1
23.0
95

bottom of
draw

333.74
4.41
15

333.0
5.1
15

332.8
5.3
15

332.8
5.3
15

332.8
5.3
25

333.2
4.9
35
RIM

338.15

0.56 342.16 342.14

Hydrant p 69

8.45 342.70 2.90 334.25

+ 12 W curb line Euclid

336.19	335.76	335.76	335.33	335.15	334.86	335.33	334.40	334.78
1.6	2.39	2.39	2.82	3.00	3.29	2.82	3.75	3.37
25	46	25	25		25	25	50	25

6 + 74 1/2 W line Euclid full return Rtd Lt

335.95

2.20
25

335.74	335.44	335.38	335.32	335.18	335.12	335.86	335.51
2.41	2.71	2.77	2.83	2.97	3.03	2.79	2.64
25	15	75	9	75	15	15	25

Conc Paving

6
+ 60

336.5	335.4	335.5	335.3	336.1	335.8
1.6	2.7	2.6	2.8	2.0	2.3
25	15		10	15	25

6
+ 24 end of SW & CO on Rt

335.7	335.0	335.4	334.8	334.81	335.05
2.4	3.1	2.7	3.3	3.34	3.10
25	15		15	25	24

Walk

6
+ 14 9th Drive Rt

334.27	335.28
2.88	3.43
15	19

338.15

338.15

v-20-50 Levels for drain

Hoops on Roselawn
 Bc99 E of Euclid Ave
 Crawford
 W/O 3/830

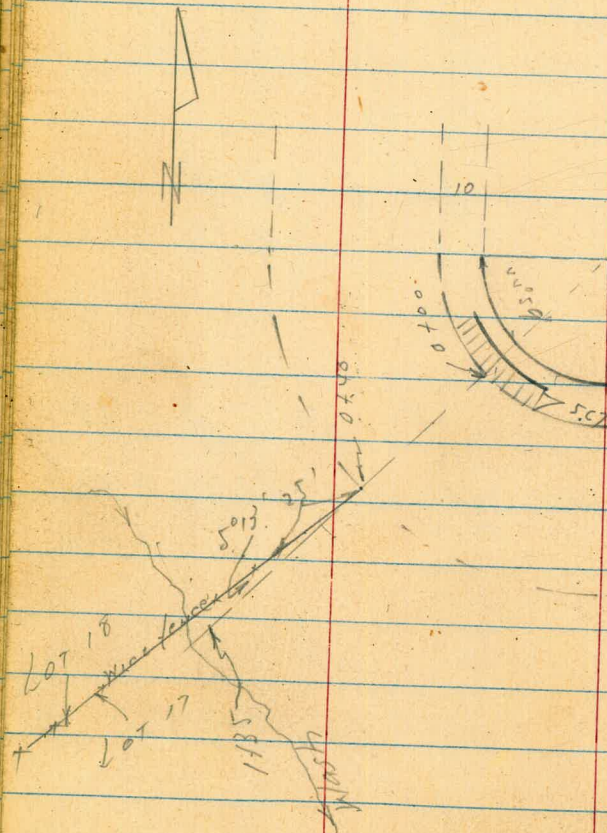

Station	Left	Right	Pr
0+90	335.6 2.0 10	328.2 14.4	329.0 18.6 7
0+75	328.1 14.5 10	325.0 12.6	326.4 11.2 6
0+50 old Fill	333.2 10	333.2 10	332.9 10
0+40	333.0 10	332.7 10	332.8 10
0+30	332.8 10	332.9 10	332.9 10
0+15 E Roselawn	332.8 10	332.8 10	332.8 10
0+100 qt dirt	333.0 4.6 10	332.9 4.7	333.0 4.6 10
0+00 Top Curb	333.76 3.92 10	333.74 3.92 10	333.76 3.92 10
Top curb EC P.T.2	372	337.68	333.96 P.T.2

P.M. for drain Levels

Lr

€

Pt

75

14.35 Wash

14.05

312.3
25.3
10

313.9
23.7
10

312.8
24.8

315.0
22.6

313.6
24.0
7

315.3
22.3
8

3376.8

Roberts
Moore
Clark
9-18-50
W.O. 31511

Survey Relocate Storm Drain
Poplar and Tuberosa

FB 628 pg 7 - 7857L

76

INDEXED
M.K.
SEP 19 1950

83
47
36

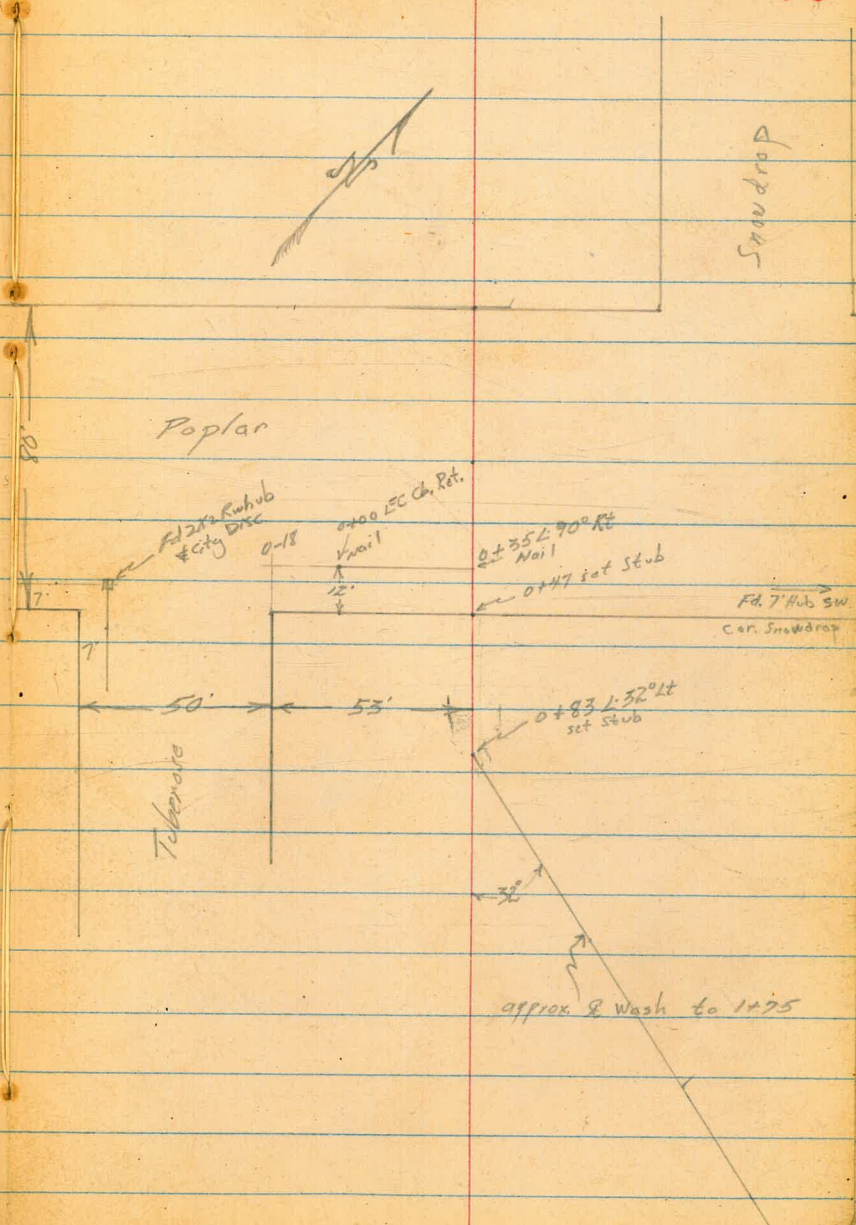

Levels along \pm of New Loc. for Sewer
in Brooklyn - 66⁺¹ to 65⁺¹

See P 16 for sketch

1+35

T.P. 12.84 270.12 ✓ 0.11 257.28 ✓

1+08.60 = Ang. 10° 01' 30" Rt.

0+80

T.P. 12.70 257.39 ✓ 0.48 ✓ 244.69 Iron pin 0+50 -Rt.

0+40

0+04 = \pm Wash

B.M. 12.68 245.17 232.52 = Mon - P. 21

Lt. \pm Rt. 78

257.9
12.2 10 4 259.7 260.1
10 10

270.12 ✓

239 on Hub. 255.00
244.0 13.4 10 8.9 248.5 250.6
10 6.8 10

257.39 ✓

232.3 12.9 10 1 235.1 237.7
10 7.5 10

12.8 232.4

12.94 232.23
on Hub. - P. 20

245.17

Lt.

Rt

79

Check B.M. = Φ Id. ct. 65th + Brooklyn 307 267.05

-267.09 - Book 1603 - P. 55

5+00 = End. - High ground on Rt.

259.1
11.02
on Hub.

4+62 - 48.5' Lt = Φ Small frame House

249.5 257.1
20.67 13.07
Dirt floor of 48.5' = floor-top.
Basement - No
Plumbing

4+50

11.4 258.7

4+00

253.7 259.1
16.4 11.0 10.5 10.4
75 10 10 10

3+60

9.4 260.7

3+20

259.0 261.9
11.1 8.2 7.7 7.8
75 10 10 10

2+80 = Beg. Graded Road.

5.3 264.8

2+35

257.1 266.5
13.0 3.6 2 1.4
100 10 6 10

1+87.47 = P.O.T. Hub

265.19
493 on Hub

1+75

5.9 264.2
270.12

Extend Prop. Sewer in Bitteren from 5+80
 See P. 17 - for sketch - P. 31 for Notes
 # 4300
 W.O. 31187
 9-27-51 - 70.
 From Madera to Klauber

Lt.

±

Rt.

80

INDEXED
 Law
 SEP 28 1951

on Klauber

3 new Houses at Klauber - Seem to be

9+75 - 99' Rt. = N.E. Cor. House - Conn.

375.3 361.9
 99
 ground floor

9+35

373.3

9+30 - Lot Line - Can angle over from east House

372.9 369.10
 30 = Lot pipe

9+00

370.4

8+77 - 92' Rt. = Conn. at N.E. Cor. House

363.3 366.67
 92 = ground floor

8+50

365.8

8+00

360.6

7+90 - 89.3' Rt. = Back - N.E. Cor. of House = Sewer Conn.

354.9 360.17
 89.3 ground floor

7+50

354.3

7+12 - 68.6' Rt. = Conn. by Bathroom on uphill side of House

346.50 345.2
 68.6 = floor ground

7+00

347.0

6+40

339.0

5+77 - 71' Rt. = Pt. of Conn. to New House - Basement
 = uphill side of House

334.83 325.23
 upper floor Pipe in
 Basement

B.M. = stab. - 5+80 - P. 21

331.96

Used Elev. Rod. actual Elev. shown.

775/31
3/00

1212.64

13 07
76
20.67

39
25
64

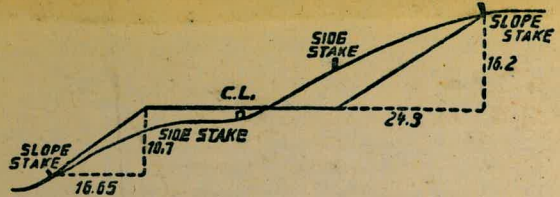

DISTANCES FROM SIDE STAKES FOR CROSS-SECTIONING.
SLOPE 1 1/2 TO 1. ROADWAY OF ANY WIDTH.

	0	.1	.2	.3	.4	.5	.6	.7	.8	.9	
0	0.00	0.15	0.30	0.45	0.60	0.75	0.90	1.05	1.20	1.35	0
1	1.50	1.65	1.80	1.95	2.10	2.25	2.40	2.55	2.70	2.85	1
2	3.00	3.15	3.30	3.45	3.60	3.75	3.90	4.05	4.20	4.35	2
3	4.50	4.65	4.80	4.95	5.10	5.25	5.40	5.55	5.70	5.85	3
4	6.00	6.15	6.30	6.45	6.60	6.75	6.90	7.05	7.20	7.35	4
5	7.50	7.65	7.80	7.95	8.10	8.25	8.40	8.55	8.70	8.85	5
6	9.00	9.15	9.30	9.45	9.60	9.75	9.90	10.05	10.20	10.35	6
7	10.50	10.65	10.80	10.95	11.10	11.25	11.40	11.55	11.70	11.85	7
8	12.00	12.15	12.30	12.45	12.60	12.75	12.90	13.05	13.20	13.35	8
9	13.50	13.65	13.80	13.95	14.10	14.25	14.40	14.55	14.70	14.85	9
10	15.00	15.15	15.30	15.45	15.60	15.75	15.90	16.05	16.20	16.35	10
11	16.50	16.65	16.80	16.95	17.10	17.25	17.40	17.55	17.70	17.85	11
12	18.00	18.15	18.30	18.45	18.60	18.75	18.90	19.05	19.20	19.35	12
13	19.50	19.65	19.80	19.95	20.10	20.25	20.40	20.55	20.70	20.85	13
14	21.00	21.15	21.30	21.45	21.60	21.75	21.90	22.05	22.20	22.35	14
15	22.50	22.65	22.80	22.95	23.10	23.25	23.40	23.55	23.70	23.85	15
16	24.00	24.15	24.30	24.45	24.60	24.75	24.90	25.05	25.20	25.35	16
17	25.50	25.65	25.80	25.95	26.10	26.25	26.40	26.55	26.70	26.85	17
18	27.00	27.15	27.30	27.45	27.60	27.75	27.90	28.05	28.20	28.35	18
19	28.50	28.65	28.80	28.95	29.10	29.25	29.40	29.55	29.70	29.85	19
20	30.00	30.15	30.30	30.45	30.60	30.75	30.90	31.05	31.20	31.35	20
21	31.50	31.65	31.80	31.95	32.10	32.25	32.40	32.55	32.70	32.85	21
22	33.00	33.15	33.30	33.45	33.60	33.75	33.90	34.05	34.20	34.35	22
23	34.50	34.65	34.80	34.95	35.10	35.25	35.40	35.55	35.70	35.85	23
24	36.00	36.15	36.30	36.45	36.60	36.75	36.90	37.05	37.20	37.35	24
25	37.50	37.65	37.80	37.95	38.10	38.25	38.40	38.55	38.70	38.85	25
26	39.00	39.15	39.30	39.45	39.60	39.75	39.90	40.05	40.20	40.35	26
27	40.50	40.65	40.80	40.95	41.10	41.25	41.40	41.55	41.70	41.85	27
28	42.00	42.15	42.30	42.45	42.60	42.75	42.90	43.05	43.20	43.35	28
29	43.50	43.65	43.80	43.95	44.10	44.25	44.40	44.55	44.70	44.85	29
30	45.00	45.15	45.30	45.45	45.60	45.75	45.90	46.05	46.20	46.35	30
31	46.50	46.65	46.80	46.95	47.10	47.25	47.40	47.55	47.70	47.85	31
32	48.00	48.15	48.30	48.45	48.60	48.75	48.90	49.05	49.20	49.35	32
33	49.50	49.65	49.80	49.95	50.10	50.25	50.40	50.55	50.70	50.85	33
34	51.00	51.15	51.30	51.45	51.60	51.75	51.90	52.05	52.20	52.35	34
35	52.50	52.65	52.80	52.95	53.10	53.25	53.40	53.55	53.70	53.85	35
36	54.00	54.15	54.30	54.45	54.60	54.75	54.90	55.05	55.20	55.35	36
37	55.50	55.65	55.80	55.95	56.10	56.25	56.40	56.55	56.70	56.85	37
38	57.00	57.15	57.30	57.45	57.60	57.75	57.90	58.05	58.20	58.35	38
39	58.50	58.65	58.80	58.95	59.10	59.25	59.40	59.55	59.70	59.85	39
40	60.00	60.15	60.30	60.45	60.60	60.75	60.90	61.05	61.20	61.35	40
41	61.50	61.65	61.80	61.95	62.10	62.25	62.40	62.55	62.70	62.85	41
42	63.00	63.15	63.30	63.45	63.60	63.75	63.90	64.05	64.20	64.35	42
43	64.50	64.65	64.80	64.95	65.10	65.25	65.40	65.55	65.70	65.85	43
44	66.00	66.15	66.30	66.45	66.60	66.75	66.90	67.05	67.20	67.35	44
45	67.50	67.65	67.80	67.95	68.10	68.25	68.40	68.55	68.70	68.85	45
46	69.00	69.15	69.30	69.45	69.60	69.75	69.90	70.05	70.20	70.35	46
47	70.50	70.65	70.80	70.95	71.10	71.25	71.40	71.55	71.70	71.85	47
48	72.00	72.15	72.30	72.45	72.60	72.75	72.90	73.05	73.20	73.35	48
49	73.50	73.65	73.80	73.95	74.10	74.25	74.40	74.55	74.70	74.85	49
50	75.00	75.15	75.30	75.45	75.60	75.75	75.90	76.05	76.20	76.35	50

THE NATIONAL BLANK BOOK COMPANY
HOLYOKE MASSACHUSETTS
NEW YORK CHICAGO BOSTON SAN FRANCISCO