

2039

TRAVEL DIARY

MICROFILMED
DEC 31 1964

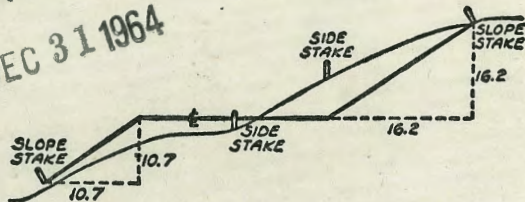

DISTANCES FROM SIDE STAKES FOR CROSS-SECTIONING
SLOPE 1 TO 1. ROADWAY OF ANY WIDTH

	0	.1	.2	.3	.4	.5	.6	.7	.8	.9	
0	0.00	0.10	0.20	0.30	0.40	0.50	0.60	0.70	0.80	0.90	0
1	1.00	1.10	1.20	1.30	1.40	1.50	1.60	1.70	1.80	1.90	1
2	2.00	2.10	2.20	2.30	2.40	2.50	2.60	2.70	2.80	2.90	2
3	3.00	3.10	3.20	3.30	3.40	3.50	3.60	3.70	3.80	3.90	3
4	4.00	4.10	4.20	4.30	4.40	4.50	4.60	4.70	4.80	4.90	4
5	5.00	5.10	5.20	5.30	5.40	5.50	5.60	5.70	5.80	5.90	5
6	6.00	6.10	6.20	6.30	6.40	6.50	6.60	6.70	6.80	6.90	6
7	7.00	7.10	7.20	7.30	7.40	7.50	7.60	7.70	7.80	7.90	7
8	8.00	8.10	8.20	8.30	8.40	8.50	8.60	8.70	8.80	8.90	8
9	9.00	9.10	9.20	9.30	9.40	9.50	9.60	9.70	9.80	9.90	9
10	10.00	10.10	10.20	10.30	10.40	10.50	10.60	10.70	10.80	10.90	10
11	11.00	11.10	11.20	11.30	11.40	11.50	11.60	11.70	11.80	11.90	11
12	12.00	12.10	12.20	12.30	12.40	12.50	12.60	12.70	12.80	12.90	12
13	13.00	13.10	13.20	13.30	13.40	13.50	13.60	13.70	13.80	13.90	13
14	14.00	14.10	14.20	14.30	14.40	14.50	14.60	14.70	14.80	14.90	14
15	15.00	15.10	15.20	15.30	15.40	15.50	15.60	15.70	15.80	15.90	15
16	16.00	16.10	16.20	16.30	16.40	16.50	16.60	16.70	16.80	16.90	16
17	17.00	17.10	17.20	17.30	17.40	17.50	17.60	17.70	17.80	17.90	17
18	18.00	18.10	18.20	18.30	18.40	18.50	18.60	18.70	18.80	18.90	18
19	19.00	19.10	19.20	19.30	19.40	19.50	19.60	19.70	19.80	19.90	19
20	20.00	20.10	20.20	20.30	20.40	20.50	20.60	20.70	20.80	20.90	20
21	21.00	21.10	21.20	21.30	21.40	21.50	21.60	21.70	21.80	21.90	21
22	22.00	22.10	22.20	22.30	22.40	22.50	22.60	22.70	22.80	22.90	22
23	23.00	23.10	23.20	23.30	23.40	23.50	23.60	23.70	23.80	23.90	23
24	24.00	24.10	24.20	24.30	24.40	24.50	24.60	24.70	24.80	24.90	24
25	25.00	25.10	25.20	25.30	25.40	25.50	25.60	25.70	25.80	25.90	25
26	26.00	26.10	26.20	26.30	26.40	26.50	26.60	26.70	26.80	26.90	26
27	27.00	27.10	27.20	27.30	27.40	27.50	27.60	27.70	27.80	27.90	27
28	28.00	28.10	28.20	28.30	28.40	28.50	28.60	28.70	28.80	28.90	28
29	29.00	29.10	29.20	29.30	29.40	29.50	29.60	29.70	29.80	29.90	29
30	30.00	30.10	30.20	30.30	30.40	30.50	30.60	30.70	30.80	30.90	30
31	31.00	31.10	31.20	31.30	31.40	31.50	31.60	31.70	31.80	31.90	31
32	32.00	32.10	32.20	32.30	32.40	32.50	32.60	32.70	32.80	32.90	32
33	33.00	33.10	33.20	33.30	33.40	33.50	33.60	33.70	33.80	33.90	33
34	34.00	34.10	34.20	34.30	34.40	34.50	34.60	34.70	34.80	34.90	34
35	35.00	35.10	35.20	35.30	35.40	35.50	35.60	35.70	35.80	35.90	35
36	36.00	36.10	36.20	36.30	36.40	36.50	36.60	36.70	36.80	36.90	36
37	37.00	37.10	37.20	37.30	37.40	37.50	37.60	37.70	37.80	37.90	37
38	38.00	38.10	38.20	38.30	38.40	38.50	38.60	38.70	38.80	38.90	38
39	39.00	39.10	39.20	39.30	39.40	39.50	39.60	39.70	39.80	39.90	39
40	40.00	40.10	40.20	40.30	40.40	40.50	40.60	40.70	40.80	40.90	40
41	41.00	41.10	41.20	41.30	41.40	41.50	41.60	41.70	41.80	41.90	41
42	42.00	42.10	42.20	42.30	42.40	42.50	42.60	42.70	42.80	42.90	42
43	43.00	43.10	43.20	43.30	43.40	43.50	43.60	43.70	43.80	43.90	43
44	44.00	44.10	44.20	44.30	44.40	44.50	44.60	44.70	44.80	44.90	44
45	45.00	45.10	45.20	45.30	45.40	45.50	45.60	45.70	45.80	45.90	45
46	46.00	46.10	46.20	46.30	46.40	46.50	46.60	46.70	46.80	46.90	46
47	47.00	47.10	47.20	47.30	47.40	47.50	47.60	47.70	47.80	47.90	47
48	48.00	48.10	48.20	48.30	48.40	48.50	48.60	48.70	48.80	48.90	48
49	49.00	49.10	49.20	49.30	49.40	49.50	49.60	49.70	49.80	49.90	49
50	50.00	50.10	50.20	50.30	50.40	50.50	50.60	50.70	50.80	50.90	50

Distance of slope stake from side or shoulder stake for any width roadway, slope 1 to 1. If ground is nearly level, the cut or fill at side stake is located by the double entry method in left column and top row. The number in body of table in same row and column gives distance from side stake to slope stake. If ground is not level estimate the difference in elevation between the side stake and slope stake, lower target by this amount if cut, elevate if fill. Add this amount to cut or fill and find distance in table. Set up rod at this point, and line of sight should cut target. If it does not make the slight adjustment necessary.

INDEXED

to page #50

except page #9

2039

I

Index

Page 2-8 X Sect Kalmia St.
Montclair to Vancouver

Page 10-13 X Sec Montezuma Rt
College Ave - 63rd

32-42 Cabrillo - Pearl to Oliver

43-50 Re-X-Sec. Missouri - Lamont to East End

48 Stake corner Lots 8-9-Blk-4 Crittendens

51- X-Sec Alley-Blk 42- Univ. Hts.

6-20-49 Xsect Kalmia St
 Hendricks
 Roberts
 Greer
 Ruter
 WSH 31306

INDEXED
 WK
 JUN 21 1949

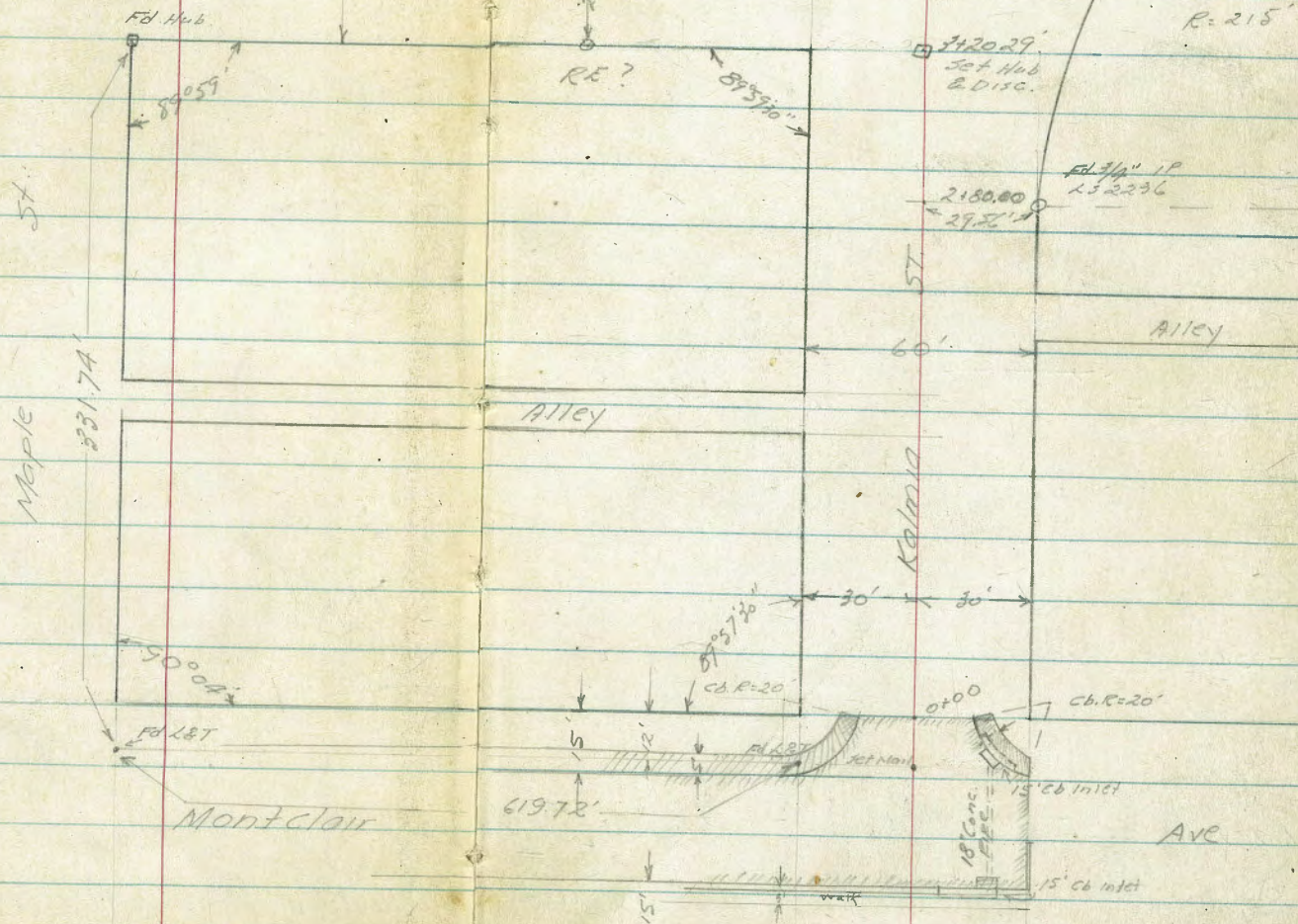

Levels Kalmia 34

SE Cb. Rel. Kalmia & Montclair BC on Montclair

L: 21.3
2 parts

NE Cb. Rel. Kalmia & Montclair BC on Montclair

L: 26.3
3 parts

0+00 E Line Montclair Edge Asph. Pav.

0-15 E Cb Line Montclair

0-30 E Montclair

BM 8.35 277.88

See Page 8 for Check Back

BM			9.24	269.53
T.P.	1.24	278.77	11.39	277.53
T.P.	2.20	288.92	11.56	276.72
BM	3.16	298.28		295.12

NE BP Kalmia & Montclair

NE BP Kalmia & Montclair

SEBP BOUNDARY & MAPLE

20.42	20.703	26.758	26.5.70	26.52	26.734	26.6.12
10.6	10.8	10.8	15.8	11.36	10.58	11.36
CB	G	CB	FL	G	CB	G
26.94	26.948	26.72	26.928	26.64	26.911	26.8.52
8.94	8.40	9.5	8.60	9.24	8.77	9.36
G	CB	G	CB	G	CB	G
BC	①	②	③	④	⑤	⑥
27.12	27.08	26.915	26.8.53	26.8.02	26.7.23	26.7.84
6.7	7.1	8.30	9.36	9.86	10.85	10.02
48	30	157	157	15.7	157	27
CB	G	CB	G	CB	G	CB
26.94	26.948	26.948	26.8.94	26.8.81	26.8.29	26.7.17
7.74	8.40	8.40	8.94	9.09	9.59	10.11
50	50	35	25	20	15	10.79
CB	G	CB	G	CB	G	CB
						11.32
						15
						20
						Pave.
26.94	26.948	26.948	26.8.94	26.8.81	26.8.29	26.7.17
8.12	9.00	9.46	9.94	10.50	10.53	11.1
50	30	15	15	30	20	18
						Edge Pav

Kalmia St Cent

1+00

274.7 274.3 274.3 273.7 273.5 273.6 273.2 272.7
31 35 35 41 42 42 45 51
50 30 24 15 15 30 50

4

0+45 & 3' Conc. Walk 29.9 Lt

274.3 273.5
35.9 42.0
50 29

0+50

274.2 273.5 273.6 272.4 272.5 272.7 272.9 272.6 271.9
37 41 49 55 54 52 50 53 60
50 30 15 12 14 15 30 50

0+38 & 3.5' Conc. Walk 30.3 Rt

272.6 272.5 272.3 272.1 272.0 271.9
52.5 30.3 26.5 26.1 270.4 270.9 271.1
55 52 71 82 94 98 75 70 62
40 30 17 14 13 17 30 34

0+07

0+01.5 End Sidewalk Lt & Rt

269.6
87.2
20.5
2W

267.94
97.4
20.5
3W

277.80
^

1452	\$ 95	Cont Drive	20.1	KT
------	-------	------------	------	----

1450 W. Line Alley Lt.

1432 & 3' Conc. VV9116

1724 \$ 4' Conc. manic 29.3 Lt

1422 Power Pole # P.3675 22.3 Kt

1+07 & 2' Ribbon Drive 294

1+02 & 2' Ribbon Drive 29.2 Lt

275.1	274.8	274.3	274.2	273.9	274.2	274.0
28	21	35	32	40	37	39
45	30	15	15	30	40	

274.18 274.18
370 370
30.3 40

275.33
275.14
255 274
70 29.3

274.6
320
294

274.3
350
29.2

277.88

2+16 & 4' Conc. Walk 30.4 Lt.

274.58
232
20.4

2+20 E Line Alley

274.5	274.1	273.6	273.3	273.4	273.7	273.4	270.9
28	28	28	28	28	28	28	28
40	30	16		18	23	30	50

2+19 Power Pole # P3685 22' Rt.

2+00 W Line Alley Rt.

275.2	275.0	274.	273.9	273.9	273.8	273.7
28	28	28	28	28	28	28
50	30	14		19	30	40

1+79 & 3' Conc. Walk 30.1 Rt.

273.93	274.67
28	28
30.1	40

1+70 E Line Alley onlt.

275.1	274.9	274.3	274.1	273.9	273.8	274.2
28	28	28	28	28	28	28
50	30	15		15	30	40

272.88
1

Kalmia St Contd.

2+87 R/C Conc Walk 30.7 Lt

272.44
544 550
40 30.7

2+80 BC on Rt.

272.6 272.3 271.3 271.3 270.7 270.4 270.7
53 55 66 66 73 75 73
40 30 17 19 30 45

2+67 End Conc Dr Lt 30.7 Lt

272.84 272.67
504 521
40 30.7

2+495 Breakin Dr.

273.0 273.4 273.03 273.27
442 448 482 461
40 40 305 305

2+31.5 Beg Conc Drives 30.4 Lt

273.7
421
30.4

227.88

Kalmia St Cont'd

8

check 11.67 298.40 3.27 295.11 = 295.12 SEBP Boundary & Maple

T.P. 10.91 289.06 2.33 286.73

T.P. 9.24 278.77 0.62 278.15

8.35 269.53 NEBP Kalmia & Montclair

3150.29 & Vancouver (to Edge of New M.H.)

269.4 269.1 268.26 267.8 267.6 266.8 266.4
85 88 96 104 103 111 115
50 30 Rim 20 23 30 50

3120.29 W. line Vancouver

270.5 270.6 270.2 269.65 269.2 269.4 269.1 268.0
74 73 77 82 87 85 88 100
40 30 22 19 25 30 50

277.88

8-25-79
 X S.C.C. Montezuma Road Hardin
 College Ave To 63rd St Hatch
 Old W.O. 900 69 Sheppard
 New W.O. 205 25

3+50

3+00

2+50

2+00

1+50

1+00

0+50

Edge of Pavc
 0+10.93

S.E. Top Hdt.
 College Ave Montezuma 456.34 4.43 452.51

INDEXED

W.K.
 MAR 13 1950

10

LT. RT.
 449.84 449.94 449.04 449.54 449.64 449.44 448.74
 7.1 7.0 7.9 7.4 7.3 7.5 8.2
 40 34 33 16.5 16.5 33
 450.44 450.54 449.64 450.24 450.34 450.24 449.44
 6.5 6.4 7.3 6.7 6.6 6.7 7.5
 40 34 33 16.5 16.5 33
 451.24 451.04 450.24 450.84 451.04 449.94
 5.7 5.9 6.7 6.1 5.9 5.9 7.0
 40 34 33 16.5 16.5 33
 451.84 451.54 450.84 451.24 451.74 451.64 451.04 451.01
 5.1 5.4 6.1 5.7 5.2 5.3 5.9 5.93
 40 34 33 16.5 16.5 33 38.6
 452.24 452.34 451.24 451.84 452.04 451.74 451.34 451.30
 4.7 4.6 5.7 5.1 4.9 5.2 5.6 5.64
 40 34 33 16.5 16.5 33 38.7
 452.04 451.84 451.24 451.94 452.14 451.74 451.34
 4.9 5.1 5.7 5.0 4.8 5.2 5.6
 40 34 33 16.5 16.5 33
 451.74 451.64 451.24 451.74 451.84 451.64 451.44
 6.2 5.3 5.7 6.2 5.1 5.3 5.5
 39 37 33 16.5 16.5 33
 450.34 450.74 450.74
 6.60 6.00 6.20
 35 16

456.94

8+00

7+50

7+00

6+50

6+00

5+50

5+00

4+50

4+00

451.87 4.74

456.14 7.23

447.13

2.16 449.71

L.T.

E

P.T.

11

446.87 446.97 446.07 446.57 446.77 446.67 446.17
 5.0 49 6.8 5.3 5.1 5.2 5.7
 40 33 33 16.5 16.5 33
 446.27 446.47 445.77 446.27 446.47 446.37 445.87
 5.6 5.4 2.1 5.6 5.4 5.5 6.0
 40 33 33 16.5 16.5 33
 446.47 446.33 445.48 445.97 446.37 446.27 445.45 446.32
 5.4 5.5 4.39 5.9 5.5 5.6 6.2 5.5 5
 40 33 33 16.5 16.5 33
 446.57 Culvert 446.67 446.07 446.27 446.17 Culvert 445.97
 5.3 5.2 6.2 5.8 5.6 6.7 5.9
 40 34 33 16.5 16.6 33
 447.07 446.87 446.17 446.37 446.57 446.57 445.97
 4.8 5.0 5.7 5.5 5.3 5.3 5.9
 40 34 33 16.5 16.5 33
 446.97 447.27 446.47 446.97 447.07 446.97 446.57
 4.9 4.6 5.4 4.9 4.8 4.9 5.3
 39 34 33 16.5 16.5 33
 447.77 447.97 447.27 447.57 447.77 447.67 447.07
 4.1 3.9 4.6 4.3 4.1 4.2 4.8
 40 33 32 16.5 16.5 33
 448.47 448.47 447.77 448.27 448.47 448.27 447.17
 3.4 3.4 4.1 3.6 3.4 3.6 4.1
 40 34 33 16.5 16.5 33
 449.17 449.27 448.47 448.87 449.07 448.87 448.27
 2.7 2.6 3.4 3.0 2.8 3.0 3.6
 41 34 33 16.5 16.5 33

451.87

12+50

12+00

11+50

11+00

10+50

10+00

9+37.67
= 9+48.42

9+00

8+50

3.99

452.07

456.06

8.93

447.13

L+

E

R+

452.56 452.26 451.46 451.86 452.26 452.06 451.66
 3.5 3.8 4.6 4.2 3.8 4.0 4.4
 40 34 33 16.5 16.5 33
 451.76 451.46 450.76 451.36 451.76 451.56 451.06
 4.3 4.6 5.3 4.7 4.3 4.5 5.0
 40 34 33 16.5 16.5 33 36
 451.26 451.36 450.26 450.56 451.06 450.96 450.36
 4.8 4.7 5.8 5.5 6.0 5.1 5.7
 39 33 32 16.5 16.5 33
 450.76 450.66 449.76 450.06 450.36 450.16 449.44
 5.3 5.4 6.3 6.0 5.7 5.9 6.6
 39 34 33 16.5 16.5 33
 449.76 449.96 449.06 449.46 449.66 449.36 448.86
 6.3 6.1 7.0 6.6 6.4 6.7 7.2
 40 33 33 16.5 16.5 33
 449.26 449.16 448.26 448.76 448.96 448.66 448.06
 6.8 6.9 7.8 7.3 7.1 7.4 8.0
 40 34 33 16.5 16.5 33
 448.46 448.46 447.76 448.06 448.26 447.66 447.96
 7.6 7.6 8.3 8.0 7.8 8.4 8.1
 39 34 33 16.5 16.5 33
 447.86 447.76 447.06 447.56 447.76 447.56 447.06
 8.2 8.3 9.0 8.5 8 8.5 9.0
 40 34 33 16.5 16.5 33
 447.26 447.26 446.66 446.86 447.06 446.96 446.66
 8.8 8.8 9.4 9.2 9.0 9.1 9.4
 40 34 33 16.5 16.5 33

456 06

L +

Z

R +

13

16 + 01.44

15 + 50

15 + 00

14 + 50

14 + 00

13 + 50

13 + 00

Check B.M.
S.E. Fire Hdt
Montezuma
6310.

0.55

458.64

459.19

7.12 452.07

454.39 454.09 453.49 453.89
4.8 5.1 5.7 5.3 5.1
40 33 33 16.5

454.19 453.89 454.09 454.39
5.0 5.3 5.1 4.8
40 33 16.5

454.19 454.09 453.49 453.89 454.39
5.0 5.1 5.7 5.3 4.8
40 33 33 16.5

453.99 453.89 453.29 453.59 454.09
5.2 5.3 5.9 5.6 5.1
40 33 33 16.5

453.79 453.69 453.09 453.29 453.69
5.4 5.5 6.1 5.9 5.5
40 34 33 16.5

453.59 453.49 452.59 452.89 453.29
5.6 5.7 6.6 6.3 5.9
40 34 33 16.5

453.09 453.09 451.99 452.49 452.79
6.1 6.1 7.2 6.7 6.4
39 34 33 16.5

454.09

5.2 5.7 5.9 4.7
16.5 33 34 40

454.39

5.0 5.3 4.6 4.8
16.5 33 34 40

454.39

4.9 5.4 5.46
16.5 33 38.8

454.09

5.2 5.6 5.63
16.5 33 38.7

453.69

5.8 5.8
16.5 33

453.29

6.3 6.4
16.5 33

452.79

6.6 7.1
16.5 33

459.19

INDEXED
W.K.
MAR 13 1950

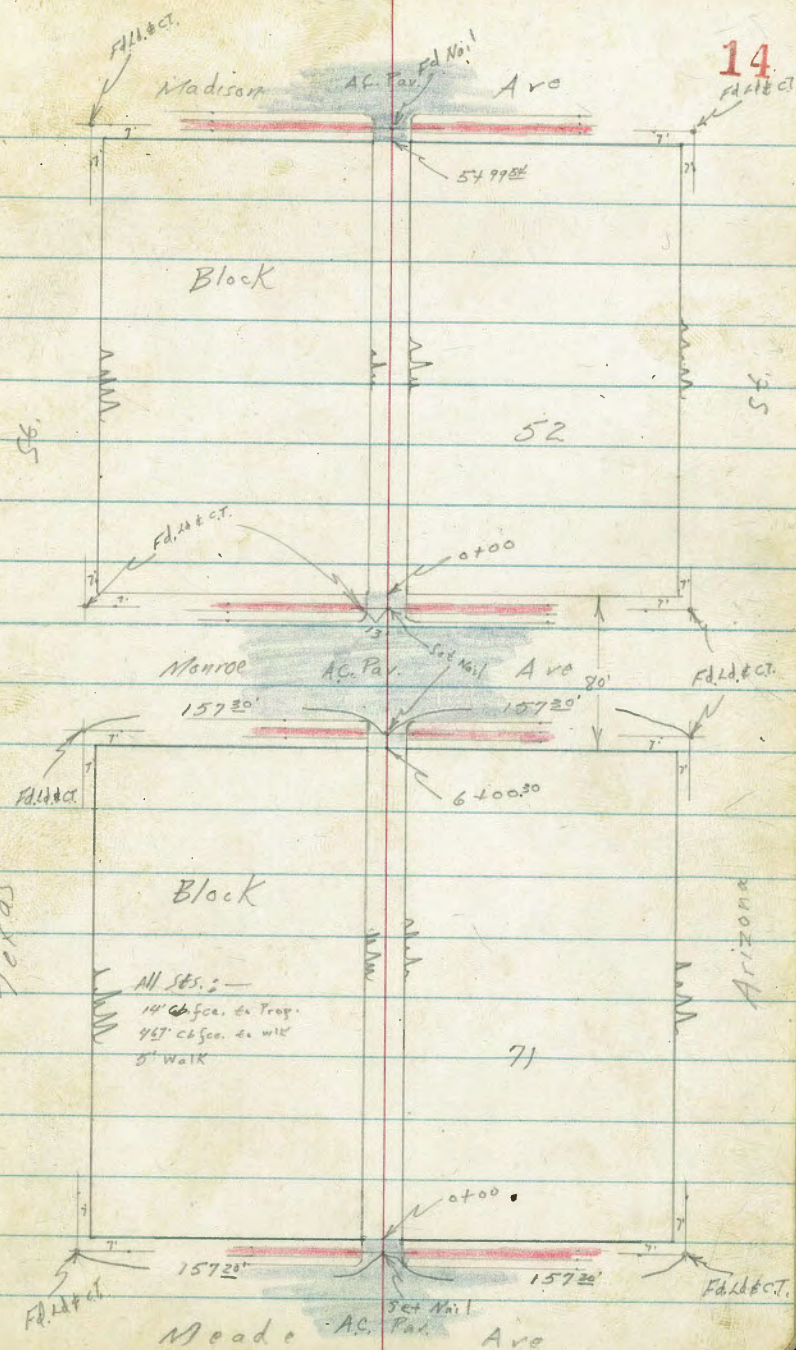

Alley Block 71

2t

2

 π

15

0+50 9¹/₂' Rt End Shed Begin Wood Fence

0+41	92'	Rt	Begin Shed	End Fence
------	-----	----	------------	-----------

0730 98' Rt Begin Wire fence

1025 Lt. Begin 6" Conc. cb.
0400 North Prop. Line Meade

0-14 No. Gurb Line Meade

0-40 E Meade Ave.

BM

9.35

340.76

331.41 SEBP
made f Texas

340.70

Cont'd From Page 15

Lt

L

Rt

16

1+18 172' Lt & Single Garage

336.7
4.1
22' Floor
Dirt 17' Apron

1+07 96' Rt Broken Par. Sabs graded for Wall

336.9
3.9 96' Grd
336.3
4.5 96' Foot
337.9
2.9 Ave. Top

1+04 205' Lt & Double Garage

336.54
4.12
20.5' Floor

1+02 Rt 102' & 15' Conc. Walk

337.41
335' 102' Walk
337.96
2.80 20' Walk

1+00 96' Rt End Board Fence

336.5
4.3 20
336.7
4.1 10
336.8
4.0
337.0
3.8 10
337.5
3.3 20

0+88 103' Lt. End 6" Curb

336.73
4.03 10.3 Top
335.9
4.9 10.3 Foot
336.6
4.2 10.3 Grd

340.76
↑

340.76
↑

Cont'd From Pg. 16

Lt

Lt

Rt

17

TP

7.03 345.16 2.63 338.13

2701

95' Lt to Center P.R. #PA4423

2700

98' Rt End Board Fence & Begin Lath

1766E

93' Rt & 4" Drain

1750

1751E

82' Rt & 4" Drain

1749

91' Rt Begin Board Fence

98' Rt End Rough wall & Board Fence

1737

98' Rt Start Board Fence on Rough wall

1731

92' Lt & Single Garage

340.76

337.8

3.0
20

337.8

3.0
10

337.7

2.9

337.8

3.0
4

338.3

2.5
10

339.3

1.5
20

3.40
9.5
Invert

337.1

3.7
20

337.2

3.6
10

337.5

3.3
8

337.2

3.6
5

337.1

3.7

337.0

3.8
3

337.6

3.2
10

338.8

2.0
20

337.33
3.43
8.5
Invert

337.6

3.2
92
Grd

337.2

3.6
92
Foot

338.8

2.0
92
Tip

336.9

3.9

99
Floor
Dirt

340.76

Cont'd From Page 17

18

3+70 12' Rt & Single Garage

3+58

3+00 9' Lt to Center P.P. # PA 4451

2+68 9' Rt & Single Garage

2+50

2+49 10' Rt End Pickit Fence

2+28 10' Lt & Single Garage

345.16

Lt

Rt

Rt

6.1
20

6.0
10

5.8

5.5
10

5.3
20

6.6
20

6.1
10

6.4
5'

6.4

5.9
10

5.8
20

6.1
20

6.4
10

6.7

6.6
10

7.0
20

7.1
10
Floor
Dirt

345.16

4.96
12' &
Floor
cont.

339.7

339.9

6.35
92
Apron
cont.

6.35
104
Floor

338.6

338.2

338.81

338.81

340.20

Cont'd From Page 18

5100 98' Lt Begin Lattice Fence

4190 10' Lt & Single Garage

4185 98' Lt End wood Fence

4182 85' Lt to Center P.Pole # Pa 4481

4177 95' Lt & 12' Conc. Walk

4171 12' Lt & 45' Conc. Walk

4165 95' Lt End Wire Begin Wood Fence

4150 95' Lt Begin Wire Fence

4100 10' Lt to Center P.Pole # PA 4467

345.16

Lt
340.9
4.3
20

341.1
4.1
10

340.56
4.6
10.1
Floor
Dirt

340.40
4.76
20
conc

340.38
4.78
9.1
conc

340.1
5.1
20

340.1
5.1
10

339.3
5.9
20

339.6
5.6
10

341.1
4.1

341.5
3.7
10

342.3
2.7
20

Rt

19

341.06
4.10
12.3
conc

340.3

340.9
4.3
10

341.5
3.7
20

340.2
5.0
10

340.6
4.6
20

345.16

Cont'd From Page 19

T.P. 6.02 347.76 3.22 341.94

6+00³⁰ So. Prop. Line Monroe Ave.

5+80

5+69 10' Rt. End Conc Apron

5+50 10' Rt. Begin Apron

5+41 12' Rt & Double Garage

5+28 11' Rt & Single Garage

5+11 10' Lt. End Lattice Fence

345.16

Lt

Rt

Rt

20

341.79

3.37
9.10
cb

341.60

3.56
9.20
Gutt

341.65

3.51

342.38

2.78
9.28
G.H.

342.60

2.56
9.26
cb

342.2

3.0
14

342.1

3.1
10

342.7

2.5
6

342.5

2.7

343.0

2.2
10

343.3

1.9
14

343.08

2.08
10
conc
apron

343.43

1.73
13
Floor

341.9

3.3
20

342.0

3.2
10

342.5

2.9
8

342.0

3.2

342.0

3.2
8

342.6

2.6
10
Grd

343.08

2.08
10
conc
apron

343.60

1.56
12.9

342.4

2.8
12
Floor
Dirt

342.01

3.15
112
Floor
Wood

345.16

Cont'd From Page 21

Lt

Rt

Rt

22

1431 143 Lt & Single Garage

345.9
2.0
14.5
Floor
Dir

1425 92' Lt to Center Pole # PA4541

345.10

344.95

1423 84' Lt. End Conc. Apron 3-Car Garage

2.83
10.2
Floor

2.98
8.2
Apron

1400

345.0
2.9
10

345.1
2.8

345.4
2.5
10

0496 89' Lt. Begin Conc. Apron 3-Car Gar.

345.09
2.84
10.2
Floor

344.93
3.00
8.2
Apron

0489 11' Rt to Conc. Apron

345.41
2.52
11.2
Apron

345.45
2.48
14.6
Floor

0460 102' Rt End Conc. Apron

345.17
2.76
10.2
Conc
Apron

345.33
2.60
14.8
Floor

347.93

347.93

Cont'd From Page 22

2t.

\$

Rt

23

2+40 { 92' Lt. Begin Shed
102' Lt. End wood Fence

2+30 92' Lt. to Center P. Pole # PA 4549

2+23 92' Lt. End wire fence Begin wood Fence.

T.P. 6.96 352.97 1.92 346.01 Nail P. Pole # PA 4549

352.97

2+00

345.2

2.7
15

345.4

2.5
10

345.3

2.6

345.6

2.3
10

346.2

1.7
20

1+90± 92' Lt. to Garage Begin Lath Fence

1+75 10' Lt. to Garage entrance from Texas

1+50

346.3

1.6
20

345.7

2.2
10

345.3

2.6
5

345.3

2.6

345.3

2.6
10

345.6

2.3
20

1+43 172' Rt. to Conc. Apron

347.93

347.93

345.63
2.30
172
Apron

345.87
2.06
172
Floor

Cont'd From Page 23

24

3+25 10' Lt. Begin Apron 4 Car Garage

346.82 Lt
6.15
112
Floor
conc.

346.82 Rt
6.15
102
Apron
conc.

3+11 17' Rt. & Pebble Garage

347.79
5.18
172
Floor
conc.

3+00

347.3
5.7
20

347.0
6.0
11

346.3
6.7
10

346.29
6.18
20
MH
Rise

346.5
6.5
10

347.4
5.6
20

2+82 13' Lt. & Single Garage

345.7
7.3
172
Floor
Dirt

2+72 11' Lt. End Conc Apron

345.89
7.08
13
Floor
conc.

345.83
7.14
112
Conc.
Apron

2+53 10' Lt. Begin Conc. Apron

345.97
7.00
122
Floor
conc.

345.79
7.18
105
Apron
conc.

2+50 9' Lt. End Shed

345.7
7.24
20

345.7
7.3
10

345.7
7.3

346.2
6.8
10

346.9
6.1
20

352.97
11

352.97
11

Cont'd From Page 24

Lt

Rt

25

4430

10' Lt & Single Garage

347.67
5.30
10' Floor
conc

347.31
5.66
8' Conc
Apron

4419

10' Lt. & Single Garage

347.40
5.57
10' Floor
conc.

347.25
5.72
9' Conc
Apron

4407

14' Rt & Conc Apron

548.82
4.15
14' Conc.
Apron

349.6
3.41
30' Floor
conc.

4401

8' Lt to Center P.Pole # PA4565

346.5
6.5
20

347.0
6.0
11

347.7
5.3
10

347.4
5.6
5

347.5
5.5

347.6
5.4
10

349.0
4.0
20

4400

3474

9' Lt. End Apron 4-Car Garage

346.97
6.00
10' Floor
conc

346.97
6.00
9' Apron
conc

3471

12' Rt & 3' Conc. Walk

348.69
4.28
12' Walk

349.07
3.90
20 Walk

3450

346.94
6.03
11 Floor

346.88
6.09
9' Apron

346.9
6.1
9' Gro

346.8
6.2

347.0
6.0
10

347.3
4.7
20

352.97
↑

352.97
↑

Cont'd From Page 25

5400

4495 12⁵' Lt. & Single Garage

4492 13⁴' Rt & Single Garage

4482 12³' Lt. & Single Garage

4481 13⁷' Rt & Single Garage

4465

4446 10⁷' Lt. & 3' Conc. Walk

4440 10¹' Lt. & Single Garage

4439 15²' Rt. & Single Garage

352.97

11

Lt

350.48

2.49
123
Floor
conc

349.72

3.25
123
Floor
conc

347.6

5.4
132

346.9

6.1
20
Walk

347.69

5.21
102
Floor
conc

350.08

2.89
102
conc.
Apron

349.43

3.54
102
conc.
Apron

347.6

5.4
11

347.51

5.46
102
Walk

347.43

5.54
79
conc
Apron

2.9
10

3.3
3

4.5
10

4.9
10

352.97

11

Rt

349.7

3.0
5

4.5
7

4.7
10

348.7

4.3
152
Floor
Dir

350.0

2.1
10

4.5
10

4.7
10

348.7

4.3
152
Floor
Dir

350.9

2.1
10

4.5
10

4.7
10

348.7

4.3
152
Floor
Dir

Rt

350.9

2.1
10

4.5
10

4.7
10

348.7

4.3
152
Floor
Dir

26

351.3

1.7
12

350.40

2.57
132
Floor
conc

350.37

2.60
132
Floor
conc

350.3

2.7
20

349.5

3.5
20

Cont'd From Page 26

Lt.

Rt.

Rt.

27

T.P. 6.17 358.65 0.49 352.48

5+50

350.9
2.1
20

351.9
1.1
12

351.9
1.1
10

352.0
1.0

352.5
0.5
92
Grd

351.8
1.2
92
Foot

354.3
+1.3
92
Top

354.0
+1.0
138

5+44 Rt Wire Fence on top Conc Wall Ends

5+43 12' Lt. & Single Garage

351.58

1.39
12' Conc Floor

351.36

1.41
10' Conc Apron

5+31 12' Lt. & Single Garage

351.16

1.81
12' Floor Conc

350.97

2.00
10' Apron Conc

5+19 9' Lt. to Center P. Pole # PA 4585

5+11.5 99' Rt Begin Conc Wall Fence on Top

350.6

2.4
12

350.5

2.5
10

350.4

2.6

351.1
1.9
92
Grd

350.5
2.5
92
Foot

353.0
0.0
92
Top

351.8
1.2
138

5+07 12' Lt. & Single Garage

350.41

2.56
12' Floor Conc

350.17

2.80
10.8 BRK

350.13

2.84
9' Conc Apron

5+06 13' Rt & Single Garage

351.24

1.73
9' Apron Conc

351.89

1.04
13.5 Floor Conc

352.97

352.97

Cont'd From Page 27

Lt

Rt

Rt

28

Check

9.71

338.97

=

338.96 S.E.B.P.

Monroe & Texas

T.P.

2.61

348.68

12.58

346.07

Check

12.68

345.97

=

346.03 S.E.B.P. Madison & Texas (Brass Plug gone)

6+39.54

£

Madison

350.5P

8.07

50

354.35

4.30

358.14

0.51

50

6+13.54

So. Curb Line Madison

350.64

8.01

50

Cb

350.15

8.50

50

Gut

353.35

5.30

12

Cb

353.02

5.13

12

Gut

353.80

4.85

12

Gut

354.71

3.94

12

Gut

355.33

3.32

12

Cb

357.55

1.10

50

Gut

358.30

0.35

50

Cb

5+99.54

98 Rb End. Concr Wall

So. Prop. Line Madison Ave.

353.82

4.83

100

Cb

353.77

4.88

100

Gut

354.14

4.51

98

Gut

354.70

3.95

98

Gut

355.17

3.48

98

Cb

354.7

4.0

98

Gut

353.9

4.8

98

Foot

355.4

5.21

98

Top

5+80

353.6

5.1

20

353.6

5.1

10

353.5

5.2

98

Grd

354.0

4.7

98

Foot

353.54

5.11

98

Foot

355.45

5.20

98

Top

355.1

5.6

12.3

358.65

↑

358.65

↑

Roberts
Garber
Moore
Clark
5-23-50
W.D. 25010

Check Levels on Southerly Curb
of Catoctin Drive from Art Street
to End of Curb at boundary Line
Alvarado Heights

Map 1634

INDEXED
MK

OCT 9 1950

29

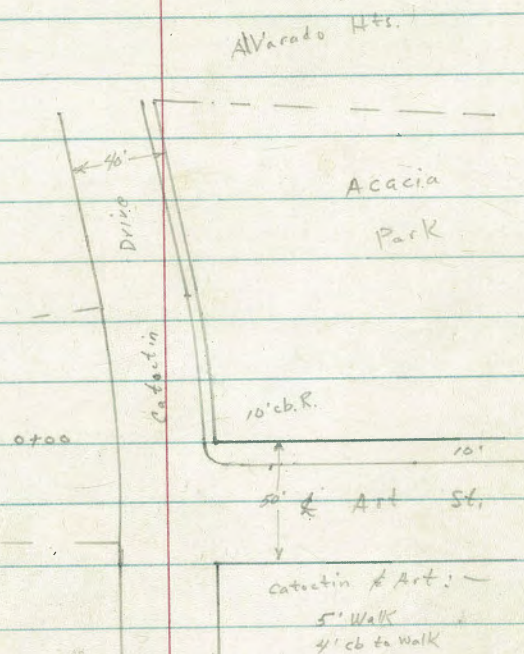

Top
Curb

0+50

460.74
5.74

0+25

461.02
5.16

0+00 B.C. Curb Ret. Catoclin

461.25
4.93

Center Curb Return

461.31
4.87

E.C. Curb Ret Art St.

461.32
4.86

45' So. E.C. Curb Ret Art St.

461.35
4.83

BM

279

466.18

↑

463.39

See FB 2008

PIH

Transferred from
hub to Nail in P. Pole SW Cor.

Cont'd From Page 30

1+53 End Curb

1+47

1+25

1+00

0+75

0+69 EC C.T. in Center Curb

466.18 x

Top
Curb

31

459⁴⁶
6.72

459⁶⁰
6.58

459⁸⁸
6.30

460¹⁹
5.99

460⁵³
5.66

460⁵⁶
5.62

466.18 x

CABRILLO -

X-Sec. Pearl to Olivet. W.O. # 31560

Sommermeier
Begg
Allen

Tie Sheet # 2145

• = Fd. 7' L+T.

□ = Fd. 1/4 hub + Tack

■ = Fd. Conc. Mon. + city disk

X = chisel cross tie out in Conc. drive

• = Nail

(M) = water meter box

Hub Fd. at 4+97.60 is in poor location,
please enter R.P.s on tie sheet so hub
can be replaced.

INDEXED

OCT 9 1950

T.R.S. 2158
TI-3-50-MQ

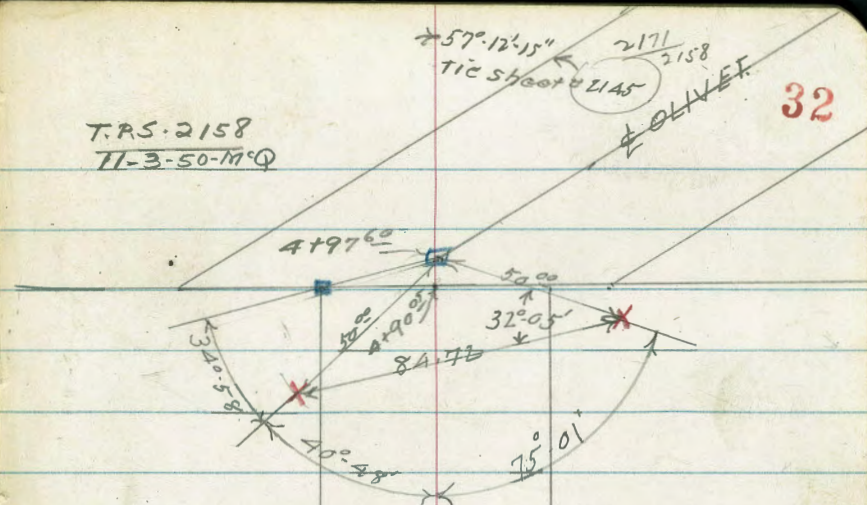

← 30' — 30' →

Cabrillo St.

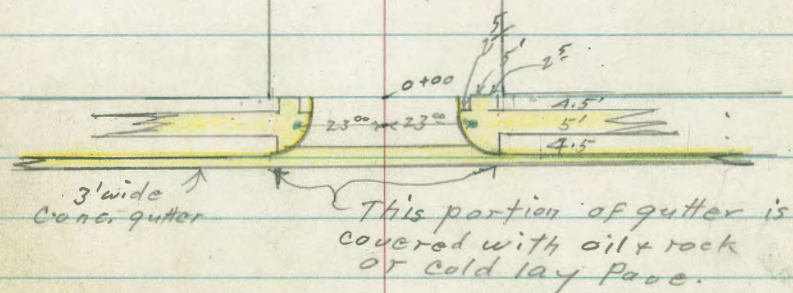

Pearl St. (cold lay or plant mix.)

Ca - 6

110

check -

2 7L 156.01

CH N.E.L + t.

EL = L 6.06 $\frac{20.53}{29}$

0-02 22' R... (u)

0-04

At. C.R

Z 138

0-14 C E

30' R. 4 C

- 1 = 8 1/2

0-15E 2'R. = Ctr. 2'x3'7 t. C L West

0-0-

(Reck o Pavc.)

9.18

19

155.01

N.W. 2' L I

L + Ca

(From X-sec. 5 b ill s o p .)

154.97	154.41	4.	55.94
3.75	4.3	4.0	2.77
20	20	20	20
158.72			
11.70	12.32	1.18	0.18
43	43	76	76
154.7	154.1	155.1	155.24
9.40	10.10	9.1	8.84
30	30	20	30
12.15	04	8.76	8.24
13.8	9.3	7.8	7.2
80	30	20	30
164.19			
155.4	154.9	157.0	164.9
13.8	9.3	7.8	7.2
80	30	20	30
164.19			

Cabrillo

34

0+42 - 34' Lt. = 6" diam tree

0+40 - 26' Rt. = start rock + Conc. wall.

5.1	5.4	4.9	5.5	4.0	4.2	1.2	1.1
30	20		18	20	28	18	30
					Base of wall	Top of wall	

0+37 - 29' Rt. = end cobble + Conc. wall.

159.2	160.7
+0.5	+2.0
29' End + base of wall	29' Top of wall

0+21 29' Rt. = start cobble + Conc. wall.

0+14 22' Rt. = (W)

158.7	160.7	161.9
0.0	+2.0	+2.6
29' End + base of wall	30' Top of wall	35'

0+10

4.5	4.4	4.0	4.4	3.1	+2.2	+3.0
30	20		17	21	30	35

0+02 - 30' Lt. = 6" Eucalyptus

4.1	2.69	2.60	1.2
30	26' walk	27' walk	30

27' Rt. = N.E. Cor. walk.
 27' Lt. = N.W. Cor. walk
 22' Rt. = N.W. Cor. walk.
 22' Lt. = N.E. Cor. walk } = end of walk

0-00 { 20' Rt. } = end existing curbs
 { 20' Lt. }

3.60	3.67	3.78	4.3	4.2	4.0	3.3	2.76
27' walk	22' walk	20' end	20		18	20	20

Cabrillo st. has thin oil coating.
 Not worth considering.

158.72

1+26

1+10 20⁸ Lt. = 3' wide Conc. walk

11.06	11.00	10.75
44	30	20 ⁸
at house		

1+07 21' Lt. = (VV)

0+91 22' Rt. = (W)

10.0	9.7	9.4	8.8	8.4	8.7	7.8	5.7	4.6
30	30	20	19		20	262	27	30
B.W.					at wall	on wall		

Note { B.W. = Base of wall
T.W. = Top of wall

1' wide. Ord. to so. level with top of wall.
0+90 - 17^E Lt. = east end cobble Ret. wall

151.2	151.5	149.2	150.6	150.4	150.1	151.1	153.1	154.1
7.5	7.2	9.5	8.1	8.3	8.6	7.6	5.6	4.6
30	20	17 ^E	17 ^E		20	262	27	30
T.W.	T.W.	B.W.	Ord + Top wall			at wall	on wall	

0+85 - 29⁹ Lt. = end Conc. apron.

151.61	151.23	151.2	150.7	150.9	150.7	151.3	150.7	152.4	154.3	155.7
7.11	7.49	7.5	8.0	7.8	8.0	7.4	8.0	5.5	4.4	3.0
48	299	20	17		20	26	262	27	30	35
Par.	BY Apron						Base wall	on wall		

0+77 24^E Rt. = steps thru wall

151.8	152.8
6.9	5.9
Ord.	262
24 ^E	on steps at line of wall

0+68^E - 30^E Lt. = start. Conc. apron to double Gar. (Conc.)

7.11	7.04
48	302
Gar Floor	Apron

158.72

Cabrillo

1+57 - 22' Lt. (W)

1+40

29' Lt. = E. & W. Conc. wall

1+39 23' Lt. = start picket fence

(walk is not good enough to try to use.)

1+37 24' Rt. = start 2' wide N. & S. Conc. walk.

T.P. 0.39 146.32 12.79 145.93

1+37 20' ± Rt. = end conc. apron

Edge of apron irregular.

1+27 1 - 20' ± Rt. = start Conc apron to Gar. Sing.

1+27

1+26 26' Rt. = end rock + conc. wall

143.2	143.6	143.1	144.6	144.3	144.5	145.0	145.0	145.52	145.55	146.3	147.9
3.0 40	2.7 30	3.2 29 8.6	2.7 29 0.1	2.0 23	1.8 20	1.7	1.3 20	0.80 24.5 walk	0.77 27 walk + End.	0.0 30	1.6 33
145.1	145.3	145.3	145.3	144.7	145.1	145.1	145.52	145.68	146.3	147.9	
1.2 40	1.0 30	1.0 29 + T.W.	1.0 29	1.6 20	1.2	1.2 20	0.70 24.5 walk	0.67 27 walk + End	0.0 30	1.6 33	
							0.66 24.5 walk	0.45 27			
							145.52	146.17			
							13.20 20 Apron	12.55 30	12.50 32 Gar. floor		
							146.11	146.22	146.37		
							12.61 20	12.50 30	12.45 32 Gar. floor		
							146.2	146.5	146.3		
							12.5 20	12.2 26.5	12.4 30		
							146.2	146.5	146.2		
							12.5 20	12.2 26.5	12.5 27 B.W.	8.7 30 T.W.	8.9
							146.2	146.5	146.2		
							12.5 20	12.2 26.5	12.5 27 B.W.	8.7 30 T.W.	8.9

158.72

Caprillo

2+16- 23' RT = (W)

2+12 27' Lt. = start steps
15' Lt. = 3' wide walk

2+06- 22' Lt. = (W)

1+98- 24' RT = 3' wide walk + steps

T.P. 3.66 142.80 7.18 139.14

1+89

1+88 30' Lt. = E & W. Conc. wall
24' Lt. = end picket fence

1+74 26' RT = E & W. Conc. steps.
25' RT = end conc. walk

1+66- 22' RT. = (W)

1+65 18' Lt. = 3' wide Conc. walk

37

139.02
3.78 15' 27
3.68 27
4.70 28
138.10 Bottom of steps
137.92 30
137.80 45

139.9
142.80
2.25 24' 24' stop
0.54 30
142.26 07
141.2 35

8.4 40	8.2 30 B.W.	8.0 30	5.8 25	5.1 15	5.7 40.6	5.7 25	4.8 30	2.3 35	1.5 40
7.4 40 T.W. fence	6.9 30 T.W.	6.5 30	5.7 25	6.4 15	5.6 40.7	5.6 25	4.7 30	2.3 35	1.5 40
141.48	141.86	142.32	142.37		142.80	142.82	143.47	144.79	
4.84 40 walk	4.46 30 walk	4.00 25 walk	3.95 189		4.02 25 walk	3.50 26 stop	2.85 30 steps	0.53 35 07 steps	

146.32

Cabrillo

38

3+16 23' Rt = (W)

3+00 - 17° Lt. = end conc. curb wall, to come out.
 30' Lt. = 3' wide conc. walk.
 2+96 { 17° Lt. = 3' wide brick walk + steps
 To come out.

2+92 - 16° Lt. = start 1' high - 9" wide cb.

2+86 - 21' Lt. = (W)

(to come out.)
 2+71 - 16° Lt. = end 10' wide conc. curb

2+67 22' Rt = (W)

To come out.
 2+60 - 16° Lt. = end 4' wide Conc. slab.

= 3' wide good Conc. walk.
 30' Lt. = west end rough walk
 walk + steps.

2+53 - 20' Lt. = start 3' wide rough Conc

slab, to come out.
 2+46 - 16° Lt. = start 4' wide N. & S. Conc. &

2+41 - 20' Lt. = (W)

curb, to come out.
 2+31 - 15° Lt. = start 10" wide - 1' high Conc.

9.23.2	8.13.5	7.13.6	6.13.9	7.13.4	6.13.9	5.13.9	3.2	0.0
9.6	8.3	7.2	6.9	7.4	6.7	5.9	3.2	0.0
40	30	26	20	17		30	31	40

7.99	7.67	6.75	6.6
40	30	28	17.5
on walk	walk	top of stop	

135.2	135.2	137.0	137.0	136.2	136.8	137.4	138.9	142.1
7.6	7.6	5.8	5.8	6.6	6.0	5.4	3.9	0.7
30	28	26	17	16		25	30	40
			curb					

7.53	6.67	6.35	5.34	5.27
40	30	26	25	20
walk	walk	Bottom stop	Top stop	

135.6	135.9	138.0	138.1	137.5	138.1	138.1	139.8	141.9
7.2	6.9	4.8	4.7	5.3	4.7	4.7	3.0	0.9
35	30	29	16	15		22	27	30
			on curb					

141.80

T.P.

6.49

Cabrillo

141.38 7.91 134.89

3+50

3+49 - 30' RT. = start cut stone wall.

3+48 - 29' RT. = 2' wide Conc. Nly. ribbon of drive

3+43 - 29' RT. = 2' wide - Conc. sly. ribbon of drive

3+38 - 15' Lh = (W)

3+35 - 29' RT. = end Conc. Dr.

3+25 - 29' RT. = start Sing. Car. Conc. drive to

3+24 - 30' RT. = 3' high stone + Conc. wall.

150.6	132.3	134.5	134.9	134.6	135.3	136.1	136.7	138.7	139.8
122	9.5	8.3	7.9	8.2	7.5	6.7	6.1	4.1	3.0
40	30	25	17	14		20	30	31	40

136.7	136.3	138.7
6.1	6.5	4.1
30	30	30
	B.W.	T.W.

137.23	140.83
5.57	1.97
299	50

137.21	140.80
5.59	2.00
299	50

137.50	142.40
5.30	0.40
299	50
drive	on drive

137.40	142.40
5.40	0.40
299	50
drive	on drive

137.2	137.0
5.6	5.8
30	30
Ord	B.W.

142.80

4+26 - 25' Rt. } = (W)
 23' Lt.

retaining wall

4+12 - 29' Lt. = start Conc. block

4+00

3+99 - 30' Rt. = end drive

3+91 - 30' Rt. = start sing. Conc. Dr.

3+90 30' Lt. = end cut stone wall

3+87 - 48' Lt. = under construction doorway to house

3+86 - 25' Rt. = (W)

8.4	5.9	8.8	6.6
30	29	29	29
End	T.W.	B.W.	End

131.7	133.5	134.5	135.2	136.0	136.9	137.9	140.2
9.7	7.9	6.9	6.2	5.4	4.5	3.5	1.2
40	30	20		25	30	32	50

136.84	138.54	140.13
4.54	2.84	1.25
30	38	50

136.94	138.66	140.14
4.44	2.72	1.24
30	38	50

136.7	136.1
4.7	5.3
30	30.3
	B.W.

131.3	133.2
10.1	8.2
48	48
End	Floor
	level

141.38

Cabrillo

4+63-29⁴ Lt. = end conc. drive

4+63-29⁴ Lt. = end conc.

4+62 29⁸ RK = 2' wide brick walk + steps

4+55 Cont.

29⁴ Lt. = start single conc. drive.

29³ Lt. = end conc. black. Ret. wall

4+55 27³ Lt. = end rough conc. slab. 2' wide

4+50 -24' RK = (W)

30' Lt. = start 3' wide steps + walk. (Brick)

Slab, To come out

4+35 27⁵ Lt. = start 2' wide N. & S. Conc.

4+34 -29⁷ Lt. = 3' wide Conc. steps + walk

8.85 132.53
30 39 29⁴
7.77 6.15

8.83 133.61
50 135.23
7.15 133.63
39 135.23
+ drive + end

133.1 133.6 135.34 135.3 135.23
8.3 7.8 6.04 6.1 6.10
30² 30² 29⁷ 29⁷ 29⁴
B.W. End T.W. End drive

132.2 133.6 135.32 134.9 136.1
8.2 7.8 6.06 6.5 5.3
40 31 30 20
Grid T.W. + end

133.23 133.86 125.04
8.15 7.52 6.34
43 31 29⁵
at house on walk walk Top wall + stop

146.9 137.34 138.69 139.89
4.5 4.04 2.69 1.49
29⁷ 29² 33 40
Grid Bottom Top of step, walk

141.38

4

42

T. P.	10.68	158,34	1.44	147.66
-------	-------	--------	------	--------

T.P.	12.55	149.10	4.83	136.55
------	-------	--------	------	--------

Set. B.M.	7.26	134.12
-----------	------	--------

4+91 28' R+ = (W)

4+90⁰⁵ cont.

302' RT. = end conc. drive
4 + 90° = Nly end Cabrillo

4+80 - 30⁹ RT. = start Conc. drive

Comp. Mon. 30' Lt. of $A + 90^{\circ 05}$ (rod on disk.)

$\frac{10.2}{67}$	$\frac{6.7}{30}$	$\frac{5.2}{20}$	$\frac{4.1}{37.2}$	$\frac{3.5}{20}$	$\frac{2.8}{30}$	$\frac{2.47}{309}$ drive	$\frac{0.51}{40}$
					$\frac{134.75}{2.65}$	$\frac{140.92}{0.46}$	$\frac{141.84}{+0.46}$
					309	40	50
					on drive		

141.38

D. Smith
R. Shepherd
Wm. Offman

Ref. FB-1837-72
FB-1767-69

Re X Sec Missouri St Lament to East end
Lt. North E

not 31584
8-9-51
Nt-South

43

0+69 25' Lt End Brick wall

119.41 118.4
052 16
253 253
Top wall footing

INDEXED

AUG

0+49 12' Rt E 14" Power Pole #P1911

0+45

119.3 118.9 118.5 117.7 117.3 117.0 116.1 116.0
07 14 14 23 27 32 32 42
36 26 21 14 12 24 36

0+44 Lt E H2O meter

117.84
216
21
valve

0+35 26' Rt E 8' con drive

116.88 116.91
312 309
262 362

0+25

119.2 118.8 118.6 117.4 116.9 116.6 116.7 116.7
08 12 14 26 31 34 33 33
36 26 22 14 15 26 36

0+00 25' Lt Start Brick wall 1' high

0+00 East Prop Lament end con parking cbs

118.40 117.2 117.02 116.86 116.21 116.12 115.67 116.28 116.44
160 28 29 314 329 384 433 372 356 28 160
253 253 26 162 162 162 162 162 262 262
Top Footing wall wall wall wall wall wall wall wall wall wall
end end end end end end end end end end

Note: int. in FB 1837-72

Lt=North

Σ Rt=South

44

1+37 25⁸ Lt & 4° flag stone walk

115.83
47 458
36 252

1+22 26² Rt & 8' con drive

114.43
557 114.62
262 352

1+20

116.8 116.6 115.6 115.0 114.4 114.4 114.3
32 34 44 50 56 56 52
36 26 16 15 11 26

1+03 13⁴ Rt & 11.0 meter

114.38
562
124
valve

0+81 14⁸ Rt & 11.0 meter

114.88
562
148
valve

0+80

118.25 118.6 116.7 116.2 116.0 116.11 116.17
175 14 3.3 3.8 4.0 3.8 3.83
26 20 14 16 26 36

0+78 26² Rt & 8' con drive

116.12 116.17
388 383
260 365

0+77 25⁹ Lt & 15' con drive

118.86 118.25
114 175
36 259

120.00

Lt. North

Rt. = South

45

2+00

114.4
56 62 73 74 82 84 85
36 26 15 15 26 36

1+90 27^e Rt. & 3' Conc. Walk

111.70 111.71
82 82
27^e 37^e

1+87 26³ Lt. Beg. 2' Conc. Blk wall

114.49
113.2
52 56
68 base

1+85 19^e Rt. & Water Meter

111.52
82
19^e valve

1+72 13^e Rt. & 10" Power Pole #1919

1+61 26^e Rt. & 8' Conc. Dr.

112.82 112.87
718 713
266 366

1+60

115.3 115.0 113.4 113.1 112.3 112.7 112.8 112.9
92 52 66 62 67 73 72 71
36 26 15 11 20 26 36

1+50 19^e Lt. & H₂O meter

114.00
60
19^e
valve

1+44 14^e Rt. & H₂O meter

112.72
708
14^e
valve
120.00

Lt. = North

Rt. = South

46

2+74 21" Lt. 5/4 of 4' Wide Cypress Hedge

2+70

114.4	114.3	113.9	113.1	112.3	112.2	112.0	111.8
52	52	61	62	72	72	80	82
36	26	18	15		11	26	36

2+66 14" Rt. 1/4" Power Pole #P1957

2+62

114.5	114.1	114.2	113.2	112.3	112.2	109	108.9
55	52	58	62	72	72	78	110
36	26	18	15		11	26	36

2+42 25" Lt. 1/2 3' Brick Walk

115.16	114.89
923	511
353	253

2+28 20" Lt. 1/2 Water Meter

2+25 26" Lt. End Conc. BIK Wall

114.7	114.70	113.56	113.5	112.8	112.2	112.0	110.9	109.3	108.2
58	532 Top	65	65	72	72	82	91	102	112
36	263	26	15		9	13	26	36	

2+07 26" Rt. 1/2 Conc. Ribbon Dr. 25' Each

111.39	111.43
861	852
262	302

2+02 20" Lt. 1/2 Water Meter

112.10
722
202

120.00

Lt. = North

Rt. = South

47

3+83 25° Lt. Beg. 2' Hedge

3+79 9° Lt. 10' Conc. Dr. & Apron

3+70 29° Rt. 6 3' Conc. Walk

3+62 15° Lt. 4 Water Meter Boxes

3+57 12° Rt. 5 Water Meter Boxes

3+50

3+45 23° End Floral Planting

3+32 26° Rt. 3' Conc. Walk

3+13 24° Rt. Begin Floral Planting

3+00

113.30 113.23 112.99 112.97 111.84
 62 62 70 75 86
 36 26 17 19 96

110.80 110.68
 9 9
 29 39

112.07
 7 7
 15 2

111.60
 8 Valve
 122

113.5 113.1 112.8 112.4 111.9 111.9 111.4 111.1
 65 69 72 76 81 81 86 89
 36 26 17 19 11 26 36

111.31 111.36
 8 8
 26 36

114.0 113.5 112.9 112.1 111.9 111.2 111.0
 62 65 71 79 81 88 90
 36 26 15 11 26 36

120

D. Smith
W. Moore
P. Pullum
J. Bishop

Stake Rear Lot Corners

N20' Lot 8 + Lot 9 BIK 4

Crittendens Add
Ed hat

wo# 20006
48
12-5-51

Robinson

Ave

INDEXED

DEC 5 1951

BIK.

59949

lot 9

lot 8

set disk

17985

set PK 14926

29951

Pennsylvania

Ave

Ed hat

4+58 25' Rt. & 2.5 Brick Walk

T.P. #1 360 112⁵² 112⁵² 108²²

4+54 25' Begin 4' Board Fence

4+38 29' Rt. & 3' Conc. Walk

4+30

4+12 25' Lt. End Hedge

4+07 29' Rt. & 3' Conc. Walk

4+04 15' & 12" Power Pole # 1983

4+00

112
Lt North

Rt. & South

49

323 322
252 352

112⁵²

1030 1018
292 352

82 82 88 93 9 8 92 103 103
36 26 16 12 11 26 36

960 958
292 392

82 72 82 82 9 2 92 92 98
36 26 17 12 11 26 36

120⁰⁰

Field BK. #1338 Pg 36
 10272 ✓
 923 10266 ✓

T.P. #2

5479²⁶ 8° RL @ 2' Conc. Walk

5479²⁶ Eastly End Missouri

5462 27° RL @ 3.5' Conc. Walk

5498 25° RL @ 36" Palm Tree

5440

5430 26.6 RL End of Board Fence

5430 15° RL @ 10" Power Pole # P1993

5400

4+02 25° RL @ 11' Conc. Slab

4+60

Lt. = North Rt. = North

50

92 93 96 97 966 98 102
 36 26 15 82 15 26

925 925
 272 372

75 83 90 92 95 95 90
 36 26 15 15 26 36

92 51 64 72 72 62 52 52 60
 36 26 15 8 12 17 26 36

525 551
 255 312

12 12 25 39 32 32 32 32 40 42
 36 26 17 15 10 12 17 26 36

112 59

W.O. 31319

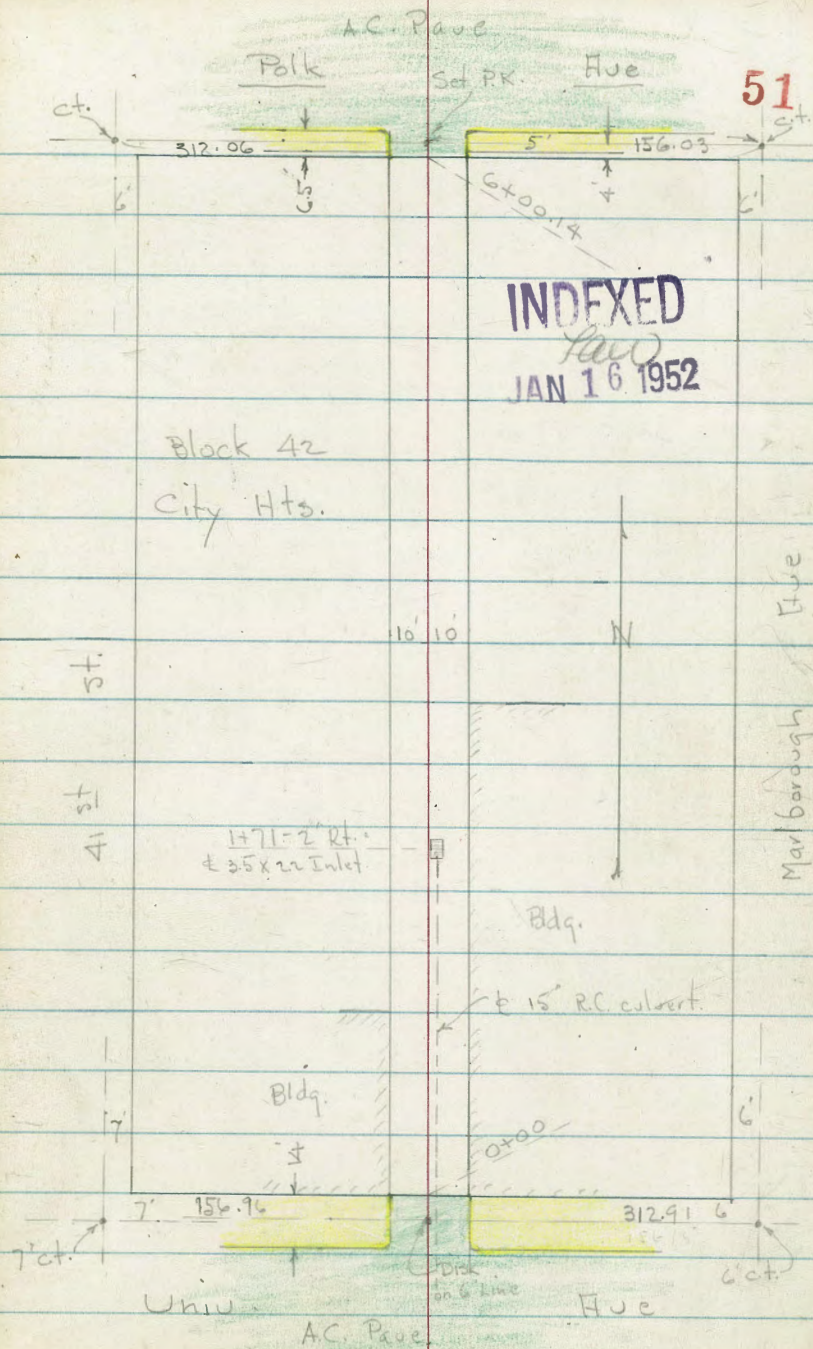

X-Sect. 20' Alley in Block 42. - See sketch - P. 51

0+70-9.8' Lt. = end Brick Bldg. = Nly. of 15' Pilaster

0+67-10.1 Rt. = \$ 6' Door to Bldg.

0+63.5-9.7' Lt. = \$ 15' Pilaster

0+58-10.1 Lt. = \$ 9' Driveway in Bldg.

0+52.5-9.7' Lt. = \$ 18' Pilaster

0+50

0+35-9.7' Lt. = \$ 18' Pilaster

0+32-10.1' Lt. = \$ 4' Door

0+23-10.1' Lt. = \$ 18' Vent in Brick Bldg.

0+18-9.7' Lt. = \$ 18' Pilaster on Bldg.

0+10

- 9.8' Rt. = Beg. Conc. Bldg. end curb on Rt.

0+00 = N.E. of Univ. + edge of AC. pauc +

0-00.5 = 10' Lt. = Beg. Conc. Bldg. + end cb.

water stays in gut. to E. see High gut. at 25 Rt.

0-14 = N. cb. of Univ. - Ret. on Rt. in poor Cond.

B.M. = N.W. B.P. - 41st + Univ.

354.00

Lt.

±

Rt.

52

52.9
9.8 = at
Cor.

52.6 52.7
10

52.76 = Conc.
Floor
10.1

53.47
10.1 = Conc. floor

53.3
10.1 = Bldg.

53.0

53.2
10.1 = Bldg.

53.54 = Conc.
10.1 floor

53.53
10.1 =

53.4
10

53.3

53.7
9.7 = Bldg.

53.39
10 = Pauc
by Bldg.

53.07

53.40
9.8 = Top cb. at Bldg.
+ gut.

53.39
10 = Top-end cb.
+ gut.

53.39 52.98 53.02 52.79 52.5 52.62 53.05/52.52 52.86
Top 50 Top 10 300 ft. 10 Top 25 50 Top
gut. 2' Rad. gut. Not shown gut. 2' Rad. gut. Top

Actual Elev. Shown.

52.7
gut. Falls to E

1+79- 9.6' Lt. = \pm W.M.

Inlet + grate = 15" R.C. pipe - South to Univ. Drain

1+71- 2' Rt. = ϕ 3.5' N.S. x 2.2' wide Conc. box +
used since new inlet was built.

Box inlet - grate - See 1543-P.67 - apparently not

1+69- 8.6' Rt. = ϕ of 32" E.W. + 20' wide - Conc.

1+50- 10.2' Rt. = Conc. found - Metal Bldg. to N.

1+49.5- 10' Lt. = end Conc apron

1+49- 10.7' Rt. = Conc. found. to S.?

1+31.5- 9.9' Lt. = Beg. Conc. apron to Doub. Gar

1+27- 11.7' Lt. = end Conc apron

1+10

1+06.5- 11.3' Lt. = Beg. Conc. apron to Doub. Gar.

1+00- 9' Lt. = \pm P. pole # JPA.4015

10.6' Rt. = Beg. Conc. found to Metal Bldg. to P.

1+00- 10.2' Rt. = end Bld. to S. - Guaranty Chevrolet.
floor.

0+92- 8.2' Lt. = ϕ W.M. + 11' Lt. = \pm Sing. Gar. Conc

0+81- 11.1' Lt. = \pm Sing. Gar. - Conc. floor

0+72- 9.2' Lt. = ϕ W.M.

49.60
9.6' Pipe

51.0 51.0 50.2 50.16 47.05 50.2

10

5

Top
grate

I.E. of
Box

10

49.92

48.80

8.6

I.E. of

Top
grate

Box

51.3

50.8

51.2

53.66 =

10

10.2 =

10.2 Top

at Bldg.

Conc.

found

51.31
14.9
floor

50.98

10

51.42

51.15

14.9 =

9.9 apron

floor

51.36

11.7 =

apron

51.6

51.5

51.8

51.8

10

10

10.6 = Bldg.

51.61

51.56

14.3

floor

11.3 = apron

52.37

50.87

1.1

floor - Gar.

8.2 = pipe

52.40 = Conc. floor

11.1

51.81

9.2 = Top pipe

Lt.

±

Rt.

54

3+03-9.3 Lt. = ± P. pole # J.P.H. 4055

3+03-13' Rt. = ± W.M.

51.91
13

3+02-13' Rt. = ± W.M.

51.92
13 = pipe

3+00-7' Rt. = end A.C. Dr. + 10.7' Rt. = wly. of Conc. wall

52.0
1552.1
10

51.9

52.06
7 = A.C.52.14
10
A.C.52.19
10.6
A.C. at
wall

2+92-11.2' Rt. = ± W.M.

51.13
11.2

2+84-8.8' Lt. = ± W.M.

50.78
8.8
Pipe

Pipe

2+81.5-10.8' Rt. = end Conc. found. to Bldg. + Beg. A.C. Drive @ 5'

51.50
5 =
A.C.

53.43

52.35
10.8 = A.C.
at Cor.

2+75

51.7
1551.5
10

51.3

51.4
10

2+67-11.2' Lt. = ± Conc. apron to Sing. Gar.

52.14
14.9
floor51.68
11.2 = apron10.8' Rt. = " " to N.
2+50-10.2' Rt. = Conc. found. to S.

2+35

226-250
VOC.
R.51.1
5050.9
2051.0
10

50.8

50.7
10 = Bldg.

2+26-9.9' Lt. = end fence

water
standing

2+10-9.1' Lt. = ± W.M.

49.90
9.1
Pipe

2+06-10.5' Lt. = Beg. board fence

2+04-8.6' Lt. = ± P. pole # P.A. 4035

2+00

51.0
1551.0
10

50.9

50.7
1050.7
10.151.06
10.1
Bottom
of Footing51.06
10.1
Top
of Conc.

53.00

Lt

Rt

Rt

55

4+50 - 10.3' Rt. = Brg. Cyclone Fence

55.3
1555.2
10

55.1

55.2
1054.9
204+34 - 8.6' Rt. = \pm W.M.

54.26

8.6 =
pipe4+32 - 9.6' Lt. = \pm W.M.

53.86

9.6 = pipe

4+31 - 8.7' Lt. = \pm 5' Conc. apron to Sing. Gar.

54.64

54.64

54.66

26.5
floor

10

8.7 = apron

4+12 - 17.2' Rt. = \pm Doub. Gar - Conc. Floor

54.52

17.2 = floor

4+08 - 17.4' Lt. = \pm Conc. apron to Sing. Gar.

54.68

54.36

26.2
floor17.4
apron4+00 - 9.2' Lt. = \pm Pipe J.P.A. 4065

54.4

54.0

54.1

54.1

10

10

15

3+86 - 9.6' Lt. = \pm W.M.

53.50

9.6
pipe3+82 - 16' Rt. = \pm Sing. Gar - Dirt floor.

53.4

16 =
floor3+76 - 9.5' Rt. = \pm W.M.

52.65

9.5 pipe

3+56 - 17.2' Lt. = \pm Sing. Gar - Dirt floor.

53.6

17.2 = floor

3+50

53.4

15

53.1

10

52.9

53.1

10

52.8

15

52.8

50

water standing

3+45 = \pm 8' Wing to House

53.1

11.1 = ground at House - No

Conc.
found.3+42 - 15' Lt. = \pm Conc. apron to Sing. Gar.

53.94

53.43

18
floor

15 = apron

3+33 - 11.4' Rt. = \pm Gate to Conc. slab.

52.89

11.4

3+21 - 10.9' Rt. = \pm Sing. Gar - Dirt floor

Conc.

slab.

52.4

10.9 = floor

Lt.

±

Rt.

56

5+99- 9' Lt. = ± P. pole # P. 4125

5+75- 10' Rt. = fence

57.9
10

57.8

57.9
10

5+61- 8.6' Rt. = ± W.M.

56.91

5+50

57.5
10

57.2

57.5
10

8.6

pipe

5+43- 9.9' Rt. = Beg. Picket fence

5+40- 10.4' Lt. = Beg. Picket fence

5+39- 9.4' Lt. = ± W.M.

56.38

9.4

on pipe

5+36- 10.4' Rt. = ± Sing. Gar. - Conc. floor

57.10

5+31- 8.7' Rt. = ± W.M.

10.4

floor

55.80

5+29- 9.9' Rt. = end fence

8.9 =

pipe

5+25- 13.1' Lt. = end apron -

56.87

13.1

apron

5+05- 13.1' Lt. = Beg. Conc. apron to Doub. Gar.

56.74

56.75

17.1

floor

13.1 = apron

5+04- 10.1' Lt. = ± W.M.

55.32

10.1

pipe

5+03- 9.5' Lt. = ± P. pole # I.P.A. 4075

5+00

56.2

20

56.1

10

56.0

56.2

10

56.4

15

4+94- 17.2' Lt. = ± Sing. Gar. - Conc. floor

56.44

17.2

floor

4+85- 8.8' Rt. = ± W.M.

55.16

8.8 = pipe

4+76- 10.4' Lt. = ± W.M.

54.55

10.4 = pipe

4+63- 9.4' Lt. = ± W.M.

54.24

9.4 = pipe

Lt.

E

Rt.

57

check cb. elev. shown in B. 1543 - P. 71

6+06.54 = S. curb line - Note low gut. in R

56.60	56.09	56.80	56.25	56.16	56.25	56.83	56.28	56.71
Top	50 gut.	Top	10 gut.		10 gut.	Top	50 gut.	Top
		2' Rad.			2' Rad.			

9.7' Rt. = end fence
 6+00.14 = S.L. Polk = edge A.C. pave + curbs.
 5+99.5 - 99' Lt. = end fence

56.92	56.75	56.61	56.97	57.19
Top = end cb.	9.9 gut.		9.9 gut.	Top = end cb.

See paving plans
7723-L

X Sec Intersection
Kalmia + Vancouver

3+51 26³ Kt Begin 6" con wall ✓

3+50 9° 03.5098 139/148 SMH ✓

33° Rt & dead man ✓

3+27 20° Rt & 18" P.P. to #3697 ✓

3+25 6° 21.2291

$\Delta = 33^\circ 56'$ mea.
 $\Sigma R = 264^\circ$ comp
 $T = 80^\circ 29'$ mea
 $L = 156^\circ 02'$
 $d = 6.491214'$

3+20 section taken along wly line Vancouver end paving

3+00 3° 38.9487 ✓

C = 2997

2+75 0° 56.6683

C = 875

0° 00'

2+66²⁷ B.C. & Kalmia transition into Vancouver

BM

801 277⁵⁴

NEBR
Kalmia
Montclair
26953

Lt. Nly

Kalmia

Rt. Sly.

60

262.7 262.4 262.2 262.7 262.4 265.9 266.4 267.1 267.3 266.2
88 91 93 93 107 116 116 104 102 113
30 25 15 13 15 25 30 50

269.3 267.7 267.3 266.9 266.6 266.4 267.7 267.9 267.0
83 98 103 106 109 111 95 96 105
36 29 25 15 15 25 30 50

271.04 267.14 267.33 266.78 266.70 266.39 266.79 266.91 266.04
65 104 103 107 108 112 107 106 95
36 26 21 21 21 15 15 20 30

271.44 269.33 268.58 267.84 267.71 267.38 267.77 267.89 267.44
61 92 92 92 93 106 96 96 82
30 22 17 17 15 15 15 20 30

272.24 269.69 269.65 269.13 269.14 268.74 268.78 269.34 270.06
53 78 78 81 84 88 87 82 78
30 20 15 15 15 15 15 20 30

272.63 270.18 269.74 269.54 269.64 269.37 269.37 269.79 270.46
42 73 78 80 86 83 82 77 78
30 20 15 15 15 15 15 20 30

19328
this book (269⁵⁰ Beach Book) 277⁵⁴

TP 784 272⁴⁶ 12⁹² 264⁶² 1441³⁵ P.R.C. Vancouver

16°58'
4+23° = end Kalmia St
1441³⁵ P.R.C. Vancouver St.
C-2309

4400 14°28.0693'
3+95 250 ft Nly end 4' wide 8' high Eugenia hedge
3+85 25° RT E 8' con drive ✓

3+80 22° RT end 6" con wall ✓

3+75 11°45.7899'

3+63 21° RT E 4' con walk ✓

267.7 266.9 265.0 264.8 264.5 264.2 264.5 263.3 262.7 261.1
98 106 125 127 130 133 122 143 148 162
50 30 25 15 6 7 20 25 30

265.8 265.5 264.9 264.4 264.7 263.8 263.0 261.7
112 120 126 131 128 132 143 158
25 15 7 15 25 40

265.7 265.1 265.0
1237 1243 1245
258 30 425
Chor
266.4 265.6 265.5
110 118 120
222 222 222
221 221 221
Fouling

267.0 266.94 266.0 265.3 265.5 265.4 266.0 266.0
105 102 115 122 120 112 115 115
25 15 11 15 25 30 40
266.43 266.48 266.23 266.03
111 1106 1131 1151
213 25 30 40
π 277⁵⁴

"X" Sec Vancouver St
Nly Kalmia to Sly Extreme

1+13 29⁷ Lt to SW cor cond rivio

1400 19° 49.6130

0+91 28° Lt to NW cor 15' wide drive con

140° 52.21051
0+75' 29² Lt End 2⁵ Picket Fence ✓

0+60 27⁶ Lt Begin 25 Picket Fence

0+57 28^g Lt E 10' con drive

0.456 $9^{\circ} 54.8070$

0144 29th Lt end 2nd Picket Fence

0125 4° 57' 40.35" 30.4 to Force here

04/14 216 Lt E 6" R/Pole #P2405

$C = 24.27$

0413 29°41' Begin 2⁵ Picket Fence

0400 B.C. 0°00' 30° L + E 8' con drive

$5 + 75^{26}$ BC. FB2080.

24. Ely

£
Van Couver

set - wly

62

26.335	27.746	26.708	26.616	26.62	26.63	26.54	26.61
4 ¹¹	5 ⁰⁰	5 ³⁸	5 ⁹	6 ³	6 ³	7 ²	6 ⁴
65	40	29.6	25	15		23	30
door	drx	drive					

5¹⁸
28⁹⁰
drill

2680 2079 2079 2681 2684 2677 2671

45 46 47 48 51 48 48 54
40 30 25 20 16 18 25

268.01 268.01 268.01

445 445 442

45 40 288

Door drive

Salix

268.0	269.0	269.5	269.6	269.1	269.0	268.4	267.4	266.81
44	44	40	38	34	35	41	51	54
70	30	25	16	10	20	30	7/12	25

*Mus-
not
done*

*Salix
latrunc.
Mau.*

41	38	35	33	27	27	25	12	14
40	30	25	16	15	25	31	40	

26838	26845	26877	2691	2696 ✓	2699	2703	2713	2715	2718
4 ²⁸	4 ⁴⁰	3 ²⁸	3 ⁴	2 ²	2 ⁶	2 ²	1 ²	1 ²	0 ²
40 ⁵	30 ⁵	30	25	14	24	26	30	40	
	5115								

$\pi 272 \frac{4}{6}$

R100 7° 00.0497

c=24³³

c=23¹³

c=26⁸⁷

1+95 25° LT Begin 3' picket fence ✓

A=48²³

1+89 34¹ LT & 12' con drive ✓ ✓

LR=240

L=202⁶⁷

T=107⁸²

1+82 24³ RT & 3' con walk ✓

d₁=7.161972

1+75 4° 01.0004' 392 to NE cor House

1+73 22° RT & 8" Eucalyptus tree ✓

1+69 24⁵ LT w/ end 5' cyclon fence to line ✓

1+68 20² LT & 6" Air Hyd

1+63 22³ LT & 8" tel Pole # 600608H ✓

1+50 1° 01.9511

c=8⁵⁵

c=8⁰³ c=9²⁷

1+41 35° PRC. 0° 00' 28° 01.5184' ↓

c=16³³

1+25 24° 47.0165

267.9
48 51 55 72 78 82 78 85 80 264.5
50 25 20 15 6 7 20 25

63

268.16 267.94 267.62
430 462 484
51 494 344
floor drive drive

267.9 267.3 267.0 265.8 265.0 264.5 264.3 264.6 264.3 264.5 263.1 259.3
44 52 55 62 75 80 83 72 82 100 92 132
50 30 25 21 15 5 7 11 25 35 50

267.6 266.9 265.5 264.8 264.6 264.3 264.8 263.9 262.8 260.4
42 55 72 72 79 83 72 85 92 131
50 30 25 15 5 7 15 25 50

267.4 267.0 265.3 264.9 264.7 264.3 264.7 263.5 262.8 260.7
42 55 72 76 78 82 78 92 92 118
50 30 25 15 6 8 20 25 50

267.8 267.0 265.7 265.1 265.2 265.0 264.4 264.8 263.2 262.1
42 55 68 72 73 75 81 72 93 94
50 31 29 25 15 8 11 25 30

272.46

23° Lt & 13' con drive ✓
 2+75 { 15° 57.1976'

2+71 11 1/2 Lt & SMH ✓

2+66 24 1/2 Lt end w/ 2' picket fence to line ✓

2+61 25 1/2 Lt end (8') con ribbon drives ✓

2+50 12° 58.1483'

2+26 24 1/2 Lt Begins (8) 2' wide con ribbon drives with 3' between ribbons ✓

TP₂ 4⁴⁹ 270⁶² 6³³ 266¹³

2+25 9° 59.0990' 32² Rt to SE cor House ✓
 Taylor says closest corner

2+24 19 1/2 Lt & 8" PPole (Anchor) ✓

2+23 19 1/2 Rt & 16" PPole #P 2360 ✓

2+22 26° Lt end 3' picket fence ✓

2+16 20° Rt & 8" tree ✓

2+11 14 1/2 Rt & 8" Pepper tree ✓

2+04 21° Lt & 18" Pepper tree ✓

Lt-Elly & Rt-w/ly

263.96 263.76 264.78 264.66 264.54 265.9 265.4 265.8 265.7 264.0 264.4 64
 66 68 58 58 58 42 42 53 48 42 66 103
 41 39 25 24 23 12 10 11 17 25 30
 Floor

266.1 45.2 11.2 run 266.74 266.63 266.42 3.88 3.27 4.20 40.3 Floor 35.3 drive 25.3 drive 266.22 266.14 266.40 265.9 265.6 265.1 265.5 265.5 264.0 262.6 261.3 259.4 3.90 3.28 4.22 4.1 5.0 5.5 5.1 5.1 6.6 8.0 9.3 11.2 40 Floor 34 24.8 15 drive 8 10 15 18 25 33 50

267.06 266.98 266.74 3.56 3.64 3.88 41.7 Floor 34.8 drive 24.8 drive

π 270⁶² 262.1 261.9 265.9 265.0 264.8 265.4 265.5 263.7 262.9 5.4 5.6 6.6 7.5 7.2 7.1 7.0 8.8 9.6 40 25 15 7 9 12 20 25

π 272⁴⁶

Lt = Ely

L

Rt = Wly

65

3+41 23° Lt & deadman ✓

3+40 22° Lt end 8" con wall with 3' fence on top ✓

3+40 17° Lt & 8" P.P. 1/2 PR 343 ✓

263.0 264.3 264.14
 84 71 725
 222 222 222
 Footing 3d Top wall

262.2 263.1 264.6 265.0 265.5 265.3 262.0
 92 83 63 63 59 52 61 94
 40 25 22 10 15 25 50

3+25 21° 55' 2962'

T.P.

465 271.39

388 266.74

PR 340
 nail in Ely of PR 340
 3+41 17° Lt

3+22 20° Lt & 35' con walk

262.62 263.22 264.22 264.41
 800 740 640 631
 352 252 232 203
 Footing top 2 steps

3+08 23° Lt Begin 8" con wall with fence on top ✓
 3' picket

262.57 262.62 263.50 264.12 264.13
 725 800 620 263.92
 425 40 252
 Floor drive

3+06 25° Lt & 9' con drive ✓

3+00 18° 56' 2469'

262.6 264.2 264.7 265.4 265.7 265.4 265.7 265.0 261.2
 80 64 52 52 49 52 49 56 94
 40 25 20 13 13 15 25 50

2+98 22° Lt end 6" con wall with 2' fence on top ✓

264.29 264.7 265.6
 633 52 500
 222 222 222
 Footing 3d Top wall
 265.57 265.0 265.7
 585 56 48
 222 222 222
 Footing 3d Top wall

2+80 23° Lt Begin 6" con wall with a 2' picket fence on top

270.62

4+43 24° Lt & 8' con drive ✓

C=16°

C=14°

C=17°

4+33⁹⁹ B.C. Rt. 0°00'

4+00

3+94 37° Rt & 3' con walk ✓

3+87 25° Lt & 10' con drive ✓

3+75

3+60 35° Rt & single garage ✓

3+44⁰² E.C. 24° 11.50"

C=17°

C=20°

3+41 17° Rt & 8' p.p. 1/2 4P 234 ✓

Lt-Ely

2

Rt-Wly

66

26521
26510
26484
26481
6° 6° 6° 6°
40 35 25 24°
floor drive

2646 2646 2652 2659 2657 2661 2660 2631
6° 6° 5° 5° 5° 5° 8°
40 25 15 10 12 25 50

2630 2632 2650 2655 2655 2655 2650 2641
8° 7° 6° 5° 5° 5° 6° 7°
40 25 15 15 25 40 50

26558 26539
5° 6°
37° 42°

26360 26257 26252
7° 7° 7°
40 35 25°
floor drive

2627 2637 2647 2654 2653 2656 2654
8° 7° 6° 6° 5° 6°
40 25 16 10 25 35

26519 26519
6° 6°
35° 40°

2616 2633 2649 2654 2654 2655 2643
9° 8° 6° 6° 5° 7°
40 25 15 12 25 50

π 271°

5450 17° 50.218' 26° RT to fence here ✓

5425 13° 59.560' 24° RT to fence here ✓

5708 25° RT & 4" Magnolia tree ✓

5400 10° 08.902 22° RT to fence here ✓

4497 21° RT & 3' on walk ✓

4490 { 22° LT & dead man
16° LT & 10' Anchor pole no number ✓

4483 13° RT & 10" PP pole # JP2332 ✓

4475 6° 18.344

4467 20° RT & 12" Cypress tree ✓

4466 20° RT Begin 2' Picket fence planting behind fence ✓

4462 24° LT to Wye cut 8' con block wall L to Wye ✓
C=24°

C=22° C=27°

4450 2° 27 586'

A=50° 22' MPA

EA=18622 comp

L=16320

T=8786

C, 9, 23034

LT=Ely

Q

RT=Wly

67

262.0 265.4 266.4 266.3 265.9 265.6 265.8 263.9
94 56 50 52 55 58 56 75
50 25 15 13 25 35 38

262.2 265.9 266.5 266.5 266.1 266.3 266.1 265.8
92 55 42 42 52 51 53 56
50 25 15 13 15 25 40

262.7 264.8 266.3 266.5 266.3 266.5 266.2 266.4 266.0
91 66 51 42 54 42 52 50 54
50 25 15 10 12 20 25 35

266.28 266.14 265.99
52 52 54
218 25 35

265.5 265.5 265.2 265.8 266.3 266.2 266.5 266.1 266.0
52 59 62 56 51 52 42 42 53 54
37 25 23 16 10 12 20 25 40

260.9 264.8 265.8 266.2 266.1 266.6 265.9 263.6
105 66 56 52 53 48 55 78
50 25 16 10 15 25 50

271 39

6+60 24° RT & 3' con walk ✓

6+48 24° LT & 10' con drive ✓

6+34 24° RT & 3' con walk ✓

6+30

6+15 25° RT & 3" Eucalyptus tree ✓

5+97 6° EC, 25° 11' 23° RT & 2' Picket Fence ✓
Begin 3' wire fence

5+97 23° LT & deadman ✓

5+96 18° LT & 12" Anchor Pole no number ✓

5+94 16° RT & 12" IPole 4 JP 2320 ✓

5+93 24° RT Begin 2' Picket Fence ✓

5+85 33° RT & 8' con drive ✓

CC 20° CC 24°

TP4 158 268 39 458 266 81 596 180 14
PK Nail in Anchor

5+75 21° 40.876' 26° RT End 3' Picket Fence ✓

LT-ELY

E

RT-WLY

68

264.2 264.2 263.1 263.3 263.2 263.96 263.01 263.22
42 42 53 51 53 543 538 517
40 28 14 12 24 25 30
264.36 264.24
403 410
35 242

263.45 263.43
424 426
24 30

265.0 265.0 263.9 263.9 263.7 263.3 263.2
34 34 45 45 42 51 52
40 28 14 12 25 35

265.1 265.7 264.4 264.8 264.9 264.3 263.0
22 27 20 36 35 41 51
40 28 18 11 25 40

264.03 263.99
436 440
338 363
dms floor

268.39
263.3 263.2 264.0 265.7 265.4 264.9 264.4
81 52 52 52 60 65 70
50 25 15 15 25 38

271.39

7+60

7+53 24⁶ RT & 3⁰ con walk ✓

7+51 22⁵ LT & 12" Pepper tree ✓

7+48 24⁷ LT Begin 6' wire fence ✓

7+42 25⁴ LT & single garage con floor ✓

7+38 25⁰ RT & 7⁰ con ribbon drive (1⁵ ca) ✓

7+30

7+25 24² RT end 3' Picket fence ✓

7+23 16³ RT & 12" PPole # JP2306 ✓

7+20 26² LT t.N.W cor house addition

7+00

6+92 24² RT & 6⁰ con ribbon drive (1⁵ ca) ✓

6+81 24³ RT Begin 3' Picket fence ✓

6+76 17⁵ RT & 10' A.C. drive ✓

6+71 24⁵ RT end 3' wire fence ✓

LT=ELY

E

RT=ELY

69

262.1 262.3 261.5 262.3 262.4 263.0 263.1
6³ 6¹ 6² 6² 6⁰ 5⁴ 5³
50 25 11 11 25 35

262.84 262.96
5⁵⁵ 5⁴³
24⁶ 35

262.24
6¹⁵
25²
Floor

262.2 261.9 261.8 262.4 262.6 262.6 262.3
6² 6⁵ 6⁵ 6⁰ 5⁸ 5⁸ 5²
25 13 11 10 25 30

262.61
5²⁸
26⁶
Floor

263.1 263.0 262.5 262.1 262.7 262.8 262.5 262.2
5³ 5⁴ 5² 6³ 5⁷ 5⁶ 5² 6²
50 25 13 12 10 25 35

262.62 262.19
5²⁷ 6²⁰
24⁷ 35

262.28 262.76 261.92 260.61
5⁶¹ 5⁶³ 6⁴⁷ 7²⁸
17⁵ 25 40 50

π 268³⁹

8+75

8+54 17° RT & deadman

8+47^E 65° RT & 3^E x 3^E gas vault

8+47 17° RT & 12" PP 1/4 P3655

TP_S

2⁹²

269⁰⁷

43⁸

264¹⁰

Pin in P1016
P3655
8+47 17° RT

8+42⁸⁴ end st)

8+31 25° Lt & 6' wire fence ✓

8+30 23⁴ Lt & FireHyd ✓

8+20

8+12 24° RT & 3" tree ✓

8+00

7+98 24° RT & planting 11 to line

7+88 47° RT & double garage con floor

7+78 23° Lt & 2⁵ con walk ✓

7+72 23° Lt & 8" Pepper tree ✓

7+72 23° RT & 8" Pepper tree ✓

Lt & Fly
256.2 259.2 260.9 262.6 263.0 262.8 262.1 70
102 72 63 45 41 43 50
36 34 25 15 25 50

263.19
388
65

260.0 261.7 260.2 261.0 262.7 263.2 263.5 263.5
84 62 82 62 52 52 42 42
40 27 25 18 15 25 40

261.5 261.5 261.8 261.0 262.8 263.4 264.0 264.2
62 62 66 74 56 55 50 42 42
35 25 18 17 11 13 25 40

261.9 261.7 261.3 262.5 263.0 263.8 263.8
65 62 71 52 54 46 46
25 14 13 12 25 45

261.23 261.76 263.87
64 63
25 23
452
47

268.39

Lt. Ely

2

rt. Wly

71

BM starting

796 269⁵⁷

✓
+004
26953

TP₂

1010 277⁵³

309 267⁴³

TP₄

509 270⁵²

164 265⁴³

10+00

9+50

9+00

8+84 E crosses Wood Barricade

Py 60000
Hodder
6-23

258.9 259.4 259.4 259.3 258.1 256.1 255.1 251.1
82 72 72 72 90 110 120 160
50 40 25 15 15 20 50

258.1 259.1 260.5 261.0 260.8 260.1 259.7 258.7
86 76 66 66 63 70 74 84
50 40 25 15 20 25 50

257.6 259.6 260.7 262.2 262.3 261.1 260.1
95 75 64 49 48 60 70
50 40 25 25 40 50

267.07

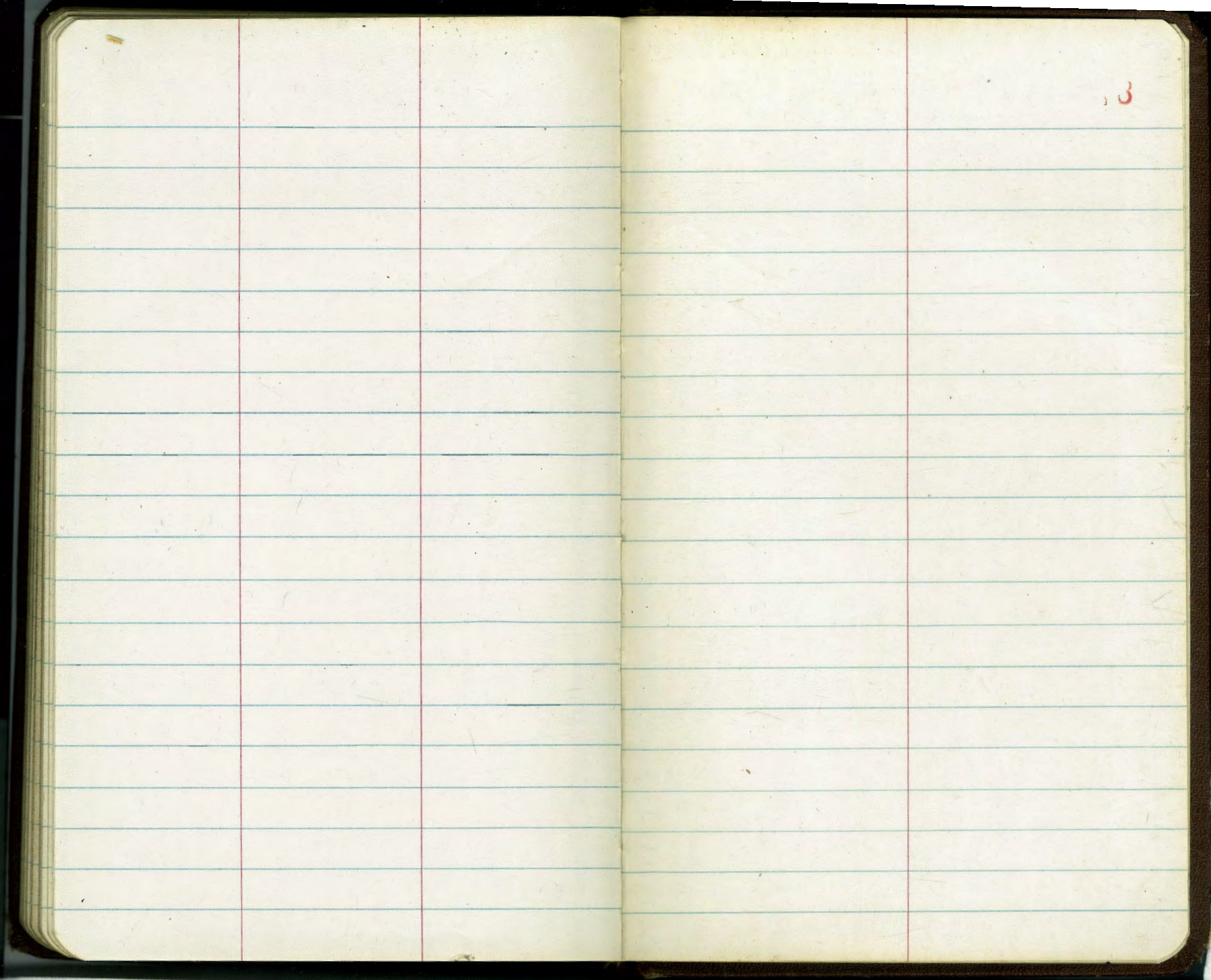

0002909
 1280
 23 2720
 5818
 0894820

SE Top Hdt 452.81

Made & Tox
 004
 SEBP 346.03

Nonro & Tox
 338.96
 SEBP

385
 285
 1133
 1518

313.91
 156.955

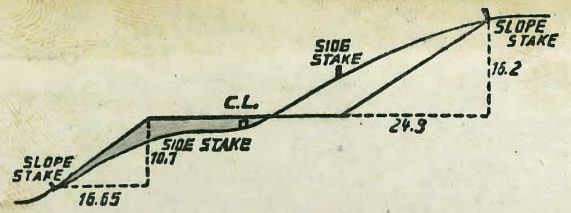

DISTANCES FROM SIDE STAKES FOR CROSS-SECTIONING.
 SLOPE 1 1/2 TO 1. ROADWAY OF ANY WIDTH.

	0	.1	.2	.3	.4	.5	.6	.7	.8	.9	
0	0.00	0.15	0.30	0.45	0.60	0.75	0.90	1.05	1.20	1.35	0
1	1.50	1.65	1.80	1.95	2.10	2.25	2.40	2.55	2.70	2.85	1
2	3.00	3.15	3.30	3.45	3.60	3.75	3.90	4.05	4.20	4.35	2
3	4.50	4.65	4.80	4.95	5.10	5.25	5.40	5.55	5.70	5.85	3
4	6.00	6.15	6.30	6.45	6.60	6.75	6.90	7.05	7.20	7.35	4
5	7.50	7.65	7.80	7.95	8.10	8.25	8.40	8.55	8.70	8.85	5
6	9.00	9.15	9.30	9.45	9.60	9.75	9.90	10.05	10.20	10.35	6
7	10.50	10.65	10.80	10.95	11.10	11.25	11.40	11.55	11.70	11.85	7
8	12.00	12.15	12.30	12.45	12.60	12.75	12.90	13.05	13.20	13.35	8
9	13.50	13.65	13.80	13.95	14.10	14.25	14.40	14.55	14.70	14.85	9
10	15.00	15.15	15.30	15.45	15.60	15.75	15.90	16.05	16.20	16.35	10
11	16.50	16.65	16.80	16.95	17.10	17.25	17.40	17.55	17.70	17.85	11
12	18.00	18.15	18.30	18.45	18.60	18.75	18.90	19.05	19.20	19.35	12
13	19.50	19.65	19.80	19.95	20.10	20.25	20.40	20.55	20.70	20.85	13
14	21.00	21.15	21.30	21.45	21.60	21.75	21.90	22.05	22.20	22.35	14
15	22.50	22.65	22.80	22.95	23.10	23.25	23.40	23.55	23.70	23.85	15
16	24.00	24.15	24.30	24.45	24.60	24.75	24.90	25.05	25.20	25.35	16
17	25.50	25.65	25.80	25.95	26.10	26.25	26.40	26.55	26.70	26.85	17
18	27.00	27.15	27.30	27.45	27.60	27.75	27.90	28.05	28.20	28.35	18
19	28.50	28.65	28.80	28.95	29.10	29.25	29.40	29.55	29.70	29.85	19
20	30.00	30.15	30.30	30.45	30.60	30.75	30.90	31.05	31.20	31.35	20
21	31.50	31.65	31.80	31.95	32.10	32.25	32.40	32.55	32.70	32.85	21
22	33.00	33.15	33.30	33.45	33.60	33.75	33.90	34.05	34.20	34.35	22
23	34.50	34.65	34.80	34.95	35.10	35.25	35.40	35.55	35.70	35.85	23
24	36.00	36.15	36.30	36.45	36.60	36.75	36.90	37.05	37.20	37.35	24
25	37.50	37.65	37.80	37.95	38.10	38.25	38.40	38.55	38.70	38.85	25
26	39.00	39.15	39.30	39.45	39.60	39.75	39.90	40.05	40.20	40.35	26
27	40.50	40.65	40.80	40.95	41.10	41.25	41.40	41.55	41.70	41.85	27
28	42.00	42.15	42.30	42.45	42.60	42.75	42.90	43.05	43.20	43.35	28
29	43.50	43.65	43.80	43.95	44.10	44.25	44.40	44.55	44.70	44.85	29
30	45.00	45.15	45.30	45.45	45.60	45.75	45.90	46.05	46.20	46.35	30
31	46.50	46.65	46.80	46.95	47.10	47.25	47.40	47.55	47.70	47.85	31
32	48.00	48.15	48.30	48.45	48.60	48.75	48.90	49.05	49.20	49.35	32
33	49.50	49.65	49.80	49.95	50.10	50.25	50.40	50.55	50.70	50.85	33
34	51.00	51.15	51.30	51.45	51.60	51.75	51.90	52.05	52.20	52.35	34
35	52.50	52.65	52.80	52.95	53.10	53.25	53.40	53.55	53.70	53.85	35
36	54.00	54.15	54.30	54.45	54.60	54.75	54.90	55.05	55.20	55.35	36
37	55.50	55.65	55.80	55.95	56.10	56.25	56.40	56.55	56.70	56.85	37
38	57.00	57.15	57.30	57.45	57.60	57.75	57.90	58.05	58.20	58.35	38
39	58.50	58.65	58.80	58.95	59.10	59.25	59.40	59.55	59.70	59.85	39
40	60.00	60.15	60.30	60.45	60.60	60.75	60.90	61.05	61.20	61.35	40
41	61.50	61.65	61.80	61.95	62.10	62.25	62.40	62.55	62.70	62.85	41
42	63.00	63.15	63.30	63.45	63.60	63.75	63.90	64.05	64.20	64.35	42
43	64.50	64.65	64.80	64.95	65.10	65.25	65.40	65.55	65.70	65.85	43
44	66.00	66.15	66.30	66.45	66.60	66.75	66.90	67.05	67.20	67.35	44
45	67.50	67.65	67.80	67.95	68.10	68.25	68.40	68.55	68.70	68.85	45
46	69.00	69.15	69.30	69.45	69.60	69.75	69.90	70.05	70.20	70.35	46
47	70.50	70.65	70.80	70.95	71.10	71.25	71.40	71.55	71.70	71.85	47
48	72.00	72.15	72.30	72.45	72.60	72.75	72.90	73.05	73.20	73.35	48
49	73.50	73.65	73.80	73.95	74.10	74.25	74.40	74.55	74.70	74.85	49
50	75.00	75.15	75.30	75.45	75.60	75.75	75.90	76.05	76.20	76.35	50

THE NATIONAL BLANK BOOK COMPANY
 HOLYOKE MASSACHUSETTS
 NEW YORK CHICAGO BOSTON SAN FRANCISCO