

2114

2114

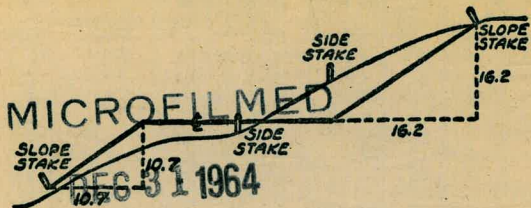

DISTANCES FROM SIDE STAKES FOR CROSS-SECTIONING
SLOPE 1 TO 1. ROADWAY OF ANY WIDTH

	0	.1	.2	.3	.4	.5	.6	.7	.8	.9	
0	0.00	0.10	0.20	0.30	0.40	0.50	0.60	0.70	0.80	0.90	0
1	1.00	1.10	1.20	1.30	1.40	1.50	1.60	1.70	1.80	1.90	1
2	2.00	2.10	2.20	2.30	2.40	2.50	2.60	2.70	2.80	2.90	2
3	3.00	3.10	3.20	3.30	3.40	3.50	3.60	3.70	3.80	3.90	3
4	4.00	4.10	4.20	4.30	4.40	4.50	4.60	4.70	4.80	4.90	4
5	5.00	5.10	5.20	5.30	5.40	5.50	5.60	5.70	5.80	5.90	5
6	6.00	6.10	6.20	6.30	6.40	6.50	6.60	6.70	6.80	6.90	6
7	7.00	7.10	7.20	7.30	7.40	7.50	7.60	7.70	7.80	7.90	7
8	8.00	8.10	8.20	8.30	8.40	8.50	8.60	8.70	8.80	8.90	8
9	9.00	9.10	9.20	9.30	9.40	9.50	9.60	9.70	9.80	9.90	9
10	10.00	10.10	10.20	10.30	10.40	10.50	10.60	10.70	10.80	10.90	10
11	11.00	11.10	11.20	11.30	11.40	11.50	11.60	11.70	11.80	11.90	11
12	12.00	12.10	12.20	12.30	12.40	12.50	12.60	12.70	12.80	12.90	12
13	13.00	13.10	13.20	13.30	13.40	13.50	13.60	13.70	13.80	13.90	13
14	14.00	14.10	14.20	14.30	14.40	14.50	14.60	14.70	14.80	14.90	14
15	15.00	15.10	15.20	15.30	15.40	15.50	15.60	15.70	15.80	15.90	15
16	16.00	16.10	16.20	16.30	16.40	16.50	16.60	16.70	16.80	16.90	16
17	17.00	17.10	17.20	17.30	17.40	17.50	17.60	17.70	17.80	17.90	17
18	18.00	18.10	18.20	18.30	18.40	18.50	18.60	18.70	18.80	18.90	18
19	19.00	19.10	19.20	19.30	19.40	19.50	19.60	19.70	19.80	19.90	19
20	20.00	20.10	20.20	20.30	20.40	20.50	20.60	20.70	20.80	20.90	20
21	21.00	21.10	21.20	21.30	21.40	21.50	21.60	21.70	21.80	21.90	21
22	22.00	22.10	22.20	22.30	22.40	22.50	22.60	22.70	22.80	22.90	22
23	23.00	23.10	23.20	23.30	23.40	23.50	23.60	23.70	23.80	23.90	23
24	24.00	24.10	24.20	24.30	24.40	24.50	24.60	24.70	24.80	24.90	24
25	25.00	25.10	25.20	25.30	25.40	25.50	25.60	25.70	25.80	25.90	25
26	26.00	26.10	26.20	26.30	26.40	26.50	26.60	26.70	26.80	26.90	26
27	27.00	27.10	27.20	27.30	27.40	27.50	27.60	27.70	27.80	27.90	27
28	28.00	28.10	28.20	28.30	28.40	28.50	28.60	28.70	28.80	28.90	28
29	29.00	29.10	29.20	29.30	29.40	29.50	29.60	29.70	29.80	29.90	29
30	30.00	30.10	30.20	30.30	30.40	30.50	30.60	30.70	30.80	30.90	30
31	31.00	31.10	31.20	31.30	31.40	31.50	31.60	31.70	31.80	31.90	31
32	32.00	32.10	32.20	32.30	32.40	32.50	32.60	32.70	32.80	32.90	32
33	33.00	33.10	33.20	33.30	33.40	33.50	33.60	33.70	33.80	33.90	33
34	34.00	34.10	34.20	34.30	34.40	34.50	34.60	34.70	34.80	34.90	34
35	35.00	35.10	35.20	35.30	35.40	35.50	35.60	35.70	35.80	35.90	35
36	36.00	36.10	36.20	36.30	36.40	36.50	36.60	36.70	36.80	36.90	36
37	37.00	37.10	37.20	37.30	37.40	37.50	37.60	37.70	37.80	37.90	37
38	38.00	38.10	38.20	38.30	38.40	38.50	38.60	38.70	38.80	38.90	38
39	39.00	39.10	39.20	39.30	39.40	39.50	39.60	39.70	39.80	39.90	39
40	40.00	40.10	40.20	40.30	40.40	40.50	40.60	40.70	40.80	40.90	40
41	41.00	41.10	41.20	41.30	41.40	41.50	41.60	41.70	41.80	41.90	41
42	42.00	42.10	42.20	42.30	42.40	42.50	42.60	42.70	42.80	42.90	42
43	43.00	43.10	43.20	43.30	43.40	43.50	43.60	43.70	43.80	43.90	43
44	44.00	44.10	44.20	44.30	44.40	44.50	44.60	44.70	44.80	44.90	44
45	45.00	45.10	45.20	45.30	45.40	45.50	45.60	45.70	45.80	45.90	45
46	46.00	46.10	46.20	46.30	46.40	46.50	46.60	46.70	46.80	46.90	46
47	47.00	47.10	47.20	47.30	47.40	47.50	47.60	47.70	47.80	47.90	47
48	48.00	48.10	48.20	48.30	48.40	48.50	48.60	48.70	48.80	48.90	48
49	49.00	49.10	49.20	49.30	49.40	49.50	49.60	49.70	49.80	49.90	49
50	50.00	50.10	50.20	50.30	50.40	50.50	50.60	50.70	50.80	50.90	50

Distance of slope stake from side or shoulder stake for any width roadway, slope 1 to 1. If ground is nearly level, the cut or fill at side stake is located by the double entry method in left column and top row. The number in body of table in same row and column gives distance from side stake to slope stake. If ground is not level estimate the difference in elevation between the side stake and slope stake, lower target by this amount if cut, elevate if fill. Add this amount to cut or fill and find distance in table. Set up rod at this point, and line of sight should cut target. If it does not make the slight adjustment necessary.

Align next 2/13

INDEXED

to page # 41

TABLE XIII—CORRECTIONS FOR TANGENTS AND EXTERNALS

These corrections are to be added to the approximate values, found by dividing the tangent, or external, for a 1° curve (Table VIII) by the degree of curve, in order to obtain the true tangents, or externals. Intermediate values may be obtained by interpolation.

FOR TANGENTS ADD

Central Angle	DEGREE OF CURVE													
	5°	10°	15°	20°	25°	30°	35°	40°	45°	50°	55°	60°	65°	70°
10°	.03	.06	.09	.13	.16	.19	.22	.25	.28	.31	.34	.38	.42	.46
15°	.04	.10	.14	.19	.24	.29	.34	.39	.45	.51	.53	.58	.63	.68
20°	.06	.13	.19	.26	.32	.39	.45	.51	.58	.65	.72	.79	.84	.90
25°	.08	.16	.24	.33	.40	.49	.58	.67	.75	.83	.90	.99	1.06	1.14
30°	.10	.19	.29	.39	.49	.59	.69	.79	.89	.99	1.09	1.20	1.29	1.39
35°	.11	.22	.34	.47	.58	.69	.79	.89	.99	1.04	1.20	1.42	1.54	1.66
40°	.13	.26	.40	.53	.67	.80	.93	1.06	1.20	1.34	1.49	1.64	1.79	1.94
45°	.15	.30	.44	.60	.76	.91	1.06	1.21	1.37	1.52	1.70	1.87	2.04	2.21
50°	.17	.34	.51	.68	.85	1.02	1.19	1.36	1.54	1.72	1.91	2.10	2.29	2.48
55°	.19	.38	.57	.76	.95	1.14	1.32	1.52	1.72	1.92	2.14	2.35	2.56	2.77
60°	.21	.42	.63	.84	1.05	1.27	1.49	1.71	1.94	2.17	2.38	2.60	2.83	3.07
65°	.23	.46	.69	.93	1.16	1.40	1.64	1.88	2.13	2.38	2.63	2.88	3.13	3.39
70°	.25	.51	.76	1.02	1.28	1.54	1.80	2.06	2.33	2.60	2.88	3.16	3.44	3.72
75°	.27	.56	.83	1.12	1.40	1.69	1.98	2.27	2.57	2.87	3.16	3.47	3.78	4.09
80°	.30	.61	.91	1.22	1.53	1.84	2.15	2.46	2.78	3.10	3.44	3.78	4.12	4.46
85°	.33	.66	1.00	1.33	1.68	2.02	2.36	2.70	3.05	3.40	3.77	4.14	4.55	4.89
90°	.36	.72	1.09	1.45	1.83	2.20	2.57	2.94	3.32	3.70	4.10	4.50	4.91	5.32
95°	.39	.79	1.19	1.55	2.00	2.40	2.80	3.20	3.61	4.02	4.40	4.98	5.38	5.83
100°	.43	.86	1.30	1.74	2.18	2.62	3.06	3.50	3.95	4.40	4.85	5.37	5.85	6.34
110°	.51	1.03	1.56	2.08	2.61	3.14	3.67	4.21	4.76	5.31	5.86	6.43	7.01	7.60
120°	.62	1.25	1.93	2.52	3.16	3.81	4.45	5.11	5.77	6.44	7.12	7.80	8.50	9.22

FOR EXTERNALS ADD

Central Angle	DEGREE OF CURVE													
	5°	10°	15°	20°	25°	30°	35°	40°	45°	50°	55°	60°	65°	70°
10°	.001	.003	.004	.006	.007	.008	.009	.011	.012	.014	.015	.017	.018	.020
15°	.003	.007	.010	.014	.018	.023	.027	.029	.032	.035	.039	.043	.047	.051
20°	.006	.011	.017	.022	.028	.034	.038	.045	.051	.057	.063	.070	.076	.083
25°	.009	.018	.027	.036	.046	.056	.065	.074	.083	.093	.106	.120	.127	.135
30°	.013	.025	.038	.051	.065	.078	.090	.103	.116	.129	.149	.170	.179	.188
35°	.018	.035	.054	.072	.086	.109	.131	.153	.175	.197	.213	.230	.247	.264
40°	.023	.046	.070	.093	.117	.141	.172	.203	.234	.265	.277	.290	.315	.341
45°	.030	.060	.093	.119	.153	.184	.216	.254	.289	.325	.351	.378	.411	.445
50°	.037	.075	.116	.151	.189	.227	.266	.305	.345	.384	.425	.467	.508	.550
55°	.046	.093	.142	.188	.236	.283	.332	.381	.420	.479	.530	.582	.641	.700
60°	.056	.112	.168	.225	.283	.340	.398	.457	.516	.575	.636	.697	.774	.851
65°	.067	.135	.204	.273	.343	.412	.483	.554	.625	.697	.771	.845	.922	1.01
70°	.080	.159	.240	.321	.403	.485	.568	.652	.735	.819	.906	.994	1.08	1.17
75°	.095	.182	.266	.353	.440	.528	.618	.707	.797	.877	1.07	1.18	1.29	1.39
80°	.110	.220	.332	.445	.558	.671	.787	.903	1.02	1.13	1.25	1.38	1.50	1.62
85°	.128	.259	.391	.524	.657	.790	.926	1.06	1.20	1.34	1.47	1.62	1.76	1.91
90°	.149	.299	.450	.603	.756	.910	1.07	1.22	1.38	1.54	1.70	1.87	2.03	2.20
95°	.174	.350	.522	.706	.885	1.06	1.25	1.43	1.62	1.80	1.99	2.18	2.38	2.58
100°	.200	.401	.604	.809	1.01	1.22	1.43	1.64	1.85	2.06	2.28	2.50	2.73	2.96
110°	.268	.536	.806	1.08	1.35	1.63	1.91	2.20	2.48	2.76	3.05	3.35	3.66	3.96
120°	.360	.721	1.08	1.45	1.82	2.19	2.57	2.95	3.33	3.72	4.11	4.50	4.91	5.32

Cross Sec. Park Blvd. Run Blvd. to Laurel St 1-34
 Add. Notes " " " " " " 55-41
 Cross Sec " " " " " " 48-63
 Cross Sec El Prado Park Blvd. West 64-66
 Prop. Change/Change Habarsh Blvd + Habarsh Ave 67-74
 Islands Normal + Utuio 75-76

Cross Section Park Blvd. For Proposed
Widening - Russ Blvd. to Laurel St.

Alignment # 2113-1 (1533-32)

+50

INDEXED
MK
SEP 29 1950

+50 = North Curb to West

TP 6.70 12398 068 11738

0+20

0+20 = South Curb Line Russ Blvd to East

0+10 = South Curb Line Russ Blvd. to West

BM 12.49 11796 105.47 11796

Sept. 21-50

5 Sisson Lt. West 2
Walker
Garber
Rietz
Barnes

Rt. - East

110.20669

Note: - Trolley Pole
Hrc Steel 10" at ground
with taper toward top
1" concrete below surface

118.24 120.38
8.74 2.60
100 139.0
25.00
100

111.38

1260
45.00

110.84

1310
15
90

112.66

111.22
36

112.95

110.03
26

113.27

10.91
13

113.70

10.38

113.81

10.17
13

114.17

9.85
26

114.63

9.35
38

115.04

7.04
80

12398

Reduced 9.26 to
11 Remington

115.04
2.92
80
80
2.56
80
2.00
128
1.81
128
1.58
119.14
1.18
128
1.58

112.05

5.71
13

112.32

5.64
13

112.26

5.70
26.0

111.92

6.04
36.0

112.51

5.45
36.0

110.39

7.57
36.0

109.75

8.21
36.0

110.21

7.75
26

111.21

6.75
13

111.78

6.18

111.86

6.10
130

111.56

6.40
26.0

112.15

5.81
26.0

112.39

5.67
36.0

11796

Lt. Z Rt.

1+13.5 = 12/10 on Rt

116.27 114.30
7.71 9.68
50.5 Gmk 50.0 "Fl/A"
1.252+4.45
116.33 116.87
7.65 7.11
53.6-60.1 53.6-66

1+05.50

111.86 115.64 116.11 116.20 116.53 112.58 116.40 113.19 116.55
13.12 8.34 7.87 7.78 7.45 11.10 7.58 10.79 7.43
40.5 40.5 26 13.0 100.0 80.0 15.0 80.0 50.0
80.0 25.0 30.0 20.0 20.0 20.0 20.0 20.0
80.0 25.0 30.0 20.0 20.0 20.0 20.0 20.0

+76

108.32 113.85 114.24 114.49 114.63 114.97 115.01 115.25 116.03 116.73
15.66 10.13 9.74 9.49 9.25 9.01 8.97 8.70 7.95 7.25
39 39 34.0 26.0 13.0 13.0 13.0 13.0 13.0 13.0
80.0 80.0 80.0 80.0 80.0 80.0 80.0 80.0 80.0 80.0

+60

120.38 120.97
3.60 3.01
127-60.1 127-60.1
80.0 80.0

0+60 = H.A. Road topped also North Column to East

113.39 113.02 113.50 113.82 114.16 114.29 114.64 115.17 117.73
10.89 10.96 10.48 10.16 9.82 9.69 9.36 8.81 6.25
35.9 35.9 26 13 13 13 13 13 13
80.0 80.0 80.0 80.0 80.0 80.0 80.0 80.0 80.0

12398

123.98

210

120.76 120.93 120.91 120.2 120.1 121.87 121.79 121.39 121.78
 12.63 12.16 12.48 12.5 12.3 11.52 11.6 12.0 11.6
 55.0 55.0 53.5 53.5 53.5 53.5 53.5 53.5 53.5
 55.0-11/16" 53.5-11/16" 53.5-11/16" 53.5-11/16" 53.5-11/16" 53.5-11/16" 53.5-11/16" 53.5-11/16" 53.5-11/16"

TP 1298 133.39 3.57 120.41

133.39

+ 73.7 = Inlet 14" Conc Pipe

116.91 116.85
 507 7.13
 50.5-11/16" 50.5-11/16"
 No. 10-11/16"

+ 55

119.09 118.80 117.14
 4.89 5.18 4.84
 41 50.5-11/16" 50.5-11/16"

+ 55

118.66 118.96 118.92 118.97 118.95 118.31 116.57 119.27
 5.30 5.02 5.06 5.01 5.03 5.17 7.97 4.71
 46.5 26 13 10-11/16" 10-11/16" 10-11/16" 10-11/16" 10-11/16"

+ 50

118.31 118.60 118.56 118.73 118.73 118.87 118.76 118.44 118.85
 5.67 5.28 5.12 5.25 5.25 5.11 5.20 5.54 5.15
 45-11/16" 26 13 13-11/16" 13-11/16" 13-11/16" 13-11/16" 13-11/16" 13-11/16" 13-11/16"

+ 30

117.11 117.48 117.51 117.74 117.66 117.72 117.61 117.16 117.60
 6.87 6.50 6.47 6.24 6.30 6.26 6.37 6.80 6.38
 43.0-11/16" 26 13 13 26 26 26 26 26 26
 43.0-11/16" 43.0-11/16" 43.0-11/16" 43.0-11/16" 43.0-11/16" 43.0-11/16" 43.0-11/16" 43.0-11/16" 43.0-11/16"

133.98

133.98

Cross Section Park Blvd.

Lt

Rt

Rt

+70 3' Rt of S = S Trolley Pole

+50

172.90 132.47 133.06 133.6 132.8 133.5 132.9 133.0 133.1 134.1 134.3 136.37 136.57 136.54
 1005 98 989 94 10.2 95 101 105 98 89 87 658 628 641
 773 46 34 16 15.2 9 10 8 15 17 23 29 34 41
 24 24 24 24 24 24 24 24 24 24 24 24 24 24 24

+40

+97

3' Rt of S = S Trolley Pole

130.54 130.74 130.30 131.0 130.0 130.9 129.8 130.4 129.4 132.3 133.27 132.57 132.41 132.81
 1241 1221 1365 120 130 131 132 121 126 107 968 1008 1050 1010
 700 470 26 24 16 130 10.6 8 19.0 27 32 34 34 34 34

TP

1152 142.95 1.96 131.43

142.95

+50

127.98 128.24 127.83 128.1 127.2 128.1 127.0 126.7 127.6 127.2 126.6 129.2 130.4 130.14 129.24 130.24
 541 515 556 53 52 53 64 67 58 62 68 62 335 325 325 315
 670 46 26 18 130 9 3 6 8 15 19 28 30 30 30 30 30 30

+23

22 Rt of S = S Trolley Pole

125.56 125.90 125.41 125.9 124.6 125.6 125.1 124.3 125.2 124.8 124.2 127.1 127.47 127.24 127.30 127.64
 783 749 798 75 88 78 8.3 9 8.2 8.6 9.7 6.2 5.97 6.07 6.09 6.27
 150 450 11 14 11 2 5 14 18 28 33 33 33 33 33

+20

+50

173 Lt of S = S Light Standard 4' Over Cox
 105 Rt of S = S Trolley Pole

123.18 123.47 123.06 122.7 123.2 122.4 123.0 122.3 124.62 124.65 124.29
 10.21 9.96 10.33 10.7 10.2 110 10.4 11.1 8.77 8.71 9.00
 820 41 210 14 11 5 5 18 29.6 31.0 33.0
 124.75 866 12.06

133.39

133.39

118 6' offset $\frac{1}{2}$ Trolley Pole

6+10

+ 44 5' offset $\frac{1}{2}$ Trolley Pole

5+43.5 = NY Pedestrian Zone

7P

11.28 150.46 3.77 139.18

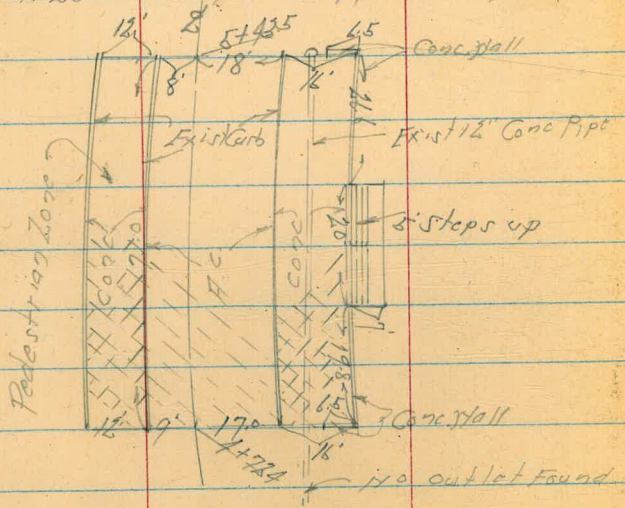

5+08

4+72.4 = NY Pedestrian Zone

14295

140.38 140.78 140.23 141.6 140.5 139.6 140.5 140.2 139.5 143.28 141.71 145.21
 10.08 9.68 10.23 8.9 10.0 10.9 10.0 10.3 11.0 7.8 5.74
 75.0 42.0 22.0 7.0 6 9 17 22.0 6.0 22.0
 140.38 140.78 140.23 141.6 140.5 139.6 140.5 140.2 139.5 143.28 141.71 145.21

137.52 138.06 137.64 138.78 139.12 138.65 138.16 137.92 138.78 139.07 141.75 141.67
 12.24 12.20 12.82 11.88 11.34 11.41 12.30 12.54 11.68 11.39 8.71 8.79
 77.0 44.0 20.0 20-cb 8-cb 8-50t 78-50t 18-cb 34-50t 34-50t 34-50t 42.0
 150.46

136.33 135.84 137.12 137.51 137.00 136.54 136.48 137.05 137.24 139.99
 6.62 7.13 5.83 5.44 5.95 6.41 6.47 5.90 5.71 2.94
 44.0 20-50t 20-50t 8-cb 8-50t 6-50t 17-50t 17-50t 33-50t 33-50t 33-50t

137.78 138.34 138.53
 9.17 1.59 1.42
 79-50t 63-50t 77-50t

134.54 134.22 135.43 135.70 135.20 134.66 134.69 135.27 135.60 136.10
 8.83 8.73 7.52 7.25 7.25 8.29 8.26 7.68 7.75 1.85
 45 21-50t 21-50t 9-2-cb 9-50t 17-50t 17-50t 33-50t 33-50t 33-50t

14295

+66 8' Rt of 1/2 = 2 Trolley Pole

+50

TP 11.14 160.92 0.68 149.78

7+0

+91.5 7' Rt of 1/2 = 2 Trolley Pole

+59 17.5 Lt of 1/2 = 2 Light Standard 15' Con Base

755.5

+50

6+47

150.46

Lt

Rt

Rt

6

151.1 152.7 152.5 152.5 152.3
9.8 8.2 8.4 8.10 7.6
3.5 2.5 2.5 2.5 2.5
5.0 5.0 5.0 5.0 5.0

147.51 148.15 147.46 146.3 147.3 148.3 148.0 147.9 146.9 148.0 147.9 147.3
13.4 12.77 13.4 12.6 12.6 12.6 12.9 13.0 14.0 12.9 13.0 12.6
8.0 40.8 17.0 12 9 7 5 9 13.0 13.0 8.6
FCNY FCNY FCNY FCNY FCNY FCNY FCNY FCNY FCNY FCNY FCNY FCNY

160.92

145.14 145.54 145.16 146.0 144.7 146.1 145.7 146.5 145.5 145.4 147.5 148.9
5.2 4.2 4.5 4.5 4.8 4.4 4.8 6.0 5.0 5.1 6.0 6.6
4.0 4.0 2.0 2.0 2.0 2.0 2.0 2.0 2.0 2.0 2.0 2.0
FCNY FCNY FCNY FCNY FCNY FCNY FCNY FCNY FCNY FCNY FCNY FCNY

142.46 140.6
8.00 9.9
6.9 6.9
147.51 146.06
2.75 2.40
8.4 8.4

142.48 143.16 142.67 143.7 142.4 143.3 142.9 142.4 143.2 142.7 141.8 146.3 147.59
7.98 7.20 7.99 6.8 8.1 7.8 7.6 8.1 7.8 7.8 8.7 4.2 2.87
7.0 4.10 2.0 1.30 1.00 7 7 7 7 7 7 7 7 7
FCNY FCNY FCNY FCNY FCNY FCNY FCNY FCNY FCNY FCNY FCNY FCNY FCNY

141.33 142.99
9.13 7.47
1.7 1.7
FCNY FCNY FCNY FCNY FCNY FCNY FCNY FCNY FCNY FCNY FCNY FCNY FCNY

150.46

Cross Section Park Blvd.

10+0

+88.5 12 ft of $\frac{1}{2}$ = $\frac{1}{2}$ Trolley Pole

+50

TP

11.01 17.61 0.32 160.60

+14 11 ft of $\frac{1}{2}$ = $\frac{1}{2}$ Trolley Pole

9+0

+54

12.8 ft of $\frac{1}{2}$ = $\frac{1}{2}$ Light Standard

+50

+10

9 ft of $\frac{1}{2}$ = $\frac{1}{2}$ Trolley Pole

8+0

160.92

LT

R

PK

7

160.22 160.62 160.24 160.7 159.7 160.7 160.2 159.4 160.3 159.8 163.9 164.9
 11.39 10.99 11.37 10.9 11.9 10.9 11.4 12.2 11.3 11.8 12.7 11.7
 55.6 34 11.5 7 4 10 8 16 20 26 17
 #21 #21 #21 #21 #21 #21 #21 #21 #21 #21 #21 #21

157.53 158.01 157.59 158.0 157.1 158.1 157.7 157.1 157.8 157.2 161.3 162.3
 14.08 13.60 14.02 13.6 14.5 13.5 13.9 14.5 13.8 14.4 10.3 9.3
 68.0 35.0 16 #21 4 9 12 16 28 37 44
 #21 #21 #21 #21 #21 #21 #21 #21 #21 #21 #21 #21

17.61

154.95 155.58 155.06 155.8 154.8 155.8 154.9 155.1 154.7 155.9 160.9
 5.97 5.34 5.84 5.1 6.1 5.1 6.0 5.8 6.2 7.0 8.0
 58 #21 16 #21 8 4 10 25 27 36 43
 #21 #21 #21 #21 #21 #21 #21 #21 #21 #21 #21

152.57 153.05 152.55 153.3 152.4 153.5 153.2 152.8 152.6 152.2 153.0 152.8 156.0
 8.35 7.87 8.37 7.6 8.5 7.4 7.7 8.1 8.7 7.9 8.1 8.5 7.9
 57 #21 18 #21 9 8 8 7 9 13 26 38 45
 #21 #21 #21 #21 #21 #21 #21 #21 #21 #21 #21 #21

150.15 150.49 150.09 150.6 149.9 150.6 150.3 149.7 150.4 150.0 155.1 156.1
 10.87 10.47 10.82 10.3 11.0 10.3 10.4 11.2 10.5 10.7 5.8 4.8
 58 #21 19 #21 11 7 4 8 12 25 48 55
 #21 #21 #21 #21 #21 #21 #21 #21 #21 #21 #21 #21

160.92

BM. 4.57 176.95
N.E. DP
Platform
50 ft x 70 ft
176.90

+76 10.5' Lt of $\frac{1}{2}$ = $\frac{1}{2}$ Light Standard # 4321

12450

172.37	173.00	172.55	172.8	171.7	172.3	172.0	171.7	172.4	172.5	171.9	173.9	174.7
9.13	8.52	8.97	8.7	8.8	9.2	8.5	9.8	9.1	9.0	9.6	7.6	6.8
55	35	15	8	28	22	10	14	16	27	30	37	41
Light Pole												

+84 14' Rt of $\frac{1}{2}$ = $\frac{1}{2}$ Trolley Pole

11498.80 B.C.Lt.

170.03	170.51	170.07	170.5	169.2	169.9	170.2	169.0	170.0	170.1	169.1	171.8	172.2
11.49	11.01	11.45	11.0	12.3	11.6	11.3	12.5	11.5	11.4	12.1	9.7	8.8
55	35	14	4	2	2	11.0	15	18	27	31	37	42
Light Pole												

18152

TP 11.66 181.52 1.75 169.86

+50 14' Rt of $\frac{1}{2}$ = $\frac{1}{2}$ Trolley Pole

167.70	167.13	167.58	168.4	166.9	167.7	167.6	166.8	167.5	167.6	166.8	169.9	171.0
3.91	3.48	4.03	3.2	4.7	3.9	4.0	4.8	4.1	4.0	4.8	1.7	0.6
55	35	14	5	2	2	11	14	17	27	31	37	42
Light Pole												

1140

165.78	165.60	165.14	165.6	164.6	165.7	165.1	164.2	165.1	165.1	164.3	167.4	168.6
6.23	6.01	6.47	6.0	7.0	6.3	6.5	7.4	6.5	6.5	7.3	4.7	3.0
55	35	14	5	3	2	10	14	17	27	30	38	42
Light Pole												

+63 13.5' Rt of $\frac{1}{2}$ = $\frac{1}{2}$ Trolley Pole

+55 11.0' Lt of $\frac{1}{2}$ = $\frac{1}{2}$ Light Standard # 4319

10450

162.77	163.15	162.71	163.2	162.0	162.7	162.2	162.0	162.6	162.5	166.7	167.3
8.84	8.46	8.90	8.1	9.1	8.9	9.1	9.6	9.0	9.1	4.9	4.3
55	35	16	8	3	2	10	13	16	30	40	45
Light Pole											

171.61

171.61

Rt 9
 Sept. 22-50
 Start 13150
 to 30+0

Lt Lt

450

180.50 180.89 180.36 180.8 180.0 180.4 180.9 179.9 180.6 180.5 179.7 180.9
 9.43 9.04 9.57 9.1 9.9 9.5 9.0 10.0 9.3 9.4 10.5 9.0
 56 38 16-E+H
 16-E+H
 4'-Fence

+45 13' Rt of Lt = Lt Trolley pole

14+0

178.98 179.38 178.71 179.1 177.9 176.6 179.2 178.0 178.8 178.9 178.1 179.3
 10.95 10.55 10.23 10.8 12.0 11.3 10.7 11.9 11.1 11.0 11.8 10.6
 55 35 15-E+H
 15-E+H
 40'-Fence

+71 13' Rt of Lt = Lt Trolley pole

450

177.00 177.49 177.58 176.0 176.8 177.3 176.3 177.0 177.1 176.2 177.5
 12.93 12.44 12.35 12.9 13.1 12.6 12.6 12.9 12.8 12.7 12.4
 55 35 12-E+H
 12-E+H
 41'-Fence

TP 11-26 189.93 285 178.67 = 0.75 Stub
 14+0
 Lt

189.93

13+0

174.89 175.38 174.61 175.4 173.6 174.8 175.4 174.2 174.8 175.0 173.9 175.4 175.9
 6.63 6.14 6.91 6.1 7.9 6.7 7.3 6.7 6.5 7.6 6.1 5.6
 56.0 35 15-E+H
 15-E+H
 12'-Fence

+76 13.5 Rt of Lt = Lt Trolley pole

12+63 = Existing Inlets Rt+Lt 10" Cast Pipe

168.40 172.88 170.32 172.96 172.33 170.79 172.59 171.23
 13.12 8.64 11.30 8.51 9.19 10.72 8.22 10.20
 51 35 10-E+H
 10-E+H
 13'-Grate
 13'-Grate
 181.52 181.52

181.52

Cross Section Park Blvd.
For Proposed Widening
Park Blvd. to Laurel St.

Lt. Lt. Rt.

+58 = outlet 10' Pipe on Rt. ^{Corp.}

187.12 185.32
1284 1464
15=HX 16=FL

+50
TP 1284 19996 281 187.12

186.01 186.47 186.11 186.69 187.0 187.4 186.7 187.2 187.7 188.0
1295 1329 1385 1327 13.0 126 13.2 128 133 12.0
7=HX 51 320=EXFL 27.0 70 15 18 29 41.5=FL

1640
+93.5 135 Rt of Lt = Lt Trolley Pole

184.58 185.05 184.71 185.5 186.1 185.6 185.9 185.0 185.7 186.4 186.8 186.4
5.25 488 522 44 38 43 40 49 43 35 34 32
67 47 27=EXFL 23 24 24 27 27 27 27 27 27 27 27 27
7=HX 7=HX 7=HX 7=HX 7=HX 7=HX 7=HX 7=HX 7=HX 7=HX 7=HX 7=HX

19996

+50
+17 18' Lt of Lt = Lt 2195 Standard # 1323
13' Rt of Lt = Lt Trolley Pole

182.32 182.72 183.24 183.95 184.3 184.4 187.6 184.1 183.3 183.9 183.9 184.6 184.9
661 621 619 598 56 55 63 58 66 60 60 53 50
62=HX 43 22=EXFL 5=HX 5=HX 5 9 13 16 23 24 41
7=HX 7=HX 7=HX 7=HX 7=HX 7=HX 7=HX 7=HX 7=HX 7=HX 7=HX 7=HX 7=HX

1540 = 5/4 21' H.C. Cross Walk

181.92 182.28 181.68 181.3 182.5 182.79 182.92 182.00 182.8 183.08
801 765 825 76 74 74 71 692 71 685
59 59 19=EXFL 6=HX 6=HX 7=HX 7=HX 7=HX 7=HX 7=HX 7=HX
5=HX 5=HX 5=HX 5=HX 5=HX 5=HX 5=HX 5=HX 5=HX 5=HX 5=HX 5=HX

18993

18993

+50

Lt.		L		Rt.	
192.19	192.77	192.38	193.0	192.9	193.7
7.77	7.19	7.58	7.0	7.1	6.5
7.70	7.19	7.30	7.26	7.1	6.5
7.70 = WHAC.		7.30 = EYAC.			

+15 175 ft of L = L Trolley Pole

18+0

190.60	191.14	190.55	191.2	191.2	192.0
9.26	8.87	9.41	8.8	8.8	7.4
9.26	8.87	9.41	8.8	8.8	7.4
9.26 = WHAC.		9.41 = EYAC.			

+89 29' Lt of L = L Light Standard #325

+50

189.09	189.55	189.30	189.4	189.9	189.4
10.87	10.41	10.66	10.6	10.1	10.6
10.87	10.41	10.66	10.6	10.1	10.6
10.87 = WHAC.		10.66 = EYAC.			

+41 16' Rt. of L = L Trolley Pole

17+0

187.49	187.96	187.41	187.9	188.0	187.6
12.47	12.00	12.55	12.1	12.0	12.4
12.47	12.00	12.55	12.1	12.0	12.4
12.47 = WHAC.		12.55 = EYAC.			

+84 412 Rt. of L = 114 Cyclone Fence Cont East

188.48	186.30
11.48	13.66
11.48	13.66
11.48 = WHAC.	

+72 146 Rt. of L = L Trolley Pole

16+70 = 15' let on Rt.

157.43	155.93
12.53	14.03
12.53	14.03
12.53 = WHAC.	

Lt.

\$

Rt.

22+0

205.02	205.55	205.30	205.8	205.8	204.7	205.7	205.7	204.8	205.4	205.5	205.5	206.1
11.8	10.95	11.20	10.7	10.7	11.8	10.8	10.8	11.7	10.8	11.0	13.0	10.4
58	38.0	17.0	13	5	4	13	16	20	28	32.0	38	

113
850.0
124
1000

TP 11.29 216.50 2.80 205.21

+52 17' R of L = 1/2 Trolley Pole

216.50

+50

203.43	203.76	203.29	204.1	204.0	203.4	203.9	204.0	203.2	203.9	203.9	204.1	204.7
15.8	12.5	4.72	3.9	4.0	4.6	4.1	4.0	4.8	4.1	4.1	3.6	5.3
56.0	38.0	16.5	12	13	13	14	17	20	30	33	38	100

21+0

201.55	201.89	201.96	202.7	201.8	202.4	201.4	202.1	202.2	202.4	202.4	202.1	201.1
14.6	6.18	5.05	5.3	6.3	5.6	6.1	5.9	5.8	6.6	5.6	5.9	6.9
55.0	36.0	17.0	13	13	14	18	21	28	33	39	50	100

190 113 Shaft = 1/2 Light Steel #321

+66.5

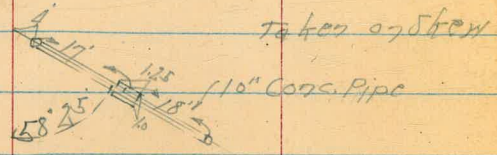

taken 275 feet

201.09	199.32	200.24	198.81	200.21	197.44
6.9	8.69	7.77	9.90	7.80	9.87
4-H.H.	4-F.L.	4-F.L.	4-F.L.	4-F.L.	4-F.L.

20+45

180' R of L = 1/2 Trolley Pole

199.42	199.79	200.04	200.96	201.06	200.8	200.3	199.1	198.9	199.9
8.59	8.22	7.97	7.05	6.95	7.2	7.7	8.9	9.1	8.09
57	37	20	705	6.95	19	33	45	53	50

20801

20801

Cross Section Park Blvd.

Lt. L Rt. 14

TP 822 222.94 1.78 214.72

+81.5 12 Rt of L - 2 Trolley Pole

+50

212.61 212.95 212.45 213.0 212.9 211.6 212.3 212.1 211.3 212.2 211.7 210.6 207.5
 389 355 405 35 36 49 42 11 52 43 48 59 90
 18 18 7 7 8 8 12 12 16 17 19 8'-Link Fence

24+0

+70 12.5 Rt of L - 2 Trolley Pole

+50

211.35 211.64 211.22 212.0 211.5 210.5 211.0 211.1 210.2 211.4 211.1 210.4 210.7 210.4 207.9
 515 486 528 45 50 60 55 54 63 50 54 61 59 61 86
 59 38 18 14 6 3 10 13 17 24 29 31 49 820'-Fence

+03

13.2 Lt of L - 2 Light Standard # 4333

23+0

209.91 210.16 209.66 210.7 210.4 209.3 209.9 210.0 208.9 209.9 210.0 209.4 210.2 209.5 208.0
 659 624 684 58 61 72 66 65 76 66 65 71 63 70 85
 58 38 17 14 7 3 10 14 18 26 30 33 24 8'-Fence

+63

15.5 Rt of L - 2 Trolley Pole

22+50

208.13 208.52 208.24 208.8 208.7 207.7 208.7 208.7 207.7 208.7 208.7 208.7 207.9 209.2 208.7
 837 798 826 77 78 88 78 78 88 78 78 86 73 78
 57 37 18 14 5 8 10 15 18 23 30 33 33 8'-Fence

206.66 207.09 206.85 207.5 207.6 206.1 207.1 207.2 206.2 207.2 207.2 207.0 206.2 207.9
 784 941 965 90 89 10.1 94 93 103 92 95 105 86
 57 34 17 14 8 7 13 16 19 27 31 370
 81'-Link Fence

216.50

216.50

2744 136 ft of $\frac{1}{2}$ - $\frac{1}{2}$ Light Standard # 4237

26495.5 (See p. 38) for add. notes



217.03 217.31 216.94 217.6 217.7 216.4 217.3 216.0 217.0 216.4 213.21 209.91

5.91 5.63 6.00 5.3 5.2 6.7 5.1 6.9 5.9 6.5 9.73 12.03

5.7 3.7 11.24 14 5.2 8.0 5.1 15 19 38 39 41

10.0 9.3 10.4 6.7 161 80.77 153.20 191 114

212.9 212.5 206.8 203.8 202.2

80.77 153.20 191 114

2006 108

497 155 ft of $\frac{1}{2}$ - $\frac{1}{2}$ Trolley Pole

456

216.23 216.51 216.16 216.6 216.4 215.4 215.7 216.7 215.0 216.0 215.6 216.1 216 214.6

6.71 6.43 6.78 6.3 6.5 7.5 7.2 6.6 7.9 6.9 7.2 10.8 10.9 18.3

5.8 3.8 12.54 16 7 7 3 14 18 38 38 27 8.3

1990

425 133 ft of $\frac{1}{2}$ - $\frac{1}{2}$ Trolley Pole

2640

215.54 215.77 215.32 215.9 215.8 214.3 215.3 214.2 215.8 214.8 216.1 211.9 214.9

7.42 7.17 7.62 7.0 7.1 8.6 8.7 7.1 8.1 10.8 11.0 18.0

5.9 3.4 11.24 15 6 3 13 17 26 38 59 8.3

206 90 201.5 111

45346 BC Rt 125 ft of $\frac{1}{2}$ - $\frac{1}{2}$ Trolley Pole

437.5

16 ft of $\frac{1}{2}$ - $\frac{1}{2}$ Light Standard # 4235

214.67 214.96 214.54 214.9 214.7 213.6 214.6 211.6 214.3 214.1 211.8 214.4 214.6

8.27 7.98 8.40 8.0 8.2 9.3 8.3 9.3 8.6 8.8 11.1 11.5 15.2

5.9 3.9 11.24 18 9 4 8.3 12 16 25 33 36 8.3

207 88 202.4 112

2540

213.65 213.92 214.56 213.8 214.0 212.5 213.5 211.1 212.5 213.3 212.9 211.6 210.5 214.8

9.79 9.02 8.38 9.1 8.9 10.4 9.4 9.8 10.1 9.6 10.9 11.3 12.1 15.1

8.0 4.0 3.0 16 9 5 9 13 16 21 30 18 8.1

22294 22294

22294

22294

Lt. Lt. Rt.

+87 16.0 Rt of $\frac{1}{2}$ = $\frac{1}{2}$ Trolley Pole
+78 70 Lt of $\frac{1}{2}$ = $\frac{1}{2}$ Light Standard #4239
+50

222.93 223.3v 223.64 223.5 223.6 223.4 222.2 222.1 222.9 220.3 221.1 220.4
480 441 469 42 51 42 55 42 48 74 76 78
55-HYARC 110-EX
HYC = PMS

+13 170 Rt of $\frac{1}{2}$ = $\frac{1}{2}$ Trolley Pole

221.45 221.65 221.23 221.8 221.9 220.7 222.0 220.7 221.7 221.3 218.7 216.5 216.9
628 608 650 59 58 70 57 70 60 64 90 92 88
52 33 17-HYARC 5 77 20 20 41 20 21
HYC = PMS

29+0

+50

220.00 220.33 219.95 220.9 219.6 220.7 219.3 220.3 219.8 217.3 217.4 215.7
773 740 798 68 81 70 84 74 79 104 103 121
53 53 14-HYARC 4 16 21 30 41 65 85
HYC = PMS

TP 723 22773 244 22050

227.73 210.3 208.8 210.0 210.2
26 72 105 115
HYC = PMS

+13 16.0 Rt of $\frac{1}{2}$ = $\frac{1}{2}$ Trolley Pole

218.9v 219.21 218.96 219.5 219.1 219.2 219.4 218.1 218.9 218.6 218.9 218.6
402 373 398 34 38 47 35 48 40 42 70 78 114
55-HYARC 24 15-HYARC 6 16 20 20 29 28 21
HYC = PMS

28+0

+70 156 Rt of $\frac{1}{2}$ = $\frac{1}{2}$ Trolley Pole

208.1 206.5 204.8
93 98 115

27+50

217.93 218.13 217.98 218.3 218.2 217.1 218.3 216.9 217.8 217.2 214.6 214.0 208.7
501 481 496 46 47 58 46 60 51 57 83 89 110
55-HYARC 38 13 4 20 4 16 19 29 38 27 20
HYC = PMS

222.94

222.94

+03 1704 top - 1/2 Light Standard #4341
 145 ft of 1/2 Trolley Pole

3340 = 514 of Curb + Grass on Lt

+97 32 ft of 1/2 1/4 Double 2" Fac Tree

+50

TP 9.38 241.46 134 232.08

+38 16 ft of 1/2 Trolley Pole

3140

+60.5 16 ft of 1/2 Trolley Pole

+50

TP 8.30 232.42 241. 225.12
 97 Trolley Pole Color
 18 ft 29.87

3040

22773

Lt.

Rt.

17
 Rt. Sept. 25-50
 F. S. 1107
 Barber
 Crawford
 D.S. 8103

231.95 232.26 231.82 232.51 222.2 230.7 232.0 230.7 231.8 231.8 228.5 227.9 227.7
 9.51 9.30 9.0 8.95 9.3 10.8 9.5 10.8 9.7 9.7 13.0 13.6 13.8
 61 41.5 19.5 19.5 5.24 19.1
 706 706
 50 ft

230.04 230.41 229.96 230.4 230.6 229.1 230.4 229.0 230.0 229.6 226.4 225.7 225.1
 11.42 11.05 11.50 11 10.9 12 11 12.5 11.5 11.7 15.1 15.8 15.8
 57 36 16.5 16 5 4 15 30 38 40 52 85
 706 706
 341.46

228.19 228.58 228.11 228.4 228.6 227.4 228.6 227.1 227.2 226.7 226.8 226.4 226.4
 5.33 4.81 5.31 5.0 4.8 6.0 4.8 6.2 5.3 4.7 8.6 9.2 9.0
 54 34 14.5 13 4 4 16 20 34 41 52 86.0
 706 706
 341.46

226.49 226.83 226.37 226.7 227.1 225.7 227.0 225.7 226.6 225.3 227.4 227.6 227.1
 6.93 6.59 7.05 6.9 6.3 7.7 6.4 7.7 6.8 8.1 10.0 10.6 6.3
 53 34 12.5 16 4 4 16 30 34 42 64 85
 706 706
 232.42

224.65 224.98 224.73 225.2 225.3 224.4 225.4 224.2 224.9 224.4 221.7 221.3 221.9
 3.08 2.75 3.00 2.5 2.4 2.3 2.8 3.5 2.8 2.8 6.0 6.4 5.8
 51.3 31.0 13.0 10 5 4 16 20 30 42 61 85
 706 706
 227.73

BM

833 240.37

SF 7 Cars
+ Entrance
Naval Hospital
41257 16
240.50

+ 83

TP

733 248.70 0.11 241.85

+ 84.5

+ 50

+ 30

38 + 0

+ 86

140 Pt of $\frac{1}{2}$ Trolley Pole

32 + 50

241.46

238.26 277.59 237.89 238.75 238.7 278.2 237.6 238.54 238.08 237.39

10AL 10AL 10.81 99.5 100 105 141 101L 13.82 11.81

125 42.6 21° 21° = Ch 6-14670 14 26.5-51/11

7.1 7.1 Gul

248.70

235.94 236.94

4.52 4.52

20-1-1044 20-1-1044

2 Corp 20-1-1044

Flow 20-1-1044

237.16 237.49 236.97 237.73 237.5 236.2 237.0 236.1 236.9 236.1 235.4 235.0 234.1

420 397 449 323 10 53 4.5 5.4 46 54 61 65 70

585 43.5 22.6 22.0 6-14670 13 17 33 40 67 83.5-Form

7.1 7.1

235.43 232.59

4.03 7.87

29.5 29.5

235.30 235.79 235.26 236.00 235.5 234.0 232.2 234.3 232.2 234.4 232.1 231.5 231.8

6/6 567 120 5.46 40 235 63 73 63 71 89 90 97

75 45 233 233-C 5-14 9.5 13 17 29 36 37 82.5-Form

233.63 244.05 232.59 234.25 232.9 232.5 231.6 224.5 231.3 222.2 220.2 222.5 229.7

783 741 787 721 76 90 79 90 82 82 118 119 118

6.74 238.03 6.74 241.46 82.5-Form

18

241.85

Check

Cross Section Park Blvd.

+857

+772

+574

+43

+25

21+0

+92

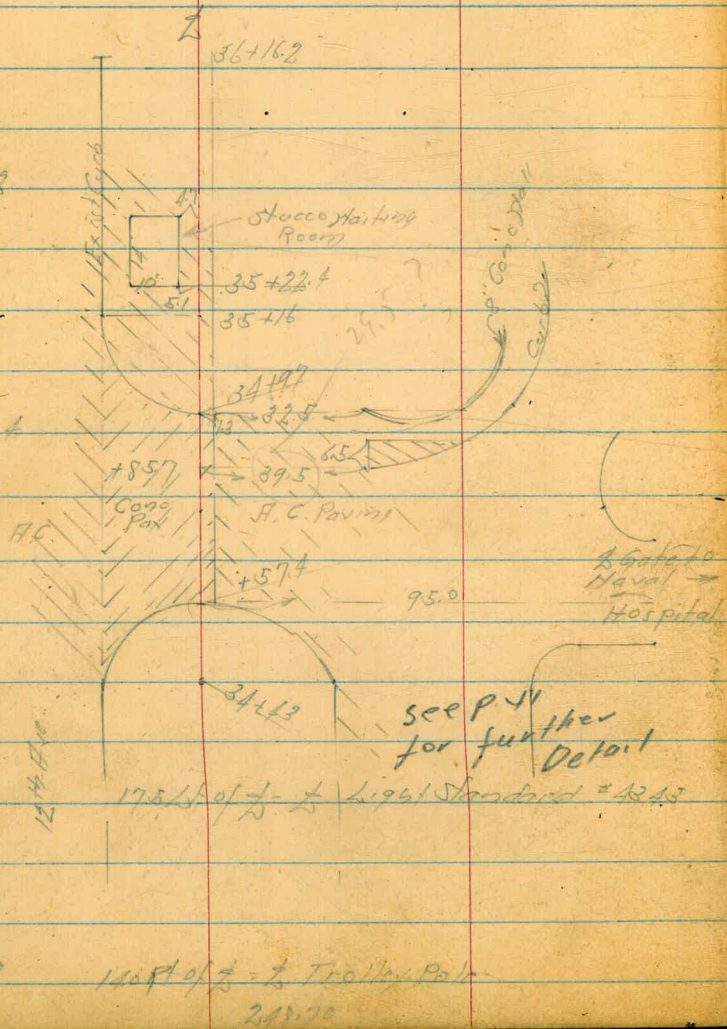

18 19

241.54 241.97 241.27 242.05 242.26 242.25 240.56 241.83 241.72 241.77
 7.16 6.73 7.43 6.65 6.44 6.35 6.14 5.87 5.98 5.93
 73.22 39.0 20.5 1.5 27.0 39.5 39.5 39.5 39.5 39.5
 241.34 5.36 828.03

49.5 ?

241.35 241.61 240.98 241.76 241.98 242.04 242.57 242.49 242.78
 7.25 7.09 7.72 6.91 6.72 6.66 6.50 6.41 6.22
 73.5 40.0 20.3 13.5 13.5 13.5 13.5 13.5 13.5
 241.68 240.96 240.27 241.08 241.25 241.41 240.08 242.28 241.16

8.09 7.74 8.43 7.64 7.45 7.30 6.62 6.42 6.54
 74.0 39.3 20.3 13.5 13.5 13.5 13.5 13.5 13.5
 240.12 240.48 239.65 240.36 240.3 239.7 240.68 241.66 242.03 241.40

8.58 8.32 9.05 8.31 8.1 8.0 8.07 7.04 6.67 6.30
 74.0 39.3 20.3 13.5 13.5 13.5 13.5 13.5 13.5
 238.81 239.13 238.46 239.17 239.1 238.5 238.0 239.19 239.95 240.25 238.9

9.89 9.57 10.27 9.53 9.6 10.2 10.7 9.51 8.75 8.45 8.28
 74.0 39.3 20.3 13.5 13.5 13.5 13.5 13.5 13.5
 248.70

+66 12' Pt of 2 - 1/4 20" Euc Tree
 +50
 +33 125' Pt of 2 - 1/2 Light Standard #4342

TP 1264 258.81 253 246.17
 Callor Trolley Pole

36+26 30" Euc tree 48' Rt.
 36+16 12" Pepper tree 12' Lt.
 36+0

35+86 48" Euc. tree 52' Rt.

+50
 +33 220' Pt of 2 - 1/2 12" Euc. Tree

15" Pepper 15' Lt.
 35+16 = Cb EC. on Lt. 55.0 Pt of 2 - 1/4 Link Faced

+98 143 Pt of 2 - 1/2 Trolley Pole

34+97 = Carb. End on Pt

248.70

247.35 247.84 247.29 248.0 246.0 246.6 246.8 247.3 247.7 246.2 247.1 247.3 246.2 246.5
 11.46 10.97 11.52 10.8 10.8 12.2 12.0 11.5 11.5 12.6 11.7 11.5 12.6 12.7
 6.90 3.6 15.6 13 7 3 1 11.0 14 17 27 30 43.0
 5.2 5.2
 257.7
 55.0 = Faced

258.81

245.70 246.06 245.72 246.00 245.62 245.6 244.6 244.6 244.6 244.4 244.4 245.23 245.6
 8.00 2.62 3.38 3.90 2.88 3.1 4.1 3.1 3.3 4.3 4.6 4.39
 7.00 35.5 15.3 15.3 11.6 14.0 17.0 27.0 30.0 41 67.5
 5.2 5.2

243.91 244.26 243.51 244.17 244.49 244.44 244.7 244.0 243.2 243.9 243.6 244.7 244.7
 4.79 4.44 5.19 4.53 4.21 4.26 5.0 4.7 5.5 4.8 4.9 5.7 6.0
 7.17 3.0 16.5 15.6 14.1 14.1 11 14 17 27 27 39 55.0
 5.2 5.2

241.75 242.98 242.32 242.87 243.36 243.30 242.4 242.5 242.0 242.70 242.0
 6.95 5.72 6.38 5.82 5.34 5.40 6.3 6.2 2.7 2.00 4.7
 7.00 3.70 17.0 17.0 2.5 3.5 3.0 3.7 3.9 4.0 4.0
 5.2 5.2

241.04 242.30 241.74 242.43 242.70 242.55 242.50 243.25 242.77 242.0
 6.6 6.40 6.26 6.27 6.00 6.15 6.20 5.25 2.22 5.7
 7.30 38.0 18.0 18.0 13.0 14.0 23.0 23.0 8.0 8.0
 5.2 5.2

248.70

+58

+33 105 ft of L - L Light Standard #4347

+30.5

+23 115 ft of L - L Trolley Pole

+16 10" Pepper 8.5' Lt.

38+0

+91 115 ft of L - W/ 36" Elec Trac

+65.7 = L Pedestrian Tunnel Taken as Skew

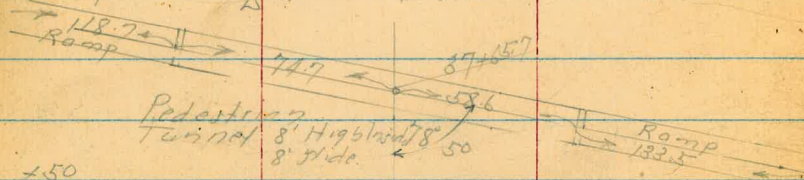

+50

+14 8" Pepper 10 Lt

+11 110 ft of L - L Trolley Pole

+10 380 ft of L - W/ 36" Elec Trac

37+0

258.81

Lt.						
254.39	254.95	254.81	254.05	255.00	254.4	
4.42	3.86	4.00	3.76	3.81	4.54	Fence
570	370	180	160	275		
FC	FC	FC	FC	FC		

253.54	254.01	253.51	254.4	254.1	254.16	254.25	254.29
5.27	4.80	5.20	4.4	4.7	4.3	4.55	4.57
580	360	140	110	110	180	180	150
FC	FC	FC	FC	FC	FC	FC	FC

252.51	252.97	252.50	253.1	253.1	252.2	252.5	252.8	251.6	254.31
6.20	5.84	6.21	5.7	5.7	6.3	6.0	4.2	4.2	4.50
580	370	140	110	6	18	30	35	150	150
FC	FC	FC	FC	FC	FC	FC	FC	FC	FC

253.26	252.96	253.06	241.18
20.43	5.83	5.73	17.63
760	79.7	580	80
FC	FC	FC	FC

250.66	251.24	250.76	251.3	250.7	250.7	249.6	250.5	251.2	251.4	251.6	251.1
8.15	7.57	8.03	7.5	8.1	8.1	9.0	8.2	7.6	4.4	4.2	5.7
660	340	136	110	10	14	18	32	37	46	46	57
FC	FC	FC	FC	FC	FC	FC	FC	FC	FC	FC	FC

249.92	249.47	249.01	249.6	249.8	249.0	249.4	248.9	248.9	248.0	248.9	248.5	250.2	250.3
9.27	9.24	9.80	9.2	9.0	10.8	12.1	9.9	9.9	10.8	9.9	10.3	5.6	5.5
686	626	145	110	15	2	1	110	14	17	290	10	550	370
FC	FC	FC	FC	FC	FC	FC	FC	FC	FC	FC	FC	FC	FC

258.81

+27 36" Euc tree 7' Lt.

+23 118 Rt of 1/2 = 2 Trolley Pole

+04 370 Rt of 1/2 = 1/4 30" Euc. Tree

40+0

39+91 30" Euc tree 9' Lt

+57 130 Rt of 1/2 = 2 Trolley Pole

+50

258.83 259.40 259.51 259.8 259.1 260.1 258.7 259.4 260.0 256.0
664 607 596 57 64 54 68 61 56 95
60 47 50 160 9 13 160 280 42
Rt H.C.

257.17 258.00 257.50 257.8 257.5 258.3 256.8 257.7 258.1 258.3
800 747 797 77 80 72 87 78 74 102 117
610 410 207 180 9 14 78 28 33 44
Rt H.C.

39+16

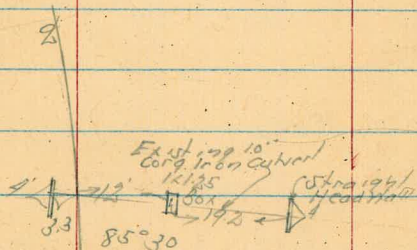

256.48 256.95 256.47 256.95 256.6 254.11 256.26 254 256.9 255.80 253.60 252.9
899 852 852 89 1136 921 91 86 967 1187 90 90 995 1248
630 400 1212 18 90 33 3.3 1094.1 110 120 120 15 26 312 312
Rt H.C.

39+09 8" Pepper 14' Lt.

+90

+89 133 Rt of 1/2 = 2 Trolley Pole

+82 550 Rt of 1/2 = 1/4 30" Euc. Tree

TP 999 265.47 333 265.48

38+78

255.05
1042
370
Rt H.C.

255.05 255.69 265.47 255.43 255.59 255.1 254.3
376 312 338 324 37 15
390 Rt H.C. 18 H.C. 20 55
Rt H.C.

Cross Section Park Blvd.

9C
~~+86~~ = Existing Culvert 12' Corq. Iron
~~+77~~
~~+79~~ 125' Lt of 1/2 - 1/2 Light Standard #4349
 42+79 48" Euc. tree 43' Rt.
 +50

+85 125' Rt of 1/2 - 1/2 Trolley pole
 42+13 8" Pepper tree 9' Lt.
 42+02 48" Euc tree 50' Rt
 12+0

41+94 21" Euc tree 8' Lt.

+57 125' Rt of 1/2 - 1/2 Trolley Pole

+50

TP 8.70 273.26 0.91 264.56

+32 24" Euc. tree 6.5' Lt
 +26 48" " " 47' Rt
 41+0

+91 105' Rt of 1/2 - 1/2 Trolley pole

+60 24" Euc. tree 7' Lt.

40+50 127' Lt of 1/2 - 1/2 Light Standard #4349

26547

264.71 267.63
 8.58 5.63
 267.03 267.36 267.59 267.9 267.6 268.5
 6.23 5.90 5.67 5.4 5.7 4.8
 6.0 4.8 8 15 9
 265.61 263.97
 7.5 9.39
 37.0 37.5
 267.0 268.2 267.2 265.5
 6.3 5.1 6.1 7.8
 13 25 38 39.0 = Fence

265.28 265.76 264.03 266.6 266.2 267.0 265.6 267.0 265.7 265.3
 7.98 7.80 7.73 6.7 7.1 6.3 7.7 6.3 7.6 8.0
 8.0 35 15 11 9 13 25 27 40 = Fence

263.56 264.16 264.44 264.4 265.4 264.1 265.3 267.0 262.4
 9.70 9.10 8.82 8.9 7.9 9.2 8.0 10.3 10.7
 5.8 3.4 13 9 13 25 32 41.0 = Fence

273.26

262.00 262.53 262.86 263.3 262.7 263.6 262.2 262.8 263.4 260.2 259.8
 3.47 3.94 3.6 3.3 3.8 1.9 3.3 3.7 2.1 5.3 5.7
 3.45 3.45 15.8 11.0 28 9 13 15 25 34 41.0 = Fence

260.42 260.97 261.32 261.8 260.9 261.8 260.3 261.0 259.7 257.0 256.4
 5.05 4.50 4.5 3.7 4.6 3.7 5.2 4.5 5.8 8.5 9.1
 5.7 3.8 17 13 13 25 32 41.0 = Fence

26547

+ 09 38 Lt of $\frac{1}{2}$ - $\frac{1}{2}$ Light Standard #4352

+ 1570

+ 92 130 Rt of $\frac{1}{2}$ - $\frac{1}{2}$ Trolley Pole

TP 1.86 281.34 295 274.48

+ 50

+ 26 130 Rt of $\frac{1}{2}$ - $\frac{1}{2}$ Trolley Pole

4440

+ 59 125 Rt of $\frac{1}{2}$ - $\frac{1}{2}$ Trolley Pole

+ 50

TP 576 277.43 1.59 271.67

1340

+ 92 125 Rt of $\frac{1}{2}$ - $\frac{1}{2}$ Trolley Pole

273.26

Lt

Rt

Rt

24

275.12	275.46	274.99	274.6	272.9	272.7	272.2	272.6	270.6	
632	588	625	67	84	76	91	77	107	
86.0	520	410	17	9	13	25	36	40	
								381.34	40

273.63	273.99	273.66	273.3	271.9	272.5	271.4	272.6	268.7
538	544	527	41	5.5	19	60	18	87
80	68	36	16	9	13	25	35	38

272.01	272.50	272.06	271.0	271.8	270.5	271.5	267.6
544	492	527	64	56	69	69	98
78.0	68.0	62	9	13	25	26	38

270.66	270.80	270.70	269.6	269.8	270.6	269.3	270.5	265.6	
707	663	672	78	76	68	81	69	48	
74	51	28	6	9	6	25	40	40	
								277.43	40

268.46	268.95	269.14	269.5	268.7	269.6	269.2	269.6	265.2
478	401	412	38	46	37	51	57	81
68.0	75	27	21	10	18	25	35	40

273.26

Sept. 28 50 25
 H.S. 5500
 RT Garber
 Ror or
 Pullen

Lt Lt

60 N of S - Light Standard # 4355

+22 40 R of S - Trolley

47+0

+91 370 R of S - Angle in Fence

+93 340 R of S - 30" Fac Tree

+84 210 Lt of S - 18" Fac Tree

+150

+28 140 R of S - Trolley Pole

TP 8.41 384.44 531 276.03 4610

46+0

+7169 FC

+59 130 R of S - Trolley Pole

15+50

279.14 279.47 279.04 279.0 279.5 277.8 275.3 275.6 274.7 273.21
 530 497 510 54 19 56 91 8.8 9.7 11.3
 160 83 80 480 32 8.5 15 430 550
 H.S. H.S. H.S. H.S. H.S. H.S. H.S. H.S. H.S. H.S.
 H.S. H.S. H.S. H.S. H.S. H.S. H.S. H.S. H.S. H.S.

276.45 278.85 278.41 278.7 277.8 274.5 275.2 274.0 275.0 274.4
 5.99 5.69 6.03 5.7 6.6 9.9 9.2 10.4 9.4 10.2
 98 740 320 37 10 110 14 27 37 = Fence
 H.S. H.S. H.S. H.S. H.S. H.S. H.S. H.S. H.S. H.S.
 H.S. H.S. H.S. H.S. H.S. H.S. H.S. H.S. H.S. H.S.

277.55 277.91 277.47 277.3 276.2 273.8 274.8 273.5 274.6 272.6
 8.79 8.43 8.87 8.9 8.1 7.5 6.5 7.8 6.7 8.7
 90 68 75 35 8 75 110 75 37 37 = Fence
 H.S. H.S. H.S. H.S. H.S. H.S. H.S. H.S. H.S. H.S.
 H.S. H.S. H.S. H.S. H.S. H.S. H.S. H.S. H.S. H.S.

276.86 277.24 276.79 276.4 274.9 273.8 274.5 272.2 274.4 271.6
 148 110 455 49 64 75 6.8 8.1 6.9 9.7
 89.0 160 440 25 7 10 14 36 100 = Fence
 H.S. H.S. H.S. H.S. H.S. H.S. H.S. H.S. H.S. H.S.
 H.S. H.S. H.S. H.S. H.S. H.S. H.S. H.S. H.S. H.S.

276.34 276.70 276.20 275.7 275.7 274.2 272.8 274.1 270.8
 500 464 511 54 76 71 8.5 7.3 10.5
 880 15 130 31 70 14 35 35 = Fence
 H.S. H.S. H.S. H.S. H.S. H.S. H.S. H.S. H.S. H.S.
 H.S. H.S. H.S. H.S. H.S. H.S. H.S. H.S. H.S. H.S.

381.34

381.34

U

S

R

- +40 910 Lt of $\frac{1}{2}$ = 00.12" Euc Tree
- +41 19' Rt of $\frac{1}{2}$ = $\frac{1}{2}$ 18" Euc Tree
- +29 28' Lt of $\frac{1}{2}$ = $\frac{1}{2}$ 30" " "
- +26 440' Rt of $\frac{1}{2}$ = 18" Euc "

TP 4.13 283.40 - 517 279.27

- +16 145' Rt of $\frac{1}{2}$ = $\frac{1}{2}$ Trolley Pole
- +07 490' Rt of $\frac{1}{2}$ = $\frac{1}{2}$ 18" Euc Tree
- 18+0

- +96 140' Lt of $\frac{1}{2}$ = $\frac{1}{2}$ 36" Euc Tree
- +91 415' Rt of $\frac{1}{2}$ = $\frac{1}{2}$ 24" Euc Tree
- +86 520' Rt of $\frac{1}{2}$ = 1. Force
- +63 = 1/4 Pav to Nursery on $\frac{1}{2}$

BM 8.77 275.67

O S I C W H I Z
N of F to
Nursery
For RR Tracks
275.27

+50 = $\frac{1}{2}$ Paving

A7+36 = 1/4 Paving to Nursery on $\frac{1}{2}$

284.44

283.40

280.10 280.41 280.14 280.16 279.5 277.8 276.4 276.6 275.6 276.5 276.4 274.0 272.8

434 103 430 428 46 66 80 78 88 79 80 104 101

1349 111.0 880 790 590 30 110 140 170 280 370 530

FCX FCX FCX FCX

279.77 280.07 279.67 280.1 279.4v 278.03 276.61 276.44 273.60

467 437 477 43 502 641 782 800 10.84

1349 1020 775 Euc 70 58.5 MY 31 on Pav 270 670 NEW Pav

278.66 279.94 279.56 279.9 278.86 278.13 276.74 276.56 276.26 274.46 273.6

478 450 488 45 558 631 770 788 805 998 10.8

179 970 736 55 376 190 3 270 270 270 270 270 270

FCX FCX FCX FCX FCX FCX FCX FCX FCX FCX FCX FCX

279.56 279.84 279.57 280.0 279.09 278.27 276.39 276.07 274.28

488 460 493 44 535 617 805 807 10.8

116 930 70 135 14 36 on Pav 36 on Pav 36 on Pav 36 on Pav 36 on Pav 36 on Pav

FCX FCX FCX FCX FCX FCX FCX FCX FCX

284.44

- +08 68' Lt of L - L 36" Euc Tree
- +03 140' Rt of L = L Trolley Pole
- 50+0
- +99 146' Rt of L - L 9" Euc Tree
- +95 50' Rt of L = L Euc "
- 48' Rt of L = L 9" Euc "
- +83 38' Rt of L = L 12" Euc "
- +70 58' Lt of L = L 42" Euc "
- 49' Lt of L = L 14" Euc "
- +59 39' Rt of L = L 16" Euc Tree
- +50
- +46 140' Rt of L = L 14" Euc Tree
- 40' Rt of L = L 13" Euc Tree
- +31 67' Lt of L = L 36" Euc Tree
- +21 117' Lt of L = L Light Standard #4357
- +11 135' Rt of L = L Trolley Pole
- 49' Rt of L = L 20" Euc Tree
- +10 38' Rt of L = L 15" Euc "
- 49+0
- +95 54' Lt of L = L 20" Euc "
- +88 20' Lt of L = L 24" Euc "
- +77 495' Rt of L = L 15" Euc "
- 38' Rt of L = L 14" Euc "
- +63 40' Lt of L = L 18" Euc Tree
- 48+50

38340

281.28 281.5 279.6 278.4 277.4 276.7 275.5 274.5 273.6 272.5 271.6 270.6 269.4 268.3

212 19 38 50 60 69 49 49 58 49 48 82 91

139.0 133 124.0 78.0 71.0 87 49 46. 13 17. 28 35 67.9

FLY

281.5 281.47 281.00 281.07 279.7 278.2 277.4 277.0 276.9 276.0 275.3 274.1 273.1 272.1 271.9

225 193 240 222 37 51 60 64 55 54 61 53 53 69 85

173 188 128.9 122.0 115 70.0 68.0 67 10. 14 18 26 31 57.0

FLY

280.73 281.10 280.74 278.2 277.0 277.5 277.7 276.7 276.4 275.6 274.8

217 200 266 54 64 59 59 67 60 68 78 86

160 138.0 116.0 57.0 27.0 78 13 17 28 33 62.0

FLY

280.47 280.80 280.47 279.1 277.5 277.1 277.1 276.1 276.9 276.9 274.3 273.9

202 260 292 43 59 63 63 73 65 65 91 95

146.0 125.0 104 88 67 10 13 17 37 35 62.0

FLY

38340

FLY

- +98 13.6' Rt of $\frac{1}{2}$ - $\frac{1}{2}$ Trolley Pole
- +91 10.10' Lt of $\frac{1}{2}$ - $\frac{1}{2}$ 30' Euc Tree
- +89 153.0' Lt of $\frac{1}{2}$ - $\frac{1}{2}$ 10" Euc Tree
- +86 93.0' Lt of $\frac{1}{2}$ - $\frac{1}{2}$ 21" Euc Tree
- +84 110' Rt of $\frac{1}{2}$ - $\frac{1}{2}$ 14" Euc "
- +80 50' Rt of $\frac{1}{2}$ - $\frac{1}{2}$ 10" Euc "
- +76 40' Rt of $\frac{1}{2}$ - $\frac{1}{2}$ 15" Euc Tree
- +70 57.0' Rt of $\frac{1}{2}$ - $\frac{1}{2}$ 8" " "
- +66 130' Rt of $\frac{1}{2}$ - $\frac{1}{2}$ 12" " "
- +58 180' Rt of $\frac{1}{2}$ - $\frac{1}{2}$ 8" " "
- +56.5 380' Rt of $\frac{1}{2}$ - $\frac{1}{2}$ 16" Euc
- +50 95' Lt of $\frac{1}{2}$ - $\frac{1}{2}$ 20" Dead Euc Tree
- +50 77' Lt of $\frac{1}{2}$ - $\frac{1}{2}$ 10" Dead Euc "
- +48 50' Rt of $\frac{1}{2}$ - $\frac{1}{2}$ 9' Euc Tree
- +46 40' Rt of $\frac{1}{2}$ - $\frac{1}{2}$ 12' Euc "
- +41 470' Rt of $\frac{1}{2}$ - $\frac{1}{2}$ 8" Euc "
- +30 = Existing 12" Corrugated Culvert 12"
- +27 140' Lt of $\frac{1}{2}$ - $\frac{1}{2}$ 30" Euc Tree
- +27 410' Rt of $\frac{1}{2}$ - $\frac{1}{2}$ 14" Euc "
- +23 470' Rt of $\frac{1}{2}$ - $\frac{1}{2}$ 9' Euc "
- 50+13 180' Rt of $\frac{1}{2}$ - $\frac{1}{2}$ 12' Euc Tree

283.40

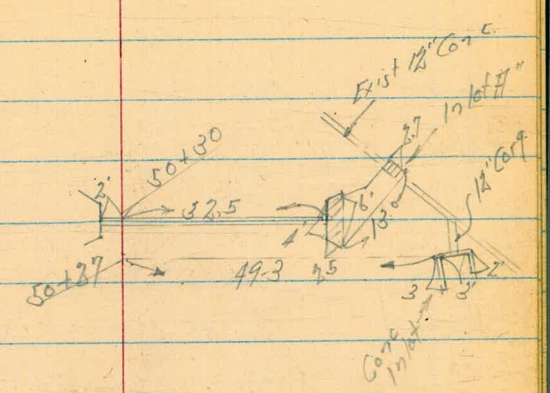

261.72	282.0	278.6	277.8	277.1	276.9	278.9	279.1	275.2	273.8
168	14	18	56	63	65	45	43	83	96
1480	1410	139	80	40	8		26.0	360	520
Euc Tree									
276.04	276.63	277.47	274.89	274.50	271.40				
7.66	9.77	5.92	8.51	8.96	12.00				
2' Fl	2' TOP UHW	3' Fl	3'25" = Flow	Top Hall	Fl 12"				
1.56	2.70	3.25	3.25	3.25	3.25				
273.75	272.12	9.65	11.38	49.3	49.3				
		Top Hall	Fl 12"	Fl 12"	Fl 12"				

283.40

Lt. Z Rt.

+25 32' Lt of L = L 18" Euc Tree
 +16 18' Rt of L = L 18" Euc Tree
 +12 100' Lt of L = L 30" Euc "



282.49
 243
 1570
 282.96 281.5 281.5 280.9 280.7 281.0 280.8 280.0 280.0 281.0 281.0 279.9 279.4
 196 34 34 40 42 39 41 49 49 39 39 50 55
 137 118 85 53 14 16 3 13 17 26 30 33 FENCE

52+0 38' Lt of L = L 9" Euc "

+94 350' Rt of L = L 12" Euc "

+76 1030' Lt of L = L 24" Euc "

+74 39' Lt of L = L 9" Euc "

+71 40' Rt of L = L 9" Euc "

+66 24' Lt of L = L 15" Euc "

+56 520' Rt of L = L 8" Euc "

TP 465 28492 313 380.27 51+50

+54 350' Rt of L = L 15" Euc Tree

+50 200' Lt of L = L 12" Euc "

+45 1030' Lt of L = L 15" Euc "

+30 37' Lt of L = L 12" Euc "

+28 170' Lt of L = L Cluster of Small Euc Trees

+20 = Sand 1090 Elec. Div. Min. Hole on Rt.

+12 15' Lt of L = L 15" Euc Tree

+10 1490' Lt of L = L Light Standard #4259

282.77



282.5 279.8 279.6 279.9 279.4 280.2 280.1 280.4 279.4 279.4 280.4 280.4 278.9 277.6
 0.9 3.6 28 25 40 22 23 30 30 40 30 30 25 5.8
 142 122 63 35 110 6 4 8 15 17 28 30 580-FENCE

284.92

282.11

282.5 279.6 278.4 278.7 278.4 279.5 279.6 278.8 279.6 279.6 276.2 275.0
 0.9 2.8 50 47 50 39 3.8 1.6 3.8 3.8 2.8 8.4
 143 122 75 37 50 39 10 16 17 16 40 84-FENCE

277.55 272.90
 5.85 10.50
 120-155
 Top
 Can Spring
 15' Euc
 15' Euc
 40' Bottom

282.40

283.40

Lt. S Pt.

TP 559 290.23 4.19 28464

- +82
- +42 13' Rt of S - NW Fence Cor of Nursery
- +39 136' Lt of S = S Light Steel # 4361
- +30 131' Lt of S = S 14" Fuc
- +30 126' Lt of S = S 15" Fuc
- +30 113' Lt of S = S 10" "
- +30 88' Lt of S = S 8" Fuc Tree

100 459 4.12 4.38 5.5 5.5 4.37 4.33 4.38 5.9 5.4 4.36 4.63 7.8 7.7
 130 54 32 13.5 13 4 4.06 17.06 17 21 26.06 45.06 8.11 8.11
 130 54 32 13.5 13 4 4.06 17.06 17 21 26.06 45.06 8.11 8.11

53+27 522 52 48 4.3 4.71 500 6.0 6.1 198 493 4.99 6.0 6.0 4.99 5.27 88 96
 +26 460' Lt of S = S 20" Fuc Tree 146.5 135 88 88 33.0 130 13 4 4.06 17.06 17 21 26.06 45.06 8.11 8.11

522 52 48 4.3 4.71 500 6.0 6.1 198 493 4.99 6.0 6.0 4.99 5.27 88 96
 146.5 135 88 88 33.0 130 13 4 4.06 17.06 17 21 26.06 45.06 8.11 8.11
 288.83

TP 535 288.83 1.44 283.48

- 52+20 75' Lt of S = S 10" Fuc Tree
- 19' Lt of S = S Power Pole SR 2457
- +92 = 5 1/2" Curbs + Black Top Pavings

113 20 130 146 26 28 14 144 147 26 28 150 127 60
 530 110 348 13 73 4 4.06 17.06 17 21 26.06 45.06 8.11 8.11
 146.5 135 88 88 33.0 130 13 4 4.06 17.06 17 21 26.06 45.06 8.11 8.11

- +88 32' Rt of S = S 12" Fuc Tree
- +85 38' Lt of S = S 14" Fuc "
- +80 560' Rt of S = S Power Pole # C 2055
- +67 47' Lt of S = S 18" Fuc Tree
- +67 30' Lt of S = S 14" Fuc "
- +52 20' Lt of S = S 14" Fuc "
- +52 420' Rt of S = S 14" Fuc "

1.5 2.2 3.9 3.7 3.1 3.1 4.0 5.9
 4.3 13 13 16 26 31 810 = Fence
 42.8 13 13 16 26 31 810 = Fence

+47 = South Line Merry Go Round or Lt

216 18 25 11 14 21 27 3.3 3.5 4.5 4.5 3.4 3.4 4.6 5.3
 149 137 123 100 76 45 16 14 3 13 17 26 39 59 = Fence

52+34 52' Rt of S = S 14" " "
 69' Lt of S = S 12" Fuc Tree
 28492

28492

+87

+80

+80 = NY Carbo + BlackTop

TP 985 296.31 377 286.46

55+18

B.M.

+37.3

54+2730 = Laurcl Prod. From West Taken by Sker

290.23

47.

2

pt.

31

12.23 13.18
Top Wall
1 Box 1/2 box
80x22x24
7.0x22x24
8 Pip 7 of each

1453 1186 112 46 47
121 131-cb top
12 = quite

8.5 8.5 9.57 9.69 10.8 10.7 9.65 9.64 9.71 11.0 11.0 9.73 9.71 9.68
59 50 32 13-cb 13 4 4-cb 12-cb 17 28 26-cb 31 46
5.5 5.5
5.5
296.31

6.95
132

6.45 6.02 4.15 4.33 5.2 5.3 4.36 4.36 4.39 5.3 5.3 4.38 4.40
88 520 31 13-cb 13 4 4 16-cb 16 26 26-cb 46-FH/Black
5.5
5.5
Top

N.W. BP
Laurcl +
Park Blvd
283.28

7.06 283.17

6.96 6.48 6.15
135 100 820
5.5
5.5
5.5

6.19 3.89 3.97 4.80 5.17 6.3 6.4 5.16 5.08 5.19 6.3 6.3 5.19 5.30 6.6
19 41 33 33 13-cb 13 4 4-cb 16-cb 16 26 26-cb 46-FH/Black
18x
18x
18x
290.23

290.23

Sept. 29 50

At.

3

+75

288.86
82.23 745
84.0 84.0 cb

75 70 27 20 45 97 10.2 9.8
84 75 27 38 7 25 63

+50

835
980
50

767 74 40 41 55 99 100 10.1 9.3 9.5
980 900 810 260 230 80 44.0 47.0 59

57+0

905
1150
64

845 80 26 28 97 10.5 10.9 9.8 10.3 11.0 10.4 9.8 10.2
1150 670 90 510 350 11 12 24 29 38 40 310

296.55

TP

401 296.55 3.77 292.54

07 Stub
± PRC

+50

1037 982
125 64
125 64

91 27.56 102 104 10.3 10.5 11.6 11.0 10.2 10.7 270
147 105 57 48 13 7 8 22 25 36 330

+21

22 1/2 = 2 1/2 " "

+15

23 1/2 = 2 1/2 " FACTIVE

56+0

1195
126 64

1122 11.0 15.5 9.5 10.7 10.9 12.1 11.6 11.0 11.1 22.8
130 123 108 77 47 13 2 14 17 27 50

296.31

296.31

4

5

R1

+50

642	710	656	686	717	647	63	41	46	45
490-cb	490-gut	180		128-gut	128-cb	310	390	380	900

289.38

290.08

59x0

670	746	685	739	679	67	40	39	44	50
740-cb	740-gut	410	8-gut	8-cb		8	380	750	

289.16

289.76

+75

697	753	696	66	40	42	29	45
530-gut	530-cb	110	60			340	700

289.02

289.59

+3196 = PRC

288.70

289.31

785	774	68	59	41	50	88	87
57-gut	57-cb	470	370		470	590	750

288.46

289.15

5810

813	740	69	24	34	46	50	41	95
718-gut	718-cb	680	370	260		12	22	70

296.55

296.55

Lt.

S

Rt.

BM

868 28819 + Perktid
288.28
H.W.B.P.
Laural

TP

299 291.87 767 28888

+56.67 - F.C.

6.42 6.17 6.26 6.52 6.4
30.0 30.0 480

290.03

60.40

296.55

6.08 6.72 6.41 6.42 6.77 6.16 6.1 6.1 6.4
37.5 37.5 35.0 36.0 35.0 36.0 35.0 36.0 36.0
37.5 Carb. 37.5 Gutter 36.0 35.0 36.0 36.0 36.0
396.55 399.78 290.79

Additional Outc Park Blvd Nidening

39+0 to 45+7/19

L of of 1/2

Oct. 6-50
H.S. Simon
Garber
Rorer
Pullen

35

+50

73.0 L of 1/2 - Fly Fac Trees

257.3

258.3

260.3

262.9

94
160

84
130

64
100

38
73

41+0

INDEXED
MK
DEC 15 1950

256.4
99
160

258.1
86
130

260.2
65
100

261.3
54
80

+50

85.0 L of 1/2 - Fly Fac. Trees

256.1
106
160

257.5
92
130

259.1
76
100

259.7
70
85

40+0

255.4
110
160

253.8
109
130

257.0
97
100

257.8
89
88

+50

254.2
125
160

255.6
111
130

256.1
166
100

256.7
100
83

89+0

86.0 L of 1/2 - Fly Fac. Trees

252.9
138
160
87
56

253.6
139
130

254.4
129
100

255.1
116
86

BM #9

213

266.69

264.56

TOPORRILL
4' L
40+94
Page 23

266.69

TP 7.47 281.84 1.9 273.57

+50 105° Lt of $\frac{1}{2}$ - Fly Eye TRCS

44+0

+50 100° Lt of $\frac{1}{2}$ - Fly Eye TRCS

42+0

+50

TP 8.77 274.76 0.70 265.99

42+0

266.89

Lt of $\frac{1}{2}$

272.4 272.9 273.7
2.4 1.9 1.6
180 180 250

271.4 271.6 272.4
3.6 3.0 2.4
180 180 90

268.5 270.0 271.0
6.3 7.8 6.8
180 180 90

264.8 266.3 268.3 268.8
10.0 8.5 5.5 6.0
180 180 100 87.0

260.6 261.9 264.0 266.9
14.3 13.9 10.8 7.9
180 130 180 77.0

274.76

258.4 259.8 261.7 264.7
8.3 6.9 5.7 3.0
180 180 100 75.0

266.89

Left of E

BM

536

27568

o J. E. Hill Calk.
Nursery
East R.R. Tract
27569
Page 26

+71.69 = FC.

138 4/10 of 2 - Fly Eucitross

274.1	275.4	276.9
69	56	41
166	130	100

+50

273.7	275.3	276.3
71	57	17
160	130	100.0

4570

273.7	274.3	275.1
73	67	59
160	130	100.0

28/04

28/04

Levels Ex. Storm Drain
Park Blvd.

38

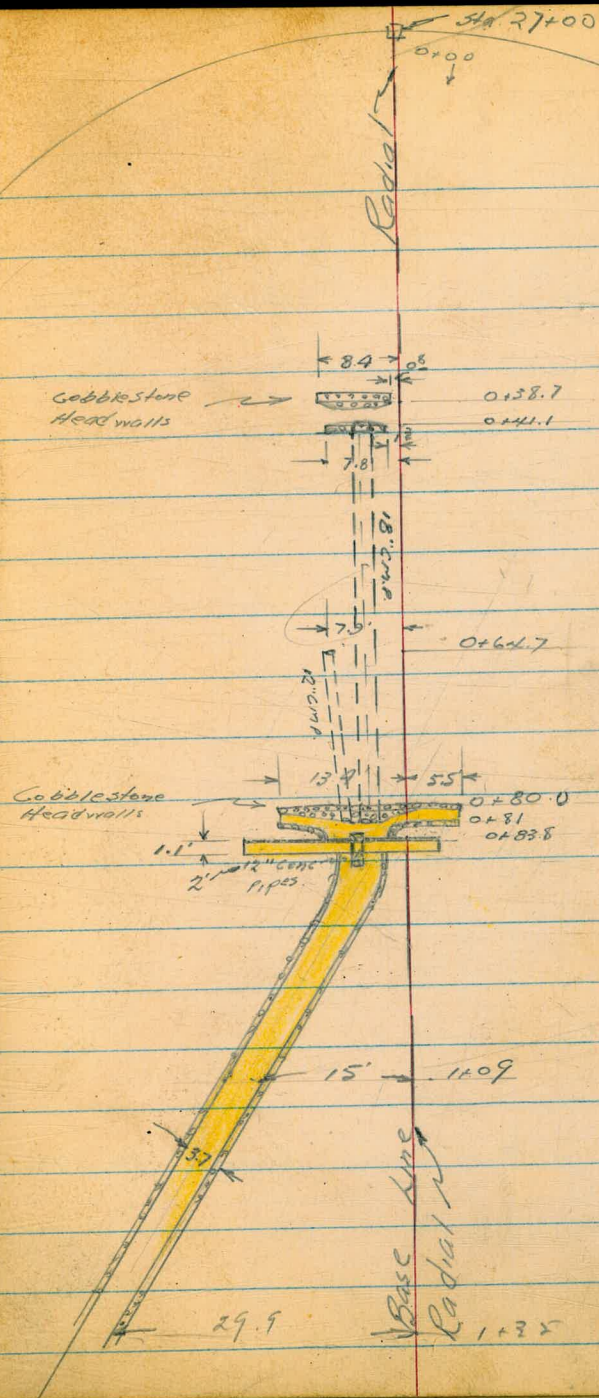

0+80 Ely Edge Cobblestone H.W.

207³⁹
5.5
H.W.206⁷⁶
4.4
H.W.206⁵⁵
17.4
H.W.

0+64.7 Prop. 12" C.M.P. on Rt.

212²
7.9
FL

0+41.1 Wly Edge Cobblestone H.W. on Rt.

213⁵³
1.3
H.W.213⁴⁸
3.9
H.W.209⁷³
3.9
FL
18" C.M.P.

0+38.7 Ely Edge Cobblestone H.W. on Rt.

213¹⁷
0.8212²¹
4.2
H.W.

0+00 = Sta 27+00

B17

213.21

Top. Ex. Cobblestone H.W.

(P. 15 this Book)

1+38

197°	195 ⁺⁷	152 ⁺⁷	171°
29.9	29.9	34.2	34.2
H.W	FL	H.W	FL

1+09

202° ⁵	199 ⁶⁴	199 ⁶⁴	201°
15	15	19.2	19.2
H.W	FL	FL	H.W

0+84.9 Beg. 3.7' Conc. & Cobblestone open Drain
 Fly Edge Conc. H.W

205 ³⁷	206° ³	202 ³⁵
H.W	57	57
	H.W	FL

0+83.8 Beg. 1.1' Conc. Headwall

206 ⁵⁸	206 ³⁵	208 ⁴³
3.2	H.W	17
H.W		H.W

0+83.2² Beg. 12" Conc. Pipes (vertical)

203 ⁹⁸	202 ³⁵
5.7	5.7
FL	FL
12" Conc	12" Conc

0+81 End 12" CMP on R.
 End 18" CMP on R. 2 Conc. Drain

204 ⁸⁷	204 ⁶¹	203 ⁸⁶	202 ³⁵	203 ⁸¹	204 ⁵⁰	204 ⁶⁹
2.3	4.4	4.4	6.2	8.0	8.0	13.7
FL	FL	FL	FL	FL	FL	FL
	18" jump	12"				
	CMP	CMP				

Detail of Ch.
 Entrance to Naval Hosp.

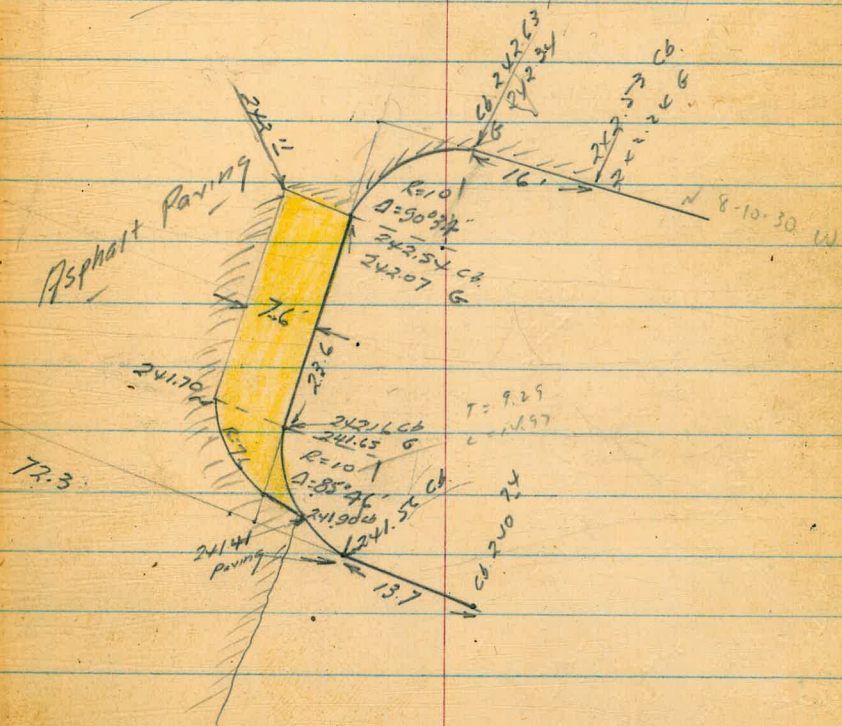
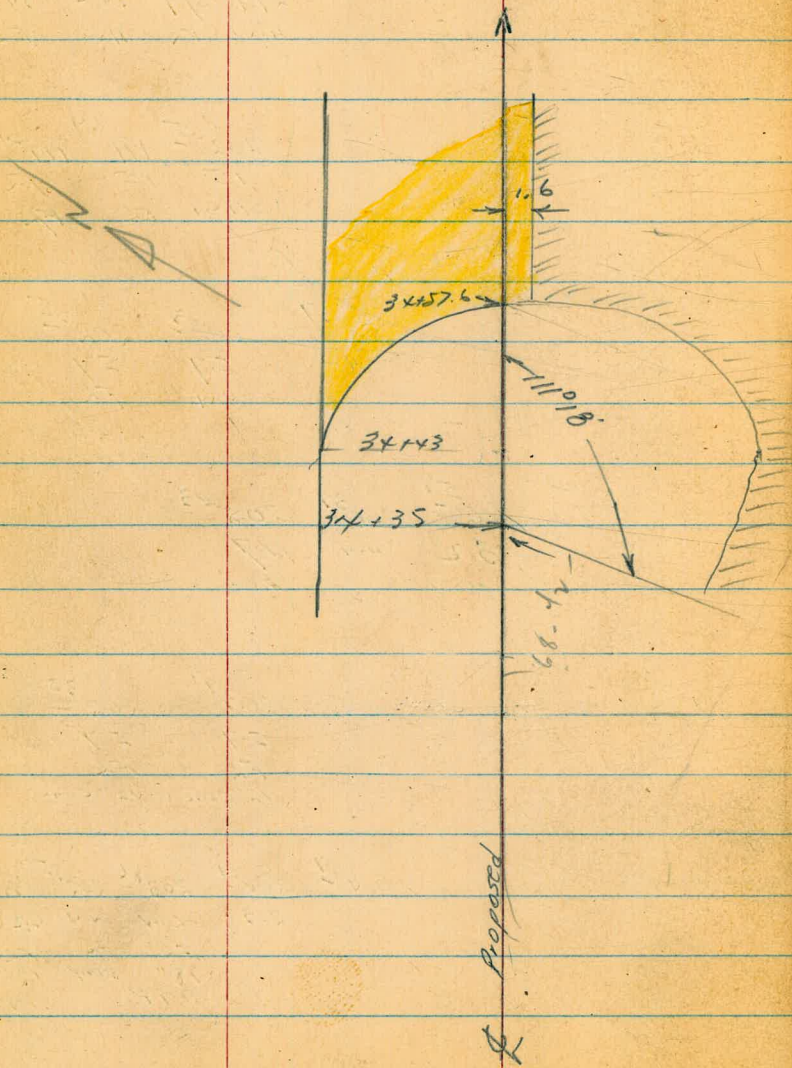

Cross Section Park Blvd "L" Line
 11+0 to North of El Prado

Alignment # 2113

INDIVIDUAL
 MAR 2, 1951

13+0

160.3 161.8 162.5 171.8 174.1 174.3 175.0 174.38 175.08 174.49
 20.8 19.3 18.6 9.3 7.0 6.8 6.1 6.71 6.01 6.60
 81.5 49.7 35.5 11' 15 20 31 54 73.7
 N.Y.C. N.Y.C. N.Y.C. N.Y.C. N.Y.C. N.Y.C. N.Y.C. N.Y.C. N.Y.C.

+50

21.7 16.2 9.7 8.3 8.6 9.3 8.6 9.45 8.57 8.81
 70 50 35 11 3 18.4 20.2 41.5 65.7
 N.Y.C. N.Y.C. N.Y.C. N.Y.C. N.Y.C. N.Y.C. N.Y.C. N.Y.C. N.Y.C.

TP 9.29 181.09 206 171.80 181.09

12+0

165.4 169.8 170.9 169.3 167.8 169.8 169.20 169.86 169.69
 8.3 4.1 3.0 4.6 4.1 4.1 1.66 1.00 1.17
 75 56 31 8 7 8.5 29.5 50.5
 N.Y.C. N.Y.C. N.Y.C. N.Y.C. N.Y.C. N.Y.C. N.Y.C. N.Y.C. N.Y.C.

+50

168.9 168.9 166.9 166.70 166.84 167.31 167.05
 5.0 5.0 7.0 7.16 7.02 6.55 6.81
 75 45 19 3.5 18 3.83
 N.Y.C. N.Y.C. N.Y.C. N.Y.C. N.Y.C. N.Y.C. N.Y.C.

11+0

166.0 165.4 167.0 164.3 165.7 164.18 164.59 164.70 164.47
 7.9 8.5 6.9 9.6 8.2 9.68 9.27 9.16 9.39
 75 57 46 30 14 13.3 8 28.6
 N.Y.C. N.Y.C. N.Y.C. N.Y.C. N.Y.C. N.Y.C. N.Y.C. N.Y.C.

TP 9.81 173.86 13.20 164.05 173.86

BM 0.85 177.25 176.90 5.04 81.09
 N.E. BP Platform
 S.D.H. 51m
 81.09

Feb 28, 51 42
 175.5500
 Garbar Rt. East
 Racer
 Bertolucci
 N.O. 20669

Lt. Lt. Rt.

+50

181.7	181.6	181.4	182.0	181.8	181.6	183.1	183.4	183.8	183.50
89	90	92	86	88	90	75	72	68	707
75	50	25	11		3	8	27	44	454
		=HWPC			=HWPC				=HWPC

15+0

173.7	179.1	179.4	178.7	179.7	179.3	181.5	181.7	182.5	182.11
169	115	112	119	109	103	91	89	81	846
76	55	45	12	109	11	19	39	47	486
			=HWPC		=HWPC				=HWPC

+50

165.8	168.7	176.9	177.3	174.9	175.9	176.0	178.7	179.5	179.8	180.9	180.10
218	219	137	123	157	147	146	119	111	108	97	1007
80	43	25	21	148		137	21	35	40	48	488
				=HWPC		=HWPC					=HWPC
				190.57							1006666

TP

9.76 19057 0.28 180.81

14+0

159.8	161.9	171.8	169.8	171.8	172.1	172.0	178.5	179.2	179.3	178.79
213	192	93	113	93	90	91	26	19	18	230
60	56	30	22.5	8		8.5	28	25	15	26
			=HWPC			=HWPC		=HWPC		=HWPC
								Top Cabok		
								Hall		

13+50

165.6	166.1	145.2	167.0	167.9	171.4	176.1	176.7	177.4	176.77	177.47	177.04
155	150	159	141	132	97	50	44	37	432	362	405
50	45	39.5	26	12		12	23	37	38.6	60	81
		=HWPC		=HWPC					=HWPC		=HWPC
					181.09						

181.09

181.09

18+0

194.7 192.43 192.77 192.21 193.4 192.4 192.0 191.5 191.89 192.26 191.78
 51 533 499 555 44 54 58 53 587 540 598
 72 85 50 328 29 7 15 17
 31/4 = 31/4 HC 31/4 = 31/4 HC 31/4 = 31/4 HC

+50

192.2 192.7 190.4 190.9 190.4 191.4 190.9 190.2 190.7 190.11 190.24 192.86
 56 51 74 69 74 64 69 76 71 765 724 790
 80 67 58 44 275 25 14 21 23 237 730
 31/4 = 31/4 HC 31/4 = 31/4 HC 31/4 = 31/4 HC 31/4 = 31/4 HC

17+14.97 = Mid. Point

190.5 191.2 188.9 189.5 188.96 190.2 189.7 189.1 189.3 188.88 189.34 188.78
 73 66 89 83 880 76 81 87 85 888 842 898
 75 62 555 40 226 20 18 26 268 47 67
 31/4 = 31/4 HC 31/4 = 31/4 HC 31/4 = 31/4 HC 31/4 = 31/4 HC

+50

187.2 186.5 187.7 186.1 186.4 186.1 187.5 187.2 186.8 187.2 186.66 187.24 186.79
 106 113 101 117 114 117 103 106 110 106 1110 1052 1027
 75 84 50 45 305 143 11 25 32 34 51 73
 31/4 = 31/4 HC 31/4 = 31/4 HC 31/4 = 31/4 HC 31/4 = 31/4 HC

TP

11.40 197.76 4.21 186.36

197.76

16+0

184.4 185.1 184.0 184.6 184.4 186.0 185.7 185.5 185.5 185.04
 62 55 66 60 62 46 49 51 51 553
 80 43 87 21.5 74 13 30 38 393
 31/4 = 31/4 HC 31/4 = 31/4 HC 31/4 = 31/4 HC 31/4 = 31/4 HC

190.57

190.57

Park Blvd 2" Line

Lt.

Rt.

Rt.

45

+79

199.9 199.9 198.4 198.50 198.71 198.79 198.99 199.13 200.17 200.12
 7.1 7.1 8.9 8.82 8.1 8.53 8.33 8.19 7.15 7.20
 70 42 39 39 4 97FC 16 37 50 75
 NYFC NYFC NYFC NYFC NYFC NYFC NYFC NYFC NYFC NYFC

+58

198.9 198.8 197.82 198.03 197.89 198.20 198.05 199.09 199.47
 8.4 8.5 9.50 9.29 9.43 9.12 9.27 8.23 7.85
 78 67 51 37 18 18 36.5 50 64
 NYFC NYFC NYFC NYFC NYFC NYFC NYFC NYFC NYFC

+37

198.7 197.02 197.29 197.12 197.7 197.3 198.1 197.04 197.41 197.15 197.62
 8.6 10.30 10.23 10.20 9.6 10.0 9.2 10.28 9.9 10.17 9.70
 75 64.5 47 33 30 11 5 NYFC NYFC NYFC NYFC NYFC NYFC NYFC NYFC NYFC NYFC

BM

9.24 19808 Lt 19+55
 24.7 19809

BP 86.5
 Lig 51 Standard
 24.7
 19809

19 + 0

197.6 195.78 196.25 195.62 196.6 195.7 196.2 196.4 195.52 196.00 195.35
 97 11.84 11.07 11.70 10.7 11.6 11 10.9 11.80 11.32 11.97
 86 NYFC 55 NYFC 39.8 NYFC 36 NYFC 7 NYFC 3 NYFC 43 NYFC 25 NYFC 46 NYFC

TP

12.16 20732 260 19516

20732

18 + 50

196.3 194.1 194.7 194.0 195.0 193.7 194.0 193.65 194.15 193.71
 15 3.7 3.1 3.8 3.8 4.1 3.8 4.1 3.58 4.05
 74 67 NYFC 63 NYFC 38.7 NYFC 34 NYFC 9 NYFC 15 NYFC 31 NYFC 52 NYFC

19776

19776

22+0

+50

TP

847

214.81

098

206.34

Top Base
of 2961/294
H 21450

21+0

+50

20+0

Lt

Rt

March 2-51
H. S. Spoon
Garber
Forster
Bertolucci

207.2	207.4	207.1	206.5	206.9	206.66	207.04	206.95	206.61	207.4	206.8	205.9	206.9
76	74	77	8.3	79	8.15	777	7.86	8.20	7.4	80	89	7.9
76	56	46	45	30	29.5	9	122	122	15	24	28	30
Top Fence												

206.0	205.9	204.9	205.5	205.07	205.44	205.43	204.96	205.8	205.7	204.6	205.3	205.3
88	89	99	93	9.74	9.25	9.38	9.85	9.0	9.1	10.2	9.5	9.5
68	53	41	27	25.5	15	9	9.8	18	26	30	23	45
Top Base of 2961/294 H 21450												

204.6	203.7	203.2	203.7	203.35	203.60	203.18	204.1	203.0	202.7	203.6
2.7	3.1	4.1	3.6	3.99	3.92	4.14	3.2	4.3	3.6	3.7
64	38	37	33	30.3	30.3	20	24	37	40	55
Top Base of 2961/294 H 21450										

202.1	201.9	202.1	201.6	202.0	201.50	201.73	201.76	201.73	202.9	201.5	202.0
5.2	5.4	5.2	5.7	5.3	5.82	5.59	5.56	5.59	4.1	5.8	5.3
75	45	33	32	16	14	8	8	25.5	31	45	50
Top Base of 2961/294 H 21450											

200.1	200.4	200.2	199.5	200.0	199.49	199.54	199.72	199.82	200.06	200.81	200.86
7.2	6.9	7.1	7.8	7.2	7.83	7.78	7.0	7.50	7.26	6.51	6.46
75	50	37	35	12	10	7	07	13	31	47	61
Top Base of 2961/294 H 21450											

15506 BCR/

TP 9.57 222.19 219 212.62

21+0

+50

22+0

22+50

21481

Lt

S

Rt

47

212.6	214.0	214.2	213.8	214.4	213.81	214.09	213.94	213.62	214.1	214.1	212.9	213.6	214.2
86	82	80	84	78	83.8	81.0	82.5	85.7	81	81	93	86	90
75	62	51	50	66	34	13		85.5	10	18	21	25	38

222.19

212.9	212.9	212.9	212.6	213.1	212.56	212.89	212.23	213.40	213.1	212.9	211.6	212.2	212.0	211.2
19	19	19	22	17	225	192	2.08	241	17	19	32	26	28	26
75	64	50	49	36	33.8	135		76		19	22	25	48	40

211.6	212.0	211.5	211.3	211.6	211.24	211.58	211.45	211.27	211.9	211.7	210.4	211.0	210.8	210.2
32	28	33	35	32	35.7	333	3.26	354	29	21	44	38	40	46
75	62	51	49	36	34	135		8	10	16	23	26	38	40

210.2	210.0	210.0	209.7	210.0	209.77	209.09	209.89	209.57	210.4	210.4	208.6	209.9	209.9
46	48	48	51	48	50.4	472	492	524	44	44	60	49	49
47	64	51	50	35	33.8	135		85	10	18	23	26	36

208.6	208.5	208.4	208.1	208.3	208.15	208.56	208.35	208.10	208.6	208.5	207.3	208.5	208.6
62	63	64	67	65	66	67.5	64	67	6.0	6.0	7.5	6.3	6.2
74	73	48	48	33	33	13		9.5	11	21	27	27	37

21481

Park Blvd. 2nd Line

Lt.

L

Rt.

48

27+0

215.8	217.5	217.9	218.4	217.77	218.10	217.9v	217.75	218.3	217.8	217.1	218.2	217.2	216.7	217
64	47	43	38	442	409	427	444	39	44	51	40	59	55	45
65	47	46	38	36	16		65	7	19	22	35	34	37	40

36-HNFC
65-FHFC

+50

216.2				217.04										
60	53	56	48	515	490	515	531	47	58	61	58	56	63	52
65	53	52	39	36	16		5	8	18	20	24	33	38	40

36-HNFC
5-FHFC

26+0

				216.20											
73	63	59	67	56	599	588	592	618	57	58	69	59	66	71	62
75	65	52	57	38	363	15		5	8	18	20	24	34	36	40

36-HNFC
5-FHFC

+50

215.1	215.9	215.6	215.4	215.9	215.47	215.74	215.83	215.16	215.9	215.6	214.6	215.6	215.4	214.6	215.4
71	68	66	68	63	672	645	636	703	63	66	76	66	70	76	68
75	63	51	50	37	35	15		65	9	16	21	24	34	37	40

35-HNFC
65-FHFC

25+0

214.5	215.0	214.6	215.1	214.62	214.21	214.70	214.39	214.9	214.7	213.3	214.6	214.0	213.3	214.
77	72	76	71	757	738	749	780	73	75	89	76	82	89	80
75	62	49	36	34.5	32.5	30	7	9	19	26	25	35	37	41

34-HNFC
7-FHFC

22219

22219

750

223.5	224.3	223.9	224.5	224.6	224.00	224.10	224.39	224.12	224.8	224.7	224.6	224.7	224.2	224.5
102.95	99	99	99	90	97.7	93.7	93.8	96.5	90	91	100.9	91	96	103
65	44	37	36	29	25	51		13.5	78	84	37	31	41	43

WATER

29+0

221.3	221.4	221.1	222.5	222.7	222.2	222.79	222.5	221.51	222.0	222.8	222.1	222.1	222.5	222.6
125.14	117	113	111	115.5	109.8	110.2	112.6	108	109	117	107	113	110	
55	56	38	37	29	28	8	14	76	22	24	29	38	44	

WATER

7P

1274 233.77 116 221.02

218.0	221.5	220.7	221.3	221.6	220.97	221.26	221.21	220.81	221.4	221.5	220.6	220.7	221.1	220.5
32	27	15	09	06	122	091	0.98	138	0.8	07	16	05	11	17
65	55	40	39	33	30	10	00	11.5	13	20	23	27	32	40

WATER

750

28+0

216.3	219.0	219.4	219.8	220.1	219.71	220.06	219.66	219.67	220.4	220.1	219.5	220.4	219.7	219.9
59.32	28	24	21	21	24.8	21.5	230	252	1.8	21	27	18	25	21
65	58	42	41	35	32.5	11		9	11	13	21	25	35	41

WATER

27+50

218.0	218.4	218.7	219.2	218.63	218.96	218.82	218.69	219.3	219.3	218.0	219.2	218.4	217.5	218.2
42	38	25	30	35.6	32	32.7	350	27	29	22	30	28	34	38
65	44	43	36	34	135	20	7	17	21	24	35	39	40	

WATER

222.19

232.19

TP 11.81 244.04 1.54 232.23

3270 ✓

+76 = 54 Curb on Rt

+50

3140

+50

3070

233.77

Lt.

2

Rt.

232.1 232.1 232.1 232.7 233.0 233.5
 07 07 07 11 08 08 26 074
 65 46 36 29 28 28 20: WYHC

232.03 232.68 232.35 232.0 231.7 232.6 232.3
 109 0.42 08 2.1 10 1.5
 22.3 25.3 39.42 46 35
 231.80 232.50
 197 137
 22.36d 22.54C

231.7 231.3 231.0 231.3 231.5 230.77 231.23 230.93 231.1 231.7 230.0 231.3 230.5
 21 25 28 25 23 200 284 284 24 21 28 25 38
 65 36 29 28 22 15: WYHC 12: HHC

229.8 230.0 229.7 229.1 229.5 229.5 229.02 229.61 229.10 229.7 229.6 229.5 229.8 229.1 229.2
 40 38 41 47 43 43 475 416 467 41 42 53 40 47 56
 65 48 37 30 29 23 21: WYHC 11: FHC

228.1 228.3 227.9 227.6 227.8 228.3 227.40 227.83 227.39 227.9 227.9 226.8 226.1 227.4 226.6 226.1
 5.7 5.5 59 6.2 60 5.5 6.27 59.4 6.38 59 59 70 57 54 7.6 51
 65 48 39 33 30 25 22: WYHC 19: FHC

225.8 226.2 225.6 226.2 226.1 225.71 226.11 226.12 225.86 226.4 226.6 225.4 226.5 225.6
 80 76 82 76 77 80.6 7.6 7.65 7.91 7.4 7.2 8.4 7.3 8.2
 65 44 34 33 27 21: FHC 23: FHC

233.77

Park Blvd. "L" Line

BM

365 240.39
SE Chisold
Entrance
Havelberg
240.39
Page 8

34+24 ✓ = Carb BC on Rt

246.0
2.0
85

241.7 240.71 240.72 240.2 240.40 240.56 237.56 240.40 240.4 239.9
46 39 34 33 20 00 217 217 39 53
Top Roll
Gutter
Carb

+ 75

240.0 239.7 239.34 239.11 238.74 238.57 239.04 238.21 239.09 239.0 238.2 238.5 238.4
40 42 37.5 28 26 20 00 218 195 50 58 55 56
Top Roll
Gutter
Carb

+ 45 = sly oil on Lt

237.9 238.29 238.31 237.64 238.03 237.39 238.22 238.0 236.9 237.3 236.7
61 57.5 57 40 6.01 65 58.2 60 71 67 75
Top Roll
Gutter
Carb

33+0

236.6
74
85

236.7 236.6 236.1 236.6 236.8 235.96 236.53 235.51 236.67 236.3 236.7 236.0 235.7
48 36 29 28 23 80.8 751 809 737 77 92 80 85
Top Roll
Gutter
Carb

32+86.70 E.C.

32+50

234.5
95
85

234.7 234.7 234.4 234.8 234.9 234.29 234.65 234.23 234.96 234.7 234.2 234.2 234.0
93 92 96 92 91 97.5 919 981 906 93 10.8 98 100
Top Roll
Gutter
Carb

244.04

244.04

Rt.
March 3-51

Lt.

25750 x

244.9
77
65

247.9	245.35	245.24	244.67	244.60	245.02	244.35	244.91	244.99	244.4	244.1
77	1034	1035	1002	1079	1057	1134	1088	1060	1148	1155
48	39	35	342	20	0.8	209	209	40	43	50
			W/Oil	Top Roll	Gut.	Gut	Gut	Fl Oil		

255.59

TP 1247 255.59 0.92 243.12

on curb
SWY gut
stations

+965 = Curb EC. 07 Rt.

245.6
116
65

245.1	243.53	243.33	242.81	242.97	243.27	242.40	242.85	243.35	243.25	242.7	242.4
71	0.51	0.71	122	107	0.97	1.64	1.19	0.69	0.99	1.3	1.6
46	39	35	34	20		213	213	27	40	42	55
			W/Oil	Top Roll	Gut.	Gut	Gut	W/Oil	Fl Oil		

+78 = N. Fly Curb 07 Rt.

244.7	244.1	242.72	242.61	242.14	242.25	242.38	241.81	241.59	242.23	242.50
70.7	70.1	132	143	190	179	166	2.23	1.45	1.31	1.54
65	42	39	35	34	20		19	41	41	55
			W/Oil	Top Roll	Gut Oil			Fl Gut	Fl Curb	on HC

+59 = Approx. Center of Drive to Naval Hospital

243.6
09
85

242.5	242.12	241.98	241.51	241.60	241.72	241.06	241.88	241.98
15	192	206	253	241	222	298	216	2.06
44	39	35	34	20		19	41	55
			W/Oil	Top Roll	Gut Oil		Fl Conc	on HC
							Fl Conc	Paving

34+39 = S. Fly Curb on Rt.

242.7
12
65

242.0	241.25	241.24	240.70	240.88	241.02	240.26	241.15	241.35
20	279	280	334	316	302	378	289	269
45	39	34	33.5	20		21.3	42	55
			W/Oil	Top Roll	Gut Oil		Fl Conc	on HC
							Fl Conc	Paving

241.04

244.04

38+0

252.9	253.1	253.21	253.22	253.71	253.14	254.1	254.1	253.1	254.07
128	126	1246	1245	1196	1253	116	116	126	1160
85	50	23-NY/Oil	19		216-FYAC	25	30	33	53

26667

SJ/F.C. 1.0
Gulf #2

TP 1184 26567 176 25383

+50

251.8	251.85	251.74	251.50	251.66	252.03	251.52	252.1	251.9	251.2	250.8	251.2
2.0	3.74	3.85	4.69	3.93	3.56	4.07	3.5	3.7	4.4	4.8	4.4
66	36-NY/Oil	31.5-Top Roll	20.5	20		19.8-FYAC	22	30	32	46	50

+40

39' Lt of 2 = NY + Ang 6 Oil on Lt

37+0

251.3	250.9	250.4	249.96	249.59	249.89	250.27	249.65	250.4	250.6	246.8	249.8
43.47	54.5	56.3	60	570	5.82	5.94	5.2	5.0	6.8	5.8	5.8
65-47	40	35-Top Roll	34.4	oil cut		19.5-FYAC	21	28	30	30	30

36+50

251.0	250.6	248.85	246.63	246.05	246.27	246.59	247.93	246.7	247.1	247.8	246.0	247.1	247.9
4	50	674	696	784	732	700	766	69	6.9	8.5	7.8	7.6	8.8
65	45	31-NY/Oil	35-Top Roll	34.3	oil cut		80-FYAC	33	39	31	35	45	47

35+966 = NY Curb on Pt.

250.7	250.3	247.10	246.91	246.31	246.44	246.70	246.11	246.77	246.7	245.7	246.0	245.3
19	52	849	848	928	915	889	948	822	89	99	96	10.3
65	46	39-NY/Oil	85-Top Roll	34.4	oil cut		30.7-Top	30.7	39	32	47	50

28559

Curb End

25559

Park Blvd "L" Line

Lt

L

Rt

54

+50

255.6	256.3	257.4	257.99	258.44	258.72	258.60	258.9	257.9
9.9 85	9.4 50	8.3 25	7.8 10	7.2 10	6.9 11	7.0 33	6.8 35	7.8 50

10' = 1/4 H.P.C.
13.35 = H.P.C.

39+0

255.1	255.4	255.7	256.36	256.92	257.01	256.69	257.2	256.4	256.9
10.6 65	10.3 50	10.0 30	9.8 13	8.7 13	8.6 7	8.9 28	8.5 30	9.3 45	8.8 50

13' = 1/4 H.P.C.
28 = H.P.C.

+60

254.1	254.3	255.0	255.04	255.74	255.54	255.9	255.6
11.6 65	11.4 50	10.7 38	10.6 18	9.9 18	10.1 25	9.8 40	10.1 50

18' = 1/4 H.P.C.
25 = 1/2 H.P.C.
10.6 = 1/2 H.P.C.

+40

253.6	254.0	254.3	254.42	255.04	255.01	255.22	256.37	256.32
13.1 85	11.7 50	11.4 31	11.2 17	10.6 17	10.6 24	10.4 33	9.3 50	9.3 57

17' = 1/4 H.P.C.
25 = 1/2 H.P.C.
57 = 1/4 H.P.C.
10.6 = 1/2 H.P.C.

28+20

253.2	253.6	253.9	253.80	254.37	254.16	254.65	254.87
12.5 85	12.1 50	11.8 30	11.8 18	11.8 18	11.5 24	11.0 36	10.8 50

18' = 1/4 H.P.C.
24 = 1/2 H.P.C.
36 = 1/2 H.P.C.
50 = 1/2 H.P.C.

26567

26567

Lt Lt

BM

11.12

264.57

TOP RR Rail
4' St. 40-194
P. Line
264.56
Page 23

+50

259.9	260.9	261.9	264.1	264.7	265.15	265.74	266.04	266.6
158 85	148 50	138 35	116 18	116 11	105	995 26.5	9.65 47.5	9.1 50
-M/F.C.								
275.69								

TP

11.24

275.69

122

264.45

4140

259.1	259.6	261.8	262.9	262.1	263.1	263.36	263.99	264.19	264.6
66 65	61 50	39 20	28 12	23 9	21	2.81 26	1.68 26	1.48 1.5	1.1 1.50
-M/F.C.									

+50

258.5	259.3	261.3	260.9	261.60	262.25	262.56	262.9	262.7
72 65	64 50	44 18	48 14	407	2.12 22	3.11 23.5	2.8 45	2.50 50
-M/F.C.								

40+0

257.1	257.9	259.5	259.1	259.83	260.01	260.44	260.76	261.3	260.6
86 65	78 50	65 23	66 20	584	586 16	523 16	491 38.3	4.4 41	5.1 50
-M/F.C.									

39+71.64 PCC.

256.0	256.7	258.3	258.60	259.15	259.46	259.60	259.9	258.7
97 65	90 50	74 24	687 10	653	6.71 13	6.07 35.5	5.8 37	7.0 51
-M/F.C.								
265.67								

26567

TP 917 28470 016 275.53

44+0

+50

43+0

+50

43+0

27569

Lt.

S

Rt. 56

273.7	274.9	274.49	274.87	274.40	274.8	273.6
20	0.8	1.20	0.82	1.29	0.9	2.1
85	36	31	35	35	25	50
		21=NYAC		23.5=PH		

272.3	272.8	273.1	272.69	273.08	273.19	272.76	273.0	272.0
24	29	26	200	261	250	293	27	37
85	50	30	15.5=NYAC	8	8	29	30	50
						29=NYAC		

270.5	270.9	271.4	270.90	271.13	271.38	271.09	271.3	270.4
52	48	43	479	458	431	450	44	53
85	50	35	10	10	12	35	37	50
			10=NYAC			35.5=NYAC		

267.4	267.6	268.9	269.06	269.09	269.43	269.43	269.5	269.3
80	81	68	663	660	676	676	67	64
85	50	30	6	6	18	10	45	50
			6=NYAC			10=NYAC		

261.9	262.9	263.6	266.9	267.21	267.53	267.77	268.1	267.9
138	128	101	88	848	816	797	76	78
85	50	30	13	13	22.5	11	76	50
					22.5=NYAC	11=NYAC		

27569

Park Blvd. 2' Line

+59.53 F.C

46+0

+50

45+0

44+50

28470

Lt.

±

RT 57

277.4	279.3	279.57	279.66	279.75	279.55	280.2	279.9	279.09	278.64	277.04
7.3	5.4	5.2	4.82	4.95	5.15	4.5	4.8	5.6	6.8	7.6
76	55	37.5	17		7.4	10	34	36.5	50	75
					F.H.P.C.			10.5	10.5	10.1

277.6	278.7	278.92	279.31	279.16	279.53	279.06	279.4	279.4	278.4
7.1	6.0	5.78	5.39	5.64	5.67	5.64	5.3	5.3	6.0
65	51	35.5	13		9	14	15	32	50
						F.H.P.C.			

277.0	278.3	278.26	278.64	278.54	278.15	278.5	278.4	278.0
7.7	6.4	6.44	6.06	6.16	6.45	6.2	6.3	6.7
65	48	32.5	11		12	13	33	58
					F.H.P.C.			

276.2	277.4	277.20	277.60	277.54	277.24	277.5	276.8	276.0
8.5	7.3	7.50	7.10	7.16	7.46	7.2	7.9	8.7
65	44	28	8		15.5	18	38	50
					F.H.P.C.			

275.0	275.9	275.93	276.15	275.77	276.1	275.4	274.6
9.7	8.8	8.77	8.55	8.93	8.6	9.2	10.1
65	40	26		19	20	44	50
					F.H.P.C.		

28470

450

TP

253

286.73

247

284.20

+24.63 RC Pt

4870

TP

626

286.67

429

280.41

450

4770

284.70

Lt.

St

March 24. 51 Saturday 58
H. S. 100
Garber
Parer
Berfalucci

278.0	278.7	280.4	280.94	281.35	281.07	280.93	280.9	279.7	278.4	277.8
87	80	63	579	538	56	500	52	70	82	82
75	64	58	345	19			17	50	75	
				386.73						

278.4	279.2	280.4	280.76	281.24	280.97	280.89	280.7	279.5	279.0	278.5	277.9
83	75	60	589	543	570	578	60	72	77	82	88
75	61	58	40	78		3.5	10	18	30	50	75
				386.67							

278.3	279.4	280.5	280.58	280.98	280.77	280.64	279.2	278.5	277.6
84	73	62	609	569	590	603	75	82	91
75	58	55	39	19		4.5	35	50	75
				386.67					

277.5	279.9	280.25	280.64	280.50	280.38	279.6	278.6	277.4	
72	48	445	406	420	432	51	61	72	
75	54	38	18		5.5	30	50	75	
				384.70					

277.4	279.8	279.89	280.22	280.12	279.19	279.90	280.3	279.6	278.6	277.3
72	49	481	448	458	471	480	44	51	51	74
75	54	385	117	6.0	7	34.5	34	40	50	75
				384.70						

57+0

282.1	282.43	282.73	282.73	282.48	282.6	281.3	280.7	280.9
46	420	400	400	425	41	5.4	60	58
509	35			35	35	60	75	
SELY		SELY		SELY		SELY		SELY

+50

281.8	282.24	282.59	282.48	282.31	281.9	279.9	279.3	279.9	279.9
49	449	414	425	442	48	68	74	68	68
497	35	11		9.5	20	30	50	59	75
SELY		SELY		SELY		SELY		SELY	

50+0

281.6	281.90	282.38	282.09	281.92	282.1	279.3	278.3	278.0
51	483	435	464	481	43	74	84	87
548	38.5	17		5.5	13	25	38	75
SELY		SELY		SELY		SELY		SELY

+57

570 Lt of 2 - SELY Stucco Bldg.

+50

280.06	281.04	281.73	282.05	281.63	281.50	281.8	279.5	278.4	277.7
667	569	500	468	570	523	49	72	82	90
75	57	41	18		25	10	20	43	75
SELY		SELY		SELY		SELY		SELY	

49+0

277.1	278.0	280.5	281.38	281.69	281.29	281.17	281.2	279.6	278.7	278.0
96	87	62	535	504	544	556	55	74	80	87
75	66	58	41.7	78		35	11	19	50	75
SELY		SELY		SELY		SELY		SELY		SELY

Park Blvd "L" Line

5370

+68 = 1/4 Conc Island
67 ft. H/100 SY
011'07" RI



+44 = 5/4 Conc Island
on Lt.

5240

TP 552 288.29 295 282.77

+59 10 H/10 1/4 1/4 Storage 849

51x50

28673

Lt. Rt. 60

282.71 281.71 282.35 282.62 282.86 283.13 283.28 283.49 283.83
5.58 6.58 5.94 5.67 5.43 5.16 5.01 4.80 4.46
105 105 75 50 30
Curbs
Top

282.49 283.47 282.72 282.79 283.06 283.18 283.44 283.74
5.90 4.82 5.57 5.50 5.22 5.11 4.85 4.55
67 288 288 200ft. 20. FH/HC + 66'6" 199.5 W/100? on 45

282.89 282.73 283.48 282.74 283.01 283.07 283.6 283.6 284.1
5.40 5.56 4.81 5.55 5.28 5.22 4.7 4.7 4.2
61 50 285 285. RC. 20. FH/HC

282.19 282.34 282.39 282.61 283.05 282.80 283.0 284.1 285.00
6.10 5.95 5.90 5.68 5.24 5.49 5.0 4.1 3.30
81.5 66 48 20 25 39 150 50
200ft. 20. FH/HC 50' Round

282.5 282.54 282.92 282.59 282.9 282.3 282.1
4.7 4.9 4.81 4.4 5.8 4.4 4.6
10. FH/HC 20. FH/HC 187 187 48 75
28673

TP 1071 293.88 5/12 28317

HMBP
Laurel St
Park Blvd.
28328

+66 115 Rt of L - L Fire Hyd

+63.5

282.61 282.23 282.81 282.29
5.68 6.06 5.48 6.00
1045 1045 75 75
=cb 50 50

282.05 282.62 283.11 282.71 282.75 283.24
285.36 283.43 283.31 283.51 284.01 284.2
5.74 5.67 5.18 5.58 5.54 5.05 4.93 4.86 4.98 4.78 4.38 4.1
50 50 39.5 39.5 30 15 15 30 30 39.5 39.5 30 30
50-cb 50 50 50 50 50 50 50 50 50 50 50

+33

282.51 282.09 282.39 282.61 282.79 283.20 283.36 283.59 283.97
5.78 6.20 5.90 5.68 5.60 5.09 4.93 4.70 4.33
1045 1045 75 50 30 30 30 50 79
=cb 50 50 50 50 50 50 50 50 79

54+0

282.77 282.06 282.43 282.65 282.81 283.27 283.33 283.60 283.89
5.52 6.23 5.86 5.64 5.48 5.02 4.76 4.69 4.40
1045 1045 75 50 30 30 30 50 79
=cb 50 50 50 50 50 50 50 50 79

+6572 = 1/2 El Prado to West

282.09 282.64 282.75 283.22 283.30 283.34 283.56 283.87
6.20 5.65 5.54 4.97 4.99 4.95 4.73 4.42
100 50 30 30 30 30 50 79
50 50 50 50 50 50 50 79

53+30

282.72 281.98 282.35 282.59 282.99 283.24 283.36 283.49 283.87
5.57 6.31 5.94 5.70 5.30 5.05 4.93 4.80 4.42
1045 1045 75 50 30 30 30 50 79
50 50 50 50 50 50 50 50 79

288.29

Lt.

S

Rt.

61

Lt.

L

Rt.

62

70

56+0

Sly 13.4 Paved Drive Way on Lt.

288.41 288.24 288.52 288.02 288.04 288.37 288.49 288.13 287.85 288.55 289.0 292.8 292.7

547 564 536 586 584 551 539 525 603 533 49 11 12
 64 36 36 29.5 15 15 15 29.5 29.5 37 47 75
 64.0 Ind. 64.0 Ind. 36.0 36.0 29.5 15 15 29.5 29.5 37 47 75
 64.0 Ind. 64.0 Ind. 36.0 36.0 29.5 15 15 29.5 29.5 37 47 75

+75

286.5 287.65 287.68 287.18 287.54 287.65 287.32 286.92 287.52 288.0 292.8 292.5

74 633 620 670 634 623 656 696 636 59 11 14
 65 365 29.5 29.5 15 15 15 29.5 29.5 37 48 75
 365 29.5 29.5 15 15 15 29.5 29.5 37 48 75

+50

286.1 286.52 286.61 286.04 286.48 286.56 286.17 285.84 286.40 286.7 292.4 291.9

78 736 727 784 740 732 771 804 748 70 15 40
 82 365 29.5 29.5 15 15 15 29.5 29.5 37 50 75
 365 29.5 29.5 15 15 15 29.5 29.5 37 50 75

55+0

284.2 284.3 284.40 284.48 283.95 284.18 284.32 284.05 283.61 284.27 284.8 291.7 292.6

97 96 948 940 922 920 956 982 1027 961 91 42 22
 62 49 365 29.5 29.5 15 15 15 29.5 29.5 37 32 75
 365 29.5 29.5 15 15 15 29.5 29.5 37 32 75

54+73

= Cont. F.S. RT + Lt

283.4 283.50 283.54 283.03 283.36 283.46 283.49 283.23 283.88 284.4 287.0 288.6

105 1038 1034 1085 1050 1042 1039 1065 1000 95 69 53
 62 365 29.5 29.5 15 15 15 29.5 29.5 41 48 75
 365 29.5 29.5 15 15 15 29.5 29.5 41 48 75

292.88

293.88

Park Blvd "L" Line

Lt

Rt

Rt

68

+50

56 + 25

293.88

289.5	289.16	289.20	288.49	288.96	289.06	288.76	288.28	289.06	289.3	292.9	292.7
14	4.72	4.68	5.39	4.90	4.82	5.10	5.60	4.82	4.6	1.0	1.3
86	36.5	37.5	37.5	37.5	15	15	29.5	29.5	37	45	73
	WNYEC		Gut				Gut				
288.5	288.85	288.96	288.41	288.81	288.88	288.55	288.19	288.83	289.0	292.7	292.9
54	5.02	4.92	5.47	5.07	5.00	5.23	5.19	5.05	4.9	1.3	1.5
83	36.5	37.5	37.5	15		15	27.5	27.5	37	43	75
	WNYEC		Gut				Gut				

293.88

Cross Section El Prado
Park Blvd. to 350 West

Lt. North

Rt. South 64

Sketch # 2113 Page 20

+73 Start of $\frac{1}{2}$ - $\frac{1}{2}$ Light
0+53.5 =

0+50 29.5 ft of $\frac{1}{2}$ - $\frac{1}{2}$ Light

0+44.7 = East Curb Line to North

0+19.7

0-0.53 = West Curb Line to North

TP 7.70 28299 10.17 27529

BM 229 28546 283.17

275.9 275.49 275.46 275.45 274.81 275.51 274.81 275.42 275.94 275.86
7.5 7.50 7.53 7.54 8.18 7.48 8.18 7.57 7.05 7.13
50.5 42.5 16. 16. 16. 16. 16. 16. 16. 16.
15' Gro. 15' Gro. 15' Gro. 15' Gro. 15' Gro. 15' Gro. 15' Gro. 15' Gro. 15' Gro. 15' Gro.
Walk Walk Walk Walk Walk Walk Walk Walk Walk

275.44 274.91 275.27 274.58 275.24 274.71 275.22 274.86 274.98 275.37 274.79 275.23 275.85 276.14
7.55 8.08 7.72 8.41 7.75 8.08 7.77 8.13 8.01 7.62 8.70 7.76 7.14 6.85
80.5 80.5 56. 56. 43. 43. 21. 21. 21. 21. 21. 21. 21. 21.
15' Gro. 15' Gro. 15' Gro. 15' Gro. 15' Gro. 15' Gro. 15' Gro. 15' Gro. 15' Gro. 15' Gro. 15' Gro. 15' Gro. 15' Gro.
Walk Walk Walk Walk Walk Walk Walk Walk Walk Walk Walk Walk Walk Walk

275.22 274.92 274.83 274.79 274.94 274.37 274.79 275.56 275.87
7.77 8.07 8.1 8.20 8.05 8.62 8.70 7.43 7.14
25. 50. 21. 16. 20.5 16. 16. 42.5 52.5
15' Gro. 15' Gro. 15' Gro. 15' Gro. 15' Gro. 15' Gro. 15' Gro. 15' Gro. 15' Gro.
Walk Walk Walk Walk Walk Walk Walk Walk Walk

274.96 274.28 274.53 274.04 274.19 273.73 273.86 274.56 274.02 274.45 275.15 275.69
8.71 8.46 8.95 8.80 9.26 9.19 8.47 8.97 8.54 7.81 7.30
64. 47. 47. 21. 21. 21. 16. 16. 16. 16. 16. 16.
15' Gro. 15' Gro. 15' Gro. 15' Gro. 15' Gro. 15' Gro. 15' Gro. 15' Gro. 15' Gro. 15' Gro. 15' Gro. 15' Gro.
Walk Walk Walk Walk Walk Walk Walk Walk Walk Walk Walk Walk Walk

Hex BP
Laurel +
Park Blvd.
See Page
21-31

28299

El Prado

Lt.

Rt.

66

B.M.

3.83

283.17

H. J. BP
Laurel
& Park Blvd.

282.63 282.23 282.50 282.11
437 477 450 489
97.5-Cb 97.5-Gut 7.5-Cb 7.5-Gut

281.97 281.91 282.75
503 509 455
12.5 5.5-Gut 15-Cb

+ 46

282.54 282.08 282.78 282.09 282.80 282.04 282.00 282.04 282.01 282.03 282.71 281.99 282.72
446 492 422 491 420 496 500 496 499 497 429 501 438
57.5-Cb 57.5-Gut 57.5-Cb 57.5-Gut 21-Cb 21-Gut 7/6 21-Gut 21-Gut 21-Gut 37.5-Gut 37.5-Cb

+ 43

290° Rt of Z = Z Li 947
290° Lt of Z = Z Li 951

282.29 282.73
471 427
52.5-7/6 Walk 52.5-Cb

+ 41

= Curb B.C. Rt + Lt

282.6

44
75

282.53 282.43 282.47 282.79 282.77 282.25 281.90 282.03 281.88 282.36 282.70 282.49 282.25
447 457 453 421 423 465 510 497 512 464 470 451 425
52.5-Cb 52.5-7/6 Walk 42.5-Cb 42.5-Gut 16-Cb 16-Gut 16-Cb 16-Gut 16-Cb 16-Gut 16-Cb 16-Gut 16-Cb 16-Gut 16-Cb 16-Gut

287.0°

TP

4.21

287.00

0.20

282.79

+ 25

282.8 281.01 282.10 281.88 281.46 281.65 281.42 281.91 282.05 281.99
0.9 0.98 0.89 1.11 1.53 1.14 1.57 1.08 0.91 1.00
52.5-7/6 Walk 42.5-7/6 Walk 16-Cb 16-Gut 16-Cb 16-Gut 16-Cb 16-Gut 16-Cb 16-Gut 16-Cb 16-Gut 16-Cb 16-Gut 16-Cb 16-Gut

2+01

21° Rt of Z = Z Li 967
282.99

282.99

Proposed Channel Change
 Hobart Boulevard Left Lane
 At Hobart Ave.

+03.34 EC	19° 06'	
8+0	18° 57.24'	
+50	16° 45.02'	$\Delta 58^{\circ} 12'$
7+0	14° 32.80'	R 650'
+50	12° 20.58'	T 225.02'
6+0 P.O.C.	10° 08.36'	L 433.36'
+50	7° 56.14'	D ₁ 2.6444
5+0	5° 43.92'	
+50	3° 31.70'	
4+0	1° 19.38'	
3+69.98 B.C. RT.		

0+0 = Opp 185+16.92 B.C. Lt Lane

June 8-51
 H. Sisson
 Bertolucci
 Fritz

INDEXED
 JUN 21 1951

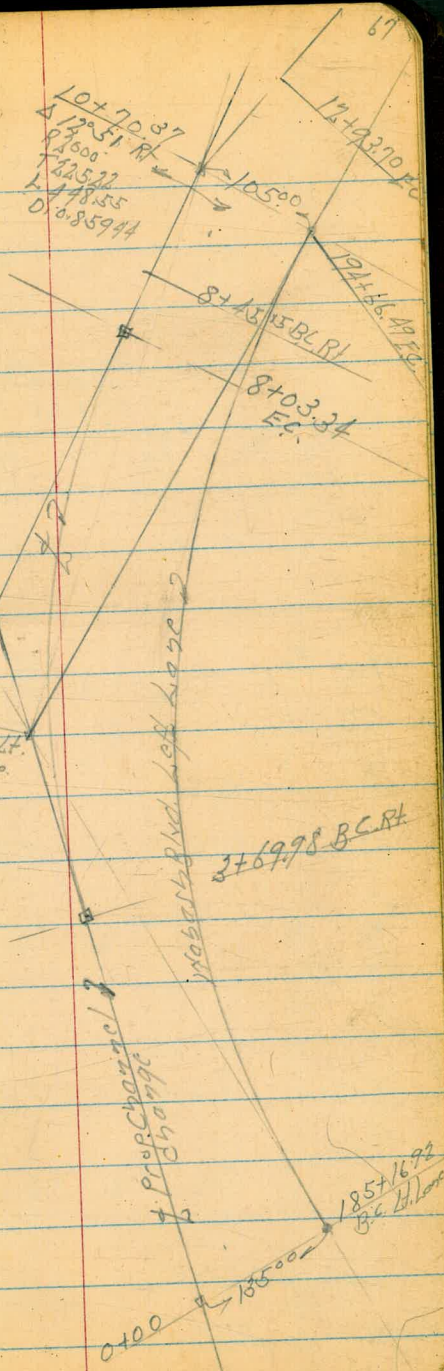

Cross Section Proposed Channel Change
 Habers Blvd Left Lane Flycatcher Pk.

Lt. West Z Rt. East 88

June/51
 P. Simon
 Roger
 Bertolucci
 Fritz

REDUCED
 MEEHAN
 6/14/51

2+0

196.1
 $\frac{0.15}{25}$
 194.2
 $\frac{0.20}{11}$
 189.5
 $\frac{7.7}{8=2\frac{1}{2} \text{ ft Bottom}$
 190.2
 $\frac{7.0}{7}$
 189.2
 $\frac{8.0}{18}$
 191.7
 $\frac{5.5}{26=Top$
 $\frac{5.0}{5.0=Top$

+50

195.3
 $\frac{1.0}{25}$
 191.6
 $\frac{5.6}{7}$
 191.1
 $\frac{9.5}{11=2\frac{1}{2} \text{ ft Bottom}$
 187.7
 $\frac{9.5}{20}$
 188.0
 $\frac{7.7}{30=Top Slope}$
 189.5

1+0

191.2
 $\frac{6.0}{25}$
 190.0
 $\frac{7.3}{25}$
 189.5
 $\frac{7.7}{25}$
 187.4
 $\frac{9.8}{27=2\frac{1}{2} \text{ ft Bottom}$
 186.9
 $\frac{10.0}{36}$
 188.0
 $\frac{9.2}{43=Top$
 $\frac{5.0}{5.0=Top$

TP

8.95 197.22 166 188.27 $\frac{0.450}{0.75 \text{ ft}$

197.22

+50

189.2
 $\frac{0.7}{25}$
 188.2
 $\frac{1.7}{9}$
 188.5
 $\frac{1.4}{9}$
 186.3
 $\frac{3.6}{13=2\frac{1}{2} \text{ ft Bottom}$
 186.0
 $\frac{3.9}{26}$
 186.4
 $\frac{3.5}{33=Top Slope}$

+17

19.5 Rt of Z = Z Power Pole c 3006

0+0: Opp. 185+16.92 Habers Blvd W. Lane

187.4
 $\frac{2.5}{25}$
 186.3
 $\frac{2.6}{5}$
 184.5
 $\frac{5.4}{4=2\frac{1}{2} \text{ ft Bottom}$
 184.6
 $\frac{5.3}{12}$
 185.7
 $\frac{4.2}{12}$
 186.7
 $\frac{3.7}{15=Top Slope}$
 189.93

BM

994 189.93 179.99 $\frac{120 \text{ ft } 181+50}{120 \text{ ft } 181+50}$

120 ft 181+50

4+0

+69.98 B.C. RT.

TP

11.82

205.12

392

193.30 ^{27.2} ^{HUB} 2+6998

+50

3+0

2+50

197.22

4+

2

RT.

69

199.4

5.7
25

198.1

7.0
11

194.9

10.2
3

194.2

10.9
3

192.5

12.8
5 = WY Bot
Mar 3

193.0

12.1
15

193.3

11.8
20 = Top Top

197.9

7.2
25

197.3

7.8
14

193.8

11.2
16

192.3

12.8
6

191.1

14.0
8 = WY Bot
Mar 3

191.6

13.5
15

192.5

12.6
18 = Top Top

205.12

197.2

9.0
25

195.2

9.0
9

192.5

4.7
16

191.2

6.0
5 = WY Bot
Mar 3

190.9

6.0
11

192.8

5.0
19 = Top Top

195.0

2.5
25

190.9

4.3
3 = WY Bot
Mar 3

190.5

6.7
9

192.4

4.8
18 = Top Top

196.3

2.0
25

192.8

4.4
8

192.2

5.0
16

189.4

7.8
11 = WY Bottom
Mar 3

189.2

8.0
14

190.6

4.1
20 = Top Top

197.22

41 2 PL

+50

200.1 198.4 196.8 196.0 198.1
67 87 100 108 87
25 12 21 21
206.78 150.00

TP

8.81 206.78 715 197.97

2021 100.1 198.3 195.6 195.9 196.8 198.1
80 70 68 95 93 80 64
25 6 9 21 33 45
150.00

6+0

+81

5.81/2: old well 119

Top of shelf

2023 198.7 197.4 196.0 195.2 194.4 196.0
28 6.4 77 91 99 107 91
25 12 11 21 33 41
150.00

+50

BM

4.73 200.8
L+Disc
M.H. Self
Victorian
20040

2024 197.0 196.3 196.3 193.4 194.4 195.9
27 81 88 88 117 107 99
25 6 2 2 15 17 28
150.00

5+0

4+50

2022 201.0 196.5 192.7 193.1 194.9
29 11 81 124 120 107
25 16 12 15 25
150.00

205/2

205/2

Proposed Channel Change
 Xhabark Blvd + Xhabark Fl.

+50

8+03.34 = EC

TP 964 213.80 262 204.16

+50

7+15

6+90

20678

Lt

2

Rt

71

205.2

8.6
25

204.8

9.0

203.9

9.9
16

205.0

8.8
19.70%
Slope

202.4

11.4
25

203.4

10.4

204.1

9.7
17

204.3

9.5

28.70%
Toc Slope

213.80

201.1

5.7
26

200.5

6.3

205.1

3.6

29.70%
Toc Slope

199.8

7.0
21

196.9

9.9

33.1%
Bot. Slope

196.6

10.2

23.70%
Toc Slope

201.1

5.7

200.8

6.8

18.80%
Toc Slope

200.2

6.6
50

199.2

7.6
25

198.7

8.1
16

196.5

10.3

196.1

10.7

196.2

10.6
5

199.0

7.8
16

199.8

7.8
25

29.90%
Toc Slope

206.78

6.7%
Toc Slope

+70.37
Δ 13° 50' Rt.

Taken on Sph of 4

+50

TP

931

218.79

432

209.48

0.7% Ho 6
10+70.137

10+0

+50

9+0

213.80

H

Z

Rt.

72

211.8

70
45

209.5

73

210.0

5.8

208.1

18.7

207.9

19.9

210.0

8.8

32 = Tot Slope

211.3

7.5
25

208.9

9.9

208.1

10.7

208.1

10.7

209.2

9.6

28 = Tot Slope

218.79

208.2

5.6
27

208.2

5.6

207.4

4.4
2

207.8

6.0

22 = Tot Slope

207.0

6.8
25

206.7

7.1

207.1

4.7
6

208.1

7.7

206.8

7.9

79 = Tot Slope

205.0

8.8
25

205.9

7.9

206.5

7.3
7

205.2

8.6
10

205.8

8.0

11 = Tot Slope

213.80

1788

IP 10.79 224.08 5.50 213.29

+50

12+0

+50

+19

15' H of T - Sewer 532 213.47 on Rim
Main Hole

11+0

218.79

224.08

213.0

5.8
35

213.7

5.7

213.8

5.0
12

213.1

5.7
15

213.6

5.5
27

2135
10.78
15. Invert 8"
RCP

Top of pipe
under cut

222.3

6.5
0

222.6

6.3

222.2

6.6
8

211.3

7.5
30

212.1

6.7
19

Top of pipe
under cut

212.8

6.0
39

222.0

6.8
19

210.8

8.0

210.7

8.1
38

Top of pipe

212.8

6.0
35

210.9

7.9

209.8

9.0
14

208.9

10.0
21

208.6

10.2
26

209.7

9.1
37

Top of pipe

218.79

BM

194

222.14

207MM
1st of
192775
222.11
207/32

14+0

+50

13+0

224.08

1st

2

1st

74

217.1

70
35-

216.9

72
30-

216.1

80

216.7

74
32.4

216.7

74
16=Top Slope

216.3

70
35-

215.6

82
30-

215.3

88
30-

214.5

92
30-

214.5

96

215.5

84
7

215.0

91
13

215.9

82
19=Top Slope

213.8

103
25

214.5

97
14

216.1

80
10

216.0

81
8

213.5

106

214

101
12

214.9

97
20=Top Slope

224.08

Location of painted Islands

Normal + University Aves.

Sommermeier
Beqq
R. Sisson
C. Ford

8-30-51
W.O. 29001

INDEXED

ALL

AUG 30 1951

Located off sly. ob. line Univ.
Δ tie to Ctr. Island on Normal
0+00 = 205' wly of wly. A in Univ. of
stations + offsets at 90° to B.L.
offsets to E of double lines. Painted.

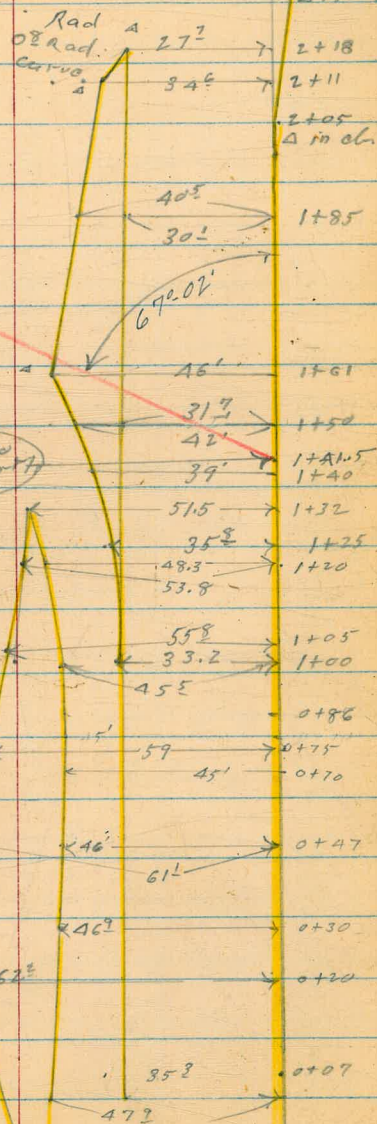
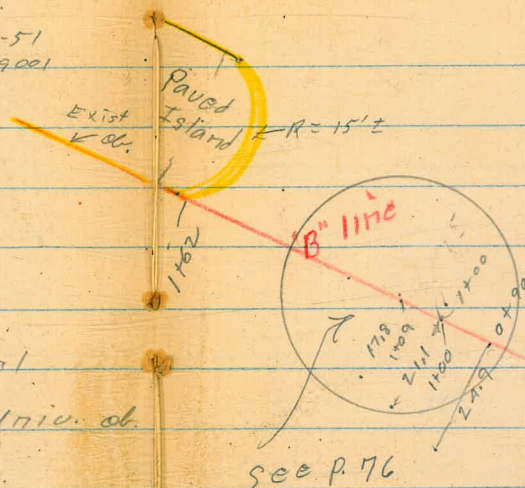

B.L.

B.L.

P.I. 8" Rad. Curve.

P.I. 6" Rad Curve

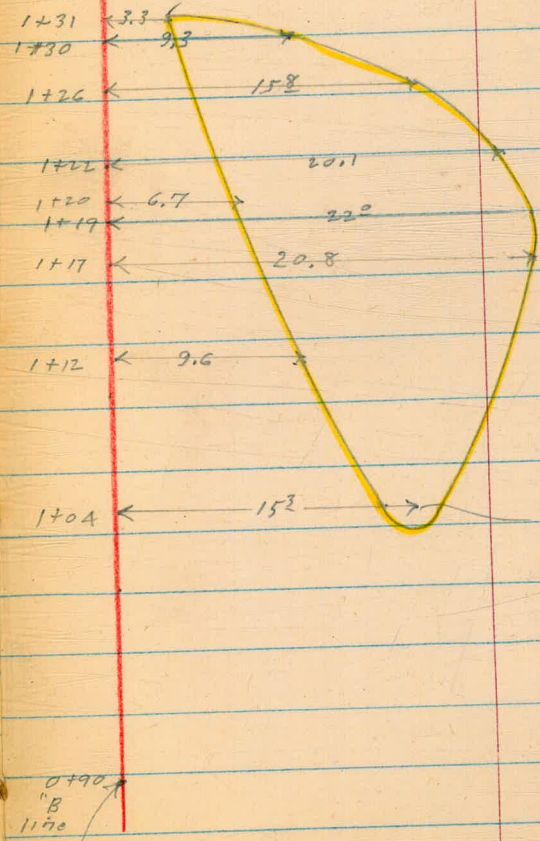
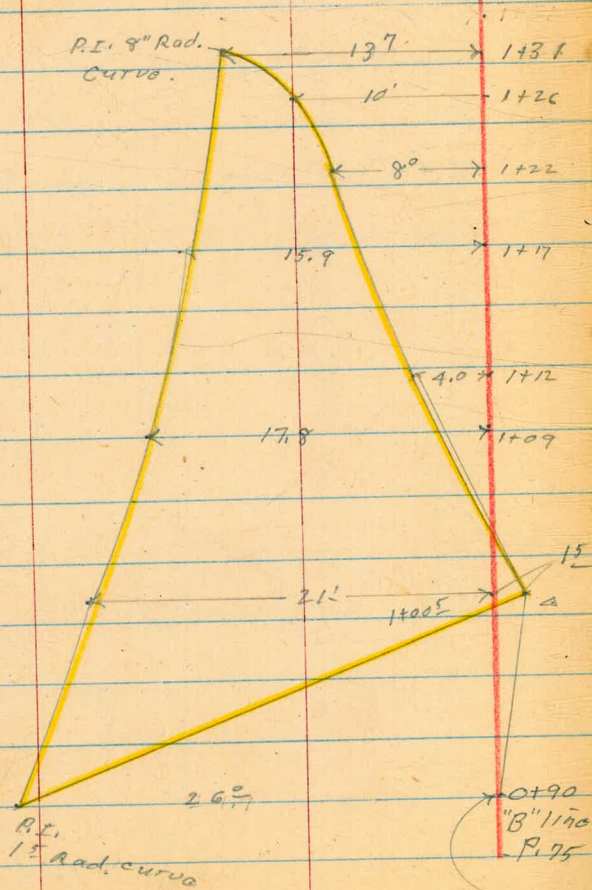

Identical points.

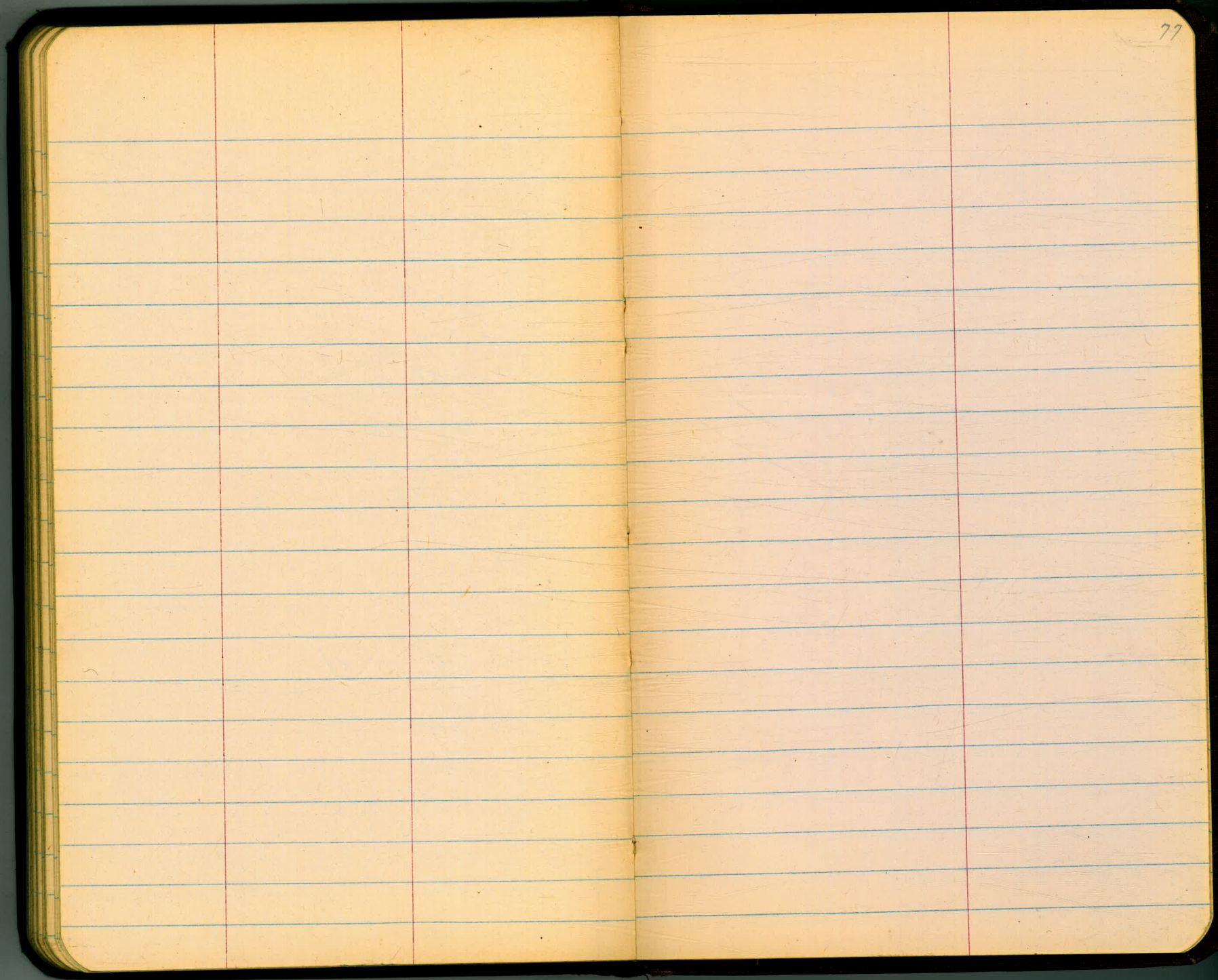

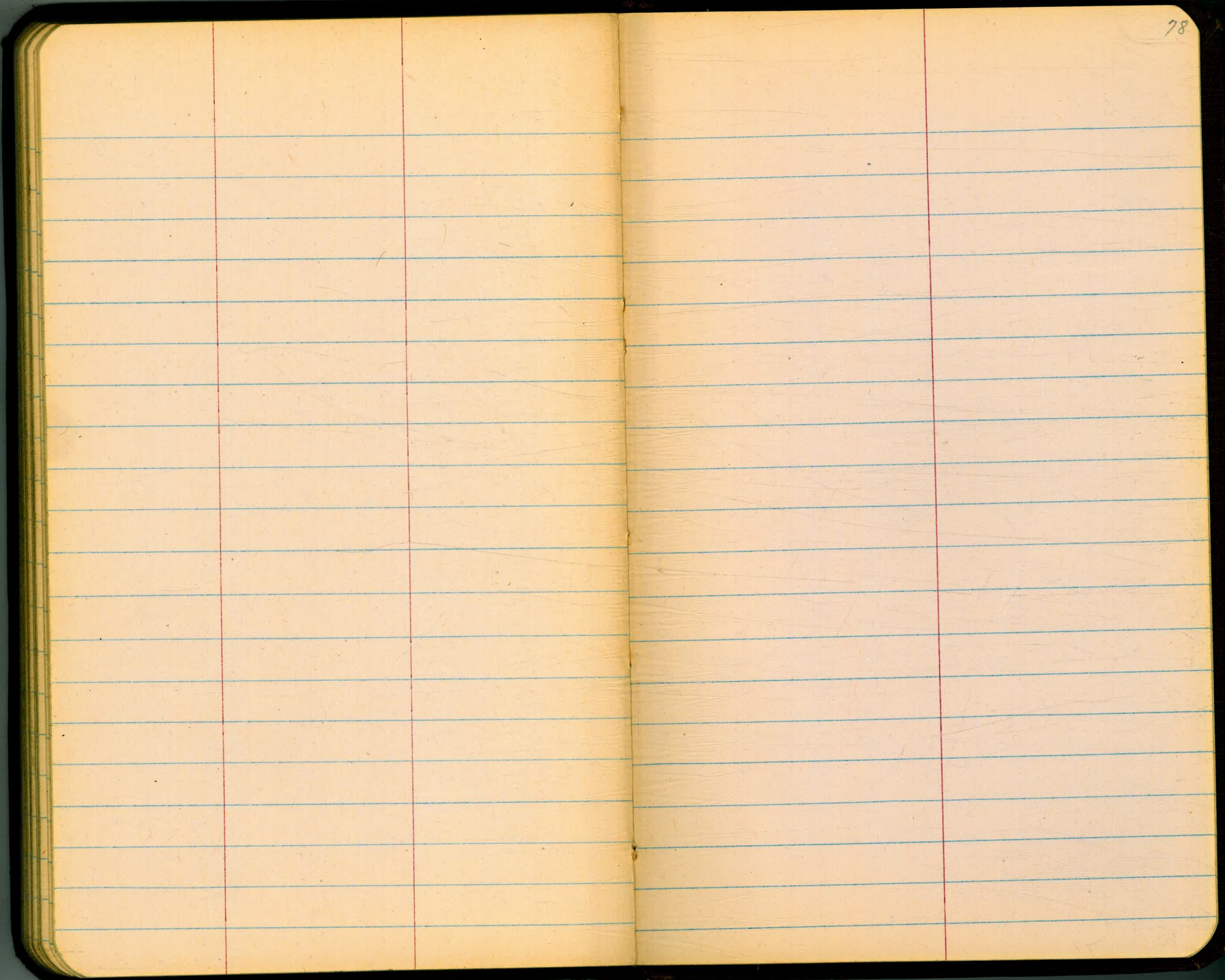

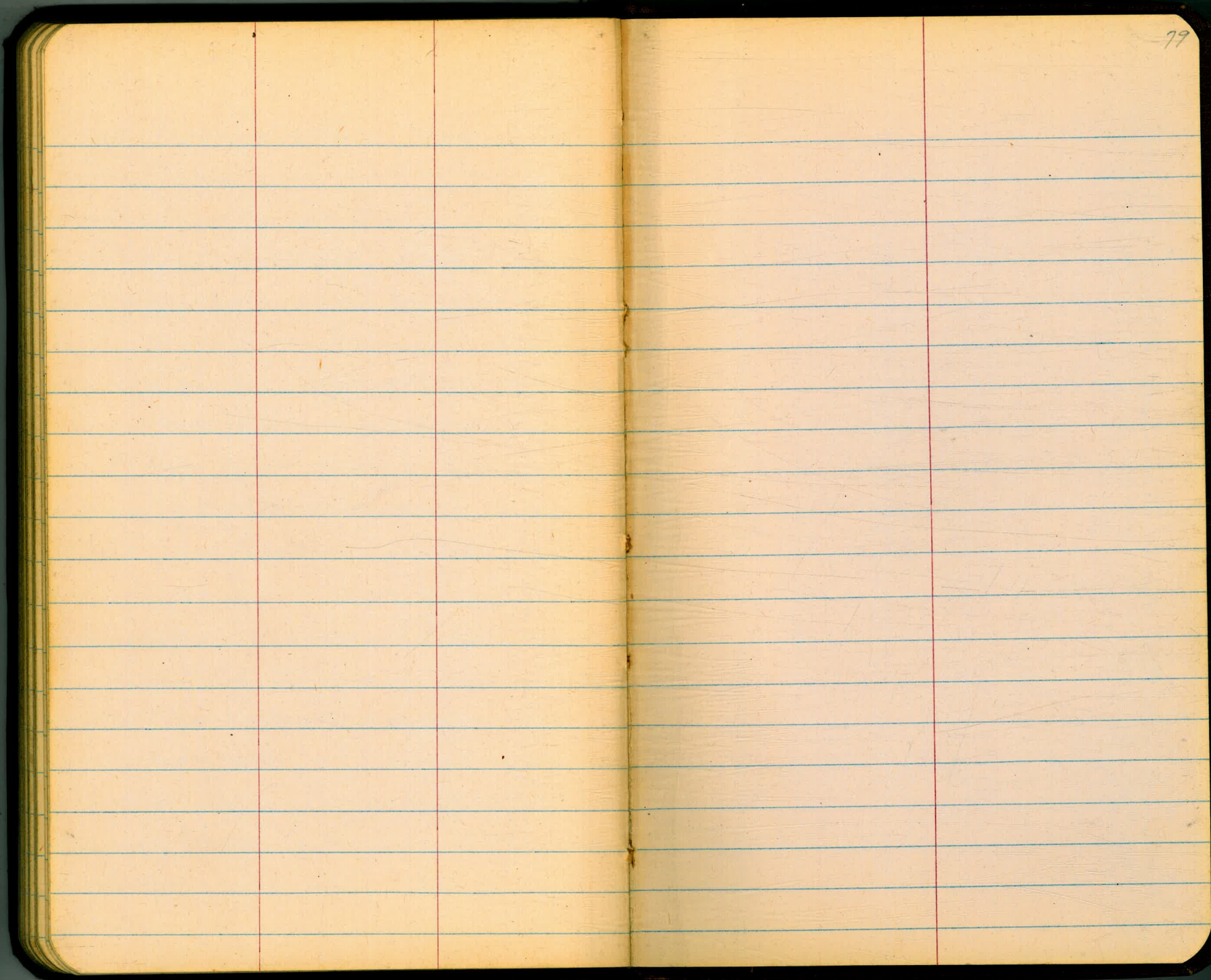

2367

1.88

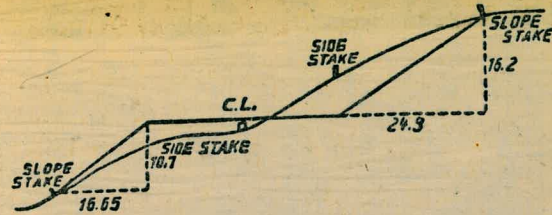

DISTANCES FROM SIDE STAKES FOR CROSS-SECTIONING.
SLOPE 1 1/2 TO 1. ROADWAY OF ANY WIDTH.

	0	.1	.2	.3	.4	.5	.6	.7	.8	.9	
0	0.00	0.15	0.30	0.45	0.60	0.75	0.90	1.05	1.20	1.35	0
1	1.50	1.65	1.80	1.95	2.10	2.25	2.40	2.55	2.70	2.85	1
2	3.00	3.15	3.30	3.45	3.60	3.75	3.90	4.05	4.20	4.35	2
3	4.50	4.65	4.80	4.95	5.10	5.25	5.40	5.55	5.70	5.85	3
4	6.00	6.15	6.30	6.45	6.60	6.75	6.90	7.05	7.20	7.35	4
5	7.50	7.65	7.80	7.95	8.10	8.25	8.40	8.55	8.70	8.85	5
6	9.00	9.15	9.30	9.45	9.60	9.75	9.90	10.05	10.20	10.35	6
7	10.50	10.65	10.80	10.95	11.10	11.25	11.40	11.55	11.70	11.85	7
8	12.00	12.15	12.30	12.45	12.60	12.75	12.90	13.05	13.20	13.35	8
9	13.50	13.65	13.80	13.95	14.10	14.25	14.40	14.55	14.70	14.85	9
10	15.00	15.15	15.30	15.45	15.60	15.75	15.90	16.05	16.20	16.35	10
11	16.50	16.65	16.80	16.95	17.10	17.25	17.40	17.55	17.70	17.85	11
12	18.00	18.15	18.30	18.45	18.60	18.75	18.90	19.05	19.20	19.35	12
13	19.50	19.65	19.80	19.95	20.10	20.25	20.40	20.55	20.70	20.85	13
14	21.00	21.15	21.30	21.45	21.60	21.75	21.90	22.05	22.20	22.35	14
15	22.50	22.65	22.80	22.95	23.10	23.25	23.40	23.55	23.70	23.85	15
16	24.00	24.15	24.30	24.45	24.60	24.75	24.90	25.05	25.20	25.35	16
17	25.50	25.65	25.80	25.95	26.10	26.25	26.40	26.55	26.70	26.85	17
18	27.00	27.15	27.30	27.45	27.60	27.75	27.90	28.05	28.20	28.35	18
19	28.50	28.65	28.80	28.95	29.10	29.25	29.40	29.55	29.70	29.85	19
20	30.00	30.15	30.30	30.45	30.60	30.75	30.90	31.05	31.20	31.35	20
21	31.50	31.65	31.80	31.95	32.10	32.25	32.40	32.55	32.70	32.85	21
22	33.00	33.15	33.30	33.45	33.60	33.75	33.90	34.05	34.20	34.35	22
23	34.50	34.65	34.80	34.95	35.10	35.25	35.40	35.55	35.70	35.85	23
24	36.00	36.15	36.30	36.45	36.60	36.75	36.90	37.05	37.20	37.35	24
25	37.50	37.65	37.80	37.95	38.10	38.25	38.40	38.55	38.70	38.85	25
26	39.00	39.15	39.30	39.45	39.60	39.75	39.90	40.05	40.20	40.35	26
27	40.50	40.65	40.80	40.95	41.10	41.25	41.40	41.55	41.70	41.85	27
28	42.00	42.15	42.30	42.45	42.60	42.75	42.90	43.05	43.20	43.35	28
29	43.50	43.65	43.80	43.95	44.10	44.25	44.40	44.55	44.70	44.85	29
30	45.00	45.15	45.30	45.45	45.60	45.75	45.90	46.05	46.20	46.35	30
31	46.50	46.65	46.80	46.95	47.10	47.25	47.40	47.55	47.70	47.85	31
32	48.00	48.15	48.30	48.45	48.60	48.75	48.90	49.05	49.20	49.35	32
33	49.50	49.65	49.80	49.95	50.10	50.25	50.40	50.55	50.70	50.85	33
34	51.00	51.15	51.30	51.45	51.60	51.75	51.90	52.05	52.20	52.35	34
35	52.50	52.65	52.80	52.95	53.10	53.25	53.40	53.55	53.70	53.85	35
36	54.00	54.15	54.30	54.45	54.60	54.75	54.90	55.05	55.20	55.35	36
37	55.50	55.65	55.80	55.95	56.10	56.25	56.40	56.55	56.70	56.85	37
38	57.00	57.15	57.30	57.45	57.60	57.75	57.90	58.05	58.20	58.35	38
39	58.50	58.65	58.80	58.95	59.10	59.25	59.40	59.55	59.70	59.85	39
40	60.00	60.15	60.30	60.45	60.60	60.75	60.90	61.05	61.20	61.35	40
41	61.50	61.65	61.80	61.95	62.10	62.25	62.40	62.55	62.70	62.85	41
42	63.00	63.15	63.30	63.45	63.60	63.75	63.90	64.05	64.20	64.35	42
43	64.50	64.65	64.80	64.95	65.10	65.25	65.40	65.55	65.70	65.85	43
44	66.00	66.15	66.30	66.45	66.60	66.75	66.90	67.05	67.20	67.35	44
45	67.50	67.65	67.80	67.95	68.10	68.25	68.40	68.55	68.70	68.85	45
46	69.00	69.15	69.30	69.45	69.60	69.75	69.90	70.05	70.20	70.35	46
47	70.50	70.65	70.80	70.95	71.10	71.25	71.40	71.55	71.70	71.85	47
48	72.00	72.15	72.30	72.45	72.60	72.75	72.90	73.05	73.20	73.35	48
49	73.50	73.65	73.80	73.95	74.10	74.25	74.40	74.55	74.70	74.85	49
50	75.00	75.15	75.30	75.45	75.60	75.75	75.90	76.05	76.20	76.35	50

THE NATIONAL BLANK BOOK COMPANY
 HOLYOKE MASSACHUSETTS
 NEW YORK CHICAGO BOSTON SAN FRANCISCO