

MICROFILMED
JAN 1 1965

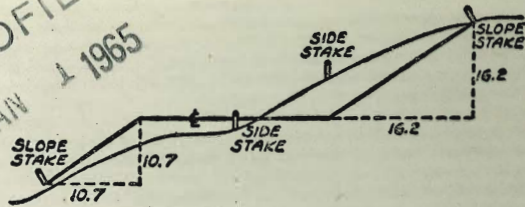

ST DR aim

DISTANCES FROM SIDE STAKES FOR CROSS-SECTIONING
SLOPE 1 TO 1. ROADWAY OF ANY WIDTH

	0	.1	.2	.3	.4	.5	.6	.7	.8	.9	
0	0.00	0.10	0.20	0.30	0.40	0.50	0.60	0.70	0.80	0.90	0
1	1.00	1.10	1.20	1.30	1.40	1.50	1.60	1.70	1.80	1.90	1
2	2.00	2.10	2.20	2.30	2.40	2.50	2.60	2.70	2.80	2.90	2
3	3.00	3.10	3.20	3.30	3.40	3.50	3.60	3.70	3.80	3.90	3
4	4.00	4.10	4.20	4.30	4.40	4.50	4.60	4.70	4.80	4.90	4
5	5.00	5.10	5.20	5.30	5.40	5.50	5.60	5.70	5.80	5.90	5
6	6.00	6.10	6.20	6.30	6.40	6.50	6.60	6.70	6.80	6.90	6
7	7.00	7.10	7.20	7.30	7.40	7.50	7.60	7.70	7.80	7.90	7
8	8.00	8.10	8.20	8.30	8.40	8.50	8.60	8.70	8.80	8.90	8
9	9.00	9.10	9.20	9.30	9.40	9.50	9.60	9.70	9.80	9.90	9
10	10.00	10.10	10.20	10.30	10.40	10.50	10.60	10.70	10.80	10.90	10
11	11.00	11.10	11.20	11.30	11.40	11.50	11.60	11.70	11.80	11.90	11
12	12.00	12.10	12.20	12.30	12.40	12.50	12.60	12.70	12.80	12.90	12
13	13.00	13.10	13.20	13.30	13.40	13.50	13.60	13.70	13.80	13.90	13
14	14.00	14.10	14.20	14.30	14.40	14.50	14.60	14.70	14.80	14.90	14
15	15.00	15.10	15.20	15.30	15.40	15.50	15.60	15.70	15.80	15.90	15
16	16.00	16.10	16.20	16.30	16.40	16.50	16.60	16.70	16.80	16.90	16
17	17.00	17.10	17.20	17.30	17.40	17.50	17.60	17.70	17.80	17.90	17
18	18.00	18.10	18.20	18.30	18.40	18.50	18.60	18.70	18.80	18.90	18
19	19.00	19.10	19.20	19.30	19.40	19.50	19.60	19.70	19.80	19.90	19
20	20.00	20.10	20.20	20.30	20.40	20.50	20.60	20.70	20.80	20.90	20
21	21.00	21.10	21.20	21.30	21.40	21.50	21.60	21.70	21.80	21.90	21
22	22.00	22.10	22.20	22.30	22.40	22.50	22.60	22.70	22.80	22.90	22
23	23.00	23.10	23.20	23.30	23.40	23.50	23.60	23.70	23.80	23.90	23
24	24.00	24.10	24.20	24.30	24.40	24.50	24.60	24.70	24.80	24.90	24
25	25.00	25.10	25.20	25.30	25.40	25.50	25.60	25.70	25.80	25.90	25
26	26.00	26.10	26.20	26.30	26.40	26.50	26.60	26.70	26.80	26.90	26
27	27.00	27.10	27.20	27.30	27.40	27.50	27.60	27.70	27.80	27.90	27
28	28.00	28.10	28.20	28.30	28.40	28.50	28.60	28.70	28.80	28.90	28
29	29.00	29.10	29.20	29.30	29.40	29.50	29.60	29.70	29.80	29.90	29
30	30.00	30.10	30.20	30.30	30.40	30.50	30.60	30.70	30.80	30.90	30
31	31.00	31.10	31.20	31.30	31.40	31.50	31.60	31.70	31.80	31.90	31
32	32.00	32.10	32.20	32.30	32.40	32.50	32.60	32.70	32.80	32.90	32
33	33.00	33.10	33.20	33.30	33.40	33.50	33.60	33.70	33.80	33.90	33
34	34.00	34.10	34.20	34.30	34.40	34.50	34.60	34.70	34.80	34.90	34
35	35.00	35.10	35.20	35.30	35.40	35.50	35.60	35.70	35.80	35.90	35
36	36.00	36.10	36.20	36.30	36.40	36.50	36.60	36.70	36.80	36.90	36
37	37.00	37.10	37.20	37.30	37.40	37.50	37.60	37.70	37.80	37.90	37
38	38.00	38.10	38.20	38.30	38.40	38.50	38.60	38.70	38.80	38.90	38
39	39.00	39.10	39.20	39.30	39.40	39.50	39.60	39.70	39.80	39.90	39
40	40.00	40.10	40.20	40.30	40.40	40.50	40.60	40.70	40.80	40.90	40
41	41.00	41.10	41.20	41.30	41.40	41.50	41.60	41.70	41.80	41.90	41
42	42.00	42.10	42.20	42.30	42.40	42.50	42.60	42.70	42.80	42.90	42
43	43.00	43.10	43.20	43.30	43.40	43.50	43.60	43.70	43.80	43.90	43
44	44.00	44.10	44.20	44.30	44.40	44.50	44.60	44.70	44.80	44.90	44
45	45.00	45.10	45.20	45.30	45.40	45.50	45.60	45.70	45.80	45.90	45
46	46.00	46.10	46.20	46.30	46.40	46.50	46.60	46.70	46.80	46.90	46
47	47.00	47.10	47.20	47.30	47.40	47.50	47.60	47.70	47.80	47.90	47
48	48.00	48.10	48.20	48.30	48.40	48.50	48.60	48.70	48.80	48.90	48
49	49.00	49.10	49.20	49.30	49.40	49.50	49.60	49.70	49.80	49.90	49
50	50.00	50.10	50.20	50.30	50.40	50.50	50.60	50.70	50.80	50.90	50

Distance of slope stake from side or shoulder stake for any width roadway, slope 1 to 1. If ground is nearly level, the cut or fill at side stake is located by the double entry method in left column and top row. The number in body of table in same row and column gives distance from side stake to slope stake. If ground is not level estimate the difference in elevation between the side stake and slope stake, lower target by this amount if cut, elevate if fill. Add this amount to cut or fill and find distance in table. Set up rod at this point, and line of sight should cut target. If it does not make the slight adjustment necessary.

INDEX

- 1-5 Tecolote Creek High Water.
- 6-7219 Prop. Bay Park Village Storm Drain
Outlet - High Water
- 8 Balboa Ave at Moreno
- 9-10 Rose canyon creek
- 19 Levels Headwall 101- for Bay Pk Storm Drain
- 20 X-SECT. IMP. - 63rd to 65th
- 25 Curb outlet at Catalina + Bernice Dr
- 27 X-SECT - POP. KELLOGG PARK (BLK 28, LA JOLLA SHORES UNIT # 2
 (BLK 37, " " " " 6

Knoxville St. Bridge
over Tecolote Creek 1-18-52

Sommermeier
E. Begg
R. Sisson
W. Altman.

H.W.M. = High water mark.

Creek overflowed Nly bank and
also cut thru. Sly. bank dyke
east of bridge allowing much
water to by pass bridge to
the north + south of bridge.

B.M. = B.P. Tecolote creek culvert
& Moraga. E.L. = 10.04

upstream (S.Ely) end bridge

E.L. = 12.8
H.W.M.

down stream (N.Wly) end bridge

Northerly

E.L. 12.2
H.W.M.

Wend 5E 10E 15E End
7.7 8.0 7.6 8.0 8.1

15' below bridge (N.Wly.)

E.L. = 11³/₄
H.W.M.

Wend 5E 10E 15E
7.0 8.0 8.1 8.3 8.4

Notes on high water
Taken during rain
will be supplemented later.

INDEXED

Recd.

MAY 6 1952

Tecolote Creek 1-18-52

Culvert under Hy. 101.

Bridge " Santa Fe Ry.

Culvert " Moreno.

B.M. = B.P. Tecolote Creek culvert

at Moreno. EL. = 10.04

Culvert ran full both ends.

H.W.M. = 4.8

Top of inside box culverts

Elev = 4.1

4.1

4.1

Ely. and Pacific Hy Culvert
(Hy 101)

EL. 2.5

1.1

2.2

North box

ctr.
box

South box

Free flow opening area shown.

by rain in Orig notes. Cannot read

Elev. top of inside of boxes blurred

Elevations on mud in culvert.

(3' 10' wide boxes)

wly and culvert at Hy. 101



North

ctr.

South

Tecelote Creek

Santa Fe Ry. bridge

Channel - 15' East of R.R. bridge

Elev:	6.0	4.2	2.2	4.0	6.0
	18	10		10	16
	H.W.M.			H.W.M.	

Santa Fe bridge (Ely end) intake

Elev:	6.6	6.0
	bottom of stringers	H.W.M.

Channel Sec. ^{of bridge} under east end

7.2	6.0	4.5	4.3	3.7	2.1	2.6	4.3	5.0	6.0	7.3
27	H.W.M.	26	14	8	4	8	16	26	H.W.M.	29
		B						B		

B = face E. + W. bulkhead

Santa Fe bridge ^(down stream) wly side

Elev:	6.6	5.9
	Bottom of stringers	H.W.M.

Tecelote Creek

5

Moreno Blvd. Culvert

+ south,
overflowed pave. to north
stopped by debris water
Intake (Ely. end)

EL. = 9.1
H.W.M.
75' North of
culvert
on building

9.0
Top of inside
of box.

Outlet (Wly end)

EL. = 7.8
H.W.M.

8.8
Top of inside
of box.

Prop. Bay Park Village storm Drain
High water at outlet. 1-18-52

INDEXED
FILED
MAY 6 1952

10' wide box culvert under Hy. 101
500 or 600' south of Jellott, St.

B.M. = top of culvert 10.00

Assumed El. ↗

For Santa Fe Ry trestle see p 7

H.W.M. Ely face of box		8.6	
Elev. top of box		8.2	
Ely end culvert on mud in box.	4.2	4.2	4.2

culvert ran full.

Elev. top of box		7.7	
Wly end culvert on mud in box.	Elev = 5.5	5.4	5.0
	5		5

North

South

1-18-52

7

Santa Fe Ry trestle

Ely. from Culvert on Page 6

B.M. = 10.00 Assumed See P-6

Sec. at Ely. end trestle.

11.0	8.7	8.7
A	B	A
B		B

Intake (Ely. end)

13.3	14.4
bottom of stringer	H.W.M.

B - denotes face of bulkhead

Sec. wly end trestle

10.7	10.6	8.0	8.0
A	B	A	A
B			B

outlet (wly end)

EL = 13.6	12.9
Bottom of stringers	H.W.M.

1-18-52
Balboa Ave at Morena Blvd.

Ely + Wly. Creek.

B.M. = top of Ry. Iron marked } 162 ft.
Sta 1+89
See Morena cross sec. for Elev. of this

Elev. = 10.00 Assumed

These are Elev. Hot rods

85' East of toe underpass abutment.

6.8	7.7	6.6	4.6	4.5	4.8	6.3	7.7	9.8
13	8	4	2		2	4	9	12
	H.W.M.						H.W.M.	

120'± East of toe of underpass Abt.

9.8	9.0	8.6	7.2	6.7	7.1	9.1	10.1	10.2
10	7	5	2±		2±	5	6	10
	H.W.M.					H.W.M.		

INDEXED

2000
MAY 6 1952

8
Elev. of this is 53.99 FB 1851 See P. 11
5±

(This will raise shown elev. 43.99')

Rose Canyon creek 1-18-52
at Balboa St. Bridge

B.M. = B.P. SE end bridge = 10.00

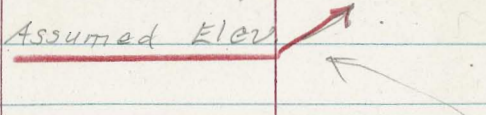
Assumed Elev 

True EL. = 13.67 - see P-11

This will raise shown elevations
3.67' above what is shown

Also see P-15-16-17

Bottom of existing sewer line ^{on bridge} hung EL. = 3.3

Both H.W.M.'s seem definite.
downstream face of bridge.

Note - this shows as lower than H.W.M. on
upstream face of bridge

H.W.M. = EL. 5.0

Downstream face of bridge

H.W.M. = EL. 5.5

15' below " " " "

H.W.M. = EL. 5.5

INDEXED
FILED
MAY 6 1952

Rose Canyon Creek
at Hy. 101

1-18-52

10

B.M. = B.P. N. Ely. end bridge EL = 10.00

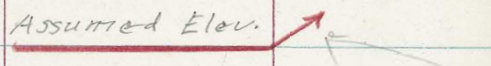
Assumed Elev. 

{ True EL = 20.92 - see P-11
this will raise shown elevations
10.92' }

Also see pages 12-13-14

May be caused by run off west of Hy. 101.

Shows lower than downstream face.

upstream face of bridge

H.W.M. 5.2 = EL.

Downstream face of bridge

H.W.M. 5.5 = EL.

Line of Levels to

Begg. Sisson Oltman	+	HI	-	Elev
TP	0.13	54.12		53.99
"	1.19	46.68	8.63	45.49
"	0.90	39.29	8.29	38.39
"	1.15	31.44	9.00	30.29
BM			1010	21.34 BM
	3.03	24.36	3.99	20.37
	5.12	25.49		
BM			4.57	20.92
BM			4.77	20.72
TP	4.57	25.49		20.92
"	3.00	23.81	4.68	20.81
BM			2.48	21.33
TP			9.64	14.17
	3.49	17.66	4.83	12.83
	5.07	17.90	4.23	13.67

Rose Canyon Bridges 101 & Balboa 11

Line of Levels to Bridge 101 Hi Way
 over Rose Canyon Creek
 Sta 1+89 16 Rt Top of RR Iron
 near RR Bridge over Balboa St.
 FB 1851 - P55 Mermax Section

See p 8

{ Set BM chis □ base of Signal Lamp }
 { NE cor. Balboa & Hi Way 101 }

set BP
 BM NE } Rose Canyon Bridge
 " BP N.W. } on 101

Check BM
 21.34 on Signal Lamp
 .01

BM P.P. SE end of Balboa St Bridge
 over Rose Canyon Creek

Rose Canyon Bridge on 101

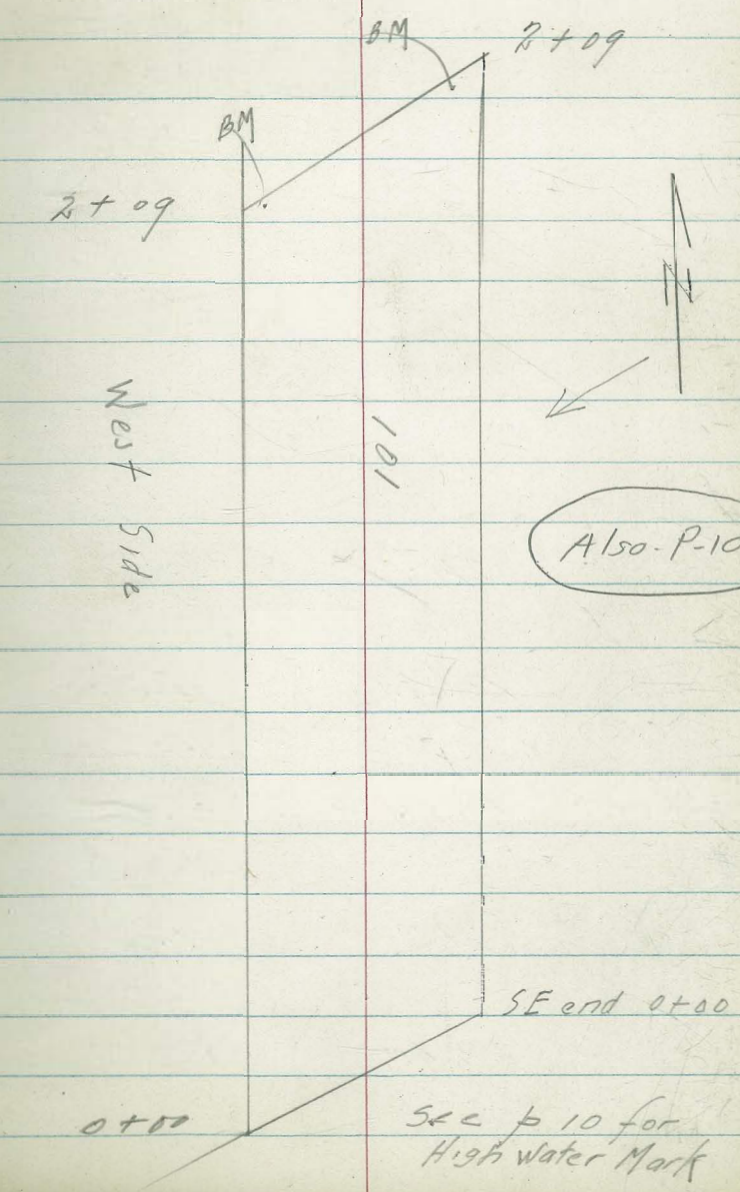

Station	Hand Rod elev by direct reading Rod	From Rod to Bottom of channel	East Side
1+20	23.95	16.0	
1+12	23.9	16.3	
1+06	23.9	17.1	
1+00	23.9	16.6	
0+80	23.8	16.1	
0+60	23.8	15.5	
0+40	23.7	17.0	
0+20	23.7	14.0	
0+00	23.8	12.0	
South End	East Side		

North End

2+09

24.2

13.9

2+00

24.1

14.3

1+80

24.1

16.4

1+60

24.0

15.2

1+40

23.95

15.3

Rose Canyon Bridge on 101

1+20	23.8	From	16.6		
1+15	23.8	Hand	16.3		
1+00	23.8	rail	16.6		
0+95	23.8	to	16.6		
0+90	23.8	Channel-	15.5		
0+80	23.8	(west	16.2	2+09	24.1
0+60	23.7	side)	16.1	2+00	24.0
0+40	23.7		16.4	1+80	23.9
0+20	23.7		15.3	1+60	23.9
0+00	23.7		12.6	1+40	23.8
South End	West Side				
					12.6 North End
					14.6
					15.9
					15.3
					15.8

Balboa St Bridge over Rose Canyon

1+20	16.7	15.4
1+10	16.7	16.1
1+00	16.7	16.3
0+90	16.7	15.4
0+80	16.7	16.2
0+70	16.7	15.6
0+60	16.7	15.7
0+40	16.8	15.1
0+20	16.8	14.0
0+00	16.9	14.8

South Side East end

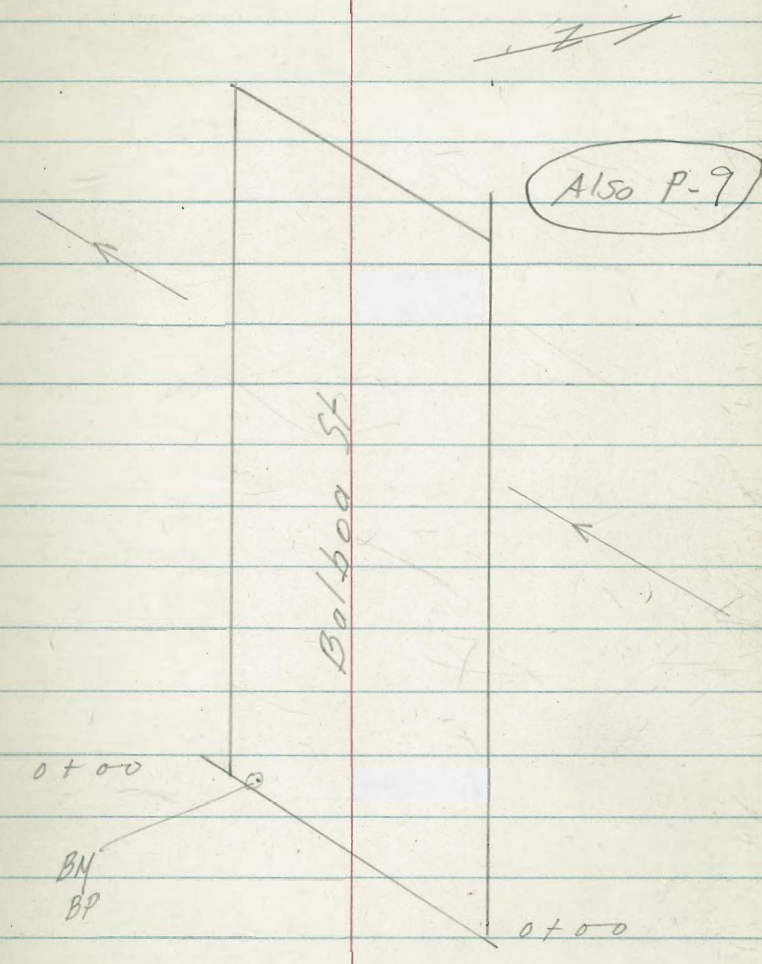

see p 9 for High Water Mark

1+30 16.7 17.0

1+10 16.7 16.6

1+00 16.7 16.5

0+90 16.7 16.0

0+80 16.7 16.2

0+70 16.7 15.8

0+60 16.8 15.3

0+40 16.8 14.0

0+20 16.8 14.5

0+00 16.9 11.8

East End N side

distance from
Rail to River
Bottom

West end South Side

1+82 16.7 13.4

1+80 16.6 13.7

1+60 16.6 13.9

1+40 16.7 15.3

Elev guard Rail

Balboa Bridge

1+82	16.7	13.0
1+80	16.6	13.1
1+60	16.7	14.4
1+40	16.7	15.6

Begg
Oltman 1. 25.52

check Levels

+	H1	-	13.67
TP 4 27	17.94	4.76	13.18
TP 5.39	18.57	2.58	15.99
BM 11.43	27.42	6.09	21.33
TP1		1.20	26.22
TP 10.90	37.12	0.98	36.14
9.19	45.33	0.71	44.62
11 22	55.84	1.84	54.00
20.59			

BM SE end Balboa Bridge See p 11

check
 $\frac{21.34}{01}$ BM chis D. see p 11 Balboa & 101

$\frac{53.99}{01}$ RR iron E of RR Bridge over
Balboa Ave.

Ellis Beeg
Wm. Oltman

125.52

19

Levels to Check Storm Drain

	+	H1	-	
				17.70
TP	1.87	19.57	6.66	12.91
TP	3.96	16.87	4.26	12.61
T.P.	4.61	17.22	3.19	14.03
TP	3.10	17.13	8.71	8.42
BM	3.95	12.37	9.67	2.70

Headwall 101 for Bay Park Storm Drain
Napier & Chicago NW BP

□ this end of existing curb 400[±] N. of Napier
on Moreno Blvd.

Nail on $\frac{1}{2}$ Headwall E side of Culvert on
101 500 or 600 S of Jelleth St

see p 6 & 7

INDEXED

Law
SEP. 30 1952

Notes: Pg. 21.

Clark
Shepherd
Johns

SECTIONS IMPERIAL

9-20-52
W.D. 21018

63rd to 65th

As Per DWG: 9920-L

DATA: DWG: 9920-L

F.B. 1546-43

" " 1269-3

DWG. NOT TO SCALE

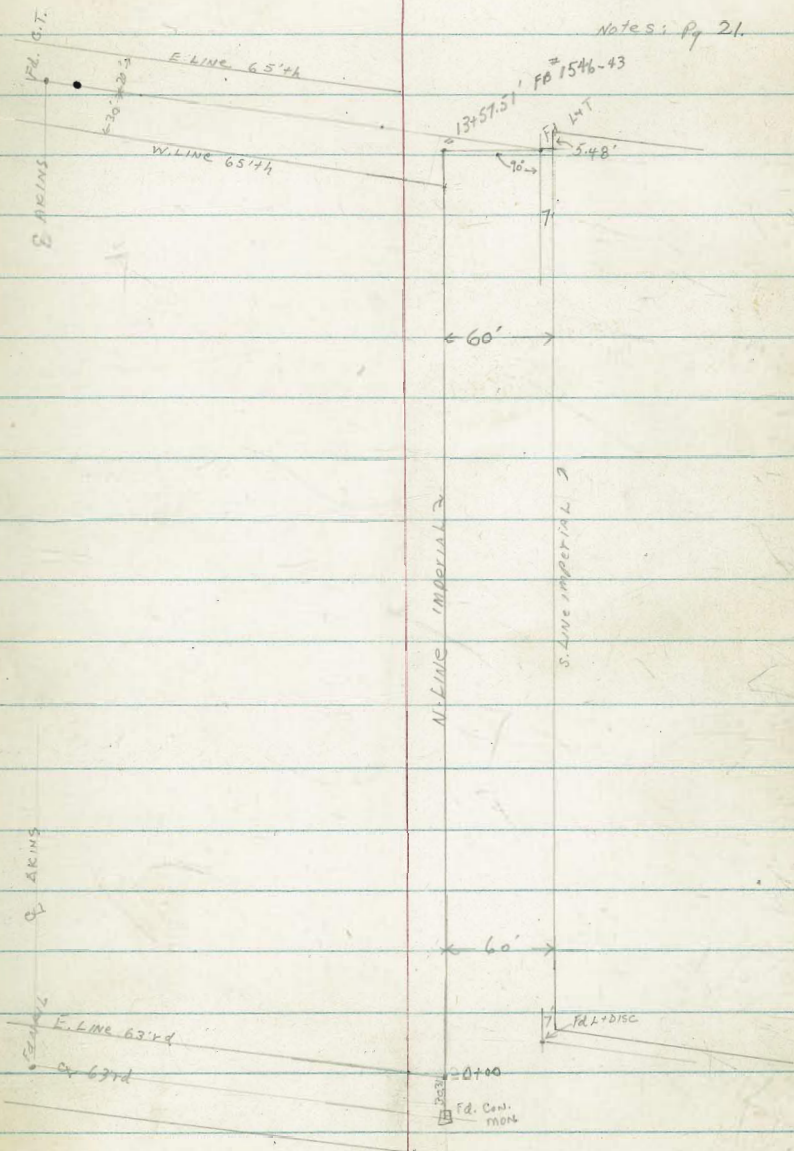

SECTIONS - IMPERIAL

63rd to 65th As per Inv. 7920-L

C = N.L. Imp.

3+65

LT.		RT.	
208.34	08.3	08.3	08.5
5.04	5.1	5.1	4.9
48	28	25	5.34
TP. RAIL	Shoulder		5

3+30

08.4	08.1	07.72
5.0	5.3	5.66
25		3

3+20

2.0' LT & Pole # 70161

207.53			
5.85	4.5	4.9	07.9
48	32	25	5.84
TP. RAIL	Shoulder		5

3+10

06.7	07.6	07.50
6.7	5.8	5.88
25		3

2+60

03.72	07.1	07.6	05.1	08.03
7.66	6.3	5.8	5.3	5.35
48	38	25		5
TP. RAIL	Shoulder			

2+10

07.5	08.7	08.31
5.9	4.7	5.07
25		5

1+60

2.0' LT & Pole # 70160

03.68	06.8	07.6	08.7	08.73
7.70	6.6	5.9	4.7	4.65
48	35	25		5
TP. South RAIL	Shoulder			on PAV

1+11

1+10

0+00 = E. Line 63rd

N. Line Imperial - 2
LINE FOR SECTIONS

Note: PAVE Edge Along N. side Imp. Vary
Irreg. Hence All shots on Pav. taken
5' SOUTH OF N. Prop. Line Imp.

B.M

0.76

213.38

212.62 Elev. S.E
F.H.V.D IMP. 463rd.

213.38

IMP. (CONT.)

LT.

E

RT.

7+78 2.5' RT E 10" Palm
 7+73.75
 7+23.75
 6+73.75
 6+65 - E Pole #171821 13' LT to Deadman
 6+23.75
 5+73.75
 5+35 1 LT E Pole #70162
 5+23.75 2' RT E 8" Palm tree
 5+23
 4+80 1 LT E Deadman
 4+73.75
 4+60.25 1 LT E #372842
 T.P. 11.41 220.82 3.97 209.41
 4+315 2' LT E Pole #372840
 4+00

12.69
 8.13
 4.8
 TP RAIL
 5.0
 2.5
 Shoulder
 15.4
 16.8
 4.0
 4.0
 5
 5
 15.1
 15.7
 215.38
 5.7
 2.5
 5.1
 5.4
 5
 11.19
 13.1
 13.5
 9.03
 4.8
 TP RAIL
 7.7
 3.0
 Shoulder
 7.3
 2.5
 6.6
 6.6
 5
 14.2
 14.06
 12.0
 13.4
 13.42
 8.8
 2.5
 7.4
 7.4
 5
 10.77
 11.2
 11.4
 10.05
 4.8
 TP RAIL
 9.6
 3.5
 Shoulder
 9.4
 2.5
 8.5
 8.7
 5
 10.5
 10.9
 10.61
 10.3
 2.5
 9.9
 10.21
 5
 09.81
 08.9
 09.6
 09.36
 11.2
 11.9
 4.8
 4.8
 RAIL
 2.5
 11.2
 11.46
 5
 08.3
 08.8
 08.38
 5.1
 2.5
 4.6
 5.00
 5
 ON RAIL

10+23 0.5' LT E Pale \pm 70 164

10+73.75

10+23.75

9+90

9+75

9+73.75

9+23.75

8+76

8+73.75

8+67

8+23.75

T.P.

7+95

2.5' RT E 12" Palm

0.5' RT E Pale \pm 174 220

0.20 RT. END APRON

0.20 RT Bag CONC. APRON
0.20 RT. END FEED Bldg

6.45 227.17 0.10 220.72

0.20 RT ^{to SLY FRONT OF Bldg} Bag Feed Store

Bldg 27.5 Deep by 72 FRONTAGE

LT.

E

RT.

14.94 16.0 18.3 19.8 20.9 20.90
12.23 11.2 8.9 7.4 6.3 6.27
4.8 3.5 2.5 2.0
TR RAIL Toe Shoulder 5

14.17 13.8 17.5 19.3 20.1 19.59
13.00 13.4 9.7 7.9 7.1 7.58
4.8 3.5 2.5 2.1
TR RAIL Toe Shoulder 5

18.0 19.4 19.02
9.2 7.8 8.15
2.5 5
Shoulder

13.45 13.45 13.5 17.2 17.3 18.64
13.72 10.0 9.9 8.53
4.8 3.4 2.7 2.5
TR RAIL Toe Shoulder 5

15.2 17.47 17.0 17.79 18.25 18.64
12.0 9.70 10.2 9.58 8.92 8.53
27.5 27.5 27.5 13
BOTT. TP. DIRT 5.9'
FATHS Filter Doorway (ex. Floor) CONC. APRON 5

17.93 17.87
7.24 9.30
5

13.84 16.01 15.2 17.16 227.17 17.21 17.21
6.98 4.01 5.6 3.66 3.61 3.61
27.5 27.5 27.5 2.7.5
BOTT. FATHS TP. FATHS Bldg. Floor Bldg. PAN AT PINT ON PAN 5

220.82

IMP. (CONT.)

LT.

RT.

RT.

Check: 441 223.60 = 223.64 = Top F. Hyd. S.E.
 65' + L + Imp.

12+23.75

12+03

11+73.75

11+61

11+23.75

11+20

T.P.

2.0 RT & 12" P.M.

2.0 RT & 12" P.M.

2.0 RT & 12" P.M.

6.94

228.01

6.10

221.07

		20.5	20.0	21.0	20.84
		7.5	8.0	7.0	7.17
		30	25		5
		Toe	Shoulder		
15.64	14.7	19.2	20.6	22.0	21.70
1237	133	9.8	7.4	6.0	6.31
48	35	32	25		5
TR	Toe	Shoulder			
RAIL					
		19.3	20.8	21.3	21.10
		8.7	7.2	6.7	6.31
		25	23		5
			Shoulder		ON RAY.

228.01

INDEXED
JER
JUN 24 1954

Survey for Curb OUT let at 1930 Catalina Blvd

Lot # 31 Catalina Villas

WO# 21259

Ref TP Sheet # 7872

6-23-54

C. Allen

D. Sisson

C. Powell

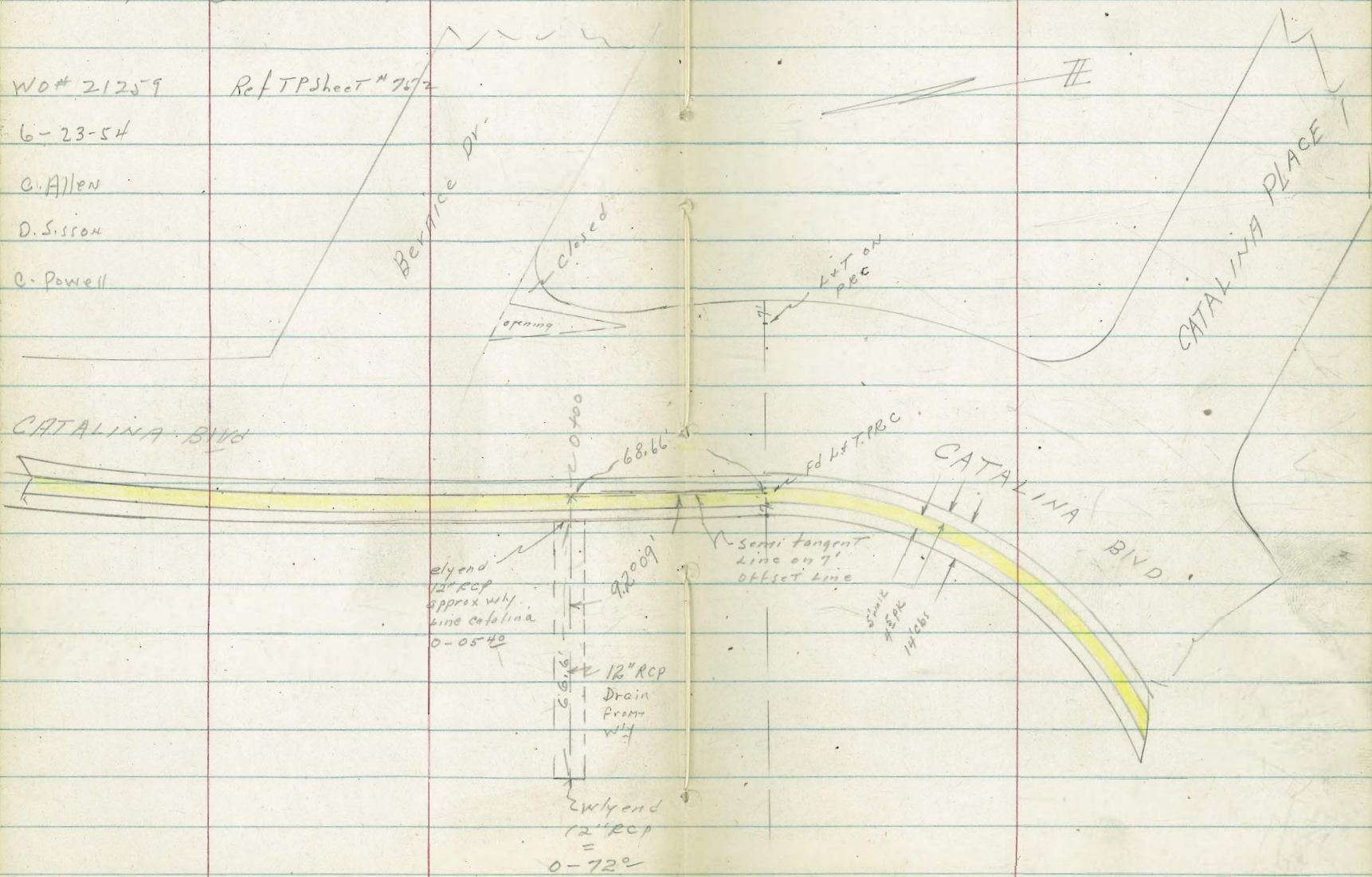

Levels for Curb out Let
 Lot 31, Catalina Villas
 Address 1930 Catalina Blvd

0+29⁶⁵ = ϕ Catalina Blvd

122⁰⁷
50

122⁹⁵

123⁸⁴
50

0+08⁶⁵ = face wly curb Catalina Blvd
 4³ LT = sty end 14' wide conc drive opening
 8⁵ RT = wly end 14' wide conc drive

123¹³

123⁷⁵

123⁸²

123²⁰

123⁹⁵

123³²

4³
(gutter)

4³
Topcb

Topcb

gutter
 ϕ

8⁶

8⁶

sty end 14' Drive

Topcb gutter
Wly end of Drive
opening

0+06⁵ = 2³ LT = ϕ 14" power pole # 1948

0+04¹⁵ = Ely edge 5' sidewalk

123⁷⁴
10

123⁸⁶

124⁰²
10

0-00 = } intersection of ϕ 12" RCP Drain + semi tangent
 of curve on 7' offset line

0-00⁸⁵ = Wly edge 5' side walk wly side Catalina

123⁷⁶
10

123⁹³

124⁰⁶
10

Wall Parallels pipe

Wall -

2² LT = Ely end 15' high Edw Conc Block
 Line Catalina Blvd

0-05⁴ = Ely end 12" RCP Drain + approx wly

124²
2⁰
ground

123⁶⁴
12" RCP

124⁶
2⁰
ground

0-72 = Wly end 12" RCP Drain

131⁸

I.E. Pipe

BM - SEBP Atascadero + Catalina - EL = 116.84

Direct elevation Rod used -

DETAILS OF SEAWALL; WALKS ETC. LAJOLLA
SHORES UNIT N^o 2

NOTE:
See Sketch Pg 27

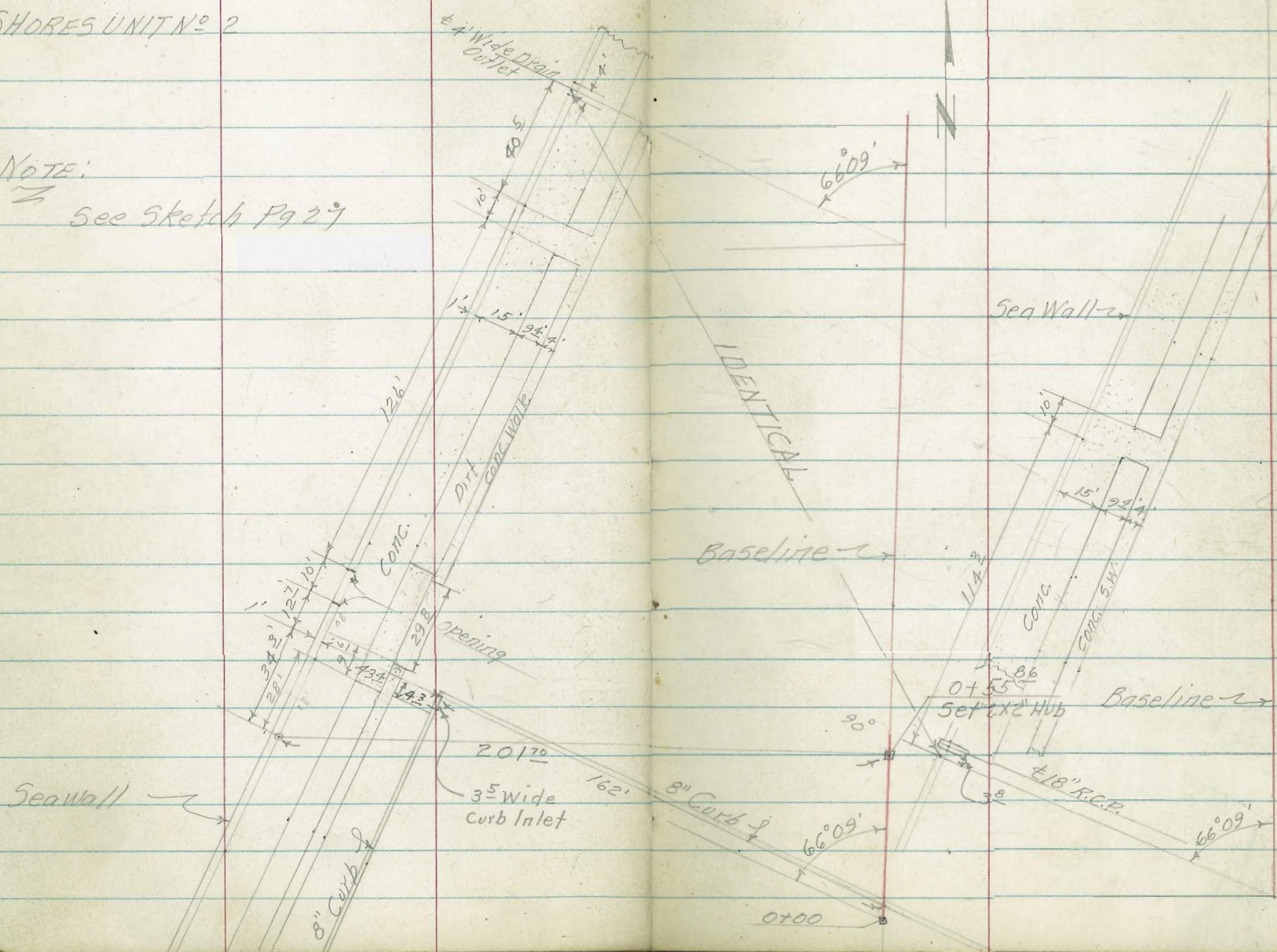

CROSS SECTIONS OF BLOCKS 28-37 OF LAJOLLA
SHORES UNIT N^o 2 KELLOGG PARK WLY OF EL
PASEO GRANDE TO SEA WALL NO. 20426

0+50 @ 90° to B.L.

0+25 @ 66°09' LH = ϕ 10' Opening in Sea wall

(see sketch)

0+03² = Sec Along Curbline Calle America

(see sketch)

0+00 = Sec. Along Wly Line Calle America

B.M.

3.02

Chis. 17 Center Ret. @ NE. Cor Camino Del Oro &
El Paseo Grande $\frac{217}{43}$

LT. RT. 29
NOTE: Transferred To
Hard Copy

T.A.S. DWG- M-432

Lt.

€

Rt.

30

4.

5

12.

(3)

The image shows an open notebook with two facing pages. Both pages are cream-colored and feature light blue horizontal ruling. A vertical red margin line is present on the left side of each page. The notebook is bound in the center, and the pages appear slightly aged with some minor discoloration and faint smudges. The page number '32' is written in the top right corner of the right-hand page.

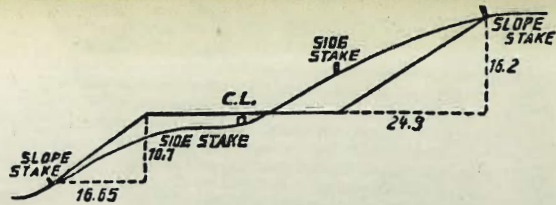

DISTANCES FROM SIDE STAKES FOR CROSS-SECTIONING.
 SLOPE 1 1/2 TO 1. ROADWAY OF ANY WIDTH.

	0	.1	.2	.3	.4	.5	.6	.7	.8	.9	
0	0.00	0.15	0.30	0.45	0.60	0.75	0.90	1.05	1.20	1.35	0
1	1.50	1.65	1.80	1.95	2.10	2.25	2.40	2.55	2.70	2.85	1
2	3.00	3.15	3.30	3.45	3.60	3.75	3.90	4.05	4.20	4.35	2
3	4.50	4.65	4.80	4.95	5.10	5.25	5.40	5.55	5.70	5.85	3
4	6.00	6.15	6.30	6.45	6.60	6.75	6.90	7.05	7.20	7.35	4
5	7.50	7.65	7.80	7.95	8.10	8.25	8.40	8.55	8.70	8.85	5
6	9.00	9.15	9.30	9.45	9.60	9.75	9.90	10.05	10.20	10.35	6
7	10.50	10.65	10.80	10.95	11.10	11.25	11.40	11.55	11.70	11.85	7
8	12.00	12.15	12.30	12.45	12.60	12.75	12.90	13.05	13.20	13.35	8
9	13.50	13.65	13.80	13.95	14.10	14.25	14.40	14.55	14.70	14.85	9
10	15.00	15.15	15.30	15.45	15.60	15.75	15.90	16.05	16.20	16.35	10
11	16.50	16.65	16.80	16.95	17.10	17.25	17.40	17.55	17.70	17.85	11
12	18.00	18.15	18.30	18.45	18.60	18.75	18.90	19.05	19.20	19.35	12
13	19.50	19.65	19.80	19.95	20.10	20.25	20.40	20.55	20.70	20.85	13
14	21.00	21.15	21.30	21.45	21.60	21.75	21.90	22.05	22.20	22.35	14
15	22.50	22.65	22.80	22.95	23.10	23.25	23.40	23.55	23.70	23.85	15
16	24.00	24.15	24.30	24.45	24.60	24.75	24.90	25.05	25.20	25.35	16
17	25.50	25.65	25.80	25.95	26.10	26.25	26.40	26.55	26.70	26.85	17
18	27.00	27.15	27.30	27.45	27.60	27.75	27.90	28.05	28.20	28.35	18
19	28.50	28.65	28.80	28.95	29.10	29.25	29.40	29.55	29.70	29.85	19
20	30.00	30.15	30.30	30.45	30.60	30.75	30.90	31.05	31.20	31.35	20
21	31.50	31.65	31.80	31.95	32.10	32.25	32.40	32.55	32.70	32.85	21
22	33.00	33.15	33.30	33.45	33.60	33.75	33.90	34.05	34.20	34.35	22
23	34.50	34.65	34.80	34.95	35.10	35.25	35.40	35.55	35.70	35.85	23
24	36.00	36.15	36.30	36.45	36.60	36.75	36.90	37.05	37.20	37.35	24
25	37.50	37.65	37.80	37.95	38.10	38.25	38.40	38.55	38.70	38.85	25
26	39.00	39.15	39.30	39.45	39.60	39.75	39.90	40.05	40.20	40.35	26
27	40.50	40.65	40.80	40.95	41.10	41.25	41.40	41.55	41.70	41.85	27
28	42.00	42.15	42.30	42.45	42.60	42.75	42.90	43.05	43.20	43.35	28
29	43.50	43.65	43.80	43.95	44.10	44.25	44.40	44.55	44.70	44.85	29
30	45.00	45.15	45.30	45.45	45.60	45.75	45.90	46.05	46.20	46.35	30
31	46.50	46.65	46.80	46.95	47.10	47.25	47.40	47.55	47.70	47.85	31
32	48.00	48.15	48.30	48.45	48.60	48.75	48.90	49.05	49.20	49.35	32
33	49.50	49.65	49.80	49.95	50.10	50.25	50.40	50.55	50.70	50.85	33
34	51.00	51.15	51.30	51.45	51.60	51.75	51.90	52.05	52.20	52.35	34
35	52.50	52.65	52.80	52.95	53.10	53.25	53.40	53.55	53.70	53.85	35
36	54.00	54.15	54.30	54.45	54.60	54.75	54.90	55.05	55.20	55.35	36
37	55.50	55.65	55.80	55.95	56.10	56.25	56.40	56.55	56.70	56.85	37
38	57.00	57.15	57.30	57.45	57.60	57.75	57.90	58.05	58.20	58.35	38
39	58.50	58.65	58.80	58.95	59.10	59.25	59.40	59.55	59.70	59.85	39
40	60.00	60.15	60.30	60.45	60.60	60.75	60.90	61.05	61.20	61.35	40
41	61.50	61.65	61.80	61.95	62.10	62.25	62.40	62.55	62.70	62.85	41
42	63.00	63.15	63.30	63.45	63.60	63.75	63.90	64.05	64.20	64.35	42
43	64.50	64.65	64.80	64.95	65.10	65.25	65.40	65.55	65.70	65.85	43
44	66.00	66.15	66.30	66.45	66.60	66.75	66.90	67.05	67.20	67.35	44
45	67.50	67.65	67.80	67.95	68.10	68.25	68.40	68.55	68.70	68.85	45
46	69.00	69.15	69.30	69.45	69.60	69.75	69.90	70.05	70.20	70.35	46
47	70.50	70.65	70.80	70.95	71.10	71.25	71.40	71.55	71.70	71.85	47
48	72.00	72.15	72.30	72.45	72.60	72.75	72.90	73.05	73.20	73.35	48
49	73.50	73.65	73.80	73.95	74.10	74.25	74.40	74.55	74.70	74.85	49
50	75.00	75.15	75.30	75.45	75.60	75.75	75.90	76.05	76.20	76.35	50

THE NATIONAL BLANK BOOK COMPANY
 HOLYOKE MASSACHUSETTS
 NEW YORK CHICAGO BOSTON SAN FRANCISCO