

2224

1911-ACT X-SECT.

TRAVEL BOOK

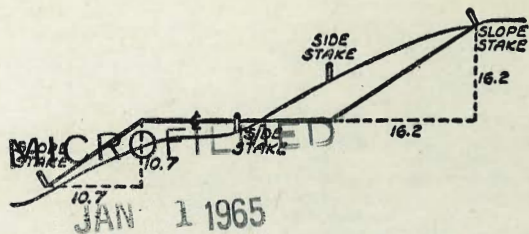

DISTANCES FROM SIDE STAKES FOR CROSS-SECTIONING
SLOPE 1 TO 1. ROADWAY OF ANY WIDTH

	0	.1	.2	.3	.4	.5	.6	.7	.8	.9	
0	0.00	0.10	0.20	0.30	0.40	0.50	0.60	0.70	0.80	0.90	0
1	1.00	1.10	1.20	1.30	1.40	1.50	1.60	1.70	1.80	1.90	1
2	2.00	2.10	2.20	2.30	2.40	2.50	2.60	2.70	2.80	2.90	2
3	3.00	3.10	3.20	3.30	3.40	3.50	3.60	3.70	3.80	3.90	3
4	4.00	4.10	4.20	4.30	4.40	4.50	4.60	4.70	4.80	4.90	4
5	5.00	5.10	5.20	5.30	5.40	5.50	5.60	5.70	5.80	5.90	5
6	6.00	6.10	6.20	6.30	6.40	6.50	6.60	6.70	6.80	6.90	6
7	7.00	7.10	7.20	7.30	7.40	7.50	7.60	7.70	7.80	7.90	7
8	8.00	8.10	8.20	8.30	8.40	8.50	8.60	8.70	8.80	8.90	8
9	9.00	9.10	9.20	9.30	9.40	9.50	9.60	9.70	9.80	9.90	9
10	10.00	10.10	10.20	10.30	10.40	10.50	10.60	10.70	10.80	10.90	10
11	11.00	11.10	11.20	11.30	11.40	11.50	11.60	11.70	11.80	11.90	11
12	12.00	12.10	12.20	12.30	12.40	12.50	12.60	12.70	12.80	12.90	12
13	13.00	13.10	13.20	13.30	13.40	13.50	13.60	13.70	13.80	13.90	13
14	14.00	14.10	14.20	14.30	14.40	14.50	14.60	14.70	14.80	14.90	14
15	15.00	15.10	15.20	15.30	15.40	15.50	15.60	15.70	15.80	15.90	15
16	16.00	16.10	16.20	16.30	16.40	16.50	16.60	16.70	16.80	16.90	16
17	17.00	17.10	17.20	17.30	17.40	17.50	17.60	17.70	17.80	17.90	17
18	18.00	18.10	18.20	18.30	18.40	18.50	18.60	18.70	18.80	18.90	18
19	19.00	19.10	19.20	19.30	19.40	19.50	19.60	19.70	19.80	19.90	19
20	20.00	20.10	20.20	20.30	20.40	20.50	20.60	20.70	20.80	20.90	20
21	21.00	21.10	21.20	21.30	21.40	21.50	21.60	21.70	21.80	21.90	21
22	22.00	22.10	22.20	22.30	22.40	22.50	22.60	22.70	22.80	22.90	22
23	23.00	23.10	23.20	23.30	23.40	23.50	23.60	23.70	23.80	23.90	23
24	24.00	24.10	24.20	24.30	24.40	24.50	24.60	24.70	24.80	24.90	24
25	25.00	25.10	25.20	25.30	25.40	25.50	25.60	25.70	25.80	25.90	25
26	26.00	26.10	26.20	26.30	26.40	26.50	26.60	26.70	26.80	26.90	26
27	27.00	27.10	27.20	27.30	27.40	27.50	27.60	27.70	27.80	27.90	27
28	28.00	28.10	28.20	28.30	28.40	28.50	28.60	28.70	28.80	28.90	28
29	29.00	29.10	29.20	29.30	29.40	29.50	29.60	29.70	29.80	29.90	29
30	30.00	30.10	30.20	30.30	30.40	30.50	30.60	30.70	30.80	30.90	30
31	31.00	31.10	31.20	31.30	31.40	31.50	31.60	31.70	31.80	31.90	31
32	32.00	32.10	32.20	32.30	32.40	32.50	32.60	32.70	32.80	32.90	32
33	33.00	33.10	33.20	33.30	33.40	33.50	33.60	33.70	33.80	33.90	33
34	34.00	34.10	34.20	34.30	34.40	34.50	34.60	34.70	34.80	34.90	34
35	35.00	35.10	35.20	35.30	35.40	35.50	35.60	35.70	35.80	35.90	35
36	36.00	36.10	36.20	36.30	36.40	36.50	36.60	36.70	36.80	36.90	36
37	37.00	37.10	37.20	37.30	37.40	37.50	37.60	37.70	37.80	37.90	37
38	38.00	38.10	38.20	38.30	38.40	38.50	38.60	38.70	38.80	38.90	38
39	39.00	39.10	39.20	39.30	39.40	39.50	39.60	39.70	39.80	39.90	39
40	40.00	40.10	40.20	40.30	40.40	40.50	40.60	40.70	40.80	40.90	40
41	41.00	41.10	41.20	41.30	41.40	41.50	41.60	41.70	41.80	41.90	41
42	42.00	42.10	42.20	42.30	42.40	42.50	42.60	42.70	42.80	42.90	42
43	43.00	43.10	43.20	43.30	43.40	43.50	43.60	43.70	43.80	43.90	43
44	44.00	44.10	44.20	44.30	44.40	44.50	44.60	44.70	44.80	44.90	44
45	45.00	45.10	45.20	45.30	45.40	45.50	45.60	45.70	45.80	45.90	45
46	46.00	46.10	46.20	46.30	46.40	46.50	46.60	46.70	46.80	46.90	46
47	47.00	47.10	47.20	47.30	47.40	47.50	47.60	47.70	47.80	47.90	47
48	48.00	48.10	48.20	48.30	48.40	48.50	48.60	48.70	48.80	48.90	48
49	49.00	49.10	49.20	49.30	49.40	49.50	49.60	49.70	49.80	49.90	49
50	50.00	50.10	50.20	50.30	50.40	50.50	50.60	50.70	50.80	50.90	50

Distance of slope stake from side or shoulder stake for any width roadway, slope 1 to 1. If ground is nearly level, the cut or fill at side stake is located by the double entry method in left column and top row. The number in body of table in same row and column gives distance from side stake to slope stake. If ground is not level estimate the difference in elevation between the side stake and slope stake, lower target by this amount if cut, elevate if fill. Add this amount to cut or fill and find distance in table. Set up rod at this point, and line of sight should cut target. If it does not make the slight adjustment necessary.

TABLE XIII—CORRECTIONS FOR TANGENTS AND EXTERNALS

These corrections are to be added to the approximate values, found by dividing the tangent, or external, for a 1° curve (Table VII) by the degree of curve, in order to obtain the true tangents, or externals. Intermediate values may be obtained by interpolation.

FOR TANGENTS ADD

Central Angle	DEGREE OF CURVE													
	5°	10°	15°	20°	25°	30°	35°	40°	45°	50°	55°	60°	65°	70°
10°	.03	.06	.09	.13	.16	.19	.22	.25	.28	.31	.34	.38	.42	.46
15°	.04	.10	.14	.19	.24	.29	.34	.39	.45	.51	.53	.58	.63	.68
20°	.06	.13	.19	.26	.32	.39	.45	.51	.58	.65	.72	.79	.84	.90
25°	.08	.16	.24	.33	.40	.49	.58	.67	.75	.83	.90	.99	1.06	1.14
30°	.10	.19	.29	.39	.49	.59	.69	.79	.89	.99	1.09	1.20	1.29	1.39
35°	.11	.22	.34	.47	.58	.69	.79	.81	.92	1.04	1.29	1.42	1.54	1.66
40°	.13	.26	.40	.53	.67	.80	.93	1.06	1.20	1.34	1.49	1.64	1.79	1.94
45°	.15	.30	.44	.60	.76	.91	1.06	1.21	1.37	1.52	1.70	1.87	2.04	2.21
50°	.17	.34	.51	.68	.85	1.02	1.19	1.36	1.54	1.72	1.91	2.10	2.29	2.48
55°	.19	.38	.57	.76	.95	1.14	1.32	1.52	1.72	1.92	2.14	2.35	2.56	2.77
60°	.21	.42	.63	.84	1.05	1.27	1.49	1.71	1.94	2.17	2.38	2.60	2.83	3.07
65°	.23	.46	.69	.93	1.16	1.40	1.64	1.88	2.13	2.38	2.63	2.88	3.13	3.39
70°	.25	.51	.76	1.02	1.28	1.54	1.80	2.06	2.33	2.60	2.88	3.16	3.44	3.72
75°	.27	.56	.83	1.12	1.40	1.69	1.98	2.27	2.57	2.87	3.16	3.47	3.78	4.09
80°	.30	.61	.91	1.22	1.53	1.84	2.15	2.46	2.78	3.10	3.44	3.78	4.12	4.46
85°	.33	.66	1.00	1.33	1.68	2.02	2.36	2.70	3.05	3.40	3.77	4.14	4.55	4.89
90°	.36	.72	1.09	1.45	1.83	2.20	2.57	2.94	3.32	3.70	4.10	4.50	4.91	5.32
95°	.39	.79	1.19	1.55	2.00	2.40	2.80	3.20	3.61	4.02	4.40	4.98	5.38	5.83
100°	.43	.86	1.30	1.74	2.18	2.62	3.06	3.50	3.95	4.40	4.88	5.37	5.85	6.34
110°	.51	1.03	1.56	2.08	2.61	3.14	3.67	4.21	4.76	5.31	5.86	6.43	7.01	7.60
120°	.62	1.25	1.93	2.52	3.16	3.81	4.45	5.11	5.77	6.44	7.12	7.80	8.50	9.22

FOR EXTERNALS ADD

Central Angle	DEGREE OF CURVE													
	5°	10°	15°	20°	25°	30°	35°	40°	45°	50°	55°	60°	65°	70°
10°	.001	.003	.004	.006	.007	.008	.009	.011	.012	.014	.015	.017	.018	.020
15°	.003	.007	.010	.014	.018	.023	.027	.029	.032	.035	.039	.043	.047	.051
20°	.006	.011	.017	.022	.028	.034	.038	.045	.051	.057	.063	.070	.076	.083
25°	.009	.018	.027	.036	.046	.056	.065	.074	.083	.093	.106	.120	.127	.135
30°	.013	.025	.038	.051	.065	.078	.090	.103	.116	.129	.149	.170	.179	.188
35°	.018	.035	.054	.072	.086	.109	.131	.153	.175	.197	.213	.230	.247	.264
40°	.023	.046	.070	.093	.117	.141	.172	.203	.234	.265	.277	.290	.315	.341
45°	.030	.060	.093	.119	.153	.184	.216	.254	.289	.325	.351	.378	.411	.445
50°	.037	.075	.116	.151	.189	.227	.266	.305	.345	.384	.425	.467	.508	.550
55°	.046	.093	.142	.188	.236	.283	.332	.381	.420	.479	.530	.582	.641	.700
60°	.056	.112	.168	.225	.283	.340	.398	.457	.516	.575	.636	.697	.774	.851
65°	.067	.135	.204	.273	.343	.412	.483	.554	.625	.697	.771	.845	.922	1.01
70°	.080	.159	.240	.321	.403	.485	.568	.652	.735	.819	.906	.994	1.08	1.17
75°	.095	.182	.266	.353	.440	.528	.617	.707	.797	.887	.977	1.07	1.18	1.29
80°	.110	.220	.332	.445	.558	.671	.787	.903	1.02	1.13	1.25	1.38	1.50	1.62
85°	.128	.259	.391	.524	.657	.790	.926	1.06	1.20	1.34	1.47	1.62	1.76	1.91
90°	.149	.299	.450	.603	.756	.910	1.07	1.22	1.38	1.54	1.70	1.87	2.03	2.20
95°	.174	.350	.522	.706	.885	1.06	1.25	1.43	1.62	1.80	1.99	2.18	2.38	2.58
100°	.200	.401	.604	.809	1.01	1.22	1.43	1.64	1.85	2.06	2.28	2.50	2.73	2.96
110°	.268	.536	.806	1.08	1.35	1.63	1.91	2.20	2.48	2.76	3.05	3.35	3.66	3.96
120°	.360	.721	1.08	1.45	1.82	2.19	2.57	2.95	3.33	3.72	4.11	4.50	4.91	5.32

x-sec-Date - Date to Form 1-7

x-sec ALLEY BIR II city Hts. Annex #2 23-33

" " " " " " " " " " 34-46

x-sec MILTON ST. - Merena to Illiony 47-76

O. Smith
 C Allen
 R Taylor
 R Parks

Cross Sec Date St.
 Dale to Fern Sts

Wot 31596
 7-2-52

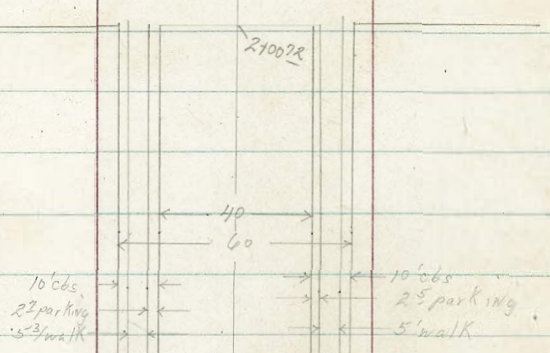

Note:
 • = Fd 7x7 L+Tracks
 all of Returns are
 10' Rad.

Date

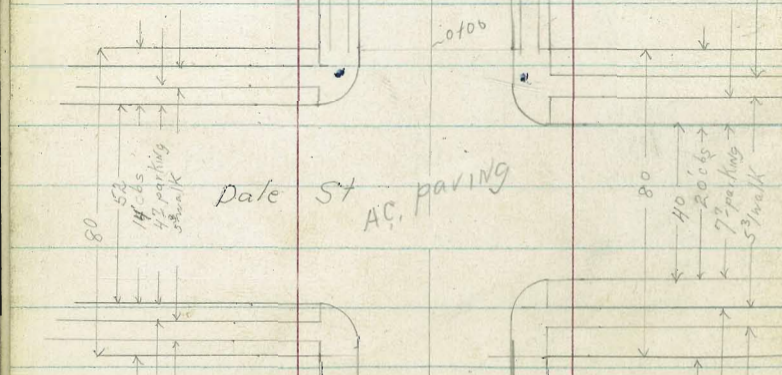

Dale St
 AC PAVING

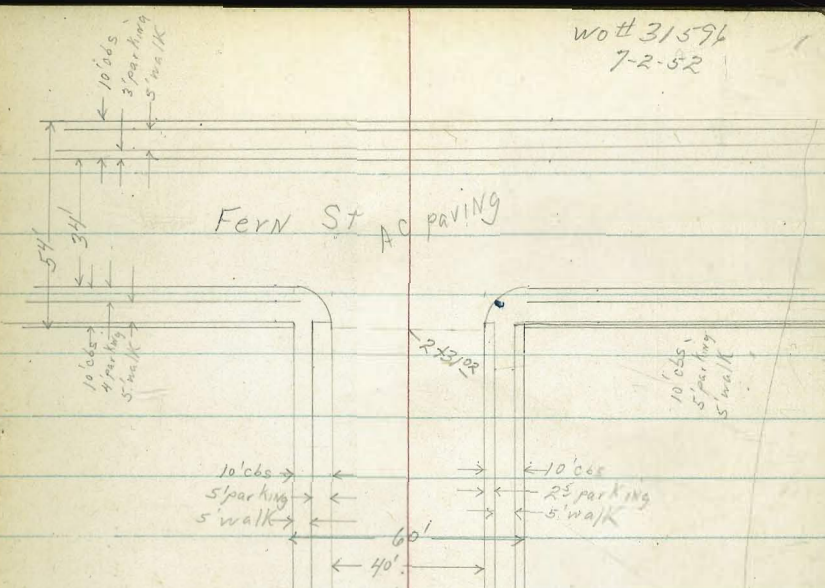

Fern St
 AC PAVING

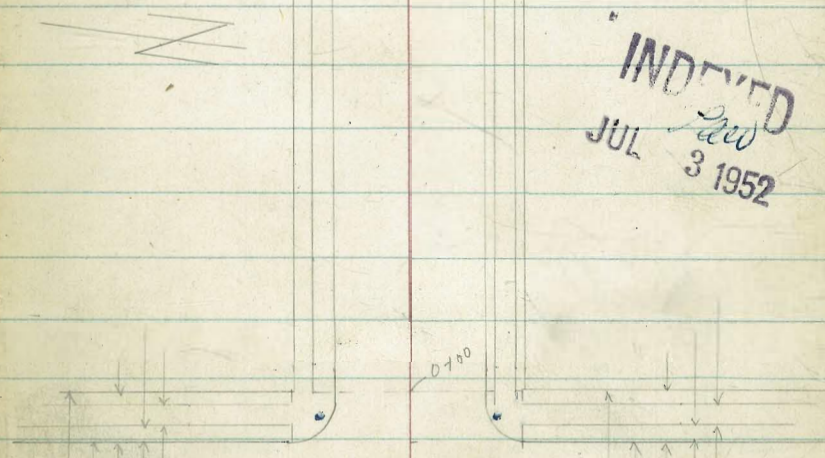

30th St
 AC PAVING

INDEXED
 JUL 3 1952

Lt=North

♀

Rt=South

2

0-64 Cb PC to North

2⁵⁵
06 236.95
3³²
9ut 236.18

0-10 Cb PC to South

6⁰⁵
9ut 233.45
5⁴⁶
06 234.04

Mid Pt Returns btwn P.C.s

2⁵²
06 236.98
3²⁹
9ut 236.21

6¹¹
9ut 233.39
5¹³
06 233.97

0-14 East Cb Line to North Dale St

2²⁶
06 238.54
1⁶⁸
9ut 237.82

2⁵⁰
06 237.00
3²¹
9ut 236.29

3⁴²
20 236.08
3²²
10 235.79

4¹³
10 235.17

5⁰⁹
10 234.42

6⁰⁶
20 233.44

0-20 East Cb Line to South Dale St

3⁰⁵
30 236.45

3³⁵
20 236.15

3²⁹
10 235.71

4³¹
10 235.19

5⁰²
10 234.40

5³¹
20 233.69

6³¹
30 233.19

5⁵²
00 233.98

10⁰¹
100 233.69

10⁰⁵
100 233.35

0-40 ♀ Dale St

10⁰⁴
100 238.46

2²⁰
30 236.60

3²⁹
20 236.23

4²⁷
10 235.23

5⁰⁹
20 234.41

5⁵⁵
30 233.95

10⁰⁶
100 219.44

BM 246

239⁵⁰

237⁰⁴

NEOP
Daler
Date

TT 239⁵⁰

lt=North

rt=South

1706 20° N-E 10' drive

1705 20° N-E 8' drive

12'

1700

0798 20° N-E 10' of broken out CB

0786 20° N-E 12' drive

0763 20° N-E 8' drive

0755 20° N-E 10' drive

0750

0700 East line Dale St. edge AC. paving

take out
renew drive
and sleep 1/3

tunnel

take out

238.13
237.95
137
222
W/K

238.20
237.98
237.30
236.90
236.40
235.80
235.00
235.52
235.65

235.18 South
45
33
225
W/K

237.65
236.99
186
227
W/K

234.77
473
235.27
423
W/K

237.68
237.51
236.90
236.30
235.70
235.00
234.20
234.72
234.91

234.38
134.85
512
465
223
W/K

237.39
237.00
236.22
235.86
235.30
234.45
233.40
234.01
234.22

239.50

0750

0744 20° Pt & 10° drive come out

0700

2480²² East Prop 30th St edge AC paving

2476²² C6 PC

Mid Pt Returns btwn PC

2466²² East C6 Line 30th St

2440²² & 30th St

1+ = North

306	368	42	45	51
238.96	238.34	237.82	237.52	236.92
30	20	20	10	5
w/k	cs			

2+ = South

54	60	5	5	5
236.42	236.02	236.150	236.67	5
10	20	20	215	5
		cs	w/k	

239.36	238.95	238.22	238.03	237.67
266	307	320	329	413
30	20	20	10	4
w/k	cs	9ut		10

237.22	236.54	236.94	237.21
4	5	5	4
10	20	20	273
	9ut	cs	w/k

238.90	238.14
312	328
cs	9ut

236.55	236.90
547	503
9ut	cs

238.90	238.13
312	329
cs	9ut

236.45	237.02
557	500
9ut	cs

241.60	241.12	238.96	238.55	238.85	238.28	237.88	237.57	237.14	237.77	236.47	236.26	237.04	231.56	232.07
042	080	306	327	327	327	414	451	485	555	526	428	104	928	
75	75	41	41	30	30	20	10	10	20	30	30	100	100	
cs	9ut	cs	9ut	cs	9ut	cs	10			9ut	cs	9ut	cs	

241.96	240.43	239.33	238.88	238.15	231.98	236.97	236.48	232.29
006	159	269	314	327	414	505	554	973
80	49	30	20	3	20	30	4	100

24202

2400

1783 20° Pt Begin drive to Service Sta

1750

* rebuild (can't do)

1738 16° Lt & 8° drive con pored over c/t top

1700

TP2 6^{HR} 244⁰² 4^{HR} 237⁶⁰

0795 20° Lt & 8° drive * rebuild

0795 20° Pt & 34° drive

leave part in 12 drive at W end

Lt-North

7 ³⁷	7 ¹²	8 ³	8 ⁵	8 ²	9 ²	9 ⁴	9 ³	8 ²	8 ²
30	20	20	10	10	10	10	20	20	20
w/k	05	05	05	05	05	05	w/k	05	w/k
234.65	234.30	233.72	233.52	233.32	232.82	232.62	232.99	233.20	233.30

6 ¹⁰	6 ⁶	7 ²	7 ²
30	20	20	10
w/k	05	05	05
236.01	235.18	234.82	234.24

5 ⁸	6 ⁶	6 ⁶
25	20	16
w/k	05	05
236.20	235.39	235.56

5 ³¹	6 ²²	6 ²	7 ¹	7 ²	8 ¹	8 ⁵	7 ⁸	7 ¹
30	20	20	10	10	10	20	20	20
w/k	05	05	05	05	05	w/k	w/k	w/k
236.71	235.80	235.32	234.82	234.32	233.92	233.42	234.10	234.21

3 ¹⁵	4 ⁸
25	20
w/k	05
238.59	237.18

6 ¹⁰	5 ²²
20	20
w/k	w/k
235.42	236.15

242⁰²

Pt-South

6

9 ⁵	8 ⁹	8 ⁴	8 ⁸
10	20	20	20
w/k	05	05	w/k
238.62	238.12	238.61	238.79

Soil sample taken center of each Block on the E Date

BM starting 365 237⁰⁵ 237⁰⁴
 TP₃ 3⁵⁸ 240⁷⁰ 6⁹⁰ 237¹²

345.8⁰³ E Fern St.

244.0⁰² Wly C6 line Fern St. taken along c6 line

Mid Pt Returns btwn PC

2431⁰² Wly Ferns St, edge AC paving

Reduce 6-10

2429 20° BT end drive to Service Sta

Notes Reduced by Douglas 7-52

ht. North 8 ft. South 7

237.58
 644 835 857 903 954 985 1142
 100 30 20 20 20 30 66
 235.67
 235.45
 239.99
 239.98
 234.17
 232.60
 238.10
 237.67
 236.00
 235.42
 235.20
 235.00
 234.87
 234.69
 234.39
 234.14
 234.85
 232.30
 235.88
 235.23
 234.33
 234.02
 235.92
 235.85
 235.26
 235.20
 235.0
 234.70
 234.36
 234.85
 235.04
 234.88
 244.02

CROSS SECTIONS POINSETTA DRIVE FROM
ALCOTT TO ELLIOTT STREETS

Sta.	Def A	Chord	Sta.	Def A	Chord
+50	4°38'	25.00			
+25	4°18'09"	"			
3+00	3°58'18"	"			
+75	3°38'26"	"			
+50	3°18'34"	"			
+25	2°58'43"	"			
2+00	2°38'52"	"			
+75	2°19'	"			
+50	1°59'08"	"			
+25	1°39'17"	"			
1+00	1°19'24"	"			
+75	0°59'39"	25.00			
+50	0°39'43"	19.61	P.C.C. 4+21.44	5°34'15"	21.44
+30.29	0°24'05"	30.39	4+00	5°17'43"	25.00
0+00	0°00'00"		3+75	4°57'52"	25.00

$\Delta = 11^{\circ}09'30''$ $R = 2164'$ $L = 421.44'$ $d = .794302402$
 $T = 211.64'$

CURVE DATA

Fd. 2x2 Disk P.C.C. + Fd. 1/2" I.P. & Disk 8

4+21.44 25'

Set 2 1/2" disk on walk
sd 6-30-54
on 9' line

Stampen
Huffman
Shorey
Sherry

W.O. 3/8/17

Ref. File/Map #1587

Phonema Villas

Field Book 2142-59

X-Sec's 64-66

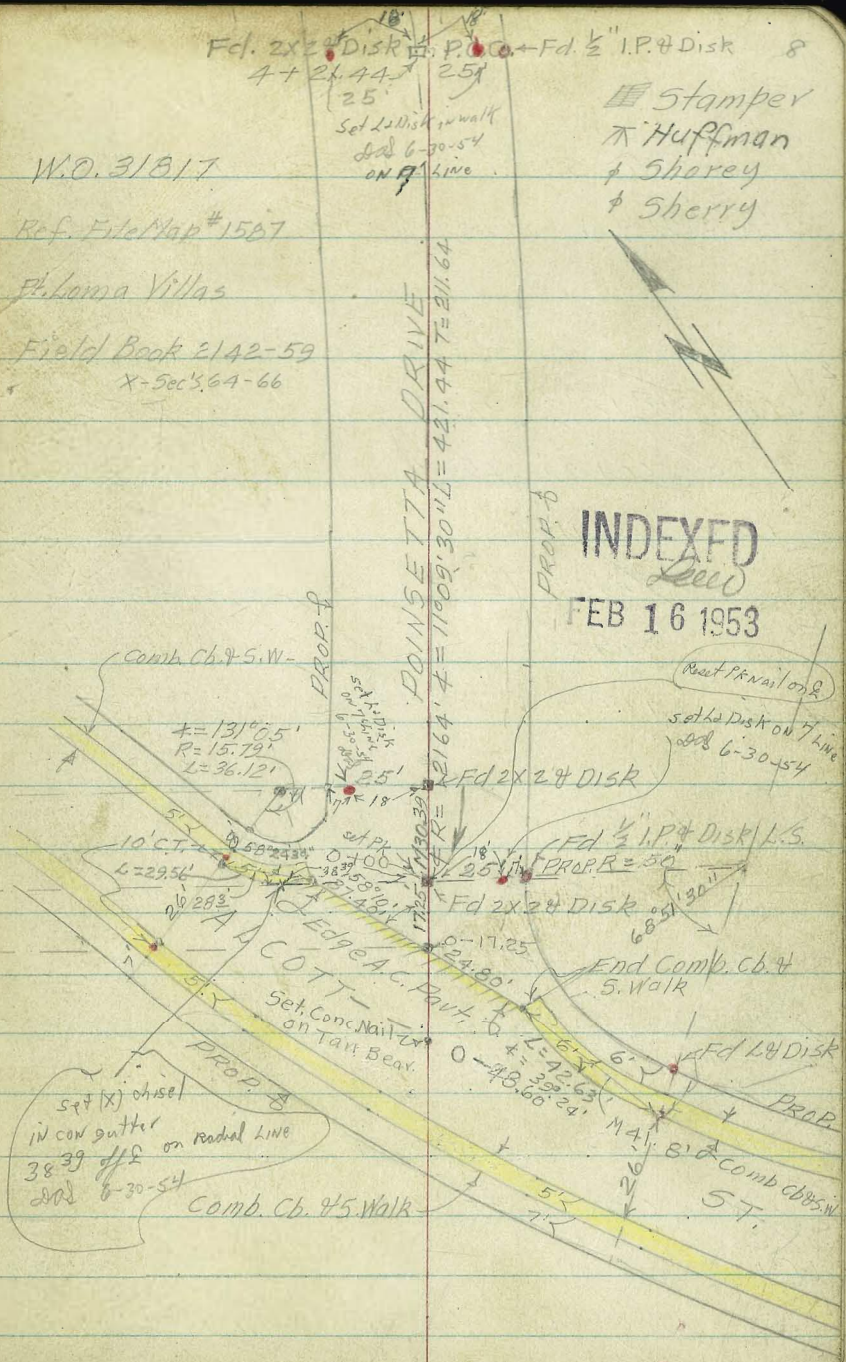

INDEXED
Lello
FEB 16 1953

Set (X) chisel
in cow putter
38'39' off
sd 6-30-54
on road line

Next P. Nail on R
Set 2 1/2" Disk on T. Line
sd 6-30-54

Fd 1/2" I.P. & Disk L.S.

Fd 2x2 & Disk PROP. R=30'

End Comb. Cb. & S.Walk

Fd 1 1/2" Disk

Comb. Cb. & S.W.

ST.

CROSS SECTIONS CONTD.

Sta DefA Chord Sta DefA Chord

P.R.C.
7+60.47 7°18' 10.47

+50 7°24'29" 25.00

+25 6°32'11" "

7+00 5°59'53" "

+75 5°27'35" "

+50 4°55'17" "

+25 4°23' "

6+00 3°50'41" "

+75 3°18'23" "

+50 2°46'05" "

+25 2°13'47" "

5+00 1°41'29" "

+75 1°09'12" 25.00

+50 0°36'54" 28.56

P.C.C.
4+21.44

R=1330.47 $\Delta=14^{\circ}36'$ L=339.03 T=170.44 d=1.2928

CURVE DATA

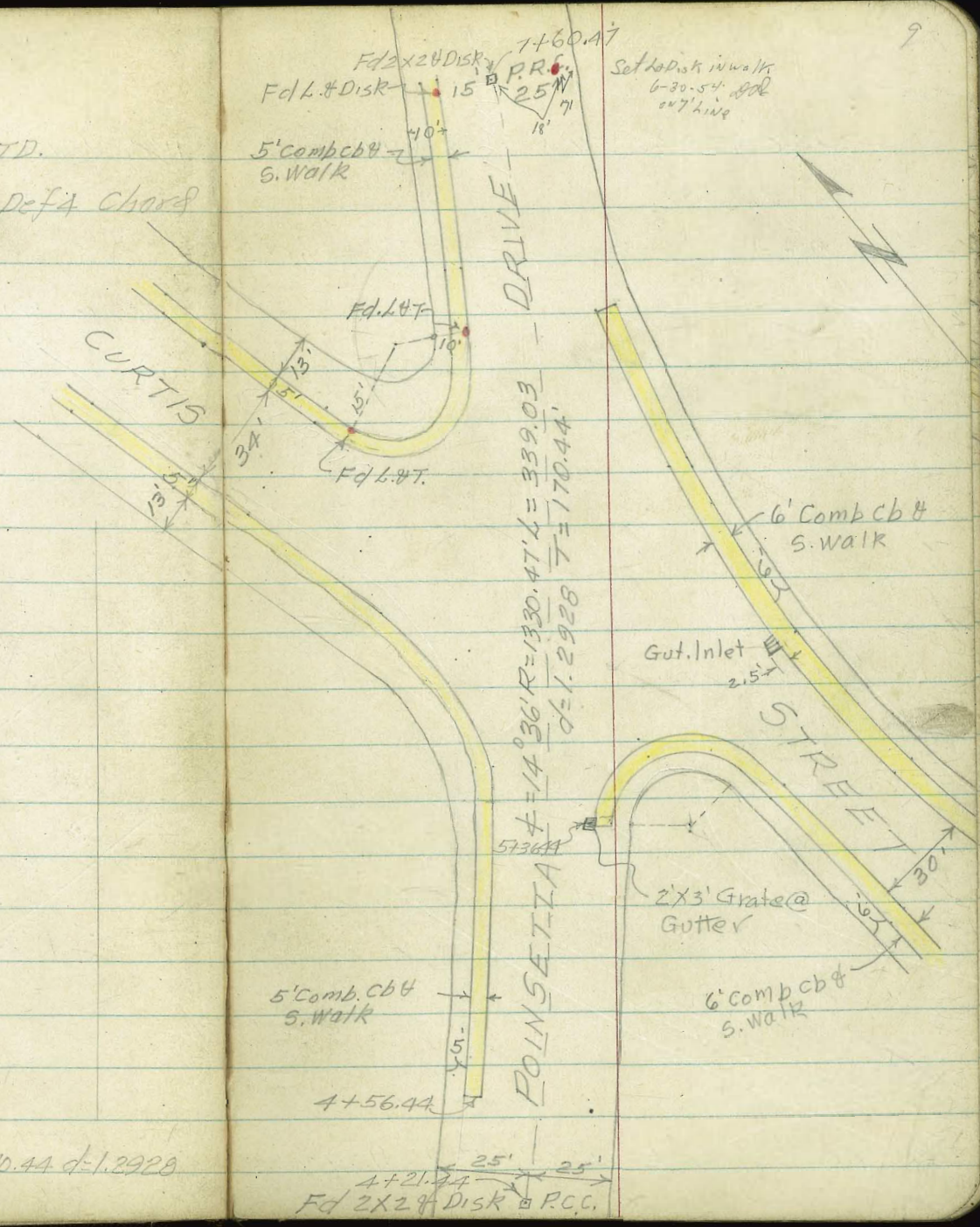

4+21.44
Fd 2x24 Disk @ P.C.C.

CROSS SECTIONS CONTD

Sta Defl Chord Sta Defl Chord

EC.					
10+07.10	5°33'	7.10			
10+00	5°23'25"	25.00			
+75	4°59'39"	"			
+50	4°15'54"	"			
+25	3°24'09"	"			
0+00	3°08'24"	"			
+75	2°34'38"	"			
+50	2°00'53"	"			
+25	1°27'05"	"			
0+00	0°53'22"	25.00			
+75	0°19'37"	14.53			
P.R.C.					
7+60.47	0°00'00"	0.0			

$R=1273.05'$ $\Delta=11°06'$ $L=246.63'$ $T=123.70'$ $d=1.350201$

CURVE DATA

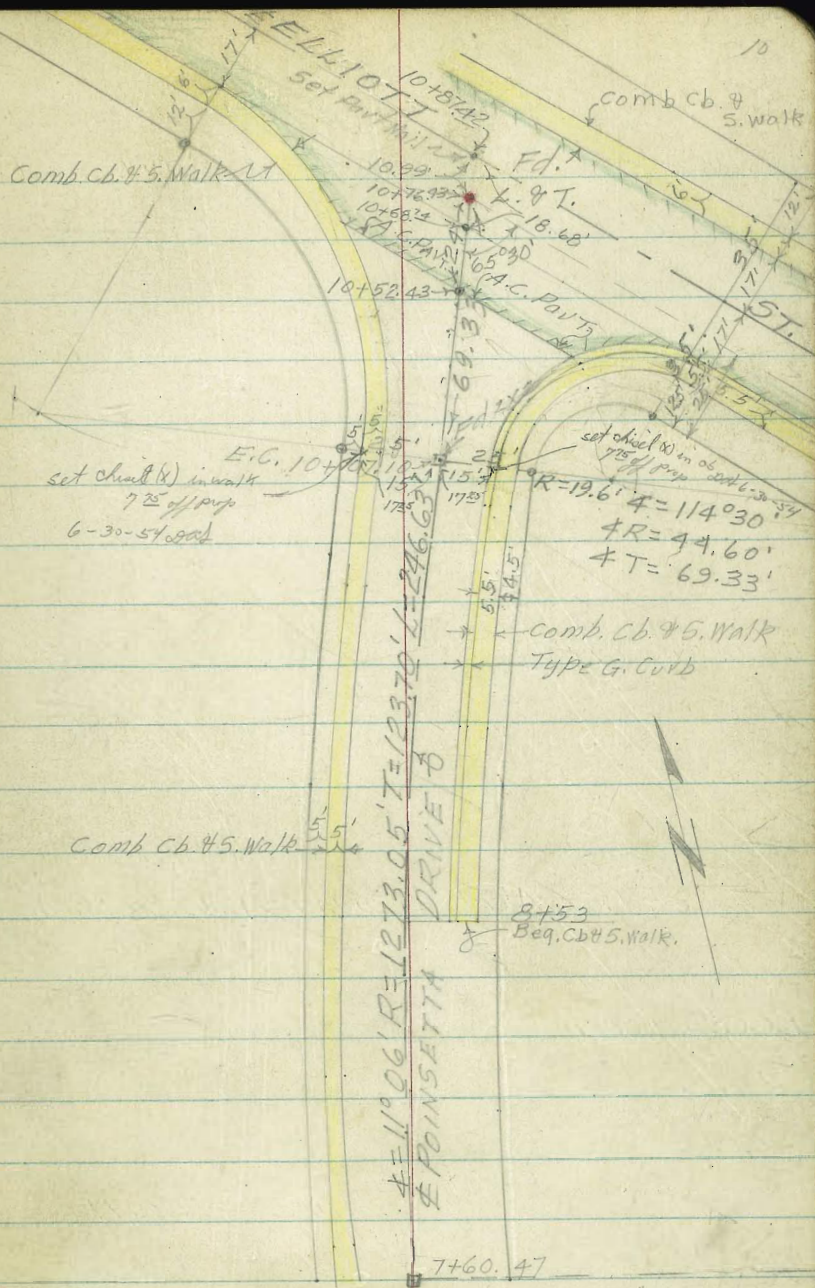

CROSS SECTIONS POINSETTA DRIVE
ALCOTT TO ELLIOTT STREETS

2-13-53

NOTE: Levels run with direct Reading Rod
See Sketch Pgs. 8-10

P.O.C. End Cb

152.69 153.11 153.22
Gut. Cb. b. S. Walk

P.O.C. End Cb

153.07 153.49 153.60
Gut. Cb. b. S. Walk

P.O.C.

153.57 154.01 154.13
Gut. Cb. b. S. Walk

cb. R = 62'
N.E. Ref. P.C.C. Alcott. $\angle = 39^{\circ} 24'$ L = 42.63; 3 @ 14.21

154.36 154.82 155.00
Gut. Cb. b. S. Walk

P.O.C. End curb

151.30 151.74 151.90
Gut. Cb. b. S. Walk

P.O.C.

151.59 152.03 152.12
Gut. Cb. b. S. Walk

P.O.C.

151.69 152.13 152.23
Gut. Cb. b. S. Walk

*P2425
T.B.M. Nail w. Side P.P. Sta. 402 150.71
on East Side Poinsetta

B.C. Alcott

151.82 152.27 152.36
Gut. Cb. B.S. Walk

N.W. Ref. Curb R = 29' 4" = $58^{\circ} 21' 34''$ L = 29.56; 3 @ 9.85'

B.M. T.P. 5

²¹⁷²⁻⁶⁴
146.13

End of Top of Cb. S.E. Ref. Poinsetta & Curtis

Lt. West & Rt. East
2-13-53

CROSS SECTIONS CONTD.

0+50 0° 39' 43"

151.6 150.7 150.0 150.3 150.5 151.4 151.9 153.40
25 17 14 0 14 15 25 25
Top of Wall

0+43 8" Pine

22.3

0+30.54" Pine (Dead)

22.5'

P.O.C. (see sketch)

0+30.39 4" Pine

151.2 151.3 150.7 150.7 150.9 151.2 152.1 152.7 154.09
25 19 18 12 0 14.5 15 25 25
Top of Cape Wall

0+20 8" Pine

22.5'

0+00 4" Pine 22.5' Rt.

151.40 151.1 151.1 151.4 151.9 152.5 153.4 154.43
33 27 10 0 15 16 25 25
Ground at 8" Wall Top of Wall

Lt. CURVED DATA

$\Delta = 11^\circ 09' 30''$ $R = 2164$ $T = 211.64$

$L = 421.44$ $d = .794302402$

0-17.25 Taken Along Edge Pavt See Sketch

151.07 151.72 152.19
19 0 13

0-13 Guy Pole No 566633H

23

0-22 Tel. Guy

24.1

0-486 & Alcott A.C. Pavt. (See Sketch)

151.92 151.56 151.34 151.80 152.61 154.24 156.03
75 50 31 0 20.5 50 75
Top S.M.H

CROSS SECTIONS CONTD.

West Lt.

4

Rt East (13)

2-13-53

1+49.4 N. Line To Double Garage

150.25 148.35
43.5' 28.4'
Floor Begin Ramp

23

1+47° 18' Pine

1+31 S. Line To Double Garage

150.30 148.41
43' 28'
Floor Begin Ramp

1+25 1° 39' 17"

150.0 148.8 148.3 148.4 149.1 149.9 151.20
40 24 14 0 13 25 25
Top 8' Wall

1+05 12" Power Pole No 2024

21'

1+02 10" Power Pole SP 2A25

20'

1+00 1° 19' 24"

151.1 130.0 149.6 148.7 148.9 149.3 150.1 151.3 152.20
50 25 20 13 0 13 18 25 25
Top 8' End Wall

1+00 6" Pine

22.5'

0+89 6" Pine

22.5'

0+82 dead man for guy

21'

0+75 0° 59' 39"

151.0 150.4 149.4 149.6 150.1 150.6 151.5 152.90
25 19 13 0 14 16 25 25
Top 8' Wall

0+75 6" Pine

22.6'

0+66 4" Pine

22.5'

0+55 8" Pine

22.5'

West Lt.

2-13-53

RT. EAST

(14)

CROSS SECTIONS CONTD.

1+95 8" Pine Tree

23'

1+95 Begin Ramp 2-Car Garage

148.12 152.49
21.5 43

Begin Ramp Floor

1+95 End 8" Wall Parallel To Rd

148.7 149.94
25' 25' top 8" wall1+93 2nd Metal Lid To 3'x4'x3' Deep Gas Vault

147.58

16.3

Top Lid.

1+92 8" Pine Stump 6' High

22.3

1+81 12"-2-Pines

22.5

1+79 Beg. Conc. Wall

149.5 150.28
25 25 top 8" wall

1+79 End Ramp To 2-Car Garage

148.93 152.10
22.3 40.2

Begin Ramp Floor

1+75 8" Pine Tree 22.5' Lt.

1484 1477 1474 1474 1474 1476 1481 148.94
43 25 20 13 0 10 18 21.5

Edge Ramp

1+59 Begin Ramp To 2-Car Garage

149.02 152.11
22.3 40.2

1+59 End 8" Conc. Ret. Wall

1496 Ramp 150.69 Floor
25 25 top 8" wall

1+50 1° 59' 08"

148.6 148.1 147.8 147.8 148.2 149.6 150.83
41 25 14 0 10 25 25

Top 8" Conc. Wall

West Lt. & Rt. East (15)
2-13-53

CROSS SECTIONS CONTD.

2+50	3" (Dead) Pine	24'									
2+40	4" Pine Shrub	24'									
2+40	18" Pine Stump 1' High					23'					
2+25	2° 58' 43"		143.9	148.2	146.9	146.8	146.7	147.0	147.2	148.2	149.64
			42	34	25	13	0	10	16	25	25
			Top Brk.							Top 8" Conc Wall	
2+25	10" Pine Stump 1' high									23	
2+20	10" Pine	24									
2+11	8" Pine	24									
2+11	Box 8" Conc. Wall 11 With Rd							148.4	149.82		
								25	25		
									Top 8" Conc Wall		
2+11	End Ramp To 2-Car Garage							147.95	152.43		
								21.2	45'		
								Bed Ramp	Floor		
2+02	8' Pine Tree	24'									
2+00	2° 38' 52"		148.3	148.2	147.4	147.1	147.0	147.2	148.07		
			40	29	25	14	0	10	21.2		
									On Toe Ramp		

CROSS SECTIONS CONTD.

West Lt 2-13-53

RT East

(16)

3+20 6" Pine
3+20 6" (dead) Pine
3+12 4" Pine Shrub

24'

23

24'

3+00 3° 58' 18"

143.4 146.1 146.9 146.3 146.1 146.2 146.4 147.7 149.05
42 32 25 21 12 0 12 25 25
Slopes to Top Bank
Conjoin to Approx seen level
TOP 8" CONC Wall

2+84 20" Pine

Slopes to Top Bank
Conjoin to Approx seen level

23

2+77 8" Tel. Pole & Dead man
#566635 H

20.5 24
Tel Pole Dead man

2+75 3° 38' 26"

142.4 147.1 146.6 146.6 146.3 146.4 146.4 148.3 149.25
42 32 25 21 16 12 0 10 25 25
Slopes to Top Bank
TOP 8" CONC Ref. Wall

2+72 8" Pine

23

2+72 10" Power Pole No 2136

22

2+66 3" Pine

24

2+62 10" Pine Stump 1' High

23'

2+50 3° 18' 34"

143.8 146.6 146.7 146.5 146.5 146.6 147.9 149.60
35 29 25 15 0 11 25 25
TOP Bank
TOP 8" CONC Wall

CROSS SECTIONS CONT'D.

West Lt.

2-13-53

(17)

Rt East

(Dirt Driveway)
4+00 Opening @ End Conc. Wall

3+92 12" Pine

3+79 12" Pine

3+79 6" Pine

TP.

3+75

N. Cor Hd. wall conc.
146.92
8" Cast Iron Pipe Surface
4° 57' 52" Drain

El. 142.31
Outlet

El. 146.06
TOP WING

El. 145.95
TOP WING

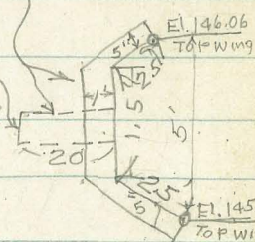

3+70 8" (Dead) Pine

3+56 8" (Dead) Pine

3+56 8" Pine

3+50

4° 38' 00"

3+45 6" Pine

3+45 10" (Dead) Pine

3+30 12" Pine

3+30 8" Pine

3+25

4° 18' 09"

146.86	145.03	145.8	145.5	145.8	146.2	147.6	148.20
21	F.L.	12	10	0	13	25	25
TOP	8 C.I.P.					TOP 8" CONC WALL	

142.5	146.3
37	29

142.9	145.5	146.0	146.1	145.7	145.8	146.2	147.6	148.73
38	31	25	12	11	0	13	25	25
TOP BANK					TOP 8" CONC WALL			

142.7	146.9	146.7	145.8	146.0	146.2	147.6	148.22
37	30	25	12	0	13	25	25
SLURRY TOP BANK					TOP 8" CONC WALL		

25'
23'
23'
24'

23'
23'
24'

24'
23'
23'
24'

CROSS SECTIONS CONTD.

1934 2-13-53
West Lt. \$ Rt East (18)

8+25 1° 27' 07"

138.74 138.63/384 138.7 138.9 139.8 138.6 139.6 140.0
20 15 15 8 10 12 15 25
b.s. Walk cb Gut 143.2 Ditch
50

8+00 0° 53' 22"

139.02 138.92 138.7 139.0 139.3 140.1 139.0 139.4 139.9
20 15 15 8 8 9 12 15 25
b.s. Walk Top Gut
Curb (Conv) 143.2 143.5
45 50

7+75 0° 19' 37"

139.65 139.55 139.3 139.6 139.7 140.6 139.4 140.7 140.6 142.6
20 15 15 0 8 9 13 18 25 33
Gut
cb. (Conv) 143.3 143.5 Ditch
44 50

\$ = 11° 06' R = 1273.05

7+60.47 P.R.C. = L = 246.63' d = 1.350201
3+39.03 F.B. 2142-66

140.13 140.0 139.7 140.0 140.20 140.9 139.8 141.00 141.7
20 15 15 0 7 10 13 17 25
cb. Gut
(Conv) 144.7 145.0
44 50

NOTE: For X-Sec's between sta's 4+21.44 &
7+60.47 See F.B. 2142-64-66 (Sketch Pg. 59)
P.C.C. = 0+00 of X-Sec's Cont'd. F.B. 2142-64-66

4+21.44 5° 34' 45"

145.6 145.7/45.1 145.6 145.8 146.9 147.0 148.52
28 12 10 0 12 17 25 25

W. Side Poinsettia
T.B.M. 10' C.T. opp Sta. 7+60.47 140.00
(see sketch)

TOP 8"
Conc Wall

4+15 6" Pine

23

4+11 N. East of Quarry & Conc 8" Wall

147.4 148.54
25 25
TOP 8" Conc
Wall

4+05 8" Cypress Approx 20' S

24

4+00 5° 17' 43"

142.0 145.3 145.9 146.1 145.3 145.6 146.1 147.6 148.66
35 28 25 11 10 0 12 25 25
TOP 8"
TOP 8" Conc
Wall

CROSS SECTIONS CONTO.

2-13-53
West Lt. $\frac{1}{2}$ Rt East

(19)

9+25	3°42'09"	141.19 19.5 b.s.W.	141.09 14.5 cb	140.6 14.5 Gut	140.7 0	141.39 15.6 LIP	141.26 17.0 Gut	141.71 17.2 cb
9+01.5	N. End Drive way				139.41 15 Gut.			
9+00	3°08'24"	140.00 19.6 b.s.W.	139.74 14.6 cb	139.7 14.6 Gut	139.7 0	140.34 15.3 LIP	140.24 16.6 Gut	140.71 16.8 cb
8+78	Beginning Drive way 23.5' Long				138.84 15 Gut			
8+75	2°34'38"	139.35 20 b.Walk	139.22 15 cb	138.9 15 Gut	139.1 0	139.58 15.2 Gut	139.51 16.4 Gut	139.28 16.6 Top b s.W.
8+53	Beq. Curb & Sidewalk on Rt.				139.7 0	139.48 15.5 Gut	139.36 16.6 cb	139.25 22.3 b.Walk
8+50	2°00'53" Critical Drainage Area (50' long)	138.5 15 cb	138.1 15 Gut	138.01 12.5 cb	137.28 12.5 Gut	138.5 15 Gut	138.7 0	139.0 8 Gut
				138.65 20	140.0 30	142.9 50	138.4 13.5 Gut	139.28 13.5 Top H/Wall

Should be Removed Should be Removed

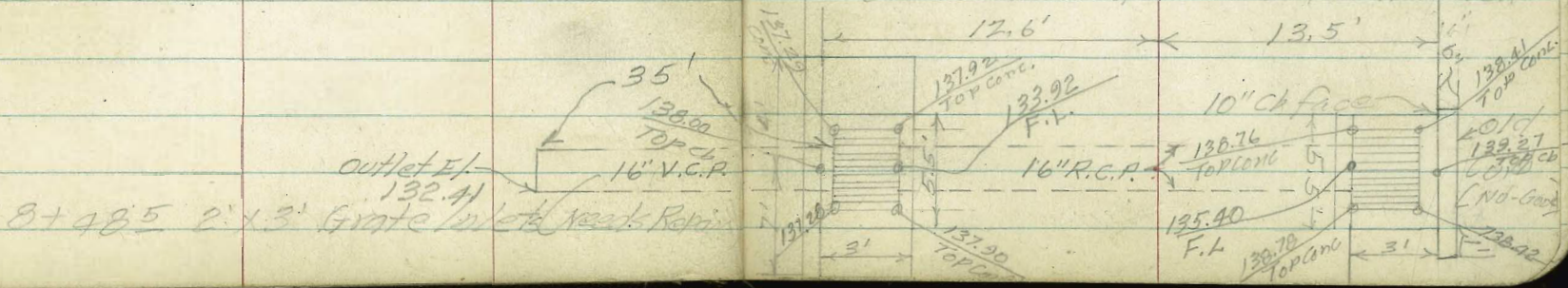

8+48.5 2' x 3' Grate Outlet needs Repair

CROSS SECTIONS CONTD.

2-13-53
West Lt. E Rt East (20)

9+97 End of Driveway West

144.83 144.1
13.4 13.4
Cb

9+95 Bottom of Drive to West

144.10
13.4

9+81 End Drive to East

144.24 144.08 144.56
15.6 17.3 17.5
LIP Gut Cb.

9+79 Bottom of Drive to East

144.12 143.97 144.08
15.5 16.9 16.9
LIP Gut Drive

9+81

143.34
LIP of Drive

9+79 Beg. Drive on West

144.01 143.87 143.2
19.2 14.2 14.2
b.s.w. Cb Gut

9+75 4°49'39"

143.91 143.78/43.1 143.1 143.6 143.96 143.83 143.95
19.2 14.2 14.2 0 15.5 15.5 16.9 16.9
b.s.w. Cb Gut (cbst) LIP Gut Drive

TP.

142.62

9+645 B

143.55 143.39 142.5 144.93
12.5 14.5 14.5 22.6
b.s.w. TOP Gut b.s.w.

9+50 4°15'54"

142.68 142.54 141.9 141.9 142.52 142.42
19.5 14.5 14.5 0 15.6 16.9
b.s.w. Cb Gut LIP Gut

9+46 Begin Driveway

142.29 142.15 142.61
15.6 16.9 17.3
LIP Gut Cb

2-13-53

CROSS SECTIONS CONTD.

10+87.42 @ Elliott St See Sketch

145.4 147.00 147.24 147.99 148.78 149.45 150.09 150.69 151.29 152.13
100 80 75 50 25 0 25 50 75 100

10+68.74 S. Carbine Elliott St. (See Sketch)

147.61 147.25 147.58 148.36 149.14 149.90 150.22 150.46 150.99 151.46
63 63 50 25 0 25 50 64 76 76
cb Gut + Drive Gut cb.
Way

25' C.T. Elliott St.

T.B.M.

@ Pennsetta

149.29

10+52.43 Edge of Pavt (See Sketch)

148.03 147.77 147.36 148.08 148.80 149.48 149.43 149.27 149.7
23.5 23.5 12 0 18 31.3 34.8 37
b.s.w. cb. Gut A.C. A.C. TOPAC. A.C. LIP Gut

149.71
37.2
cb.

10+25

P.O.T.

146.49 146.41 145.9 147.10 147.9 147.73 147.65 148.09 148.29
18.3 13.3 13.3 0 17 19.2 21 21.2 27
b.s.w. cb Gut LIP Gut cb b.s.w

E.C.

10+07.10

5°33'

145.21 145.30 149.5 145.1 145.25 145.85 146.36 146.42
17.9 12.9 12.9 0 15.7 17.0 17.2 22.7
b.s.w. cb Gut LIP Gut cb b.s.w

2-13-53

CROSS SECTIONS CONTD

E.C. Elliott		150.30	150.20	150.73
		LIP	GUT	CB
B.M.	146.18 = <u>146.13</u>			
TP. Top Conc. Wall E.S. Pansetta	146.45			
	OPP Sta. B+53			
P.O.C.		149.89	149.75	150.18
		LIP	GUT	CB
P.O.C.		148.25	148.82	149.26
		LIP	GUT	CB
P.O.C.		147.96	147.81	148.22
		LIP	GUT	CB
P.O.C.		146.98	146.80	147.22
		LIP	GUT	CB
B.C. S.E. Ret.		145.28	145.87	146.38
		LIP	GUT	CB
S.E. Ret Pansetta & Elliott				
	R=30' \angle =114°30' L=59.96 5@12'			

X-sec Alley BIR II - City Hqs Annex
 WO # 31310
 5-14-53
 Allen
 Powell
 Schutt

LT = W 14 6 et cetera 23

For sketch see FB 1770 - Page 26

0+10

10² LT = SE COR 3 CAR garage Apts Above
 CONC Block
 0+00 Nly Line THORN ST

0-12 = EC's 2' Rad Alley Returns

Drive ON WEST is 27' wide
 0-14 = Nly Curb Line THORN ST

BM 6.97 329.56

NW BT. Highland
 + THORN
 322.59

324.99	25.00	25.03	25.1	25.0	25.3	25.25	25.8
4.9	4.56	4.53	4.5	4.6	4.3	4.2	3.18
37 ² CAR FLOR SWCOR.	10 ² GAR FLOR	9 ² CB	9 ² GUT		10 ² GUT	10 ² CB	5.0
324.75	24.4			0.50	24.5	24.94	
4.81	5.2				5.1	4.62	
	9.2	9.2			10.2	10.2	
	GUT	GUT			GUT	CB	
323.93	323.16	324.16	324.36	324.4	324.5	324.5	325.09
5.83	6.4	5.40	5.2	5.2	5.1	5.1	4.47
100 CB	100 GUT	12 CB	12 GUT	10	10	12 GUT	12 CB
		SE COR Drive To garage Facing South					
				329.56			

325.7
 37
 34
 3
 26.2
 10
 28.6
 0
 50
 16
 29.0

24.65
 24.85

X-sec Alley BIK II. City HFS Annex
WD # 3/310-

LT=W14

Rt=ely - 24

0+62-29⁸ Rt=φ Double garage - Conc Floor + Apron

330.24
5.89
29.8
Apron
32.35
5.75
Floor

0+42-28' Rt=φ Single garage - conc floor

330.05
6.05
28.1
Floor

TP, 7.13 336.10 0.59 328.97

336.10

0+40

329.9
0.2
1.5
29.1
0.5
10
28.5
1.1
10
29.1
0.5
10

2²' high x 6" wide
0+25-10² LT= Ely end ETW Conc Retaining wall

0+22⁹ 10² LT=φ 3⁸ wide Conc Walk

328
1.31
20²
WK
28.15
1.41
10²
WK

0+21-10² LT= NE COR Conc Block 13/49

329.56

1736- 9³ LT = NE COR 6' CONC slab

1715- 10¹ LT = S.E. COR 6' CONC slab

1401- 9³ LT = begin 3⁵ high picket fence

1400- 9² RT = ϕ 10" power pole JPA 3330

0+95- 8² LT = ϕ 10" power pole # A3333

0+93- 9³ LT = end CONC Drive to Double garage

0+72- 9⁶ LT = Begin CONC Drive to Double garage

0+70

LT = W 1/4

ϕ RT = 04 -

25

331.86

24

10¹
NE COR
slab.

331.43

67

10¹

330.8

5³

25

30.9

5²

10

30.6

5⁴

10

31.0

5¹

10

31.3

8

25

331.13

97

25^E
Gar floor

30.93

5¹⁷

9³
NE COR DRIVE

331.06

5⁰⁴

25^E
Gar floor

30.35

5⁷⁵

9⁶
SE COR
DRIVE

330.1

6⁰

10

29.7

6⁴

10

30.1

6¹⁰

10

336.10

✓ 2701 - 9⁵ LT = wly Pole # A3351

2700

1798 - 10⁸ LT = NE. cor garage

1781 - 10⁷ LT = SE cor single gar. conc floor
opens to south

1758 - 10⁸ RT = 2 Ribbon Drive 8' wide 2 conc strips

1750

✓ 1749 - 9⁶ LT = NE. cor garage facing west

1742 - 11² RT = 2 single garage conc floor & apron

✓ 1736 - 9³ LT = SE cor garage facing west

LT = W14

2 steady 26

32.6	32.5	32.7	32.7	32.9
3 ⁵	3 ⁶	3 ⁴	3 ⁴	3 ⁵
25	10	10	25	

332.48

36²
10¹
Floor

331.4	31.6	31.7	31.9	32.09	32.09
4 ²	4 ⁵	4 ⁴	4 ²	40 ¹	40 ¹
25	10	10	25	10 ²	20 ²

331.61
4⁴
11²
Apron

31.74
4³
13²
Floor

336.10²

✓ 95 ft = end picket fence
3+00 = 93 ft = Begin Lath fence

✓ 2+67 = 10' ft = Begin picket fence

✓ 2+60 = 10' ft = single garage - DIRT floor

✓ 2+51 = 93 ft = old Tel pole #4161434.

✓ 2+50 = 90' LT = end wire fence + Beg Picket fence

✓ 2+50 = 99 ft = NW cor Garage

✓ 2+25 = 99 ft = SW. COR Double Gar - DIRT floor
opens to East

✓ 2+20 = 94' LT = fence

✓ 2+02 = 95' LT = begin 4 1/2' high chicken wire fence

LT = W 14

27

333.6

25

25

336

25

10

336

25

33.6

25

10

333.3

25

25

33.2

29

10'

DIRT

Floor

332.0

33.2

33

25

33.2

29

10

33.2

29

33.2

29

10

33.2

29

25

336.10 ft ✓

X-sec Alley BIK 11 - City Hts Annex

LT = W 11

Rt = 04y. 28

✓ 9⁴ LT = Begin Board fence

3+38 - 8⁵ LT = end Board Fence

✓ 3+23 - 8¹ LT = end gar Bldg + Beg. High Board fence

✓ 3+21 - 9⁶ RT = begin shed

✓ 3+15 - 11⁶ RT = 2 single garage. DIRT floor

✓ 3+08 - 9³ RT = end Lath fence

✓ opens west to Highland

✓ 8⁴ LT = S.E. COR single Gar CONC floor

3+02 - 8⁶ LT = end picket fence

TP₂

7.31

340.96

2.45

333.65

340.96 X

336.10 X

333.6
7.2
11.6
DIRT
FLOOR

333.71
7.25
8.4
FLOOR

LT=Wly

⊕

Rt=ely

29

3+

3+ Picket fence removed

3+

339.5

9²

9⁸

DIRT FLOOR

3+60- 9⁸Rt=⊕ single garage. DIRT floor ✓

3

TP₃

6.73

343.67 ✓

4.02

Nail in pole
LT 5100 PA3455
336.94 ✓

343.67 ✓

3+

9² LT= Begin Lath fence

3+50 } 9⁵ Rt= end shed DIRT floor

337.3

34.3

34.4

6²

6²

6⁶

10

9⁵
DIRT
FLOOR

3+

3+49- 9² LT=end Board fence

T 3+39- 8⁶ LT=Wly P. pole #PA 3405

340.96 ✓

LT = W 14

study. 30

37

4448 - 14² LT = $\frac{1}{2}$ 2²' conc walk along N. side ^{Bldg.}

335.60

807

242 WK

335.59

808

142 WK

3

4447 - 14² LT = N. end Gar and APTs ^{Conc floor + Apron}

335.70

727

175 Floor

335.54

815

148 APRON

3

4441 - 10² LT = $\frac{1}{2}$ 7 wide Ribbon Drive 2 strips

335.55

812

175 Floor

335.32

835

148 APRON

4403 - S. end 4 car gar + APTS above ON LT.

35.98

769

108 DR

36.19

748

200 DR

3

4401 - 14² LT = $\frac{1}{2}$ 18' Conc walk along S. side of ^{Gar + APTS}

334.96

871

242 WK

335.17

850

148 WK

3

4400 - 9² LT = end shed

334.77

89

10

34.9

88

8

34.7

90

10

34.87

88

25

3

3497 - 9² LT = Cor. Frame (Below)

3480 - 9² LT = Cor. Frame for prep ^{Behind} Bldg fence

343.67

5442 - 13² RT = 2 single garage - Conc Floor

3

5418 - 9² LT = 2' brick walk

5401 - 8⁶ LT = 12" powder # PA 3455

5400 - 9² LT = fence

4480 - 13² LT = 3' conc walk to house

4464 - 10² LT = begin picket fence

4455 - 15² LT = 2 single gar - DIRT floor

4450

LT = W 17

2

RT = 90

31

337.90
577

13²
Floor

336.59

57.08

678

659

199
WK

99
WK

336.4

36.6

73

71

25

10

36.4

37.1

66

10

37.3

64

25

336.91

36.47

696

720

202
WK

132
WK

335.0

79

15²
DIRT floor

335.8

35.8

79

79

25

10

36.0

72

36.1

76

10

36.3

74

25

343.67 x

LT=wly

of=ely

32

+Sly edge AC. Pave - AC. Rough here
5+99²⁸ = Sly Line Myrtle -

338.43	38.57	38.10	38.29	38.30	38.72
524	516	536	538	520	495
100 Sly edge Drive	99 Cb.	99 Gut		100 Gut	100 Cb
				Rough AC	

Now eliminated by new const
5+82 - Li at this point shown in FB1770

10^o LT = Begin Ely edge Conc drive
opening North
5+72 } 9^o LT = NECOR Double garage Conc Floor

338.53	38.42
514	525
Gar Floor	10 ^o Cove Dr.

5+52 - 9^o LT = end picket fence ✓

5+52 - 9^o LT = S.F. cor garage - opens to N.

5+50

337.2	37.6	37.5	37.7	38.0
65	61	6	60	52
25	10	6	10	25

343.67 x ✓

REDUCED 5-18-53 - J. D. ELLIS

TP
7

7.41 <336.24>
336.26 ✓

S.W. 7 1/4 T Highland & Myrtle - FB 1770-31

See also FB 1770 page 10.
6+13 98 Sly Curb Line Myrtle

337.30	336.64	338.07	337.65	337.65	337.67	337.90	337.91	338.60	338.98	339.50
6 37	703	561	602	602	6 00	577	576	507	469	417
100	100	12	12	10	10	12	12	100	100	
cb	GUT	cb	GUT			GUT	cb	GUT	cb	

338.11	339.95	338.00	338.62
5 56	5 92	5 67	5 05
92	92	100	100
cb	GUT	GUT	cb

6+11. 98 = BC's Curb Radius - 2' Rad

342.67 x

X-sec Alley BIK 10 City Hts. Annex #2
 See sketch FB1770 - Page 32

LT = wly & st = eby 34

0-00 = N.L. Thorr. 10' ft = Beg. 7" conc wall.

312 ⁹ 20	313 ⁸ 10	314 ³ 7	314 ¹	314 ⁸¹ 10.1 TopCb + Gut edgeCNC	317 ³⁹ 10.2 Top Wall	317.88 20 Top Wall
------------------------	------------------------	-----------------------	------------------	--	--	-----------------------------

0-01.7 = N. edge Walkoff Left

313²⁴
10.5
CORWK.

INDEXED
 200
 MAY 18 1953

0-07 = S. ly edge conc walk (No curb on Lt.)

310 ⁴⁷ 50 WK	313 ¹⁸ 10.5 CORWK.	313 ¹	314 ⁷⁰ 10 Cb + Gut
-------------------------------	-------------------------------------	------------------	-------------------------------------

0-10⁵ = N. edge Conc slab

313 ⁰⁸ 9.5 COR Gut	313 ⁶²	314 ¹⁶ 10 Gut edgeCNC	314 ⁵⁹ 10 TOP
-------------------------------------	-------------------	---	--------------------------------

0-14 = N. curb line Thorr ST

309 ⁵ 5.0 DIT 9.5	312 ² 10	312 ⁶¹ 9.5 edgeCNC 9.5	313 ²⁶	313 ²⁰ 10 9.5	314 ⁵⁴ 10 TOP Cb 3' Rad	316 ⁴ 5.0 Gut	316 ⁷⁸ 5.0 TOP Cb
---------------------------------------	------------------------	--	-------------------	--------------------------------	--	--------------------------------	---------------------------------------

0-18 = S. edge conc slab for gutter

313.01 9.5 COR slab	313 ⁵⁹	314.22 10 COR slab
---------------------------	-------------------	--------------------------

BM Direct Elev Rod used

NW BP - Highland
 322.59 Thorr.

X-sec Alley BIK 10 - City Hts Annex #2.
0450 - Rt = end Board fence w/ CONC wall Base

0440 -

0435 - 10° Rt = Begin 7" CONC wall Base ^{Board fence} ✓

0430 - 10° Rt = $\frac{1}{2}$ single gar. CONC Floor ✓

0421 - 27.8 Lt = $\frac{1}{2}$ House

0420 - 10° Rt = $\frac{1}{2}$ single gar. CONC Floor ✓

0415 - 10° Rt = end CONC wall at Gar ✓

LT = wly

Rt = eLy - ³⁵
317² 319¹³ 317⁵ 319²
10⁵ 10⁵ 10⁵ 11⁰
Gr wly Topwall FOOT Gr Ely

316⁹ 316² 316.7 317⁵ 320⁰
15 10 10 20

316⁹ 317⁵ 319.13
10⁰ 10⁰ 10⁰
FOOT Gr TOPWALL

317⁴⁴
10⁵
Floor

313⁹⁷ 312⁸
27⁸ 27⁸
Floor Gr

317²²
10⁸
Floor

313⁷ 314⁸ 315⁶ 316.1 317⁰ 316⁸ 318⁸
20 10 6 10⁵ 10⁵ 20
FOOT Gr

LT = w/ly

2 Rtsely.

36

1400 - 9⁹ Rt = end 7" Conc wall ✓

317⁸

318⁷⁴

317³

FOOT

9⁹

9⁹

Top wall to suit

1400 - 8⁸ Lt = w/ly power pole #PA 3325 ✓

315⁶

317²

317²

318²

319²

25

10

10

10

25

0494 - 11⁵ Lt = N. end double garage ✓

316⁵³

316⁴²

15⁸
Floor

11⁵
Apron

New house on right - improvements out

0474 - 11⁸ Lt = S. end double garage Conc Floor ✓
+ Apron

316⁵⁴

316⁴⁵

15⁸
Floor

11⁸
Apron

conc Base 15 high 10^L Rt = begin 4" high Board fence w/ Rubble Conc

0470 - 10^L Rt = end double gar. Conc Floor + Apron

317²

317⁸

318¹³

317⁸

317⁸

18²⁴

10

10^L

10^L

10^L

18²

APRON

Gr

Floor

Floor

0451 - Rt. begin double gar. Conc Floor + Apron

318¹⁰

318²⁰

10³

18⁵

APRON

FLOOR

LT = W 14

Rt = e 14

37

1450 - 9² Rt = end 5' high Conc Block Wall

322¹
50

322⁶
25

322⁸
10

321⁸

321⁸
9²
Gr

320⁹
9⁷
Foot

321⁰
10⁵
Gr
E 14

321⁰
15

1449 - 9⁵ Rt = N. side brick incinerator ✓

Brick incinerator now behind Conc Block Wall

322⁶¹
9⁵
Conc Base

322.61
10⁵
Conc Wall
on Base

1445 - 9⁵ Rt = S. side brick incinerator
Conc base =

322¹⁹
9⁵
Conc
Base

322.27
10⁵
Conc Wall on Base

1437 - 9² Rt = 4 10' wide opening in Block Wall ✓

321⁸
Ground
Reference
9²

1425 - 13² LT = end Conc Block Wall ✓

319²
15

318⁶
13²
Foot

319⁷
13⁹
Gr

319⁴
10

319¹

319⁴
3

320⁸
10

321⁷
15

1460 - 9² Rt = begin 10' conc Block Wall 5' high ✓

318⁴
9²
Gr-at
Wall
W 14

317⁹
9²
Foot

319⁸
10⁵
Gr To
E 14

1400 - 14⁰ LT = begin 2 1/2' high Conc Block Wall ✓

317⁶
14⁰
Foot

318²
14⁰
Gr

X-sec Alley BIK 10 - City HAs Annex #2

LT = wly

RT = eLy.

38

2416 - 9² RT = begin 3' Lath fence ✓
9² RT = end shed ✓

328⁶
9²
Floor

2409 - 9⁶ LT = wly P pole # PA 3363 ✓

2700 - 10² RT = end 3' high Board fence ✓
10² RT = beg. Shed ✓

326⁸ 327³ 327¹ 327⁴ 328³ 328² 28⁴
25 10 4 5 10 25

1482 - 15² LT = single garage - DIRT floor

325⁸
15²
DIRT floor

1475

325⁹ 325⁴ 324⁶ 325⁰ 325⁸ 326⁰
15 10 4 15 10

1451 - 9² RT = beg. 3' high board fence ✓

322⁶ 323² 322⁰ 322² 323⁷ 324⁰ 325¹
25 10 4 8 10 25

2+97- 9⁵ LT = 2³ conc walk

LT = w 17

Rt = e 17

31

2+177- 10⁵ LT = 2³ conc walk

2+82 - 10⁵ Rt = end wire fence + Begin chicken

5/13 wooden floor

332.19

10⁻
Floor

2+77- Rt = 2³ conc walk

331³²
10[±]

331⁴¹
20[±]

2+60-

329⁸
25

330²
10

330³
10

330⁴
10

330⁷
25

2+50- 10⁵ Lt = end 3' high Lath + Begin chicken wire fence

2+30

328⁵
25

328²
10

329⁰

329⁰
10

329¹
25

LT = wly

RT = ch

40

3450 - 10³ RT = end 5' high Conc Block Wall

332⁷
10³
Gr

332⁰
10³
Foot

3470

332⁰
10

332¹

332⁴
10

3424 - 8⁸ LT = NE COR Gar along Shed Below
dirt floor ✓

331⁶

8⁸
dirt floor

3418 - 10⁰ RT = 8' wide opening in wall & 2' conc wall

331⁹¹
10⁰
WR

331⁹⁸
20⁰
WR

3404 - 8⁸ LT = SE COR Shed along Gar on
Conc Foundation

331.82
8⁸
Top Conc
Found.

330⁹
8⁸
Gr

3401 - 9² LT = wly p pole # PA 3399 ✓

3400

330⁵
25

331⁰
10

331²

331⁶
10

331⁸
25

10¹ RT = beam 5' high conc block wall

2499 - 10¹ RT = end shed

331⁵
10¹
Gr

331⁰
10¹
Foot

4450 - 10³ Rt = end fence

4430

4423 - 11⁴ LT = ϕ Small house

4401 - 9⁷ LT = wly P. pole # PA 3431 ✓

10⁴ Rt = beg. 5' high Board fence
4400 - 10¹ Rt end wire fence + begin board

3490 - 11⁹ LT = ϕ Small house ✓

3477 - 10⁵ Rt = Begin 5' high woven wire fence

3470

opening to East
3463 - 12¹ Rt = ϕ Double gar. conc floor

LT = wly

ϕ Rt = eby

41

332⁵
25

333⁰
10

332⁹

333²
10

333⁴
25

333⁴
11⁴
Floor

333^L
11⁴
Grat
House

332⁸
25

333²
10

332³

333⁴
10

333⁹
25

334⁴⁸
11⁹
Floor

333^L
11⁹
6-

332⁴
10

332⁹

333³
10

333⁷²
12¹
Floor

LT = Wly

Rocky

42

5400 - 10⁵ LT = Begin wire fence - 6" CONC

Foundation

325³
10⁵
Foot

327³⁸
10⁵
Top CONC

5400 & S.M.H. ✓

328²⁶
R.M.

5400 - 9⁸ LT = Wly P. Pole # 346 ✓

327³
25

328⁴
10

328²⁶
3

328⁴
3

229⁹
5

330⁶
10

4486 - 9⁵ pt = & 3" Holley Tree

4485

331⁰
10

330⁴
7

330⁰
3

330⁸
3

331⁹
5

332⁵
10

4460

331²
25

332⁶
10

332²

332⁹
10

LT=WHY

RT=CLY 43

5490 - 10° LT - end CONC Wall + fence

327³²
10
Topwall

5435

Low point in Alley

5430 - 11° RT = 4 10' Shed - DIRT FLOOR

326⁵
25

326⁷
10

327¹

327⁶
10

328⁵
25

5413 - 10° RT = end CONC Wall + slab

330⁸
10°
TOP
Wall

329³²
11°
TOP
Slab

5410

326⁵
10°
Gr
WHY
wall

327⁰
10
Gr
5 1/4" Wall

327⁵

328²
10

5403 - 10° RT = Beg 6" CONC Wall = ^{begegedge CONC slab} ✓

329³
10°
9r

330³²
10°
TOP
Wall

329⁵²
11°
TOP
Slab

LT = W 14

RT = e 14

45

51 edge A.S. Pavement
6400.15 = S.L. Myrtle

334.65
10.0
cb

334.20
10.0
GUT

334.13

334.44
10.0
GUT

334.05
10.0
TOP
cb

5497-44 = RT = NW COR House

334.4
14.5
9"

335.08
14.5
Upper
Floor level

5497-107 CONC Dr to myrtle
LT = NE COR Gar CONC Found. + Floor

334.52
10.7
TOP
Found +
Floor Gar

334.0
10.7
9"

5492-107 RT = Beg CONC Wall

331.8
10.7
9"

334.43
10.7
TOP
Wall

334.43
14.0 TOP
Wall at
House

5485

334.28
10.0
TOP
Fond
gar

332.6
10.0
Gr
EIV
Gar Fond

331.9
7

332.5

332.3
4

329.9
10

LT = W14

Alley

RT = cly

46

See FB 1770 - For original notes

on Alley

CK - Curbs per F.O. FB - 1770

332 ¹⁰	332 ⁹³	334 ¹²	333 ⁵³	334 ¹⁰	335 ¹⁶	335 ⁰⁹	335 ⁷²
100	100	50	50	50	50	100	100
Top	60T	cb	60T	60T	Top	60T	Top
cb							cb

6 + 14, 15 - sly curb line Myrtle

334 ¹⁸	333 ⁹¹	333 ⁹⁴	333 ⁹⁸	334 ¹³	334 ¹⁸	334 ⁷¹
12 ⁰	12 ⁰	10		10	12 ⁰	12 ⁰
cb	60T				60T	Top
					cb	

alley curb + Ret on West is original
alley curb + Return on East is New

6 + 12, 15 = BS. Alley Returns

334 ⁴⁵	333 ⁹⁶	334 ¹²	334 ⁷⁴
10 ⁰	10 ⁰	10 ⁰	10 ⁰
Top	60T	60T	Top
			cb

CROSS SECTIONS OF MILTON ST. FROM
 MORENA TO UNION ST. W.O. 32127
 Sta.

INDEXED
 JUL 31 1953

0-02 Top Bank Sec. To North

0-04 Toe Sec. To North

0-12⁵ E. Edge Pavt. Morena Blvd

0-25 4 Pavt. Morena Blvd

+0.42 19.26
 TP +0.48 31.36 -12.52 18.84

TP -12.72 30.88

B.M. H. 57 43.60 42.03

7-10-53

4 North

Ref F.B. 2221 for sketch

T.P. 1502
 48

NOTE: Rods Shown Thus (-0.0)
 are plus rods & should be

added to H.T.
 13.7 13.6 10.76 11.28
 6.1 56 8.50 7.28
 60 43 42 0
 Top EP
 Top Toe

NOTE: For B.L. Sketch for these Sec's

See 2221

10.5 2610.72 11.24 11.17
 8.7 8.54 8.02 8.09
 60 46 0 2.7
 EP EP

10.56 10.80 11.07 11.42 11.65
 8.70 8.46 8.19 7.84 7.61
 100 50 0 50 100
 EP EP EP EP EP

10.91 11.10 11.26 11.49 11.65
 8.35 8.16 8.00 7.77 7.61
 100 50 0 50 100

19.26

S.W.B.P. End of Milton

Stampel 47
 Sisson
 Sherry
 Palmer Rt. South

7-10-53

X-SEC'S MILTON ST. CONTD.
Sta.

Lt. North E Rt. South

0+60 4" Apple Tree on RT

38
Tree

0+50

14.2	14.2	13.7	13.4	13.13	13.26	13.09	13.7	15.7	15.8
5.0	5.0	5.5	5.8	6.13	6.00	6.17	5.5	3.5	3.4
50	40	31	29	13.5	0	13.5	21	22	40
		Top	Toe	EP		EP	Toe	Top	@ 844

0+25

13.8	13.8	13.7	12.2	12.14	12.26	12.10	12.4	11.7	11.9
5.4	5.4	5.5	7.0	7.12	7.00	7.16	6.8	4.5	4.3
50	40	30	27	13.5	0	13.5	21	21	40
		Top	Toe	EP		EP	Toe	Top	@ 844

0+16 End Conc Ret Wall on RT

11.90	11.68	11.5	13.8	14.2	14.7
7.36	7.58	7.4	5.9	5.0	4.79
0	13.5	22	23	38	38
	EP		Ground		Top Conc Wall

0+13 Begin Conc Ret Wall on RT.

0+00

12.6	13.2	13.5	10.83	11.32	11.16	11.6	11.9
6.6	6.0	5.7	8.43	7.94	8.10	7.6	7.3
100	50	39	38	0	22	50	100
		Top	EP		EP		

12.46
20.14
20.20
12.43
12.40

Winn-Dixie Co.
Oil Site

12.1
7.1
38
Ground
Top Conc Wall

19.26

19.26

7-10-53

X-SEC'S MILTON ST. CONTD.
Sta

Lt North & Rt. South

1+35+4 Alley on Lt.

16.8	16.8	16.2	16.3	15.58	15.86
2.4	2.4	3.0	2.9	3.68	3.40
75	40	28	26	13.5	

ER. Top M.H.

1+23 P.P. N^o JP 3949 on Rt.

23.65 23.95

285
P.P.

15.6	15.1	15.9	15.2	14.58	14.80	14.56	15.2	16.1	17.6
3.6	3.5	3.3	4.0	4.68	4.44	4.70	4.0	2.5	1.6
50	40	29	28	133	0	132	21	22	40

ER. ER. to top

Union oil Co photos

1+00

0+94 Deadman Guy on Rt.

285
Deadman

(Cont. Floor)
0+74 Sing Car Guy on Rt.

16.34
2.92
42
Cont. Floor

(Cont. Floor)
0+66 Sing Car Guy on Rt.

19.26

16.42
2.84
42
Cont. Floor

19.26

7-10-53

X-SEC'S MILTON ST. CONTD.

Lt. North

⊕

Rt. South

Sta.

21.40

21.47

2+49 Begin Conc. Paving on Rt. 7.5' W. (519)

7.21

7.14

29°

36°

Top Conc. Paving

Top Conc. Paving

2+21 E. Line 2' Conc. Ribbon Sing Car Gar on Lt.

19.51

19.36

9.11

9.25

62°

28°

Top Conc. Floor

Top Conc. Ramp

2+14 W. Edge 2' Conc. Ribbon To Sing Car Gar on Lt.

19.46

19.31

9.15

9.30

62°

28°

Top Conc. Floor

Top Conc. Ramp

2+00

19.0 19.2 18.5 17.57 17.84 17.61 18.1 19.1 19.5

9.6 9.4 10.1 11.04 10.77 11.00 10.5 9.5 9.1
40 29 28 13.5 0 13.3 22 23 40
EP EP

+10.77 28.61

▲ 28.61

1+84 Begin Picket fence on Rt. (4' poor condition)

TP

-1.42

17.84

17.7 17.7 17.9 17.0 16.11 16.32 16.15 16.6 17.6 18.6
1.3 1.5 1.3 2.2 3.15 2.91 3.11 2.6 1.6 0.6
50 40 30 28 13.5 0 13.5 22 23 40
EP EP

1+50

1+48 Begin Picket fence 4' on Lt.

19.26

39° fence cor
▲ 19.26

X-SECS. MILTON ST. CONTD.

Sta

3+09.76 \pm Chicago St. To N.

2+91.5 End 3' Ricket fence on Lt.

2+69.76 Wly Prop Chicago To N.

2+67 P. Pole N^o 3999 (12") on Rt.

2+57 End Conc Patio on Rt.

2+50

28.61

7-10-53

North Lt

\pm

Rt. South

21.0	21.4	21.5	20.84	21.01	20.78	21.4	22.2	22.4
7.6	7.2	7.1	7.77	7.60	7.83	7.2	6.9	6.2
75	50	24	135	0	135	22	23	40
			EP.		EP.			

38°
fence lot

20.8	20.9	20.4	19.81	19.94
7.8	7.7	8.2	8.80	8.67
40	28	27	135	0
			EP.	

28°

PP.

21.57	21.64
7.04	6.97
292	365

Top Conc
Patio

Top
Conc

20.4	20.5	19.9	19.15	19.33	19.15	19.7	20.6	21.0
8.2	8.1	8.7	9.46	9.28	9.46	8.9	8.0	7.6
40	29	28	13.5	0	13.5	22	23	40
			EP.		EP.			

28.61

7-10-53

X-SEC'S MILTON ST. CONTD.

North Lt. & Rt. South

Sta

4+74 End 6' Eugenia Hedge on Lt. ^{2' wide}

40°

Hedge
S. Edge

4+50

26.2	26.9	26.1	25.31	25.45	25.25	25.9	26.5	27.3	27.9
2.4	1.7	2.5	3.30	3.16	3.36	2.7	2.1	1.3	0.9
40	28	27	135	0	135	23	24	30	40
			EP		EP				

4+700

25.2	25.2	24.3	23.59	23.75	23.60	24.2	25.0	25.5
3.4	3.4	1.3	5.04	4.86	5.01	4.4	3.6	3.1
40	28	27	135	0	135	22	23	40
			EP		EP			

3+97 Begin 6' Eugenia Hedge on Lt 2' w

40°

Hedge
S. Edge

3+91 10" P.P. N^o-JP 4021 on Bt.

275

P.P.

3+49.76 Ely Prop Chicago St. to N.

23.2	23.2	23.4	22.8	21.87	22.10	21.89	22.8	23.1	23.6
5.4	5.4	5.2	5.8	6.74	6.51	6.72	5.8	4.9	5.0
60	40	28	27	135	0	135	22	23	40
				EP		EP			

28.61

∇ 28.61

X-SEC'S MILTON ST. CONTD

Sta

6+00

5+50 Dead man (Guy) on RT

5+32 12" P. Pole N^o 4075 on RT

5+00

4+97 Beam 4' Picket fence on LT
(Poor Condition)

4+95 End Picket fence on RT

4+84 76 ± 20' ALLEY on LT

TR + 10.98 37.90 - 1.69 26.92

28.61

7-10-53

North	LT	±	RT	South
31.2	31.3	30.9	30.39	30.61
30.42	31.0	31.2		
6.7	6.6	7.0	7.51	7.29
7.48	6.9	6.7		
40	28	27	135	0
			EP	EP

29.4	29.7	29.2	28.69	28.93	28.73	29.8	30.5
8.5	8.2	8.7	9.21	8.97	9.17	8.1	7.4
40	28	27	135	0	135	27	270
			EP	EP			deadman

27.5
RR

27.5	27.9	27.4	27.01	27.15	27.04	27.6	28.2	29.1
10.4	10.0	10.5	10.89	10.75	10.86	10.3	9.7	8.8
40	28	27	135	0	135	23	24	40
			EP		EP			

405
fence

26.4	27.1	27.0	26.56	26.68
11.5	10.8	10.9	11.34	11.22
75	40	25	135	0
			EP	

320
fence

37.90

7-10-53

X-SEC'S MILTON ST. CONTD.

North Lt. & Rt. South

Sta

6+89 Begin 3' Woven Wire Fence on Lt.

371
fence
cov.

6+81 2' Dia Pepper Tree on Rt.

6+71 10' R.P. No 4103 on Rt.

342
Tree 282
& P.P.

1.53 43.56 42.03

T.B.M. Sta 6+71 -4.27 33.63

Set Nail N. Side R.P. No 4103 - 282 Rt.

6+59.52 & Denver St. To North

32.70	33.00	32.90	32.10	32.30	32.05	32.6	33.4	33.3
5.2	4.9	5.0	5.80	5.60	5.85	5.3	4.5	4.6
7.5	40	25	13.5	0	13.5	26	37	40
			E.P.		E.P.			

6+42 End 4' Picket Fence on Lt.

372
fence
cov.

6+19.52 W/4 Prop Denver St. To N.

37.90

32.0	31.8	31.10	31.25
5.9	6.1	6.80	6.65
40	27	13.5	0
		E.P.	
37.90			

X-SEC'S MILTON ST. CONTD.

8+17 10" TEL Pole No 488067-Head

8+00

7+99 & 2-Deadmen Guys On Rt

Begin 5' Board fence
7+87 End 3' Woven Wire fence on Lt

7+50

6+99.52 Ely Prop Denver St. North

43.56

7-13-53

North Lt. & Rt. South

293

TEL+PP

37.8	37.6	37.5	36.6	36.11	36.20	35.94	36.5	37.4	37.6	37.8
5.7	5.9	6.0	6.9	7.45	7.36	7.62	7.0	6.1	5.9	5.7
60	40	30	28	135	0	135	25	31	40	60
				EP		EP				

275

& 2-Deadmen

360

fence car

35.9	35.8	35.7	35.2	34.7	34.76	34.51	35.0	35.8	36.0	36.1
7.6	7.7	7.8	8.3	9.09	8.80	9.05	8.5	7.7	7.5	6.8
50	40	30	28	135	0	135	26	30	40	60
				EP		EP				

34.7	34.6	33.9	33.08	33.24	33.04	32.8	31.2	31.6	35.2
8.9	8.9	9.6	10.48	10.32	10.52	9.7	9.3	8.9	8.3
50	30	28	135	0	13.5	25	31	40	60
			EP		EP				

43.56

7-13-53

X-SEC'S MILTON ST. CONTD

Sta.

North Lt. & Rt. South

8+67 ± 3' Conc Walk on Lt.

39.12	38.99
4.44	4.57
50	40 ±
on walk	Conc. Walk

8+54 End Conc Ramp to Sing Car. Gr. on Lt.

39.18	38.86
4.08	4.70
59 ±	40 ±
Conc. Floor	Conc. Ramp

8+46 Begin Conc Ramp to Sing Car. on Lt.

39.19	38.75
4.07	4.81
59 ±	40 ±
Conc. Floor	Conc. Ramp

8+34.52 ± 20' Alley on Lt.

38.1	37.9	37.8	37.23	37.18	37.00	37.6	38.4	38.7	38.7
5.4	5.6	5.7	6.33	6.38	6.59	5.9	5.1	4.8	4.8
75	40	28	135	0	135	26	52	40	60
			EP	N.H.	EP				

8+25 End Picket fence on Lt.

36 ±
fence
Cor.

8+23 12" P.Pale No 4/51 on Rt

275
P.P.

A 4356

X-SEC'S MALTON ST. CONTD.

7-13-53

57

North Lt. E Rt. South

Sta

9+50

42.3	41.9	41.7	41.2	40.44	40.58	40.26	40.4	41.5	41.7	41.7
1.2	1.6	1.8	2.3	3.12	2.98	3.30	3.1	2.0	1.8	1.8
55	40	29	23	13.5	0	13.5	26	32	40	60
				ER		ER				

9+29.34 Conc Block Lateral Wall 2' High on Lt.

41.95	39.9
1.61	3.6
40.3	40.3
Top Conc Wall	Ground

9+26 Ely Edge 1.5' Conc Ribbon To Sign Car Gars on Lt.

40.11	40.00
3.45	3.56
50.3	40.3
Conc Walk	Top Conc Ribbon

9+20 Wly Edge 1.5' Conc Ribbon To Sign Car Gars on Lt.

40.10	40.06
3.46	3.50
50	40.3
	Top Conc Ribbon

9+02.5 ± 3' Conc Walk on Lt.

40.01	39.92
3.55	3.64
51	40.3
Conc Walk	Top Conc Walk

9+00

39.8	39.7	39.3	39.5	39.87	39.12	38.88	39.8	40.4	40.6	40.3
3.7	3.8	4.2	4.0	4.69	4.44	4.68	3.7	3.1	2.9	3.2
50	40	31	24	13.5	0	13.5	27	33	40	60
				ER		ER				

13.56

7-13-53

X-SEC'S MILTON ST. CONTD

North Lt. & Rt. South

Sta

10+00

9+91.24 Wly Ch Line Erie St. Sly

42.7	42.8	42.6	41.9	41.97	41.99	41.33	41.26	41.66	42.01	42.25	42.68
0.6	0.7	0.9	1.6	2.19	2.07	2.23	2.30	1.90	1.55	1.31	0.88
60	40	32	24	135	0	135	26	59.5	54.5	104.7	104.5

Gut
E.C. cb

9+79.44 Wly Prop Erie St. Sly

42.7	42.6	42.2	41.7	41.14	41.28	41.02	41.00	41.43	42.2	42.7	42.7
0.8	0.9	1.3	1.8	2.42	2.28	2.59	2.56	2.13	1.3	0.8	0.8
60	40	32	24	135	0	135	30	30	31	40	60

EP. EP. Gut cb

9+77 12" R.P. on RL

9+69.44 Wly Line Erie St. To North

42.7	42.3	42.1	41.5	40.94	41.10	40.84	40.71	41.13	41.5	42.2	42.7
0.8	1.2	1.4	2.0	2.62	2.46	2.72	2.85	2.13	2.0	1.3	1.1
60	40	32	25	135	0	135	26	26	28	35	46

Gut cb

9+62 B.C. Sly Ch Line Erie St.

R=132'±

42.4	42.2	42.0	41.4	40.70	40.90	40.66	40.94	40.74	40.9	42.0	42.2
1.1	1.3	1.5	2.1	2.86	2.66	2.90	3.12	2.82	2.6	1.5	1.3
55	40	29	23	135	0	135	26	26	27	34	40

Gut cb

9+50 8" R.P. Tol Pole No 488063-H

JP 4188

293
E.P.P.

43.56

7-13-53

X-SEC'S MILTON ST. CONTD.

North Lt. & Rt. South

10+63 10" R.P. N° 90844-H on Lt.

295
L.P.P.

10+58 Fire Hydrant on Rt.

310
F.H.

10+49.44 Fly Line Erie St. N/ly

44.5	44.5	44.6	43.6	42.40	42.54	42.34	42.54	42.96	44.2	44.7
8.7	8.7	8.6	9.4	10.84	10.70	10.90	10.70	10.28	9.0	8.5
60	40	33	26	135	0	135	29	29	40	60
				EP		EP	Gut	cb.		

10+43 Deadman Guy on Lt.

10+39.44 Fly Line Erie St. Sly

44.1	44.1	44.0	43.4	42.13	42.30	42.12	42.20	42.62	42.8	43.4
2.1	2.1	2.2	2.8	1.11	10.24	11.12	11.24	10.62	10.4	9.8
60	40	32	26	135	0	135	36	36	40	60
						EP	Gut	cb.		

10+27.44 Fly Cb. Line Erie St. Sly

43.8	43.8	43.6	43.3	41.97	42.10	41.87	42.18	42.04	42.30	42.18	42.42
9.4	9.4	9.6	9.9	11.27	11.4	11.3	11.26	11.20	10.94	11.06	10.82
75	40	22	26	135	0	135	60.5	60.5	70.5	70.5	
		(32)		EP		BC	BC	Gut	cb.		

B.M. + 11.21 53.24 -1.53 42.03

10+09.44 & Erie St.

42.9	42.5	42.3	41.65	41.81	41.64	41.81	41.91	41.91	42.76
0.6	1.0	1.2	1.21	1.75	1.92	1.75	1.65	0.80	
60	40	24	135	0	135	26	54	104	

43.56

X-SEC'S MILTON ST. CONTD.
Sta.

12+00

11+84.44 ± 20' Alley To North

11+82 P. + Tel Pole 8" N^o 90815-H on Lt

11+80 15" P.P. N^o 422.5 on Rt

11+79 End 4' Bd fence on Rt.

11+75 10" P. Pole N^o 578870-H on Lt

11+30

11+27 Begin 4' Board fence on Lt. + Rt.
End Conc Ramp To Sing Co. Gen. Corp

7-13-53

North Lt. & Rt. South

54.8	50.4	50.0	48.2	47.61	47.75	48.61	48.6	48.6	48.9
-1.6	2.8	3.2	5.0	5.63	5.49	5.63	4.6	4.6	4.3
50	40	35	25	135	0	135	26	40	60
				EP		EP			

41.3	48.5	48.1	46.95	47.17	47.03	48.0	48.4	48.2	48.7
1.9	4.7	5.1	6.29	6.07	6.21	5.2	4.8	5.0	5.0
75	40	27	135	0	135	25	27	40	60
			EP	M.H.	EP				

296
Tel P

280
400
Fence

398	298									
Fence	+ P.P.									
COY										
47.5	47.4	47.3	46.6	45.81	46.00	45.82	46.6	47.5	47.2	46.7
57	58	59	6.6	7.43	7.34	7.42	6.6	5.7	6.0	6.5
60	40	28	27	132	0	132	25	29	40	50
				EP		EP				

46.54	46.09								
670	715								
472	298	392							
conc floor	conc Ramp	fence							

53.24

7-13-53

X-SEC'S. MILTON ST. CONTD.

North Lt. & Rt. South

Sta.

12+00

12+99 14" P. Pipe No 4249 on Rt

12+99 B.C. Sly. Ch. Ret. Frankfurt St. Rt

54.0	53.2	51.4	51.37	50.51	50.97	51.17	51.00	28.0
70	7.8	2.6	965	1051	1005	9.85	1002	10.66
40	34	27	cb.	Gut	13	0	135	20°
			20	20				20°
								26°
								26°
								40
								Ground
								50.9
								60

TP. + 9.72 61.02 - 1.94 51.30

12+90.2 & 3.5' x 22' Grate Inlet.

50.99	50.21	49.92	50.68
2.25	3.09	3.32	2.56
20.2	20.2	20.2	20.2
Top Hd. Wall	Top Grate	Top Grate	Top Hd. Wall
	@ Gutter	@ Gut.	

12+88 W/ly line Begin 16" Inlet Structures ONLY 4 RT

53.4	53.1	51.2	50.99	50.14	50.61	50.79	50.59	49.94	50.70	50.8	50.7
40	35	29	19.2	19.2	135	0	135	20.1	2.54	2.4	2.5
54.2									20.1	40	60
(4.0)									Gut.	Top Hd. Wall	
60											

12+56.5 Begin Conc Block Ret Wall 16" on Lt

50.7	50.7	50.7	50.7	50.7	50.7	50.7	50.7	50.7	50.7	50.7	50.7
5	5	5	5	5	5	5	5	5	5	5	5
50.7	50.7	50.7	50.7	50.7	50.7	50.7	50.7	50.7	50.7	50.7	50.7
50	50	50	50	50	50	50	50	50	50	50	50

12+50

53.24

7-13-53

X-SEC'S MILTON ST. CONTD.
Sta

North Lt. & Rt. South

13+53.20 Fly Edge A.C. Frankfort St

53.2	52.0	52.2	53.4	52.53	52.77	52.48	52.32	52.37	52.46	52.64
7.8	9.0	8.8	7.6	8.49	8.25	8.54	8.70	8.65	8.56	8.38
60	40	33	24	135	0	135	20	40	60	90
				EP		EP				

13+48.3' Dia Pepper Tree on Lt.

44°
Tree

13+33.20 Wly Ch. Line Frankfort St

54.2	53.2	51.7	52.6	52.02	52.21	52.03	51.87	51.91	52.20	51.91	52.41
6.8	7.8	9.3	8.4	9.00	8.81	8.99	9.15	9.11	8.82	9.11	8.61
60	40	32	25	135	0	135	17	20	28	60	60
				EP		EP					

13+19.20 Wly Prop Frankfort St

54.6	53.6	52.0	51.6	51.58	52.81	52.01	52.46	51.36	51.12	51.79	51.8	52.1
6.5	7.5	9.0	9.5	9.44	8.21	9.49	9.66	9.92	9.23	9.28	9.2	8.9
60	33	26	24	133	0	133	18	32	28	40	60	
				EP		EP						

13+16 End Conc Block wall 1.5' high on Lt

53.46	52.2
7.56	8.8
402	402
Top Conc Wall	Ground

13+04 End Inlet Structures RT & Lt

52.0	51.5	51.41	50.55	51.09	51.32	51.06	50.35	51.15	51.2	51.28	51.4
9.0	9.5	9.61	10.27	9.93	10.92	10.67	9.87	9.8	9.74	9.6	
34	27	202	202	135	0	135	202	202			

61.02

52.5 61.02

9.6 51.4

X-SECS MILTON ST. CONT'D.

North Lt. & Rt. South

Sta.

14+04 Deadman (Guy) on Rt.

235
Deadman

14+00 18" Pepper Tree on Rt.

135 28
Tree

13+99.20 Ely Prop Line Frankfort St.

56.5	55.2	54.7	54.4	53.62	53.88	53.12	54.4	55.0	53.9	53.8
5.5	5.8	6.3	6.6	7.40	7.14	7.30	6.6	6.0	7.1	7.2
60	40	31	25	135	0	135	23	25	40	60
				EP		EP				

13+86 3' Palm Tree on Rt.

300
Tree

12" Anchor Guy Pole on Rt

13+86 Deadman Guy on Lt

390
Deadman

Guy Pole
245
Guy Pole

13+81 8" P.P. No 90846-H. on Lt.

293
P.P.

13+59.20 & Frankfort

53.9	52.1	52.1	53.5	52.66	52.90	52.66	52.3	52.6	53.4
7.1	8.9	8.9	7.5	8.36	8.12	8.36	8.7	8.4	8.6
60	40	35	24	135	0	135	20	40	60
						EP			

61.02

X-SEC'S MILTON ST. CONTD.

7-13-53

North Lt. & Rt. South

Sta.
15400

57.4	57.8	58.6	57.6	56.71	56.94	56.74	57.5	58.9	58.6	58.9
3.6	3.2	2.4	3.4	4.31	4.08	4.28	3.5	2.1	2.4	2.1
60	40	29	25	132	0	135	22	26	40	56
				EP						EP

14+98 2' Base Cluster Eucalyptus on Lt.

330
& Trees

14+81 3' Dia Palm Tree on Rt.

310
& Tree

14+75 3' Dia Eucalyptus on Lt.

330
& Tree

8" Pepper Tree on Rt.
14+65 14" Eucalyptus on Lt.

290

14+56 2.5' Eucalyptus on Lt.

& Tree

255
& Tree

14+53 10" Eucalyptus Tree on Lt.

330 280
& Tree & Tree

14+50

56.7	56.4	56.9	56.0	55.14	55.22	55.15	55.4	56.2	56.0	57.0	56.8	57.0
4.3	4.6	2.1	3.0	5.88	5.70	5.87	5.6	4.8	5.0	4.0	4.2	4.0
60	40	30	25	133	0	135	22	25	35	36	40	60
				EP								EP

14+45 10" Pepper Tree on Rt.

285
& Tree

14+18 4' Base Cluster 5-Eucalyptus Trees

320
& Trees

14+13 4' Eucalyptus Tree on Lt.

320
& Tree

14+10 3' Dia Palm Tree on Rt.

300
& Tree

61.02

X-SEC'S MILTON ST. CONT'D.
Sta.

15+71 10" Pepper Tree on Rt.

25°
Tree

15+66 14" Dia Pepper Tree on Rt.

25°
Tree

15+53 16" Dia Palm Tree on Rt.

30°
Tree

15+57 2.5' Dia Eucalyptus on Lt.

T.P. +12.67 ^{73.45} - 0.24 60.78

North Lt. 7-13-53 Rt. South (69)
315 \nearrow 73.45
Tree
59.4 60.5 60.4 59.95 59.63 59.43 60.1 62.0 61.8 62.2
1.6 0.5 0.6 1.57 1.39 1.59 0.9 (-1.0) (-0.8) (-1.2)
50 36 25 132 0 133 24 25 40 60
EP EP

15+50

15+44 10" R. Pale No 4349 on Rt.

275
58.9 58.9 58.9 58.4 58.46 58.62 58.30 P.P. 59.0 60.2 61.8
2.1 2.1 2.1 1.6 2.56 2.46 2.72 2.0 0.8 (-0.3)
60 50 40 26 133 0 133 24 40 50
EP TOP M.H. EP

15+34 20' Alley

15+14 10' Spread Shrub Palm

31°
Shrub

15+06 2' Dia Palm Tree on Rt.

30°
Tree

15+03 3' Dia - 2- Eucalyptus Trees on Lt.

61.02

32°
Trees \nearrow 61.02

7-13-53

(67)

North Lt. & Rt. South

X-SEC'S MILTON ST. CONTD.
Sta.

16+20 14" Eucalyptus on Lt.

305
Tree

16+17 12" Dia Eucalyptus on Lt.

273
Tree

16+16 2'-Dia Cluster Pepper Trees on Rt.

270
Trees

16+11 6" Pepper Tree on Rt.

26
Tree

16+08 2' Dia Eucalyptus on Lt.

305
Tree

16+05 3' Dia Palm on Rt.

295

16+00

63.9	63.9	64.8	64.01	64.31	64.05	64.4	64.4	65.8	66.4	66.9
9.5	9.5	8.6	9.44	9.14	9.40	9.0	9.0	7.6	7.0	6.5
60	40	26	135	0	135	22	26	36	40	60
			EP		EP					

Tree

15+97 14" Base Eucalyptus on Lt.

315
Tree

15+80 4'-Cluster (Dead) Eucalyptus on Lt.

310
Trees

15+73 Deadman (Guy) on Rt.

7345

275
Deadman

7-13-53

X-SECS MILTON ST. CONT'D.
STA.

North. LT ⊕ Rt. South

16+72 30" Twin Eucalyptus on Lt

31°											
⊕ Tree											
68.5	69.2	68.9	71.7	71.22	71.54	71.39	72.1	73.9	74.4	75.4	
4.9	4.2	4.5	1.7	2.23	1.9	2.06	1.3 (-0.5)	(-1.0)	(-2.0)		
60	40	31°	32	24	13.5	0	13.5	22	24	40	60
⊕ Tree		Top Top		E.P.		E.P.					

W/4 Prop Galveston St.
16+69 12" (Dead) Eucalyptus on Lt

16+63 10" Pepper Tree on Rt

26.5
⊕ Tree

16+55 ⊕ 5' Cluster Eucalyptus on Lt

28°
⊕ Trees

16+53 30" Palm on Rt.

16+50

29.5											
⊕ Tree											
67.4	67.8	67.1	69.7	69.3	69.7	69.60	70.2	72.2	72.4	72.8	
6.0	5.6	6.3	3.7	4.02	3.68	3.85	3.2	1.2	1.0	0.6	
60	40	28	23	13.5	0	13.5	23	24	40	60	
		Top		E.P.		E.P.					

16+48 3'-Dia Base Twin Eucalyptus on Lt.

30°
Tree

16+42 10" Pepper Tree on Rt.

27.5
⊕ Tree

16+39 3'-Dia. Cluster Eucalyptus on Lt.

27°
⊕ Trees

16+28 16" Eucalyptus on Lt

73.45

30.5
⊕ Tree 73.45

7-13-53

X-SEC'S MILTON ST. CONTD.
Sta.

North Lt. & Rt. South

17+41.0 Tree Sec on South

77.5	77.3	77.1	76.44	76.76	76.66	77.3	78.2	78.2
8.4	8.6	8.8	9.779	13	9.25	8.6	7.7	7.7
60	40	22	135	0	135	32	40	60
			ER		ER			

17+31 & Sewer M.H.

17+09.08 & Galveston St.

76.4	75.9	75.3	74.31	74.50	74.25	75.2	75.9	77.3
9.5	10.0	10.6	11.60	11.41	11.66	10.7	10.0	8.6
60	40	26	135	0	135	25	40	60
			ER		ER			

16+69.08 Wly Line Galveston St.

~~135 0 135~~
~~ER ER~~

16+85 12" P.P. 1e N=4407 on Rt.

85.91

275
P.P.

16+87 16" Palm Tree on Rt.

TP +12.49 85.91 -0.03 73.42

290
& Tree

16+78 8" Pepper Tree on Rt.

TBM -10.70 62.75

62.72 (Check)

260
& Tree

16+76 30" Eucalyptus on Lt.

73.45

310
Tree

73.45

7-13-53

X-SEC'S MILTON ST. CONTD.

North Lt & Rt. South

19+00

(Alley) 1074-99

+13.01 111.63

18+70 10' P.P. No 4449 on Rt.

T.P. -0.01 98.62

18+50

+129) 98.63

T.P. -0.19 85.72

18+00

17+69 Fire Hydr on Rt.

17+51.2 End A.C. Part Begin Conc. Part Ely

17+49.08 Ely Line Galveston & Top Cut

85.91

100.3	101.0	100.4	101.4	100.26	100.54	100.22	101.3	102.4	102.4	101.6	107.2
11.3	10.6	11.2	10.2	11.37	11.09	11.41	10.3	9.2	8.2	7.0	11
60	40	33	25	135	0	135	24	29	38	40	60
				EP		EP					

111.63

89.7	91.2	91.5	92.3	92.54	92.73	92.54	93.5	97.5	98.6	99.3
89	7.4	7.1	5.3	6.09	5.90	6.09	5.1	7.1	0.0(-1.3)	
60	40	33	25	135	0	135	23	39	40	60
				EP		EP				

98.63

83.1	84.8	84.9	85.4	84.61	84.80	84.78	85.6	87.1	87.9	88.8
2.8	1.1	1.0	0.5	1.30	1.1	1.18	0.3	(-1.2)	(-2.0)	(-2.9)
60	40	30	24	135	0	135	24	30	40	60
				EP		EP				

322

77.61	77.89	77.56
8.24	8.02	8.35
135	0	135
		EP

78.4	78.4	78.2	77.65	77.59	77.41	78.8	82.8	84.7
7.5	7.5	7.7	8.26	8.32	8.50	7.1	3.1	1.2
60	40	25	135	0	135	24	40	60
			EP		EP			

85.91

7-13-53

X-SEC'S MILTON ST. CONT'D

Sta. checked ^{T.A.S.} 8-7-53
 42.28 Top of cut.
 21+48.92 Ely Line Hartford To South - 100
 +12.86 (148.76)

TP -0.39 136.17
 21+33 Toe Sec To South

17.28
 21+23.92 E Hartford To South -

20+92.28 Ely Line Hartford To N.
 20+48.92 Wly Line Hartford To S. (100)

20+80

20+78

20+77 12" P.P. N^o 4511 RT. 27
 20+58.92 E Hartford St To North

20+31.5 12" P.P. N^o 4199 on Rt

TP +13.11 ~~136.44~~ -0.47 ~~123.33~~

OK 20+18.92 Wly Line Hartford St
 +12.76 (123.80)

19+50 111.63 -0.59 111.04

North 11. E Rt. South

139.8	140.4	139.4	136.5	136.04	136.35	136.15	136.1	145.8	145.9
9.1	8.5	9.5	12.4	12.92	12.61	12.81	12.8	3.1	3.0
60	40	30	28	13.5	0	13.3	35	40	60
41 148.96									
131.0	138.4	136.6	133.9	132.48	133.99	133.51	134.6	134.7	134.0
(-2.6)	(-2.0)	(-0.2)	2.5	2.96	2.45	2.93	1.8	1.7	(-0.6)
60	40	30	27	13.5	0	13.5	26	40	60
EP									

137.0	136.4	135.3	132.8	132.49	132.74	132.59	133.6	133.9	136.0
(-0.6)	0.0	1.1	3.6	3.95	3.70	3.85	2.8	2.5	0.4
60	50	40	31	26	13.5	0	24	40	60
EP									

129.9	130.3	130.2	129.4	128.77	129.75	129.08	128.6	133.9	136.1
6.5	6.1	6.2	7.0	7.67	7.29	7.36	7.8	2.5	0.3
60	40	30	26	13.5	0	13.5	38	40	60
126.9	127.7	127.7	126.4	126.15	126.58	126.47	127.2	128.6	131.20
9.5	10.0	10.0	10.04	10.04	9.86	9.97	9.2	7.8	5.2
60	40	30	27	13.5	0	13.5	27	34.5	40.0
124.6	125.3	125.3	125.6	126.15	126.33	126.18	127.1	127.5	131.0
11.8	11.1	11.1	10.8	10.29	10.11	10.26	7.3	7.9	5.4
60	40	30	27	13.5	0	13.5	27.1	34	40
124.84	124.8	124.8	123.83	123.96	123.96	123.76	124.1	125.3	127.6
14.6	11.6	11.6	12.61	12.48	12.48	12.68	11.7	11.1	8.8
40	27	13.5	0	13.5	0	13.5	25	27	40
60									

136.44 (omitted in book) cl

116.7	117.3	120.1	118.84	119.16	119.06	120.6	121.9	123.2	27.0
7.1	6.5	3.7	4.96	4.69	4.74	3.2	1.9	0.6	P.P.
60	40	25	13.5	0	13.5	26	20	60	
104.3	108.6	108.7	109.5	108.12	108.28	108.60	108.7	110.4	111.1
13.0	2.9	2.1	3.51	3.5	3.63	2.9	1.2	0.5	(-0.5)
60	40	25	13.5	0	13.5	27	33	40	(-3)
EP									

X-SEC'S MILTON ST. (CONTD)

Sta. ^{T.A.S.} checked 8-7-53
 21+48.92 Ely Line Hartford To South - 10
 +12.86 (148.76)

TP. -0.39 136.10
 21+33 TOC Sec To South

17.28
 21+23.92 E Hartford To South

20+92.28 Ely Line Hartford To N.
 20+78.92 Wly Line Hartford To S. + 10

20+80

20+78

20+77 12" P.P. N^o 4511 RT. 27

20+38.92 E Hartford St To North

20+21.5 12" P.P. N^o 4199 on RT

TP. +13.11 136.44 -0.47 123.33

OK 20+18.92 Wly Line Hartford St
 +12.76 (129.80)

19+50 111.63 -0.59 111.04

126.4 125.8 124.0 121.3 120.84 121.35 120.85 122.0 122.1 124.4
 (2.6) (2.0) (2.2) 2.5 2.5 2.5 2.5 1.8 1.7 (-0.6)
 60 40 30 27 132 0 135 26 40 60

122.6 124.4 123.8 122.7 120.2 119.85 120.10 119.95 121.0 121.3 123.4
 1.2 6.0 0.0 1.1 3.6 3.9 3.70 3.85 2.8 2.3 0.4
 60 50 40 31 26 135 0 135 24 40 60

117.3 117.7 117.6 116.8 116.13 116.51 116.44 116.0 121.3 123.5
 6.5 6.1 6.2 7.0 7.67 7.29 7.36 7.8 2.5 0.3
 60 40 30 26 133 0 133 38 60 120.3
 114.34 115.1 113.8 113.76 113.94 113.83 114.64 116.0 118.6 120.3
 9.5 8.7 10.0 10.3 9.86 9.77 9.2 7.8 5.2 3.5
 60 40 27 135 0 135 27.5 39 40 60
 112.0 112.7 113.0 113.51 113.79 113.54 114.5 115.9 118.4 120.3
 11.8 11.1 10.8 10.2 10.11 10.26 9.3 7.9 5.4 3.5
 60 40 27 135 0 135 27 34 40 60
 111.5 112.2 112.2 111.9 111.42 111.12 112.1 112.7 115.0 117.3
 12.3 11.6 11.6 12.1 12.48 12.68 11.7 11.1 8.8 6.5
 60 40 27 135 0 135 25 27 40 60

136.44
 116.7 117.3 120.1 118.84 119.16 119.06 120.6 27.0
 71 65 37 49 4 69 474 3 2 1.9 0.6
 60 40 25 132 0 132 26 40 60
 104.3 102.6 108.7 109.5 106.12 106.28 106.30 108.7 110.4 111.1 121.1 114.7
 3.0 2.9 2.4 3.5 3.5 3.63 2.9 1.2 0.5 (-0.5) (-3.1)
 60 40 25 135 0 135 27 33 39 40

X-SEC'S MILTON ST. CONTD.

North St. & Rt. South

Sta.

7< T.A.S. on RT
22+82 End Conc Ramp To Sing Car Gar

157.43
4.06
40.6
157.52
3.97
49.2

N. 13' wide on RT
22+59 Begin Conc Ramp To Sing Car Gar

Conc Ramp Conc floor
157.09
4.40
40.6
Conc Ramp Conc floor
157.27
4.22
49.2

22+59 End woven wire fence

22+50

158.2 157.7 157.8 157.4 150.96 150.70 150.53 40.3
3.3 3.7 3.6 10.1 11.03 10.79 10.26 9.9 4.4 4.3 4.3
60 40 33 26 13.2 0 13.2 20 33 40 60
E.P.

12" (22+17 alley)
22+22.5 P. Pole N^o P. 4549 on RT.

T.A.S. checked o.k.
149.8 150.14 150.4
(-0.9) (-1.2) (-1.5) 4.4 5.28 5.86 5.33 3.9 (-4.2) (-4.3)
60 40 32 26 13.2 8 13.2 23 35 40
161.49
265
143.63 145.0 153.1 153.2
RR

TR +12.60 161.49 -0.07 148.89
22+00

21+63 92 E.C. 15' R. To Woven Wire fence on RT

40.2

21+43.92 B.C. Woven Wire fence 5.5' High on RT

148.96

148.96
55.2
B.C.

Concave To N. R=15'

X-SEC'S - MILTON ST. CONT'D.

North Lt. & Rt. South

23+30 Begin Wooden 2-Rail fence on Lt.

169.42 41°
fence 162.27
(-7.93) (-0.78)
41° 41°
Top Wall. Bot Ftg.

23+30 End Conc Blk Wall 6' High on Lt.

23+08 End 5.5' High Woven Wire fence on Rt.

40°
fence Cor

23+00

163.6	163.5	162.1	155.4	154.59	154.81	154.67	154.4	158.5	157.8	156.1
(-2.1)	(-2.1)	(-0.6)	6.1	6.96	6.68	6.82	6.1	3.6	3.7	5.4
60	40	32	26	13	0	13	21	30	40	60

22+94⁵ Begin 6' Conc Blk Wall on Lt.

169.42 160.71
(-7.93) (-0.78)
41° 41°
Top Wall. Bot Ftg.

22+78 End Conc @ fence

40°
49°
Conc Runn. Conc @
Ely Wall
Grass

22+78 Begin Woven Wire fence on Rt.

161.49
40°
fence

7-13-53

X-SEC'S MILTON ST. CONTR

North Lt

R + South

23+87 Toe Sec. To South

157.5	157.1	157.9	156.44	156.44	156.15	155.8	154.2	153.1
4.0	4.4	4.6	5.05	5.05	5.34	5.7	7.5	8.3
60	40	26	135	0	135	22	40	60
			ER		ER	BR		

23+83 Top Cut Bank To North

161.5	160.9	160.3	156.7	156.28	156.40	156.13	156.39	156.2	156.0
0.0	0.6	1.2	4.8	5.1	5.09	5.36	4.90	5.3	5.5
60	40	33	26	135	0	135	26	40	60
							EMH.		

23+78⁵ End 2-Rail fence on Lt
Top Cut Bnk on South

20' g
fence
cor.

23+71 P.F. N^o 4599

Wly Line. Milton St.
23+68 End Conc Pad To Phone Booth

162.7	161.6	161.1	157.0	156.20	156.28	156.05	156.5	157.4	156.0
(-1.2)	0.0	0.4	4.5	5.29	5.21	5.44	4.9	5.1	5.5
60	40	34	26	135	0	135	20	40	60

23+61 Begin 7' x 3.5' lat. Conc Pad for Phone Booth

40'

N Edge

Top Conc.

23+50

161.49

163.1	163.5	161.7	156.8	156.03	156.12	155.92	156.6	156.4	156.3
(-1.6)	(-2.0)	(-0.2)	4.7	5.46	5.37	5.57	4.9	5.1	5.2
60	40	34	25	135	0	135	20	30	40

161.49

6.0
60

7-13-53

X-SEC'S MILTON ST CONTR
Sta

North Lt & Rt. South

B.M.

-3.85 157.64

158.46	157.21	156.68	156.64	156.60	156.22	155.99	155.11	150.95
3.03	4.28	4.81	4.85	4.89	5.27	5.50	6.38	10.51
75	40	20	132	0	135	20	40	80

to MILTON ST

(24+08.73 FB 2221-27 cpl)
Q. Mon

~~23+59 to Sec to North~~

161.49

161.49

8-10-53

ADDITIONAL
X-SEC'S MILTON ST. CONT'D
Sta.

Lt. & Rt

NOTE: Levels taken with direct
Reading Rod

- Stampel
- ✕ Huffman
- ✕ Sherry
- ✕ Less

El 148.67

22+33.82 & 20' Alley Sec. Nly.

144.7	142.3	154.6	154.4	149.6	148.31	148.73	148.60	149.8	151.1	153.6
75	50	40	33	27	13.5	0	13.5	20	24	34
					EP		EP			

B.M. 150.70

& Sta 22+50 (See Pg 72) $\frac{155.5}{40}$ $\frac{155.3}{50}$

El 97.64

18+84.00 & 20' Alley Sec. Nly.

93.6	95.8	96.4	97.3	98.8	97.79	98.01	97.85	98.9	101.9
75	50	40	31	27	13.5	0	13.5	26	38
					EP		EP		

B.M. 100.54

& Sta 19+00 (See Pg 70) $\frac{102.7}{40}$ $\frac{103.7}{50}$ $\frac{106.0}{70}$

13

26.16

16.80

42.96 (14.37)

3

12

12

09

27

26

27

3) 42.65 (14.2)

3

12

6

6

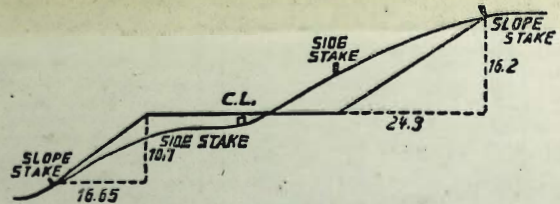

DISTANCES FROM SIDE STAKES FOR CROSS-SECTIONING.
SLOPE 1 1/2 TO 1. ROADWAY OF ANY WIDTH.

	0	.1	.2	.3	.4	.5	.6	.7	.8	.9	
0	0.00	0.15	0.30	0.45	0.60	0.75	0.90	1.05	1.20	1.35	0
1	1.50	1.65	1.80	1.95	2.10	2.25	2.40	2.55	2.70	2.85	1
2	3.00	3.15	3.30	3.45	3.60	3.75	3.90	4.05	4.20	4.35	2
3	4.50	4.65	4.80	4.95	5.10	5.25	5.40	5.55	5.70	5.85	3
4	6.00	6.15	6.30	6.45	6.60	6.75	6.90	7.05	7.20	7.35	4
5	7.50	7.65	7.80	7.95	8.10	8.25	8.40	8.55	8.70	8.85	5
6	9.00	9.15	9.30	9.45	9.60	9.75	9.90	10.05	10.20	10.35	6
7	10.50	10.65	10.80	10.95	11.10	11.25	11.40	11.55	11.70	11.85	7
8	12.00	12.15	12.30	12.45	12.60	12.75	12.90	13.05	13.20	13.35	8
9	13.50	13.65	13.80	13.95	14.10	14.25	14.40	14.55	14.70	14.85	9
10	15.00	15.15	15.30	15.45	15.60	15.75	15.90	16.05	16.20	16.35	10
11	16.50	16.65	16.80	16.95	17.10	17.25	17.40	17.55	17.70	17.85	11
12	18.00	18.15	18.30	18.45	18.60	18.75	18.90	19.05	19.20	19.35	12
13	19.50	19.65	19.80	19.95	20.10	20.25	20.40	20.55	20.70	20.85	13
14	21.00	21.15	21.30	21.45	21.60	21.75	21.90	22.05	22.20	22.35	14
15	22.50	22.65	22.80	22.95	23.10	23.25	23.40	23.55	23.70	23.85	15
16	24.00	24.15	24.30	24.45	24.60	24.75	24.90	25.05	25.20	25.35	16
17	25.50	25.65	25.80	25.95	26.10	26.25	26.40	26.55	26.70	26.85	17
18	27.00	27.15	27.30	27.45	27.60	27.75	27.90	28.05	28.20	28.35	18
19	28.50	28.65	28.80	28.95	29.10	29.25	29.40	29.55	29.70	29.85	19
20	30.00	30.15	30.30	30.45	30.60	30.75	30.90	31.05	31.20	31.35	20
21	31.50	31.65	31.80	31.95	32.10	32.25	32.40	32.55	32.70	32.85	21
22	33.00	33.15	33.30	33.45	33.60	33.75	33.90	34.05	34.20	34.35	22
23	34.50	34.65	34.80	34.95	35.10	35.25	35.40	35.55	35.70	35.85	23
24	36.00	36.15	36.30	36.45	36.60	36.75	36.90	37.05	37.20	37.35	24
25	37.50	37.65	37.80	37.95	38.10	38.25	38.40	38.55	38.70	38.85	25
26	39.00	39.15	39.30	39.45	39.60	39.75	39.90	40.05	40.20	40.35	26
27	40.50	40.65	40.80	40.95	41.10	41.25	41.40	41.55	41.70	41.85	27
28	42.00	42.15	42.30	42.45	42.60	42.75	42.90	43.05	43.20	43.35	28
29	43.50	43.65	43.80	43.95	44.10	44.25	44.40	44.55	44.70	44.85	29
30	45.00	45.15	45.30	45.45	45.60	45.75	45.90	46.05	46.20	46.35	30
31	46.50	46.65	46.80	46.95	47.10	47.25	47.40	47.55	47.70	47.85	31
32	48.00	48.15	48.30	48.45	48.60	48.75	48.90	49.05	49.20	49.35	32
33	49.50	49.65	49.80	49.95	50.10	50.25	50.40	50.55	50.70	50.85	33
34	51.00	51.15	51.30	51.45	51.60	51.75	51.90	52.05	52.20	52.35	34
35	52.50	52.65	52.80	52.95	53.10	53.25	53.40	53.55	53.70	53.85	35
36	54.00	54.15	54.30	54.45	54.60	54.75	54.90	55.05	55.20	55.35	36
37	55.50	55.65	55.80	55.95	56.10	56.25	56.40	56.55	56.70	56.85	37
38	57.00	57.15	57.30	57.45	57.60	57.75	57.90	58.05	58.20	58.35	38
39	58.50	58.65	58.80	58.95	59.10	59.25	59.40	59.55	59.70	59.85	39
40	60.00	60.15	60.30	60.45	60.60	60.75	60.90	61.05	61.20	61.35	40
41	61.50	61.65	61.80	61.95	62.10	62.25	62.40	62.55	62.70	62.85	41
42	63.00	63.15	63.30	63.45	63.60	63.75	63.90	64.05	64.20	64.35	42
43	64.50	64.65	64.80	64.95	65.10	65.25	65.40	65.55	65.70	65.85	43
44	66.00	66.15	66.30	66.45	66.60	66.75	66.90	67.05	67.20	67.35	44
45	67.50	67.65	67.80	67.95	68.10	68.25	68.40	68.55	68.70	68.85	45
46	69.00	69.15	69.30	69.45	69.60	69.75	69.90	70.05	70.20	70.35	46
47	70.50	70.65	70.80	70.95	71.10	71.25	71.40	71.55	71.70	71.85	47
48	72.00	72.15	72.30	72.45	72.60	72.75	72.90	73.05	73.20	73.35	48
49	73.50	73.65	73.80	73.95	74.10	74.25	74.40	74.55	74.70	74.85	49
50	75.00	75.15	75.30	75.45	75.60	75.75	75.90	76.05	76.20	76.35	50

THE NATIONAL BLANK BOOK COMPANY
HOLYOKE MASSACHUSETTS
NEW YORK CHICAGO BOSTON SAN FRANCISCO