

DISTANCES FROM SIDE STAKES FOR CROSS-SECTIONING
SLOPE 1 TO 1. ROADWAY OF ANY WIDTH

	0	.1	.2	.3	.4	.5	.6	.7	.8	.9	
0	0.00	0.10	0.20	0.30	0.40	0.50	0.60	0.70	0.80	0.90	0
1	1.00	1.10	1.20	1.30	1.40	1.50	1.60	1.70	1.80	1.90	1
2	2.00	2.10	2.20	2.30	2.40	2.50	2.60	2.70	2.80	2.90	2
3	3.00	3.10	3.20	3.30	3.40	3.50	3.60	3.70	3.80	3.90	3
4	4.00	4.10	4.20	4.30	4.40	4.50	4.60	4.70	4.80	4.90	4
5	5.00	5.10	5.20	5.30	5.40	5.50	5.60	5.70	5.80	5.90	5
6	6.00	6.10	6.20	6.30	6.40	6.50	6.60	6.70	6.80	6.90	6
7	7.00	7.10	7.20	7.30	7.40	7.50	7.60	7.70	7.80	7.90	7
8	8.00	8.10	8.20	8.30	8.40	8.50	8.60	8.70	8.80	8.90	8
9	9.00	9.10	9.20	9.30	9.40	9.50	9.60	9.70	9.80	9.90	9
10	10.00	10.10	10.20	10.30	10.40	10.50	10.60	10.70	10.80	10.90	10
11	11.00	11.10	11.20	11.30	11.40	11.50	11.60	11.70	11.80	11.90	11
12	12.00	12.10	12.20	12.30	12.40	12.50	12.60	12.70	12.80	12.90	12
13	13.00	13.10	13.20	13.30	13.40	13.50	13.60	13.70	13.80	13.90	13
14	14.00	14.10	14.20	14.30	14.40	14.50	14.60	14.70	14.80	14.90	14
15	15.00	15.10	15.20	15.30	15.40	15.50	15.60	15.70	15.80	15.90	15
16	16.00	16.10	16.20	16.30	16.40	16.50	16.60	16.70	16.80	16.90	16
17	17.00	17.10	17.20	17.30	17.40	17.50	17.60	17.70	17.80	17.90	17
18	18.00	18.10	18.20	18.30	18.40	18.50	18.60	18.70	18.80	18.90	18
19	19.00	19.10	19.20	19.30	19.40	19.50	19.60	19.70	19.80	19.90	19
20	20.00	20.10	20.20	20.30	20.40	20.50	20.60	20.70	20.80	20.90	20
21	21.00	21.10	21.20	21.30	21.40	21.50	21.60	21.70	21.80	21.90	21
22	22.00	22.10	22.20	22.30	22.40	22.50	22.60	22.70	22.80	22.90	22
23	23.00	23.10	23.20	23.30	23.40	23.50	23.60	23.70	23.80	23.90	23
24	24.00	24.10	24.20	24.30	24.40	24.50	24.60	24.70	24.80	24.90	24
25	25.00	25.10	25.20	25.30	25.40	25.50	25.60	25.70	25.80	25.90	25
26	26.00	26.10	26.20	26.30	26.40	26.50	26.60	26.70	26.80	26.90	26
27	27.00	27.10	27.20	27.30	27.40	27.50	27.60	27.70	27.80	27.90	27
28	28.00	28.10	28.20	28.30	28.40	28.50	28.60	28.70	28.80	28.90	28
29	29.00	29.10	29.20	29.30	29.40	29.50	29.60	29.70	29.80	29.90	29
30	30.00	30.10	30.20	30.30	30.40	30.50	30.60	30.70	30.80	30.90	30
31	31.00	31.10	31.20	31.30	31.40	31.50	31.60	31.70	31.80	31.90	31
32	32.00	32.10	32.20	32.30	32.40	32.50	32.60	32.70	32.80	32.90	32
33	33.00	33.10	33.20	33.30	33.40	33.50	33.60	33.70	33.80	33.90	33
34	34.00	34.10	34.20	34.30	34.40	34.50	34.60	34.70	34.80	34.90	34
35	35.00	35.10	35.20	35.30	35.40	35.50	35.60	35.70	35.80	35.90	35
36	36.00	36.10	36.20	36.30	36.40	36.50	36.60	36.70	36.80	36.90	36
37	37.00	37.10	37.20	37.30	37.40	37.50	37.60	37.70	37.80	37.90	37
38	38.00	38.10	38.20	38.30	38.40	38.50	38.60	38.70	38.80	38.90	38
39	39.00	39.10	39.20	39.30	39.40	39.50	39.60	39.70	39.80	39.90	39
40	40.00	40.10	40.20	40.30	40.40	40.50	40.60	40.70	40.80	40.90	40
41	41.00	41.10	41.20	41.30	41.40	41.50	41.60	41.70	41.80	41.90	41
42	42.00	42.10	42.20	42.30	42.40	42.50	42.60	42.70	42.80	42.90	42
43	43.00	43.10	43.20	43.30	43.40	43.50	43.60	43.70	43.80	43.90	43
44	44.00	44.10	44.20	44.30	44.40	44.50	44.60	44.70	44.80	44.90	44
45	45.00	45.10	45.20	45.30	45.40	45.50	45.60	45.70	45.80	45.90	45
46	46.00	46.10	46.20	46.30	46.40	46.50	46.60	46.70	46.80	46.90	46
47	47.00	47.10	47.20	47.30	47.40	47.50	47.60	47.70	47.80	47.90	47
48	48.00	48.10	48.20	48.30	48.40	48.50	48.60	48.70	48.80	48.90	48
49	49.00	49.10	49.20	49.30	49.40	49.50	49.60	49.70	49.80	49.90	49
50	50.00	50.10	50.20	50.30	50.40	50.50	50.60	50.70	50.80	50.90	50

Distance of slope stake from side or shoulder stake for any width roadway, slope 1 to 1. If ground is nearly level, the cut or fill at side stake is located by the double entry method in left column and top row. The number in body of table in same row and column gives distance from side stake to slope stake. If ground is not level estimate the difference in elevation between the side stake and slope stake, lower target by this amount if cut, elevate if fill. Add this amount to cut or fill and find distance in table. Set up rod at this point, and line of sight should cut target. If it does not make the slight adjustment necessary.

INDEX

Page

1-14

{ Cross Sect. Honey cut + Morrel
Pac. Beach Dr. - South.

15.

{ X-sec Jewell Dr. Cosgrove's Rancho
Casitas to 37th
Xsec 'T' St - Jewell Dr. to 38th St

34

X-sec. Fortuna { INGRAHAM
to Crown Pt. Dr.

67

"Ingraham Fortuna to
Pac. Beach Dr

71

X-SECT. ALLEY BIRK-NOBICA MTS #2 DIVISION to
MARINE VIEW

6-23-45% - Honey 1
 40% - Full St.

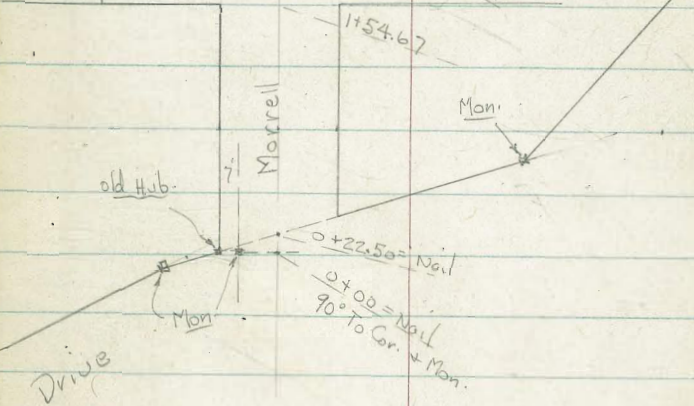
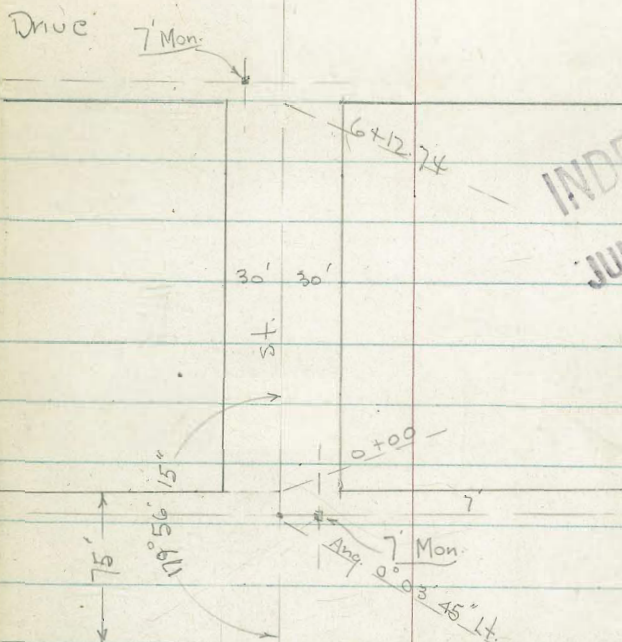
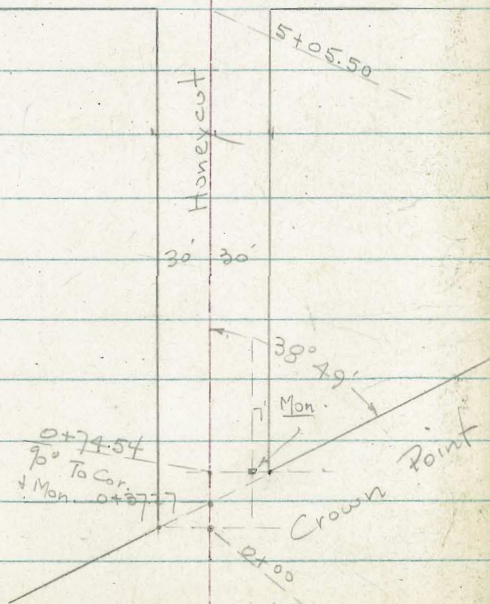
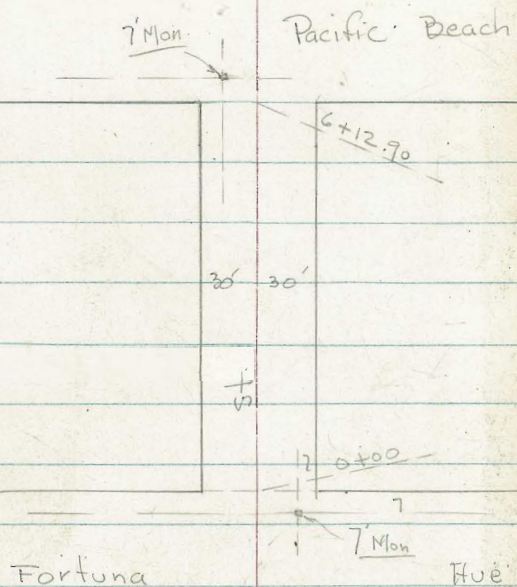

INDEXED
 Law
 JUN 16 1952

X-Sect. Morell - Fortuna

Pacific Beach Dr.

6329

6-11-52-

7.0.

W.O. 32074

1+50

16.6 15.6 15.3 15.0 14.1 13.8
30 20 12 20 30

1+46- 21' Lt. = Φ w.M.

15.29 on pipe

1+35- 32.5' Lt. = Φ 36" Euc.

1+00

15.8 15.6 15.3 15.0 14.6 13.7 13.5 13.4
40 30 20 14 20 30 40
in Divt Dr.

0+97- 25.2' Rt. = Φ w.M.

12.57 = pipe

0+97- 20.3' Lt. = Φ 36" Pepper

0+88- 43' Rt. = Φ Conc. porch - low House.

13.5 13.70
30 43 = porch

0+85- 20.4' Lt. = Φ w.M.

14.58 = pipe

0+75- 20.3' = Φ 16" pepper

0+60- 20.3' Lt. = Φ 24" Pepper

0+50

15.6 15.2 15.1 14.7 14.3 14.0
30 20 15 20 30

0+35- 24.3' Lt. = Φ w.M.

14.94 = pipe

0+31- 20' Lt. = Φ 2.8' Conc. walk

16.45 16.24 16.02
44.2 30 20
d porch

0+10- 22.3' Rt. = Φ w.M.

14.04 = pipe

0+00 = N.L.

17.0 16.3 16.2 15.7 15.8 15.4 15.3 15.1 14.4
75 40 30 20 20 30 40 75

0-37.5 = Φ Fortuna

17.0 16.9 16.9 16.6 16.1 15.6 14.8
100 60 30 30 60 100

B.M. = Nail in SW Pole
Fortuna + Morell

18.18

Actual Elev. shown

3+00

2+89- 22 Rt. = E W.M. 18.47 = pipe

2+75- 30' Lt. = ± 4' Conc. walk

2+61- 21' Lt. = ± W.M. 18.77 = pipe
 30.2 Rt. = S. Cor. of 9' Conc. Dr.

2+50- 30' Lt. = N. Cor. of 8' Conc. Dr.

2+37- 21' Rt. = ± W.M. 16.53 = pipe

2+34- 30.2 Rt. = E 4' Conc. walk

2+28- 30' Lt. = ± 9' Conc. Dr. ✗

2+12- 24.5 Rt. = E W.M. 15.10 = pipe

2+10- 29.7 Lt. = ± 4' Conc. walk

2+06- 30.2 Rt. = end. Dr.

2+00

1+96- 21' Lt. = ± W.M. 15.87 on pipe

1+92- 30.2 Rt. = Ber. Conc. Dr. to Doub. Gar.

1+79- 30' Lt. = ± 9' Conc. Dr.

1+76- 30.2 Rt. = ± 2.5' Conc. walk

~~1+76~~

1+59- 30.1' Lt. = ± 4' Conc. walk

	21.7	21.0	20.6	19.9	19.7	19.5	19.4	19.4
	40	30	20	12		20	30	40
	20.81	20.34						
	50.2 at Porch	30 = walk						
	20.26	20.08	19.3	18.3	18.0	17.8	17.45	17.18
	45 Dr.	30 Dr.	20	13		17	30.2 Dr.	45 Dr.
						16.79	16.77	
						30.2	43.9 = at porch	
	19.39	19.08						
	45 Dr.	30 = Dr.						
	18.93	18.37						
	42 at Porch	29.7						
						14.93 = Dr.		
						30.2		
	18.2	17.5	16.9	16.5	16.5	16.2	15.4	14.9
	40	30	20	13		13	20	30
						14.81	15.20	
						30.2	45.2 = floor	
	17.54	16.73						
	45.4 Dr.	30 = Dr.						
						14.52	14.23	
						30.2 walk	30	
	17.58	16.75						
	at Porch 43.3	30.1 = walk						

Morrel

4

Lt. # Rt.

4+63-21.5 Lt. = # 14" Pepper

4+50

24.5 23.9 23.4 23.2 23.1
30 20 20 30

4+44-21.4 Lt. = # 16" Pepper

4+22-21.2 Lt. = # 12" Pepper

4+22-27.8 Rt. = # w.M.

22.10 pipe

4+02-25.8 Rt. = # w.M.

21.43 pipe

4+00-30' Lt. = sly. of 9' Conc. Dr.

24.63 23.89 23.1 22.5 22.6 22.3 22.1 21.9
51.1 30 20 10 20 30 40

3+87-29.7 Rt. = # 4' Conc. steps to house

floor gar. Dr. 21.69 22.83
29.7 34.6
Bottom Top = Porch.

3+85-30.2 Lt. = # 4' Conc. walk

24.25 23.71
42.5 30.2 = walk
at porch.

3+76-19.1 Lt. = # w.M.

21.88 pipe

3+59-24' Rt. = # w.M.

19.80 pipe

3+51-22.9 Lt. = # w.M.

21.31 on pipe

3+50

22.0 21.8 21.2 21.1 20.5 20.4
30 20 10 20 30

3+39-30.5 Rt. = # 2.5' Conc. walk

20.22 20.15
30.5 45
walk

3+30-30.1 Lt. = # 8' Conc. Dr.

22.58 21.99
50.2 30.1 = Dr.
floor gar.

3+28-30.2 Rt. = # 9' Conc. Dr.

20.28 20.37
30.2 51.6 = Gar. floor
Dr.

3+13-22.1 Lt. = # w.M.

20.40 = pipe

3+08-30.3 Rt. = # 4' Conc. walk

19.74 19.93
30.3 14 = at
walk Porch

3+07-30.2 Lt. = # 4' Conc. walk

21.99 21.37
42.8 at porch 30.2 = walk

Morrell

6+09 - 22.8' Rt. = w.M. 22.41 pipe

6+07 - 22.8' Rt. = $\frac{\text{Top} = \text{Elev. } 25.27}{\text{F.H.}}$ 23.02 = flange at Bottom.

6+03 - 30' Lt. = ϕ 10.5' Conc. Dr.

5+90 - 30.1' Rt. = ϕ 4' Conc. Walk

5+77 - 22.9' Lt. = ϕ w.M. 23.97 pipe

5+75 - 30.1' Rt. = Nly of 9' Conc. Dr.

5+50

5+39 - 22.8' Rt. = ϕ w.M. 22.75 pipe

5+34 - 22.5' Lt. = ϕ w.M. 24.65 pipe

5+30 - 31.5' Lt. = ϕ 3' Conc. Walk

5+17 - 29.8' Rt. = ϕ 8' Conc. Dr.

5+05 - 21.8' Lt. = 34" Pepper

5+00

4+99 - 21.9' Rt. = ϕ w.M. 23.17 pipe

4+94 - 20' Lt. = ϕ 4' Conc. Walk

4+92 - 30.1' Rt. = ϕ 4' Conc. walk

4+88 - 21.5' Lt. = ϕ w.M. 23.69 pipe

4+84 - 21' Lt. = ϕ 20" Pepper

4+72 - 30.1' Rt. = ϕ 8.5' Conc. Dr.

Lt. ϕ Rt. 5

25.93 25.22
45 30
Dr.

22.97 22.95
30.1 43
walk at porch

25.4 24.9 24.2 23.5 23.35 22.71
30 20 20 30.1 49.4
Dr.

25.7 25.2 24.6 23.7 23.5
30 20 20 30

26.30 25.62
45 31.5
walk

23.79 23.30
29.8 45
Dr.

24.9 24.8 24.4 24.4 24.1 23.7 23.7
40 30 20 20 30 40

25.09 24.69 24.56
45.7 30 20
at Porch walk

23.67 23.68
30.1 44
walk at porch

23.42 22.78
30.1 50
Dr.

Morrel

Lt.

±

Rt.

6

Soil Sample taken at 2+50

6+42.74 = ±

27.0 25.4 24.5 24.1 23.54 23.2 22.2 21.8 20.9 19.2
90 50 30 20 5 20 30 50 90

= E. Rim

on Sewer
MH.

6+22.74

27.1 25.6 24.4 24.2 23.5 22.3 21.7 21.0 18.9
90 50 30 20 20 30 50 90

6+12.74 = S. Pacific Beach Dr.

27.3 26.0 25.3 24.1 23.6 23.1 22.7 21.8 20.5
90 50 30 20 20 30 50 90

B.M. = S.W. 7 Mon. Morrel
+ Pacific Beach.

23.53

Lt. E Rt.

Beq. X-Section of Honeycut - Crown Pt. Dr. to Pacific Beach Dr. - Sketch-P. 1

1+59 - 22.7 Lt. = £ 48" Palm

1+50

1+47 - 16.8 = Lt. = £ 2' Brick walk

1+37 - 21.8 Lt. = £ 54" Palm

1+26 - 16.7 Lt. = £ 15" Brick walk

1+12 - 22.7 Lt. = £ W.M.

19.43 pipe

21.6 21.5 - 20.8 21.0 21.3 21.1
30 20 12 20 30

21.67 21.64 21.46
40 30 16.8
walk

21.65 21.69 21.63
40 30 16.7
walk

1+00

21.5 21.3 21.0 21.0 21.2 21.3
30 20 12 20 30

0+87 - 22.7 Rt. = £ F.H.

21.60 = Bottom flange

0+74.54 = opp. NE-Cor.

21.1 21.4 20.7 20.8 21.1 20.8 20.7
30 20 12 20 30 50

0+60 - 22.5 Lt. = £ W.M.

19.23 pipe

0+37.27

20.9 20.5 20.4 20.7 20.9 20.2
30 15 20 30 56 = Top bank

0+29 - 29.2 Lt. = £ 2' Conc. Walk

21.32 21.24
40 29.2 = walk
walk

See B. 1563 for Crown Pt. Dr. sections. ok. yet

0+00 = opp. N.W. Cor.

21.0 20.7 20.3 20.5 20.3 20.8 16.4
30 30 20 11 23 30

B.M. = N.E. 7' Man.

20.85

Prop. Cor.

Top of bank

Honeycut + P.B. Drive

Honeycut

3+00

2+98-30.2 Rt. = £ 4' Conc. Walk

2+88-30.2' Rt. = £ 9' Conc. Dr.

2+85-30.3' Lt. = £ 11' Conc. Dr.

2+69-22.7' Rt. = £ W.M. 18.00 pipe

2+66-22.7' Lt. = £ W.M. 18.45 pipe

2+50

2+48-30.6' = £ 3.5' Conc. Walk

2+40-29.4' Lt. = £ 7' Brick Dr. - 2 strips

2+39-30.1 Rt. = £ 9' Conc. Dr.

2+22-32.5' = £ Dr. - 2 - 18" Brick Strips

2+15-31.3' Lt. = £ 4' Brick Walk

2+00

1+92-22' Lt. = £ W.M. 19.02 pipe

1+67-22' Lt. = £ W.M. 20.03 pipe

8

Lt.

£

Rt.

20.0 19.4 18.7 18.6
30 20 12

18.8 19.2
20 30

19.21
30.2 = walk 19.53
19.37 19.94 at porch
30.2 45.2
Dr. floor gar.

20.30 20.29
40 30.3
Dr.

20.7 20.7 19.8 20.0 20.3 21.1
30 20 12 20 30

20.78 20.67
44.2 30.6
at porch walk

21.00 20.71
43 Dr. 29.4

21.24 21.22
30.1 40
Dr.

21.30 21.23
40 32.5 - Dr.
Dr. 21.45 21.33
40 31.3
walk

21.3 21.0 20.5 21.2 21.1
30 20 20 30

Honey cut

22.7 Lt. = \pm W.M. 17.78 = pipe
 5+05.50 = 2L Fortuna 19.7
 100
 4+95-29.8 Lt. = \pm 3.5 Conc. walk
 4+93-22.5 Rt. = \pm F.H. 17.34 = Bottom
 Flange
 4+88-22.5 Lt. = \pm W.M. 17.17 pipe
 4+75
 4+50
 4+47-22.6 Rt. = \pm W.M. 16.70 pipe
 4+43-22.5 Lt. = \pm W.M. 17.03 pipe
 4+33-30' Rt. = \pm 4' Conc. Walk
 4+15-30.2 Rt. = \pm 9' Conc. Dr.
 4+00 30.6 Lt. = \pm of Conc. Dr. 10'
 3+91-30.4 Rt. = \pm 5' Conc. walk
 3+76-30.2 Rt. = \pm 8' Conc. Dr.
 3+53-23' Rt. = \pm W.M. 17.30 pipe
 3+50
 3+13-23' Rt. = \pm W.M. 17.53 pipe
 3+07-22.2 Lt. = \pm W.M. 18.40 pipe

9
 Lt. \pm Rt.
 19.4 18.9 19.0 18.3 18.3 17.7 17.6 16.6
 50 30 20 20 30 50 100
 19.24 19.50
 46 29.8
 at porch walk
 18.5 18.3 17.8 17.7 18.2 17.5
 30 20 12 20 30
 18.4 18.2 17.5 17.6 17.5 17.7
 30 20 13 20 30
 18.00 17.99
 walk 42.8
 18.00 18.02 at
 30.2 Dr. 40 Porch
 18.40 18.38 18.2 17.8 17.6 18.0 18.0
 40 30.6 20 14 20 30
 Dr. - 18.20 18.11
 30.4 46
 walk 17.95 17.90 at
 30.2 40 Porch
 Dr. -
 18.9 18.7 18.0 17.9 17.9 18.2
 30 20 12 20 30

Honeycut

Lt. \$ Rt.

10

1+10-21.5' Lt. = \$ 4" Cypress

1+07-22.2' Lt. = \$ W.M. 18.95 pipe

1+05-21.5' Lt. = \$ 4" Cypress

1+03-21.5' Lt. = \$ 4" Cypress

1+00

20.9 20.9 20.8 20.6 20.4
30 20 20 30

0+91-22.5' Rt. = \$ W.M. 18.40 pipe

0+95-21.4' Lt. = \$ 6" Cypress

0+90-22.5' Lt. = \$ 3' Conc. walk

21.14 20.88 20.80
47 30 25
at porch walk

0+60-22.9' Lt. = Beg. Rail Fence

0+50-21.6' Rt. = \$ 48" Palm

20.6 20.6 20.4 20.3 20.1
30 20 20 30

0+28-22' Rt. = \$ W.M. 18.03 pipe

0+28-22.1' Lt. = \$ W.M. 18.53 pipe

0+20-22' Lt. = \$ 54" Palm

0+15-20.6' Lt. = \$ 3' Conc. walk

20.01 20.03 20.08
40 30 20.6

0+13-30.2' Rt. = \$ 4' Conc. walk

19.65 19.83
30.2 47.5 at
walk porch

75' N. = N.L. = 0+00 ahead.

20.4 19.8 20.0 19.5 19.9 19.8 19.8 19.5 18.2
100 50 30 20 20 30 50 100

37.5' N. = \$ Fortuna. - Rough Graded.

19.8 19.4 19.2 19.2 19.1 18.8 18.6 18.2 17.3
100 50 30 20 20 30 50 100

8.5' N. - 29.5' Lt. = \$ P. pole # J.P. 1949

Honeycut

2+64- 29.6 Rt. = £ 2' Conc. Walk

2+62- 29.9 Rt. = £ 12" Acacia

2+59- 22.3 Rt. = £ w.M. 21.58

pipe

2+56- 21.9 Lt. = £ w.M. 21.70

pipe

2+50

23.2
30 23.3 23.1 23.0 22.8
30 20 20 30

2+49- 22' Lt. = £ 40" Palm

2+40- 30' Lt. = £ 4' Conc. walk

23.25 23.21
45 walk 30

2+29- 28.6 Rt. = £ 12" Acacia

2+22- 30' Lt. = £ 9' Conc. Dr.

22.70 22.57
45 Dr. 30

2+12- 34.3 Lt. = £ 72" Euc.

2+00 = Sly. of 8' Conc. Dr.

23.09 22.85 21.9 22.0 21.4 21.5
55 Dr. 30.1 20 20 30

1+93- 17.8 + 19' Rt. = £ 4" Euc. Trees

1+78- 22.4 Lt. = £ w.M. 20.10

pipe

1+74- 23' Rt. = £ w.M. 19.60

pipe

1+58- 30.8 Rt. = £ 8' Conc. Dr.

21.57 21.38
30.8 Dr. 50

1+50- 30.8 Rt. = £

21.6 21.4 21.4 21.3 21.3
30 20 20 30 30

1+34- 22.8 Rt. = £ w.M. 19.15

pipe

1+14- 22.7 Lt. = end fence

1+14- 21.4 Lt. = £ 4" Cypress

Honeycut

Lt.

±

Rt.

4+19-30.3 Rt. = ± 9' Conc. Dr.				27.50	27.40
				30.3 Dr.	45
4+00			26.8	26.9	26.5
			30	20	
3+99-22' Lt. = ± 40" Palm				26.7	26.8
				20	30
3+94-21.8' Lt. = ± W.M.	24.55	pipe			
3+88-30.6' Lt. = ± 2' Conc. walk			26.90	26.70	
			44.6	30.6	
			at porch.		
3+74-22' Lt. = ± 48" Palm					
3+60-22.3' Rt. = ± W.M.	23.60	pipe			
3+50			25.9	25.7	25.7
			30	20	
				25.8	25.7
				20	30
3+48-28' Rt. = ± 2' Conc. walk				25.66	25.68
				28	48.4' at House
				walk	
3+47-22' Lt. = ± W.M.	23.86	pipe			
3+38-31' Lt. = ± 2' Conc. walk			25.81	25.65	
			43.7	31	
			at porch	walk	
3+24-22.2' Lt. = ± 40" Palm					
3+20-28.2 Rt. = ± 8' Conc. Dr.				24.55	24.47
				28.2 Dr.	45
3+00			23.9	24.0	24.4
			30	20	
				23.7	23.7
				20	30
2+95-29.6 Rt. = ± 3' Conc. walk				23.70	23.78
				29.6	45
				walk	
2+65-22.2 Rt. = ± W.M.	21.22	pipe			

Honeycut

5+72- 21.8 Lt. = \pm 40" Palm

5+58- 31' Lt. = \pm 2.5' Conc. Walk

5+50- 21.4' Rt. = \pm 40" Palm

5+41- 32.5' Rt. = \pm 4' Conc. walk

5+28- 30.8' Lt. = \pm 9' Conc. Dr.

5+21- 32' Rt. = \pm 8' Conc. Dr.

5+14- 21.3' Lt. = \pm 24" Palm

5+07- 32.4' Lt. = \pm 3.5' Conc. Walk

5+05- 22.7' Rt. = \pm w.M. 27.20 pipe

5+00

4+99- 22.4' Lt. = \pm w.M. 27.70 pipe

4+83- 21.7' Lt. = \pm 40" Palm

4+65- 30' Lt. = \pm 10' Conc. Dr.

4+53- 22.1' Lt. = \pm 30" Palm

4+50

4+44- 22.3' Rt. = \pm w.M. 26.85 pipe

4+35- 22.1' Lt. = \pm w.M. 26.12 pipe

4+29- 30.5' Lt. = \pm 3.5' Conc. Walk

4+21- 21.8' Lt. = \pm 40" Palm

Lt.

\pm

Rt.

31.26
47.2
at Porch

31.02
31

30.7 30.4 30.2
30 20

30.2 30.1
20 30

29.96 30.05
32.5 42.6 = at porch

30.62 30.33
45 30.5
- Dr. -

29.45 29.66
32 51.1 = floor gar.
Dr.

29.97 29.68
46.4
at porch walk = 32.4

29.5 28.9 29.0 28.8 28.8
30 20 30

28.58 28.44
45 - Dr. 30

28.1 27.8 27.7 27.9 27.9
30 20 20 30

27.79 27.77
47.8 30.5
at porch

Honey cut

Lt.

±

Rt.

Soil Sample taken at 4th - N. of Fortune

6+42.90 = ±

33.0	32.9	32.8	32.32	32.0	31.6	30.5
100	50	30	on S. Rim of Sewer M.H.	30	50	100

6+12.90 = S.L. Pac. Beach Dr.

32.3	32.6	32.3	31.8	31.8	31.6	31.5	31.1	30.5
100	50	30	20		20	30	50	100

6+02-22' Lt. = ± 36" Palm

5+82-33.4' Rt. = ± 2.5' Conc. Walk

30.91	30.87
33.4	41.7 at Porch.

5+80

31.6	31.3	30.9	31.1	30.7
30	20		20	30

5+75-21.9 Rt. = ± 36" Palm

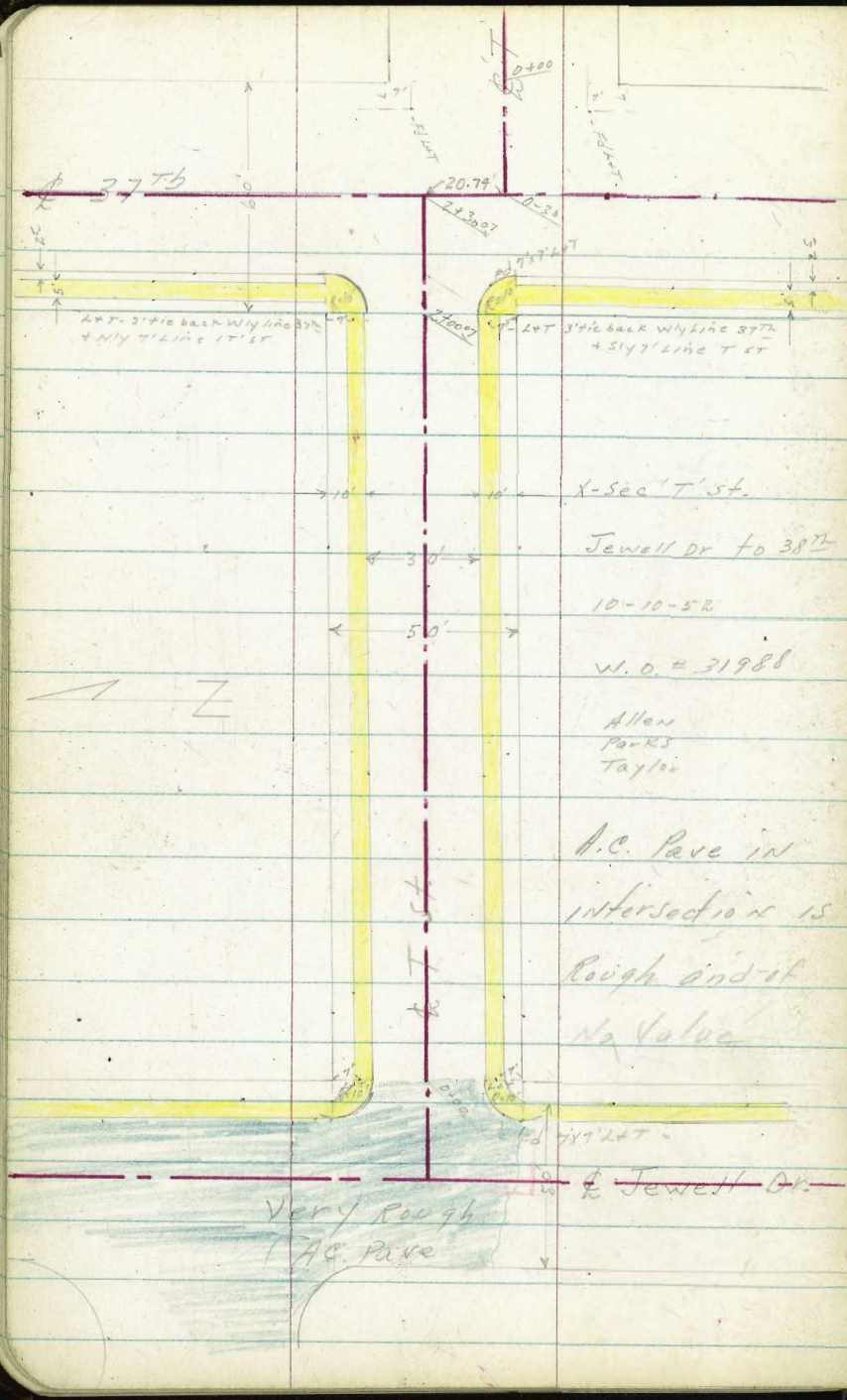

X-SEC 'T' ST.
 Jewell Dr to 38th
 10-10-5R
 W.O. # 31988
 Allen
 Parks
 Taylor

A.C. Pavc in
 intersection is
 Rough and it
 No Value

Very Rough
 A.C. Pavc

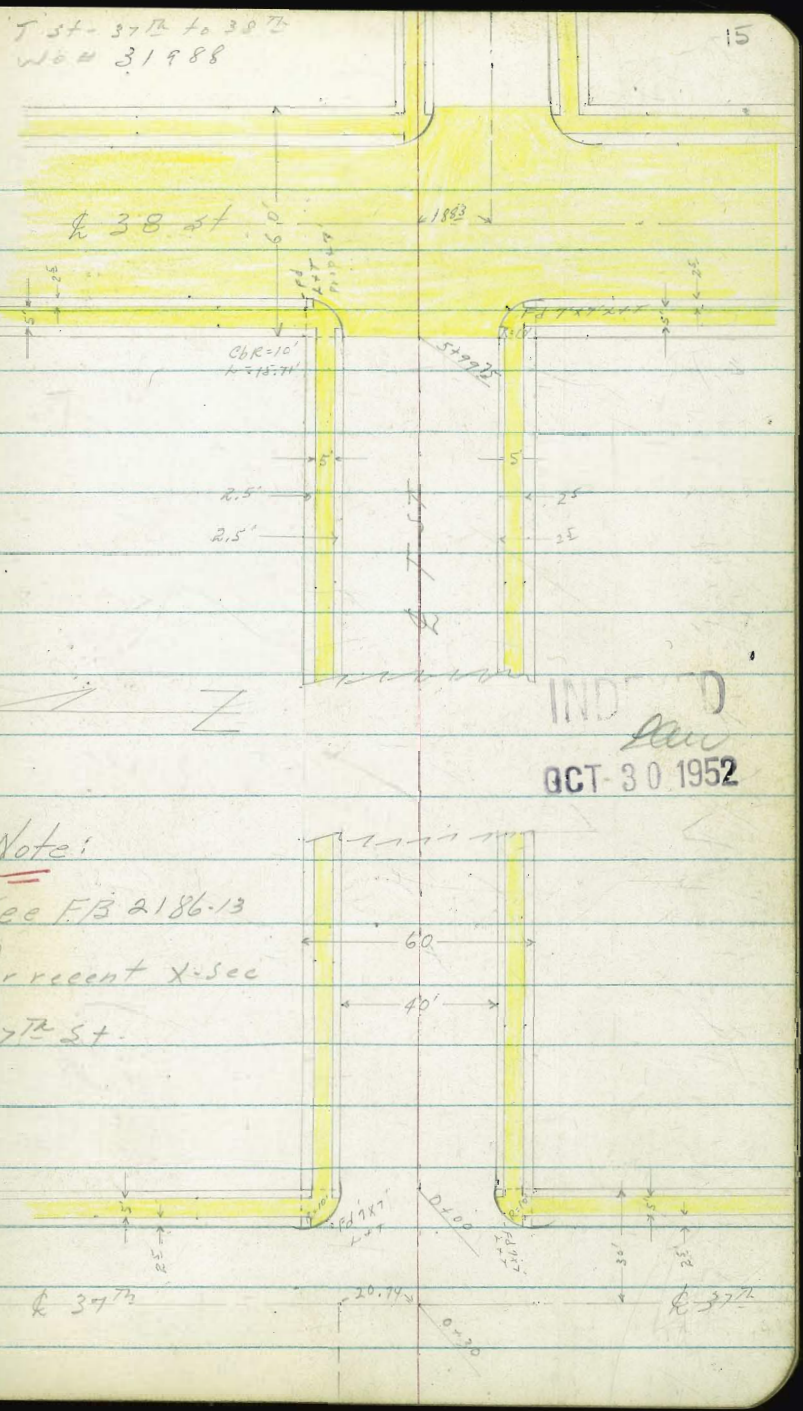

Note:
 See F/B 2186-13
 for recent X-SEC
 37th St.

IND. D
 OCT-30 1952

X-sec Jewell Dr from
 Crosgrove's Rancho Casitas
 To 37th
 10-10-52

WO# 31988

Indexed

Note: L&T on T-Line
 along Jewell Dr. do NOT
 line up well-

$\Delta = 90^\circ$
 PL Rad. = 100

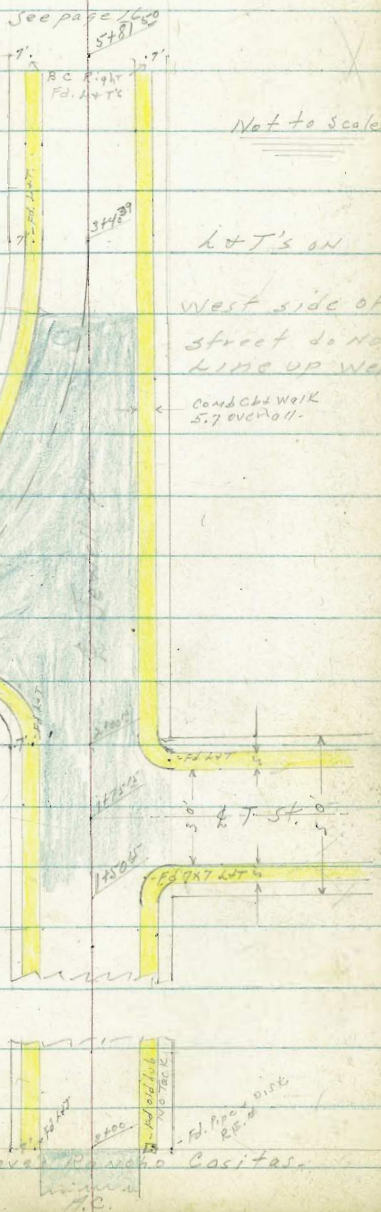

X-sec Jewell Dr from
 Crosgrove's Rancho Casitas
 To 37th
 WO# 31988
 10-10-52

5' walks with 7' wide Cb.

Not to scale

L&T's on

West side of
 street do NOT
 line up well

Comb. Cb. Wk.
 5.7 overall.

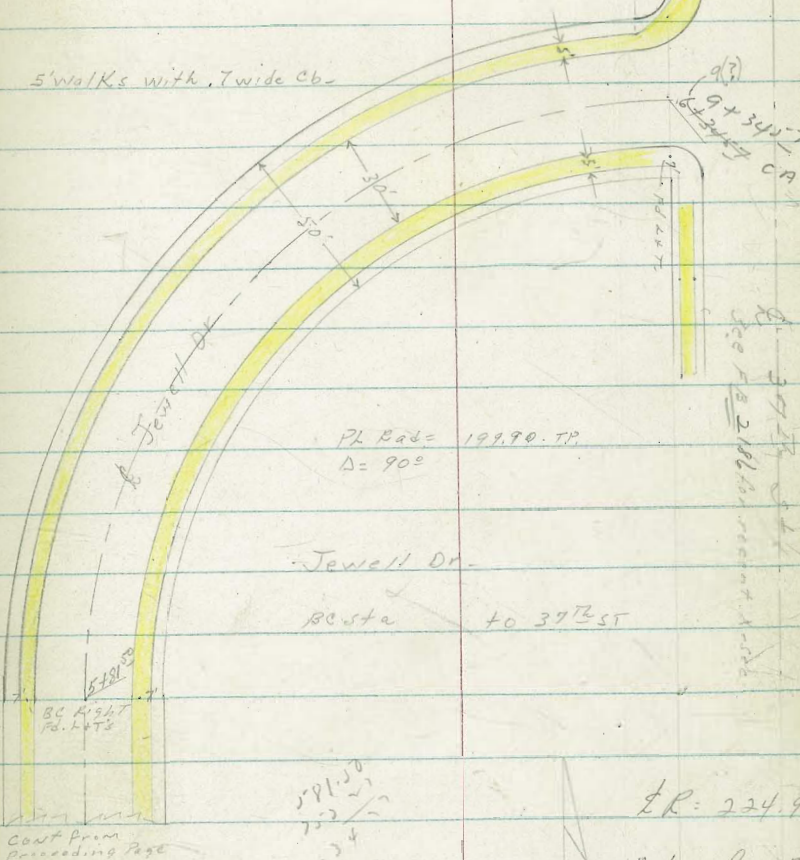

Ref. TP 354

1748-L

TP 355

2923-L

1749-L

Why line Crosgrove's Rancho Casitas

X-sec 17.1. Jewell Dr to 38257
 WO#31988 See sketch Page 15.

LT = North

£

RT = South 17

CONC floor - Apron from back walk to Gar. floor

0+82. 30' RT = £ 2 car Garage - Nine feet curb broken
 out but Not official Driveway

66.9	66.55	66.59	61.79
64	67	67	553
14 1/2	14 1/2	20	30
G	cb	WIK	Gar floor
		FROM	

0+80

66.51	66.35	65.5	65.5	64.9	65.36	65.49
68	69	78	78	8	796	783
210	155	150		144	142	20
WIK	cb	G		G	cb	WIK

0+00 = Ely line Jewell Dr

65.13	64.99	64.7	64.4	63.6	64.02	64.12
89	833	91	89	97	930	920
210	155	150		142	142	200
WIK	cb	G		G	cb	BE WIK

0-03 = Mid point of S.E + NE Returns

64.90	64.3	63.4	63.87
82	90	99	945
162	162	162	162
cb	G	G	cb.

0-10 = Ely Curb line Jewell Dr

64.97	64.6	64.88	64.5	64.3	64.2	63.5	63.1	63.62	62.8	63.42
830	87	8	88	90	91	98	102	970	105	990
35	35	25	25	15		15	25	25	30	35
cb	G	cb	G			G	GUT	cb	G	cb.

0-25 = £ Jewell Dr - for outs see X'sec Jewell Dr.

this book

64.1	63.9	63.8	63.6	63.1	62.7	62.2
92	94	95	92	101	106	111
40	25	15		12	24	40

BM 2.18 73.32

W.B.P.
 372 + 757
 71.14

73 32

Lt = North

Right = Sec 18

TP, (start) 12.47 836 2.18 71.14

24300' 37th st

72.2	71.4	71.1	70.7	70.7	70.6	70.5
1	19	22	2	26	27	28
50	25	15		15	25	50

For outs see recent X-sec of 37th st.
24100' Wly curb line so. 37th st.

71.98	71.2	71.13	70.5	70.1	69.9	69.5	69.5	69.47	69.4	69.23
134	2	29	28	32	34	38	38	35	32	35
50	50	25	15	15		15	25	25	50	50
cb	G	cb	G	cb		G	G	cb	G	cb

Note - See FB 2166-13 for recent
X-sec 37th

240700' = mid point S.W + N.W. Returns

70.95	70.1	69.3	69.85
237	32	40	347
164	164	160	160
cb	G	G	cb

24000' Wly line 37th st. curb 13e's

71.01	70.88	70.0	69.7	69.2	69.82	69.87
231	244	33	36	41	350	345
212	152	152	144	144	144	144
WIK	cb	G	G(100)	G(100)	cb(100)	WIK 200

1450

69.50	69.43	68.8	68.7	68.3	67.9	68.43	68.60
582	389	45	46	50	54	488	472
210	155	152	82	144	144	144	200
Walk	cb	G		G	G	cb	WIK

1400

68.14	67.92	67.1	67.2	66.8	66.4	66.96	67.09
520	540	62	61	65	62	636	623
212	152	152	8	144	144	144	200
WIK	cb	G		G	G	cb	WIK

73.32 T

Lt. North ♀ Rt. South 19

7
1400
R
78.34
527
275
WIK
78.10
551
200
Cb
77.2
61
200
G
77.8
58
200
G
77.5
61
200
G
78.39
522
200
Cb
78.60
521
275
WIK

0+75-
2
76.69
692
275
WIK
76.52
709
200
Cb
75.6
82
200
G
76.3
73
200
G
75.7
72
200
G
76.52
709
200
Cb
76.67
694
275
WIK

0+50
R
76.18
743
275
WIK
75.02
852
200
Cb
74.3
93
200
G
74.6
90
200
G
74.2
94
200
G
74.80
881
200
Cb
74.91
864
275
WIK

0+00 = Curb B's Right + Left. Ely line 37th
R
72.16
1145
275
WIK
71.87
1174
200
Cb
71.3
123
200
G
71.9
112
200
G
71.1
124
200
G
70.99
1262
200
Cb
71.8
1245
275
WIK

0-03 = Mid point S.E. + N.E. Returns
71.91
1170
217
Cb
71.2
124
217
G
70.9
127
220
G
70.99
1262
220
Cb
Dirt
over
Ret.

0-10 = Ely Comb line 37th
for outs see recent X sec 37th
74.79
882
100
Cb
74.2
94
100
G
71.90
1166
30
Cb
71.1
125
30
Cb
71.1
125
20
71.4
122
20
70.8
128
20
70.6
130
30
Gbc
70.94
1267
30
Cb
70.0
136
100
G
70.31
1324
100
Cb

83.61

2400

Lt = North

Rt = South 20

83.06	82.86	82.2	82.9	82.7	83.47	83.66
912	932	100	93	92	82	852
275 W	200 Cb	200 G	200 G	200 G	200 Cb	275 WIR

2 TP₂ 9.10 92.18 0.53 83.08

92.18

1491-198 Lt = R 10' Conc Drive Way

82.79	82.67	81.94
082	094	167
325 Dr	225 Dr	198 Dr G

1475

82.14	81.91	81.2	81.9	81.9	82.53	82.67
142	170	54	12	12	108	094
275 WIR	192 Cb	192 G	200 G	200 Cb	200 Cb	275 WIR

1450 - Curb shot taken 1' ahead

81.05	80.88	80.3	80.8	80.6	81.43	81.61
286	273	33	28	30	218	200
275 WIR	198 Cb	198 G	200 G	200 Cb	200 Cb	275 WIR

1445-192 Lt = R 12' Conc Driveway

80.84	80.70	79.99
277	281	362
325 Dr	225 Dr	192 G

1425

79.71	79.49	78.6	79.3	79.1	79.94	80.10
390	412	50	43	45	307	351
275 WIR	200 Cb	200 G	200 G	200 G	200 Cb	275 WIR

83.61

3482 - 20° Lt = 13' Drive Way

3450

3407 - 20° Rt = 13' Conc Drive

3400

2450

2425

87.79
439
325
Dr

87.69
459
225
Dr

86.98
520
200
Lip G.

86.80
538
275
W

86.68
550
200
Cb

86.0
600
200
G

86.7
55

86.2
60
192
G

86.90
528
198
Cb

87.08
510
275
W

85.50
608
200
G

86.13
605
225
Dr

86.29
589
325
Dr

85.57
661
275
W

85.43
675
200
Cb

84.7
75
200
G

85.5
62
200
G

85.2
70
200
Cb

85.86
632
200
Cb

86.04
612
275
W

84.32
726
275
W

84.15
803
200
Cb

83.6
80
200
G

84.2
80

84.1
81
200
G

84.79
739
200
Cb

85.00
718
275
W

83.78
840
275
W

83.57
861
200
Cb

82.9
90
200
G

83.6
86
200
G

83.5
82
200
Cb

84.22
796
200
Cb

84.40
778
275
W

92.18

Lt = North

R

Rt = South 22

5750

91.90	91.68	90.9	91.7	90.52	90.96	91.12
530	552	63	61	67	624	608
275 W	192 Cb	192 G		200 G	200 Cb	275 W

TP3

6.88

97.20

1.86

90.32

97.20

5700

90.64	90.43	89.7	90.2	89.4	89.93	90.09
154	175	25	20	22	225	209
275 W	200 Cb	200 G		200 G	200 Cb	275 W

4756 - 20° Lt = R

CONC Driveway

89.67	89.35	88.74
251	283	344
325 Dr	225 Dr	200 G

4750

89.30	89.10	88.6	89.1	88.4	88.99	89.17
288	308	36	37	38	319	301
275 W	200 Cb	200 G		192 G	192 Cb	275 W

4707 - 20° Lt = R 13' CONC Driveway

88.57	88.36	87.56
307	382	462
325 Dr	225 Dr	200 G

4700

88.09	87.98	87.3	88.0	87.3	87.83	87.99
409	420	49	42	49	435	418
275 W	200 Cb	200 G		192 G	192 Cb	275 W

92.18

LT: North ⊕ Rt: South

S.E. BP 38th St

T.P. BM

530

91.90 (91.99)

6+29⁷⁵ = ⊕ 38th St.

91.17
303
100

92.98
422
30

92.50
470

91.94
526
30

89.92
728
110

91.10
310
100
CL

89.71
749
110
CL

6+09⁷⁵ Wly Curb line 38th St

92.41
379
100
G

92.94
426
300
CL BC

92.40
480
300
G BC

92.40
480
20

92.44
476
10

92.29
421

92.00
520
10

91.64
556
20

91.33
587
300
G BC

92.03
527
300
CL BC

89.14
806
110
G

6+06⁷⁵ = Mid point NW + SW Returns

92.87
433
230
CL

92.25
495
230
G

91.49
521
230
G

92.02
518
230
CL

5+99⁷⁵ - Wly line 38th + Begin Cone Pavement

92.14
406
270
W

92.90
430
200
CL BC

92.10
510
200
G BC

92.30
490
100

92.21
498

91.98
522
100

91.44
576
200
G BC

91.98
522
200
CL BC

92.22
498
270
W

97.20 X

X-sec Jewel Dr - Cos Groves Ranch Caritas
 to 37th St. See sketch Pages 16-
 No. # 31908-10-28-52

Lt = West

Rt = East 24

1400

61.59	61.37	60.5
8 1/2	8 3/4	9 1/2
20 1/2	14 1/2	14 1/2
WIK	Cb	G

61.1	60.9	61.80	62.04
8 1/2	8 3/4	7 1/2	7 1/2
15 1/2	15 1/2	21 1/2	21 1/2
G	Cb	WIK	

0458-14³ Lt = 10' Conc Drive

60.41	60.05	59.32
9 2/3	9 6/8	10 3/8
18 1/2	18 1/2	14 1/2
PR	D-	WIP

0450

59.73	59.67	58.9	59.2	59.3	59.90	60.11
9 1/2	10 1/3	10 1/2	10 1/2	10 1/2	9 1/2	9 1/2
19 1/2	14 1/2	14 1/2	15 1/2	15 1/2	21 1/2	21 1/2
WIK	Cb	G	G	Cb	WIK	WIK

0442-15⁵ Rt = 11' Conc Driveway

59.85	59.87	60.17
10 6/8	9 1/2	9 1/2
15 1/2	21 1/2	21 1/2
DRIP	PRSD	PR

0413 14⁵ Lt = 11' Conc Driveway

57.75	58.11	58.05	57.49
11 1/2	11 1/2	11 1/2	12 1/2
30	20 1/2	16 1/2	14 1/2
PR	WIK	PR	WIP

End H.C. Pavement

0400-Nly line Cos Groves Ranch Caritas

57.40	57.59	57.75	57.95	57.71	57.84	57.69	58.17	58.34
12 3/8	12 1/2	12 1/2	12 1/2	11.99	11.86	12 1/2	11 1/2	11 3/8
20 1/2	14 1/2	14 1/2	10	10	10	15 1/2	15 1/2	21 1/2
WIK	Cb	G				G	Cb	PRSD WIK

TP, 5.79 69.70x 8.79 63.91

69.70 T

BM 1.56 72.70

NW 1/4 37 1/2 + T 1/4
 71.14

Lt = West

Rt = East 24

1475¹⁵ - E 'T' st to east

60 ¹⁵	61 ⁵⁵	62 ³¹	63 ⁶	64 ²	64 ⁴	64 ⁸
20 ¹	14 ⁶	14 ⁶	14 ⁶	14 ¹	13 ¹	12 ¹
WIK	CB	G				

1460¹⁵ - Sky curb line 'T' st to east

63 ³⁵	63 ²⁸	62 ⁶	63 ²	63 ¹⁰	63 ⁵	64 ⁰⁰	64 ¹	64 ⁶¹
20 ¹	14 ²	14 ²	14 ²	14 ²	14 ²	14 ²	14 ²	14 ²
WK	CB	G						

1457 = Mid point return S.E. Cor

63 ³	63 ⁷⁴
14 ²	14 ²
G	CB

also begin rough A.C. Pavc - No good.

1450¹⁵ Sky line 'T' st. Curb BC on Right

63 ¹⁵	63 ⁰²	63 ⁴	63 ⁸	63 ¹	63 ⁶⁰	63 ⁸⁰
20 ¹	14 ²	14 ²	14 ²	14 ²	14 ²	14 ²
WIK	CB	G				

1443 - 14² Lt = E 11' Conc Driveway

62 ⁷⁵	62 ⁹⁴	62 ³¹
28 ⁵	18 ⁵	14 ⁴
Dr	B.K	LIP

1425

62 ³⁴	62 ¹⁸	61 ⁵	61 ⁹	61 ⁹	62 ⁹²	63 ¹²
73 ⁶	75 ²	8 ²	78	78	67 ⁸	65 ⁸
20 ¹	14 ⁴	14 ⁴	14 ⁴	14 ⁴	14 ⁴	21 ⁰
WK	CB	G			CB	WK

69.70 *

2150

2125

For S.W. & N.W. Curb returns see page #29.

and Curb B.C. N.E. Curb return
2100¹⁵ Begin fair 2" A.C. pavement

14990¹ Curb + Prop B.C. on West - 5/4 line 'T' st to west

14931⁵ Mid point on N.E. Return 'LT' st.

1490¹⁵ Nly Curb line 'T' st to east

Lt = West			Rt = East 26		
61.3	63.2	64.0	64.9	65.3	65.83
8 ¹	6 ¹	5 ¹	4 ⁸	4 ⁴	3 ⁸⁷
50	54	10	15 ¹	15 ¹	21 ¹
			G	CB	WK
62.70	61.8	62.53	64.3	64.7	65.32
700	79	77	5 ¹	5 ⁰	4 ²⁰
35 ¹	35 ¹	25 ⁰	15 ¹	15 ¹	21 ¹
86	G	15	G	CB	WK

64.21	64.04	63.4	63.9	64.5	64.82
5 ¹	5 ⁶⁶	6 ¹	5 ⁸	5 ²	4 ⁸⁸
20 ¹	14 ¹	14 ¹	15 ¹	15 ¹	21 ¹
WK	CB	G	G	CB	WK

64.21	64.04	63.4	63.9	64.5	64.82
5 ¹	5 ⁶⁶	6 ¹	5 ⁸	5 ²	4 ⁸⁸
20 ¹	14 ¹	14 ¹	15 ¹	15 ¹	21 ¹
WK	BC	BC	G	CB	WK

64.4	64.87
5 ¹	4 ⁸³
18 ⁰	18 ⁰
G	CB

63.97	63.87	63.3	63.8	64.4	64.4	64.97	64.7	65.22
5 ¹	5 ⁸³	6 ¹	5 ¹	5 ¹	5 ¹	4 ¹	5 ¹	4 ¹
20 ¹	14 ¹	14 ¹	15 ¹	15 ¹	15 ¹	21 ¹	21 ¹	21 ¹
WK	CB	G	G	CB	CB	CB	CB	CB

6970 X

3456 - 15' RT = ϕ 8' Conc Driveway

3454 - 14' LT = ϕ 10' Conc Dr

3440³⁹ Curb & Prop BC ON WEST

3400

2475

TP₂ 74⁴ 72.93 4.21 65.49

2457 - 15' ^(RT) LT = ϕ 9' Conc Driveway

LT = West

Right = East

66.51	67.01	66.90	66.33
64 ²	59 ²	60 ³	64 ⁰
30 ³	20 ³	17 ²	14 ²
DR	DR	DR	DIP

66.70	66.53 ⁵	66.60	66.6
62 ³	63 ⁸	69 ⁶	66.6
20 ³	14 ²	14 ²	13 ³
WK	CB	G	67.0
			67.81
			51 ²
			15 ²
			20 ²
			WK

64.78	64.72	64.2	64.9	66.0	66.2	66.88	67.05 ¹
81 ⁵	82 ¹	87 ²	80 ⁰	69	67	60 ⁵	588
28 ¹	22 ²	22 ²	15 ¹	6	15 ²	15 ²	20 ⁸
WK	CB	G			G	CB	WK

62.98	62.4	63.6	64.5	65.4	65.5	66.29	66.49
99 ⁵	105 ²	93 ³	84 ⁵	75 ⁵	74 ⁴	64 ⁴	644
35 ²	35 ²	25 ¹	15 ¹	14 ²	14 ²	15 ²	21 ²
CB	G			CB	CB	CB	WK

72.93

65.44	66.04	66.15 ⁵	
42 ⁹	366	355	
15 ²	16 ²	21 ²	31 ²
DIP	DR	WK	DR

69.70

Lt = West

±

Rt = East

28

Cont. on Page 30

TP3 3.35 76.20 0.08 72.85

5+00

69.32	69.16	69.0	69.7	69.8	70.13	70.34
361	371	39	32	31	280	259
205	142	149		150	152	206
WIK	Cb	G		G	Cb	WIK

4+58-15' Rt = ± 13' Conc Driveway

68.96	69.58	69.73	73.13
327	335	320	324
150	180	202	302
LIP	Dr	Dr	Dr

4+50

68.54	68.43	68.1	68.6	68.7	69.35	69.53
439	450	48	4	42	358	340
205	142	141		150	152	202
WIK	Cb	G		G	Cb	WIK

4+06-15' Rt = ± 8' Conc Driveway

68.24	68.88	68.93	71.18
469	405	400	125
152	175	202	302
LIP	Dr	Dr	Dr

4+00

67.81	67.74	67.3	67.8	68.2	68.73	68.86
512	519	516	51	42	420	407
202	142	142		151	151	202
WIK	Cb	G		G	Cb	WIK

72.93

1760	Gut 10.88 56.70	Cb 1028 57.50	Q 10 33 57.25
1740	58.37 921	58.65 893	58.51 907
1720	59.67 791 2.100 Dr.	No Curb (Driveway)	59.86 72
1700	60.80 678	61.14 644	61.38 620
0480	61.80 578	62.27 531	62.84 474
0460	63.01 457	63.54 404	64.35 323
0440	64.23 335	64.75 283	65.49 209
0420	65.20 238	65.80 178	66.23 151
BC Jewell Dr 0400	65.97 161 G	66.55 103 Cb	66.62 096 Q
			171

67.58 ↑

Northwest Curb Return - Jewell Dr and T' St. 160' of curb starting at BC, on Jewell Dr laid off in 20' sections. Shots on E' T' St to West taken Radial from 20' Points on Curb.

			Shot 40' West of Curb EC on T' St	58.48 910 Gut.	58.98 860 Curb
				Gut.	Curb
			(PRD) EC on T' St	60.63 6.95	61.45 6.13
			3/4	61.98 6.20	62.38 5.20
			1/2	62.39 5.19	63.30 4.28
			1/4	63.14 4.44	63.90 3.68
			BC Jewell Dr.	63.42 4.16 Gut	64.03 3.55 Cb
				<u>67.58</u> ↑	

Southwest Curb Return - Jewell Dr & T' St. 54' in length - Divided into 4 parts 13' each BC on Jewell Dr.

64065° 3°11.06'

T.P. 10.59 81.02 5.77 70.43

5481.50 = BC Right - Δ = 90° & R = R.R.S

5460 - 15° Rt = 13' Conc Driveway

5440

5413 = end Fair A.C. Pave. Needs Replacing

5413 - 15° Rt = 8' Conc Driveway

Lt = West

Rt = East

30

70.92	70.78	70.6	71.3	71.3	71.74	71.96
10 1/2	10 2/4	10 1/2	9 2	9 2	9 2 1/2	9 0 1/2
20 1/2 WK	15 1/2 CB	15 1/2 G.	15 1/2 G	15 1/2 CB	20 1/2 WK	

81.02

70.47	70.39	70.2	70.8	70.8	71.30	71.44
5 7/3	5 8/1	6 0	5 1/2	5 1/2	4 9/0	4 7/6
20 1/2 WK	14 1/2 CB	14 1/2 G	15 1/2 G	15 1/2 CB	20 1/2 WK	

70.32	70.97	71.04	72.04
5 8/0	5 2/3	5 1/2	4 1/6
14 1/2 1/2 P	17 1/2 1/2 P	20 1/2 1/2 P	30 1/2 1/2 P

69.93	69.76	69.4	70.2	70.2	70.66	70.88
6 2/7	6 4/4	6 1/5	6 0	6 0	5 5/4	5 3/2
20 1/2 WK	14 1/2 CB	14 1/2 G	15 1/2 G	15 1/2 CB	20 1/2 WK	

69.95	70.40	70.45	71.47
6 2/5	5 8/0	5 7/5	4 7/3
15 1/2 1/2 P	17 1/2 1/2 P	20 1/2 1/2 P	30 1/2 1/2 P

76.20

Lt. Westerly & Rt. Easterly

31

7406⁵⁰ 15° 55.30'

73.42	73.39	72.9	73.3	72.9	73.79	73.93
76°	76°	81	72	81	72°	70°
20° WK	15° Cb	15° G		14° G	14° Cb	20° WK

6491⁵⁰ - 149 Lt = & 10' Conc Drive

72.66	72.96	72.95	72.66
83°	80°	80°	83°
30° Dr	20° Dr	15° Dr	14° Dr

6481⁵⁰ 12° 44.24'

72.71	72.67	72.3	72.8	72.6	73.22	73.38
83°	83°	82°	82°	82°	76°	76°
20° WK	14° Cb	14° G		14° G	14° Cb	20° WK

6476 - 146 Rt = & 10' Conc Drive

72.59	73.19	73.25	74.88
84°	78°	77°	61°
14° Dr	17° Dr	20° Dr	30° Dr

6456⁵⁰ 9° 33.18'

72.22	72.07	71.5	72.3	72.0	72.63	72.80
88°	89°	95°	82°	90°	83°	82°
20° WK	14° Cb	14° G		14° G	14° Cb	20° W.K

6431⁵⁰ - 6° 22.12'

71.53	71.40	71.0	71.8	71.6	72.30	72.41
94°	96°	100°	92°	94°	87°	86°
20° WK	14° Cb	14° G		14° G	14° Cb	20° WK

6415 - 15° Rt = & 11' Conc Driveway

71.42	71.99	72.06	73.22
96°	90°	89°	77°
15° Dr	17° Dr	20° Dr	30° Dr

81.02

Lt = Westerly

Rt = Easterly

32

8731⁵⁰ 31° 50.60' Break in Grade at this Point on Easterly Curve

78.53	78.34	77.4	77.7	77.3	78.20	78.30
2 ¹ / ₉	2 ⁶ / ₉	3 ⁶ / ₉	3 ³ / ₉	3 ⁷ / ₉	2 ⁸ / ₂	2 ⁷ / ₂
21 ⁵ / ₉ WK	15 ⁹ / ₉ Cb	15 ⁹ / ₉ G		14 ¹ / ₆	14 ⁴ / ₆ Cb	19 ² / ₆ WIK

8706⁵⁰ 28° 38.54'

74.88	76.78	76.1	76.5	76.0	76.89	77.04
4 ¹ / ₄	4 ² / ₄	4 ⁹ / ₄	4 ⁵ / ₄	5 ⁰ / ₄	4 ¹³ / ₄	3 ⁹ / ₈
21 ³ / ₄ WK	16 ⁰ / ₄ Cb	16 ⁰ / ₄ G		13 ² / ₄ G	13 ² / ₄ Cb	19 ² / ₄ WIK

7781⁵⁰ 25° 27.48' - 14²/₂R = $\frac{7}{2}$ 23' Conc Dr.

75.66	76.53	75.5	75.2	75.25	76.02	77.6
5 ³ / ₆	4 ⁴ / ₉	5 ⁵ / ₆	5 ⁸ / ₆	5 ² / ₇	5 ⁰ / ₀	3 ¹ / ₄
21 ³ / ₆ WK	15 ⁵ / ₆ Cb	15 ⁵ / ₆ G		14 ² / ₇ WIK	19 ² / ₇ WIK	29 ² / ₇ Dr

7765 - 15^d Lt = $\frac{8}{2}$ 15' Conc Driveway

74.56	74.94	74.84	74.64
6 ⁴ / ₆	6 ⁰ / ₈	6 ¹ / ₈	6 ³ / ₈
31 ⁴ / ₆ Dr	21 ⁴ / ₈ Dr	16 ² / ₈ Dr	15 ² / ₈ WIK

7756⁵⁰ - 22° 16.42'

74.69	74.53	74.2	74.4	74.0	74.93	75.04
6 ³ / ₃	6 ⁴ / ₉	6 ⁸ / ₉	6 ⁵ / ₉	7 ⁰ / ₉	6 ⁰ / ₉	5 ⁹ / ₈
21 ² / ₃ WK	15 ⁴ / ₉ Cb	15 ⁴ / ₉ G		14 ² / ₉ G	14 ² / ₉ Cb	20 ⁰ / ₈ WK

7731⁵⁰ 19° 06.36'

74.09	74.02	73.5	73.8	73.5	74.37	74.45
6 ⁹ / ₃	7 ⁰ / ₀	7 ⁵ / ₅	7 ² / ₈	7 ⁵ / ₅	6 ⁶ / ₇	6 ⁵ / ₇
26 ⁸ / ₃ WIK	15 ² / ₀ Cb	15 ² / ₅ G		14 ³ / ₅ G	14 ³ / ₇ Cb	20 ¹ / ₇ WIK

8102 A

TP₆

5.30 82.79 (82.82)

S.E. BP-3724
Hemlock (5) - 0.03

Lt = Westerly
1 North

Rt = Easterly
15.1074 33

Sec FB-2186 for recent 'X' sec 37th for refs. + cuts
6434⁵¹ E.C. + Wly line 37th ST - 45°00'

78.01	77.84	77.3	78.2	78.5	78.87	79.05
1008	1025	108	99	96	922	904
24 ² WK	178 Cb	178 G		15-2 G	15-1 Cb	200 WK

TL₅ 9.22 88.09 2.15 78.87

88.09

9406⁵⁰ 41°22, 78'

78.50	78.46	77.8	78.2	78.2	78.76	78.85
252	246	32	28	28	226	217
20Z WK	15-2 Cb	15-2 G		15-2 G	15-0 Cb	200 WK

8781⁵⁰ - 38°12.72' - 15² = 2.20' Conc Dr.

76.77	78.94	78.83	78.08	78.3	77.9	78.70	78.85
225	208	219	294	27	31	232	217
302 Dr	202 Dr	174 Dr	15-2 Lip		14-2 G	14-2 Cb	20-2 WK

8456⁵⁰ - 35°01.56'

79.08	78.93	78.0	77.8	78.57	78.70
192	209	30	32	242	232
213 WK	15-2 Cb	15-2 G	14-2 G	14-2 Cb	20-2 WK

8440 - Break in Grade on Westerly Curb

78.98	78.74	77.5	77.9	77.6	78.35	78.52
204	228	35	31	34	267	250
210 WK	15-2 Cb	15-2 G		14-2 G	14-2 Cb	19-2 WK

81.02

FORTUNA AVE Cross Sec.
Ingraham to Crown Point Dr.

12-5-52
W.D.# 32074

C.H.S.
Boyer
Oltman
Johns

Indexed
5-27-53

75' street

- denotes Ed. Conc. Man.
- denotes Ed City L.T. or disk

B.M. = \pm L.T. INGRAHAM & FORTUNA.
used EL = 44.65 to tie in with
elevation plane of work west
of INGRAHAM (Lamont - Kendall -
Chico - Shasta) etc.

- E.P. denotes edge of pavement.
- P. " " pave. at gutter
- B.W. " " base of wall

Produced by B.L.C.
2/3/53

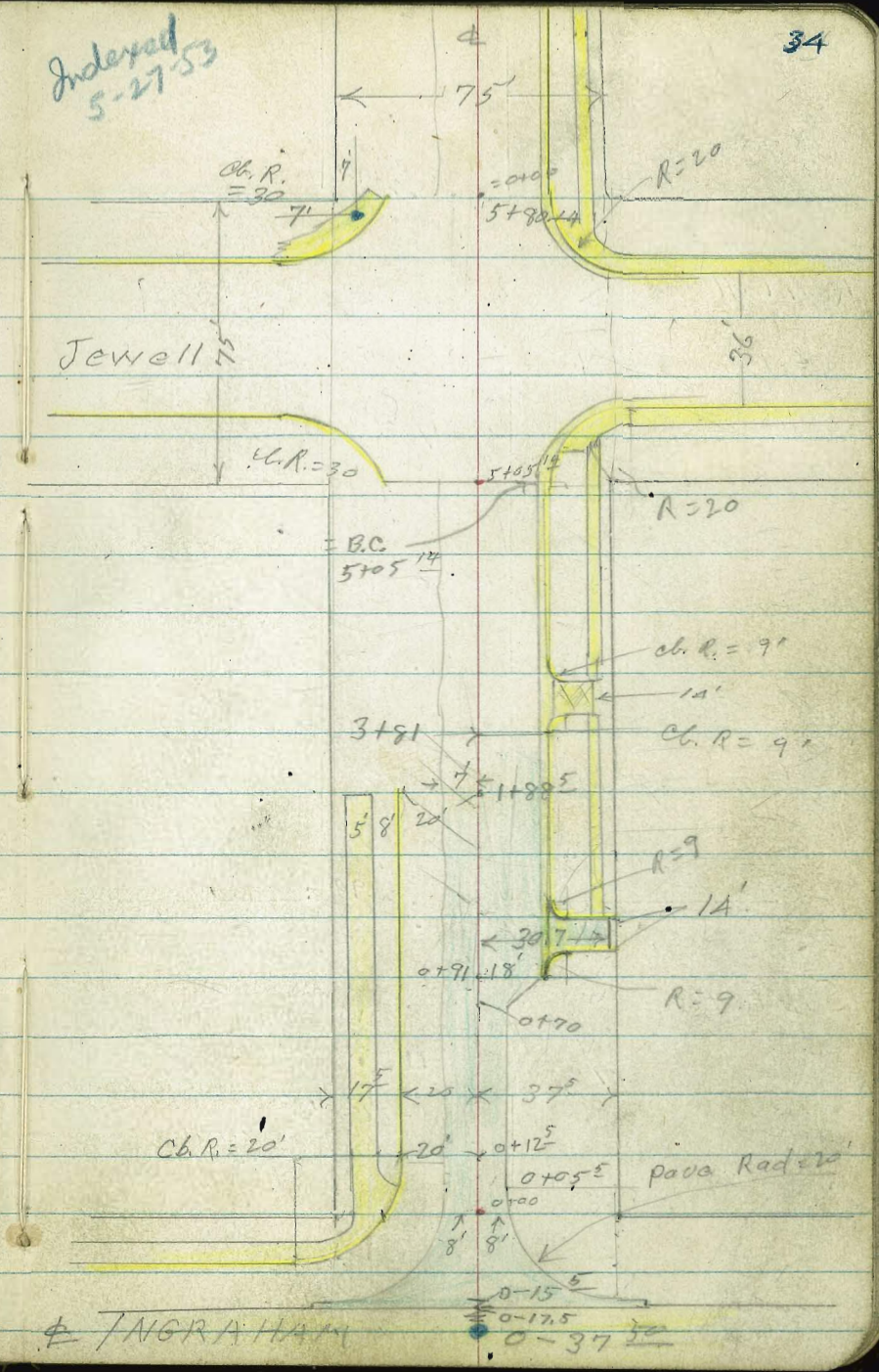

Kendall

Lamont

Shasta

Sequoia

Fort J W D

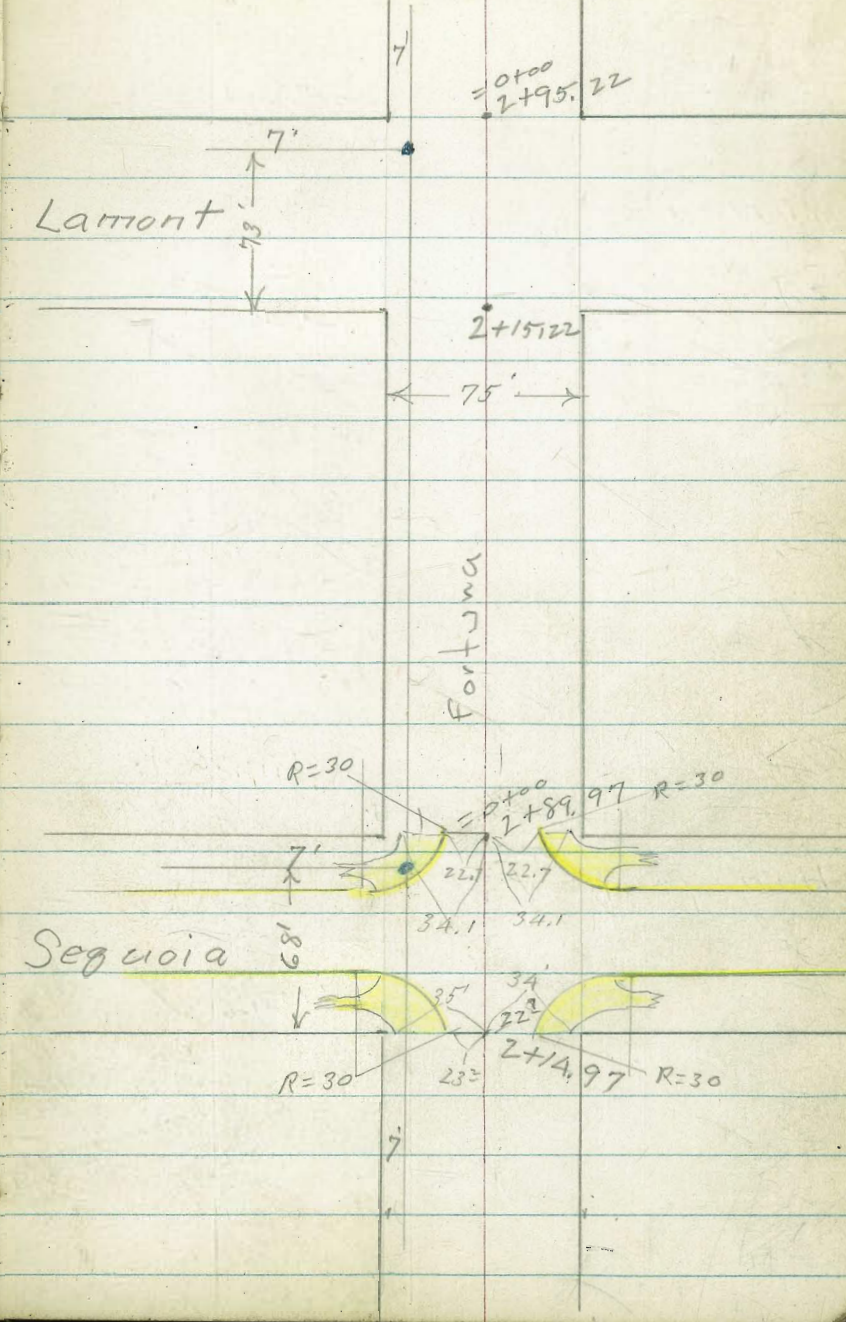
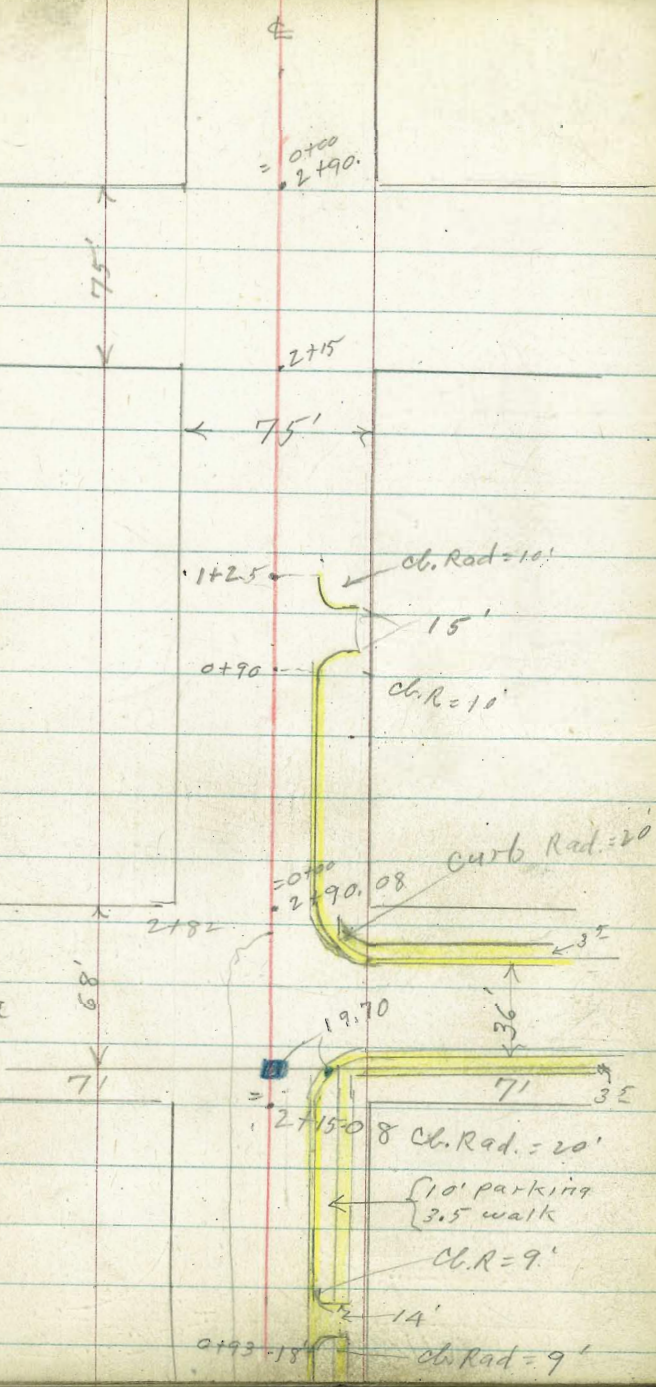

Morrell

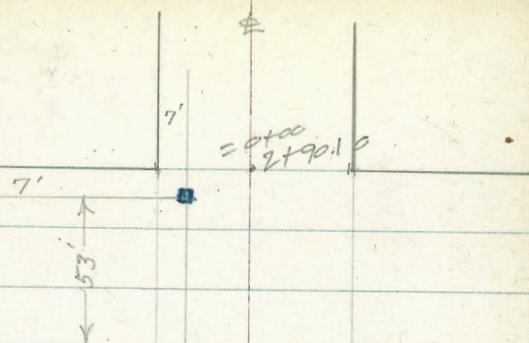

2+30.10

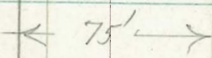

= 0+00 3+13.26

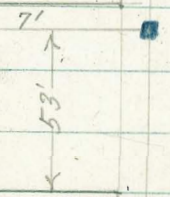

Honeycut

2+53.26

Ties - see G 318
P 79

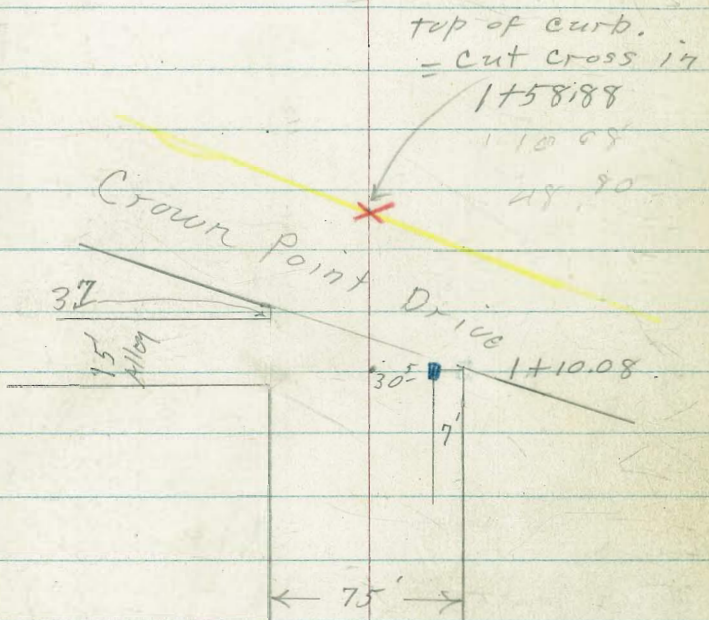

Map
107.5

			0.41	21.31 - B.M.#1		
B.M.#7	7.85	21.72 ✓	6.35 ✓	11.87 ✓		± Fortuna produced, Cross in Ely. curb. Crown Point Drive on
B.M.#6	3.12 ✓	18.22 ✓	5.71 ✓	15.10 ✓		N.E. 7' Mon. Fortuna + Morrell
B.M.#5	2.03 ✓	20.81 ✓	3.93 ✓	18.78 ✓		N.E. 7' Mon. Fortuna + Honeycutt.
	1.39 ✓	22.71 ✓		21.32 ✓		B.M.#1 - below
			2.32 ✓	21.34 (21.32)		B.M.#1 - below
	4.05 ✓	23.66 ✓	8.96 ✓	19.61 ✓		
	1.20 ✓	28.57 ✓	11.14 ✓	27.37 (27.36)		B.M.# 2 - below
	3.35 ✓	38.51 ✓	8.29 ✓	35.16 (35.15)		Nail in pole # P-1799
	1.99 ✓	43.45 ✓	4.04 ✓	41.46 ✓		B.M.#3 - below
	8.28 ✓	45.50 ✓	5.66 ✓	37.22 (37.23)		B.M.#4 below
	2.52 ✓	42.88 ✓	7.85 ✓	40.36 ✓		
	3.56 ✓	48.21 ✓				
B.M.#4			3.42 ✓	44.65 ✓ (F.B. 2084 44.84)		± L.H. Fortuna + Ingraham.
	7.71	48.07 ✓	1.96 ✓	40.36 ✓		
B.M.#3-A	5.09	42.32 ✓	7.30 ✓	37.23 ✓		N.E. 7' disk Jowall + Fortuna Fortuna + Shasta.
B.M.#3	3.07 ✓	44.53 ✓	1.98 ✓	41.46 ✓		L.H. w/ly. 7' line + Sly. 17.80 line of
T.B.M.#1	7.79 ✓	42.94 ✓	2.26 ✓	35.15 ✓		Nail in pole # P-1799 Fortuna + Kendall
B.M.#2	9.99 ✓	37.35 ✓	4.90 ✓	27.36 ✓		N.E. 7' disk Fortuna + Sequoia
	5.85 ✓	32.26 ✓	0.58 ✓	26.41 ✓		+ Crown Pt. drive EL: 20.77
B.M.#1	5.67 ✓	26.99 ✓		21.32 ✓		This B.M. Brought up from N.W. Conc. Mon Sequoia N.E. 30' ab. Rad. Cross Fortuna + Lamont GB 292-P21 (P)

0+16-39^E Rt. = N.W. corner stucco House

0+12^E 20' Lt. = cl. E.C.

44.47	43.1	43.55	43.64	43.55
4.50	5.19	5.42	5.33	5.42
20	20	8		8
cc				

0+11-27³ Rt. = Ctr. 0.8' pole #JP 1605

0+05^E 8' Lt } E.C. of A.C. Pavc.

43.75	43.61	43.75
5.12	5.16	5.22
8		8
E.P.		E.P.

0+01-37³ Rt. = start picket fence

0+00 = Ely line Ingraham.

44.69	43.1	43.85	43.96	43.99	43.3	44.7	44.4
4.28	5.3	5.12	5.01	5.00	3.7	4.3	4.6
24	24	93		105	26	375	50
Top cl.		E.P.		E.P.			

0-07^E (40' Lt. = B.C.) Ingraham. Face of cl. to North on

44.92	44.71
4.05	4.16
90	40
on cl.	cl. B.C.

0-08 - 41^E Rt. = Ctr. Fire Hydt.

0+15^E 28' Lt } B.C. A.C. Pavc.
Ely edge A.C. Pavc

44.44	44.34	43.95	43.42
4.53	4.63	5.02	5.05
375	28	28	375
41	B.C.	B.C.	
44.61	44.59	44.06	43.96
4.16	4.30	4.38	4.59
1375	875	375	375
			4.91
			5.61
			6.35
			1375

0-17^E wly edge 4"± thick A.C. Pavc
Ely edge Conc Pavc

45.07	44.98	44.97	44.65	44.41	43.71	42.99
3.90	3.99	4.10	4.32	4.56	5.26	5.98
1375	875	375		375	875	1375

0-37^E & Ingraham

432 48.97

44.65

48.97
& Lt Ingraham & Fortuna

1+08 - drain out let thru. curbs
2d Lt. = Ctr. 2' wide 4" high

1+09 = E 14' alley to south

1+00 31' RT = end alley cl. + pave.
27' RT = F.C. Alley cl. Ret.

0+94 45' RT = E Sing Bar. No apron

Also = edge of Pavement.
0+91 - 18' RT = cl. B.C. = start curb.

0+84 RT = end stucco + frame wall.

0+70 - 8' RT = Δ in A.C. pave.

0+40 { 39' RT = N.E. Cor. Stucco House
38' RT = start wood frame
5' High. Stucco wall
38' RT = End picket fence.
T.P. 14.22 47.12 6.07 42.90

41.09

6.03

20
I.E.

41.82

40.8

41.29

41.19

40.84

41.17

40.9

40.2

5.30

6.2

5.83

5.93

6.28

5.95

6.1

6.8

20

20

8

18

31

37.5

10

cl

E.P.

41.94

40.9

41.32

41.35

40.92

41.2

41.34

41.30

5.18

6.1

5.75

5.77

6.20

5.80

5.78

5.82

20

20

8

18

27

31

31

cl

E.P.

cl

G.

cl

42.6

43.30

4.4

3.82

45

45

End.

Curb. floor

42.08

41.2

41.58

41.50

41.07

41.51

42.6

5.04

5.8

5.54

5.62

6.05

5.55

4.4

20

20

8

18

18

37.5

cl

E.P.

G.

cl

42.5

41.6

37.5

Gd & B.W.

41.94

41.94

41.80

5.18

5.18

5.32

8

8

E.P.

E.P.

43.54

42.2

42.84

42.84

42.72

41.4

44.4

3.53

4.8

4.28

4.28

4.20

2.6

2.6

20

20

8

8

37.5

13.6

cl

E.P.

38

47.12

T.P. Nail 2.38 42.26 7.24 39.88
in pole

2+25 - 27' RT = 10" pole # J.P. 1649

2+15 - 22^E RT = 8" diam eucalyptus

2+00

1+88 } 8' high Fence.
37' Lt. = line of chain link
28' Lt. = end of walk
20' Lt. = end of curb

1+50 } 4 unit dwelling
46' RT = N.W. cor. 21' wide

1+23 - 18' RT = E.C. Ch. Rot.

1+17 - 21^E Lt. = Guy pole for same.

1+16 - 27^E RT = ctr. 1' pole # J.P. 1627

1+14 - 27' RT = B.C. 9' Rad Ch. Rot.

38.7	39.2	39.5	39.5	39.27	39.75	40.0	39.1
8.8	7.9	7.6	7.60	7.85	7.37	7.1	8.0
375	18	7		18	18	34	375
		E.P.		G	cl		

40.4	40.60	39.1	37.9	37.7
6.6	6.52	7.9	9.1	9.3
375	33	375	45	60
	N.E. cor			
	walk			

40.52	40.32	39.8	39.69	39.71	39.47	39.94	40.1
6.60	6.82	7.3	7.43	7.35	7.65	7.18	6.9
28	20	20	8		18	18	34
S.E. cor	cl		E.P.		G	cl	
walk							

387	38.5	39.0
8.4	8.6	8.1
39	46	46
		Floor
		level

41.01	40.0	40.46	40.55	40.24	40.70	40.9	39.2
6.11	7.0	6.66	6.57	6.88	6.42	6.1	7.8
20	20	8		18	18	31	375
cl		E.P.		G	cl		

40.66	41.17
6.46	5.95
18	18
G	cl

41.37	41.39	41.42	41.42
5.75	5.73	5.66	5.70
27	27	31	31
G	cl	G	cl

A7, 12

Fortuna

31st RT. = end pave.
3+97 = $\frac{1}{2}$ Alley to south

31st RT. = end of ch.
26th RT. = ch. E.C.

3+90 - 21st Lt. = 10" guy pole for #301335H
(Gas. & Elec. # is gone.)
3+87 27th RT = ctr. 10' pole # 301335H curb.
3+81 17th RT = start of Rad. alley

52nd A unit dwelling
3+50 62nd RT = Nly face 2' wide

3+00

3+00

2+50

38.3	37.7	35.86	36.03	35.61	35.99	35.83	34.61
4.0	4.6	6.40	6.27	6.65	6.27	6.43	7.59
37 th	E1	8		17 th	31 st	37 th	70
		E.P.		G		Alley cold	
							194

36.08	36.19	36.20	36.21
6.18	6.07	6.06	6.07
26 th	26 th	31 st	31 st
G	CL	G	CL

35.98	36.50
6.28	5.76
19	19
G	cc. B.C.

38.9	37.7	36.7	36.80	36.81	36.53	37.03	37.3	35.4	34.11
3.4	4.6	5.6	5.46	5.39	5.73	5.23	5.0	6.9	8.15
37 th	14	12	7		18	18	32	37 th	52 nd
			E.P.		G	CL			

Plot 1006

38.4	34.2	33.3
3.9	8.1	9.0
50	60	80

38.7	38.2	37.7	37.8	37.50	37.49	37.95	38.3	37.3
3.6	4.1	4.6	4.48	4.46	4.79	4.31	4.0	5.0
37 th	20	17	8		18	19	32	37 th
			E.P.		G	CL		

39.6	39.1	38.7	38.63	38.67	38.25	38.90	39.2	38.4
2.7	3.2	3.6	3.63	3.59	4.01	3.36	3.1	3.9
37 th	20	18	7 th		18	18	33	37 th
			E.P.		G	CL		

42.26

Fortuna

start full width pavement
22 1/2 Lt = start existing curb.

18 1/2 Lt = B.C. 20' Rad. Curb.
5+05 = Wly. line Jewell

36.3	36.20	35.55	36.46	35.50	35.10	35.10	35.61	35.8	35.0
2.3	4.40	5.05	5.15	5.10	5.50	4.99	4.8	5.6	
37E	22E	22E	7		18	18	37E	50	
	cl	G.	E.P. to west		G.	cl.			

5+01 23' Rt. = 4" diam. Eucalyptus.

4+97 23 1/2 Lt. = #1696

4+70

35.4	37.5	35.6	35.55	35.55	36.20	35.70	36.74	34.6
2.2	3.1	5.0	5.05	5.05	4.40	4.90	4.6	6.0
37E	19.	9	8 E.P.		17E	17E	32	37E
					G.	cl.		

4 unit dwelling
4+35 Cont. 52' Rt. = Nly. face 21' wide

33.2	33.7
7.4	6.9
50	52 Floor level

4+35

38.1	37.7	35.62	35.65	36.25	35.75	35.0	34.50
2.5	2.9	4.98	4.98	5.35	4.85	4.6	6.1
37E	20	8 E.P.		17E	17E	32E	37E
				G.	cl.		

T.P. 4.81 ✓ 40.60 ✓ 6.47 ✓ 35.79 ✓

40.60

4+13 26 1/2 Rt. = E.C. Alley cl.

35.33	35.81
6.92	6.45
17E	cl
G.	

31 1/2 Rt. = sly end alley curb.

4+0.4 26.8 Rt. = B.C. 9' Rad Alley Ret.

36.12	36.16	36.18	36.16
6.14	6.10	6.08	6.10
G.	cl	G.	cl
26E		31E	

42.26

5+25 Cont.

34.05	34.55	33.24	33.70
6.55	6.05	7.36	6.70
88	88	138	138
G	cl	G	cl

5+25 = wly. cl. Jewell to south

35.57	35.26	34.97	35.49
5.03	5.34	5.63	5.11
	18	38	38
		G	cl
			E.C.

5+22.5 Cont.

40.15	39.48	38.14
0.45	1.12	2.46
150	150	100
cl	G	cl

5+22.5 = cl. line to north

38.00	37.00	36.26	35.82	35.55
2.60	3.60	4.34	4.78	5.05
100	50	50	20	
G	cl.	G		
	E.C.			

#1 = B.C. - 18' RT of Sta 5+05
S. wly. Return - Jewell (4 parts.)

35.10	35.61	35.01	35.55	35.08	35.56	35.04	35.54	34.97	35.48
5.50	4.99	5.53	5.05	5.52	5.04	5.56	5.06	5.63	5.12
#1	#1	#2	#2	#3	#3	#4	#4	#5	#5
G	cl.	G	cl.	G	cl.	G	cl.	G	cl.
	E.C.								E.C.

part #1 = 22' Lt of Sta. 5+05

Page 42

N. wly. Ret. Jewell. (in 4 parts)

35.55	36.20	35.72	36.34	35.89	36.54	36.03	36.67	36.26	36.94
5.05	4.40	4.88	4.26	4.71	4.06	4.57	3.93	4.34	3.66
#1	#1	#2	#2	#3	#3	#4	#4	#5	#5
G	G	G	cl.	G	cl.	G	cl.	E.C.	E.C.
								G	cl.

5+09 27' RT = 12" pole # JP 1699.

Sta 5+62^E
N. Ely. of Ret. Jewell B.C. = 50' Lt. of

36.94	37.56	36.64	37.28	36.54	37.16	36.54	37.18	36.69	37.30
3.66	3.04	3.96	3.32	4.06	3.44	4.06	3.42	3.91	3.30
#1	#1	#2	#2	#3	#3	#4	#4	#5	#5
G	cl	G	cc	G	cl	G	cl	G	cc
	B.C.								End of
									cutb

5+62^E Cont.

40.70	40.07	39.24
+0.10	0.53	1.36
150	150	100
cl	G	cc

5+62^E = Ely. cl. line - to north

38.62	37.56	36.94	36.31	35.99
1.88	3.04	3.66	4.29	4.61
100	50	50	20	
G	cl	G		
	B.C.			

Sta. 5+61
S. Ely. Ret. Jewell B.C. = 38' Rt. of

35.01	36.54	35.26	35.70	35.51	35.97	35.19	36.26	36.03	36.54
3.59	3.06	3.34	4.90	5.09	4.63	4.81	4.34	4.57	4.00
#1	#1	#2	#2	#3	#3	#4	#4	#5	#5
G	cl	G	cl	G	cl	G	cc	G	cc
	B.C.								E.C.

5+61 Cont.

34.67	33.32	33.52
5.93	7.28	6.78
88	138	138
cl	G	cc

5+61 = Ely. cl. Jewell to south

35.95	35.60	35.01	35.54	34.17
4.65	5.00	5.59	5.06	6.43
	18	38	38	88
		G	cc	G
			B.C.	

5+62^{CA} = E Jewell

40.18	38.77	37.00	36.07	35.68	35.46	35.24	34.44	33.55
0.42	1.83	3.60	4.53	4.92	5.14	5.36	6.10	7.05
150	100	50	20		18	38	88	138

40.60

Fortuna

0+25 Cont.

36.5	36.2
8.8	9.1
<u>40</u>	<u>60</u>

0+25

41.0	39.7	38.1	37.75	37.14	37.39	37.89	38.1	37.1
4.3	5.6	7.2	7.59	7.60	7.95	7.45	7.2	7.6
37E	76	8	7E	45.34	18	18	32	37E
			E.P.		G	G		

T.P. 8.11v 45.34 3.37 37.23v

0+05

40.60	40.60	35.2	36.8	36.75	36.30	36.60	37.20	36.9
0.0	0.0	2.4	3.80	3.85	4.90	3.80	3.4	3.7
50	37E	20	7		17E	17E	32	37E
			E.P.		G	G		

0+03^E 28^E Lt. = N. Ely Cor. Conc. walk

37.45
37.15
28E
walk

0+01 - .17^E Rt. = Arq. E.C. 20' d. Rot

36.03	36.54
4.57	4.06
17E	17E
G	G.E.C.

Check B.M. #3-A. - P-37) 3.38 37.22 (37.23)

0+00 Cont.

37.8	37.35	36.6	35.9
2.8	3.22	4.0	4.7
37E	29E	37E	60
	Back at		
	walk		

= 0+00 = end full width pavement

37.30	36.69	36.55	36.50	36.01	36.50	36.7
3.30	3.91	4.05	4.10	4.59	4.10	3.9
22E	22E	7.5		17E	17E	32
G	G	E.P.		G	G	
end		To east			G.E.C.	

5+80^{1A} Ely. line Jewell

49.60

41.77	41.76	41.70
5.54	5.55	5.6
31	31	37E
a	a	

31' RT = end alley etc. +
@ conc. pave.

1+02 27' RT = E.C. 9' Rad. alley return.

43.7	42.3	41.31	41.56	41.28	41.76	41.75
3.6	5.0	6.00	5.75	6.03	5.55	5.56
37E	20	8		18	27	27
		E.R.			a	E.C
						a

1+00 28E Lt = Guy pole for pole # P1725

37E Lt = end board fence.

0+98 - 23' RT = pole # P 1725

47.31N

T.P. 5.81 47.31 3.84 41.50N

0+93 - 18' RT = B.C. 9' Rad. alley Ret.

41.19	41.69
4.15	3.65
18	18
a	cc. B.C.

0+83 - 37E Lt = start board fence.

0+80 - 37E = end apron

42.98
2.36
37E
Apron

0+75 - 22E RT = dead man

0+65 - 37E Lt = start conc. apron.

43.59	42.83
1.75	2.51
52	37E
Car floor	Apron

0+60 54' RT = Alley pace. 21' wide
A unit dwelling

38.0	37.1	38.4
7.3	8.2	6.9
37E	50	54
		Floor level.

0+60

42.0	41.0	39.44	39.64	39.33	39.85	40.03
3.3	4.3	5.90	5.70	6.01	5.49	5.31
37E	17	7E		18	18	32
		E.R.	45.34	a	a	

For. hly 1/2 of intersection
see sheet 9102-L (Now under
construction.)

34.40	39.86	38.26	38.71
604	5.58	7.18	6.73
88	88	138	138
G	cc	G	cc

SHASTA
2+35 = Wly ab. line to south

41.21	41.05	40.54	41.00
4.23	4.39	4.90	4.42
45.44	18	38	38
	G	G	cc
			E.C.

T.P. 3.94 45.44 5.84 41.47

2+15⁰⁸ = Wly line Shasta

41.20	43.6	41.36	41.43	41.10	41.55	41.5
3.1	3.7	5.95	5.88	6.21	5.76	5.8
375	20	75		18	18	375
		E.P.		G	cc	

A-unit dwelling
1+60 50' RT. = Nly end 21' wide

44.1	44.0	41.76	41.82	41.48	41.95	42.1	40.8
2.6	3.3	5.55	5.49	5.83	5.36	5.2	6.5
375	14	7		18	18	375	52
		E.P.		G	cc		Floor level

1+25 - 18' RT. = E.C. 9' Rad alley return

44.1	43.4	41.91	41.95	41.70	42.20	42.1
3.2	3.9	5.40	5.36	5.61	5.11	5.2
375	17	7		18	18	375
		E.P.		G	cc	

31' RT. = start alley curb

1+16 - 27' RT. = B.C. 9' Rad Alley Ret.

41.73	41.83	41.80	41.78
5.58	5.48	5.51	5.53
27	27	31	31
G	B.C.	G	cc

(cold lay topping)
1+09 = E Alley to south

41.9	44.3	43.5	41.65	41.55	41.36	41.61	41.47	39.8
2.4	3.0	3.8	5.66	5.46	5.95	5.70	5.83	7.5
50	375	16	8		18	31	375	90
			E.P.			E.P.		

Fortuna

♀

48

20+00 = Ely Shasta.

2+90⁰⁸. 7' Rt = Nly edge A.C. Pavc.

40.3	41.1	40.4	40.3	40.30	40.26	40.72	40.9	40.9
3.1	4.3	5.0	5.1	5.14	5.18	4.72	4.5	4.5
375	12	9		7	18	18	19	375
				E.P.	G	cl		

2+82 = Nly edge pavc. on ♀.

~~41.84~~ 40.60
4.84
E.P.

of. Sta 2+71 (in 4 parts)

S. Ely. return Shasta - B.C. = 38' Rt

40.55	41.00	40.51	40.96	40.30	40.88	40.32	40.81	40.26	40.72
4.89	4.44	4.93	4.48	5.05	4.56	5.12	4.63	5.18	4.72
#1	#2	#2	#2	#3	#3	#4	#4	#5	#5
G	cl.	G	cl	G	cl	G	cl	G	cl.
	B.C.								E.C.

2+71 - Cont.

39.89	38.21	38.68
5.55	7.23	6.76
88	138	138
cl.	G	cl.

2+71 - Ely. cl. Shasta to south.

40.84	40.77	40.55	41.00	39.39
4.60	4.67	4.89	4.44	6.05
	18	38	38	88
		G	cl.	G
			B.C.	

2+72.58 ♀ Shasta.

40.99	39.94	40.79	39.73	38.58
4.45	4.50	4.65	5.71	6.86
	18	375	88	138

B.C. = 18' Rt Sta. 2+15

S. Wly. return Shasta (4 parts)

41.07	41.54	40.97	41.46	40.80	41.28	40.66	41.13	40.54	41.02
4.27	3.90	4.47	3.98	4.64	4.16	4.78	4.31	4.90	4.42
#1	#1	#2	#2	#3	#3	#4	#4	#5	#5
G	cl.	G	cl	G	cl	G	cl	G	cl.
	B.C.								E.C.

45.44

±

0+94- 2V RT = pole # P1775
 T.P. 5.36 43.16 7.64 37.80
 0+90- 18' RT = B.C. 10' Rad alley

39.35 37.80
 8.09 7.64
 18 18
 G cl.
 B.C.

0+72 Cont. 52' RT = N.E. Cor. 21' wide
 A unit dwelling

35.0 37.1 37.7
 7.4 8.3 7.7
 37.5

Floor level

0+72 30° Lt = start picket fence.

40.8 39.8 39.0 38.2 35.13 37.95 36.39
 4.6 5.6 6.4 7.2 7.31 7.49 7.05
 37.5 12 8 7 18 18
 E.P. G cl.

0+71 40° Lt = end apron.

41.13
 4.31
 40.2
 Apron

0+55 40° Lt = start conc. apron
 To double Gar.

42.16 41.34
 3.28 4.10
 4.6 40.2
 Gar floor Apron

0+52- 31' Lt = end post + wire fence.

41.3 40.3 39.4 38.9 35.85 35.66 39.10 35.4
 4.1 5.1 6.0 6.5 6.59 6.78 6.34 7.0
 37.5 11 9 7 18 18 37.5
 E.P. G cl.

0+50 post + wire fence.
 0+11- 30° Lt = start 2' high

45.44

Fortuna

T.B.M.#1

Nail in pole # P1799

T.P. 6.0A 41.19V 8.0M 35.15V R37

1+28- 38' Lt. = end board fence.
1+26 27' Rt. = dead man
18' Rt. = E.C. = end of curb.
1+25 8' Rt. = end pave.

31.8 31.5 36.9 31.7 36.55 36.22 36.64 31.2 31.6
5.4 5.7 6.3 6.5 6.61 6.94 6.52 6.0 6.6
37.5 8 7 8 18 18 19 37.5
E.P. G G

1+16- 26' Rt. = pole # J.P.A. 3998

1+15- Cont.

37.45 37.55
5.71 5.61
28 31.8
G E.P.

38' Lt. = start G' high board fence.
Return.
1+15 28' Rt. = B.C. 10' Rad. ch.

38.3 31.7 31.2 36.9 36.9 36.61 31.34
4.9 5.5 6.0 6.3 6.26 6.55 5.82
37.5 9 8 8 18 28
E.P. G

1+07⁵ Cont.

37.46 36.63
5.70 6.53
37.5 100

1+07⁵ & Alley

40.1 38.6 37.8 37.5 31.1 37.05 36.88 37.44
3.1 4.7 5.4 5.7 6.1 6.11 6.28 5.72
100 37.5 9 7 8 18 31.8
E.P. E.P.

37.58 37.64
5.58 5.52
28 31.8
E.P. E.P.

31.8 Rt. end conc. pave.
30' Lt. = end picket fence.

1+00- 28' Rt. = end curb

39.1 39.3 37.6 37.2 37.26 37.12 37.54
3.5 3.9 5.6 6.0 5.90 6.04 5.62
37.5 20 8 43.16 7 18 28
E.P. G

0+45 - 39³ Rt. = 18" diam poplar.0+40 - 26³ Lt. = ϕ 2' diam palm.

0+17 - 38' Rt. = 4" trunk bush

0+10 - 38' Rt. = 8" diam poplar

0+05 - 38' Rt. = 6" " "

0+00 - 38' Rt. = 6" diam poplar

0+35

0+26 - 26³ Lt. = 2' diam palm.0+11 - 26⁶ Lt. = 2' diam palm.

4 Conc. wall - (See Page 52)

37² Lt. = start brick pillars

0+00 = Ely line Kendall

Kendall St. Now being improved. Under Const.

See sheet 8498 L.

2+15 = Wly line Kendall

2+8 - 26⁴ Rt. = polo. # P 1799

Conc. slab.

1+65 42' Lt. = sly edge 10' wide

1+58 37' Lt. = end hedge.

1+48 37⁸ Lt. = ϕ 3 wide Conc. walk1+29 - 37' Lt. = ϕ 2' wide hedge

36.2	36.2	37.6	37.4	33.5	33.4	33.6	33.6
5.0	5.0	6.4	6.8	7.7	7.8	7.4	7.6
50	40	37 ²	25	10.		15	37 ²

34.8	34.6	34.8	33.2	33.6	33.7	34.4	34.4
7.4	6.6	6.4	8.0	7.6	7.5	6.8	6.8
37 ²	37 ²	23	22		12	17	37 ²
B.W.							

36.1	35.2	34.0	33.4	34.4	34.9
5.1	6.0	7.2	7.8	6.8	6.3
37 ²	13		16	17	37 ²

37.42	36.9	36.2	35.6	35.5	35.9	35.6	35.0
3.77	4.3	5.0	5.4	5.7	5.3	5.6	6.2
42	37 ²	8		7	18	37 ²	50
on conc.							
37.85	37.69						
3.34	3.50						
47 ⁸	37 ⁸						

41.19

0+864

Detail for notes
on P. 51

0+00 (P 35 Lt. + P. 51)

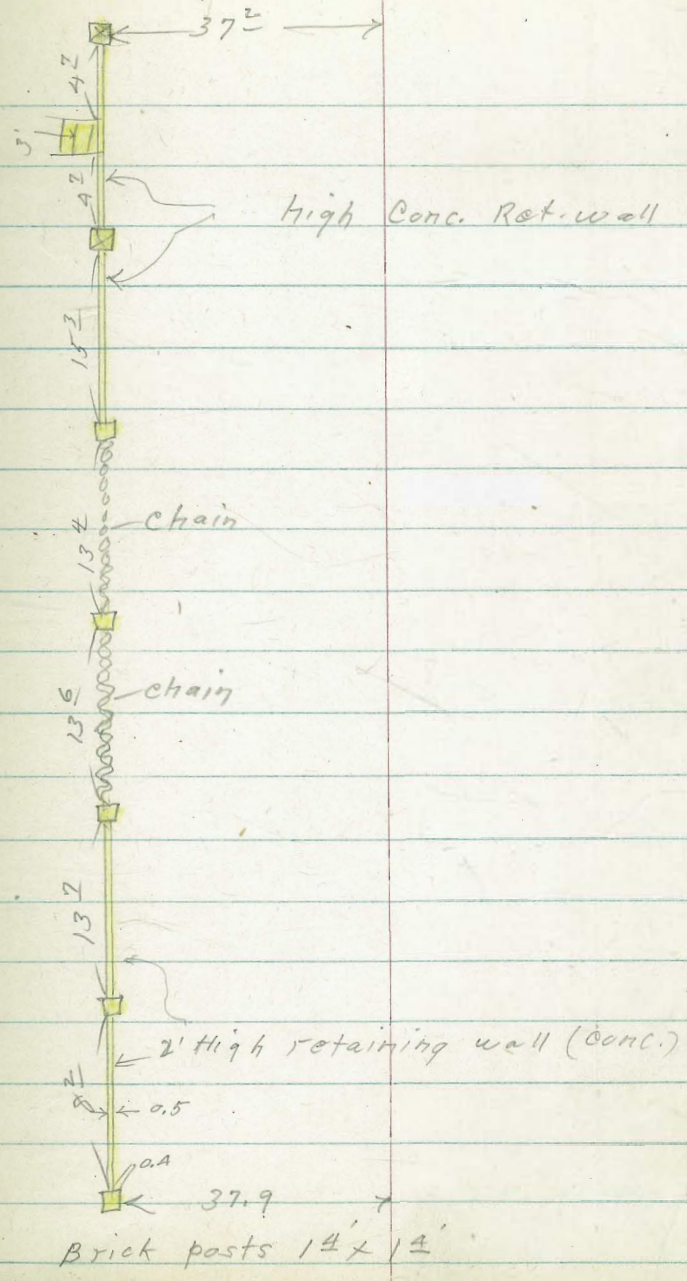

0+98 27² Rt = pole # P 1825
apron.

0+94- 34² Lt = 8' wide level conc.

0+86^d 37² Lt = end brick pillar
Conc. wall. (see P-52)

0+86- { 26' Lt = 2' diam palm
to double gar.
39^E = 2' second single door

0+79 { 37^E Lt = 3' wide conc. steps
22² Lt = 3' conc. walk.

0+76 - 39^E Rt = 1' st sing door to gar.
Conc. floor.

T.P. 2.91 ✓ 36.66 ✓ 7.44 33.75 ✓

0+73 37⁴ Rt = end lattice fence

0+71- 26' Lt = 20" diam palm.

0+61- 37⁴ Rt = start lattice fence
of eander.

0+59- 37⁴ Rt = ctr. 8" C/ump

0+56- 26² Lt = 2' diam palm.

33.74 33.71
2.88 2.95
37^E 34^E
Gar. Floor Apron.

33.9
21.8
37^E
B.W.

32.9 33.00
31.8 3.66
39 39^E
Gar. Floor

35.71 33.99 33.74
0.95 2.67 2.92
40⁴ 37^E 22^E
top of walk
steps.

33.0 32.95
3.7 3.71
39 39^E
Gar. Floor

36.66

33.6 34.2 33.7 33.1 32.7 32.4 32.6 32.9
7.4 7.0 7.5 8.1 8.5 8.8 8.6 8.3
37^E 37^E 20 10 13 16 37^E
B.W.

41.19

T.B. 77 4.87 ✓ 32.24 ✓ 9.29 ✓ 27.37 ✓ (27.36 B.M.#2-P37

1+61 ^{thin wall} AI⁵ Rt. = 3' wide Conc. walk

30.64
6.02
41⁵
walk

1+49-37⁵ Rt. = end Conc. apron

30.58
5.78
37²
31.06
5.60
41⁵
Apron

1+40 37⁸ Lt. = end Conc. wall

31.5 32.0 31.6 31.5 31.0 30.9
5.2 4.7 5.1 5.2 5.7 5.8
37⁸ 37⁵ 18 15 37²
B.W.

1+33 { 37² Rt. = end Brick wall.
to double bar.
37⁵ Rt. = start Conc. apron

30.94 30.5 31.08
5.72 6.2 5.58
37⁵ 37² 41⁵
Apron Bar.
Floor

1+16 37⁶ Lt. = start 5' high Conc. wall.

32.3 33.2
4.4 3.5
37⁶ 37⁵
B.W.

1+15 37⁷ Rt. = start 5' high brick wall

31.3 30.5
5.4 6.2
37⁵ 37²
B.W.

1+07⁵ = 4 Alley

34.3 32.6 32.5 32.2 31.6 32.1 31.6 31.6
2.4 3.1 3.9 4.5 4.9 4.6 5.1 5.1
50 37⁵ 18 15 20 37⁵ 50

1+01 26' Lt. = 20" diam. palm.

36.66

2+52^E =~~F~~ Sequoia

26.66	27.76	27.57	27.06	26.64	26.49	25.78
3.58	4.48	4.67	5.18	5.60	5.75	6.46
100	50	375		375	50	100

2+32^E Cont.

29.13	28.54	26.94	25.73	26.38
3.11	3.70	5.30	6.51	5.86
100	100	50	100	100
06	G	06.E.C.	G	06

{ 50' RT } = L.C. 30' Rad. 06. Rot.
 { 50' LT } = Wly cl. line Sequoia

2+16 - 27² RT. = Polo #500270 Him walk

27.24	27.60	27.40	27.24	27.02	26.76	26.55	26.29
4.00	4.64	4.84	5.00	5.22	5.48	5.71	5.95
50	50	375	20		20	375	50
06	G						G

{ 22.9 RT }
 { 23.2 LT } = start curbs + walks
 2+16 = Wly Sequoia start, A.C. Pavc
 same as above.
 2+14.97 = Wly Sequoia Ground stots

26.9	28.11	28.04	27.43	27.42	26.83	27.48	27.44	27.6
3.3	4.13	4.20	4.81	4.82	5.41	4.76	4.80	3.6
375	35	235	235		229	229	34	375
	N.W. Cor.	06	G		G	06	S.W. Cor.	walk

2+00

20.9	29.9	28.4	28.7	28.1	29.2	29.7
1.3	2.3	3.8	3.5	4.1	3.0	2.5
375	22	13		15	20	375

1+75

31.6	30.9	30.2	30.5	29.9	30.2	30.2
0.6	1.3	2.0	1.7	2.3	2.0	2.0
375	20	11		15	20	375

32.24

500269H

Nail in pole 3.24 ✓ 28.45 ✓

T.P. 3.36 28.57 7.03 25.21 ✓

0469 - 37^E Lt. = end picket fence.

25.7	25.4	24.8	24.7	24.9
6.5	6.8	7.4	7.5	7.3
37 ^E	23		25	37 ^E

0452 - 37^E Lt. = 3' wide Conc. walk

26.29	26.20
5.95	6.04
47 ^E	37 ^E
on walk	

0433 37^Z Rt. = start 5' high board fence.

0431 37^Z Rt. = 4' wide Conc. walk

26.9	26.7	26.1	26.0	25.8	26.5	26.96
5.3	5.5	6.1	6.2	6.4	5.7	5.28
37 ^E	18		20	30	37 ^E	37 ^Z

0410

27.5	27.4	26.4	26.3	26.5	26.5
4.7	4.8	5.8	5.9	5.7	5.7
37 ^E	10	15		22	37 ^E

36^E Lt. = start 2' high picket fence
(22^Z Rt.) = end of curbs

0400 (22^Z Lt.)
2+90 = Ely. line Sequoia

27.4	27.3	26.96	26.39	26.41	26.60	26.40	26.59	26.7
4.8	5.01	5.28	5.85	5.83	6.44	5.84	5.65	5.5
37 ^E	34 ^L	22 ^Z	22 ^Z		22 ^Z	22 ^Z	34 ^L	37 ^E
	N.E. Cor. walk		C		C	C	S.E. Cor. walk	

29.64	28.03	26.40	25.06	25.69
3.60	4.21	5.84	7.18	6.55
100	100	50	100	100
C	C	cc. B.C.	C	C

50' Rt. } = B.C. 30' Rad. cl. Rot.
50' Lt. }

2+72^E } Ely. cl. line Sequoia

27.74	27.16	27.02	26.82	26.67	26.41	26.02	25.76
4.50	5.08	5.22	5.42	5.57	5.93	6.22	6.48
50	50	37 ^E	20		20	37 ^E	50
C	C						C
B.C.							

32.24

- 1+59 23' Lt = Ctr. ctr. 3⁵' palm.
 1+50
 1+43 - 23' Lt. = ctr. 4' diam palm.
 lain on top of ground.
 4" to 6" high + 6" to 10" wide
 stones set in Conc.
 37^E Lt = start row of cobbles
 1+28 22^E Lt = Ctr. 8" Cedar tree
 Car.
 1+21 36^E Lt = ϕ Conc. apron to Sing
 1+15 - 37^E Rt = start lath + wire fence.
 1+02 36^E Rt = pole # 1875
 1+00 37^E Rt = end 2' high picket fence.
 0+82 37^E Lt = ϕ 8' wide level Conc. apron
 to Sing Car.
 also start 2' high picket fence.
 0+80 - 37^E Rt = end 5' high board fence
 0+78 - 28^E Rt = Pole # 500269-4
 0+72 - 37^E Lt = ϕ 3' wide Conc. walk

23.6	23.4	22.9	22.9	22.7
4.9	5.0	5.5	5.5	5.7
37 ^E	12		20	37 ^E

24.45	24.39
4.00	4.06
37 ^E	36 ^E
Car. Floor	Apron

24.4	24.0	25.6	23.5	23.6
4.0	4.4	4.8	4.9	4.8
37 ^E	13		22	37 ^E

25.3	25.1	24.0	23.6	24.2
3.1	3.3	4.4	4.8	4.2
37 ^E	23		22	37 ^E

25.9 ^E	25.50
2.47	2.75
43	37 ^E
Car. Floor.	Apron

25.80	25.70
2.65	2.75
17 ^E	37 ^E
on walk	

28.45

Fortuna

See construction plans.
Lamont St now being improved.

T.P. 4.26 23.76 8.95 19.50

T.P. Pole # 500268 H, 29' RT. of Sta. 2+14

36' Lt. end cobble set in conc.

2+15²² = why line Lamont.

22.5	20.2	20.1	20.6	21.4	21.4
5.9	8.2	8.8	8.8	7.0	7.0
375	21		21	22	375

2+14 29' RT = pole # 500268 H

2+02 - 22⁵ Lt. = 4' diam. palm

2+00

22.8	22.3	21.2	21.1	21.7	21.8
5.6	6.1	7.2	7.3	6.7	6.6
375	15	14		19	375

1+95 37⁵ Lt. = ± 3' wide conc. walk.

23.61	23.35
4.84	5.10
475	375

on walk

1+89 - { 22⁵ Rt. = Guy pole to pole # P3998

22⁵ Lt. = 4' diam. palm

1+85

23.0	22.5	22.1	22.5	22.2
5.4	5.9	6.3	5.9	6.2
375	10		20	375

1+83 - 22 RT. dead man

1+74 - 23 Lt. = 3⁵ diam palm.

1+63 - 37⁵ Rt. = end lath fence.

Fortuna Ave

1+00

~~rt. 8' wide level conc.~~ drive

18.4
5.4
20

18.0
5.8

17.3
6.5
17

19.8
4.0
27

19.9
5.9
37.5

0+90

1 0+87-30' rt = deadman

0+84-31⁸ rt = 3' wide conc. walk.

19.71

4.05
31.8

19.79

3.97
37.5

19.81

3.95
39.8

at house

0+52-31⁸ rt = 8' wide level conc. drive

20.28
3.48
31.8

20.32
3.44
37.5

20.34
3.42
39.8

Bar. floor

0+50

18.4
5.4
20

18.2
5.6

17.3
6.5
16

20.4
3.4
27

20.4
3.4
37.5

0+34-31⁵ rt = 3' wide conc. walk

20.13

3.63
31.5

20.27

3.49
37.5

20.31

3.45
39.5

at house

0+24-29³ rt = 9" diam. pole # JP 1911

10+00 = Ely line Lamont.

18.7
5.1
20

18.0
5.8

17.6
6.2
18

18.1
5.7
19

20.3
3.5
26

20.2
3.6
37.5

23.76

Fortuna

39⁴ Rt. = start 3' wide E. + W. Conc. walk

1+70-37⁸ Rt. = end Conc. apron.

20.3	20.0	17.3	17.6	16.9	14.6	19.6	19.53
3.5	3.8	6.5	6.2	6.9	4.2	4.2	4.23
37 ⁵	23	18		18	26	37 ⁵	38 ⁵
							Apron

1+40-37⁸ Rt. = start Conc. apron. to double Gar.

19.66	19.93
4.10	3.83
37 ⁸	42 ⁴
Apron	Gar. floor

1+34

19.9	14.5	15.2	17.8	17.0	14.1	19.3
3.9	4.0	5.6	6.0	6.8	4.7	4.5
37 ⁵	31	20		17	28	37 ⁵

1+33

16.8	17.8	18.2	17.8	17.0	18.7
5.0	6.0	5.6	6.0	6.8	5.1
37 ⁵	31	20		17	37 ⁵

1+21

18.7	17.8	18.1	19.1
5.1	6.0	5.7	4.7
37 ⁵		16	37 ⁵

1+20

20.1	18.4	17.5	18.1	14.6	14.9
3.7	5.4	6.0	5.7	4.2	3.9
37 ⁵	20		16	26	37 ⁵

1+19-29⁵ Rt. = ± 12" pole # P. 1925

1+02-31⁵ Rt. = ± 8' wide Conc. drive

19.88	20.00	20.06
3.88	3.76	3.70
23.76	37 ⁵	39 ⁵
		Gar. floor

Fortuna

±

61

3+00

17.5	17.0	16.5	16.0	16.3
6.3	6.8	7.3	7.8	7.5
375	17		18	375

2+70

17.8	16.8	16.5	16.3	16.7
6.0	7.0	7.3	7.5	7.1
375	20		16	375

2+63

19.8	19.5	16.6	16.6	16.3	18.8	18.6
4.3	4.3	7.2	7.2	7.5	5.0	5.2
375	26	16		16	25	375

2+54 - 29³ ft. = 10" diam pole J.P. 1949.2+53²⁶ = Wly. line Honey out

19.8	19.7	16.6	16.8	16.3	19.1	18.9
4.0	4.1	7.2	7.0	7.5	4.7	4.9
375	25	16		16	25	375

2+11 - 39² ft. = end conc. perch.

19.4	20.96
4.4	2.86

End Top. of perch

start step + perch

2+05 - 39² ft. = end E.+W. walk

19.57
4.25
39 ²
walk.

2+00

20.3	20.0	17.0	17.3	16.7	19.4	19.5
3.5	3.8	6.8	6.5	7.1	4.4	4.3
375	24	16		16	25	375

TIP. 4.22 23.82 4.16 19.60

23.82

Fortuna

Wly Crown Pt. Dr. on South
1+10⁰⁸ 30⁵⁰ Rt. = Mon. see sketch.

T.B.M. on Mon. A.76

1+00 - 29³ Rt. = dead man.

0+82 - 29⁵ Rt. = 10" diam. pole # J.P. 2023

0+50

0+46 - 37⁸ Lt. = 3' wide Conc. walk

0+00 - continued from Page 6C

- ELY LINE MORRELL

T.P. #1 5103 18.79

0+50 continued on Page C4

See Honey cut cross sec.

-0400 } 30' Rt. = N.W. cor. Conc. drive

3+13.26 } = Ely line Honey cut

37⁸ Lt. = start chairlink fence.

3+03

12.6	13.3	12.6	12.7	12.8	13.4	11.4
5.5	5.0	5.7	5.6	5.5	4.9	3.9
37 ⁵	19	17		18	21	37 ⁵

13.3	13.1	12.7	12.6	12.7	11.3	11.5
5.6	5.2	5.6	5.5	5.6	4.0	3.5
37 ⁵	18	16		17	20	37 ⁵

11.4	14.6	13.4	13.4	13.6	15.1	15.9
3.9	3.5	4.9	4.9	4.7	3.2	2.4
37 ⁵	20	17		18	20	37 ⁵

14.4	14.2
3.83	3.98
43 ⁵	37 ⁸
on walk	

18.26 X. from P. 6C.

T.B.M. = N.E. 7' Mon. Honey cut + Fortuna

14.4	14.3	16.8	16.5	16.0	17.0	17.80	17.80
4.4	4.5	7.0	7.3	7.8	6.8	6.02	6.00
37 ⁵	22	16		18	24	36	37 ⁵
							com. drive

14.6	14.6	17.0	16.5	16.0	16.8	17.0
4.2	4.2	6.8	7.3	7.8	7.0	6.8
37 ⁵	25	16		19	22	37 ⁵

Fortuna

±

63

(on L - along curb)

good, should be replaced.

Point Dr. this curb is no

1+58² = Face. Fly. Curb. Crown

± of Drive for Profile only

± Crown Pt. Drive. taken along

1+26² = wly. Crown Pt. Dr. to North

11.4	11.7	11.9	12.1	12.2	12.4
6.9	6.6	6.4	6.2	6.1	5.9
38	18		18	33	37.5
				End of db.	

10.2	11.1	11.9	12.5	13.0
8.1	7.2	6.4	5.8	5.3
100	50		50	100
11.6	11.9	12.6	12.6	12.7
6.7	6.4	5.7	5.7	5.6
37.5	20		20	37.5

18.26

Fortuna -

64

Continued from page 62

1+23 37³ Lt. = start link wire fence

1+15

1+08 30' Rt. = 9" pole # J.P. 1973

1+07 37⁸ Lt. = end fence.

1+00

17.5	17.4	15.4	15.5	15.3	16.9	17.0
3.0	3.1	5.1	5.0	5.2	3.6	3.5
37 ^E	27	17		17	27	37 ^E

17.6	17.6	15.5	15.7	15.4	16.3	16.9
2.9	2.9	5.0	4.8	5.1	4.2	3.6
37 ^E	25	17		17	24	37 ^E

0+92 37⁶ Rt. = 9' wide level ^{apron} Conc.

0+82 37⁸ Lt. = start fence.

0+82 - 37⁵ Lt. = end apron

17.04	17.54
3.46	2.96
37 ^E	52
Apron	Gar. floor

18.10
2.40
37^E
Apron

double Gar.
37⁵ Lt. = start Conc. apron to
0+66 37⁸ Lt. = end fence

18.91	18.10
1.59	2.40
49	37 ^E
Gar. floor	Apron

0+50

18.3	17.4	16.1	16.2	16.1	16.9	17.3
2.2	3.1	4.4	4.3	4.4	3.6	3.2
37 ^E	22	17	20.50	17	24	37 ^E

Continued from red line on P-62

1.71 20.50

18.79

T.P. #1 P 62 N.E. Mon Honeycutt + Fortuna

Continued from P-62

Fortuna

2+30¹⁰ = wly line Morrell

2+28 30' Rt = 12" pole # P 2001

2+08 30' Rt = deadman

2+00

1+80 38' Rt = end apron.

1+77 48' Lt = \pm Sing Gar. Conc. floor

1+73 37⁵ Lt = end fence.

1+61 - 38' Rt = start Conc apron to double bar.

1+50

16.1	16.0	14.8	15.1	14.9	16.6	17.3
4.4	4.5	5.7	5.4	5.6	3.9	3.2
37 ⁵	23	16		18	23	37 ⁵

16.7	16.8	15.1	15.0	15.0	16.8	16.9
3.8	3.7	5.4	5.5	5.5	3.7	3.6
37 ⁵	23	16		17	24	37 ⁵

17.00
3.50
38
Apron

17.66
2.84
48'
Floor

17.05
3.45
38
Apron

17.32
3.18
46⁵
Bar-plan

17.3	17.3	15.1	15.3	15.2	16.7	16.8
3.2	3.2	5.4	5.2	5.3	3.8	3.7
37 ⁵	26	16		17	24	37 ⁵

Fortuna

66

Continued at red line - Page 62

3.15 18.26 5.39 15.11 (15.10)

= N.E. 7' Mon Fortuna + Morrell

= 0+00

2+90¹⁰ = Ely line Morrell

15.1	15.3	14.1	14.4	14.2	16.6	16.9
5.4	5.2	6.4	6.1	6.3	3.9	3.6
37E	21	15		18	26	37E

2+73

15.6	15.8	14.4	14.7	14.2	17.0	17.0
4.9	4.7	6.1	5.8	6.3	3.5	3.5
37E	24	16		18	26	37E

2+70

15.3	15.1	14.5	14.7	14.2	15.9
5.2	5.4	6.0	5.8	6.3	4.6
37E	25	16		18	37E

2+45

15.3	15.3	14.7	15.0	14.6	15.6
5.2	5.2	5.8	5.5	5.9	4.7
37E	23	17		18	37E

20.50

Fortuna
Ingraham. to P.B. Drive
Easterly side (pave to ch.)

3-30-53

C.H.S.

see page 34.

check tie sheets for
correct sta. at 5+26±

INDEXED
file
MAY 2 1953

67

Pacific Beach
Drive

5+26±

20' ± 10'

INGRAHAM

75' ← Comb walk
+ ch.

0+02^E
0+00

20' Ch. Rad.

↑
N14.
Fortuna

Fortuna

~LTT=0-37⁵⁰

Ingraham

#

68

1450

44.93		45.15
5105	515	4183
20	30	30
E.P.		cb

1400

44.82		45.04
5116	516	4194
20	30	30
E.P.		cb

0450

44.68		44.92
5130	518	5106
20	30	30
E.P.		cb

0402^E 30' Nt. = cb. E.C.

44.60		44.82
5138	612	5116
20	30	30
E.P.		cb. E.C.

0400 = Nly. Fortune

44.59		44.82
5139	612	5116
20	30	30
E.P.		cb
49.98		

5.33

49.98

44.65

B.M # A page 37 # Lt. Fortune & Ingraham

Ingraham

4+21 - in drive

5155
30

4+08 in drive

45530
5161
30
5136 516 5109
20 30 30
E.P. 06

4+00

45520
5146 516 5116
20 30 30
E.P. 06

3+50

45512
5154 517 5125
20 30 30
E.P. 06

3+00

45508
5158 518 5137
20 30 30
E.P. 06

2+50

50.66

T.P. 5.22 50.66 4.54 45.44

2+00

4497
501 513 4.74
20 30 30
E.P. 06

49.98

Ingraham

5+75

5+46t Cont.

5+46t 50' RT. = E.C. 20' Rad. cb. Ret.

ctr. of cb. Ret.

5+26 = 30' RT. = B.C. 20' Rad cb. Ret.

5+00

4+50

TIP	5.13	<u>51.00</u>	4.79	45.87
		50.66		

#

70

5.21	5.2	5.2	4.9
21	30	50	100
E.P.			

5.3	4.45
100	100
	cc

5.40	5.7	5.7	4.89
20	30	50	50
E.P.			cc. E.C.

5.02

cc. cc.

5.45	5.7	5.18
20	30	30
E.P.		cc

5.53	5.7	5.25
20	30	30
E.P.		cc

5.64	5.8	5.29
20	30	30
E.P.		cc

51.00

Clark
Shepherd
Brumer
O'Neil

2-28-55
WO 32485

X-SECT. ALLEY BIK 17 - NORDICA HTS #2
(CASEMENT)

REF: MAP 1455
T.P.S. #419

Sketch not to scale:
Notes pg 72

INDEXED
MER
MAR 1 1955

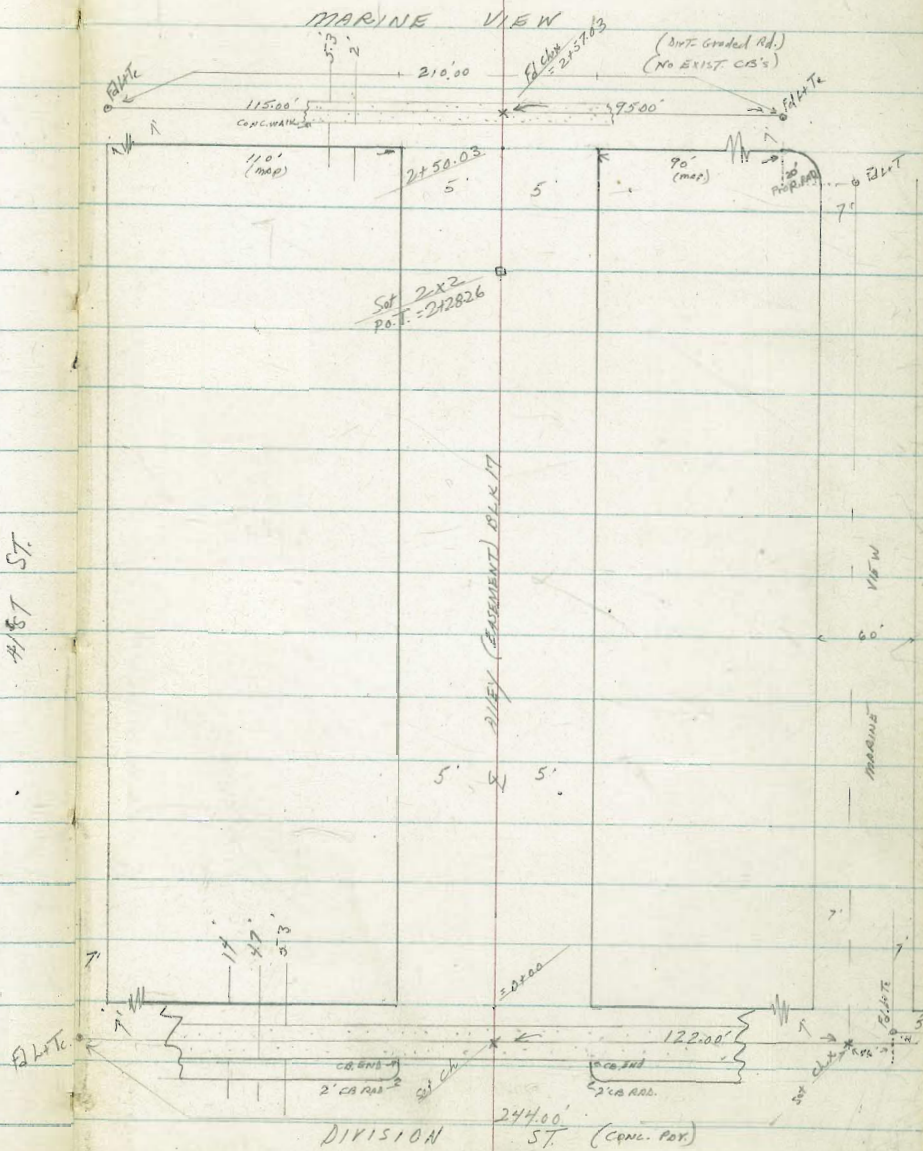

71

V-SECT ALLEY BLK 17- NORDICA HT'S #2

LT.

E

RT.

72

71.3 71.5 70.7 70.8 71.0 71.4 70.5 73.0 73.1
 8.1 8.1 8.7 8.6 8.4 8.0 8.4 6.3 6.3
 8 5 3 5 5 6.5 8 15
 172
 wall

0+20

0+18

5.6 LT Bay 6.0' Board Fence

0+11

4.2 LT E Deadman

TR

9.85 79.39 1.09 69.54

79.39

0+00

68.4 68.2 68.5 68.7 69.0 72.8 72.6
 2.2 2.4 2.3 1.9 1.6 12.2 12.0
 7 5 5 5 6.7 8 15
 172
 wall

0-02.1

6.7 RT Bay Conc. Ret. wall
 8.35 LT Bay 9' w. 4' apcs (opens on division ST)

68.2 67.1 73.06 72.8 72.6
 2.4 3.5 2.43 12.2 12.0
 6.7 6.7 6.7 8 15
 172
 wall

0-04=

BK. edge walk

67.76 67.07 67.1 67.45 67.5 68.0 67.75 67.10
 3.87 3.56 3.5 3.19 3.1 2.6 2.88 2.53
 10 5 5 5 5 5 10
 BK BK BK BK BK BK BK BK
 WALK WALK WALK WALK WALK WALK WALK WALK

0-09.3

LT = CB. END (Flush walk)
 RT = CB. END
 edge conc. Pav / Flush Tr. WALK

66.60 66.92 66.91 67.29 67.5 67.57 67.97
 4.03 3.71 3.72 3.70 3.08 3.06 2.66
 10 5 5 5 5 5 10
 F. WALL F. WALL F. WALL F. WALL F. WALL F. WALL F. WALL

0-14=

NLY CB Line Division

66.29 66.29 66.19 66.19 66.29 66.29 66.29 66.29 66.29 66.29
 8.54 8.46 8.27 8.27 8.27 8.27 8.27 8.27 8.27 8.27
 7.5 5.0 5.0 5.0 5.0 5.0 5.0 5.0 5.0 5.0
 CB CB CB CB CB CB CB CB CB CB

0-39=

E Imp's (unequal PK'G on division)

62.16 63.79 67.26 70.63 72.2
 8.47 6.84 3.37 4.00 4.59
 7.5 3.0 5.0 7.5 7.5

B.M.

13.29 70.63

57.34 N.W.B.P.
 DIVISION X H'ST

70.63

ALLEY BIK 17 (CONT)

- 1+00
- 0+99 4.5' LT $\frac{1}{2}$ Pole PA 2169
- 0+94 5.3' LT END 2.5' WALK
- 0+91 39.8 RT $\frac{1}{2}$ Single gar, 38.1 RT APRON
- 0+78 $\left\{ \begin{array}{l} 5.4' \text{ LT Bay 2.5' wide conc. walk // to Alley} \\ 7.6' \text{ RT END wall} \\ 5.0' \text{ LT END CON. DRIVE (APRON)} \end{array} \right.$
- 0+65 5.00' LT Bay Conc. Drive (Apron) 8.5' LT gar
- 0+63.5 5.4' LT END Board Fence
- 0+56.5 5.7' LT $\frac{1}{2}$ 6" Tree
- 0+50 = $\frac{1}{2}$ E-WESTLY CON. WALL - MEETS NLY $\frac{1}{2}$ 5 1/4" WALL
- 0+34 4.0' LT $\frac{1}{2}$ Pole # PA 2195
- 0+28 3.4' LT $\frac{1}{2}$ 2x34 CONC. SLAB IN ALLEY
- 0+25 3.4' LT $\frac{1}{2}$ 2.5' WALK

LT. E RT.

73.1 73.2 73.6 73.6 73.1 73.9

6.3 6.2 5.8 5.8 5.7 5.5

10 8 5 5 5 15

73.33

6.06

5.3

E-W EDGE

WALK

15.28

4.11

38.1

LIP

15.39

4.00

37.8

F.I.

72.81

72.83

72.79

6.58 6.56 6.60

8.5 6.4 5.0

F.I. EDGE LIP

9.1 WALK

72.5

74.69

6.9 4.70

7.6 7.8

F.I. WALK

72.77

72.70

6.62 6.69

8.5 5.0

F.I. LIP

72.5 72.6

6.9 6.8

72.5 72.6

6.9 6.8

72.5 72.6

6.6 6.2 6.0

6.5 7.8 15

F.I. WALL

71.78

72.06

71.94

7.91 7.83 7.75

10 3.4

10 WALK LIP

79.39

ALLEY BIK 17 (CONT)

LT

E

RT

7A

1494 17.7 LT & Single-gar - Con. Fl.

7A.16
5.23
14.7
Fl.

1471 17.7 LT end Double-gar,

7A.16
5.23
14.7
Fl.

1456.5 15.3 RT & Single-gar - Con. Fl.

7A.16
3.88
15.3
Fl.

1454 14.5 LT Bay Double-gar & APTS, Con. Fl.

7A.13
5.26
14.5
Fl.

1450

7A.8
5.6
15

7A.0
5.7
5

7A.1
5.3

7A.2
5.2
5

7A.8
4.6
5

1434 12.6 RT - B.C. 2.5' Con walk - Curves Ely AWAY From alley

7A.51
4.88
12.6
w. edge
walk

7A.66
4.73
12.1
AK
edge

1423 6.6 LT end gar. (12.3 LT to E gar - Con. Fl.)

7A.89
6.50
12.3
Fl.
gar

7A.9
6.71
12.3
Fl.
gar

1409 E gar - 12.5 RT to Lip walk, 15 RT to Floor

7A.42
4.97
12.5
LP

7A.42
4.77
15
Fl.

1403.5

6.9 LT Bay gar. // to alley - (opens N'ly)
12.4 RT - w. edge 2.5' CON WALK // to alley
(curves 22' away from alley this pt.)

7A.39
5.00
12.4
w. edge
walk

7A.56
4.83
14.9
AK
edge

1401

6.1 LT & 2' Con. walk

7A.74
6.5
16
on walk

7A.87
6.52
6.1
LP

79.39

ALLEY BIK 17 (CONT.)

- 2137 5.7 LT & Pole # 416725-H
- 2125 4.5 LT = L IN 5' PICKET FENCE // to alley here
- 2121 7' LT Beg 5' Picket Fence
- 2120
- 2119 19.2 LT & 3' CON. WALL
- 2116 14.9 LT END APRON
- 2106 14.8 LT Beg CON. APRON, 22.6 LT FL. APRON
- 2104 7.15 RT = L IN BIK WALL // to alley here
- 2100 11.1 RT = L E/W WALL - CONC. BIK 5' high
- 1499 5.3 LT & Pole # PA 2131

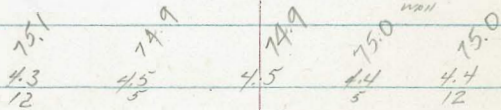
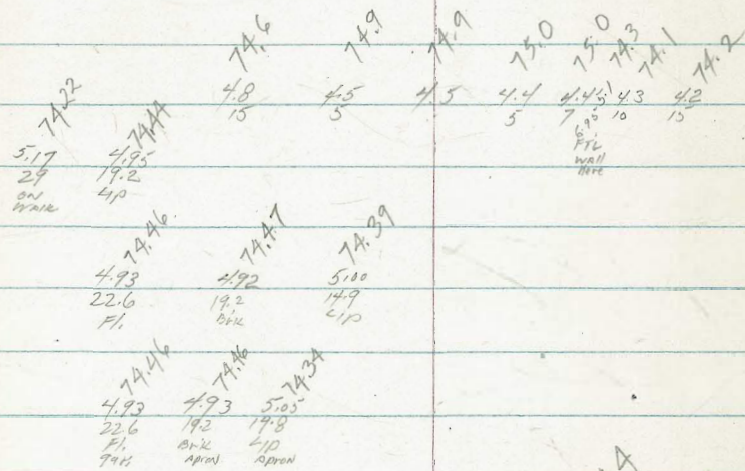

79.39

*

LT.

E

RT.

PILEY BIR, 17 (CONT.)

2+62 = 9th Brk = cut grade along Marine-way

2+58 → 7.4 LT & Brk #411

2+57.30 = Front Edge MARK (No CBS)

2+52 = BK. Edge Conc. MARK

T.P. 4.66 72.40 11.65 67.74

2+50.03 (Sect. Along Tee - Cut BANK - (No walls))

2+50.03 = S/Ly Line MARINE VIEW (Sect. along Tee)
 5.5' LT END 5' Picket-Fence
 LT END Bank Conc. WALL 25 W. 4y 90°
 5.05' RT END CON. Ret WALL - 25 6 2y at 90°

2+49 6.7' RT End BRK. WALL

2+46.5 6' LT & Deadman

2+44 4.9' LT Bay ROCKS - CON. WALL, 15" wide (Flush with grid)

2+43 5.1' RT Bay CON. Ret. WALL - 6" wide (Flush with TP EXIST. grid)

2+38 = BRK
 5' RT & 4' W 4y 4" CH. DRAIN

LT.	£	RT.	76
62.8	67.3	67.6	67.9
77	66.5	67.0	67.9
68	67.2	66.7	67.9
5.9 5.2	5.1 5.8	5.8 5.7	4.5 4.7
8.6	4.8 4.83	4.66 4.7	4.5 4.7
100	4.8	4.52	4.5 4.7
9th FW	5th FW	5th FW	5th FW
67.52	67.10	67.85	67.99
4.88	4.70	4.55	4.41
10	5	5	5
B.W	B.W	BK WALL	B.W

67.1	67.4	67.7	67.9	68.1	68.3	68.4
12.3	12.0	11.7	10.5	11.3	11.1	11.0
25	15	5		5	15	25

13.4	6.9	73.67	68.9	68.4	67.3	74.70	74.7
6.0	12.5	5.72	10.5	11.0	12.1	4.69	4.7
15	5	5		5	5.05	5.05	15
9th BK WALL	10th BK WALL	TP BANK WALL		9th BK WALL	10th BK WALL	TP BANK WALL	9th BK WALL

73.99
 5.40
 6.7
 FFL WALL

73.00
 6.39
 4.8
 FFL WALL

74.4
 5.7
 15

74.5
 4.9
 5

74.6
 4.8

79.39

74.71
 72.01
 7.38
 5.1
 TP WALL
 74.6
 74.27
 75.0
 4.8
 5.67
 5
 FFL WALL
 4.6
 4.6
 10
 15

Alley BIK 17 (cont)

LT

CF

RT

77

LKR 7.94 57.33 = 57.34 STG.B.M.

T.P 2.26 65.27 9.37 63.01

2480.037 4 Marine View (graded dirt Rd)

63.0
9.4
/100

65.0
7.4
/50

67.4
5.0

67.7
4.7
/50

68.2
4.2
/95

72.40
/

446
272
778
359

4770

Lamont 9336-L

50

12.5

114.61

107.61

25.22

58.89

26.20

37.68

214.99

107.49

68

175.49

163.00

12.49

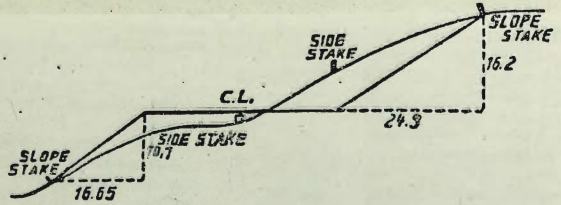

DISTANCES FROM SIDE STAKES FOR CROSS-SECTIONING.
SLOPE 1 1/2 TO 1. ROADWAY OF ANY WIDTH.

	0	.1	.2	.3	.4	.5	.6	.7	.8	.9	
0	0.00	0.15	0.30	0.45	0.60	0.75	0.90	1.05	1.20	1.35	0
1	1.50	1.65	1.80	1.95	2.10	2.25	2.40	2.55	2.70	2.85	1
2	3.00	3.15	3.30	3.45	3.60	3.75	3.90	4.05	4.20	4.35	2
3	4.50	4.65	4.80	4.95	5.10	5.25	5.40	5.55	5.70	5.85	3
4	6.00	6.15	6.30	6.45	6.60	6.75	6.90	7.05	7.20	7.35	4
5	7.50	7.65	7.80	7.95	8.10	8.25	8.40	8.55	8.70	8.85	5
6	9.00	9.15	9.30	9.45	9.60	9.75	9.90	10.05	10.20	10.35	6
7	10.50	10.65	10.80	10.95	11.10	11.25	11.40	11.55	11.70	11.85	7
8	12.00	12.15	12.30	12.45	12.60	12.75	12.90	13.05	13.20	13.35	8
9	13.50	13.65	13.80	13.95	14.10	14.25	14.40	14.55	14.70	14.85	9
10	15.00	15.15	15.30	15.45	15.60	15.75	15.90	16.05	16.20	16.35	10
11	16.50	16.65	16.80	16.95	17.10	17.25	17.40	17.55	17.70	17.85	11
12	18.00	18.15	18.30	18.45	18.60	18.75	18.90	19.05	19.20	19.35	12
13	19.50	19.65	19.80	19.95	20.10	20.25	20.40	20.55	20.70	20.85	13
14	21.00	21.15	21.30	21.45	21.60	21.75	21.90	22.05	22.20	22.35	14
15	22.50	22.65	22.80	22.95	23.10	23.25	23.40	23.55	23.70	23.85	15
16	24.00	24.15	24.30	24.45	24.60	24.75	24.90	25.05	25.20	25.35	16
17	25.50	25.65	25.80	25.95	26.10	26.25	26.40	26.55	26.70	26.85	17
18	27.00	27.15	27.30	27.45	27.60	27.75	27.90	28.05	28.20	28.35	18
19	28.50	28.65	28.80	28.95	29.10	29.25	29.40	29.55	29.70	29.85	19
20	30.00	30.15	30.30	30.45	30.60	30.75	30.90	31.05	31.20	31.35	20
21	31.50	31.65	31.80	31.95	32.10	32.25	32.40	32.55	32.70	32.85	21
22	33.00	33.15	33.30	33.45	33.60	33.75	33.90	34.05	34.20	34.35	22
23	34.50	34.65	34.80	34.95	35.10	35.25	35.40	35.55	35.70	35.85	23
24	36.00	36.15	36.30	36.45	36.60	36.75	36.90	37.05	37.20	37.35	24
25	37.50	37.65	37.80	37.95	38.10	38.25	38.40	38.55	38.70	38.85	25
26	39.00	39.15	39.30	39.45	39.60	39.75	39.90	40.05	40.20	40.35	26
27	40.50	40.65	40.80	40.95	41.10	41.25	41.40	41.55	41.70	41.85	27
28	42.00	42.15	42.30	42.45	42.60	42.75	42.90	43.05	43.20	43.35	28
29	43.50	43.65	43.80	43.95	44.10	44.25	44.40	44.55	44.70	44.85	29
30	45.00	45.15	45.30	45.45	45.60	45.75	45.90	46.05	46.20	46.35	30
31	46.50	46.65	46.80	46.95	47.10	47.25	47.40	47.55	47.70	47.85	31
32	48.00	48.15	48.30	48.45	48.60	48.75	48.90	49.05	49.20	49.35	32
33	49.50	49.65	49.80	49.95	50.10	50.25	50.40	50.55	50.70	50.85	33
34	51.00	51.15	51.30	51.45	51.60	51.75	51.90	52.05	52.20	52.35	34
35	52.50	52.65	52.80	52.95	53.10	53.25	53.40	53.55	53.70	53.85	35
36	54.00	54.15	54.30	54.45	54.60	54.75	54.90	55.05	55.20	55.35	36
37	55.50	55.65	55.80	55.95	56.10	56.25	56.40	56.55	56.70	56.85	37
38	57.00	57.15	57.30	57.45	57.60	57.75	57.90	58.05	58.20	58.35	38
39	58.50	58.65	58.80	58.95	59.10	59.25	59.40	59.55	59.70	59.85	39
40	60.00	60.15	60.30	60.45	60.60	60.75	60.90	61.05	61.20	61.35	40
41	61.50	61.65	61.80	61.95	62.10	62.25	62.40	62.55	62.70	62.85	41
42	63.00	63.15	63.30	63.45	63.60	63.75	63.90	64.05	64.20	64.35	42
43	64.50	64.65	64.80	64.95	65.10	65.25	65.40	65.55	65.70	65.85	43
44	66.00	66.15	66.30	66.45	66.60	66.75	66.90	67.05	67.20	67.35	44
45	67.50	67.65	67.80	67.95	68.10	68.25	68.40	68.55	68.70	68.85	45
46	69.00	69.15	69.30	69.45	69.60	69.75	69.90	70.05	70.20	70.35	46
47	70.50	70.65	70.80	70.95	71.10	71.25	71.40	71.55	71.70	71.85	47
48	72.00	72.15	72.30	72.45	72.60	72.75	72.90	73.05	73.20	73.35	48
49	73.50	73.65	73.80	73.95	74.10	74.25	74.40	74.55	74.70	74.85	49
50	75.00	75.15	75.30	75.45	75.60	75.75	75.90	76.05	76.20	76.35	50

THE NATIONAL BLANK BOOK COMPANY
HOLYOKE MASSACHUSETTS
NEW YORK CHICAGO BOSTON SAN FRANCISCO