

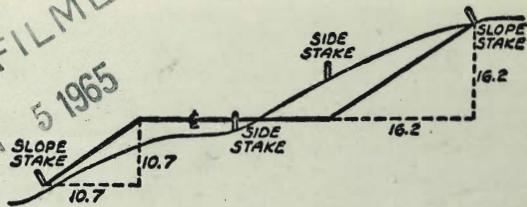



MICROFILMED  
 JAN 5 1965



DISTANCES FROM SIDE STAKES FOR CROSS-SECTIONING  
 SLOPE 1 TO 1. ROADWAY OF ANY WIDTH

	0	.1	.2	.3	.4	.5	.6	.7	.8	.9	
0	0.00	0.10	0.20	0.30	0.40	0.50	0.60	0.70	0.80	0.90	0
1	1.00	1.10	1.20	1.30	1.40	1.50	1.60	1.70	1.80	1.90	1
2	2.00	2.10	2.20	2.30	2.40	2.50	2.60	2.70	2.80	2.90	2
3	3.00	3.10	3.20	3.30	3.40	3.50	3.60	3.70	3.80	3.90	3
4	4.00	4.10	4.20	4.30	4.40	4.50	4.60	4.70	4.80	4.90	4
5	5.00	5.10	5.20	5.30	5.40	5.50	5.60	5.70	5.80	5.90	5
6	6.00	6.10	6.20	6.30	6.40	6.50	6.60	6.70	6.80	6.90	6
7	7.00	7.10	7.20	7.30	7.40	7.50	7.60	7.70	7.80	7.90	7
8	8.00	8.10	8.20	8.30	8.40	8.50	8.60	8.70	8.80	8.90	8
9	9.00	9.10	9.20	9.30	9.40	9.50	9.60	9.70	9.80	9.90	9
10	10.00	10.10	10.20	10.30	10.40	10.50	10.60	10.70	10.80	10.90	10
11	11.00	11.10	11.20	11.30	11.40	11.50	11.60	11.70	11.80	11.90	11
12	12.00	12.10	12.20	12.30	12.40	12.50	12.60	12.70	12.80	12.90	12
13	13.00	13.10	13.20	13.30	13.40	13.50	13.60	13.70	13.80	13.90	13
14	14.00	14.10	14.20	14.30	14.40	14.50	14.60	14.70	14.80	14.90	14
15	15.00	15.10	15.20	15.30	15.40	15.50	15.60	15.70	15.80	15.90	15
16	16.00	16.10	16.20	16.30	16.40	16.50	16.60	16.70	16.80	16.90	16
17	17.00	17.10	17.20	17.30	17.40	17.50	17.60	17.70	17.80	17.90	17
18	18.00	18.10	18.20	18.30	18.40	18.50	18.60	18.70	18.80	18.90	18
19	19.00	19.10	19.20	19.30	19.40	19.50	19.60	19.70	19.80	19.90	19
20	20.00	20.10	20.20	20.30	20.40	20.50	20.60	20.70	20.80	20.90	20
21	21.00	21.10	21.20	21.30	21.40	21.50	21.60	21.70	21.80	21.90	21
22	22.00	22.10	22.20	22.30	22.40	22.50	22.60	22.70	22.80	22.90	22
23	23.00	23.10	23.20	23.30	23.40	23.50	23.60	23.70	23.80	23.90	23
24	24.00	24.10	24.20	24.30	24.40	24.50	24.60	24.70	24.80	24.90	24
25	25.00	25.10	25.20	25.30	25.40	25.50	25.60	25.70	25.80	25.90	25
26	26.00	26.10	26.20	26.30	26.40	26.50	26.60	26.70	26.80	26.90	26
27	27.00	27.10	27.20	27.30	27.40	27.50	27.60	27.70	27.80	27.90	27
28	28.00	28.10	28.20	28.30	28.40	28.50	28.60	28.70	28.80	28.90	28
29	29.00	29.10	29.20	29.30	29.40	29.50	29.60	29.70	29.80	29.90	29
30	30.00	30.10	30.20	30.30	30.40	30.50	30.60	30.70	30.80	30.90	30
31	31.00	31.10	31.20	31.30	31.40	31.50	31.60	31.70	31.80	31.90	31
32	32.00	32.10	32.20	32.30	32.40	32.50	32.60	32.70	32.80	32.90	32
33	33.00	33.10	33.20	33.30	33.40	33.50	33.60	33.70	33.80	33.90	33
34	34.00	34.10	34.20	34.30	34.40	34.50	34.60	34.70	34.80	34.90	34
35	35.00	35.10	35.20	35.30	35.40	35.50	35.60	35.70	35.80	35.90	35
36	36.00	36.10	36.20	36.30	36.40	36.50	36.60	36.70	36.80	36.90	36
37	37.00	37.10	37.20	37.30	37.40	37.50	37.60	37.70	37.80	37.90	37
38	38.00	38.10	38.20	38.30	38.40	38.50	38.60	38.70	38.80	38.90	38
39	39.00	39.10	39.20	39.30	39.40	39.50	39.60	39.70	39.80	39.90	39
40	40.00	40.10	40.20	40.30	40.40	40.50	40.60	40.70	40.80	40.90	40
41	41.00	41.10	41.20	41.30	41.40	41.50	41.60	41.70	41.80	41.90	41
42	42.00	42.10	42.20	42.30	42.40	42.50	42.60	42.70	42.80	42.90	42
43	43.00	43.10	43.20	43.30	43.40	43.50	43.60	43.70	43.80	43.90	43
44	44.00	44.10	44.20	44.30	44.40	44.50	44.60	44.70	44.80	44.90	44
45	45.00	45.10	45.20	45.30	45.40	45.50	45.60	45.70	45.80	45.90	45
46	46.00	46.10	46.20	46.30	46.40	46.50	46.60	46.70	46.80	46.90	46
47	47.00	47.10	47.20	47.30	47.40	47.50	47.60	47.70	47.80	47.90	47
48	48.00	48.10	48.20	48.30	48.40	48.50	48.60	48.70	48.80	48.90	48
49	49.00	49.10	49.20	49.30	49.40	49.50	49.60	49.70	49.80	49.90	49
50	50.00	50.10	50.20	50.30	50.40	50.50	50.60	50.70	50.80	50.90	50

Distance of slope stake from side or shoulder stake for any width roadway, slope 1 to 1. If ground is nearly level, the cut or fill at side stake is located by the double entry method in left column and top row. The number in body of table in same row and column gives distance from side stake to slope stake. If ground is not level estimate the difference in elevation between the side stake and slope stake, lower target by this amount if cut, elevate if fill. Add this amount to cut or fill and find distance in table. Set up rod at this point, and line of sight should cut target. If it does not make the slight adjustment necessary.



TABLE XIII—CORRECTIONS FOR TANGENTS AND EXTERNALS

These corrections are to be added to the approximate values, found by dividing the tangent, or external, for a 1° curve (Table VIII) by the degree of curve, in order to obtain the true tangents, or externals. Intermediate values may be obtained by interpolation.

FOR TANGENTS ADD

Central Angle	DEGREE OF CURVE													
	5°	10°	15°	20°	25°	30°	35°	40°	45°	50°	55°	60°	65°	70°
10°	.03	.06	.09	.13	.16	.19	.22	.25	.28	.31	.34	.38	.42	.46
15°	.04	.10	.14	.19	.24	.29	.34	.39	.45	.51	.53	.58	.63	.68
20°	.06	.13	.19	.26	.32	.39	.45	.51	.58	.65	.72	.79	.84	.90
25°	.08	.16	.24	.33	.40	.49	.58	.67	.75	.83	.90	.99	1.06	1.14
30°	.10	.19	.29	.39	.49	.59	.69	.79	.89	.99	1.09	1.20	1.29	1.39
35°	.11	.22	.34	.47	.58	.69	.79	.81	.92	1.04	1.29	1.42	1.54	1.66
40°	.13	.26	.40	.53	.67	.80	.93	1.06	1.20	1.34	1.49	1.64	1.79	1.94
45°	.15	.30	.44	.60	.76	.91	1.06	1.21	1.37	1.52	1.70	1.87	2.04	2.21
50°	.17	.34	.51	.68	.85	1.02	1.19	1.36	1.54	1.72	1.91	2.10	2.29	2.48
55°	.19	.38	.57	.76	.95	1.14	1.32	1.52	1.72	1.92	2.14	2.35	2.56	2.77
60°	.21	.42	.63	.84	1.05	1.27	1.49	1.71	1.94	2.17	2.38	2.60	2.83	3.07
65°	.23	.46	.69	.93	1.16	1.40	1.64	1.88	2.13	2.38	2.63	2.88	3.13	3.39
70°	.25	.51	.76	1.02	1.28	1.54	1.80	2.06	2.33	2.60	2.88	3.16	3.44	3.72
75°	.27	.56	.83	1.12	1.40	1.69	1.98	2.27	2.57	2.87	3.16	3.47	3.78	4.09
80°	.30	.61	.91	1.22	1.53	1.84	2.15	2.46	2.78	3.10	3.44	3.78	4.12	4.46
85°	.33	.66	1.00	1.33	1.68	2.02	2.36	2.70	3.05	3.40	3.77	4.14	4.55	4.89
90°	.36	.72	1.09	1.45	1.83	2.20	2.57	2.94	3.32	3.70	4.10	4.50	4.91	5.32
95°	.39	.79	1.19	1.55	2.00	2.40	2.80	3.20	3.61	4.02	4.40	4.98	5.38	5.83
100°	.43	.86	1.30	1.74	2.18	2.62	3.06	3.50	3.95	4.40	4.88	5.37	5.85	6.34
110°	.51	1.03	1.56	2.08	2.61	3.14	3.67	4.21	4.76	5.31	5.86	6.43	7.01	7.60
120°	.62	1.25	1.93	2.52	3.16	3.81	4.45	5.11	5.77	6.44	7.12	7.80	8.50	9.22

FOR EXTERNALS ADD

Central Angle	DEGREE OF CURVE													
	5°	10°	15°	20°	25°	30°	35°	40°	45°	50°	55°	60°	65°	70°
10°	.001	.003	.004	.006	.007	.008	.009	.011	.012	.014	.015	.017	.018	.020
15°	.003	.007	.010	.014	.018	.023	.027	.029	.032	.035	.039	.043	.047	.051
20°	.006	.011	.017	.022	.028	.034	.038	.045	.051	.057	.063	.070	.076	.083
25°	.009	.018	.027	.036	.046	.056	.065	.074	.083	.093	.105	.120	.127	.135
30°	.013	.025	.038	.051	.065	.078	.090	.103	.116	.129	.149	.170	.179	.188
35°	.018	.035	.054	.072	.086	.109	.131	.153	.175	.197	.213	.230	.247	.264
40°	.023	.046	.070	.093	.117	.141	.172	.203	.234	.265	.277	.290	.315	.341
45°	.030	.060	.093	.119	.153	.184	.216	.254	.289	.325	.351	.378	.411	.445
50°	.037	.075	.116	.151	.189	.227	.268	.305	.345	.384	.425	.467	.508	.550
55°	.046	.093	.142	.188	.236	.283	.332	.381	.420	.479	.530	.582	.641	.700
60°	.056	.112	.168	.225	.283	.340	.398	.457	.516	.575	.636	.697	.774	.851
65°	.067	.135	.204	.273	.343	.412	.483	.554	.625	.697	.771	.845	.922	1.01
70°	.080	.159	.240	.321	.403	.485	.568	.652	.735	.819	.906	.994	1.08	1.17
75°	.095	.182	.286	.383	.480	.578	.678	.777	.877	.977	1.07	1.18	1.29	1.39
80°	.110	.220	.332	.445	.558	.671	.787	.903	1.02	1.13	1.25	1.38	1.50	1.62
85°	.128	.259	.391	.524	.657	.790	.926	1.06	1.20	1.34	1.47	1.62	1.76	1.91
90°	.149	.299	.450	.603	.756	.910	1.07	1.22	1.38	1.54	1.70	1.87	2.03	2.20
95°	.174	.350	.522	.706	.885	1.06	1.25	1.43	1.62	1.80	1.99	2.18	2.38	2.58
100°	.200	.401	.604	.809	1.01	1.22	1.43	1.64	1.85	2.06	2.28	2.50	2.73	2.96
110°	.268	.536	.806	1.08	1.35	1.63	1.91	2.20	2.48	2.76	3.05	3.35	3.66	3.96
120°	.360	.721	1.08	1.45	1.82	2.19	2.57	2.95	3.33	3.72	4.11	4.50	4.91	5.32

X-Sec alley 22 City Hts.

1-6

Valencia + Point Cometa  
Re X Sec B/K A Sunset Crest Alexandria, Trinidad 45-50



D. Smith  
C. Allen  
R. Taylor  
R. Parks

Cross Sec. Alley BIK RR

(M) Montclair #1684

W.O.# 31806

1/24/53

INDEXED  
Low  
JAN 29 1953

Quince St

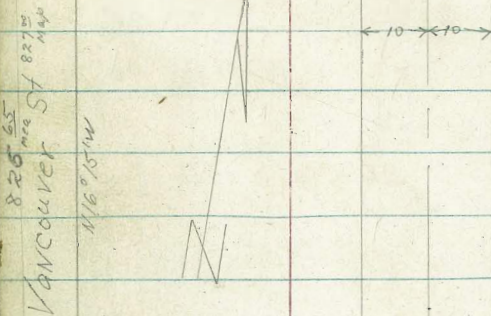
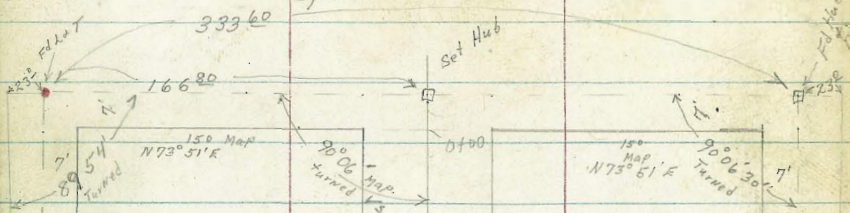

3408 set pot stub

cont at p. 20

Vancouver St

Haller St

613288 set pot stub

6174 24 set pot stub

6174 24 set pot stub

6174 24 set pot stub

10 x 10

Haller St

6136 27 set pot stub

6174 24 set pot stub

7486 72 set pot stub

6429 30 set pot stub on swim SHH.

7452 24 set pot stub

set pot stub

set pot stub

34829

Olive St

150 Map 13064

90°02'30" turned 30'

30' set pot stub

150'



Lt-East

Rt-West

2

0+66 11<sup>3</sup> Lt E double garage con floor apron

0+62 11<sup>0</sup> Rt E single garage con floor

0+50

Begin 3' iron grill fence

0+40 9<sup>2</sup> Rt End 5' wire fence

0+00 Sly Quince 9<sup>2</sup> Rt Begin 5' wire fence

B.M.

0-07 ON E Hub

5<sup>48</sup> 293<sup>51</sup>

0-12

0-14

0-30 E Quince

TR 8<sup>24</sup>

298<sup>99</sup>

0<sup>24</sup>

290<sup>05</sup>

BM 11<sup>30</sup>

290<sup>99</sup>

279<sup>69</sup>

NEBP  
Quince  
Nite

298<sup>99</sup> ✓

293.01  
5<sup>98</sup>  
15<sup>2</sup> Floor

292.17  
6<sup>23</sup>  
11<sup>3</sup> apron

6<sup>13</sup> 292.7  
25

6<sup>13</sup> 292.7  
10

6<sup>10</sup> 292.8  
10

6<sup>10</sup> 293.0  
10

6<sup>10</sup> 293.0  
15

6<sup>10</sup> 292.98  
11<sup>0</sup> Floor

293.2  
5<sup>8</sup>  
25

293.9  
5<sup>1</sup>  
10

293.9  
5<sup>2</sup>  
6

293.7  
5<sup>3</sup>  
3

293.5  
5<sup>5</sup>  
6

293.2  
5<sup>8</sup>  
10

293.6  
5<sup>4</sup>  
10

294.0  
5<sup>0</sup>  
25

292.4  
6<sup>6</sup>  
50

293.4  
5<sup>6</sup>  
25

293.9  
5<sup>1</sup>  
10

294.1  
4<sup>9</sup>  
10

293.6  
5<sup>4</sup>  
10

294.1  
4<sup>2</sup>  
25

294.1  
4<sup>8</sup>  
50

292.1  
6<sup>0</sup>  
50

293.1  
5<sup>9</sup>  
25

293.6  
5<sup>4</sup>  
10

293.8  
5<sup>2</sup>  
10

293.7  
5<sup>3</sup>  
10

293.6  
5<sup>4</sup>  
25

293.8  
5<sup>2</sup>  
50

292.3  
6<sup>7</sup>  
50

293.1  
5<sup>9</sup>  
25

293.5  
5<sup>5</sup>  
10

293.8  
5<sup>2</sup>  
10

294.0  
5<sup>0</sup>  
10

294.2  
4<sup>8</sup>  
25

294.2  
4<sup>8</sup>  
50



Lt = East

Rt = West

3

1774 10<sup>2</sup> Lt E double garage con floor + apron

~~291.02~~  
291.02  
448  
132  
floor

477  
103  
apron

1750

610.9  
46  
20  
291.1  
44  
10  
291.3  
42  
10  
291.4  
44  
10  
291.2  
43  
25

1745 10<sup>2</sup> Lt E 3' con walk

291.63  
387  
102  
w/k

1734 10<sup>3</sup> Lt E double garage con floor + apron

291.89  
361  
132  
floor

291.77  
373  
103  
apron

1724 11<sup>0</sup> Lt E 4' con walk

292.01  
349  
110  
w/k

1723 9<sup>6</sup> Lt E 10' Polt JPA 2980

TP<sub>2</sub> 3<sup>23</sup> 295<sup>50</sup> 7<sup>22</sup> 291<sup>17</sup>

1700

292.5  
65  
10  
292.2  
6  
292.1  
62  
3  
292.0  
70  
3  
292.4  
66  
6  
292.5  
65  
10

0795 10<sup>0</sup> Rt E 20' con deck for const of ship

292.33  
666  
132  
w/k

292.44  
555  
100  
con

0787 13<sup>2</sup> Lt E 1<sup>5</sup> con walk

0785 10<sup>0</sup> Rt E 9' wide con deck for ship const.

292.44  
655  
100  
con

298.99



3450 9<sup>5</sup> Lt E 9" pole #PA2940

3428 E SMH

3400

2467 11<sup>3</sup> Rt E 3<sup>5</sup> cow walk

2465 9<sup>2</sup> Lt end 5' picket fence

2462 9<sup>5</sup> Lt E deadman

2450

2441 9<sup>2</sup> Lt Begin 5' picket fence

2440 9<sup>2</sup> Lt E 8" pole #PA2960

2425 10<sup>3</sup> Lt E 3' cow walk

2419 9<sup>2</sup> Rt E 8' cow drive

2415 10<sup>0</sup> Lt E double garage con floor + apron

2400 12<sup>0</sup> Rt E single garage con floor + apron

Lt = East

S, L

Rt = West

4

287.2	287.5	287.7	
13	8	7	
10		10	
287.9	287.2	288.2	288.5
76	73	73	70
20	10	10	20
			5
			113
			wk
			289.53
			289.7
			289.1
			289.6
			289.2
			289.4
			290.1
			290.09
			541
			103
			wk
			290.12
			138
			92
			con
			290.45
			290.15
			535
			102
			apron
			290.2
			290.2
			290.3
			290.49
			291.00
			52
			50
			450
			120
			apron
			142
			floor
			295.50



Lt=East

Q

Rt=West

5

5700 6<sup>o</sup> Lt E 4" tree

9<sup>1</sup> 282.1  
30

7<sup>4</sup> 283.7  
10

7<sup>3</sup> 283.8  
5

6<sup>5</sup> 284.6  
6

6<sup>4</sup> 284.7  
10

6<sup>3</sup> 284.8  
25

6<sup>o</sup> Rt end floral planting  
4796 6<sup>o</sup> Rt end 6" cor wall

6<sup>2</sup> 284.9  
6

6<sup>1</sup> 284.9  
25

5<sup>28</sup> 285.3  
5

4785 9<sup>o</sup> Rt E 30" Palm tree

6<sup>o</sup> 9<sup>o</sup> footing

6<sup>o</sup> top

4776 6<sup>o</sup> Lt End floral planting

4763 6<sup>o</sup> Lt Begin floral planting

4763 5<sup>o</sup> Rt Begin 6" wall 11 to line

5<sup>6</sup> 285.5  
52

5<sup>2</sup> 285.4  
52

5<sup>23</sup> 285.9  
52

6<sup>o</sup> Rt Q same  
4762 7<sup>o</sup> Lt E 3' square cor & rock pilaster

4760 10<sup>o</sup> Lt E 10" Pole # PA 2920

4750

6<sup>2</sup> 284.4  
25

5<sup>6</sup> 285.5  
10

5<sup>2</sup> 285.9  
6

5<sup>2</sup> 285.9  
5

4<sup>9</sup> 286.2  
10

4<sup>6</sup> 286.5  
25

4730 6<sup>o</sup> Rt Begin floral planting

4709 9<sup>o</sup> Rt end hedge

4700

5<sup>2</sup> 285.9  
25

4<sup>6</sup> 286.5  
20

4<sup>2</sup> 286.7  
10

3<sup>00</sup> 287.3  
7

3<sup>00</sup> 287.3  
3

3<sup>2</sup> 287.2  
10

3<sup>5</sup> 287.6  
25

3785 9<sup>o</sup> Rt Begin 3' acacia hedge 1' wide

3778 8<sup>o</sup> Rt E single garage con floor & apron

TP  
3

3<sup>23</sup>

291<sup>12</sup>

76

287<sup>89</sup>

3450 Lt  
# PA 2940

3<sup>47</sup> 287.6  
83  
apron

3<sup>23</sup> 287.8  
156  
floor

PA 291<sup>12</sup>



BM starting  
 TP1. 133 28922 1022 27920 +001 ✓  
 TP2 429 29829 920 28839  
 TP5 112 29366 016 29350  
 124 28179  
 6110 E cut ditch outs along ditch

5485

B.M.  
 5474 94 POT stub 243 38040

5473 93 H E 1" Eucalyptus

5454 E SMH

5452 93 Lt E 6" Palm tree

5450

TP4 022 28283 921 28191

5443 92 Lt 8'x8' Lath house

5441 E cross 3' con & brick walk

5435 90 Rt E 6" Palm tree

5426 90 Lt E 10 clump trees

5421 15 Rt E 10" pepper tree

5405 90 Lt E 4" Palm tree

5404 E cross 6" con wall

Lt-East 6  
 255.8 256.4 257.4 258.8 259.9 260.7 261.8 262.3 262.8  
 27° 26' 25' 24° 22' 22' 21° 20' 20' 20'  
 150 120 100 75 50 40 20 20 30

275.9 278.1 279.6 280.3  
 69 42 38 25  
 25 10 10

279.3 280.8 280.9 281.7 282.5  
 34 20 19 11 0.3  
 15 13 10 10

28283

28229

28447

28410

28411

665

Top 94 footing

29112



Roberts  
Cota  
Moore  
Morales  
5-7-53  
W.O. #32208

X-Section Wunderlin Ave.

65<sup>th</sup> to 69<sup>th</sup>

Encanto Heights

Map 1062 TP 12 pg 12: 36927

Weather: varied from Santa Ana to cool & rainy.

INDEXED  
LAW  
MAY 20 1953

7

Also see P28

Reduced & Plotted  
Pearson 7/1/53

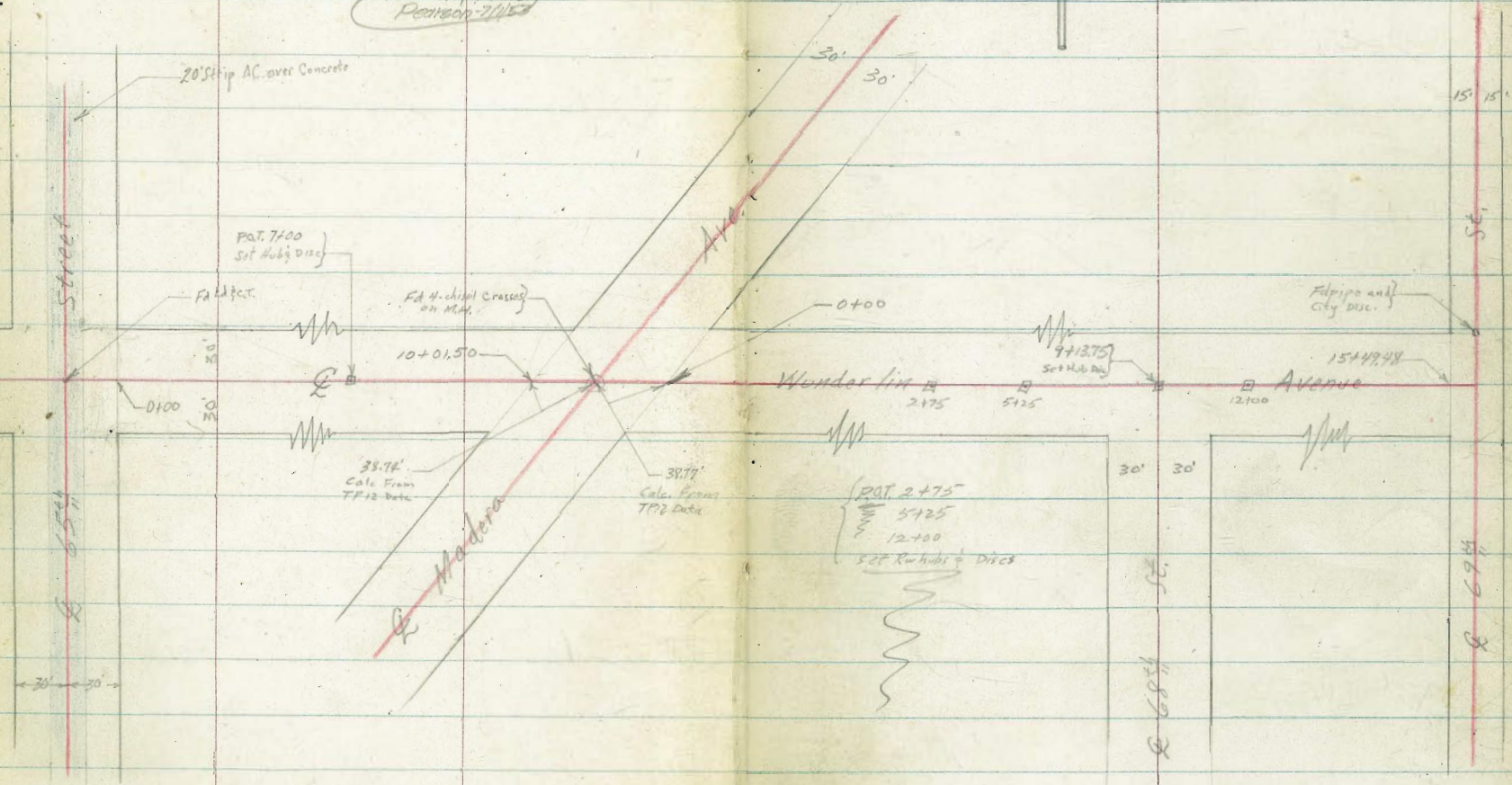



Contd From Page 7

Lt

Rt

Rt 8

0+41 19<sup>2</sup> Rt to center 9" Tree

0+30 20<sup>2</sup> Rt to center Okanalis

0+00 East Line 65<sup>th</sup> Street

90.6	90.1	88.6	87.0	86.6	86.3	87.1	86.9	86.2
2.0	2.5	4.0	5.6	6.0	6.3	5.5	5.7	6.4
40	30	17	11		16	22	30	40

0-09

90.5	89.2	87.0	86.6	86.1	87.0	86.0
2.1	3.4	5.6	6.0	6.5	5.6	6.6
50	23	11		17	26	50

0-14

88.9	87.6	86.5	85.35	84.4
3.7	5.0	6.1	7.25	8.2
50	23		26	50

0-20 East Edge Paving Strip

91.98	89.17	86.81	84.76	82.72
0.58	2.39	5.75	7.80	9.84
100	50		50	100

65<sup>th</sup> Street

292.19	89.44	87.12	285.01	82.93
0.37	3.12	5.44	7.55	9.61
100	50	on 25	50	100

BM

5.6 292.56X

211 & 212  
286.90 Under 65<sup>th</sup>  
in 0.00

292.56X



Cont'd From Page 8

T.R. 5.12 289.68 A 8.00 284.56

1700

0+90 196' Rt to center 9" Tree

0+89 20' Lt to center 14" Poplar Tree

0+85 292' Rt & 3' Conc. Walk ?

0+75 192' Rt to center 6" Tree

0+64 20' Lt to center 30" Elm Tree

0+60 24' Lt & Walk & Steps at School ?

0+53 20' Rt to center 10" Tree

0+50 192' Rt to center P.P. # P79660

292.56 A

Lt

Rt

Rt

9

92.8	92.8	88.16	87.3	84.8	85.0	84.7	83.9	83.6
+0.2	+0.2	3.8	5.3	7.9	7.6	7.9	8.7	9.0
46	37	30	26	12		15	30	40

284.40

284.08

8.16  
292  
conc

8.48  
392  
conc

90.12  
87.77  
87.77

2.44	4.79	4.79
302	28	24
7p	8th	conc
Steps	Steps	

290.6	90.1	89.3	88.1	86.6	86.3	85.9	85.5	85.1
2.0	2.2	3.3	4.5	6.0	6.3	6.7	7.1	7.5
40	31	30	28	12		14	30	40

292.56 A



2+345

31<sup>2</sup>

Lt &amp; open drain off school yard

2+00

1+94

19<sup>2</sup>

Rt to center 9" Pepper Tree

1+69

20<sup>2</sup>

Rt to center 6" Pepper Tree

1+50

1+485

19<sup>2</sup>

Rt to center P. Pale # 78651

1+44

19<sup>5</sup>

Rt to center 6" Pepper Tree

1+19

19<sup>2</sup>

Lt to center 12" Pepper Tree

1+14

20<sup>2</sup>

Lt to center 20" Euc. Tree

289.687

90.5

85.73

70.8

39.5

40

31<sup>2</sup>

INV.

91.7

91.7

87.6

84.6

83.7

83.6

83.4

81.8

81.0

+2.0

+2.0

2.1

5.1

6.0

6.1

6.3

7.9

8.7

50

38

30

25

13

6.1

13

30

40

7 91.9

91.9

87.5

85.5

84.0

83.9

83.5

82.4

81.8

+2.2

+2.2

2.2

4.2

5.7

5.8

6.2

7.3

7.9

50

37

30

26

12

5.8

14

30

40

289.687



3+23 21<sup>3</sup> Rt to center 2" Tree3+12 21<sup>2</sup> Rt to center 1" Tree3+02 20<sup>3</sup> Rt to center 1" skanker

3+00

91.4	91.3	86.9	85.2	83.3	83.6	83.0	81.7	81.1
+1.7	+1.6	2.9	4.5	6.4	6.1	6.7	8.0	8.6
50	39	30	27	13		14	30	40

2+91 20<sup>9</sup> Rt to center 3" Tree2+80 21<sup>2</sup> Rt to center 2" Tree2+77 24<sup>5</sup> Lt & 4" wooden steps to schoolyard2+71 21<sup>2</sup> Rt to center 2" Tree2+60 21<sup>9</sup> Rt to center 2" Tree

2+50

91.4	91.2	86.4	84.8	83.5	83.5	83.0	81.4	80.8
88.0	88.2							
+1.7	+1.5	3.3	4.9	6.2	6.2	6.7	8.3	8.9
50	39	30	27	13		13	30	40



4100 21° Lt center of a cluster 2" Olive Trees

41.1	46.2	45.3	43.1	43.5	42.9	42.5	42.1
11.4	35	44	66	6.2	6.8	7.2	7.6
39	30	20	13		17	30	40

3199 15° Rt to center P.P. #274394

3183 20° Rt to center 3" Tree

3170 20° Rt to center 3" Tree

3162 20° Rt to center 2" Tree

3154 20° Rt to center 3" Tree

3150

41.7	41.4	45.8	45.2	43.5	43.8	43.4	42.5	42.1
12.0	2.3	39	45	62	59	63	7.2	7.6
38	30	27	17	13		14	30	40

42.37

3144 46° Rt E Double Garage

7.31  
1/6  
core  
Phase

3135 21° Rt to center 1" Tree

289.68π

289.68π



Contd From Page 12

T.P. 42' 289.41  $\pi$  7.62 285.20 2<sup>nd</sup> PGT HVB

6404 132' Rt to center P.Pole # P70889

6400

91.8	90.8	88.6	88.1	87.9	87.5	87.0	85.5
1.0	2.0	4.2	4.7	4.9	5.3	5.8	7.5
40	30	11		11	30	40	50

5450

89.3	88.3	85.6	85.1	84.8	83.3	82.5	80.3
3.5	4.5	7.2	7.7	8.0	7.5	10.3	12.5
40	30	12		14	24	30	30

5425E 21 $\frac{1}{2}$ ' Lt to center 10" Olive Tree

5400 X-sec. for yardage  
see page 28 for now

85.5	85.0	83.3	82.9	82.9	80.4	80.0	77.3
7.3	7.8	7.5	9.9	9.9	12.4	12.8	15.5
40	30	14		13	23	30	50

4462 21 $\frac{3}{4}$ ' Lt to center 10" Olive Tree

T.P. 10.07 292.82  $\pi$  6.93 282.75 292.82  $\pi$

4450

84.9	83.9	83.0	82.5	82.3	82.0	80.4	80.3	79.9
4.8	5.8	6.7	7.2	7.4	7.7	9.3	9.4	9.8
40	30	23	12		17	25	30	40

289.68  $\pi$

289.68  $\pi$



Cont'd From Page 13

Lt

E

R 14

T.P. 0.70 264.52  $\bar{A}$  12.73 26382

8+50

7.9	8.9	11.2	13.6	15.4	15.7	17.2
40	30	10		24	30	40

268.9  
267.9  
265.6  
263.2  
261.4  
261.1  
259.6

8+02 2 1/2 Rt to center P.O.T. # 70888

8+00

0.2	1.2	3.5	5.5	7.2	8.1	10.5
40	30	10		20	30	50

276.6  
275.6  
273.3  
271.3  
269.6  
268.7  
266.3

T.P. 0.31 276.75  $\bar{A}$  12.77 27644

276.75  $\bar{A}$

7+50

7.2	7.7	9.7	10.1	10.9	12.0	12.8
40	30	12		20	30	40

282.2  
281.7  
279.7  
279.3  
278.5  
277.4  
276.6

7+00 P.O.T.

0.2	0.2	2.5	3.6	4.9	7.1	9.0
40	30	11		18	30	50

289.4  
289.2  
286.9  
285.8  
284.5  
282.3  
280.4

6+94 30° Lt to center 14" Pepper Tree

6+50

+3.8	+3.1	+0.9	1.9	1.7	1.7	2.6	5.3
40	30	9	7		23	30	50

293.2  
292.5  
292.3  
287.5  
287.5  
287.1  
286.8  
284.1

289.41  $\bar{A}$

289.41  $\bar{A}$



(Section Parallel to Modera)

10+01.50 West Line Modera Avenue

250.9  
8.7  
100

244.0  
10.6  
38.7

248.5  
11.1  
10

247.4  
12.2

246.2  
13.4  
38.7

244.0  
14.7  
100

(Rt. Location)

9+89 29° Rt to center P.R. # ?

9+60

244.8  
9.8  
40

249.5  
10.1  
30

248.3  
11.3  
10

247.6  
12.0

246.8  
13.8  
15

246.5  
13.1  
30

246.4  
13.2  
40

9+54 25° Rt to center 10" Pepper Tree

9+25

254.0  
5.6  
40

252.5  
7.1  
30

250.5  
9.1  
12

249.4  
10.2

248.7  
10.9  
15

247.4  
12.2  
30

246.8  
12.8  
40

T.P. 8.12 259.61 T 13.03 251.49

259.61 T

9+00

259.3  
5.2  
40

258.3  
6.2  
30

254.2  
10.3  
15

11.7

252.6  
12.9  
15

251.6  
14.7  
18

249.8  
16.3  
30

248.7  
17.6  
50

246.9

8+75

264.5  
0  
40

263.6  
0.9  
30

260.8  
3.7  
10

6.6

257.9  
7.1  
15

257.4  
8.1  
18

256.4  
11.4  
30

253.1  
13.2  
40

251.3

264.52 T

264.52 T



T.P. 12.76 284.36 T 0.18 271.60

0+30

257.7  
14.1 13.3 9.8 8.9 8.3 10.3 6.4 3.5  
40 30 12 11 17 30 40

258.5  
262.0  
262.9  
263.5  
261.5  
265.4  
268.3

T.P. 12.29 271.78 T 0.12 259.49

271.78 T

0+00 East Line Madera Avenue

(Section Parallel to Madera)

257.3  
2.3 6.1 5.4 6.4 7.1 9.5 10.7 13.5  
100 38.7 15 11 21 38.7 100

259.5  
254.2  
253.7  
257.5  
250.1  
248.9  
246.1

♀ Madera plus seven feet

(Section Parallel to Madera)

251.0  
8.6 10.3 11.5 13.0 14.5  
100 50 50 100

249.3  
248.1  
246.6  
245.1

♀ Madera Avenue

(Section Parallel to Madera)

251.0  
8.6 10.3 11.5 13.0 14.5  
100 50 50 100

249.3  
248.11  
246.6  
245.1

10+18

Section Parallel to Madera

250.9  
9.2 11.1 12.1 13.3 15.0  
100 50 50 100

248.5  
247.5  
246.3  
244.6

259.6 T

259.6 T



Contd From Page 16

2450

T.P. 12.41 320.03 T 1.01 307.62

2400

T.P. 12.29 308.63 T 0.50 296.34

1756 21° E to center P. File # 70890

1750

T.P. 12.59 296.84 T 0.11 284.25

1700

0760

284.36 T

44

$\begin{matrix} 311.6 \\ 8.4 \\ 40 \end{matrix}$ 
 $\begin{matrix} 313.2 \\ 6.8 \\ 30 \end{matrix}$ 
 $\begin{matrix} 314.9 \\ 5.1 \\ 22 \end{matrix}$ 
 $\begin{matrix} 317.3 \\ 2.7 \\ 15 \end{matrix}$ 
 $\begin{matrix} 318.2 \\ 1.8 \\ 7 \end{matrix}$ 
 $\begin{matrix} 318.4 \\ 1.6 \\ 75 \end{matrix}$ 
 $\begin{matrix} 320.0 \\ 1.2 \\ 30 \end{matrix}$ 
 $\begin{matrix} 322.7 \\ 1.0 \\ 40 \end{matrix}$ 
 $\begin{matrix} 324.0 \\ 1.0 \\ 40 \end{matrix}$

320.03 T

$\begin{matrix} 299.5 \\ 9.1 \\ 50 \end{matrix}$ 
 $\begin{matrix} 303.4 \\ 5.2 \\ 30 \end{matrix}$ 
 $\begin{matrix} 304.3 \\ 4.3 \\ 22 \end{matrix}$ 
 $\begin{matrix} 307.9 \\ 0.7 \\ 13 \end{matrix}$ 
 $\begin{matrix} 308.3 \\ 0.3 \\ 6 \end{matrix}$ 
 $\begin{matrix} 308.7 \\ 1.1 \\ 8 \end{matrix}$ 
 $\begin{matrix} 310.7 \\ 1.0 \\ 30 \end{matrix}$ 
 $\begin{matrix} 313.8 \\ 1.1 \\ 50 \end{matrix}$ 
 $\begin{matrix} 316.9 \\ 1.1 \\ 50 \end{matrix}$

308.63 T

$\begin{matrix} 289.5 \\ 7.3 \\ 40 \end{matrix}$ 
 $\begin{matrix} 291.7 \\ 5.1 \\ 30 \end{matrix}$ 
 $\begin{matrix} 293.5 \\ 3.3 \\ 22 \end{matrix}$ 
 $\begin{matrix} 296.6 \\ 0.2 \\ 9 \end{matrix}$ 
 $\begin{matrix} 296.6 \\ 0.1 \\ 9 \end{matrix}$ 
 $\begin{matrix} 296.7 \\ 1.1 \\ 7 \end{matrix}$ 
 $\begin{matrix} 296.9 \\ 1.2 \\ 75 \end{matrix}$ 
 $\begin{matrix} 299.3 \\ 1.3 \\ 30 \end{matrix}$ 
 $\begin{matrix} 303.1 \\ 1.3 \\ 30 \end{matrix}$ 
 $\begin{matrix} 304.5 \\ 1.7 \\ 40 \end{matrix}$

296.84

$\begin{matrix} 271.6 \\ 12.8 \\ 50 \end{matrix}$ 
 $\begin{matrix} 271.5 \\ 6.9 \\ 30 \end{matrix}$ 
 $\begin{matrix} 281.1 \\ 3.3 \\ 18 \end{matrix}$ 
 $\begin{matrix} 283.0 \\ 1.4 \\ 10 \end{matrix}$ 
 $\begin{matrix} 283.0 \\ 1.0 \\ 10 \end{matrix}$ 
 $\begin{matrix} 283.4 \\ 1.3 \\ 8 \end{matrix}$ 
 $\begin{matrix} 283.1 \\ 1.3 \\ 85 \end{matrix}$ 
 $\begin{matrix} 287.3 \\ 1.7 \\ 30 \end{matrix}$ 
 $\begin{matrix} 291.1 \\ 1.6 \\ 30 \end{matrix}$ 
 $\begin{matrix} 293.4 \\ 1.7 \\ 50 \end{matrix}$

$\begin{matrix} 264.0 \\ 20.4 \\ 40 \end{matrix}$ 
 $\begin{matrix} 266.4 \\ 18.0 \\ 30 \end{matrix}$ 
 $\begin{matrix} 271.5 \\ 12.9 \\ 10 \end{matrix}$ 
 $\begin{matrix} 272.0 \\ 12.4 \\ 10 \end{matrix}$ 
 $\begin{matrix} 272.0 \\ 12.2 \\ 85 \end{matrix}$ 
 $\begin{matrix} 272.2 \\ 6.7 \\ 9 \end{matrix}$ 
 $\begin{matrix} 277.7 \\ 6.7 \\ 19 \end{matrix}$ 
 $\begin{matrix} 277.7 \\ 3.1 \\ 30 \end{matrix}$ 
 $\begin{matrix} 281.3 \\ 1.2 \\ 40 \end{matrix}$ 
 $\begin{matrix} 283.2 \\ 1.2 \\ 40 \end{matrix}$

284.36 T



3+52 216 Lt to center 10" Euc. Tree ✓

3+50

327.5	328.6	331.6	333.4	334.3	336.1	336.8	337.3
16.1	15.0	12.0	10.2	9.3	7.5	6.8	6.3
40	30	20		18	22	30	40

3+48 22 E Rt to center HPole # 370891

T.P. 12.32 343.64  $\Delta$  0.67 331.32343.64  $\Delta$ 

3+25

323.4	325.0	325.7	328.0	330.6	332.0	332.7	333.6	334.4
8.6	7.0	6.3	4.0	1.4	0	+0.7	+1.6	+2.4
40	30	25	18		7	23	30	40

2+88 242 Rt @ 3' conc. walk

331.35	331.83
0.64	+0.16
342	442
conc	conc

2+75 P.O.T.

316.7	318.7	319.4	322.1	322.8	323.3	326.9	328.6	329.6	330.2
15.3	13.3	12.6	9.9	9.2	8.7	5.1	3.4	2.4	1.8
40	30	24	17		62	7	15	30	40

T.P. 12.45 331.99  $\Delta$  0.49 319.54331.99  $\Delta$ 320.03  $\Delta$



5700 30<sup>I</sup> Rt & 2<sup>S</sup> Conc walk

80 344.1 345.7 346.6 347.6 348.0 348.2 347.8 347.83 347.84  
46 64 53 45 41 39 43 42 30<sup>I</sup> 473  
30 15 18 20 30 Conc Conc

4786 25<sup>S</sup> Lt to center 15' cluster Trees

4773 27<sup>o</sup> Lt & Single Garage

344.9  
7.7  
27  
Dirt  
Floor

T.P. 8.73 35 2.07A 0.30 343.34

352.07A

4750

338.8 339.3 340.8 342.7 343.5 344.3 345.1 345.5 345.5  
4.8 4.3 2.8 0.9 0.1 +0.7 +1.5 +1.9 +1.9  
10 32 30 15 18 21 30 40

4725 21<sup>o</sup> Lt to center 16" Euc. Tree

4700

333.6 335.3 336.7 338.1 339.1 340.6 341.1  
10.0 8.3 6.9 5.5 4.5 3.0 2.5  
40 30 19 17 30 40

3770 22<sup>o</sup> Lt to center 14" Euc. Tree

3760 22<sup>o</sup> Lt to center 10" Euc. Tree

343.64A

343.64A



5790 25° Rt to center 48" Pepper Tree

That's Right!

5765 30° Rt C 2' conc walk

347.01  
5.06 6.00  
30 70  
conc conc

5751 21<sup>8</sup> Rt to center P. Pole #P70892

5750

347.0 348.7 349.8 349.5 348.7  
5.1 3.4 2.3 2.6 3.4  
40 30 23 18 40  
348.1 348.3 347.7 347.3  
4.0 3.8 4.4 4.8  
18 23 30 40

5744

30° Rt C Ribbon Drive

20' Ribbons  
65' overall

347.93 347.35  
4.4 4.2  
30 40  
conc conc

5728 23° Lt to center 8" Orange Tree

5725 P.O.T.

347.8 347.6 348.2 348.6 348.5 348.6 348.4 348.1  
4.3 4.5 3.9 3.5 3.6 3.5 3.7 4.0  
40 30 15 40 18 25 30 40

5718

30° Lt C 3' Conc walk

346.47 347.17  
5.60 4.90  
40 30  
conc conc

5708

22° Lt to center 10" Orange Tree

352.07A

352.07A



7+78 28<sup>5</sup> Rt End wire Fence

7+73<sup>5</sup> 34<sup>2</sup> Rt to N.E. Corner Garage Opens to East

7+50 29<sup>0</sup> Rt to Fence

7+48 21<sup>1</sup> Rt to center P.Pole # P70893

7+00

T.P. 0.91 340.01A 12.97 339.10

6+50 30<sup>0</sup> Rt Begin wire Fence

6+00

352.07A

376.54  
13.47  
34<sup>2</sup>  
Floor

340.4  
+0.4  
40

339.0  
1.0  
30

44

335.6  
6.5  
3

333.5  
6.2  
23

333.8  
2.1  
30

331.9  
8.9  
35

331.1  
12.9  
40

344.2  
+4.2  
40

342.2  
+2.2  
30

1.9

338.1  
1.9  
2

338.1  
3.3  
18

336.7  
4.7  
30

335.3  
5.7  
40

334.3

340.01A

347.1  
5.0  
40

347.4  
4.7  
30

347.1  
4.4  
25

345.8  
6.3  
17

9.4

342.7  
11.2  
3

340.9  
11.4  
21

340.7  
12.1  
30

340.0  
12.7  
40

339.4

342.3  
4.8  
40

347.6  
4.5  
30

348.0  
4.1  
24

348.6  
3.5  
16

5.7

346.4  
6.3  
21

345.8  
7.2  
30

344.9  
8.2  
40

343.9

352.07A



9702

333.7  
+0.9 0.3 3.2 6.1 6.2 6.7 8.1 8.3 11.6  
40 30 5 3 16 24 30 50

9700

30' Rt to inlet 24" Steel Culvert

324.67  
8.16 10.17  
20 34.9  
INVERT INVERT  
2.111'

8791

22.5' Lt. to deadman  
17' Lt. to center Guy Pole  
29.8' Rt. to center P. Pole # 173936

8783.75

West Line 68th Street

335.4  
+2.6 0.1 # 1 6.2 6.3 7.0 7.4 10.9  
50 30 3 23 30 35 50

T.P.

0.87 332.78 X 8.10 331.91 Mail in Guy Pole

332.78 X

8750

339.9  
5.1 6.6 11.4 12.3 12.6 13.7 13.7 16.4  
40 30 3 20 23 30 40

8700

337.5  
2.5 4.0 9.6 10.6 10.1 11.4 12.7 14.2  
40 30 3 20 27 30 40

7791

27.8' Rt to center 24" Pepper Tree

340.01 X

340.01 X



10+62 295' 41' & 10' Conc Drive

334.88  
+2.10 0.86  
50' 295'  
conc. conc.

10+50

332.1 331.3 327.4 326.2 325.5 324.9 323.3 321.9 319.8  
0.7 15 54 6.6 7.3 7.9 9.5 11.4 13.0  
40 30 5 3 22 30 33 50

10+00

333.4 332.0 328.6 327.1 325.9 325.9 323.7 321.7 320.5  
+0.6 0.8 4.2 5.7 6.9 6.9 9.1 11.1 12.3  
40 20 5 3 21 30 40 50

9+43.75 East Line 68th Street

333.4 331.8 328.4 327.0 325.2 324.2 320.6  
+0.6 1.0 4.1 5.7 7.6 8.6 12.2  
40 30 5 25 30 50

9+35

333.3 331.8 328.6 327.1 325.9 323.0 319.3  
+0.5 1.0 4.2 5.7 6.9 8.8 13.5  
40 30 4 15 30 50

Q 68th Street

333.6 332.2 328.9 326.65 326.5 325.9 323.2 319.8 313.5  
+0.8 0.6 3.9 6.3 6.3 6.9 9.6 13.0 18.3  
40 30 4 2 15 30 50 100

9+07

333.7 332.5 329.1 327.0 326.6 325.6 323.0 319.0  
+0.9 0.3 3.7 5.8 6.2 7.2 9.8 13.8  
40 30 5 2 18 30 50

332.78 T

332.78 T



Contd From Page 23

24

Rt. 24

12+00 P.O.T.

327.1	326.0	320.8	318.8	318.8	318.6	315.1	317.8	319.0	315.9	315.1
+3.7	+2.6	2.6	4.6	4.6	4.8	8.3	5.6	4.4	7.5	8.3
40	30	6	2	4	18	28	28	28	30	40

Foot CSD TIP Wall

11+63 21' Rt to dealman

329.0

327.6

+5.6	+4.2
40	26.2
conc.	conc.

11+57 26' L.G. 15' Conc Walk

329.4

328.5

323.6

322.9

321.6

321.4

320.0

318.4

321.0

318.6

317.5

11+50 { 28' Rt Begin Conc. Ret. Wall  
21' Rt to center P.P. # P70895

+6.0	+5.1	+4.2	0.5	1.8	2.0	3.4	5.0	2.4	4.8	5.9
40	30	3		2	19	28	28	28	30	40

Foot CSD TIP Wall

11+48

334.4

333.7

330.7

327.0

324.4

323.5

322.1

322.0

321.0

320.3

318.8

+1.0	+0.3	+0.3	+0.6	+1.0	+0.1	1.3	1.4	2.4	3.1	4.6
40	34	30	21	3		3	20	23	30	50

TR 0.55 323.37 T 9.96 322.82

333.7 T

11+00

334.8

334.5

333.0

330.0

326.3

325.0

323.9

323.6

322.5

320.5

319.6

+2.0	+1.7	+0.2	2.8	6.5	7.7	8.9	9.2	10.3	12.3	13.2
40	32	30	22	6		3	22	27	30	50

10+75

335.6

335.2

334.2

330.1

327.8

325.9

322.9

324.4

323.0

320.9

319.8

+2.8	+2.4	+1.4	2.7	5.0	6.9	2.9	8.4	9.8	11.9	13.0
40	32	30	21	7		3	20	26	30	50

332.78 T

332.78 T







Cont'd From Page 25

15702 28<sup>th</sup> Lt Q 45' Conc. Steps

T.P. 519 29499T 10.51 29980

15+00

14+78 21<sup>st</sup> Rt to Deadman

14+57 21<sup>st</sup> Rt to center P.Pole #P178218

14+50

T.P. 169 30031T 12.72 298.62

14+00

13+75 12' Lt Q 1" Pepper Tree

31134T

Lt

R 26

	297.89	
+2.90		+1.10
340		280
Top		Bottom
Step		Step

296.09

294.99T

	298.6	297.5	295.8	294.6	293.6	293.7	292.8	291.8	291.6	290.6
1.7	2.8	4.5	5.7	6.7	6.6	7.5	8.5	8.7	9.7	
40	30	27	15	9		18	21	30	40	

	301.9	301.0	298.7	296.6	296.6	296.5	295.3	295.1	294.4
+1.6	+0.7	1.6	3.7	3.7	3.8	5.0	5.2	5.9	
40	30	7	2		17	22	30	40	

300.31T

	312.3	311.3	302.6	300.1	300.1	300.0	299.2	299.1	297.6
+1.0	0	8.7	11.2	11.2	11.3	12.1	12.2	13.7	
40	30	7	1		17	20	30	40	

31134T



check 6.35 249.16 = 249.31

Top Fire Hydrant S.W. Corner Imperial = 68<sup>±</sup>/<sub>11</sub>

N.G. Pipe bent over!

check 2.57 253.51 5.21 252.92 = 253.44

2" pipe SW corner box culvert 69<sup>th</sup> = Imperial

T.P. 0.03 258.13 13.06 258.10

T.P. 0.63 271.16 12.29 270.53

T.P. 0.57 282.82 12.74 282.25

Q 69<sup>th</sup> Street

	297.2	293.1	289.8	286.7	283.1
+2.2	1.9	5.2	8.8	11.9	
100	50		50	100	

15+54.5 Crosses 12" R.C.P. Culvert

	291.01	286.93
3.91	8.06	
18 <sup>±</sup>	50 <sup>±</sup>	
INVERT	INVERT	

15+49.48 West Line 69<sup>th</sup> Street

	294.6	293.6	291.8	291.1	289.7	289.0	287.2
0.4	1.4	3.2	3.9	5.3	6.0	7.8	
40	30	12		15	30	50	



Additional notes

INDEXED

NER

NOV 18 1953

7+00

T.P. 400 5.65 290.85 8.22 285.20  
Hub 7+00

6+50

(This is a new pole.)

6+10- 16" Rt. = 12" pole P 76889

6+00

5+50

5+00

stationing from page 13

8.22 293.42

285.20

Reduced  
11-18-53  
F.A. Valenzuela

LT

±

RT

28

<sup>289.3</sup> 1.6 30	<sup>287.6</sup> 3.3 23	<sup>285.9</sup> 5.0 <u>290.85</u>	<sup>284.4</sup> 6.3 17	<sup>282.7</sup> 8.2 30
-------------------------------	-------------------------------	--	-------------------------------	-------------------------------

<sup>292.6</sup> 0.8 30	<sup>291.7</sup> 1.7 19	<sup>290.4</sup> 3.0 9	<sup>288.4</sup> 5.0 6	<sup>287.9</sup> 5.5 30	<sup>287.6</sup> 5.8 23	<sup>286.8</sup> 6.6 30
-------------------------------	-------------------------------	------------------------------	------------------------------	-------------------------------	-------------------------------	-------------------------------

<sup>290.9</sup> 2.5 30	<sup>288.1</sup> 4.7 8	<sup>285.3</sup> 5.1	<sup>287.9</sup> 5.5 15	<sup>287.3</sup> 6.1 30
-------------------------------	------------------------------	-------------------------	-------------------------------	-------------------------------

<sup>288.2</sup> 5.3 30	<sup>286.0</sup> 7.5 13	<sup>285.2</sup> 8.1	<sup>283.0</sup> 8.5 15	<sup>282.6</sup> 10.8 30
-------------------------------	-------------------------------	-------------------------	-------------------------------	--------------------------------

<sup>284.9</sup> 8.5 30	<sup>283.4</sup> 10.0 14	<sup>282.3</sup> 10.1	<sup>282.4</sup> 11.0 14	<sup>280.1</sup> 13.3 30
-------------------------------	--------------------------------	--------------------------	--------------------------------	--------------------------------

293.42

T.P. on. Point. Hub - page 13



Wunderlin

9+20

<del>253.3</del>	<del>251.1</del>	<del>250.5</del>	<del>249.7</del>	<del>247.6</del>
5.1	7.0	7.9	8.7	10.8
30	16		16	30

8+90

<del>256.4</del>	<del>256.2</del>	<del>254.9</del>	<del>252.1</del>	<del>249.8</del>	<del>249.2</del>
+ 2.0	2.2	3.5	5.8	8.6	9.3
30	13	<u>258.43</u>		22	27
				30	

T.P. 2.06 258.43 13.20 256.37

8+50

<del>268.0</del>	<del>265.6</del>	<del>264.3</del>	<del>262.2</del>	<del>261.4</del>
1.6	4.0	5.3	6.7	8.2
30	13	<u>269.57</u>		20
				30

T.P. 3.23 269.57 13.32 266.34

8+00

<del>275.7</del>	<del>273.3</del>	<del>271.5</del>	<del>271.0</del>	<del>269.2</del>
4.0	6.4	8.2	8.7	10.5
30	10		20	30

T.P. 1.23 279.66 12.42 278.43

279.66

7+50

<del>282.9</del>	<del>280.8</del>	<del>279.1</del>	<del>278.1</del>
8.0	10.1	11.5	12.8
30	17		30

290.85

LT

E

RT

29



Wanderlin

LT

±

RT

30

10+01<sup>50</sup> = See p. 74 15  
Wly Madera fo  
along line of Madera.

9+75

9+60

249<sup>1</sup>

9.3

387

247<sup>5</sup>

10.9

246<sup>5</sup>

11.9

387

247<sup>23</sup>

11.2

30

246<sup>8</sup>

11.6

11

248<sup>1</sup>

10.3

8

247<sup>5</sup>

10.5

246<sup>6</sup>

11.8

30

249<sup>5</sup>

8.9

30

249<sup>1</sup>

9.3

9

247<sup>8</sup>

10.6

246<sup>7</sup>

11.7

30

258.43



CROSS SECTION 5 ALLEY BLK 102  
 CENTRAL PARK FOR IMPROVEMENTS  
 W.O. 32415

Ref F.B. 1667  
 37

(31)

INDEXED  
 FEB 10 1954

2-9-54

T.A. Stamer

31-5T

5T

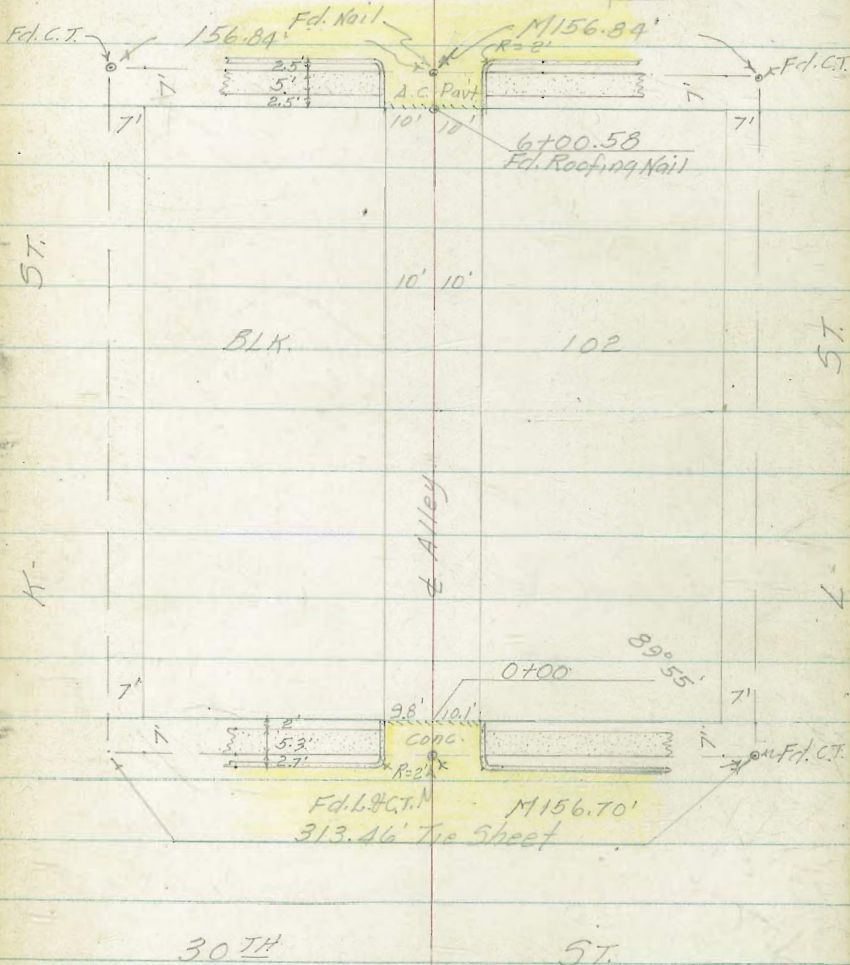



CROSS SECTIONS ALLEY BLK 102 CENTRAL  
PARK ADD. FOR IMPROVEMENTS W.O. 32415

2-9-59

(32)

Lt

±

Rt.

Stamper   
Huffman   
Nordahl   
Sherry

NOTE: Direct Elev. Rod Used

0-00.2 Edge Pavt.

71.59	71.53	71.25	71.72	71.80
98	98	0	101	101
cb	G		G	cb

0-08 E.C. Curb Ret.

71.40	71.22	71.11	71.30	71.62
98	98	0	102	102
cb	Glt		G	cb

0-10 = Ely Curbline 30th St.

(R)

3080	71.37	71.01	71.05	71.10	71.16	71.19	71.59	71.33
30	12 <sup>0</sup>	12 <sup>0</sup>	10 <sup>0</sup>	0	10 <sup>0</sup>	12	12	25
G	cb	G				G	cb	G

3119	71.20
30 <sup>0</sup>	25
cb	cb

0-30 ± 30-th. St. ± Sewer M.H.

71.04	71.23	71.44	71.66	71.91	72.18	72.43
75	50	25	0	25	50	85

TOP WY CURB

B.M.

73.98

S.E.B.P. 30th & L. Sts.



2-9-59

Lt.                      &                      Rt.

X-SEC'S ALLEY BIK. 102

0+90- Lpt. 8<sup>3</sup> Rt. 6' Picket fence

0+77- 7<sup>3</sup> Rt. & PPN<sup>o</sup> A-3012

0+73- 8<sup>3</sup> Rt. Begin 6' Lath fence

0+56 & Abandoned Gar. Foundations 8<sup>6</sup> Rt. <sup>12' wide</sup>

0+54- 10<sup>1</sup> Lt. Begin 4'-High Lath fence

0+53- 10<sup>4</sup> End 4'-High Board fence

0+53- 9<sup>2</sup> Lt. & P. & Tel. P<sup>#</sup> NP1PA3011

0+50- 9<sup>2</sup> Rt. End 6'-High Frame Shed

73.0 73.1 72.9 73.1 73.6 73.4  
25 10 0 6 10 25

73.97  
8<sup>6</sup>  
Top Foundations  
decomposed conc.

0+37- 9<sup>8</sup> Rt. Begin 6'-High Frame Shed

72.3 72.1 72.7

Begin 4'-High Board fence 10<sup>3</sup> Lt.

0+00 & 8" Lateral Conc. Ret Walk 10<sup>3</sup> Lt.

72.25 71.5 72.9 71.5 71.3 71.8 73.2 72.9  
25 25 10<sup>2</sup> 10 0 10 15 25  
Top Top  
Wall Wall



X- SEC'S. ALLEY BIK. 102

2-9-54

(34)

Lt.

±

Rt.

1+20 - 10<sup>2</sup> Lt. Begin - 4' Picket fence

1+20 - 9<sup>2</sup> Lt. End Apron - 2' Con Gar

1+20 - 8<sup>2</sup> Rt. Begin 5.5' High Picket fence

74.05 73.84  
10<sup>2</sup> 9<sup>2</sup>  
floor Apron

1+08 - 17<sup>2</sup> Lt. ± Sing Gar Dirt floor

74.7  
17<sup>2</sup>  
Dirt floor

End 4' Lath fence 104 Lt.

1+00 Begin Conc Apron - 2' Con Gar 8<sup>2</sup> Lt

74.2 74.14 74.05 73.83 73.9 74.1 74.3  
25 10<sup>2</sup> 10<sup>2</sup> 8<sup>2</sup> 8 10 25  
floor Apron

TP  
0+98<sup>3</sup> ± Sewer M. H.

Top Wly Rim  
73.90

73.90  
Top Wly Rim



2-9-54

(35)

Lt.

£

Rt.

X-SEC'S ALLEY BLK 102

1+70 - 8<sup>2</sup> Rt. £ Sing Gar Dirt floor

74.7  
8<sup>2</sup>  
Dirt

1+67 - 10<sup>5</sup> Lt. £ Sing Gar Dirt floor

74.5  
10<sup>5</sup>  
Dirt

1+65 - 8<sup>2</sup> Rt End 4' Board fence

1+63 10<sup>5</sup> Lt. End 4' Lath fence

✓ 1+51 - 9<sup>0</sup> Lt. £ T.P. No 464014-H

8<sup>0</sup> Rt. Begin 4' Board fence

1+51 - 8<sup>0</sup> Rt End 5.5' Picket fence

1+50

74.9 74.5 74.5 74.5 74.7  
25 10 0 10 25



X- SEC'S ALLEY BIK. 102

2-9-54

(36)

Lt.

£

Rt.

2+19 - 10° Lt. Begin 5' High Board fence

2+16 - 10° Lt. £ 6' Wide frame Shed

2+00 - 8° Rt. 5' Lateral Board fence

2+00 - 7° Rt. £ PPN<sup>o</sup> A-3036

74.9 74.9 75.2 75.2  
10 0 10 25  
@BIM

(?)

1+79 - 8° Rt. £ Sing Gar. Dirt floor

74.9  
8°  
Dirt

1+78 - 10° Lt. £ Sing Gar. Dirt floor

74.6  
10°  
Dirt



Lt.                    ±                    Rt

X-SECS ALLEY BLK. 102

2+86<sup>7</sup> - 9<sup>2</sup> Rt. End Conc. Slab

75.97  
9<sup>2</sup>  
Conc Slab

2+78 - 9<sup>2</sup> Rt. Begin Conc. Slab Parallel

75.97  
9<sup>2</sup>  
Conc  
Slab

2+73 - 14<sup>2</sup> Lt. & 4' Conc. Walk (Lateral)

76.26      76.32      76.0  
24<sup>2</sup>      14<sup>2</sup>      14<sup>2</sup>  
on walk      & walk Ground

2+61 - 8<sup>8</sup> Rt. Begin 4'-High Board Fence

2+56 - 11<sup>5</sup> Rt. & 5' 10" Gar Dirt floor

75.5  
11<sup>5</sup>  
Dirt.

2+51 - 10<sup>2</sup> Lt. End 5'-High Board Fence

2+50

76.0      75.5      75.3      75.4      75.7  
25      10      0      10      25



X-SEC'S ALLEY BIK. 102

2-9-54

(38)

Lt.                    &                    Rt.

3+01-10<sup>1</sup> Lt. End 5' Board fence

3+00<sup>5</sup> 9<sup>2</sup> Rt. Begin 5" Conc. Ret Wall

76.19  
9<sup>4</sup>  
Top Conc.  
Ret wall

3+00<sup>5</sup> 8<sup>2</sup> Lt. & T. & P.P. N° NRJPA3049

3+00<sup>5</sup> 8<sup>3</sup> Rt. & P.P. N° A3050

3+00

76.0	76.1	76.0	76.1	76.3
25	10	0	10	25

2+99-9<sup>3</sup> Rt. End 5'-High frame Shed

2+94-10<sup>2</sup> Lt. Begin 5' Board fence

9<sup>2</sup> Rt. Begin 5'-High frame Shed

2+91-9<sup>2</sup> Rt. End 4'-Board fence

2+88-9<sup>2</sup> Rt. & 2.5' Conc. Walk (Lateral)

75.96	75.96
9 <sup>2</sup>	19 <sup>2</sup>
& walk	on walk



X- SEC'S ALLEY BLK 102

3+21 - 11<sup>2</sup> Rt & 24" Cypress Tree

3+20 9<sup>2</sup> Rt. Begin 6'-High Woven Wire fence

3+20 - 9<sup>2</sup> Lt. & Rt. 6<sup>5</sup> High Picket fence

3+17<sup>5</sup> 9<sup>8</sup> Lt. & 3' Conc. Walk

2-9-54  
Lt.                      &                      Rt.  
  
76.20 76.21 75.93  
2/3 113 98  
concrete Break & Walk

3+14 - 10<sup>2</sup> Lt. Begin 6<sup>5</sup> High Picket fence

3+10 - 9<sup>2</sup> Rt & Sing Gar

76.15 76.25  
9<sup>2</sup> 11<sup>3</sup>  
Apron Floor

3+07 - 10<sup>2</sup> Lt. & Sing Gar

76.20  
10<sup>2</sup>  
conc. floor

3+03 - 9<sup>2</sup> Rt. End 5" Conc. Ret Wall  
(Flash.)

76.20  
9<sup>2</sup>  
Top Ret  
Wall



2-9-54

(40)

Lt.

£

Rt.

X- SEC'S ALLEY BLK. 102

3+65-10<sup>2</sup> Lt. £ 3' Conc Walk

76.47 76.34  
20<sup>2</sup> 10<sup>2</sup>  
on walk £ walk

3+60<sup>5</sup> 9<sup>5</sup> Rt. Begin 6' High Board fence

3+60.5 9<sup>5</sup> Rt. End 6<sup>5</sup> High frame Shed

3+50<sup>5</sup> 9<sup>2</sup> Rt. Begin 6<sup>5</sup> High frame Shed

3+50 9<sup>3</sup> Lt. Begin 5' Picket fence

3+50- 9<sup>3</sup> Rt. End 6' Woven Wire fence

76.1 76.2 76.4 76.4 76.6  
25 10 0 10 25

3+46<sup>5</sup> - 15<sup>2</sup> Lt. End 2-Car Gar

76.73  
15<sup>2</sup>  
conc floor

3+27<sup>5</sup> 15<sup>1</sup> Lt. Begin 2-Car Gar

76.77  
15<sup>1</sup>  
conc floor

TBM.

77.30

Set P.K. Sly Side Tel Pole N<sup>o</sup> NRJPA 3061  
Sta A+00-8<sup>3</sup>' Lt. £ Alley



2-9-59

①

Lt.                      £                      Rt.

X- SEC'S. ALLEY B/LK. 102

4+08<sup>5</sup> - 98 Rt. End 6' Board fence4+08 - 95 Lt. & Sing Gar <sup>16'-wide</sup> Dirt floor

76.7

95

Dirt.

4+05 - 10<sup>5</sup> Rt. & 6" Conc. Walkway

77.16

10<sup>5</sup>

&amp; conc. walk

4+05 - 92 Rt. Begin 6' Board fence

4+00<sup>5</sup> 91 Rt. End - 2-Car Gar Dirt floor

76.7

91

Dirt.

4+00 - 87 Lt. End 5' Picket fence

4+00 - 83 Lt. & T&P N<sup>o</sup> NPJPA30614+00 - 85 Rt. & PP. N<sup>o</sup> A 3062

76.4

25

76.8

10

76.7

0

76.7

10

3+80<sup>5</sup> 97 Rt. Begin 2-Car Gar Dirt floor

76.5

97

Dirt

3+80<sup>5</sup> 97 Rt. End 6' Board fence



X- SEC'S ALLEY BIK. 102

5+00- 10° Rt. End Conc. Slab <sup>To Cabinet</sup> Shop Bldg

77.3 77.2 77.5 77.35 77.49 77.7  
25 10 0 100 112 25

5+00- 9° Lt. End 5'- Woven Wire fence

Conc. Conc @ Bldg

5+00- 8° Rt. & PP. N° A-3072

5+00- 8° Lt. & Tel. PP. N° NPJPA3075

4+76° 10° Rt. & 10'- Door-Way <sup>shop</sup> To Cabinet

77.29 77.35  
100 112  
Apron floor

4+67<sup>5</sup> 10° Rt. Begin Conc. Slab To Cabinet Shop

77.26 77.34  
100 112  
conc. Conc @ Bldg

4+50- 10° Lt. Begin 5'- High Woven Wire fence

4+50 10° Lt. End 5' Board fence

77.5 77.3 77.2 77.0 77.3  
25 10 0 10 25

4+17- 9° Lt. Begin 5'- Board fence



2-9-54

(43)

Lt.                    E                    Rt.

X- SEC'S ALLEY BLK. 102

6+0058 = W/4 P.L. 31-5+ Edge AC. Paving  
Begin Curb

77.7	77.92	77.24	76.98	77.22	77.26	77.45
25	10	10	0	10	15	25
	6	4		6		CONC.

5+97- 11° Pt. E 4" Conc Drain from Down-  
spout @ Blk

77.31  
11°  
F.L. CONC.  
Pipe

5+94- 14° Pt. Conc. Apron Extents to S.W.

78.0	77.8	77.2	77.3	77.2	78.0	78.03	77.94
25	10	4	0	4	10	14	25
						on CONC.	on CONC.

5+82<sup>3</sup> 9° Lt. E T.R. N° 425581-H

5+62. 9° Lt. E Deadman

77.6                    77.5                    77.7

5+50

77.6	77.4	77.6	77.5	77.6
25	10	0	10	15

T.B.M.

78.20

Set P.K. Sly Side Tel Pole N° 425581-H  
Sta 5+82-9° Lt E Alley



X-SEC'S ALLEY BLK 102

2-9-54

(49)

Lt.      &      Rt.

B.M.

78.55

78.59  $\frac{1667}{41-A}$

NEBP

31-st & K.

Listed as

78.4833

6+30.58 = & 31-st St. & Sewer M.H.

77.38 77.19 77.14 76.99 76.88 76.83 76.73  
75 50 25 0 25 50 75

Wly Em

6+10.58 = Wly Curbline 31-st St.

76.72 77.21 76.68 76.67 76.51 76.50 76.52 77.05 76.44  
25° 12° 12° 10° 0 10° 12° 12° 25°  
G cb G                      G cb G

77.32 76.92  
25° 25°  
cb cb

6+08.58 = B.C. Curb Returns

77.26 76.95 76.61 76.77 77.10  
10° 10° 0 10° 11°  
cb G                      G cb



wo # 32184

7-22-54

D. Smith

J. Gray

R. Taylor

B. Fish

1430

X Sec  
see

Alley BIKA Sunset Crest Add.

Lt = Wly

Mt = Ely

(25)

Sketch & Notes pg 37 KB-1757

Note: these are profits & new improvements only

RECEIVED  
JUL 23 1954

1425

1400

0475

0450

0425

0400 Nly Valencia Dr edge A.C. part + cbs

235 29 46

289B top curb  
Mt Ely  
Valencia Dr

291 46

280.56  
278.91  
1255  
78  
75  
9d footing

105	102	102	92	91	85
15	75	4	75	15	15
281.0	281.3	281.3	281.6	282.4	283.0
202.2	283.0	283.3	283.5	284.0	285.2
93	80	80	80	75	65
105	75	10	6	15	15
284.86	285.66	285.46	285.56	286.46	287.06
15	75	5	5	75	15
287.06	287.36	287.36	287.36	288.26	288.76
44	44	44	44	32	22
75	6	6	75	15	15
287.56	287.86	287.91	288.16	288.86	289.96
32	36	35	33	25	15
85	75	4	75	15	15
287.56	287.33	287.56	288.24	289.11	
32	43	30	28	28	
73	73	70	70	70	
05	90	05	05	05	

Notes Received  
7-23-54  
B. Fish



2+19 8<sup>3</sup> Lt Nly edge diagonal drive

2+13 28<sup>2</sup> Lt Most. Sly cor garage Bldg

2+100

1+91 8<sup>3</sup> Lt Sly diagonal drive to double garage cov floor

1+85 8<sup>3</sup> Lt Nly edge drive & double garage cov floor

1+75

(8<sup>3</sup> Lt Sly edge cov drive to double garage cov floor

1+70 8<sup>3</sup> Lt end 6" cov block wall

1+60 7<sup>5</sup> Rt Begin footing dug for proposed wall

TP 1<sup>22</sup> 279<sup>72</sup> 12<sup>26</sup> 278<sup>50</sup>

1+50

Lt = Wly

Rt = Ely

(76)

271.53  
8<sup>3</sup>  
28<sup>2</sup>  
Floor

271.44  
8<sup>3</sup>  
drive

272.41  
7<sup>6</sup>  
15<sup>1</sup>  
dirt

272.56  
7<sup>6</sup>  
8<sup>3</sup> 7<sup>5</sup>  
drive

272.6  
7<sup>6</sup>

273.0  
7<sup>6</sup>

272.8  
6<sup>9</sup>  
5

273.2  
6<sup>5</sup>  
7<sup>5</sup>

275.0  
4<sup>2</sup>  
15

273.08  
16<sup>4</sup>  
8<sup>3</sup>  
drive

273.22  
6<sup>50</sup>

273.10  
6<sup>62</sup>

275.33  
4<sup>39</sup>

39<sup>5</sup>  
Floor

37  
Bk.

8<sup>3</sup>  
drive

273.44  
4<sup>28</sup>

274.0  
3<sup>7</sup>

275.9  
1<sup>8</sup>

276.6  
3<sup>5</sup>

277.2  
1<sup>5</sup>

273.24  
6<sup>48</sup>

273.30  
6<sup>42</sup>

277.46  
2<sup>26</sup>

275.57  
4<sup>28</sup>

37  
3<sup>4</sup>

276.2  
3<sup>36</sup>

39<sup>5</sup>  
Floor

34<sup>3</sup>  
Bk wall

8<sup>3</sup>  
top

8<sup>3</sup>  
Footing

58

8<sup>3</sup>  
drive

278.6  
1<sup>6</sup>

277.08  
2<sup>64</sup>

7<sup>5</sup>

9<sup>6</sup>

Footing dug

279<sup>72</sup>

279.0  
12<sup>5</sup>

278.1  
12<sup>4</sup>

278.6  
12<sup>2</sup>

278.8  
12<sup>3</sup>

279.0  
12<sup>5</sup>

280.2  
11<sup>3</sup>

280.4  
11<sup>1</sup>

281.7  
9<sup>8</sup>

281.8  
9<sup>2</sup>

20

291<sup>46</sup>



3400

2499 7<sup>5</sup> Lt Begin 4' board fence

2478 16<sup>5</sup> Lt Most Ely cor double garage

2475

2468<sup>5</sup> 8<sup>0</sup> Lt Nly edge con drive diagonal

2459 31<sup>5</sup> Lt Most Sly cor double garage con floor

2458 22<sup>2</sup> Lt E double garage con floor only

TP2 1<sup>4</sup> 268.13 13<sup>00</sup> 266.67

2455 7<sup>2</sup> Lt to drive L.

2450 6<sup>3</sup> Lt { Sly con drive  
Ely end 6" con block wall L to line

2427 11<sup>7</sup> Lt Most Ely cor garage

2425

2423 11<sup>0</sup> Lt low pt drainage of drive & garage  
drains NEly.

LT = Wly  
6<sup>5</sup> 261.6  
15  
7<sup>5</sup> 261.2  
6  
7<sup>5</sup> 260.6  
7<sup>5</sup> 260.6  
RT = Ely  
7<sup>5</sup> 260.8  
15 260.7

2654  
22 36 41 Floor  
12 75 6  
264.5  
264.0  
139  
16  
266.74  
266.36  
177  
80  
drive  
4 264.0  
32 264.2  
75 15 264.3  
264.81  
132  
31  
Floor  
1 22  
222  
Floor

268.13  
266.66  
13<sup>00</sup>  
72  
26.76  
266.76  
267.04  
12<sup>4</sup> 12<sup>8</sup> 12<sup>11</sup> 12<sup>11</sup> 12<sup>2</sup> 12<sup>3</sup> 12<sup>6</sup> 13<sup>0</sup>  
15 10 72 62 63 6  
B.K. drive driver wall con  
266.8  
268.62  
266.8  
267.0  
267.1  
266.7  
8<sup>0</sup> 271.46  
112  
Floor  
9 370.6  
75 5 98 269.9  
9 269.8  
96 270.1  
75 15 95 270.2  
7 279.72



TP4

025

246<sup>84</sup>

90

246<sup>59</sup>

4413 18° RT &amp; double garage cov Floor only

4400

3475

3470 7<sup>5</sup> Lt end 4' Board fence

3450

3446 8<sup>4</sup> RT wly emb cov Block wall under cov

TP3

026

255<sup>99</sup>

130

255<sup>03</sup>3429 45<sup>2</sup> RT & double garage cov Floor only

3425

Lt-Wly

2

RT-Flg

(48)

242.7  
133  
15243.2  
120  
75243.9  
121  
75244.5  
115  
75244.4  
115  
751215  
182  
Floor  
243.99247.8  
82  
15247.2  
85  
75248.6  
84  
75248.4  
85  
75248.4  
85  
15253.5  
35  
15253.3  
32  
75252.6  
44  
5252.3  
47  
75251.5  
45  
75253.0  
30  
15252.77  
322  
84  
footing253.33  
266  
84  
top253.4  
26  
84  
90255<sup>99</sup>257.8  
103  
15258.1  
100  
75256.3  
118  
5256.3  
118  
75256.7  
114  
75256.9  
112  
151136  
452  
Floor  
256.77

T. 26813



5750

5725

TP<sub>3</sub>

224

241<sup>00</sup>

888

238<sup>26</sup>

Mail in 1761  
JPA1353  
490124

5400

4475

4464

4454 11<sup>4</sup> 67 #0 NELY cor double garage + cow floor + spread

4450

4425

Lt = Wly

5<sup>15</sup> 235.7

5<sup>14</sup> 235.6

5<sup>1</sup> 235.9

4<sup>1</sup> 236.3

3<sup>15</sup> 237.5

(49)

4<sup>2</sup> 236.1

4<sup>2</sup> 236.3

4<sup>4</sup> 236.6

3<sup>10</sup> 237.2

2<sup>11</sup> 238.3

7 241<sup>00</sup>

9<sup>6</sup> 237.2

9<sup>2</sup> 237.1

9<sup>3</sup> 237.5

9<sup>3</sup> 237.6

8<sup>14</sup> 238.3

9<sup>7</sup> 237.1

9<sup>0</sup> 237.8

8<sup>3</sup> 238.5

7<sup>2</sup> 238.9

7<sup>4</sup> 238.7

9<sup>33</sup> 237.51

11<sup>2</sup> spread end

9<sup>24</sup> 237.60

11<sup>2</sup> floor

8<sup>2</sup> 238.6

7<sup>5</sup> 239.3

7<sup>0</sup> 239.8

6<sup>2</sup> 239.9

6<sup>13</sup> 240.5

5<sup>2</sup> 240.9

5<sup>10</sup> 241.8

8<sup>3</sup> 238.5

6<sup>1</sup> 240.7

4<sup>10</sup> 242.0

4<sup>15</sup> 242.3

3<sup>10</sup> 243.0

3<sup>10</sup> 243.0

7 246<sup>84</sup>



T.P.B.M.

934

231.66

231.20

on Nail  
614731-614720 PG 43 FB1757

61720 Sly Point Loma Ave taken along

231.25  
928 928 936 794 751  
81 81 88 86  
end end end

6150

234.1  
62 70 72 80 80 74 68 51 22 71  
15 10 10 6 6 6 7 9 18 15

6125

234.6  
64 58 50 64 64 50 31 31  
15 10 15 5 6 7 13 15

6100

235.0  
60 54 54 56 56 52 34 30  
15 13 15 5 5 7 12 15

5175

234.7  
64 52 54 41 34  
15 15 15 15 15

5164 29 1/2 ft double garage con floor apron

231.69  
931 943 8  
34 32 29 1/2  
Floor Bk apron

241.00







Actually  
a 5' walk  
back of R.I. cb.

Type 5 Roll Curb

Laurel

Boundary

As Paving

5' Comb. Walk of Curb

3' Walk

Homemade Curb

32.2'

Prop. Line

3' Walk

1" = 20'

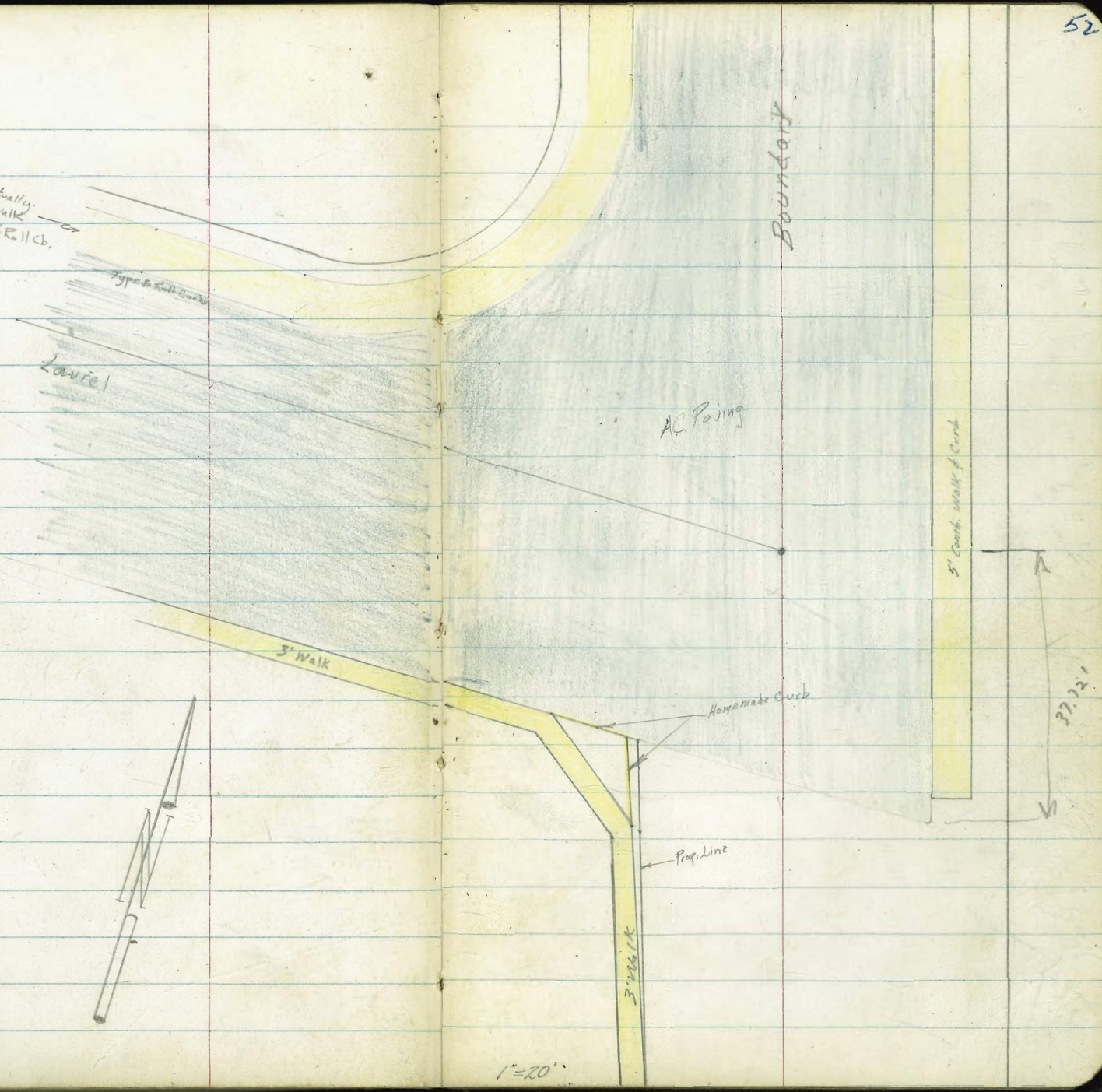
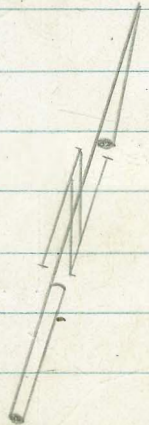



Old City Boundary

0+33 20 Lt End Curb & Walk ✓

288.49 ✓  
288.23 ✓  
288.20 ✓  
289.77 ✓  
47 496 499 542  
30 25 20 20  
walk cb Gut

288.49 ✓  
289.09 ✓  
289.39 ✓  
289.49 ✓  
289.70 ✓  
289.89 ✓  
47 41 38 37 349 32  
15 17 21 21 30  
Gut cb

0+31 Approx. Edge paving and on line of Curb & Walk  
Section Parallel to Laurel

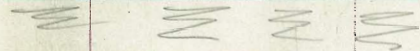

287.75 ✓ 37%  
288.35 ✓  
288.53 ✓ 96  
288.71 ✓  
289.14 ✓  
289.79 ✓  
5.44 288.35 4.66 288.71 289.14 289.79  
21 5 10 22 22 50 50  
Pav. Gut cb Gut cb

0+28.5 17<sup>±</sup> Rt to Near Edge P Pole # P2498 ✓

0+25 21 Rt Angle point in curb

288.96 ✓  
289.71 ✓  
289.89 ✓  
4.23 4.42 3.3  
21 21 31  
Gut cb

0+00 Old North Line Laurel (section taken at Right Angles)

289.14 ✓  
289.57 ✓  
289.34 ✓  
289.65 ✓  
289.58 ✓  
4.05 4.62 3.85 3.54 3.61  
20 20 20 20 50  
cb Gut

0 minus 100 or -1-00

291.34 ✓  
290.76 ✓  
291.42 ✓  
291.39 ✓  
291.20 ✓  
1.85 2.48 1.77 1.80 1.49  
20 20 20 20 21  
cb Gut cb

T.P. 3.85 293.197 771 289.34

293.197

BM 1.93 297.05

SEBP  
295.12 Boundary & Maple



1400

<sup>287.39</sup> ✓  
<sup>287.49</sup> ✓  
<sup>287.59</sup> ✓  
<sup>286.49</sup> ✓  
<sup>287.19</sup> ✓  
<sup>287.39</sup> ✓  
<sup>287.29</sup> ✓  
<sup>288.19</sup> ✓  
<sup>289.10</sup> ✓

58 57 56 67 60 58 59 50 42  
 40 30 23 18 10 15 19 30

0+94

30 Lt & 8 conc drive (No Garage) (Bedroom) ✓

<sup>287.55</sup> ✓  
<sup>287.41</sup> ✓  
 5.64 5.78  
 44I 30  
 conc conc

0+86

21 Rt & 8 conc drive ✓

<sup>289.02</sup> ✓  
<sup>289.76</sup> ✓  
 4.17 3.43  
 21 44  
 conc Floor

0+81

30<sup>2</sup> Lt & 25<sup>2</sup> conc walk ✓

<sup>287.62</sup> ✓  
<sup>287.71</sup> ✓  
 5.57 5.48  
 40<sup>2</sup> 30<sup>2</sup>  
 walk walk

0+77

20<sup>2</sup> Rt End 3 walk ✓

<sup>289.46</sup> ✓  
 3.73  
 20<sup>2</sup>  
 walk

0+50

<sup>288.49</sup> ✓  
<sup>288.29</sup> ✓  
<sup>287.89</sup> ✓  
<sup>287.59</sup> ✓  
<sup>288.19</sup> ✓  
<sup>288.39</sup> ✓  
<sup>288.99</sup> ✓  
<sup>288.19</sup> ✓  
<sup>289.49</sup> ✓  
<sup>289.61</sup> ✓  
<sup>288.99</sup> ✓

47 49 53 56 50 48 43 40 37 35 32  
 40 30 18 17 8 15 16 21 21 30  
 walk

0+46

18 Rt to deadman ✓

0+44

25 Lt & 12<sup>2</sup> conc drive ✓

<sup>288.16</sup> ✓  
<sup>288.64</sup> ✓  
 5.03 4.55  
 25 44 Down  
 conc BR

293.19A

293.19A



T.P. 1.07 2850.27 9.24 283.95

2400

<sup>✓</sup> 281.19  
<sup>✓</sup> 283.12  
<sup>✓</sup> 283.79  
<sup>✓</sup> 283.39  
<sup>✓</sup> 283.99  
<sup>✓</sup> 284.29  
<sup>✓</sup> 284.79  
<sup>✓</sup> 285.29

12.0 107 94 98 92 89 92 84 7.9  
 40 30 24 20 12 12 16 30

1777 18 Rt 10 conc drive ✓

<sup>✓</sup> 285.00  
<sup>✓</sup> 286.11  
<sup>✓</sup> 286.30

7.29 7.08 6.89  
 18 20 34  
 conc BRK conc

1771 198 Rt End Curbing ✓

<sup>✓</sup> 282.39  
<sup>✓</sup> 284.09  
<sup>✓</sup> 285.19  
<sup>✓</sup> 285.39  
<sup>✓</sup> 285.09  
<sup>✓</sup> 285.69  
<sup>✓</sup> 285.79  
<sup>✓</sup> 285.79  
<sup>✓</sup> 287.19  
<sup>✓</sup> 287.39

10.8 8.5 8.0 7.8 8.1 7.5 7.4 7.4 6.85 5.8  
 40 30 27 21 18 8 14 20 30  
 cb

1750

1730 { 20 Rt begin 6" Curbing flush with yard ✓  
 { 15<sup>3</sup> Rt to Near Edge P.P. #P2466 ✓

<sup>✓</sup> 287.9  
 5.27  
 20  
 cb

1714 30<sup>3</sup> Lt 3' Conc Walk ✓

<sup>✓</sup> 286.85  
<sup>✓</sup> 286.79

6.34 6.40  
 40<sup>3</sup> 30<sup>3</sup>  
 conc conc



2+94 18<sup>1</sup> Rt & 9 Conc Drive ✓

281.77  
325 3.57  
187 33  
Conc Floor

2+825 18<sup>1</sup> Rt & 8 Conc Drive ✓

282.11  
291 2.96  
181 30  
Conc Conc

2+75 16 Rt End Curbing ✓

282.46  
2.56  
16  
Cb

2+55 13 Rt to deadman ✓

2+50

279.82 ✓  
281.92 ✓  
282.32 ✓  
282.02 ✓  
282.62 ✓  
282.72 ✓  
282.62 ✓  
283.50 ✓  
283.22 ✓  
5.2 3.1 2.7 3.0 2.4 2.3 2.4 1.52 1.8  
40 30 24 22 13 10 16<sup>2</sup> 30  
Cb Cb

2+35 { 16<sup>2</sup> Rt to begin 9" curb.  
13<sup>2</sup> Rt to Near Edge P.Pole #P2434 ✓

284.02  
1.00  
16<sup>2</sup>  
Cb

2+24 19<sup>4</sup> Rt & 8 Conc drive ✓

284.22  
0.80 0.71  
194 30  
Conc Conc

285.02 X

285.02 X



3+61.5 47 Rt to Near Edge 4" pine tree ✓

3+50 41 Rt to Near Edge 4" Pine tree ✓

3+48.13 ♀ Kalmia

9.4	70	72	62	67	63	57	6.01	6.4	8.0
50	40	30	23	21	5	3	on Hub	16.6	30

3+45 45 Rt to near edge 8" pine tree ✓

3+38 19 Rt End Conc block wall ✓

3+18.13 North Line Kalmia  
Check for Closings.

8.7	5.4	3.4	4.7	4.4	4.5
50	30	21		19	30

3+13.5 34 Lt ♀ 10 Conc. drive that curves to garage opening to south. Opening opposite station 2+89 ✓

7.47	5.94
50 from Floor	34 Conc

3+00 188 Rt begin conc block wall

6.4	4.3	4.1	4.7	4.0	3.9	3.8	3.6	4.4	0.6	4.0
40	30	24	21	12		7	18	18	18	30
							GRD	Foot	Top	



11.52  
30  
9.09

check 1.04 295.14 = 295.12

J.P. 11.67 296.18 0.51 284.51

S.L. Kalmia plus 100'

South Line Kalmia plus 50'

3+78.13 South Line Kalmia

274.32	274.92	276.42	276.02	276.42	277.32	277.62	276.33	275.92	274.42
10.7	10.1	8.6	7.0	8.2	7.7	7.4	11.5	9.1	10.6
50	31	30	25	6	5		22		30

3+74 42° Rt to near edge 3" Pine tree ✓

3+70 { 10° Lt to near edge P.P. # P23.98 ✓  
15° Rt to deadman ✓

285.02

285.02

267.92  
17.1

272.52  
12.5

Hochke  
1-21-55



2-SEC LAUREL, COMMONWEALTH TO  
BOUNDARY

COTA  
GARBER  
MORALEZ  
KELLY  
1-05-55  
W.D. # 32272

INDEXED  
JER  
JAN 7 1955

SEE SKETCH PG. 52 FOR MORE DETAIL  
THIS INFORMATION



NOT TO SCALE

ROLLED CURB

LAUREL ST.

BOUNDARY ST.

22.23'

24.98'

34.563

14.35  
308 FT

1457.2

SEE PAGE NOTES

PROP LINE

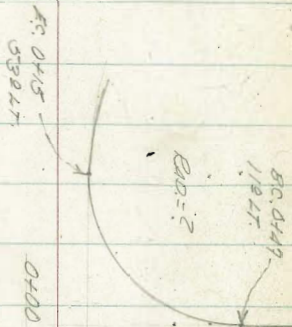

SAME AS SKETCH PG. 57

DEAD CORNER

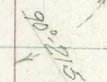

40'

04025  
301 FT

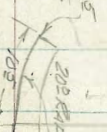

5' CORNER CENTER MARK

COMMONWEALTH ST.

40'

B.L. 0-4  
301 FT

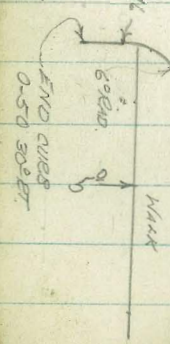



LT.

6

RT.

2886 2883  
12 87

0450

286.41	286.11	286.10	285.92	285.70	285.8
12	11		20	29.2	30
CB.	GUT			EDGE	
TOP				PAVING	
				2 F.P.	

0447, 112 LT. CB. BC. (ROLLED CB.)

286.41	286.05
12	112
CB.	GUT
TOP	

0415 53.5 LT. CB. BC. (ROLLED CB.)

286.38	285.95
53.5	53.5
CB.	GUT.

0425 30<sup>1</sup>/<sub>2</sub> RT. END OF CURB

284.91	285.59	
30.1	30.1	284.97
GUT.	CB.	90 CB.

0400 ELY CB. LINE COMMONWEALTH

↑  
SECTIONS TAKEN PARALLEL TO COMMONWEALTH

286.00	285.13	284.77	285.10	284.51
50		10	10	30
		GUT.	CB.	GUT

0-20 @ COMMONWEALTH

285.35	285.16	284.60	284.04
50		50	100

DIRECT ELEV. ROAD

289.34 P.K. MARK @ BOUNDARY  
@ OLD NORTH LINE LAUREL

12-02 D.S.-0



LT.

±.

RT.

2400

DRIVE 288.80 288.80 288.64 288.57 288.3  
 11 20 29.2 30  
 GUT BOT 80T  
 OB

288.1 288.2  
 10 30  
 TOP  
 OB

1463<sup>5</sup> 30° RT. BEGIN 12" WIDE CONC. CB. ✓

287.72 288.58  
 30 30  
 BOT TOP  
 CB. CB.

1461 30<sup>8</sup> RT. TO NEAR EDGE T.P. # P3589 ✓

287.2  
 50

1451<sup>2</sup> APPROX ± ALLEY (SEE SKETCH)

288.22 287.90 287.94 287.85 287.13 287.5  
 12 11 20 29.0 30  
 OB. GUT E.P.  
 TOP

1445 30° RT. END 4<sup>5</sup> HIGH METAL FENCE ✓

1419 30° RT. BEGIN 4<sup>5</sup> HIGH METAL FENCE ✓

1406 29<sup>5</sup> RT. ± 10" WIDE CONC. DRIVE ✓

286.78 288.02  
 29.5 46  
 CONC. CURB  
 L.P.

288.0 287.8  
 50 37

1400

DRIVE 287.00 287.09 286.86 286.55 286.7  
 11 20 29.2 30  
 GUT E.P.



2483, 55<sup>5</sup> LT. CB. BC.

291.01 290.16  
55.5 55.5  
CB. TOP GUT.

2450

290.2 289.83  
10 30  
TOP CB.

290.05 289.64 289.63 289.39 289.11 289.0  
12.2 11.2 20 29.5 30  
CB. GUT. F.P. CB.

2444.12 112 LT. CB. B.C.

289.98 289.60  
12 11  
CB. GUT.  
TOP

289.01  
34  
29.5

2476 29<sup>8</sup> RT. BEGIN, 30" WIDE COMBINATION CB & WALK  
(PRIVATE CB & WALK)

288.7 289.53 289.34  
29.8 29.8 32.8  
BOT. TOP EDGE  
CB. CB. WALK

2444.2 29<sup>2</sup> RT. 11<sup>5</sup> WIDE CONC. DRIVE

288.65 288.99 289.19  
29.2 31 14  
LIP FLOOR GUT.

2406 30<sup>0</sup> RT. END CONC. CB.

288.1 288.62  
30 30  
BOT. TOP  
CB. WALK - ?



LT.

¢

RT.

315.63  
293.4  
-----  
22.23

3415.63 ¢ BOUNDRY - SECTION TAKEN ALONG  
BOUNDRY

290.53 289.3A 288.50 288.4  
50 33.3 50  
EP

289.7  
10

3402 ¢ SECTION TAKEN AT RT. ANGLES TO OUR  
LINE, 309 RT. END PRIVATE OS.

290.18 290.01 289.64 289.09 288.73 289.76  
50 20 20 30 30  
PROP OS.  
COR  
GUT

289.5  
50

3495 ¢ WEST PROP LINE OF BOUNDRY INTERSECTS  
OUR ¢; SECTION TAKEN PARALLEL TO  
BOUNDRY ST.  
(ON SOUTH)

290.75 290.42 290.05 289.77 289.14 288.33 289.76  
75 50 20 20 31 31  
GUT OS.  
TAP

PROP  
COR.



INDEXED

HER  
JUN 27 1955

6-23-55

T.A. Stamper

(69)

CROSS SECTION ALLEY M. TRACT N<sup>o</sup> 2  
OF ALTA VISTA W.O. 32464

Ref. T.P. 3329

Map N<sup>o</sup> 1029

IMPERIAL

Fd. Nothing

A.C. Pavt.

Set P.K. Nail

M. 95.43

M. 74.22

M. 399.35

399.19 T.P.

AVE.

M. 325.13

Fd L. & TK.

This Tack is in Error According  
to Tie Sheet

NOTE: Check for 10' opening

5' S.W.

5+99.42

Set 2x2" Hub & TK

Fd L. & TK

3'

7'

ST.

ALLEY

(CLOSED)

ST.

48-TH

15' 0+00

Set Lead & Disk

Type "G" Curb

Conc. Pavt.

2' Cb. R.

A.C. Pavt. FRANKLIN

AVE

Fd. P.K. Nail

30'

53'

30'

M.

139.60

Set chis/ on M.H.

Rim (A)

M. 634.48' (634.70' Tie Sheet)

Set chis/ Cross  
E. Rim Sewer M.H.



6-23-55

Stamper  
Huffman  
Blunt  
Elmore

CROSS SECTION ALLEY "M" TRACT N<sup>o</sup> 2  
OF ALTA VISTA W.O. 32464

Lt

Rt

Rt.

0-08 = E.C. Cb Refs.

112.54	112.10	112.16	112.40	112.87
613	657	6.51	6.27	5.80
74	74	0	75	75
cb	G		G	cb

0-10 = N. Cb. line Franklin Ave

112.11	111.58	112.50	111.99	112.07	112.19	112.34	112.39	112.92	112.69	113.22
656	7.09	617	668	660	648	633	628	575	598	5.45
25	25	97	91	75	0	75	91	97	25	25
cb	G	cb	G			G	G	cb	G	cb

= & Sewer M.H.  
0-30 = & Franklin Ave

111.30	111.92	112.53	113.00	113.51
7.37	6.75	6.14	5.67	5.16
50	25	0	25	50

Sewer  
M.H.

118.67

+2.76 118.67

TP -3.92

115.91

Set P.K. P.P. N<sup>o</sup> P-70094 Sta 1+03-6<sup>o</sup> Lt.

+7.66 119.83

B.M.

112.17

S.E.B.P. Imperial & 47-14



6-24-55

66

X- SEC. ALLEY "M"

LH

E

RT

0+50

114.6	114.9	115.5	115.4	115.5	120.2
6.6	6.3	5.7	5.8	5.7	1.0
17	7.5	0	7.5	15	25
				Toe	Top

0+23 Top break

114.6	114.9	115.4	115.3	115.3	120.5
6.6	6.3	5.8	5.9	5.9	0.7
18	7.5	0	7.5	15	25
				Toe	Top
<u>121.16</u>					
					bank

+5.25 121.16

T.P.

-2.76

115.91

0+07 Toe break

114.3	114.4	112.8	112.5	112.9	113.1	114.9	115.0	118.5
4.5	4.3	5.9	6.2	5.8	5.6	3.8	3.7	0.2
25	9	7.5	0	7.5	8	10	16	25

= Edge Pavt &amp; End Curbs

0+00 = N. Line Franklin Ave

114.1	114.2	112.71	112.28	112.13	112.58	113.06	113.9	114.7	116.4
4.6	4.5	5.96	6.39	6.54	6.09	5.61	4.8	4.0	2.3
25	10	7.5	7.5	0	7.5	7.5	11	17	25
		cb	G		G	cb			

118.67



X-SEC. ALLEY "M"

1+98<sup>B</sup> - 6° Lt. & P.P.N° 170848

1+87 = Critical Drainage Area  
(Could be Drained To West.)

110.50	111.6	110.1	109.2	109.9	110.5	112.5	112.2	112.3	112.7	113.2	120.1
1066	100	11.1	120	11.3	10.7	9.7	9.0	8.9	8.5	8.0	1.1
150	142	127	100	75	50	25	75	0	75	11	24
A.C.										Toe	Top

1+50

111.6	112.1	112.7	113.3	113.3	113.2	113.4	120.0
9.6	9.1	8.5	7.9	7.9	8.0	7.8	1.2
25	15	75	4	0	75	12	24
						Toe	Top

1+03 - 6° Lt. & P.P.N° P-70094

1+00

114.7	114.7	115.3	115.2	115.2	115.2	120.2	
6.5	6.5	5.9	6.0	6.0	6.0	1.0	
15	75	5	0	75	14	24	
						Toe	Top

0+86 - 9° Lt. & 8' Garage

114.97  
6.19  
9.5  
Conc. floor

121.16

Lt.

&

rt

(67)



X- SEC. ALLEY "M"

Lt. & Rt

3+00 - & Sewer Manhole

113.0	113.1	113.6	113.5	113.25	113.1	113.1	120.4
8.2	7.8	7.6	7.7	7.9	8.1	7.8	0.8
25	12	7.5	0	0	7.5	10	23
			Ground	Sly Bin		Toe	Top
			M.H.				

2+99.5 - 6" Lt. & P.P.N. P-70093

2+88 - 12" Lt. & 8' Gar.

113.10  
8.06  
12"  
Conc floor

2+50

112.7	113.1	113.0	112.8	113.2	120.0
8.5	8.1	8.2	8.4	8.0	1.2
25	7.5	0	7.5	10	22
				Toe	Top

2+00

111.7	112.3	112.8	112.7	113.1	120.1
9.5	8.9	8.4	8.5	8.1	1.1
25	7.5	0	7.5	12	23
				Toe	Top

121.16



X- SEC. ALLEY "M"

Lt.                      &                      Rt

6-24-55

3+82 - 12° Lt. & 3' Conc Walk & End 1'  
Conc along bldg

113.94                      113.86  
7.22                      7.30  
22°                      12°  
on Walk                      & Walk

3+52 - 11° Lt. & 2' Conc Walk & Begin 1'  
Conc Walk along back of bldg

113.95                      113.90  
7.21                      7.26  
21°                      11°  
on Walk                      & Walk

3+50

113.4                      113.7                      113.8                      114.0                      113.5                      113.7                      120.4  
7.8                      7.5                      7.4                      7.2                      7.7                      7.5                      0.8  
25                      11                      7.5                      0                      7.5                      10                      22  
Toe                      Toe

3+27<sup>5</sup> - 11<sup>5</sup> Lt. & 15<sup>5</sup> Garage

113.68  
7.48  
15<sup>5</sup>  
Conc floor

121.16



X- SEC. ALLEY "M"

4+86-11<sup>5</sup> Lt End 4-Gar. (Dirt floor)

4+50-11<sup>6</sup> Begin 4-Garages (Dirt floor)

+6.82 123.23

Set P.R. Sta 5+01

TP. P.P.# P-70092 -4.75 116.41

4+00

3+99-73 Lt. & PPN# F-170849

3+89<sup>5</sup> 12' Lt. & 2-1<sup>5</sup> Conc. Ribbons

To 6<sup>5</sup> Drive

Lt & Rt

114.5  
8.7  
11.5  
Dirt floor

114.0 114.4 114.5 114.4 114.6 120.2

9.2 8.8 8.7 8.8 8.6 3.0  
11.6 7.5 0 7.5 10 20  
Dirt floor Toe Top

123.23

114.0 114.2 114.3 114.0 114.3 120.5

7.2 7.0 6.9 7.2 6.9 0.7  
1.5 7.5 0 7.5 10 2.2  
Toe Top

113.87

7.29  
12.0  
Conc.  
Apron

121.16



X-SEC. ALLEY "M"

Lt

±

Rt

(70)

5+97<sup>42</sup> - 7<sup>2</sup> Rt = B.C. 2' Cb. Ret.

5+99 - 12<sup>3</sup> Lt. ± PPN<sup>o</sup> P-70090

= 5. Line Imperial Ely

5+89<sup>42</sup> 7<sup>2</sup> Rt. Begin Curb

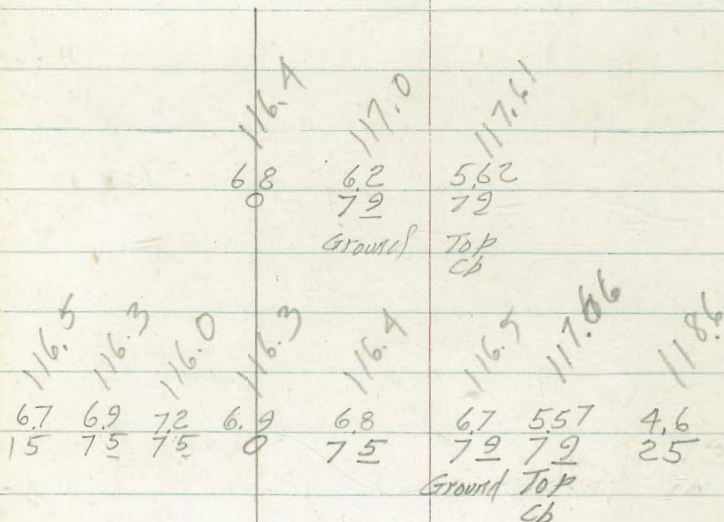

5+50

5+21 - 7<sup>3</sup> Lt. ± 2-Deadmen

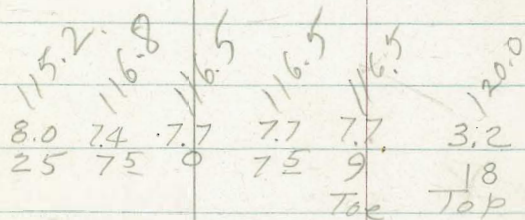

5+01 - 7<sup>1</sup> Lt. ± PPN<sup>o</sup> P-70092

5+00

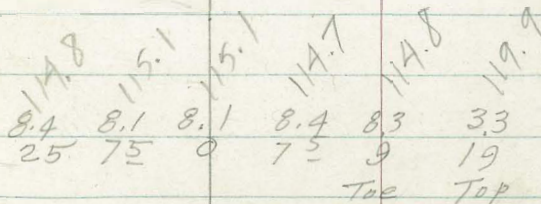

± 123.23



Lt

ε

Rt

X - SEC. ALLEY "M"

6+17- Lt = Line AC Pavt To W.

116.19	117.11	117.44	118.01
7.04	6.12	5.79	5.22
25	0	8	25
Ac.	A.C	Conc	Conc

6+12 = Edge AC on ε

117.01  
6.22  
0

6+10<sup>8</sup> Rt. Edge AC & Conc.

117.33  
5.90  
79  
Conc

5+99<sup>42</sup> = S. line Imperial Wly = Curblin Ely

115.8	116.4	116.7	116.96	117.09	117.68	117.60	118.13
7.4	6.8	6.8	6.27	6.14	5.55	5.63	5.10
25	73	0	79	99	99	25	25
			Conc. Pavt	Gut	cb.	G	cb

123.23



X- SEC. ALLEY "M"

6-24-55

(73)

Lt. E Rt

B.M.

-11.08

112.15 — 112.17 (Starting Bench)

6 + 30.30 = E/Imperial Ave

115.79	116.56	117.33	118.14	119.09
7.44	6.67	5.90	5.09	4.14
50	25	0	25	50

123.23



48  
25/3  
73

640.24

640.71  
38.77

6479.48

6401.97

10740.24

4.00

6490.20

72  
24  
110  
24  
0.8

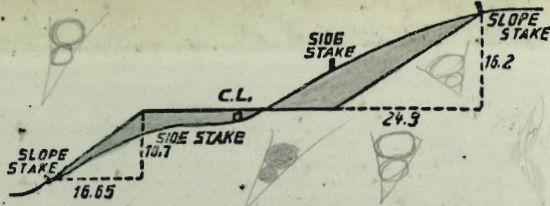

DISTANCES FROM SIDE STAKES FOR CROSS-SECTIONING.  
SLOPE 1 1/2 TO 1. ROADWAY OF ANY WIDTH.

	0	.1	.2	.3	.4	.5	.6	.7	.8	.9	
0	0.00	0.15	0.30	0.45	0.60	0.75	0.90	1.05	1.20	1.35	0
1	1.50	1.65	1.80	1.95	2.10	2.25	2.40	2.55	2.70	2.85	1
2	3.00	3.15	3.30	3.45	3.60	3.75	3.90	4.05	4.20	4.35	2
3	4.50	4.65	4.80	4.95	5.10	5.25	5.40	5.55	5.70	5.85	3
4	6.00	6.15	6.30	6.45	6.60	6.75	6.90	7.05	7.20	7.35	4
5	7.50	7.65	7.80	7.95	8.10	8.25	8.40	8.55	8.70	8.85	5
6	9.00	9.15	9.30	9.45	9.60	9.75	9.90	10.05	10.20	10.35	6
7	10.50	10.65	10.80	10.95	11.10	11.25	11.40	11.55	11.70	11.85	7
8	12.00	12.15	12.30	12.45	12.60	12.75	12.90	13.05	13.20	13.35	8
9	13.50	13.65	13.80	13.95	14.10	14.25	14.40	14.55	14.70	14.85	9
10	15.00	15.15	15.30	15.45	15.60	15.75	15.90	16.05	16.20	16.35	10
11	16.50	16.65	16.80	16.95	17.10	17.25	17.40	17.55	17.70	17.85	11
12	18.00	18.15	18.30	18.45	18.60	18.75	18.90	19.05	19.20	19.35	12
13	19.50	19.65	19.80	19.95	20.10	20.25	20.40	20.55	20.70	20.85	13
14	21.00	21.15	21.30	21.45	21.60	21.75	21.90	22.05	22.20	22.35	14
15	22.50	22.65	22.80	22.95	23.10	23.25	23.40	23.55	23.70	23.85	15
16	24.00	24.15	24.30	24.45	24.60	24.75	24.90	25.05	25.20	25.35	16
17	25.50	25.65	25.80	25.95	26.10	26.25	26.40	26.55	26.70	26.85	17
18	27.00	27.15	27.30	27.45	27.60	27.75	27.90	28.05	28.20	28.35	18
19	28.50	28.65	28.80	28.95	29.10	29.25	29.40	29.55	29.70	29.85	19
20	30.00	30.15	30.30	30.45	30.60	30.75	30.90	31.05	31.20	31.35	20
21	31.50	31.65	31.80	31.95	32.10	32.25	32.40	32.55	32.70	32.85	21
22	33.00	33.15	33.30	33.45	33.60	33.75	33.90	34.05	34.20	34.35	22
23	34.50	34.65	34.80	34.95	35.10	35.25	35.40	35.55	35.70	35.85	23
24	36.00	36.15	36.30	36.45	36.60	36.75	36.90	37.05	37.20	37.35	24
25	37.50	37.65	37.80	37.95	38.10	38.25	38.40	38.55	38.70	38.85	25
26	39.00	39.15	39.30	39.45	39.60	39.75	39.90	40.05	40.20	40.35	26
27	40.50	40.65	40.80	40.95	41.10	41.25	41.40	41.55	41.70	41.85	27
28	42.00	42.15	42.30	42.45	42.60	42.75	42.90	43.05	43.20	43.35	28
29	43.50	43.65	43.80	43.95	44.10	44.25	44.40	44.55	44.70	44.85	29
30	45.00	45.15	45.30	45.45	45.60	45.75	45.90	46.05	46.20	46.35	30
31	46.50	46.65	46.80	46.95	47.10	47.25	47.40	47.55	47.70	47.85	31
32	48.00	48.15	48.30	48.45	48.60	48.75	48.90	49.05	49.20	49.35	32
33	49.50	49.65	49.80	49.95	50.10	50.25	50.40	50.55	50.70	50.85	33
34	51.00	51.15	51.30	51.45	51.60	51.75	51.90	52.05	52.20	52.35	34
35	52.50	52.65	52.80	52.95	53.10	53.25	53.40	53.55	53.70	53.85	35
36	54.00	54.15	54.30	54.45	54.60	54.75	54.90	55.05	55.20	55.35	36
37	55.50	55.65	55.80	55.95	56.10	56.25	56.40	56.55	56.70	56.85	37
38	57.00	57.15	57.30	57.45	57.60	57.75	57.90	58.05	58.20	58.35	38
39	58.50	58.65	58.80	58.95	59.10	59.25	59.40	59.55	59.70	59.85	39
40	60.00	60.15	60.30	60.45	60.60	60.75	60.90	61.05	61.20	61.35	40
41	61.50	61.65	61.80	61.95	62.10	62.25	62.40	62.55	62.70	62.85	41
42	63.00	63.15	63.30	63.45	63.60	63.75	63.90	64.05	64.20	64.35	42
43	64.50	64.65	64.80	64.95	65.10	65.25	65.40	65.55	65.70	65.85	43
44	66.00	66.15	66.30	66.45	66.60	66.75	66.90	67.05	67.20	67.35	44
45	67.50	67.65	67.80	67.95	68.10	68.25	68.40	68.55	68.70	68.85	45
46	69.00	69.15	69.30	69.45	69.60	69.75	69.90	70.05	70.20	70.35	46
47	70.50	70.65	70.80	70.95	71.10	71.25	71.40	71.55	71.70	71.85	47
48	72.00	72.15	72.30	72.45	72.60	72.75	72.90	73.05	73.20	73.35	48
49	73.50	73.65	73.80	73.95	74.10	74.25	74.40	74.55	74.70	74.85	49
50	75.00	75.15	75.30	75.45	75.60	75.75	75.90	76.05	76.20	76.35	50

THE NATIONAL BLANK BOOK COMPANY  
HOLYOKE MASSACHUSETTS  
NEW YORK CHICAGO BOSTON SAN FRANCISCO