

DISTANCES FROM SIDE STAKES FOR CROSS-SECTIONING  
SLOPE 1 TO 1. ROADWAY OF ANY WIDTH

	0	.1	.2	.3	.4	.5	.6	.7	.8	.9	
0	0.00	0.10	0.20	0.30	0.40	0.50	0.60	0.70	0.80	0.90	0
1	1.00	1.10	1.20	1.30	1.40	1.50	1.60	1.70	1.80	1.90	1
2	2.00	2.10	2.20	2.30	2.40	2.50	2.60	2.70	2.80	2.90	2
3	3.00	3.10	3.20	3.30	3.40	3.50	3.60	3.70	3.80	3.90	3
4	4.00	4.10	4.20	4.30	4.40	4.50	4.60	4.70	4.80	4.90	4
5	5.00	5.10	5.20	5.30	5.40	5.50	5.60	5.70	5.80	5.90	5
6	6.00	6.10	6.20	6.30	6.40	6.50	6.60	6.70	6.80	6.90	6
7	7.00	7.10	7.20	7.30	7.40	7.50	7.60	7.70	7.80	7.90	7
8	8.00	8.10	8.20	8.30	8.40	8.50	8.60	8.70	8.80	8.90	8
9	9.00	9.10	9.20	9.30	9.40	9.50	9.60	9.70	9.80	9.90	9
10	10.00	10.10	10.20	10.30	10.40	10.50	10.60	10.70	10.80	10.90	10
11	11.00	11.10	11.20	11.30	11.40	11.50	11.60	11.70	11.80	11.90	11
12	12.00	12.10	12.20	12.30	12.40	12.50	12.60	12.70	12.80	12.90	12
13	13.00	13.10	13.20	13.30	13.40	13.50	13.60	13.70	13.80	13.90	13
14	14.00	14.10	14.20	14.30	14.40	14.50	14.60	14.70	14.80	14.90	14
15	15.00	15.10	15.20	15.30	15.40	15.50	15.60	15.70	15.80	15.90	15
16	16.00	16.10	16.20	16.30	16.40	16.50	16.60	16.70	16.80	16.90	16
17	17.00	17.10	17.20	17.30	17.40	17.50	17.60	17.70	17.80	17.90	17
18	18.00	18.10	18.20	18.30	18.40	18.50	18.60	18.70	18.80	18.90	18
19	19.00	19.10	19.20	19.30	19.40	19.50	19.60	19.70	19.80	19.90	19
20	20.00	20.10	20.20	20.30	20.40	20.50	20.60	20.70	20.80	20.90	20
21	21.00	21.10	21.20	21.30	21.40	21.50	21.60	21.70	21.80	21.90	21
22	22.00	22.10	22.20	22.30	22.40	22.50	22.60	22.70	22.80	22.90	22
23	23.00	23.10	23.20	23.30	23.40	23.50	23.60	23.70	23.80	23.90	23
24	24.00	24.10	24.20	24.30	24.40	24.50	24.60	24.70	24.80	24.90	24
25	25.00	25.10	25.20	25.30	25.40	25.50	25.60	25.70	25.80	25.90	25
26	26.00	26.10	26.20	26.30	26.40	26.50	26.60	26.70	26.80	26.90	26
27	27.00	27.10	27.20	27.30	27.40	27.50	27.60	27.70	27.80	27.90	27
28	28.00	28.10	28.20	28.30	28.40	28.50	28.60	28.70	28.80	28.90	28
29	29.00	29.10	29.20	29.30	29.40	29.50	29.60	29.70	29.80	29.90	29
30	30.00	30.10	30.20	30.30	30.40	30.50	30.60	30.70	30.80	30.90	30
31	31.00	31.10	31.20	31.30	31.40	31.50	31.60	31.70	31.80	31.90	31
32	32.00	32.10	32.20	32.30	32.40	32.50	32.60	32.70	32.80	32.90	32
33	33.00	33.10	33.20	33.30	33.40	33.50	33.60	33.70	33.80	33.90	33
34	34.00	34.10	34.20	34.30	34.40	34.50	34.60	34.70	34.80	34.90	34
35	35.00	35.10	35.20	35.30	35.40	35.50	35.60	35.70	35.80	35.90	35
36	36.00	36.10	36.20	36.30	36.40	36.50	36.60	36.70	36.80	36.90	36
37	37.00	37.10	37.20	37.30	37.40	37.50	37.60	37.70	37.80	37.90	37
38	38.00	38.10	38.20	38.30	38.40	38.50	38.60	38.70	38.80	38.90	38
39	39.00	39.10	39.20	39.30	39.40	39.50	39.60	39.70	39.80	39.90	39
40	40.00	40.10	40.20	40.30	40.40	40.50	40.60	40.70	40.80	40.90	40
41	41.00	41.10	41.20	41.30	41.40	41.50	41.60	41.70	41.80	41.90	41
42	42.00	42.10	42.20	42.30	42.40	42.50	42.60	42.70	42.80	42.90	42
43	43.00	43.10	43.20	43.30	43.40	43.50	43.60	43.70	43.80	43.90	43
44	44.00	44.10	44.20	44.30	44.40	44.50	44.60	44.70	44.80	44.90	44
45	45.00	45.10	45.20	45.30	45.40	45.50	45.60	45.70	45.80	45.90	45
46	46.00	46.10	46.20	46.30	46.40	46.50	46.60	46.70	46.80	46.90	46
47	47.00	47.10	47.20	47.30	47.40	47.50	47.60	47.70	47.80	47.90	47
48	48.00	48.10	48.20	48.30	48.40	48.50	48.60	48.70	48.80	48.90	48
49	49.00	49.10	49.20	49.30	49.40	49.50	49.60	49.70	49.80	49.90	49
50	50.00	50.10	50.20	50.30	50.40	50.50	50.60	50.70	50.80	50.90	50

Distance of slope stake from side or shoulder stake for any width roadway, slope 1 to 1. If ground is nearly level, the cut or fill at side stake is located by the double entry method in left column and top row. The number in body of table in same row and column gives distance from side stake to slope stake. If ground is not level estimate the difference in elevation between the side stake and slope stake, lower target by this amount if cut, elevate if fill. Add this amount to cut or fill and find distance in table. Set up rod at this point, and line of sight should cut target. If it does not make the slight adjustment necessary.

PAGES

INDEX

DATE

1-18 X-SEC. FOR IMPROVEMENTS ALLEY BLK 2 MTNVIEW 3-8-54

54

X-SECT. ALLEY BLK #3 - ROLANDO #1

T.A. Stamper ①  
3-8-54

CROSS SECTION ALLEY BLK 2 MTN. VIEW  
& ALLEY BLK 15 FAIRMOUNT ADDITION FOR  
IMPROVEMENTS W.O. 31716

INDEXED  
*Law*  
MAR 9 1954

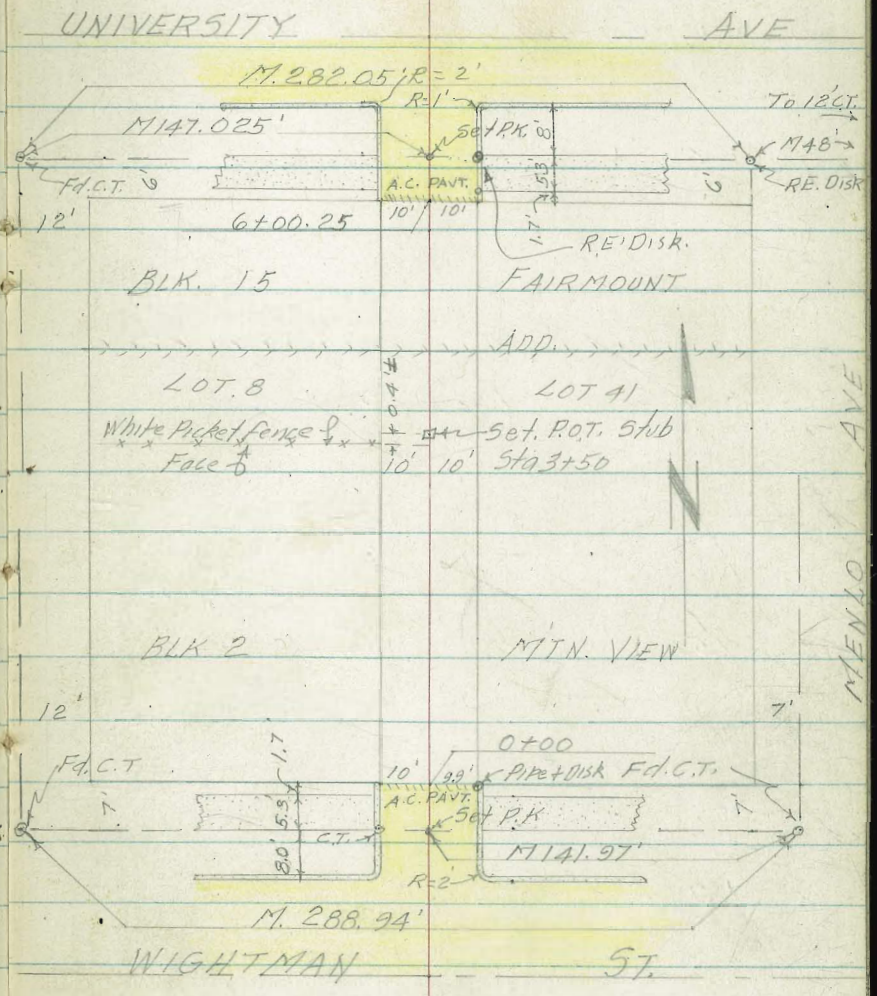

CROSS SECTIONS ALLEY BLK. 2 MTN. VIEW;  
BLK. 15, FAIRMOUNT ADDITION W.O. 31716

Lt. 3-8-54

REDUCED- HAGLUND  
3/12/54

Rt. Stamper  
Huffman  
Nordahl  
Sherry

0+00 N/4 Line Wightman St.

343.5	343.40	343.01	342.66	343.03	343.31	343.6
5.8	5.92	6.25	6.66	6.29	6.01	5.7
25	10°	10°	0	9.2	9.2	25
	cb	G		G	cb	

0-13 E.C. Curb Returns

343.10	342.45	342.41	342.46	343.11
6.22	6.84	6.81	6.86	6.21
9.2	9.2	0	9.2	9.2
cb	G		G	cb

0-15 N/4 Curbline Wightman

343.09	342.48	342.08	342.45	342.43	342.42	342.42	342.40	343.07	342.23	342.95
6.23	6.84	6.24	6.87	6.89	6.90	6.90	6.92	6.25	6.99	6.37
25	25	12	12	10	0	10	12	12	25	25
cb	G	cb	G				G	cb	G	cb
		BL	BL				BL	BL		

0-40 & Wightman

342.86	342.71	342.66	342.64	342.53	342.46	342.41
6.46	6.55	6.66	6.68	6.79	6.86	6.91
75	50	25	0	25	50	75

T.P. + 6.07 349.32 7.98 343.25  
TBM - 7.66 343.57  
+ 3.30 351.23

Tap T' C.T. W. Side Alley Blk 2 Mtn View  
NET 12' C.T. 46-th & Wightman Side Shot.  
349.32

B.M. 347.93

N.W. B.P. Wightman & Chaucer

X-SEC'S - ALLEY BLK 2 & 15

Lt.  
W

±

Rt.  
E

(3)

3-8-54

0+84-10<sup>3</sup> Lt. End Conc Slab Bldg floor

346.16      345.7  
3.6      3.6  
10<sup>3</sup>      10<sup>3</sup>  
Top Conc floor      Ground

0+76-9<sup>5</sup> Lt. & PPN<sup>o</sup> PA 3811

346.20      345.5  
3.12      3.8  
10<sup>1</sup>      10<sup>1</sup>  
Top Plan floor      Ground

0+74<sup>5</sup> 10<sup>1</sup> Lt. Begin Conc floor Bldg

0+50

345.3      345.1      345.1      344.8      344.9      344.9      345.7  
4.0      4.2      4.2      4.5      4.4      4.4      3.6  
25      10      7      6      0      10      25

0+10

344.4      343.9      343.9      343.5      343.6      343.1      344.9      345.1  
4.9      5.4      5.4      5.8      5.7      5.2      4.4      4.2  
25      10      8      7      0      10      11      25

349.32

ALLEY 2 of 15

4. 4 Rt. 3-8-54 (4)

1+07-13<sup>0</sup> Rt & 5.0 opening 2-Car Gar 8' wide  
(Dirt floor)

347.3  
6.4  
13<sup>0</sup>  
Dirt floor

1+03<sup>5</sup> 9<sup>0</sup> Lt Begin 4' Conc. Walk Parallel

347.05  
346.90  
6.65 6.80  
13<sup>0</sup> 9<sup>0</sup>  
Conc. Conc.  
@ Blk

1+02-11<sup>5</sup> Lt & 2.5 Conc Walk

346.70 346.08  
7.00 7.02  
215 113  
on walk

+7.20 353.70  
Set P.K. E. Side RR NE PA-3811  
TP Sta 0+76 -2.82 346.50

345.9  
346.5  
346.6  
346.2  
346.2  
346.4  
346.6  
346.6  
353.70

1+00- 14.8" Conc Walk

3.4 2.8 2.7 3.1 3.1 2.9 2.7 2.7  
25 10 7 6 0 7 10 25

349.32

ALLEY 2 & 15

1+51-9<sup>2</sup> Lt. Begin frame Bldg Storage Shed

1+50<sup>5</sup> 10<sup>2</sup> Rt. End 4' Picket fence

1+50

1+41<sup>5</sup> 9<sup>1</sup> Lt. End 4' Conc. Parallel Walk & Nly  
Edge 2<sup>5</sup> Lateral Conc Walk

1+33<sup>5</sup> 9<sup>1</sup> Lt. & Simp Car Gar. (check)

1+22<sup>3</sup> 10<sup>0</sup> Rt. Begin 4' Picket fence

1+20 & Sewer M.H. Buried

1+18-13<sup>5</sup> Rt. & 8' Wide - N. Openog 2-Car Gar  
(Dirt Floor)

Lt.

±

Rt.

(5)

3-8-54

348.6

5.1

92

Floor  
level  
(Dirt)

347.7

348.2

348.4

348.8

349.2

348.8

6.0

5.5

25

10

5.3

4.9

4.5

4.9

7

10

25

347.61

6.09

192

Nly Edge  
Walk

6.01

92

Top Walk

347.79

5.91

137

floor

347.57

6.13

97

Apron

346.88

6.82

0

Top Walk

6.6

0

Ground

347.1

347.4

6.3

135

Dirt floor

353.70



ALLEY 2 & 15

Lt.

±

Rt

①

3-8-54

349.40

349.47

1+89-10<sup>5</sup> Lt. ± 2' Conc walk

4.30

4.23

202

105

on walk

± walk

1+65<sup>3</sup> 9<sup>8</sup> Lt. Beam 4' Picket fence

1+65<sup>3</sup> 9<sup>8</sup> Lt. End frame Bldg Lt.

350.60

✓ 1+57-15<sup>1</sup> Rt. floor 4-Car Gar.

3.10

15-

Conc floor

1+55<sup>5</sup> 10<sup>1</sup> Rt. Begin Conc Apron 4-Car

349.87

3.83

10-

Apron

1+53-10<sup>1</sup> Rt. ± 5' Conc walk

349.82

349.83

3.88

10-

Top walk

3.87

20-

on walk

⌈ 353.10

ALLEY 2415

+ 6.01 357.39  
Set P.K. EN Side P.P.N. JPA 3829  
T.P. Sta 2+00-8<sup>1</sup>/<sub>4</sub> -2.32 351.38

2+00-8<sup>1</sup>/<sub>4</sub> P.P.N. JPA 3829

2+00-10<sup>5</sup>/<sub>8</sub> Lt. End 4' Picket fence

1+99-10<sup>1</sup>/<sub>2</sub> Rt. 3' Corral Wn/R

1+97<sup>5</sup>/<sub>8</sub> 10<sup>1</sup>/<sub>2</sub> Rt. End Corral Apron & Corral

1+96-15<sup>0</sup>/<sub>8</sub> Rt. End floor level of Corral

Lt. E Rt. ⑦

3-8-59

349.8	350.6	350.3	350.2	350.5	350.8	351.4
3.2	3.1	3.4	3.5	3.2	2.9	2.3
25	10	8	7	0	10	25

350.60	350.50
3.10	3.20
10 <sup>1</sup> / <sub>2</sub>	20 <sup>1</sup> / <sub>2</sub>
Corral	on walk

350.62
3.08
10 <sup>1</sup> / <sub>2</sub>
Corral Apron

350.63
3.07
15 <sup>0</sup> / <sub>8</sub>
Corral floor

△ 353.70

ALLEY 2 & 15

✓ 2+37-15<sup>3</sup> Rt. & N. Opening 2-Car Gar

✓ 2+36-11<sup>0</sup> Lt. & S. Opening 2-Car Gar

✓ 2+25<sup>3</sup>-15<sup>2</sup> Rt. & S. Opening 2-Car Gar

✓ 2+22<sup>5</sup>-11<sup>3</sup> Lt. & 2' Conc Walk

✓ 2+05<sup>5</sup>-10<sup>4</sup> Lt. & Sing Gar

Lt. & Rt.

3-8-54

8

352.09

5.30  
15<sup>3</sup>  
Conc. floor

351.79

5.60  
11<sup>2</sup>  
Conc floor

352.09

5.30  
15<sup>2</sup>  
Conc. floor

351.03

6.36  
~~315~~  
on walk

351.09

6.30  
11<sup>5</sup>  
+ walk

351.16

6.23  
11<sup>4</sup>  
Conc floor

351.39

ALLEY 2415

- ✓ 2+99- 9° Rt. End frame Shed
- ✓ 2+99- 8° Lt. & pp. N<sup>o</sup> D-30907-T
- 2+93- 15<sup>s</sup> N. & Sing Gar Dirt floor ✓
- ✓ 2+89- 8° Rt. End 4 Board fence
- 2+89- 8° Rt. Begm frame Shed
- 2+75- 9° Rt. < Pt. 4' High Board fence
- ✓ 2+53<sup>s</sup> 14<sup>s</sup> Lt. & 4' Conc Walk

Lt.                      Rt.  
3-8-54

352.00

5.9  
15<sup>s</sup>  
Dirt floor

351.83

352.00

5.56      5.39  
246      146  
concrete walk      concrete walk

2+50

352.1	351.9	351.7	351.7	351.7	352.0	352.0	351.8
5.3	5.5	5.7	5.7	5.7	5.4	5.4	5.6
25	10	17	0	6	7	10	25

351.77

- ✓ 2+45- 11° Lt. & N. opening 2-Car Gar

5.62  
11<sup>s</sup>  
Conc floor

351.39

ALLEY 2 & 15

1 3+95-10<sup>1</sup> Rt. End Conc Apron 4-Car Gar

1 3+05-10<sup>2</sup> Rt. <sup>Conc</sup> Apron 4-Car Gar

3+01<sup>5</sup> 10<sup>2</sup> Rt. & 4' Conc Walk

3+00

Lt.

C

Rt.

3-8-54

(10)

352.23

352.48

5.16 4.91  
10 15  
Apron floor

352.24

352.55

5.15 4.84  
10 15  
Apron floor

352.25

352.31

5.14 5.08  
10 20  
twalk onwalk

352.1

351.9

352.4

352.4

352.2

352.1

5.3 5.5 5.0 5.0 5.2 5.3  
25 10 8 0 10 25

357.39

ALLEY 2415

Lt. & Rt.

3-8-54

(1)

3+53- 14° Rt. Begin floor level 4' on Grad

352.62

4.77  
14.8  
conc floor

3+52- 10° Rt. Begin Conc Apron 4' on Grad

352.10

5.29  
10°  
Apron

3+50- 10° Lt. Begin 4' Board fence

351.5

351.6

352.0

352.1

352.21

352.19

5.9	38	54	5.3	5.18	5.20
25	10	8	0	10°	20°
				on cont. walk	on cont.

3+49- 10° Rt. & 6' Conc Walk

352.25

5.14  
10°  
walk

352.19

5.20  
20°  
walk

351.39

ALLEY 2 & 13

3+99-10<sup>2</sup> Lt. Begin 5' latb fence

3+99-8<sup>6</sup> Lt. & PP, N<sup>o</sup> JPA-3863

3+99-9<sup>6</sup> Lt. End 4' Board fence

3+96<sup>3</sup> 10<sup>2</sup> Rt. & 4<sup>3</sup> Conc Walk

3+94-10<sup>2</sup> Rt. End Conc Apron & Low Crwl

3+93-14<sup>2</sup> Rt. End Conc floor level

Lt.                      €                      Rt.

3-8-54

(12)

351.64

351.57

5.75

5.82

10<sup>0</sup>

10<sup>0</sup>

& walk

con walk

351.70

3.69

10<sup>0</sup>

Apron

352.50

4.89

14<sup>2</sup>

Conc floor

357.39

ALLEY 2 of 15

✓ 4+42 - 15<sup>0</sup> Rt. & Sing Gar Conc floor

✓ 4+38<sup>5</sup> - 11<sup>0</sup> Lt. & S. Opening - 2 Car Gar

4+34 - 9<sup>0</sup> Lt. End 5' lath fence

✓ 4+10 - 15<sup>2</sup> Rt. & Sing Gar Conc floor

4+00

Lt. & Rt.

3-8-54

(13)

350.19

7.20  
15<sup>0</sup>  
Conc floor

349.71

7.68  
11<sup>0</sup>  
Conc floor

350.87

6.42  
15<sup>2</sup>  
Conc floor

350.8

350.9

351.4

351.4

351.2

351.3

351.3

350.9

6.6  
25

6.5  
11

6.0  
10

6.0  
8

6.2  
7

6.1  
0

6.1  
10

6.5  
25

357.39



Lt. E Rt.  
3-8-54

ALLEY 2 & 15

4+55 9<sup>3</sup> Lt. & Sing Gar Conc floor

349.29  
8.10  
9.3  
conc floor

4+51<sup>3</sup> 9<sup>B</sup> Begin Conc Apron 2-Car Gar

349.54  
348.74  
7.05 8.65  
9.0 2.2  
Conc Apron Conc @  
Bldg

4+51-9<sup>2</sup> Lt. Begin frame Garage Bldg

349.5 349.6 349.5 349.6 349.6 350.0 350.0  
7.9 7.8 7.9 7.8 7.8 7.4 7.4  
10 7 6 0 10 15 25  
@frame  
Bldg

4+50

4+46<sup>3</sup> 11<sup>2</sup> Lt. & N. Opening 2-Car Gar

349.7  
7.7  
11.2  
Dirt floor

357.39

ALLEY 2 & 15

4+99<sup>3</sup> 10<sup>1</sup> Rt. End Conc. Apron Slab 2-Car Gar

4+99 8<sup>7</sup> Lt. & PP. N<sup>o</sup> PA 3879

4+81<sup>5</sup> 9<sup>2</sup> Rt. & N. Opening 2-Car Gar

4+69- 15<sup>1</sup> Lt. & 2' Conc. Walk

4+67- 9<sup>2</sup> Lt. End frame Gar Bldg

4+66- 9<sup>2</sup> Rt. & S. Opening 2-Car Gar

+4.09 354.16  
Set P.R.E. side PPX<sup>2</sup> PA-3879

T.P. Sta 4+99 -7.32 350.07

357.39

Lt

&

Rt.

(15)

3-8-59

348.71

348.52

5.45 5.64  
101 201  
Conc Apron on Conc.

349.19

348.50

348.78

4.97 5.66 5.38  
92 20 21.8  
Apron Gut floor  
Drumme

349.41

349.04

4.75 5.12  
220 120  
on Walk & walk

349.30

348.60

348.75

4.86 5.56 5.41  
92 204 21.8  
Apron Gut Conc Floor  
Drumme

354.16

ALLEY 2 of 15

5+50

5+40 <sup>5</sup> 9<sup>2</sup> Lt. Begin Conc Block Bldg

5+00-10<sup>2</sup> Rt. Begin 8" Parallel Conc Ret Wall

5+00-10<sup>1</sup> Rt. N. Edge 8" Conc. Ret Wall

24 3-8-59 et. (16)

	350.0	349.2	349.2	348.9	347.9	349.02	347.06
	42	50	5.0	5.3	6.3	5.4	7.1
	10	8	0	8	10 <sup>2</sup>	10 <sup>0</sup>	11
	@ Bldg				Ground Top	Ground	Ground
					@ Conc Wall	Wall	bk. Wall
	348.56	349.86		348.6			
	5.60	4.30		7.6			
	9 <sup>2</sup>	9 <sup>2</sup>		2.5			
	fig.	Floor Level					
		Side Entrance					

	348.8	349.71	347.3
	54	4.45	6.9
	10 <sup>2</sup>	10 <sup>2</sup>	11 <sup>2</sup>
	Top Wall	Ground	Ground
	Ground	behind	Wall
	front		
	Wall		
	349.1	348.78	347.3
	349.4		347.3
	5.1	4.8	4.9
	25	10	0
			5.38
			10 <sup>2</sup>
			Top lat
			conc wall
			6.9
			10 <sup>1</sup>
			fig.
			6.9
			20

354.16

AILEY 2415

6+15.25 E.C. Curb Returns

347.38	346.93	346.99	346.57	346.51	346.19	345.98	345.95	346.45	345.44	346.04
636	681	675	717	723	755	776	779	789	830	770
25°	25°	12°	12°	10°	0	10°	11°	11°	25°	25°
cb	G	cb	G			G	cb	G	cb	

6+14.25 BT

6+13.25 AB.C Curb Returns &

346.92	346.56	346.22	346.00	346.48
682	718	752	774	726
10°	10°	0	10°	10°
cb	G		G	cb

Edge A.C. Pavt. on top of Cong.

6+00.25 S1/4 P.L. University Ave

End 18" Conc Ret. Wall.

347.62	347.24	346.91	346.59	346.62	346.67	346.91
612	650	683	715	712	707	533
25	10°	10°	0	10°	10°	10°
cb	G		Gut	cb.	Top Wall.	
@ End						
Blk						

+ 7.14 353.74

TOP RE. DISK E. SIDE ALLEY

T.B.M. on 6' Line S1/4 Univ. Ave - 7.56

346.60

349.9	348.9	348.8	348.4	347.6	348.4	346.8	346.5
4.3	5.3	5.4	5.8	6.6	5.78	7.4	7.7
10	7	0	8	10°	10°	11	25
@ Blk				@ wall	Top Blk	Top Blk	Top Blk
					wall	wall	wall

5+75

353.74

354.16

Lt.

3-8-54

Rt.

(17)

Lt. 3-8-54

Rt.

(18)

ALLEY 2415

B.M.

B.M. -3.46 347.94 ~ -347.93 Starting Beach

+ 7.82 351.40

T.P. - 9.10 343.58 ~ -343.57 (see Pg. 2)

+ 1.39 352.68

B.M. - 2.45 351.29 ~ -351.23 N.W. B.P. 46-10 of University

6+40.25 - of University Ave

353.74

349.31	348.62	347.89	347.14	346.44	345.72	345.00
4.37	5.12	5.85	6.60	7.30	8.02	8.74
75	50	25	0	25	50	75

353.74

INDEXED  
SER  
AUG 23 1954

Note: Please look up openings and  
R.O.W. on 40th A. Sisson's notes FB 1616-11  
call 66' R.O.W. while File Map # 2522 shows  
50' R.O.W.

Map & street book shows 50' street; also  
Opening # 4-88 G.W. Reynolds  
shift  $\frac{1}{2}$  of street 5' toward  
the east.

Note  $\frac{1}{2}$  of 40th St. was realigned 5' Ely  
lateral distances adjusted accordingly - Notes  
reduced - G.W. Reynolds  
10-29-54

D. Smith  
R. Taylor  
B. Fish

WO# 32473 (19)  
8-19-54

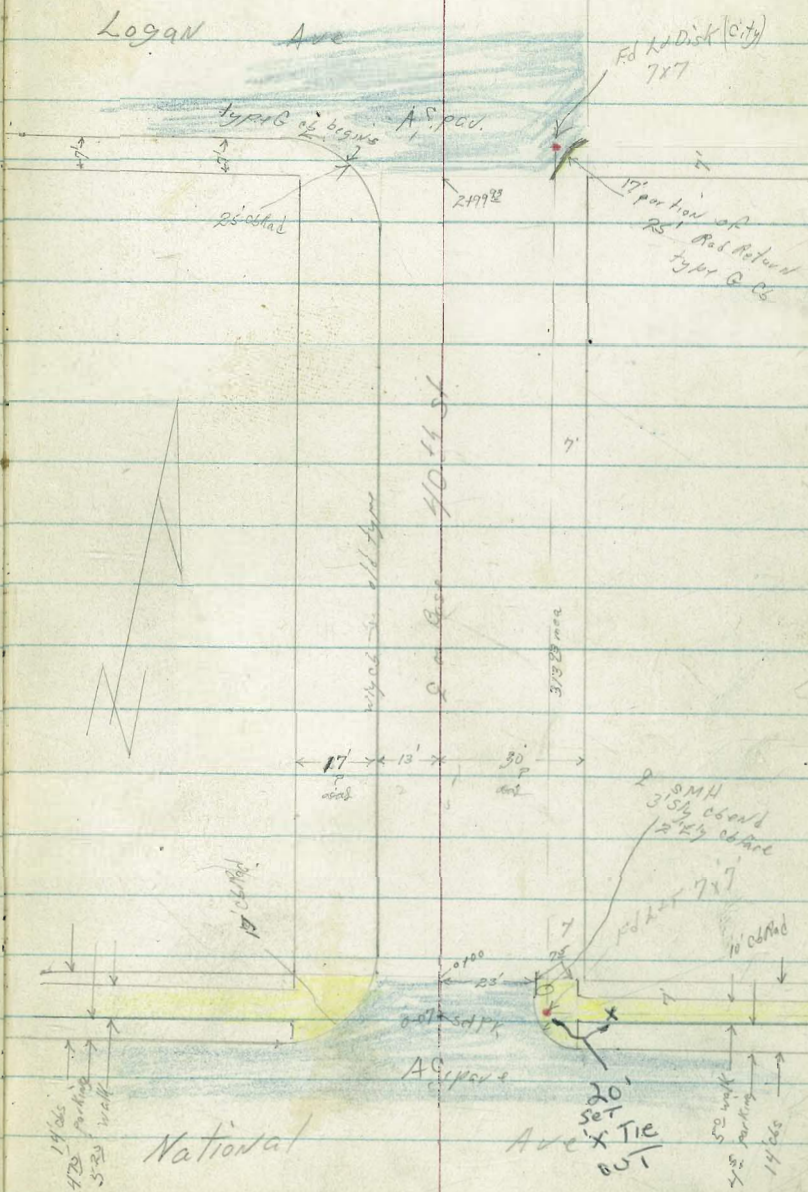

0475

0450

0425

0421 28° N E deadman

0402 13° Lt C6 B9

0402 29° N E 12" Pol. <sup>4</sup> J P 999

0400 Nly National Ave edge AC pav.

Mid Pt Returns

0-14 Nly of Lind National Ave

BM

485

70 25

65 40

SW fire Hyd.  
40th National

Lt. Wly

2

PT = Fly

(20)

673	657	658	647	650	648	643	648	657
30	46	497	56	53	55	60	55	51
30	26	13	13	10	17	32	30	
35	25	18	18	5	5	112	17	22

673	656	659	646	646	642	638	645	643
30	42	506	52	52	52	65	58	60
30	20	13	13	10	17	33	30	
35	25	18	18	5	5	12	18	25

667	653	651	641	642	638	632	639	644
30	50	514	62	61	65	71	64	59
30	22	15	15	10	20	22	20	
35	27	18	18	5	5	15	17	25

650	645
520	58
130	130
20	50
190	180

651	6500	6440	6386	6312	6257	6212	6200
474	520	580	39	713	768	713	700
276	132	132	10	20	20	20	272
414	0	50	5	15	15	15	227
326	182	182	5	5	5	5	

6491	6421	6261	6299
534	600	724	726
06	90	947	06

642	6394	638	6443	6362	6227	6193	6258	6231	6305	6001	6010
383	431	50	582	643	698	732	767	784	720	1024	952
30	80	20	20	13	10	20	20	20	20	20	20
20	20	20	20	13	10	20	20	20	20	20	20
20	20	20	20	13	10	20	20	20	20	20	20
20	20	20	20	13	10	20	20	20	20	20	20
20	20	20	20	13	10	20	20	20	20	20	20

70 25

2100 15<sup>5</sup>LT & SMH.

1775

TP 6<sup>62</sup> 7<sup>259</sup> 4<sup>28</sup> 6<sup>592</sup>

1759 13<sup>2</sup>LT & 11' drive

1750 18<sup>2</sup>LT & 10" PP<sub>1/2</sub> J P 930

1749 22<sup>5</sup>RT & SMH

1739 29<sup>5</sup>RT & 10" PP<sub>1/2</sub> & gone

1726

1709 13<sup>2</sup>LT & 12<sup>2</sup> drive

1700

LT = Wly

Q  
at  
East

RT = Fly

21

66.4	66.3	66.44	66.35	65.8	66.2	66.2	66.0	66.4	66.2
63	63	65	62	68	64	64	66	62	64
30	30	rim	cs	23	20	17	22	30	
35	25	20.5	18	18	5	5	12	17	25

66.3	65.9	66.11	65.5	66.0	65.9	65.7	66.0	65.9
63	62	64	72	66	62	62	66	62
36	30	23	13	10	10	17	22	30
35	25	18	18	5	5	12	17	25

72.59

66.25	66.15	65.51							
40	40	47							
36	4	12							
35	21	18							
66.1	66.0	65.95	65.3	65.7	65.7	65.4	65.3	65.5	65.5
42	43	42	50	46	46	42	50	58	50
30	30	23	23	10	17	20	30	30	30
35	25	18	18	5	5	12	15	25	25

65.45  
4.00  
32.5  
11M  
17.5

66.1	65.8	65.65	65.4	65.4	65.4	65.0	65.3	65.6
42	45	40	51	42	42	53	50	42
30	30	22	24	10	17	20	30	30
35	35	25	18	5	5	12	15	25

66.25  
32.0  
30

66.8	65.7	65.52	65.0	65.7	65.1	64.7	65.2	65.3
35	45	42	53	51	52	56	51	50
20	20	15	13	10	17	20	30	30
35	25	18	18	5	5	12	14	25

70.25



BM, starting 1920

7<sup>20</sup>

65<sup>39</sup> 70<sup>01</sup>

Lt. Wly

Case

Rt. Fly

22

3415 Rt to end Nly part cb Ret.

6797	6785	6780	6778	6770	6745	6762	6809
462	474	479	481	489	514	492	450
30	20	13		10	19	26	30
35	25	18	5	5	14	25	25

3406<sup>23</sup> Sly cb Live Logan to Wly

6806	6851	6798	6754	6752	6768	6774	6739	6745	6794	
353	408	441	505	502	494	491	485	520	514	465
28	28	28	28	36	13		10	212	242	242
28	28	28	28	36	13		10	212	242	242
93	93	43	43	35	18	5	5	16	19	19

3405 29<sup>4</sup> Rt E 12" P.P. 1. # 2903

2499<sup>23</sup> Sly Logan Ave edge A<sup>c</sup> par  
Sly cb end part Return Rt.

6777	6766	6778	6749	6758	6763	6766	6786	681
42	42	54	50	50	42	53	42	45
30	22	22	13		10	23	23	30
25	27	22	18	5	5	18	18	25

2480 B.C. Return Lt

679	677	6735	668	673	673	673	681
42	42	52	58	53	53	53	45
30	20	13	13		10	20	30
35	25	18	18	5	5	15	25

2467 29<sup>3</sup> Rt E dead road

2456 13<sup>c</sup> Lt E 14' drive

6727	6720	6650						
532	533	609						
28	18	13						
Pool	4ir							
33	23	18						
6727	671	6699	661	668	669	667	673	679
54	55	56	61	58	52	59	53	42
30	20	13	13		10	17	22	30
35	25	18	18	5	5	12	17	25

2450

2449 29<sup>c</sup> Rt E 6" P.P. 1. # 5196274

2439 30<sup>c</sup> Rt E single garage cov floor 1920

669	667	6613	661	665	666	663	670	673	6767
52	58	58	65	64	60	63	54	53	492
20	20	13	13		10	10	23	30	30
25	25	18	18	5	5	13	18	25	28.4

2425

7.7252

INDEXED  
 MER  
 FEB 22 1955

CROSS SECTION GILMORE ST. FROM  
 36-TH TO 37-TH; SOUTHLOOK AVE FROM  
 OLIVEWOOD TERRACE TO GILMORE ST.;  
 OLIVEWOOD TERRACE FROM OCEAN  
 VIEW BLVD TO GILMORE ST. FOR  
 IMPROVEMENTS W.O. 31836

Ref. Tie Points Book N° 12

Ref. Map N° 1555

Improvement Plan 1999-L

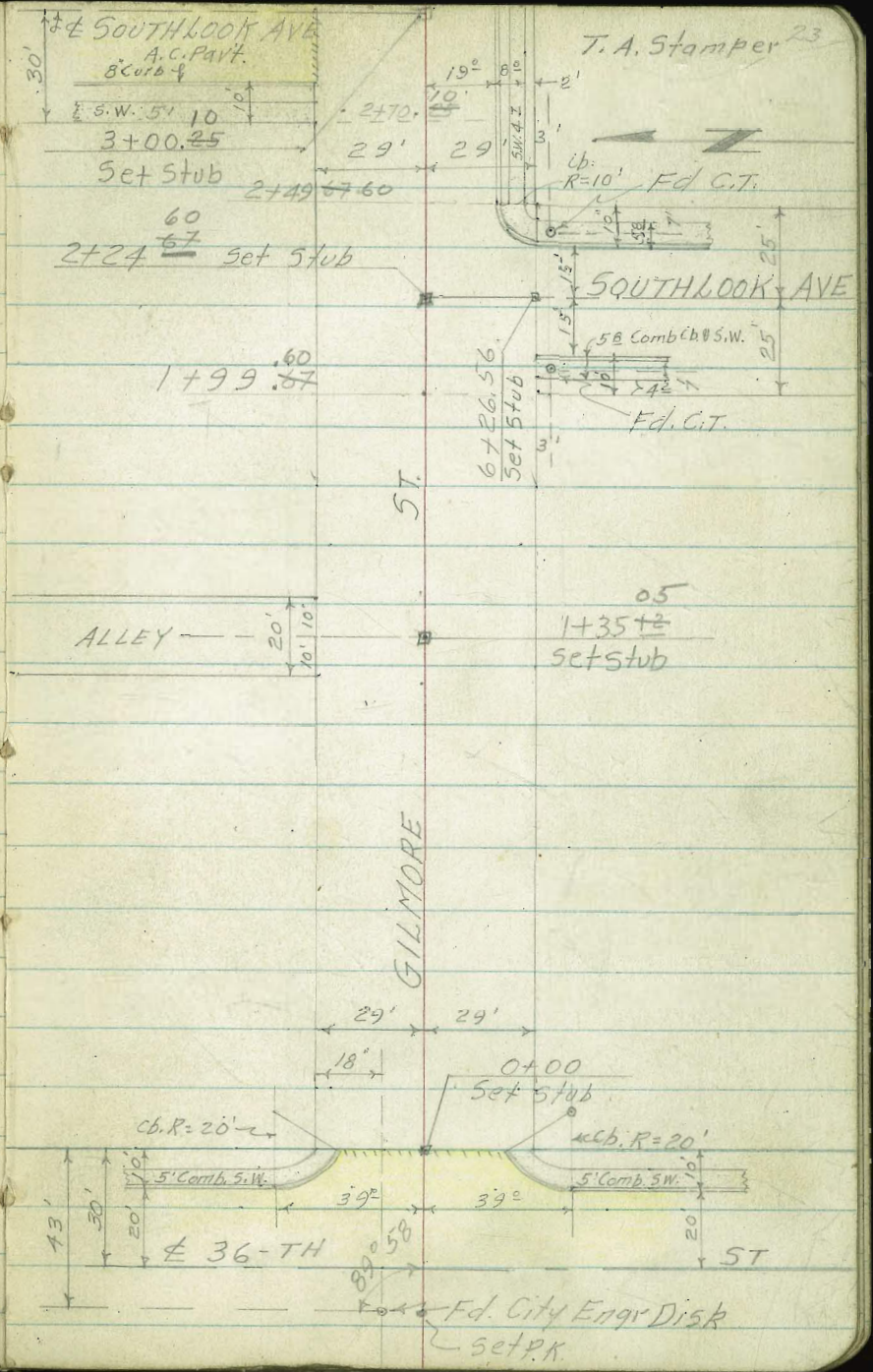

BASELINE SKETCH GILMORE ST.

INSERT & DETAILS  
OF CURB INLET @ NW  
COR. OCEAN VIEW & OLIVEWOOD  
TERRACE

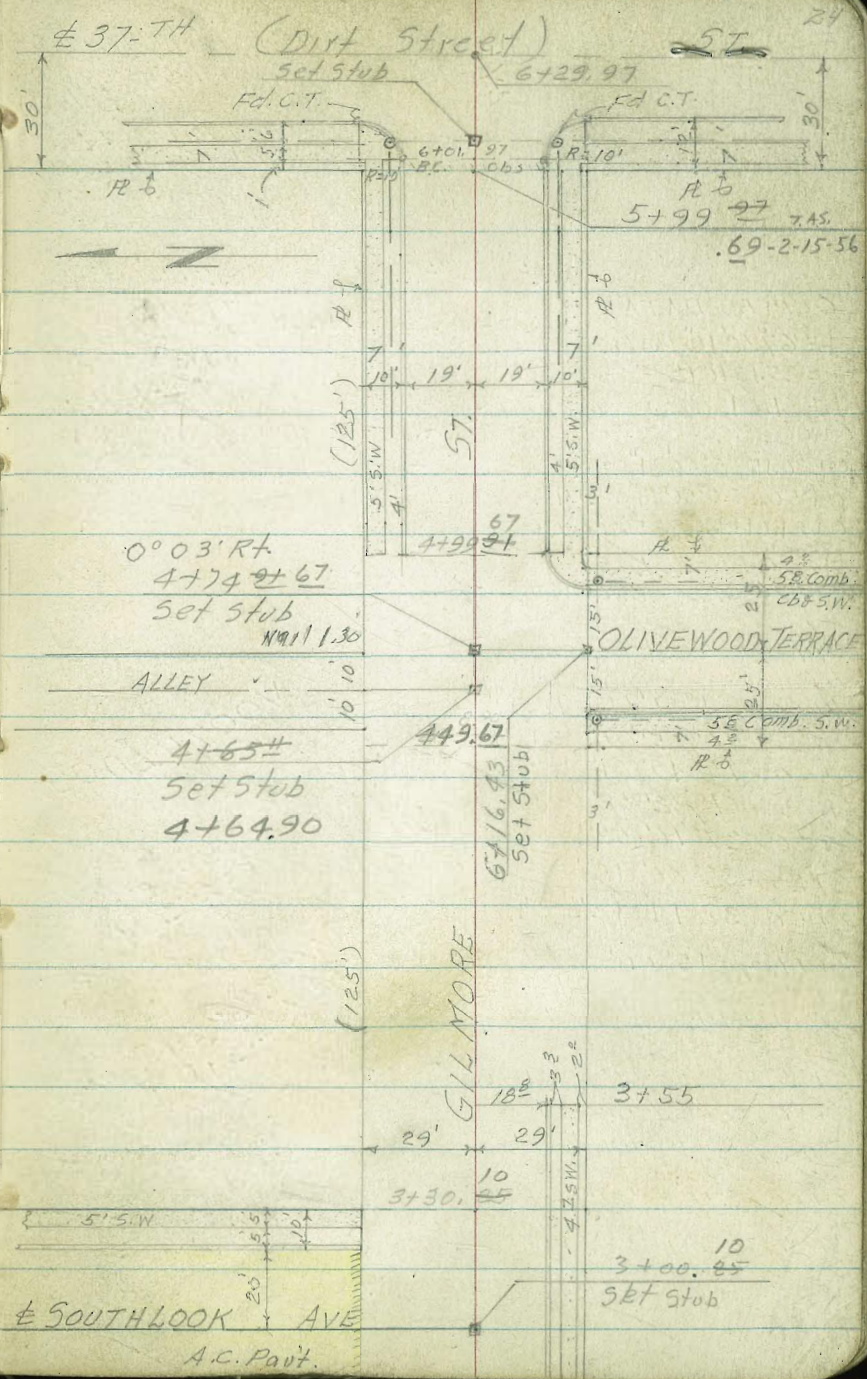
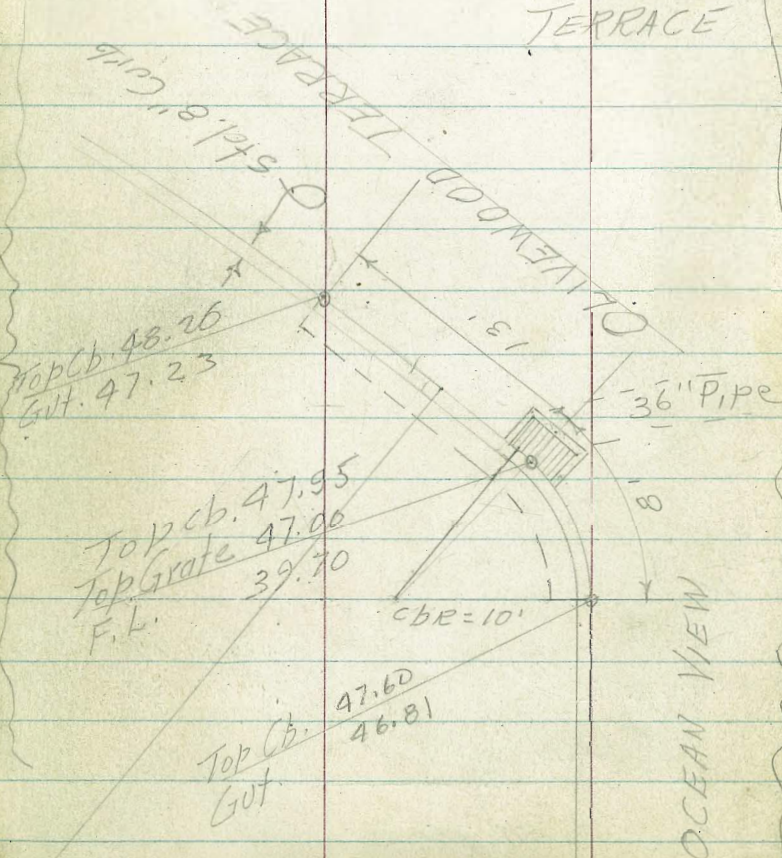

Top Cb. 48.26  
Gut. 47.23

Top Cb. 47.95  
Top Grate 47.00  
F.L. 39.70

Top Cb. 47.60  
Gut. 46.81

4774#  
Set stub  
NW 11.30

4765#  
Set stub  
4764.90

449.67  
Set stub  
6716.43

3755

3730.45

3400.85  
Set stub

KTE 377

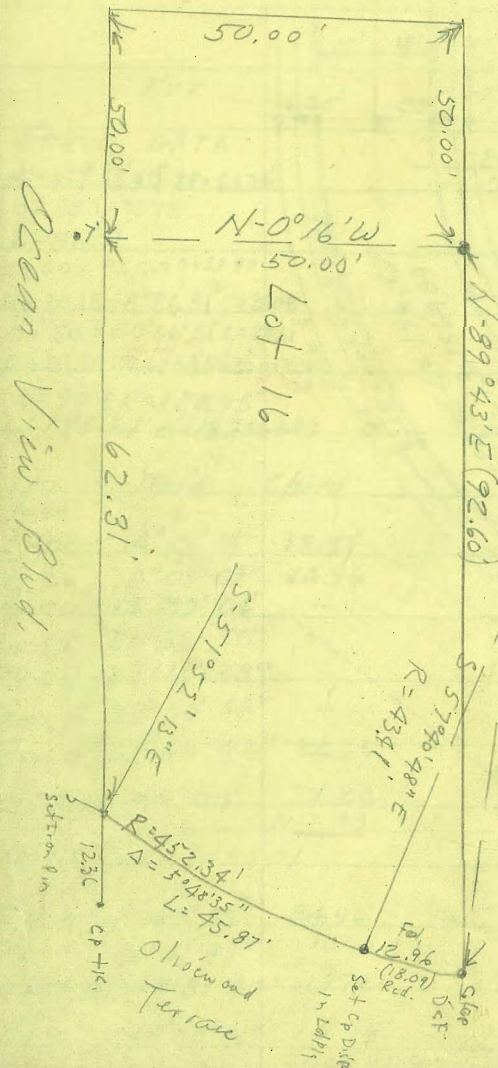

Copped  
 2/16/55 from Phd  
 Surveyed Jan 10<sup>th</sup> 1958  
 Daniel Allen RE #913

slightly Radius  
 .95 as shown  
 Sheet should  
 creased to  
 s Per Rec. Map  
 computed chords  
 too short

9.95' TR 338  
 (red)  
 TE  
 should be 100.10  
 in Meas. Chord

NOTE: R should be  
 43.44  
 from Chord

NOTE:  
 See Pg 24 for cb inlet  
 @ N.W. Cor. Ocean View  
 & Gilmore Sts.

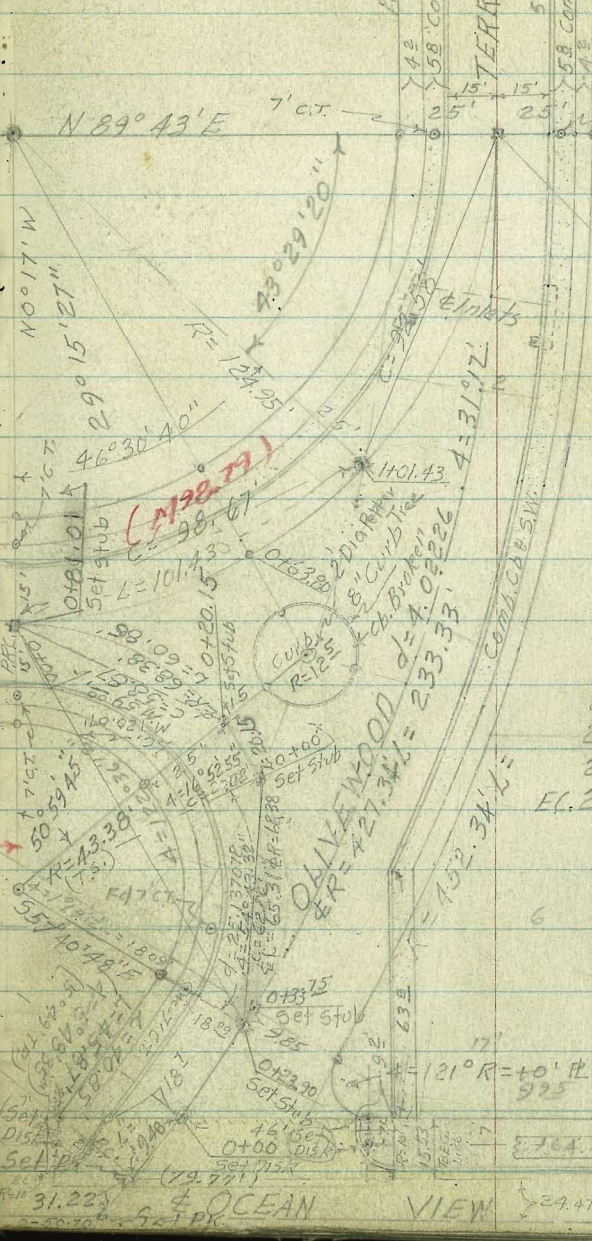

2+67.08  
 Set Stub

CURVE DATA  
 R=427.34  
 L=267.08  
 BC=0-19.48  
 Sta. Def 4  
 0+00 1°18'21"  
 0+23.90 2°54'29"  
 0+33.75 3°34'06"  
 0+50 4°39'28"  
 0+75 6°20'01"  
 1+00 8°00'35"  
 1+25 9°41'08"  
 1+50 11°21'42"  
 1+75 13°02'15"  
 2+00 14°42'48"  
 2+25 16°23'22"  
 2+50 18°03'55"  
 FL 2+67.08 19°12'36"

T.A. Stamper

N 89° 43' E  
 5' N  
 50  
 R 8913 Dist  
 A.C. Paul

OCEAN VIEW BLVD

T.A. Stamper

NOTE: See Pg 24 for cb inlet @ NW Cor. Ocean View & Gilmore Sts.

slightly Radius of 95' as shown on the street should be increased to 100' as per Rec. Map as computed chords are too short

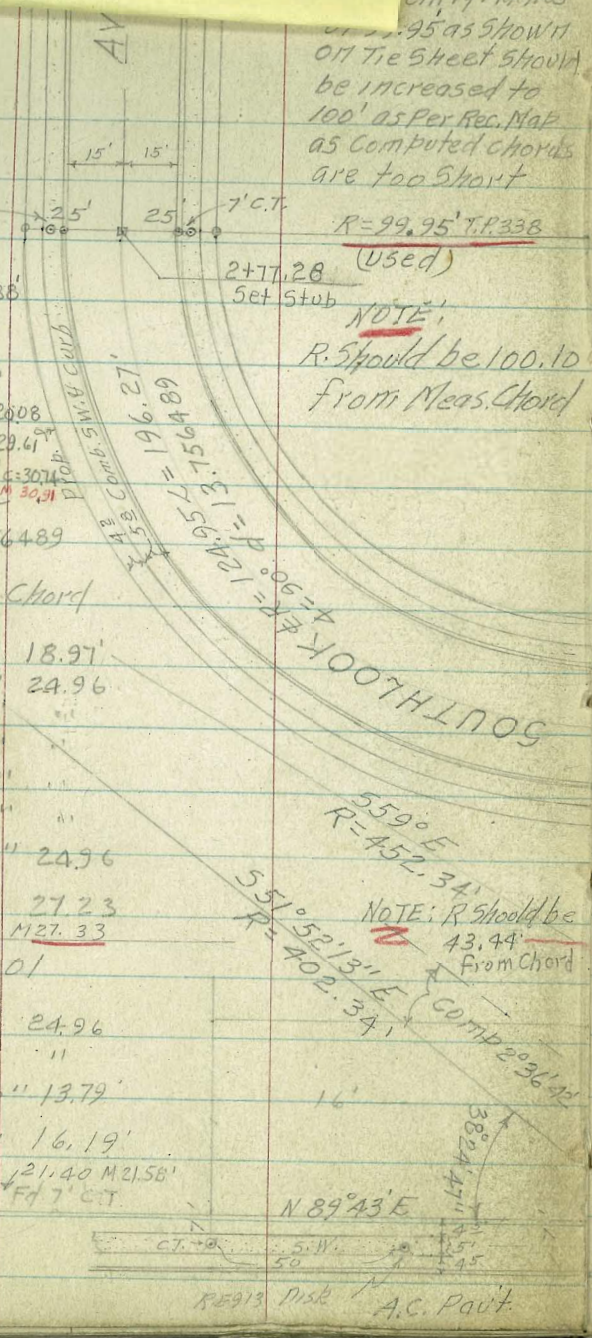

CURVE DATA

$\Delta = 167^{\circ} 52' 40''$   $\Delta R = 68.35'$   
 $d = 25.137072$   
 $L = 81.01$   
 $0+00 = P.C.C. = 0+23.90$   
 $0+20.15 = 8^{\circ} 26' 31''$   $C = 26.08$   
 $0+50 = 20^{\circ} 56' 51''$   $C = 29.64$   
 $0+81.01 P.R.C. = 33^{\circ} 56' 20''$   $C = 30.74$   
 $\Delta = 90^{\circ}$   $\Delta R = 124.95'$   
 $L = 196.27'$   $d = 13.756489$

Sta	Def $\Delta$	Chord
5+9		
18.99		
1+00	$4^{\circ} 21' 14''$	18.97'
1+25	$10^{\circ} 05' 09''$	24.96
1+50	$15^{\circ} 49' 04''$	
1+75	$21^{\circ} 32' 58''$	
2+00	$27^{\circ} 16' 53''$	
2+25	$33^{\circ} 00' 48''$	
2+50	$38^{\circ} 44' 42''$	24.96
2+77.28	$45^{\circ} 00'$	27.23
EC. 28		M 27.33
0+00	$E 14 = 0+81.01$	
0+25	$5^{\circ} 43' 55''$	24.96
0+50	$11^{\circ} 27' 49''$	"
0+63.80	$14^{\circ} 37' 40''$	13.79
16.20		
0+80	$18^{\circ} 20' 31''$	16.19'
P.C.C.		21.40 M 21.56'
1+01.43	$23^{\circ} 15' 20''$	F 7' C.T.

$R = 99.95'$  T.P. 338 (Used)

NOTE: R should be 100.10 from Meas. Chord

NOTE: R should be 43.44' from Chord

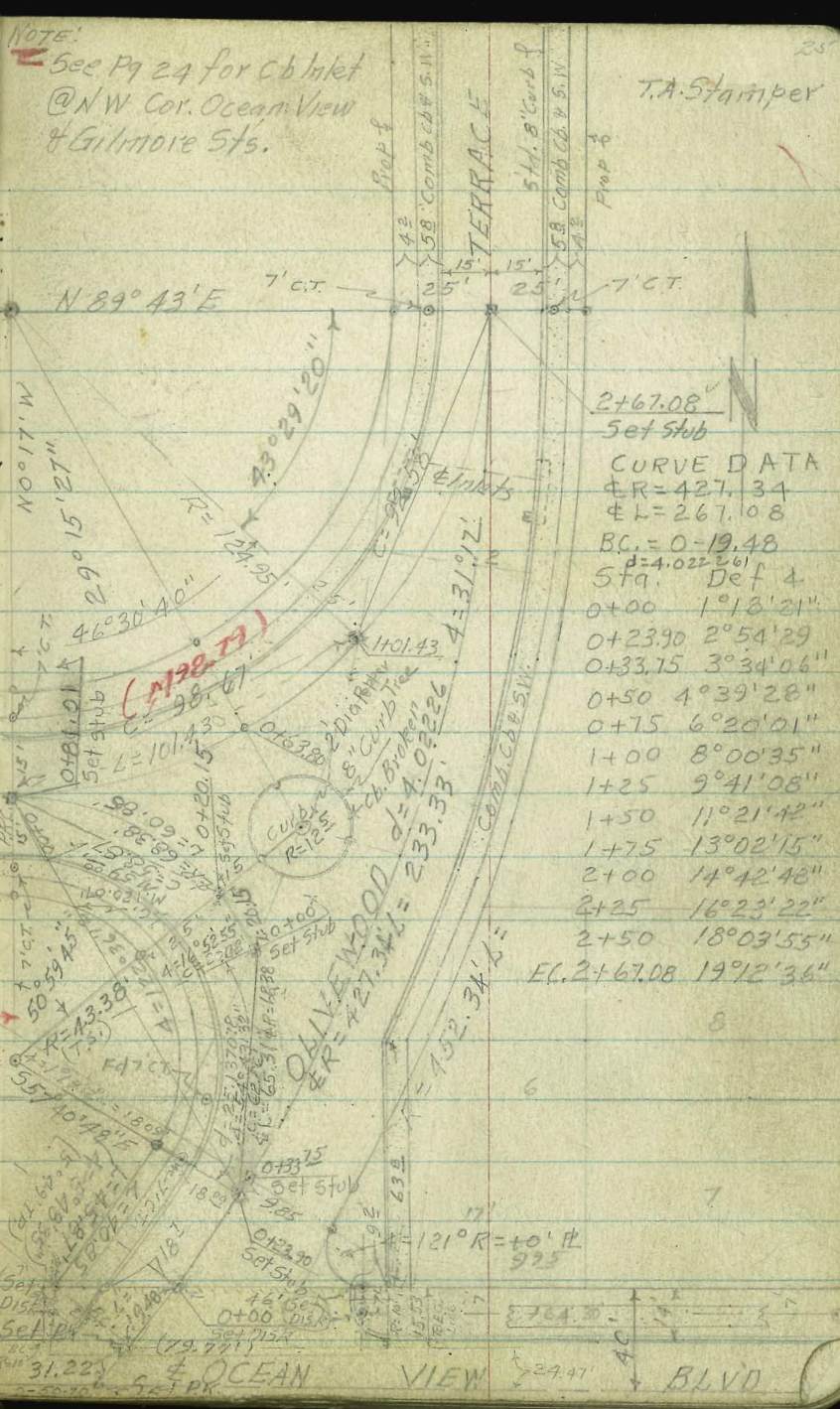

CURVE DATA

$\Delta R = 427.34$   
 $\Delta L = 267.08$   
 $BC = 0-19.48$   
 $d = 4.022261$  Def  $\Delta$   
 $0+00$   $1^{\circ} 18' 21''$   
 $0+23.90$   $2^{\circ} 54' 29''$   
 $0+33.75$   $3^{\circ} 34' 06''$   
 $0+50$   $4^{\circ} 39' 28''$   
 $0+75$   $6^{\circ} 20' 01''$   
 $1+00$   $8^{\circ} 00' 35''$   
 $1+25$   $9^{\circ} 41' 08''$   
 $1+50$   $11^{\circ} 21' 42''$   
 $2+00$   $14^{\circ} 42' 48''$   
 $2+25$   $16^{\circ} 23' 22''$   
 $2+50$   $18^{\circ} 03' 55''$   
 $FC. 2+67.08$   $19^{\circ} 12' 36''$

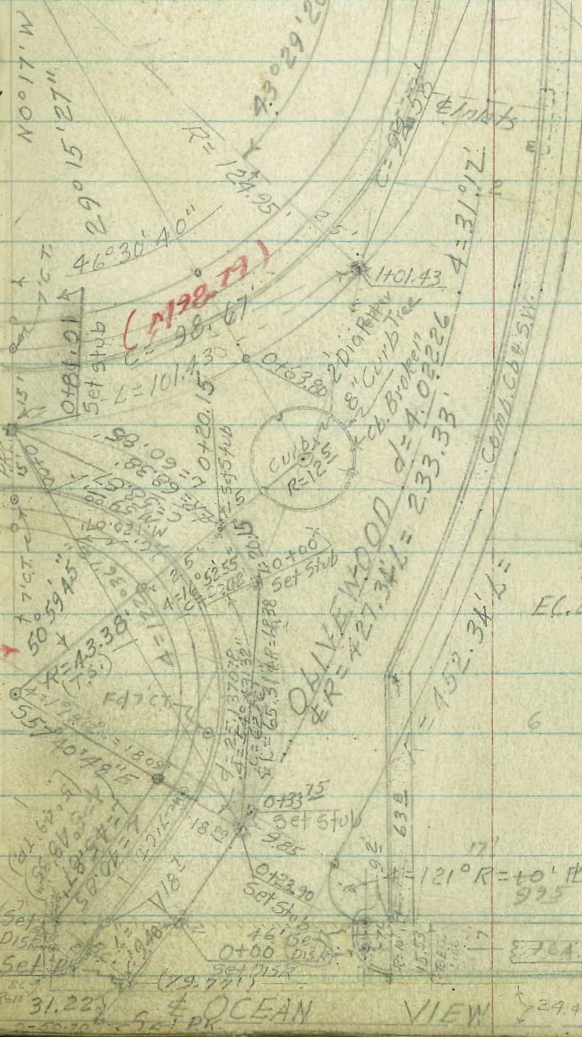

OCEAN VIEW BLVD

AVE

NOTE: Evidently Radius of 99.95 as shown on Tie Sheet should be increased to 100' as Per Rec. Map as Computed chords are too short

See Pg 24 for Cb Inlet @ NW Cor. Ocean View & Gilmore Sts.

T.A. Stamper

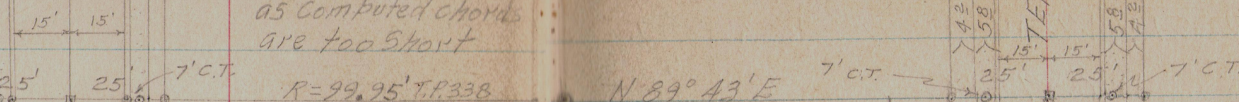

CURVE DATA

$\Delta = 167.52'40''$   $\Delta R = 68.38'$

$d = 25.137072$

$L = 81.01$

$0+00 = P.C.C. = 0+23.90$

$0+20.15 = 8^\circ 26' 31'' C = 20.08$

$0+50 = 20^\circ 56' 51'' C = 29.61$

$0+81.01 P.R.C. = 33^\circ 56' 20'' C = 30.74$

$\Delta = 90^\circ$   $\Delta R = 124.95'$

$L = 196.27'$   $d = 13.756489$

Sta Defl Chord

18.99 4° 21' 14" 18.97'

1+25 10° 05' 09" 24.96

1+50 15° 49' 04" 24.96

1+75 21° 32' 58" 24.96

2+00 27° 16' 53" 24.96

2+25 33° 00' 48" 24.96

2+50 38° 44' 42" 24.96

2+77.28 45° 00' 27.23

0+00 E14 = 0+81.01

0+25 = 5° 43' 55" 24.96

0+50 = 11° 27' 49" 24.96

0+63.80 = 14° 37' 40" 13.79

0+80 = 18° 20' 31" 16.19'

1+01.43 = 23° 15' 20" 21.40 M21.58'

1+01.43 = 23° 15' 20" 21.40 M21.58'

1+01.43 = 23° 15' 20" 21.40 M21.58'

1+01.43 = 23° 15' 20" 21.40 M21.58'

1+01.43 = 23° 15' 20" 21.40 M21.58'

1+01.43 = 23° 15' 20" 21.40 M21.58'

1+01.43 = 23° 15' 20" 21.40 M21.58'

1+01.43 = 23° 15' 20" 21.40 M21.58'

1+01.43 = 23° 15' 20" 21.40 M21.58'

1+01.43 = 23° 15' 20" 21.40 M21.58'

1+01.43 = 23° 15' 20" 21.40 M21.58'

1+01.43 = 23° 15' 20" 21.40 M21.58'

1+01.43 = 23° 15' 20" 21.40 M21.58'

$R = 99.95'$   $\Delta R = 338$

(Used)

NOTE: R should be 100.10'

from Meas. Chord

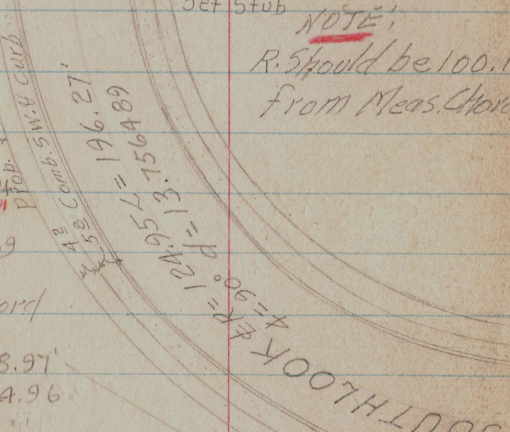

2+67.08 Set Stub

CURVE DATA

$\Delta R = 427.34$

$\Delta L = 267.108$

BC = 0-19.48

Sta Defl

0+00 1° 18' 21"

0+23.90 2° 54' 29"

0+33.75 3° 34' 06"

0+50 4° 39' 28"

0+75 6° 20' 01"

1+00 8° 00' 35"

1+25 9° 41' 08"

1+50 11° 21' 42"

1+75 13° 02' 15"

2+00 14° 42' 48"

2+25 16° 23' 22"

2+50 18° 03' 55"

EC 2+67.08 19° 12' 36"

NOTE: R should be 43.44'

from Chord

$R = 452.34'$

$R = 51.13'$   $\Delta R = 402.34'$

$R = 402.34'$

$R = 402.34'$

$R = 402.34'$

$R = 402.34'$

$R = 402.34'$

$R = 402.34'$

$R = 402.34'$

$R = 402.34'$

$R = 402.34'$

$R = 402.34'$

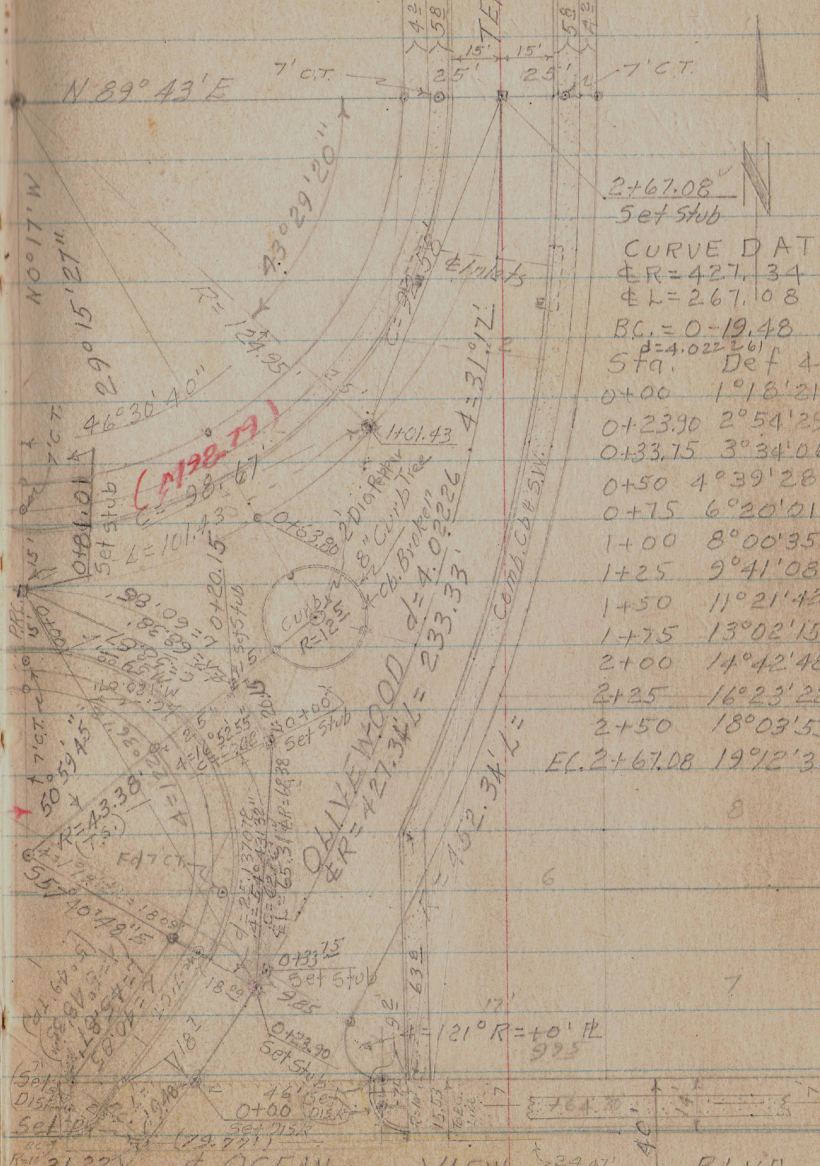

OCEAN VIEW BLVD

TERRACE

NOTES REDUCED  
2-25-55 - W.G.A.

2-21-55

Stamper  
Huffman  
Kelley  
Elmore

CROSS SECTION OLIVEWOOD TERRACE  
FROM OCEAN VIEW TO GILMORE ST.

W.O. 31836

(See Sketch)  
0+23.90 = F.C.C. Lt. Radial

#7.45	#7.53	#7.53	#7.58	#7.58	#7.58	#7.58	#7.58	#7.58	#7.58
600	612	612	637	637	60	50	453	407	
40	25	208	150	150	0	25	390	390	
		brsw	cb	cb	AC covered		G	cb	

Sec Along Ocean View

0+00 = Nly Line Ocean View Blvd Edge Ac	#7.71	#7.37	#7.33	#7.57	#7.12	#7.26	#7.50	#7.90	#7.6	#7.81	#7.18	
	6.74	7.08	7.08	7.12	7.88	6.33	5.19	4.55	4.05	3.9	3.64	3.27
	40	262	25	187	187	0	25	46°	46°	55°	55°	66°
	brsw	cb	cb	G	G	G	G	cb	Dir	cb	5.M.B	Dir

Sec Along Ch. Line  
0-17.56 = Nly cb Ocean View

#7.00	#7.53	#7.53	#7.06	#7.60	#7.81	#7.13	#7.03	#7.93	#7.07	#7.20	#7.33	#7.37
7.45	7.92	7.86	8.39	7.85	8.64	7.32	6.12	5.02	4.36	3.75	262	208
825	825	340	340	27°	27°	0	25	50	687	687	100	100
cb	cb	cb	G	cb	G	bc	G	G	bc	cb	G	cb
End Dr way	Begin Dr. Way											

Sec Along E Ocean View  
0-50.70 = E Ocean View

#7.21	#7.36	#7.71	#7.39	#7.64	#7.50	#7.56	#7.95	#7.37	#7.73
624	7.09	7.74	8.06	7.81	6.95	5.89	4.50	3.08	1.72
100	75	50	25	0	25	5.0	75	100	125

+6.30 55.45

Σ 55.45

T.B.M. -5.61 49.15  
B.M. 10.27 54.76 54.49

Set PK. PP NW Cor. Olive wood & Ocean View  
NW BP Hemlock & Olive wood Terrace

OLIVEWOOD TERRACE

Lt

E

Rt

2-21-55

0+81-15<sup>8 ft</sup> Lt. in Cb. on Rt.

50.51	50.82	50.93
50	463	452
158	158	212
G	Cb.	bk.S.W.

0+75

51.88	51.1	51.0	50.8	50.5	50.82	50.93
357	44	4.5	4.7	5.0	463	4.48
393	393	25	0	188	188	248
6	G	G	G	G	Cb	bk.S.W.
						@ bldg

0+50

51.18	50.58	50.80	50.2	50.0	50.1	50.5	50.6	50.87	51.19
3.68	4.07	5.05	5.24	5.5	5.4	5.0	4.9	4.58	4.26
40	285	25	213	213	0	25	134	340	401
	bks.w.	bks.w.	Cb.	G	G	G	Cb	Cb	bks.W.
									@ bldg

0+46<sup>5</sup> 28° Lt & V.P.N. 442

0+42-27<sup>2</sup> Lt. Begin Conc. & brick wall 8"

(see sketch)

0+33.75 P.C.C. Rt.

51.60	51.62	51.61	51.27	51.27	51.27	50.6	51.2	51.53	51.75
5.85	5.83	5.84	6.18	5.8	4.9	4.3	3.90	3.50	
40	25	220	150	150	0	25	430	430	490
		bks.w.	Cb	G	G	G	Cb	bk.S.W.	
				AC					

5545



OLIVEWOOD TERRACE

LT

2-21-55

RT

(28)

1+75

55.0 54.4  
106 112  
40 25

54.3 54.5 53.3 54.0  
11.3 11.3 12.3 11.46 11.36 11.2 10.7  
1.5 0 1.5 1.5 208 25 40  
G cb. bk.SW.

+10.64 65.55

65.55

TP

-0.54 54.91  
54.1 53.3  
14 2.2  
40 25

53.0 53.1 52.0 52.40  
2.5 2.4 3.5 3.05 3.07 2.6 2.3  
15 0 1.5 1.5 208 25 40  
G cb. bk.SW.

1+50

NOTE:  
1+25 Curb 11/2-RO 22 1.51 2.5 3.12  
15 broken & should  
be replaced 40 40 25 15  
G cb  
12.5R  
Cb NO Good  
broken

52.0 52.1 51.5 51.70 51.88 52.1 52.5  
3.5 11.3.4 4.0 3.75 3.57 3.4 3.0  
15 15 0 1.5 1.5 208 25 30  
G cb bk.SW.

1+00

52.4  
3.1  
40

51.6 51.4 51.3 50.8 51.33 51.48 51.4  
3.9 4.1 4.0 4.7 4.12 3.97 4.1  
25 15 0 1.5 1.5 21 25  
G cb. bk.SW.

55.45

Lt

±

et

2-21-55

# OLIVEWOOD TERRACE

2+25 P.O.C.

50.6	58.3	57.90	57.88	57.91	57.0	57.1	57.5	56.53	57.53	57.58	57.4	56.1
5.0	7.3	7.65	7.66	7.64	8.6	8.5	8.1	9.02	8.02	7.97	8.2	8.9
40	32	268	25	206	206	15	0	142	142	207	25	40
Top	Top	bks.w. cb			G			G		bks.w.		

## INSERT CURV. DETAILS

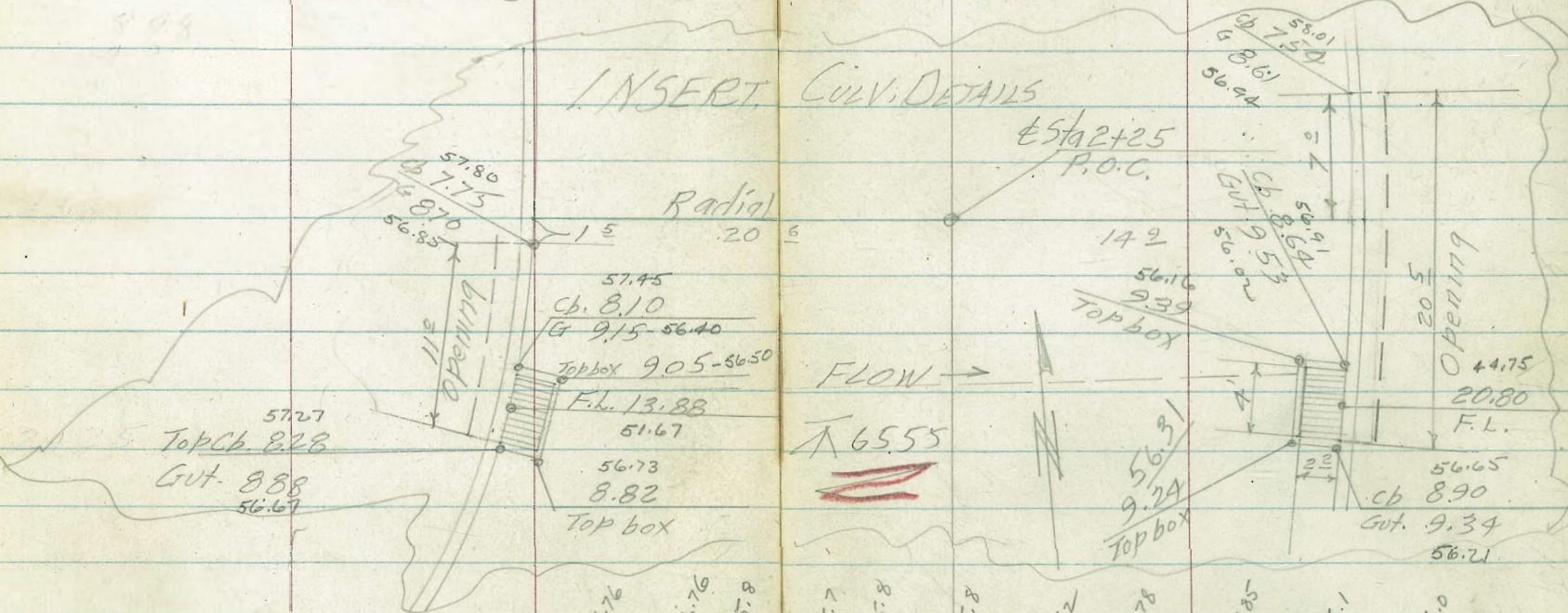

57.27  
Top Ch. 8.28  
Gut. 8.88  
56.67

57.45  
Ch. 8.10  
G 9.15-56.40  
Top box 9.05-56.50  
F.L. 13.88  
51.67  
56.73  
8.82  
Top box

56.16  
9.39  
Top box

56.65  
cb 8.90  
Gut. 9.34  
56.21

2+00 P.O.C.

56.76	56.76	55.8	55.7	55.8	55.2	55.78	58.55	56.1	56.0
8.79	8.79	9.8	9.9	9.8	10.4	9.77	9.70	9.5	9.6
353	292	292	25	15	0	150	130	20.8	25
bks.w. ch		G		G		cb		bks.w.	

± 65.55

Lt.

☉

Bt.

2-21-55

OLIVEWOOD TERRACE

	73.0	70.7	68.6	68.65	68.56
3+50	2.6	4.9	7.0	6.95	7.04
	30	25	23	208	150
			700	bksw	cb.

	68.0	68.0	67.2	67.71	68.00	68.1
	7.6	7.6	8.4	7.89	7.60	7.5
	150	0	150	150	208	250
	G		G	cb.	bksw	@b119

		66.7	64.3	64.07	63.93
3+00		8.9	11.3	11.53	11.67
		30	25	208	150
		Toe	bksw	cb	

	63.3	63.1	62.6	63.31	63.39	63.3	62.2
	12.3	12.5	13.0	12.29	12.21	12.3	13.4
	150	0	150	150	208	25	40
	G		G	cb.	bksw		

+12.60 75.60

△ 75.60

TP. -2.55

		61.1	63.00	
2+67.08 EC.	2.3	4.5	4.50	4.57
	31	25	208	150
		Toe	bksw	cb

	60.6	60.8	59.8	60.37	60.48	60.6	60.3
	5.1	5.2	5.8	5.8	5.07	5.0	5.3
	150	0	150	250	208	25	40
	G		G	cb.	bksw		

	51.9	60.1	59.8	59.63	59.69
2+50 P.O.C.	3.7	5.5	5.8	5.92	5.96
	35	28	25	21.6	158
		Toe		bksw	cb

	59.1	59.2	58.6	59.18	59.23	59.1	58.7
	6.3	6.4	7.0	6.37	6.32	6.5	6.9
	150	0	150	150	208	25	35
	G		G	cb.	bksw		

△ 65.55

2-23-55

(37)

Lt.

Rt.

## OLIVEWOOD TERRACE

(cont. bet 4 & 5)

5+50	0.4	2.47	6.21	6.29	6.39	7.3	7.3	8.0	7.52	7.50	7.60	7.76
= 5/4 line (approx)	35	25°	25°	20°	142	142	0	15L	15L	20B	25	30
= 1/4 ch. S.W. on Lt.		TOP	TOE	bk.S.W.	cb	G		G	cb	bk.S.W.	conc	conc.
= 1/4 ch. S.W. on Rt.		CONC	CONC	Wall								

5+00	2.4	4.2	4.21	7.3	7.65	7.76	8.5	8.8	9.5	8.90	8.78	10.7	16.0
	35	25	24L	24L	20B	15°	15°	0	15°	15°	20B	25	35
			TOP	TOE	bk.S.W.	cb	G		G	cb	bk.S.W.		TOE

4+50	5.7	5.70	8.7	9.29	9.32	10.2	10.3	10.9	10.22	10.26	10.4	
	25	232	232	20B	15°	15°	0	15L	15L	20.8	25	
		TOP	TOE	bk.S.W.	cb	G		G	cb	bk.S.W.		

+11.07 85.75

set chisel 5' side

TBM Drive Way on W.	-0.92	74.68										
Side Olive Wood	15.42	73.4	73.14									
4+00 opposite House N-330	0.18	2.2	2.46									
85+9.4+25±	25°	24.5	20B									
		TOP	TOE	bk.S.W.								
		8" CONC										
		Ret Wall										

75.60

Lt.

¢

Rt.

OLIVEWOOD TERRACE

B.M.

Top S.W. C.T. Olivehood  
TBM: Terrace & Gilmore - 4.84

80.91 =  
83.6  
2.0  
75

80.91 (see P953)  
82.3 81.4 80.4 78.9 77  
35 44 5.6 6.9 8.7  
50 25 0 25 50

15.0  
10.8  
75

6+45.43 = ¢ Gilmore St.

(see sketch P9.24)

6+26.43 = 5/4 Cb. Line Gilmore St. Fly

82.1  
3.7  
50

81.1 80.4 80.2 79.2 78.6  
4.7 5.4 5.9 6.6 7.2  
25 15 0 15 25  
G G

78.71 76.3 77.38  
6.04 9.5 8.37  
25 50 50  
G G Cb  
E.C.

6+16.43 = 5/4 Line Gilmore St.  
= End Curb & S.W. on Lt.  
= B.C. Curb Ret. on Rt.

83.7 81.7 81.13  
2.1 4.1 4.68  
50 25 20  
b.R.S.W.

82.08 80.8 80.0 79.3 78.6  
4.8 5.5 5.8 6.5 6.11  
15 15 0 15 15  
G G G Cb  
B.C. B.C.

79.74 79.8 77.6  
6.01 6.0 8.2  
20 25 50  
b.R.S.W.

6+00

83.8 82.2 80.61  
0.0 3.6 5.14  
32 25 20  
b.R.S.W.

80.57 79.8 79.6 79.9  
5.8 6.0 6.2 6.9 6.54  
15 15 0 15 15  
Cb G G Cb

79.21 79.20 79.5 79.3  
6.55 6.3 6.5  
20 25 30  
b.R.S.W.

85.75

CROSS SECTIONS OF SOUTHLOOK AVE  
FROM OLIVEWOOD TERRACE TO

GILMORE ST. W.O. 31836  
3.7 Lt = E Sewer M.H.

O+81.01 P.R.C.  
53.99 56.87 54.9 56.02  
5.24 2.36 4.3 3.21  
34 25 25 20  
@ bldg Top 8" Top br.S.W.  
Wall Wall

O+50 P.O.C.  
53.69 53.86 56.03 53.89 54.29  
554 537 320 534 494  
29.6 25 22.5 22.5 20.2  
@ M.H. Top Top br.S.W.

O+29 = 0.7' Jog in cb  
on Lt  
53.09 8" Wall 52.2  
6.14 6.28 7.0  
15.2 15.0 15.0  
cb cb G

O+20.15 P.O.C.  
52.8 52.7 55.03 52.73 52.76  
6.4 6.5 9.20 6.50 6.47  
35 25 23.4 23.4 21.2  
Top 8" Conc br.S.W.  
Wall

(see sketch Pg. 25)  
O+00 = Wly Line Olivewood  
P.R.C.  
52.4 51.9 54.11 51.75 51.7  
6.8 7.3 5.12 7.48 7.52  
35 25 23.4 23.4 21.1  
Top Conc br.S.W.  
8" Wall

B.M. +10.08 59.23 49.15

Lt E Pt. 33

55.96 54.8 55.91 53.0 55.2 57.11 57.23 58.4 59.90  
327 144 326 3.2 3.0 2.12 2.00 0.8 (-0.7)  
142 142 32 0 15.0 15.0 20.6 25 30  
cb. G Top 8" Top br.S.W.  
M.H.

54.16 53.5 54.2 54.5 54.6  
507 57 5.0 4.7 4.6  
142 142 15 2.5  
cb. G

52.59 51.8 52.3 52.0 52.74 53.2  
6.64 7.5 6.9 7.2 6.49 6.0  
15.1 15.1 0 15.1 15.1  
cb. G G cb 25  
12.5  
Radius

51.56 50.8 51.2 51.2 51.4  
7.68 8.4 8.0 8.0 7.8  
15.1 15.1 0 15 25  
cb G

59.23  
(See Pg. 26)

Lt 2-23-55 Rt

SOUTHLOOK AVE

1+75 P.O.C.	57.2 10.5 35	57.6 10.1 25	57.57 10.17 20.4 br.s.w.	57.59 10.35 147 cb	57.8 10.9 147 G	57.6 10.1 0	57.9 9.8 151 G	61.0 8.64 151 cb	61.24 8.50 208 br.s.w.	62.5 7.2 25	65.7 4.0 35			
1+50 P.O.C.	56.5 13.2 30	57.0 11.7 25	57.70 11.04 20.5 br.s.w.	57.61 11.13 149 cb	57.9 11.8 149 G	57.6 11.1 0	57.8 10.9 152 G	57.87 9.85 152 cb	60.11 9.63 209 br.s.w.	62.0 7.7 25	64.3 5.4 30			
1+25 P.O.C.	57.2 12.5 30	57.8 11.9 25	57.84 11.90 20.5 br.s.w.	57.74 12.00 148 cb	57.8 12.9 148 G	57.6 12.1 0	57.0 11.7 151 G	57.01 10.73 151 cb	57.22 10.52 208 br.s.w.	61.3 8.4 25	63.6 6.1 30			
TP. +10.85	69.74	-0.34	58.89	A. 69.74										
1+00 P.O.C.	57.5 5.7 30	57.83 1.40 27	57.7 4.5 27	55.2 4.0 25	56.3 2.9 24	56.86 2.37 207 br.s.w.	56.74 2.49 148 cb	56.0 3.2 148 G	56.7 2.5 0	57.1 2.1 142 G	57.87 1.36 142 cb	57.00 1.23 206 br.s.w.	57.6 (-0.4) 25	63.2 (-4.0) 35

A 59.23

View Blvd

SOUTHLOOK AVE

Lt.

±

Rt

2+77.28 E.C.

64.9	64.6	64.40
4.8	5.1	5.34
35	25	20.6
		bk.S.W.

64.32	63.8	64.6	64.7	65.06	65.58	66.4	68.3
5.42	5.9	5.1	5.0	4.28	4.16	2.8	1.4
14.8	14.8	0	15.0	15.0	20.8	25	30
Ch	G		G	Ch	bk.S.W.		

2+50

64.0	63.1	62.84
5.7	6.6	6.90
35	25	20.6
		bk.S.W.

62.68	62.3	62.0	63.3	64.13	64.22	64.76	65.8
7.06	7.4	6.7	6.4	5.61	5.52	4.98	3.9
14.8	14.8	0	15.2	15.2	20.2	20.2	25
Ch	G		G	Ch	bk.S.W.	TOP 8"	
						Concret	Wall
				6.1			
				0.6			
				3.5			

2+27-10<sup>8</sup> Lt. ± Sewer M.H.

61.23		
8.51		
10.8		
TOP W. Rim		
62.16	62.7	61.20
6.1	7.4	8.24
35	25	20.5
		bk.S.W.

61.39	61.2	61.7	62.1	63.23	63.37	64.52	64.8
8.35	8.5	8.0	7.6	6.51	6.37	5.22	4.9
14.2	14.2	0	15.3	15.3	20.8	20.8	25
Ch	G		G	Ch	bk.S.W.	TOP 8"	
						Concret	Wall
				6.1			
				1.6			
				3.5			

2+25

2+00 P.O.C.

62.8	61.6	60.57
6.9	8.1	9.17
35	25	20.5
		bk.S.W.

60.71	60.0	60.6	61.0	62.16	62.34	63.56	64.0
9.03	9.7	9.1	8.7	7.58	7.40	6.18	5.7
14.7	14.7	0	15.3	15.3	20.9	21.2	25
Ch	G		G	Ch	bk.S.W.	TOP 8"	
						Concret	Wall
				3.2			
				3.5			

69.74



SOUTHLOOK AVE.

Lt.

±

Rt.

	77.0	76.7	76.63
4+50	3.3	3.6	3.68
	35	25	20.4
			br.S.W.

	76.51	76.0	76.8	76.7	77.39	77.56	77.7	77.4	90.5
	3.80	4.3	3.5	3.6	2.92	2.75	2.6	0.9	(-0.2)
	148	148	0	151	151	20.7	24	25	30
	cb.	G		G	cb.	br.S.W.			

	74.25	74.35	73.01
4+00	6.06	6.96	7.30
	35	25	20.4
		conc	br.S.W.

	72.96	72.7	73.2	73.3	74.02	74.20	74.7	74.51
	7.35	7.6	7.1	7.0	6.27	6.11	5.6	3.80
	148	148	0	151	151	20.7	25	25
	cb.	G		G	cb.	br.S.W.	Toe	Top 8'
								CONC WALL

	69.1	69.3	69.41
3+50	11.2	11.0	10.90
	35	25	20.7
			br.S.W.

	69.35	68.5	69.5	69.5	70.54	70.65	71.8	76.3
	10.96	11.4	10.8	10.8	9.77	9.66	8.5	4.0
	142	142	0	151	151	20.8	25	35
	cb.	G		G	cb.	br.S.W.		

+10.69      80.31  
2254

80.31

3+26- set P.K. Conc. b/k Wall  
TBM.      - 0.12

	69.62		65.92
3+00	3.55	3.70	3.82
	35	25	20.5
		conc	br.S.W.

	65.81	65.3	66.2	66.4	67.83	67.23	68.8	73.2
	3.93	4.4	3.5	3.3	2.71	2.51	0.9	(-3.5)
	142	142	0	150	150	20.8	25	35
	cb.	G		G	cb.	br.S.W.		

69.74

SOUTH LOOK AVE

(see sketch Pg. 23)

6+26.56 = 5/4 line Gilmore St.  
= End Curb & S.W. on Lt.  
= B.C. SE. Ch. Ret.

Lt.

±

Rt.

88.8  
4.7 4.7 4.47  
35 25 20.8  
bk.S.W.

88.83 87.7 88.5 89.0 89.95 90.09 90.5 90.5  
4.62 5.8 5.0 4.5 3.50 3.36 3.0 3.0  
15 15 0 15 15 20.8 25 35  
cb. G G cb. bk.S.W.  
B.C.

6+00

86.9 87.1 87.5  
6.6 6.4 6.32  
35 25 20.4  
bk.S.W.

87.03 86.1 87.1 87.2 88.13 88.19 89.5 92.3  
6.42 7.4 6.4 6.3 5.32 5.26 4.0 1.2  
14.8 14.8 0 15.1 15.1 20.8 25 35  
cb. G G cb. bk.S.W.

5+50

83.5 83.7 83.67  
9.6 9.8 9.78  
35 25 20.5  
bk.S.W.

83.03 83.0 84.1 84.8 84.48 84.62 85.6 87.4  
9.90 10.5 9.4 9.7 8.97 8.83 7.9 5.6  
14.2 14.2 0 15.1 15.1 20.8 25 35  
cb. G G cb. bk.S.W.

5+00

79.5 80.0 80.12  
13.6 13.5 13.33  
35 25 20.7  
bk.S.W.

79.50 79.5 80.5 80.2 80.88 81.06 82.5 85.6  
13.55 14.0 13.0 13.3 12.57 12.39 11.0 7.9  
14.9 14.9 0 15.1 15.1 20.7 25 35  
cb. G G cb. bk.S.W.

+13.17 93.45

± 93.45

TP.

-0.03 80.28

± 80.31

80.31

Lt.

€

Rt.

SOUTHLOOK AVE

(NOTE: THIS IS Closest Check in Vicinity)

B.M. -6.64 96.05

-96.16 Top SE F Hyd 36-1/4 Imperial

+4.78 102.69

B.M. -5.45 97.87

-98.58 Top SE F Hyd 38-1/4 Imperial  
(Bench Book)

+5.41 103.32

B.M. -1.78 97.91

118.38 <sup>???</sup> SE BP S. Look & Imperial  
(Bench Book)

+7.38 99.69

T.P. -0.62 92.31

+0.18 92.93

Set PK Guy & Tel Pole N° 419236-H

T.B.M. Sta 100 Gilmore -0.70 92.75

Lt.

6+55.56 = € Gilmore St.

0.0	89.0	89.3	89.1	89.5	89.1	89.5
35	40	42	40	36	34	36
75	50	25	0	25	50	75

6+36.56 = 5/4 Ch. line Gilmore St. 5/4

83.3	88.8	89.1	88.8	89.2	89.6	90.09	89.4	89.89
42	46	54	47	43	39	336	41	356
50	25	15	0	15	25	25	50	50
					G	cb	G	cb

93.45

CROSS SECTIONS OF SOUTHLLOOK  
AVE FROM STA 0+81.01 NELY

lt-      &      rt.

	57.2	57.7	55.90	55.71	55.0	54.1	52.4	54.30	53.33
0+63.80 P.O.C.	0.0	1.5	3.33	3.52	4.2	5.1	5.8	4.93	5.9
	30	25	20.6	142	142	0	148	148	25
			bk.S.W.	cb	G		G	cb	
								12.5 Rod	

	59.4	57.5	55.99	55.84	54.8	54.1	53.2	52.5
0+50 P.O.C.	-(-0.2)	1.7	3.24	3.39	4.4	5.1	6.0	6.7
	30	25	20.8	150	150	0	15	25
			bk.S.W.	cb.	G			

	60.1	58.1	56.45	56.31	55.2	54.8	53.7	53.1
0+25 P.O.C.	-(-0.9)	1.1	2.78	2.92	4.0	4.4	5.5	6.1
	30	25	20.8	150	150	0	15	25
			bk.S.W.	cb.	G.			

0+00 = 0+81.01 (see Sketch Pg. 25) = 0+81.01

bk.S.W.

cb G

G

cb

bk.S.W.

B.M.

Δ 5923 (see Pg 33)

SOUTHLOOK, NELY FROM STA 0+81.01

Lt.

±

Rt.

TP

-0.34

58.89

(see P 9.39)

1+01.43 P.C.C. = W/4 line  
Olivewood Terrace

	58.6	57.3	56.24
	0.6	1.9	2.99
	35	25	20.7
			BR. SW.

	56.14	55.3	54.4	53.9	53.8	53.6
	309	39	4.8	5.3	5.4	5.6
	151	151	0	10	15	25
	cb.	G				

0+80 P.O.C.

	56.65	56.51	55.87
	2.58	2.72	3.36
	26 <sup>0</sup>	25	20.7
	@ 64. Long.		BR. SW.
	floor		

	56.77	55.1	54.2	53.2	52.7
	346	41	5.0	6.0	6.5
	151	151	0	15	25
	cb.	G			

59.23

2-24-55

(2)

Lt.

±

Rt.

CROSS SECTIONS OF GILMORE ST.  
FROM 36-TH TO 37-TH ST. W.O. 31836

0+23<sup>5</sup> - 20' Lt. & 3' Conc. Walk 537  
302  
on walk

576  
202  
on walk

0+00.29° Lt. Begin 4' Picket fence

= Edge A.C. Pavt.  
0+00 = Ely line 36-TH St.

94.24  
95.3 94.3 94.19  
4.3 5.3 5.42  
50 29 27.8  
BASW.

93.85  
93.98 93.52 93.53 93.00  
563 609 608 661  
212 212 0 212  
Cb G G

93.48 93.20 94.9 95.9 96.5  
613 591 47 3.7 3.1  
212 275 29 35 50  
Cb BR SW. Top bank

0-10 = Ely Cb. line. 36-TH St. 5.00 5.47 5.21 5.67 5.26  
75° 75° 50 30 39°  
Cb G Cb G Cb  
BC.

93.85  
93.71 93.67  
576 584 594  
39° 19 0 19 39°  
G BC.

93.47 93.48 93.94 93.61 92.99 92.84 92.28  
614 613 567 600 662 577 533  
39° 39° 50 50 75 75  
G Cb G Cb G Cb

0-30 = ± 36-TH St.

94.98  
471  
75

94.71 94.48 94.23 94.03 93.88 93.79  
490 513 538 558 573 582  
50 25 0 25 50 75

99.61

+5.27 99.61

T.B.M.

- 5.31

94.34

N<sup>o</sup> 3601  
Nail in PP @ SE COR 36th Gilmore St  
(See Pg 30)

T.B.M. +6.90

99.65

92.75

Lt.

±

Rt

GILMORE ST.

0+81-29<sup>o</sup> Lt. Begin 3' Picket fence

0+81-28<sup>3</sup> Lt. ± Deadman

92.23

92.35

0+78-28<sup>4</sup> Lt. End Conc. Slab (carport)

7.38  
38±  
on Conc.

7.26  
28±  
Conc

92.45

92.71

0+62-28<sup>7</sup> Lt. Begin Conc Slab Carport

7.16  
38±  
on Conc.

6.90  
28±  
Conc.

0+62-29<sup>o</sup> Lt. End 3' Picket fence  
(Through Drive Way)

93.6

93.1

92.4

92.6

91.9

92.3

92.5

92.3

94.0

0+50

6.0  
40

65  
29

72  
19

7.0  
0

7.7  
17

7.3  
19

7.1  
29

4.3  
35

3.6  
50

93.89

93.55

0+47-28<sup>5</sup> Lt. ± 3' Conc. Walk

6.12  
36±  
on walk

6.06  
28±  
on walk

99.61

GILMORE ST.

Lt.

E

Rt.

X = E Sewer m. H.  
1+35.12 = E Alley Nly

90.2  
90.4  
9.4 9.2  
50 29

90.5 90.4 90.2 90.2 89.7 90.1 90.3 89.6 87.0  
9.1 9.2 9.4 9.39 9.9 9.5 9.3 10.0 12.6  
19 16 15 0 14 16 19 29 50

TOPELY  
Rim M.H.

- 29° Rt & Deadman  
1+28-20<sup>5</sup> Rt & PPN<sup>o</sup> 3623

90.3 90.9 90.7 90.5 89.9 90.4 90.4 89.7 87.4  
9.3 8.7 8.9 9.1 9.7 9.2 9.2 9.9 12.2  
50 29 19 0 14 17 19 29 50

1+25.12 = W. Line Alley Nly

1+25-29° Lt. End 3' rd fence (laterals)

1+24-30<sup>4</sup> Lt. & 10" Acacia Tree

1+09-29<sup>2</sup> Lt. & 3' Conc Walk

91.61  
8.00  
33<sup>o</sup>  
on Walk

91.55  
8.06  
29.2  
E Walk

1+02-29<sup>5</sup> Rt. Begin 3<sup>5</sup> Picket fence

91.8  
7.8  
37  
@ bldg

91.8 91.7 90.9 91.0 90.3 90.9 91.1 91.1 89.1  
7.8 7.9 8.8 8.6 9.3 8.7 8.5 8.5 10.5  
29 19 15 0 14 17 19 29 50

1+00-20<sup>1</sup> Lt. & Guy Pole & Tel. Pole N<sup>o</sup> 419236-4

0+99<sup>5</sup> 28<sup>1</sup> Lt. & Deadman

8+87-29<sup>1</sup> Lt. End 3' Picket fence

91.61



Lt.

E

Rt

GILMORE ST.

2+04-29° Rt. End S.W.

88.98  
 10.63  
 29°  
 Top S.W.

88.64  
 10.97  
 39°  
 on Walk.

1+99.67 = Wly Line Southlook Ave Sly

90.3	90.0	89.5	89.2	88.4	88.8	88.8	88.7	88.6	87.6
9.3	9.6	10.1	10.4	11.2	10.8	10.8	10.9	11.0	12.0
50	29	19	0	14	16	19	29	35	50

1+70-33° Lt. & Sing Gar. (Dirt floor)

89.8  
 9.8  
 33°  
 Dirt floor

1+58-25° Rt. & Begin 3 Eugenia Hedge

26° Rt. = E Conc Drive Sing Gar  
 1+45.12 = E. Line Alley Nly

90.0	90.4	90.3	90.1	90.0	90.0	89.9	89.8	89.77	89.49	88.76
9.6	9.2	9.3	9.5	9.6	9.6	9.7	9.8	9.84	10.12	10.85
50	29	19	15	0	13	15	19	26.6	29	36.6

on conc Drive      conc on Drive

1+39-30° Rt End 4' Picket Fence

89.61

GILMORE ST.

2+51-20<sup>o</sup> Rt. & PPN<sup>o</sup> 3645

2+49.67 = Ely Line Southlook  
Ave Sly

2+39.67 = Ely Cb. Line Southlook 29<sup>o</sup> Rt.  
Ave Sly.

+6.36 95.12

T.P.

-10.85

88.76

80.8

2+24.67 = & Southlook Ave Sly

88

50

2+09.67 = -29<sup>o</sup> Rt. = Wly Curbl. line  
Southlook Ave Sly

Lt.

&

Rt

(45)

91.8	90.9	90.4	89.8	89.5	90.0	90.5	90.1
33	42	47	53	56	50	46	50
50	29	19	0	19 <sup>o</sup>	19 <sup>o</sup>	29	50
				G	G		
				EC	EC		

91.6	90.3	89.5	89.7	89.1	89.8	89.7	87.6	88.6
35	48	56	54	60	63	57.8	75	65.1
50	29	19	0	79	29 <sup>o</sup>	29 <sup>o</sup>	50	50
					G	G	G	G
					BC	BC		

95.12

90.2	90.2	89.8	89.8	88.6	87.5	86.0
94	94	10.2	10.2	11.0	12.1	13.6
29	22	19	0	25	50.	75

90.6	90.1	89.6	89.2	88.1	87.6	88.3
90	95	100	104	115	120	10.78
50	29	19	0	19	29 <sup>o</sup>	29 <sup>o</sup>
					G	G

92.61

GILMORE ST.

3+00.25 =  $\epsilon$  Southlook Ave  
N14

90.96	90.96	90.71	90.16	89.9	89.1	89.66	89.96	90.7	93.11
4.15	4.16	4.35	4.5	5.2	6.0	5.46	5.16	4.4	2.0
75	50	29	25	0	19°	19°	27	29	35
AC	AC	AC			G	cb			

2+80.25 = W. Cb. line Southlook Lt. 28<sup>g</sup>  
Ave N14.

91.09	90.89	90.93	90.31	90.4	90.0	89.2	89.83	90.02	91.0	93.0
4.03	4.63	4.19	4.81	4.7	5.1	5.9	5.27	5.10	4.1	2.1
50	50	282	282	19	0	19°	19°	27	29	35
cb	G	cb	G			G	cb			Top bank

2+75.25-28<sup>g</sup> Lt. = E. Edge S.W.

91.09  
4.03  
288  
S.W.

Lt. 28<sup>g</sup> = W. Edge S. Walk  
2+70.25 = W. line Southlook  
Ave N14

91.33	91.20	91.20	90.5	89.9	89.4	89.91	90.11	90.9	92.8
3.79	3.92	3.92	4.6	5.2	5.7	5.21	5.01	4.2	2.3
50	29	288	19	0	19°	19°	27	29	35
S.W.	S.W.	S.W.			G	cb	brsw.		Top bank

2+57-20<sup>7</sup> Lt.  $\epsilon$  Tel. Pole N<sup>o</sup> 460789-H

9512

GILMORE ST

3+46<sup>3</sup> 29<sup>2</sup> Lt. & deadman

3+46<sup>5</sup> 20<sup>2</sup> Lt. & Tel Pole No 460790-4

3+41<sup>5</sup> - 22<sup>0</sup> Rt. N. Edge S.W. Break up <sup>from</sup> tree Roots

3+41<sup>5</sup> (Should be Replaced)

28 Lt = E. Edge S.W.

3+30.25 = Ely Line Southlook Ave Nly

3+25.25 - 28<sup>0</sup> Lt. = W. Edge S.W.

3+20.25 = Ely Cb Line Southlook 28<sup>0</sup> Lt. Ave Nly

Lt.

±

Rt

(47)

	90.74	90.74	90.74	89.8	88.5	88.5	88.4	88.26	88.63	90.3	89.5	
	433	438	438	536	666	666	67	586	549	4.8	1.6	
	50	29	28 <sup>1</sup>	19	14	0	19 <sup>0</sup>	19 <sup>0</sup>	27	29	40	
			S.W.				4	Cb			Top bank	
			90.62									
			450									
			288									
			S.W.									
	90.53	90.09	90.39	89.94	89.3	89.0	88.6	89.50	89.83	90.5	93.0	93.6
	459	503	473	518	586	61	6.5	5.2	529	4.6	2.1	1.5
	50	50	28 <sup>0</sup>	28 <sup>0</sup>	19	0	19 <sup>0</sup>	19 <sup>0</sup>	27 <sup>0</sup>	29	35	40
	Cb	4	Cb	6			4	Cb	brsw			Top

Λ 95.12

GILMORE ST.

4+00

87.2  
79  
50

86.7 84 11.1 29  
88.0 11.1 12.1 19  
88.0 11.1 15  
88.7 11.4 0  
88.3 11.8 17

84.0 11.1 19  
85.1 10.0 29  
88.06 7.06 29  
88.5 5.6 33  
89.1 5.0 378

Top Wall @ bldg

3+88<sup>5</sup> - 28<sup>6</sup> Rt. Begin 6" Conc Blk Ret Wall

85.2 9.7 28<sup>6</sup> Ground  
88.52 10.58 28<sup>6</sup> ftg  
88.52 6.60 28<sup>6</sup> Top Wall

3+66 - 26<sup>7</sup> Rt & Sing Conc Drive

87.52 7.60 Conc  
89.12 6.00  
36.7 ON DRIVE

3+59 - 208 Rt & PPN# 3663

3+55 - 18<sup>8</sup> Rt. End Cb & SW

87.1 80 18<sup>8</sup> G  
87.72 7.40 18<sup>8</sup> cb  
87.85 7.23 22.1 TOP SW  
88.11 7.01 26.8 BK SW

3+50

87.8 43 50  
88.5 46 29  
88.5 66 19  
88.0 8.1 14  
87.2 7.7 19  
87.4 7.7 19

87.76 7.36 29  
88.33 6.79 22.2  
88.42 6.70 27  
88.51 6.6 29  
88.9 5.2 40

95.12

195/2

W/P Driveway

GILMORE ST.

4+55<sup>11</sup> = Wly Line Alley Nly

83.0  
3.1  
50

81.7  
4.4  
29

81.3  
4.8  
19

80.8  
5.7  
15

81.1  
3.0  
0

80.5  
5.6  
19

81.02  
505  
290  
S.W.

80.49  
558  
500  
S.W.

4+54<sup>11</sup> = W End S.W. 29° Rt

81.06  
501  
290  
S.W.

4+49<sup>91</sup> = Wly Line Okewood  
Terrace Sly

83.5  
22  
50

82.2  
39  
29

81.5  
46  
19

80.7  
54  
15

81.3  
4.8  
0

80.7  
5.4  
19

81.6  
4.5  
22

81.6  
45  
29

82.6  
3.5  
50

4+49-20<sup>11</sup> Rt & PPN<sup>o</sup> 3679

TR +4.02 86.07 -13.07 82.05

4+25-28<sup>6</sup> Rt End 6" Conc blk Ret  
Wall

86.07

83.5  
116  
286  
Ground

83.02  
1210  
286  
Ft 9

86.87  
8.25  
286  
Top  
Wall

9512

GILMORE ST.

4+88-20<sup>±</sup> Lt & Tel P No 460787-H

4+75<sup>±</sup> = E. Line of Alley Nly

81.3	79.5	80.0	79.5	80.2	80.1	79.8	78.9
48	6.6	6.1	6.2	5.9	6.0	6.7	7.2
50	29	19	16	0	25	50	75

4+74.91 = E Olivewood Terrace Sly

81.3	79.5	80.0	79.5	80.2	80.1	79.4	78.9
48	6.6	6.1	6.2	5.9	6.0	6.7	7.2
50	29	19	16	0	25	50	75

= E Sewer M.H.  
4+65<sup>±</sup> = E Alley Nly

81.0	80.8	80.6	80.1	80.8	80.8	80.1	79.6
47	5.3	5.5	6.0	5.49	5.7	6.0	6.5
50	29	19	16	0	19	29	50

Top Wly  
Rim M.H.

4+59<sup>21-29</sup> Pt = Wly Cb  
Line Olivewood Terrace

81.7	81.6	81.0	80.3	80.8	80.4	80.2	80.88	79.6	80.46
42	4.5	5.1	5.8	5.2	5.7	5.9	5.19	6.5	5.61
50	29	19	15	0	19	29 <sup>2</sup>	29 <sup>2</sup>	50	50

86.07

Lt.

E

Rt.

GILMORE ST.

5469-20<sup>6</sup> Rt & PPN# 3689

(overhangs Street)

5453-22<sup>4</sup> Rt. & 12 Pepper Tree

5450

74.6	74.5-4	76.0	75.746	75.82	74.5-	75.0	74.2	75.14	75.5-	75.6
6.5	6.48	10.1	10.11	10.25	11.6	11.1	11.9	10.93	10.6	10.5
38°	29°	29°	28	19°	19°	0	19°	19°	29	45
@ bldg	Top Toe 8"	8" wall	SW. Cb	G			G	Cb		
	Conc. Blk	Wall								

5409-20<sup>9</sup> Lt. & deadman

= Begin Cb & SW. on Lt.

4799.91 = EG. Cb. Ref. Rt.

82.3	80.0	80.06	80.07	79.57	79.00	78.5	78.8	79.70	79.88	79.8	79.3
3.8	6.1	6.0	6.00	6.10	7.1	7.2	7.3	6.37	6.19	6.3	6.8
50	29	28°	23°	19°	19°	0	19°	19°	28°	29	50
		SW.	SW.	Cb	G		G	Cb	bk		
								SW			

4789.91 = Ely Cb. Line  
Olivehood Terrace Sky

82.1	80.2	80.1	79.1	78.5	78.2	78.3	79.63	78.7	79.12
4.0	5.9	6.0	7.0	6.6	6.9	6.8	6.44	7.4	6.95
50	29	19	13	0	19	29°	29°	50°	50°
						G	Cb	G	Cb

86.07



GILMORE ST.

6+10-29<sup>5</sup> Rf. & PPN = 300

72.74	72.2	71.56	71.1	70.7	70.2	69.8	68.9	70.5	67.8	68.8
424	48	542	59	6.3	6.8	7.6	8.1	6.47	92	8.00
50°	50°	29°	29°	19	0	19	29°	29°	50°	50°
cb	G	cb	G				G	cb	G	cb

6+11.97 = Wly Ch. Line 37th

cb = 10' Lt + Rt.  
6+01.97 = B.C. Ch. Returns

71.70	71.0	69.5	70.5
5.28	6.0	7.1	6.41
182	182	19	19
cb	G	G	cb.

5+99<sup>27</sup> = Wly Line 37th St.

72.9	71.9	71.85	71.85	71.0	71.0	70.0	70.60	70.82	71.5	70.5
4.1	5.1	5.13	5.13	6.0	6.0	7.0	6.38	6.16	5.5	6.5
50	29	28	19	19	0	19	19	28	29	50
		cb	G			G	cb	bksw		

(overhangs street)  
5+95-20<sup>3</sup> Lt & 10" Poplar Tree

5+92-20<sup>2</sup> Rt & deadman

76.98

TP. +360 76.98 - 1269 73.38  
86.07

lt

et

et.

2-24-55

GILMORE ST.

B.M.	-0.92	54.48	-	54.49	Starting B.M. (See Pg 26)
	+6.26	55.40		5	

T.B.M.	-10.02	49.14	-	49.15	(see Pg 26)
	+2.87	59.16			

T.P.	-12.57	56.29	-	56.31	Top cbasin (see Pg. 29)
	+0.30	68.86			

T.P.	-12.76	68.56			
	+0.41	81.32			

T.B.M.	2.55	80.91	-	80.91	(see Pg 32)
	+10.08	83.46			

T.P.	-3.60	73.38			
------	-------	-------	--	--	--

6 + 29.97 = et 37.44 = et Sewer M.H.	74.0	72.5	71.4	70.4	69.1	67.7	66.1
	3.0	4.5	5.6	6.57	7.9	9.3	10.9
	75	50	25	0	25	50	75

W/4 Rim Mult.

76.98

Clark  
Shepard  
Brewer  
ONEID

X-SECT ALLEY BIK 3 - ROLANDO - UNIT

7-11-55

W.O. 25020

REF: MAP # 1932-2

INDEXED  
JUL 1955

54

Note: Too much time could not be taken  
on 25020 to Fd. Tie-pts.  
Believe those shown are as good as will be  
Fd. this area.  
Suggest chk. with Private Surveyor who  
Laid-out Rolando #1 to determine  
Correct offset distances, of L. Plugs  
No Tie-Points available

Note: ON 25020 - No attempt made to show  
possible encroachments - Only  
such as walls - fences etc.  
only those improvements, the elev's  
of which are important in establishing  
grade, are shown.

PANHEAST

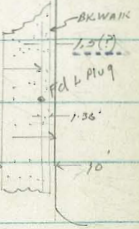
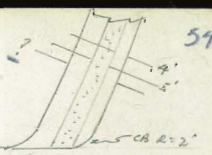
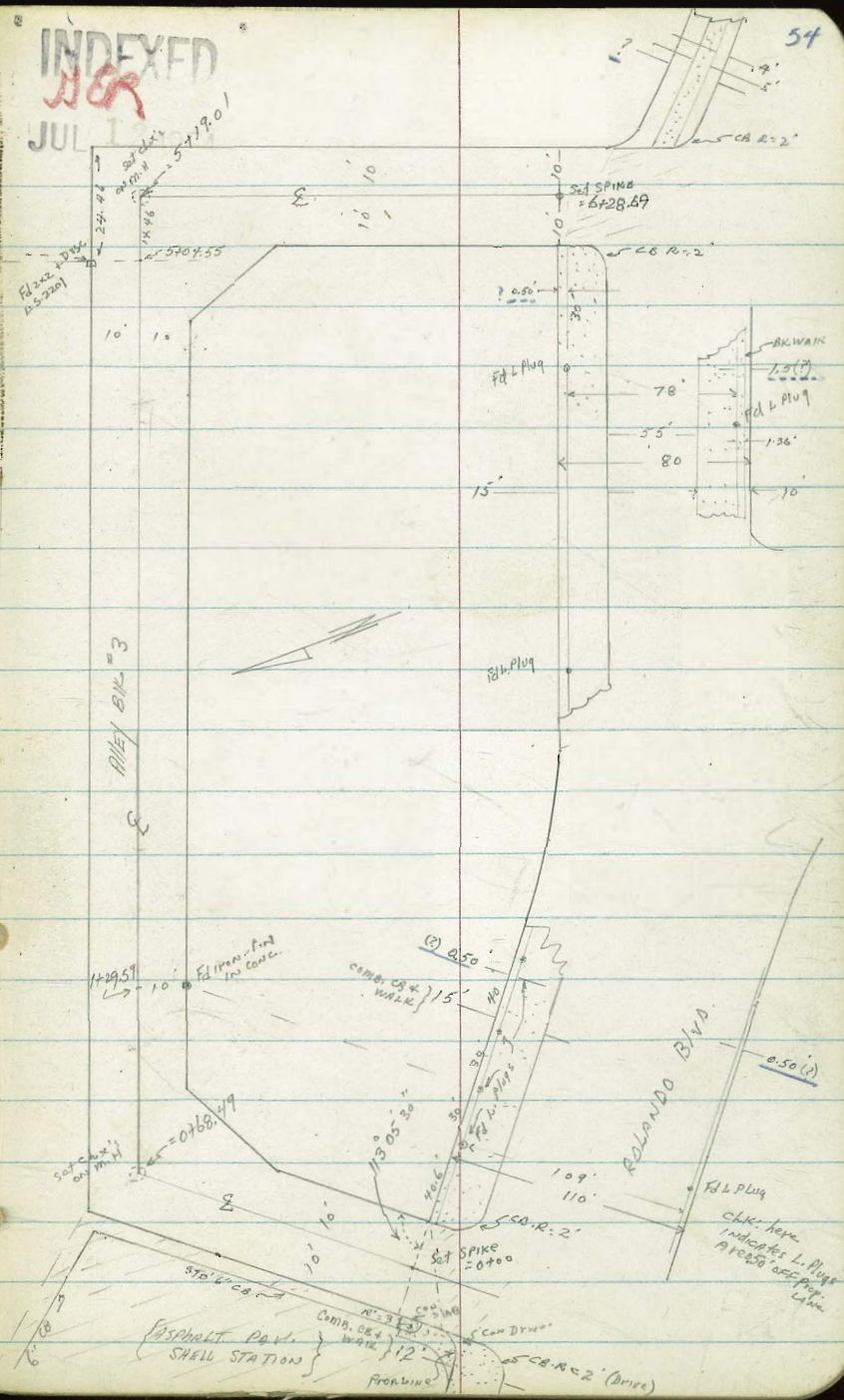

chk. here  
indicates L. Plug  
Areas not  
shown

Alley BK = 3 - Rolando #1

0+45 RT Beg Con. Pav. 1/4 (Canc. Pav. along Sly Prop. Line) (Asph)

0+4.28 9.95 RT = CB End & Edge A.C. Pav. Alley

0+100 Sect at 90° E

0+100 = Fly Line Rolando - (Sly) Sect along Prop. Line

0-07.7 = Edge A.C. Pav - ON DIAG. (BUILT AT E) (11' req.)

0-12.8 14.1 LT = E.C. 6" CB

0-15.8 9.8 LT = END CON. DRIVE (cuts 90° E Alley) (on station property) & Edge A.C. Pav. Alley

0-16.2 = Fly CB Line Rolando - Sly (cuts along Line CB) (cut to CB at 90°)

0-35: Fly CB Line Rolando - NLY (cuts along CB Line) STD CBS - A.C. Pav.

T.P. 11.33 458.29 6.92 446.96

B.M. 0.15 453.88 453.73 = S.W.B.P.

EL. CATION 4674L  
Orig. Alley 450.70 - Reset by W. GARRER

452.49  
5.80  
25  
(Asph)

452.73  
5.56  
14.1  
(Asph)

453.00  
5.29  
14.1  
G  
(Asph)

453.05  
5.84  
10.9  
Edge  
(Asph)

453.6  
4.7  
10

452.64  
5.65  
25  
(Asph)

452.70  
5.59  
14.1  
G  
(Asph)

452.97  
5.32  
14.1  
Edge  
CB

453.10  
5.79  
11  
To  
Asph

453.1  
4.5  
10.9  
9.4

453.2  
5.1  
10.9  
9.4

452.66  
5.63  
20  
Asphalt

452.79  
5.39  
14.1  
G  
(Asphalt)

452.99  
5.30  
10.7  
To  
Sub

453.06  
5.4  
10.7  
9.4

LT.

452.7

5.6

5.6

5.98  
edge AC  
9.4

452.10

6.19

6.19

6.10

458.29

458.29

RT.

453.8  
4.5  
10  
9.4

454.17  
4.12  
10.3  
Con.

454.22  
4.07  
16  
Edge  
Calc.

452.57  
5.70  
9.95  
Edge  
Pav.

452.81  
5.52  
10.7  
CB  
End  
& Walk  
BK edge

452.85  
5.58  
9.95  
Edge  
Calc.

452.81  
5.52  
10.7  
CB  
End  
& Walk  
BK edge

452.81  
5.52  
10.7  
CB  
End  
& Walk  
BK edge

452.81  
5.52  
10.7  
CB  
End  
& Walk  
BK edge

452.81  
5.52  
10.7  
CB  
End  
& Walk  
BK edge

452.81  
5.52  
10.7  
CB  
End  
& Walk  
BK edge

452.81  
5.52  
10.7  
CB  
End  
& Walk  
BK edge

452.81  
5.52  
10.7  
CB  
End  
& Walk  
BK edge

452.81  
5.52  
10.7  
CB  
End  
& Walk  
BK edge

452.81  
5.52  
10.7  
CB  
End  
& Walk  
BK edge

452.81  
5.52  
10.7  
CB  
End  
& Walk  
BK edge

ALLEY BK 3 (CONT.)

1+10  
 1+00 10.5 RT END CON. PAR. Yd  
 0+89 10.45 RT = L CON PAR. Yd  
 T.P. 3.85 458.66 3.48 454.81 = Large P.K.

IN Pole at L -  
 -ALLEY = 0+68.49  
 #1 P176617

3.55' Ahead of L Alley (on BK Tang. Proj. Ahead) (See Sketch)  
 10.9 LT END ASPH PAR. STA

0+68.49  
 = L in alley  
 9.9 LT = E Pole # P176617 (2.5' BK L OFF E FOR TANG)  
 AT 90° FOR TANG

OF L  
 E.M.H. = 0+70 ahead on BK TANG & Proj. Ahead of L

0+68.49 = L of alley (sect 90° BK TANG)

453.7  
 3.0  
 30  
 451.8  
 6.9  
 20  
 453.30  
 5.7  
 10  
 453.4  
 5.3  
 453.5  
 5.2  
 6  
 453.5  
 5.2  
 6  
 454.2  
 4.5  
 10  
 454.4  
 4.2  
 10.5  
 454.46  
 4.2  
 10.4  
 2nd CON  
 454.57  
 4.07  
 20  
 CON  
 454.66

452.61  
 5.68  
 25  
 on  
 ASPH.  
 453.31  
 4.98  
 10.9  
 edge  
 ASPH.  
 452.3  
 6.0  
 25  
 453.3  
 5.0  
 10  
 453.22  
 5.07  
 453.4  
 4.8  
 10

452.27  
 6.02  
 25  
 (Asph)  
 552.62  
 5.67  
 14.1  
 (Asph)  
 452.94  
 5.35  
 14.1  
 CR  
 453.11  
 5.18  
 10.9  
 edge  
 ASPH.  
 453.5  
 4.8  
 10  
 5.07  
 453.22  
 453.5  
 4.8  
 10  
 453.5  
 4.8  
 19  
 454.27  
 4.02  
 19.3  
 edge  
 CON  
 454.46  
 3.83  
 30  
 2nd  
 CON

458.29

Alley BIR #3 (cont.)

2154.5 10' LT END C. Lay Pav, Yd.

2150

2124 E 995. 32' LT

2114 E 995. 32' LT

2105.5 9.0' LT E Pa/e JP176618

2100

1475 E 3.5 Can Walk 10.5' RT

1259.3 98 4' Bog Cold-Lay Pav yd. - irreg. edge along Alley

1157 E 2.5 Can Walk 8.6 LT

1150

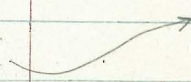

4.4386	LT.	E	RT
4.80	5.11		
20	10		
C. Lay	E. C. Lay		
	4.53.91		
	4.75	5.08	4.53.6
	20	10	4.54.7
	C. Lay	E. C. Lay	20
			4.53.58
			4.53.6

4.54.16	4.53.75
4.50	4.71
32	10# (irreg.)
Fl.	edge
	C. Lay
4.54.16	4.53.76
4.50	1.90
32	10# (irreg.)
Fl.	edge
	C. Lay

4.54.06	4.53.7
4.60	4.53.5
20	10
C. Lay	edge
	9rd
	4.53.8
	4.9
	10
	5.0

4.54.31	4.53.80
4.35	4.86
20	10
on Walk	Fl.
4.54.13	4.53.80
4.66	4.53.80
8.6	
211	

4.55.4	4.53.5	4.53.4
3.3	4.50	5.3
20	10	6
		4.53.9
		4.55.4
		4.53.7
		3.3
		3.0
		20

4.58.66

ALLEY BIK #3 (CONT)

4450

4426

E 10.4 RT, 2' CON WALK

4405.5

7.5 RT & 48" EUCALYPTUS TREE

4400

3480

E 10' RT 2.8 CON WALK

3457

E 10.1 LT 3.5' wide & 2.3' deep CON Landing 8.5 Steps  
(depth 0.80' } steps  
Rise = 1.0' }

3455

9.6 LT & Pole # P176327

3450

T.P

4.41 458.14 4.93 453.73

3400

447.5  
9.2  
25  
= Per grid  
1' ahead  
on station

446.2  
12.5  
25

LT  
49  
10  
453.8

453.5

RT  
5.0  
10  
453.7

4.7  
20  
454.0

453.51  
5.15  
10.4  
up

4.75  
20  
walk

453.91

445.6  
13.1  
25

46  
10  
454.1

5.0  
6  
453.7

5.1  
453.6

5.2  
10  
453.5

5.0  
20  
453.7

549.44  
49.2  
10  
up

453.34  
8K  
2.4

453.24  
Edge  
Landing

453.71  
4.87  
20  
walk

9.22  
15.4  
causing  
Butt Step

5.32  
12.4  
BK  
2.4

5.42  
10.1  
Edge  
Landing

449.8  
8.9  
25

453.7  
5.0  
10

454.3  
4.4  
8

453.9  
4.8

453.0  
4.7  
10

454.3  
4.4  
20

450.9  
7.8  
25

453.1  
5.6  
10

453.4  
5.3  
8

458.14  
5.1  
453.6

453.6  
5.1  
10

454.3  
4.4  
10

454.7  
4.1  
20

Alley BIK #3 (CONT)

LT. E RT.

6+28.59 of Fly Line Rolando - NLY  
995 RT = CB END, WEDGE A.C. Pav.

6+00

5+86.5 10' LT E CON Landing + Step (3.5 wide)

5+50

5+19.01  $\angle$  alley (90° to For. Tang.)  
Sect.

T.P 5.82 459.37 4.59 453.55

10' Ahead  $\angle$  Alley ON E BK TANG. (outs 90° BK TANG.)

5+19.01 0.3' LT E M.H  
 $\angle$  Alley

5+00

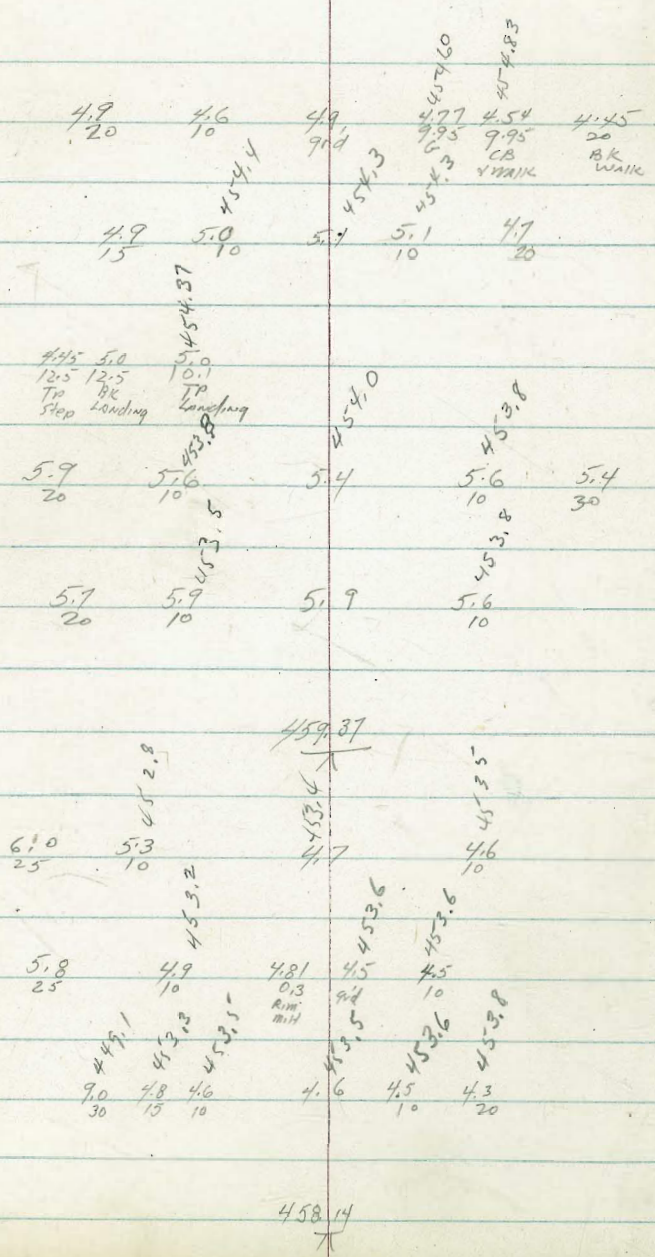



ALLEY BIK 3 (CONT.)

LT.      E      RT.

CHK1

0.21 459.16 = 459.13 =

T.B.M TP. FIRE-HYD S'LY Rolando (described as SWLY)  
CB, RT. + SHANNON (INF 904)  
[F.B 904 WATER-DEPT  
Pg 48]

6+52.5#

= E'LY CB LINE (S'LY) outs to LT. Along CB  
Line (BUILT str. CURVE)  
to show grade 90ft.

6.21 6.90 5.42 6.08 4.99 5.58 5.56 5.37 5.16  
125 125 50 50 12 12 10 10  
CB C CB C EC EC P.I.  
CB C

6+51

10' LT = ALLEY B.C.

5.02 5.52  
10 10  
CB 90T

6+43.8

= E'LY CB LINE (N'LY)  
Rolando

4.94 5.34 5.41 5.35 5.31 4.75 4.93 4.57 3.95  
9.75 9.95 10 10 12 50 50 100 no  
CB C P.I. EC CB C CB C

3 6+41.3

9.9 RT = ALLEY B.C.

4.5 4.58  
4 5 4.37  
4.79 5.00  
10 10  
CB 90T

5.28 4.72  
9.9 9.9  
Cut. CB

6+32.6

10' LT = CB END of Edge A.C.

4.5 4.45

3 6+30.7

= Edge A.C. at E - Pav. on Diag.

4.9 4.92  
2.4 Edge A.C.  
E  
459.37

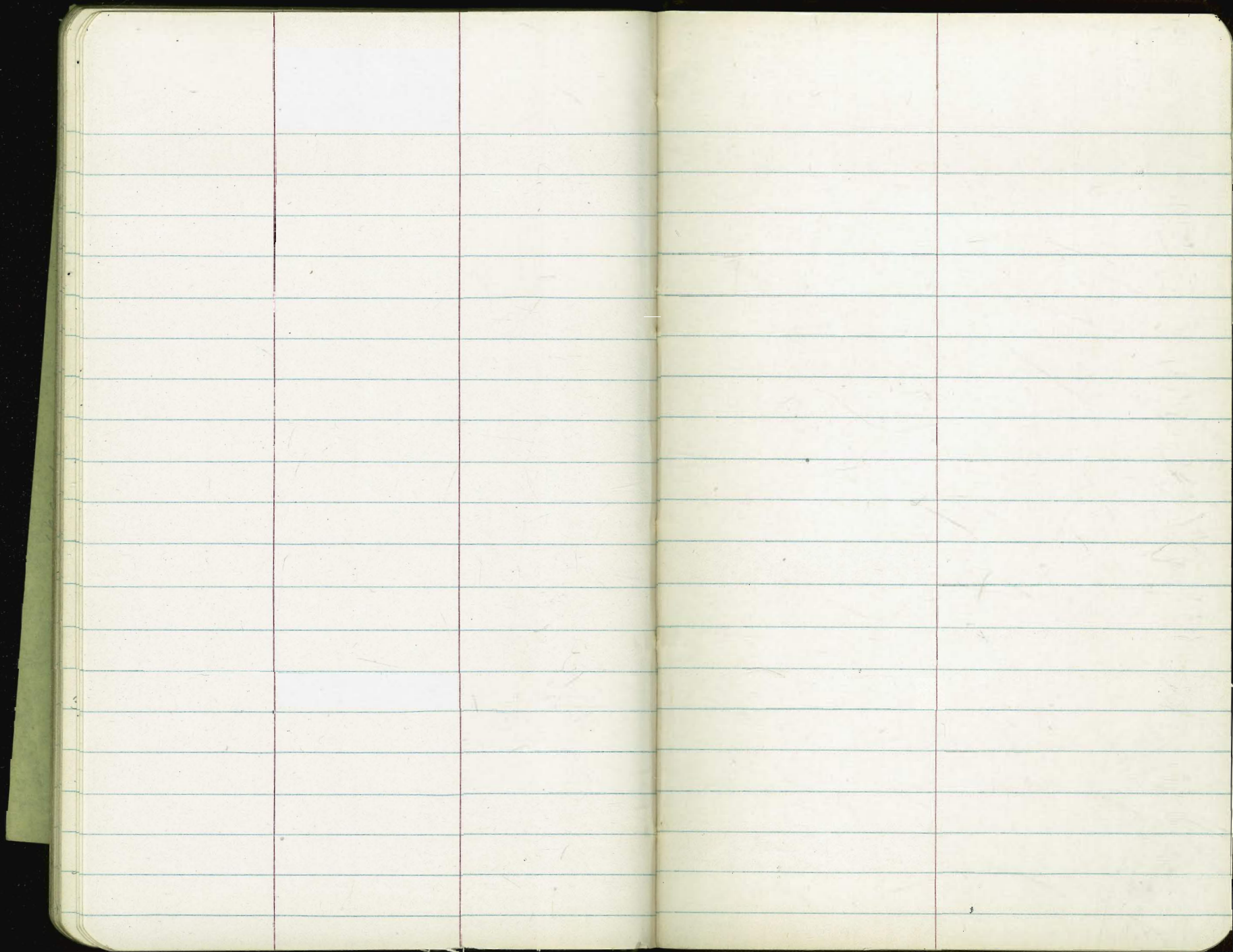

46-71+0000. NWBP. 351.23

SEBP Sr. Look 4/Imperial  
E1. 118.38

0  
1  
2  
3  
4  
5  
6  
7  
8  
9  
10  
11  
12  
13  
14  
15  
16  
17  
18  
19  
20  
21  
22  
23  
24  
25  
26  
27  
28  
29  
30  
31  
32  
33  
34  
35  
36  
37  
38  
39  
40  
41  
42  
43  
44  
45  
46  
47  
48  
49  
50

+ 5.58

20.69 To Disk

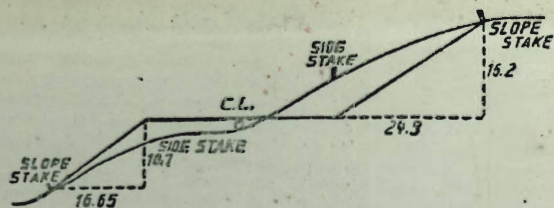

**DISTANCES FROM SIDE STAKES FOR CROSS-SECTIONING.**

**SLOPE 1 1/2 TO 1. ROADWAY OF ANY WIDTH.**

	0	.1	.2	.3	.4	.5	.6	.7	.8	.9	
0	0.00	0.15	0.30	0.45	0.60	0.75	0.90	1.05	1.20	1.35	0
1	1.50	1.65	1.80	1.95	2.10	2.25	2.40	2.55	2.70	2.85	1
2	3.00	3.15	3.30	3.45	3.60	3.75	3.90	4.05	4.20	4.35	2
3	4.50	4.65	4.80	4.95	5.10	5.25	5.40	5.55	5.70	5.85	3
4	6.00	6.15	6.30	6.45	6.60	6.75	6.90	7.05	7.20	7.35	4
5	7.50	7.65	7.80	7.95	8.10	8.25	8.40	8.55	8.70	8.85	5
6	9.00	9.15	9.30	9.45	9.60	9.75	9.90	10.05	10.20	10.35	6
7	10.50	10.65	10.80	10.95	11.10	11.25	11.40	11.55	11.70	11.85	7
8	12.00	12.15	12.30	12.45	12.60	12.75	12.90	13.05	13.20	13.35	8
9	13.50	13.65	13.80	13.95	14.10	14.25	14.40	14.55	14.70	14.85	9
10	15.00	15.15	15.30	15.45	15.60	15.75	15.90	16.05	16.20	16.35	10
11	16.50	16.65	16.80	16.95	17.10	17.25	17.40	17.55	17.70	17.85	11
12	18.00	18.15	18.30	18.45	18.60	18.75	18.90	19.05	19.20	19.35	12
13	19.50	19.65	19.80	19.95	20.10	20.25	20.40	20.55	20.70	20.85	13
14	21.00	21.15	21.30	21.45	21.60	21.75	21.90	22.05	22.20	22.35	14
15	22.50	22.65	22.80	22.95	23.10	23.25	23.40	23.55	23.70	23.85	15
16	24.00	24.15	24.30	24.45	24.60	24.75	24.90	25.05	25.20	25.35	16
17	25.50	25.65	25.80	25.95	26.10	26.25	26.40	26.55	26.70	26.85	17
18	27.00	27.15	27.30	27.45	27.60	27.75	27.90	28.05	28.20	28.35	18
19	28.50	28.65	28.80	28.95	29.10	29.25	29.40	29.55	29.70	29.85	19
20	30.00	30.15	30.30	30.45	30.60	30.75	30.90	31.05	31.20	31.35	20
21	31.50	31.65	31.80	31.95	32.10	32.25	32.40	32.55	32.70	32.85	21
22	33.00	33.15	33.30	33.45	33.60	33.75	33.90	34.05	34.20	34.35	22
23	34.50	34.65	34.80	34.95	35.10	35.25	35.40	35.55	35.70	35.85	23
24	36.00	36.15	36.30	36.45	36.60	36.75	36.90	37.05	37.20	37.35	24
25	37.50	37.65	37.80	37.95	38.10	38.25	38.40	38.55	38.70	38.85	25
26	39.00	39.15	39.30	39.45	39.60	39.75	39.90	40.05	40.20	40.35	26
27	40.50	40.65	40.80	40.95	41.10	41.25	41.40	41.55	41.70	41.85	27
28	42.00	42.15	42.30	42.45	42.60	42.75	42.90	43.05	43.20	43.35	28
29	43.50	43.65	43.80	43.95	44.10	44.25	44.40	44.55	44.70	44.85	29
30	45.00	45.15	45.30	45.45	45.60	45.75	45.90	46.05	46.20	46.35	30
31	46.50	46.65	46.80	46.95	47.10	47.25	47.40	47.55	47.70	47.85	31
32	48.00	48.15	48.30	48.45	48.60	48.75	48.90	49.05	49.20	49.35	32
33	49.50	49.65	49.80	49.95	50.10	50.25	50.40	50.55	50.70	50.85	33
34	51.00	51.15	51.30	51.45	51.60	51.75	51.90	52.05	52.20	52.35	34
35	52.50	52.65	52.80	52.95	53.10	53.25	53.40	53.55	53.70	53.85	35
36	54.00	54.15	54.30	54.45	54.60	54.75	54.90	55.05	55.20	55.35	36
37	55.50	55.65	55.80	55.95	56.10	56.25	56.40	56.55	56.70	56.85	37
38	57.00	57.15	57.30	57.45	57.60	57.75	57.90	58.05	58.20	58.35	38
39	58.50	58.65	58.80	58.95	59.10	59.25	59.40	59.55	59.70	59.85	39
40	60.00	60.15	60.30	60.45	60.60	60.75	60.90	61.05	61.20	61.35	40
41	61.50	61.65	61.80	61.95	62.10	62.25	62.40	62.55	62.70	62.85	41
42	63.00	63.15	63.30	63.45	63.60	63.75	63.90	64.05	64.20	64.35	42
43	64.50	64.65	64.80	64.95	65.10	65.25	65.40	65.55	65.70	65.85	43
44	66.00	66.15	66.30	66.45	66.60	66.75	66.90	67.05	67.20	67.35	44
45	67.50	67.65	67.80	67.95	68.10	68.25	68.40	68.55	68.70	68.85	45
46	69.00	69.15	69.30	69.45	69.60	69.75	69.90	70.05	70.20	70.35	46
47	70.50	70.65	70.80	70.95	71.10	71.25	71.40	71.55	71.70	71.85	47
48	72.00	72.15	72.30	72.45	72.60	72.75	72.90	73.05	73.20	73.35	48
49	73.50	73.65	73.80	73.95	74.10	74.25	74.40	74.55	74.70	74.85	49
50	75.00	75.15	75.30	75.45	75.60	75.75	75.90	76.05	76.20	76.35	50

THE NATIONAL BLANK BOOK COMPANY

HOLYOKE

MASSACHUSETTS

MASSACHUSETTS

NEW YORK

CHICAGO

BOSTON

SAN FRANCISCO