

Please Return To
 CITY ENGINEER
 CIVIC Center,
 SAN Diego

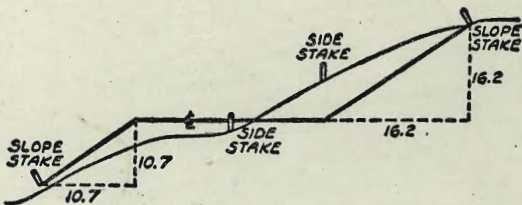

DISTANCES FROM SIDE STAKES FOR CROSS-SECTIONING
 SLOPE 1 TO 1. ROADWAY OF ANY WIDTH

	0	.1	.2	.3	.4	.5	.6	.7	.8	.9	
0	0.00	0.10	0.20	0.30	0.40	0.50	0.60	0.70	0.80	0.90	0
1	1.00	1.10	1.20	1.30	1.40	1.50	1.60	1.70	1.80	1.90	1
2	2.00	2.10	2.20	2.30	2.40	2.50	2.60	2.70	2.80	2.90	2
3	3.00	3.10	3.20	3.30	3.40	3.50	3.60	3.70	3.80	3.90	3
4	4.00	4.10	4.20	4.30	4.40	4.50	4.60	4.70	4.80	4.90	4
5	5.00	5.10	5.20	5.30	5.40	5.50	5.60	5.70	5.80	5.90	5
6	6.00	6.10	6.20	6.30	6.40	6.50	6.60	6.70	6.80	6.90	6
7	7.00	7.10	7.20	7.30	7.40	7.50	7.60	7.70	7.80	7.90	7
8	8.00	8.10	8.20	8.30	8.40	8.50	8.60	8.70	8.80	8.90	8
9	9.00	9.10	9.20	9.30	9.40	9.50	9.60	9.70	9.80	9.90	9
10	10.00	10.10	10.20	10.30	10.40	10.50	10.60	10.70	10.80	10.90	10
11	11.00	11.10	11.20	11.30	11.40	11.50	11.60	11.70	11.80	11.90	11
12	12.00	12.10	12.20	12.30	12.40	12.50	12.60	12.70	12.80	12.90	12
13	13.00	13.10	13.20	13.30	13.40	13.50	13.60	13.70	13.80	13.90	13
14	14.00	14.10	14.20	14.30	14.40	14.50	14.60	14.70	14.80	14.90	14
15	15.00	15.10	15.20	15.30	15.40	15.50	15.60	15.70	15.80	15.90	15
16	16.00	16.10	16.20	16.30	16.40	16.50	16.60	16.70	16.80	16.90	16
17	17.00	17.10	17.20	17.30	17.40	17.50	17.60	17.70	17.80	17.90	17
18	18.00	18.10	18.20	18.30	18.40	18.50	18.60	18.70	18.80	18.90	18
19	19.00	19.10	19.20	19.30	19.40	19.50	19.60	19.70	19.80	19.90	19
20	20.00	20.10	20.20	20.30	20.40	20.50	20.60	20.70	20.80	20.90	20
21	21.00	21.10	21.20	21.30	21.40	21.50	21.60	21.70	21.80	21.90	21
22	22.00	22.10	22.20	22.30	22.40	22.50	22.60	22.70	22.80	22.90	22
23	23.00	23.10	23.20	23.30	23.40	23.50	23.60	23.70	23.80	23.90	23
24	24.00	24.10	24.20	24.30	24.40	24.50	24.60	24.70	24.80	24.90	24
25	25.00	25.10	25.20	25.30	25.40	25.50	25.60	25.70	25.80	25.90	25
26	26.00	26.10	26.20	26.30	26.40	26.50	26.60	26.70	26.80	26.90	26
27	27.00	27.10	27.20	27.30	27.40	27.50	27.60	27.70	27.80	27.90	27
28	28.00	28.10	28.20	28.30	28.40	28.50	28.60	28.70	28.80	28.90	28
29	29.00	29.10	29.20	29.30	29.40	29.50	29.60	29.70	29.80	29.90	29
30	30.00	30.10	30.20	30.30	30.40	30.50	30.60	30.70	30.80	30.90	30
31	31.00	31.10	31.20	31.30	31.40	31.50	31.60	31.70	31.80	31.90	31
32	32.00	32.10	32.20	32.30	32.40	32.50	32.60	32.70	32.80	32.90	32
33	33.00	33.10	33.20	33.30	33.40	33.50	33.60	33.70	33.80	33.90	33
34	34.00	34.10	34.20	34.30	34.40	34.50	34.60	34.70	34.80	34.90	34
35	35.00	35.10	35.20	35.30	35.40	35.50	35.60	35.70	35.80	35.90	35
36	36.00	36.10	36.20	36.30	36.40	36.50	36.60	36.70	36.80	36.90	36
37	37.00	37.10	37.20	37.30	37.40	37.50	37.60	37.70	37.80	37.90	37
38	38.00	38.10	38.20	38.30	38.40	38.50	38.60	38.70	38.80	38.90	38
39	39.00	39.10	39.20	39.30	39.40	39.50	39.60	39.70	39.80	39.90	39
40	40.00	40.10	40.20	40.30	40.40	40.50	40.60	40.70	40.80	40.90	40
41	41.00	41.10	41.20	41.30	41.40	41.50	41.60	41.70	41.80	41.90	41
42	42.00	42.10	42.20	42.30	42.40	42.50	42.60	42.70	42.80	42.90	42
43	43.00	43.10	43.20	43.30	43.40	43.50	43.60	43.70	43.80	43.90	43
44	44.00	44.10	44.20	44.30	44.40	44.50	44.60	44.70	44.80	44.90	44
45	45.00	45.10	45.20	45.30	45.40	45.50	45.60	45.70	45.80	45.90	45
46	46.00	46.10	46.20	46.30	46.40	46.50	46.60	46.70	46.80	46.90	46
47	47.00	47.10	47.20	47.30	47.40	47.50	47.60	47.70	47.80	47.90	47
48	48.00	48.10	48.20	48.30	48.40	48.50	48.60	48.70	48.80	48.90	48
49	49.00	49.10	49.20	49.30	49.40	49.50	49.60	49.70	49.80	49.90	49
50	50.00	50.10	50.20	50.30	50.40	50.50	50.60	50.70	50.80	50.90	50

Distance of slope stake from side or shoulder stake for any width roadway, slope 1 to 1. If ground is nearly level, the cut or fill at side stake is located by the double entry method in left column and top row. The number in body of table in same row and column gives distance from side stake to slope stake. If ground is not level estimate the difference in elevation between the side stake and slope stake, lower target by this amount if cut, elevate if fill. Add this amount to cut or fill and find distance in table. Set up rod at this point, and line of sight should cut target. If it does not make the slight adjustment necessary.

Roberts Preliminary Survey For Storm Drain
 Cota Moore
 Mocaloz
 12-9-53
 W.O. #32288

"A" § 18th to "K" § 13th

SWITZER DRAIN

INDEXED
 HER
 DEF 18-3

CONTROL POINTS AND STATIONS: →

- Set PK Nails in AC Paving.
- Set Chisel Crosses in Conc. Paving.

Locations at Curves made off
 of Semi-tangents - per Simonds.

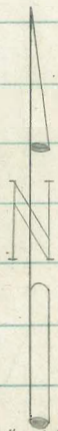

Scale: 1" = 60'

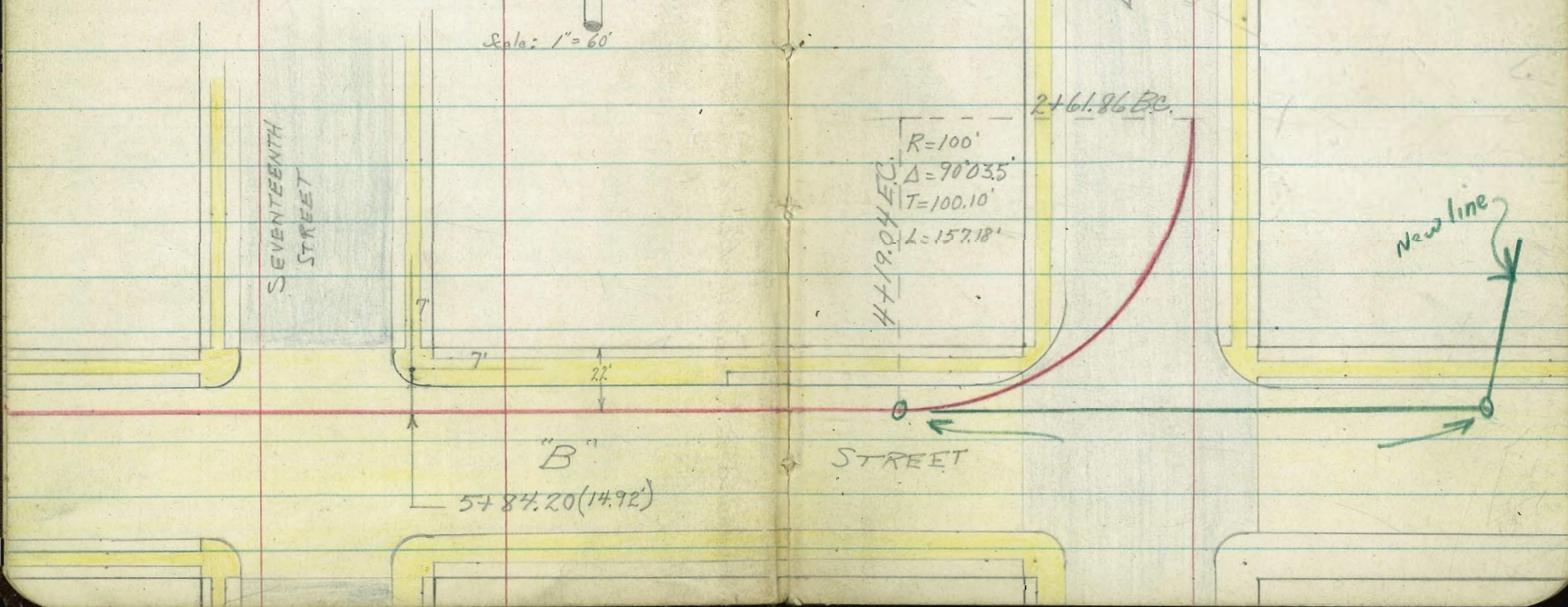

"B" STREET

7+79.52BC

R=100
Δ=90°00.5'
L=157.09'
T=100.01'
9+36.61EC

STREET

SIXTEENTH

1/22

"C"

STREET

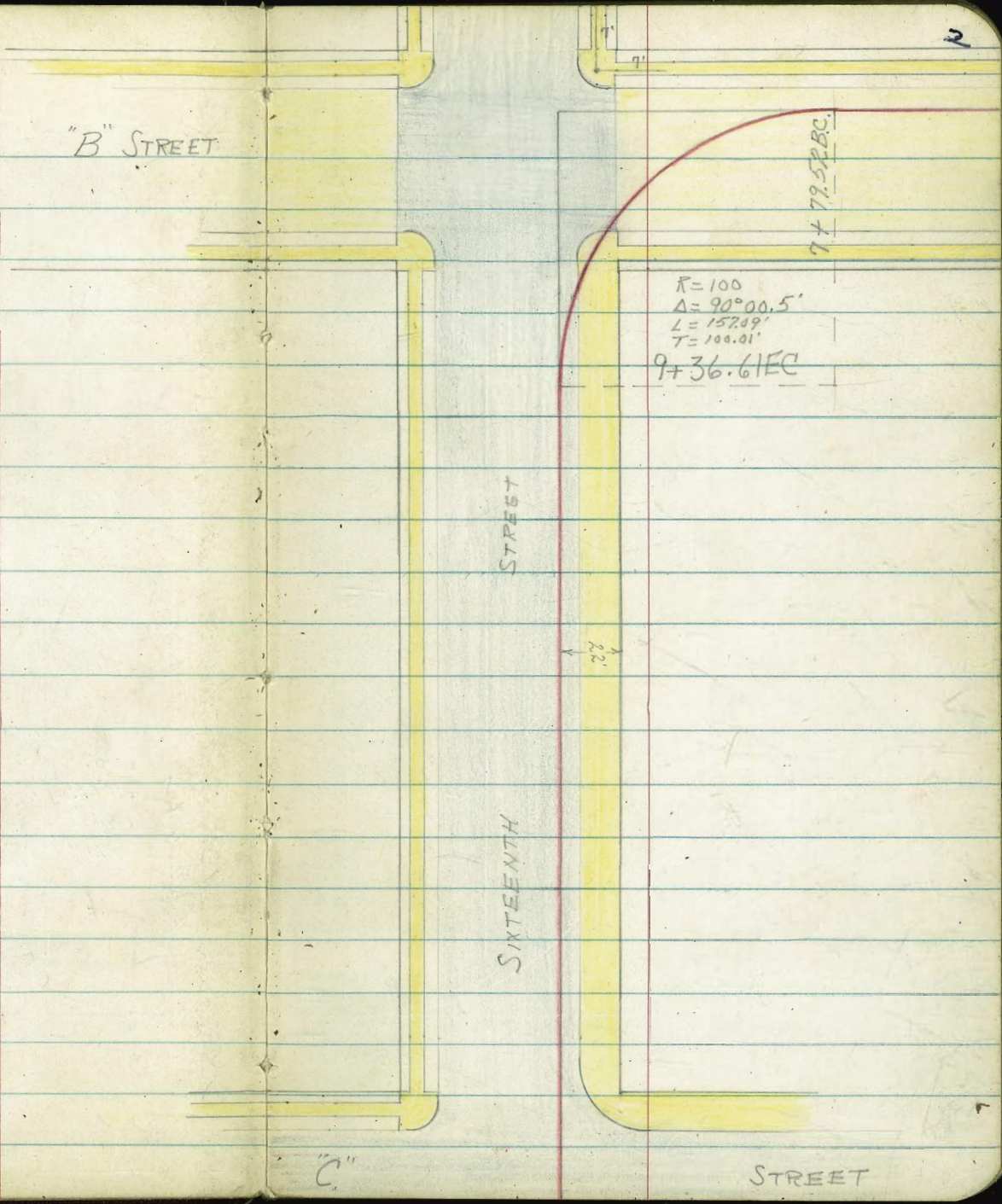

"C"

12+67.69
(50.96)

STREET

3

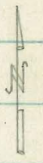

SIXTEENTH STREET

SIXTEENTH STREET

Chaining Bull!

Eq. $\left\{ \begin{array}{l} 14+76.15 BC \uparrow \\ 14+78.15 BC \downarrow \end{array} \right.$

$R = 130'$
 $\Delta = 90^\circ 01.2'$
 $T = 130.05'$
 $L = 204.25'$

16+82.40 EC.

FIFTEENTH STREET

18+17.63
(41.94)

31'

BROADWAY

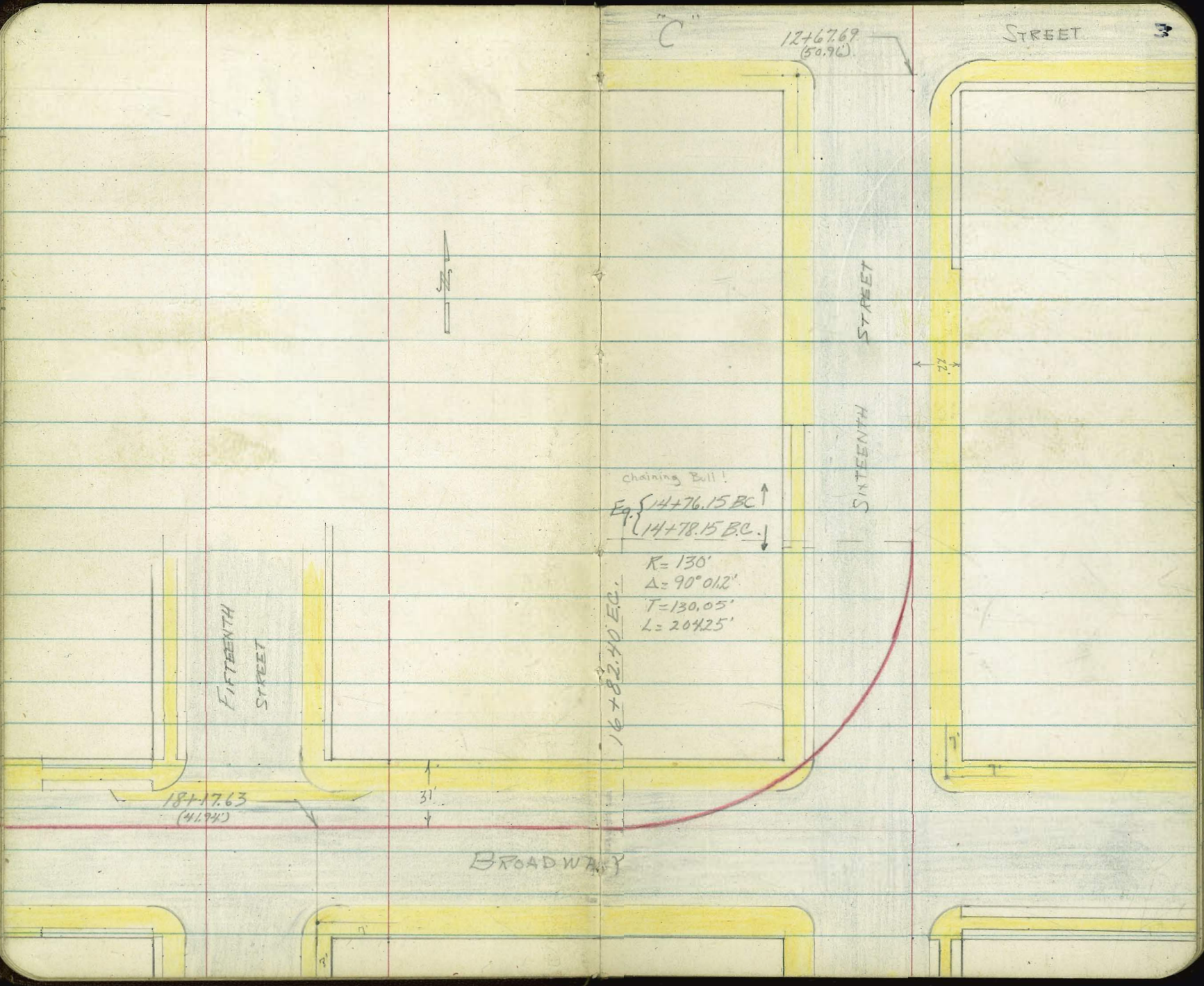

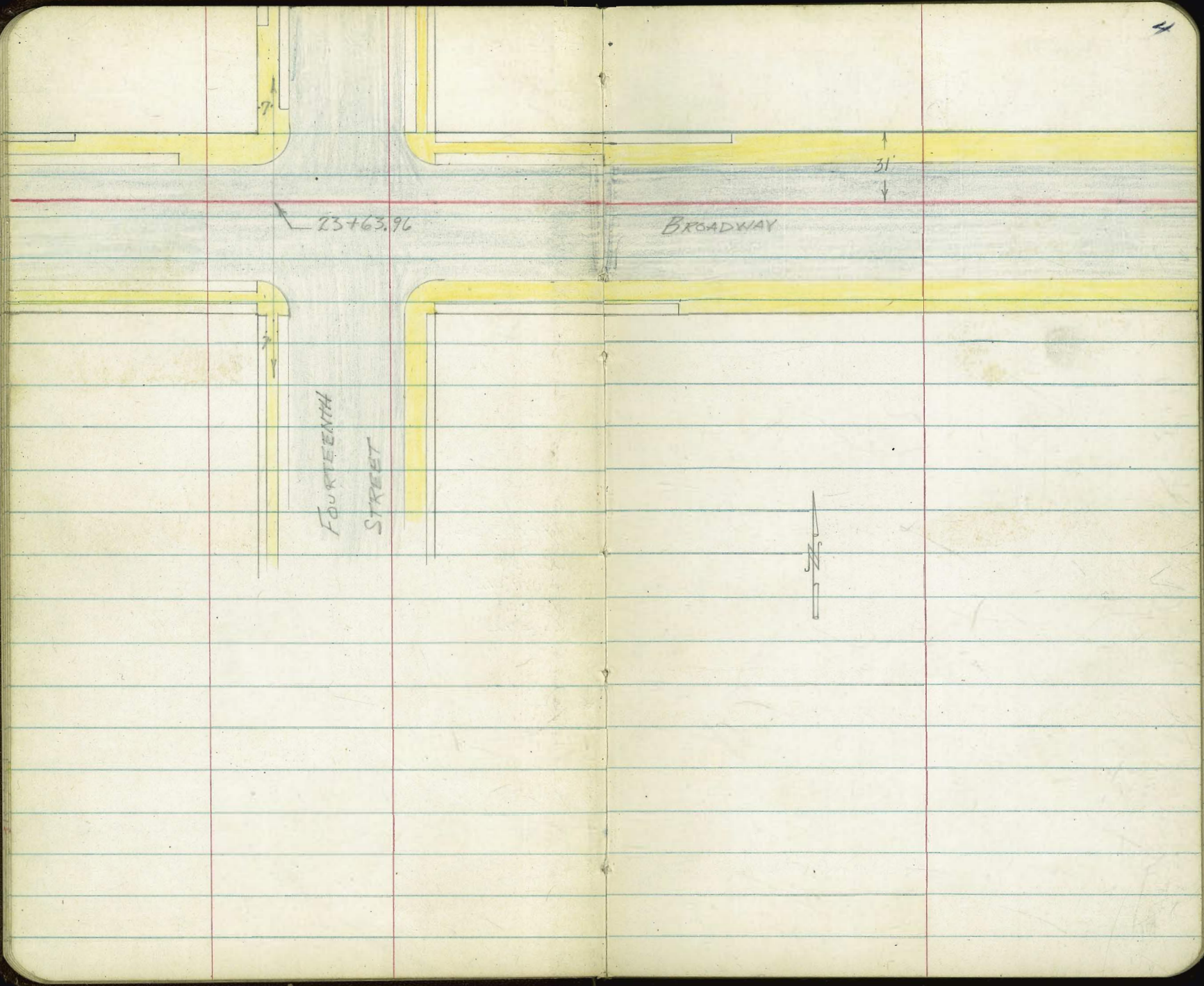

23+63.96

BROADWAY

FOURTEENTH
STREET

N
S

31

7

7

80
31
49
100
51

BROADWAY

$R=100'$
 $\Delta=90^{\circ}01.8'$
 $T=100.05'$
 $L=157.13'$

25728.85 EC.

26785.98 EC.

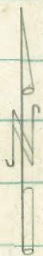

THIRTEENTH STREET

THIRTEENTH STREET

"E"

STREET

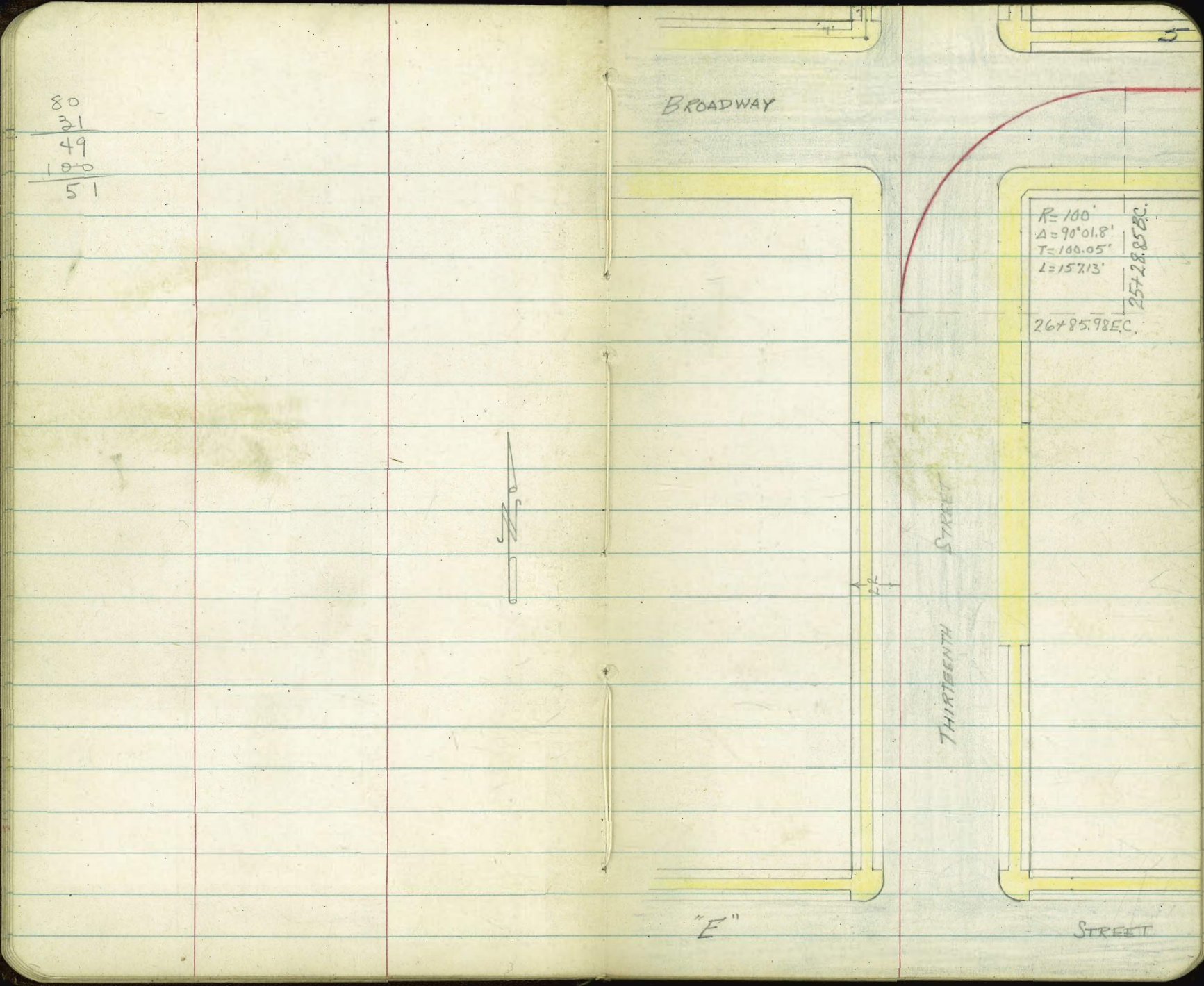

"E"

30+08.33 STREET

30+08.33
73
29+35.33

28+12

+18.8

THIRTEENTH STREET

THIRTEENTH STREET

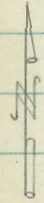

"F" STREET

33+88.62 (18.10)

"G"

STREET

37+68.80 (15.04)

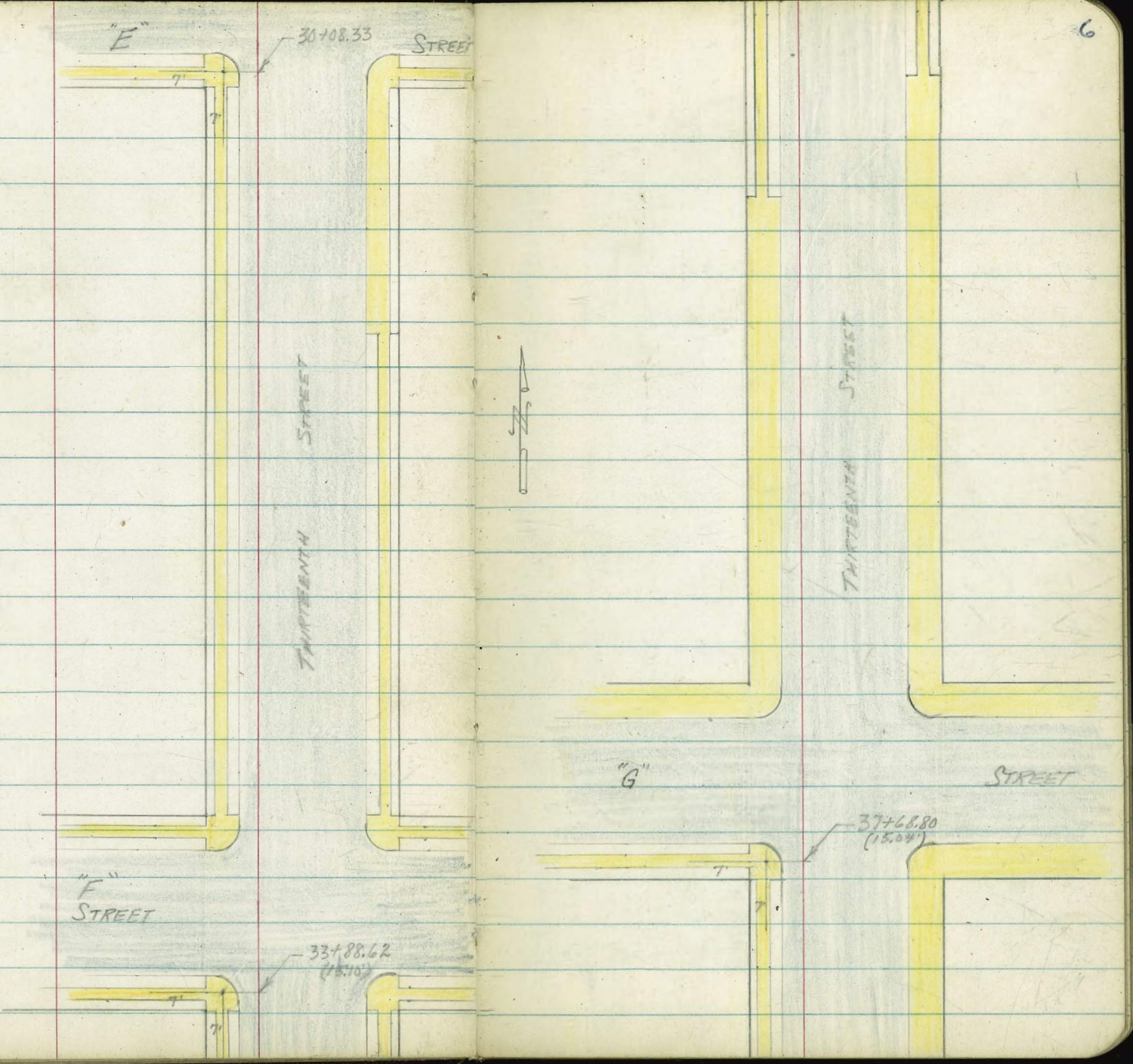

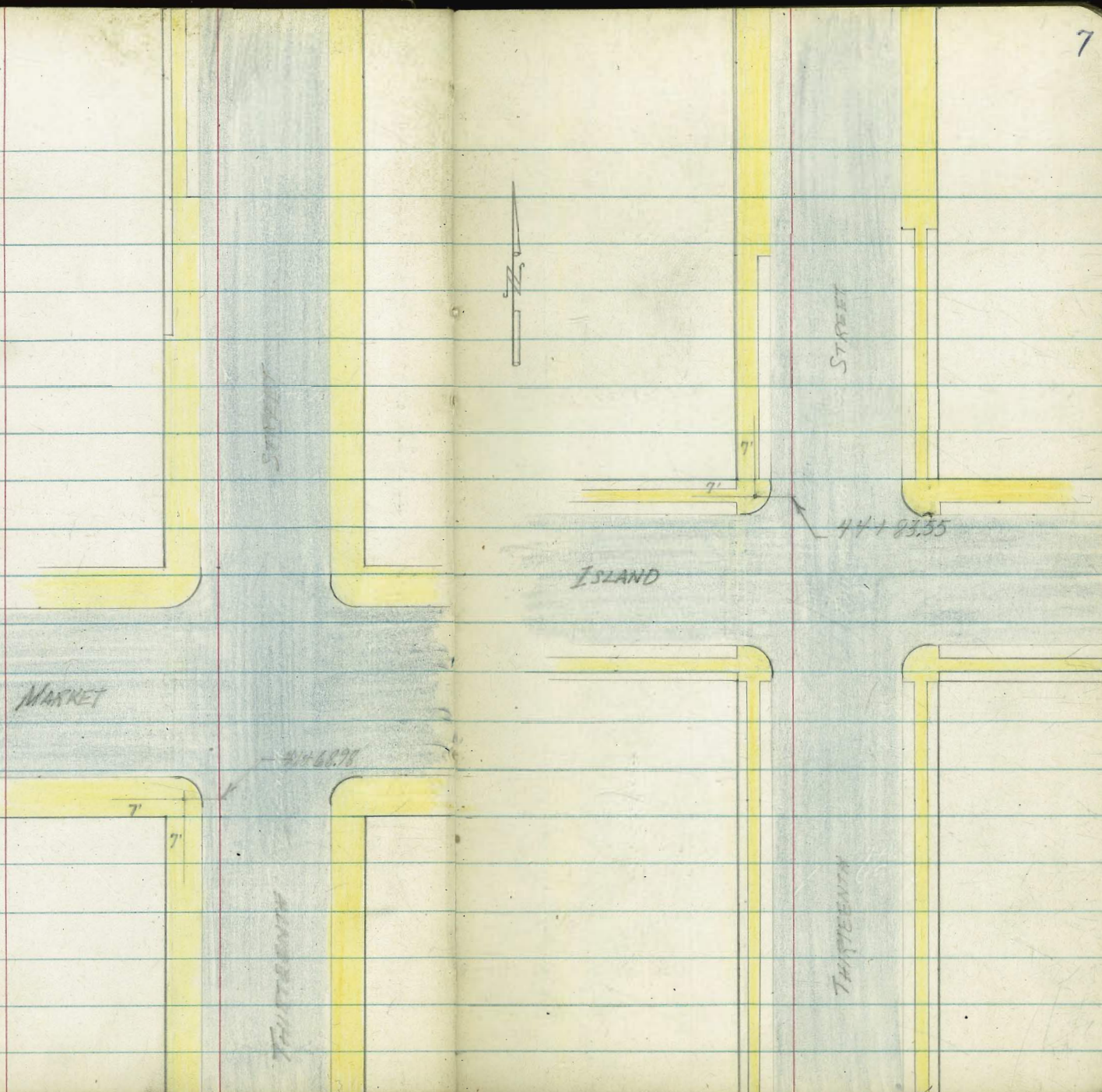

STREET

STREET

ISLAND

MARKET

441 68.76

441 83.55

THIRTEENTH

THIRTEENTH

7'

7'

7'

7'

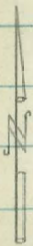

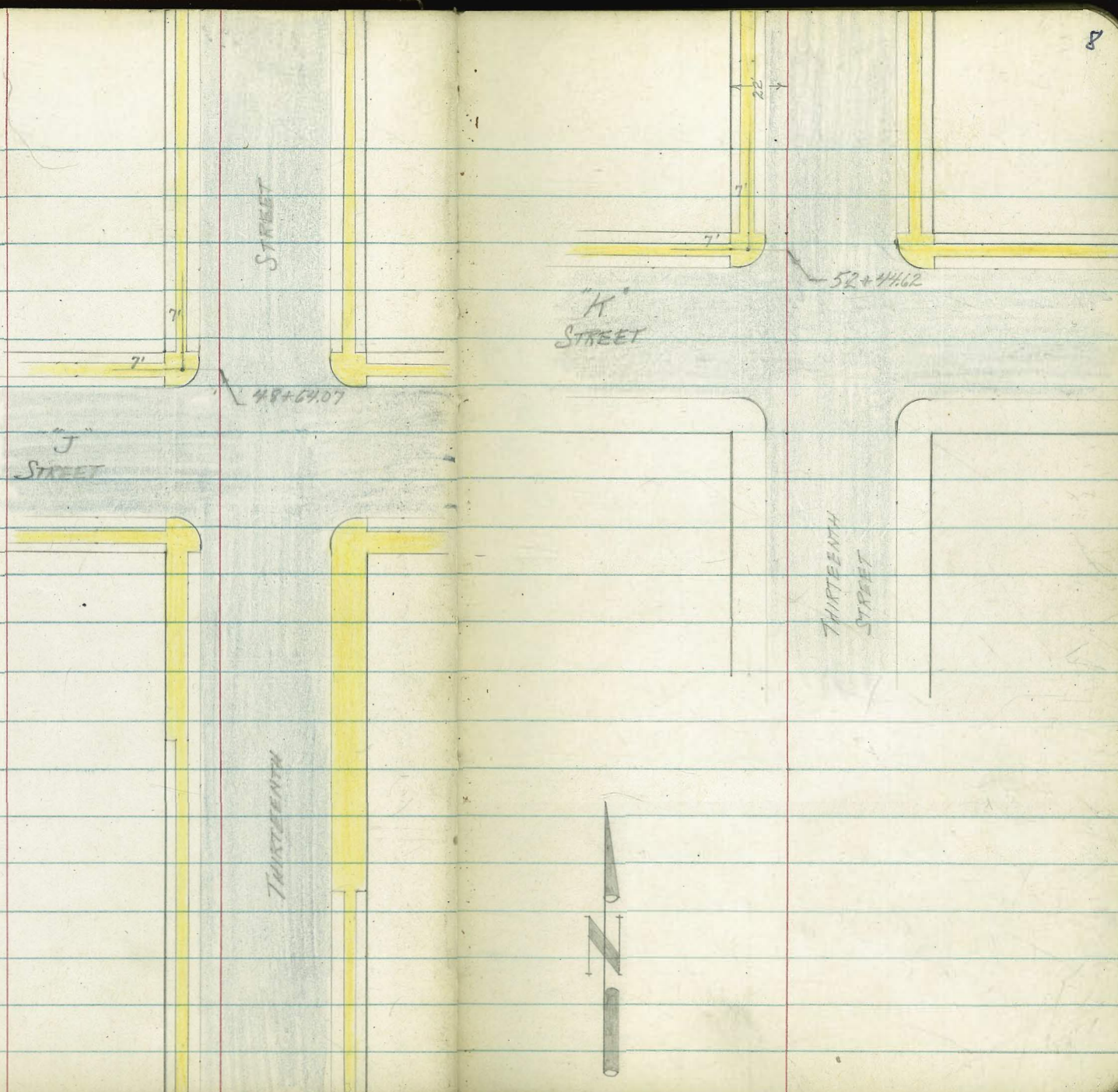

0+41 9⁸ Lt to center F.P. #2

0+36 Opposite Curb BR.

0+10 { 59 Rt to water gate
crossg of old ditch (water)

0+04.5 3 Rt to water gate

0+00 Q "A" STREET

0-60 18 Rt to center MH

85.52
5.15
8
cb

84.92
5.18
8
Gvt

85.22
5.43

85.22
5.38
6

85.52
5.06
9

85.22
4.84

85.22
4.92
6

80.65
10.80
18
INVERT

T.P. 6.73 90.65[✓] 2.98 83.92[✓]

90.65[✓]

T.P. 13.21 86.90[✓] 0.05 73.69[✓]

T.P. 10.94 73.74[✓] 8.09 62.80[✓]

B.M. 0.66 70.87[✓] 70.23 20th FB

SEBP

Contd From Page 9

Lt.

2

Rt.

10

1740 & 1741 2-4" Drains in curb.

1738 Gas lateral on right

1716 Water meter on left.

1700

81.97	81.75	81.25	82.02
868	920	8.75	8.56
8	8		6
Cb	cut		

0+94 46' Rt to Speed Limit Sign

0+92 Gas Line on right

0+89 Water meter on Right

0+78 4" Drain in curb on Right. Most of these drains are outlets from roof drains, crossing under walk.

0+64.5 Water Meter on Left

0+50

87.96	87.72	87.72	87.83
5.69	6.28	5.73	6.82
8	8		6
Cb	cut		

90.15π

90.65π

Cont'd From Page 10

Lt

C

Rt

11

2+60.4 { 29^E Rt to traffic Plate Near Edge
20^E Rt to Traffic Plate Near Edge

2+24 Water meter on left

2+19 Gas Lateral on left

2+13.5 { 9^E Lt to Deadman
45 Rt to No Parking sign

2+00

76.16	75.65	76.11	76.27
3.00	3.51	3.05	2.89
8	8		6
cb	cut		

T.P. 1.42 77.16^A 12.91 77.74^v

77.16^A^v

1+90 { 10 Lt to center P.Pole # JP1251
46 Rt to center P.Pole # P1248

1+60 Water Meter on right.

1+55 10 Lt No Parking Sign

1+50

79.03	78.56	79.00	79.23
11.62	12.09	11.65	11.43
8	8		6
cb	cut		

90.65^A

90.65^A

Cont'd From Page 11

Lt

£

Rt

12

7.P 9.20 77.52K 10.84 68.32

3+85

67.97	67.50	67.68	68.24	69.36
11.69	11.66	11.78	10.90	10.8
6		28 Gut	22 cb	6

3+60

67.65	67.89	67.68	68.21
11.51	11.67	11.48	10.95
6		6 Gut	6 cb

3+50

68.08	68.13	68.05
11.08	11.07	11.11
6		6

3+25

69.05	69.35	69.52
10.11	9.81	9.63
6		6

3+00

70.13	70.30	70.26
9.03	8.66	8.40
6		6

2+61.86 B.C.

71.80	72.87	72.21
Drive 7.18	6.69	6.45
8		6
cb 6x		

79.16K

79.16K

Contd From Page 12

Lt

E

Rt

13

PI plus 9 34^E Left to water gate

P.I. plus 4 28 Left to water gate

BC plus 78^E 11^E Left to ^{Traffic.} street signal

BC plus 46 45 Right No. Parking Sign

BC plus 39^E 10 Left to center T.Pole # 517290H

BC plus 28 46 Right to center P.Pole # 1210

BC plus 22.5 46^E Rt to center 15" Palm

BC plus 2.3 Water Meter on Right

BC plus 0.5 Pull Box back ch on Right

4119.04 EC.

7752K

687

687

687

687

939

935

935

861

6

8

8

Gvt

CB

7752K ✓

Cont'd From Page 13.

Lt

Q

Rt

14

4+52 water Meter on Right

4+51 45 Left to Pull Box

68.22

68.82

68.60

75.52

4+50

8.75

8.70

8.72

7.96

6

8
9.4

8
0.6

P1 plus 94 water Meter on Right

P1 plus 77 9[±] Right to center T. Pole # 4027604

P1 plus 72 10[±] Right to center 10" Palm

P1 plus 66 11 Right to traffic signal

P1 plus 58 { 46 Left to Street Sign
14[±] Right to Pull Box

P1 plus 46 55[±] Left to ^{Traffic} Street Signal

P.I. plus 18 57 Left to MH

58.96

57

INVERT
ELEVATION

77.52 π

77.52 π

Contd From Page 14

Lt

C

Rt

15

5+50

7025
6.77
6

7082
6.70

7072
6.73
8
6.4

Drive
8
Cb

5+47

Gas Lateral on Right

5+29.5

Water on Right

5+22

46 Lt to center P.Pole # 1749

5+19.5

4" Drain in Curb Right

5+18

Gas Lateral Right

5+06.5

Rt Water Meter

5+00

6969

6923

7.83
6

7.79

6923
7.79
8
6.4

7021
7.11
8
Cb

4+85

Rt 4" Drain in Curb

4+76.5

9^E Rt to center T.Pole # JP 1730

4+56

{ 29^E Lt to Near Edge of Traffic Plate
20^E Lt

7752X

7752X^v

6+53.7 3 Left to Gas Valve

6+53.2 Opposite Curb BC

6+43.2

6+17.5 59 Lt to MH

6+09 58 Lt to Water gate

5+91.2

5+81.2 Opposite Curb BC

5+75 95 Rt to center T. Pole # 02937 TT

7/29	7/21	7/27	7/23
6.13	6.11	6.15	5.50
6		8 Gut	8 CB

7/16	7/22	7/20
6.36	6.30	6.22
6		6

62.65	59	5.83	5.57
59	6		6
INVERT ELEVATION			

7/11	7/21	7/27
6.41	6.31	6.23
6		6

7/29	7/20	7/27	7/25
6.23	6.12	6.18	5.47
6		8 Gut	8 CB

77.52A

77.52A

Contd. From Page 16

L2

E

R2 17

8+00

73 ³⁰	73 ³⁰	73 ³⁵
718	710	702
6		6

7+79.52 BC.

73 ¹³	73 ²⁰	73 ¹³	73 ²⁰
735	728	735	658
6		8 Gut	8 cb

T.P. 9.22 80.42 A 6.26 71.26

80.42 A

7+63 Water Meter on Right

7+50

72 ⁷²	72 ⁷²	72 ⁷²	72 ⁷²
480	475	473	410
6		8 Gut	8 cb

7+00 9⁵ Rt to center T. Pole # 5 P 1674

72 ⁰³	72 ⁰⁶	72 ⁰⁷	72 ⁷¹
549	546	545	481
6		8 Gut	8 cb

6+72.5 Water Meter on Right

6+58.5 45 ft to Street Sign

77.52 A

77.52 A

Cont'd From Page 17

9+25

Drive 10.30 10.20 10.24
 74 74 6
 cb gut

9+00

71.66 71.65 71.19 71.12 71.25
 8.82 8.82 8.38 9.36 9.23
 6 13 15 6

8+95.3

Leaves Curb

71.93 71.85
 9.15 8.63
 gut cb

8+77.1

Hit Curb

71.63 71.98
 8.85 8.50
 gut cb

8+75

72.12 72.05 71.43 71.68 72.10
 8.36 8.43 8.85 8.80 8.38
 6 25 25 6

8+50

72.20 72.15 72.98
 7.78 7.33 7.00
 6 6

8+25

72.28 72.57 72.23
 7.10 6.91 6.75
 6 6

80.48X

80.48X

Lt

R

Rt 18

PI plus 36.2 { 23⁵ Rt to gate } water
 { 1⁶ Lt to gate }

P.I. plus 26.5 5⁷ Rt to center MH ³⁰ Drain

66.12? you are right
~~76.72~~
5⁴
INVERT
ELEVATION

BC plus 77⁵ 28⁸ Lt to water gate

BC plus 75.0 9⁸ Rt to center T. Pole # 309080H

BC plus 32.0 Water meter on right.

BC plus 18.5 45⁵ Lt to center P. Pole # 1611

BC plus 8.0 9⁵ Rt to center T. Pole # D526RT

BC plus 6.9 4" drain in curb on right

BC. plus 6.8 Gas lateral on right.

9+36.61 EC.

70.87	69.82	64.82	69.81
10.11	10.66	10.66	10.67
8	8		6
cb	Got		

80.48 X

80.48 X ✓

PI plus 76 21[±] Lt to water stand pipe

PI plus 68.5 9[±] Lt to STOP sign

PI plus 64.5 9[±] Lt to center T. Pole # D5970T

PI plus 61.5 45[±] Rt to center P. Pole # 1198

PI plus 61 { 17° Rt to MH
3[±] Rt to water gate
9[±] Lt to center fire hydrant

64.96
17
INVERT
ELEVATION

PI plus 59.5 44" drain in curb

PI plus 58 6° Rt to water gate

PI plus 45-49[±] Rt to center 14" corr. pipe outlet
odd curb Inlet

67.10 ?
77.10
49[±]
INVERT
ELEVATION

P.I. plus 38 { 22 Rt to center MH } See page 66
3[±] Lt to center MH } FB2203

63.97 ?
32
INVERT
ELEVATION

62.77 ?
22
INVERT
ELEVATION

80.48 T

80.48 T

Cont'd From Page 20

T.P. 139 69.27K 12.60 67.88

10+00

9+94.7 45[±] Rt to center P. Pole # 1140

9+93.8 3" drain in curb on left

9+91.6 9[±] Lt to abandoned oil refill.
see pg 65 FB 2203

9+70.5 3" drain in curb on right

9+67 water Meter on right

9+45.6 water Meter on Left

9+43 4" Drain drain on left

P.I. plus 925 4" Drain in curb on right

80.48K

Lt

£

Rt 21

67.88	67.88	67.88	67.88
12.54	13.10	13.00	12.99
8	8		6
67	67		67

80.48K

10+70 Probable Gas lateral on Left

10+59.8 10 Lt to deadman

10+50

	65.92	65.55	65.69
319	385	372	358
8	8		6
cb	Gut		

10+46.6 10 Lt to center P. Pole # P1133

10+44.6 4" drain in curb on right.

10+32.5 Gas lateral on right

10+31.5 4" drain in curb on right

10+16.8 Water Meter on right

10+05 4" drain in curb on left

10+03.5 Water Meter on Left

6927X

6927X

11+77.1 Gas lateral on right:

11+71.5 Water Meter on Right

11+66.5 Water Meter on left

11+60.8 ~~45° Rt~~ to center P. Pole #1110

11+50

62.27	61.23	61.84	62.00
7.00	7.65	7.43	7.27
8	8		6
06	60t		

11+31.5 water meter on right

11+20.8 Water Meter on Left

11+00

69.48	68.53	68.28	67.85
5.07	5.75	5.53	5.42
8	8		6
06	60t		

10+94.5 4" drain in curb on right

10+77 Water Meter on right

6927A

6927A

Contd From Page 23

Lt

R

R

R

12+35

60 20
9.07
6

60 23
9.04

60 24
9.03
6

12+10.5

41

Rt to near edge drain (2" x 2")
^{14" pipe outlet}

55 65
13.62
41
INVERT

12+09

60 20
9.27
6

60 16
9.11

60 25
9.02
6

12+07

58

Rt to Traffic Signal

11+94.8

{ 46 Rt to Street Sign
44 Rt to Curb gutter Drain (12" pipe)
62 Rt to gate

60 23
8.54
10 3
Cb

60 03
9.24
10 3
Gut

60 21
9.00

60 09
8.83
6

58 09
10.38
44
INVERT

11+93.2

45

Rt to STOP Sign

11+89.4

10

Lt to center Traffic Signal

11+77.4

9

Lt to Street Sign

69.27 X

69.27 X

13+00

Dive
8
cbSP65
10.62
8
Gut5822
10.285915
10.12
6

12+99.5

4 1/4" drain in curb on right

12+88

10 Lt to center fire hydrant

12+87.5

1° Rt to water gate

12+77.8

3° Rt to water gate

12+77

17° Rt to center MH

51.97
17°
INVERT
ELEVATION

12+76

12° Lt to STOP Sign

12+74.7

45° Rt to traffic signal

12+63.7

26° Lt to Traffic Signal

12+60.7

5825
9.93
65826
9.665826
9.51
6

69.27A

69.27A

13+82 46 Rt to center Street Light #4274

13+76 Gas Lateral on Left

13+71 10 Lt Parking Meter

13+53 Gas Lateral on Right

13+50

	500	500	500
Drive	4/6	373	357
8	8		6
cb	gut		

13+32 Water Meter on Left

13+30 10 Lt to Street Light #4277

13+22 46 Rt Parking Meter

13+02 46 Rt Parking Meter

T.P. 348 62.16 π 10.59 58.68 \checkmark 62.16 π \checkmark

69.27 π

14+26 4" Drain in curb on left

14+24 4" Drain in curb on left

14+22 10 Lt Parking Meter

14+20 10 Lt to center Street Light #4275

14+00

	57.25	57.85	58.02
Drive	471	431	414
8	8		6
cb	Gut		

13+99.5 Water Meter on Right

13+96 46' Rt to center Pole #1844

13+95 46' Rt Parking Meter

13+94 Water Meter on Right

13+84 { 4" Drain in Curb on Right
Water Meter on Left

62.16 N

62.16 N

15+75

55 24
6.40
6

55 66
6.50

55 52
6.63
6

15+50

56 25
5.91
6

56 29
5.87

56 24
5.90
6

15+25

56 32
5.77
6

56 59
5.57

56 45
5.51
6

15+00

56 25
5.81
6

56 62
5.47

56 20
5.26
6

Behind Ahead Equation
~~14+76.15 BC = 14+78.15 BC~~ what the hell?

55 09
5.72
8
cb

56 84
5.72
8
cut

56 02
5.19

55 11
5.05
6

14+69.5 10 24 Parking Meter

14+50

56 25
5.31
8
cb

57 22
4.87

57 29
4.72
6

14+42 46 24 to center Street Light #4274

62.16 A

62.16 A

Cont'd From Page 28

Lt

R

Rt

29

16+82.40 EC

16+50

T.P. 6.99 62.87A 6.29 55.88

16+25

16+15.6 Leaves curb

16+00

No Basement.
75 Rt to bldg. corner (column)

15+88.3 Hits Curb

62.16A

56.25	57.21	58.05	55.60	
6.62	6.66	6.82	7.27	Drive
6		6	165	165
			Gut	cb
56.25	55.88	55.68	55.90	10.95
6.68	6.98	7.19	7.47	6.86
6		6	132	132
			Gut	cb

62.87A

55.82	55.81	55.24	55.81
6.64	6.75	6.90	6.35
6		5	5
		Gut	cb

55.55	55.62
7.01	6.52
Gut	cb

54.61	55.22	55.82	55.96
7.55	6.43	6.34	6.20
65	65		6
Gut	cb		

55.25	55.68
7.02	6.48
Gut	cb

62.16A

BC plus 53.3 45¹ Rt to center T. Pole #1010

BC plus 50.5 4" Drain in curb on left

BC plus 40.5 ⁴⁷ 10' Rt to Parking Meter

BC plus 36 water Meter on right

BC plus 32 46 Rt to Parking Meter

BC plus 16.5 water Meter on right

BC plus 14.8 water Meter on right

BC plus 11.5 { 46 Rt to Parking Meter
10 Lt to center Street Light # 4273

BC plus 3.7 Gas lateral on Right

BC plus 2.7 46² Rt oil refill

BC plus 110 11" Lt to center Curbinlet

BC plus 99 { 46 Rt to Street Sign
173 Rt to center MH

53.07
11"
INVERT
ELEVATION
(For MH & Inlets not shown
here see FB2203, pg 10 & 61)

38.15
173 see pg 61
INVERT FB2203
ELEVATION

BC plus 93 10" Lt to center Street Light #4271

BC plus 74 46 Rt to Parking Meter

BC plus 68.5 15" Lt to Parking Meter

BC plus 60.4 46 Rt to center Street Light #4272

BC plus 58.5 4" drain incurb on Right

BC plus 55.8 46 Rt to parking Meter

BC plus 55 water Meter on left

Cont'd From Page 31

Lt

R

R

32

56.33	56.34	57.25	55.70	56.29
6.54	6.63	6.74	7.17	6.58
6		6	17	17
			6.4	6

17+00

16+90.3

19' Right to center Street Light

#842

P.I. plus 113

19^E Rt to BUS STOP

P.I. plus 97

37 Lt to center Street Light *

843

P.I. plus 75.5

14' Rt to center Telephone MH

P.I. plus 64

36^S Lt to STOP Sign

P.I. plus 58

{ 19 Rt to center Street Light # 844

{ 36^S Lt to center P.Pole #1599

P.I. plus 47

{ 37^E Lt to center curb inlet

{ 21 Rt " " " "

52.99
37^E
INVERT
ELEVATION

52.18
21
INVERT
ELEVATION

P.I. plus 19.2

3^E Lt to center MH

43.31
3^E
INVERT
ELEVATION

P.I. plus 1.5

24^L Lt to center MH

45.61.9
24^L
INVERT
ELEVATION

62.87 π

62.87 π

Cont'd From Page 32

lt

25

£

17

Rt

23

17470⁵, 19° RT. CENTER ST. LIGHT #840

17455⁰, 19° RT. TO PARK. METER

17451⁵, 37° LT. TO PARK. METER

17450

6.19
6

59 25
58 25
6.22

75 25
25
6.30
6

56 25
25
6.62
17
6.04

57 25
25
5.82
17
6.04

17433, 19° RT. TO PARK. METER

17429, 37° LT. CENTER ST. LIGHT #841

17412⁰, 19° RT. PARKING METER

17410⁰, 36⁵ LT. TO CENTER RR # R 15496

17402⁵, 37° LT. TO PARKING METER

62.87 H.I.

62.87 H.I.

Cont'd From Page 33

Lt

£

Rt 34

18+14, 19° LT TO WATER GATE

18+12⁸, 19° RT. TO ST. SIGN

18+10⁵, 37° LT. CENTER ST. LIGHT #839

18+07⁸, 18⁵ RT. FIRE ALARM BOX

18+07, 36⁵ LT. PP. # R 1501

18+00

5.5702
5.80
6

5.5700
5.87

5.5720
5.97
6

5.5762
6.24
17
62

5.5736
5.51
17
2

17+98⁵, 19° RT. PARK. METER

17+77, 19° RT. PARK. METER

62.87 H.I.

62.87 H.I.

Cont'd From Page 34

Lt

Rt

Rt 35

19+00

57.27
560
6

57.24
563

57.14
573
6

56.02
599
17
cut

57.52
535
17
cb

(36⁴ Lt. TO CENTER FIRE HYDRANT
18+92, } 22⁹ Lt. TO CENTER WATER GATE

(19⁰ Rt. TO ST. LIGHT #838
18+90⁵ } 8⁹ Lt. TO CENTER M.H.

Full of Dirt
8⁹
INVERT

18+77², 19⁰ Lt. TO WATER GATE

18+76, LINE CROSSES DEAD CULVERT

	50.54	57.22	57.23	57.12	29
	50	57	57	56	56
18+50, 25 ⁰ Lt. CENTER OF MAN HOLE	11.75	12.53	565	564	570
	25	25	6	6	6
	DIOP	INVERT			cut
	INVERT				

18+42, 31⁷ Rt. TO WATER GATE

18+31⁷, 10⁷ Rt. CENTER TELEPHONE M.H.

18+25, CROSS DEAD CULVERT

62.87 H.I.

62.87 H.I.

19+64 27²R to Oil refill or sewer cleanout??

19+62 37 Lt to Parking Meter

19+50

$$\begin{array}{r} 57.42 \\ 6.35 \\ \hline 6 \end{array}$$

$$\begin{array}{r} 57.81 \\ 6.41 \\ \hline 6 \end{array}$$

$$\begin{array}{r} 57.35 \\ 6.47 \\ \hline 6 \end{array}$$

$$\begin{array}{r} 57.13 \\ 6.69 \\ \hline 6 \end{array}$$

$$\begin{array}{r} 57.88 \\ 5.94 \\ \hline 6 \end{array}$$

19+48 19' R to Parking Meter

19+43.5 4" drain in curb on right

19+33 4" drain in curb on left

19+31 37 Lt to center Street Light #837

19+17.5 Water Meter on left

19+01 37⁵ Lt + BUS STOP signT.P. 6.10 63.82 π 5.15 57.7263.82 π 62.87 π

Cont'd From Page 36

Lt

Rt

Rt 37

20+13 Gas Lateral on left

20+06.7 3" drain in curb on left

20+01.5 37 Lt to Parking Meter

20+00

57.23	57.22	57.65	57.52	58.01
6.09	6.13	6.18	6.50	5.73
6		6	17	17
			6.17	6

19+98.5 19 Rt to Parking Meter

19+90 Gas Lateral on right

19+88.5 4" Drain in curb on Right

19+81 19 Rt to center Street Light #836

19+78 Water Meter on left

19+74.5 Water Meter on right

63.82 X

63.82 X

Cont'd From Page 37

Lt

♀

R 58

20+72 19 Rt to center Street Light #834

20+71.1 37 Lt to Parking Meter

20+70.8 38 Lt + Valve ??

20+55 Water Meter on left

20+53 37 Lt to Parking Meter

20+51.5 36.5 Lt to center P. Pole #1453

20+51.0 18⁵ Rt to center Steel Pole #C1456R

20+50

57.22	57.92	57.92	57.45	58.29
588	590	592	628	553
6		6	17	17
			gut	06

20+49.5 19 Lt to Parking Meter

20+21 37 Lt to center Street Light #835

63.82T

63.82T

21+32 Water Meter on Right

21+29.7 37Lt to Parking Meter

21+24.5 19Rt to Parking Meter

21+14 37Lt to Parking Meter

21+11 37Lt to center Street Light #833

21+00.6 19Rt to Parking Meter

21+00

58.02	58.04	58.02	57.95	58.21
5.73	5.78	5.80	5.79	5.35
6		6	17	17
			6ut	06

20+98.5 8⁸ Lt to center MH

57.8
12.64
8⁸
INVERT

20+76.8 19Rt to Parking Meter

63.82X

63.82X

Cont'd From Page 39

Lt

C

Rt 40

22701 37 Lt to center Street Light #851

22700

$\overline{57.62}$	$\overline{57.57}$	$\overline{57.52}$	$\overline{57.25}$	$\overline{57.20}$
6.20	6.25	6.30	6.58	6.04
6		6	17	17
			Gut	cb

21798 Water Meter on Right

21779 36 Lt to center P. Pole # R1433

21768 Gas Lateral on Left

21760 19 Rt to center Street Light #832

21755 18 Lt to center Steel Pole #G1434R

21750

$\overline{57.90}$	$\overline{57.86}$	$\overline{57.82}$	$\overline{57.57}$	$\overline{58.27}$
5.92	5.96	6.00	6.25	6.33
6		6	17	17
			Gut	cb

21745.5 Water Meter on Left

21733 4" drain in curban left

63.82X

63.82X

Cont'd From Page 40

Lt

R

R 41

T.P. 5.38 62.98 $\bar{\Delta}$ 6.22 57.60 \checkmark

22+82.5 17 \bar{R} to center Curb inlet

22+81.5 35 \bar{L} to center Curb inlet

22+79.7 18 \bar{E} \bar{R} to Mail Box on post.

22+78 18 \bar{E} \bar{R} to Street Sign

22+76 20 \bar{L} \bar{R} to center Telephone MH

22+50 19 \bar{R} to center Street Light # 830

22+48 Water Meter on right

22+30.5 25 \bar{L} to center MH

22+15.5 4" Drain in curb on right

22+14 19 \bar{R} to Parking Meter

63.82 $\bar{\Delta}$

56 \bar{E}
7.35
35
6.4

57 \bar{E}
6.38
17
6.4

57 \bar{E}
6.50
6
57 \bar{E}
6.53
6
57 \bar{E}
6.58
6
57 \bar{E}
6.80
17
6.4
57 \bar{E}
6.22
17
6.4

57 \bar{E}
11.30
25
INVERT

63.82 $\bar{\Delta}$

Cont'd from Page 41

23+31 32⁶ Lt to center MH

23+20.5 { 47⁶ Lt to water gate
31³ Rt to gate (water)

23+17.3 53³ Lt to water gate

23+15 10⁶ Rt to center MH (Telephone)

23+05.6 9³ Lt to center MH

23+04.5 { 36⁶ Lt to center MH
17³ Rt to center MH

23+00

22+9.5 37 Lt to center Street Light #829

22+8.7 36⁵ Lt to center P. Pole # R1401

62.98 π

Lt

E

Rt

#2

49.42
13.38
32⁶
INVERT

55.65
7.33
9³
INVERT

7.55
7.84
36⁶
INVERT

55.55
7.03
17³ Full of Water
INVERT

57.4
5.87
6

57.4
5.87

57.3
5.85
6

57.05
5.94
17

62.98 π

Cont'd from Page 42

Lt

E

Rt

43

23+81 17th Rt to center Curb Inlet

56.58
6.74
17
Gut

23+80.5 35th Lt to center Curb Inlet

55.69
7.29
35
Gut

23+75 37th Lt to BUS STOP sign

23+72 36th Lt to center P. Pole # ?

23+70.5 19th Rt to center Street Light #828

55.22
1.06
17th
INVERT

23+57.5 17th Rt to center MH

55.44

23+55 82nd Lt to center MH

7.49
8.9
INVERT

23+50

57.13
5.86
6
57.10
5.88
6
57.10
5.88
6
57.20
5.78
17

23+41 19th Lt to Gas Gate

62.98⁷

62.98⁷

24+66.2 - 18.5 Rt to center Steel Pole # G1328R

24+54.7 19 Rt to center Street Light # 826

24+53.2 4" Drain in curb on right

24+52.4 37 Lt to Parking Meter

24+50

57.22
556
657.24
5.6257.22
566
657.09
589
17
GutDrive
17
Cb

24+44.5 Water Meter on left

24+24.7 4" Drain in curb on right

24+11.3 Water Meter on right

24+10.8 37 Lt to center Street Light # 827

24+00

57.24
574
657.09
5.8957.10
588
656.24
624
17
GutDrive
17
Cb

62.98 *

62.98 *

25712.5 Water Meter on left

25708 Water Meter on Right

25703.5 19E Rt to Oil Refill

25700

57.66	57.62	57.57	57.33	57.25
5.32	5.36	5.47	5.65	5.03
6		6	17	17
			cut	cb

24795 19Rt to Parking Meter

24794 37Lt to Parking Meter

24791.5 37Lt to center Street Light # 825

24776 3" Drain in curb on Left.

24773 37Rt to center P.Pole # R1349
19Rt to Parking Meter

24768 Water Meter on Right

Cont'd From Page 45

Lt

R

Rt #6

26+25

$\frac{57.92}{6}$
5.98

$\frac{58.02}{6}$
5.88

$\frac{58.04}{6}$
5.86

26+00

$\frac{57.82}{6}$
6.04

$\frac{58.04}{6}$
5.86

$\frac{58.21}{6}$
5.68

25+75

$\frac{58.00}{6}$
5.90

$\frac{58.10}{6}$
5.80

$\frac{58.12}{6}$
5.78

25+50

$\frac{57.21}{6}$
5.99

$\frac{57.85}{6}$
6.05

$\frac{57.82}{6}$
6.08

T.P.

5.58

63.90 ∇ 466 58.32

63.90 ∇

25+28.85 BC.

$\frac{57.24}{6}$
5.26

$\frac{57.20}{6}$
5.28

$\frac{57.63}{6}$
5.35

$\frac{57.52}{17}$
5.39
Gut

$\frac{58.85}{17}$
4.93
cb

25+26.5 4" Drain in curb on right

25+17 19 Rt to Parking Meter

62.98 ∇

62.98 ∇

Cont'd From Page 46

Lt

Q

Rt #77

BC plus 42.5 { 37 Lt to center Street Light #823
35 Lt to Gutter Inlet
20 Lt to water gate

56.32
758
35
Gut
58.57

BC plus 41.5 185 Rt to Fire Alarm on post

Prop 58.57

BC plus 35 365 Lt to center P.P. de #R1301

26's. 58.64

BC plus 29.7 19Rt to Parking Meter

BC plus 10.5 19Rt to Parking Meter

P.C. 58.74

B.C. plus 2.2 19Rt to center Street Light #824

26 + 85.98 E.C. 6' Lt of our Q is a gas line in thirteenth street

58.25
565
6
58.12
578
6.90
8
Gut
58.74
5.16
8
cb

26 + 75

72.85
569
6
72.85
580
5.96
9±
Gut
72.85
5.19
9±
cb

26 + 50

72.85
579
6
72.85
576
5.83
6

63.90X

63.90A

P.I. plus 52 { 45³ Lt to center Fire hydrant
32³ Lt to water gate

P.I. plus 50.7 4" Drain in curb on right.

P.I. plus 49 { 44 Lt to Gutter Drain
8 Rt to Gutter Drain

P.I. plus 34 7³ Rt to center MH

P.I. plus 20 22⁵ Rt to water gate

P.I. minus 15⁸ 7 Rt to center MH

BC plus 78⁵ 24⁸ Lt to center MH

BC plus 70.5 31 Rt to water gate

BC plus 59.3 9¹ Lt to center MH

BC. plus 56.5 34³ Lt to center MH

63.90A

Lt.

Rt.

Rt.

48

54.33
7.58
44
Gut

57.57
6.37
8
Gut

57.05
6.75
7³
INVERT

58.02
5.81
7
INVERT

54.17
9.71
24⁸
INVERT

50.52
12.96
9¹
INVERT

58.35
7.54
34³
INVERT

63.90A

Cont'd From Page 48

Lt

R

Rt 49

28+00

$\begin{array}{r} 58.24 \\ 6.57 \\ \hline 6 \end{array}$

$\begin{array}{r} 58.22 \\ 6.63 \\ \hline \end{array}$

$\begin{array}{r} 58.62 \\ 6.69 \\ \hline 8 \\ \text{cut} \end{array}$

Drive
8
cb

27+96

Water Meter on left

T.P.

594 65.31 π 453 59.37

65.31 π

27+77

Gas Lateral on Left

$\begin{array}{r} 58.52 \\ 5.31 \\ \hline 6 \end{array}$

$\begin{array}{r} 58.55 \\ 5.46 \\ \hline \end{array}$

$\begin{array}{r} 58.22 \\ 5.51 \\ \hline 8 \\ \text{cut} \end{array}$

9.07

27+50

27+38

45^S Lt to center P. Pole

#937

27+35

9^S Rt to center P. Pole #R940

27+34

4" Drain in curb on right

P.I. plus 94.8

Gas lateral on right.

P.I. plus 92

4" drain in curb on right

P.I. plus 55

45^S Lt to STOP sign

63.90 π

63.90 π

29+50

588²²
6.39
6

5810
6.21

5823
6.08
8

PC on R = 9.97

29+47.5 22 Rt to center street light #682

5822
12.54
183
INVERT

5821
6.38
6

5812
6.14

9.22
5820
5.91
8
Gut

5817
5.34
8
cb

9.79

9.97 = OK

29+35.5 18³ Lt to center MH

29+34.5 10 Rt to street sign

29+08.5 Water Meter on right

29+00

5815
6.16
6

5815
6.16

8.97
5818
6.13
8
Gut

115
Drive
8
cb

Top 9.67

28+72 9² Rt to center P. Pole # 2908

28+71 Water Meter on left

28+56² Gas Lateral on left

28+50

9.76
walk

5825
6.36
6

5825
6.40

5821
6.45
8
Gut

5853
5.78
8
cb

9.58 = G

9.41

31+18 Water Meter on Left

31+00

30+50

30+38 Water Meter on Left

45[±] Lt to center Fire Hydrant
32[±] Lt to Water gate

30+19.7

4" Drain in curb on Right
10 Rt to center P.P. # 898

30+15

30+04 Cross Conduit - lights ?

30+00

29+75

65.31 π

5850	5850	5850	5850
6.81	6.81	6.84	6.19
6	6	8 9.04	8 6

5850	5850	5850	5850
6.30	6.32	6.41	5.66
6	6	8 9.04	8 6

5921	5925	5925	6002	P.C. = F.
6.00	5.96	5.96	5.28	60.03
6	6	8 9.04	8 6	

5850	5850	5850
5.88	5.80	5.77
6	6	6

5850	5850	5850
5.80	5.64	5.50
6	6	6

65.31 π

Cont'd From Page 51

Lt.

R

R 52

32+38.5 Water Meter on left

32+00 Water Meter on left

31+85.5 Water Meter on right

31+76 46.5 ft Oil refill

31+61 95 ft to center P. Pole # 838

31+50

T.P. 482 63.53 π 660 58.71 \checkmark

31+40 18 ft to center MH *D.E. from South*

sta OK
31+76 18 ft to center MH *D.E. from North*

31+19 Gas Lateral on left

65.31 π

65.31 \checkmark π

		57.57	58.17
57.57	57.56	57.57	58.17
5.91	5.97	5.96	5.36
6		8	8
		gut	cb

		58.09	58.09
58.09	58.09	58.09	58.09
5.44	5.49	5.44	4.84
6		8	8
		gut	cb

71.92
18
INVERT

57.80
11.51
18
INVERT

Cont'd From Page 52

Lt

Rt

Rt 53

81.6
33+81.6

566
486
6

5664
488
6

95
492
6

T.P.

453

61.52 T

654

56.99

SW
70 CT
E 1/2

61.52 T

33+56

56
6.56
6

57
6.49
6

57
6.44
6

33+30

56
7.28
6

57
7.20
6

57
7.18
8

33+28

22 Rt to center Street Light #396

56
7.07
6

57
7.03
6

57
7.05
8
5+

57
6.52
8
6

33+15

29 Lt to Water Gate
10 Rt to Street Sign

33+00

56
6.85
6

57
6.89
6

57
6.90
8
5+

57
6.39
8
6

32+68.5

92 Rt to center P. Pole #820

57
6.36
6

57
6.46
6

57
6.48
8
5+

57
5.90
8
6

32+50

6353 T

6353 T

Lt

£

Rt - 54

34+36.5 46 Lt to Parking Meter

34+33.5 46 Lt to No Parking Sign

33+98 { 76 - 4" drain in curb
45⁸ Lt to Fire Hydrant

33+97 33 Lt to water gate

33+96.5 18 Lt to center ~~M.H.~~

50.58
10.94
18
INVERT

33+96 9⁵ Rt to center P.P. pole # R764G

56.52
500
6

24

5.88

27

5.19

8

60t

24

4.68

8

66

33+95.6 29⁶ Lt to water gate

33+83 57⁸ Lt to center Street Light # 397.

82.4
33+82.4 Cross elec. Conduit (Maybe - old ditch)

61.52 T

61.52 T

34+91.5 { 4 1/2 Lt to horse hitching ring in curb.
Water Meter on right.

34+90 10 Rt to Parking Meter

34+89 Sewer Lateral on left

34+81 10 Rt to Parking Meter

34+77 4 1/2 Lt to Parking Meter

34+55.5 4 1/2 Lt to Parking Meter

34+50

5878
574
6

5562

590

5896

606

8
Gut

Drive

8
cb

34+48 { 4 1/2 Lt to horse hitching ring in curb.
Water Meter on Left

34+44.4 Gas Lateral on right

34+44 Gas Lateral on Left

35+85.5 Water Meter on right.

35+84.5 6" Drain in curb on right

35+75.7 10 Rt to Parking Meter

35+50

35+43.2 5" Drain in curb on Right

35+02.5 10 Rt to Parking Meter

35+00

34+98.5 4" drain in curb on right.

34+95 4" drain in curb on left.

34+94 95 Rt to center P. Pole # R. 744

59.27	59.25	59.02	59.04
7.15	7.27	7.45	6.88
6		8	8
		Gut	cb

58.10	59.26	59.26	58.34
6.42	6.56	6.76	6.18
6		8	8
		Gut	cb

36+45 9^E Rt to center P. Pole # R71036+41.7 10^{Rt} to parking meter.36+39 4^E Lt to gasoline refill. ^{Tank under} walk

36+19 10 right to parking meter

36+13 3" drain in curb on right

36+12 Water Meter on right (6" line)

36+07 Gas lateral on right

36+00

53.6453.5053.2153.89

7.88

8.02

8.21

7.63

6

8

8

Gut

Cb

35+97.5 10^{Rt} to Parking Meter

35+96.5 6" drain in curb on right

36+96

36+91.5 2" Drain in curb on right

36+83.3 10 Rt to Parking Meter

36+69 Water Meter on left.

36+67 46 Lt to Parking Meter

36+65.5 4" Drain in curb on right

T.P. 507 57.80 π 8.79 52.73

36+63 10 Rt to Parking Meter

36+61.8 Possible Sewer Lateral on right

36+51.5 13 Rt to center Gas Co. MH

36+50

36+49 57 Lt to possibly Sewer Cleanout

61.52 π

Lt

52.02
5.76
6

52.02
5.78

51.23
5.87
8
Gut

Rt 58
52.48
5.32
8
Gut

57.80 π

52.81
8.65
6

52.25
8.77

52.52
8.99
8
Gut

52.13
8.39
8
Gut

61.52 π

Cont'd From Page 58

Lt

Rt

Rt 59

37+89.5 ^{sta. OK} 10 Rt to 6" Oleander

37+95 49¹ Lt to gasoline refill - 400gal Tank

Do not know exact Location of these Yellow Cab Tanks.

37+78 { 32^E Lt to water gate
45^S Lt to Fire Hydrant

37+76.5 95 Rt to center P.P. #698

37+76 18 Lt to center MH

"Y" cleanout
18
INVERT

37+61.6

52 20
5.40 5.85 5.77
6 8

37+36

52 26
5.74 5.13 5.10
6 6

37+10

51 22
5.93 5.88 5.88
6 8

36+96.3 10 Rt to Street Sign

57.80 T

57.80 T

Cont'd From Page 59

Lt

Q

Rt

60

39+00

51.20
6.50
6

51.02
6.71

50.78
7.02
8
cut

Drive
8
cb

38+95.5 5 1/2 Lt to gasoline refill - 10,000 gal Tank

38+88.5 Gas lateral on left.

38+77.5 10 Rt to center P. Pole # 644

38+50

51.62
6.11
6

51.28
6.32

51.20
6.60
8
cut

51.02
5.98
8
cb

38+46.6 Gas lateral on right

38+26.9 4" Drain in curb on left.

38+03 Gas Lateral on right.

38+01.5 4 1/2 Lt to gasoline refill - 4000 gal Tank

38+00

52.09
5.71
6

51.82
6.91

51.57
6.23
8
cut

52.13
5.67
8
cb

57.80A

57.80A

Cont'd From Page 60

Lt

Q

Re 61

40+18.8 { 10 Water Meter on left
Rt to Center P. Pole #610

40+16 Water Meter on right

40+00

50 54
7.26
6

50 28
7.52

50 07
7.73
8
Gut

Drive
8
cb

39+83 4" Drain in curban right.

39+78.5 4" Drain in curb on left.

39+60.5 5 1/2" Lt to gasoline refill - 10,000 gal. Tank

50 87
6.93
6

50 69
7.11

50 88
7.37
8
Gut

Drive
8
cb

39+50

39+28 3" Drain in curb on right

39+26.5 4" drain in curb on left.

39+12 Water Meter on left.

57.807

57.807

Contd From Page 61

Lt

E

Rt

62

40+76.5 45° Lt to Street Sign

40+76 29 Lt to water gate

40+75.5 95° Rt to STOP SIGN

40+73.5 E Crosses Sewer lat. built on Angle.

40+66.8 Water Meter on right

40+50

40+44.5 Water Meter on left

40+25.5 4" Drain in curb on left

40+24.5 Gas lateral on right

40+22 Gas lateral on left

57.807

49.05	49.23	44.50	50.00
7.15	8.07	8.30	7.75
6		8 Gut	8 Cb

50.01	49.01	49.72	50.27
7.13	7.93	8.08	7.53
6		8 Gut	8 Cb

57.807

41+47

49.35	49.34	49.34
3.90	3.91	3.91
6		6

41+26

49.22	49.21	49.20
3.33	3.34	3.35
6		6

41+04

50.05	50.01	50.00
3.22	3.24	3.25
6		6

T.P. 3.17 53.25 ∇ 7.72 50.08

53.25 ∇

40+92

49.92	49.91	49.63
7.90	8.03	8.17
6		8

40+90.29 Rt to center Street Light #90

40+88.5 Cross elec. Conduit (lights)

40+86 Cross Telephone Conduit

57.80 ∇

57.80 ∇

42718.2 4" Drain in curb on right

42711 10' Rt to Parking Meter

42700

41499 10' Rt to Parking Meter

41494.5 Water Meter on right

41477.2 { 46 Lt to STOP sign
10' Rt to center P. Pole # R598

41476.4 18" Lt to center MH

41473 Cross Gas Line

41462 { 23 Rt to center P. Pole # R1299
58' Lt to P. Pole #?

41460

53.25 π

53.25 π

97.95	97.75	97.95	98.15
5.30	5.54	5.98	5.72
6		8 Gut	8 cb

98.33	98.15	97.22	98.92
4.92	5.12	5.48	4.83
6		8 Gut	8 cb

"Y" Cleanout
18" INVERT

98.81	98.62	98.7
4.44	4.63	5.08
6		8

42+73- 10 Rt to Parking Meter

42+61.5 10 Rt to Parking Meter

42+53.5 4" Drain in curb on left

42+48 Car on + 50

$$\begin{array}{r} 47.4 \\ 47.4 \\ 5.91 \\ 6 \end{array}$$

$$\begin{array}{r} 47.10 \\ 47.10 \\ 6.15 \end{array}$$

$$\begin{array}{r} 46.00 \\ 46.00 \\ 6.37 \\ 8 \\ 5.07 \end{array}$$

$$\begin{array}{r} 47.00 \\ 47.00 \\ 5.85 \\ 8 \\ 0.6 \end{array}$$

42+49 Gas Lateral on left

42+48.5 10 Rt to Parking Meter

42+47.5 Water Meter on left

42+35.5 10 Rt to Parking Meter

42+27.7 9 Rt to Parking Sign

42+23.5 10 Rt to Parking Meter

53.25

53.25

43+71.5 Water Meter on left

43+70 Gas Lateral on left

43+68 4" Drain in curb on right

43+50

43+12.5 Water Meter on left

43+87.5 Gas Lateral on left

43+00

42+95.5 Water Meter on left

42+84 10 Rt to Parking Meter

42+76.6 10 Rt to center P.Pole # R536

42+75.7 4" Drain in curb on right

95.91
7.34
6

95.21
7.54

95.55
7.70
8
Gut

Drive
8
Cb

96.63
6.63
6

96.20
6.85

96.15
7.10
8
Gut

Drive
8
Cb

44+75 4" Drain in curb on right

44+63 47 Lt to center 40" palm

44+50

75.46	44.25	44.28	44.23
491	5.03	514	459
6		8	8
		Gut	cb

44+41 Water Meter on Right

44+38.5 Water Meter on left

44+33.5 13 Rt to center 40" Palm

44+25 47 Lt to center 44" Palm

44+22.7 Gas Lateral on left

T.P. 4.24 49.42 8.07 45.18

49.42

44+20.3 95 Rt to center P.P. # 518

44+00 Water Meter on left

45.21	45.02	44.23	45.21
8.04	8.23	8.42	7.84
6		8	8
		Gut	cb

43+93 13 Rt to center 40" Palm

53.25

53.25

Cont'd From Page 67

Lt

£

Rt 68

45+58.5 10 Rt to center P.Pole # 498

45+57.7 { 45[±] Lt to Fire Hydrant
32 Lt to water gate

45+56.5 18[±] Lt to center MH

45+42.5

45+16.5

44+91

44+77

44+76.5 10 Rt to street Sign

49.42A

	93.69	93.61	93.83	94.02
"Y" Cleanout	5.73	5.81	5.99	5.40
18 [±]	6		8	8
INVERT			gut	cb

	93.87	93.77	93.64	
	5.55	5.65	5.78	
	6		8	

	94.08	94.09	94.14	
	5.34	5.33	5.28	
	6		6	

	94.09	94.09	94.89	
	5.33	5.38	5.53	
	6		8	

	94.16	94.06	94.20	94.28
	5.26	5.26	5.50	4.94
	6		8	8
			gut	cb

49.42A

46+77.5 WATER METER ON LT.

46+45 Cars, cars!

41.54	41.80	41.18	41.22
7.88	8.02	8.24	7.65
6		8	8
		Gutter	Curb

46+46 Water meter on right

46+19 Gas lateral on right

46+18 Water Meter on left

46+16.5 Gas Lateral on left

46+07.5 Water Meter on right

46+04.5 Water Meter on left

46+05 Car on Station

42.58	42.82	42.20	42.73
6.84	7.00	7.22	6.69
6		8	8
		Gut	Cb

49.42 H.I.

49.42 H.I.

T.P. 3.44 41.79[✓] 11.07 38.35[✓]

17+98⁵ WATER METER ON RT

17+58¹ 10° RT TO PP #420

17+50

	38.22	38.22	38.51	
10.59		10.70	10.83	Drive
6			8	8
			Gut	cb

17+37⁸ WATER METER ON RT.

17+13⁵ WATER METER ON LEFT

17+11, 9⁵ RT TO DEAD MAN

17+00

	40.12	40.01	39.22	40.11
9.30		9.41	9.63	8.93
6			8	8
			Gut	cb

16+90 1" DRAIN IN CURB ON RT.

16+87 10° RT, CENTER PP #416

49.42 H.I.

49.42 H.I.

18+96

$$\begin{array}{r} 35.24 \\ 6.55 \\ \hline 6 \end{array}$$

$$\begin{array}{r} 35.23 \\ 6.56 \\ \hline 6 \end{array}$$

$$\begin{array}{r} 35.26 \\ 6.43 \\ \hline 6 \end{array}$$

18+71

$$\begin{array}{r} 35.85 \\ 5.94 \\ \hline 6 \end{array}$$

$$\begin{array}{r} 35.83 \\ 5.96 \\ \hline 6 \end{array}$$

$$\begin{array}{r} 35.79 \\ 6.00 \\ \hline 8 \end{array}$$
18+65⁵ LINE CROSSES TELEPHONE CONDUIT18+57 29⁹ LT. TO WATER GATE18+56⁵ 10⁹ RT. TO ST. SIGN

18+50

$$\begin{array}{r} 36.28 \\ 5.51 \\ \hline 6 \end{array}$$

$$\begin{array}{r} 36.22 \\ 5.57 \\ \hline 6 \end{array}$$

$$\begin{array}{r} 36.16 \\ 5.63 \\ \hline 8 \\ \text{Gut} \end{array}$$

$$\begin{array}{r} 36.82 \\ 4.97 \\ \hline 8 \\ \text{cb} \end{array}$$

18+20 GAS LATERAL ON LT.

18+09 WATER METER ON LT

18+03 Sewer Lateral on right

18+00

$$\begin{array}{r} 37.63 \\ 4.16 \\ \hline 6 \end{array}$$

$$\begin{array}{r} 37.59 \\ 4.30 \\ \hline 6 \end{array}$$

$$\begin{array}{r} 37.59 \\ 4.70 \\ \hline 8 \\ \text{Gut} \end{array}$$

$$\begin{array}{r} 8 \\ \text{cb} \end{array}$$

4179A

4179A

T.P. 2.88 37.45[✓] 7.22 37.57[✓] SW7CT
89 12th

(49?)

48+50

X

48+40 WATER METER ON LT.

X

48+39 { 15⁵ LT. TO FIRE HYDRANT
32⁰ LT. TO WATER GATE

X

49+38 18⁰ LT. TO MAN HOLE

49+37

49+23

49+08 { 57⁰ LT. TO WATER GATE
22⁰ RT. " " "

41.79[✓]

33.12	33.02	32.70	32.51
8.62	8.77	9.01	8.38
6		8	8
		cut	cb

"Y" cleanout

33.02	33.70	33.23	34.02
7.92	8.01	8.06	7.37
6		8	8
		cut	cb

34.44	34.20	34.07
7.35	7.51	7.72
6		8

41.79[✓]

T.P. - 1.41 26.21 ∇ 12.65 2480'

50+71, WATER METER ON LT.

50+50

2605	2591	2576	2630
11.71	11.54	11.69	11.15
6		8	8
		Gut	cb

50+10, GAS LATERAL ON LT.

50+33, WATER METER ON RT.

50+07 9.5 FT, PP #360

50+00

2965	2928	2923	2996
7.80	7.97	8.12	7.49
6		8	8
		Gut	cb

49+88, WATER METER ON LT.

49+86, 1" DRAIN IN CURB ON LT.

49+73 10^o RT. TO DEAD MAN

3745 ∇

3745 ∇

T.P. 317 16.81 $\overline{12.57}$ 13.64

5242 WATER METER ON LT.

51495

$\overline{15.83}$	$\overline{15.68}$	$\overline{15.93}$	$\overline{15.95}$
10.38	10.52	10.78	10.26
6		8 Gvt	8 cb

51488 SEWER LATERAL ON LT.

51487⁵ 109 RT, PP #310

51473, GAS LATERAL ON LT.

51468, GAS LATERAL ON RT.

51445

$\overline{14.38}$	$\overline{14.10}$	$\overline{14.91}$	$\overline{14.49}$
6.83	7.03	7.30	6.72
6		8 Gvt	8 cb

51407, WATER METER ON LT.

51400

$\overline{22.54}$	$\overline{22.25}$	$\overline{22.02}$	
3.67	3.86	4.19	Drive
6		8 Gvt	8 cb

26.21 $\overline{1}$

26.21 $\overline{1}$

M.H. INVERT ELEVATIONS ON NEXT PAGES.

The pour that refreshes.

check

4.83 13.87 = 13.95 NWBP "K" E 14 1/2"

T.P.

524

18.70

3.55

13.26

52462⁵ 18⁵ FT. TO MAN HOLE

704
9.77
18⁵
INVERT

52450 { 43⁹ FT. TO MAN HOLE
7⁹ FT. TO MAN HOLE

1151
1151
1.30
43
INVERT

1141
5.40
7
INVERT

52437 { 10² FT. TO STREET SIGN
14⁰ FT. TO GUTTER DRAIN
8⁹ FT. TO GUTTER DRAIN

1125	1322	1321	1223	1129	1193	1225
5.06	3.73	3.80	3.87	4.73	4.87	3.86
44	6		58	58	8	8
6.06			Rv	Gut	Gut	06

16.81 π

16.81 π

MH at 17th E "A" on So. Line A, INVERT ELEV. = 94.98

MH at 16th E "A" on So. Line A, INVERT ELEV. = 104.70

DMH at 18th E "C" & 18th E No. Line C I.E. = ^{50.78} 46.32

MH at 18th E "C" on Qs I.E. = 44.98

MH at 18th E "C" ^{10' off so. cb.} on E. Line 18th I.E. = 50.21

DMH at 17th E "C" on No. Line C I.E. = ^{47.38} 43.47

MH at 17th E "C" on Qs I.E. = 42.68

MH at 15th E "C" So. Line C I.E. = 71.70

MH in 15th at Alley So. of C I.E. = 62.11

MH in 14th E "C" So. Line C I.E. = 67.58

M.H. at 13th $\frac{1}{2}$ C on So. line C I.E. = "Y" Cleanout

M.H. at 17th $\frac{1}{2}$ Broadway on E I.E. = 39.66

B.M.H. at 17th $\frac{1}{2}$ Bldg on So. line Bldg I.E. = ^{62.86} 41.05

could not get one drop I.E.

M.H. at 17th $\frac{1}{2}$ Bldg ^{Close to So. line Bldg} 5⁺E of W. cb 17th I.E. = 47.45

M.H. in 17th 100⁺ No. s of Broadway I.E. = 48.52

M.H. at 12th $\frac{1}{2}$ Broadway on So. line Bldg I.E. = "Y" Cleanout

M.H. at 14th $\frac{1}{2}$ "E" on So. line E I.E. = "Y" Cleanout

M.H. at 14th $\frac{1}{2}$ "E" on E. line 14th I.E. = 45.23

INDEXED
JER
DEC 18 1953

2t

Q

Rt 78

26

E

Rt

79

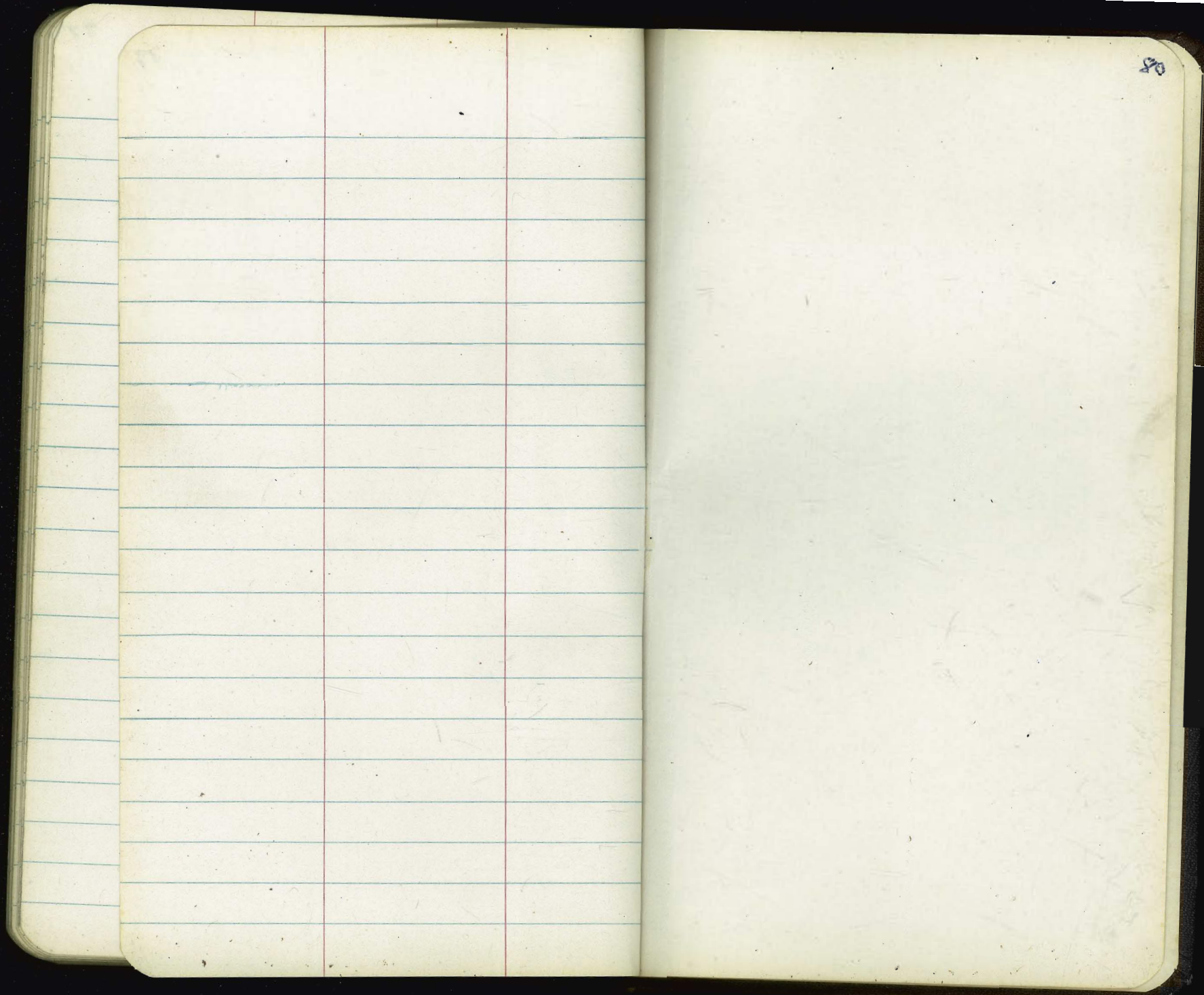

80

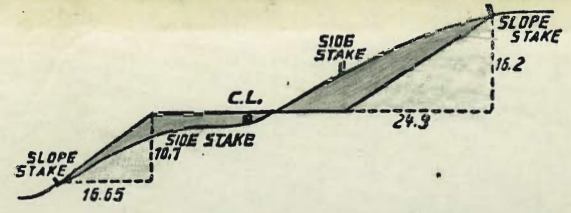
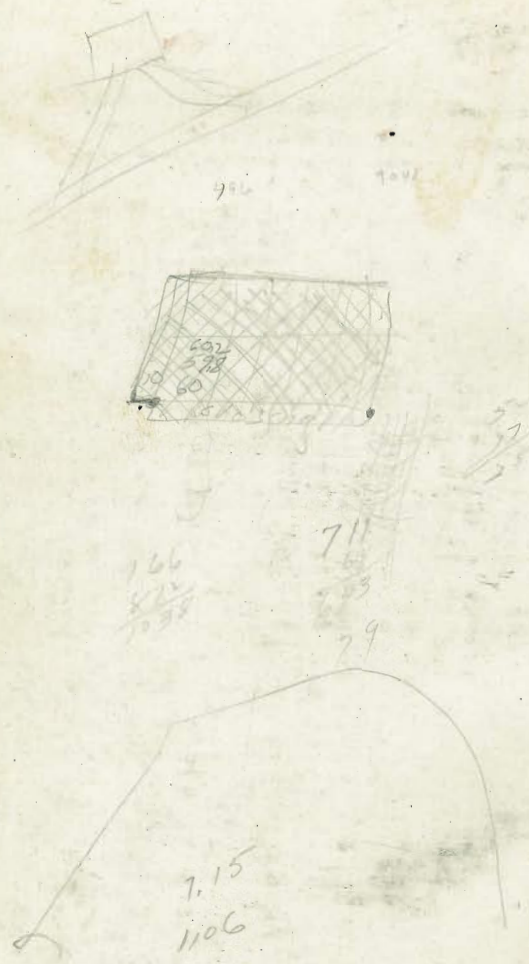

DISTANCES FROM SIDE STAKES FOR CROSS-SECTIONING.
 SLOPE 1 1/2 TO 1. ROADWAY OF ANY WIDTH.

	0	.1	.2	.3	.4	.5	.6	.7	.8	.9	
0	0.00	0.15	0.30	0.45	0.60	0.75	0.90	1.05	1.20	1.35	0
1	1.50	1.65	1.80	1.95	2.10	2.25	2.40	2.55	2.70	2.85	1
2	3.00	3.15	3.30	3.45	3.60	3.75	3.90	4.05	4.20	4.35	2
3	4.50	4.65	4.80	4.95	5.10	5.25	5.40	5.55	5.70	5.85	3
4	6.00	6.15	6.30	6.45	6.60	6.75	6.90	7.05	7.20	7.35	4
5	7.50	7.65	7.80	7.95	8.10	8.25	8.40	8.55	8.70	8.85	5
6	9.00	9.15	9.30	9.45	9.60	9.75	9.90	10.05	10.20	10.35	6
7	10.50	10.65	10.80	10.95	11.10	11.25	11.40	11.55	11.70	11.85	7
8	12.00	12.15	12.30	12.45	12.60	12.75	12.90	13.05	13.20	13.35	8
9	13.50	13.65	13.80	13.95	14.10	14.25	14.40	14.55	14.70	14.85	9
10	15.00	15.15	15.30	15.45	15.60	15.75	15.90	16.05	16.20	16.35	10
11	16.50	16.65	16.80	16.95	17.10	17.25	17.40	17.55	17.70	17.85	11
12	18.00	18.15	18.30	18.45	18.60	18.75	18.90	19.05	19.20	19.35	12
13	19.50	19.65	19.80	19.95	20.10	20.25	20.40	20.55	20.70	20.85	13
14	21.00	21.15	21.30	21.45	21.60	21.75	21.90	22.05	22.20	22.35	14
15	22.50	22.65	22.80	22.95	23.10	23.25	23.40	23.55	23.70	23.85	15
16	24.00	24.15	24.30	24.45	24.60	24.75	24.90	25.05	25.20	25.35	16
17	25.50	25.65	25.80	25.95	26.10	26.25	26.40	26.55	26.70	26.85	17
18	27.00	27.15	27.30	27.45	27.60	27.75	27.90	28.05	28.20	28.35	18
19	28.50	28.65	28.80	28.95	29.10	29.25	29.40	29.55	29.70	29.85	19
20	30.00	30.15	30.30	30.45	30.60	30.75	30.90	31.05	31.20	31.35	20
21	31.50	31.65	31.80	31.95	32.10	32.25	32.40	32.55	32.70	32.85	21
22	33.00	33.15	33.30	33.45	33.60	33.75	33.90	34.05	34.20	34.35	22
23	34.50	34.65	34.80	34.95	35.10	35.25	35.40	35.55	35.70	35.85	23
24	36.00	36.15	36.30	36.45	36.60	36.75	36.90	37.05	37.20	37.35	24
25	37.50	37.65	37.80	37.95	38.10	38.25	38.40	38.55	38.70	38.85	25
26	39.00	39.15	39.30	39.45	39.60	39.75	39.90	40.05	40.20	40.35	26
27	40.50	40.65	40.80	40.95	41.10	41.25	41.40	41.55	41.70	41.85	27
28	42.00	42.15	42.30	42.45	42.60	42.75	42.90	43.05	43.20	43.35	28
29	43.50	43.65	43.80	43.95	44.10	44.25	44.40	44.55	44.70	44.85	29
30	45.00	45.15	45.30	45.45	45.60	45.75	45.90	46.05	46.20	46.35	30
31	46.50	46.65	46.80	46.95	47.10	47.25	47.40	47.55	47.70	47.85	31
32	48.00	48.15	48.30	48.45	48.60	48.75	48.90	49.05	49.20	49.35	32
33	49.50	49.65	49.80	49.95	50.10	50.25	50.40	50.55	50.70	50.85	33
34	51.00	51.15	51.30	51.45	51.60	51.75	51.90	52.05	52.20	52.35	34
35	52.50	52.65	52.80	52.95	53.10	53.25	53.40	53.55	53.70	53.85	35
36	54.00	54.15	54.30	54.45	54.60	54.75	54.90	55.05	55.20	55.35	36
37	55.50	55.65	55.80	55.95	56.10	56.25	56.40	56.55	56.70	56.85	37
38	57.00	57.15	57.30	57.45	57.60	57.75	57.90	58.05	58.20	58.35	38
39	58.50	58.65	58.80	58.95	59.10	59.25	59.40	59.55	59.70	59.85	39
40	60.00	60.15	60.30	60.45	60.60	60.75	60.90	61.05	61.20	61.35	40
41	61.50	61.65	61.80	61.95	62.10	62.25	62.40	62.55	62.70	62.85	41
42	63.00	63.15	63.30	63.45	63.60	63.75	63.90	64.05	64.20	64.35	42
43	64.50	64.65	64.80	64.95	65.10	65.25	65.40	65.55	65.70	65.85	43
44	66.00	66.15	66.30	66.45	66.60	66.75	66.90	67.05	67.20	67.35	44
45	67.50	67.65	67.80	67.95	68.10	68.25	68.40	68.55	68.70	68.85	45
46	69.00	69.15	69.30	69.45	69.60	69.75	69.90	70.05	70.20	70.35	46
47	70.50	70.65	70.80	70.95	71.10	71.25	71.40	71.55	71.70	71.85	47
48	72.00	72.15	72.30	72.45	72.60	72.75	72.90	73.05	73.20	73.35	48
49	73.50	73.65	73.80	73.95	74.10	74.25	74.40	74.55	74.70	74.85	49
50	75.00	75.15	75.30	75.45	75.60	75.75	75.90	76.05	76.20	76.35	50

THE NATIONAL BLANK BOOK COMPANY
 HOLYOKE MASSACHUSETTS
 NEW YORK CHICAGO BOSTON SAN FRANCISCO