

DISTANCES FROM SIDE STAKES FOR CROSS-SECTIONING
SLOPE 1 TO 1. ROADWAY OF ANY WIDTH

| | 0 | .1 | .2 | .3 | .4 | .5 | .6 | .7 | .8 | .9 | |
|----|-------|-------|-------|-------|-------|-------|-------|-------|-------|-------|----|
| 0 | 0.00 | 0.10 | 0.20 | 0.30 | 0.40 | 0.50 | 0.60 | 0.70 | 0.80 | 0.90 | 0 |
| 1 | 1.00 | 1.10 | 1.20 | 1.30 | 1.40 | 1.50 | 1.60 | 1.70 | 1.80 | 1.90 | 1 |
| 2 | 2.00 | 2.10 | 2.20 | 2.30 | 2.40 | 2.50 | 2.60 | 2.70 | 2.80 | 2.90 | 2 |
| 3 | 3.00 | 3.10 | 3.20 | 3.30 | 3.40 | 3.50 | 3.60 | 3.70 | 3.80 | 3.90 | 3 |
| 4 | 4.00 | 4.10 | 4.20 | 4.30 | 4.40 | 4.50 | 4.60 | 4.70 | 4.80 | 4.90 | 4 |
| 5 | 5.00 | 5.10 | 5.20 | 5.30 | 5.40 | 5.50 | 5.60 | 5.70 | 5.80 | 5.90 | 5 |
| 6 | 6.00 | 6.10 | 6.20 | 6.30 | 6.40 | 6.50 | 6.60 | 6.70 | 6.80 | 6.90 | 6 |
| 7 | 7.00 | 7.10 | 7.20 | 7.30 | 7.40 | 7.50 | 7.60 | 7.70 | 7.80 | 7.90 | 7 |
| 8 | 8.00 | 8.10 | 8.20 | 8.30 | 8.40 | 8.50 | 8.60 | 8.70 | 8.80 | 8.90 | 8 |
| 9 | 9.00 | 9.10 | 9.20 | 9.30 | 9.40 | 9.50 | 9.60 | 9.70 | 9.80 | 9.90 | 9 |
| 10 | 10.00 | 10.10 | 10.20 | 10.30 | 10.40 | 10.50 | 10.60 | 10.70 | 10.80 | 10.90 | 10 |
| 11 | 11.00 | 11.10 | 11.20 | 11.30 | 11.40 | 11.50 | 11.60 | 11.70 | 11.80 | 11.90 | 11 |
| 12 | 12.00 | 12.10 | 12.20 | 12.30 | 12.40 | 12.50 | 12.60 | 12.70 | 12.80 | 12.90 | 12 |
| 13 | 13.00 | 13.10 | 13.20 | 13.30 | 13.40 | 13.50 | 13.60 | 13.70 | 13.80 | 13.90 | 13 |
| 14 | 14.00 | 14.10 | 14.20 | 14.30 | 14.40 | 14.50 | 14.60 | 14.70 | 14.80 | 14.90 | 14 |
| 15 | 15.00 | 15.10 | 15.20 | 15.30 | 15.40 | 15.50 | 15.60 | 15.70 | 15.80 | 15.90 | 15 |
| 16 | 16.00 | 16.10 | 16.20 | 16.30 | 16.40 | 16.50 | 16.60 | 16.70 | 16.80 | 16.90 | 16 |
| 17 | 17.00 | 17.10 | 17.20 | 17.30 | 17.40 | 17.50 | 17.60 | 17.70 | 17.80 | 17.90 | 17 |
| 18 | 18.00 | 18.10 | 18.20 | 18.30 | 18.40 | 18.50 | 18.60 | 18.70 | 18.80 | 18.90 | 18 |
| 19 | 19.00 | 19.10 | 19.20 | 19.30 | 19.40 | 19.50 | 19.60 | 19.70 | 19.80 | 19.90 | 19 |
| 20 | 20.00 | 20.10 | 20.20 | 20.30 | 20.40 | 20.50 | 20.60 | 20.70 | 20.80 | 20.90 | 20 |
| 21 | 21.00 | 21.10 | 21.20 | 21.30 | 21.40 | 21.50 | 21.60 | 21.70 | 21.80 | 21.90 | 21 |
| 22 | 22.00 | 22.10 | 22.20 | 22.30 | 22.40 | 22.50 | 22.60 | 22.70 | 22.80 | 22.90 | 22 |
| 23 | 23.00 | 23.10 | 23.20 | 23.30 | 23.40 | 23.50 | 23.60 | 23.70 | 23.80 | 23.90 | 23 |
| 24 | 24.00 | 24.10 | 24.20 | 24.30 | 24.40 | 24.50 | 24.60 | 24.70 | 24.80 | 24.90 | 24 |
| 25 | 25.00 | 25.10 | 25.20 | 25.30 | 25.40 | 25.50 | 25.60 | 25.70 | 25.80 | 25.90 | 25 |
| 26 | 26.00 | 26.10 | 26.20 | 26.30 | 26.40 | 26.50 | 26.60 | 26.70 | 26.80 | 26.90 | 26 |
| 27 | 27.00 | 27.10 | 27.20 | 27.30 | 27.40 | 27.50 | 27.60 | 27.70 | 27.80 | 27.90 | 27 |
| 28 | 28.00 | 28.10 | 28.20 | 28.30 | 28.40 | 28.50 | 28.60 | 28.70 | 28.80 | 28.90 | 28 |
| 29 | 29.00 | 29.10 | 29.20 | 29.30 | 29.40 | 29.50 | 29.60 | 29.70 | 29.80 | 29.90 | 29 |
| 30 | 30.00 | 30.10 | 30.20 | 30.30 | 30.40 | 30.50 | 30.60 | 30.70 | 30.80 | 30.90 | 30 |
| 31 | 31.00 | 31.10 | 31.20 | 31.30 | 31.40 | 31.50 | 31.60 | 31.70 | 31.80 | 31.90 | 31 |
| 32 | 32.00 | 32.10 | 32.20 | 32.30 | 32.40 | 32.50 | 32.60 | 32.70 | 32.80 | 32.90 | 32 |
| 33 | 33.00 | 33.10 | 33.20 | 33.30 | 33.40 | 33.50 | 33.60 | 33.70 | 33.80 | 33.90 | 33 |
| 34 | 34.00 | 34.10 | 34.20 | 34.30 | 34.40 | 34.50 | 34.60 | 34.70 | 34.80 | 34.90 | 34 |
| 35 | 35.00 | 35.10 | 35.20 | 35.30 | 35.40 | 35.50 | 35.60 | 35.70 | 35.80 | 35.90 | 35 |
| 36 | 36.00 | 36.10 | 36.20 | 36.30 | 36.40 | 36.50 | 36.60 | 36.70 | 36.80 | 36.90 | 36 |
| 37 | 37.00 | 37.10 | 37.20 | 37.30 | 37.40 | 37.50 | 37.60 | 37.70 | 37.80 | 37.90 | 37 |
| 38 | 38.00 | 38.10 | 38.20 | 38.30 | 38.40 | 38.50 | 38.60 | 38.70 | 38.80 | 38.90 | 38 |
| 39 | 39.00 | 39.10 | 39.20 | 39.30 | 39.40 | 39.50 | 39.60 | 39.70 | 39.80 | 39.90 | 39 |
| 40 | 40.00 | 40.10 | 40.20 | 40.30 | 40.40 | 40.50 | 40.60 | 40.70 | 40.80 | 40.90 | 40 |
| 41 | 41.00 | 41.10 | 41.20 | 41.30 | 41.40 | 41.50 | 41.60 | 41.70 | 41.80 | 41.90 | 41 |
| 42 | 42.00 | 42.10 | 42.20 | 42.30 | 42.40 | 42.50 | 42.60 | 42.70 | 42.80 | 42.90 | 42 |
| 43 | 43.00 | 43.10 | 43.20 | 43.30 | 43.40 | 43.50 | 43.60 | 43.70 | 43.80 | 43.90 | 43 |
| 44 | 44.00 | 44.10 | 44.20 | 44.30 | 44.40 | 44.50 | 44.60 | 44.70 | 44.80 | 44.90 | 44 |
| 45 | 45.00 | 45.10 | 45.20 | 45.30 | 45.40 | 45.50 | 45.60 | 45.70 | 45.80 | 45.90 | 45 |
| 46 | 46.00 | 46.10 | 46.20 | 46.30 | 46.40 | 46.50 | 46.60 | 46.70 | 46.80 | 46.90 | 46 |
| 47 | 47.00 | 47.10 | 47.20 | 47.30 | 47.40 | 47.50 | 47.60 | 47.70 | 47.80 | 47.90 | 47 |
| 48 | 48.00 | 48.10 | 48.20 | 48.30 | 48.40 | 48.50 | 48.60 | 48.70 | 48.80 | 48.90 | 48 |
| 49 | 49.00 | 49.10 | 49.20 | 49.30 | 49.40 | 49.50 | 49.60 | 49.70 | 49.80 | 49.90 | 49 |
| 50 | 50.00 | 50.10 | 50.20 | 50.30 | 50.40 | 50.50 | 50.60 | 50.70 | 50.80 | 50.90 | 50 |

Distance of slope stake from side or shoulder stake for any width roadway, slope 1 to 1. If ground is nearly level, the cut or fill at side stake is located by the double entry method in left column and top row. The number in body of table in same row and column gives distance from side stake to slope stake. If ground is not level estimate the difference in elevation between the side stake and slope stake, lower target by this amount if cut, elevate if fill. Add this amount to cut or fill and find distance in table. Set up rod at this point, and line of sight should cut target. If it does not make the slight adjustment necessary.

PAGES

INDEX

DATE

1-6 STORM DRAIN SURVEY 7-TH TO 16-TH ON MARKET 3-17-54

21 PROPOSED DRAIN - GIRARD ST. VIRGINIA-WAY SLY to Center

BUSINESS DISTRICT STORM DRAIN
 SURVEY FROM ELY LINE 10-TH AVE
 TO ELY LINE 7-TH AVE W.O. 32361

NOTE: for additional Notes
 See FB 2318

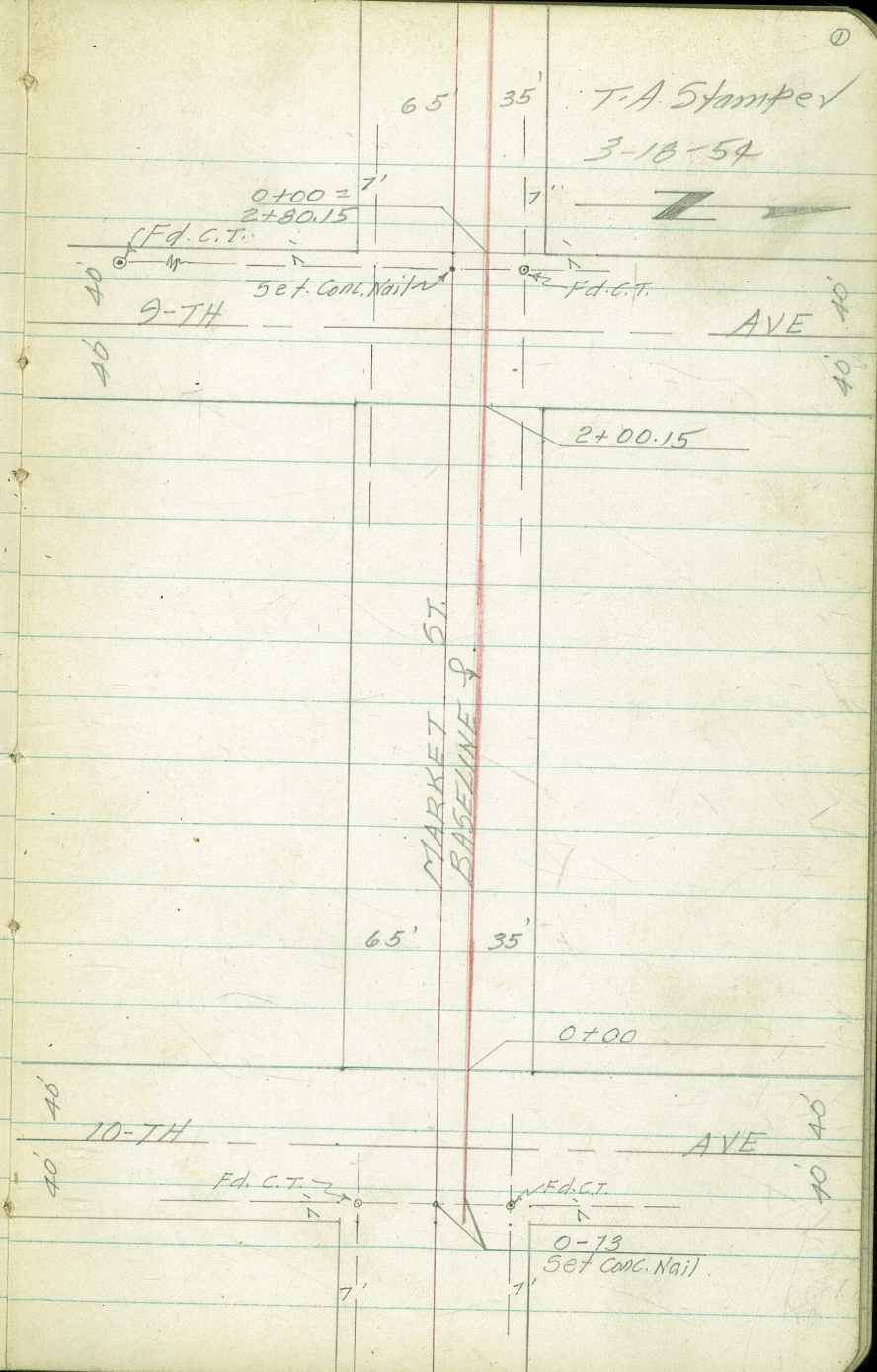

BASELINE CONTD

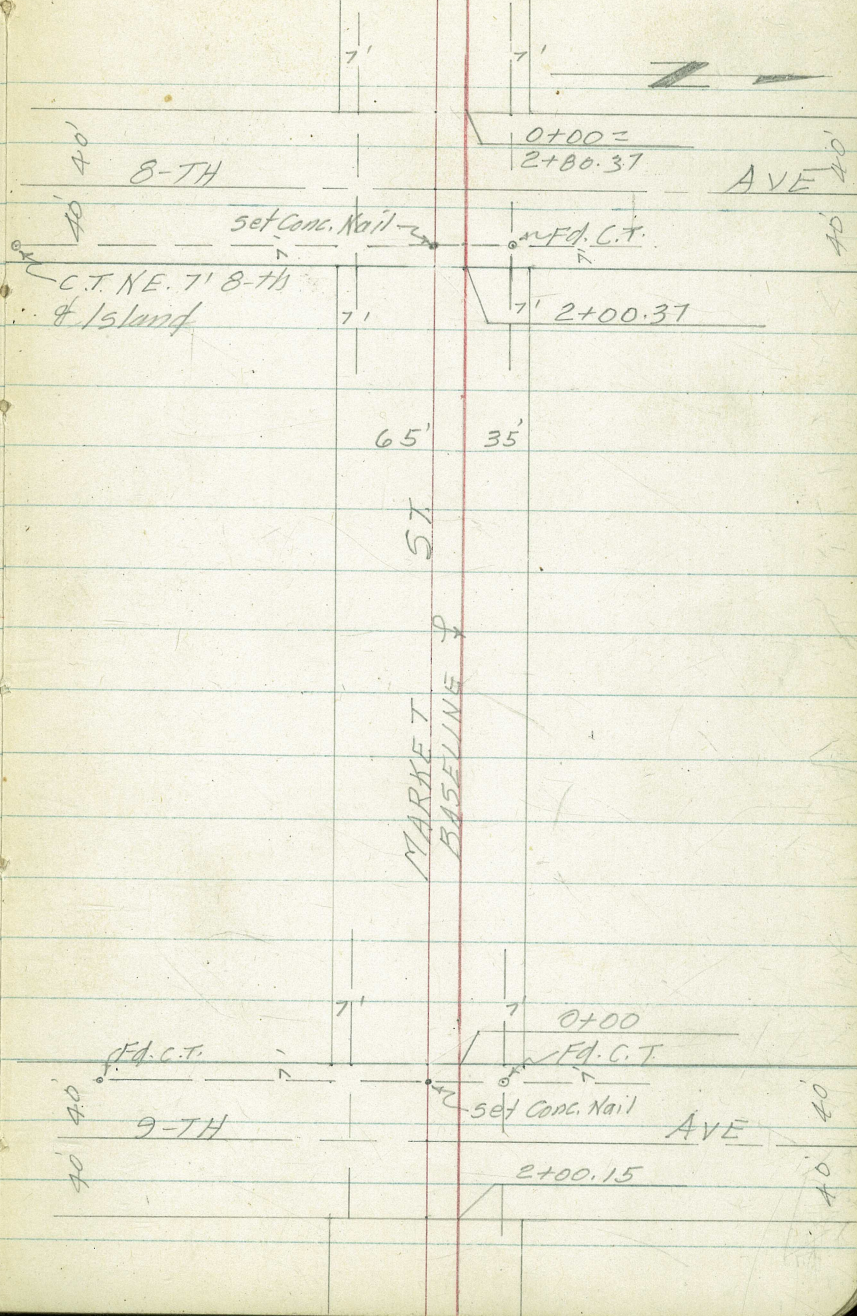

BASELINE CONTD.

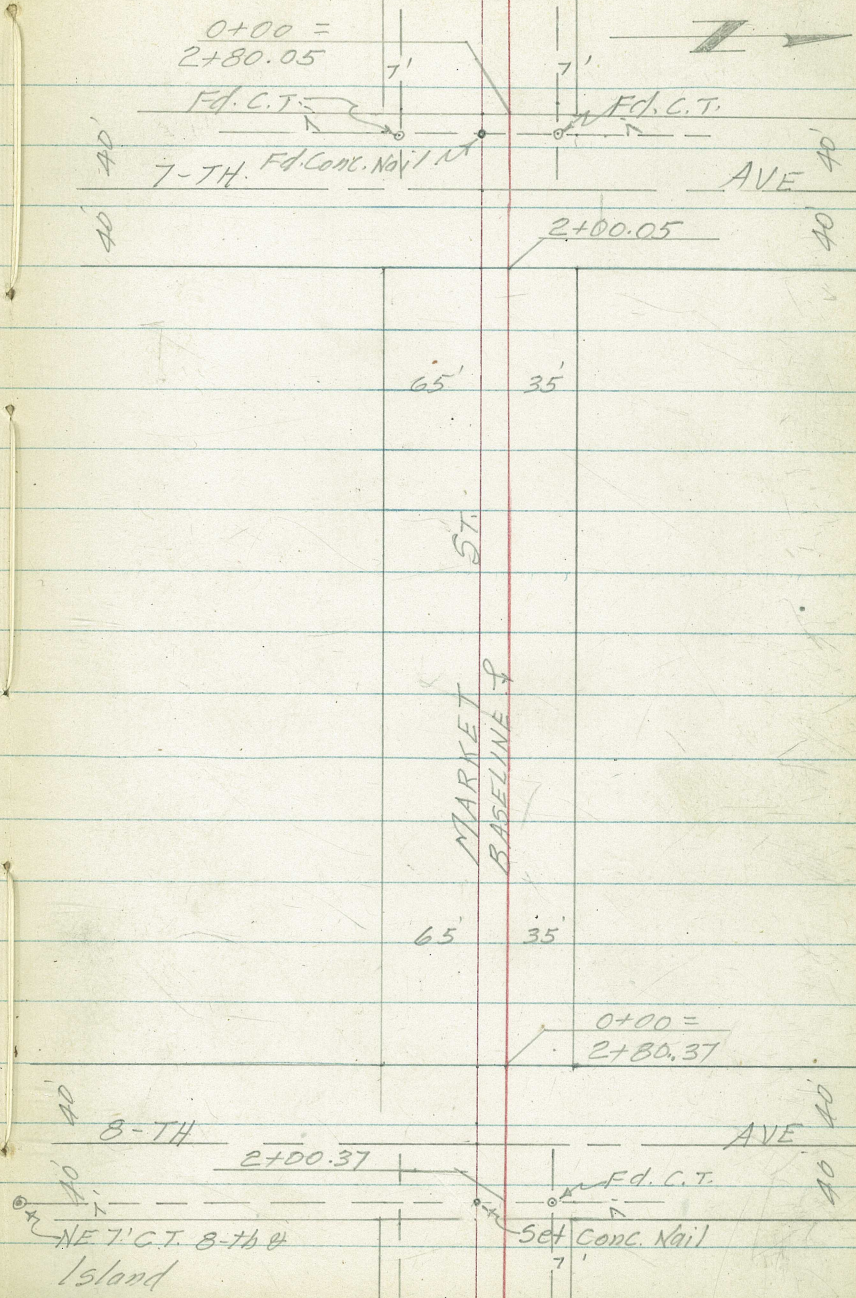

STORM DRAIN SURVEY WLY ALONG
MARKET ST. 10-TH TO 9-TH AVE

Lt. ± Pt. ④
3-18-54

34.08
18"
Top MH

| | | | |
|------------------------------------------------------------|-----------------|----------------|--------------------------------|
| 2+15-18° Pt. & 2" M.H. ? | | | |
| 2+14.15 Fly Gutter 9-th | | | 34.30 |
| 2+12 ⁵ -50 ⁵ Lt. & 2' Dia Sewer M.H. | 33.08 | | |
| 2+00.15 - Fly Line 9-th Ave | 50 ⁵ | | |
| 1+50 | Top Wly Rim | | 34.48 |
| 1+00 | | | 35.31 |
| 0+50 | | | 36.38 |
| 0+00 - Wly Line Tenth Ave | | | 37.38 |
| 0-14 Wly Gutter Tenth Ave | | | 38.32 |
| 0-22 ⁵ 40' Lt. & 2' Dia. Gas Co. M.H. | | | 38.53 |
| 0-40 - 65° Lt. & 2' Dia. Sewer M.H. | 38.06 | | |
| | 40 | | |
| | Top Wly Rim | 37.85 | 38.90 |
| | | 65° | |
| | | Top Wly Rim | |
| 0-66 - Fly Gutter | | | 39.22 |
| 0-80 Fly Line Tenth Ave. | | | 39.45 |
| B.M. 1 | 33.65 | 33.51 | NW BP 9-th & Market |
| T.P. | 31.61 | | |
| B.M. 2 | 30.38 | | Top F.H. NE. Cor 7-th & Market |

STORM DRAIN SURVEY WLY ALONG MARKET
 ST.; 9-TH To 8-TH. AVE

| | | |
|---------------------------------------|---------|-------|
| 2+66.37 - Wly Gutter line 8-th Ave | | 29.62 |
| E 8-th Ave | | |
| 2+40.37 - 65° Lt. E 2' Dia. Sewer M.H | 28.61 | 29.84 |
| | 65° | |
| | Top Wly | |
| | Rim | |
| 2+14.37 Ely Gutter 8-th Ave | | 30.09 |
| 2+00.37 Ely Line 8-th Ave | | 30.21 |
| 1+50 | | 31.06 |
| 1+00 | | 32.01 |
| TP | | |
| 0+50 | 31.61 | 32.89 |
| 0+00 Wly Line 9-th Ave | | 33.71 |
| 0-14 - Wly Gutter 9-th | | 33.84 |
| 66° Lt. E 2' Dia. Sewer M.H. | | |
| 0-40 E 9-th Ave | 33.00 | 34.05 |
| | 66° | |
| | Top Wly | |
| | Rim | |

STORM DRAIN SURVEY WLY ALONG
MARKET ST 8-TH TO 7-TH AVE

B.M.

30.39

30.38 Top F. Hyd. NE Cor 7-th & Market St

2+00.05 Ely Line 7-th Ave

27.66
0

1+50

28.08
0

1+00

28.57
0

0+97-13° Rt. & 2⁵ Dia M. H.

28.24
13°
Top Wly
Rim

0+50

29.66
0

0+00 Wly Line 8-th Ave

29.52
0

3-18-54

8

STORM DRAIN SURVEY CONTD
S.E. CURB RETURN @ 4-TH & G-ST.

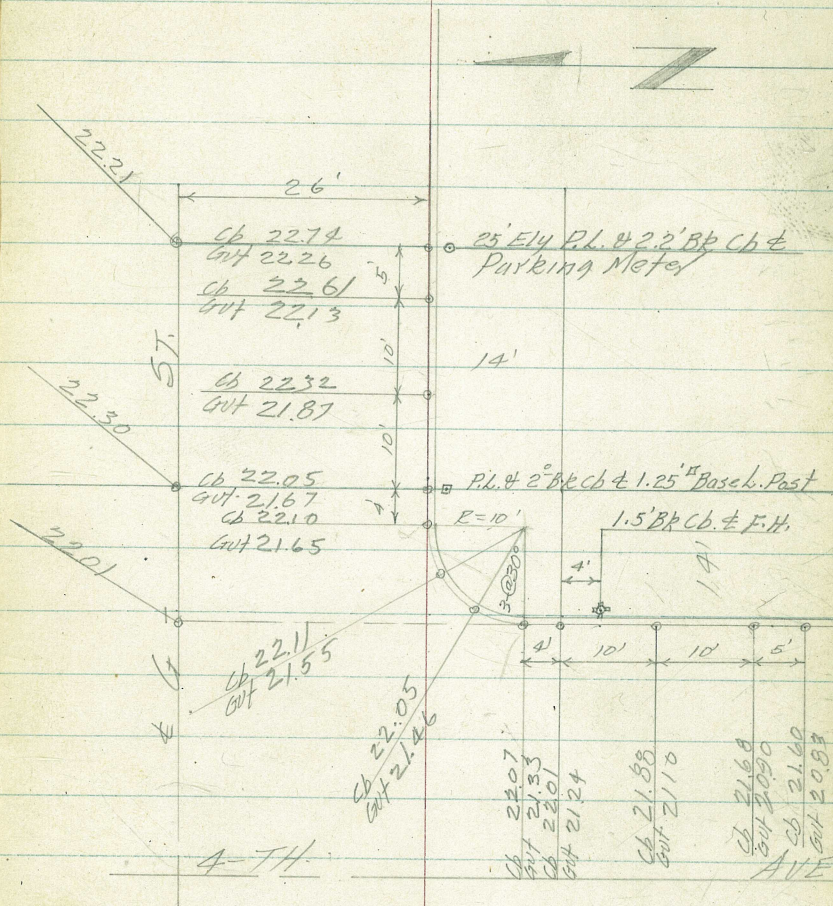

B.M.

26.36

S.E. B.P. 5th & G

STORM DRAIN SURVEY CONTD
S.E. CURB RETURN @ 4-TH BROADWAY

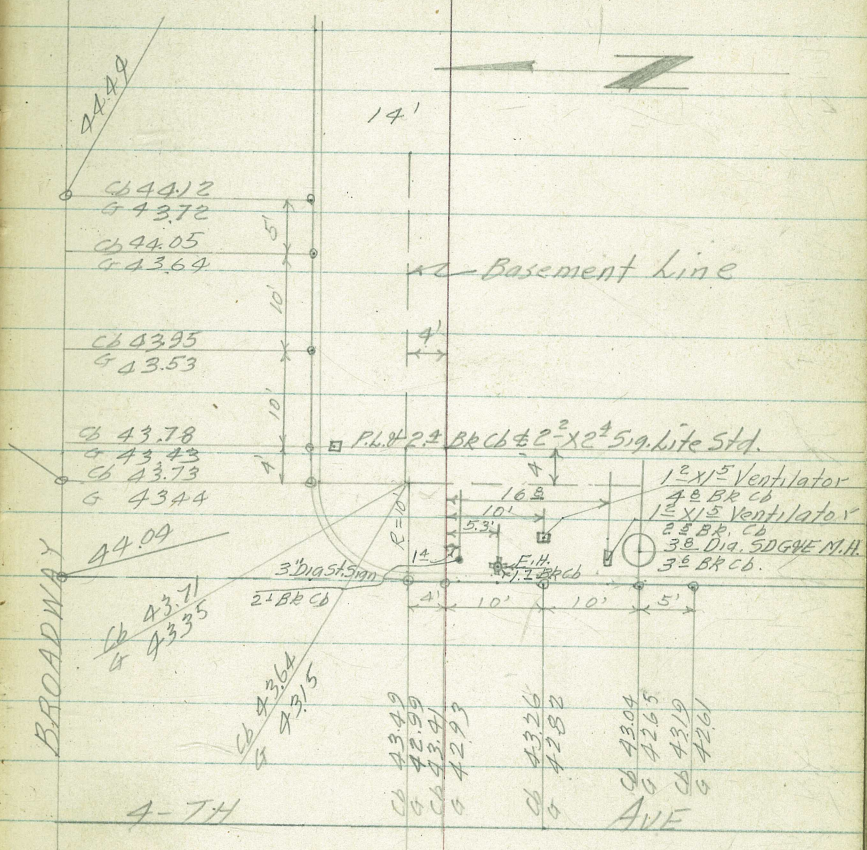

B.M.

43.85

SWBP 4-Th of Broadway

3-18-54

(10)

STORM DRAIN SURVEY CONTD SE CURB RETURN @ 5-TH & BROADWAY

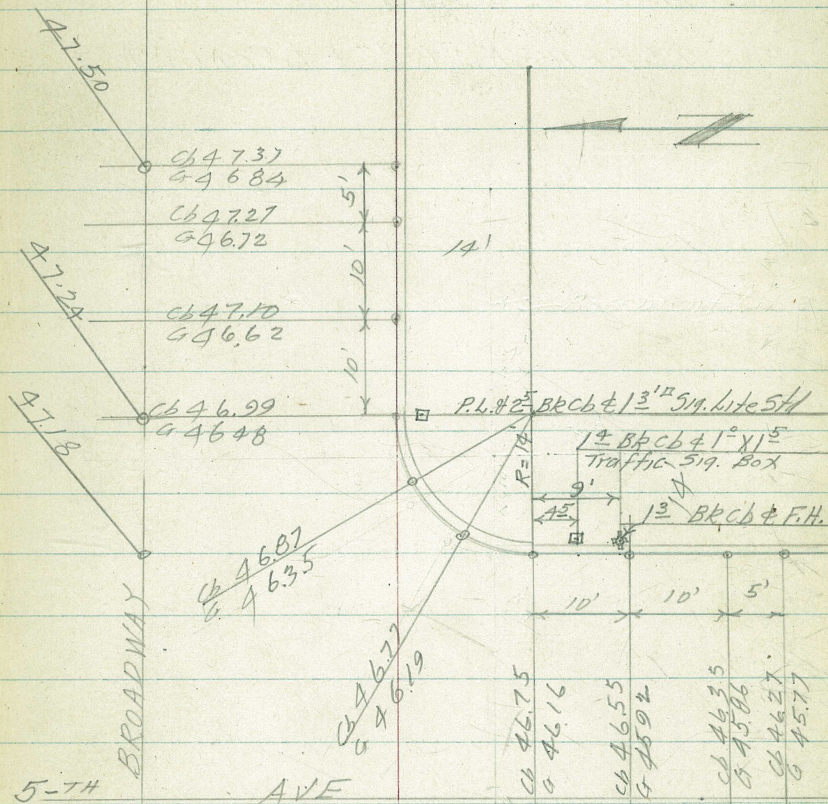

B.M.

43.85

S.W. B.P. 4-TH & Broadway

3-19-54

(11)

STORM DRAIN SURVEY CONTD SE. CURB RETURN @ 6-TH & BROADWAY

NOTE: W.M. = Water Meter Vault

P.M. = Parking Meter

F.H. = Fire Hydrant

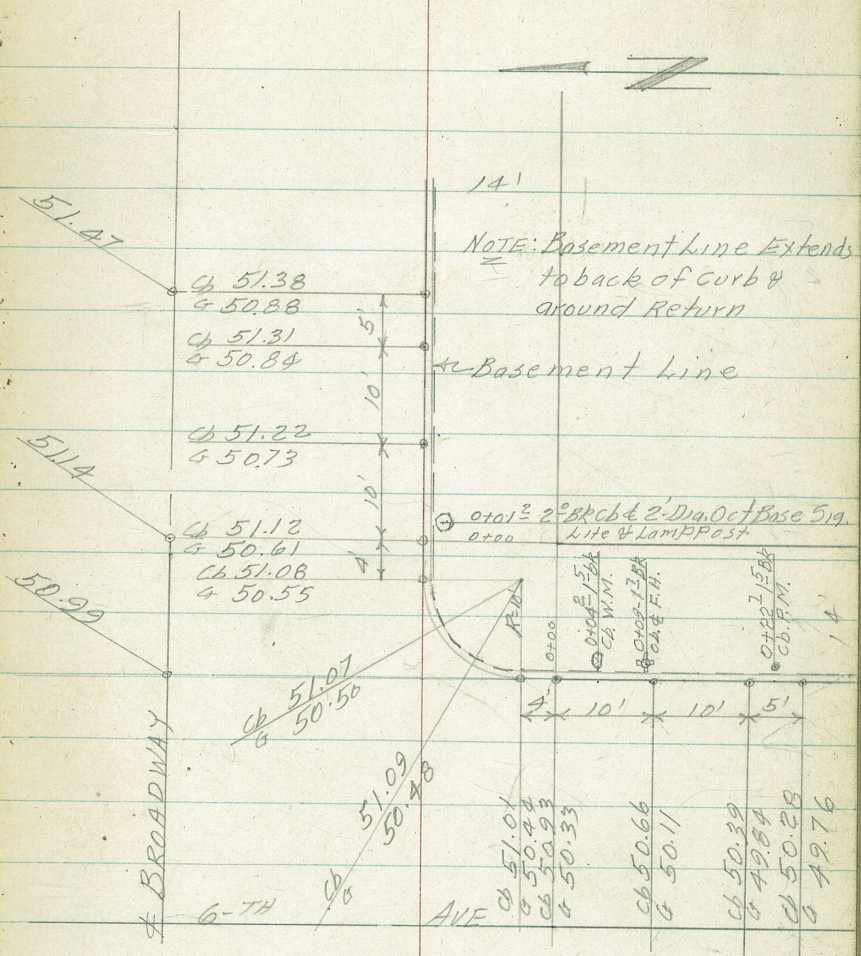

B.M.

62.29

Top N.E. F. Hyd 7-th & C

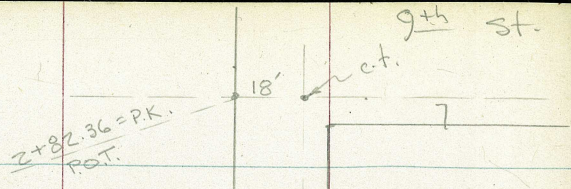

Prop. Storm Drain →

7'
7'

→ Z

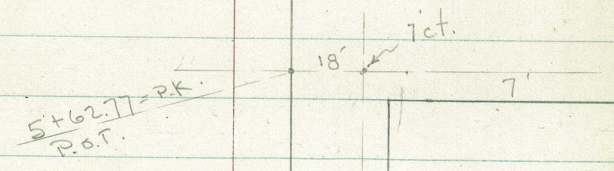
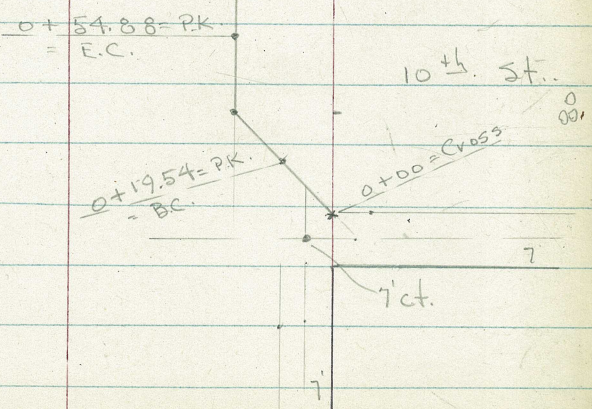

7'
7'

9th St.

50'

7th St.

6th St.

8+42.73 = P.K.
= P.O.T.

11+23.85 = P.K.
= P.O.T.

11+12.35 = P.K.
Ang. 5° Rt.
10

10+54.76 = P.K.
Ang. 5° Lt.
10

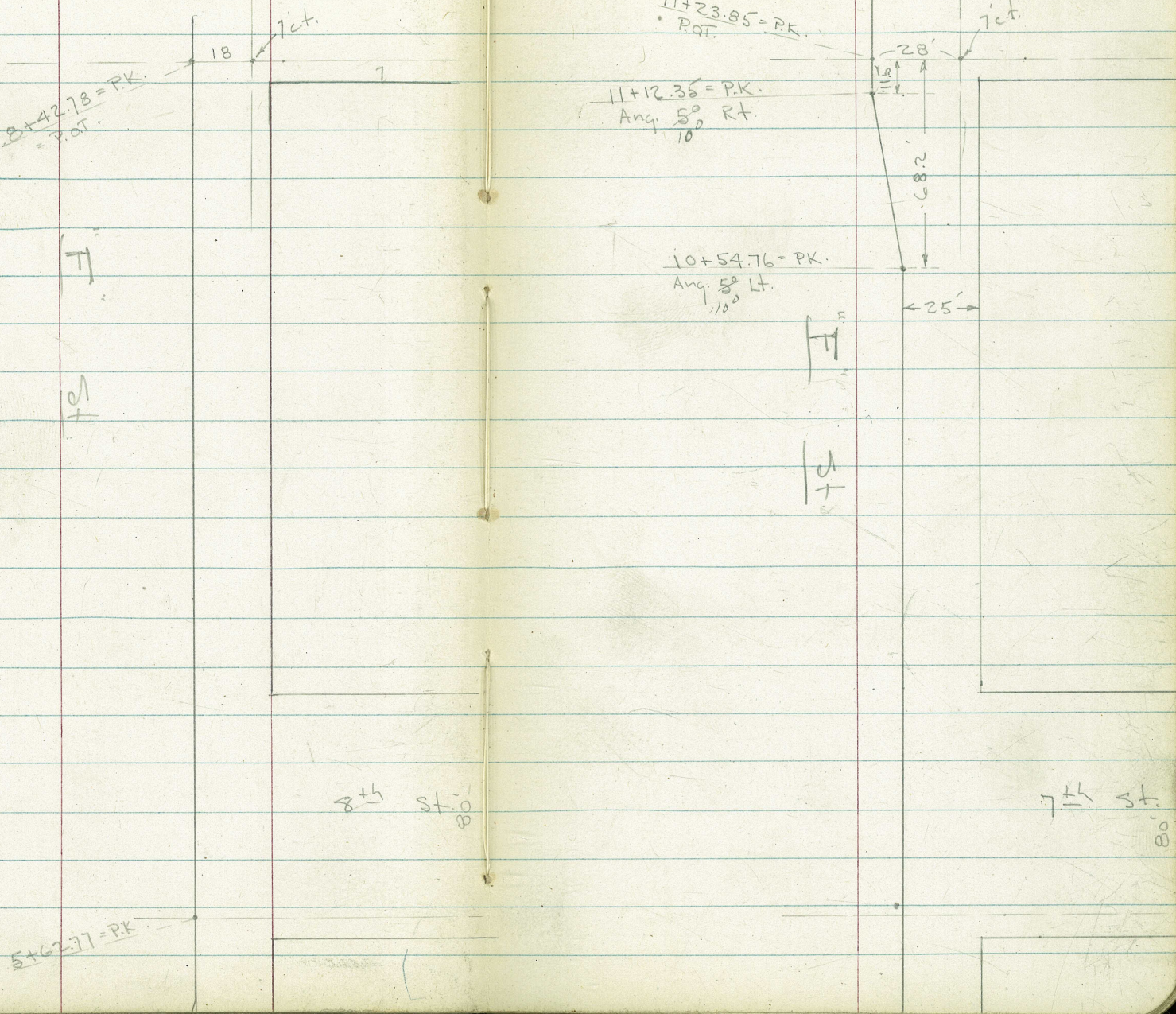

8th St.
80

7th St.
80

5+62.77 = P.K.

$14+07.20 = \text{P.K.}$
P.O.T.

28'

ct.

5th St.

10'

7

← 35' →

6th St.
80

$17+07.33 = \text{P.K.}$
= end.

$16+84.33 = \text{P.K.}$
P.O.T.

28'

7' ct.

4th St. K

7

7

5th St.
80

$14+07.20$

ct.

10'

7

Lt. E Rt.

Req. Levels along E of Prop. Drain in
"F" St. - See Sketch - P. 12-14

See P. 17 for Ret. Elev. - Cont. on P. 18

5+50.77 = S.F. of E.L. 8th - See Plan.

44.80

5+00

46.12

4+50

47.34

4+00

48.59

3+50

49.62

Set B.M. = N.E. 7th Id. + ct. - 9th 50.63

3+00

50.26

2+50

50.79

2+00

51.35

1+50

51.89

1+00

52.44

E.C. = 0+54.88

52.84

0+19.54 = B.C.

52.93

0+00.4 = db. face on E

53.27
Top

52.86
gut.

0+00 = Cross. on cb. 2' N. of N.L. F.

53.27
on Cross

B.M. = Id. + ct. 7th - N.E. Cor. 53.18

10th + F

Actual Elev. Shown.

Levels - N.E. Cor. 8th & F

BM = N.W. 7' Ld tot.
8th & F.

43.68

8th St

8th St

F St

Top 45.52
gut 44.76

Top 45.21
gut 44.39

Top 45.06
E.C. Top 45.04
gut 44.30

2/3 Top 45.06
gut 44.27

1/3 Top 45.06
gut 44.27

P.C. = Top 45.06
gut 44.18
Top 45.08
gut 44.75

Top 45.33
gut 44.47

Top 45.87
gut 44.72

Top 45.70
gut 44.94

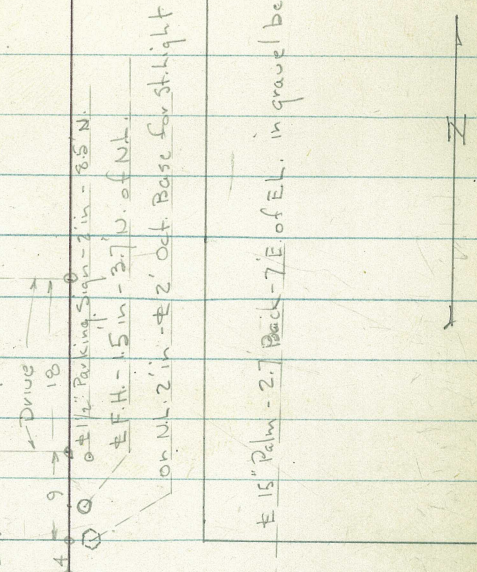

± 15" Palm - 2.7' Back - 7' E of E.L. in gravel bed.



13+00
 12+50
 Sec B. 2318-P 29
 check B.M. = S.W. B.P. - 6th & F 36.22
 12+00
 11+70.7 - 42' It = ϕ Sewer M.H. - Covered.
 11+60
 11+35' - 6' Rt. = ϕ 3' Steam M.H.
 11+12.35' = Ang. Pt.
 10+54.76 = Ang. Pt.
 Set B.M. = on N.E. 7th direct - 7th 41.20
 9+50
 9+00
 8+50
 8+32.78 = 3' E. of EL
 8+00
 7+50
 7+00
 6+50
 6+00
 Cont. from P. 16

18

| Lt. | ϕ . | Rt. |
|---------|----------|---------|
| | 34.87 | |
| | 35.59 | |
| | 36.21 | |
| 36.42 | 36.44 | |
| 42 | | |
| on A.C. | 36.41 | |
| | 36.35 | 36.41 |
| | 36.52 | 6 - Rim |
| | 37.54 | |
| | 38.59 | |
| | 39.54 | |
| | 40.48 | |
| | 41.01 | |
| | 41.00 | |
| | 41.35 | |
| | 41.87 | |
| | 42.37 | |
| | 43.02 | |
| | 43.87 | |

Lt. ± Rt.

Check B.M. = S.W. B.P. 4th + F 28.73

17 + 07.33 = End.

check B.M. = 33.12

33.15 - B. 2318 - P. 31

29.50

29.53

21 = cb.
Line

16 + 77.33 = E. 4th

29.75

16 + 50

30.18

16 + 00

31.10

15 + 50

32.07

Check B.M. = S.W. B.P. - 5th + "F" 32.97

15 + 00

32.98

14 + 51 - 4.1' Lt. = ± Sewer M.H.

33.52

4.1 = Rim

14 + 40

33.55

14 + 15.5 - 7.5 Rt. = ± 3' Steam M.H.

33.62

14 + 02.5 - 5.5 Rt. = ± 22' x 15' Grate - Inlet

7.5
Rim

33.55

5.5 = Top
grate

14 + 00

33.62

13 + 50

34.18

Levels - N.E. Cor. 8th + Market

B.M. = N.W. B.P. 9th + Market. 33.65
Sec P. 4

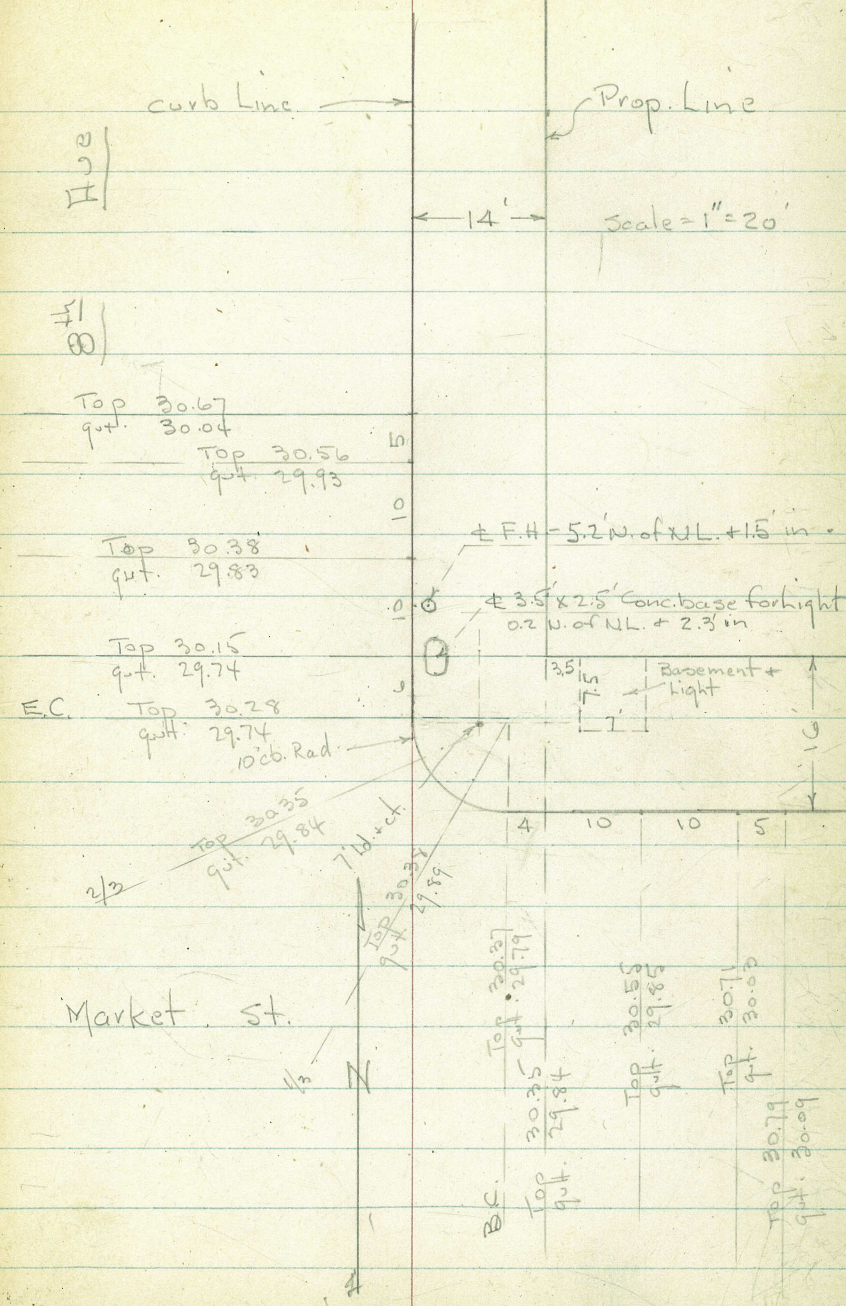

Clark
Shepherd
Engineer
B'Veils
5-28-54
W.O. 32995

PROPOSED DRAIN ("RAYNA ST")
GIRARD AVE. SECTION:
VIRGINIA WAY - S'ly to GENTER ST

REF: FB 1769-36
7.5 2/47
" 2/60

INDEXED
HER
JUN 11 1954

Set P.M. = 0412.62

90°

5.84'

PERRI

Set P.M. = 6731.16

ST.

Proposed Drain

Set P.M. - 0100.54

ax. 38' R.O.P

HANSCH L. WAY

Proposed Drain

Sketch not to scale:

notes: Pg 23

VIRGINIA WAY

Set P.M. = 0480.62

GIRARD
(Ac. P.M.)

Set P.M. = 0412.62

Set P.M. = 0100.54

For detail exist. inlet see opp. pg.

DETAIL EXIST. CB INLET: GIRARD & VIRGINIA-WAY
AS-BUILT

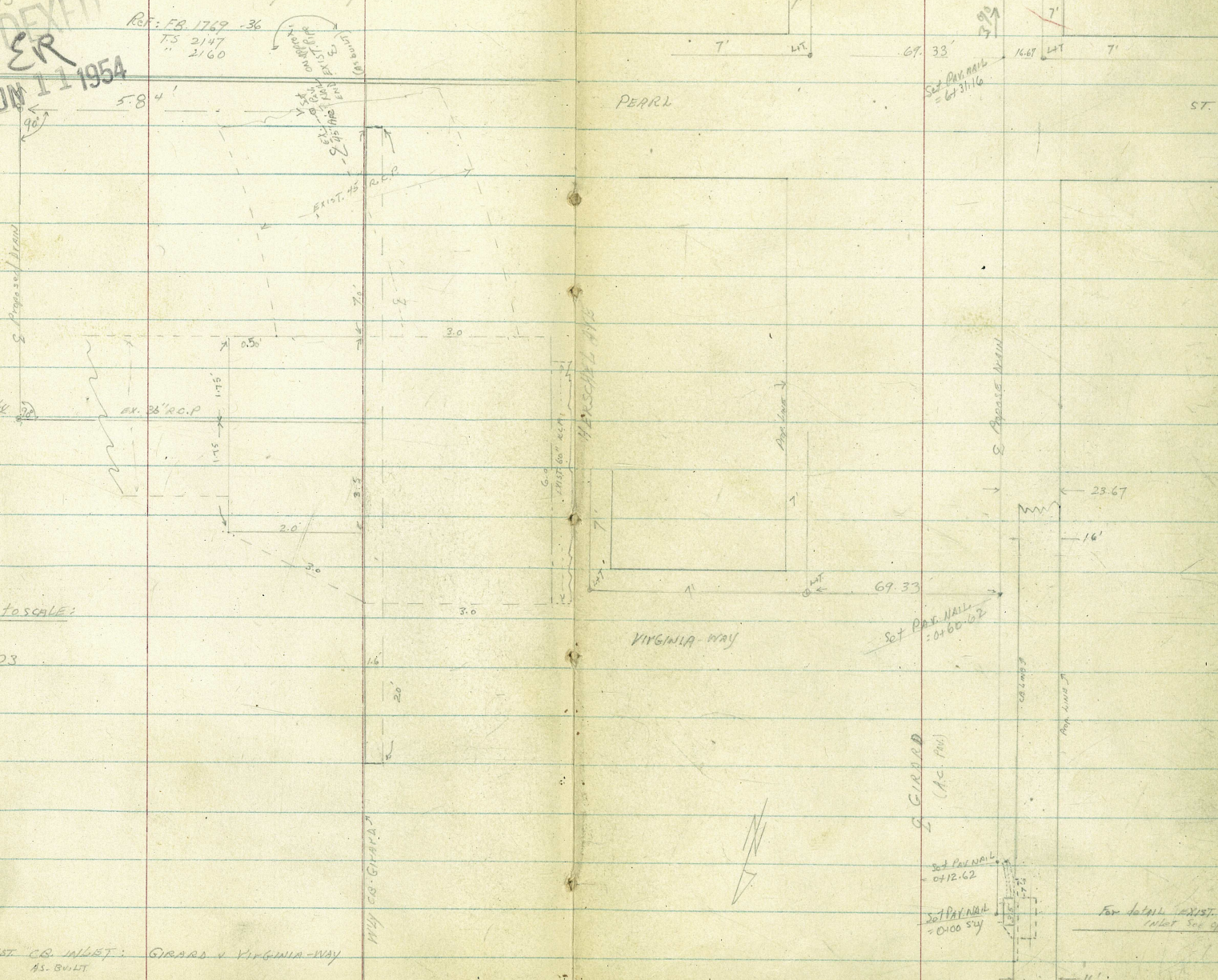

Ed 3/4" Pipe
L.S. 2201

(See opp. pg)
= 14+79.22

P.I. Set
= 13+60.92
Δ = 30° BT

(ENCLOSURE WALL)
BY CABLE
WALL

Ed 3/4" Pipe
L.S. 2201

Set PAR. WALL
P.I. = 12+48
Δ = 38° BT

18+55.21
P.I.
Set XI
Δ = 87° BT

Set HUB P.I.
= 17+90.66
Δ = 32° 07' 30" BT

Ed 3/4" Pipe
L.S. 2201

Ed 3/4" Pipe
L.S. 2201

CENTER

Ed 3/4" Pipe
L.S. 2201

Ed 3/4" Pipe
L.S. 2201

Set P.I. WALL
= 10+57.96

Ed 3/4" Pipe
L.S. 2201

P.I. Set
= 16+91.57
P.I. MARKED IN CONC.
Δ = 27° 35' 45" BT

16'

GUTTER

Proposed drain

Proposed drain

Proposed drain

Proposed drain

Set PAR. WALL
= 12+37.18

Ed 3/4" Pipe
L.S. 2201

14+79.22

PEARL ST.

(See opp. pg)

GIRARD AVE DRAIN

(L.S.) LT.

E

RT. (W4)

23

3+00

102.28
1.19
26.33
1.47
102.50
1.83
102.14
101.72
2.25
7.67
C
1.77
7.67
T_B

2+50

100.55
3.42
10
100.20
3.77
4.15
7.67
C
99.82

2+00

99.90
5.07
26.33
98.47
5.30
10
98.34
5.63
6.03
7.67
C
97.94
98.58
5.59
7.67
T_B

1+50

96.83
7.14
10
96.46
7.51
7.95
1.67
C
96.02

1+00

95.5A
8.43
26.33
Eornd
95.26
8.71
10
94.86
9.11
9.50
7.67
C
94.47
95.21
8.76
7.67
T_B

0+50

94.04
9.89
10
93.76
10.21
93.43
10.54
7.67
C

0+12.62 5.84 RT = APPROX END EXIST 45" R.C.P. (E)

93.37
10.60
10
92.83
11.14
92.46
11.51
5.84
on Pav
92.14
11.50
7.67
C

0+00 7.67 RT = EXIST INLET (see sketch)

93.8A
10.13
26.33
S.GIRARD
93.19
10.78
10
92.52
11.45
81.28
22.69
7.67
Box
92.10
11.87
7.67
GUT
92.05
11.02
7.67
T_B
C_B

T.P. 0.21 103.97 12.72 103.76

103.97

B.M. 1.31 116.48

115.17 = S.E. B.P.
GIRARD &
PEARL

GIRARD AVE. DRAIN (CONT)

LT E RT

6+24 = SLY CB. LINE Pearl

5+98 = E PEARL

T.P. 11.88 123.84 1.30 111.96

5+72 = NLY CB. LINE Pearl

Note: for detail on Returns Girard & PEARL See Pg 31

5+50

5+00

4+50

4+00

3+50

T.P. 9.32 113.26 0.03 103.94

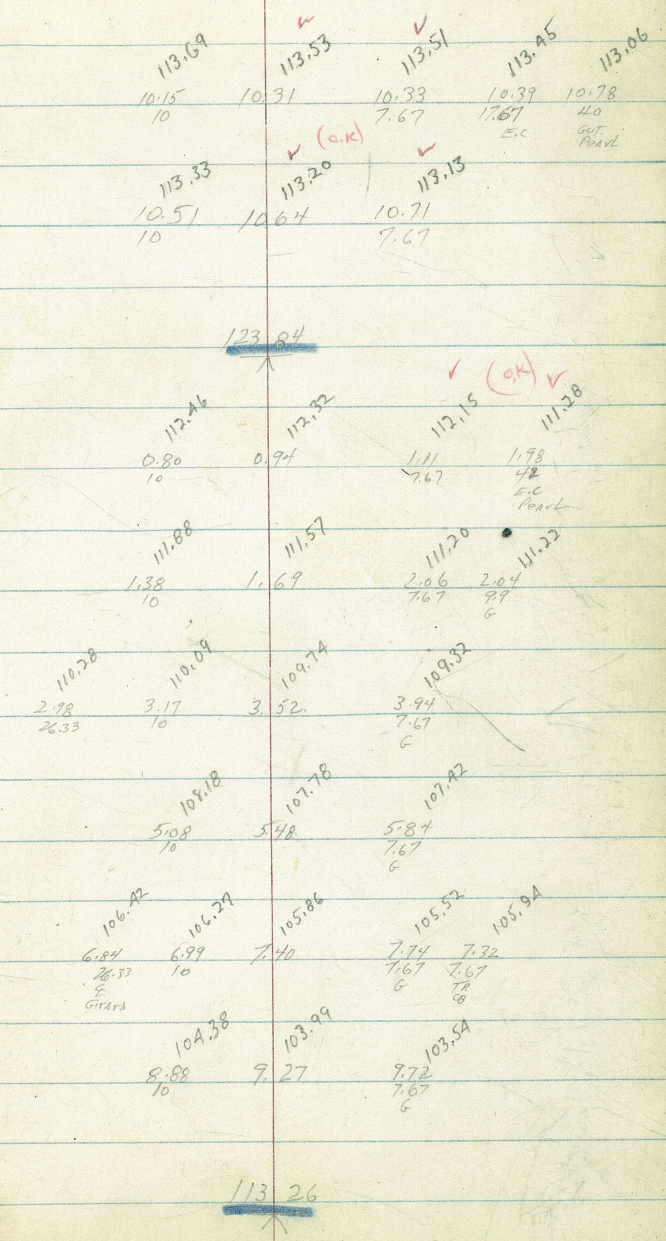

GIRARD DRAIN (Cont.)

LT.

£

RT.

25

10+00

128.21 128.08 127.86 127.72 128.39
 3.41 3.54 3.76 3.90 3.23
 26.33 10 7.67 7.67 7.67
 G G G

9+50

126.14 125.90 125.72
 5.48 5.72 5.90
 10 7.67 7.67
 G G

9+00

124.39 124.23 124.02 123.84 124.40
 7.23 7.39 7.60 7.78 7.22
 26.33 10 7.67 7.67 7.67
 G G G

8+50

122.21 121.99 121.87
 9.41 9.63 9.75
 10 7.67 7.67
 G G

8+00

120.53 120.16 120.02 119.96 120.53
 11.07 11.46 11.60 11.66 11.40
 26.33 10 7.67 7.67 7.67
 G G G

T.P.

7.06 131.62 128 122.56

131.62

7+50

118.57 118.04 117.92
 5.57 5.80 5.92
 10 7.67 7.67
 G G

7+00

116.65 116.37 116.17 116.09 116.62
 7.19 7.47 7.67 7.75 7.22
 26.33 10 7.67 7.67 7.67
 Girard G G

6+50

114.71 114.51 114.01
 9.43 9.53 9.83
 10 7.67 7.67
 G G

123.84

GIRARD DRAIN (CONT.)

13+51.4 = { N.W. Edge 2-PLANK (2" x 12") CATWALK (Temporary)
BUILT Along Edge EXIST PAV - EXTENDS FROM ELY CB
21' toward E. Guard

13+46.5 - 9.7 RT E Beg Cobble Wall.

13+00 (Approx. E Guard)

12+48 Sect 90° Fori TANG

12+48 = L LT. 30' (Sect 90° BK. TANG)

T.P. 12.89 151.02 1.50 138.13

12+00

11+50

11+00

10+50

T.P. 9.97 139.63 1.96 129.66 ON DISC. & ST.
10+37.96

5000
37.96
12.00

LT. E RT.

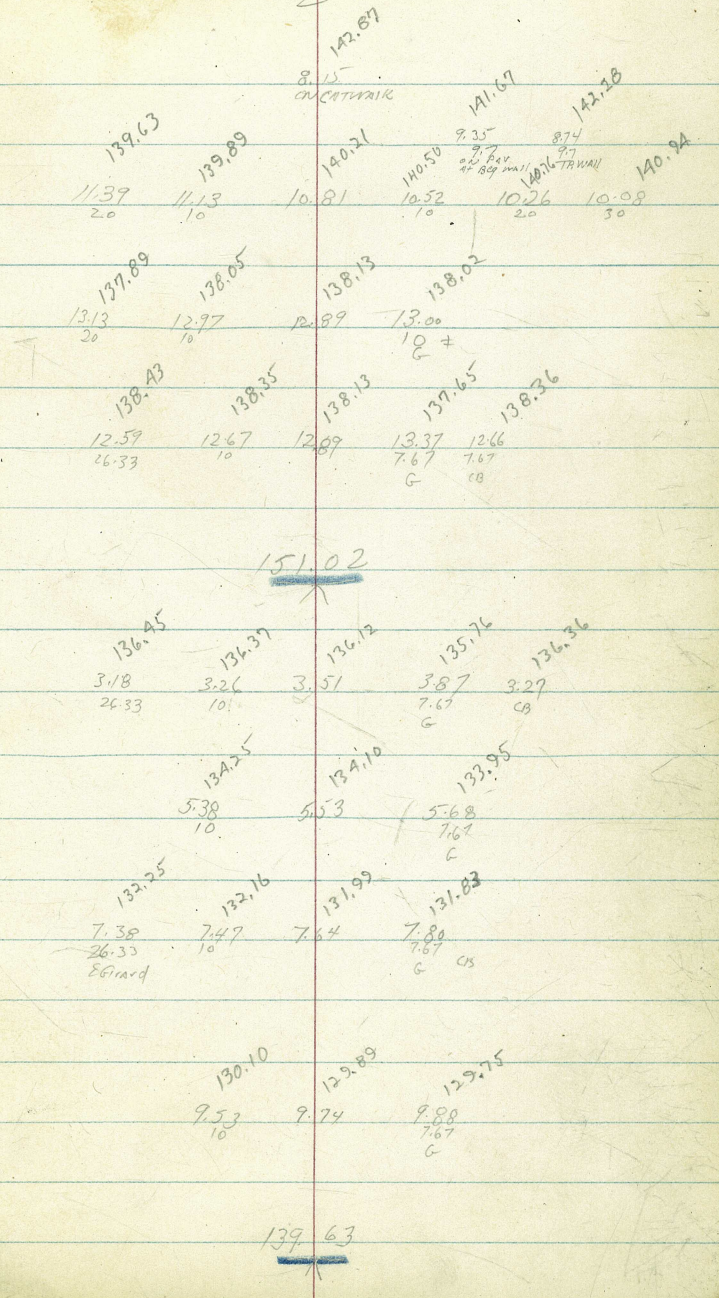

GIRDARD DRAIN (CONT)

LT.

£

RT.

27

14+82

6.5' LT & Rile #1345 ✓

14+62

5.5' LT & Deadman ✓

14+50

14+00

(showing along school yd)

for survey to Jolla school yd - L.S. 2201 - P. Lot #1262
Note: for addl details this area see sheets #1 & 2.

13+68.50

5.7' LT & to wly end 12" C.Pipe (90° to ST)
Drains water into ditch From inlet in school yd.
2 1/2" LT & 1.5' x 2 1/2" inlet Box - Drains water
4" x 2.5" N.T.S. CONC. GUTT. From Gutter school yd. Gutter
23' long cobble wall EXTRA. cast iron length school yd.
5' 4" to N.W.

13+60.92

8' LT TP (FC) COBBLED WALL
(Sect. 90° FOR-TANG)
14' RT TP (FC) COBBLED WALL (open ditch)

13+60.92 = L RT 30°

13+60.5

9.2' LT TP (FC) COBBLED WALL (BUILT on a m...
(1:1 RATIO. + BASE CURVED)

13+52.3

(Sect. 90° Prop. & Drain)

13+52.30 Edge EXIST. PAV. LT. (Section along edge Pav.)
8.2' LT to CB FC (MEAS. along line edge PAV.
approx. 60° & Prop. Drain

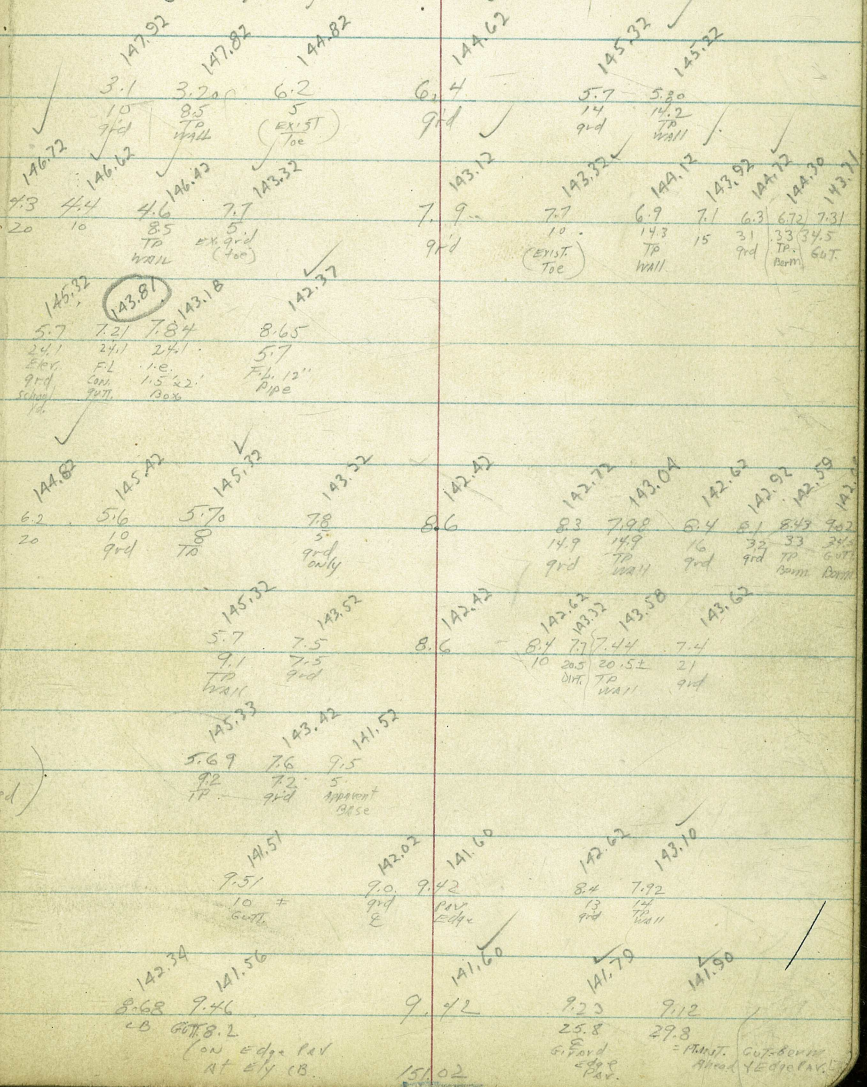

GIRARD DRAIN (CONT.)

16+83 7.6 LT = 1 WALL

16+81.57 (Sect 90° For TANG.)
 27.0 LT TP WALL = 2 LT COBBLE WALL
 35.0 LT E.C.W. GUT = 4 LT.

16+81.57 = 1 LT 27° 35' 45" (Sect 90° BK TANG.)

BRIDGE 20.5 LONG: - 10 RT to WLY END MEAS. along line of bridge

16+76.5 30" LY Edge 4' wide wood Bridge over COBBLED Ditch Approx 90° to For TANG. see above

16+70 13.0 RT = ANGLE PT WALL

16+50

16+00

15+50

15+00

T.P.

11.85 159.34 3.53 147.47

14+95

15.5 RT & 18" Tree

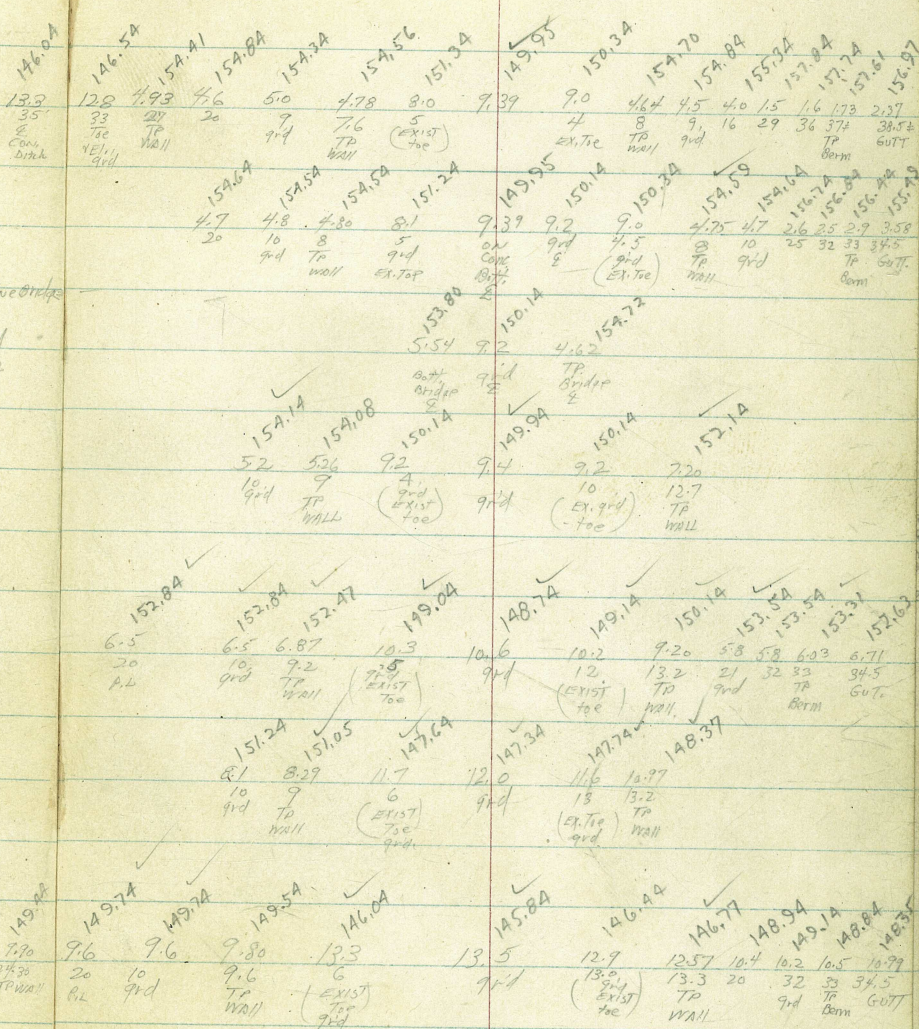

159.34

GIRARD DRAIN (CONT.)

18+03.5 = 8' 4" c.i. Pipe (Runs approx. 4' RT & 4' LT) supported on wooden trestle 4' x 4' verticals - 4' RT & 4' LT of E meas. along Pipe line to school Prop. line E (Sly Prop. Line) Westly

17+90.66 (Sect. 90° Forrtang.)

17+90.66 Beg open ditch ahead - (Section along TP of West Fall above steel wire barricade) (At 90° forrtang.)

3.7 LIE steel R.R. rail
 Wire Fence - Barricade across end of ditch
 3.6 RT E Steel R.R. Rail - used as anchor for steel-
 13.0 RT toe - end Cobble wall - 6 RT tp. wall
 3.5 LT toe - end Cobble wall - 6 LT tp. wall

17+90.66 = 1 RT
 Δ = 32° 01' 30"
 = Pt. int. sly line school property

17+83 24 LT End Cobble wall

17+77 28 RT E End Cobble wall

17+75 33.3 LT Conc. gut. Slightly approx. // sly line school grids

17+69 41.4 RT E Pole #199

T.P. 4 93 163.06 1.21 158.13

17+50

17+00

LT

RT

29

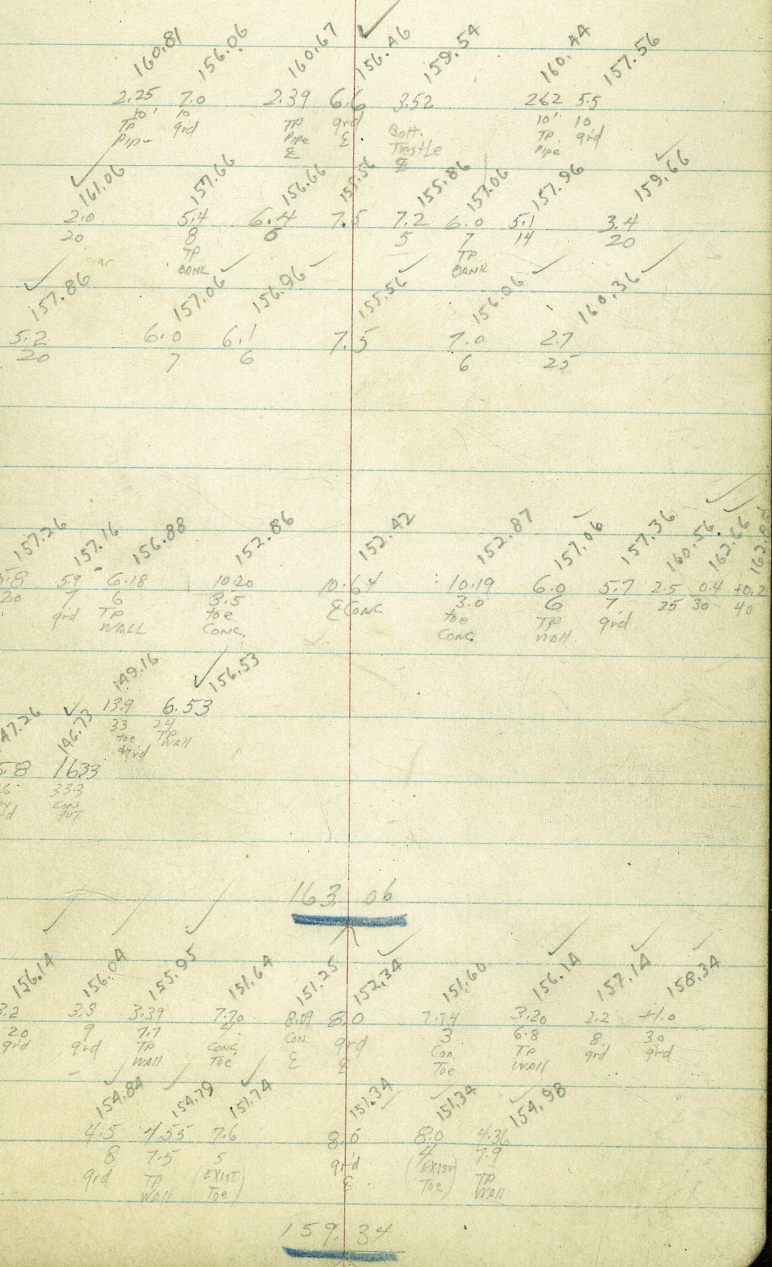

GIRARD DRAIN (CONT)

LT.

E

RT.

Chk:

6.75 158.51 = 158.55 - N.W.B.P.
GIRARD CENTER

19+50

channel Ls to RJ approx. 15°

19+00

in channel ahead

18+55.21

(Sect 90° For. Tang)

18+55.21 = L LT & channel
Δ = 89°

(Sect 90° Bk Tang)

18+45.4

= Sky Edge Bridge - 10.2 RT to Wly Edge ✓

6" x 12" horizontal supports - no vertical supports
connected with 1" x 12" planking

18+34

= Nly Edge 215' x 11 1/2' wooden bridge 7.2 LT to Ely End ✓
(def. angle to Lts along Live Bridge = approx 100°)

18+25

T.P.

5.55 165.26 3.35 159.71

18+10

12' RT & 28" tree ✓

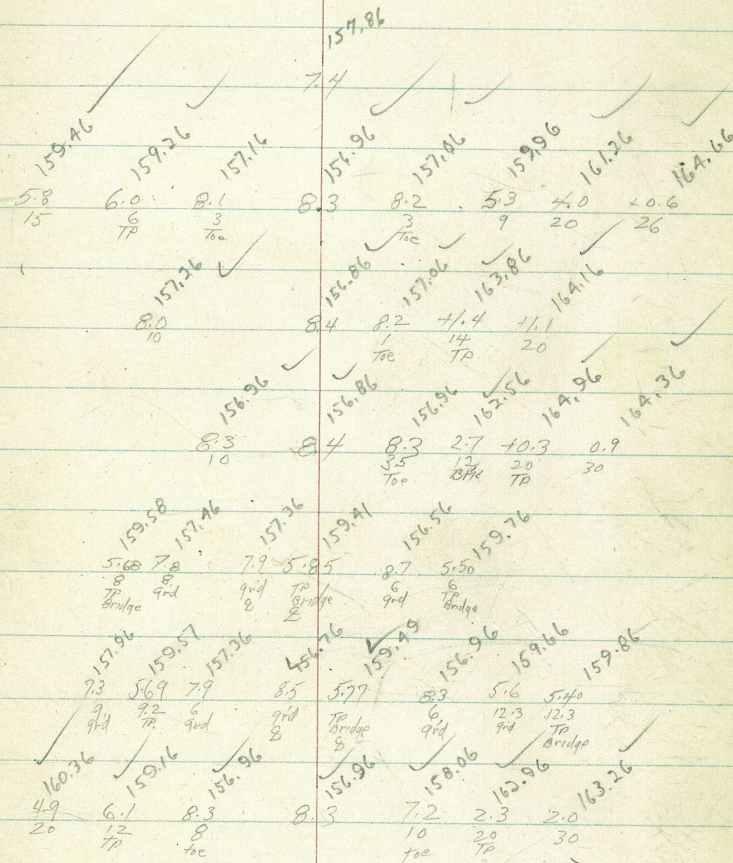

165.26

Reduced by
Hadtko. 6-11-54

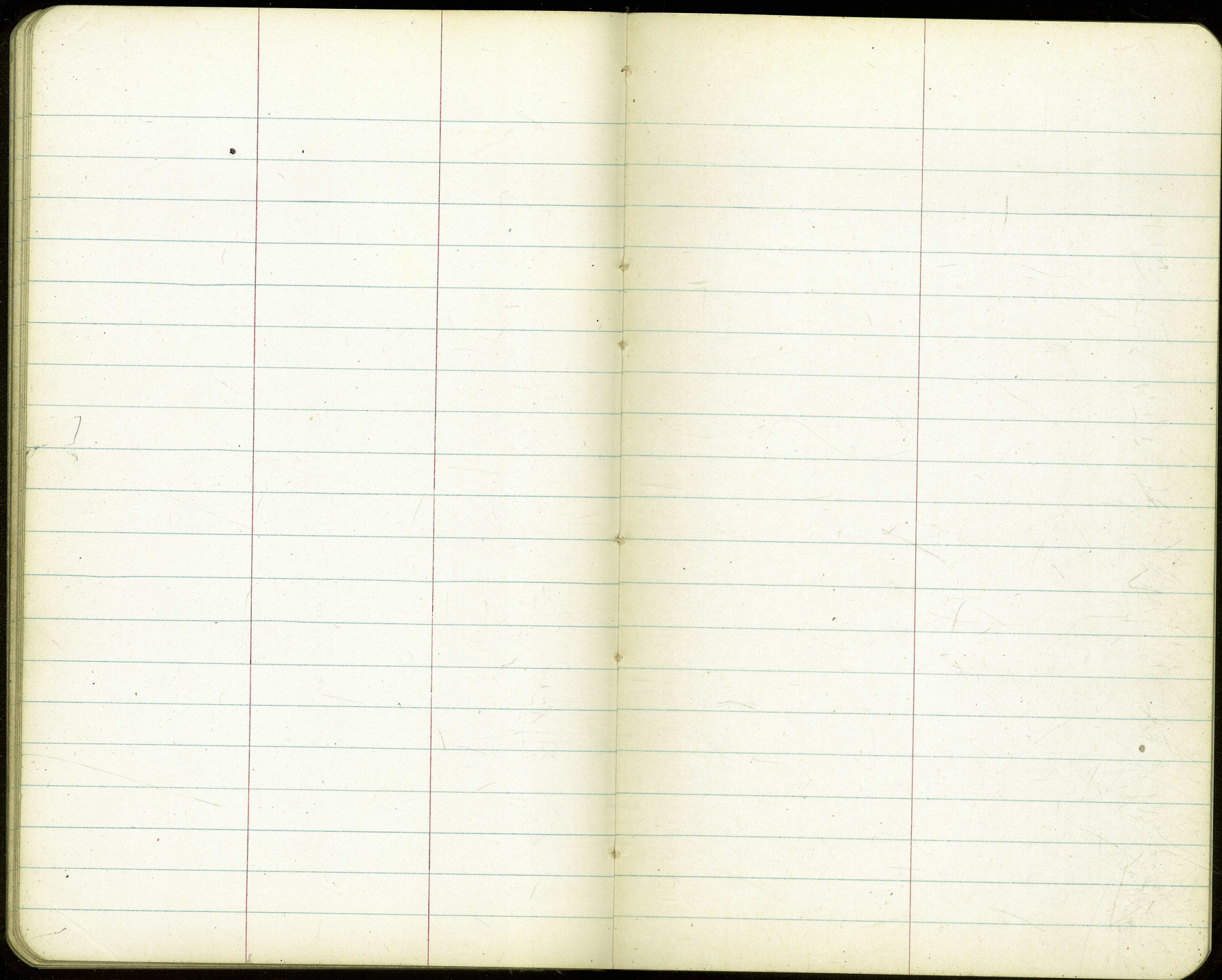

NE. Cor. 8th + Market

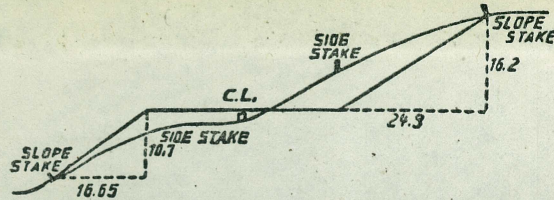

DISTANCES FROM SIDE STAKES FOR CROSS-SECTIONING.
SLOPE 1 1/2 TO 1. ROADWAY OF ANY WIDTH.

| | 0 | .1 | .2 | .3 | .4 | .5 | .6 | .7 | .8 | .9 | |
|----|-------|-------|-------|-------|-------|-------|-------|-------|-------|-------|----|
| 0 | 0.00 | 0.15 | 0.30 | 0.45 | 0.60 | 0.75 | 0.90 | 1.05 | 1.20 | 1.35 | 0 |
| 1 | 1.50 | 1.65 | 1.80 | 1.95 | 2.10 | 2.25 | 2.40 | 2.55 | 2.70 | 2.85 | 1 |
| 2 | 3.00 | 3.15 | 3.30 | 3.45 | 3.60 | 3.75 | 3.90 | 4.05 | 4.20 | 4.35 | 2 |
| 3 | 4.50 | 4.65 | 4.80 | 4.95 | 5.10 | 5.25 | 5.40 | 5.55 | 5.70 | 5.85 | 3 |
| 4 | 6.00 | 6.15 | 6.30 | 6.45 | 6.60 | 6.75 | 6.90 | 7.05 | 7.20 | 7.35 | 4 |
| 5 | 7.50 | 7.65 | 7.80 | 7.95 | 8.10 | 8.25 | 8.40 | 8.55 | 8.70 | 8.85 | 5 |
| 6 | 9.00 | 9.15 | 9.30 | 9.45 | 9.60 | 9.75 | 9.90 | 10.05 | 10.20 | 10.35 | 6 |
| 7 | 10.50 | 10.65 | 10.80 | 10.95 | 11.10 | 11.25 | 11.40 | 11.55 | 11.70 | 11.85 | 7 |
| 8 | 12.00 | 12.15 | 12.30 | 12.45 | 12.60 | 12.75 | 12.90 | 13.05 | 13.20 | 13.35 | 8 |
| 9 | 13.50 | 13.65 | 13.80 | 13.95 | 14.10 | 14.25 | 14.40 | 14.55 | 14.70 | 14.85 | 9 |
| 10 | 15.00 | 15.15 | 15.30 | 15.45 | 15.60 | 15.75 | 15.90 | 16.05 | 16.20 | 16.35 | 10 |
| 11 | 16.50 | 16.65 | 16.80 | 16.95 | 17.10 | 17.25 | 17.40 | 17.55 | 17.70 | 17.85 | 11 |
| 12 | 18.00 | 18.15 | 18.30 | 18.45 | 18.60 | 18.75 | 18.90 | 19.05 | 19.20 | 19.35 | 12 |
| 13 | 19.50 | 19.65 | 19.80 | 19.95 | 20.10 | 20.25 | 20.40 | 20.55 | 20.70 | 20.85 | 13 |
| 14 | 21.00 | 21.15 | 21.30 | 21.45 | 21.60 | 21.75 | 21.90 | 22.05 | 22.20 | 22.35 | 14 |
| 15 | 22.50 | 22.65 | 22.80 | 22.95 | 23.10 | 23.25 | 23.40 | 23.55 | 23.70 | 23.85 | 15 |
| 16 | 24.00 | 24.15 | 24.30 | 24.45 | 24.60 | 24.75 | 24.90 | 25.05 | 25.20 | 25.35 | 16 |
| 17 | 25.50 | 25.65 | 25.80 | 25.95 | 26.10 | 26.25 | 26.40 | 26.55 | 26.70 | 26.85 | 17 |
| 18 | 27.00 | 27.15 | 27.30 | 27.45 | 27.60 | 27.75 | 27.90 | 28.05 | 28.20 | 28.35 | 18 |
| 19 | 28.50 | 28.65 | 28.80 | 28.95 | 29.10 | 29.25 | 29.40 | 29.55 | 29.70 | 29.85 | 19 |
| 20 | 30.00 | 30.15 | 30.30 | 30.45 | 30.60 | 30.75 | 30.90 | 31.05 | 31.20 | 31.35 | 20 |
| 21 | 31.50 | 31.65 | 31.80 | 31.95 | 32.10 | 32.25 | 32.40 | 32.55 | 32.70 | 32.85 | 21 |
| 22 | 33.00 | 33.15 | 33.30 | 33.45 | 33.60 | 33.75 | 33.90 | 34.05 | 34.20 | 34.35 | 22 |
| 23 | 34.50 | 34.65 | 34.80 | 34.95 | 35.10 | 35.25 | 35.40 | 35.55 | 35.70 | 35.85 | 23 |
| 24 | 36.00 | 36.15 | 36.30 | 36.45 | 36.60 | 36.75 | 36.90 | 37.05 | 37.20 | 37.35 | 24 |
| 25 | 37.50 | 37.65 | 37.80 | 37.95 | 38.10 | 38.25 | 38.40 | 38.55 | 38.70 | 38.85 | 25 |
| 26 | 39.00 | 39.15 | 39.30 | 39.45 | 39.60 | 39.75 | 39.90 | 40.05 | 40.20 | 40.35 | 26 |
| 27 | 40.50 | 40.65 | 40.80 | 40.95 | 41.10 | 41.25 | 41.40 | 41.55 | 41.70 | 41.85 | 27 |
| 28 | 42.00 | 42.15 | 42.30 | 42.45 | 42.60 | 42.75 | 42.90 | 43.05 | 43.20 | 43.35 | 28 |
| 29 | 43.50 | 43.65 | 43.80 | 43.95 | 44.10 | 44.25 | 44.40 | 44.55 | 44.70 | 44.85 | 29 |
| 30 | 45.00 | 45.15 | 45.30 | 45.45 | 45.60 | 45.75 | 45.90 | 46.05 | 46.20 | 46.35 | 30 |
| 31 | 46.50 | 46.65 | 46.80 | 46.95 | 47.10 | 47.25 | 47.40 | 47.55 | 47.70 | 47.85 | 31 |
| 32 | 48.00 | 48.15 | 48.30 | 48.45 | 48.60 | 48.75 | 48.90 | 49.05 | 49.20 | 49.35 | 32 |
| 33 | 49.50 | 49.65 | 49.80 | 49.95 | 50.10 | 50.25 | 50.40 | 50.55 | 50.70 | 50.85 | 33 |
| 34 | 51.00 | 51.15 | 51.30 | 51.45 | 51.60 | 51.75 | 51.90 | 52.05 | 52.20 | 52.35 | 34 |
| 35 | 52.50 | 52.65 | 52.80 | 52.95 | 53.10 | 53.25 | 53.40 | 53.55 | 53.70 | 53.85 | 35 |
| 36 | 54.00 | 54.15 | 54.30 | 54.45 | 54.60 | 54.75 | 54.90 | 55.05 | 55.20 | 55.35 | 36 |
| 37 | 55.50 | 55.65 | 55.80 | 55.95 | 56.10 | 56.25 | 56.40 | 56.55 | 56.70 | 56.85 | 37 |
| 38 | 57.00 | 57.15 | 57.30 | 57.45 | 57.60 | 57.75 | 57.90 | 58.05 | 58.20 | 58.35 | 38 |
| 39 | 58.50 | 58.65 | 58.80 | 58.95 | 59.10 | 59.25 | 59.40 | 59.55 | 59.70 | 59.85 | 39 |
| 40 | 60.00 | 60.15 | 60.30 | 60.45 | 60.60 | 60.75 | 60.90 | 61.05 | 61.20 | 61.35 | 40 |
| 41 | 61.50 | 61.65 | 61.80 | 61.95 | 62.10 | 62.25 | 62.40 | 62.55 | 62.70 | 62.85 | 41 |
| 42 | 63.00 | 63.15 | 63.30 | 63.45 | 63.60 | 63.75 | 63.90 | 64.05 | 64.20 | 64.35 | 42 |
| 43 | 64.50 | 64.65 | 64.80 | 64.95 | 65.10 | 65.25 | 65.40 | 65.55 | 65.70 | 65.85 | 43 |
| 44 | 66.00 | 66.15 | 66.30 | 66.45 | 66.60 | 66.75 | 66.90 | 67.05 | 67.20 | 67.35 | 44 |
| 45 | 67.50 | 67.65 | 67.80 | 67.95 | 68.10 | 68.25 | 68.40 | 68.55 | 68.70 | 68.85 | 45 |
| 46 | 69.00 | 69.15 | 69.30 | 69.45 | 69.60 | 69.75 | 69.90 | 70.05 | 70.20 | 70.35 | 46 |
| 47 | 70.50 | 70.65 | 70.80 | 70.95 | 71.10 | 71.25 | 71.40 | 71.55 | 71.70 | 71.85 | 47 |
| 48 | 72.00 | 72.15 | 72.30 | 72.45 | 72.60 | 72.75 | 72.90 | 73.05 | 73.20 | 73.35 | 48 |
| 49 | 73.50 | 73.65 | 73.80 | 73.95 | 74.10 | 74.25 | 74.40 | 74.55 | 74.70 | 74.85 | 49 |
| 50 | 75.00 | 75.15 | 75.30 | 75.45 | 75.60 | 75.75 | 75.90 | 76.05 | 76.20 | 76.35 | 50 |

THE NATIONAL BLANK BOOK COMPANY
HOLYOKE MASSACHUSETTS
NEW YORK CHICAGO BOSTON SAN FRANCISCO