

Misc. Street Cross Sections

Hawthorne

104
14th

Old # 73

TRANSIT BOOK

12

F.B. 601

601

dd #13

MICROFILMED
DEC 1 # 1964

9.2
0.24
6.7

196.75

226.0
7.9
218.10

7.1
1.2
5.9

7.1
1.2
5.9

0.25.51
29.51
6.9
0

1

Lower section of Long St. Street 201889. Remains
North Sidewalk
Remains
Remains
Remains
Remains

Sidewalk South

Lower Section of Long St. May 23/1889. *Remond* *Wilmont*

North *Wilmont* *Remond* *Wilmont* *Remond*
+ 49 - - - - - Blv - *North* *Wilmont* *Remond* *Wilmont* *Remond*
18.08 12.51 *North* *Blv* *Wilmont* *Remond* *Wilmont* *Remond*
1.18 7.68 11.58 6.49 11.1 - 5.5

10.4	- 3.2	10.5	- 8.9	9.2	- 1.6	9.9	- 2.3	12.4	- 4.8	0.765
9.6	- 2.0	11.1	- 3.4	10.9	- 3.3	11.8	- 3.2	10.8	- 3.2	0
6.8	1.4	9.1	- 1.5	9.5	- 1.9	9.0	- 1.4	8.0	- 1.4	0
4.1	3.5	7.5	0.1	7.5	0.1	7.9	- 0.3	7.6	0.0	0
4.2	3.4	5.0	2.6	5.9	1.7	6.4	0.9	7.1	0.5	0
+0.9	8.5	3.6	4.0	4.8	2.4	5.5	2.1	5.7	1.9	0
1.6	6.0	2.8	5.3	2.4	5.2	3.4	4.5	2.7	4.9	0
(12.3)	7.9	(15.3)	8.1	0.8	7.4	0.9	6.7	6.8	4.9	0
11.4	8.3	11.8	8.0	11.6	7.7	11.9	7.4	11.9	7.4	0
11.0	8.3	11.5	8.0	11.6	7.7	11.9	7.4	11.9	7.4	0
7.2	12.1	6.4	12.5	4.5	14.9	7.4	11.9	7.3	12.0	0
3.4	10.9	3.5	12.0	3.5	12.0	3.5	12.0	3.5	12.0	0

West line of Blv

Center of Solid St

11.95 19.34 0.881 7.41

East line of cal. St

Blv 11.76 30.86 0.75 18.61

West line of North

11.89 41.35 0.587 29.49

Center of North

3.4	16.9	3.2	16.1	3.1	16.2	5.8
4.5	14.5	5.3	14.0	6.7	12.6	6.8
4.8	14.5	3.7	16.6	4.9	14.4	6.5
2.2	17.1	2.3	17.0	2.4	16.9	3.0
0.3	19.0	0.7	18.6	2.8	14.5	1.4
9.4	20.6	9.4	20.0	9.9	20.5	10.6
7.9	22.6	7.9	22.6	7.9	22.5	8.7
6.0	24.4	6.9	24.5	6.1	24.3	7.0
4.5	26.1	4.2	26.2	4.6	25.8	5.1
3.8	27.2	2.9	27.5	3.4	27.0	4.2
2.2	28.2	1.9	28.5	2.5	28.1	3.2
1.7	27.7	1.2	29.2	1.8	28.6	2.8
10.6	30.5	10.5	30.6	10.8	30.6	10.4
(41.4)						50.6
41.8						41.8

✓

(41.4)

#

#

#

North SW Section 8 W
Ely Road Ely Road Ely Road Ely Road
76.31

11.90	86.77	0.44	74.87																
				10.9	76.9	11.0	75.9	11.4	75.4	12.4	75.9	12.4	75.9	12.4	75.9	12.4	75.9	12.4	75.9
				10.8	76.5	10.1	76.7	10.9	75.9	12.8	74.8	11.7	75.1	12.5	74.5	12.0			
				8.7	78.1			9.3	77.5			9.9	76.9						
				1.2	79.6	7.4	79.4	7.5	79.2	9.8	77.0	9.5	77.3						
				6.8	80.0	6.6	80.2	7.1	79.7	8.5	78.5	8.9	77.9						
				5.2	81.6	5.3	81.5	5.7	81.1	6.0	80.8	6.5	80.3						
				3.7	83.1	3.9	82.9	3.7	83.1	3.5	83.3	4.0	82.5						
				2.2	84.6	2.1	84.7	1.6	85.2	1.0	85.8	1.2	86.6						
				11.5	86.4	11.0	86.9	10.0	87.9	9.1	88.8	9.7	88.2						
				9.8	88.7	9.4	89.1	8.1	89.8	7.6	90.3	8.0	89.9						
				7.1	90.8	6.6	91.3	4.8	93.1	5.5	92.6	5.5	92.4						

West drive of Division
108.21
97.16

11.6	96.6	10.9	97.3	10.2	98.0	10.5	97.7	10.2	98.0	11.2									
5.2	92.7	4.7	93.2	3.0	94.9	3.0	94.9	3.2	94.7	3.2	94.7	3.2	94.7						
2.0	95.9	1.5	96.4	0.8	97.1	0.4	97.5	0.0	97.9	2.0									

East line Division D1

10.1	98.1	8.4	99.8	7.4	100.8	5.5	102.9	3.7	104.8	7.0										
8.1	100.1																			
5.6	102.5																			
4.8	103.4	5.1	105.2	6.1	108.1	5.5	109.9	3.7	109.8	7.0										

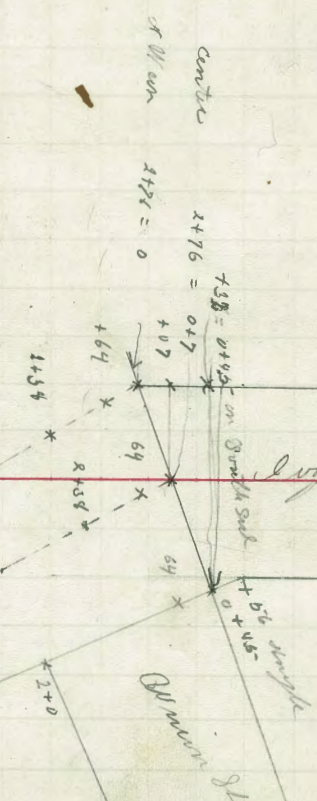

East line Division D1
108.21
97.16

H 2
108.21

11.67 119.08 0.86 107.85

10.88 12.97 4.09 118.93

West line Bank St
Center line Bank St
East line of Bank
11.60 140.94 0.48 129.34

North
East line of Division St
S.W.
East line of Bank St
South
4

1.6 106.6 2.0 106.2 8.7 124.5
108.8
119.0
3.0 105.8 3.4 104.8
0.45
#

9.4 109.6 9.6 109.4 10.8 108.7
5.7 112.3 5.5 113.5 7.0 118.8
2.0 117.0 2.5 116.5 3.8 115.8
9.7 120.1 10.2 119.6 10.8 119.0
129.8
12.1 117.7 12.5 117.5 14.25
9.1 120.7 10.2 119.6 14.52
#

6.6 122.2 6.8 123.0 6.6 123.2
5.5 124.3 5.1 124.7
4.1 125.7 3.9 126.9 3.6 126.2
140.9
5.7 135.2 6.1 134.9 7.2 133.7
3.8 137.7 3.5 137.4 4.3 136.6
9.6 131.3 9.4 131.5
5.2 135.7 6.8 136.1
125.7 4.2 125.6
#

11.66 132.56 0.34 140.70

10.48 162.00 0.54 151.52

West line of
Center of
East line of

0.1 140.8 0.3 141.6 0.6 141.3
152.14
1.0 139.9 2.2 139.7
#

8.6 148.8 9.0 148.4 9.5 148.9
5.0 147.4 5.8 147.2 5.6 145.8
1.6 130.8 1.7 130.7 2.5 149.9
162.0
4.4 145.0 6.2 146.2
#

8.4 153.6 9.1 152.9 1.1 151.5
6.5 153.5 7.2 154.8 9.3 152.7
3.9 153.1 5.1 156.9 8.2 153.8
2.2 159.8 4.7 157.3 7.8 154.2
1.3 160.7 4.4 157.6 6.8 155.2
1.7 160.3 3.1 158.9 6.1 155.9
8.0 152.0 4.2 153.9
#

10.48 162.00 0.54 151.52
West line of
Center of
East line of
10.48 151.24
1.7 160.3 4.4 157.6 6.8 155.2
1.3 160.7 4.4 157.6 6.8 155.2
1.7 160.3 3.1 158.9 6.1 155.9
8.0 152.0 4.2 153.9
#

11.40	162.00	11.40	172.37	0.95	161.05	North	8. W.	South	8. W.	South	5		
		162.00				Blue Rock Elm	Blue Rock Elm	Blue Rock Elm	Blue Rock Elm	Blue Rock Elm	Blue Rock Elm		
		(172.47)											
		10.8	168.4	11.8	160.6	4.0	158.0	5.6	5.6	153.4	5.3	156.5	+ 2.5
		(172.47)				(162.0)		(162.0)		(162.0)			
		9.3	163.1	10.9	161.5	2.5	159.5	3.0	159.0	2.8	159.4	4.50	
		(172.47)				(172.47)		(172.47)		(162.0)			
		9.3	163.1	10.4	162.0	10.4	162.0	11.0	161.4	11.2	161.2	+ 7.5	
		8.4	164.0	8.4	164.0	8.6	163.8	9.5	163.9	8.3	164.1	+ 7.0	
		5.3	167.1	5.4	167.0	5.3	167.1	5.0	167.4	5.1	167.3	+ 2.5	
		3.1	169.3	2.4	170.0	1.3	171.1	1.2	171.2	1.6	170.4	+ 5.0	
		(172.47)				(172.47)		(172.47)		(172.47)			
		9.8	173.2	8.8	174.2	8.3	174.7	9.1	173.9	10.0	173.0	+ 7.5	
		6.7	176.3	6.2	176.8	6.4	176.6	7.6	176.4	8.2	174.8	+ 1.0	
		3.6	177.4	3.4	177.6	6.0	177.0	7.4	175.6	7.9	175.1	+ 1.4	
		4.1	178.9			4.5	178.5			3.9	177.1	+ 4.0	

11.40 162.00 0.80 171.57
West line Prunt St
North line Prunt

Evidence of Prunt

11.99	198.83	194	181.06	3.7	179.8	3.6	179.4	4.6	178.4	3.4	177.6	6.2	176.8	4.6
		198.83	194	181.06										
		3.4	179.6	3.6	179.4	4.1	178.9	5.0	178.0	5.8	177.5	6.8	176.8	4.6
		2.5	180.5	2.8	180.2	3.5	179.5	4.5	178.5	5.1	177.9	5.8	177.9	5.0
		1.7	181.3	2.1	180.9	3.2	179.8	4.3	178.7	5.0	178.0	6.0	178.0	4.5
		0.7	182.3	1.5	181.5	2.6	180.4	4.1	178.9	4.4	178.2	5.4	178.2	4.5
		9.5	183.5	9.4	183.0	11.3	181.3	12.5	180.8	13.4	179.4	14.0	179.4	14.0
		8.4	184.4	9.1	183.7	10.1	182.7	11.0	181.8	11.6	181.2	12.5	181.2	12.5
		7.4	185.4	7.9	184.9	9.4	184.4	9.6	183.2	9.9	182.9	10.5	182.9	10.5
		6.2	186.6	6.5	186.3	6.6	186.2	7.7	185.1	8.4	184.4	9.0	184.4	9.0
		4.5	188.3	4.6	188.2	5.1	187.7	6.2	186.6	6.9	185.9	7.5	185.9	7.5
		2.6	190.2			3.7	189.1	5.1	189.7	5.1	189.7	6.0	189.7	6.0
		1.4	191.4	1.9	190.9	1.4	191.4	3.1	189.7	3.1	189.7	4.0	189.7	4.0
		+ 0.8	193.6	+ 0.4	193.2	0.6	192.2	1.0	191.8	1.8	191.0	2.5	191.0	2.5
		10.55	222.83	0.55	192.48									

11.99 198.83 194 181.06

West line Prunt St

North line of 2nd St

East " " Prunt St

2nd St Bank

10.55 222.83 0.55 192.48

Even section of Long St 26

1889

Number of posts

+	Hg	Blue	North	Side W	Side E	North	Side W	Side E	South
	202.88								

9.6	198.2	9.9	192.9	10.3	192.5	11.0	191.8	11.4	191.4	+25
9.3	198.5	9.8	193.0	10.9	192.1	11.5	191.3	12.0	190.8	+50
9.2	197.6	9.3	193.5	10.4	192.4	11.1	191.7	11.5	191.3	+75
9.5	195.3	9.0	194.5	9.1	193.7	9.6	193.2	9.6	193.2	+10
6.4	196.4	6.9	195.9	7.8	195.6	8.8	194.6	8.0	194.8	+25
5.5	197.3	5.9	196.9	5.6	197.2	6.8	196.6	6.9	195.9	+50
4.8	198.0	5.4	197.4	5.4	197.4	5.8	197.0	5.8	197.0	+75
4.6	198.2	4.5	198.0	5.5	197.3	6.0	196.8	6.1	196.7	+10
4.7	198.1	4.7	198.1	5.7	197.1	6.0	196.8	6.6	196.2	+14
8.0	199.8			5.3	197.5			6.6	196.2	+40
2.8	200.6	3.4	199.4	4.5	198.3	5.5	197.3	5.4	197.4	+66
1.8	201.0	2.9	199.9	4.8	198.6	5.1	197.7	4.8	198.0	0
0.8	202.6	2.5	200.5	3.2	199.6	4.0	198.8	3.5	199.2	+25

West-dive Road St
 8.0m. 4.44 198.39
 Century Road St
 8.0 199.8

West-dive Road St
 0.1 202.7 1.1 201.7 2.8 200.6

5.74 207.14 1.28 201.70

3.8	204.0	4.8	202.9	4.9	202.3	5.6	201.6	5.1	202.1	+75
1.5	205.7	2.4	204.8	3.3	203.9	3.7	203.5	4.1	203.1	+10
0.7	206.5	1.4	205.8	2.5	204.7	3.9	203.3	4.9	202.8	+25
2.3	207.9	3.3	205.9	4.4	202.4	6.3	200.9	7.6	199.6	+50
5.8	208.0	6.4	202.8	8.9	198.3	10.0	197.2	11.6	195.6	+75
8.0	208.0									
3.3	196.5	7.4	195.0	4.7	195.1	9.3	190.5	11.6	188.2	+10
1.6	198.7	1.9	198.4	3.2	191.1	4.4	185.5	10.0	184.3	+14
6.8	177.5			5.0	175.7			4.7	168.5	+40

1.33 199. 188 8.69 199.45
 6.56 194.38 11.82 187.96
 0.95 183.61 11.66 182.66
 1.94 173.16 11.49 172.12

3.3 196.5 7.4 195.0 4.7 195.1
 1.6 198.7 1.9 198.4 3.2 191.1
 6.8 177.5

207.2
 199.8
 194.3
 183.3

28 200.0 25 200.3+50
 28 200.0 25 200.3+50
 28 200.0 25 200.3+50

North side W
 East side W
 South

129 - Blue Rod
 129.16
 166.07
 11.16
 158.00

East drive of East. Sta.

1.8
 5.4
 8.1
 0.9
 4.8
 172.4
 154.9
 160.7
 158.0
 165.3
 172.4
 178.4
 17.6.4
 141.5

0.2
 4.9
 9.7
 4.8
 9.4
 15.0
 168.9
 161.2
 153.4
 161.9
 167.9
 173.5
 180.6
 190.6

0.8
 4.9
 11.0
 6.8
 6.9
 8.8
 0.8
 4.9
 11.1
 8.9
 6.9
 9.8
 8.4
 7.4
 8.4

166.7
 165.4
 161.8
 155.1
 159.8
 170.3
 178.7
 146.1
 199.6
 191.0
 191.0
 196.5
 186.5
 186.8

5.8
 9.3
 11.1
 8.9
 0.1
 6.0
 6.0
 8.4
 11.1
 8.4
 8.4
 6.5
 6.5
 8.7
 148.0

160.8
 157.9
 156.0
 163.2
 177.1
 148.5
 186.5
 186.5
 196.5
 191.2
 191.2
 192.5
 191.2
 186.8

11.8.3
 199.63
 0.08
 184.40

West drive of 4th Sta
 East of Bank

8.6
 5.4
 3.0
 0.9
 10.3
 5.3
 8.0
 6.0
 4.5
 3.4
 2.4
 2.1
 2.1
 6.6

202.1
 205.3
 207.7
 209.8
 21.5
 21.5
 215.8
 215.8
 217.3
 219.0
 219.4
 219.7
 215.7
 215.8

9.0
 5.3
 10.1
 1.8
 11.2
 10.1
 2.8
 6.7
 4.7
 3.2
 2.7
 2.5
/>

201.7
 205.4
 207.7
 209.4
 210.6
 211.7
 214.0
 215.7
 217.1
 218.6
 219.1
 219.3
 215.7
 215.8

5.5
 6.1
 4.0
 2.4
 18.0
 10.1
 7.4
 6.0
 5.0
 3.9
 3.5
 3.8
 3.8
 7.1

208.2
 204.6
 206.7
 208.8
 209.8
 211.7
 214.4
 215.8
 216.8
 217.9
 218.5
 218.5
 214.5
 214.7

9.3
 6.3
 5.6
 8.6
 4.7
 9.0
 7.1
 6.4
 5.5
 4.9
 4.1
 3.8
 3.8
 7.9

201.4
 204.4
 205.1
 208.1
 210.1
 212.8
 214.7
 215.4
 216.3
 216.9
 217.7
 218.0
 218.0
 215.9

9.5
 5.8
 5.4
 4.7
 18.3
 5.9
 7.0
 6.2
 5.4
 5.2
 4.4
 3.6
 4.0
 8.5

201.2
 204.9
 205.3
 206.0
 209.5
 212.9
 214.8
 215.6
 216.6
 216.6
 217.4
 218.2
 217.8
 215.0

West drive of 5th Sta
 East of Bank

12.0
 22.1.79
 0.86
 209.79

10.3
 5.3
 8.0
 6.0
 4.5
 3.4
 2.4
 2.1
 2.1
 6.6

21.5
 21.5
 215.8
 215.8
 217.3
 219.0
 219.4
 219.7
 215.7
 215.8
 217.9
 218.5
 218.5
 214.5
 214.7

9.0
 5.3
 10.1
 1.8
 11.2
 10.1
 7.4
 6.0
 5.0
 3.9
 3.5
 3.8
 3.8
 7.1

201.7
 205.4
 207.7
 209.4
 210.6
 211.7
 214.0
 215.8
 216.8
 217.9
 218.5
 218.5
 214.5
 214.7

9.3
 6.3
 5.6
 8.6
 4.7
 9.0
 7.1
 6.4
 5.5
 4.9
 4.1
 3.8
 3.8
 7.9

201.4
 204.4
 205.1
 208.1
 210.1
 212.8
 214.7
 215.4
 216.3
 216.9
 217.7
 218.0
 218.0
 215.9

9.5
 5.8
 5.4
 4.7
 18.3
 5.9
 7.0
 6.2
 5.4
 5.2
 4.4
 3.6
 4.0
 8.5

	North	side W	Eastern	Side W	South	
H ₀ -	Blue	Red	Blue	Red	Blue	Red
221.79						
	6.4	215.4	7.0	214.8	7.7	214.1
	5.4	216.4			9.2	219.6
	5.4	216.4	6.0	215.8	6.9	214.9
	7.9	216.9	5.1	216.7	6.5	215.3
	0.4	221.4	0.9	220.9	2.8	219.0
	4.2	222.8	4.5	221.8	5.2	220.8
	2.8	220.2	3.4	222.6	4.5	221.5
	1.5	224.5	2.0	224.0	2.6	223.4
	0.4	225.6	0.7	226.3	1.6	224.4
	0.0	226.0	0.8	225.7	1.5	224.5
	0.0	226.0	0.6	225.4	1.8	224.2
	0.7	225.3	1.0	225.0	1.8	224.2
					2.6	223.4
					3.5	222.7
					4.5	221.5
					5.2	220.4
					6.9	219.1
					7.9	218.3
					8.8	217.1
					9.8	215.9
					10.8	214.1
					11.8	212.5
					12.8	210.9
					13.8	209.3
					14.8	207.7
					15.8	206.1
					16.8	204.5
					17.8	202.9
					18.8	201.3
					19.8	199.7
					20.8	198.1
					21.8	196.5
					22.8	194.9
					23.8	193.3
					24.8	191.7
					25.8	190.1
					26.8	188.5
					27.8	186.9
					28.8	185.3
					29.8	183.7
					30.8	182.1
					31.8	180.5
					32.8	178.9
					33.8	177.3
					34.8	175.7
					35.8	174.1
					36.8	172.5
					37.8	170.9
					38.8	169.3
					39.8	167.7
					40.8	166.1
					41.8	164.5
					42.8	162.9
					43.8	161.3
					44.8	159.7
					45.8	158.1
					46.8	156.5
					47.8	154.9
					48.8	153.3
					49.8	151.7
					50.8	150.1
					51.8	148.5
					52.8	146.9
					53.8	145.3
					54.8	143.7
					55.8	142.1
					56.8	140.5
					57.8	138.9
					58.8	137.3
					59.8	135.7
					60.8	134.1
					61.8	132.5
					62.8	130.9
					63.8	129.3
					64.8	127.7
					65.8	126.1
					66.8	124.5
					67.8	122.9
					68.8	121.3
					69.8	119.7
					70.8	118.1
					71.8	116.5
					72.8	114.9
					73.8	113.3
					74.8	111.7
					75.8	110.1
					76.8	108.5
					77.8	106.9
					78.8	105.3
					79.8	103.7
					80.8	102.1
					81.8	100.5
					82.8	98.9
					83.8	97.3
					84.8	95.7
					85.8	94.1
					86.8	92.5
					87.8	90.9
					88.8	89.3
					89.8	87.7
					90.8	86.1
					91.8	84.5
					92.8	82.9
					93.8	81.3
					94.8	79.7
					95.8	78.1
					96.8	76.5
					97.8	74.9
					98.8	73.3
					99.8	71.7
					100.8	70.1

Bank line

Bank line 5th St
 East drive of 5th St
 Top of Bank
 9.74 226.04 5.49 216.80

(221.8)

(226.0)

B.A.# 5th St

B.A.#

Brown Section of Hawthorn Street

Aug 29 1889

Hawkins Hill

North S Walk
East line of road Sta V
4.19 187.99
0.51 176.77
11.73 176.26

Center S Walk
S Walk South Sta
185.80
176.26
10.4 166.4
8.9 167.9
51 171.7
4.9 174.9
0.8 177.5
188.5
185.8
178.7
188.3

11.95 188.31
144 176.33
3.5 195.5
2.0 174.8
0.7 176.1
188.3
180.9
4.6 185.7
2.9 185.7
187.6
187.6
188.6
187.5

8.4 179.9
7.7 181.6
4.1 184.2
0.7 157.6
12.8 188.4
195.5
198.6
192.1
5.9 192.7
27.5
4.9 193.7
194.0

10.48 198.58
0.15 184.16
2.5 189.1
10.4 188.2
9.1 189.5
7.7 190.9
6.8 191.8
250
7.2 191.4
8.2 190.4
7.8 191.8
6.5 192.1
5.9 192.7
17.5
8.5 193.1
4.5 194.1
5.0 193.6
4.5 194.1
21.4
8.5 195.1
3.1 195.5
3.7 194.9
4.5 194.1
4.9 193.7
194.0
2.0 196.6
3.4 195.2
1.0 194.6
4.6 194.0
194.0

1.9 196.5
2.4 195.8
3.1 195.5
7.0 194.6
4.6 194.0
194.0
2.0 196.6
2.9 195.2
1.0 194.6
4.6 194.0
194.0
1.9 196.5
2.4 195.8
3.1 195.5
7.0 194.6
4.6 194.0
194.0

2.98 205.88
2.27 196.31
6.3 199.0
6.8 198.5
5.0 200.8
5.8 199.5
6.9 198.4
7.7 199.6
8.2 197.1
7.2 191.4
8.2 190.4
7.8 191.8
6.5 192.1
5.9 192.7
17.5
8.5 193.1
4.5 194.1
5.0 193.6
4.5 194.1
21.4
8.5 195.1
3.1 195.5
3.7 194.9
4.5 194.1
4.9 193.7
194.0
2.0 196.6
3.4 195.2
1.0 194.6
4.6 194.0
194.0
1.9 196.5
2.4 195.8
3.1 195.5
7.0 194.6
4.6 194.0
194.0

0.7 197.9
1.4 197.2
1.8 196.8
3.3 195.3
3.9 194.7
6.3 199.0
6.8 198.5
5.0 200.8
5.8 199.5
6.9 198.4
7.7 199.6
8.2 197.1
7.2 191.4
8.2 190.4
7.8 191.8
6.5 192.1
5.9 192.7
17.5
8.5 193.1
4.5 194.1
5.0 193.6
4.5 194.1
21.4
8.5 195.1
3.1 195.5
3.7 194.9
4.5 194.1
4.9 193.7
194.0
2.0 196.6
3.4 195.2
1.0 194.6
4.6 194.0
194.0
1.9 196.5
2.4 195.8
3.1 195.5
7.0 194.6
4.6 194.0
194.0

0.9 204.4
1.7 203.6
4.0 201.5
6.8 199.0
6.8 198.5
5.0 200.8
5.8 199.5
6.9 198.4
7.7 199.6
8.2 197.1
7.2 191.4
8.2 190.4
7.8 191.8
6.5 192.1
5.9 192.7
17.5
8.5 193.1
4.5 194.1
5.0 193.6
4.5 194.1
21.4
8.5 195.1
3.1 195.5
3.7 194.9
4.5 194.1
4.9 193.7
194.0
2.0 196.6
3.4 195.2
1.0 194.6
4.6 194.0
194.0
1.9 196.5
2.4 195.8
3.1 195.5
7.0 194.6
4.6 194.0
194.0

Down section of 14th St from Dr A. South of 1885
 Kingston
 parish
 13

7	110	Blue sand	Blue	3 W	Blue	Pointe	3 W	Red Blue	3 W	Red Blue	Red Blue	Red Blue	Blue
11.86	119.87					(119.4)							
✓	109.11												
✓	91	110.5	8.8	111.2	6.9	118.5	5.3	114.1	3.7	115.7			
✓	5.9	103.5	4.7	114.7	3.3	116.1	1.1	118.3	0.1	119.5			
✓	11.75	130.3	30.79	115.58		(130.3)							
✓	8.1	117.5	0.8	118.6	9.7	120.6	29	122.4	6.7	123.6	17.0		
✓	8.8	121.5	8.0	122.3	5.9	124.4	4.6	125.7	3.1	127.2	7.50		
✓	11.34	141.26	0.61	129.78		(141.3)							
✓	4.8	126.1	4.0	126.3	2.8	127.5	0.9	130.4	10.1	131.2	2+0		
✓	10.4	130.9	10.1	131.2	9.4	131.9	8.6	132.7	7.1	134.2	4.50		
✓	7.1	134.2	6.4	134.9	5.1	136.2	4.8	136.5	4.4	136.9	3+0		
✓	6.4	134.9	6.1	135.2	4.6	136.7	4.0	137.3	3.6	137.7	4.14		
✓	5.0	136.3			2.9	139.4	1.3	139.8		140			

158.95

14th St

13

Annual record of Hawthorn St

Sta	T	HO	-	Blv	North	South	North	South	North	South	North	South	North	South	North	South	North	South
1+25		34.41			7.3	27.1	7.6	26.8	7.8	26.6	8.0	26.4	7.7	26.7				
+50					6.0	28.4	6.2	28.2	6.9	27.5	6.8	27.6	6.7	27.7				
+75					5.7	28.7	5.7	28.7	6.0	28.4	5.4	29.0	5.4	29.0				
2					5.1	29.3	5.2	29.2	5.0	29.4	4.4	30.0	4.4	30.0				
+12					4.9	29.5	4.6	29.8	4.3	30.1	4.2	30.2	3.6	30.8				
Blv.																		
+26					4.4	30.0	3.7	30.7										
+37.5					2.8	31.6	2.6	31.8	2.6	31.8	2.2	32.2	2.1	32.3				
+45					3.9	30.5	3.5	30.9										
+63					3.3	31.1	2.6	31.8	1.6	32.8	0.5	33.9	0.0	34.4				
#									(43.9)									
9					12.2	31.7	11.6	32.3	10.4	33.5	9.4	34.5	9.1	35.1				
+25					11.0	32.9	10.4	32.5	9.1	34.8	7.7	36.2	7.4	36.5				
-50					9.9	34.0	9.3	34.6	8.0	35.9	6.9	37.0	6.4	37.5				
+75					8.6	35.3	8.1	35.8	6.8	37.1	5.7	38.2	5.4	38.5				
+20					6.8	37.1	6.3	37.6	5.8	38.1	4.5	39.4	4.4	39.5				
+50					5.3	38.6	5.0	38.9	4.5	39.4	3.5	40.4	3.2	40.7				
+75					4.1	39.8	3.6	40.3	3.2	40.7	2.7	41.2	2.2	41.7				
2					2.8	41.1	2.9	41.0	2.0	41.9	1.3	42.6	1.0	42.9				
#					1.3	42.6	1.2	42.7	0.4	42.5	0.0	43.9	0.0	43.9				
Blv									(51.9)									
0																		
+25					7.1	47.8	6.8	48.1	5.9	49.0	5.8	49.1	6.0	48.9				
+50					4.6	50.3	4.4	50.5	4.2	50.7	3.7	51.3	4.0	50.9				
+60					2.1	52.8	2.3	52.6	1.9	53.0	2.0	52.9	2.0	52.9				
#									(64.3)									
+75					9.7	54.6	9.7	54.6	9.7	54.6	9.3	55.0	8.9	55.4				
1					8.7	55.5	8.2	56.1	8.0	56.3	7.5	56.8	7.1	57.2				

Intersection of
 Ordway St
 already graded.

Annex X seed of Hawthorn St

Sta	#	HO	-	Blk	1st	2nd	3rd	4th	5th	6th	7th	8th	9th	10th	11th	12th	13th	14th	15th	16th	17th	18th	19th	20th	
1+25		64.31																							
+50					6.5	57.8	6.7	57.6	6.5	57.8	5.8	58.5	5.8	58.5	5.8	58.5	5.8	58.5	5.8	58.5	5.8	58.5	5.8	58.5	5.8
+75					4.8	59.5	5.3	59.0	5.1	59.2	4.6	59.7	4.6	59.7	4.6	59.7	4.6	59.7	4.6	59.7	4.6	59.7	4.6	59.7	4.6
2					3.4	60.9	3.6	60.7	3.2	61.1	3.1	61.2	3.1	61.2	3.1	61.2	3.1	61.2	3.1	61.2	3.1	61.2	3.1	61.2	3.1
+12					1.7	62.6	1.8	62.5	1.6	62.7	1.6	62.7	1.6	62.7	1.6	62.7	1.6	62.7	1.6	62.7	1.6	62.7	1.6	62.7	1.6
#					1.0	63.3	1.1	63.2	1.0	63.3	0.8	63.5	0.8	63.5	0.8	63.5	0.8	63.5	0.8	63.5	0.8	63.5	0.8	63.5	0.8
+37.5		74.43	0.88	63.43																					
+63					7.8	66.6	7.9	66.5	7.4	67.0	7.5	66.9	7.5	66.9	7.5	66.9	7.5	66.9	7.5	66.9	7.5	66.9	7.5	66.9	7.5
B.M.					7.0	67.4	7.4	67.0	6.9	67.5	7.0	67.4	7.1	67.3	7.1	67.3	7.1	67.3	7.1	67.3	7.1	67.3	7.1	67.3	7.1
+25					5.6	68.8	5.7	68.7	5.6	68.8	5.5	68.9	5.7	68.7	5.7	68.7	5.7	68.7	5.7	68.7	5.7	68.7	5.7	68.7	5.7
1					4.4	70.0	4.4	70.0	4.1	70.3	4.3	70.1	4.5	69.9	4.5	69.9	4.5	69.9	4.5	69.9	4.5	69.9	4.5	69.9	4.5
+75					2.9	71.5	3.0	71.4	2.8	71.6	2.8	71.6	2.8	71.6	2.8	71.6	2.8	71.6	2.8	71.6	2.8	71.6	2.8	71.6	2.8
#					1.1	73.3	1.3	73.1	1.3	73.1	1.2	73.2	1.2	73.2	1.2	73.2	1.2	73.2	1.2	73.2	1.2	73.2	1.2	73.2	1.2
+25					9.6	74.9	9.8	74.7	10.0	74.5	9.8	74.7	9.8	74.7	9.8	74.7	9.8	74.7	9.8	74.7	9.8	74.7	9.8	74.7	9.8
+50					8.5	76.0	8.6	75.9	8.3	76.2	7.6	76.9	7.6	76.9	7.6	76.9	7.6	76.9	7.6	76.9	7.6	76.9	7.6	76.9	7.6
+75					7.4	77.1	7.3	77.2	7.0	77.5	6.8	78.0	6.4	78.1	6.4	78.1	6.4	78.1	6.4	78.1	6.4	78.1	6.4	78.1	6.4
A.M.					5.8	78.7	5.8	78.7	5.8	79.5	5.0	79.5	5.0	79.5	5.0	79.5	5.0	79.5	5.0	79.5	5.0	79.5	5.0	79.5	5.0
#					11.8	83.5	11.7	83.6	11.1	84.2	11.0	84.3	11.0	84.3	11.0	84.3	11.0	84.3	11.0	84.3	11.0	84.3	11.0	84.3	11.0
0					10.0	85.3	10.1	85.2	9.4	85.9	9.1	86.2	9.3	86.0	9.3	86.0	9.3	86.0	9.3	86.0	9.3	86.0	9.3	86.0	9.3
+25					8.6	86.7	8.4	86.9	8.3	87.0	7.8	87.5	7.6	87.7	7.8	87.5	7.6	87.7	7.8	87.5	7.6	87.7	7.8	87.5	7.6
+50					7.2	88.1	7.3	88.0	6.9	88.4	6.2	89.1	6.0	89.5	6.2	89.1	6.0	89.5	6.2	89.1	6.0	89.5	6.2	89.1	6.0
+75					5.4	89.9	5.1	90.2	4.7	90.6	4.0	91.3	3.8	91.4	4.0	91.3	3.8	91.4	4.0	91.3	3.8	91.4	4.0	91.3	3.8
#					3.2	92.1	3.3	92.0	2.8	92.5	2.9	94.4	1.5	93.8	2.9	94.4	1.5	93.8	2.9	94.4	1.5	93.8	2.9	94.4	1.5
10.19		10446	1.05	94.27																					

Intersection of State & Hawthorn already graded

(84.5)

(74.4)

(64.3)

East State

West of State

center of Columbia St

Columbia St

Hawthorn St

Animal X deer of Hawthorn St

Sta	H ₀	Blu	Part	Sidewall	Center	Sidewall	Spot
1+50	104,46		101.5	94.2	92	96.3	8.7
+70			7.5	97.8	64	98.1	5.6
2	Wood & Ummon		4.5	99.9	4.3	100.2	3.6
0 1/2 #	11.72	115.12	1.06	103.40			
			N.E. on Ummon Intersection of Ummon & Hawthorn graded.				
+25			1.0	114.1	1.5	112.6	3.1
					(126.7)		(115.1)
#	11.73	126.70	0.15	114.97			
+50			9.1	117.6	9.6	117.1	10.9
							(126.7)
+75			7.2	119.5	8.2	118.5	9.3
							(126.7)
			5.8	120.8	6.9	119.8	7.1
							119.6
							8.9
							117.8
							9.1
							117.7

Graded to the East line of Albatross.

#	9.44	136.13	0.01	126.69
B.M. #	11.48	145.91	1.70	134.43

East of Albatross

#	11.47	136.99	0.39	145.32
---	-------	--------	------	--------

+50

#	11.0	146.60	11.9	145.1
---	------	--------	------	-------

+75

#	7.9	149.1	8.2	148.8
---	-----	-------	-----	-------

1

#	3.9	153.1	4.7	152.3
---	-----	-------	-----	-------

+25

#	11	155.9	1.9	155.1
---	----	-------	-----	-------

+50

Albatross & Hawthorn (145.9)

5.8 140.1 7.6 138.3 8.1 137.8

7.8 138.1 9.2 136.7

3.0 142.9 3.7 142.2 5.7 140.2 6.6 139.3 7.4 138.5

11.0 146.60 11.9 145.1 2.5 143.4 4.3 141.6 5.3 140.6

7.9 149.1 8.2 148.8 11.1 145.9 2.3 143.6 3.3 142.4

3.9 153.1 4.7 152.3 7.8 149.2 11.2 145.8 1.5 144.4

11 155.9 1.9 155.1 3.9 153.1 9.4 148.6 10.0 146.5

4.3 158.7 3.3 157.7 2.0 155.0 6.2 150.8 7.4 148.6

Final X-sec of Hawthorn St

Sta	+	RD	-	Blk	Dist	Width	Count	Side	Dist	Side				
1475		162.96			11.8	161.2	3.1	159.9	6.5	156.5	4.7	152.3	7.0	150.0
2					11.9	161.1	3.9	159.1	7.4	153.6	4.9	152.1	7.1	149.9
					Intersection of Grand & Hawthorn									
					SW corner of 7' joint									
0					5.8	156.3	6.5	155.6	10.1	152.0	11.8	150.3	12.1	150.0
+ 25					3.6	158.5	5.5	156.6	8.3	153.8	11.3	150.8	12.7	149.3
+ 50					1.4	160.7	3.2	158.9	6.5	155.6	11.2	152.9	12.2	149.9
+ 75					1.0	161.1	2.7	159.4	7.9	154.3	11.5	150.6	12.1	150.0
1					8.3	161.0	3.2	158.9	8.4	153.7	10.9	151.2	11.3	150.8
#					7.8	161.5	2.6	159.7	6.2	155.9	7.8	154.3	8.4	153.7
+ 25														
450					6.7	162.6	8.1	161.2	3.3	158.8	5.6	156.5	6.9	155.2
+ 75					5.2	164.1	5.9	163.4	2.0	160.1	4.8	157.3	4.4	157.7
2					4.2	165.1	5.8	163.6	2.2	159.9	2.6	159.5	2.0	160.1
B9#					18th and Hawthorn									
					Intersection of Hawthorn & 18th in grades									
0					2.5	174.8	6.6	169.7	9.7	167.6	12.4	164.9	4.5	172.8
+ 25														
+ 50														
+ 75														
#														

Each of first St

5.74 182.50 0.56 176.76

0.7
6.1
37
0.2

176.6
170.6

8.2
37.0

169.1
177.1

8.7
8.1

168.6
169.2

168.1
175.5

4.3
5.8

173.0
171.5

177.3

177.3

12.4

164.9

4.5

172.8

18th in grades

Hawthorn

18th in grades

Final & recd of Hawthorn St

Sta	HD	Blk	North	Stilewell	Quarry	Stilewell	South
+ 44	182.50		4.4	178.1	4.1	178.4	7.6
+ 44			4.4	178.1	4.1	178.4	7.6
+ 50			3.9	178.6	4.0	178.5	7.4
+ 75			2.4	152.1	3.1	178.4	9.3
+ 25			1.5	151.0	2.2	150.3	4.8
+ 50			0.0	152.5	0.8	181.7	4.8
+ 55			0.0	152.5	0.8	181.7	4.8
+ 75			1.2	181.3	1.4	181.4	6.4
1.24	191.39	11.85	190.65				
1.30	162.47	11.72	160.17				
+ 14			2.9	159.6	7.6	154.9	10.3
+ 14			2.9	159.6	7.6	154.9	10.3
+ 40			7.5	166.4	3.1	159.8	2.4
+ 42			2.1	171.9	8.8	166.1	6.7
+ 66			3.7	177.0	10.1	168.2	3.3
+ 25			8.1	172.6	0.9	147.9	4.5
+ 50			10.9	179.8	3.2	166.6	10.0
+ 75			11.30	173.92	0.27	162.62	
#			6.99	180.66	0.25	173.67	
#			0.03	168.76	11.93	168.73	
1			6.2	162.5	10.8	153.0	10.9
#			0.36	178.46	10.66	158.10	9.1

Sta	T	AD	Elev	North	R	E	Side walk	R	E	Center	R	E	Side walk	R	E	South	R	E
1+50		202.142					202.4						202.9					
+75																		
2																		
+12	West of 14th St			6.7	195.7	7.2	195.2	7.5	194.9	8.1	194.3	7.9	194.5					
B.M.	East of 4th St	5.67 196.70		6.7	195.7	7.2	195.2	7.5	194.9	8.1	194.3	7.9	194.5					
0				3.5	198.9	3.9	198.5	6.7	195.7	7.5	194.9	6.8	195.6					
+25				2.2	200.2	2.8	199.6	5.2	196.2	5.6	196.8	5.5	196.9					
+50				1.5	200.9	1.8	200.6	4.0	198.4	4.0	198.4	3.8	198.6					
+75				0.3	202.1	0.8	211.6	3.2	199.2	3.0	199.4	3.0	199.4					

-1				10.5	203.1	0.2	202.2	2.2	200.2	2.6	199.8	2.5	199.9					
+20				9.1	204.5	10.3	203.3	2.3	200.1	3.3	199.1	3.5	198.9					
+50				7.8	205.5	10.3	203.3	6.0	196.4	4.6	197.8	4.5	198.9					
+75				8.4	205.2	10.5	203.1	8.1 8.1 10	195.9	8.9	193.5	5.0	197.4					
2	West of 7th St		7.2	9.4	204.2	6.9	206.7	6.5	195.9	7.4	195.0	8.0	194.4					
+14	Center of 5th St		B.M. 16.6	15.7	207.9	5.5	196.9	6.8	195.6	7.5	194.9	8.3	194.1					
+40			15.7	207.9	5.5	196.9	6.8	195.6	7.5	194.9	8.3	194.1						
+66				4.3	198.1	5.1	197.3	6.2	196.2	7.3	195.1	7.5	194.6					
				4.7	197.7	5.2	197.2	6.1	196.3	7.3	195.1	7.8	194.6					
					(213.6)	203.1	0.2	202.2	2.2	200.2	2.6	199.8	2.5	199.9				

Sta	+	HD	-	Blu	North	Side walk	Centre	Side walk	South					
					R	R	R	R	R					
0	East of 5th St	202.42			4.0	202.4	1954	4.6	202.4	1957	7.1	1958		
+ 25					4.3	1981	4.8	1956	2.5	1989	1.9	2015	1.6	200.8
#	11.23	213.55	0.10	202.32	8.4	2052	7.6	2060	7.0	2060	6.2	2074	6.2	2074
+ 50					4.2	2094	4.9	2085	5.6	2080	3.9	2097	4.5	1991
+ 75					1.8	2118	3.7	2089	4.3	2093	2.9	2104	3.6	2100
1					1.8	2141		2096	4.0	2096	2.5	2104		
1					3.5	2141		2096	4.0	2096	2.5	2104		
1					3.7	2141		2096	4.0	2096	2.5	2104		
+ 25					1.2	2124	1.3	2123	1.8	2115	2.5	2111	3.1	2105
+ 50					1.2	2124	1.4	2122	2.0	2116	2.8	2108	3.4	1992
+ 69	Peak class				2.2	2114	2.2	2114	3.0	2100	3.7	2099	4.6	2090
B.M	3.02	205.84		202.32										

6.62 198.92. Over Run W of 4th St

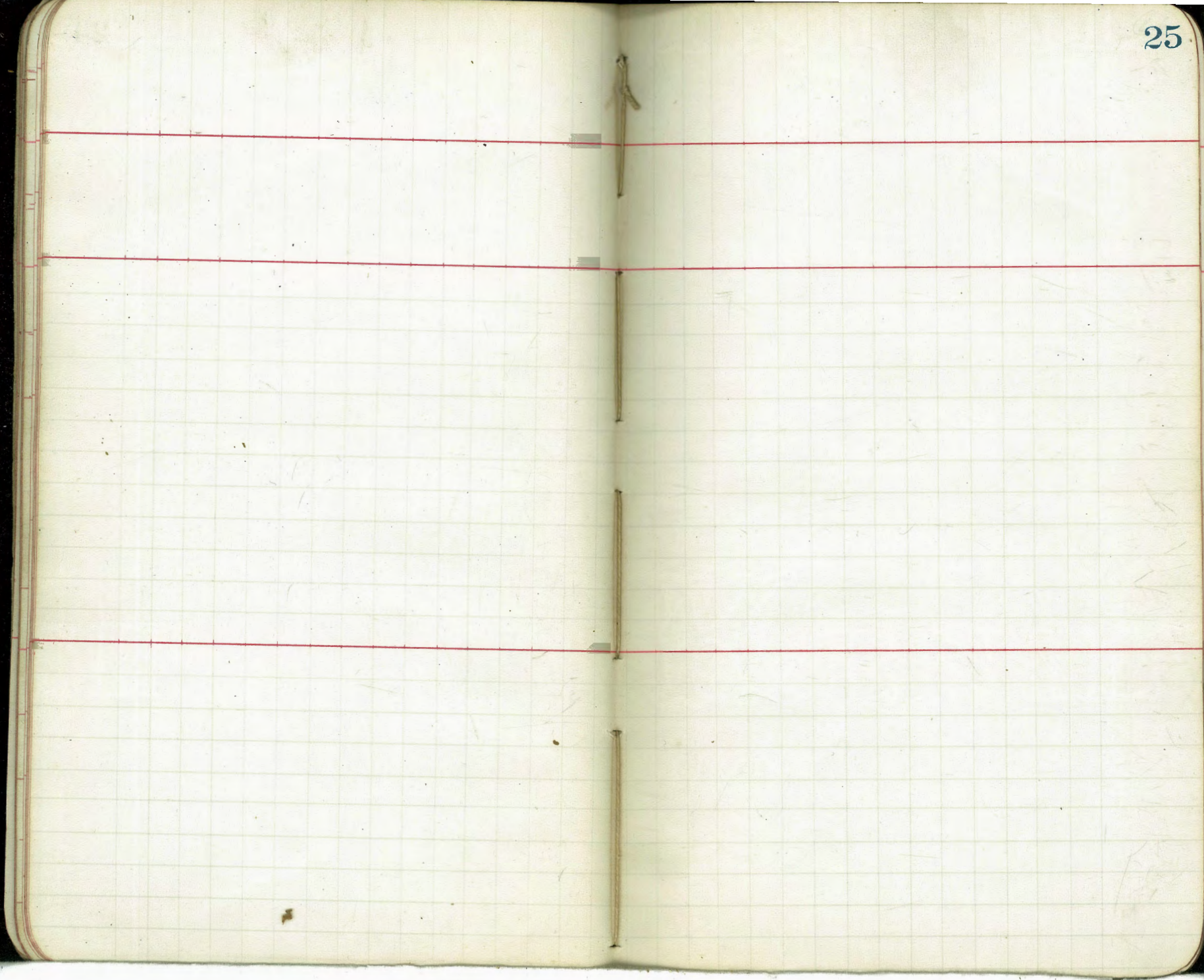

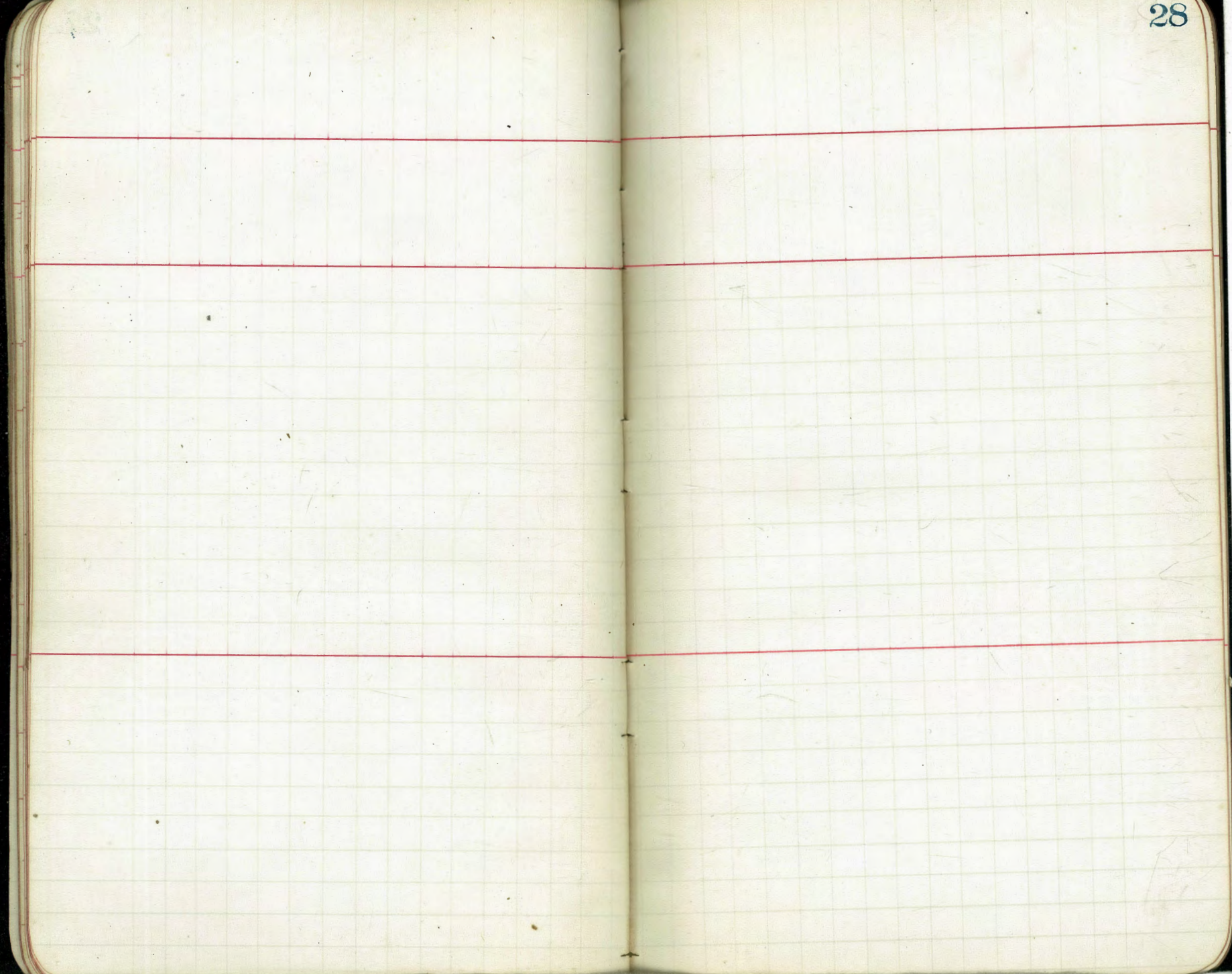

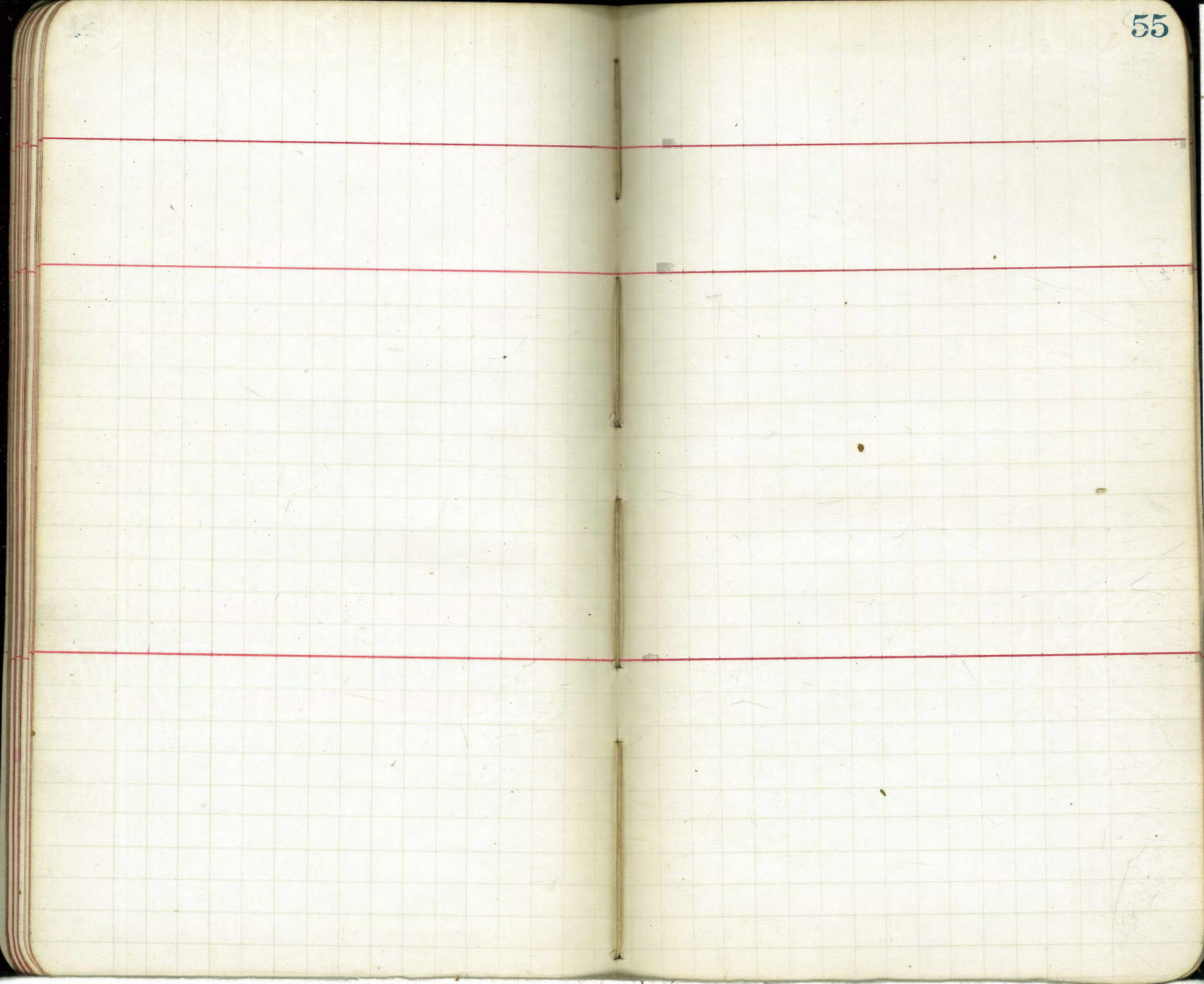

89c ml
 181-
 181-

134.43
 150.21
 155.62

S.E. Mygale-
 S.W. *Mygale-
 sum pini* but 7' the point
 S.E. *Mygale of Mygale*

148
 162.96
 150.21
 12.75

TRAVERSE TABLE FOR TRANSIT BOOK,
From 1° to 90° for a distance of 100.

Degrees.	DEGREES.		¼ DEGREE.		½ DEGREE.		¾ DEGREE.		Degrees.
	Lat.	Dep.	Lat.	Dep.	Lat.	Dep.	Lat.	Dep.	
0			100.00	0.44	100.00	0.87	99.99	1.31	85
1	99.98	1.75	99.98	2.18	99.97	2.62	99.95	3.05	84
2	99.94	3.49	99.92	3.93	99.91	4.36	99.88	4.80	83
3	99.86	5.23	99.84	5.67	99.81	6.10	99.79	6.54	82
4	99.76	6.98	99.73	7.41	99.69	7.85	99.66	8.28	81
5	99.62	8.72	99.58	9.15	99.54	9.58	99.50	10.02	80
6	99.45	10.45	99.41	10.89	99.36	11.32	99.31	11.75	79
7	99.25	12.19	99.20	12.62	99.14	13.05	99.09	13.49	78
8	99.03	13.92	98.97	14.35	98.90	14.78	98.84	15.21	77
9	98.77	15.64	98.70	16.07	98.63	16.50	98.56	16.93	76
10	98.48	17.36	98.40	17.79	98.33	18.22	98.25	18.65	75
11	98.16	19.08	98.08	19.51	97.99	19.94	97.90	20.36	74
12	97.81	20.79	97.72	21.22	97.63	21.64	97.53	22.07	73
13	97.44	22.50	97.34	22.92	97.24	23.34	97.13	23.77	72
14	97.03	24.19	96.92	24.62	96.81	25.04	96.70	25.46	71
15	96.59	25.88	96.48	25.30	96.36	26.72	96.25	27.14	70
16	96.13	27.56	96.00	27.98	95.88	28.40	95.76	28.82	69
17	95.63	29.24	95.50	29.65	95.37	30.07	95.24	30.49	75
18	95.11	30.90	94.97	31.32	94.83	31.73	94.69	32.14	74
19	94.55	32.56	94.41	32.97	94.26	33.38	94.12	33.79	73
20	93.97	34.20	93.82	34.61	93.67	35.02	93.51	35.43	68
21	93.36	35.84	93.20	36.24	93.04	36.65	92.88	37.06	67
22	92.72	37.46	92.55	37.86	92.39	38.27	92.22	38.67	66
23	92.05	39.07	91.88	39.47	91.71	39.87	91.53	40.27	65
24	91.35	40.67	91.18	41.07	91.00	41.47	90.81	41.87	64
25	90.63	42.26	90.45	42.66	90.26	43.05	90.07	43.44	63
26	89.88	43.84	89.69	44.23	89.49	44.62	89.30	45.01	62
27	89.10	45.40	88.90	45.79	88.70	46.17	88.50	46.56	61
28	88.29	46.95	88.09	47.33	87.88	47.72	87.67	48.10	60
29	87.46	48.48	87.25	48.86	87.04	49.24	86.82	49.62	59
30	86.60	50.00	86.38	50.38	86.16	50.75	85.94	51.13	58
31	85.72	51.50	85.49	51.88	85.26	52.25	85.04	52.62	57
32	84.80	52.99	84.57	53.36	84.34	53.73	84.10	54.10	56
33	83.87	54.46	83.63	54.83	83.39	55.19	83.15	55.56	55
34	82.90	55.92	82.66	56.28	82.41	56.64	82.16	57.00	54
35	81.92	57.36	81.66	57.71	81.41	58.07	81.16	58.42	53
36	80.90	58.78	80.64	59.13	80.39	59.48	80.13	59.83	52
37	79.86	60.18	79.60	60.53	79.34	60.88	79.07	61.22	51
38	78.80	61.57	78.53	61.91	78.26	62.25	77.99	62.59	50
39	77.71	62.93	77.44	63.27	77.16	63.61	76.88	63.94	49
40	76.60	64.28	76.32	64.61	76.04	64.94	75.76	65.28	48
41	75.47	65.61	75.18	65.93	74.90	66.26	74.61	66.59	47
42	74.31	66.91	74.02	67.24	73.73	67.56	73.43	67.88	46
43	73.14	68.20	72.84	68.52	72.54	68.84	72.24	69.15	45
44	71.93	69.47	71.63	69.78	71.33	70.09	71.02	70.40	44
45	70.71	70.71							
Degrees.	Dep.	Lat.	Dep.	Lat.	Dep.	Lat.	Dep.	Lat.	Degrees.
	DEGREES.		¼ DEGREE.		½ DEGREE.		¾ DEGREE.		

Published by Edward Denny & Co., Stationers, Drawing Materials,
Mathematical Instruments, Etc., San Francisco.

37.5
95
77.0

16.3
10.9
13.21