

PARK

#1

9

TRANSIT

F.B. 618

618 ntuse

- 200. A. Brickyard
- 220. A. "
- 220 C. Switzer
- 240 C. "
- 260 C. "
- 40 A² School house
- 60 A² "
- 80 A² "

School house
MICROFILMED

DEC 14 1964

April 20th 98

City Park Contain survey

Franklin

PUBLISHED BY

EDWARD DENNY & CO.

DRAWING PAPER & MATERIAL, MATHEMATICAL INSTRUMENTS, ETC.,
STATIONERS AND PRINTERS,

SAN FRANCISCO, CAL.

Table for Running on Slopes.

In the following table the first column shows the angle, the second, the number of links to be added to a chain on the slopes, to make one chain, a horizontal measurement.

Angle.	Cor. in links	Angle.	Cor. in links.	Angle.	Cor. in links.	Angle.	Cor. in links.
0		0		0		0	
4	0.24	11	1.88	18	5.14	25	10.54
5	0.38	12	2.24	19	5.76	26	11.26
6	0.55	13	2.63	20	6.42	27	12.24
7	0.76	14	3.06	21	7.11	28	13.37
8	0.98	15	3.53	22	7.85	29	14.34
9	1.24	16	4.02	23	8.64	30	15.47
10	1.55	17	4.56	24	9.47	35	22.07

Brick Yard Canon

200 ft. Contour line

Sta.	Left	Right			
70	80°19'				
69	74°03'				
+55	74°10'				
68	64°14'				
67	62°54'				
66	63°23'				
+82	62°58'				
65	56°48'				
+22	53°56'	Intersection of E. Canon = Sta. 3			
64	53°40'				
63	51°00'				
+78	49°51'				
62	43°14'				
61	34°55'	Intersection of B. Canon = 16+10			
60	39°00'				
+35	40°30'				
59	37°55'				
58	27°05'				
57	16°45'				
56	15°10'				

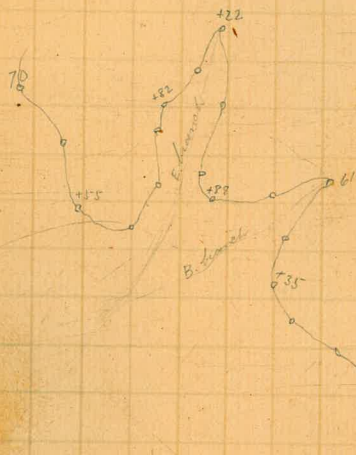

Continued on form T.P. of 53+36

250 ft. Contour line

Sta. Left Right

Sta.	Left	Right
82	108° 11'	
+70	105° 59'	
81	100° 58'	
+13	99° 25'	
80	98° 45'	
+60	96° 30'	
79	90° 55'	
+60	87° 31'	
78	87° 5-8'	
+62	87° 31'	
77	84° 06'	
+56	82° 02'	
76	78° 44'	
75	73° 33'	
+80	72° 46'	No station in contour
74	79° 5-4'	
+20	79° 5-8'	
73	80° 29'	
72	76° 57'	
71	76° 02'	



200 ft. Contour line

Sta. Left Right

96	13°28'	
95	12°45'	
94	11°55'	
+80	11°48'	
93	6°57'	
92	14°57'	
	23°35'	Sta. 4. & 5. Cancun
+34	25°51'	
91	32°05'	
90	44°08'	
89	44°35'	
+30	42°58'	
88	41°08'	
87	61°41'	
86	32°02'	
+92	17°30'	
+62	35°06'	
85	34°41'	
84	114°18'	
83	115°15'	



200 ft. Contour line

Sta.	Left	Right
106	77°58'	
+30	67°37'	
105	62°18'	
+58	56°55'	
104	48°10'	
103	40°06'	
+77	38°05'	
+45	37°34'	
102	33°10'	
+64	31°35'	
101	31°34'	
100	32°47'	
+50	33°32'	
99	31°49'	
+65	29°35'	
98	25°15'	
	23°48'	Sta. 10. E. Canon
+72	22°51'	
97	22°47'	
96+50	21°15'	

Intersection of E. Canon = 10+25

200 ft. Contour line

No.	Left	Right
117	21°20'	
+40	19°47'	
116	16°42'	
+78	14°20'	
+16	7°01'	
115	6°20'	
114	2°10'	
113		4°58'
112		12°06'
111		9°30'
110+56		46°06'
110		43°20'
109+76		33°31'
+36		6°42'
109		13°04'
+61		26°50'
108		7°27'
107+50	95°08'	
+22	95°50'	
107	94°34'	



200 ft. Contour line

Sta.	Left	Right
+68	64°08'	
130	60°50'	
+24	57°42'	
129	56°35'	
128	55°26'	
+23	55°53'	
127	56°26'	
+54	50°47'	
126	47°46'	
+32	36°50'	
125	35°31'	
124	35°49'	
123	34°04'	
122	31°37'	
121	28°03'	
	25°02'	Sta. 30. N. Canon
+20	26°15'	
120	25°10'	
119	23°40'	
118	23°30'	

Intersection of N. Canon = 30+75

200 ft. Contour line

Sta.	Left	Right
143450	84°21'	8
143	73°15'	
142	32°38'	
141+72	168°56'	
+45	164°21'	
141	160°12'	
+55	154°15'	
140	149°25'	
139	137°30'	
138	125°45'	
	113°55'	Sta. 4, H. Canon
137	113°28'	
136	118°25'	
+32	119°37'	
135	105°56'	
134	96°10'	
+37	83°05'	
133	82°20'	
132	77°33'	
131	66°50'	

Intersection of H. Canon = 4920



200 ft. Contour line

Sta.	Left	Right
154		15° 47'
+64		12° 10'
153		39° 08'
152 + 64		80° 32'
152		82° 00'
+30		89° 26'
151		99° 06'
		131° 47'
+30		122° 26'
150		125° 15'
149		103° 05'
148 + 74		48° 10'
148		21° 20'
147 + 58		23° 44'
147		18° 20'
+38		11° 55'
146		14° 20'
145		29° 24'
144 + 64		13° 39'
144		31° 43'

Sta. 4+50, A. Canon

Intersection of A. Canon = 4+20

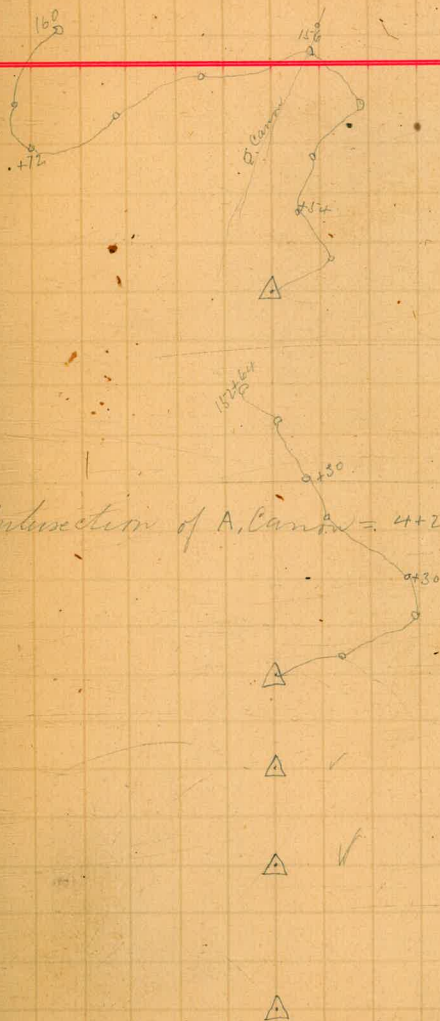

200 M. Contour line

Sta. Left Right

167		20°35'
166+73		11°56'
166		21°22'
165+49		70°01'
165		71°50'
+76		71°20'
+28		74°06'
164		77°45'
163		82°26'
162		85°02'
+67		78°47'
161		75°24'
160	20°00'	
159	33°05'	
+72	35°27'	
158	23°18'	
157	5°43'	

13°55' Sta. 9.8 Canon

156 11°34'

155 19°18'

Franklin (transit)

9



Intersection of 2 Canons = 8+70

200 ft. Contour line

Sta	Left	Right
181	83°17'	
+35	75°17'	
180	70°40'	
+36	61°20'	
179	54°40'	
178	41°00'	
177	33°55'	
176	36°46'	Intersection of R. Canyon - 17+00
175	28°14'	
174	25°08'	
173	19°12'	
+40	4°32'	
172	3°39'	
+74	3°38'	
+30		7°38'
171		8°52'
170	9°46'	
+58	5°35'	
169	4°06'	
168		9°35'
167+70		16°15'



200 ft. Contour line

Sta. Left Right

+67		89°57'
194		104°15'
193		79°46'
192+42		95°47'
192		91°23'
191		85°06'
190	152°06'	
+30	152°40'	
189	151°12'	
+60	149°51'	
188	149°22'	
+68	148°55'	
187	144°51'	
186	137°34'	
+37	142°35'	
185	139°04'	
+63	138°14'	
184	131°33'	
+30	129°40'	
183	124°57'	
182	107°11'	

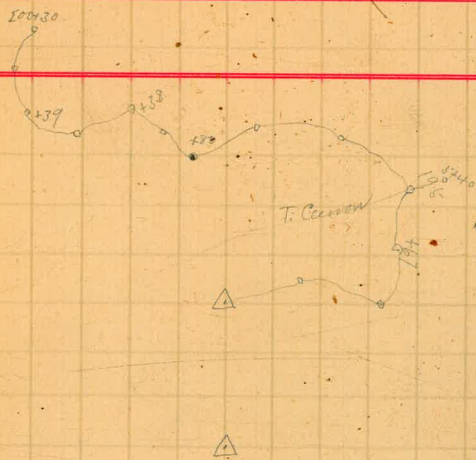

200 ft. Contour line

Sta.	Left	Right
206.		23°57'
205+57		71°59'
+44		73°05'
205		81°23'
204		101°12'
+58		108°51'
203		115°20'
202		114°47'
201		74°20'
200+30.		6°38'
200		4°38'
+39		3°40'
199		9°32'
+38		19°33'
198		23°43'
+80		27°20'
197		43°11'
196		65°14'
		91°30' Sta. 5+40 T. Canon
195		89°43'

Intersection of A. Canon = 3+10



Intersection of T. Canon = 5+05.

200 ft. Contour line

Sta.	Left	Right	
5+34	157°44'		
5	156°10'		
+26	155°25'		
4	150°07'		
3	148°50'		
+34	147°57'		
2	145°50'		
1	139°30'		
0+60	137°08'		
	134°43'	Sta 7+00 N. line of pass	
0=6+09	136°14'		
	4°11'	Sta. 19+00 N. line of pass	
211+10=18+82	5°28'		
211	4°16'		
210		11°35'	Intersects w. Contour = 10+50
209		3°17'	
+77		1°37'	
208		3°35'	
207		5°10'	
206+4		7°03'	

18+82
12+43
6+39

18+82
6+09
12+73

G.O

6+09
5+10
2+95
13

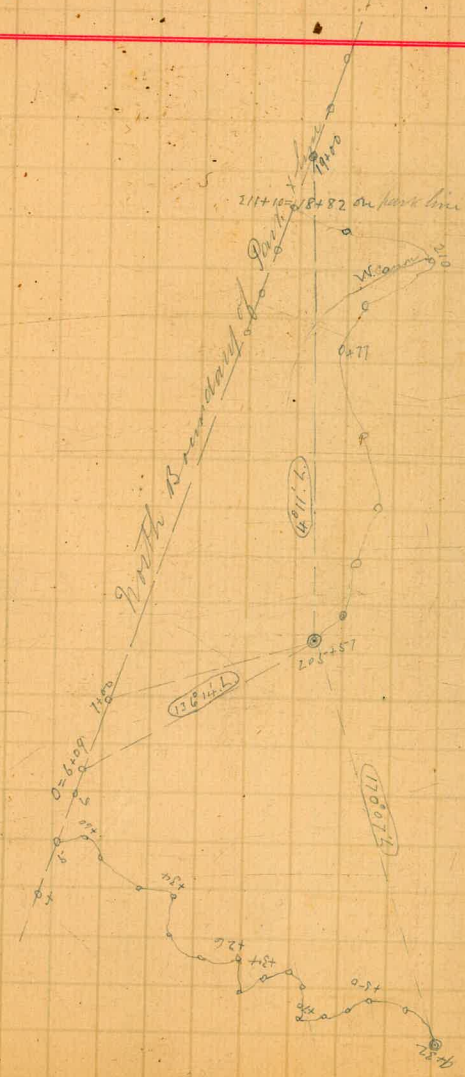

200 ft. Contour line.

Sta.	Left	Right
18		71°30'
17+82	80°12'	
17	86°05'	
16	77°10'	
15	75°40'	
+80	76°19'	
14	64°51'	
13	63°46'	
12	32°06'	
+33	132°0'	
11	9°40'	
10		6°45'
9+32	170°07'	
9	168°20'	
+50	165°33'	
8	164°42'	
7	162°45'	
+70	161°26'	
6	160°45'	
5+94	159°58'	

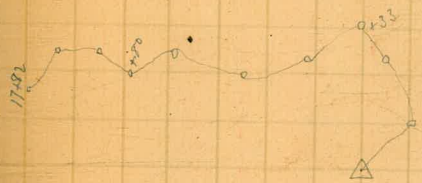

200 ft. Contour line

No.	Left	Right
36		129°10'
35+79		18°32'
35		18°45'
34		21°26'
33		22°11'
32		26°25'
31		33°02'
30		37°15'
29		42°00'
28		41°47'
27		55°13'
26+85		16°02'
26		22°02'
25		30°44'
+53		34°40'
24		37°15'
23		38°59'
22		42°56'
21		57°42'
20		71°45'
19		78°45'



200 ft. Contour line

Sta. Left Right

$40+63=292+89$	$102^{\circ}06'$ Sta 293 W. line of section
40	$100^{\circ}41'$
+64	$111^{\circ}15'$
39	$118^{\circ}14'$
38	$115^{\circ}14'$
37	$95^{\circ}33'$
	$130^{\circ}07'$

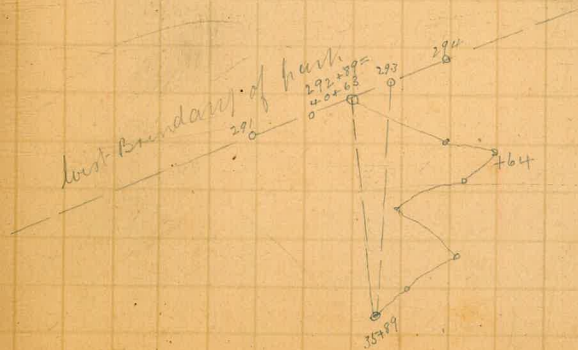
 $40+63=292+89$ on west line of part

220 ft. Contour line

Sta.	Left	Right
------	------	-------

13+35	56°01'	
13	55°26'	
12	56°10'	
11	57°03'	
10	52°22'	
9	43°26'	
8+48		10°05'
8		7°44'
7	5°55'	
6	20°55'	
5	23°33'	
4	23°13'	
3	35°24'	
2+37		34°57'
2		39°34'
1		49°03'
0=10+19 ²	76°14'	

© T.P. 4+66² from a 200 ft. line

0.200 ft. line

Franklin (transit)

17

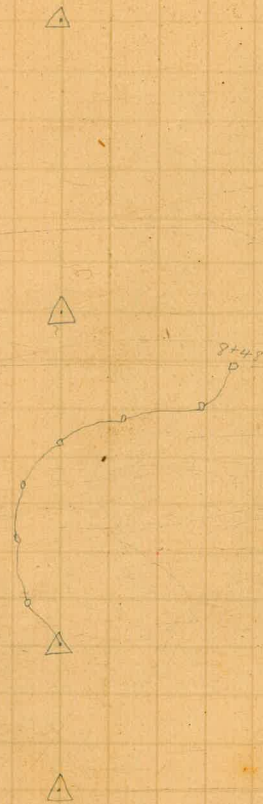

Set up on 0.200 ft. Contour line back sight to 0.150 ft. line. Reversed and turned left 76°14' from 200 ft. to 220 line = 10+19²

220 ft. Contour line

Sta. Left Right

28	14°40'	
27	17°10'	
26+56	13°19'	
26	24°19'	
25	54°34'	
24	83°48'	
23	94°36'	
22		24°35'
+34		31°22'
21		26°20'
20	10°30'	
+53	28°10'	
19	38°45'	
18+22		5°41'
18		8°45'
+60		4°36'
17	10°18'	
16	38°51'	
+46	54°00'	
15	56°43'	
14	73°10'	

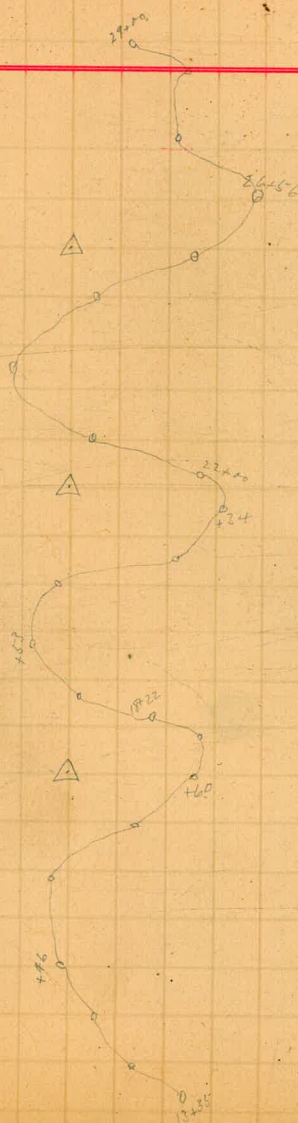

220 ft. Contour line

Sta.	Left	Right
47		16°20'
46		12°33'
45		8°20'
44		3°23'
43	3°25'	
	5°12'	Sta. 5+00 A' Canon
+56	6°30'	
42	6°40'	
41	11°17'	
40	16°05'	
39	20°18'	
38	30°17'	
37	44°41'	
36	59°41'	
35	71°52'	
34	97°35'	
33	117°40'	
32	137°20'	
31	153°10'	
30	119°05'	
29	17°41'	

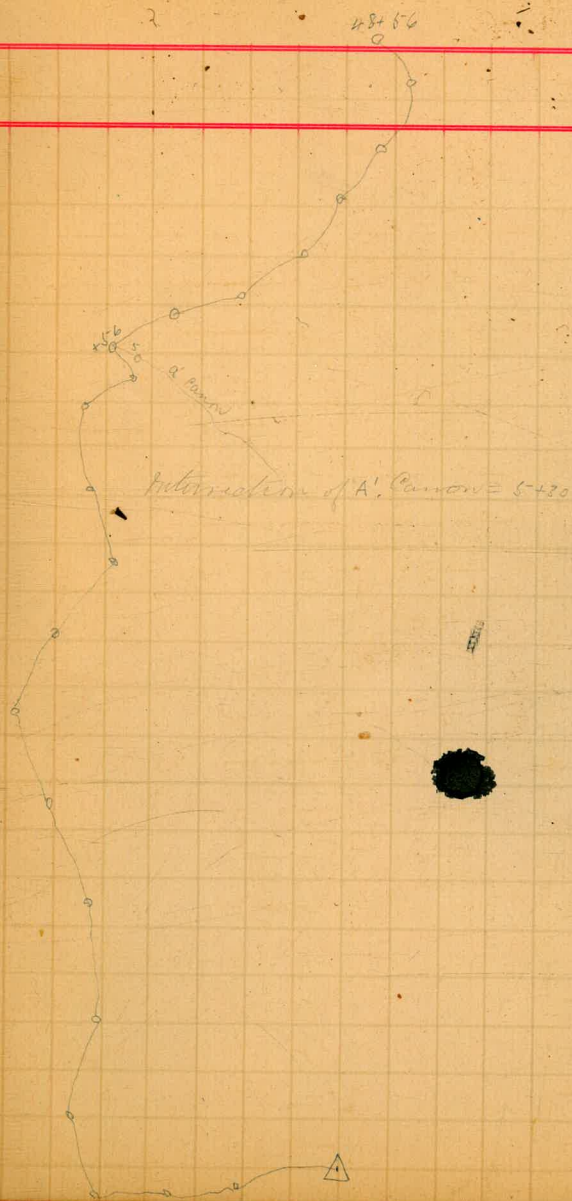

220 ft. Contour line

Sta.	Left	Right
63		114°37'
62		102°11'
61		80°31'
+27		66°29'
60		59°31'
59		42°00'
		37°21' Sta. 12+00 O. Canyon
58		36°46'
57		26°28'
+70		20°37'
56		9°29'
55	4°15'	
54	6°30'	
53	44°10'	
52	11°55'	
51	14°06'	
50	24°35'	
49+50	53°57'	
49	39°35'	
48+56		17°25'
48		18°30'

Traverse

Intersection of O Canyon = 12+20'

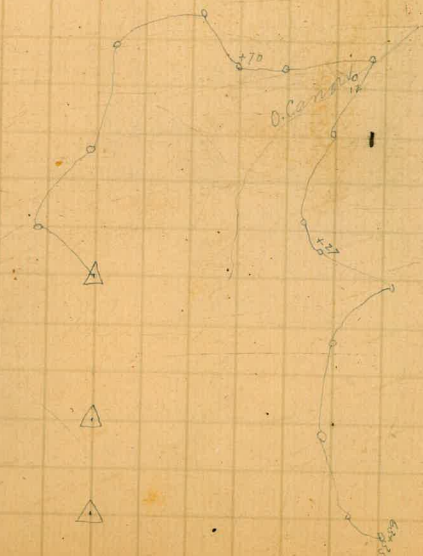

220 ft. Contour line

No.	Left	Right
-----	------	-------

10	2°41'	
9	4°00'	
8	4°15'	
7	7°32'	
6	10°30'	
5	1°31'	
4	102°14'	
3	101°55'	
2	103°48'	
1	104°44'	

0 = 73 + 235

65 + 10 = 42 + 49 59°08'

65 59°38'

64 51°38'

63 + 35

15°43' T.P. 46 + 57⁵ on park line

Intersection of N. park line

112°59'



Set up on 0 = 73 + 235 on north line of park.
Back sight to Sta. 68 + 00 and turned
left without measuring.

North boundary of park



220 ft. Contour line

Sta.	Left	Right
0 = 99+35		16° 51'
	73° 20'	Sta 99+00 E. park line
23+42 = 92+02	26° 17'	Intersection of E. park line
23	16° 14'	
22+75	44° 16'	
22	5° 09'	
21+35		4° 09'
21		4° 17'
20		3° 14'
19	1° 12'	
19+52	16° 57'	
18	16° 09'	
17		59° 25'
16		58° 48'
15		14° 41'
14	22° 06'	
13	21° 33'	
12+36	35° 36'	
12	2° 27'	
11	1° 53'	

East Boundary of Park

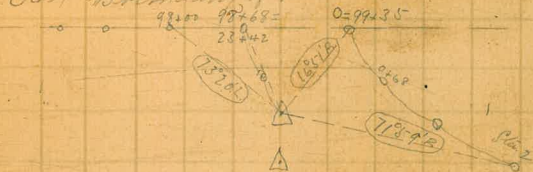

Intersection of f'



220 ft. Contour line

Sta. Left Right

	7°02'	TP Sta. 107+07 E. line of main
9=107+77	11°02'	
8	7°40'	
7	4°14'	
6+50		0°55'
6		0°58'
5	14°12'	
4	15°27'	
3	16°14'	
2		71°59'
1		66°56'
0+68		56°15'

East Abutment of main
 9=107+77
 220 ft. Contour line



220 ft. Contour line

Sta. Left Right

13		21°47'
12+48	21°25'	
12	17°40'	
11	4°06'	
10		5°16'
+70		8°31'
9		10°27'
8		9°38'
7		7°53'
6		4°33'
5		24°20'
4		22°07'
+90		20°28'
3		26°51'
+54		31°03'
2		26°50'
1	31°12'	
0=10+19 ²		



Set up on 0=10+19² Back sight to 0.200 ft line
 Reversed and turned left to Sta. 1
 for from 0.200 ft line to 0.220 ft line = 10+19²

220 ft. Contour line

Sta. Left Right

31 2°22'

30 25°08'

37°10' Sta. 12+00 E. Canal

+5.0 34°45'

29 37°03'

28 25°15'

27 23°53'

26 0°45'

25 1°33'

24 5°42'

23 5°53'

22 2°43'

21 11°25'

20 24°36'

19 25°39'

18 27°30'

17 26°00'

16 22°08'

15 36°22'

14 36°04'

Intersection of E. Canal = 11+80

E. Canal

12+00

20+00

37+00

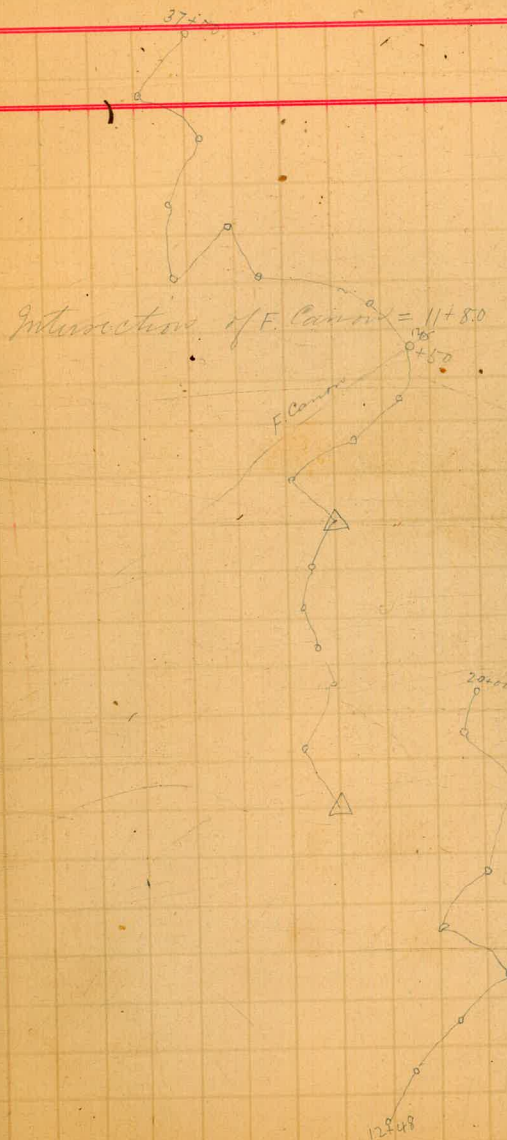

220 ft Contour line

Sta.	Left	Right
50	0°39'	
49	8°34'	
48		1°15'
47		0°24'
46		3°48'
45		0°12'
44		15°53'
43		29°10'
		42°31' Sta. 33+60 N. Canon
42		39°37'
41		41°20'
40		50°03'
39		58°35'
38		71°16'
37	10°18'	
36	16°41'	
35	10°45'	
34	15°20'	
33	16°42'	
32	0°19'	

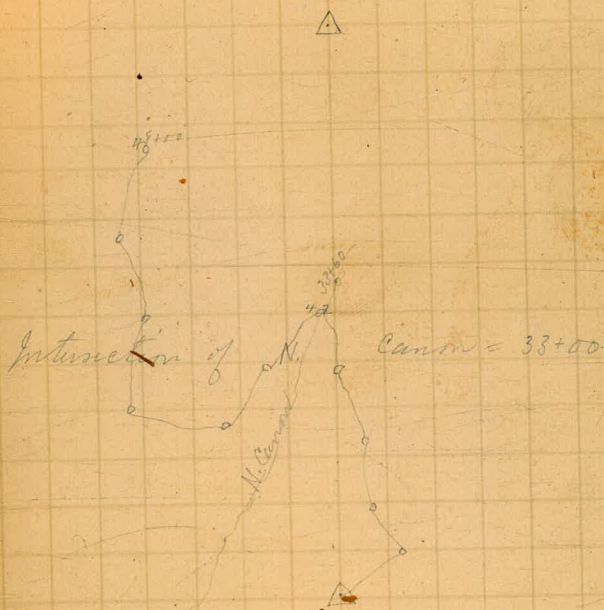

220 H. Contour line

Sta.	Left	Right
8		20°50'
7		25°37'
6		31°55'
5		39°35'
4		37°13'
3		89°26'
2		84°20'
1		87°19'

0=3+145

52+39=26+41

52

51

31°28'

10°04'

8°21'

4°50'

Sta. 28+00. N. park line

Intersection of north
line of park

Traverse (transit)

7+23+5
32
4+0
27

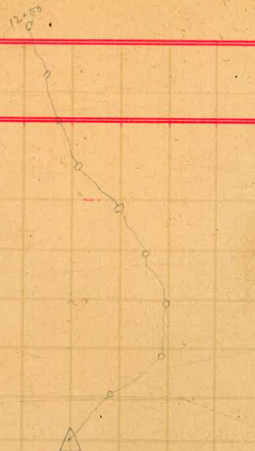

Set up on 0=3+145 with line of park
sighted to Sta. 6+00 turned right without
measuring 87°19'

North boundary of park

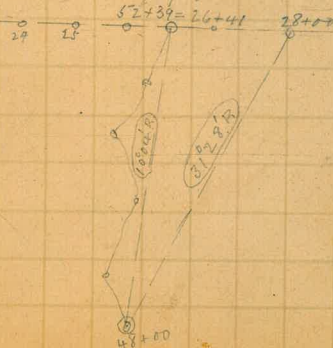

220 ft. Contour line

Sta. Left Right

30°32' Sta. 304+00 W. part line

74°07' T.P. 305+50

13+50 = 305+37

69°25'

13

72°52'

12

12°27'

11

13°00'

10

14°11'

9

16°43'

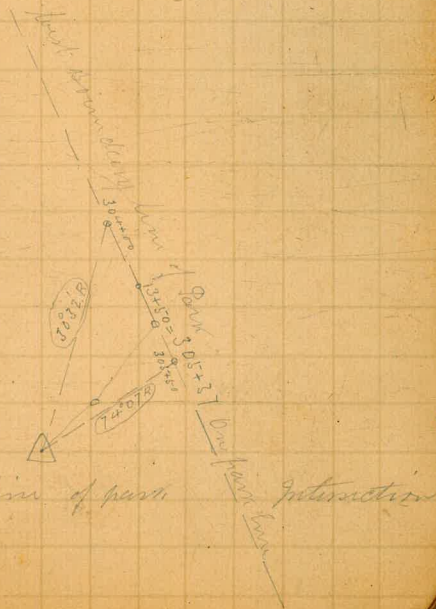

13+50 = 305+37 W. part line of pass

Intersection

240 ft. Contour line

Sta.	Left	Right
0 = 91+56	22° 20'	
	58° 18'	Sta. 90+00 E. park line
14 = 90+53	43° 52'	Intersection of E. Park line
13 + 56	37° 52'	
13	47° 20'	
12	92° 26'	
11	5° 10'	
10		0° 35'
9		2° 54'
8		1° 50'
7	5° 35'	
6	8° 12'	
5	4° 35'	
4	2° 33'	
3		2° 25'
2	4° 46'	
1+77	102° 59'	
1	101° 53'	
0 = 74+105		

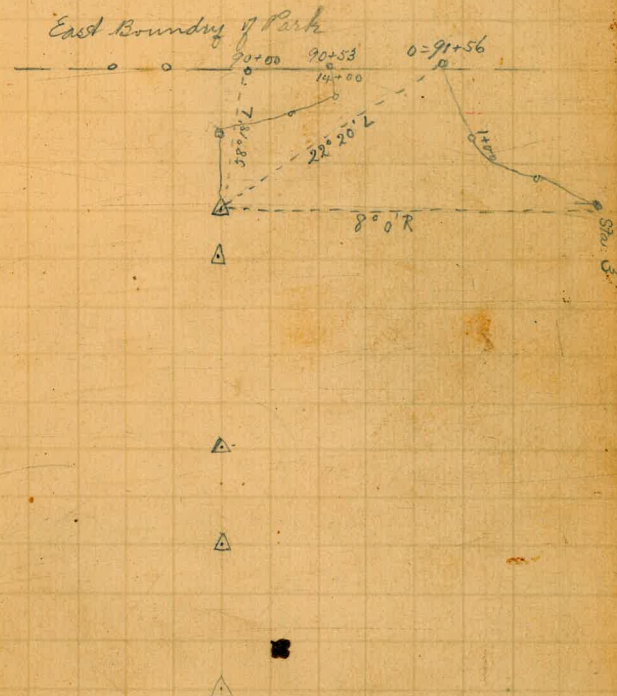

Set up on 0=74+105 on north line of
park sighted to Sta. 68+00. and turned
left to Sta. 1+00 without measuring

240 ft Condour line

Sta Left Right

		4° 24'	Sta. 96+00 E line Park
4+94		8° 28'	
4		4° 54'	
3		8° 0'	
2		8° 24'	
1	1° 14'		

East boundary of Park



260 ft Contour line

Sta. Left Right

Sta.	Left	Right
	30° 34'	Sta. 85+00 E. line of Park
6+77	16° 31'	
6	5° 44'	
5	59° 24'	
4	60° 13'	
3	61° 32'	
2	62° 25'	
1	64° 21'	
0=76+50		



Set up on 0=76+50 on North line of Park, sighted to Sta. 79+96 N.E. Corn Park, and turned right to Sta. 1+00 without reversing, 64° 21'

40 ft. contour line

Sta. Left Right

5+265	180° 0'	Intersection of South line park
5	174° 26'	
4	145° 58'	
3	116° 45'	
2+42	102° 14'	Intersection of Canon
2	99° 54'	
1	99° 02'	
0=212+11		

5+265 = 259+94 on South line park

Intersection of Canon



Set up on 0=212+11 on South line of park sighted
 to Sta. 0=213+38 ^(60 ft. chain line) and turned right to
 Sta. 1+00 without reversing

60 ft. contour line

Sta. Left Right

12+88	180° 0'	Intersection of Park lines
12	171° 22'	
11	157° 40'	
10	143° 51'	
9	133° 36'	
8	124° 18'	
7	119° 05'	Intersection of Canon
6	119° 43'	
5	115° 52'	
4+60	112° 16'	
4	103° 43'	
3	95° 35'	
2	96° 55'	
1	91° 20'	
0-213+38		

12+88 = 208+90 on South line of Park

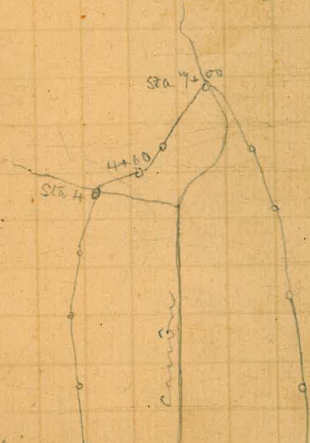

South Park boundary line

Set up on 0-213+38 on South line of Park sighted to Sta 0-214+27 (80 ft line) and turned right to Sta 1+00 without covering

80 ft. contour line

Sta.	Left	Right
13		78° 18'
12		14° 21'
11+35	23° 05'	
11	27° 43'	
10+27		15° 40'
10	1° 51'	
9	42° 02'	
8	32° 55'	
7+50		118° 19'
7		117° 05'
6+73		116° 23'
6		109° 02'
5		102° 13'
4		98° 20'
3		92° 16'
2		89° 49'
1		85° 08'

0=214+27

Intersection of 11+35 Contour

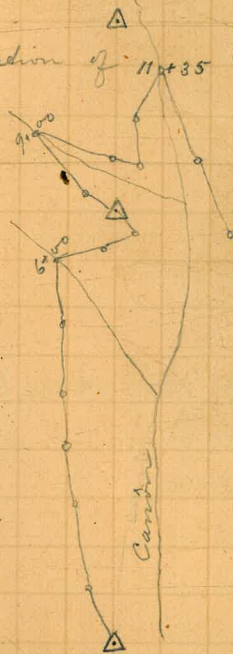

Set up on 0=214+27 on south line of Park sighted
to Spike and turned right to Sta. 1 without
reversing.

80 ft. Contour line
Sta. Left Right

19+25

19

18

17

16

15

14

103° 22' = 206+94 South line park

101° 51'

102° 45'

102° 12'

102° 15'

101° 38'

101° 12'

99° 30'

Sta 13+00

19+25

26 feet

End of 80 ft contour.

206+94

South boundary line

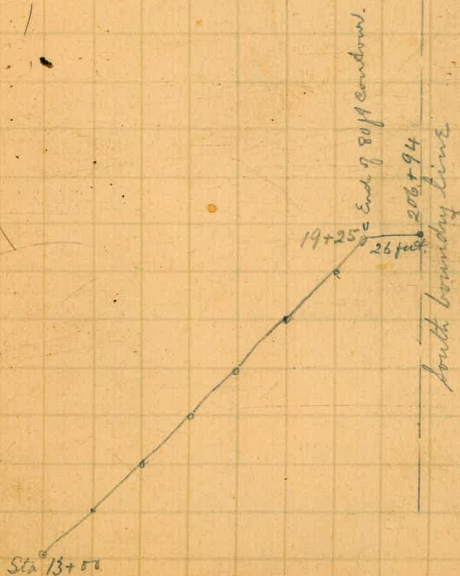

C. Canyon of B of N "Brickyard"

Sta Left Right

10	6° 59'	
9	40° 31'	
8		85° 29'
7+70		96° 52'
7		66° 16'
6+88	12° 0'	
6	14° 27'	
5+56	24° 27'	
5	13° 17'	
4	34° 31'	
3		30° 23'
2		11° 25'
1	50° 34'	
B5+00		

Sta 10+00



Set up on B5+00 back sight on 3+00 and
turn and left to Sta: 1 without crossing

Chainage of canons at intersection of
Canon Branch Chainage

140 Contour line. - "Buckyard" -

G		6+75
I		10+39
J		6+32
O		5+62
P	B	2+62
P		7+43
P	A	4+09

Orphans Home Tract

Commencing at a pt where
the centre of 17th St would
cross the centre of Beech St.
were those Sts. extended through
the City Park, running thence
North 3890 ft running thence East
1120 ft to the centre of 21st St.
were such St. extended through
the Park running thence 3890 ft
to the centre of Beech St. were
such St. extended through the
Park running thence west 1120
ft. to that place of beginning -
containing 100 acres more or
less -

Beginning at a pt where
the West line of 17th St.
intersects the South line of the
City Park running thence west
376 ft thence North 580 ft thence
East 376 ft thence South to the
pt of beginning - containing
5 acres more or less -

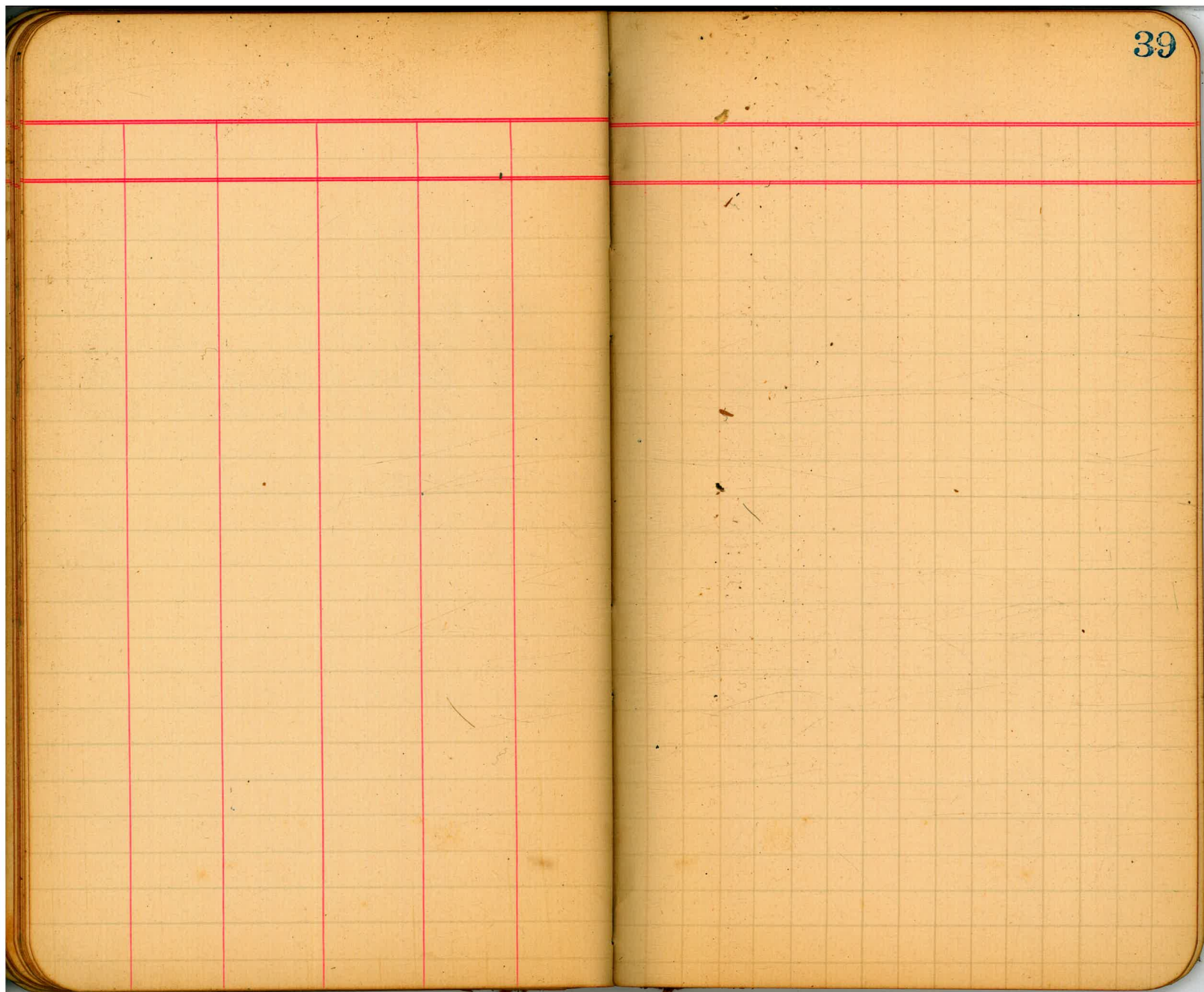

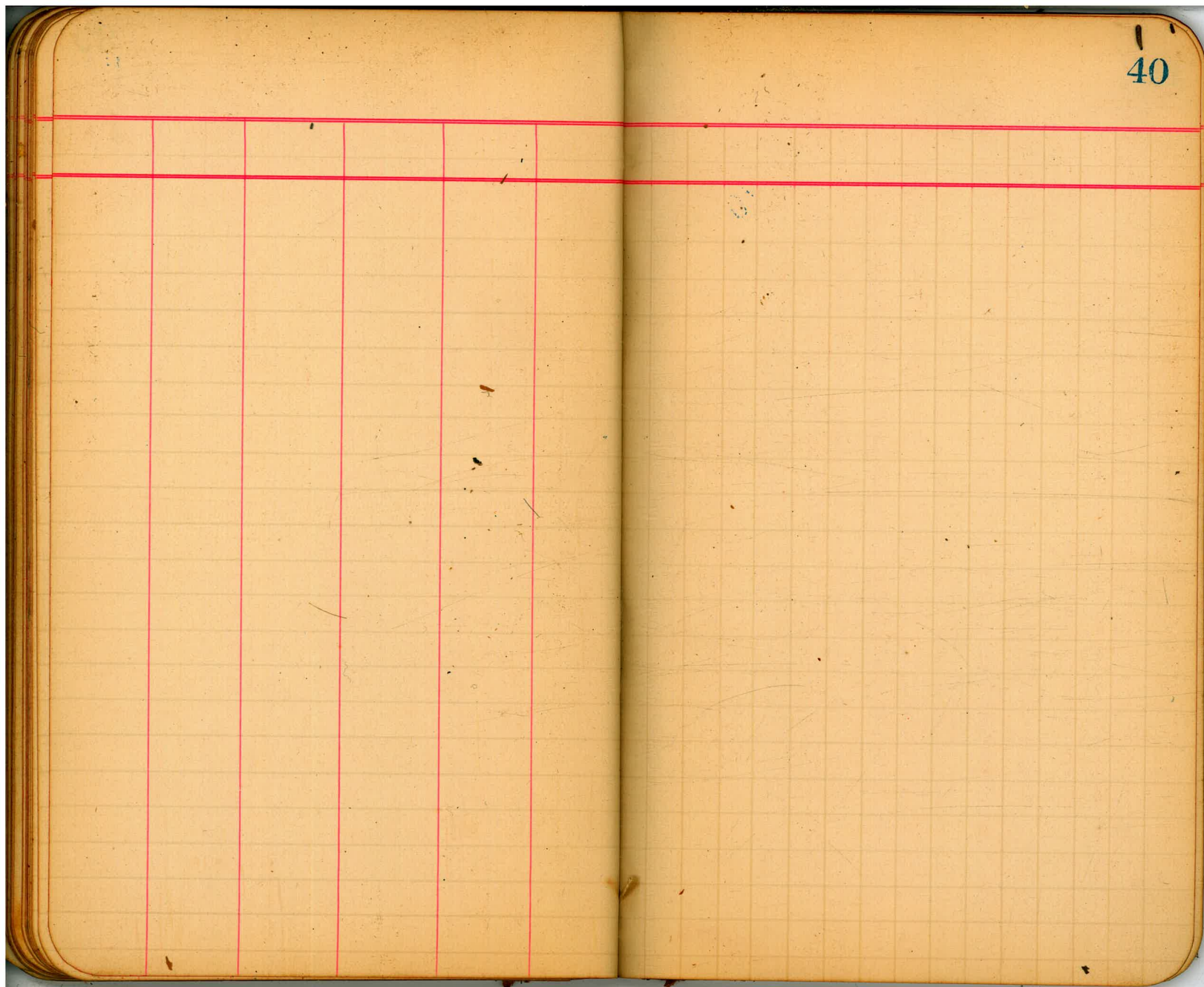

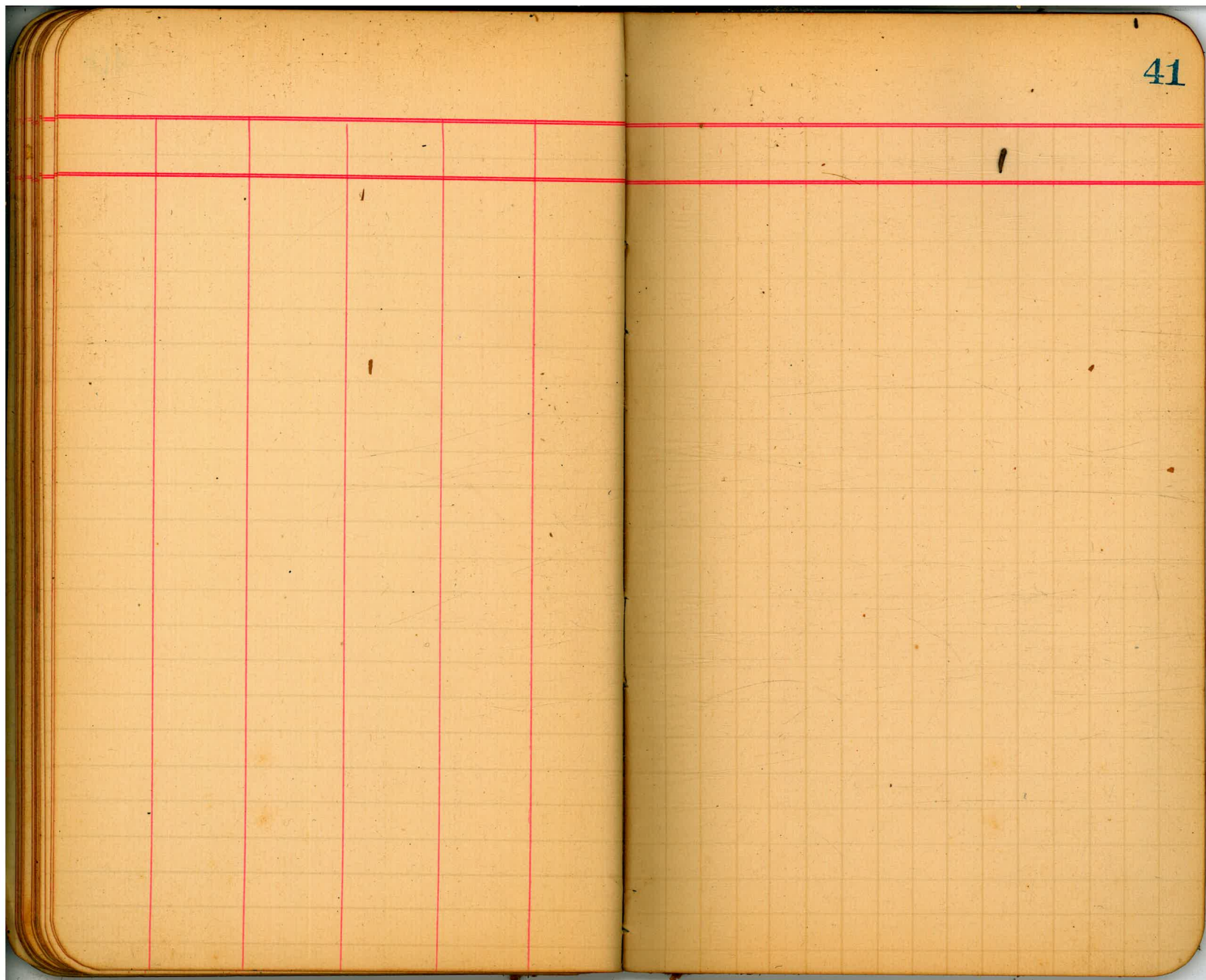

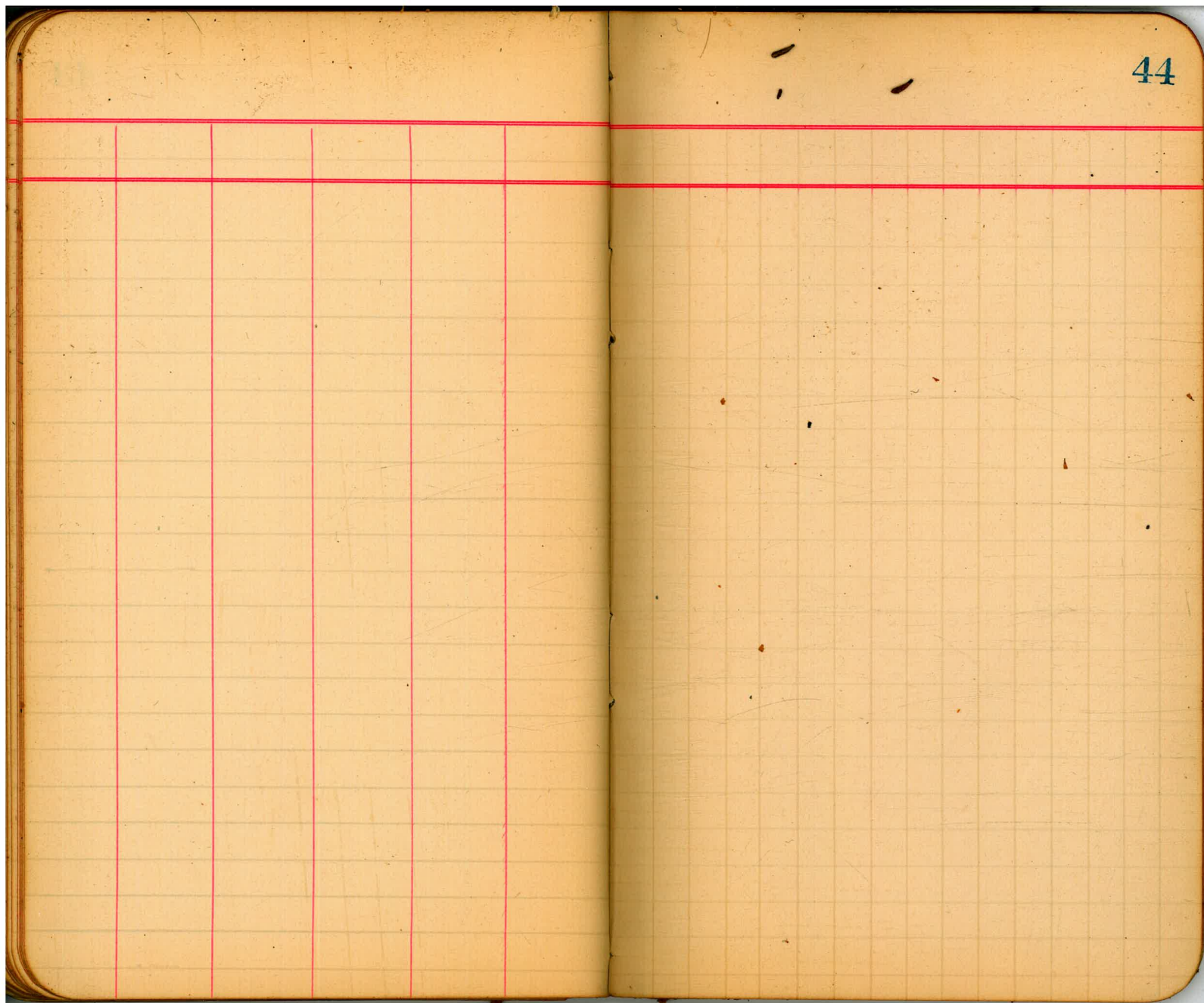

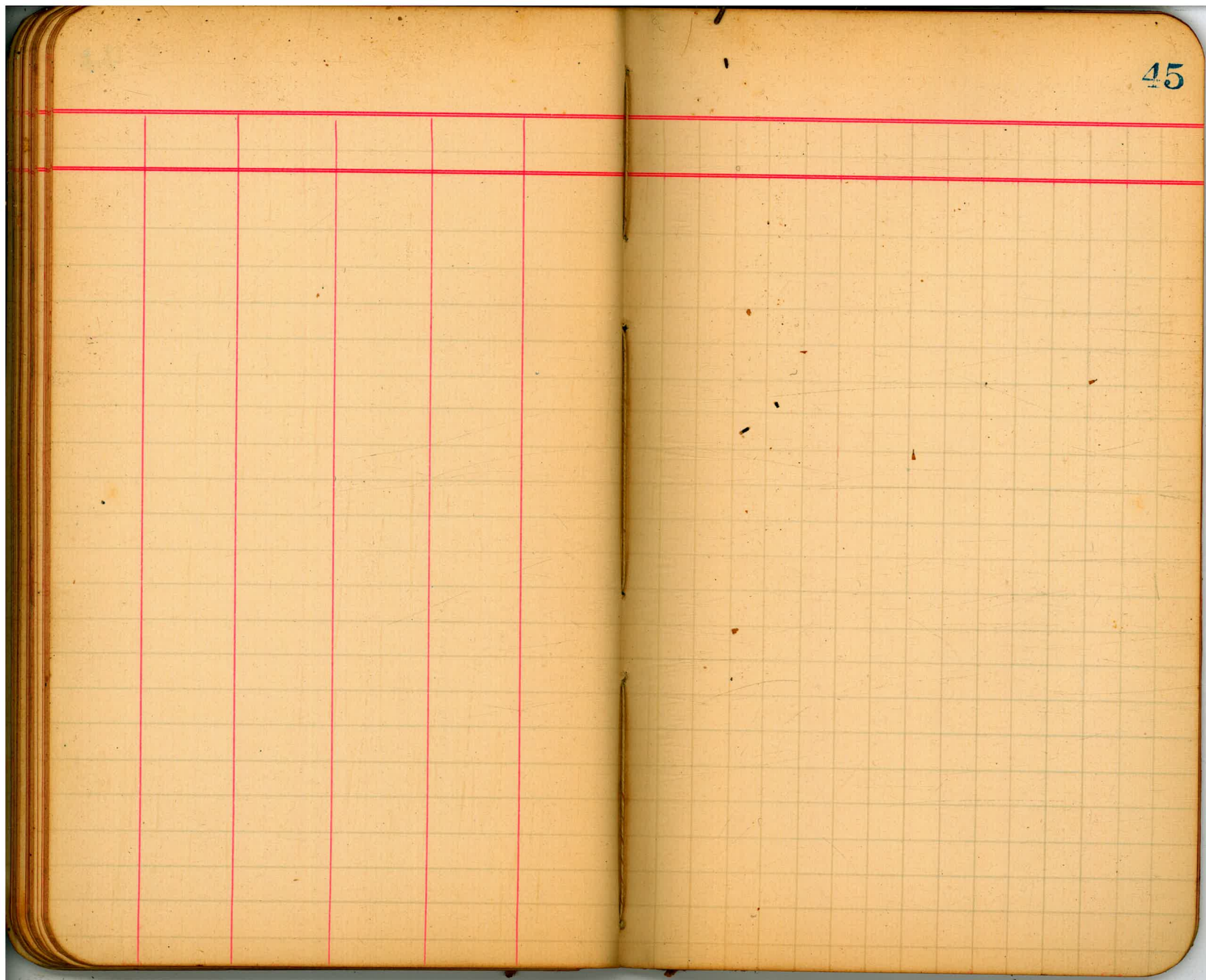

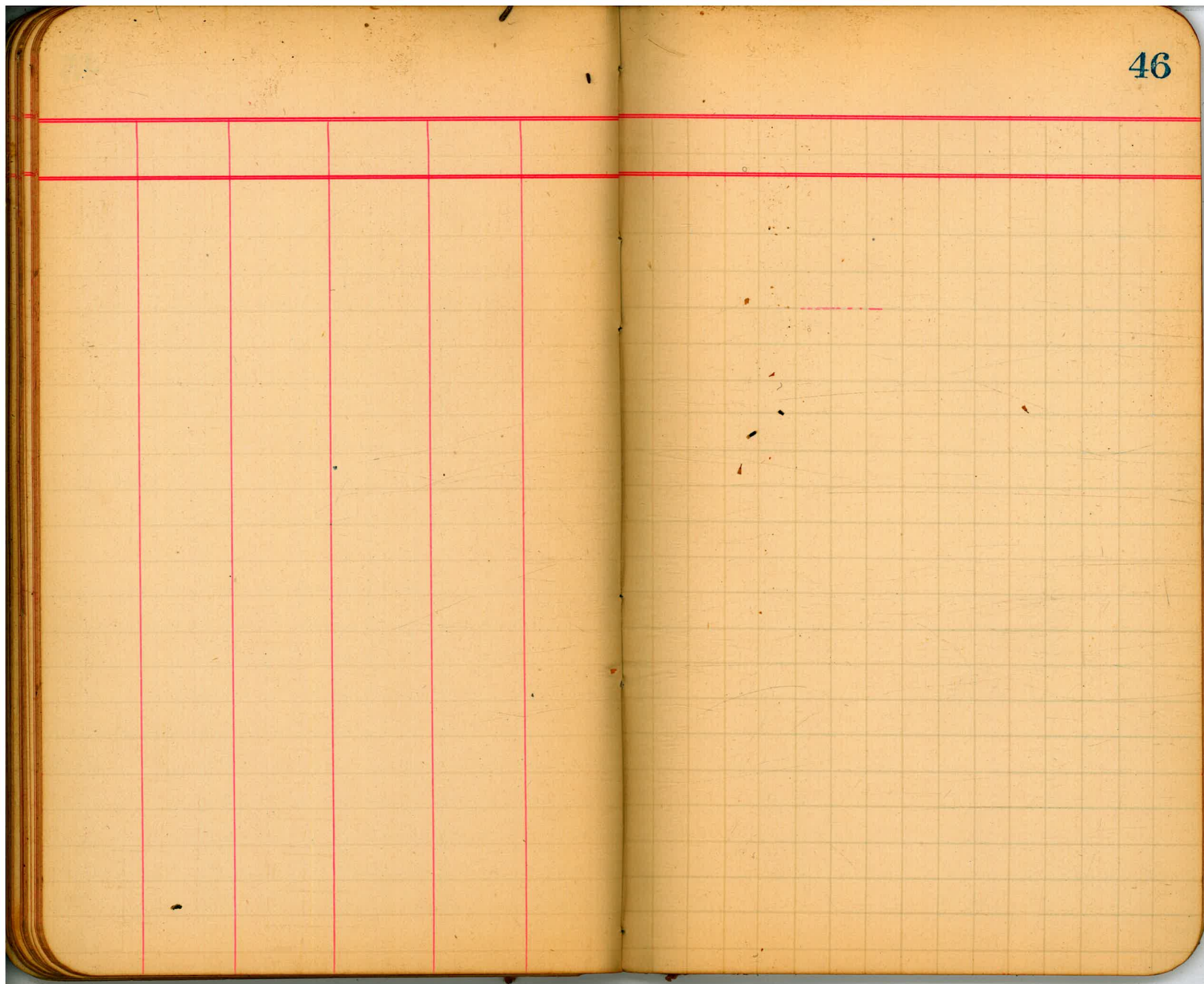

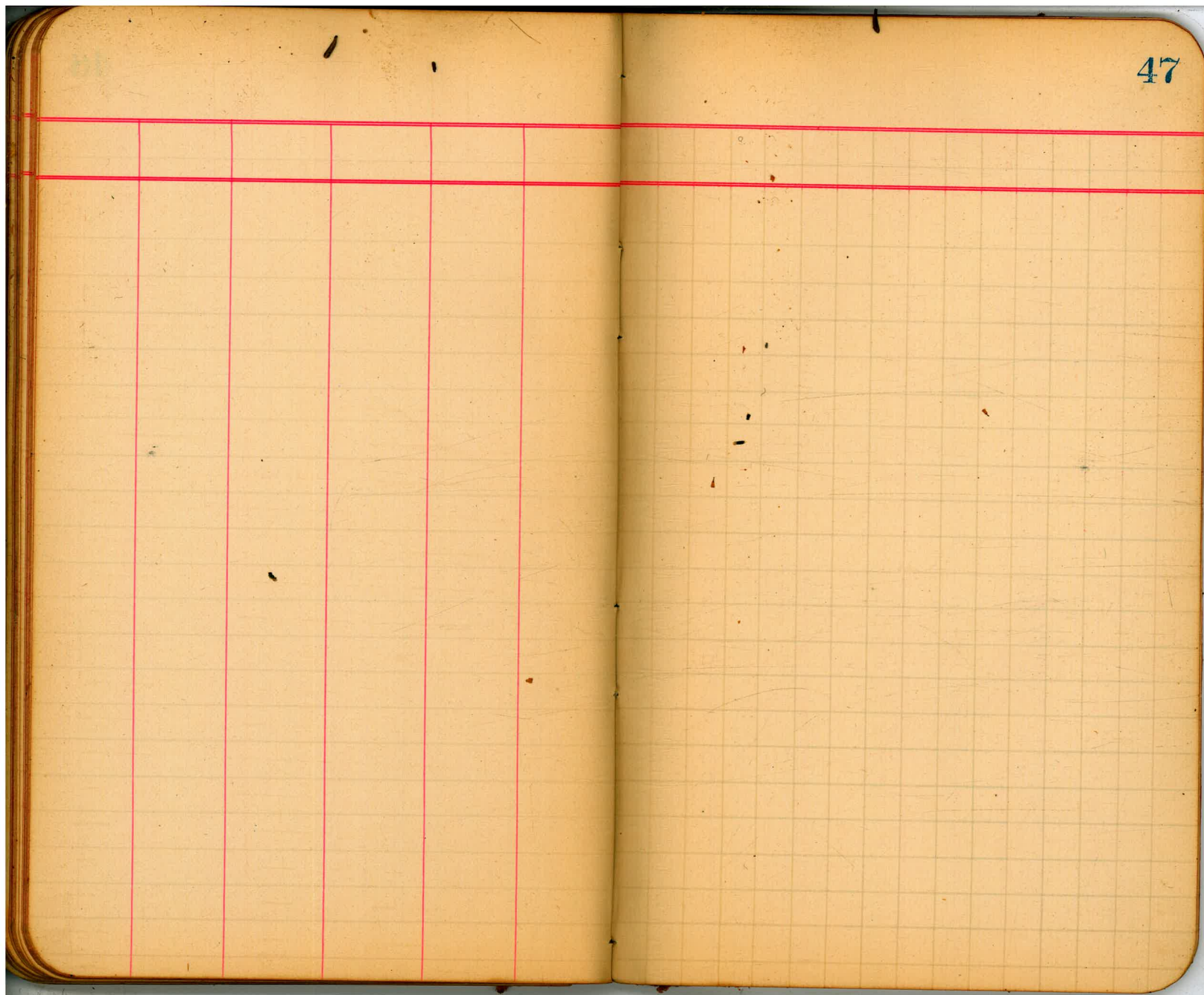

The image shows an open notebook with two pages. The pages are a light tan or cream color and feature a faint grid pattern. The left page is further divided into six vertical columns by red lines. The right page is a single, uncolumnar grid. The number '48' is printed in the top right corner of the right page. The notebook is placed on a light blue surface, and the right edge of the image shows a white, textured material, possibly a scanning bed or a piece of paper.

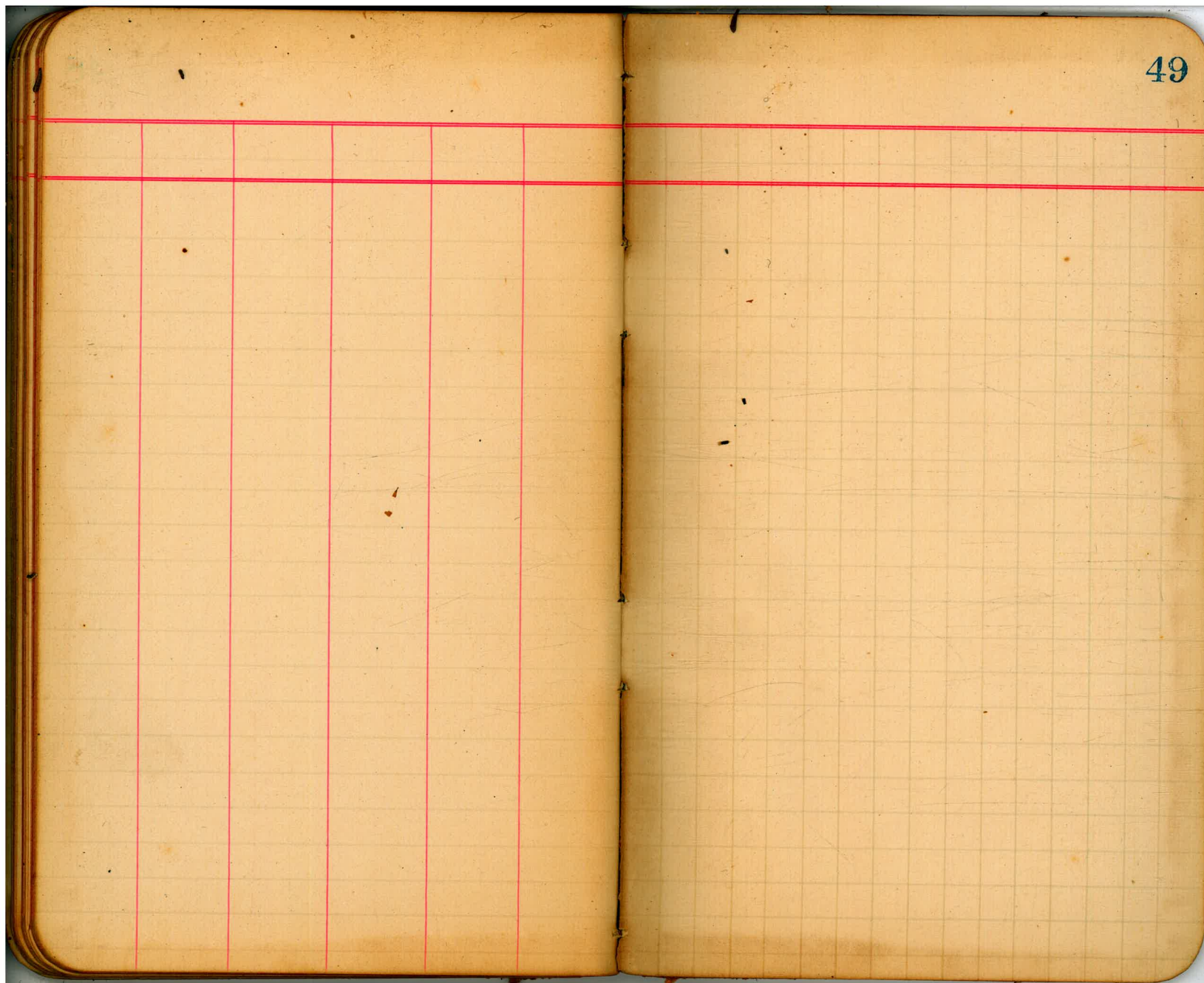

80 7 30
15 4

11 35

TRAVERSE TABLE FOR TRANSIT BOOK,
From 1° to 90° for a distance of 100.

Degrees.	DEGREES.		¼ DEGREE.		½ DEGREE.		¾ DEGREE.		Degrees.
	Lat.	Dep.	Lat.	Dep.	Lat.	Dep.	Lat.	Dep.	
0			100.00	0.44	100.00	0.87	99.99	1.31	85
1	99.98	1.75	99.98	2.18	99.97	2.62	99.95	3.05	84
2	99.94	3.49	99.92	3.93	99.91	4.36	99.88	4.80	83
3	99.86	5.23	99.84	5.67	99.81	6.10	99.79	6.54	82
4	99.76	6.98	99.73	7.41	99.69	7.85	99.66	8.28	81
5	99.62	8.72	99.58	9.15	99.54	9.58	99.50	10.02	80
6	99.45	10.45	99.41	10.89	99.36	11.32	99.31	11.75	79
7	99.25	12.19	99.20	12.62	99.14	13.05	99.09	13.49	78
8	99.03	13.92	98.97	14.35	98.90	14.78	98.84	15.21	77
9	98.77	15.64	98.70	16.07	98.63	16.50	98.56	16.93	76
10	98.48	17.36	98.40	17.79	98.33	18.22	98.25	18.65	75
11	98.16	19.08	98.08	19.51	97.99	19.94	97.90	20.36	74
12	97.81	20.79	97.72	21.22	97.63	21.64	97.53	22.07	73
13	97.44	22.40	97.34	22.92	97.24	23.34	97.13	23.77	72
14	97.03	24.19	96.92	24.62	96.81	25.04	96.70	25.46	71
15	96.59	25.88	96.48	26.30	96.36	26.72	96.25	27.14	70
16	96.13	27.56	96.00	27.98	95.88	28.40	95.76	28.82	69
17	95.63	29.24	95.50	29.65	95.37	30.07	95.24	30.49	68
18	95.11	30.90	94.97	31.32	94.83	31.73	94.69	32.14	67
19	94.55	32.56	94.41	32.97	94.26	33.38	94.12	33.79	66
20	93.97	34.20	93.82	34.61	93.67	35.02	93.51	35.43	65
21	93.36	35.81	93.20	36.24	93.04	36.65	92.88	37.06	64
22	92.72	37.46	92.55	37.86	92.39	38.27	92.22	38.67	63
23	92.05	39.07	91.88	39.47	91.71	39.87	91.53	40.27	62
24	91.35	40.67	91.18	41.07	91.00	41.47	90.81	41.87	61
25	90.63	42.26	90.45	42.66	90.26	43.05	90.07	43.44	60
26	89.88	43.84	89.69	44.23	89.49	44.62	89.30	45.01	59
27	89.10	45.40	88.90	45.79	88.70	46.17	88.50	46.56	58
28	88.29	46.95	88.09	47.33	87.88	47.72	87.67	48.10	57
29	87.46	48.48	87.25	48.86	87.04	49.24	86.82	49.62	56
30	86.60	50.00	86.38	50.38	86.16	50.75	85.94	51.13	55
31	85.72	51.50	85.49	51.88	85.26	52.25	85.04	52.62	54
32	84.80	52.99	84.57	53.36	84.34	53.73	84.10	54.10	53
33	83.87	54.46	83.63	54.83	83.39	55.19	83.15	55.56	52
34	82.90	55.92	82.66	56.28	82.41	56.64	82.16	57.00	51
35	81.92	57.36	81.66	57.71	81.41	58.07	81.16	58.42	50
36	80.90	58.78	80.64	59.13	80.39	59.48	80.13	59.83	49
37	79.86	60.18	79.60	60.53	79.34	60.88	79.07	61.22	48
38	78.80	61.57	78.53	61.91	78.26	62.25	77.99	62.59	47
39	77.71	62.93	77.44	63.27	77.16	63.61	76.88	63.94	46
40	76.60	64.28	76.32	64.61	76.04	64.94	75.76	65.28	45
41	75.47	65.61	75.18	65.93	74.90	66.26	74.61	66.59	44
42	74.31	66.91	74.02	67.24	73.73	67.56	73.43	67.88	43
43	73.14	68.20	72.84	68.52	72.54	68.84	72.24	69.15	42
44	71.93	69.47	71.63	69.78	71.33	70.09	71.02	70.40	41
45	70.71	70.71							
Degrees.	Dep.	Lat.	Dep.	Lat.	Dep.	Lat.	Dep.	Lat.	Degrees.
	DEGREES.		¼ DEGREE.		½ DEGREE.		¾ DEGREE.		

Published by Edward Denny & Co., Stationers, Drawing Materials,
Mathematical Instruments, Etc., San Francisco.