

*Main Sewer  
on  
Coronado Beach.*

2

LEVEL

F.B. 637

637

2337  
180  
2517  
547  
1970  
1955

1980  
540  
2585  
547  
222  
225  
113

2525  
222  
2800  
2525  
895  
890

Preliminary list for main  
sewers on Coronado Beach

Mar 20 1890

Humbert  
Caton  
Hewes & Co  
Williams

13

12

11

10

9

+62

+38 9° 42' Right

+33

8

7

6

5

4

3

+22

2

1

0

S 35° 45' W

S 25° 35' W

Blk 161 cor x 80' x  
of End & Blvd.

center of manhole on  
second St.

looks like ditch

28  
 27  
 +30  
 26  
 25  
 +35  
 24  
 23  
 +36  
 22  
 21  
 +74  
 20  
 19  
 18  
 17  
 16  
 15  
 +14+95  
 +39  
 14

3/20 25' W

55° 37' Left  
 32° 37' Right

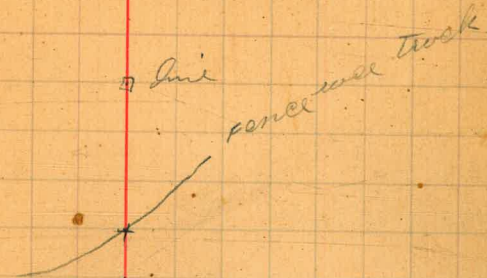

white of 48' 12.5' 0  
 & Boulder.

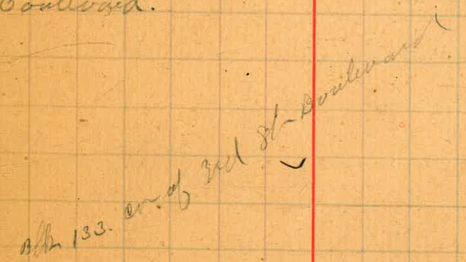

appears to be under stone  
 more some fence but

481  
45  
44  
43  
42  
41  
40  
39  
38  
37  
36  
35  
34  
33  
32  
31  
30  
29

95° 10' W

750 9° 16' left

pl 49 43' 74

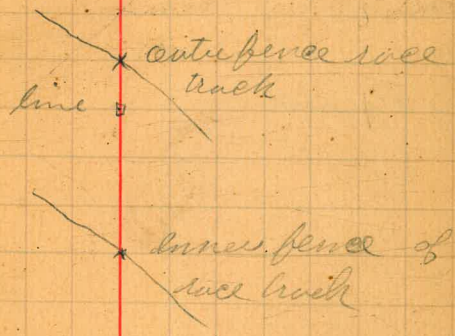

62

61

60

59

58

57

56

91.6.20/E

+60

720 11° 01' Left

55

54

53

52

51

50

49

40° 25' Left

48

47

+06

40° 0' Left

46

90° 15' E  
90° 50' E

\* cor-ble 25  
72.0  
9th & Boulevard

Width of walk on the line of trees on  
Boulvard - 16'

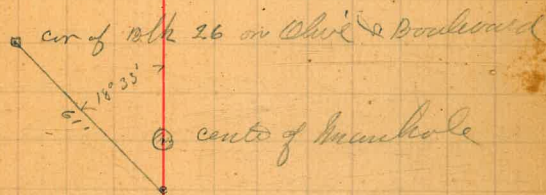

+07.4

70

69

68

67

+33 18° 00' Left

66

65

64

63

+67 10° 17' Left

+36

ply. center 29 on 10th St. Boulevard  
48'

Levels on Main Sewer in  
Coronado Beach

Dec 21 1891

Hambro  
William

Sta	+	H <sub>2</sub> O	-	Elev	D.M.
B.M.	4.92	24.92			20.00
			4.77	20.18	
70+07			9.14	15.78	
70			4.9	20.0	
69			5.5	19.4	
68			5.6	19.3	
67			5.8	19.1	
#	4.39	23.96	5.35	19.57	
66+33			4.6	19.4	
66			4.4	19.5	
65			3.8	20.1	
64			4.0	19.0	
63			4.6	19.3	
62+67			4.5	19.4	
B.M.			4.18	19.78	
62			4.6	19.4	
61			4.5	19.4	
#	3.89	23.845	4.005	19.955	
60			4.4	19.4	
59			4.5	19.3	
58			4.7	19.1	

N.E. cor of Olive & Boulevard on Pkg.  
rim of manhole  
Bottom of manhole

N.E. cor of 10th & Boulevard on pkg.



Levels on Main Sewer Casamento  
Beach

Sta	+	HD	-	Blw
		23.845		
57			4.7	19.1
56			5.0	18.8
55+20			4.90	18.7
B.M.	4.570	23.655	4.760	19.085
55			4.6	19.0
54			4.3	19.3
53			4.6	19.0
52			4.5	19.1
51			4.4	19.2
50			3.0	20.6
#	3.345	24.000	3.000	20.655
49			2.0	22.0
48			3.0	21.0
47			4.9	19.1
46+06			4.5	19.5
46			4.4	19.6
B.M.			4.13	19.87
45			3.8	20.2
44			3.5	20.5
#	2.96	23.94	3.02	20.98

off of Boulevard SE corner on Plug.

N.E. cor of 8th & Boulevard on Plug.

Levels on main line of Sewer  
on Colorado Beach.

Sta	+	H <sub>2</sub> O	-	Ells
		23.940		
43			4.3	19.6
42			4.8	19.1
41+50			4.8	19.1
41+10			4.4	19.5
41			2.4	21.5
#	3.065	24.930	2.075	21.865
40			3.7	21.2
B.M.			0.88	24.05
39			4.1	20.8
38			4.1	20.8
37			4.4	20.5
36			5.1	19.8
#	4.77	24.66	5.04	19.89
35			5.2	19.5
34			4.7	19.8
B.M.			3.75	20.91
33			4.7	20.0
32			4.9	19.8
31			4.3	20.4
#	5.23	25.94	3.95	20.71

Top of embankment along race course.

Spk. top of fence post north of 1/2 mile post  
on race track and near N line of  
7th St

Spk. in Park near 3/4 Stake on race  
track

Levels on Main Sewer on  
Coronado Beach

Sta	+	HO	-	Elev
		25.94		
30			4.6	21.3
29			4.5	21.4
28			5.3	20.6
27			5.6	20.3
26			4.6	21.3
B.M.			0.85	25.09
25			2.9	23.0
24+95			6.4	19.5
#	2.85	26.09	2.70	23.24
24			3.6	22.4
23			4.0	22.1
B.M.			3.91	22.18
22			4.4	21.7
21			5.3	20.8
20+74			6.5	20.6
20			5.8	20.3
19			6.1	20.0
18			6.2	19.9
#	4.325	24.595	5.82	20.270
17			4.5	20.1

sprk <sup>tot</sup> on Post inside fence of rose truck  
near row of trees along E of border.  
Inner edge of rose truck

4th Boulevard N.E. cor on Plg.

Sta	+	NO	-	Elev
		24.595		
16			4.1	20.5
15			3.6	21.0
14+59			3.3	21.3
B.M.			2.640	21.955
14			4.2	20.4
13			4.6	20.0
12			4.0	20.6
11			3.5	21.1
#	3.160	24.345	3.21	21.385
10			3.5	21.0
9			4.4	20.1
8+38			5.0	19.5
8+33			9.790	14.755
B.M.			4.155	20.390
8			5.3	19.2
7			6.0	18.5
6			5.7	18.8
#	5.94	25.00	5.485	19.060
5			4.5	20.5
4			4.7	20.3

3rd S Boulevard NE on pty.

Bottom of Manhole 2nd S. B'd.  
2nd S B'd S.E. on pty.

Stc	+	HO	-	Elv
3		25.01		
3			4.8	20.2
P.M.			4.19	20.81
2			5.7	19.3
1			6.5	18.5
0			6.5	18.5
#	2.28	20.29	6.99	18.01
			8.72	11.57

Boulevard & Palm Ave 162 SW corner  
on Plug.

Point on Beach

Elv at curb at outlet sewer

Tide observations at Sewer  
Temp

Mar 24 1881

Hamlin  
Detroit

Time		Below datum		
h 1				
8 30		-3.79		
8 35		-3.80		
8 40		-3.80		
8 45		-3.78		
8 50		-3.74		
9 0		-3.75		
Sta	+	170	-	610
B.M.	2.87	23.69		20.81
		6.83	16.85	= -3.78 City
		8.88	14.80	
			14.88	bottom
B.M.	4.35	24.74		20.39
#	<del>4.59</del>	9.32	15.42	
			14.70	bottom

83  
83  
88  
15.7  
14.7

B.M. Palm & Boulevard.  
Bottom.

Top of Sewer at 1st & B'd 8" pipe

2nd & B'd.  
Top of Sewer at 2nd & B'd 8" pipe

Levels on Alameda St for Main  
Sewer Casemate Bench

Mass 24 1891

19.12  
15.92  
3.70

Sta	+	40	-	Blw	Bm
B.M.	8.09	30.05			21.96
0			10.93	19.12	= 18.57 Bottom
+50			7.3	22.7	
			6.3	23.7	
1			5.7	24.3	
+50			4.7	25.3	
2			3.8	26.2	
+50			2.4	27.6	
3			1.4	28.6	
#	5.11	33.98	1.18	28.87	
+50			4.6	28.4	
4			3.9	29.1	
+50			3.8	29.2	
+75			3.8	29.2	
5+32			12.29	21.69	20.97 Bottom
5+55 - 0					South of 44 St
#	1.92	27.31	8.59	25.39	
			2.0	25.3	
#	6.60	28.39	5.53	21.79	
B.M.			5.28	25.10	

End of Benchmarked  
Top of Sewer Sid & Ad 6" pipe  
South line of Alameda St

19.12  
53  
18.37

21.68

21.68  
72  
20.97

67  
72

N line of 44 St  
Top of Sewer 4th Alameda 8" pipe  
outer fence race track South of 44 St

Ally 4 St - 1st B.M. Alameda

on Fence

Levels on Alameda Ave

Stk	+	HO	-	Elev	
		28.38			
0					
+50			2.1	26.3	
1			3.9	24.5	
+50			3.3	25.1	
2			4.0	24.4	
+50			3.8	24.6	
3			4.0	24.4	
+50			3.7	24.7	
4			3.4	25.0	
+50			2.8	25.6	
#	3.65	29.62	2.41	25.97	
5			3.5	26.1	
+40			3.7	25.9	
+80 = 0			3.4	26.2	
B.M.			3.35	26.27	
			5.7	23.9	
0+50			3.9	25.7	26+85
1			4.8	24.8	27+35
+50			5.2	24.4	27+85
2			5.8	23.8	28+35
+50			6.2	23.4	28+85

= South of 4th St

North line of 5th St

South of 5th St

Tack on Stake NE. cor. 6th & Alameda  
 Alley & 3th St bet. Alameda & B'd.



Levels on Alameda Ave

19 17  
03  
18.5

Sta	+	HO	-	Elev	Sta
		29.62			
3			6.6	23.0	29+35
+50			6.5	23.1	+85
#	4.88	28.88	6.12	23.60	
4			5.2	23.2	30+35
+50			5.1	23.3	+85
5			4.8	23.6	31+35
+40			4.8	23.6	31+75
+58			7.21	19.17	18.45 Bottom
B. 9m.			6.34	23.04	
+80 = 0			4.4	24.0	32+15
			6.7	21.7	+65
+50			4.5	23.9	+65
1			4.4	24.0	33+15
+50			4.7	23.7	+65
2			4.8	23.6	34+15
+50			5.2	23.2	+65
3			4.8	23.6	35+15
+50			4.6	23.8	+65
#	4.45	28.26	4.57	23.81	36+15
4			4.5	23.7	36+15

6.7  
72  
19.17  
18.45

N line of 6th St

Top of sewer 6th & Alameda

6th & Alameda N.W. Flycatcher (vertical)

South line of 6th St

6th & Alley bet Alameda & B'd.

Swell on Alameda Ave

Sta	+	hd	-	Clu	
		28.26			
450			4.8	23.4	36+45
5			4.5	23.7	37+45
+40			4.5	23.7	+45
+57			8.49	19.77	19.05 Bottom
B.M.			4.55	23.71	
			6.8	21.4	
B.M.			4.17	24.09	(24.00)
+80 = 0			4.3	23.7	37+55
0 + 50			4.4	23.8	38+45
1			4.8	23.4	+95
+50			4.7	23.5	39+45
2			4.3	23.9	+95
+50			4.0	24.2	40+45
3			3.8	24.4	+95
#	4.59	29.38	3.47	24.79	
+50			4.8	24.6	41+45
4			5.4	24.0	+95
+50			5.7	23.7	42+45
B.M.			3.26	26.12	(26.09)
5			4.1	25.3	+95

North of 7th St

Top of Sewer 7th & Alameda 8" dia  
 7th Alameda N. W. ply & track (Water)   
 Alley & 7th St bet Alameda & Bld  
 Rd & race track at 1/2 mile cur.  
 South line of 7th St

1/2 top of Post-race track near row of trees

Levels on Alameda St

Sta	+	110	-	Elev	
		29.38			
5707			6.1	23.3	43+02
#	2.76	26.47	5.67	23.71	
B.M. (23)			6.54	19.84 (19.87)	
5+83			5.88	20.59	19.87 Bottom
+47			3.8	22.7	43.42
5+87 = 0			3.4	23.1	43+82
0+50			2.6	23.9	44+32
1			1.6	24.9	+82
#	4.06	29.36	1.17	25.30	
+50			3.8	25.6	45+32
2			3.7	25.7	+82
+50			3.7	25.7	46+32
3			4.1	25.3	+82
+50			4.1	25.3	47+32
4			5.1	24.3	+82
+50			5.6	23.8	48+32
5			5.7	23.7	+82
+28			5.8	23.6	49+10
B.M.#	4.47	27.70	6.13	23.23	
5+55			7.55	20.15	19.43 Bottom

20.53  
 67  
 19.92  
 20.67  
 19.

North of 8th St  
 (21.6) Elev at alley & 8th St Sid & Al.  
 8th & Railroad  
 Top of Sewer 8th & Alameda 8"

South of 8th St

North of 9th St  
 9th & Alameda NW on Plg.  
 Top of Sewer 9th & Alameda 8" pipe

Levels on Alameda Ave

Sta	+	H <sub>2</sub> O	-	Blw	
		27.70			
5+68			4.60	23.1	
6+08=0			4.4	23.3	49+90
			5.9	21.8	
0+50			4.4	23.3	30+40
1			4.4	23.3	+90
+50			4.7	23.0	51+40
2			4.8	22.9	+90
+50			4.7	23.0	52+40
3			4.9	22.8	+90
+50			5.1	22.6	53+40
4			4.9	22.9	+90
#	4126	27.54	4.42	23.28	5
+50			4.6	22.9	54+40
5			4.3	23.2	+90
+50			4.3	23.2	55+40
+93			4.2	23.3	+93
6+9-7			9.16	18.38	<u>17.68</u> Bottom
+34			4.5	23.0	
6+85=0			4.6	22.9	56+75
B.M.			4.4A	23.13	<u>17.66</u> Bottom

South line of 9th St  
 Alley 9th St bet Boulevard & Alameda

181.54  
 67  
 19.71

North of 10th St  
 Top of sewer at 10th Alameda 8" pipe

South of 10th St  
 10th & Alameda 3 E, 1/2 g

Sewer on Alameda Ave

Sta	+	H.O	-	Elev	
		(27.54)			
			5.7	21.8	
0+50			4.7	22.8	57+25
1			4.5	23.0	+75
+50			4.3	23.2	58+25
2			4.2	23.3	+75
+50			4.2	23.3	59+25
#	4.38	28.11	3.81	23.73	
3			4.7	23.4	+75
+50			4.5	23.6	60+25
4			4.5	23.6	+75
+50			4.6	23.5	61+25
5			4.6	23.5	+75
+50			4.3	23.8	62+25
+67			4.4	23.7	+42
6+17			3.8	24.3	+92
+67			8.60	19.51	<u>18.79</u> Bottom
+73 = 0			4.3	23.8	63+48
B.M.			3.99	24.12	
B.M.			4.07	19.94	
0+50			4.0	24.1	63+98

Alley bet B'd & Alameda on 10th St

19.51  
67  
18.84

North line of Olive Ave

Top of Sewer at Olive St 8" pipe

South of Olive:

Olive & Alameda. S.E. on Plg.

Olive & B'd.

*Levels on Blamedu. Ave*

Sta	+	H <sub>9</sub>	-	Blv	
		28.11			
1			3.9	24.2	64+48
+50			3.7	24.4	+98
2		31	3.6	24.5	65+48
#	5.95	30.98	3.08	25.03	
+50			6.3	24.7	+98
3			6.1	24.9	66+48
+50			5.5	25.5	+98
4			5.1	25.9	67+48
+50			4.9	26.1	+98
5			4.7	26.3	68+48
+50			4.6	26.4	+98
6			4.5	26.5	69+48
+50			4.3	26.7	+98
7			4.5	26.5	70+48
+50			4.0	27.0	+98
8			4.1	26.9	71+48
+56			8.96	22.50	<u>21.78</u> Bald
#	3.80	31.46	3.32	27.66	
+50			4.4	27.1	+98
9			4.2	27.3	72+48

~~22.50  
21.8~~

*on top of Sewer.*

Sta	+	HD	-	Blw	
		31.46			
9+50			4.0	27.5	72+98
10			4.0	27.5	73+48
B.M.			4.31	27.15	+
+50			4.2	27.3	+98
11			4.0	27.5	74+48
+50			3.7	27.8	+98
12			3.8	27.7	75+48
+50			3.3	28.2	+98
13			3.4	28.1	76+48
+50			3.9	27.6	+98
+88			9.0	22.46	<u>21.55</u> Bottom

28.96  
~~27.93~~  
~~21.63~~

Dale to Ave all 20 m. ply.

Top of Sewer

~~21.46~~  
~~27.96~~  
~~27.50~~

22.46  
~~85~~  
~~21.60~~

21.60  
~~13~~  
~~8.6~~

Levels in Main Sewer on Coronado  
Beach from Sta 44+50 to Sta 58+10

Sta	+	HO	-	Elev.	
-----	---	----	---	-------	--

0.9m				26.09	
44+50					

1/2 top of post on Alameda & Rice track



Sta	Dist	Bearing	Angle
Sto	38+98		29° 18' Left
	35+19		
	22+50		
	21+63 ✓		
	21+07		
J to E	17+56.5 ✓		53° 41' Left
C to D	14+69 ✓		30° 31' Right
B to C	8+33 ✓		9° 51' R
A to B	893		

Seventh St Sewer,  
 Sixth St Sewer  
 top of Bank at inside R.C.  
 Sewer on 4th St  
 north line of 4th St

Point in Paulson's where  
 line turns into alley

corner at end of

4' south of manhole  
 on end of

7865

78+75  
~~77~~  
78+65  
74+90  
74+68  
74+73

317  
317  
317

80° 52' Right

71+11  
71+30

344  
344

12° 10' Right

65+03  
45+24

360  
331

21° 41' Left

58+10  
58+35

331  
317

21° 34' Left

57+43  
51+64

317  
317

10° 40' Left

45+31  
45+57

366  
366

10° 35' Right

End of line  
Sewer ditch

Sewer at Olive St

Sewer on 10th St  
Manhole 50' below main

Sewer on 9th St

Sewer on 8th St

Tie points Main Sewer on  
Carmichael Beach.

	72 35 75	75
Tie points for sewer to cor of Blk 20, A. at Boulevard & Alameda to Sta 78+65 = 54.5 from cor; to Sta 78+80 39.2 " "		
Sta 74+68 <sup>dist</sup> 1. to cor of Blk 20 cor of Tolita & Alameda is 61.1 ✓ dist to cor of Blk 21 cor of Tolita & Alameda is 36.1		
Sta 71+11 dist to cor of Blk 23 cor of Alameda & I is 76.8 dist to cor of Blk 20 B cor of Alameda & I Ave is 52.2		
Sta 65+03 dist to cor of Blk 23 cor of Alameda & Alameda is 81.7 ✓ dist to cor of Blk 25 cor of Alameda & Alameda is 59.0 depth of manhole 5.45		

	+ HO	-	Elev
Sta 58+10 ✓ dist to cor of Blk 30 cor of 10th & Alameda is 74.2 dist to cor of Blk <sup>Fractured</sup> <sub>manhole</sub> cor of 10th & Alameda is 147.7 D.M. cor 10th & Alameda 4.54 27.67 23.13 Top of man hole 10th & Alameda 4.30 23.37 Depth of manhole 5.6 17.77			
Sta 58+35	3.90		23.77
Sta 51+43 dist to cor of Blk 57 cor of 9th & Alameda 51.2 dist to cor of Blk 58 cor of 9th & Alameda 67.8 D.M. 9th & Al. 4.65 27.86 23.23 Top of man hole 4.27 23.51 Depth of manhole 4.05 19.46			
Sta 51+65	4.33		23.55

45+31 ✓  
Sta 45+50

Dist to cor of Blk 57 cor  
of 8th & Alameda 90.0

Dist to cor of Blk 58 cor  
of 8th & Alameda 84.1

Sta 14+69

Dist to cor of Blk 134 cor  
of 3rd & Alameda 74.5

Dist to cor of Blk 133 cor  
of Alameda & Boulevard 76.5

Sta 8+33

Dist to cor of Blk 161 cor of  
2nd & Boulevard 70.0

Dist to cor of Blk 162 cor of  
2nd & Boulevard 115.2

Sta + HD - Elev

17	2.72	28.80		26.08
			5.96	22.84
			5.82	22.98
B.M.			8.93	19.87
#	3.44	29.27	2.97	25.83
B.M.			6.10	23.17

17  
20  
+25  
+50  
+75  
31  
+25  
+50  
+75  
32

8A & Alameda  
9A & Alameda

+25

+50

+75

33

+25

+50

+75

34

+25

+50

+75

35

+25

+50

+75

36

+25

+50

+75

37

Levels from Sta 44+50 to 38+10  
 Coronado Beach Main Sewer

Apr 24

Hamlin level  
 Hensley rod.

Sta	+	HO	-	Elv
13.9m	3.59	29.68		26.09
44+50			6.93	22.75
+75			5.59	24.09
45			5.37	24.31
+25	7.20	30.03	6.85	22.83
+31			7.06	22.97
+50			7.16	22.87
+75			6.97	23.06
46			6.85	23.18
+25			6.34	23.69
+50			6.01	24.02
+75			5.53	24.50
47			4.95	25.08
+25			4.60	25.43
+50			4.44	25.59
+75			4.38	25.65
48			4.22	25.81
+25			3.42	26.61
+50			4.18	25.85
+75			4.41	25.62
49			4.63	25.40

Alameda race track

Sta 81

Sta	+	HO	-	Elv
49+25		30.03	4.90	25.13
+50#	3.03	27.74	5.32	24.71
+75			3.35	24.39
50			3.56	24.18
+25			3.83	23.91
+50			4.08	23.66
+75			4.04	23.70
51			4.11	23.63
+25			4.34	23.40
+43			4.34	23.40
B.M.			4.58	<u>23.16</u> <u>23.23</u>
+50			4.47	23.27
+75			4.52	23.22
52			4.36	23.38
+25			4.49	23.25
+50			4.48	23.26
+75			4.41	23.33
53			4.58	23.16
+25#	3.79	27.13	4.40	23.34
+50			3.97	23.16
+75			4.10	23.03

9th St

9th & Hamedia



Sta	+	HO	-	Elev	
54		27.13	4.23	22.90	
+25			4.22	22.91	
+50			4.24	22.89	
+75			4.53	22.58	
55			4.38	22.75	
+25			4.57	22.56	
+50			4.58	22.55	
+75			4.41	22.72	
56			4.21	22.92	
+25			4.22	22.91	
+50			4.18	22.95	
+75			4.10	23.03	
57#	4.07	27.41	4.09	23.04	
+25			4.38	23.03	
+50			4.32	23.09	
+75			4.13	23.28	
58			4.15	23.26	
+10			3.73	23.68	
B.g.m.			4.34	23.07	23.13
#	3.55	25.53	5.43	21.99	
B.g.m.			5.76	19.77	19.78

10th St  
10th St

10th St

Levels from Sta 58+10 to Sta 78+75  
 Coronado Main Sewer

Nov. 28 1880

Hamber level  
 William Wad.

Sta	+	HD	-	Elev	109m
0.92	4.92	27.99			23.07
58+10			4.31	23.68	
+25			5.21	22.78	
+50			5.14	22.85	
+75			5.17	22.82	
59			5.20	22.79	
+25			5.09	22.90	
+50			5.10	22.89	
+75			4.93	23.06	
60			5.04	22.95	
+25			4.91	23.08	
+50			4.80	23.19	
+75			4.65	23.34	
61			4.67	23.32	
+25			4.69	23.30	
+50			4.78	23.21	
+75			4.61	23.38	
62			4.60	23.39	
+25			4.56	23.43	
+50			4.50	23.49	
+75#			4.49	23.50	

10th & Placida  
 Marshall on 10th St.

Sta	+	HO	-	Elev
63		27.99	4.43	23.56
+25 #	5.07	28.45	4.61	23.38
+50			4.92	23.53
+75			4.83	23.62
64			4.77	23.68
+25			4.75	23.70
+50			4.86	23.59
+75			4.87	23.58
65+103	near	Tether		
+103			4.09	24.36
+25			4.52	23.63
B.M.			4.89	<u>24.06</u> 24.06
+50	out.			
+75			4.52	23.93
66			4.45	24.00
+25			4.36	24.09
+50			4.44	24.01
+75			4.35	24.10
67			4.42	24.03
+25			4.33	24.12
+50			4.34	24.11

man hole at elev

elev x Alameda

Sta	+	H <sub>0</sub>	-	Elev.
67+75		28.45	4.17	24.28
68			4.11	24.34
+25#	6.46	30.83	4.08	24.37
+50			6.18	24.65
+75			5.76	25.07
69			5.62	26.21
+25			5.56	25.27
+50			5.18	25.65
+75			4.94	25.89
70			4.82	26.01
+25			4.88	25.98
+50	not in			
+75			4.71	26.12
71			4.65	26.18
+11			4.46	26.37
+25			4.47	26.36
+50			4.73	26.10
+75			4.86	25.97
72			4.98	25.85
+25			5.35	25.49
+50			5.38	25.45

man hole

Sta	+	H.O	-	Elev
72+75		30183	5.24	25.59
73			5.13	25.70
+25			4.71	26.12
+50#	5.72	32.13	4.42	26.41
+75			5.28	26.85
74			4.99	27.14
+25			5.34	26.79
+50			5.44	26.69
+68			5.08	27.05
+75			5.14	26.99
75			5.21	26.92
+25			5.24	26.89
+50			5.26	26.87
Bgn.			5.05	<u>27.08</u> 27.15
+75			5.49	26.64
76			5.69	26.44
+25			5.94	26.19
+50			5.82	26.31
+75			5.40	26.73
77			5.66	26.47
+25			5.32	26.81

Falata Ave

Sta	+	HO	-	Elv.
77+50		32.13	4.81	27.32
+75			4.38	27.75
78			4.31	27.82
+25			4.47	27.66
+50			5.06	27.07
+75			4.99	27.14
B.M.	4.67	31.75		27.08
78+75			4.59	27.16
			9.81	21.94
				89
				21.00

\*

Start plug

Foot of Pipe

83  
86  
89

21.05  
18.86  
2.19

853  
8  
51

21.00  
21.74  
91  
21.03

Grade for bottom of seal tanks  
at coronado hotel.

9.00  
9.20  
4.80

9.00  
4.0  
9.5

Sta	+	H.D.	Grade	Rod	-	Elev
	4.20	24.20				20.00
			20.00			
			15.20	9.00	✓	
			15.80	8.90	✓	
			15.35	8.85	✓	
			15.90	8.70	✓	
			15.40	8.80	✓	
			15.30	8.90	✓	

assumed elev 24.20 top of walk  
top of wall  
at outlet  
South end.  
SW circle  
NW circle  
North end  
NE circle

9.20  
9.5

9.20  
9.2  
9.82

afterward lowered to points 2'

			10.6 Elev 13.6	13.6 rod
0		14.60		
1	Rods	8.90	15.80	13.71
2	"	8.90	15.30	13.82
3	"	8.96	15.24	13.93
4	"	8.39	15.81	14.04
5	"	6.85	17.35	14.15
6	"	5.15	19.05	14.27
7	"	4.74	19.46	14.38
8	"	4.47	19.73	14.50
9				14.6

bottom of outlet  
bottom of outlet pipe

Grade for outlet pipe  
Stds 1, 2, etc all  
same length of pipe  
in feet - 148.5

Grade for Seal Tank at the  
Coronado Hotel

Apr. 29 1891 Hamlin  
Williams

Sta	+	HO	-	Elev	Grade	Rod
B.M.	4.20	24.20		20.00		
					19.80	
					15.00	9.20
					15.10	9.10
					15.20	9.00
					15.30	8.90
					15.20	9.00
					15.10	9.10

2 1/2 in wall (assumed elevation)  
Top of wall  
Bottom of tank at outlet

Grades for outlet pipe

0					15.6	
+16.5			8.90	15.30	13.71	+1.59
+33.0			8.90	15.30	13.82	+1.48
+49.5			8.96	15.24	13.93	+1.31
+66.0			8.39	15.81	14.04	+1.77
+82.5			6.85	17.35	14.15	+3.20
+99.0			5.15	19.05	14.27	+4.78
+115.5			4.74	19.46	14.38	+5.08
+132			4.47	19.73	14.50	+5.23
+148.5					14.60	

End of pipe.

outlet of tank 0.4 below bottom



Sta	+	HD	-	Elev	Grade	Prd.
-----	---	----	---	------	-------	------

09m	5.22	28.29				
-----	------	-------	--	--	--	--

				23.07		
--	--	--	--	-------	--	--

				25.31	2.98	
--	--	--	--	-------	------	--

				25.28	3.01	
--	--	--	--	-------	------	--

				25.26	3.03	
--	--	--	--	-------	------	--

				25.24	3.05	
--	--	--	--	-------	------	--

Elev's for 10th St sewer raised  
to conform to new Main

Sta	+	H <sub>2</sub>	-	Elev
-----	---	----------------	---	------

B.M.

23.07

0

+25

+50

+75

1

+25

+50

+75

2

+25

+50

+75

3

May 5 1897 Hamlin level +  
Ceter Rod.

10th & Main

Elevs are on top of Board levelled  
across ditch.

Levels on top of sewer in 10th St

19.60

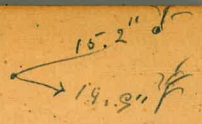

Sta	T	H <sub>2</sub> O	-	Elv.	
B.M.	5.16	28.23		23.07	
3400			8.89	19.34	top of pipe
				$\frac{72}{18.62}$	bottom of pipe
#	5.04	28.84	4.43	23.80	
6+0			8.66	20.18	top of pipe
				$\frac{72}{19.46}$	bottom of pipe
#	4.80	30.44	5.20	25.64	
8+20			9.57	20.85	
				$\frac{72}{20.13}$	bottom of pipe
9+25			9.23	21.21	
				$\frac{72}{20.49}$	bottom of pipe
B.M.			4.53	25.91	
#	3.57	28.81	5.20	25.24	
B.M.			4.75	24.00	

10th & Slaveda  
from Manhole

on 10th cor 10th

600' from Manhole

820' from Manhole  
at 8+20

$$1 \text{ in } 600 \text{ for } 820' = \frac{1.37}{18.83} \\ 20.22$$

$$1 \text{ in } 600 \text{ for } 925' = \frac{1.54}{18.83} \\ 20.39$$

align 10th NE on - on Pkg.

align & Slaveda

Levels for Sewer on 10th St  
 related to empty into New Man

July 5-1891

Hamlin level  
 Clinton Rod

3/8 day full party on line

Sta	+	H.O.	-	Blw	B.M.
B.M.	5112	28.19			23.07
0			4.99		23.70
+25			5.11		23.08
+50			5.05		23.14
+75			5.00		23.19
1			5.02		23.17
+25			4.84		23.35
+50			4.94		23.25
+75			4.75		23.44
2			4.72		23.47
+25			4.63		23.56
+50			4.70		23.49
+75			4.56		23.63
3			4.50		23.69
+25			4.47		23.72
+50			4.68		23.51
B.M.			4.39	23.80	23.80
+75			4.50		23.69
4			4.45		23.74
+25			4.54		23.65
+50			4.47		23.72

10th & Alameda  
 manhole on 10th & Alameda

Sta	+	HD	-	Elev	B.M.
4+75		28.19	4.59	23.60	
5 #	5.71	29.47	4.43	23.76	
+25			5.60	23.87	
+50			5.51	23.96	
+75			5.36	24.11	
6			5.12	24.35	
+25			5.12	24.35	
+50			4.74	24.73	
+75			4.73	24.74	
7			4.61	24.86	
+25			4.60	24.87	
+50			4.51	24.96	
+75			4.30	25.17	
8			4.29	25.18	
B.M.			3.55	<u>26.92</u>	<u>26.91</u>

Paul Reutter	began Monday
Ch. Nagle	11
Walden	Monday 2' o'clock

222 Price book

$\frac{175}{45.00}$

$\frac{158}{10}$   
 $\frac{178}{86}$   
 $\frac{86}{92}$

$\frac{308}{272}$   
 $\frac{86}{86}$

~~$\frac{178}{86}$~~

$\frac{148}{86}$   
 $\frac{86}{92}$

$\frac{168}{10}$   
 $\frac{178}{86}$   
 $\frac{86}{92}$

4.5  
2  
3.5

25

29° 18' Left      S 17° 0' E

12.55  
11.57  
1.98

18  
16  
34

17  
12 20  
29 20

Low 10th St Manhole 85' E of West line

11  
19.95  
2.13

39.50  
27  
38 23

39.50  
27  
39 23

112

39.98  
39.23  
75

45.56  
23  
45.31

39.00  
27  
34.73

38.94  
38.73  
25

14.7 at 2nd  
18.5 at 2nd  
Extreme H.W. = 18.78  
Ordinary H.W. = 16.78  
" L.W. = 15.13  
Extreme L.W. = 10.18

11.5  
11.2  
0.8

Extreme H.W. = 18.78  
Ordinary H.W. = 16.78  
Ordinary L.W. = 12.85  
Extreme L.W. = 10.18 41

308  
222  
86

75  
36.5  
18.5  
2/112  
57  
95

41  
17  
35  
33  
50

112  
188  
86  
92  
82  
164



$$\begin{array}{r} 30 \\ 19 \\ \hline 17 \end{array}$$

$$\begin{array}{r} 30 \\ 19 \\ \hline 17 \end{array}$$

$$\begin{array}{r} 30 \\ 19 \\ \hline 17 \end{array}$$

$$\begin{array}{r} 5168 \\ 437 \\ \hline 57 \end{array}$$

$$\begin{array}{r} 475 \\ 37 \\ \hline 53 \end{array}$$

$$\begin{array}{r} 2311 \\ 15 \\ \hline 21.620 \end{array}$$

$$\begin{array}{r} 20.65 \\ 8.85 \\ \hline 11.78 \end{array}$$

$$\begin{array}{r} 26.5 \\ 32 \\ \hline 23.3 \end{array}$$

$$\begin{array}{r} 16.85 \\ 3.75 \\ \hline 20.60 \end{array}$$

$$\begin{array}{r} 300 \\ 42 \\ \hline 258 \end{array}$$

$$\begin{array}{r} 35 \\ 25 \\ \hline 60 \end{array}$$

$$\begin{array}{r} 60 \\ 15 \\ \hline 75 \end{array}$$

$$\begin{array}{r} 91.1 \\ 20 \\ \hline 511.1 \\ 22. \end{array}$$

$$\begin{array}{r} 16.85 \\ 3.75 \\ \hline 20.60 \end{array}$$

$$\begin{array}{r} 475 \\ 30 \\ \hline 5.25 \end{array}$$

$$\begin{array}{r} 537 \\ 26 \\ \hline 563 \end{array}$$

$$\begin{array}{r} 14 + 69 \\ 27 \\ \hline 21 \end{array}$$

$$\begin{array}{r} 16.85 \\ 3.75 \\ \hline 20.60 \end{array}$$

$$\begin{array}{r} 20.63 \\ 3.85 \\ \hline 16.78 \end{array}$$

City datum = 20.63 assumed datum  
 16.78 ordinary H.W.  
 11.78 of L.W.

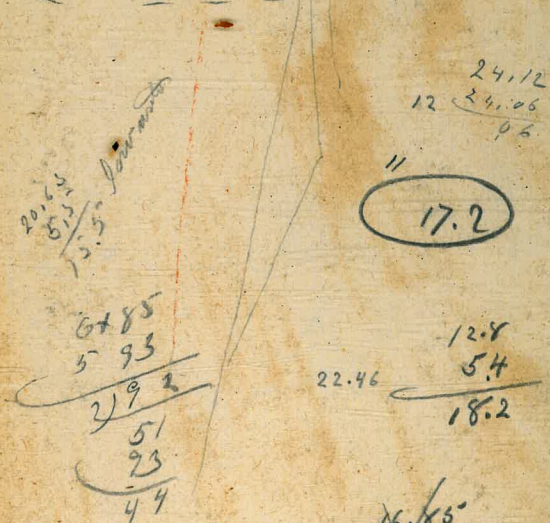

$$\begin{array}{r} 16.85 \\ 3.75 \\ \hline 20.60 \end{array}$$

$$\begin{array}{r} 16.85 \\ 3.75 \\ \hline 13.1 \end{array}$$

$$\begin{array}{r} 20.60 \\ 8.8 \\ \hline 11.8 \\ 5.9 \\ \hline 17.2 \end{array}$$