

No. 2.

Sewer Y Branches

Location of Y Branches

From 18th Street north of 12

to 11th Street East from 2nd

736

LEVEL BOOK

13

F.B. 736

736

MICROFILMED
DEC 15 1964

Table showing the difference of latitude and departure in running 80 chains at any course from 1 to 60 minutes.

| Minutes. | Lks. | Minutes. | Lks. | Minutes. | Lks. |
|----------|------|----------|------|----------|------|
| 1..... | 2½ | 21..... | 49 | 41..... | 95½ |
| 2..... | 4½ | 22..... | 51½ | 42..... | 98 |
| 3..... | 7 | 23..... | 53½ | 43..... | 100½ |
| 4..... | 9½ | 24..... | 56 | 44..... | 102½ |
| 5..... | 11½ | 25..... | 58½ | 45..... | 105 |
| 6..... | 14 | 26..... | 60½ | 46..... | 107½ |
| 7..... | 16½ | 27..... | 63 | 47..... | 109½ |
| 8..... | 18½ | 28..... | 65½ | 48..... | 113 |
| 9..... | 21 | 29..... | 67½ | 49..... | 114½ |
| 10..... | 23½ | 30..... | 70 | 50..... | 116½ |
| 11..... | 25½ | 31..... | 72½ | 51..... | 119 |
| 12..... | 28 | 32..... | 74½ | 52..... | 121½ |
| 13..... | 30½ | 33..... | 77 | 53..... | 123½ |
| 14..... | 32½ | 34..... | 79½ | 54..... | 126 |
| 15..... | 35 | 35..... | 81½ | 55..... | 128½ |
| 16..... | 37½ | 36..... | 84 | 56..... | 130½ |
| 17..... | 39½ | 37..... | 86½ | 57..... | 133 |
| 18..... | 42 | 38..... | 88½ | 58..... | 135½ |
| 19..... | 44½ | 39..... | 91 | 59..... | 137½ |
| 20..... | 46½ | 40..... | 93½ | 60..... | 140 |

PUBLISHED BY
EDWARD DENNY & CO.
DRAWING PAPER & MATERIAL, MATHEMATICAL INSTRUMENTS, ETC.
STATIONERS AND PRINTERS,
SAN FRANCISCO, CAL.

Table for Running on Slopes.
In the following table the first column shows the angle, the second, the number of links to be added to a chain on the slopes, to make one chain, horizontal measurement.

| Angle. | Cor. in links | Angle. | Cor. in links. | Angle. | Cor. in links. | Angle. | Cor. in links. |
|--------|---------------|--------|----------------|--------|----------------|--------|----------------|
| ° | | ° | | ° | | ° | |
| 4 | 0-24 | 11 | 1-88 | 18 | 5-14 | 25 | 10-54 |
| 5 | 0-33 | 12 | 2-24 | 19 | 5-76 | 26 | 11-26 |
| 6 | 0-55 | 13 | 2-63 | 20 | 6-42 | 27 | 12-21 |
| 7 | 0-76 | 14 | 3-06 | 21 | 7-11 | 28 | 13-37 |
| 8 | 0-98 | 15 | 3-53 | 22 | 7-85 | 29 | 14-34 |
| 9 | 1-24 | 16 | 4-02 | 23 | 8-64 | 30 | 15-47 |
| 10 | 1-55 | 17 | 4-56 | 24 | 9-47 | 35 | 22-07 |

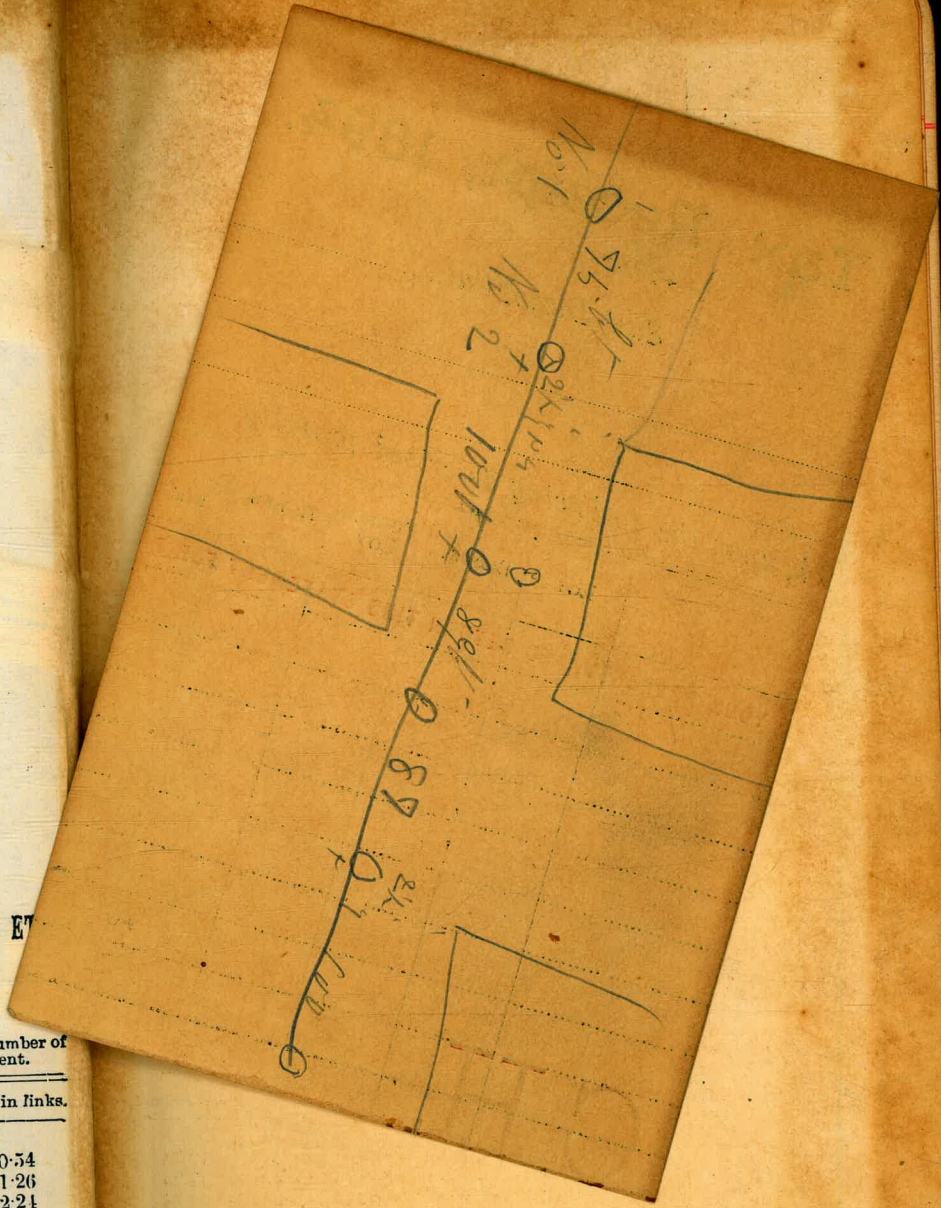

18th Street north of 12

W E

| | |
|-------------------|-------------------|
| 0x46 | 0x48 |
| 71 | 73 |
| 95 ⁵ | 97 ⁵ |
| 1x20 | 1x22 |
| 46 | 48 |
| 70 | 72 |
| 94 ⁵ | 96 ⁵ |
| 2x21 | 2x23 |
| 45 | 47 |
| 71 | 73 |
| 95 ⁵ | 97 ⁵ |
| 3x21 | 3x23 |
| 3x48 | Inspector's line |
| of M Street | |
| 4x25 ⁵ | 4x27 ⁵ |
| 51 | 53 |
| 75 ⁵ | 77 ⁵ |
| 5x00 ⁵ | 5x02 ⁵ |
| 26 | 28 |
| 50 ⁵ | 52 ⁵ |
| 75 | 77 |
| 6x00 | 6x02 |
| 25 ⁵ | 27 ⁵ |
| 51 | 53 |
| 76 | 78 |
| 7x00 | 7x02 |

W E

| | |
|--------------------|--------------------|
| 7x28 | Inspection |
| South line of | |
| L Street | |
| 7x46 | 6 ² 1/2 |
| East for L | |
| 8x05 | 8x07 |
| 31 | 33 |
| 55 ⁵ | 57 ⁵ |
| 80 | 82 |
| 9x06 | 9x08 |
| 30 | 32 |
| 54 | 56 |
| 81 | 83 |
| 10x05 | 10x07 |
| 31 | 33 |
| 55 | 57 |
| 81 | 83 |
| 11x08 | Inspection |
| South line of | |
| K Street | |
| 11x25 ⁵ | 6 ² 1/2 |
| East for K St | |
| 11x86 | 11x88 |
| 12x10 ⁵ | 12x12 ⁵ |
| 36 | 38 |
| 60 | 62 |

18th Street

W E

| | |
|-----------------|-----------------|
| 12x86 | 12x88 |
| 13x10 | 13x12 |
| 36 | 38 |
| 60 ⁵ | 62 ⁵ |
| 86 | 88 |
| 14x11 | 14x13 |
| 35 | 37 |
| 61 | 63 |
| 14x88 | end of |
| Pipe so line | |
| of H Street | |
| Flushlock | |
| South of | |
| H Street | |
| East West | |
| 0x86 | 0x88 |
| 1x11 | 1x13 |
| 33 | 35 |
| 61 ⁵ | 63 ⁵ |
| 85 ⁵ | 87 ⁵ |
| 2x11 | 2x13 |
| 37 | 39 |
| 61 | 63 |
| 86 | 88 |

W

E

| | |
|-------------------|-----------------|
| 3x11 | 5x13 |
| 37 | 39 |
| 61 | 63 |
| 3x86 | Inspection No |
| line of J Street | |
| 4x66 | 4x68 |
| 91 | 93 |
| 5x16 | 5x18 |
| 41 | 43 |
| 66 | 68 |
| 90 | 92 |
| 6x16 | 6x18 |
| 40 | 42 |
| 66 | 68 |
| 90 ⁵ | 92 ⁵ |
| 7x15 | 7x17 |
| 41 | 43 |
| 7x67 | end of |
| Pipe in Flushlock | |

18th Street

North of H

| W | E | W | E |
|-----------------|-------------------|--------------------|--------------------|
| 0x92 | 0x94 | 7x29 | 7x31 |
| 1x24 | 1x26 | 55 ^s | 55 ^s |
| 48 ^s | 50 ^s | 7x79 | Inspector |
| 74 ^s | 76 ^s | F Street | |
| 99 | 2x01 | 7x98 | 6 in Y |
| 2x23 | x25 | East for F Str | |
| 49 | 51 | 8x00 | 6 in Y |
| 73 | 75 | West for F Str | |
| 99 | 3x01 | 8x58 | 8x60 |
| 3x23 | 25 | 83 | 85 |
| 49 | 51 | 9x07 | 9x09 |
| 73 | 75 | 81 ^s | 83 ^s |
| 4x00 | Inspector | 58 | 60 |
| G Street | | 83 | 85 |
| 4x17 | 6 in Y East for G | 10x07 ^s | 10x09 ^s |
| 4x79 | 4x81 | 82 ^s | 84 ^s |
| 5x04 | 5x06 | 57 | 59 |
| 29 | 31 | 83 | 85 |
| 54 | 56 | 11x08 | 11x10 |
| 78 | 80 | 38 | 35 |
| 6x04 | 6x06 | 12x40 | Prop |
| 28 ^s | 30 ^s | Line No Line | |
| 54 | 56 | of E Street | |
| 78 | 80 | 12x37 | 12x39 |
| 7x04 | 7x06 | 62 | 64 |

18th Street

North of H

North of C

| W | E | W | E |
|-------------------|--------|-----------------|-----------------|
| 12x87 | 12x89 | 0x42 | 0x44 |
| 13x13 | 13x15 | 64 | 66 |
| 37 | 39 | 88 | 90 |
| 63 | 65 | 1x125 | 1x145 |
| 88 | 90 | 375 | 395 |
| 14x135 | 14x155 | 64 | 66 |
| 37 | 39 | 88 ^s | 90 ^s |
| 63 | 65 | 2x13 | 2x15 |
| 88 | 90 | 375 | 395 |
| 15x14 | end of | 64 | 66 |
| Pipe in Flue Tank | | 88 | 90 |
| | | 5x14 | 3x16 |
| | | 3x41 | Inspector |
| | | B Street | |
| | | 3x59 | 6 in Y West |
| | | for B Street | |
| | | 4x19 | 4x21 |
| | | 42 ^s | 44 ^s |
| | | 68 ^s | 70 ^s |
| | | 94 | 96 |
| | | 5x18 | 5x20 |
| | | 42 ^s | 44 ^s |
| | | 68 | 70 |
| | | 94 | 96 |
| | | 6x18 | 6x20 |

19th North from N

| W | E | W | E |
|-------------------|-------------------|-------------------|--------------------|
| 0x40 | 0x42 | 6x69 | 6x71 |
| 0x42 | Prop line | 93 | 95 |
| 65 | x67 | 7x22 | Inspector |
| 89 ^s | 91 ^s | 50 line | of I St |
| 1x15 | 1x17 | 8x00 | 8x02 |
| 39 ^s | 41 ^s | 24 | 26 |
| 64 | 66 | 49 | 51 |
| 90 | 92 | 75 | 77 |
| 2x14 ^s | 2x16 ^s | 99 | 9x01 |
| 40 | 42 | 9x28 ^s | 25 ^s |
| 64 ^s | 66 ^s | 50 | 52 |
| 90 | 92 | 74 | 76 |
| 3x15 | 3x17 | 98 ^s | 10x00 ^s |
| 3x42 | Inspector | 10x25 | .27 |
| of M Street | sol line | .49 | .51 |
| 4x18 | 4x20 | .74 | .76 |
| 44 | 46 | 11x02 | Inspector |
| 69 | 71 | 80 line | K Street |
| 94 ^s | 96 ^s | 11x22 | 6 in Y |
| 5x19 | 5x21 | | East |
| 45 | 47 | 11x79 | 11x81 |
| 69 | 71 | 12x05 | 12x07 |
| 93 | 95 | 29 | .31 |
| 6x19 | 6x21 | 53 | 55 |
| 43 | 45 | 79 ^s | 81 ^s |

19th Street

| North of N. | | North from H | |
|-------------------------------|--------------------|-------------------|-------------------|
| W | E | W | E |
| 13x04 | 13x06 | 0x74 ^s | 0x76 ^s |
| 30 | 32 | x77 | Prop line |
| 54 | 56 | 1x00 | 1x02 |
| 78 | 80 | 24 ^s | 26 ^s |
| 14x05 | 14x07 | 48 ^s | 50 ^s |
| 28 | 30 | 75 | 77 |
| 54 ^s | 56 ^s | 99 | 2x01 |
| 14x82 | Inspector | 2x25 | 27 |
| South line | | 49 ^s | 51 ^s |
| of J Street | | 74 | 76 |
| 15x00 | 6 in Y | 3x00 | 3x02 |
| East for J St | | 24 | 26 |
| 15x60 | 15x62 | 50 | 52 |
| 84 ^s | 86 ^s | 3x86 | Inspector south |
| 16x08 ^s | 16x10 ^s | line of Y Street | |
| 34 ^s | 36 ^s | 4x55 | 6 in Y East |
| 58 ^s | 60 ^s | for Y Street | |
| 85 | 87 | 4x64 | 4x66 |
| 17x09 | 17x11 | 88 ^s | 90 ^s |
| 35 | 37 | 5x14 | 5x16 |
| 59 | 61 | 38 | 40 |
| 85 | 87 | 63 | 65 |
| 18x10 | 18x12 | 88 ^s | 90 ^s |
| 34 ^s | 36 ^s | 6x12 ^s | 6x14 ^s |
| x61 | end of hill | 39 | 41 |
| South line of 5 th | | | |
| Alburtark | | | |

20th Street

North from "N"

| W | E | W | E |
|----------------------|--------|-------------------|--------|
| 0x41 | 0x43 | 6x70.5 | 6x72.5 |
| 65 | 67 | 95 | 97 |
| 91 | 93 | 7x21 Inspection | |
| 1x15 | 1x17 | South line of | |
| 41 | 43 | I. Street | |
| 66 | 68 | 7x39 G in Y | |
| 90 | 92 | East for II | |
| 2x15.5 | 2x17.5 | 7x98 | 8x00 |
| 40 | 42 | 8x24 | 26 |
| 66 | 68 | 49 | 51 |
| 91 | 93 | 73 | 75 |
| 3x16 | 3x18 | 99 | 9x01 |
| 3x43 Inspection | | 9x24 | 26 |
| South line of M. St. | | 48.5 | . |
| 4x21 | 4x23 | 72.5 | |
| 46 | 48 | 99 | 10x01 |
| 70 | 72 | 10x23 | 25 |
| 96 | 98 | 49 | 51 |
| 5x25 | 5x27 | 74 | 76 |
| 45 | 47 | 11x03 Inspection | |
| 70 | 72 | South line K Sta | |
| 96 | 98 | 11x21-G in Y East | |
| 6x20.5 | 6x22.5 | 11x81 | 11x83 |
| 46 | 48 | 12x06 | 12x08 |
| | | 30.5 | 32.5 |

20th Street

North from N, South from I to J

| W | E | W | E |
|-------------------|---------|--------------------|--------|
| 12x54.5 | 12x56.5 | | |
| 80.5 | 82.5 | 0x57.5 | 0x59.5 |
| 13x06 | 13x08 | 85 | 87 |
| 31 | 33 | 1x08 | 1x10 |
| 55.5 | 57.5 | 33 | 35 |
| 80 | 82 | 57.5 | 59.5 |
| 14x06 | 14x08 | 83 | 85 |
| 30.5 | 32.5 | 2x07.5 | 2x09.5 |
| 56 | 58 | 33 | 35 |
| 14x85 end of Pipe | | 58 | 60 |
| in Flue tank | | 82.5 | 84.5 |
| 14x83 Prop. line | | 3x08 | 3x10 |
| South side of | | 33 | 35 |
| J. Street | | 3x60 end of | |
| | | Pipe for Flue tank | |

20th Street

North from I to F

| W | E | W | E |
|-------------------|-------------------|--------------------|--------------------|
| 0x58 ⁵ | 0x60 ⁵ | 6x88 | 6x90 |
| 85 | 87 | 7x12 | 7x14 |
| 1x10 | 1x12 | 38 | 40 |
| 34 | 36 | 7x77 | Inspection |
| 60 | 62 | so line of G. St. | |
| 83 ⁵ | 85 ⁵ | East for G. St. | |
| 2x09 | 2x11 | 8x54 ⁵ | 8x56 ⁵ |
| 35 | 37 | 80 | 82 |
| 59 ⁵ | 61 ⁵ | 9x05 | 9x07 |
| 84 | 86 | 29 ⁵ | 31 ⁵ |
| 3x10 | 3x12 | 54 | 56 |
| 34 | 36 | 80 | 82 |
| 3x65 | Inspection so | 10x05 | 10x07 |
| line of H Street | | 30 | 32 |
| 3x88 | 6 in East | 55 | 57 |
| for H Street | | 79 ⁵ | 81 ⁵ |
| 4x68 | 4x65 | 11x03 ⁵ | 11x05 ⁵ |
| 88 | 90 | 32 | 34 |
| 5x13 | 5x15 | 11x54 | 6 in |
| 37 | 39 | East for F. St. | |
| 63 | 65 | 11x58 | end of |
| 87 | 89 | Pipe in Flash tank | |
| 6x13 | 6x15 | | |
| 37 ⁵ | 39 ⁵ | | |
| 68 | 65 | | |

20th Street

South from C

| E | W | E | W |
|-------------------|-------------------|--------------------|-------------------|
| 0x58 | 0x40 | 6x18 ⁵ | 6x20 ⁵ |
| 64 | 66 | 44 | 46 |
| 88 | 90 | 69 | 71 |
| 1x14 | 1x16 | 93 ⁵ | 95 ⁵ |
| 38 ⁵ | 40 ⁵ | 7x21 | Inspection North |
| 63 | 65 | line of E Street | |
| 89 | 91 | 7x39 | 6 in East for B |
| 2x12 ⁵ | 2x14 ⁵ | 7x99 | 8x01 |
| 39 | 41 | 8x23 | 25 |
| 63 ⁵ | 65 ⁵ | 47 ⁵ | 49 ⁵ |
| 88 | 90 | 74 | 76 |
| 3x14 | 3x16 | 98 | 9x00 |
| 3x41 | Inspection North | 9x24 | 26 |
| line of G Street | | 49 | 51 |
| 3x57 | 6 in East for | 73 ⁵ | 75 ⁵ |
| G Street | | 97 ⁵ | 99 ⁵ |
| 3x59 | 6 in East | 10x24 | 10x26 |
| 4x18 ⁵ | 4x20 ⁵ | 49 | 51 |
| 44 | 46 | 74 | 76 |
| 69 | 71 | 11x00 | for Buck |
| 93 | 95 | 11x02 | end of |
| 5x19 | 5x21 | Pipe in Flash tank | |
| 43 | 45 | | |
| 67 ⁵ | 69 ⁵ | | |
| 94 | 96 | | |

21st Street

North of 12

| W | E | W | E |
|-------------------|-------------------|---------------------|-------------------|
| 0x59 | 0x41 | 6x95 ⁵ | 6x95 ⁵ |
| 62 | 64 | 7x21 | Inspector |
| 88 | 90 | So line of L Street | |
| 1x12 ⁵ | 1x14 ⁵ | 7x98 | 8x00 |
| 38 | 40 | 8x23 | 25 |
| 62 ⁵ | 64 ⁵ | 49 | 57 |
| 88 ⁵ | 90 ⁵ | 74 | 76 |
| 2x12 ⁵ | 2x14 ⁵ | 98 | 9x00 |
| 37 | 39 | 9x22 ⁵ | 24 ⁵ |
| 63 | 65 | 49 | 57 |
| 87 | 89 | 74 | 76 |
| 3x12 | 3x14 | 98 | 10x00 |
| 3x41 | Inspector south | 10x24 | 26 |
| line of M Street | | 48 ⁵ | 50 ⁵ |
| 4x18 | 4x20 | 74 | 76 |
| 42 ⁵ | 44 ⁵ | 11x01 | Inspector |
| 69 | 71 | So line of K Str. | |
| 93 ⁵ | 95 ⁵ | 11x19 | 6x4 |
| 5x17 ⁵ | 5x19 ⁵ | East for K Str. | |
| 44 | 46 | 11x77 | 11x79 |
| 68 | 70 | 12x05 | 12x05 |
| 92 ⁵ | 94 ⁵ | 28 | 30 |
| 6x19 | 6x21 | 52 | 54 |
| 43 ⁵ | 45 ⁵ | 79 | 81 |
| 67 | 69 | 13x08 | 13x05 |

21st Street

North of 12 = South of J Str

| W | E | W | E |
|----------------------|--------------------|-------------------|-------------------|
| 13x28 | 13x30 | 0x60 ⁵ | 0x58 ⁵ |
| 55 ⁵ | 55 ⁵ | 84 ⁵ | 82 ⁵ |
| 78 | 80 | 1x09 | 1x07 |
| 14x02 ⁵ | 14x04 ⁵ | 35 | 33 |
| 27 | 29 | 59 | 57 |
| 49 | 51 | 85 | 83 |
| 14x56 | end of Pipe | 2x07 ⁵ | 2x07 ⁵ |
| in Filurhtank | | 35 | 33 |
| 14x81 | Prop line | 60 | 58 |
| South line of J Str. | | 84 | 82 |
| | | 3x10 | 3x08 |
| | | 35 | 33 |
| | | 3x60 | end of Pipe |
| | | in Filurhtank | |
| | | North line | |
| | | of J Street | |

21st Street

North of J Street

| W | E | W | E |
|-------------------|-------------------|---------------------|-----------------|
| 0x86 ^s | 0x88 ^s | 7x42 | 7x44 |
| 1x12 | 1x14 | 67 | 69 |
| 36 ^s | 38 ^s | 8x06 | Inspection |
| 62 | 64 | South line of J St. | |
| 87 | 89 | 8x24 | 6 in Y East for |
| 2x12 | 2x14 | J Street | |
| 36 | 38 | 8x84 | 8x86 |
| 62 | 64 | 9x09 | 9x11 |
| 87 | 89 | 34 | 36 |
| 3x11 | 3x13 | 59 | 61 |
| 37 | 39 | 84 | 86 |
| 61 ^s | 63 ^s | 10x09 | 10x11 |
| 3x94 | Inspection South | 34 | 36 |
| line of K Street | | 58 ^s | 60 ^s |
| 4x21 | 6 in Y East | 83 | 85 |
| 4x92 | 4x94 | 11x09 | 11x11 |
| 5x17 | 5x19 | 33 ^s | 35 ^s |
| 42 | 44 | 58 | 60 |
| 66 ^s | 68 ^s | 11x85 | end of |
| 92 | 94 | Pipe in Flue tank | |
| 6x16 | 6x18 | 11x85 | Prop line |
| 42 | 44 | South line of | |
| 66 | 68 | J. Street | |
| 92 | 94 | | |
| 7x17 | 7x19 | | |

21st Street

South of C

| W | E | W | E |
|---------------------|-------------------|----------------------|-------------------|
| 0x40 | 0x42 | 6x69 | 6x71 |
| 65 | 67 | 95 | 97 |
| 89 | 91 | 7x22 | Inspection No |
| 1x15 | 1x17 | line of J Street | |
| 40 | 42 | 7x39 ^s | 6 in Y East |
| 64 | 66 | 7x99 ^s | 8x01 ^s |
| 90 | 92 | 8x25 | 27 |
| 2x14 | 2x16 | 49 | 51 |
| 40 | 40 | 73 ^s | 75 ^s |
| 64 | 66 | 99 ^s | 9x01 ^s |
| 90 | 92 | 9x24 | 26 |
| 3x14 | 3x16 | 50 | 52 |
| 3x42 | Inspection | 74 | 76 |
| no line of J Street | | 10x00 | 10x02 |
| 3x60 | 6 in Y East | 23 ^s | 25 ^s |
| 4x20 | 4x22 | 49 ^s | 51 ^s |
| 45 | 47 | 75 | 77 |
| 69 | 71 | 10x98 | 6 in Y East for J |
| 94 | 96 | 11x02 | end of Pipe |
| 5x18 ^s | 5x20 ^s | in Flue tank | |
| 45 | 47 | 11x02 | Prop line |
| 69 | 71 | South side of J. St. | |
| 95 | 97 | | |
| 6x19 | 6x21 | | |
| 45 | 47 | | |

21st Street

North of C

| W | E |
|-------------------|-------------------|
| 0x38 ⁵ | 0x40 ⁵ |
| 66 | 68 |
| 91 | 93 |
| 1x15 | 1x17 |
| 39 ⁵ | 41 ⁵ |
| 66 | 68 |
| 91 | 93 |
| 2x15 | 2x17 |
| 41 | 43 |
| 66 | 68 |
| 90 ⁵ | 92 ⁵ |

3x15 3x17
 3x40⁵ 6th Y East for 13 Street
 3x43 end of in Filbert tank
 on Prop line

22nd Street

North of 11

| W | E | W | E |
|-----------------------------------|-------------------|---------------------------------------|------------------------|
| Regon at 0 | | 6x67 ⁵ | 6x69 ⁵ |
| 0x37 | 0x39 | 91 ⁵ | 93 ⁵ |
| 62 ⁵ | 64 ⁵ | 7x20 | Inspection so |
| 86 | 88 | line of 2 nd Street | |
| 1x10 | 1x12 | 7x38 | 6 th Y West |
| 36 | 38 | 7x97 | 7x99 |
| 61 | 63 | 8x22 ⁵ | 8x24 ⁵ |
| 85 | 87 | 46 | 48 |
| 2x11 ⁵ | 2x13 ⁵ | 71 | 73 |
| 36 | 38 | 95 ⁵ | 97 ⁵ |
| 61 | 63 | 9x21 | 9x23 |
| 85 ⁵ | 87 ⁵ | 47 | 49 |
| 8x12 | 3x14 | 71 | 73 |
| 8x40 | Inspection | 96 | 98 |
| So line of 1 st Street | | 10x21 ⁵ | 10x23 ⁵ |
| 4x16 ⁵ | 4x18 ⁵ | 47 ⁵ | 49 ⁵ |
| 41 | 43 | 71 | 73 |
| 67 | 69 | 11x00 | Inspection |
| 91 | 93 | South line of 11 th Street | |
| 5x17 | 5x19 | 11x77 | 11x79 |
| 42 | 44 | 12x01 ⁵ | 12x03 ⁵ |
| 66 ⁵ | 68 ⁵ | 27 ⁵ | 29 ⁵ |
| 91 | 93 | 52 | 54 |
| 6x17 ⁵ | 6x19 ⁵ | 77 | 79 |
| 41 ⁵ | 43 ⁵ | 13x01 | 13x03 |

22nd Street
North of K

| W | E | W | E |
|---------------------------------------|--------------------|---------------------|--------------------|
| 13X27 ⁵ | 13X29 ⁵ | 19X61 ⁵ | 19X63 ⁵ |
| 52 ⁵ | 54 ⁵ | 86 | 88 |
| 77 ⁵ | 79 ⁵ | 20X12 ⁵ | 20X14 ⁵ |
| 14X02 | 14X04 | 36 ⁵ | 38 ⁵ |
| 28 | 30 | 61 | 63 |
| 52 | 54 | 87 ⁵ | 89 ⁵ |
| 14X80 Inspector Solari of J Street | | 21X11 | 21X13 |
| 14X98 6in Y west for J str. | | 87 | 89 |
| 15X57 | 15X59 | 62 ⁵ | 64 ⁵ |
| 83 | 85 | 86 | 88 |
| 16X07 ⁵ | 16X09 ⁵ | 22X11 | 22X13 |
| 31 | 33 | 22X47 Inspector So. | |
| 56 | 58 | line of H Street | |
| 82 | 84 | 22X70 6in Y | |
| 17X06 | 17X08 | East for H Str | |
| 32 | 34 | 23X43 | 23X45 |
| 56 | 58 | 69 | 71 |
| 82 | 84 | 93 ⁵ | 95 ⁵ |
| 18X06 ⁵ | 18X08 ⁵ | 24X18 | 24X20 |
| 32 ⁵ | 34 ⁵ | 44 ⁵ | 46 ⁵ |
| 18X60 Inspector Solari of J Street | | 69 | 71 |
| 18X78 6in Y East for J | | 93 ⁵ | 95 ⁵ |
| 19X37 | 19X39 | 25X20 | 25X22 |
| | | 44 ⁵ | 46 ⁵ |
| | | 68 ⁵ | 70 ⁵ |

22nd Street

| W | E | W | E |
|---------------------------------------|--------------------|---|--------------------|
| 25X94 ⁵ | 25X96 ⁵ | 32X42 ⁵ | 32X44 ⁵ |
| 26X18 ⁵ | 26X20 ⁵ | 68 | 70 |
| 26X60 Inspector Solari of G Street | | 92 ⁵ | 94 ⁵ |
| 26X78 6in Y East for G | | 33X18 | 33X20 |
| 26X80 Reducer 8to6in | | 42 ⁵ | 44 ⁵ |
| 27X88 | 27X40 | 67 | 69 |
| 63 | 65 | 92 ⁵ | 94 ⁵ |
| 87 | 89 | 34X20 Inspector South | |
| 28X115 | 28X13 ⁵ | line of E Street | |
| 37 ⁵ | 39 ⁵ | 34X99 | 34X01 |
| 62 ⁵ | 64 ⁵ | 35X21 ⁵ | 23 ⁵ |
| 87 | 89 | 47 | 49 |
| 29X12 ⁵ | 29X14 ⁵ | 71 | 73 |
| 38 | 40 | 97 | 99 |
| 61 ⁵ | 63 ⁵ | 36X21 ⁵ | 36X23 ⁵ |
| 88 | 90 | 45 ⁵ | 47 ⁵ |
| 30X12 ⁵ | 30X14 ⁵ | 72 | 74 |
| 30X40 Inspector South | | 97 | 99 |
| line of F Street | | 37X23 | 37X25 |
| 31X17 ⁵ | 31X19 ⁵ | 47 ⁵ | 49 ⁵ |
| 41 ⁵ | 43 ⁵ | 73 | 75 |
| 68 | 70 | 38X00 end of Pipe on F Street in Humboldt | |
| 87 | 89 | | |
| 32X16 ⁵ | 32X18 ⁵ | | |

22nd Street

South of C

North of C

| W | E | W | E |
|--|-------------------|--|-------------------|
| 0x36 ^s | 0x38 ^s | 0x41 | 0x43 |
| 62 ^s | 64 ^s | 66 | 68 |
| 89 | 91 | 90 ^s | 92 ^s |
| 1x12 ^s | 1x14 ^s | 1x16 | 1x18 |
| 38 ^s | 40 ^s | 39 ^s | 41 ^s |
| 62 ^s | 64 ^s | 67 | 69 |
| 88 | 90 | 90 ^s | 92 ^s |
| 2x12 ^s | 2x14 ^s | 2x16 ^s | 2x18 ^s |
| 38 | 40 | 40 | 42 |
| 62 ^s | 64 ^s | 67 | 69 |
| 89 | 91 | 91 ^s | 93 ^s |
| 3x16 end of Pipe in Filtration tank | | 3x19 end of Pipe in Filtration tank | |

22nd Street Branched from
H Street from 22 to 24th = 4th Stn from 22 to 23rd

| North | South | North | South |
|-------------------|-----------------------------------|----------------------------------|-----------|
| 0x40 ^s | 0x42 ^s | 0x40 | Prop Line |
| 65 | 67 | 42 | 0x44 |
| 89 | 91 | 68 | 70 |
| 1x15 | 1x17 | 92 | 94 |
| 39 | 41 | 1x18 | 1x20 |
| 65 | 67 | 41 | 43 |
| 89 ^s | 91 ^s | 68 | 70 |
| 2x13 ^s | 2x15 ^s | 93 | 95 |
| 39 ^s | 41 ^s | 2x19 | Inspector |
| 64 | 66 | west line of 2 nd Stn | |
| 90 | 92 | (2x14 Prop line) | |
| 3x14 | 3x16 | | |
| 40 | 42 | | |
| 64 | 66 | | |
| 90 | 92 | | |
| 4x14 | 4x16 | | |
| 4x44 | end of Pipe in Filtration tank | | |

23rd Street
North of G Street

| W | E |
|-------------------|-------------------|
| 0x62 | 0x64 |
| 0x66 | Prop line |
| 88 | 0x90 |
| 1x14 | 1x16 |
| 88 ^E | 40 ^E |
| 64 | 66 |
| 88 ^E | 90 ^E |
| 2x13 ^E | 2x15 ^E |
| 89 | 41 |
| 62 | 64 |
| 88 ^E | 90 ^E |
| 3x14 | 3x16 |
| 39 | 41 |
| 3x67 | Inspection south |
| line of F Street | |
| 4x44 | 4x46 |
| 68 ^E | 70 ^E |
| 92 | 94 |
| 5x18 ^E | 5x20 ^E |
| 42 | 44 |
| 68 ^E | 70 ^E |
| 93 | 95 |
| 6x19 | 6x21 |
| 43 | 45 |
| 67 | 67 |

| W | E |
|---------------------|---------------------|
| 6x93 | 6x95 |
| 7x19 | 7x21 |
| 7x46 | Inspection |
| So line of E St | |
| 8x22 ^E | 8x24 ^E |
| 8x34 | Begin wooden Bot |
| 8x50 ^E | 8x52 ^E |
| 74 ^E | 76 ^E |
| 8x93 | end of Bot |
| 8x96 ^E | 8x98 ^E |
| 9x22 ^E | 9x24 ^E |
| 48 | 50 |
| 72 | 74 |
| 98 | 10x00 |
| 10x22 ^E | 24 ^E |
| 48 | 50 |
| 72 | 74 |
| 97 ^E | 99 ^E |
| 11x26 | Inspection |
| So line of D Street | |
| 12x02 ^E | 12x04 ^E |
| 27 ^E | 29 ^E |
| 54 | 56 |
| 77 ^E | 79 ^E |
| 13x03 ^E | 13x05 ^E |

23rd Street

| W | E |
|--------------------|--------------------|
| 13x27 ^E | 13x29 ^E |
| 53 | 55 |
| 77 | 79 |
| 14x04 | 14x06 |
| 27 | 29 |
| 55 ^E | 55 ^E |
| 78 | 80 |
| 15x06 | Inspection So. |
| line of C Street | |
| 15x84 | 15x86 |
| 16x07 ^E | 16x09 ^E |
| 34 | 36 |
| 57 | 59 |
| 83 ^E | 85 ^E |
| 17x07 ^E | 17x09 ^E |
| 34 | 36 |
| 58 | 60 |
| 84 | 86 |
| 18x08 ^E | 18x10 ^E |
| 33 | 35 |
| 18x60 | end of Prop |
| in Filbert Park | |
| 18x86 | Prop line |
| on B Street | |

N Street

East from 8th Street

| North | South | North | South |
|---|-------|--|-------|
| 0x62 ⁵ 6in Y north for 8 th Street | | 12x49 ⁵ | |
| 1x9 | 1x11 | 14x00 Inspection on Prop line west side of 13 th St | |
| 79 | 81 | 14x18-6in Y north for 13 th Street | |
| 2x10 | 2x12 | | |
| | 28 | 14x80 Prop line East side of 13 th St | |
| 2x97 6in Y north. 17 ft from line of Building | | 15x15 | |
| 4x08 | | 15x65 16x14 ⁵ | |
| 4x59 ⁵ | 5x10 | 16x90 Prop line West side of 14 th St | |
| 5x77 6in Y for 10 th Street | | 16x90 Inspection | |
| 6x79 ⁵ | | 16x99-6in Y north for 14 th Street | |
| 7x39 ⁵ 7x89 ⁵ | | 17x91 17x89 | |
| 8x40 Inspection | | 18x40 18x38 | |
| 8x58 6in Y north for 11 th Street | | 90 ⁵ 88 ⁵ | |
| 9x69 | | 19x40 ⁵ 19x38 ⁵ | |
| 10x20 ⁵ 10x68 ⁵ | | 90 88 | |
| 11x37 6in Y for 12 th St | | 20x40 20x38 | |
| | North | 90 88 | |
| 11x70-8 ⁵ 6in Reducer | | 21x40 Inspection | |
| 12x00 Inspection 12 th St. | | 21x69 6in Y north for 15 th Street | |
| on Prop line | | 21x90 Prop line west side of 15 th St | |
| 12x00 Prop line | | | |

N Street,

16th St from 12

| North | South | W | E |
|--|-------|--|---|
| 22x89 ⁵ | | 24x62 Prop line North side of N St. | |
| 23x59 ⁵ 23x89 | | 24x67 24x65 | |
| 24x29 Prop line west side of 16 th Street | | 92 90 | |
| 24x36 Inspection | | 25x20 25x18 | |
| | | 44 ⁵ 42 ⁵ | |
| | | 68 ⁵ 66 ⁵ | |
| | | 96 94 | |
| | | 26x25 26x19 ⁵ | |
| | | 45 43 | |
| | | 70 68 | |
| | | 95 93 | |
| 10 ft out East of property line fence N + 14 th | | 27x21 27x19 | |
| | | 47 45 | |
| | | 27x58 6in Y West from M Street | |
| | | 27x60 end of Pipe in Flue tank, | |

16th Street south
from II. Street

| West | East | North | South |
|--|------|--|-----------------|
| 0x75 Prop line south side of II. Str | | 4x76 | 4x78 |
| 0x76 0x74 | | 5x81 | Manhole |
| 1x01 99 | | 6x03 | 6x12 V |
| 25 ⁵ 1x28 ⁵ | | north for 17 th St | |
| 49 ⁵ 47 ⁵ | | 6x12 - 6 by 12 V | |
| 76 74 | | East for M Street | |
| 2x00 98 | | → | |
| 24 ⁵ 1x22 ⁵ | | 17 th Street | |
| 50 ⁵ 48 ⁵ | | East West | |
| 75 73 | | 6x70 | 6x72 |
| 99 97 | | 6x80 Prop line So. | |
| 8x25 ⁵ 5x28 ⁵ | | side of M. Street | |
| 8x35 Inspection 1 - 12 in V turned up | | 7x20 | 7x22 |
| 39 ft north of north line of M Street | | 70 | 72 |
| 8x48 | | 8x20 | 8x22 |
| | | 69 ⁵ | 71 ⁵ |
| 3x50 = 24 ft north of north line of M Street | | 9x21 | 9x31 |
| 8x75 Prop line north line of M Street | | 52 ⁵ | 54 ⁵ |
| 4x17 Prop line east side of 16 th Street | | 9x70 Prop line | |
| 4x20 Inspection M Street | | North side of 12 Street | |
| | | 10x12 Prop line East side of 17 th Street | |

12 Street East from 17th St

| North | South | North | South |
|--|--------------------|--------------------|---|
| 10x59 | 10x61 | 15x10 | 6 in V north for 19 th Street |
| 85 | 87 | 15x70 | 15x72 |
| 11x09 ⁵ | 11x11 ⁵ | 96 ⁵ | 98 ⁵ |
| 35 | 37 | 16x21 | 16x23 |
| 60 | 62 | 45 ⁵ | 47 ⁵ |
| 85 | 87 | 70 ⁵ | 72 ⁵ |
| 12x12 Prop line west side of 18 th Street | | 95 | 97 |
| 12x12 end of 12 in Pipe in Manhole | | 17x19 ⁵ | 17x45 ⁵ |
| 12x17 8 in Pipe begins west line of 20 th Street | | 17x72 | Inspection |
| 12x24 6 in V north for 18 th Street | | 17x72 Prop line | |
| 12x92 Prop line east side of 18 th Street | | 17x90 | 6 in V north for 20 th Street |
| 12x91 ⁵ | 12x93 ⁵ | 18x50 | 18x52 |
| 13x16 ⁵ | 13x18 ⁵ | 18x52 | Prop line |
| 41 ⁵ | 43 ⁵ | 18x77 | 18x79 |
| 66 ⁵ | 68 ⁵ | 19x01 | 19x03 |
| 91 | 93 | 26 | 28 |
| 14x16 | 14x18 | 50 | 52 |
| 44 | 46 | 76 | 78 |
| 66 | 68 | 20x00 ⁵ | 20x02 ⁵ |
| 14x91 ⁵ | Inspection | 25 | 27 |
| West line of 19 th Street | | 20x52 | Prop line west side of 21 st Street |

12 Street East of 21st St

| North | South |
|--------------------------------------|--------------------|
| 20x69 ⁵ | 8x6y |
| North for 21 st Street | |
| 21x82 Prop line | |
| East side of 21 st Street | |
| 21x80 ⁵ | 21x32 ⁵ |
| 56 | 58 |
| 81 | 83 |
| 22x05 | 22x07 |
| 31 | 33 |
| 56 | 58 |
| 81 | 83 |
| 23x06 | 23x08 |
| 23x80 ⁵ Inspector | |
| 23x82 Prop line East | |
| side of 22 nd Street | |
| 23x49 | 8x8y for |
| 22 nd Street | |
| 24x12 Prop line east | |
| side of 22 nd Street | |
| 24x11 | 24x13 |
| 36 | 38 |
| 60 | 62 |
| 85 | 87 |
| 25x11 | 25x13 |
| 35 | 37 |

24th Street

| West North | West South | W | E |
|---------------------------|--------------------|----------------------|--------------------|
| 30x06 | 30x08 | 35x07 | 8x6y East |
| 31 | 33 | for II Street | |
| 56 | 58 | 36x12 | 80x14 |
| 81 | 83 | 37 | 39 |
| 31x06 | 31x08 | 61 ⁵ | 63 ⁵ |
| 31 | 33 | 85 ⁵ | 87 ⁵ |
| 31x62 Inspector North | | 37x12 | 37x14 |
| of South line of M Street | | 36 | 38 |
| 31x75 8x6y West for | | 62 | 64 |
| M Street | | 86 | 88 |
| 32x33 | 32x35 | 38x11 | 38x13 |
| 59 | 61 | 37 | 39 |
| 83 ⁵ | 85 ⁵ | 61 | 63 |
| 33x08 | 33x10 | 87 | 89 |
| 34 ⁵ | 36 ⁵ | 39x14 Inspector | |
| 60 | 62 | K Street | |
| 34 ⁵ | 36 ⁵ | 39x31 6in y West for | |
| 34x08 ⁵ | 34x10 ⁵ | K Street | |
| 35 ⁵ | 37 | 39x46 6in y East | |
| 59 ⁵ | 61 ⁵ | for K Street | |
| 84 | 86 | 39x91 ⁵ | 39x93 ⁵ |
| 35x10 | 35x12 | 40x16 | 40x18 |
| 35x35 Inspector II St. | | 42 | 44 |
| 35x52 8x6y West | | 67 ⁵ | 69 ⁵ |
| for II Street | | 92 | 94 |

24th Street

| W | E | W | E |
|--------------------|---------------------|--------------------|--------------------|
| 41x16 ^s | 41x18 ^s | 47x52 | 47x54 |
| 41 | 48 | 77 | 79 |
| 66 | 68 | 48x02 ^s | 48x04 ^s |
| 41x99 | Inspector J. Street | 27 | 29 |
| 42x89 | Reduces 8 to 6 | 52 | 54 |
| 43x11 ^s | 6 in V West for J | 76 | 78 |
| 45x27 | 6 in V East " J | 48x98 | 6 in V |
| 45x73 | 45x75 | East for | Ally |
| 97 ^s | 99 ^s | 49x01 | 49x03 |
| 44x20 | 44x22 | 26 | 28 |
| 47 | 49 | 57 | 58 |
| 71 ^s | 73 ^s | 77 | 79 |
| 97 ^s | 99 ^s | 50x02 | 50x04 |
| 45x17 | 6 in V East | 26 | 28 |
| for Ally | | 50x62 | Inspection |
| 45x21 ^s | 45x23 ^s | South side of | H Street |
| 47 | 49 | 50x94 ^s | 6 in V |
| 72 ^s | 74 ^s | East for H. Street | |
| 97 ^s | 99 ^s | 51x60 ^s | 51x62 ^s |
| 46x22 | 46x24 | 84 | 86 |
| 47 | 49 | 52x09 | 52x11 |
| 46x74 | Inspector | 34 | 36 |
| I Street | | 60 ^s | 62 ^s |
| 47x08 | 6 in V East | 85 | 87 |
| for I Street | | | |

24th Street

| W | E | W | E |
|--------------------|--------------------|---------------------|-------------------|
| 53x01 | 6 in V East | 58x27 | 58x29 |
| for Ally | | 58x56 ^s | Inspection 1/2 |
| 53x09 ^s | 53x11 ^s | ft north of south | line of H. Street |
| 35 ^s | 37 ^s | 58x72 ^s | 6 in V East |
| 60 | 62 | for H Street | |
| 85 ^s | 87 ^s | 59x33 | 59x35 |
| 54x10 | 54x12 | 58 | 60 |
| 36 | 38 | 82 | 84 |
| 54x75 | Inspector So. | 60x08 | 60x10 |
| side of G Street | | 32 ^s | 34 ^s |
| 54x93 | 6 in V East | 57 | 59 |
| for G Street | | 60x63 | 6 in V East |
| 55x53 ^s | 55x55 ^s | for Ally | |
| 77 | 79 | 60x83 | 60x85 |
| 56x02 | 56x04 | 61x07 | 61x09 |
| 27 | 29 | 32 | 34 |
| 52 | 54 | 58 | 60 |
| 77 | 79 | 82 ^s | 84 ^s |
| 56x82 | 6 in V | 62x07 | 62x09 |
| East for Ally | | 62x36 | Inspector |
| 57x62 ^s | 57x64 ^s | 1 ft north of south | line of E Street |
| 27 | 29 | 62x53 | 6 in V East |
| 52 | 54 | for I St. | |
| 78 | 80 | | |
| 58x03 | 58x05 | | |

24th Street

| W | E | W | E |
|--------------------|--------------------|-----------------------|--------------------|
| 63x12 ⁵ | 63x14 ⁵ | 68x17 ⁵ | 68x19 ⁵ |
| .37 | .39 | 68x23 ⁵ | 6 in Y |
| .65 | .67 | East for Alley. | |
| .88 | .90 | 68x45 ⁵ | 68x45 ⁵ |
| 64x12 | 64x14 | .68 | .70 |
| .38 | .40 | .93 ⁵ | .95 ⁵ |
| 64x42 | 6 in Y East | 69x18 | 69x20 |
| for Alley | | .42 ⁵ | .44 ⁵ |
| 64x63 | 64x65 | .67 | .69 |
| .88 ⁵ | .90 ⁵ | 69x94 | Inspection |
| 65x13 | 65x15 | 1 ft south of | |
| .37 | .39 | south line of C. Str. | |
| .63 ⁵ | .65 ⁵ | 69x95 | Prop line |
| .88 | .90 | So line of C Str | |
| 66x15 | Inspection south | 70x13 | 6 in Y East |
| side of X Street | | for C Street | |
| 66x33 | 6 in Y East | 70x71 ⁵ | 70x73 ⁵ |
| for II Street | | .96 ⁵ | .98 ⁵ |
| 66x93 | 66x95 | 71x21 | 71x23 |
| 66x93 | Prop line north | .47 | .49 |
| line of II Street | | .71 ⁵ | .73 ⁵ |
| 67x18 | 67x20 | .97 ⁵ | .99 ⁵ |
| .42 ⁵ | .44 ⁵ | 72x23 | 6 in Y East |
| .68 ⁵ | .70 ⁵ | for Alley | |
| .93 | .95 | 72x21 ⁵ | 72x23 ⁵ |

24th Street

171 Street west from
24th Str.

| W | E | South | North |
|-----------------------|------------------|-------------------|-------------------|
| 72x48 | 72x50 | 0x32 ⁵ | 0x34 ⁵ |
| .71 ⁵ | .73 ⁵ | .56 | .58 |
| .96 | .98 | .79 | .81 |
| 73x22 | 73x24 | 1x05 | 1x07 |
| .42 | .44 | .30 | .32 |
| 73x50 end of 6 in | | .56 | .58 |
| pipe in Filamentark | | .80 | .82 |
| 73x75 | Prop line | 2x04 | 2x06 |
| south line of B. Str. | | .30 | .32 |
| | | .54 ⁵ | .56 ⁵ |
| | | .79 | .81 |
| | | 3x05 ⁵ | 3x05 ⁵ |
| | | .30 | .32 |
| | | .54 | .56 |
| | | .80 | .82 |
| | | 4x04 | 4x06 |
| | | .26 | .28 |
| | | 4x33 end of Pipe | |
| | | on M Street | |

I. Street
West from 24th

South North

Began at 0

0x36 0x38

.64 .66

.88 .90

1x12 1x14

.88⁵ .40⁵

.61 .63

.87 .89

2x13 2x15

.88⁵ .40⁵

.64 .66

.89⁵ .91⁵

3x14 3x16

.87⁵ .89⁵

4x15⁵ 4x17⁵

4x22 end of Pipe
in Flushing tank

K. Street
West of 24th

South North

Began at Sta 0

0x31 0x33

.62 .64

.93 .95

1x18⁵ 1x20⁵

.43 .45

.67⁵ .69⁵

.93⁵ .95⁵

2x17⁵ 2x19⁵

.43⁵ .45⁵

.68 .70

.93 .95

3x19⁵ 3x21⁵

.43⁵ .45⁵

.68 .70

.93⁵ .95⁵

4x15 4x17
4x21⁵ end of
Pipe in Flushing tank

J. Street
from 24th to 22nd

South North

Began at 0

0x31 0x33

.54⁵ .56⁵

.81 .83

1x05 1x07

.31 .33

.56 .58

.80⁵ .82⁵

2x05 2x07

.29⁵ .31⁵

.55 .57

.80 .82

3x04 3x06

.30⁵ .32⁵

.55 .57

.80 .82

4x06 4x08
4x38 end of Pipe
in

I Street
East from 22 to 24th

North South

Began at 0

0x39 0x41

0x42 Prop line East
side of 22nd Street

0x64 0x66

.90 .92

1x14⁵ 1x16⁵

.39 .41

.65 .67

.89⁵ .91⁵

2x14 2x16

.40 .42

.64⁵ .66⁵

.89 .91

3x15 3x17

.40 .42

.64 .66

.90 .92

4x15 4x17

4x46 end of Pipe

4x46 Prop line

West side of

24th Street

TRAVERSE TABLE FOR TRANSIT BOOK,
From 1° to 90° for a distance of 100.

| Degrees. | DEGREES. | | ¼ DEGREE. | | ½ DEGREE. | | ¾ DEGREE. | | Degrees. |
|----------|----------|-------|-----------|-------|-----------|-------|-----------|-------|----------|
| | Lat. | Dep. | Lat. | Dep. | Lat. | Dep. | Lat. | Dep. | |
| 0 | | | 100.00 | 0.44 | 100.00 | 0.87 | 99.99 | 1.31 | 85 |
| 1 | 99.98 | 1.75 | 99.98 | 2.18 | 99.97 | 2.62 | 99.95 | 3.05 | 84 |
| 2 | 99.94 | 3.49 | 99.92 | 3.93 | 99.91 | 4.36 | 99.88 | 4.80 | 83 |
| 3 | 99.86 | 5.23 | 99.84 | 5.67 | 99.81 | 6.10 | 99.79 | 6.54 | 82 |
| 4 | 99.76 | 6.98 | 99.73 | 7.41 | 99.69 | 7.85 | 99.66 | 8.28 | 81 |
| 5 | 99.62 | 8.72 | 99.58 | 9.15 | 99.54 | 9.58 | 99.50 | 10.02 | 80 |
| 6 | 99.45 | 10.45 | 99.41 | 10.89 | 99.36 | 11.32 | 99.31 | 11.75 | 79 |
| 7 | 99.25 | 12.19 | 99.20 | 12.62 | 99.14 | 13.05 | 99.09 | 13.49 | 78 |
| 8 | 99.03 | 13.92 | 98.97 | 14.35 | 98.90 | 14.78 | 98.84 | 15.21 | 77 |
| 9 | 98.77 | 15.64 | 98.70 | 16.07 | 98.63 | 16.50 | 98.56 | 16.93 | 76 |
| 10 | 98.48 | 17.36 | 98.40 | 17.79 | 98.33 | 18.22 | 98.25 | 18.65 | 75 |
| 11 | 98.16 | 19.08 | 98.08 | 19.51 | 97.99 | 19.94 | 97.90 | 20.36 | 74 |
| 12 | 97.81 | 20.79 | 97.72 | 21.22 | 97.63 | 21.64 | 97.53 | 22.07 | 73 |
| 13 | 97.44 | 22.50 | 97.34 | 22.92 | 97.24 | 23.34 | 97.13 | 23.77 | 72 |
| 14 | 97.03 | 24.19 | 96.92 | 24.62 | 96.81 | 25.04 | 96.70 | 25.46 | 71 |
| 15 | 96.59 | 25.88 | 96.48 | 26.30 | 96.36 | 26.72 | 96.25 | 27.14 | 70 |
| 16 | 96.13 | 27.56 | 96.00 | 27.98 | 95.88 | 28.40 | 95.76 | 28.82 | 69 |
| 17 | 95.63 | 29.24 | 95.50 | 29.65 | 95.37 | 30.07 | 95.24 | 30.49 | 68 |
| 18 | 95.11 | 30.90 | 94.97 | 31.32 | 94.83 | 31.73 | 94.69 | 32.14 | 67 |
| 19 | 94.55 | 32.56 | 94.41 | 32.97 | 94.26 | 33.38 | 94.12 | 33.79 | 66 |
| 20 | 93.97 | 34.20 | 93.82 | 34.61 | 93.67 | 35.02 | 93.51 | 35.43 | 65 |
| 21 | 93.36 | 35.84 | 93.20 | 36.24 | 93.04 | 36.65 | 92.88 | 37.06 | 64 |
| 22 | 92.72 | 37.46 | 92.55 | 37.86 | 92.39 | 38.27 | 92.22 | 38.67 | 63 |
| 23 | 92.05 | 39.07 | 91.88 | 39.47 | 91.71 | 39.87 | 91.53 | 40.27 | 62 |
| 24 | 91.35 | 40.67 | 91.18 | 41.07 | 91.00 | 41.47 | 90.81 | 41.87 | 61 |
| 25 | 90.63 | 42.26 | 90.45 | 42.66 | 90.26 | 43.05 | 90.07 | 43.44 | 60 |
| 26 | 89.88 | 43.84 | 89.69 | 44.23 | 89.49 | 44.62 | 89.30 | 45.01 | 59 |
| 27 | 89.10 | 45.40 | 88.90 | 45.79 | 88.70 | 46.17 | 88.50 | 46.56 | 58 |
| 28 | 88.29 | 46.95 | 88.09 | 47.33 | 87.88 | 47.72 | 87.67 | 48.10 | 57 |
| 29 | 87.46 | 48.48 | 87.25 | 48.86 | 87.04 | 49.24 | 86.82 | 49.62 | 56 |
| 30 | 86.60 | 50.00 | 86.38 | 50.38 | 86.16 | 50.75 | 85.94 | 51.13 | 55 |
| 31 | 85.72 | 51.50 | 85.49 | 51.88 | 85.26 | 52.25 | 85.04 | 52.62 | 54 |
| 32 | 84.80 | 52.99 | 84.57 | 53.36 | 84.34 | 53.73 | 84.10 | 54.10 | 53 |
| 33 | 83.87 | 54.46 | 83.63 | 54.83 | 83.39 | 55.19 | 83.15 | 55.56 | 52 |
| 34 | 82.90 | 55.92 | 82.66 | 56.28 | 82.41 | 56.64 | 82.16 | 57.00 | 51 |
| 35 | 81.92 | 57.36 | 81.66 | 57.71 | 81.41 | 58.07 | 81.16 | 58.42 | 50 |
| 36 | 80.90 | 58.78 | 80.64 | 59.13 | 80.39 | 59.48 | 80.13 | 59.83 | 49 |
| 37 | 79.86 | 60.18 | 79.60 | 60.53 | 79.34 | 60.88 | 79.07 | 61.22 | 48 |
| 38 | 78.80 | 61.57 | 78.53 | 61.91 | 78.26 | 62.25 | 77.99 | 62.59 | 47 |
| 39 | 77.71 | 62.93 | 77.44 | 63.27 | 77.16 | 63.61 | 76.88 | 63.94 | 46 |
| 40 | 76.60 | 64.28 | 76.32 | 64.61 | 76.04 | 64.94 | 75.76 | 65.28 | 45 |
| 41 | 75.47 | 65.61 | 75.18 | 65.93 | 74.90 | 66.26 | 74.61 | 66.59 | 44 |
| 42 | 74.31 | 66.91 | 74.02 | 67.24 | 73.73 | 67.56 | 73.43 | 67.88 | 43 |
| 43 | 73.14 | 68.20 | 72.84 | 68.52 | 72.54 | 68.84 | 72.24 | 69.15 | 42 |
| 44 | 71.93 | 69.47 | 71.63 | 69.78 | 71.33 | 70.09 | 71.02 | 70.40 | 41 |
| 45 | 70.71 | 70.71 | | | | | | | |

Published by Edward Denny & Co., Stationers, Drawing Materials,
Mathematical Instruments, Etc., San Francisco.